



Cliff Berry, Incorporated
Environmental Services

RECEIVED
JAN 08 2010
DEPT of ENV PROTECTION
WEST PALM BEACH

January 7, 2010

Ms. Karen Kantor, P.G.
Permitting Coordinator
Florida Department of Environmental Protection Southeast District (FDEP)
400 N. Congress Avenue
Suite 200
West Palm Beach, Florida 33401

RE: Cliff Berry, Inc. - Miami Facility
EPA ID Number: FLD 058 560 699
Used Oil Processing Facility Permit Number: 77628-HO-003

Dear Ms. Kantor:

Cliff Berry, Inc. (CBI) has received your Hazardous Waste / Used Oil Inspection Report dated December 10, 2009 concerning the above referenced facility. Specifically, you listed eight (8) items that CBI needs to address. (See Attachment No. 1)

I reviewed your inspection report and personally followed up on the matter. Listed below is each item in order from your report and our response in bold:

A. Item No. 1 - Potential Violation of Rule 262.11:

One unlabeled 55-gallon drum of unknown contents was observed in the unloading pit area. A partial identifier indicating " Pep Boys " was noted.

The drum in question was labeled from the generator with the type of waste, however the address on the label was not specific. The drum has been properly disposed of and a copy of the Bill of Lading and pictures of the above referenced drum are attached.

(See Attachment No. 2)

B. Item No. 2 - Potential Violation of Rule 62-730.171(2)(a):

Employee training records were not available for review during the inspection.

A copy of all of the employee training records are attached for your review.

(See Attachment No. 3)

C. Item No. 3 - Area Of Concern - Rule 62-710.850(5)(a):

Release of used oil was observed beneath the inoperable filter crusher.

The very small release of used oil observed beneath the out of service used oil filter crusher was cleaned up immediately. It should be noted, the spot of oil was very small, in a secondary contained area and inside the warehouse. Please see the attached picture of the clean area.

(See Attachment No. 4)

D. Item No. 4 - Potential Violation of Rule 279.54(b):

One frac tank stored within the solid waste roll-off storage area is leaking used oil into secondary containment.

The leak has been taken care and the used oil has been cleaned up. The frac tank is empty and clean. Please see the attached pictures.

(See Attachment No. 5)

E. Item No. 5 - Potential Violation of Rule 279.54(c):

The secondary containment of the solid waste roll-off storage area is not adequate to hold the leaking frac tank. In addition, the area is not intended to hold used oil containers.

The frac tank is empty and clean. The frac tank is just parked in the roll-off storage area; it does not contain any used oil. Please see the attached pictures.

(See Attachment No. 6)

F. Item No. 6 - Potential Violation of Rule 279.52(b)(2):

Inspectors noted the Contingency Plan lacked the locations of emergency equipment within the facility.

The SPCC Plan has been updated to show the location of the emergency equipment within the facility. Please see a copy of the revised page from the SPCC Plan.

(See Attachment No. 7)

G. Item No. 7 - Potential Violation of Rule 279.52(b)(3):

Documentation of the distribution of the facility's current Contingency Plan was not available during the inspection.

Revised copies of the CBI - Miami Facility SPCC Plan have been redistributed. Please see the attached cover letters and FedEx receipts.

(See Attachment No. 8)

H. Item No. 8 - Are Of Concern - Rule 62-710.800(3)(a):

Facility did not have a copy of the approved Closure Plan for the facility.

A copy of the approved CBI - Miami Facility Closure Plan is provided for your review. The facility now has a copy of the Closure Plan also.

(See Attachment No. 9)

Thankyou for bringing the above items to our attention so that they could be corrected. We look forward to a continued close working relationship with the FDEP Southeast District.

If you have any questions or need any additional information please contact me at (954) 763-3390 or e-mail me at bparkes@cliffberryinc.com.

Sincerely,

A handwritten signature in black ink, appearing to read 'W. E. Parkes, Jr.', with a stylized flourish at the end.

William E. Parkes, Jr.
Manager Regulatory Affairs and Capital Projects
Cliff Berry, Inc. (CBI)

RECEIVED
JAN 08 2010
DEPT of ENV PROTECTION
WEST PALM BEACH

ATTACHMENT NO. 1



Florida Department of
Environmental Protection
Hazardous Waste Inspection Report

Draft

FACILITY INFORMATION:

Facility Name: Cliff Berry Inc - Miami Terminal

On-Site Inspection Start Date: 12/10/2009

On-Site Inspection End Date: 12/10/2009

ME ID#: 51668

EPA ID#: FLD058560699

Facility Street Address: 3033 NW North River Dr, Miami, Florida 33142-6304

Contact Mailing Address: PO Box 13079, Fort Lauderdale, Florida 33316-0100

County Name: Miami-Dade

Contact Phone: (954) 763-3390

NOTIFIED AS:

CESQG (<100 kg/month)

Transporter

Used Oil

INSPECTION TYPE:

Routine Inspection for Used Oil Processor facility

Routine Inspection for Hazardous Waste Transporter facility

Routine Inspection for Transfer Facility

Routine Inspection for Used Oil Transfer Facility

Routine Inspection for Universal Waste Transporter facility

INSPECTION PARTICIPANTS:

Principal Inspector: Karen E Kantor, Inspector

Other Participants: Kathy Winston, Environmental Consultant; Leroy Arce, Facility Manager; Zack Davis, Project Manager

LATITUDE / LONGITUDE: Lat 25° 47' 47.6926" / Long 80° 14' 38.8063"

SIC CODE: 4953 - Trans. & utilities - refuse systems

TYPE OF OWNERSHIP: Private

New Potential Violations and Areas of Concern:

CESQG Checklist - 40 CFR 261.5

Type: Violation

Rule: 262.11

Question Number: 7.1

Question: Did the facility conduct a waste determination on all wastes generated?

Explanation: One unlabeled 55-gallon drum of unknown contents was observed in the unloading pit area. A partial identifier indicating "Pep Boys" was noted.

Corrective Action: Perform a waste determination of the contents of the drum, and properly label and store the container for disposal.

Transporters Checklist

Type: Violation
Rule: 62-730.171(2)(a)
Question Number: 1.390
Question: Does the facility have personnel training records including job title, description of position, and description of employee's training?
Explanation: Employee training records were not available for review during the inspection.
Corrective Action: Provide legible documentation of compliance with training requirements

Used Oil Processor

Type: Area Of Concern
Rule: 62-710.850(5)(a)
Question Number: 28.90
Question: Are the filters stored in above ground containers which are (All of the following checkboxes must be checked for this question to be marked Ok, otherwise this question must be marked as Not Ok.):
Explanation: Release of used oil was observed beneath the inoperable filter crusher.
Corrective Action: Stop the leak from the machine, and document the response to the release.

Type: Violation
Rule: 279.54(b)
Question Number: 28.170
Question: Are containers and tanks in good condition and not leaking?
Explanation: One frac tank stored within the solid waste roll-off storage area is leaking used oil into secondary containment.
Corrective Action: Immediately stop leak and respond to spill. Provide documentation of response to the Department.

Type: Violation
Rule: 279.54(c)
Question Number: 28.180
Question: Are containers provided with secondary containment consisting of walls and floor at a minimum?
Explanation: The secondary containment of the solid waste roll-off storage area is not adequate to hold the leaking frac tank. In addition, the area is not intended to hold used oil containers.
Corrective Action: The frac tanks observed on site need to be stored within adequate secondary containment, or emptied of their contents, if any. The solid waste storage area is not designated for the storage of used oil containers.

Type: Violation

Rule: 279.52(b)(2)

Question Number: 28.340

Question: Does the plan include the following?

Explanation: Inspectors noted the Contingency Plan lacked the locations of emergency equipment within the facility.

Corrective Action: Update Contingency Plan and provide documentation to the Department.

Type: Violation

Rule: 279.52(b)(3)

Question Number: 28.360

Question: Has the plan been distributed to the:

Explanation: Documentation of the distribution of the facility's current Contingency Plan was not available during the inspection.

Corrective Action: Distribute updated version of Contingency Plan and provide documentation to the Department (certified mail receipts).

Type: Area Of Concern

Rule: 62-710.800(3)(a)

Question Number: 28.730

Question: Has the facility submitted a written closure plan?

Explanation: Facility did not have a copy of the approved Closure Plan for the facility.

Corrective Action: Maintain a copy of the facility's Closure Plan.

Summary of Potential Violations and Areas of Concern:

Potential Violations

Rule Number	Area	Date Cited	Explanation
CESQG Checklist - 40 CFR 261.5 262.11		12/10/2009	One unlabeled 55-gallon drum of unknown contents was observed in the unloading pit area. A partial identifier indicating "Pep Boys" was noted.
Transporters Checklist 62-730.171(2)(a)		12/10/2009	Employee training records were not available for review during the inspection.
Used Oil Processor 279.54(b)		12/10/2009	One frac tank stored within the solid waste roll-off storage area is leaking used oil into secondary containment.
279.54(c)		12/10/2009	The secondary containment of the solid waste roll-off storage area is not adequate to hold the leaking frac tank. In addition, the area is not intended to hold used oil containers.
279.52(b)(2)		12/10/2009	Inspectors noted the Contingency Plan lacked

Rule Number	Area	Date Cited	Explanation
279.52(b)(3)		12/10/2009	the locations of emergency equipment within the facility. Documentation of the distribution of the facility's current Contingency Plan was not available during the inspection.

Areas of Concern

Rule Number	Area	Date Cited	Explanation
Used Oil Processor 62-710.850(5)(a)		12/10/2009	Release of used oil was observed beneath the inoperable filter crusher.
62-710.800(3)(a)		12/10/2009	Facility did not have a copy of the approved Closure Plan for the facility.

Conclusion:

The facility was not in compliance at the time of the inspection. Please provide the requested documentation of corrective actions within thirty (30) days.

• **Signed:**

A hazardous waste compliance inspection was conducted on this date, to determine your facility's compliance with applicable portions of Chapters 403 & 376, F.S., and Chapters 62-710, 62-730, 62-737, & 62-740 Florida Administrative Code (F.A.C.). Portions of the United States Environmental Protection Agency's Title 40 Code of Federal Regulations (C.F.R.) 260 - 279 have been adopted by reference in the state rules under Chapters 62-730 and 62-710, F.A.C. The above noted potential items of non-compliance were identified by the inspector(s).

This is not a formal enforcement action and may not be a complete listing of all items of non-compliance discovered during the inspection.

Karen E Kantor

PRINCIPAL INSPECTOR NAME

Inspector

PRINCIPAL INSPECTOR TITLE**PRINCIPAL INSPECTOR SIGNATURE**

12/10/2009

DATE

Kathy Winston

INSPECTOR NAME

Environmental Consultant

INSPECTOR TITLE

NO SIGNATURE

INSPECTOR SIGNATURE

FDEP

ORGANIZATION

Leroy Arce

REPRESENTATIVE NAME

Facility Manager

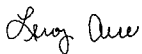
REPRESENTATIVE TITLE**REPRESENTATIVE SIGNATURE**

Cliff Berry

ORGANIZATION

12/10/2009

DATE

Zack Davis

REPRESENTATIVE NAME

Project Manager

REPRESENTATIVE TITLE

NO SIGNATURE

REPRESENTATIVE SIGNATURE

Cliff Berry

ORGANIZATION

NOTE: By signing this document, the Site Representative only acknowledges receipt of this Inspection Report and is not admitting to the accuracy of any of the items identified by the Department as "Potential Violations" or areas of concern.

ATTACHMENT NO. 2



BILL OF LADING		1. Generator's US EPA ID No. CESQG	Manifest Document No. 143071 -2	2. Page 1 of 1	Truck Number
3. Name and Mailing Address PEP BOYS C/O EC GROUP INC 201 EAST ORCHARD ST HAMMONTON, NJ 08037			4. Phone 609-909-0993		UO 60
5. Transporter 1 Company Name CLIFF BERRY, INC. (DANIA)		6. USA EPA ID Number FLR000083071		A. Transporter's Phone 954-763-3390	
7. Transporter 2 Company Name		8. USA EPA ID Number		B. Transporter's Phone	
9. Designated Facility Name and Site Address CLIFF BERRY, INC. (MIAMI) 3033 NW RIVER DRIVE, MIAMI, FL 33142		10. USA EPA ID Number FLD058560699		C. Facility's Phone (305) 638-2030	
11. Shipping Name and Description			12. Containers No. Type	13. Total Quantity	14. Unit Wt/Vol
a. NON REGULATED MATERIAL, LIQUID (ANTIFREEZE FOR RECYCLE)			1	TP	110 G
b.					
c.					
d.					
D. Additional Descriptions for Materials Listed Above 11a: USED ANTIFREEZE			E. Pickup Location PEP BOYS STORE #113 204 BLANDING BLVD ORANGE PARK, FL 32073		
15. Special Handling Instructions and Additional Information Consolidated into 1 tote and 1 drum.					
16. CERTIFICATION: This is to certify that the above named materials are properly classified, described, packaged, marked and labeled, and are in proper condition for transportation according to the applicable regulation of the Department of Transportation. I certify the materials described above on this manifest are not subject to federal regulations for reporting proper disposal of Hazardous Waste.					
Printed/Typed Name		Signature		Month	Day Year
17. Transporter 1 Acknowledgement of Receipt of Materials		Signature		Month	Day Year
Printed/Typed Name		Signature		Month	Day Year
18. Transporter 2 Acknowledgement of Receipt of Materials		Signature		Month	Day Year
Printed/Typed Name		Signature		Month	Day Year
19. Discrepancy Indication Space					
20. Facility Owner or Operator: Certification of receipt of hazardous materials covered by this manifest except as noted in Item 19.					
Printed/Typed Name		Signature		Month	Day Year



WASTE

CUTTING

NON

SHIP

ADDRESS

CITY, STATE

CONTENTS

used for bicycle

WASTE

WASTE

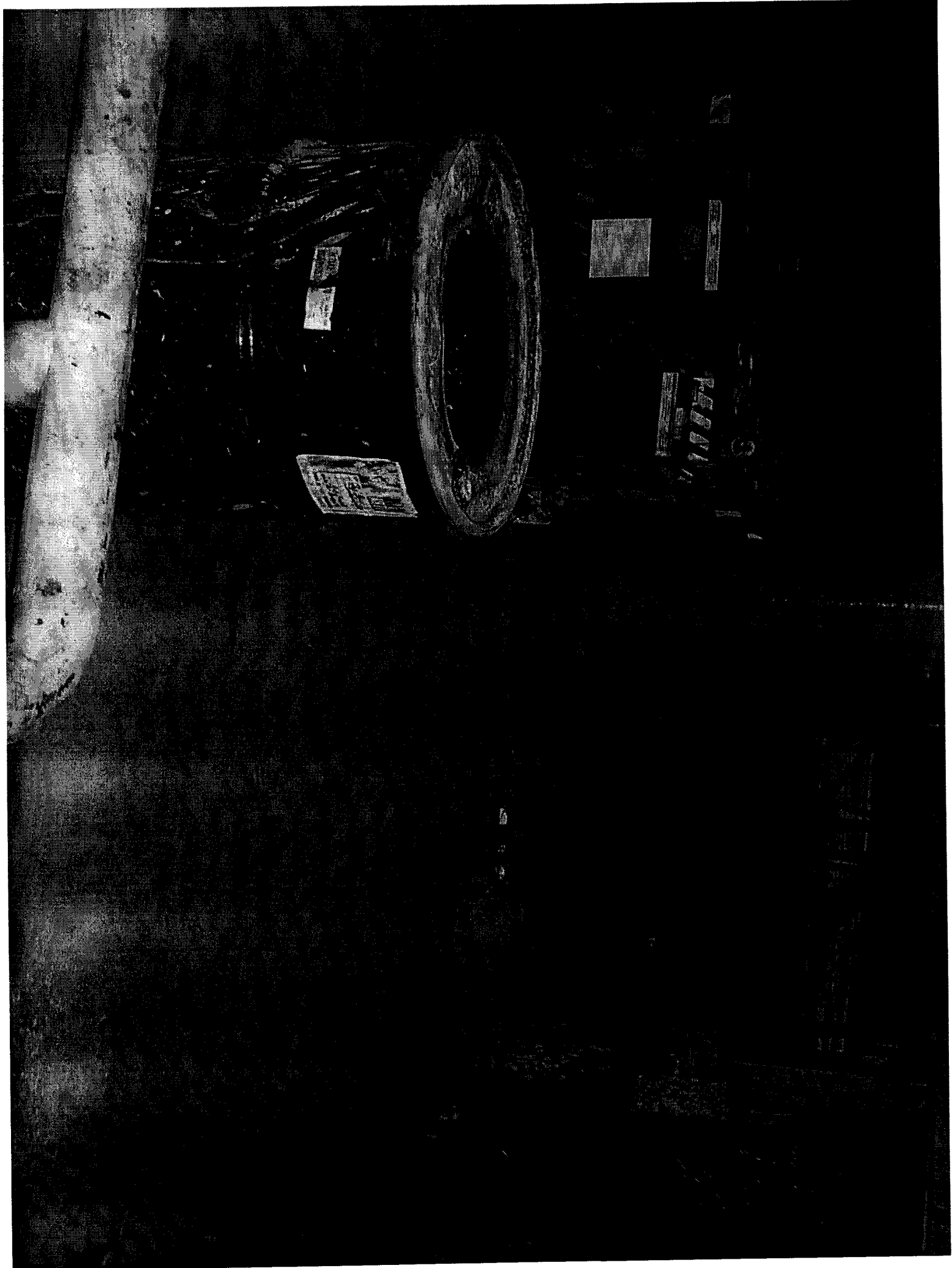

ATTACHMENT NO. 3

Name	Position	Hire Date	USDOT MED REQUIRED	HAZWOPER CERTIFIED	Last HAZMAT Physical	Last DOT Physical	Last Fit Testing Date	HAZCOM	1st Responder Ops Level	24 Hour HazWoper	40 Hour HazWoper	8 Hour Hazmat Refresher	8 Hour HM 181, 128F, 215	8 Hour Haz waste Supervisor	Confined Space	Confined Space Rescue	First Aid / CPR	Bloodbourne Pathogen Awareness	Haz Waste Mgmt	Reasonable Suspicion Training	Fire Extinglusher Training	Powered Industrial Truck Safety	Shipyard Competent Person	CSX Roadway Woker Training	API Worksafe Expiration	ExxonMobile SPSA Process Training	Smith-System Driver Training
Arce, Leroy	Miami Facility Manager	01/05/09						01/05/09																			
Blanco Garcia, Joel	Plant System Operator	11/06/98						03/04/09	08/22/00			08/07/08	04/12/05					10/22/03		08/09/06	10/22/03	04/07/04		05/09/06			
Cabrera, Pablo	Plant System Operator	11/09/07						03/04/09	04/07/08				01/28/08														
Del Pozo Rodriguez, Armando	Plant System Operator	04/03/06						03/04/09					01/28/08										10/04/07		05/09/06		
Del Pozo Ruiz, Armando	Plant System Operator	09/19/07							04/07/08														10/04/07				
Dougherty, Meegan	Chemist	01/28/09						03/04/09																			
Fuentes, Alan	Field Tech	05/10/04					10/28/04	03/04/09	08/01/07			02/15/01	11/08/07	03/09/05		08/07/04							10/11/07			01/17/09	
Garcia, Alcei	Plant System Operator	05/03/07					09/20/07	03/04/09					01/28/08										10/04/07				
Garcia, Aurelio	Plant System Operator	07/09/07						03/04/09	04/07/08			11/08/07											10/04/07				
Marinez, Michael	Plant System Operator	02/26/08							04/07/08				01/28/08														
Montejo, Alexander	Plant System Operator	11/18/08						03/04/09																			
Palmazula, Eduardo	Plant System Operator	11/14/08						03/04/09	04/17/01			04/21/06	03/14/06	02/22/05	04/20/06			04/17/06				04/17/06	06/09/04	05/09/06			
Ruller, Juan	Assistant Facility Manager	06/18/07						03/04/09	04/07/08			11/08/07															
Saavedra, Julio	Plant System Operator	04/02/07					10/25/07	03/04/09			10/25/07												10/04/07				
Soto, Yuner	Plant System Operator	02/06/08							04/07/08																		
Villavicencio, Elmer	Plant System Operator	01/28/08							04/07/08				01/28/08														



Job Title: Waste Water Treatment Manager
FLSA Status: Exempt
Reports To: General Manager
Supervises: Waste Water Treatment Technicians & Offloading Technicians

Job Summary:	The Waste Water Treatment Manager has overall responsibility for the processing and treatment of all incoming industrial waste water for disposal in the POTW (Publicly Owned Treatment Works and supervises off-loading of liquid waste.

Essential Function:	
1	Ensures all incoming liquid waste streams have accurate/valid profiles and maintains appropriate records of same.
2	Oversees collection of samples from tanker truck, rail car, vacuum truck, frac or ISO tank for analysis by Laboratory staff.
3	Supervise and connects and disconnects hoses used for removal of liquid waste.
4	Coordinates with operations on cleaning of receiving pits.
5	Transfers waste stream to designated tank(s) by supervising and operating pumping system
6	Reviews records of tank levels.
7	Supervises and monitors incoming waste water from water tank in oil/water separator.
8	Supervises personnel and performs the removal of oil from waste water and transfers back to oil processing area by operating pumping system.
9	Instruct personnel in monitoring ph level of waste water by examining samples and determines ph level.
10	Oversees cleaning and calibration of ph probe.
11	Supervises and performs chemical dosage.
12	Ensures accurate MSDS postings for chemical inventory.
13	Monitors chemical inventory used for water treatment, ensures proper storage and trains subordinates in proper handling techniques.
14	Supervises and operates and monitors DAF (Dissolved Air Flotation) unit to produce effluent meeting Miami-Dade County discharge parameters.
15	Responsible for maintaining accurate documentation of discharge volumes into POTW.
16	Monitors and removes solids from DAF.
17	Maintains overall responsibility for solids disposal of DAF
18	Supervises and treats sludge from DAF unit to produce moisture-free cake.
19	Supervise personnel in monitoring air stripping unit.
20	Maintains water processing log of activities.
21	Supervise personnel maintaining cleanliness of work area.
22	Conducts on the job training for waste water treatment processing technicians to instruct in proper safety, waster water processing, and mechanical technique
23	Provides continual performance coaching and provides feedback and guidance to direct reports.
24	Evaluates employee performance and performs annual review.
25	Coordinates repair of equipment, monitors equipment performance and schedules maintenance activities.
26	Directs maintenance personnel and coordinates daily list of activities.
27	Performs additional duties as assigned.

Knowledge, Skills and Abilities Required:
Knowledge: <ul style="list-style-type: none">Knowledge of the principles and practices of industrial waste water treatment.



- Mechanical knowledge of fluid transfer, oil-water separator, DAF, piping, pumps and pumping systems
- Knowledge of air stripping units.
- Working knowledge of relevant sampling, analytical, data management, and equipment maintenance techniques.
- Knowledge of chemicals used in waste water treatment
- Knowledge of safety procedures and application of safety principles to fuels handling, use of equipment, facility maintenance, and use of personal protective equipment.

Skills:

- Skill in operating fluid transfer systems, oil-water separator, DAF, piping, pumps and pumping systems.
- Skill in fluid transfer methods
- Skill in collecting samples and monitoring ph levels.
- Skill in administering correct chemical dosages.
- Skill in performing quality control of product
- Skill in operating air stripping unit.

Abilities:

- Ability to supervise personnel and activities.
- To provide continuous feedback and coaching to personnel to increase productivity and maintain accident-free safety record.
- To understand and follow oral/written instructions, work well with culturally diverse people; communicate clearly and concisely in English, both verbally and in writing;
- Establish and maintain effective working relationships with other employees and the public.
- Understand and perform basic sample testing
- Organize activities in order to complete tasks in accordance with priorities, address multiple demands, or meet deadlines; ability to organize tasks and working environment to maximize efficiency.
- Focus attention on tasks, which may be complex, routine, or repetitive, without losing concentration or becoming distracted by external activities; adapt to interruptions, instrument/equipment failures, unusual demands, or changing priorities.
- Perform Quality Assurance/Quality Control checks required to ensure validity of data.
- Perform routine equipment checks and completing related records and reports.

Education and Experience Requirements

- A minimum of five years of experience in industrial waste water treatment
- Licensed waste water treatment operator

Working Conditions and Physical Effort

- The work environment characteristics described here are representative of those an employee encounters while performing the essential functions of the job. The noise level in the environment is moderately noisy. The physical demands described here are representative of those that must be met by an employee to successfully perform the essential functions of the job. While performing the duties of this job, the employee is frequently required to sit, use hands to finger, handle, or feel objects, tools, or controls; and reach with hands and arms. The employee is frequently required to walk, talk or hear.
- Exterior environment involves hazards requiring use of protective equipment that conforms to OSHA regulations and some physical discomfort due to temperature, dust and noise. May be required to work in confined spaces, on ladders and rooftops, and in

CBI

adverse weather conditions.

- Hazards include possible exposure to toxic, corrosive, or flammable chemicals. Physical demands are described as heavy (exert up to 100 lbs. of force occasionally, and/or in excess of 50 lbs. of force frequently, and/or in excess of 20 lbs. of force constantly to lift, carry, push, pull, or otherwise move objects, including the human body.)
- The technicians work involves being around dangerous equipment. Specific vision abilities required by this job include close vision, distance vision, depth perception, and ability to adjust focus. The ability to discriminate color is helpful.
- Technician is expected to extend scheduled working hours to accommodate emergency coverage or complete work in progress.
- Reasonable accommodation may be made to enable individuals with disabilities to perform the essential functions.

EMPLOYEE NAME (PLEASE PRINT)	
EMPLOYEE SIGNATURE	DATE
IMMEDIATE SUPERVISOR	DATE



Job Title: Waste Water Treatment Technician
FLSA Status: Non-Exempt
Reports To: Water Treatment Manager
Supervises: None

Job Summary:	The Waste Water Treatment Technician processes and treats incoming industrial waste water for disposal in the POTW (Publicly Owned Treatment Works).
---------------------	--

Essential Function:	
1	Monitors incoming waste water from water tank in oil/water separator.
2	Removes oil and transfers back to oil processing area by operating pumping system.
3	Performs sampling to monitor ph level of waste water and maintains ph level as instructed by supervisor.
4	Cleans and calibrates ph probe.
5	Performs chemical dosage as instructed.
6	Operates & monitors DAF (Dissolved Air Flotation).
7	Monitors and removes solids from DAF.
8	Treats sludge from DAF unit to produce moisture-free cake.
9	Monitors air stripping unit.
15	Maintains cleanliness of work area and paints area as needed.
16	Monitors equipment and reports issues to supervisor.
17	Performs additional duties as assigned.

Knowledge, Skills and Abilities Required:	
Knowledge:	
•	Working knowledge of the principles and practices of industrial waste water treatment.
•	Mechanical knowledge of fluid transfer, oil-water separator, DAF, piping, pumps and pumping systems
•	Working knowledge of air stripping units.
•	Working knowledge of relevant sampling, analytical, data management, and equipment maintenance techniques.
•	Working knowledge of chemicals used in waste water treatment
•	Working knowledge of safety procedures and application of safety principles to fuels handling, use of equipment, facility maintenance, and use of personal protective equipment.
Skills:	
•	Skill in operating fluid transfer systems, oil-water separator, DAF, piping, pumps and pumping systems.
•	Skill in fluid transfer methods
•	Skill in collecting samples and monitoring ph levels.
•	Skill in administering correct chemical dosages.
•	Skill in performing quality control of product
•	Skill in operating air stripping unit.
Abilities:	
•	Ability to work with a minimum of supervision; to work effectively in limited space with multiple personnel and activities.
•	To understand and follow oral/written instructions, work well with culturally diverse people; communicate clearly and concisely in English, both verbally and in writing;
•	Establish and maintain effective working relationships with other employees and the public.



- Understand and perform basic sample testing
- Organize activities in order to complete tasks in accordance with priorities, address multiple demands, or meet deadlines; ability to organize tasks and working environment to maximize efficiency.
- Focus attention on tasks, which may be complex, routine, or repetitive, without losing concentration or becoming distracted by external activities; adapt to interruptions, instrument/equipment failures, unusual demands, or changing priorities.
- Perform Quality Assurance/Quality Control checks required to ensure validity of data.
- Perform routine equipment checks and completing related records and reports.

Education and Experience Requirements

- Two years of experience in waste water treatment
- Licensed waste water treatment operator preferred.

Working Conditions and Physical Effort

- The work environment characteristics described here are representative of those an employee encounters while performing the essential functions of the job. The noise level in the environment is moderately noisy. The physical demands described here are representative of those that must be met by an employee to successfully perform the essential functions of the job. While performing the duties of this job, the employee is frequently required to sit, use hands to finger, handle, or feel objects, tools, or controls; and reach with hands and arms. The employee is frequently required to walk, talk or hear.
- Exterior environment involves hazards requiring use of protective equipment that conforms to OSHA regulations and some physical discomfort due to temperature, dust and noise. May be required to work in confined spaces, on ladders and rooftops, and in adverse weather conditions.
- Hazards include possible exposure to toxic, corrosive, or flammable chemicals. Physical demands are described as heavy (exert up to 100 lbs. of force occasionally, and/or in excess of 50 lbs. of force frequently, and/or in excess of 20 lbs. of force constantly to lift, carry, push, pull, or otherwise move objects, including the human body.)
- The technicians work involves being around dangerous equipment. Specific vision abilities required by this job include close vision, distance vision, depth perception, and ability to adjust focus. The ability to discriminate color is helpful.
- Technician is expected to extend scheduled working hours to accommodate emergency coverage or complete work in progress.
- Reasonable accommodation may be made to enable individuals with disabilities to perform the essential functions.

EMPLOYEE NAME (PLEASE PRINT)

EMPLOYEE SIGNATURE

DATE

CBI

IMMEDIATE SUPERVISOR

DATE



Job Title: Offload Technician
FLSA Status: Non-Exempt
Reports To: Water Treatment Manager
Supervises: None

Job Summary:	The Offload Technician removes liquid waste streams by hose connection from tanker trucks, rail cars, vacuum trucks, frac & ISO tanks and pumps waste stream to designated tank(s).
---------------------	--

Essential Function:	
1	Collects sample from tanker truck, rail car, vacuum truck, frac or ISO tank for analysis by Laboratory staff.
2	Determines if waste stream is consistent with manifest and profile.
3	Connects and disconnects hoses used for removal of liquid waste.
4	Performs initial quality control activities of initial inbound waste streams
5	Under supervision, transfers waste stream to designated tank(s) by operating pumping system.
6	Records tank levels by maintaining daily log of activities.
7	Maintains cleanliness of work area and paints area as needed.
8	Monitors equipment and reports issues to supervisor.
9	Performs additional duties as assigned.

Knowledge, Skills and Abilities Required:	
Knowledge:	
<ul style="list-style-type: none">Working knowledge of fluid transfer, piping, pumps and pumping systemsWorking knowledge of safety procedures and application of safety principles to waste stream handling, use of equipment, facility maintenance, and use of personal protective equipment.	
Skills:	
<ul style="list-style-type: none">Skill in the connection and disconnection of hoses.Skill in operating piping, pumps and pumping systems.Skill in fluid transfer methods	
Abilities:	
<ul style="list-style-type: none">Ability to work with a minimum of supervision; to work effectively in limited space with multiple personnel and activities.To understand and follow oral/written instructions, work well with culturally diverse people; communicate clearly and concisely in English, both verbally and in writing;Establish and maintain effective working relationships with other employees and the public.Organize activities in order to complete tasks in accordance with priorities, address multiple demands, or meet deadlines; ability to organize tasks and working environment to maximize efficiency.Focus attention on tasks, which may be complex, routine, or repetitive, without losing concentration or becoming distracted by external activities; adapt to interruptions, instrument/equipment failures, unusual demands, or changing priorities.Perform routine equipment checks and completing related records and reports.	

Education and Experience Requirements	
<ul style="list-style-type: none">One year of experience in operating pumps and pumping systems.	



Working Conditions and Physical Effort

- The work environment characteristics described here are representative of those an employee encounters while performing the essential functions of the job. The noise level in the environment is moderately noisy. The physical demands described here are representative of those that must be met by an employee to successfully perform the essential functions of the job. While performing the duties of this job, the employee is frequently required to sit, use hands to finger, handle, or feel objects, tools, or controls; and reach with hands and arms. The employee is frequently required to walk, talk or hear.
- Exterior environment involves hazards requiring use of protective equipment that conforms to OSHA regulations and some physical discomfort due to temperature, dust and noise. May be required to work in confined spaces, on ladders and rooftops, and in adverse weather conditions.
- Hazards include possible exposure to toxic, corrosive, or flammable chemicals. Physical demands are described as heavy (exert up to 100 lbs. of force occasionally, and/or in excess of 50 lbs. of force frequently, and/or in excess of 20 lbs. of force constantly to lift, carry, push, pull, or otherwise move objects, including the human body.)
- The technicians work involves being around dangerous equipment. Specific vision abilities required by this job include close vision, distance vision, depth perception, and ability to adjust focus. The ability to discriminate color is helpful.
- Technician is expected to extend scheduled working hours to accommodate emergency coverage or complete work in progress.
- Reasonable accommodation may be made to enable individuals with disabilities to perform the essential functions.

EMPLOYEE NAME (PLEASE PRINT)	
EMPLOYEE SIGNATURE	DATE
IMMEDIATE SUPERVISOR	DATE



Job Title: Oil Processing Manager
FLSA Status: Exempt
Reports To: General Manager
Supervises: Oil Processing Technicians

Job Summary:	The Oil Processing Manager oversees all aspects of the treatment of incoming oil products, handles quality control over all finished product, and maintains record of all production, sales and volumes.
---------------------	---

Essential Function:	
1	Determines proper heating temperature of cooker tanks and instructs personnel to adjust temperatures accordingly.
2	Manages proper firing of Gencor thermal heater by review of logs of Gencor stack gases & thermo levels of cooker tanks.
4	Supervises transfers of product between tanks and monitors levels.
6	Instructs personnel on desired chemical mix and amounts for treatment.
7	Performs and supervises sampling from cooker tanks as well as bench scale testing.
	Proactively coordinates tanks transfers with Water Treatment Manager
8	Supervises removal of water from cooker tanks and transfer water to treatment tank.
9	Reviews results of moisture content tests of oil in tanks.
11	Supervises transfers of product from cooker tank to finished product tank.
12	Monitors strainers during loading of finished product.
13	Supervises and performs quality control by collecting sample from tanker trucker/railcar when loading of finished product is complete.
14	Maintains logs of all finished product sales.
15	Performs daily inventory of product levels of fuel storage, waste water & finished product in tank farm.
16	Performs end of month inventory of production, sales, volume and product type for mgmt. review.
17	Maintains chemicals inventory and orders supplies.
18	Ensures accurate MSDS postings for chemical inventory.
19	Maintains inventory of office supplies.
20	Conducts on the job training for oil processing technicians to instruct in proper safety, oil processing, and mechanical technique.
21	Provides continual performance coaching and provides feedback and guidance to direct reports.
22	Evaluates employee performance and performs annual review.
23	Coordinates repair of equipment, monitors equipment performance and schedules maintenance activities.
24	Oversees operation of Gencor thermal heater, establishes maintenance schedules and performs monthly safety/maintenance checks.
25	Collects and tracks essential data for monthly/annual reports for oil treatment activities as required.
26	Oversees cleaning of oil processing work area.
27	Performs additional duties as assigned.

Knowledge, Skills and Abilities Required:	
Knowledge:	
	<ul style="list-style-type: none">• Knowledge of the principles and practices of petro-chemical engineering.• Mechanical knowledge of hydraulics, thermal fluid heaters, fluid transfer, piping, pumps and pumping systems• Knowledge of relevant sampling, analytical, data management, and equipment maintenance techniques.



- Working knowledge of safety procedures and application of safety principles to fuels handling, use of equipment, facility maintenance, and use of personal protective equipment.

Skills:

- Skill in operating hydraulic systems, thermal fluid heaters, piping, pumps and pumping systems.
- Skill in fluid transfer methods
- Skill in preparing samples and bench scale tests and analysis of same.
- Skill in performing quality control of product

Abilities:

- Ability to supervise personnel and activities.
- To provide continuous feedback and coaching to personnel to increase productivity and maintain accident-free safety record.
- To understand and follow oral/written instructions, work well with culturally diverse people; communicate clearly and concisely in English, both verbally and in writing;
- Establish and maintain effective working relationships with other employees and the public.
- Understand and perform sample and bench scale testing
- Organize activities in order to complete tasks in accordance with priorities, address multiple demands, or meet deadlines; ability to organize tasks and working environment to maximize efficiency.
- Focus attention on tasks, which may be complex, routine, or repetitive, without losing concentration or becoming distracted by external activities; adapt to interruptions, instrument/equipment failures, unusual demands, or changing priorities.
- Read, understand, and apply technical manuals, complex analytical methods, and research reports.
- Perform Quality Assurance/Quality Control checks required to ensure validity of data.
- Perform routine equipment checks and completing related records and reports.

Education and Experience Requirements

- A minimum of five years of experience in petro-chemical engineering.
- Bachelor's degree in chemical engineering

Working Conditions and Physical Effort

- The work environment characteristics described here are representative of those an employee encounters while performing the essential functions of the job. The noise level in the environment is moderately noisy. The physical demands described here are representative of those that must be met by an employee to successfully perform the essential functions of the job. While performing the duties of this job, the employee is frequently required to sit, use hands to finger, handle, or feel objects, tools, or controls; and reach with hands and arms. The employee is frequently required to walk, talk or hear.
- Exterior environment involves hazards requiring use of protective equipment that conforms to OSHA regulations and some physical discomfort due to temperature, dust and noise. May be required to work in confined spaces, on ladders and rooftops, and in adverse weather conditions.
- Hazards include possible exposure to toxic, corrosive, or flammable chemicals. Physical demands are described as heavy (exert up to 100 lbs. of force occasionally, and/or in excess of 50 lbs. of force frequently, and/or in excess of 20 lbs. of force constantly to lift, carry, push, pull, or otherwise move objects, including the human body.)



- The technicians work involves being around dangerous equipment. Specific vision abilities required by this job include close vision, distance vision, depth perception, and ability to adjust focus. The ability to discriminate color is helpful.
- Technician is expected to extend scheduled working hours to accommodate emergency coverage or complete work in progress.
- Reasonable accommodation may be made to enable individuals with disabilities to perform the essential functions.

EMPLOYEE NAME (PLEASE PRINT)	
EMPLOYEE SIGNATURE	DATE
IMMEDIATE SUPERVISOR	DATE



Job Title: Oil Processing Technician
FLSA Status: Non-Exempt
Reports To: Oil Processing Manager
Supervises: None

Job Summary:	The Oil Processing Technician processes and treats incoming oil products, monitors product levels, operates cooker tanks, and performs quality control on finished products.

Essential Function:	
1	Heats cooker tanks to desired temperatures as instructed by supervisor.
2	Maintains logs of stack & thermo levels of cooker tanks.
3	Monitors product levels in tanks.
4	Transfers product between tanks as instructed by supervisor and monitors levels.
5	Operates Gencor thermal heater within design parameters.
6	Adds proper amount of desired chemical for treatment as instructed by supervisor.
7	Performs sampling from cooker tanks as well as bench scale testing as instructed by supervisor.
8	Removes water from cooker tanks and transfers water to treatment tank as instructed by supervisor.
9	Performs moisture content tests of oil in tanks.
10	Performs recirculation of oil products in cooker tanks.
11	Transfers product from cooker tank to finished product tank.
12	Monitors strainers during loading of finished product.
13	Performs quality control by collecting sample from tanker trucker/railcar when loading of finished product is complete.
14	Records and maintains log of finished product volumes loaded to tanker trucks/railcars.
15	Performs monthly maintenance (inspection/cleaning) of Gencor thermal heater.
16	Maintains cleanliness of work area and paints area as needed.
17	Monitors equipment and reports issues to supervisor.
18	Performs additional duties as assigned.

Knowledge, Skills and Abilities Required:	
Knowledge:	
<ul style="list-style-type: none">Working knowledge of the principles and practices of petro-chemical engineering.Mechanical knowledge of hydraulics, thermal fluid heaters, fluid transfer, piping, pumps and pumping systemsWorking knowledge of relevant sampling, analytical, data management, and equipment maintenance techniques.Working knowledge of safety procedures and application of safety principles to fuels handling, use of equipment, facility maintenance, and use of personal protective equipment.	
Skills:	
<ul style="list-style-type: none">Skill in operating hydraulic systems, thermal fluid heaters, piping, pumps and pumping systems.Skill in fluid transfer methodsSkill in preparing samples and bench scale tests and analysis of same.Skill in performing quality control of product	
Abilities:	
<ul style="list-style-type: none">Ability to work with a minimum of supervision; to work effectively in limited space with multiple personnel and activities.	



- To understand and follow oral/written instructions, work well with culturally diverse people; communicate clearly and concisely in English, both verbally and in writing;
- Establish and maintain effective working relationships with other employees and the public.
- Understand and perform basic sample testing
- Organize activities in order to complete tasks in accordance with priorities, address multiple demands, or meet deadlines; ability to organize tasks and working environment to maximize efficiency.
- Focus attention on tasks, which may be complex, routine, or repetitive, without losing concentration or becoming distracted by external activities; adapt to interruptions, instrument/equipment failures, unusual demands, or changing priorities.
- Read, understand, and apply technical manuals, complex analytical methods, and research reports.
- Perform Quality Assurance/Quality Control checks required to ensure validity of data.
- Perform routine equipment checks and completing related records and reports.

Education and Experience Requirements

- Two years of experience in oil processing.

Working Conditions and Physical Effort

- The work environment characteristics described here are representative of those an employee encounters while performing the essential functions of the job. The noise level in the environment is moderately noisy. The physical demands described here are representative of those that must be met by an employee to successfully perform the essential functions of the job. While performing the duties of this job, the employee is frequently required to sit, use hands to finger, handle, or feel objects, tools, or controls; and reach with hands and arms. The employee is frequently required to walk, talk or hear.
- Exterior environment involves hazards requiring use of protective equipment that conforms to OSHA regulations and some physical discomfort due to temperature, dust and noise. May be required to work in confined spaces, on ladders and rooftops, and in adverse weather conditions.
- Hazards include possible exposure to toxic, corrosive, or flammable chemicals. Physical demands are described as heavy (exert up to 100 lbs. of force occasionally, and/or in excess of 50 lbs. of force frequently, and/or in excess of 20 lbs. of force constantly to lift, carry, push, pull, or otherwise move objects, including the human body.)
- The technicians work involves being around dangerous equipment. Specific vision abilities required by this job include close vision, distance vision, depth perception, and ability to adjust focus. The ability to discriminate color is helpful.
- Technician is expected to extend scheduled working hours to accommodate emergency coverage or complete work in progress.
- Reasonable accommodation may be made to enable individuals with disabilities to perform the essential functions.



EMPLOYEE NAME (PLEASE PRINT)	
EMPLOYEE SIGNATURE	DATE
IMMEDIATE SUPERVISOR	DATE

Safety Meeting Sign-in Sheet

Date September 17, 2009

[illegible]

CBI Miami Plant Safety Meeting Sign-in Sheet

September 9, 2009

lock out / Tagout

[illegible]

Safety Meeting Sign-in Sheet

Date 8/20/09

[illegible]

CBI Miami Plant Safety Meeting Sign-in Sheet

August 5, 2009

SPCC Plan

[illegible]

Safety Meeting Sign-in Sheet

Date July 23, 2009

[illegible]

CBI Miami Plant Safety Meeting Sign-in Sheet

July 8, 2009

Emergency Response Plan

[illegible]

MOTHLY SAFETY TRAINING SIGN-IN SHEET

DATE: 05/21/09

LOCATION: Migmi - H02 COM

THE COST OF ACCIDENTS

	PRINTED NAME	SIGNATURE
1	Leroy Arce	Leroy Arce
2	Zachary Davis	Zachary Davis
3	Jake Betancourt	Jake Betancourt
4	Alexis Gorriz	Alexis Gorriz
5	Isabel Arce	Isabel Arce
6	Julio Sanchez	Julio
7	Miguel Duarte	Miguel
8	Juan Fuentes	Juan Fuentes
9	Pablo Chikera	Pablo
10	Armando del Pozo Ruiz	Armando
11	Eduardo Palenzuela	Eduardo
12	Armando del Pozo Ruiz	Armando
13	Alexander Montijo	Alexander
14	Juan C. Rullia	Juan C. Rullia
15	JUAN C. Rullia	JUAN C. Rullia
16	STEVE MARINO	STEVE MARINO
17	ALBERT MONTE	ALBERT MONTE
18	Megan Dougherty	Megan Dougherty
19		
20		

Worked Video
5/21/09 & Regal
Informative Sheet

ATTACHMENT NO. 4

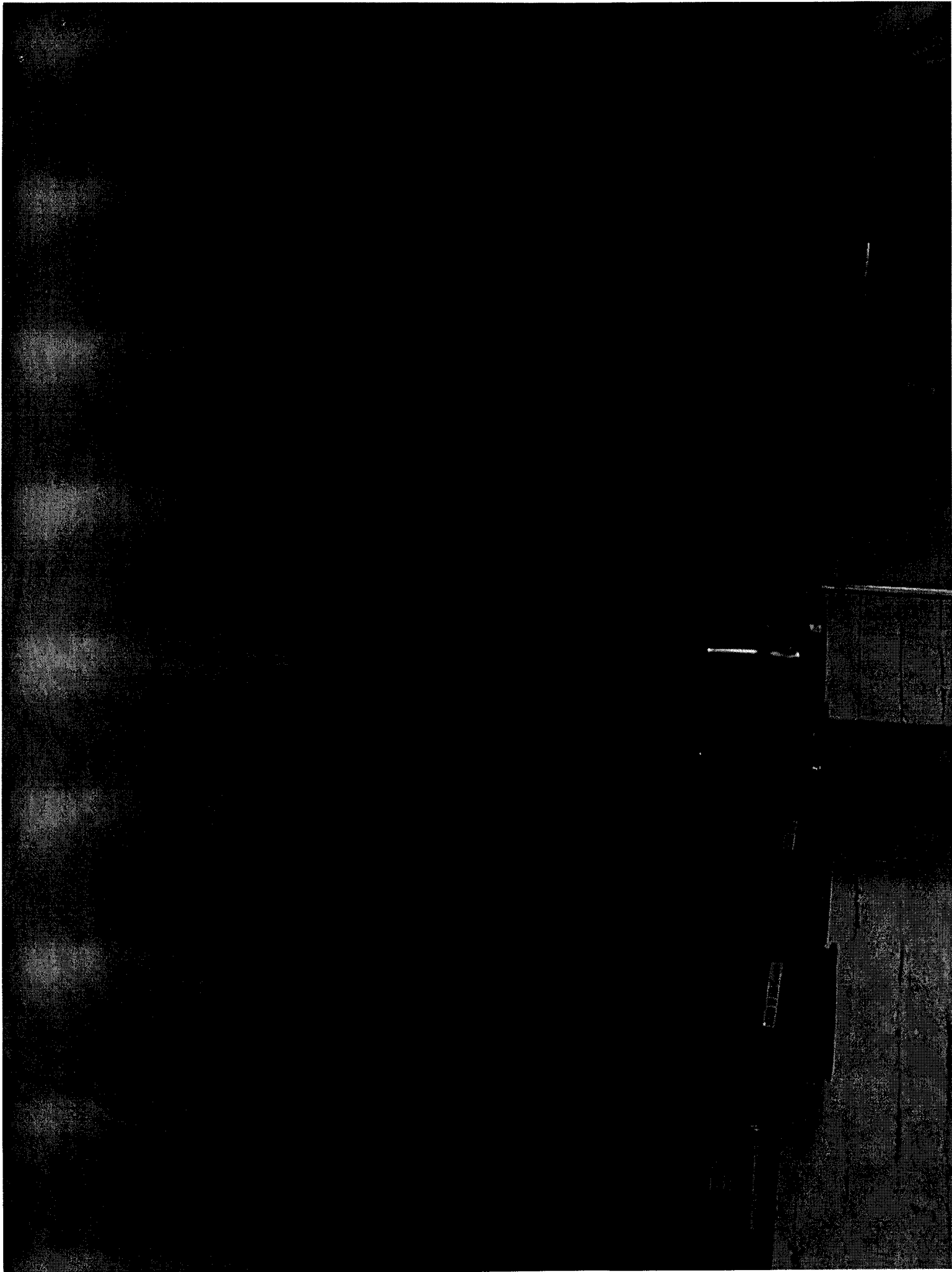

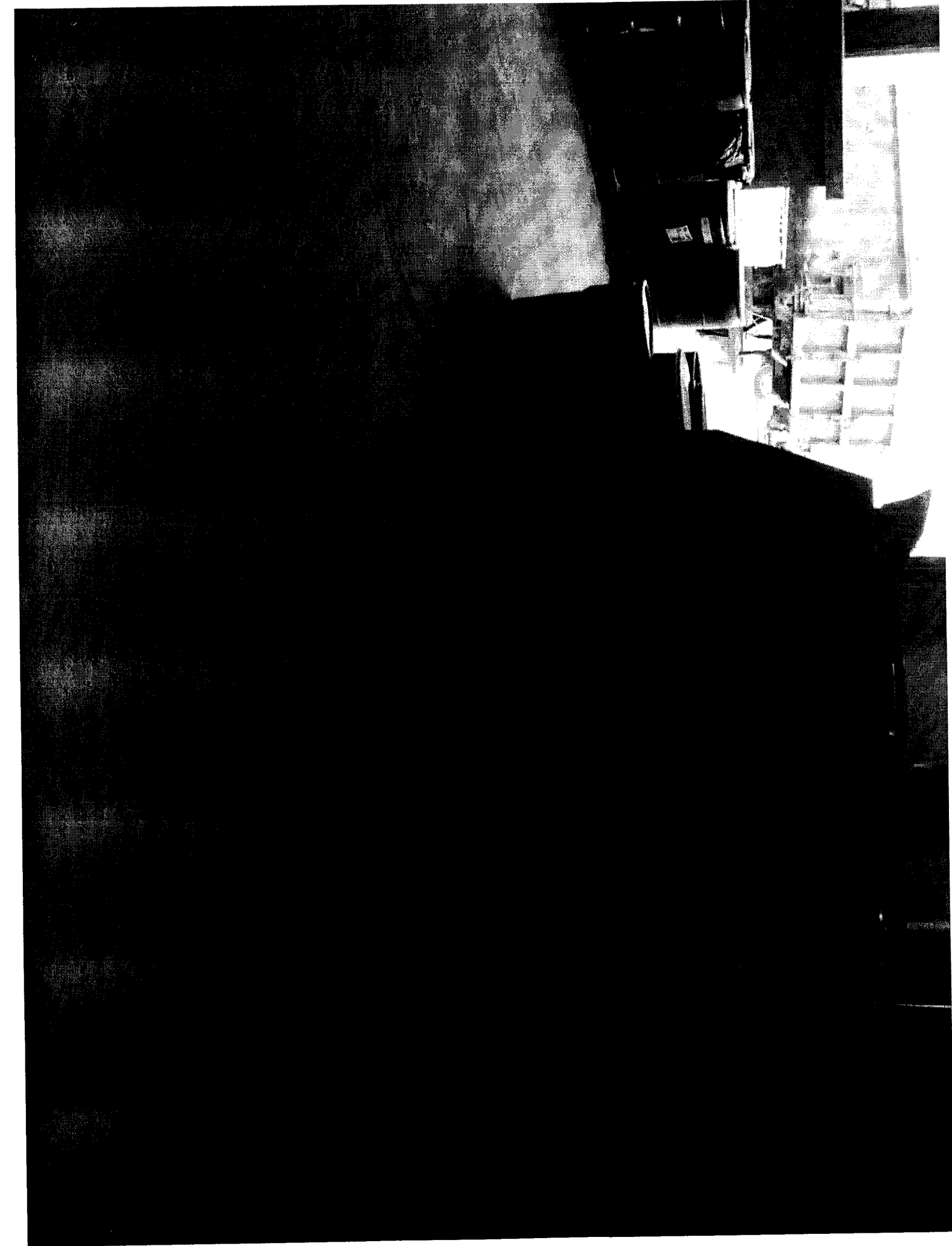

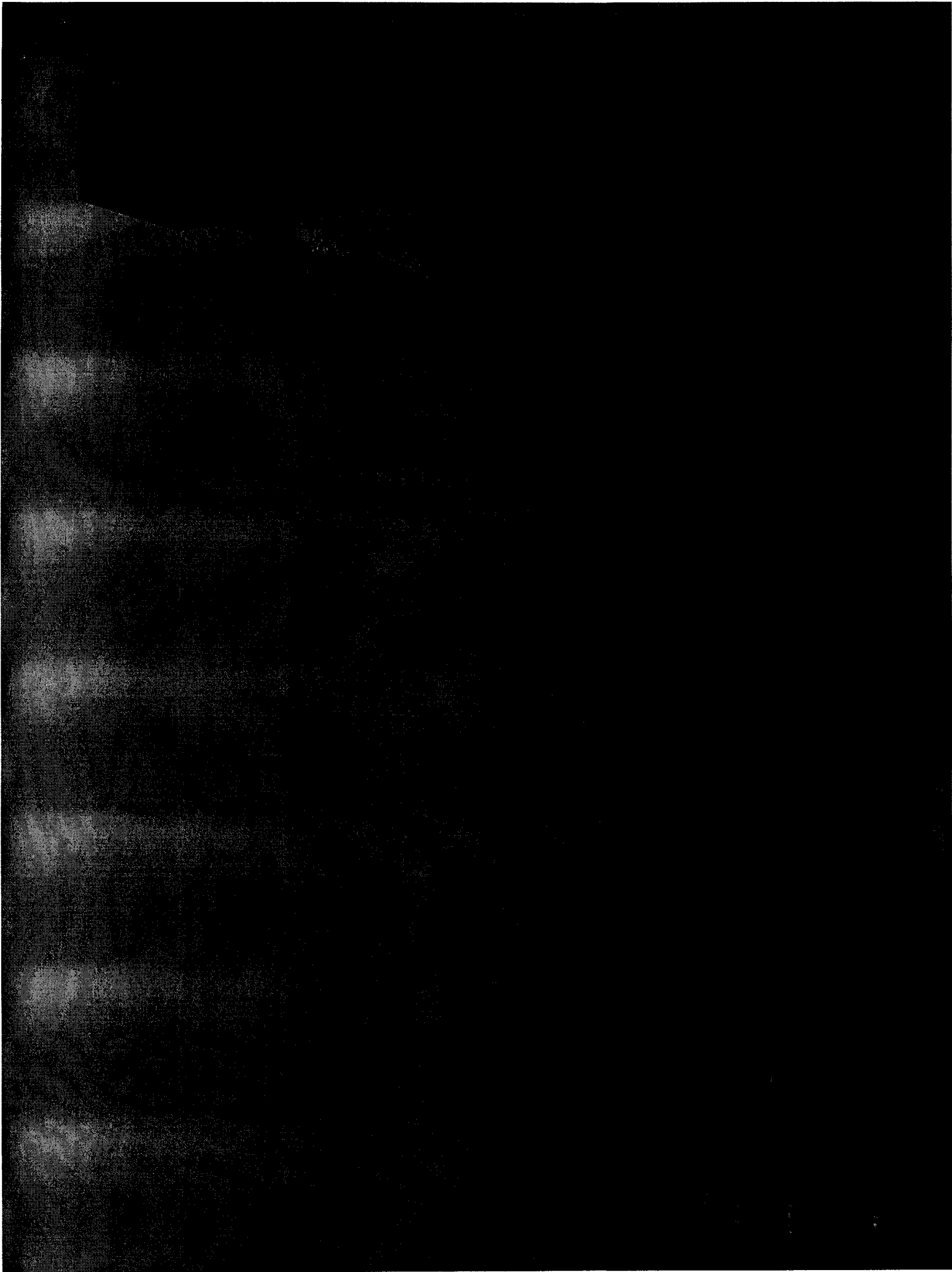

ATTACHMENT NO. 5

31

CONFINED SPACE
ENTRY BY PERMIT ONLY

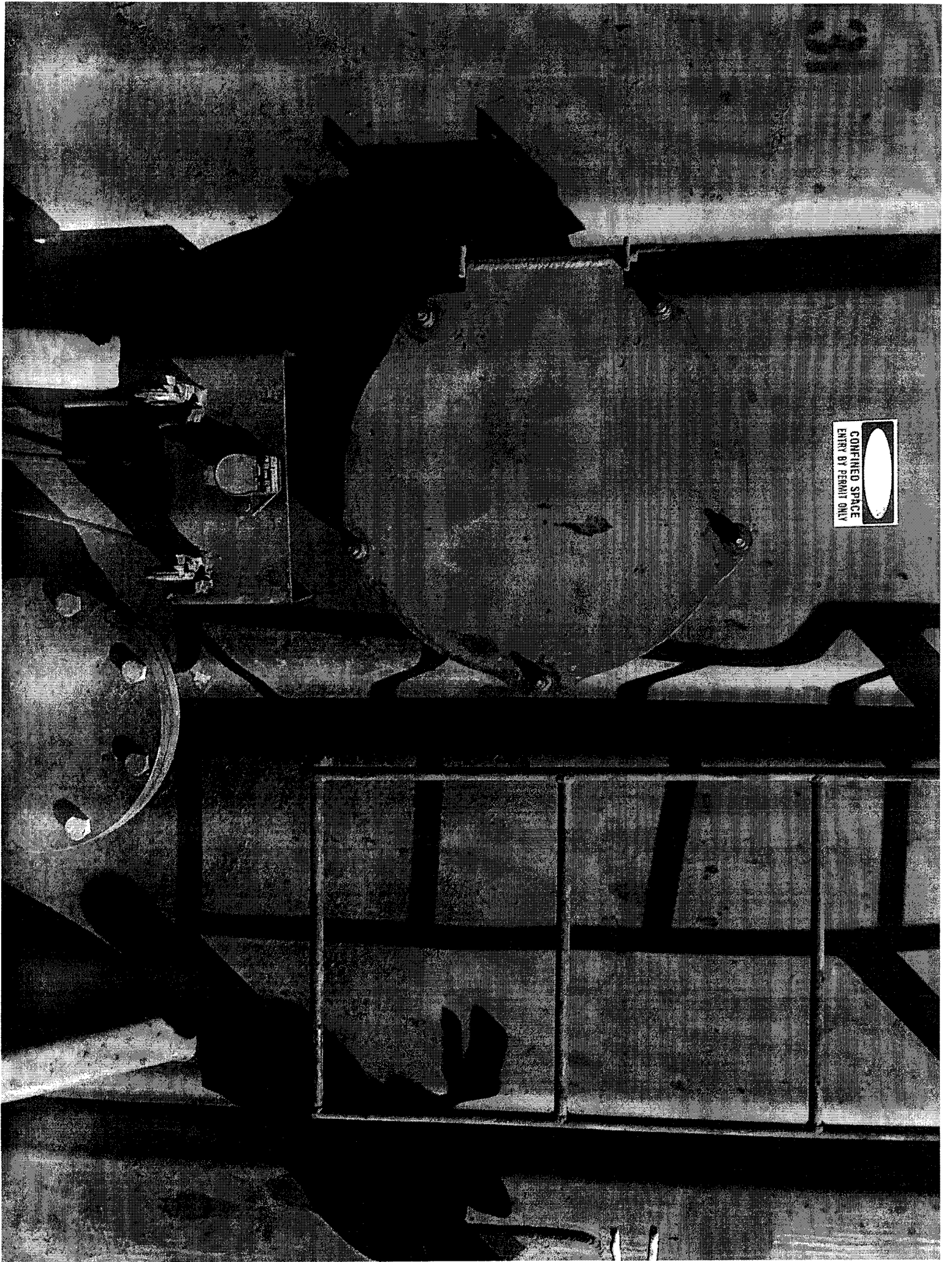



ATTACHMENT NO. 6





ATTACHMENT NO. 7

SITE PLAN

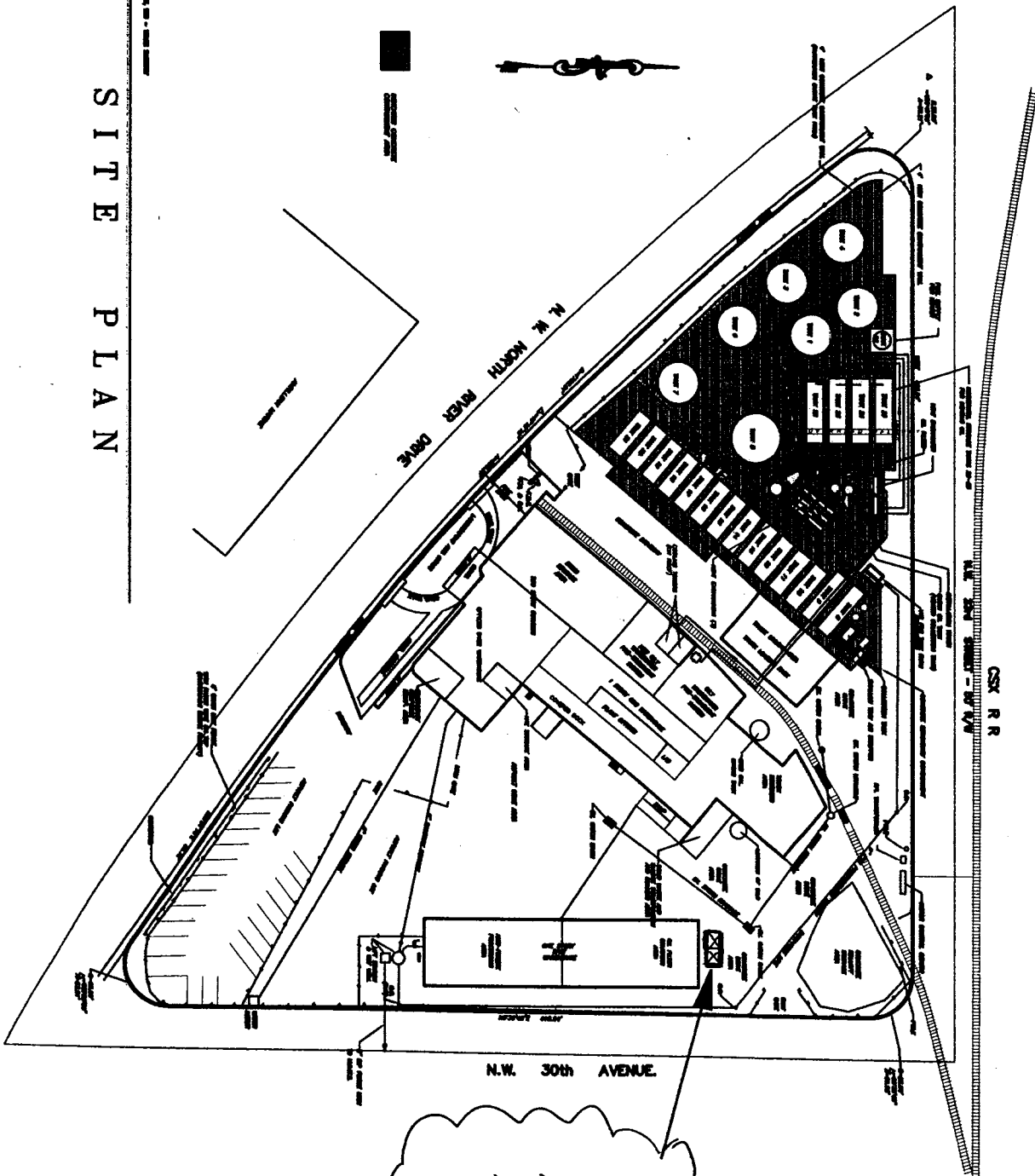

LOCATION OF
EMERGENCY
EQUIPMENT
FOR THE CBT-
MIAMI FACILITY

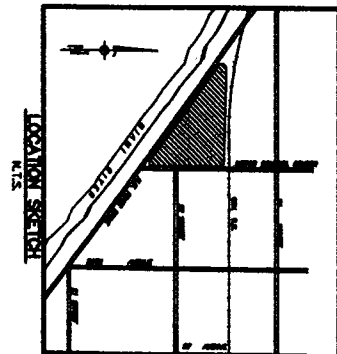

CLIFF BERRY INC. MIAMI FACILITY

3033 N.W. NORTH RIVER DRIVE, MIAMI, FL 33142
SITE PLAN

REVISIONS	DATE	BY	CHK.

DIVERSIFIED CONSTRUCTION
DCES
ENGINEERING SERVICES
2295 N.W. CORPORATE BLVD., #125, BOCA RATON, FL 33431
561-750-3717 FAX 561-750-3686
CD 00408

DOCS
SCALE 1"=30'
DATE 4-10-07
BY: B.T. M.K.
CHK: B.T. M.K.
IN: P.L.
JOB NO.:
732-98
SHEET 1 OF 1

ATTACHMENT NO. 8



Cliff Berry, Incorporated
Environmental Services

January 7, 2010

Florida Department of Environmental Protection Southeast District (FDEP)
400 N. Congress Avenue
Suite 200
West Palm Beach, Florida 33401

RE: Letter of Transmittal Regarding a Copy of the Revised SPCC Plan for the CBI - Miami Facility

To Whom It May Concern:

Cliff Berry, Inc. (CBI) hereby submits a copy of the revised Spill Prevention Control & Countermeasure Plan and Contingency Plan and Emergency Procedures (SPCC Plan) for the CBI - Miami Facility located at 3033 N.W. North River Drive, Miami, Florida 33142 for your file.

If you have any questions or need any additional information please contact me at (954) 763 - 3390 or e-mail me at bparkes@cliffberryinc.com.

Sincerely,

A handwritten signature in black ink, appearing to read "W. Parkes, Jr.", is written over a horizontal line.

William E. Parkes, Jr.
Manager Regulatory Affairs and Capital Projects
Cliff Berry Inc. (CBI)

From: Origin ID: HWOA (800) 899-7745
 Bill Parkes
 Cliff Berry Inc.
 851 Eller Dr.

Ft. Lauderdale, FL 33316



J0530006712823

Ship Date: 07JAN10
 ActWgt: 1.0 LB
 CAD: 9220572/NET9090
 Account#: S *****

Delivery Address Bar Code



Ref #
 Invoice #
 PO #
 Dept #

SHIP TO: (561) 681-6670

BILL SENDER

FDEP, Southeast District
 400 N CONGRESS AVE STE 200

WEST PALM BEACH, FL 33401

TRK# 7982 8107 7292
 0201

FRI - 08JAN A2
 STANDARD OVERNIGHT

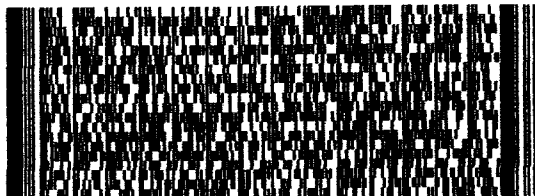

3E PBI A

33401
 FL-US
 PBI

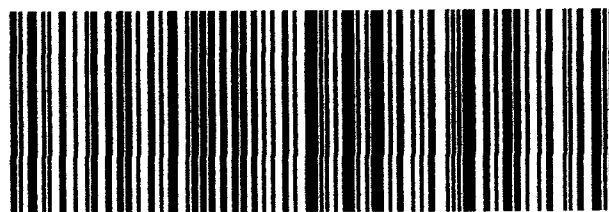

After printing this label:

1. Use the 'Print' button on this page to print your label to your laser or inkjet printer.
2. Fold the printed page along the horizontal line.
3. Place label in shipping pouch and affix it to your shipment so that the barcode portion of the label can be read and scanned.

Warning: Use only the printed original label for shipping. Using a photocopy of this label for shipping purposes is fraudulent and could result in additional billing charges, along with the cancellation of your FedEx account number.

Use of this system constitutes your agreement to the service conditions in the current FedEx Service Guide, available on fedex.com. FedEx will not be responsible for any claim in excess of \$100 per package, whether the result of loss, damage, delay, non-delivery, misdelivery, or misinformation, unless you declare a higher value, pay an additional charge, document your actual loss and file a timely claim. Limitations found in the current FedEx Service Guide apply. Your right to recover from FedEx for any loss, including intrinsic value of the package, loss of sales, income interest, profit, attorney's fees, costs, and other forms of damage whether direct, incidental, consequential, or special is limited to the greater of \$100 or the authorized declared value. Recovery cannot exceed actual documented loss. Maximum for items of extraordinary value is \$500, e.g. jewelry, precious metals, negotiable instruments and other items listed in our Service Guide. Written claims must be filed within strict time limits, see current FedEx Service Guide.



Cliff Berry, Incorporated
Environmental Services

January 7, 2010

Miami-Dade County Department of Environmental Resources Management (DERM)
701 N.W. 1st Court
7th Floor
Miami, Florida 33136

RE: Letter of Transmittal Regarding a Copy of the Revised SPCC Plan for the CBI - Miami Facility

To Whom It May Concern:

Cliff Berry, Inc. (CBI) hereby submits a copy of the revised Spill Prevention Control & Countermeasure Plan and Contingency Plan and Emergency Procedures (SPCC Plan) for the CBI - Miami Facility located at 3033 N.W. North River Drive, Miami, Florida 33142 for your file.

If you have any questions or need any additional information please contact me at (954) 763 - 3390 or e-mail me at bparkes@cliffberryinc.com.

Sincerely,

A handwritten signature in black ink, appearing to read "W. E. Parkes, Jr.", written in a cursive style.

William E. Parkes, Jr.
Manager Regulatory Affairs and Capital Projects
Cliff Berry Inc. (CBI)

From: Origin ID: HWOA (800) 899-7745
 Bill Parkes
 Cliff Berry Inc.
 851 Eller Dr.



Ft. Lauderdale, FL 33316

Ship Date: 07JAN10
 ActWgt: 1.0 LB
 CAD: 9220572/NET9090
 Account#: S *****

Delivery Address Bar Code



Ref #
 Invoice #
 PO #
 Dept #

SHIP TO: (305) 372-8504

BILL SENDER

DERM
 701 NW 1ST CT FL 7

MIAMI, FL 33136

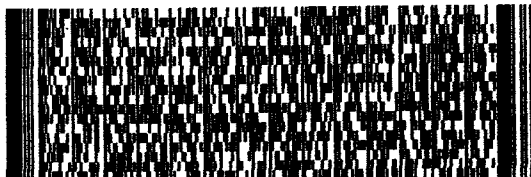

TRK# 7982 8109 2237
 0201

FRI - 08JAN A1
 STANDARD OVERNIGHT
 RES

3C MPBA

33136
 FL-US
 MIA

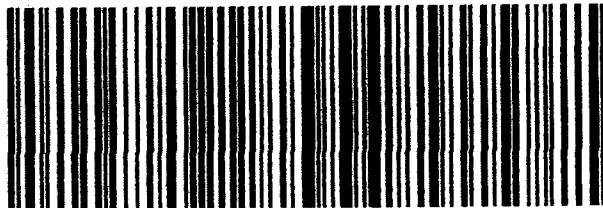

After printing this label:

1. Use the 'Print' button on this page to print your label to your laser or inkjet printer.
2. Fold the printed page along the horizontal line.
3. Place label in shipping pouch and affix it to your shipment so that the barcode portion of the label can be read and scanned.

Warning: Use only the printed original label for shipping. Using a photocopy of this label for shipping purposes is fraudulent and could result in additional billing charges, along with the cancellation of your FedEx account number.

Use of this system constitutes your agreement to the service conditions in the current FedEx Service Guide, available on fedex.com. FedEx will not be responsible for any claim in excess of \$100 per package, whether the result of loss, damage, delay, non-delivery, misdelivery, or misinformation, unless you declare a higher value, pay an additional charge, document your actual loss and file a timely claim. Limitations found in the current FedEx Service Guide apply. Your right to recover from FedEx for any loss, including intrinsic value of the package, loss of sales, income interest, profit, attorney's fees, costs, and other forms of damage whether direct, incidental, consequential, or special is limited to the greater of \$100 or the authorized declared value. Recovery cannot exceed actual documented loss. Maximum for items of extraordinary value is \$500, e.g. jewelry, precious metals, negotiable instruments and other items listed in our Service Guide. Written claims must be filed within strict time limits, see current FedEx Service Guide.



Cliff Berry, Incorporated
Environmental Services

January 7, 2010

Miami-Dade County Police Department Northside Station
2950 N.W. 83rd Street
Miami, Florida 33147

RE: Letter of Transmittal Regarding a Copy of the Revised SPCC Plan for the CBI - Miami Facility

To Whom It May Concern:

Cliff Berry, Inc. (CBI) hereby submits a copy of the revised Spill Prevention Control & Countermeasure Plan and Contingency Plan and Emergency Procedures (SPCC Plan) for the CBI - Miami Facility located at 3033 N.W. North River Drive, Miami, Florida 33142 for your file.

If you have any questions or need any additional information please contact me at (954) 763 - 3390 or e-mail me at bparkes@cliffberryinc.com.

Sincerely,

A handwritten signature in black ink, appearing to read "W. E. Parkes, Jr.", written in a cursive style.

William E. Parkes, Jr.
Manager Regulatory Affairs and Capital Projects
Cliff Berry Inc. (CBI)

From: Origin ID: HWOA (800) 899-7745
 Bill Parkes
 Cliff Berry Inc.
 851 Eller Dr.



Ft. Lauderdale, FL 33316

Ship Date: 07JAN10
 ActWgt: 1.0 LB
 CAD: 9220572/INET9090
 Account#: S *****

Delivery Address Bar Code



Ref #
 Invoice #
 PO #
 Dept #

SHIP TO: (305) 836-8601 **BILL SENDER**
Northside Station
Miami-Dade County Police Dept.
2950 NW 83RD ST

MIAMI, FL 33147

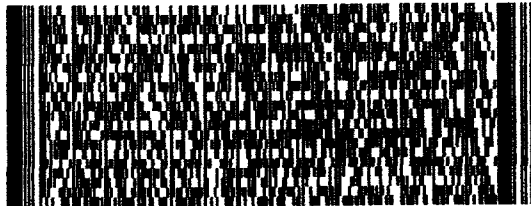

TRK# 7982 8114 0081
 0201

FRI - 08JAN A1
STANDARD OVERNIGHT

32 OPFA

33147
FL-US
FLL

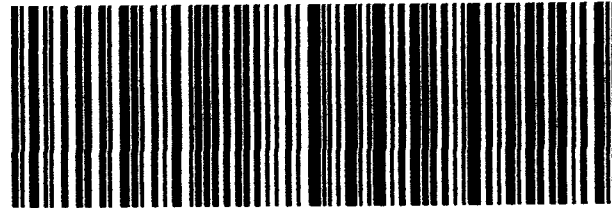

After printing this label:

1. Use the 'Print' button on this page to print your label to your laser or inkjet printer.
2. Fold the printed page along the horizontal line.
3. Place label in shipping pouch and affix it to your shipment so that the barcode portion of the label can be read and scanned.

Warning: Use only the printed original label for shipping. Using a photocopy of this label for shipping purposes is fraudulent and could result in additional billing charges, along with the cancellation of your FedEx account number.

Use of this system constitutes your agreement to the service conditions in the current FedEx Service Guide, available on fedex.com. FedEx will not be responsible for any claim in excess of \$100 per package, whether the result of loss, damage, delay, non-delivery, misdelivery, or misinformation, unless you declare a higher value, pay an additional charge, document your actual loss and file a timely claim. Limitations found in the current FedEx Service Guide apply. Your right to recover from FedEx for any loss, including intrinsic value of the package, loss of sales, income interest, profit, attorney's fees, costs, and other forms of damage whether direct, incidental, consequential, or special is limited to the greater of \$100 or the authorized declared value. Recovery cannot exceed actual documented loss. Maximum for items of extraordinary value is \$500, e.g. jewelry, precious metals, negotiable instruments and other items listed in our Service Guide. Written claims must be filed within strict time limits, see current FedEx Service Guide.



Cliff Berry, Incorporated
Environmental Services

January 7, 2010

Miami-Dade County Fire Rescue Department
6460 N.W. 27th Avenue
Miami, Florida 33127

RE: Letter of Transmittal Regarding a Copy of the Revised SPCC Plan for the CBI - Miami Facility

To Whom It May Concern:

Cliff Berry, Inc. (CBI) hereby submits a copy of the revised Spill Prevention Control & Countermeasure Plan and Contingency Plan and Emergency Procedures (SPCC Plan) for the CBI - Miami Facility located at 3033 N.W. North River Drive, Miami, Florida 33142 for your file.

If you have any questions or need any additional information please contact me at (954) 763 - 3390 or e-mail me at bparkes@cliffberryinc.com.

Sincerely,

A handwritten signature in black ink, appearing to read "William E. Parkes, Jr.", written over a horizontal line.

William E. Parkes, Jr.
Manager Regulatory Affairs and Capital Projects
Cliff Berry Inc. (CBI)

From: Origin ID: HWOA (800) 899-7745
 Bill Parkes
 Cliff Berry Inc.
 851 Eller Dr.

Ft. Lauderdale, FL 33316



00000007312823

SHIP TO: (305) 836-1766

BILL SENDER

Miami-Dade County Fire Rescue Dept.
6460 NW 27TH AVE

MIAMI, FL 33147

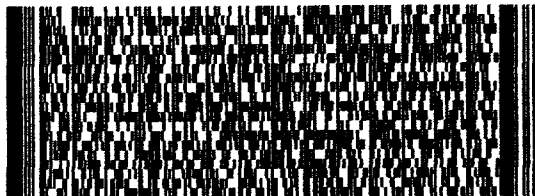

Ship Date: 07JAN10
 ActWgt: 1.0 LB
 CAD: 9220572/INET9090
 Account#: S *****

Delivery Address Bar Code



Ref #
 Invoice #
 PO #
 Dept #

TRK# 7931 6012 1164
 0201

FRI - 08JAN A1
STANDARD OVERNIGHT

32 OPFA

33147
FL-US
FLL



After printing this label:

1. Use the 'Print' button on this page to print your label to your laser or inkjet printer.
2. Fold the printed page along the horizontal line.
3. Place label in shipping pouch and affix it to your shipment so that the barcode portion of the label can be read and scanned.

Warning: Use only the printed original label for shipping. Using a photocopy of this label for shipping purposes is fraudulent and could result in additional billing charges, along with the cancellation of your FedEx account number.

Use of this system constitutes your agreement to the service conditions in the current FedEx Service Guide, available on fedex.com. FedEx will not be responsible for any claim in excess of \$100 per package, whether the result of loss, damage, delay, non-delivery, misdelivery, or misinformation, unless you declare a higher value, pay an additional charge, document your actual loss and file a timely claim. Limitations found in the current FedEx Service Guide apply. Your right to recover from FedEx for any loss, including intrinsic value of the package, loss of sales, income interest, profit, attorney's fees, costs, and other forms of damage whether direct, incidental, consequential, or special is limited to the greater of \$100 or the authorized declared value. Recovery cannot exceed actual documented loss. Maximum for items of extraordinary value is \$500, e.g. jewelry, precious metals, negotiable instruments and other items listed in our Service Guide. Written claims must be filed within strict time limits, see current FedEx Service Guide.



Cliff Berry, Incorporated
Environmental Services

January 7, 2010

Jackson Memorial Hospital
1611 N.W. 12th Avenue
Miami, Florida 33136

RE: Letter of Transmittal Regarding a Copy of the Revised SPCC Plan for the CBI - Miami Facility

To Whom It May Concern:

Cliff Berry, Inc. (CBI) hereby submits a copy of the revised Spill Prevention Control & Countermeasure Plan and Contingency Plan and Emergency Procedures (SPCC Plan) for the CBI - Miami Facility located at 3033 N.W. North River Drive, Miami, Florida 33142 for your file.

If you have any questions or need any additional information please contact me at (954) 763 - 3390 or e-mail me at bparkes@cliffberryinc.com.

Sincerely,

A handwritten signature in black ink, appearing to read "W. E. Parkes, Jr.", is written over a horizontal line.

William E. Parkes, Jr.
Manager Regulatory Affairs and Capital Projects
Cliff Berry Inc. (CBI)

From: Origin ID: HWOA (800) 899-7745
 Bill Parkes
 Cliff Berry Inc.
 851 Eller Dr.

Ft. Lauderdale, FL 33316



JB1308067312823

SHIP TO: (305) 585-2582

BILL SENDER

Jackson Memorial Hospital
 1611 NW 12TH AVE

MIAMI, FL 33136

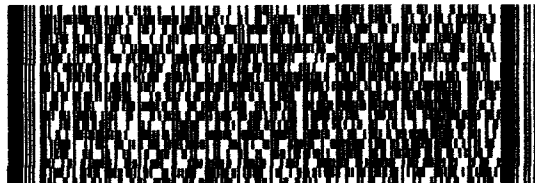

Ship Date: 07JAN10
 ActWgt: 1.0 LB
 CAD: 9220572/INET9090
 Account#: S *****

Delivery Address Bar Code



Ref #
 Invoice #
 PO #
 Dept #

TRK# 7982 8115 9860
 0201

FRI - 08JAN A1
 STANDARD OVERNIGHT

3C MPBA

33136
 FL-US
 MIA

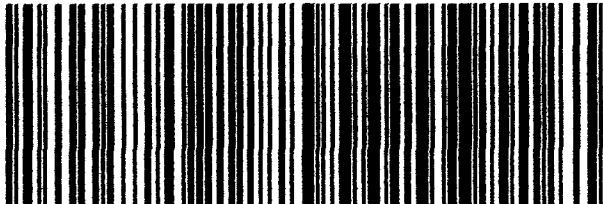

After printing this label:

1. Use the 'Print' button on this page to print your label to your laser or inkjet printer.
2. Fold the printed page along the horizontal line.
3. Place label in shipping pouch and affix it to your shipment so that the barcode portion of the label can be read and scanned.

Warning: Use only the printed original label for shipping. Using a photocopy of this label for shipping purposes is fraudulent and could result in additional billing charges, along with the cancellation of your FedEx account number.

Use of this system constitutes your agreement to the service conditions in the current FedEx Service Guide, available on fedex.com. FedEx will not be responsible for any claim in excess of \$100 per package, whether the result of loss, damage, delay, non-delivery, misdelivery, or misinformation, unless you declare a higher value, pay an additional charge, document your actual loss and file a timely claim. Limitations found in the current FedEx Service Guide apply. Your right to recover from FedEx for any loss, including intrinsic value of the package, loss of sales, income interest, profit, attorney's fees, costs, and other forms of damage whether direct, incidental, consequential, or special is limited to the greater of \$100 or the authorized declared value. Recovery cannot exceed actual documented loss. Maximum for items of extraordinary value is \$500, e.g. jewelry, precious metals, negotiable instruments and other items listed in our Service Guide. Written claims must be filed within strict time limits, see current FedEx Service Guide.

ATTACHMENT NO. 9

Cliff Berry, Inc.
Miami Facility Closure Plan
Revised: September, 2005

Introduction:

Cliff Berry, Inc. (CBI) operates a used oil transfer station which receives used oil, oily water and contaminated soil which are generated by retail gasoline stations, oil companies, automobile dealerships, airports and marine interests. All product is delivered to the CBI plant by over the road transport vehicles or railroad tank cars. The facility has a capacity of storing approximately 1.3 million gallons of used oil and oily waste water.

The facility operates under licenses issued by the Miami Dade County Department of Environmental Resource Management (DERM), and the State of Florida Department of Environmental Protection (FDEP). Company owned transport vehicles are licensed by Broward County Department of Planning and Environmental Protection (DPEP) and Miami Dade County Department of Environmental Resources Management (DERM). All oily liquids and contaminated soils are transferred and stored within containment areas which have been designed to meet rules and regulations current at the time of installation. All oily liquids and contaminated soils delivered to the facility are handled under manifests issued by the generators.

General Provisions:

As required by the Florida Administrative Code (FAC) Rule 63-710.800 (9), CBI has adopted this document to be used as required, during the closure of the facility.

At closure, CBI will institute the following steps:

1. Remove all standing liquids, waste and waste residues from the facility. All stored liquids will be tested, if POTW standards are met, discharge will be made to the sewer system. All liquids which do not meet POTW standards will be transferred to a suitable transfer station.
2. Current plans require that the closure event will result in the complete cessation of all operations at the CBI Transfer Station. Management does not contemplate partial operation of the facility. There will be no need for further facility maintenance.
3. All on site monitoring wells will be sampled in accordance with an approved Quality Assurance Plan and analyzed for US EPA approved mixed product analytical group parameters - Volatile Halocarbons (601), volatile aromatics in water (602), Total Volatile Aromatics (VOA), Poly-nuclear Aromatic Hydrocarbons (610, 1,2 dibromomethane (EDB), Methyl tert-butyl ether (MTBE) and lead.

4. A split spoon coring device will be used for the extraction of composite soil samples (taken from the surface to groundwater). Soil samples will be taken from areas immediately adjacent to where trucks are stored. Visual inspection of soils adjacent to the containment area will determine the location of soil sampling. An OVA/FID instrument will be used for the detection of organic contamination at levels greater than 50 parts per million. The samples identified as being most contaminated will be submitted to an approved laboratory for analysis and identification of individual constituents. Should contamination be found, CBI will submit a Contamination Assessment Plan (CAP). After the approval and implementation of the CAP a Contamination Assessment Report (CAR) and Remedial Action Plan (RAP) will be developed.
5. All tanks, piping, secondary containment and ancillary equipment will be emptied, cleaned and decontaminated as necessary. Filter sand, sludge and treatment process residues will be tested for hazardous characteristics; disposal of these items will be consistent with the results of the analysis. Contaminated surfaces will be high pressure washed with appropriate detergents. The effectiveness of all decontamination steps will be assessed by using swab samples of the formerly contaminated surfaces. Decontamination will be confirmed through the analysis of final rinsate liquids.

All assessment and remedial work will be done in accordance with the Florida Administrative Code (F.A.C.) Rules 62-762 and 62-710.510.

Should material or containerized soils be encountered during the closure, steps will be taken to control mitigation of hazardous waste and hazardous waste constituents from the affected area into ground or surface water. Used oil will not contaminate ground or surface water.

These steps will include:

1. Contaminated material will be containerized and sealed prior to their proper disposal to prevent runoff due to rainfall.
2. Isolation of contaminated areas and materials from contact with personnel. Closed, covered containers will be utilized for soils.
3. Separation of decontaminated material from non-contaminated materials.
4. Containment of all wash water and decontamination materials. Such will be handled as appropriate, either as a hazardous waste through a manifest or will be discharged to POTW. Approval from the POTW will be obtained prior to release.

During the execution of the above steps, the following factors will provide the basis of action:

1. Should disposal of closure generated materials require land treatment, the type and

amount of hazardous waste and hazardous waste constituents along with the mobility and expected rate of migration of the material will be evaluated prior to implementing a remedial plan.

2. Factors such as location, topography surrounding land use, climate (frequency) and PH of precipitation and biological characteristics of potential disposal sites will be performed.
3. Site specific studies involving unsaturated zone monitoring, type, concentration and depth of migration of hazardous waste constituents in the soil as compared to their background concentrations will be performed.

Prior to initiating site closure, the following will be done:

- i. Contaminated soil and liquids will be manifested off site to a permitted TSD facility.
- ii. Tanks, piping and machinery will be either removed and/or decontaminated.
- iii. Placement of final cover considering:
 - a. Functions of the cover.
 - b. Characteristics of the cover including material, final surface contours, thickness, porosity/permeability, slope, length of run of slope and type of area vegetation.
 - c. Monitoring of groundwater.

Final Closure:

Sixty (60) days prior to the scheduled date of closing of the Facility, CBI will submit an updated and detailed closure plan to the FDEP.

In the event hazardous wastes are temporarily stored, a revised final plan will be submitted. This plan will be issued during a closure event and will identify the steps necessary to perform partial and/or final closure of the facility. The amended closure plan will include:

1. A description of how each hazardous waste management unit at the facility will be closed.
2. A description of how final closure of the facility will be conducted. The description will identify the maximum extent of operation which will be unclosed during the active life of the facility,.
3. A projection of the maximum inventory of hazardous waste stored on site over the active life of the facility; and a detailed description of the methods to be used during partial and

final closure including but not limited to procedures for cleaning equipment and removing contaminated soils, methods for sampling and testing surrounding soils, and criteria for determining the extent of contamination necessary to satisfy the closure performing standards.

4. A detailed description of the steps necessary to remove or decontaminate all hazardous waste residues and contaminated material systems components, equipment, structures, and soil during partial and final closure including but not limited to procedures for cleaning equipment and removing contaminated soils, methods for sampling and testing surrounding soils, and criteria for determining the extent of contamination necessary to satisfy the closure performing standards.
5. A detailed description of other activities necessary during the partial or final closure period to insure that all closure activities satisfy the closure performance standards including but not limited to groundwater monitoring, leachate collection, and run-on and run-off control.
6. A schedule for closure of each hazardous waste management unit and for final closure of the facility. The schedule will include the total time required to close each hazardous waste management unit and the time required for intervening closure activities which will allow tracking of the progress of partial and final closure.

Within thirty (30) days of final closure of the Facility, CBI will submit a certification of closure completion to the FDEP demonstrating that the Facility was closed in substantial compliance with the detailed Closure Plan.