

FLORIDA DEPARTMENT OF TRANSPORTATION  
FAIRBANKS DISPOSAL PIT SURVEY

SITUATED IN  
ALACHUA COUNTY, FLA.

SURVEYOR'S NOTES:

- 1) THIS IS NOT A BOUNDARY SURVEY.
- 2) THE MAP SHOWN HEREON IS BASED ON AERIAL PHOTOGRAPHY PERFORMED BY ABBAMS AERIAL SURVEY CORP., GAINESVILLE, FLA.
- 3) STEREO REDUCTION OF ABOVE REFERENCED AERIAL SURVEY IS BASED ON A HORIZONTAL CONTROL FIELD SURVEY BY HENDERSON, QUINN AND ASSOC., INC., GAINESVILLE, FLORIDA DATED APRIL, 1987. HORIZONTAL CONTROL IS BASED ON THE GPS SURVEY OF ALACHUA COUNTY, FL. DATED 1988/1989, AND IS TIED TO GPS POINT 0842 AND AOTA.
- 4) COORDINATE GRID SHOWN HEREON IS BASED ON STATE PLANE COORDINATES OF POINTS REFERENCED ABOVE OF THE ALACHUA COUNTY GPS SURVEY. ALL COORDINATES FURNISHED ARE FLORIDA STATE PLANE GRID COORDINATES.
- 5) VERTICAL DATUM OF THIS SURVEY IS USGS 1989 NATIONAL GEODETIC VERTICAL DATUM. VERTICAL CONTROL FOR THIS SURVEY IS BASED ON A FIELD SURVEY BY HENDERSON, QUINN AND ASSOC., INC., GAINESVILLE, FL. DATED MAY, 1987.
- 6) ALL WELL LOCATIONS SHOWN HEREON AND FURNISHED COORDINATES AND ELEVATIONS ARE BASED ON FIELD MEASUREMENTS. ALL ELEVATIONS FURNISHED FOR WELLS SHOWN ARE ELEVATION OF "TOP OF CASING" OR "TOP OF CAP" UNLESS NOTED OTHERWISE.
- 7) BASIS OF BEARINGS FOR THIS SURVEY IS STATE PLANE COORDINATE SYSTEM.
- 8) ALL DISTANCES BETWEEN COORDINATES FURNISHED ARE GRID DISTANCES (ADJUSTED FIELD MEASURED DISTANCES).

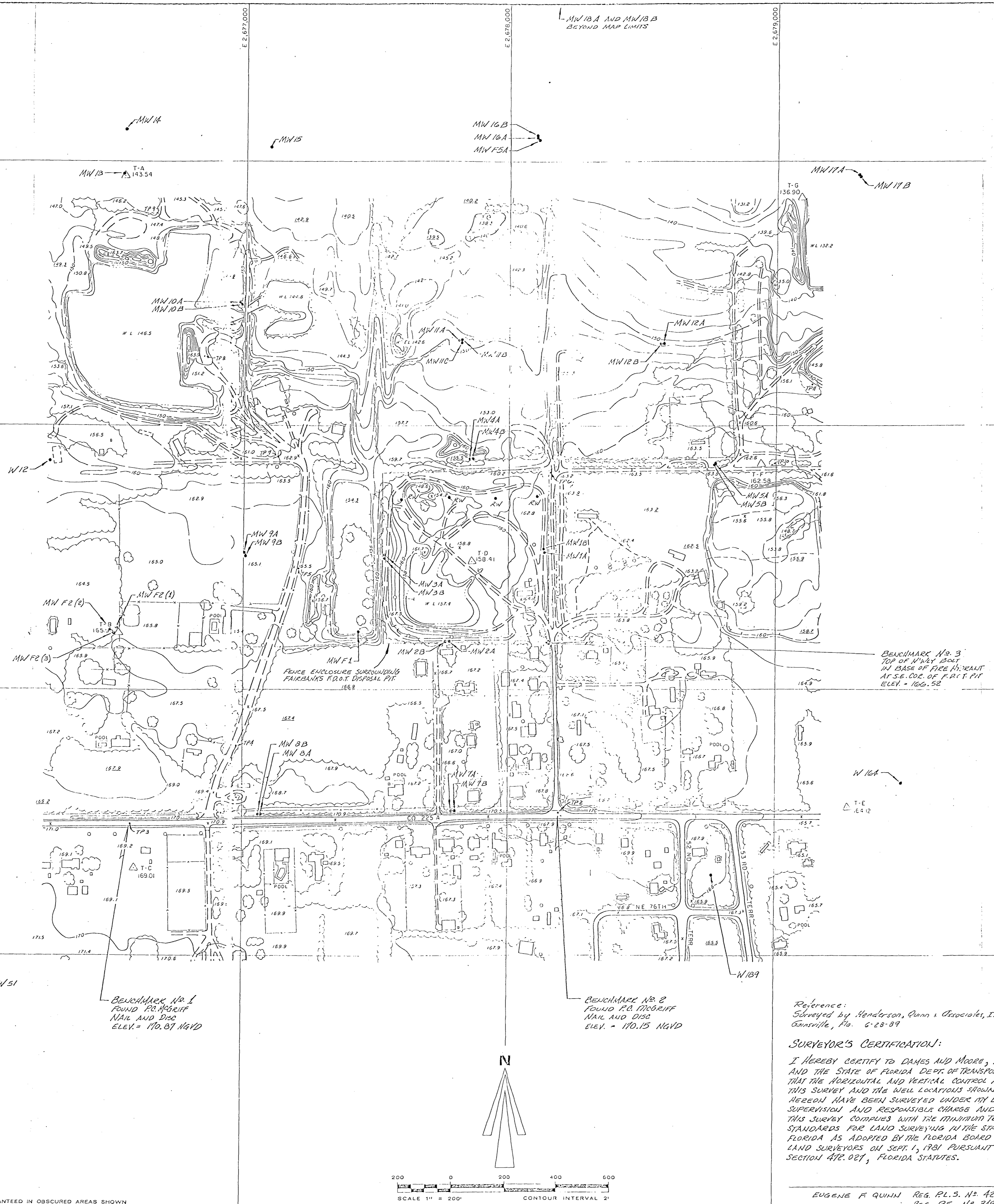

- LEGEND
- Δ-T-A - DENOTES AERIAL TARGET LOCATION
  - H— - DENOTES CONTOUR LINE AND ELEVATION
  - R— - DENOTES GRADED ROADS
  - X— - DENOTES EXISTING FENCE
  - T— - DENOTES TREE CANOPY OUTLINE
  - 162.9 - DENOTES SPOT ELEVATION
  - - DENOTES WELL LOCATION
  - RW - DENOTES RECOVERY WELL
  - MW - DENOTES MONITOR WELL
  - W - DENOTES WELL
  - T.P. - DENOTES TURNING POINT FOR FIELD TRAVERSE
  - N.C. - DENOTES WATER LEVEL ELEVATION

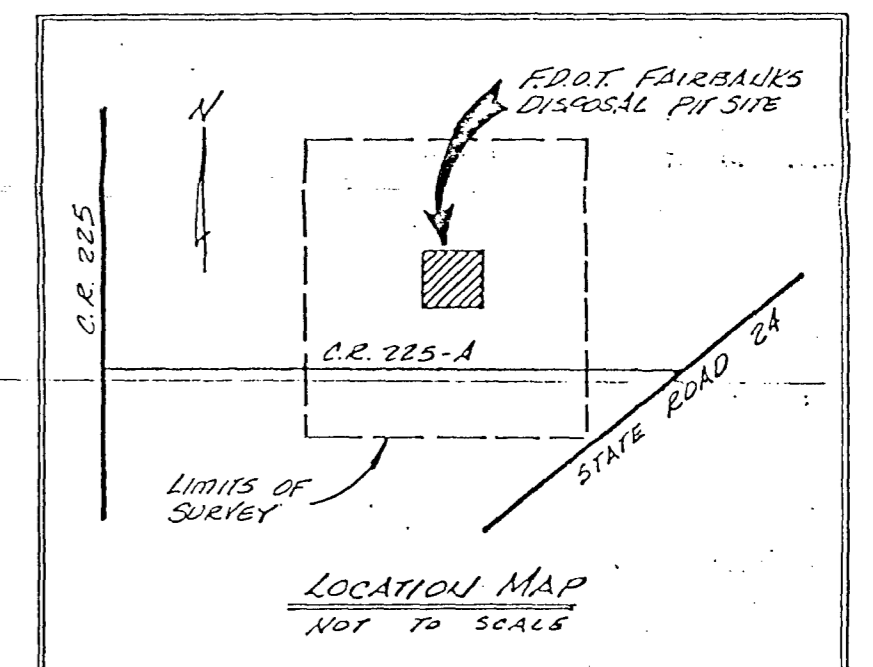

BENCHMARK No. 3  
TOP OF N.W. 1/4 2567  
IN BASE OF TREE TRUNK  
AT S.E. COR. OF F.A.T. PIT  
ELEV. = 166.52

BENCHMARK No. 1  
FOUND P.C. MOORE  
NAIL AND DISC  
ELEV. = 170.87 NGVD

BENCHMARK No. 2  
FOUND P.C. MOORE  
NAIL AND DISC  
ELEV. = 170.15 NGVD

Reference:  
Surveyed by Henderson, Quinn & Associates, Inc.  
Gainesville, Fla. 6-28-89

**SURVEYOR'S CERTIFICATION:**  
I HEREBY CERTIFY TO DAMES AND MOORE, INC., AND THE STATE OF FLORIDA DEPT. OF TRANSPORTATION THAT THE HORIZONTAL AND VERTICAL CONTROL FOR THIS SURVEY AND THE WELL LOCATIONS SHOWN HEREON HAVE BEEN SURVEYED UNDER MY DIRECT SUPERVISION AND RESPONSIBLE CHARGE AND THAT THIS SURVEY COMPLIES WITH THE MINIMUM TECHNICAL STANDARDS FOR LAND SURVEYING IN THE STATE OF FLORIDA AS ADOPTED BY THE FLORIDA BOARD OF LAND SURVEYORS ON SEPT. 1, 1981 PURSUANT TO SECTION 472.021, FLORIDA STATUTES.

EUGENE F. QUINN REG. P.L.S. No. 425B FL.  
REG. P.E. No. 3490B FL.

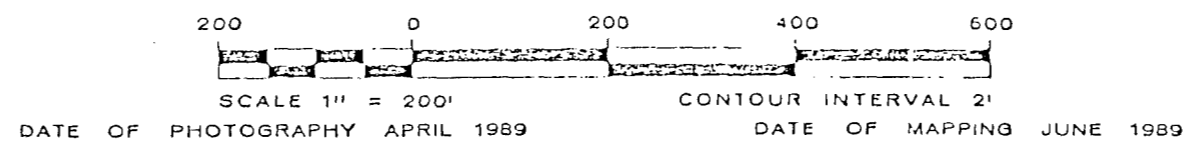
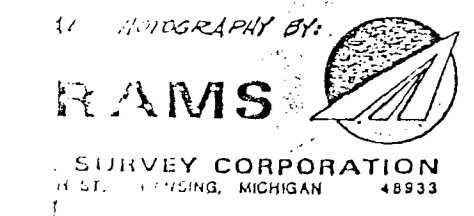

ACCURACIES NOT GUARANTEED IN OBSCURED AREAS SHOWN BY DASHED CONTOURS AND UNDERLINED ELEVATIONS.

DAMES & MOORE  
A PROFESSIONAL LIMITED PARTNERSHIP  
150 WEST CAMINO GARDENS BOULEVARD  
SUITE 1000, FLORIDA 32609

SURVEY OF FDOT  
FAIRBANKS DISPOSAL PIT

RECEIVED  
OCT 15 1992  
FAIRBANKS WASTE  
PERMITTING

DRAWN BY:	R. L. ENGELHARDT
CHECKED BY:	R. L. ENGELHARDT
APPROVED BY:	R. L. ENGELHARDT
DATE:	6-28-89

REVISIONS	

FIGURE IV-1

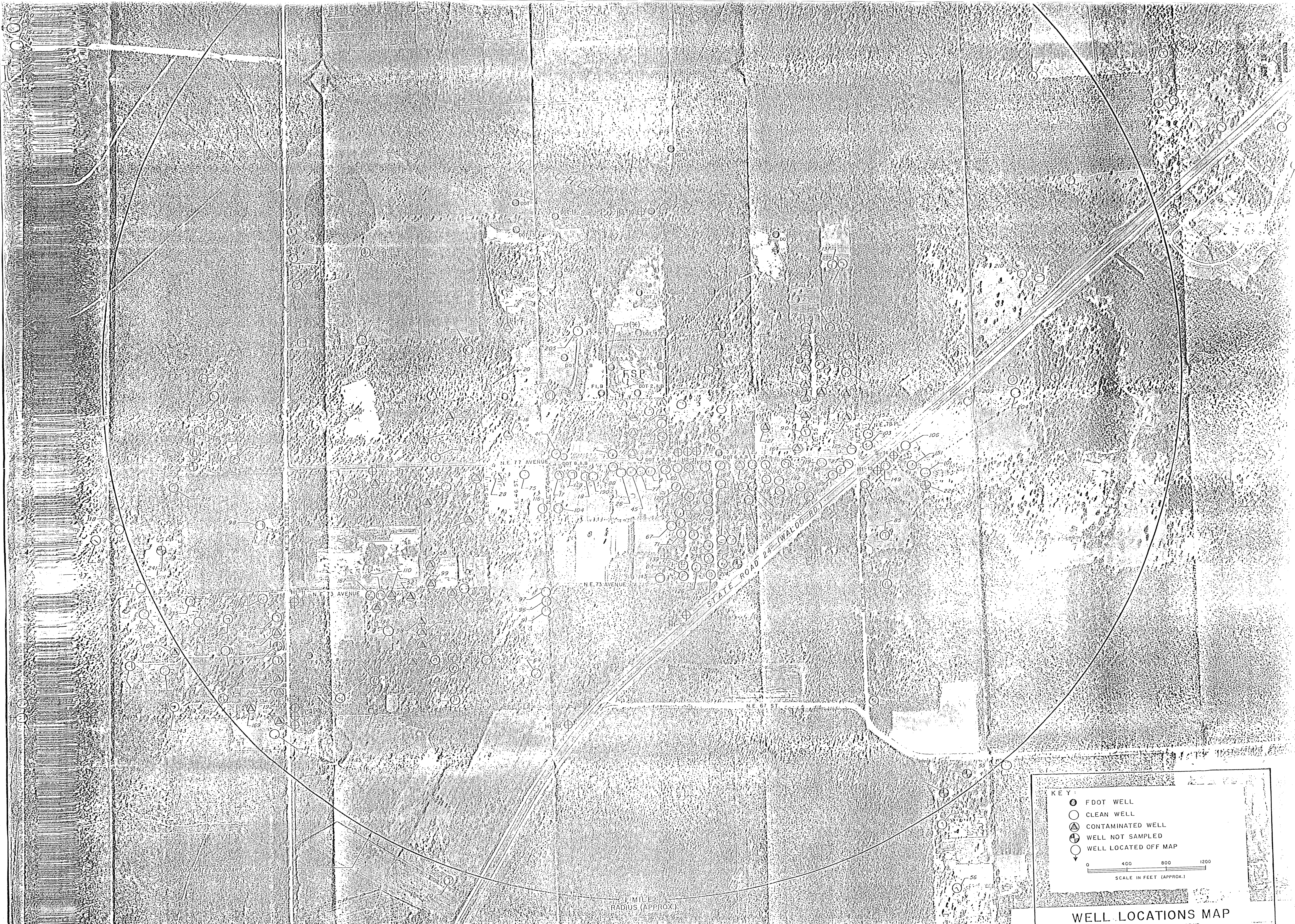

KEY:

- FDOT WELL
- CLEAN WELL
- ⊠ CONTAMINATED WELL
- ⊕ WELL NOT SAMPLED
- ⊙ WELL LOCATED OFF MAP

0 400 800 1200  
SCALE IN FEET (APPROX.)

WELL LOCATIONS MAP

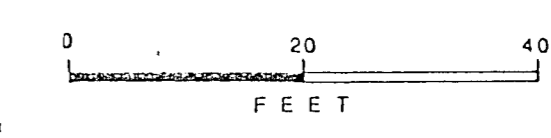
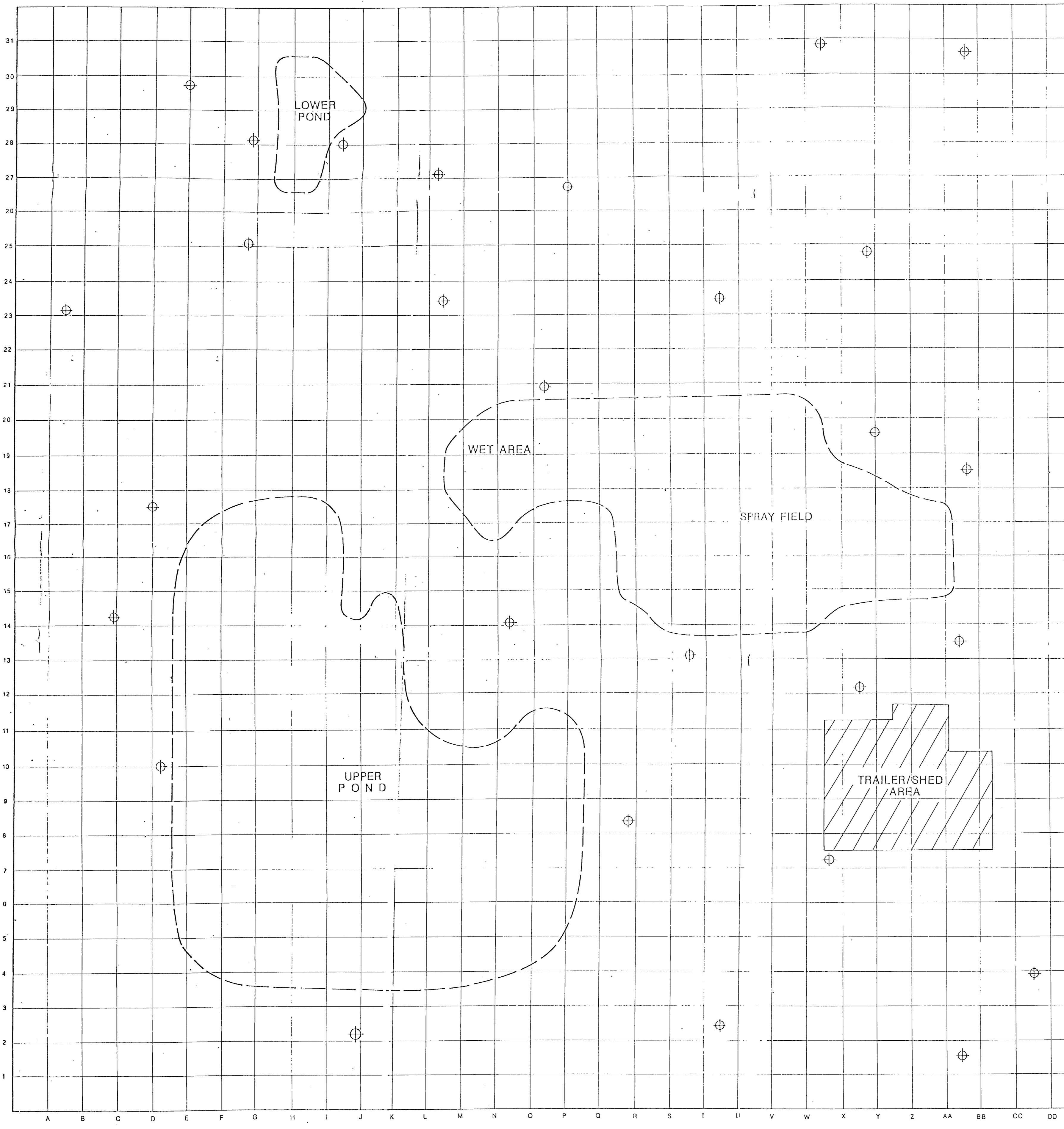

LEGEND:  
 ⊕ PROPOSED SOIL BORING LOCATION

REVISIONS

DRAWN BY :	R. ALZATE
CHECKED BY :	R. ENGELHARDT
APPROVED BY :	R. ENGELHARDT
DATE :	6-26-89
JOB No. :	11120005 02/13/89

PROPOSED  
 SOIL BORING LOCATION PLAN  
 FAIRBANKS DISPOSAL PIT

**RECEIVED**  
 OCT 15 1992  
 HAZARDOUS WASTE  
 CONSULTING

**DAMES & MOORE**  
 A PROFESSIONAL LIMITED PARTNERSHIP  
 100 WEST CAMINO GARDENS BOULEVARD, SUITE 201  
 BOCA RATON, FLORIDA 33431  
 (407) 361-9070

FIGURE III-4

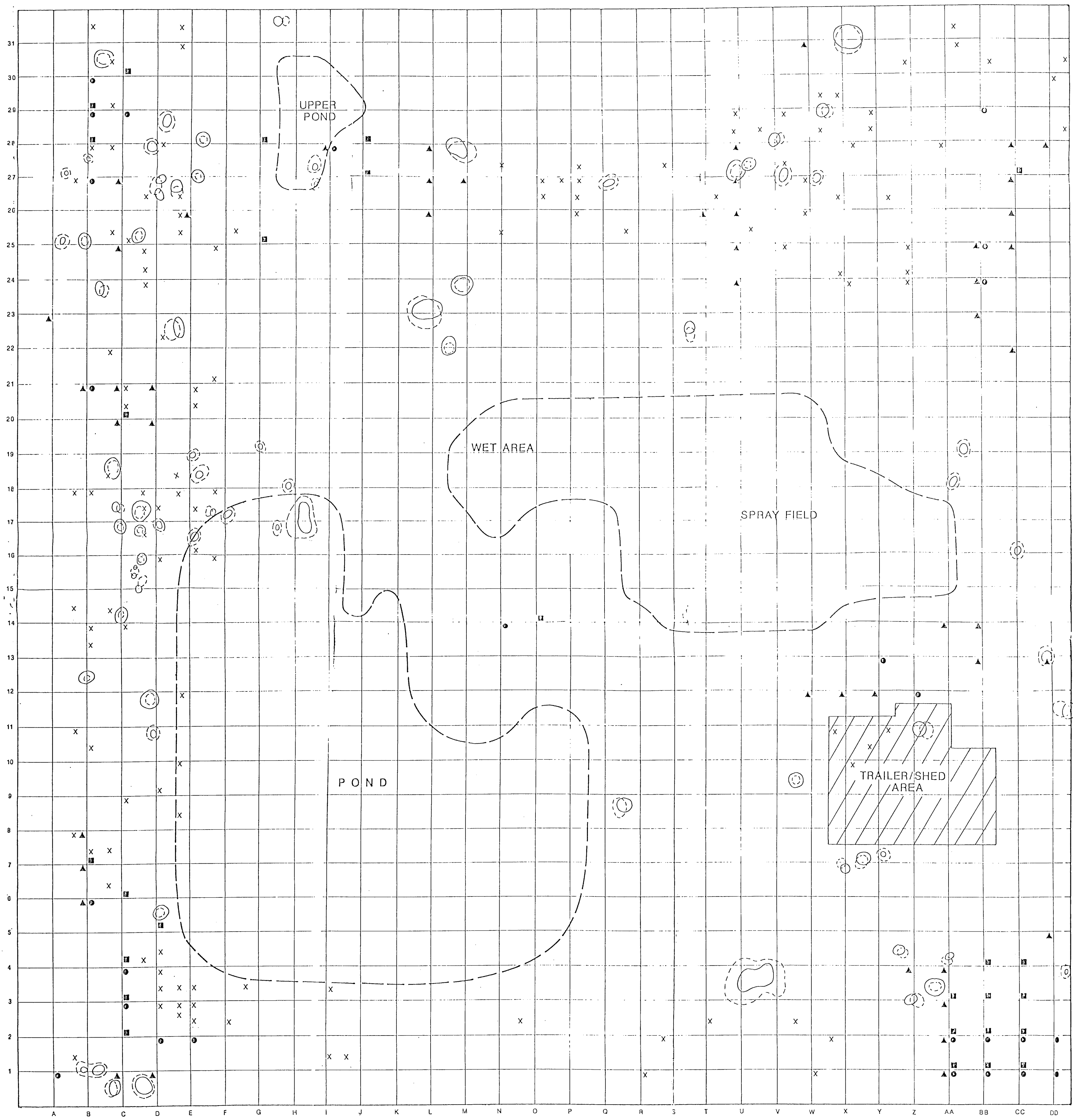

LEGEND :

- EM31-D
- EM34-3 (VERTICAL)
- ▲ EM34-3 (HORIZONTAL)
- x ANOMALIES LOCATED DURING THE 1987 GPR SURVEY
- ⊗ ANOMALIES LOCATED DURING THE 1983 METAL DETECTOR AND MAGNETOMETER SURVEY

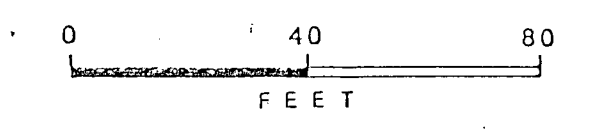

**DAMES & MOORE**  
 PROFESSIONAL LIMITED PARTNERSHIP  
 130 WEST CAMINO GARDENS BOULEVARD, SUITE 201  
 BOCA RATON, FLORIDA 33433  
 (561) 994-0070

**RECEIVED**  
 OCT 15 1992  
 HAZARDOUS WASTE  
 PERMITTING

**ELECTROMAGNETIC CONDUCTIVITY SURVEY**  
**FAIRBANKS DISPOSAL PIT**

DRAWN BY : R. ALZATE  
 CHECKED BY : R. MACWILLIAMS  
 APPROVED BY : R. ENGELHARDT  
 DATE : 6-28-89  
 JOB No. 11120005-02/43/091

REVISIONS

FIGURE III-3

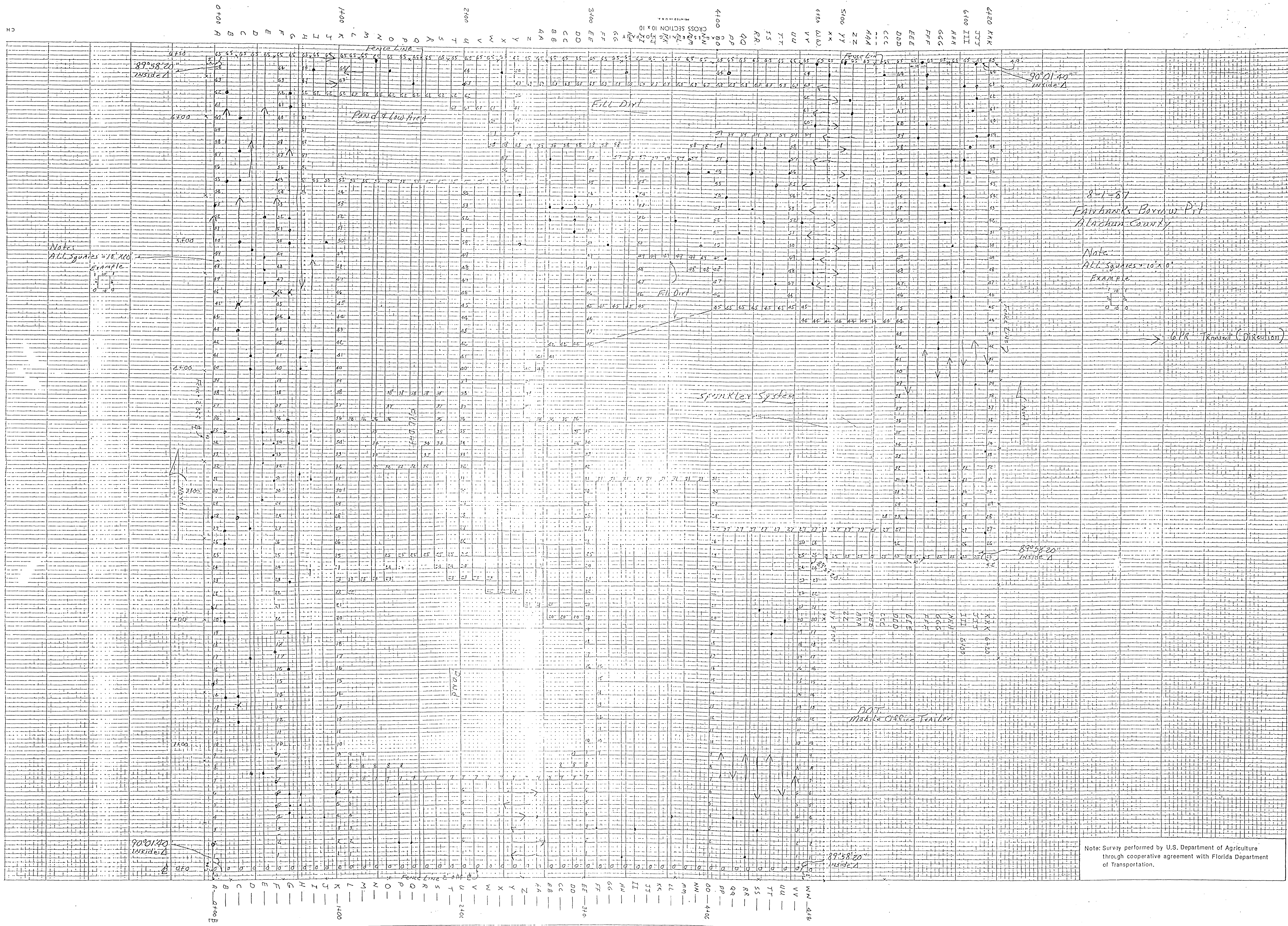

**DAMES & MOORE**  
 A PROFESSIONAL LIMITED PARTNERSHIP  
 120 WEST CAIRO GARDENS BOULEVARD, SUITE 301  
 BOCA RATON, FLORIDA 33433  
 (407) 993-6000

**RECEIVED**  
 OCT 15 1992  
 HAZARDOUS WASTE PERMITTING

**GROUND PENETRATION RADAR SURVEY**  
**FAIRBANKS DISPOSAL PIT**

DRAWN BY: R. ALZATE  
 CHECKED BY: R.L. FUGELHARDT  
 APPROVED BY: R.L. FUGELHARDT  
 DATE: 6-28-89  
 JOB No. 11128-005-024

REVISIONS

8-1-87  
 Fairbanks Boxway Pit  
 Alachua County

Note:  
 All Squares = 10' x 10'  
 EXAMPLE

GPR Traversal (Direction)

89°58'20"  
 Inside Δ

90°01'40"  
 Inside Δ

DOT  
 Mobile Office Trailer

Note: Survey performed by U.S. Department of Agriculture through cooperative agreement with Florida Department of Transportation.

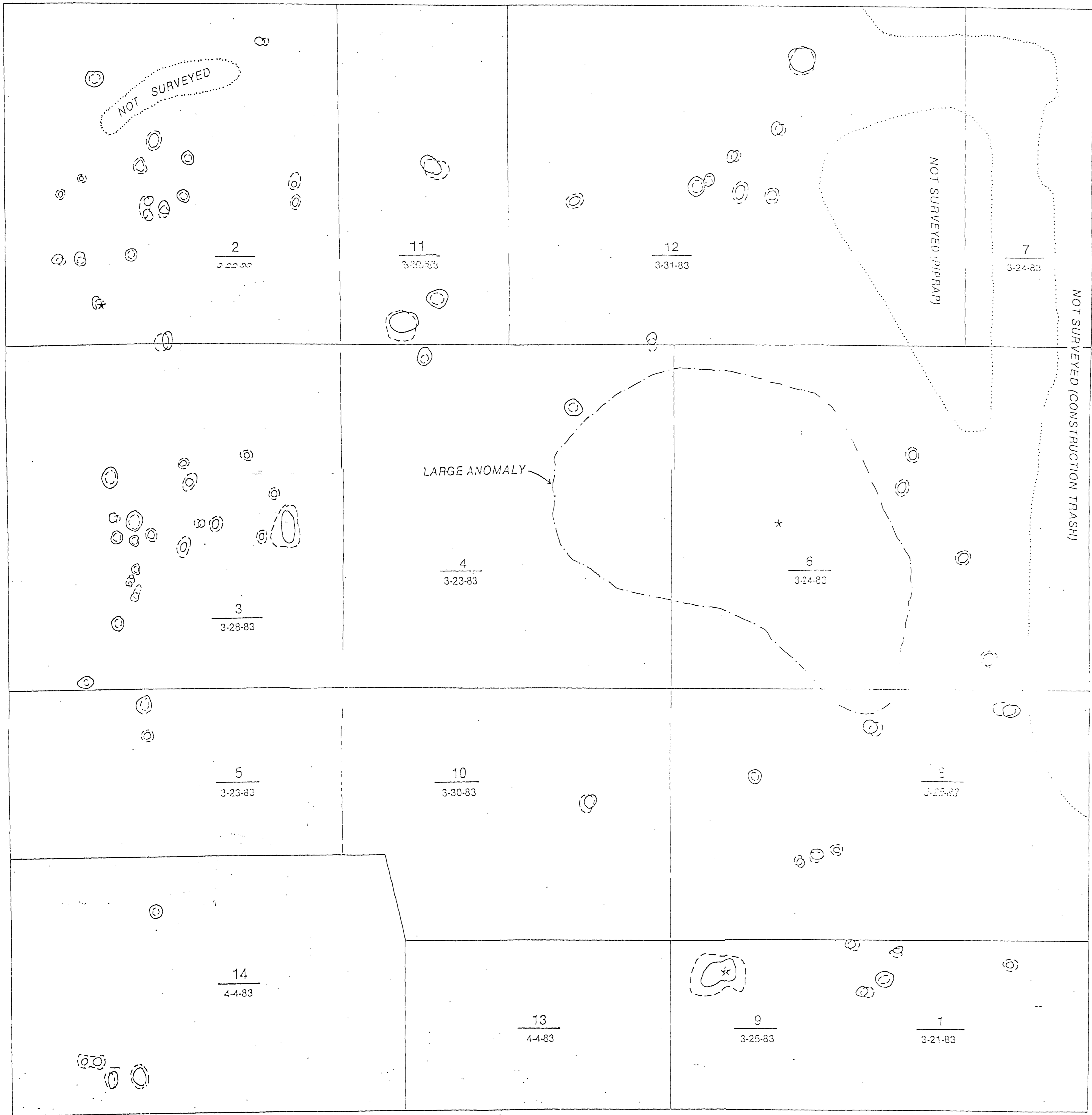

**LEGEND:**  
 --- MAGNETOMETER  
 --- METAL DETECTOR  
 \* AREA REQUIRING FURTHER INVESTIGATION  
 1 QUADRANT NUMBER  
 3-21-83 DATE SURVEYED

**NOTE:**  
 DOT PERSONNEL HAVE IDENTIFIED ALL ANOMALOUS SOURCES AS METALLIC TRASH, EXCEPT FOR STARRED (\*) AREAS.  
 SURVEY PERFORMED BY ENVIRONMENTAL SCIENCE AND ENGINEERING, INC. UNDER SUBCONTRACT TO DAMES & MOORE.

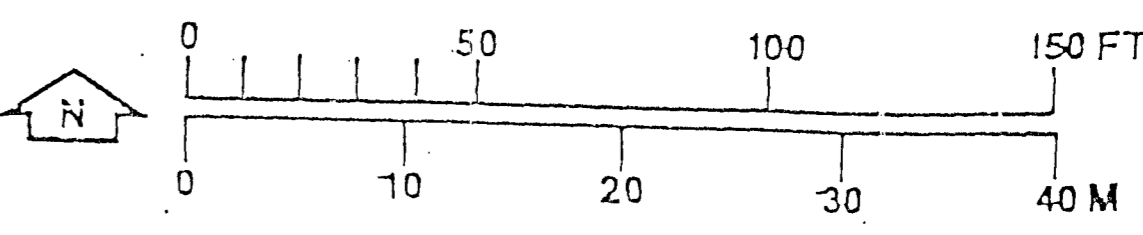

**MAGNETOMETER-METAL DETECTOR SURVEY**  
**FAIRBANKS DISPOSAL PIT**

**DAMES & MOORE**  
 A PROFESSIONAL LIMITED PARTNERSHIP  
 300 WEST CAMINO CARDENS BOULEVARD, SUITE 200  
 BOCA RATON, FLORIDA 33432  
 (407) 369-9000

DRAWN BY: R. ALZATE
CHECKED BY:
APPROVED BY: R. L. ENGELHARDT
DATE: 6-28-89
JOB No.: 1120-005-024

REVISIONS

FIGURE III-1

OCT 15 1992  
 HAZARDOUS WASTE PERMITTING

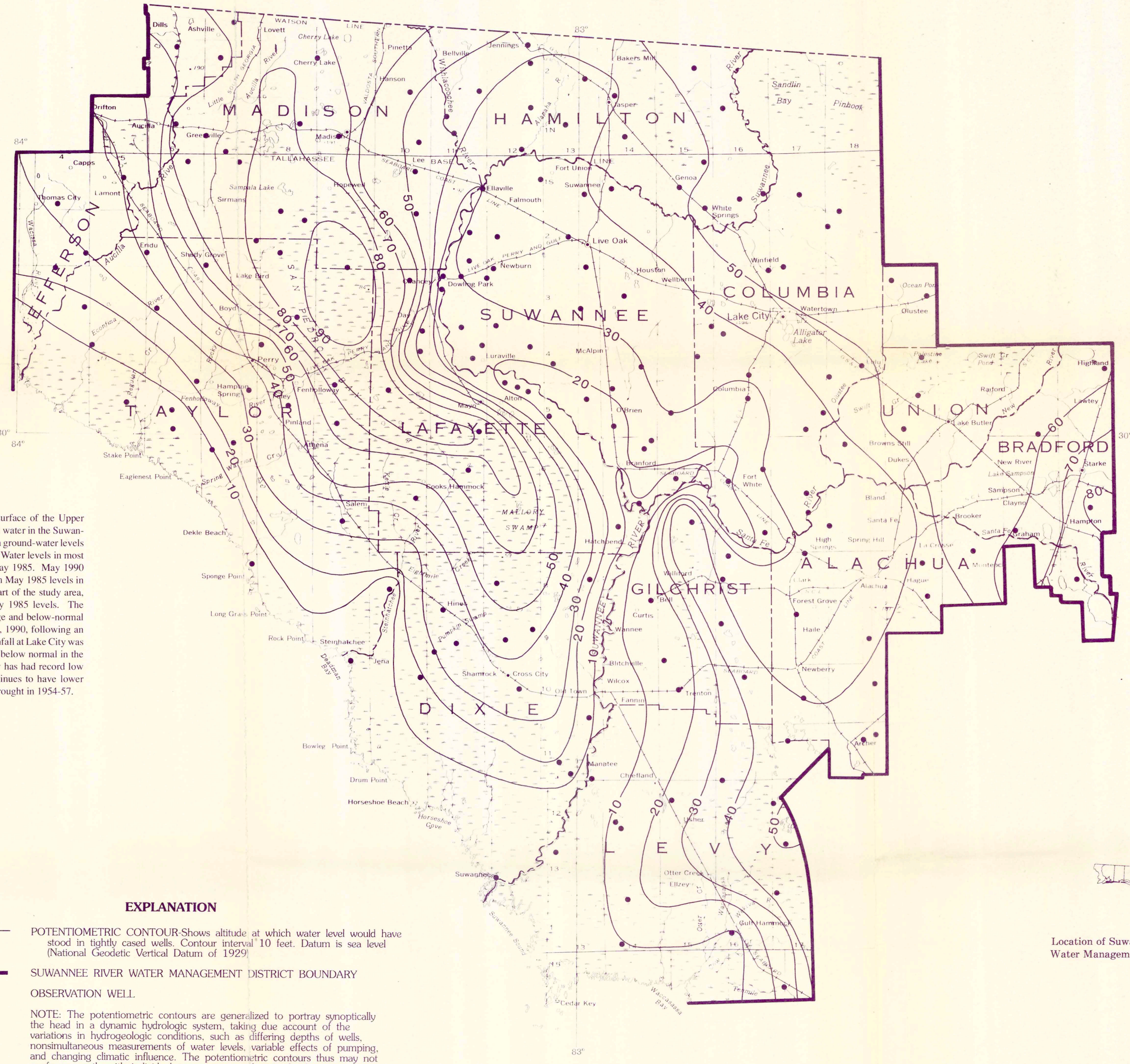

This map shows the May 1990 potentiometric surface of the Upper Floridan aquifer, the principal source of fresh ground water in the Suwannee River Water Management District and is based on ground-water levels measured during the annual low water-level period. Water levels in most wells measured were lower in May 1990 than in May 1985. May 1990 levels were slightly lower, about 1.5 feet or less, than May 1985 levels in the western part of the study area. In the eastern part of the study area, May 1990 levels averaged 4.5 lower than the May 1985 levels. The water-level declines are related to irrigation pumpage and below-normal rainfall. Water-level data were collected May 14-18, 1990, following an extended period of deficient rainfall. Cumulative rainfall at Lake City was 10.55 inches below normal in 1989 and 7.85 inches below normal in the first part of 1990. One long-term well at Lake City has had record low water levels for eight consecutive months and continues to have lower water levels than those measured during the major drought in 1954-57.

**EXPLANATION**

- 10 — POTENTIOMETRIC CONTOUR—Shows altitude at which water level would have stood in tightly cased wells. Contour interval 10 feet. Datum is sea level (National Geodetic Vertical Datum of 1929).
- — SUWANNEE RIVER WATER MANAGEMENT DISTRICT BOUNDARY
- OBSERVATION WELL

NOTE: The potentiometric contours are generalized to portray synoptically the head in a dynamic hydrologic system, taking due account of the variations in hydrogeologic conditions, such as differing depths of wells, nonsimultaneous measurements of water levels, variable effects of pumping, and changing climatic influence. The potentiometric contours thus may not conform exactly with individual measurements of water level.

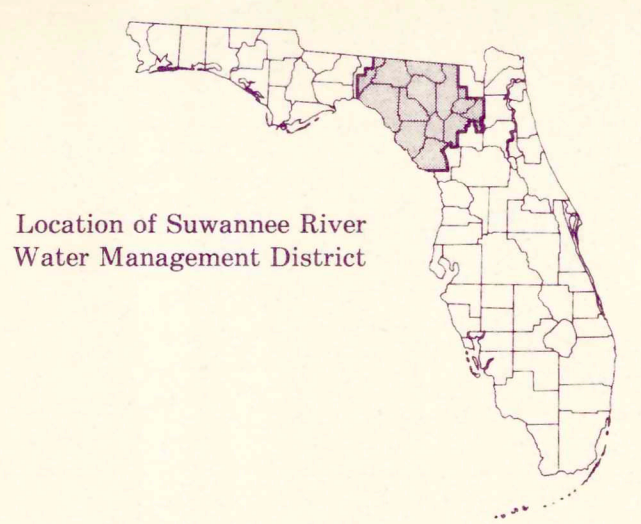
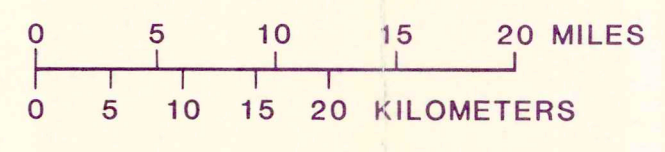

**POTENTIOMETRIC SURFACE OF THE UPPER FLORIDAN AQUIFER SYSTEM IN THE SUWANNEE RIVER WATER MANAGEMENT DISTRICT, FLORIDA, MAY 1990**

By Paul E. Meadows  
1991