

Russell, Merlin

From: Wyluda, John H <jwyluda@triumvirate.com>
Sent: Monday, October 28, 2013 3:22 PM
To: Russell, Merlin
Subject: RE: Final Responses
Attachments: Closure Plan updates.pdf

Hi Merlin,

Attached are the updated pages.

Thanks,
John

From: Russell, Merlin [<mailto:Merlin.Russell@dep.state.fl.us>]
Sent: Monday, October 28, 2013 10:43 AM
To: Wyluda, John H
Cc: Tripp, Anthony
Subject: RE: Final Responses

Good Morning John,

I have a few items to discuss with you. The sooner the better. I am available all day today and tomorrow. We can probably cover everything in 15-20 minutes. Thank you.

merlin

From: Wyluda, John H [<mailto:jwyluda@triumvirate.com>]
Sent: Thursday, October 24, 2013 12:01 PM
To: Russell, Merlin
Subject: Final Responses

Hi Merlin,

Attached are the updated pages to the Part B application.

Thank you,
John

John H. Wyluda
Lab Services and Compliance Coordinator | Triumvirate Environmental
P: 954.583.3795 | M: 443.370.8041
Email: jwyluda@triumvirate.com
www.triumvirate.com

Table II.k.1.g.2a

Table II.K.1.g.-2a			
B. Closure Cost Estimate for Transportation of Inventory			
90 Drums per Trip			
		<u>Quantity</u>	
1. AES Environmental, LLC.			
	Corrosive Liquids	72	
	Waste Fuel	440	
	Flammable Solids	12	
	Total Drums	524	
	Trips	10	
	Trip Cost	\$ 2,189.40	
Total Transportation Cost		\$ 21,894.00	
2. Stablex Canada			
	Inorganics	268	
	Oxidizers	12	
	Total Drums	280	
	Trips	4	
	Trip Cost	\$ 3,090.00	
Total Transportation Cost		\$ 12,360.00	
3. Ross Incineration Services			
	Poisons	16	
	Reactives	4	
	Total Drums	20	
	Trips	1	
	Trip Cost	\$ 2,075.00	
Total Transportation Cost		\$ 2,075.00	
Total Cost for Transportation Inventory			\$ 36,329

Table II.K.1.2.-5a

E.CLOSURE COST ESTIMATE FOR ENGINEER

Time to review closure plan in hrs:	4	
Time to inspect closure operations in hrs:	12	
Time to prepare certification of closure in	4	
Professional services in hrs:	20	
Cost of professional service per hr:	\$ 75.00	
Cost of engineer certifications:		1,500.00

Table II.K.1.g.-6a

Summary of Closure Cost Estimates

A. Disposal of Inventory	\$48,652.00
B. Transportation of Inventory	\$36,329.00
C. Decontamination of Structures	\$3,909.00
D. Sampling and Testing of Soils and Final Rinsates	\$5,376.00
E. Engineer Certification:	\$1,500.00
10% for Management and Supervision	\$9,576.6
10% for Contingencies	\$9,576.6
Total Closure Cost Estimate	\$114,919.2

The current Closure Fund maintained by Triumvirate Environmental (Florida), Inc. is \$156,585.00. The difference between this amount and \$104,410.08 represents additional contingency funds maintained by Triumvirate Environmental (Florida), Inc. This current amount will be the base Closure Fund for the facility for 2014 and this amount will be adjusted for inflation as required for subsequent years.

ROCKET BLVD.

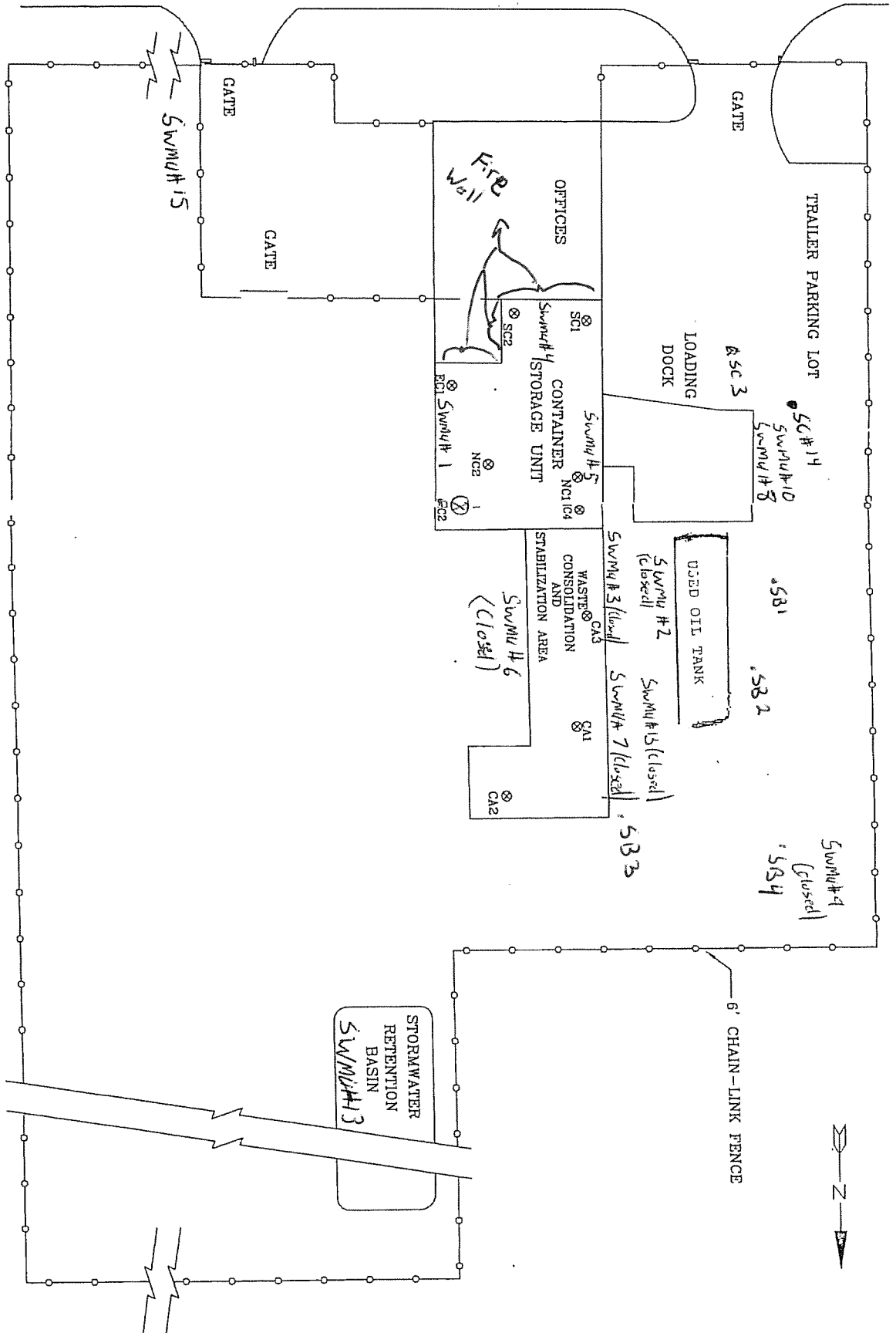

Triumvirate Environmental		ORLANDO, INC.	
FACILITY CLOSURE SAMPLING LOCATIONS			
and Solid Waste Management Units			
CHECKED BY:	DRAWN BY:	DATE DRAWN:	PROJECT #:
GBG	BAH	05-09-08	PTIOR080009
FIGURE II K 1		SCALE: 1" = 100'	
REVISION:		0	
<div style="display: flex; justify-content: space-between;"> <div> <p>SCHREIBER & YONLEY</p> <p>ENVIRONMENTAL ENGINEERS</p> </div> <div> <p>ENVIRONMENTAL ENGINEERS</p> </div> </div>			