



Environmental Protection and Growth Management Department
Pollution Prevention, Remediation and Air Quality Division
One North University Drive, Suite 203, Plantation, Florida 33324
954-519-1260 • FAX 954-765-4804

FDEP Notifier:
(Circle One) FLAGLER CONSTRUCTION EQUIPMENT, LLC
Facility Name:
(Current) FLAGLER CONSTRUCTION EQUIPMENT, LLC

Date: 4/9/2012

Current EPA ID: FLR 000007708

Facility Address: 5210 KREEP RD. DAVIE 33314

Facility Contact: TRACY GEDMAN

Generator Status:
(Circle One) Non-Handler Non-Notifier CESQG, SQG,
LQG

Phone Number: 954-581-4744

Facility Status:
(Circle One) Open Closed,
Potential HW Generator Yes No

Email Address: TGEDMAN@FLAGLERCE.COM

Employees (Number): 2

Compliance Assistance Visit (CAV) Areas of Concern

An inspection was conducted at your facility on the date listed above, under the authority of Section 403.091 and Chapter 403, Part IV of the Florida Statutes (F.S.). This inspection was designed to determine your facility's compliance with applicable Florida law regarding solid and hazardous waste management. Relevant provisions of Title 40 Code of Federal Regulations (CFR) §260-271 and §279 have been adopted in Chapters §62-710, §62-737, and §62-730 of the Florida Administrative Code (FAC) and Broward County Ordinance Chapter 27. During the inspection, the following potential items of non-compliance were identified by the inspector. Please note: this is not a formal enforcement action and may not be a complete listing of all items of non-compliance which exist at the time of the inspection.

Items Requested, Corrective Actions, and Inspector Comments:

CONSTRUCTION EQUIPMENT SERVICE FACILITY. FACILITY HAS DW AGST NEW OIL (4X50). FACILITY HAS SW AGST (1X50) USED, SW AGST FOR DIESEL (1X30). 7-55 GPD FOR USED OIL FILTERS, 200 GPD FOR USED COOLANT. RACS, BATTERIES, 1 PART WASHES. WASTE GENERATED: USED OIL - 1000 L/MONTH, USED OIL FILTERS - 5500 L/MONTH, PART WASHES - 14 GPD/YEAR (USED OIL). USED COOLANT - 200 L/MONTH, RACS - 10 L/MONTH LAUNDRY SERVICES. ALL CONTAINERS LABELED. CONTAINED. FACILITY NOT GENERATING SQG. NO LEAK. POUND 5710-12FC PROVIDED.

The owner/operator is hereby requested to correct all non-compliance issues. A written description of said corrective actions must be mailed or faxed, to the attention of the inspector at the address and number listed above or emailed to ekoenig@broward.org within (14) days of receipt of this Notice. Failure to correct the non-compliance item(s) will result in the Florida Department of Environmental Protection (FDEP) being notified. Be advised that FDEP may take enforcement action if non-compliance continues. If you need further assistance please contact the inspector at the phone number listed below.

Date of Notice: 4/9/12

Inspector Phone Number: (954) 740-0231

Operator Signature: T. Gedman

Inspector Name: Eduardo Koenig

Received by: TRACY GEDMAN

Return to Compliance Date

Follow-up Visit Required:
(Circle One) Yes No

Referred to FDEP: (Circle One) Yes No

Time Spent On Inspection,
Including prep time (in full
HOURS): 2 HRS

Signature: Eduardo Koenig

Violations Observed

General Requirements:

- Failure to ensure delivery of HW to proper HW facility {40 CFR §261.5}(27-356(b)(4)c.9) (RF)
- Failure to provide hazardous waste determination {40 CFR §262.11 (27-356(b)(4)c.9)} (RD)
- Facility exceeds 90/180 day time limit {40 CFR §262.34 (27-356(b)(4)c.8)} (RT)
- ✓ Failure to notify as generator {40 CFR §262.12; (27-353(g)(1)(RM))
- Failure to use a manifest or reclamation agreement {40 CFR §262.20 (27-356(b)(4)d.1)} (RM)
- Improper disposal of mercury containing devices {§62-737-300(1) FAC (27-353(g)(1)) (RM)
- Failure to provide personal training {40 CFR §265.16, §262.34(27-353(g)(1))} (RP)
- Evidence of release(s) of {40 CFR §262.34(d)(27-353(g)(2))} (RR)

Facility Record Keeping:

- Manifests 40 CFR §262.40, §262.44 (FM) (27-356(b)(4)d.1)
- Training Records 40 CFR §262.34 (d)(5) (FC) (27-356(b)(4)a.6))
- Contingency plan 40 CFR §262.34 (FC)(27-356(b)(4)a.6))
- Weekly inspection records {§62-730-160(6) FAC (FW)} (27-353(g)(1))
- Information not posted by phone 40 CFR §262.34(d)(4) (FI) (27-353(g)(1))
- Authorities not notified 40 CFR §262.34 (d)(5) (FA) (27-355)
- Failure to maintain disposal records §62-730-030 FAC (FB) (27-356(b)(4)d.1)
- Failure to label UW lamp containers §62-737.400(5) FAC (FE) (27-353(g)(1))

Used Oil/Filter Requirements:

- Failure to label oil containers {§279.2s(c) (OC) (27-356(b)(4)a.2.)}
- Oil containers in poor condition §62.710.401(6) FAC (OA) (27-356(b)(4)c.3)
- Oil containers without secondary containment {§62-710-401(6) FAC (OF) (27-356(b)(4)a.1.)}
- Failure to respond to releases {§279.22(d) (OR) (27-355)}
- Failure to document used oil disposal 40 CFR §279.10 (OD) (27-356(b)(4)d.1.)
- Failure to manage used oil filters §62-710.850(1) FAC (OI) (27-353(g)(1))

Container Management:

- Unlabeled containers {40 CFR §262.34(a)(3) (27-356(b)(4)a.2.)} (CL)
- Undated containers 40 CFR §262.34(a)(2) (FD) (27-356(b)(4)a.2.) (FD)
- Containers not in good condition (leaking/bulging) {40 CFR §265.171 (27-356(b)(4)c.3) (CD)}
- Open containers 40 CFR {§265.173 (CO) (27-356(b)(4)a.2.) (CO)}
- Inadequate aisle space {§62.730.160 FAC (27-356(b)(4)a.2.) (CA)}

Storage Tank Secondary Containment:

- Drain valves open {§62.671.700(3)(a)(3) FAC (SV) (27-309(c)(1)c. 27-356(b)(4)b.3.b)}
- Incomplete containment structure {§62-671.700(3)(c) FAC (SC) 27-307(3)c.3.b)}

Materials Provided for Compliance Assistance

- ✓ DEP Small Quantity Generator Handbook (MQ)
- Computer, TV, Electronic Facts, Recyclers (MY)
- Summary of Used Oil/Used Oil Filter Regs (MU)
- Flourescent lamps/Mercury Containing Devices (MM)
- Antifreeze for Recycling/Antifreeze Facts (MF)
- Florida Automotive Recycles Handbook (MA)
- ✓ EPA 8700-12 Document (ME)

- CAV - DEP HW Regulations, for CESQG (DC)
- CAV - DEP HW Regulations, for SQG (DR)
- CAV - Antifreeze Recycling Vendors List (MV)
- CAV - Spill Avoidance Response Procedures (MI)
- CAV - P2 Pamphlet (MP)
- CAV - Environmental Reg-Agriculture Industry (MG)

DEP Small Business Compliance Assistance Guides

- DEP Printers Handbook - SBA Program (DP)
- DEP Photo Shops Handbook (DO)
- DEP Pharmacies Handbook (DH)
- DEP Printed Wiring Board Manufacturers Handbook (DW)
- DEP Furniture Refinishers Handbook (DF)
- DEP Pain Body Shops Handbook (DB)
- DEP Fiber-Reinforced Plastic Mfrs. Handbook (DE)
- DEP Automotive Repair Handbook (DA)

- DEP Managing Hg at Med Facilities Handbook (DM)
- DEP Laboratories Handbook (DL)
- DEP Dry Cleaners Handbook (DD)
- Other Materials (specify in inspection comments) (DX)
- DEP Summary of HW Regulations (MH)
- Environmental Lab List (ML)
- List of HW/Used Oil Transporters (MT)
- Auto Repair Self-Audit Workbook (MZ)

NOTICE OF POTENTIAL HAZARDOUS WASTE NON-COMPLIANCE – Page 1 of 2

FACILITY NAME Flagler Construction Equipment		TYPE OF INSPECTION: CAV: <input type="checkbox"/> CEI: <input type="checkbox"/> CI: <input type="checkbox"/> OTHER: <input type="checkbox"/>	
ADDRESS 5210 Reese Road		CITY Davie	STATE FL
EPA ID NUMBER FLR00000708		DATE OF INSPECTION 8-19-15	PAGE 1 OF 2
FOLLOW UP CAV INSPECTION WITHIN 120 DAYS: <input type="checkbox"/> YES <input type="checkbox"/> NO			

A hazardous waste/used oil compliance inspection was made this date, under the authority of Section 403.091, Florida Statutes (F.S.), to determine your facility's compliance with Chapter 403, F.S. and Chapters 62-730 and 62-710, Florida Administrative Code (F.A.C.). Provisions of Title 40 Code of Federal Regulations (C.F.R.) Parts 260 through 268 and 279, which are cited on this form, have been adopted by reference as the state hazardous waste and used oil rules in Chapter 62-730 and 62-710, F.A.C. The following potential items of non-compliance were identified by the inspector(s). **This is not a formal enforcement action and may not be a complete listing of all items of non-compliance which exist at the time of this inspection.**

GENERAL REQUIREMENTS:

- ☐ Failure to ensure delivery of HW to proper HW facility § 261.5
- ☐ Failure to provide hazardous waste determination § 262.11
- ☐ Failure to notify as generator § 262.12
- ☐ Failure to use a manifest or reclamation agreement § 262.20
- ☐ Failure to provide personnel training § 265.16, 262.34
- ☐ Evidence of release(s) of waste § 265.31
- ☐ Facility exceeds 90/180 day time limit § 262.34

CONTAINER MANAGEMENT:

- ☐ Unlabeled containers § 262.34
- ☐ Undated containers § 262.34
- ☐ Leaking or bulging containers § 262.34
- ☐ Open containers § 265.173
- ☐ Inadequate aisle space § 62-730.160

RECORDKEEPING REQUIREMENTS:

- ☒ Manifests § 262.40, § 262.44 **2013 & 2015**
- ☐ Training records § 262.34
- ☒ Contingency Plan § 262.34 **update em #**
- ☐ Weekly Inspection records § 62-730.160
- ☐ Information not posted by phone § 262.34
- ☐ Authorities not notified § 262.37

USED OIL VIOLATIONS:

- ☐ Failure to label containers § 279.22
- ☐ Failure to respond to releases § 279.22
- ☐ Failure to document used oil disposal § 279.10

MATERIALS PROVIDED to assist in accomplishing corrective actions

☐ DEP Small Quantity Generator Handbook

☐ EPA Managing Used Oil

☐ Mercury Lamp Recyclers



☐ Environmental Yellow Pages

☐ Other _____

☐ List of HW/Used Oil Transporters

☐ Other _____

☐ Antifreeze Recycling Vendors

☐ Other _____

David "JR" Langworthy
Service Manager

Flagler Construction Equipment
5210 Reese Road
Davie, FL 33314
www.flaglerce.com

o: 954.581.4744
f: 954.583.0318
m: 954.707.9356
dlangworthy@flaglerce.com

Other: _____

Other: _____

Other: _____

Other: _____

HAZARDOUS WASTE INSPECTION EXIT INTERVIEW SUMMARY, NOTICE OF POTENTIAL VIOLATIONS
Page 2 of 2

ITEMS REQUESTED OR RECOMMENDATIONS BY THE "INSPECTOR":

- ① Please send 2013 and 2015 records for used oil.
Send three years of records for parts washer waste
- ② Please update the facility's SPCC emergency contact list
and send the signed attendees page for employees
attending the SPCC plan review.

OWNER/OPERATOR COMMENTS:

The owner/operator is hereby requested to submit in writing, within 7 days of this inspection, 1) a description of all corrective actions taken, 2) a schedule for completion of corrective actions to be taken and 3) a description of efforts to prevent recurrence of the above items to the person signing as "**INSPECTOR**", Florida Department of Environmental Protection, 400 North Congress Avenue, Suite 200, West Palm Beach, FL 33401. The actions taken within ___ days of this notice will be considered in determining whether enforcement, including the assessment of penalties, should be initiated.

IF YOU HAVE QUESTIONS, contact: Bridgette Buxell ⁶⁷²² at (561) 681-~~6600~~.

"INSPECTOR" (signature): _____ Date: 8-19-15

The undersigned person hereby acknowledges that he/she received a copy of this notice and has read and understands the same.

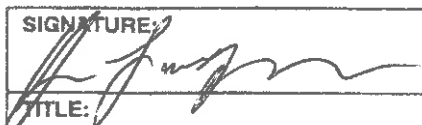
SIGNATURE: 	PRINTED NAME: <u>Sr. LANDWORTHY</u>
TITLE: <u>SERVICE MANAGER</u>	DATE: <u>8/18/15</u>

Facility Detailed List Report

Number of Facilities = 1

Facility Info									
Facility ID	County	Status	EPA ID	Other ID	Old Fac. ID	Follow Up			
11595	Broward	A - Active - Waste Generator	FLR000007708	04799	616263	N - None Needed			
Facility Name	Mailing Address	Location Address	Contact	Title	Phone	E-mail Address			
Flagler Construction Equipment Llc	5210 Reese Rd Davie, FL 33314	5210 Reese Rd Davie, 33314	Tracy Gedman	Mgr	(954) 581-4744				
STC Code	Gen Stat	Total HW Disposal	Data Type	Date	Org Contact	Org Code			
5082 - Wholesale Trade - Construction And Mining Machinery	3 - Cond Exempt Small Quantity Generator	1264	X - Esqg Verification	4/10/2013	Eduardo Koenig	6 - Broward			
Full-Time Employees	Facility Updated Date								
6	7/11/2013 7:53:02 AM								
Waste Info									
Waste Type	Storage Method	Disposal Method	Mo. (Units)	Max Mo. (Lbs)	Lbs / Year	Disposal Location	Ques Storage	Ques Disposal	RCRA Hazardous
AMNO - Antifreeze (Not Hw)	C5 - 40 Or More Gallon Container	ER - Exempt Recycle (Battery, Etc)	15 (GALLONS)	125	1501	Off-Site	N	N	N
BDEB - Lead-Acid Batteries	OG - Other Good	ER - Exempt Recycle (Battery, Etc)	15 (UNITS)	570	6840	Off-Site	N	N	N
NPIA - Mineral Spirits-Parts Cleaner	OP - Parts Washer	HH - Shipped For Hw Rcra Treatment	16 (GALLONS)	105	1263	Off-Site	N	N	Y
OBOU - Sludges & Solids With Tc Organics -Also Soils	OG - Other Good	HH - Shipped For Hw Rcra Treatment	1 (POUNDS)	1	1	Off-Site	N	N	Y
UPEO - Used Oils & Other Lubricants	TA - Tanks Above Ground	EU - Shipped For Used Oil Recycling	500 (GALLONS)	3810	45720	Off-Site	N	N	N
UREH - Rags With Oil	C1 - 0-9 Gallon Container	EC - Commercial Laundry (Rags)	15 (POUNDS)	15	180	Off-Site	N	N	N
UUNO - Uncrushed Oil Filters	C5 - 40 Or More Gallon Container	EU - Shipped For Used Oil Recycling	75 (POUNDS)	75	900	Off-Site	N	N	N
Activity Info									
Activity Type	Description	Activity Date	Return To Compliance Date						
DA	DEP Automotive Repair Handbook	4/9/2012							
ME	EPA 8700-12 NOTIFICATION DOCUMENT	4/9/2012							
MH	DEP Summary of HW Regulations	4/9/2012							

Signature: _____

Date: _____

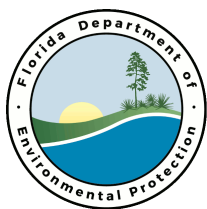

**Florida Department of
Environmental Protection
Hazardous Waste Inspection Report**

Draft

FACILITY INFORMATION:

Facility Name: Flagler Construction Equipment

On-Site Inspection Start Date: 08/19/2015

On-Site Inspection End Date: 08/19/2015

ME ID#: 7960

EPA ID#: FLR000007708

Facility Street Address: 5210 Reese Rd, Fort Lauderdale, Florida 33314-1205

Contact Mailing Address: 5210 Reese Road, Fort Lauderdale, Florida 33314

County Name: Broward

Contact Phone: (954) 581-4744

NOTIFIED AS:

Non-Handler

Used Oil

INSPECTION TYPE:

Routine Inspection for Used Oil Transporter facility

INSPECTION PARTICIPANTS:

Principal Inspector: Bridjette Bucell, Inspector

Other Participants: David Langworthy, Service Manager

LATITUDE / LONGITUDE: Lat 26° 4' 57.0" / Long 80° 13' 10.0"

SIC CODE: 7353 - Services - heavy construction equipment rental

TYPE OF OWNERSHIP: Private

Introduction:

Flagler Construction Equipment (Flagler) is a business which provides rental, sales, and servicing of heavy equipment. The facility is approximately five acres in size and is located in a commercial area. There are approximately 14 employees.

The facility is connected to city water and sewer, and has been in operation at the current location for about 30 years.

COMPLIANCE HISTORY

Flagler has notified with the Department as a Non-Handler of Hazardous Waste; Universal Waste Batteries. Flagler is also registered as a Used Oil Transporter, Used Oil Transfer Facility, Used Oil Filter Transporter, Used Oil Filter Transfer Facility (reg exp on 06/30/2016).

The facility has not been inspected by the Department. A Broward county inspection dated 04/09/2012 was reviewed during the facility's file review.

Process Description:

Technicians perform work, including oil and oil filter changes, both on-site and in the field. Field technicians will change the oil in the engine and then transport the used oil and used oil filters back to the facility. Used oil and used oil filters generated in the field are added to the used oil and used oil filters generated on-site. As a result of processes conducted at the facility waste streams include used oil, batteries, used oil filters, used antifreeze, and parts washer sludge. The facility consists of one building containing an office at the entrance, a product storage area, a parts room, and an equipment repair shop. The parts room is next to the office. The used batteries are stored on a pallet in this area. Spent

Inspection Date: 08/19/2015

Draft

battery's are picked up by Napa.

A PureWasher parts washer was observed in the equipment repair shop. The facility representative stated that the parts washer contains mineral spirits which is managed by the facility. The parts washer sludge is added to the used oil during annual clean-outs. Approximately 10 gallons is removed during this process. The mop water is added to the closed looped equipment wash. This area had a final clean rinse bath and Safety Kleen parts washer, as well. The remaining bays were set up in the same manner. Outside the bay doors, on the west

side of the property was the secondary containment structure for the aboveground used oil and diesel tanks. The used oil tank was labeled both "Used Oil" and "Waste Oil."

Behind the facility is the equipment wash rack and contaminated soil storage area. The contaminated soil was originally taken by Rinker but it's now transported to the Solid Waste Authority for incineration. Water from the equipment wash rack is on a closed looped filtering system.

The facility transports only the used oil and used oil filters generated through the mobile servicing of their own equipment, which is leased to other facilities for use. As such, the facility is not subject to Rule 62-710.600, F.A.C., with the exception of (2)(e) for financial responsibility. As the facility transports its own used oil and used oil filters to its own central collection facility for storage prior to having the used oil picked up by a certified used oil transporter (Safety Kleen), it is also not subject to the additional record keeping and reporting requirements of Rule 62-710.510, F.A.C.

RECORD REVIEW

Disposal records for used oil, used oil filters, oily absorbents and antifreeze were reviewed and appeared to be in order.

SPCC plan was reviewed and appeared to be out of date. The emergency contacts had employees listed that are no longer with the company. The Inspector also asked if the employees are trained or given the SPCC plan to review so that they are familiar with the companies procedures in the event that it will be needed.

Conclusion:

The facility appears to be in compliance.

Inspection Date: 08/19/2015

Draft

Signed:

A hazardous waste compliance inspection was conducted on this date, to determine your facility's compliance with applicable portions of Chapters 403 & 376, F.S., and Chapters 62-710, 62-730, 62-737, & 62-740 Florida Administrative Code (F.A.C.). Portions of the United States Environmental Protection Agency's Title 40 Code of Federal Regulations (C.F.R.) 260 - 279 have been adopted by reference in the state rules under Chapters 62-730 and 62-710, F.A.C. The above noted potential items of non-compliance were identified by the inspector(s).

This is not a formal enforcement action and may not be a complete listing of all items of non-compliance discovered during the inspection.

Bridgette Bucell

PRINCIPAL INSPECTOR NAME

Inspector

PRINCIPAL INSPECTOR TITLE

FDEP

ORGANIZATION

NOTE: By signing this document, the Site Representative only acknowledges receipt of this Inspection Report and is not admitting to the accuracy of any of the items identified by the Department as "Potential Violations" or areas of concern.

Mail original completed form to: Department of Environmental Protection For assistance call: 850-245-8707
2600 Blair Stone Road, Mail Station 4560
Tallahassee, Florida 32399-2400

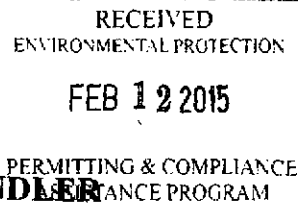

STATE OF FLORIDA
CERTIFICATE OF LIABILITY INSURANCE
HAZARDOUS WASTE TRANSPORTER AND USED OIL HANDLER

I. Sentry Select Insurance Company
(Name of Insurer)
(the "Insurer"), of 4400 E 53rd St Davenport IA 52807
(Address of Insurer)

hereby certifies that it has issued liability insurance covering bodily injury and property damage including environmental restoration for sudden accidental occurrences to

Flagler Construction Equipment
(Name of Insured)
(the "Insured"), of 8418 Palm River Rd Tampa FL 33619
(Physical Address of Insured)

in connection with the insured's obligation to demonstrate financial responsibility under Florida Administrative Code Rule 62-710.600(2) and 62-730.170. The coverage applies at:

EPA/DEP I.D. No. Name Physical Address
flr000097378 Flagler Construction EG 9601 Boggy Creek Rd Orlando 32824

flr000007708 Flagler Construction EQ 5210 Reese Rd Davie FL 33314

flr 0000 88518, Flagler Construction EQ, 8418 Palm River Road,
(If coverage is for multiple facilities, identify each facility insured.) Tampa, FL 33619

This insurance is primary and the company shall not be liable for amounts in excess of
\$ 15,000,000 for each accident, exclusive of legal defense costs. The coverage is provided
under policy number 2551455, issued on 5/01/2014
(date)

The effective date of said policy is 05/01/2014 and the expiration date of said policy
is 05/01/2015
(date)

This insurance is excess and the company shall not be liable for amounts in excess of
\$ 15,000,000 for each accident in excess of the underlying limit of
\$ 15,000,000 for each accident, exclusive of legal defense costs. The coverage is provided
under policy number 2551455, issued on 05/01/2014. The effective date of
said policy is 05/01/2014 and the expiration date of said policy is 05/01/2015
(date) (date)

Mail original completed form to: Department of Environmental Protection For assistance call: 850-245-8707
2600 Blair Stone Road, Mail Station 4560
Tallahassee, Florida 32399-2400

2. The Insurer further certifies the following with respect to the insurance described in Paragraph 1:
- (a) Bankruptcy or insolvency of the insured shall not relieve the Insurer of its obligations under the policy.
 - (b) The Insurer is liable for the payment of amounts within any deductible applicable to the policy, with a right of reimbursement by the insured for any such payment made by the Insurer.
 - (c) Whenever requested by the Secretary (or designee) of the Florida Department of Environmental Protection (FDEP), the Insurer agrees to furnish to the Department a signed duplicate original of the policy and all endorsements.
 - (d) Cancellation of the insurance, whether by the Insurer or the Insured and any other termination of the insurance (e.g., expiration, non-renewal), will be effective only upon written notice and only after the expiration of thirty (30) days after a copy of such written notice is received by the Secretary of the FDEP as evidenced by certified mail return receipt.
 - (e) The Insurer shall not be liable for the payment of any judgment or judgments against the Insured for claims resulting from accidents which occur after the termination of the insurance described herein, but such termination shall not affect the liability of the Insurer for the payment of any such judgment or judgments resulting from accidents which occur during the time the policy is in effect.

I hereby certify that the Insurer is licensed to transact the business of insurance, or eligible to provide insurance as an excess or surplus lines insurer, in one of more States including Florida.

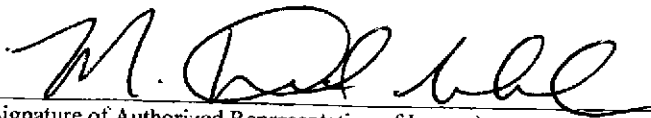

(Signature of Authorized Representative of Insurer)

Derek Wheeler

(Typed name)

Account Manager

(Title)

Authorized Representative of

Sentry Select Insurance Company

(Name of Insurer)

210 Myrtle Brook Bend Ponte Vedra FL 32081

(Address of Representative)



DEPARTMENT OF ENVIRONMENTAL PROTECTION

Mail Station 4560, 2600 Blair Stone Road, Tallahassee, Florida 32399-2400

DEP Form #62-710.901(3)
Form Title Annual Report by Used Oil and Used Oil Filter Handlers
Effective Date 4-23-13
Incorporated in Rule 62-710.510(5)

Annual Report by Used Oil and Used Oil Filter Handlers*

(*Handlers are any persons subject to the registration requirements of rule 62-710.500 and 62-710.850, F.A.C. See Section A, Box 5 below.)

For the reporting period January 1, 2014 through December 31, 2014

Use the information recorded in your **Record Keeping Form [62-710.901(2)]** or equivalent to complete this document.

SECTION A TO BE COMPLETED BY ALL REGISTERED PERSONS

1. Company Name: Flagler Construction Equipment 2. Telephone No. 904 581-4744

Site Address: 5210 Reese Rd., Davie, FL 33314

3. EPA ID No. FLR000007708

☐ Check box if any of the above items (1-3) have changed since your last registration.

4. Name of person preparing report (please print) Lisa Hawthorne

Title: Safety & Training Admin. Phone number (if different from #2, above) 404 965-5945

5. Type of operation (check as many as apply to your operations)

Used Oil: ☐ Transporter ☐ Transfer Facility ☐ Collection Center/Aggregation Point ☐ Processor ☐ Marketer ☐ Burner (of off-specification used oil)
Used Oil Filter: ☐ Transporter ☐ Transfer Facility ☐ Processor ☐ End User

SECTION B USED OIL (TO BE COMPLETED BY ALL REGISTERED USED OIL HANDLERS. USED OIL FILTER HANDLERS SEE SECTION C)

1. Amount (in gallons) of Used Oil and Oily Wastes collected (type code)

a. In Florida

b. From out of State

c. Beginning Inventory

d. Total (sum of totals from Lines a + b + c)

Automotive	Industrial	Mixed	Total
	6000		
0	0	0	0
			6000

2. Amount (in gallons) of Used Oil and Oily Wastes managed (end use code)

N - Transferred to another facility (not an end use)

O - Marketed as an on-specification used oil fuel

F - Marketed as an off-specification used oil fuel

I - Marketed for an industrial process

B - Burned as an off-specification used oil fuel

D - Disposed of: Landfilled

Treated at a wastewater treatment unit

Incinerated

In State	Out of State
5875	
5875	
125	

3. Total amount (in gallons) of Used Oil managed

4. End of year, on hand estimate (difference between Line 1d and Line 3)

SECTION C USED OIL FILTERS (OPTIONAL) (USE TABLE BELOW FOR CONVERSIONS)

CHECK COLUMN IF OUT OF STATE ↓

1. Number of filters on hand from previous year	50	<input type="checkbox"/>
2. Number of used oil filters collected	600	<input type="checkbox"/>
3. Total number of used oil filters to manage (Line 1 plus Line 2)	650	<input type="checkbox"/>
4. Disposition of used oil filters collected:		
a. Transferred to another registered facility	600	<input type="checkbox"/>
b. Burned for energy recovery at a Waste-To-Energy facility	0	<input type="checkbox"/>
c. Transferred directly to a metal foundry for recycling	0	<input type="checkbox"/>
d. TOTAL	600	<input type="checkbox"/>
5. End of year, on hand estimate (Line 3 minus Line 4d)	50	<input type="checkbox"/>
6. Gallons of used oil collected as a result of filter processing	150	<input type="checkbox"/>
7. Gallons of used oil transferred to a used oil handler (transporter or processor)	5875	<input type="checkbox"/>
8. Volume of oily waste collected and managed as a result of filter processing <input checked="" type="checkbox"/> gallons <input type="checkbox"/> cubic yards.....	150	<input type="checkbox"/>

9. Description of oily waste management Oily pads and rags sent to FCC Environmental facility to be recycled.

DIRECTIONS FOR SECTION C

Conversion Table

One 55-gallon drum of crushed used oil filters = approximately 400 used oil filters

One 55-gallon drum of uncrushed used oil filters = approximately 250 used oil filters

One ton of drained used oil filters = approximately 2,350 used oil filters

1. Enter the number of Used Oil Filters on hand, from previous year's inventory.
2. Enter the number of Used Oil Filters collected.
3. Enter the sum of Line 1 + Line 2.
4. Enter the number of filters managed by your facility in blocks 4a-c. Enter the sum of 4a-c in block 4d.
5. Enter the number of filters on hand at your site as of December 31, last year.
6. Fill in the number of gallons of used oil collected by your filter operation.
7. Enter the number of gallons transferred to a used oil transporter or processor.
8. List the volume (gallons or cubic yards) of the oily wastes collected through your filter handling. Oily wastes are identified in Florida Administrative Code Rule 62-710.201(1), and include wastewaters, filter residues or sludges, tank bottoms, sorbents, wipes, etc.
9. Describe how oily wastes were managed (sent to a WTE, hazardous waste facility, landfilled after appropriate testing, etc.).

For assistance with this form, please call the Used Oil Coordinator at 850-245-8707.



Flagler Construction Equipment
9601 Boggy Creek Road
Orlando, FL 32824

Attn: Janet Ashwood
DEP Waste Management Division- HRWS, MS4560
2600 Blair Stone Rd.
Tallahassee, FL 32399-2400

Dear Ms. Ashwood,

Please find the initial registration paperwork attached. The information is based on an estimate only for the year of 2014. Our policy going forward for 2015 will maintain accurate records for our used oil. Also we are awaiting a W-9 from the DEP in order to release the registration check in the amount of \$100.00. We currently have 2 voicemails into the business office along with an email. As soon we receive this form we will overnight the checks to your attention. If you have any questions please feel free to contact myself or Lisa Hawthorne @ 407.850.9614.

Sincerely,

A handwritten signature in black ink, appearing to read "Kevin Walden", with a long horizontal flourish extending to the right.

Kevin Walden

Oil Spill Prevention, Control and Countermeasure (SPCC) Plan

Flagler Construction Equipment
5210 Reese Road
Davie, FL 33314

Facility Operator:
Flagler Construction Equipment, LLC
9601 Boggy Creek Road
Orlando, Florida 32824

Revised as of:
November, 2012

Table of Contents

2.0	SPCC PLAN APPROVALS AND REVIEWS	2
2.1	MANAGEMENT APPROVAL	2
2.2	PROFESSIONAL ENGINEER'S CERTIFICATION	2
2.3	FIVE YEAR SPCC PLAN REVIEW AND EVALUATION.....	3
3.0	FACILITY IDENTIFICATION AND SUMMARY DESCRIPTION	4
4.0	OIL STORAGE INVENTORY AND POTENTIAL SPILLS	5
6.0	FACILITY DRAINAGE.....	8
6.1	DRAINAGE FROM Diked OUTDOOR OIL STORAGE AREAS	8
6.2	DRAINAGE FROM UNDIKED OUTDOOR OIL MANAGEMENT AREAS.....	8
7.1	GENERAL.....	9
7.2	STATIONARY ABOVEGROUND STORAGE TANKS.....	9
7.3	UNDERGROUND STORAGE TANKS	9
7.4	DRUMS AND MOBILE/PORTABLE OIL STORAGE CONTAINERS	9
7.5	OTHER STORAGE CONTAINERS.....	10
8.0	TRANSFER OPERATIONS, PUMPING AND ON-SITE PROCESSES	11
9.0	TANK TRUCK AND TANK CAR UNLOADING/LOADING	12
10.0	INSPECTIONS, TESTS AND RECORDS	14
10.1	ROUTINE VISUAL INSPECTIONS AND MAINTENANCE.....	14
10.2	TESTS.....	14
10.3	RECORDS	14
11.0	SECURITY	15
12.0	EMPLOYEE TRAINING	16
13.0	OIL SPILL RESPONSE PROCEDURES	17
14.0	STATE REGULATIONS AND GUIDELINES FOR OIL DISCHARGE PREVENTION AND CONTAINMENT	19
14.1	NEW OIL	19
14.2	USED OIL.....	20
15.0	SPCC PLAN AMENDMENT BY THE REGIONAL ADMINISTRATOR	22
16.0	FACILITIES, PROCEDURES, METHODS OR EQUIPMENT NOT YET FULLY OPERATIONAL	23
	APPENDICES.....	23

2.0 SPCC PLAN APPROVALS AND REVIEWS

2.1 MANAGEMENT APPROVAL

The facility represented by this SPCC Plan is committed to preventing discharges of oil to navigable waters of the United States, and to maintaining the procedures defined herein for spill prevention, control and countermeasures. As a member of management who has been given the authority to commit the necessary resources, I approve this SPCC Plan and authorize facility personnel to full implement the measures defined in this SPCC Plan to prevent or respond to a release of oil [§112.7]

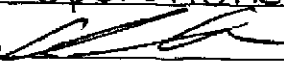
Printed Name of Management Representative	Kevin Wolden
Title of Management Representative	Operations Manager
Management Representative Signature	
Date	11/15/12

2.2 PROFESSIONAL ENGINEER'S CERTIFICATION

I hereby attest and certify that: (i) I am familiar with the requirements of 40 CFR Part 112; (ii) I (or my agent) have visited and examined the facility; (iii) this SPCC Plan for the Flagler Construction Equipment, LLC facility located at 5210 Reese Road, Davie, FL 33314 has been prepared in accordance with good engineering practices, including consideration of applicable industry standards, and with the requirements of 40 CFR Part 112; (iv) procedures for required inspections and testing have been established in this SPCC Plan and (v) this SPCC Plan is adequate for the facility. Employees working at this facility have provided certain information in this SPCC Plan. It is understood that the management of this facility also certifies that the information provided is true and accurate. This certification does not relieve the facility of its duty to implement this SPCC Plan in accordance with 40 CFR Part 112. [§112.3 (d)(1) and (2)]

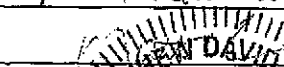
Printed Name of Professional Engineer:	Matthew David Campo
Signature of Professional Engineer and Date	
P.E. Registration Number:	10-53988
Date of SPCC Document:	

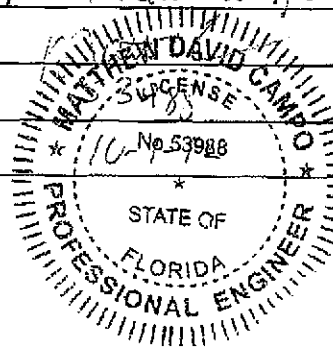

2.3 FIVE YEAR SPCC PLAN REVIEW AND EVALUATION

In accordance with 40 CFR §112.5(b), the owner and/or operator of the facility must conduct a review and evaluation of this SPCC Plan at least once every five (5) years. This SPCC Plan must be amended within six months of each review and evaluation include more effective prevention and control technology if; (1) such technology will significantly reduce the likelihood of a discharge of oil in quantities that may be harmful (as described in 40 CFR Part 110) into or upon the navigable waters of the United States or adjoining shorelines, *and* (2) such technology has been field-proven at the time of review. Any technical amendment(s) to this SPCC Plan must be reviewed and certified by a registered Professional Engineer within six months after a change in the facility design, construction, operation, or maintenance occurs which materially affects the facility's potential for the discharge of oil in quantities that may be harmful into or upon the navigable waters of the United States or adjoining shorelines [§112.5(b); §112.5(c)]

I have completed a review of this SPCC Plan, and determined that (check one)

☐ Significant changes to the facility have occurred since the last review, and therefore this SPCC Plan must be appropriately updated and re-certified by a registered Professional Engineer.

☐ Only non-technical amendments to this SPCC Plan are necessary at this time.

☐ No amendment to this SPCC Plan is necessary at this time, per 40 CFR §112.5(b).

Reviewer's Name and Title:	
Reviewer's Signature and Date:	

Professional Engineer's recertification, if technical amendments are made to this SPCC Plan

I hereby attest and certify that: (i) I am familiar with the requirements of 40 CFR Part 112; (ii) I (or my agent) have visited and examined the facility; (iii) this SPCC Plan for the Flagler Construction Equipment facility located at 5210 Reese Road., Davie, FL 33314 has been prepared in accordance with good engineering practices including consideration of applicable industry standards, and with the requirements of 40 CFR Part 112; (iv) procedures for required inspections and testing have been established in this SPCC Plan; and (v) this SPCC Plan is adequate for the facility. Employees working at this facility have provided some of the information in this SPCC Plan, It is understood that the management of this facility also certifies that the information provided is true and accurate. This certification does not relieve the facility of its duty to implement this SPCC Plan in accordance with 30 CFR Part 112. [§112.3(d)(1) and (2)]

Printed Name of Professional Engineer	
Signature of Professional Engineer	
P.E. Registration Number:	

(Apply P.E. seal over the written information)

Make a copy of this page for each review/update, and insert it into the SPCC Plan here.

3.0 FACILITY IDENTIFICATION AND SUMMARY DESCRIPTION

Name of Facility	Flagler Construction Equipment, LLC
Address of Facility	5210 Reese Road., Davie, FL 33314
Name of Owner	Flagler Construction Equipment, LLC
Owner's Address	9601 Boggy Creek Road, Orlando, FL 32824
Owner's Phone	407-850-9614
Name of Operation (if different from Owner)	(Not Applicable)
Operator's Address (if different from Owner)	(Not Applicable)
Operator's Phone (If different from Owner)	(Not Applicable)
Emergency Phone Number	CELL: 407-922-299
Primary Facility Contact: (SPCC Coordinator)	Lisa Hawthorne Safety & Training Administrator
Primary Contact's Work phone and Fax	Office: 407-850-9614 EXT 5969,
Primary Contact's Off-Hours Phone:	Fax: 407-850-0823, Cell: 407-922-2993
Secondary Facility Contact (Backup SPCC Coordinator)	Mike Hinson
Secondary Contact's Phone	Office: 239-481-8554
Secondary Contact's Off Hours Phone	Cell: 813-220-8111

The facility contact is the person directly accountable for oil spill prevention and response (i.e., the facility's SPCC Coordinator). [§112.7(f)]

This facility is engaged in the sale/leasing and servicing of construction equipment. It occupies approximately two (2) acres, about 50% (percent) of which is covered by the building and paved areas. Appendix B contains Figure 1 – Site Plan and Figure 2 – Tank Locations, approximately to scale, that includes (where applicable); (1) the general facility layout, including the location and contents for each aboveground and underground oil tank and other fixed container (e.g., hydraulic system reservoir or oil-filled transformer) having a capacity of 56 gallons or greater; (2) an indication of each area where drums and other portable containers with a capacity of 56 gallons or greater are normally stored; (3) each oil transfer station and its connecting pipes; (4) each truck loading and unloading area; (5) the surface drainage pattern from each outdoor storage tank, container storage location, and truck loading and/or unloading location; and (6) the location of each storm drainage feature, water body, or potential wetland that is on or proximate to the facility. [§112.7(a) (3)]

There are no floor drains in the buildings. The Property slopes slightly from north to south and storm water runoff from the roof and parking lot flows toward a small retention pond on the southwestern portion of the property. Runoff does not pass through an oil/water separator prior to being discharged from the Property.

The facility is located in Davie with Reese Road and Interstate 595 forming the northern boundary of the Property and the Florida Turnpike forming the eastern boundary. The southern boundary of the property is a large retention pond while the western boundary is a warehouse complex. The nearest off-site body of surface water is a very large retention pond just to the south of the property (approximately 150 Yards).

4.0 OIL STORAGE INVENTORY AND POTENTIAL SPILLS

Table 2 – Oil Inventory and Potential Spill Summary (in Appendix C) summarizes the facility's storage capacity for new petroleum products and used/waste oil in each container that has a capacity of 56 gallons or more. The term "container" includes a stationary aboveground storage tank (AST), an underground storage tank (UST), a drum or other non-stationary large container (e.g., a "tote" tank, or a tank on wheels), and any item of oil-filled equipment that has a capacity of 56 gallons or more (e.g., a hydraulic system reservoir, or an oil-filled transformers that belongs to the facility owner or operator). The location of each stationary tank and normal storage location for drums and other portable containers is shown on Figure 2. Areas of the facility in which oil trucks are parked during uploading (or loading, in the case of use oil) operations are also shown on Figure 1 [§112.1(b); §112.7(a)(3)(i)]

Table 2 also provides a prediction of the direction, maximum potential rate of flow, and total quantity of oil that could be discharged from each tank and other container as a result of a major spill or equipment failure, and the expected destination of that oil [§112.7(b)]

5.0 CONTAINMENT AND/OR DIVERSIONARY STRUCTURES OR EQUIPMENT TO PREVENT A DISCHARGE

Appropriate containment and/or diversionary structures are provided for the facility's oil storage and transfer areas, except where determined to be technically impracticable, to prevent a discharge of oil in harmful quantities into or upon the navigable waters of the United States or adjoining shorelines. These provisions include at least one of the following preventive systems or its equivalent; (1) double-walled tanks; (2) building walls, dikes, berms, curbing, retaining walls, and/or sumps that are sufficiently impervious to contain spilled oil; (3) culverts, gutters, or other drainage systems; (4) weirs, booms or other barriers; (5) spill diversion/retention ponds; and/or (6) sorbent materials. [§112.7(c)]

The containment and/or diversionary structures in use are summarized below. If the measures described above have been determined to be impracticable, a clear explanation as to why is provided. In the event a strong oil spill contingency plan following the provisions of 40 CFR Part 109, and including a written commitment of manpower, equipment and materials required to expeditiously control and remove any quantity of oil discharged that may be harmful, is provided in an Appendix. [§112.7(d)]

Potential Source Release ¹	Current Containment ²	Containment Volume ³
500-gallon motor oil steel AST (indoors)	Concrete Diked area	Not Applicable
500-gallon hydraulic oil steel AST (indoors)	Concrete Diked area	Not Applicable
500-gallon axle oil steel AST (indoors)	Concrete Diked area	Not Applicable
500-gallon transmission fluid steel AST (indoors)	Concrete Diked area	No Applicable
500-gallon waste oil steel AST (outdoors)	Concrete Diked area	>500 gallons (secondary containment does not collect precipitation)
250-gallon mineral spirits steel AST (outdoors)	Concrete Diked area	>250 gallons (secondary Containment does not collect precipitation)
150-gallon waste oil steel AST (indoors)	Concrete Diked area	>150 gallons (secondary containment does not collect precipitation)
100-gallon anti-freeze coolant Plastic AST (outdoors)	Concrete Diked area	>100 gallons (secondary containment does not collect precipitation)
300-gallon diesel fuel steel AST (outdoors)	Concrete Diked area	>300 gallons (secondary containment does not collect precipitation)
100-gallon Used anti-freeze coolant Plastic AST (outdoors)	Concrete Diked area	>100 gallons (secondary containment does not collect precipitation)
55-gallon drums (outdoors)	Concrete Diked area	>55 gallons (secondary containment does not collect precipitation)
55-gallon plastic drums (inside)	Spill containment pallets	Not Applicable
Parts Washer		Not Applicable

The facility does not presently have containment or diversionary structures for its outdoor tank truck unloading and unloading areas, due in part to the small size of the transfers and their relatively low frequency of occurrence. Procedures to minimize the potential for an oil discharge during a transfer are discussed below and in Appendix E.

¹ From individual containers that have a capacity of 55 gallons or more of oil.

² Secondary containment has been deemed impractical for "other oil filled equipment" (e.g., hydraulic fluid reservoirs and transformers). The facility will use monthly visual inspections to minimize the potential for an oil discharge from any such equipment.

³ If the secondary containment can collect precipitation, its volume must exceed the sum of the capacity of the largest tank within it plus the volume of precipitation from a 100-year, 24-hour storm event.

6.0 FACILITY DRAINAGE

6.1 DRAINAGE FROM DIKED OUTDOOR OIL STORAGE AREAS

This section summarizes drainage from outdoor oil storage areas that have open localized secondary containment, such as curbs or dikes. A manually operated valve or other positive means retains liquid that accumulates in such an area. Drainage from indoor storage is not covered under this section. Except as specifically discussed below, the facility does not discharge liquid from a curbed or diked area to an oil/water separator. [§112.8(b)(1); §112.8(b)(5); §112.8(c)(3)]

Secondary containment for outdoor ASTs is referenced in Section 5.0. Drainage from a containment area that could receive precipitation is by means of: (1) a gravity drain valve that is manually operated by facility employees and is locked in the closed position when not attended; or (2) a manually activated pump or siphon. The accumulated liquid is visually observed for the presence of an oil sheen or other evidence of oil prior to being discharged. If that observation indicates the presence of oil, alternate means will be employed to remove, contain, and treat or dispose of the accumulated liquid. Table 2 identifies the receiving point for drained liquid. [§112.8(b)(1) and (5)]

6.2 DRAINAGE FROM UNDIKED OUTDOOR OIL MANAGEMENT AREAS

This section summarizes the facility's drainage control measures for outdoor oil management areas that are not equipped with localized secondary containment. Drainage from indoor undiked storage areas is not applicable under this section. [§112.8(b)(3) and (4)]

The facility's outdoor truck unloading/loading areas for the 300 gallon off road diesel fuel AST is not diked. Drainage from this area could contain oil as the result of leaks or spills. If a leak or spill occurs during a transfer, the oil spill response procedures defined in this SPCC Plan will be implemented immediately. Oil spill booms and /or absorbent materials can be used to control the release and/or divert it away from local drainage courses. If the release is large, outside assistance will be obtained. If not, absorbents or equivalent measures will be used to directly contain the oil, followed by housekeeping measures as necessary to ensure that no residual oil remains that could adversely impact subsequent drainage from the area.

7.0 TANK AND OTHER CONTAINER STORAGE

7.1 GENERAL

The facility visually inspects all of its aboveground oil tanks and other containers, and its oil handling areas, at least monthly. Appendix F – Monthly AST Inspection Report can be used to document AST inspections. [§112.8(c)(8)]

The facility does not have any tanks with internal heating coils. [§112.8(c)(7)]

The facility does not have an oil water separator. [§112.8(c)(9)]

The facility does not have any field-constructed ASTs. [§112.7(i)]

7.2 STATIONARY ABOVEGROUND STORAGE TANKS

Table 2 (in Appendix C) provides information about the facility's stationary ASTs, including materials of construction and any secondary containment. The facility does not have any partially buried tanks. The materials and method of construction of each tank and secondary containment are compatible with the material stored and conditions of storage. Each secondary containment system is sufficiently impervious to contain spilled oil and is sized to hold the contents of the single largest tank, plus (for outdoor single-walled tanks) additional freeboard volume based on the 100-year, 24-hour storm event for the facility area. [§112.8(c)(1) and (2)]

At a minimum, each working AST is equipped with a manual or electronic level gauge and is filled under the direct supervision/observation of employees to no more than 90% (percent) of the tank's design capacity.

7.3 UNDERGROUND STORAGE TANKS

The facility does not have any underground oil storage tanks. [§112.8(c)(1) and (2)]

7.4 DRUMS AND MOBILE/PORTABLE OIL STORAGE CONTAINERS

Table 2 (in Appendix C) contains a summary of the facility's storage of drums and mobile/portable oil storage containers (tanks on wheels, skid mounted tanks, etc.). When not in active use, they are kept in locations where they could not reasonably be expected to discharge oil in harmful quantities into or upon the navigable waters of the United States or adjoining shorelines, which can include secondary containment or drainage to an oil/water separator. [§112.8(c)(11)]

7.5 OTHER STORAGE CONTAINERS

Table 2 (in Appendix C) contains a summary of other stationary oil storage containers (e.g., hydraulic fluid reservoirs or oil-filled transformers that are owned or operated by the facility). All such containers are inspected for leaks or deterioration at least monthly. [§112.8(c)]

8.0 TRANSFER OPERATIONS, PUMPING AND ON-SITE PROCESSES

Piping and related oil transfer equipment are only associated with the facility's ASTs. Piles that are not in active use will be capped or blank-flanged. Aboveground metal piping is painted for corrosion protection, and supported to minimize abrasion and allow for expansion and contraction. All aboveground piping is elevated or otherwise located to minimize the potential for damage from vehicular traffic. [§112.8(c)]

Aboveground valves, pipelines and related appurtenances are visually inspected at least monthly, during the inspection of ASTs. [§112.8(d)(4)]

The driver of a vehicle entering any portion of the facility where aboveground oil piping exists and could be damaged by that vehicle will be warned to ensure that they will not endanger that piping or other oil transfer operations. [§112.8(d)(5)]

The requirements in §112.7(d) pertaining to underground piping are not applicable, because the facility does not have any buried piping associated with oil transfer, storage, or use except pressurized hydraulic system piping. [§112.8(d)(1), (2) and (3)]

9.0 TANK TRUCK AND TANK CAR UNLOADING/LOADING

Minimum Standard Operating Procedures

Tank cars are not unloaded or loaded at the facility. Tank truck unloading/loading activities meet the minimum requirements of the U.S. Department of Transportation and include, at a minimum, the following standard operating procedures:

- a) Appropriate facility personnel are notified when a tank truck unloading/loading event will take place, prior to initiation.
- b) No smoking is allowed during the active tank truck unloading/loading event. Fire is kept away from the immediate unloading/loading area at all times.
- c) Tank truck unloading/loading operations are conducted only in areas specifically designated for that purpose.
- d) Each tank truck unloading/loading event is directly attended and continuously monitored by the truck driver and by an appropriate facility employee. These personnel will take immediate actions to stop the flow of oil when the working capacity of the receiving tank (designed as 90% of the design capacity) has been reached, or in the event that an equipment failure or emergency occurs.
- e) The truck's manual brake is set throughout the duration of the unloading/loading event. A facility employee determines if a physical barrier and/or wheel chocks must also be put in place prior to initiation of active unloading or loading, to prevent motion of the truck during the unloading/loading event.
- f) Prior to filling of any tank truck, the lowermost drain and all outlets of the tank truck are closely inspected for potential for discharge. If necessary, such drains and outlets are tightened, adjusted, or replaced to prevent liquid discharge while in transit. [§112.7(h)(3)]
- g) A facility employee ensures that drip pans or buckets, or oil absorbent pads are placed beneath all hose connections that may be prone to leakage, prior to initiation of the tank truck unloading/loading event.
- h) Unloading or loading does not begin until the level in the receiving tank truck or tank has been checked and confirmed to have sufficient available volume, based on the working capacity of the receiving tank (90% of the design capacity), to receive the volume of oil intended to be transferred.
- i) Throughout the transfer process, the truck driver and facility employee remain alert and keep an unobstructed view of the truck, delivery hose(s), and storage tank, to the maximum extent practicable. Unless the truck engine is used for operation of the transfer pump, no flammable oil is transferred while the engine is running.
- j) The drain/transfer valve on the truck/tank is closed and the transfer line is fully drained back to the tank truck or tank (as appropriate), or blown empty, prior to disconnecting the transfer line, except for nozzle-fill transfer hoses that are designed to remain full.
- k) Prior to departure of the truck, the lowermost drain and all outlets of the tank truck are inspected for the potential for a discharge. If necessary, such drains and outlets are tightened, adjusted, or replaced to prevent liquid discharge while in transit. Also, all warning signs, wheel chocks or physical barriers are removed. [§112.7(h)(3)]

- l) The facility will promptly implement appropriate spill response procedures for any leakage or spillage arising from a n unloading/loading event.

These measures have been incorporated into Appendix E – Truck Unloading and Loading Procedures, for reference be affected employees.

Measures to Prevent Vehicle Departure Prior to Line Disconnect

For each tank truck unloading/loading event, a physical barrier system, warning signs, wheel chocks, and/or a vehicle brake interlock system will be used to prevent the truck from departing before complete disconnection of the flexible or fixed oil transfer line. Appropriate measures are included in the Minimum Standard Operating Procedures. [§112.7(h)(2)]

Secondary Containment Provisions for the Truck Unloading/loading Areas

Except as noted in Table 2, the facility's outdoor truck unloading/loading areas do not have secondary containment or drainage diversion to a spill containment area. Runoff from those areas could contain oil as the result of leakage or spillage during a transfer. Per the Minimum Standard Operating Procedures, each transfer will be continuously monitored. If oil leakage or spillage occurs, facility personnel will immediately implement the defined spill response procedures. Oil absorbents and/or other means will be employed to prevent oil from entering a drainage feature (unless it is connected to an oil/water separator). Absorbent materials will be used to clean up minor releases. Final cleanup and housekeeping measures will occur to the extent necessary to ensure that no residual oil remains that could contact and adversely impact subsequent drainage from the area.

10.0 INSPECTIONS, TESTS AND RECORDS

10.1 ROUTINE VISUAL INSPECTIONS AND MAINTENANCE

The SPCC Coordinator or their designee conducts a documented visual inspection of all oil storage and handling areas at least monthly, but no more than 35 days apart. In practice, employees normally observe the storage tanks and drums each workday. All oil storage and handling areas are visually inspected for signs of leaks or equipment deterioration that might result in a spill and/or discharge. Appendix F contains a form for documenting the inspections of ASTs and ancillary equipment. Any identified deficiency is promptly reported, and repaired as soon as is practicable. Deficient equipment is drained of oil and taken out of use if necessary to accommodate the required repairs and/or if a release may be imminent. Records are kept of adequate response measures for all significant deficiencies identified during visual inspections. [§112.7(e)]

In addition to response measures triggered by monthly inspections, corrective action is initiated promptly in response to any observed loss of oil from a container, including but not limited to leaks from seams, gaskets, piping, pumps, valves, etc. [§112.8(c)(10)]

As included on the Appendix F inspection record, all storage tank liquid level gauges are checked as part of the monthly inspection program. [§112.8(c)(8)(v)]

The facility's routine preventive maintenance program for oil-containing equipment includes performing regularly scheduled equipment maintenance, conducting routine inspections, keeping appropriate types and quantities of spill response equipment and materials, and maintaining good housekeeping.

10.2 TESTS

In addition to the routine monthly inspection program, each AST with a capacity of 10,000 gallons or more is tested for structural integrity at least every ten years, and each UST (if any) is regularly tested for leaks. The schedule and testing type(s) for tanks, and associated record keeping requirements, are outlined below. [§112.8(c)(4) and (6)]

10.3 RECORDS

The following records are maintained for a minimum of three years from the date they are created (or as otherwise specified below) in support of this SPCC Plan: [§112.7(e); §112.8(c)(iv)]

- a. Completed records of monthly visual inspections of AST (keep for 3 years, per EPA rules).
- b. Records of drainage of outdoor diked areas (part of the Appendix F inspection record), and any associated records required under permits issued in accordance with 40 CFR Parts 112.416)(2) and (m)(3). [§112.8(c)(3)(iv)]
- c. Documentation of major repairs and/or upgrades made to ASTs or their appurtenances or secondary containment structures, in response to deficiencies identified during the monthly visual inspections.
- d. Documentation of training sessions for all oil handling personnel.
- e. Tank integrity test results for ASTs and leak detection test results for USTs (keep for 3 years, per EPA rules).

11.0 SECURITY

Facility employees are present during all normal operating hours. Chain-link fencing that is locked when the facility is unattended surrounds outdoor areas associated with handling or storing oil. Visitor access is through the office portion of the building; only facility employees and persons accompanied by them are allowed in the portions of the facility where oil is stored. [§112.7(g)(1)]

All valves permitting direct outward flow of oil from a container are kept in the closed position when in non-operating or non-standby status. [§112.7(g)(2)]

Each oil pump is locked in the "off" position and located in a site accessible only to authorized personnel when the pump is in a non-operating or non-standby status. All pumps are inside of the building, which is locked when not attended. [§112.7(g)(3)]

All unloading/loading connections are securely capped or blank-flanged when not in service or when in standby service for an extended time, including piping that is emptied of liquid content either by draining or by blowing it empty. [§112.7(g)(4)]

Lighting commensurate with the type and location of the facility is provided to assist in: (1) the discovery of discharges occurring during hours of darkness, both by facility employees, if present, and by others (such as local police); and (2) the prevention of discharges occurring due to acts of vandalism. [§112.7(g)(5)]

12.0 EMPLOYEE TRAINING

All facility personnel involved with handling of oil are properly trained in general facility operations; applicable oil pollution control laws, rules and regulations; the operation and management of equipment to prevent discharges; discharge (spill) initial response procedures and protocols; and the contents and requirements of this SPCC Plan. Further, the training highlights and describes any past spill or discharge incident at the facility that reached the environment, past equipment failures, component malfunctions, and any recently developed precautionary measures. Training is provided by or at the direction of the facility's SPCC Coordinator. Refresher training is provided on an annual basis for all employees involved with handling of oil. New employees involved with the handling of oil receive this training within two weeks of their initial work assignment. Appendix G provides a typical outline of the training provided to such personnel, and Appendix H contains a spill response protocol. All training sessions are documented, with records retained in support of this SPCC Plan for at least three years. [§112.8(f)]

13.0 OIL SPILL RESPONSE PROCEDURES

Oil Spill Response Equipment [§112.7(a)(3)(iii)]

Minimum Quantity	Type of Equipment	General Location
Two	Absorbent - pads/rolls	Spill kit stations
Two	Absorbent - pigs/socks	Spill kit stations
Seven	Fire extinguishers	In every doorway
One each	Shovel and broom	Clean up rack in middle of shop

Oil Spill Response Protocols [§112.7(a)(3)(iii)]

The facility's oil spill response procedures are in Appendix H. They are in two stand-alone pages, for easy use in the event of an emergency. A list of Emergency Telephone Numbers follows those response procedures. Those numbers are on one stand-alone page, for ease of reference in an emergency. A Spill Incident Form is provided following the Emergency Telephone Number list, as a one-page form that is easily completed in the event of an emergency. An associated Spill Incident Reporting Form follows the Spill Incident Form, for reporting of regulated spills; it also is a one-page form that can be completed easily. [§117.7(a)(5)]

Methods of Disposal of Recovered Materials [§112.7(a)(3)(v)]

As indicated in the facility's spill response procedures (in Appendix H), all materials recovered from a spill response will be appropriately containerized and labeled as to contents, date, nature of origination, etc. The facility will make a hazardous waste determination of each such containerized waste, in accordance with federal (40 CFR Part 261) and state regulations for hazardous and otherwise regulated wastes. This will include, in part: (1) a review of the waste vis-à-vis listed hazardous wastes; (2) a review of it vis-à-vis the hazardous waste characteristics; (3) a review of it vis-à-vis mixtures of the waste with other hazardous wastes; and (4) knowledge of the waste's characteristics. If the recovered material is determined to be a regulated waste, it will be managed and disposed of in accordance with the appropriate requirements, including the requirements for manifesting if applicable.

If the recovered materials are determined to be non-regulated, they will be managed as part of the facility's routine solid waste stream.

Spill Incident Reporting [§117.7(a)(4)]

Federal: Federal regulations at 40 CFR §110.3 define a spill as the discharge of oil into, or upon the navigable waters of the United States or adjoining shoreline, in harmful quantities. Harmful quantities are defined as a discharge that violates applicable water quality standards or causes a sheen upon, or discoloration of, the surface water or adjoining shoreline. In the event that such a discharge of oil occurs, the facility's designated SPCC Coordinator or their designee is to be notified immediately. That person will then immediately notify the National Response Center (NRC) at 800/424-8802. The regulations in 40 CFR Part 110.6 will be further consulted for appropriate notification procedures in the event that direct reporting to the NRC is not practicable.

Information to be reported includes:

- a) The name of the person making the report, and -his/her job title;
- b) The name, address and phone number of the facility;
- c) Time and date of the discharge;
- d) Type of material discharged;
- e) Estimates of the total quantity discharged;
- f) Estimates of the quantity discharged as described in 40 CFR 112.1(b);
- g) The source of the discharge;
- h) A description of all affected media (e.g., soil, surface water, ground water);
- i) The cause of the discharge;
- j) Any known damages or injuries caused by the discharge;
- k) Actions being taken to stop, remove, and mitigate the effects of the discharge;
- l) Whether an evacuation has occurred or may be needed; and
- m) The names of individuals and/or other organizations that have also been contacted.

State: The applicable regulations (62-761.450, F.A.C.) state that upon discovery of a petroleum discharge, the owner or operator shall report to the County on Discharge Report Form 62-761.900(1) within 24 hours or before the close of the County's next business day. A discharge includes a spill or overfill event of petroleum products 1) to soil or other pervious surface, equal to or exceeding 25 gallons, 2) to impervious surfaces (e.g. Concrete) equal to or exceeding 100 gallons, or 3) inside a diked area equal to or exceeding 500 gallons.

14.0 STATE REGULATIONS AND GUIDELINES FOR OIL DISCHARGE PREVENTION AND CONTAINMENT

14.1 NEW OIL

The Florida State Storage Tank Regulations (62-761.450, F.A.C.) apply to all aboveground petroleum storage tank systems having individual storage tank capacities greater than five hundred and fifty (550) gallons and all underground storage tanks having individual capacities of greater than one hundred ten (110) gallons. Hydraulic system reservoirs and transformers are not considered tanks under these regulations. The Florida Department of Environmental Protection (FDEP) administers the Storage Tank Program. Key requirements of that program are summarized below; the regulations must be consulted for more detailed information. [§112.7(j)]

Chapter 62-761 - Storage Tank Systems

- 62-761.100 Intent.
This describes the purpose of this chapter, which is to provide standards for the installation and operation of USTs with capacities greater than 110 gallons and ASTs with capacities greater than 550 gallons.
- 62-761.200 Definitions.
Provides definitions of terms used by the FDEP.
- 62-761.210 Reference Standards.
States a listing of possible places where reference standards may be obtained.
- 62-761.300 Applicability.
States the general requirements and exemptions that apply to the owners and operators of USTs and ASTs.
- 62-761.400 Registration and Financial Responsibility.
States the general registration requirements, registrations fees, and financial responsibility associated with the tanks.
- 62-761.410 Registration Fees. (Repealed)
- 62-761.450 Notification, Reporting, and Response.
States the notification procedures for installation of new tanks and notification and protocol for discharges.
- 62-761.460 Reporting. (Repealed)
- 62-761.480 Financial Responsibility. (Repealed)
- 62-761.500 Performance Standards for Storage Tank Systems.
States standards for tank integrity, placement and containment.
- 62-761.510 Performance Standards for Category-A and Category-B Storage Tank Systems. (Repealed)
- 62-761.520 Performance Standards for Other Existing Petroleum and Petroleum Product Storage Tank Systems (Non-Vehicular Fuels). (Repealed)
- 62-761.550 Performance Standards for New Hazardous Substance Storage Tank Systems. (Repealed)
- 62-761.560 Performance Standards for Existing Hazardous Substance Storage Tank Systems. (Repealed)
- 62-761.600 Release Detection Standards.
States the standards and methods of release detection required.

- 62-761.610 Release Detection Methods. (Repealed)
- 62-761.620 Release Detection Standards for Other Existing Regulated Substance Storage Tanks. (Repealed)
- 62-761.630 Release Detection Standards for Integral Piping. (Repealed)
- 62-761.640 Performance Standards for Release Detection Methods. (Repealed)
- 62-761.680 Tightness Testing Standards. (Repealed)
- 62-761.700 Operation, Maintenance and Repairs.
Describes standards for operation, maintenance, and repairs of ASTs and also storm water management from secondary containment systems.
- 62-761.710 Recordkeeping.
States that all records shall be dated, maintained, and available for inspection from the FDEP.
- 62-761.720 Inventory Requirements. (Repealed)
- 62-761.730 Operating Requirements for Cathodic Protection. (Repealed)
- 62-761.740 Certified Contractors. (Repealed)
- 62-761.800 Out-of-Service and Closure Requirements.
States the procedures for adding regulated substances back into out-of-service tanks as well as requirements for closure of storage tank systems.
- 62-761.820 Incident and Discharge Response. (Repealed)
- 62-761.840 Locally Administered Programs. (Repealed)
- 62-761.850 Alternative Requirements and Equipment Approvals.
This section states how to request alternative requirements if a portion of this chapter does not apply to the regulated tank system at a facility.
- 62-761.860 Approval of Storage Tank Systems and Release Detection Equipment. (Repealed)
- 62-761.890 Mineral Acid Storage Tank Requirements.
This section is an overview of terms used, requirements, registration of tanks, and incident reporting for mineral acid tanks.
- 62-761.900 Storage Tank Forms.
States the forms needed for the installation and operation of USTs and ASTs. They may be obtained from FDEP.

14.2 USED OIL

Used oil filters must be stored in above ground containers which are clearly labeled "Used Oil Filters," and which are in good condition. The storage containers must be protected from weather and stored on an oil impermeable surface. Any leak or spill must be stopped, contained, managed and the tank repaired or replaced.

Chapter 62-710 — Used Oil Management

- 62-710.100 Intent. (Repealed)
- 62-710.200 Definitions. (Repealed)
- 62-710.210 Documents Incorporated by Reference.
General provisions relating to solid waste management may be found in this chapter, including statements of intent, definitions, prohibitions, general permitting requirements, alternate procedures, and forms.

- 62-710.400 Prohibitions. (Repealed)
- 62-710.500' Registration and Notification.
Used oil transporters, processors, marketers and burners shall register their used oil handling activities with the FDEP.
- 62-710.510 Record Keeping and Reporting.
Each facility shall maintain records on an FDEP form and be retained for a period of three years. These records shall be kept at the street address of the facility and shall be available for inspection by the FDEP during normal business hours.
- 62-710.520 Reporting. (Repealed)
- 62-710.530 Exemptions. (Repealed)
- 62-710.600 Certification of Used Oil Transporters.
States the requirements and exceptions of a used oil transporter.
- 62-710.800 Permits for Used Oil Processing Facilities.
This rule shall apply to any owner or operator of a facility which processes used oil.
- 62-710.850 Management of Used Oil Filters.
This rule provides regulations on disposal of used oil and oil filters, and notification requirements for releases.
- 62-710.900 Forms. (Repealed)
- 62-710.901 Used Oil Processing Permit Application and Instructions, December 23, 1996.
This section states the form and instruction used by the DEP and may be obtained by writing from FDEP.

15.0 SPCC PLAN AMENDMENT BY THE REGIONAL ADMINISTRATOR

If the facility discharges more than 1,000 U. S. gallons of oil in a single discharge into or upon the navigable waters of the United States or adjoining shorelines, or discharges more than 42 gallons of oil in each of two discharges into or upon the navigable waters of the United States or adjoining shorelines within any twelve month period, the facility will submit the following information to the Regional Administrator within 60 days from the time that the facility exceeds either of these discharge thresholds:

- a. Name of the facility;
- b. Name of facility personnel providing this information;
- c. Location of the facility;
- d. Maximum storage or handling capacity of the facility and normal daily throughput;
- e. Corrective action and countermeasures that have been taken by the facility, including a description of equipment repairs and replacements;
- f. An adequate description of the facility, including maps, flow diagrams, and topographical maps, as necessary;
- g. The cause of such discharge(s), including a failure analysis of the system or subsystem in which the failure occurred;
- h. Additional preventive measures that the facility has taken or contemplated to minimize the possibility of recurrence; and
- i. Such other information as the Regional Administrator may reasonably require pertinent to this SPCC Plan or discharge. [§112.4(a)]

The facility will also submit this specific information to the State agency (or the agency to which the State has delegated authority) in charge of oil pollution control. [§112.4(c)]

Following submittal of this information, the facility will appropriately amend this SPCC Plan as may be specified by the Regional Administrator and/or other cognizant agency, in accordance with the requirements and procedures of §112.4(d)-(0). [§112.4(d)-(0)]

16.0 FACILITIES, PROCEDURES, METHODS OR EQUIPMENT NOT YET FULLY OPERATIONAL

Some facilities/equipment, procedures, and/or methods that are required components of an SPCC Plan are not yet fully operational. This includes changes mandated by the revisions to 40 CFR Part 112 that were promulgated in 2002 with future effective dates. [§112.7]

For an existing facility, §112.3(a) specifies compliance dates whereby: (1) the facility must amend its SPCC Plan to appropriately address the amended requirements of §112; and (2) the facility must implement the SPCC Plan requirements developed in response to the amended requirements of §112.

Tank Truck Unloading/loading Areas

The facility will amend this SPCC Plan to appropriately address the additional spill containment requirements in §112.7(h) prior to the specific compliance dates for the actions specified at §112.3(a), and will implement the new requirements contained in the amended SPCC Plan prior to the specific compliance date specified for such action by § 112.3(a), for the tank truck unloading/loading areas.

Oil Filled Electric Transformers

The facility will amend this SPCC Plan to appropriately address the amended requirements of § 112.7(c) prior to the specific compliance dates for the actions specified at § 112.3(a), and the facility will implement the new requirements contained in the amended SPCC Plan, to appropriately address the amended requirements of § 112.7(c), prior to the specific compliance date for such action specified by §112.3(a), for each oil-filled electrical transformer that it owns or operates and that is subject to the amended requirements.

APPENDIX A

Table 1 – SPCC Plan Cross-Reference

Table 1 – SPCC Rule Cross-Reference

This table provides a cross-reference for the requirements listed in the August, 2002 SPCC regulations in 40 CFR Part 112 with the equivalent requirements contained in the facility's SPCC Plan. It lists each requirement in those regulations, lists the corresponding paragraph (if any) in the previous version of the regulations, provides a brief summary description of the requirement, and indicates the section number of the facility's SPCC Plan in which the requirement is addressed. The Table of Contents identifies the page number for the respective SPCC Plan section. For each listed requirement, the referenced SPCC Plan section provides a discussion of the facility's conformance with the listed requirement.

Current SPCC Rule	Previous SPCC Rule	Description of Requirement	SPCC Plan Section
§112.1	§112.1	General applicability	1.0
§112.2	§112.2	Definitions	N/A
§112.3(a)-(c)	§112.3	Timeframe to prepare SPCC Plan	N/A
§112.3(d)	§112.3(d)	Certification by Licensed PE	2.2, 2.3
§112.3(e)	§112.3	Onsite maintenance and availability of SPCC Plan	1.0
§112.4	§112.4	Amendment of SPCC Plan by EPA Regional Administrator	15.0
§112.5	§112.5	Amendment of SPCC Plan by the facility	1.0, 2.3
§112.7	§112.7	General requirements for SPCC Plans for all facilities and all oil types	Entire Plan
§112.7	§112.7	Management approval of the SPCC Plan	2.1
§112.7(a)	§112.7	General requirements; discussion of facility's conformance with rule requirements; deviations from Plan requirements; facility characteristics that must be described in the Plan; spill reporting information in the Plan; emergency procedures	Entire Plan
§112.7(b)	§112.7(b)	Fault analysis.	4.0
§112.7(c)	§112.7(c)	Secondary containment	5.0
§112.7(d)	§112.7(d)	Contingency planning.	5.0
§112.7(e)	§112.7(e)	Inspections, tests and records	10.0
§112.7(f)	§112.7(f)	Employee training and discharge prevention procedures	12.0
§112.7(g)	§112.7(g)	Security (excluding oil production facilities)	12.0
§112.7(h)	§112.7(h)	Unloading/loading (excluding offshore facilities)	9.0
§112.7(i)	§112.7(i)	Brittle fracture evaluation requirements	7.1
§112.7(j)	§112.7(j)	Conformance with State requirements	14.0

§112.8(a) §112.12	§112.7(e)(1)	Requirements for onshore facilities (excluding production facilities).	Entire Plan
§112.8(a) §112.12(a)	(NONE)	General & Specific requirements	Entire Plan
§112.8(b) §112.12(b)	§112.7(c)(1)	Facility drainage.	6.0
§112.8(c) §112.12(c)	§112.7(e)(2)	Bulk storage containers.	7.0
§112.8(d) §112.12(d)	§112.7(c)(3)	Facility transfer operations, pumping, and facility process	8.0
§112.9 §112.13	§112.7(e)(5)	Requirements for onshore production facilities	Not Applicable
§112.9(a) §112.13(a)	NONE	General and specific requirements	Not Applicable
§112.9(b) §112.13(b)	§112.7(e)(5)(ii)	Oil production facility drainage	Not Applicable
§112.9(c) §112.13(c)	§112.7(e)(5)(iii)	Oil production facility bulk storage containers	Not Applicable
§112.9(d) §112.13(d)	§112.7(e)(5)(iv)	Facility transfer operations, oil production facility	Not Applicable
§112.10 §112.14	§112.7(e)(6)	Requirements for onshore oil drilling and workover facilities	Not Applicable
§112.10(a) §112.14(a)	(NONE)	General and specific requirements	Not Applicable
§112.10(b) §112.14(b)	§112.7(e)(6)(i)	Mobile facilities	Not Applicable
§112.10(c) §112.14(c)	§112.7(e)(6)(ii)	Secondary containment – catchment basins or diversion structures	Not Applicable
§112.11 §112.15	§112.7(e)(7)	Requirements for offshore oil drilling, production, or workover facilities	Not Applicable
§112.11(a) §112.15(a)	(NONE)	General and specific requirements	Not Applicable
§112.11(b) §112.15(b)	§112.7(e)(7)(ii)	Facility drainage	Not Applicable
§112.11(c) §112.15(c)	§112.7(e)(7)(iii)	Sump Systems	Not Applicable
§112.11(d) §112.15(d)	§112.7(e)(7)(iv)	Discharge prevention systems for separators and treaters.	Not Applicable
§112.11(e) §112.15(e)	§112.7(e)(7)(v)	Atmospheric storage or surge containers; alarms.	Not Applicable
§112.11(f) §112.15(f)	§112.7(e)(7)(vi)	Pressure containers; alarm systems.	Not Applicable
§112.11(g) §112.15(g)	§112.7(e)(7)(vii)	Corrosion protection.	Not Applicable
§112.11(h) §112.15(h)	§112.7(e)(7)(viii)	Pollution prevention system procedures.	Not Applicable
§112.11(i) §112.15(i)	§112.7(e)(7)(ix)	Pollution prevention systems; testing and inspections	Not Applicable
§112.11(j) §112.15(j)	§112.7(e)(7)(x)	Surface and subsurface well shut-in valves and devices	Not Applicable

Spill Prevention, Control and Countermeasure (SPCC) Plan
Flagler Construction Equipment, LLC 5210 Reese Road, Davie, FL 33314

§112.11(k) §112.15(k)	§112.7(e)(7)(xi)	Blowout prevention	Not Applicable
§112.11(l) §112.15(l)	§112.7(e)(7)(xiv)	Manifolds	Not Applicable
§112.11(m) §112.15(m)	§112.7(e)(7)(xv)	Flowlines, pressure sensing devices	Not Applicable
§112.11(n) §112.15(n)	§112.7(e)(7)(xvi)	Piping; corrosion protection	Not Applicable
§112.11(o) §112.15(o)	§112.7(e)(7)(xvii)	Sub-marine piping; environmental stresses	Not Applicable
§112.11(p) §112.15(p)	§112.7(e)(7)(xviii)	Inspections of sub-marine piping	Not Applicable

APPENDIX B

Figure 1 – Site Map

And

Figure 2 – Tank Location

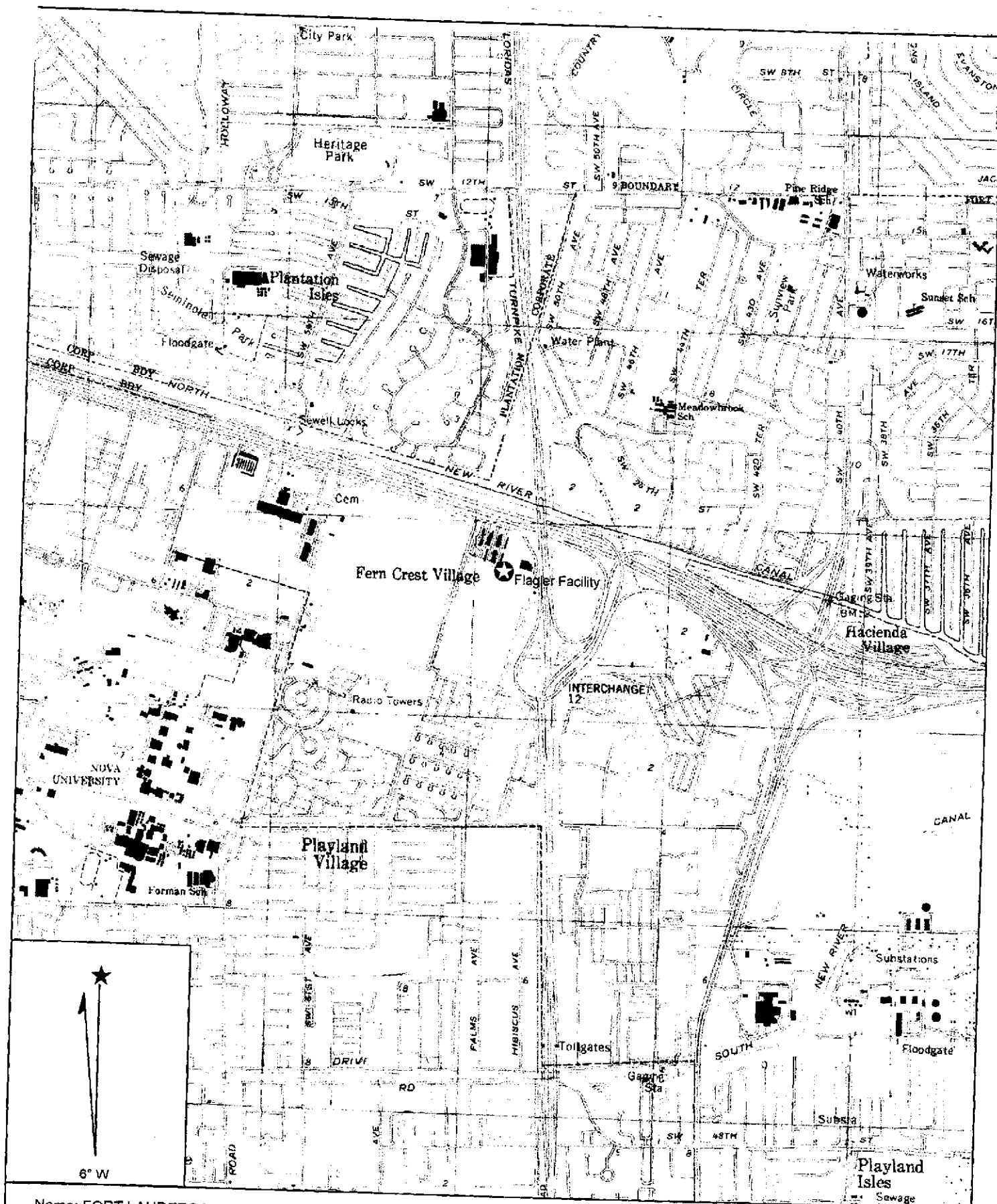

Name: FORT LAUDERDALE SOUTH
 Date: 9/5/2012
 Scale: 1 inch equals 2000 feet

Location: 026° 05' 11.5" N 080° 13' 07.2" W
 Caption: Flagler Construction Equipment
 3210 Reese Road
 Davie, FL 33314

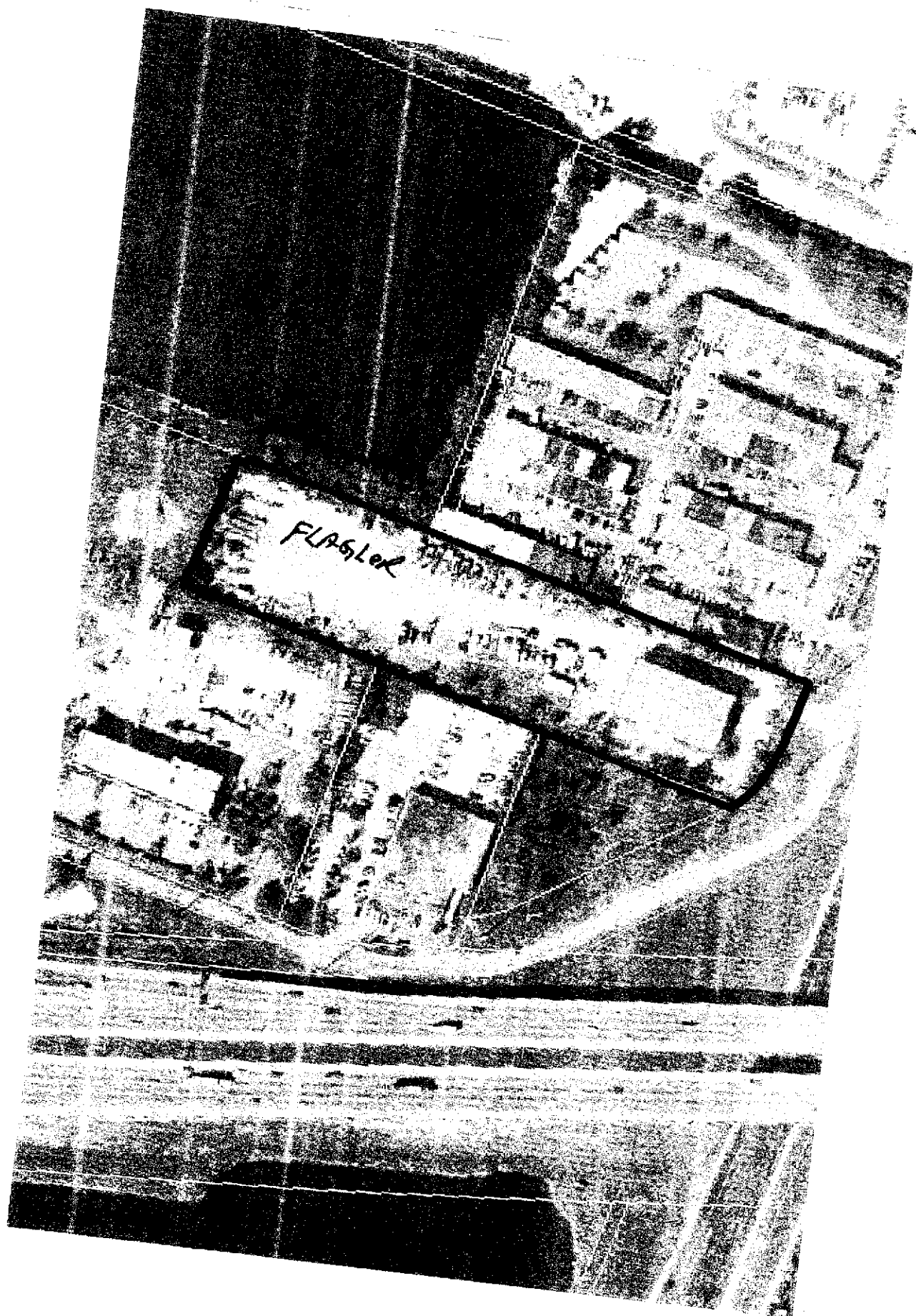

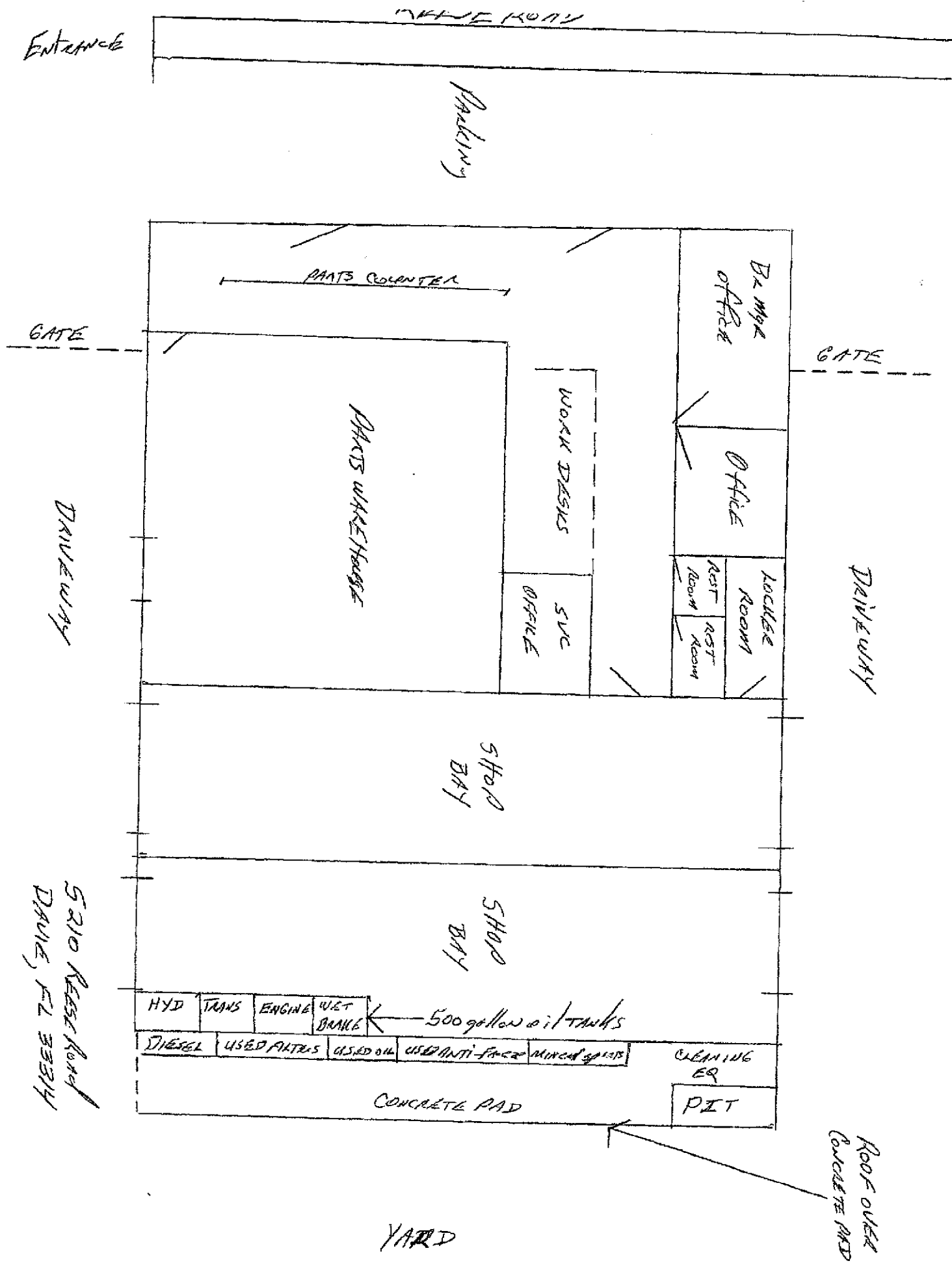

ENTRANCE

PARKING

GATE

DRIVEWAY

GATE

DRIVEWAY

PARTS COUNTER

Br Mgr
Office

Office

Locutor
Room

Rest
Room

WORK DESKS

SVC

OFFICE

PARTS WAREHOUSE

SHOP
BAY

SHOP
BAY

HYD TRANS ENGINE WET DRAIN

500 gallon oil tanks

DIESEL USED FILTERS USED OIL USED ANTI-FREEZE MINCED SPILLS

CLEANING
EQ

PIT

CONCRETE PAD

YARD

5210 Reese Road
DRIVE, FL 33314

ROOF OVER
CONCRETE PAD



09/06/2012





Please Remit Payment To
FCC Environmental, LLC
P.O. Box 674156
Dallas, Texas 75267-4156

INVOICE NUMBER 0486851

INVOICE DATE 03-08-11

SHIP TO: FLAGLER CONSTRUCTION EQUIP
5210 REESE RD

DAVIE
52184201

FL 33314

TO:

FLAGLER CONSTRUCTION EQUIP
ATTN ACCOUNTS PAYABLE
4700 MILLENIA BLVD SUITE 500
ORLANDO

FL
32839-6019

SITE NUMBER

521842

ATTN: A/P TAM
PH#: 954-581-4744

YOUR PURCHASE ORDER	SERVICE ORDER NUMBER	WORK DATE	SALES DISTRICT	SERVICE CENTER
NONE NEEDED	3779349	03-03-11	NONE	52
TERMS OF PAYMENT				
NET 30 DAYS				
QUANTITY	DESCRIPTION		UNIT PRICE	TOTAL
2.00	P/N:COL3-SOILDML	SOIL DM LANDFILL	150.00	300.00
300.00	P/N:M-ENERGYSURCH	ENERGY SURCHG	0.10	30.00
Any questions regarding this invoice, please call 1-800-235-0189.			SALES TAX	1.80
Federal Tax I.D. # 45-0569557			PLEASE PAY THIS AMOUNT	
ORIGINAL INVOICE			\$331.80	





Please Remit Payment To
FCC Environmental, LLC
P.O. Box 674156
Dallas, Texas 75267-4156

INVOICE NUMBER 0536293

INVOICE DATE 04-27-11

SHIP TO: FLAGLER CONSTRUCTION EQUIP
5210 REESE RD

DAVIE
52184201

FL 33314

TO:

FLAGLER CONSTRUCTION EQUIP
ATTN ACCOUNTS PAYABLE
4700 MILLENIA BLVD SUITE 500
ORLANDO FL
32839-6019

SITE NUMBER

521842

ATTN: A/P TAM

PH#: 954-581-4744

YOUR PURCHASE ORDER	SERVICE ORDER NUMBER	WORK DATE	SALES DISTRICT	SERVICE CENTER
NONE NEEDED	3836601	04-21-11	NONE	52
TERMS OF PAYMENT				
NET 30 DAYS				
QUANTITY	DESCRIPTION		UNIT PRICE	TOTAL
680.00	P/N:COL-OWAGA	OILY WATER AUTO GA	0.35	238.00
1.00	P/N:FS-PPE	PERSONAL PROTECTIVE EQ	45.00	45.00
1.00	P/N:FS-DEMOB	MOB & DEMOBILIZATION C	125.00	125.00
798.00	P/N:M-ENERGYSURCHS	ENERGY SURCGH SVC	0.12	95.76
2.00	P/N:M-VAC	VAC (MIN) SERVICES CHAR	85.00	170.00
80.00	P/N:COL3-SLUDGE GA	SLUDGE GA	1.50	120.00
2.00	P/N:M-MINCHG	REMEDIAL TECH (MIN) HRS	50.00	100.00
Any questions regarding this invoice, please call 1-800-235-0189.			SALES TAX	0.00
Federal Tax I.D. # 45-0588557			PLEASE PAY THIS AMOUNT	\$893.76

ORIGINAL INVOICE





FCC environmental

623 N. Sam Houston Parkway East, Suite 400, Houston, TX 77060

1-800-235-0159
CUSTOMER CONTACT

PHONE NUMBER

214-681-6794
SITE NUMBER NAME AND ADDRESS

52107201
FLAYLER CONSTRUCTION EQUIP
3250 REESE RD

SPECIAL NOTES

OVER CREDIT LIMIT !!
RG BY CORRY, PER DAVID
DUNNELLY, AG

CALL WAS TAKEN ON 04-19 AT 0906 BY GRAY

PROBLEM SYNOPSIS, AS REPORTED

P/O CAR WASH RACK

FL 33314

DAVID

VEHICLE NO.

908008

TRAILER NO.

UP/TIME UNIT NO.

542501

TM

ST

ARRIVE DATE

4/21/11

ARRIVE TIME

11:00

CLOSE DATE

4/21/11

CLOSE TIME

12:48

VEHICLE NO.

908008

TRAILER NO.

UP/TIME UNIT NO.

542501

TM

ST

ARRIVE DATE

4/21/11

ARRIVE TIME

11:00

CLOSE DATE

4/21/11

CLOSE TIME

12:48

VEHICLE NO.

908008

PART / DESCRIPTION

UAM QUANTITY

SHIPPING DESCRIPTION

ARRIVE DATE

ARRIVE TIME

CLOSE DATE

CLOSE TIME

COL - WASH

QTY

180

Non DOT Regulated Oily Water

QTY

1

QTY

1

QTY

1

QTY

20

QTY

80

COL - WASH

QTY

180

Non DOT Regulated Oily Water

QTY

1

QTY

1

QTY

1

QTY

20

QTY

80

COL - WASH

QTY

180

Non DOT Regulated Oily Water

QTY

1

QTY

1

QTY

1

QTY

20

QTY

80

COL - WASH

QTY

180

Non DOT Regulated Oily Water

QTY

1

QTY

1

QTY

1

QTY

20

QTY

80

COL - WASH

QTY

180

Non DOT Regulated Oily Water

QTY

1

QTY

1

QTY

1

QTY

20

QTY

80

COL - WASH

QTY

180

Non DOT Regulated Oily Water

QTY

1

QTY

1

QTY

1

QTY

20

QTY

80

COL - WASH

QTY

180

Non DOT Regulated Oily Water

QTY

1

QTY

1

QTY

1

QTY

20

QTY

80

COL - WASH

QTY

180

Non DOT Regulated Oily Water

QTY

1

QTY

1

QTY

1

QTY

20

QTY

80

COL - WASH

QTY

180

Non DOT Regulated Oily Water

QTY

1

QTY

1

QTY

1

QTY

20

QTY

80

COL - WASH

QTY

180

Non DOT Regulated Oily Water

QTY

1

QTY

1

QTY

1

QTY

20

QTY

80

COL - WASH

QTY

180

Non DOT Regulated Oily Water

QTY

1

QTY

1

QTY

1

QTY

20

QTY

80

COL - WASH

QTY

180

Non DOT Regulated Oily Water

QTY

1

QTY

1

QTY

1

QTY

20

QTY

80

COL - WASH

QTY

180

Non DOT Regulated Oily Water

QTY

1

QTY

1

QTY

1

QTY

20

QTY

80

COL - WASH

QTY

180

Non DOT Regulated Oily Water

QTY

1

QTY

1

QTY

1

QTY

20

QTY

80

COL - WASH

QTY

180

Non DOT Regulated Oily Water

QTY

1

QTY

1

QTY

1

QTY

20

QTY

80

COL - WASH

QTY

180

Non DOT Regulated Oily Water

QTY

1

QTY

1

QTY

1

QTY

20

QTY

80

COL - WASH

QTY

180

Non DOT Regulated Oily Water

QTY

1

QTY

1

QTY

1

QTY

20

QTY

80

COL - WASH

QTY

180

Non DOT Regulated Oily Water

QTY

1

QTY

1

QTY

1

QTY

20

QTY

80

COL - WASH

QTY

180

Non DOT Regulated Oily Water

QTY

APPENDIX C

Certification of the Applicability of the No Substantial Harm Criteria

CERTIFICATION OF THE APPLICABILITY OF THE NO SUBSTANTIAL

HARM CRITERIA CHECKLIST

(40 CFR 112 Appendix C, Attachment C-11)

1. Does the facility transfer oil over water to or from vessels and does the facility have a total oil storage capacity greater than or equal to 42,000 gallons? Yes _____ No ~~X~~
2. Does the facility have a total oil storage capacity greater than or equal to 1 million gallons and does the facility lack secondary containment that is sufficiently large to contain the capacity of the largest aboveground oil storage tank plus sufficient freeboard to allow for precipitation within any aboveground oil storage tank area? Yes _____ No ~~X~~
3. Does the facility have a total oil storage capacity greater than or equal to 1 million gallons and is the facility located at a distance (as calculated using the formula in Attachment C-III, Appendix C, 30 CFR 112 or a comparable formula¹) such that a discharge from the facility could cause injury to fish and wildlife and sensitive environments? For further description of fish and wildlife and sensitive environments, see Appendices I, II and III to DOC/NOAA's "Guidance for Facility and Vessel Response Environments" (Section 10, Appendix E, 40 CFR 112 for availability) and the applicable Area Contingency Plan. Yes _____ No ~~X~~
4. Does the facility have a total oil storage capacity greater than or equal to 1 million gallons and is the facility located at a distance (as calculated using the appropriate formula (Attachment C-III, Appendix C, 40 CFR 112 or a comparable formula¹) such that a discharge from the facility would shut down a public drinking water intake²? Yes _____ No ~~X~~
5. Does the facility have a total oil storage capacity greater than or equal to 1 million gallons and has the facility experienced a reportable oil spill in any amount greater than or equal to 10,000 gallons within the last 5 years? Yes _____ No ~~X~~

¹ If a comparable formula is used, documentation of the reliability and analytical soundness of the comparable formula must be attached to this form.

² For the purposes of 40CFR part 112, public drinking water intakes are analogous to public water systems as described at 40 CFR 143.2(c) (from 40 CFR 112 APPENDIX C, ATTACHMENT C-II)

CERTIFICATION

I certify under penalty of law that I have personally examined and am familiar with the information submitted in this document, and that based on my inquiry of those individuals responsible for obtaining this information, I believe that the submitted information is true, accurate and complete.

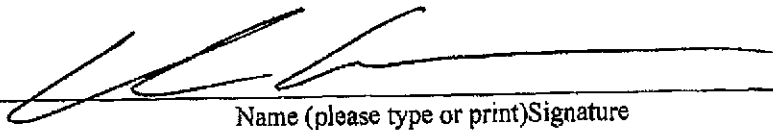

Name (please type or print)Signature

Operations Manager

Title (please type or print)Date

APPENDIX D

Truck Unloading and Loading Procedures

Oil truck Unloading and Loading Procedures

Mishaps associated with transfers of bulk oil from a truck to a storage tank, or from a tank to a truck (e.g., used oil), pose a potential for spills in the transfer area. The following procedures are to be used to prevent a spill, and to minimize the impact if one does occur.

1. A facility employee, and the truck driver are to continuously attend each transfer.
2. Smoking is prohibited within 25 feet of any part of the transfer system.
3. Position the truck, chock its wheels, put up signs or physical barriers if necessary, and have the truck driver set the vehicle's manual brake and turn off the engine (unless it is required to operate the pump).
4. Put a spill collection pail, drip pan, or oil absorbent pads beneath all hose connections that may be prone to leakage, before starting the transfer. If appropriate, use portable curbing or a mat to isolate the transfer area from a nearby storm drainage feature.
5. Make sure all valves are closed, then connect and secure the transfer hose.
6. Tell the truck driver the approximate amount of the transfer, and assure that the working capacity of the tank or truck (normally 90% of design capacity) will not be exceeded.
7. Open the valves and check for leaks.
8. Start the transfer, with both the truck driver and an employee present within 25 feet and in view of the hose and/or tank at all times.
9. Monitor for leaks while unloading. If a leak occurs, immediately stop the transfer until the leak has been eliminated, and try to contain the oil on pavement. If any oil reaches soil, water, or a storm drain, immediately notify the facility manager.
10. Stop the flow when the working capacity of the receiving vessel has been reached, or the desired amount has been transferred, whichever occurs first, and close all transfer valves.
11. Disconnect the transfer hose so that no oil is spilled. If the hose is not designed to remain filled, blow it empty, or drain it into a collection device and transfer the collected oil into an appropriate tank or other container, or the truck.
12. Again, check the truck for leakage and the transfer area for spilled oil, and notify the facility manager and/or **SPCC Coordinator** (or designee) of any release.
13. Remove the wheel chocks and any signs or barriers before releasing the truck.

APPENDIX E

MONTHLY INSPECTION REPORT

MONTHLY INSPECTION REPORT
ABOVEGROUND PETROLEUM STORAGE AND DISTRIBUTION SYSTEMS

MONTH AND YEAR _____

Facility: Flagler Construction Equipment, LLC 5210 Reese Road, Davie, FL 33314
Storage Tank Registration Number (if any) _____

Condition of Tank and Ancillary Equipment

<i>Tank Number</i>					
Exterior Condition					
Supports and Foundations (visible portion)					
Surrounding Area (no evidence of leak or spill)					
Markings (contents, tank number, total & working capacities)					
Secondary Containment (if other than double walled tank)					
Piping, Valves, Pumps, and their Supports					
Gauge and/or High Level Alarm					
Leak Detection System					
Fill Port Locked (if outdoors and not fenced)					
Fill Port Color Coding					
Liquid in Outdoor Secondary Containment Inspected and Drained					

Notes:

1. "OK" means no leak, spill, crack, malfunction, missing item, significant corrosion or settling, etc.
2. "NO" means that one or more deficiencies were identified (describe below)
3. "NA" means that the topic is not applicable to the tank
4. Report any deficiency immediately
5. Keep this inspection report for three (3) years.

Comments:

Inspection Requirements:

- 1) Inspect exterior surfaces of tanks, other containers, pipes, valves and other equipment for leaks and maintenance deficiencies;
- 2) Identify cracks, areas of wear, corrosion and thinning, poor maintenance and operating practices, excessive settlement of structures, separation or swelling of tank insulation, malfunctioning equipment and structural and foundation weaknesses; and
- 3) Inspect and monitor all leak detection systems, cathodic protection monitoring equipment, or other monitoring or warning systems which may be in place at the facility.

Certification: I hereby certify that this inspection has been performed in a manner consistent with the applicable requirements of Chapter 62-761, F.A.C.

Inspector Printed Name

Inspector's Signature in Full

Date

APPENDIX F

**TYPICAL SPCC PERSONNEL TRAINING PROGRAM OUTLINE
AND RECORD**

TYPICAL SPCC PLAN PERSONNEL TRAINING PROGRAM OUTLINE

A. Program Intent

- a. Federal (U.S. EPA) program for proper onsite management and handling of oil, prevention of spills, and proper spill response if spill occur. The U.S. EPA could inspect facility for compliance with this SPCC Plan.
- b. "Oil" includes petroleum-based materials (gasoline, diesel fuel, kerosene, fuel oil, motor oil, hydraulic fluid, used oil, transform oil, etc.), as well as vegetable oil, in a container having a capacity of 55 gallons or more.

B. SPCC Plan

- a. Developed for implementation by site personnel
- b. Facility copy must be maintained/updated by facility's SPCC Coordinator
- c. Copy is available for review by all employees at any time

C. Training – Who, When, What

- a. WHO – ALL Facility employees involved in handling and management of any oil.
- b. WHEN – Minimum initial and annual refresher for all employees involved in oil handling.
 - Within two weeks of hire for new employees involved in oil handling.
 - If/when facility oil handling changes (so the SPCC Plan must be updated)

c. WHAT -

- | | | |
|------|----------------|---|
| i. | Initial: | Entire SPCC Plan |
| ii. | Annual Update: | Known spill events or failures, malfunctioning components |
| iii. | Ongoing: | Facility changes, recently developed precautionary measures |

D. SPCC Coordinator

- a. Responsible for SPCC Plan implementation and oil spill prevention at the facility, see that person if ever any questions or concerns.

E. General Facility Layout, Site Plan and Drainage Systems (SPCC Plan Section 3.0)

- a. Ensure understanding of general facility operations, overall facility layout, drainage discharge locations, sensitive receiving water bodies, etc.

F. Site Plan(Figure 1) summarizes the facility locations for oil handling.

Typical SPCC Plan Personnel Training Program Outline

- A. Facility's Specific Oil Handling Inventory (SPCC Plan Section 4.0)
 - a. Applies to containers with a capacity of 55 gallons or more , and transfers to/from them:
 - i. Stationary and mobile aboveground storage tanks (ASTs)
 - ii. Underground storage tanks (USTs)
 - iii. Drum and "tote" tank storage and handling
 - b. Also applies to:
 - i. Gauges, alarms and leak detection systems
 - ii. Piping systems
 - iii. Oil-filled electrical, operating and manufacturing equipment
 - iv. Oil unloading/loading areas
 - v. Additional Oil storage or handling activities
- B. Containment and/or Diversionary Structures or Equipment to Prevent a Discharge
 - a. Specific facility measures provided, as per the SPCC Plan
 - b. Important because spilled oil will flow in accordance with drainage paths
 - c. Intent of program is to keep oil out of water, out of storm water and drainage
 - d. Review operation and maintenance of all equipment intended to prevent discharges
- C. Facility Drainage (SPCC Plan Section 6.0)
 - a. Management of drainage from diked areas
 - b. Drainage from undiked areas
 - c. Potential impact on surface waters (including wetlands)
- D. Facility Transfer Operations, Pumping and In-plant Processes (SPCC Plan Section 8.0)
 - a. Operation and maintenance measures to prevent discharges
- E. Truck Unloading/loading Areas
 - a. Spills from inbound/outbound transfers including direction of flow
 - b. Unloading/loading must be visually monitored by facility personnel at all times
 - c. Immediate response must be made to any spills, per the Plan's spill response procedures
- F. Inspections and Tests (SPCC Plan Section 10.0)
 - a. Comprehensive visual inspection monthly, with documentation
 - b. Prompt completion of required repairs, with documentation
 - c. Periodic integrity testing of tanks

G. Security (SPCC Plan Section 11.0)

- a. General facility security measures, and localized measures for individual oil handling areas .

H. Spill Response Procedures (SPCC Plan Section 13.0)

- a. Need to watch for, report, and clean up spills
- b. Spill response equipment, inventory, minimum amount to be always maintained, replenishment of use materials, etc.
- c. Review understanding of spill equipment, intent and how to use/deploy it; supplement with construction equipment if necessary, etc.
- d. Spill reporting requirements to Federal and State agencies.\

I. Additional State Requirements

- a. Petroleum Bulk Storage Program
- b. Used Oil Requirements

J. Miscellaneous

- a. Describe and review past discharges, reasons or causes, procedures to prevent recurrence, etc.
- b. Describe and review any other equipment failures, malfunctioning components and any recently developed precautionary measures relative to oil handling and spill control

K. General Rules

- a. Do not wait for problems or spills to occur. Keep eyes open, anticipate problems and take precautionary measures to prevent incidents. Report all identified or suspected concerns.

Record of SPCC Plan Training and Discharge Prevention Briefings

Facility: Flagler Construction Equipment, LLC 9601 Boggy Creek Road, Orlando, FL 32824

1) SPCC Plan Personnel Training Topics

- a. Operation and maintenance of equipment to prevent discharges
- b. Discharge procedure protocols
- c. Applicable pollution control, laws, rules and regulations
- d. General facility operations
- e. Contents of the facility SPCC Plan

2) Discharge Prevention Briefings

- a. Known discharges and failures
- b. Malfunctioning components
- c. Any recently developed precautionary measures

Training/Briefing Date: _____

Training/Briefings Presented by: _____

*Spill Prevention, Control and Countermeasure (SPCC) Plan
Flagler Construction Equipment, LLC 5210 Reese Rd. Davie, FL 33314*

Attendees:

NAME	SIGNATURE	ID NUMBER

APPENDIX G

FACILITY OIL SPILL RESPONSE PROTOCOLS

Oil Spill Response Prevention

Note: Facility personnel are trained in responding to routine oil spills and associated housekeeping requirements. They are not trained as "first responders" in the event of a major oil release. Commercial emergency response contractors and/or local municipal hazardous materials response teams (HazMat Teams) are to be utilized to respond to significant spills.

- 1) In the event of an oil spill, from a distance, attempt to visually locate and determine the source and extent of the spill.
- 2) If unsafe conditions are evident or appear possible, evacuate the immediate spill area and notify facility management and emergency response personnel.
- 3) If the spill area appears safe, secure the spill area to protect personnel and the public from immediate danger. If possible, take appropriate measures to stop the source of the spill. Extinguish all sources of ignition (flames, sparks, hot surfaces, cigarettes, etc.) if possible.
- 4) If the spill response measures include the shutdown of any process or operating equipment, ensure that appropriate facility personnel are sufficiently aware of these shutdowns and any resulting effects (pressure buildups, gas generation, service disruptions, etc.).
- 5) As appropriate, place and seal barriers over or around catch basins and grates to reduce introduction of oil to drainage courses.
- 6) Attempt to contain or limit the spill, utilizing the facility's spill response equipment and supplies. Try to limit the discharge of the spill by diverting the spill, creating temporary dikes and/or using absorbent materials.
- 7) If secondary containment is provided at the spill location, verify that all discharge valves are closed. Plug all drains and weep holes that may provide a pathway for further oil migration.
- 8) Notify the facility's SPCC Coordinator, who will provide the further internal and external notifications, including, as necessary, notifications to the local police and fire departments and an emergency response contractor. The following information should be provided to the SPCC Coordinator:
 - a. The name of the person reporting the spill
 - b. The location of the spill
 - c. The type of oil spilled
 - d. An estimate of the amount of oil spilled

- e. Actions already taken in response to the spill
 - f. Any significant imminent concerns regarding the spill
- 9) If the spill is routine, facility personnel should proceed with appropriate cleanup of the spill, using the facility's spill response equipment and supplies. In the event of a larger spill, the facility's SPCC Coordinator will direct the spill cleanup measures.
- a. Retrieve any bulk oil using available means and place in proper liquid container. Immediately label the container as to the contents and date and nature of origination or, as appropriate, return the bulk oil to the intended storage vessel, if the material is confirmed to be uncontaminated.
 - b. Apply absorbent material to pick up the remaining oil after the bulk oil has been retrieved. Place the oil spill residue in proper containers. Immediately label the containers as to their contents and the date and nature of origination. Do not mix oil spill residue with bulk oil. Do not step on spilled oil.
 - c. Clean up spill control equipment and containers. Be sure to replace all equipment to its proper location. Restock/order any spill response material (absorbents, etc.) as necessary
 - d. Carefully wash all spilled oil from skin and clothing using soap. Change clothes if necessary to avoid further oil contact. Containerize and appropriately manage clothing that cannot be easily washed.
- 10) Promptly document the spill utilizing the Spill Incident Report Form provided within this Appendix, following the Emergence Telephone Number page. Provide this completed form to the facility's SPCC Coordinator.
- 11) Normal operations and activities in the affected spill area are to resume only upon specific approval by the facility's SPCC Coordinator.
- 12) The SPCC Coordinator will immediately proceed with initiating the proper agency notifications for the spill, as appropriate.

**SPILL PREVENTION CONTROL AND COUNTERMEASURE (SPCC) PLAN
EMERGENCY TELEPHONE NUMBERS**

Facility: Flagler Construction Equipment, LLC 5210 Reese Road, Davie, FL 33314

SPCC Coordinator (off hours)	Michael Dueyour 954-295-8338
Backup SPCC Coordinator (off hours)	Mike Henson 813-220-8111
Fire	911 or 954-759-6800
Police	911 or 954-828-5700
Ambulance	911 or 954-564-3699
Municipal HazMat Team	911 or 954-759-6800
Commercial Emergency Response Contractor	SWS Environmental First Response 800-852-8878
Spill Response Equipment and Supply Vender	Grainger 954-463-3451
National Response Center	800-424-8802 (24-Hour Number) 202-267-2675 (24 Hour Number)
CHEMTREC	800-424-9300 (24 Hour Number)
State Environmental Agency	800-320-0519 (24 Hour Number)

SPILL INCIDENT DATA FORM

Facility: Flagler Construction Equipment, LLC 5210 Reese Road, Davie, FL 33314

Date and Time of discharge:

Name, title and phone number of person completing this form:

Type of material discharged:

Estimated total quantity of material discharged (weight or volume basis):

Source, cause and duration of material discharged:

Brief description of the discharge:

Description of all affected media (estimated extent of contamination to land, air, and/or water):

Describe actions used to stop, remove and mitigate the effects of the discharge:

Is or was site evacuation needed?

Individuals and/or organizations already contacted:

Signature of person completing this form, and date:

SPILL INCIDENT REPORTING FORM

Facility: Flagler Construction Equipment, LLC 5210 Reese Road, Davie, FL 33314

Report information as provided on the completed Spill Incident Form.

Name and title of person reporting discharge:

Date, time and method of reporting:

Agencies notified:

Comments:

Note: There is usually no minimum threshold of material quantity to preclude the need to report a spill. Refer to the text of the SPCC Plan for additional information on spill reporting requirements.



SENTRY SELECT INSURANCE COMPANY
STEVENS POINT, WISCONSIN
(A PARTICIPATING STOCK COMPANY)
A MEMBER OF THE SENTRY FAMILY OF INSURANCE COMPANIES

CERTIFICATE OF INSURANCE

ACCOUNT NUMBER 25-51455

This certificate is issued as a matter of information only and confers no rights upon the certificate holder. This certificate does not amend, extend or alter the coverage afforded by the policies below.

Name and Address of
Certificate Holder

FCE PROPERTIES OF DAVIE LLC
9601 BOGGY CREEK RD
ORLANDO, FL 32824

Name and Address
of the Insured

FLAGLER CE HOLDINGS LLC DBA
FLAGLER CONSTRUCTION
EQUIPMENT LLC
8418 PALM RIVER RD
TAMPA, FL 33619

This certificate is issued on 05-01-2014 and is effective until 05-01-2015. It certifies that policies of insurance listed below have been issued to the insured named above. Notwithstanding any requirement, term or condition of any contract or other document with respect to which this certificate may be issued or may pertain, the insurance afforded by the policies described herein is subject to all the terms, exclusions, and conditions of such policies. Limits shown may have been reduced by paid claims.

<u>Coverage Provided</u>	<u>Policy Number</u>	<u>Coverage Limits</u>
<u>General Liability</u>	25-51455-05	General Aggregate \$ 3,000,000
Bodily Injury and	OCCURRENCE	Products Aggregate \$ 3,000,000
Property Damage Combined		Pers/Adv Injury \$ 1,000,000
		Each Occurrence \$ 1,000,000
		Premises Damage \$ 100,000
		Medical Expense \$ 5,000
<u>Automobile Liability</u>	25-51455-05	Each Accident \$ 1,000,000
Includes: Bodily Injury and Property Damage Combined -Any Auto		
<u>Excess/Umbrella Liability</u>	25-51455-05	Each Occurrence \$ 15,000,000
		General Aggregate \$ 45,000,000
		Products Aggregate \$ 45,000,000

RE: 5210 REESE ROAD DAVIE FL AND 8418 PALM RIVER RD, TAMPA FL 33619

Should any of the above described policies be cancelled before the expiration date thereof, notice will be delivered in accordance with the policy provisions.

80-C1035 (MECH)

FLA 25-51455 01-015309
04-18-2014
PAGE 1
(0345)

LDI COI 269628-1 02 11



SENTRY SELECT INSURANCE COMPANY
STEVENS POINT, WISCONSIN
(A PARTICIPATING STOCK COMPANY)
A MEMBER OF THE SENTRY FAMILY OF INSURANCE COMPANIES

CERTIFICATE OF INSURANCE

ACCOUNT NUMBER 25-51455

This certificate is issued as a matter of information only and confers no rights upon the certificate holder. This certificate does not amend, extend or alter the coverage afforded by the policies below.

Name and Address of
Certificate Holder

FCE PROPERTIES OF FT MYERS LLC
9601 BOGGY CREEK RD
ORLANDO, FL 32824

Name and Address
of the Insured

FLAGLER CE HOLDINGS LLC DBA
FLAGLER CONSTRUCTION
EQUIPMENT LLC
8418 PALM RIVER RD
TAMPA, FL 33619

This certificate is issued on 05-01-2014 and is effective until 05-01-2015. It certifies that policies of insurance listed below have been issued to the insured named above. Notwithstanding any requirement, term or condition of any contract or other document with respect to which this certificate may be issued or may pertain, the insurance afforded by the policies described herein is subject to all the terms, exclusions, and conditions of such policies. Limits shown may have been reduced by paid claims.

<u>Coverage Provided</u>	<u>Policy Number</u>	<u>Coverage Limits</u>
<u>General Liability</u>	25-51455-05	General Aggregate \$ 3,000,000
		Products Aggregate \$ 3,000,000
		Pers/Adv Injury \$ 1,000,000
		Each Occurrence \$ 1,000,000
		Premises Damage \$ 100,000
		Medical Expense \$ 5,000
Bodily Injury and Property Damage Combined	OCCURRENCE	
<u>Automobile Liability</u>	25-51455-05	Each Accident \$ 1,000,000
Includes: Bodily Injury and Property Damage Combined -Any Auto		
<u>Excess/Umbrella Liability</u>	25-51455-05	Each Occurrence \$ 15,000,000
		General Aggregate \$ 45,000,000
		Products Aggregate \$ 45,000,000
RE 5151 MARTIN LUTHER KING BLVD FT MYERS FL		

Should any of the above described policies be cancelled before the expiration date thereof, notice will be delivered in accordance with the policy provisions.

80-C1035 (MECH)

FLA 25-51455 01-015309
04-18-2014
PAGE 1
(0346)

LDI COI 269628-1 02 11



SENTRY SELECT INSURANCE COMPANY
STEVENS POINT, WISCONSIN
(A PARTICIPATING STOCK COMPANY)
A MEMBER OF THE SENTRY FAMILY OF INSURANCE COMPANIES

CERTIFICATE OF INSURANCE

ACCOUNT NUMBER 25-51455

This certificate is issued as a matter of information only and confers no rights upon the certificate holder. This certificate does not amend, extend or alter the coverage afforded by the policies below.

Name and Address of
Certificate Holder

FLAGLECE HOLDINGS LLC
9601 BOGGY CREEK RD
ORLANDO, FL 32824

Name and Address
of the Insured

FLAGLER CE HOLDINGS LLC DBA
FLAGLER CONSTRUCTION
EQUIPMENT LLC
8418 PALM RIVER RD
TAMPA, FL 33619

This certificate is issued on 05-01-2014 and is effective until 05-01-2015. It certifies that policies of insurance listed below have been issued to the insured named above. Notwithstanding any requirement, term or condition of any contract or other document with respect to which this certificate may be issued or may pertain, the insurance afforded by the policies described herein is subject to all the terms, exclusions, and conditions of such policies. Limits shown may have been reduced by paid claims.

Coverage Provided

Policy Number

Coverage Limits

General Liability

Bodily Injury and
Property Damage Combined

25-51455-05	General Aggregate	\$ 3,000,000
OCCURRENCE	Products Aggregate	\$ 3,000,000
	Pers/Adv Injury	\$ 1,000,000
	Each Occurrence	\$ 1,000,000
	Premises Damage	\$ 100,000
	Medical Expense	\$ 5,000

Automobile Liability

Includes: Bodily Injury
and Property
Damage Combined
-Any Auto

25-51455-05	Each Accident	\$ 1,000,000
-------------	---------------	--------------

Excess/Umbrella
Liability

25-51455-05	Each Occurrence	\$ 15,000,000
	General Aggregate	\$ 45,000,000
	Products Aggregate	\$ 45,000,000

Should any of the above described policies be cancelled before the expiration date thereof, notice will be delivered in accordance with the policy provisions.

80-C1035 (MECH)

FLA 25-51455 01-015309
04-18-2014
PAGE 1
(0105)

LDI COI 269628-1 02 11



SENTRY SELECT INSURANCE COMPANY
STEVENS POINT, WISCONSIN
(A PARTICIPATING STOCK COMPANY)
A MEMBER OF THE SENTRY FAMILY OF INSURANCE COMPANIES

CERTIFICATE OF INSURANCE

ACCOUNT NUMBER 25-51455

This certificate is issued as a matter of information only and confers no rights upon the certificate holder. This certificate does not amend, extend or alter the coverage afforded by the policies below.

Name and Address of
Certificate Holder

FCE PROPERTIES OF DAVIE LLC
9601 BOGGY CREEK RD
ORLANDO, FL 32824

Name and Address
of the Insured

FLAGLER CE HOLDINGS LLC DBA
FLAGLER CONSTRUCTION
EQUIPMENT LLC
8418 PALM RIVER RD
TAMPA, FL 33619

This certificate is issued on 05-01-2015 and is effective until 05-01-2016. It certifies that policies of insurance listed below have been issued to the insured named above. Notwithstanding any requirement, term or condition of any contract or other document with respect to which this certificate may be issued or may pertain, the insurance afforded by the policies described herein is subject to all the terms, exclusions, and conditions of such policies. Limits shown may have been reduced by paid claims.

<u>Coverage Provided</u>	<u>Policy Number</u>	<u>Coverage Limits</u>
<u>General Liability</u> Bodily Injury and Property Damage Combined	25-51455-05 OCCURRENCE	General Aggregate \$ 3,000,000 Products Aggregate \$ 3,000,000 Pers/Adv Injury \$ 1,000,000 Each Occurrence \$ 1,000,000 Premises Damage \$ 100,000 Medical Expense \$ 5,000
<u>Automobile Liability</u> Includes: Bodily Injury and Property Damage Combined -Any Auto	25-51455-05 Each Accident	\$ 1,000,000
<u>Excess/Umbrella Liability</u>	25-51455-05 Each Occurrence General Aggregate Products Aggregate	\$ 15,000,000 \$ 45,000,000 \$ 45,000,000
<u>General Liability</u> Bodily Injury and Property Damage Combined	25-51455-11 OCCURRENCE	General Aggregate \$ 3,000,000 Products Aggregate \$ 3,000,000 Pers/Adv Injury \$ 1,000,000 Each Occurrence \$ 1,000,000 Premises Damage \$ 100,000 Medical Expense \$ 5,000

RE: 5210 REESE ROAD DAVIE FL AND 8418 PALM RIVER RD, TAMPA FL 33619

Should any of the above described policies be cancelled before the expiration date thereof, notice will be delivered in accordance with the policy provisions.

80-C1035 (MECH)

FLA 25-51455 01-015309
04-22-2015
PAGE 1
(0345)

LDI COI 269628-1 02 11



SENTRY SELECT INSURANCE COMPANY
STEVENS POINT, WISCONSIN
(A PARTICIPATING STOCK COMPANY)
A MEMBER OF THE SENTRY FAMILY OF INSURANCE COMPANIES

CERTIFICATE OF INSURANCE

ACCOUNT NUMBER 25-51455

This certificate is issued as a matter of information only and confers no rights upon the certificate holder. This certificate does not amend, extend or alter the coverage afforded by the policies below.

Name and Address of
Certificate Holder

FLORIDA DEPT OF MANAGEMENT
SERVICES
4050 ESPLANADE WAY
TALLAHASSEE, FL 32399

Name and Address
of the Insured

FLAGLER CE HOLDINGS LLC DBA
FLAGLER CONSTRUCTION
EQUIPMENT LLC
8418 PALM RIVER RD
TAMPA, FL 33619

This certificate is issued on 05-01-2015 and is effective until 05-01-2016. It certifies that policies of insurance listed below have been issued to the insured named above. Notwithstanding any requirement, term or condition of any contract or other document with respect to which this certificate may be issued or may pertain, the insurance afforded by the policies described herein is subject to all the terms, exclusions, and conditions of such policies. Limits shown may have been reduced by paid claims.

Coverage Provided	Policy Number	Coverage Limits
General Liability	25-51455-05	General Aggregate \$ 3,000,000
Bodily Injury and	OCCURRENCE	Products Aggregate \$ 3,000,000
Property Damage Combined		Pers/Adv Injury \$ 1,000,000
		Each Occurrence \$ 1,000,000
		Premises Damage \$ 100,000
		Medical Expense \$ 5,000
Automobile Liability	25-51455-05	Each Accident \$ 1,000,000
Includes: Bodily Injury and Property		
-Any Auto		
Excess/Umbrella	25-51455-05	Each Occurrence \$ 15,000,000
		General Aggregate \$ 45,000,000
		Products Aggregate \$ 45,000,000

80-C1035 (SFA)

FLA 25-51455 01-015309
07-23-2015
PAGE 1
(0428)

LDI COI 269628-1 02 11



CERTIFICATE OF INSURANCE - (CONT)**ACCOUNT NUMBER 25-51455**

Coverage Provided	Policy Number	Coverage Limits
General Liability	25-51455-11	General Aggregate \$ 3,000,000
		Products Aggregate \$ 3,000,000
Bodily Injury and	OCCURRENCE	Pers/Adv Injury \$ 1,000,000
Property Damage Combined		Each Occurrence \$ 1,000,000
		Premises Damage \$ 100,000
		Medical Expense \$ 5,000

Should any of the above described policies be cancelled before the expiration date thereof, notice will be delivered in accordance with the policy provisions.

80-C1035 (SFA)

FLA 25-51455 01-015309

LDI COI 269628-1 02 11

07-23-2015

PAGE 2

(0428)

JULY 2015