



Cliff Berry, Incorporated  
Environmental Services

Dept. of Environmental  
Protection

JUN 22 2007

June 20, 2007

Southwest District

Mr. Bheem Kothur, P.E. III  
Hazardous Waste Regulation  
Florida Department of Environmental Protection ( FDEP )  
Twin Towers Office Building  
2600 Blair Stone Road  
Tallahassee, Florida 32399-2400

RE: Cliff Berry, Inc. - Tampa Facility  
EPA ID Number: FLR 000 013 888  
Used Oil Processing Facility Permit Modification Dated February 12, 2007

Dear Mr. Kothur:

Cliff Berry, Inc. ( CBI ) has received your response letter and information request via e-mail dated April 25, 2007 concerning the above referenced facility. Specifically, you listed two ( 2 ) items that CBI needs to address.

( See Attachment No. 1 )

I reviewed your letter and personally followed up on the matter. Listed below is each item in order from your letter and our response:

- A. Item No. 1 - **Attachment 3:** Please specify the tank numbers on the map with tank capacity and provide a revised Tank Table. Also provide 8 1/2" x 11" drawing for the tank area identifying all tanks to be attached in the permit.

The items above have been provided.

( See Attachment No. 2 )

- B. Item No. 2 - **Cost Estimate:** Please review and revise the closure cost estimate.

The item above has been provided.

( See Attachment No. 3 )

If you have any questions or need any additional information please contact me at ( 954 ) 763 - 3390 or e-mail me at [bparkes@cliffberryinc.com](mailto:bparkes@cliffberryinc.com).

*cliff berry*

Sincerely,



William E. Parkes, Jr.  
Manager Regulatory Affairs and Capital Projects  
Cliff Berry Inc. ( CBI )

cc:

 James Dregne  
Mike Ambrose, P.E.

 ~~FDEP Southwest District~~  
Carnahan, Proctor and Cross Consulting Engineers

**ATTACHMENT NO. 1**



## Florida Department of Environmental Protection

Bob Martinez Center  
2600 Blair Stone Road  
Tallahassee, Florida 32399-2400

Charlie Crist  
Governor

Jeff Kottkamp  
Lt. Governor

Michael W. Sole  
Secretary

April 25, 2007

SENT VIA EMAIL  
[bparkes@cliffberryinc.com](mailto:bparkes@cliffberryinc.com)

Mr. William E. Parkes, Jr.  
Cliff Berry, Incorporated  
Post Office Box 13079  
Port Everglades Station  
Fort Lauderdale, Florida 33316

RE: Cliff Berry, Inc. – Tampa Facility  
EPA I.D. No. FLR 000 013 888  
Used Oil Processing Facility Permit modification

Dear Mr. Parkes:

The Florida Department of Environmental Protection (Department) has received your permit application dated February 12, 2007 and subsequent submittal dated March 16, 2007 to modify your Used Oil Processing Facility, Tampa, Florida.

The review of the permit application indicates that it is incomplete. Please provide the information requested in the enclosed summary. In preparing your response, the Department recommends that you identify each comment followed by your response and also provide your revised pages of the application. The revised pages are to include the new revision date.

Further action on processing your application is temporarily held in abeyance pending receipt of your complete response. Please submit three copies of your written response within 30 days of receipt of this notice. If you cannot submit this information within 30 days, you must formally request an extension and provide a schedule, with dates, indicating when this information will be submitted.

Mr. William E. Parkes, Jr.  
April 25, 2007  
Page Two

Should you like to arrange a meeting or if you have any questions, please contact Rabin Prusty at (850) 245-8780, e-mail: [rabin.prusty@dep.state.fl.us](mailto:rabin.prusty@dep.state.fl.us).

Sincerely,



Bheem Kothur, P.E. III  
Hazardous Waste Regulation

BK/rp

Enclosure

cc: James Dregne, Tampa, [james.dregne@dep.state.fl.us](mailto:james.dregne@dep.state.fl.us)  
Raoul Clarke, DEP/Tallahassee, [raoul.clarke@dep.state.fl.us](mailto:raoul.clarke@dep.state.fl.us)  
Fred Wick, DEP/Tallahassee, [fred.wick@dep.state.fl.us](mailto:fred.wick@dep.state.fl.us)

**ATTACHMENT**  
**April 24, 2007**  
**Cliff Berry, Inc. - Tampa Facility**  
**EPA I.D. No. FLR 000 013 888**  
**Notice of Deficiency**

1. **Attachment 3:** Please specify the tank numbers on the map with tank capacity and provide a revised Tank Table. The tank numbers on the map must match with the Tank Table. Please also provide an 8 ½" x 11" drawing for the tank area identifying all tanks to be attached in the permit.
2. **Cost Estimate:** By adding two new tanks you are adding 50,000 gallons to the system. It seems the closure cost estimate provided for 12 tanks is not adequate. Please review and revise the cost estimate as appropriate.



FLORIDA DEPARTMENT OF  
ENVIRONMENTAL PROTECTION  
JUN 22 2007  
SOUTHWEST DISTRICT  
TAMPA

ATTACHMENT NO. 2

**Table # 1**  
**Vertical Tanks**

<b>Tank #</b>	<b>Date Installed</b>	<b>Size ( Gallons )</b>	<b>Material of Construction</b>	<b>Products</b>
<b>1</b>	<b>6-05</b>	<b>25,000</b>	<b>Steel</b>	<b>Used Oil / Water</b>
<b>2</b>	<b>6-05</b>	<b>15,000</b>	<b>Steel</b>	<b>Used Oil / Water</b>
<b>3</b>	<b>6-05</b>	<b>15,000</b>	<b>Steel</b>	<b>Used Oil / Water</b>
<b>4</b>	<b>6-05</b>	<b>30,000</b>	<b>Steel</b>	<b>Used Oil / Water</b>
<b>5</b>	<b>6-05</b>	<b>25,000</b>	<b>Steel</b>	<b>Used Oil / Water</b>
<b>6</b>	<b>6-05</b>	<b>25,000</b>	<b>Steel</b>	<b>Used Oil / Water</b>
<b>7</b>	<b>6-05</b>	<b>25,000</b>	<b>Steel</b>	<b>Used Oil / Water</b>
<b>8</b>	<b>6-05</b>	<b>25,000</b>	<b>Steel</b>	<b>Used Oil / Water</b>
<b>9</b>	<b>6-05</b>	<b>30,000</b>	<b>Steel</b>	<b>Used Oil / Water</b>
<b>10</b>	<b>6-05</b>	<b>25,000</b>	<b>Steel</b>	<b>Used Oil / Water</b>

**Horizontal Tanks**

<b>11</b>	<b>proposed</b>	<b>30,000</b>	<b>Steel</b>	<b>Used Oil / Water</b>
<b>12</b>	<b>proposed</b>	<b>20,000</b>	<b>Steel</b>	<b>Used Oil / Water</b>



This lot as described is in zone "B" or 500 year flood zone as defined by the National Flood Insurance Program.  
(Community Panel No. 120112 0367 E, dated 8/15/89)  
**THIS PARCEL IS NOT WITHIN THE 100 YEAR FLOOD ZONE.**  
Elevations shown are in feet and refer to N.G.V.D. Mean Sea Level Datum.

[illegible]

Tract 7 in the Northwest 1/4 of Section 34, Township 29 South, Range 19 East, SOUTH TAMPA SUBDIVISION, according to map or plat thereof as recorded in Plat Book 6, Page 3 of the Public Records of Hillsborough County, Florida, less the following described part thereof: Beginning at the Northwest corner of said Tract 7, and running thence South 85°51'00" East, along the North boundary line of said Tract 7, 524.58 feet; thence South 00°32'12" West, 636.93 feet, to a point on the North right-of-way 516.24 feet; thence along the North right-of-way South 88°21'15" West, 143 feet, to the Point of Beginning; and also less right-of-way for St. Paul Street of the South side thereof.



EXISTING CONTAINMENT AREA

TOTAL AREA:	2,765 SF
NET AREA - TANKS & EQUIP.:	1,740 SF
VOLUME REQ. TO STORE:	30,000 GALS. X 110% = 4,412 CF
HEIGHT OF WALL REQ.:	31"

PROPOSED CONTAINMENT AREA

TOTAL AREA:	3,447 SF
NET AREA - TANKS & EQUIP:	2,465 SF
VOLUME REQ. TO STORE:	30,000 GALS. X 110% = 4,412 CF
HEIGHT OF WALL REQ:	23"

TANK #	SIZE (DALLONS)
1	25,000
2	15,000
3	15,000
4	30,000
5	25,000
6	25,000
7	25,000
8	25,000
9	30,000
10	25,000
11	30,000
12	20,000

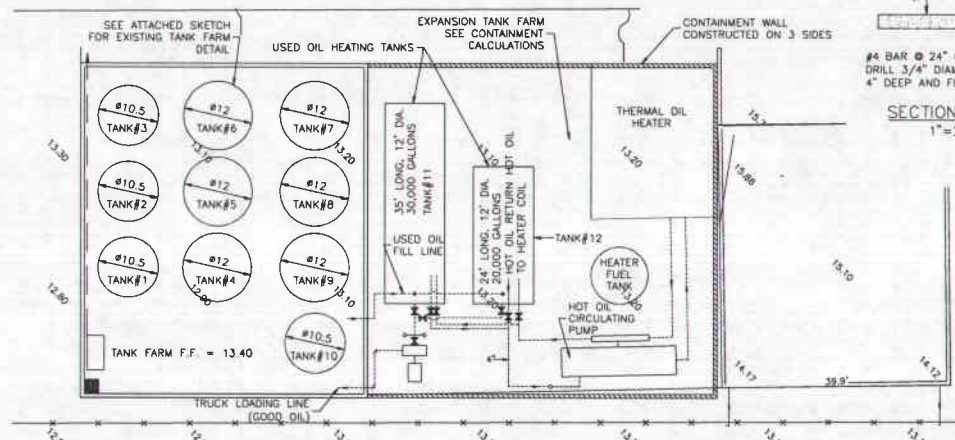

### USED OIL HEAT EXCHANGER LAYOUT

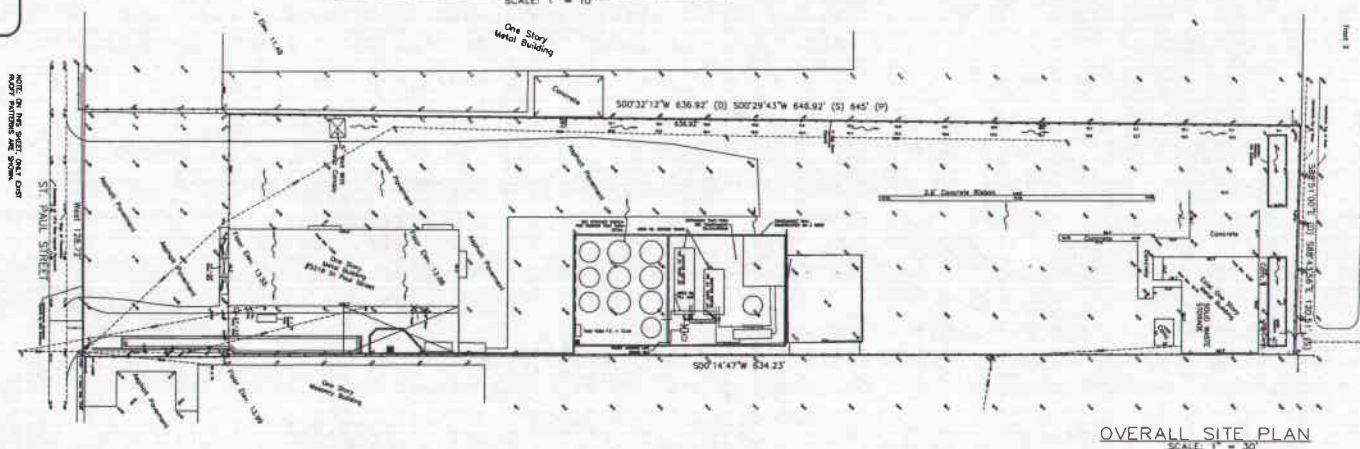

OVERALL SITE PLAN  
SCALE: 1" = 30'

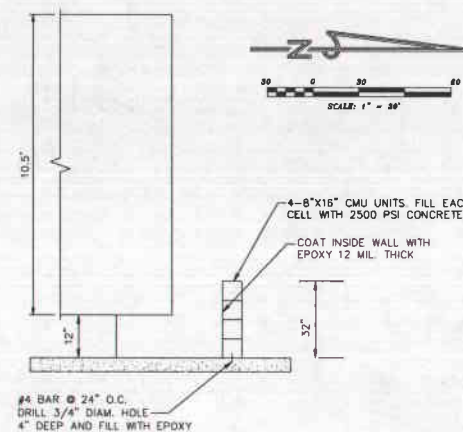

SECTION A-A  
1"=2'

**CBI TAMPA  
USED OIL TRANSFER FACILITY  
ST. PAUL STREET**

**C** **CARNAHAN • PROCTOR • CROSS, INC.**  
CONSULTING ENGINEERS • SURVEYORS • PLANNERS  
4301 WEST 47th AVENUE, SUITE 300, MINNEAPOLIS, MINNESOTA 55412

FILE NO. 050812

SCALE:	1"=30'
DATE:	4/28/08
DRAWN BY:	RCW
CHECKED BY:	DMA
DESIGNED BY:	DMA
1 OF 1	
D.M. AMBROSIO, P.E. FLORIDA REGISTRATION NO. 12801	

SEAL

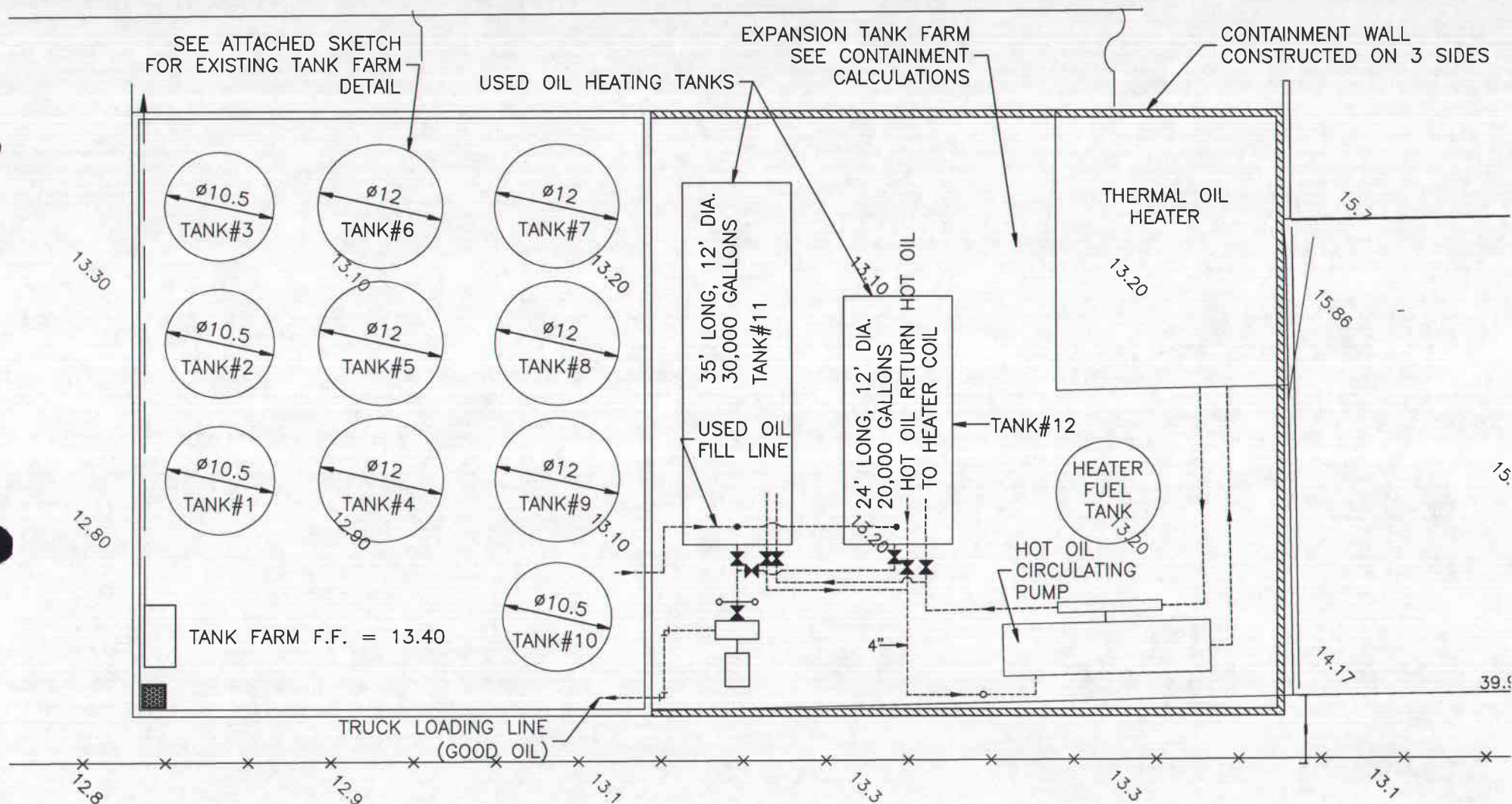

FLORIDA DEPARTMENT OF  
ENVIRONMENTAL PROTECTION  
JUN 22 2007  
SOUTHWEST DISTRICT  
TAMPA

ATTACHMENT NO. 3





# Florida Department of Environmental Protection

Twin Towers Office Bldg. • 2600 Blair Stone Road • Tallahassee, Florida 32399-2400

DEP Form #52-710.901(7)  
Form Title Used Oil Facility Financial  
Assurance Closing Cost Estimate Form  
Effective Date June 9, 2005

## Used Oil Processing Facility Closing Cost Estimate Form

Date: JUNE 11, 2007 Date of DEP Approval: \_\_\_\_\_  
I. GENERAL INFORMATION: Latitude: 27°55'10" NORTH Longitude: 82°23'45" WEST EPA ID Number: FLR 000 013 888  
Facility Name: CLIFF BERRY, INC. - TAMPA FACILITY Permit Number: 0076517-HO-002  
Facility Address: 5218 ST. PAUL STREET, TAMPA, FLORIDA 33619  
Mailing Address: P.O. Box 13079, FORT LAUDERDALE, FLORIDA 33316  
Contact Person's Name: WILLIAM E. PARKES, JR. Phone Number: (954) 763-3390  
Fax Number: (954) 763-8375  
Email: bparkes@cliffberryinc.com

### II. TYPE OF FINANCIAL ASSURANCE DOCUMENT (Check Type)

☒ Letter of Credit\* ☐ Performance Bond\* ☐ Guaranty Bond\*  
☐ Insurance Certificate ☐ Financial Test ☐ Trust Fund Agreement

\*Indicate mechanisms that  
require use of a Standby  
Trust Fund Agreement

### III. ESTIMATE ADJUSTMENT: (check and use either box a or b, below)

40 CFR Part 264, Subpart H, as adopted by reference in Rule 62-701.630, Florida Administrative Code, sets forth the method of annual cost estimate adjustment. Cost estimates may be adjusted by using an inflation factor or by recalculating the maximum costs of closing in current dollars. Estimates are due annually between January 1 and March 1. Select one of the methods of cost estimate adjustment below.

#### ☐ (a) Inflation Factor Adjustment

Inflation adjustment using an inflation factor may only be made when a Department approved closing cost estimate exists and no changes have occurred in the facility operation which would necessitate modification to the closure plan. The inflation factor is derived from the most recent Implicit Price Deflator for Gross National Product published by the U.S. Department of Commerce in its survey of Current Business. The inflation factor is the result of dividing the latest published annual Deflator by the Deflator for the previous year. The inflation factor may also be obtained from the Solid Waste Financial Coordinator at (850) 245-8732 or be found online at <http://www.dep.state.fl.us/waste/categories/swfr/>

This adjustment is based on the Department approved closing cost estimate dated: \_\_\_\_\_

_____	X	_____	=	_____
Latest DEP approved		Current Year		Inflation Adjusted
Closing Cost Estimate		Inflation Factor		Annual Closing Cost Estimate

Signature: \_\_\_\_\_ Phone: \_\_\_\_\_

Name and Title: \_\_\_\_\_ E-Mail: \_\_\_\_\_

If you have questions concerning this form, please contact the Used Oil Coordinator at the address below, by phone at (850) 245-8755, or by E-Mail at: [richard.neves@dep.state.fl.us](mailto:richard.neves@dep.state.fl.us)

**Please mail this completed cost estimate to:**

**Please mail a copy of the cost estimate to:**

Used Oil Permit Coordinator  
MS4560  
FDEP  
2600 Blair Stone Road  
Tallahassee, FL 32399-2400

Solid Waste Financial Coordinator  
MS 4565  
FDEP  
2600 Blair Stone Road  
Tallahassee, FL 32399-2400

FLORIDA DEPARTMENT OF  
ENVIRONMENTAL PROTECTION  
JUN 22 2007  
SOUTHWEST DISTRICT  
TAMPA

☐ (b) Recalculated Cost Estimates (complete items IV and V)

#### IV. RECALCULATIONS OF CLOSING COSTS

For the time period in the facility's operation when the extent and manner of its operation makes closing **most expensive**.

Third Party Estimate/Quote must be provided for each item.  
Costs must be for a third party providing all materials and labor.

DESCRIPTION	UNIT	QUANTITY	UNIT COST, \$	TOTAL \$
<b>1. Decontamination and Disposal</b>				
Note: These costs must be broken down by individual waste stream. If contamination is found, the cost estimate must be recalculated to include remediation costs.				
a. Used Oil tanks, containers, piping, equipment and secondary containment decontamination	<u>12</u>	<u>TANKS</u>	<u>1,200.00</u>	<u>14,400.00</u>
waste characterization	<u>8</u>	<u>TESTS</u>	<u>800.00</u>	<u>6,400.00</u>
disposal	<u>12</u>	<u>DRUMS</u>	<u>1,100.00</u>	<u>13,200.00</u>
b. Wash water				
waste characterization	<u>3</u>	<u>TESTS</u>	<u>800.00</u>	<u>2,400.00</u>
disposal	<u>6</u>	<u>DRUMS</u>	<u>1,100.00</u>	<u>6,600.00</u>
c. Sludges/ sediment				
waste characterization	<u>8</u>	<u>TESTS</u>	<u>800.00</u>	<u>6,400.00</u>
disposal	<u>10</u>	<u>VAC. BOXES</u>	<u>1,100.00</u>	<u>11,000.00</u>
d. Used oil filter management				
waste characterization	<u>2</u>	<u>TESTS</u>	<u>800.00</u>	<u>1,600.00</u>
disposal	<u>3</u>	<u>DRUMS</u>	<u>1,100.00</u>	<u>3,300.00</u>
e. Petroleum Contaminated Water (PCW), tanks, containers, piping, equipment and secondary containment				
waste characterization	<u>3</u>	<u>TESTS</u>	<u>800.00</u>	<u>2,400.00</u>
disposal	<u>4</u>	<u>DRUMS</u>	<u>1,100.00</u>	<u>4,400.00</u>
f. Mobilization Costs	<u>1</u>	<u>L.S.</u>	<u>5,000.00</u>	<u>5,000.00</u>
g. other _____	_____	_____	_____	_____
Subtotal (1) Decontamination/Disposal:				<u>77,100.00</u>

**2. Engineering (on-site inspections and Quality Assurance are to be included in this item).**

a. Closure sampling and analysis plan implementation  
as described in the permit application

\$6,000.00

b. Closure Certification Report

\$4,000.00

**Subtotal (2) Professional Services:**

\$10,000.00

**Subtotal of (1) and (2) Above:**

\$87,100.00

**3. Contingency (10% of the Subtotal)**

\$8,710.00

**Closing Cost Subtotal:**

\$95,810.00

**TOTAL CLOSING COST:**

\$95,810.00

**V. CERTIFICATION BY ENGINEER and OWNER/OPERATOR**

This is to certify that the Financial Assurance Cost Estimates pertaining to the engineering features of the this solid waste management facility have been examined by me and found to conform to engineering principals applicable to such facilities. In my professional judgment, the Cost Estimates are a true, correct and complete representation of the financial liabilities for closing of the facility, and comply with the requirements of Florida Administrative Code (F.A.C.), Rule 62-701.630 and all other Department of Environmental Protection rules, and statutes of the State of Florida. It is understood that the Financial Assurance Cost Estimates shall be submitted to the Department **annually** between January 1 and March 1 of each year and revised, adjusted and updated as required by Rule 62-701.630(4), F.A.C.



Signature of Engineer

D.M. AMBROSE, P.E.

Engineer's Name and Title (please print or type)

12831

Florida Registration Number (please print or type)

P.O. Box 2368, Blowing Rock, N.C. 28605

Engineer's Mailing Address

(954) 821-7635

Engineer's Telephone Number

ambrosefox@bellsouth.net

Engineer's email address

Signature of Owner/Operator

CLIFF BERRY II, PRESIDENT

Owner's Name and Title (please print or type)

(954) 763-3390

Owner/Operator's Telephone Number

cb2@cliffberryinc.com

Owner/Operator's E-Mail Address



**D. M. AMBROSE, P.E.**

P.O. Box 2368 Blowing Rock, N.C. 28605

Job No.:

10010

Prepared by:

D.M. Ambrose, P. E.

Date:

1/6/06

Contractor:

Cliff Berry Inc.

**Closing Cost, Cliff Berry Inc. Tampa Facility**

5218 Saint Paul Street, Tampa, FL 33618

**Cost Estimate**

DESCRIPTION	QUANTITY	UNITS	UNIT PRICE	BID PRICE	TOTAL
<b>I. Used Oil Tanks</b>					
Decontamination-Tank Cleaning	12	Tanks	\$1,200.00		\$14,400.00
Waste Characterization	8	Tests	\$800.00		\$6,400.00
Waste Disposal	12	Drums	\$1,100.00		\$13,200.00
<b>SUBTOTAL</b>					<b>\$34,000.00</b>
<b>II. Wash Water</b>					
Waste Characterization	3	Tests	\$800.00		\$2,400.00
Waste Disposal	6	Drums	\$1,100.00		\$6,600.00
<b>SUBTOTAL</b>					<b>\$9,000.00</b>
<b>III Sludges/Sediment</b>					
Waste Characterization	8	Tests	\$800.00		\$6,400.00
Waste Disposal	10	Vac. Boxes	\$1,100.00		\$11,000.00
<b>SUBTOTAL</b>					<b>\$17,400.00</b>
<b>IV Used Oil Filter Management</b>					
Waste Characterization	2	Tests	\$800.00		\$1,600.00
Waste Disposal	3	Drums	\$1,100.00		\$3,300.00
<b>SUBTOTAL</b>					<b>\$4,900.00</b>
<b>V. Petroleum Contaminated Water</b>					
Waste Characterization	3	Tests	\$800.00		\$2,400.00
Waste Disposal	4	Drums	\$1,100.00		\$4,400.00
<b>SUBTOTAL</b>					<b>\$6,800.00</b>
<b>VI Mobilization</b>					
Used Oil Tanks	1	Ea.	\$1,400.00		\$1,400.00
Wash Water	1	Ea.	\$900.00		\$900.00
Sludges/Sediment	1	Ea.	\$900.00		\$900.00
Used Oil Filter Management	1	Ea.	\$900.00		\$900.00
Petroleum Contaminated Water	1	Ea.	\$900.00		\$900.00
<b>SUBTOTAL</b>					<b>\$5,000.00</b>
<b>SUMMARY</b>					
<b>Used Oil Tanks</b>					<b>\$34,000.00</b>
<b>Wash Water</b>					<b>\$9,000.00</b>
<b>Sludges/Sediment</b>					<b>\$17,400.00</b>
<b>Used Oil Filter Management</b>					<b>\$4,900.00</b>
<b>Petroleum Contaminated Water</b>					<b>\$6,800.00</b>
<b>Mobilization</b>					<b>\$5,000.00</b>
<b>TOTAL</b>					<b>\$77,100.00</b>

Prepared by: D.M. Ambrose, P.E.

5/31/2007