

# **LIMITED MERCURY SOIL INVESTIGATION**

**July 2003**

**Facility:**

**ONYX RECYCLITE FACILITY  
TALLAHASSEE FACILITY  
342 MARPAN ROAD  
TALLAHASSEE, FLORIDA 32305  
FACILITY ID NUMBER FL0000207449**

**Prepared For:**

**Florida Department of Environmental Protection  
Northwest District  
160 Governmental Center  
Pensacola, Florida 32501-5794**

**and**

**Onyx Special Services, Inc.  
342 Marpan Road  
Tallahassee, Florida 32305**

**Prepared By:**

**American Environmental Associates, Inc.  
Post Office Box 3103  
Tallahassee, Florida 32315-3103  
850-402-1970**

**PROFESSIONAL CERTIFICATION  
FOR  
LIMITED MERCURY SOIL INVESTIGATION**

**ONYX RECYCLITE FACILITY  
TALLAHASSEE FACILITY  
342 MARPAN ROAD  
TALLAHASSEE, FLORIDA 32305  
FACILITY ID NUMBER # FL0000207449**

The Limited Mercury Soil Investigation Report is based solely upon the information made available or gathered by American Environmental Associates, Inc. (AEA). The scope of services, methodology, results, conclusions and recommendations are based upon the requirements of the Florida Department of Environmental Protection (FDEP).

AEA does not assume responsibility for conditions which did not come to knowledge or conditions not recognized as environmentally unacceptable at the time this report was prepared. AEA has performed this investigation in a manner consistent with sound practices and that level of care and skill normally exercised by members of the profession operating under similar circumstances.

This document and the information contained within have been prepared solely for the use of Onyx Special Services, Inc. and the Florida Department of Environmental Protection. The undersigned professional has prepared this report as an employee of American Environmental Associates, Inc.

Signature:



Date:

7/7/03

**Dan Litteral, P.G.  
Florida License No. PG0002995**

**ONYX RECYCLITE FACILITY  
TALLAHASSEE, FLORIDA  
FACILITY ID NUMBER FL0000207449**

## **1.0 INTRODUCTION**

American Environmental Associates, Inc. conducted a limited mercury soil investigation at Onyx Special Services, Inc. – Tallahassee Facility, Tallahassee, Florida. The site is located at latitude 30°21'52" and longitude 84°16'07". The Florida Department of Environmental Protection (FDEP) facility identification number for this facility is Facility ID # FL0000207449. The Onyx Special Services, Inc. – Tallahassee Facility is located at 342 Marpan Lane, Tallahassee, Leon County, Florida.

## **2.0 SITE HISTORY/BACKGROUND**

The facility has served as a fluorescent lamp recycling facility since 1994. The entire facility is approximately one acre in size and is enclosed by a six-foot chain link fence. The site is located in a commercial/light industrial park. The west and north property lines border the National Forest. The east property line borders the public street allowing access into the facility. The south property line borders another commercial building. The site includes office space, warehouse area, processing area, employee areas, exterior storage yard, and a truck loading area.

The facility owner is performing this investigation as the first step in the implementation of a pollution prevention program developed in accordance with consent order OGC File No. 02-1839-37-HW. The southern most portion of the yard has been previously surfaced with concrete. This area serves as the storage location for the glass byproduct storage bins. **Figure 1** illustrates the facility layout including on-site structures such as: buildings, storage areas and other site features.

In May of 2003, Onyx Special Services, Inc. - Tallahassee Facility contracted with American Environmental Associates, Inc. (AEA) to conduct a limited mercury soil investigation. The purpose for the limited mercury soil investigation is to establish the presence or absence of mercury in the exterior storage yard. Investigation activities included sampling soil in areas within the exterior storage yard. American Environmental Associates, Inc. performed all field investigations and sampling activities. This report details all field investigations, sampling methodologies, analytical procedures and conclusions.

## **3.0 FACILITY SAMPLING ACTIVITIES**

On May 29, 2003, AEA began the limited mercury soil investigation at the Onyx Special Services, Inc. - Tallahassee Facility. **Figure 2** illustrates the site layout within the exterior storage yard.

AEA, on May 29, 2003, initiated and completed the collection of thirteen soil samples for laboratory analysis from the surface soil in the exterior storage yard. The borings were placed on a grid system, based on areas of past use. The exterior yard is composed of a loose sandy soil along the fence line and a stabilized backfill/gravel in the center portion of the yard. This loose

**ONYX RECYCLITE FACILITY  
TALLAHASSEE, FLORIDA  
FACILITY ID NUMBER FL0000207449**

sandy soil will not support motorized material handling equipment. As such, the past use of the perimeter areas of the yard have been used on a very limited basis. The perimeter area along the fence is illustrated in Figure 2. Sampling activities were concentrated on the primary areas of use (center portion of yard) and adjacent to the glass byproduct storage bins.

Twelve soil borings (SB) were installed and the corresponding samples collected. Each soil sample collected included soil from land surface (SUR) to a depth of 6 inches. Five soil borings were installed adjacent to the glass byproduct storage bins (SB-1-A thru SB-5-A). Seven soil borings were installed in the stabilized exterior yard (SB-6-A thru SB-11-A). A background sample was collected, SB-12-A, from the adjacent property north of the fence as illustrated on Figure 2. A duplicate sample was split from SB-4-A and logged on the chain of custody as SB-13-A. Soil boring 4 (SB-4) was extended to a total depth of ten feet below land surface. Groundwater was not encountered during the installation of SB-4. The soil characteristics in SB-4 consisted of a coarse to fine sand material.

The samples were collected with a stainless steel hand auger. All sampling equipment was decontaminated between samples. Samples were analyzed for mercury (EPA Method 7471A). Laboratory soil samples were collected in accordance with AEA's approved Comprehensive Quality Assurance Plan, preserved per the Environmental Protection Agency/Florida Department of Environmental methods and shipped to IntraNet Lab Services, LLLP in Tallahassee, Florida for analysis. A copy of the analytical results have been included in Appendix A.

**Table I** summarizes the laboratory analytical results for the soil samples collected during the site activities. Figure 2 illustrates where the soil borings were installed and the corresponding laboratory sample were collected. Soil borings 3, 4, 5 and 6 each exhibited mercury levels above the laboratory detection limit, but below the Soil Cleanup Target Levels (SCTLs) for residential exposure. The SCTL for residential exposure for mercury is 3.4 mg/kg. All remaining samples were below the laboratory detection limit.

#### **4.0 SUMMARY and CONCLUSIONS**

During the limited mercury soil investigation, four soil borings exhibited low levels of mercury in the laboratory analytical soil samples. Groundwater was not encountered to a depth of ten feet below land surface during AEA's investigation at the facility. Laboratory analysis indicated that all analytical laboratory samples were less than the state established SCTLs for residential exposure.

After reviewing the data collected, it is the considered opinion of AEA that impacts greater than SCTL target limits has not occurred at the facility.

## FIGURES



NATIONAL FOREST

PROPERTY LINE (FENCE)

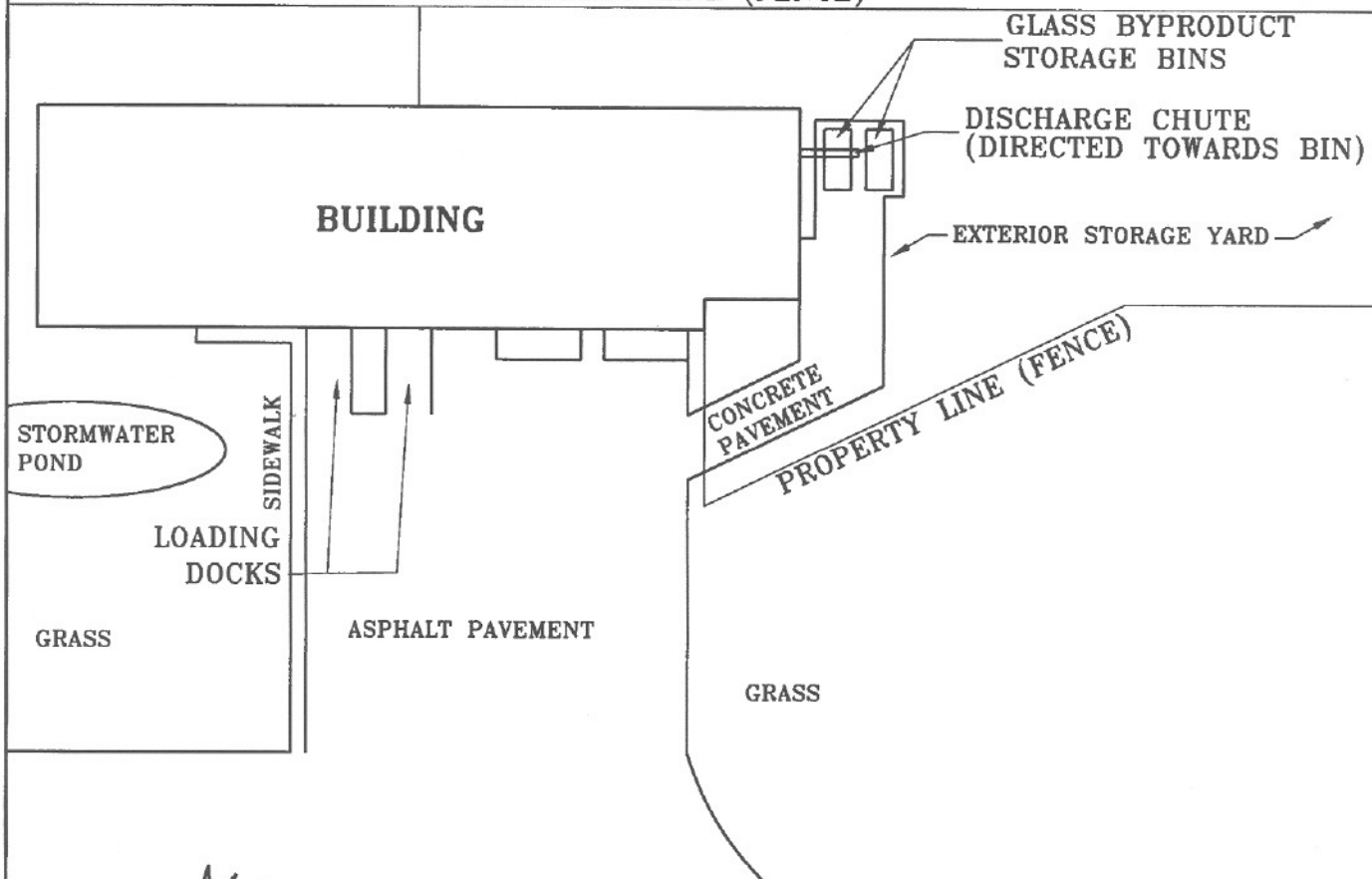

MARPAN LANE

1" = 50'  
25 0 50

**AEA**

AMERICAN ENVIRONMENTAL ASSOCIATES, INC.  
MELBOURNE & TALLAHASSEE, FLORIDA

FIGURE 1

JULY 2003

**SITE DIAGRAM**

ONYX SPECIAL SERVICES, INC.  
342 MARPAN LANE  
TALLAHASSEE, FLORIDA

LIMITED MERCURY SOIL INVESTIGATION  
FDEP FACILITY ID NO. 0000207449

SCALE 1" = 50'

DRAWN BY CEB

SHEET 1 OF 2



# NATIONAL FOREST - PLANTED PINES

GLASS BYPRODUCT  
STORAGE BINS  
PROPERTY LINE (FENCE)

SANDY SOIL THAT WILL NOT  
SUPPORT MOTORIZED MATERIAL  
HANDLING EQUIPMENT

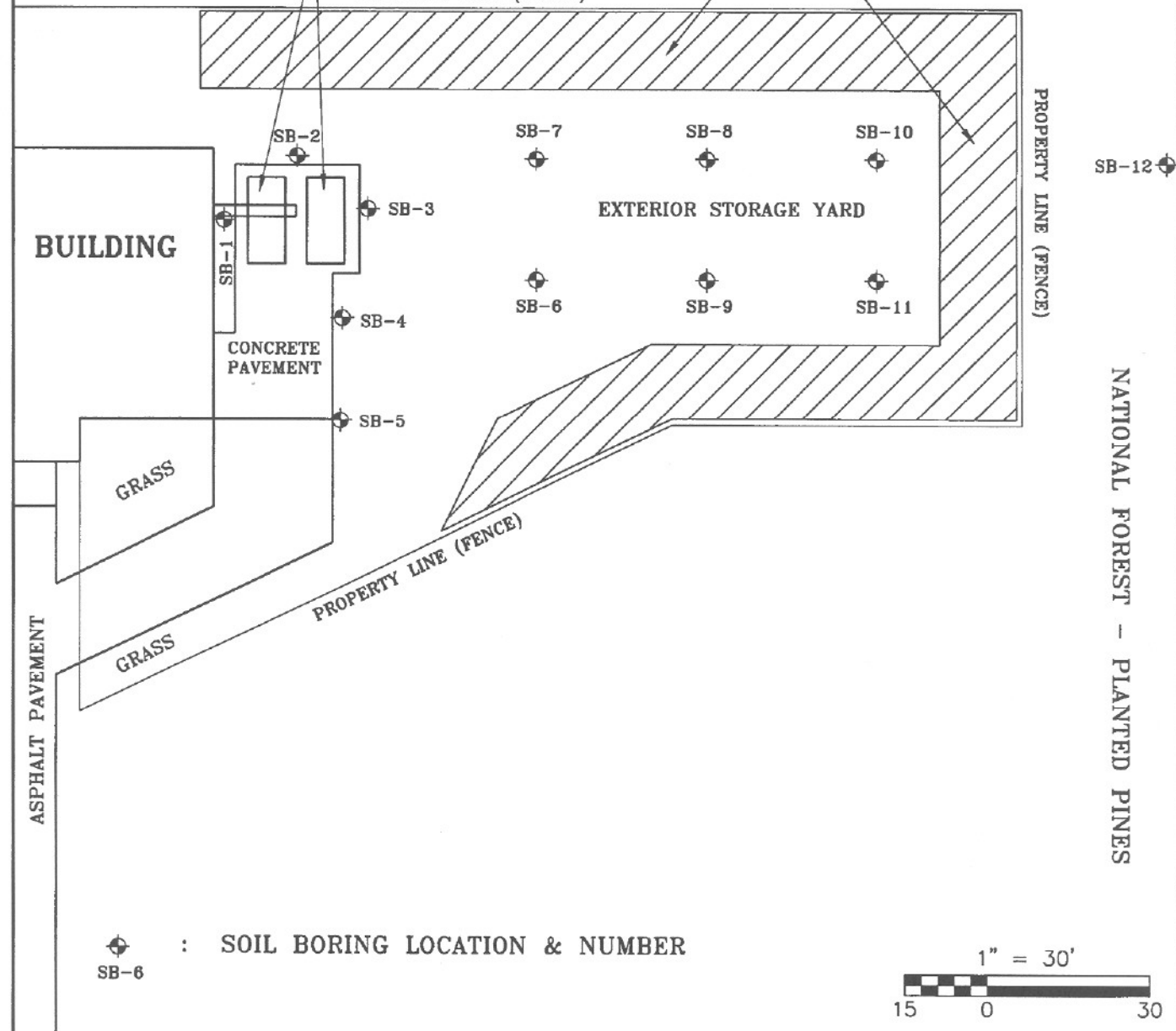

**AEA**  
AMERICAN ENVIRONMENTAL ASSOCIATES, INC.  
MELBOURNE & TALLAHASSEE, FLORIDA

## SOIL BORING LOCATIONS

ONYX SPECIAL SERVICES, INC.  
342 MARPAN LANE  
TALLAHASSEE, FLORIDA

FIGURE 2

LIMITED MERCURY SOIL INVESTIGATION  
FDEP FACILITY ID NO. 0000207449

JULY 2003

SCALE 1" = 30'

DRAWN BY CEB

SHEET 2 OF 2

## TABLE



FACILITY:  
Onyx Special Services, Inc.  
342 Marpan Road  
Tallahassee, Florida

TABLE I  
SOIL SAMPLING ANALYTICAL SUMMARY

Sample			Laboratory Analysis							
Location Collected	Date Collected	Sample Interval (fbls)	Mercury (ppm)							
SB-1-A	5/29/2003	SUR-6"	<0.100							
SB-2-A	5/29/2003	SUR-6"	<0.100							
SB-3-A	5/29/2003	SUR-6"	0.502							
SB-4-A	5/29/2003	SUR-6"	0.103							
SB-5-A	5/29/2003	SUR-6"	0.101							
SB-6-A	5/29/2003	SUR-6"	0.244							
SB-7-A	5/29/2003	SUR-6"	<0.100							
SB-8-A	5/29/2003	SUR-6"	<0.100							
SB-9-A	5/29/2003	SUR-6"	<0.100							
SB-10-A	5/29/2003	SUR-6"	<0.100							
SB-11-A	5/29/2003	SUR-6"	<0.100							
SB-12-A	5/29/2003	SUR-6"	<0.100							
SB-13-A (Dup of SB-4-A)	5/29/2003	SUR-6"	0.199							

**APPENDIX A**

**ANALYTICAL RESULTS  
for  
LABORATORY ANALYTICAL SAMPLES  
(Soil Collected On May 29, 2003)**

**INTRANET LAB SERVICES, LLLP**

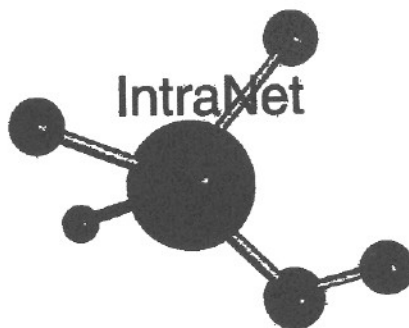

IntraNet

Lab Services, LLLP

Chris Brockmeier  
American Env. Assoc.  
PO 3103

Tallahassee, FL 32315

Page 1  
June 5, 2003  
Report # 305001529  
Order # 46123  
FDEP CompQAP# 990102  
FL-DOH Certification# E86349, 86413  
Alabama Cert ID# 41180

Site Location/Project

Onyx

Sample I.D.: SB-1-A  
Collected: 05/29/03 08:30  
Received: 05/30/03 10:00  
Collected by: Client

PARAMETER	RESULT	UNITS	METHOD	DETECTION LIMIT-RQL	DATE EXT.	DATE ANALY.	ANALYST
Percent Solids	93.9	%	160.3(ASTM-D2216	0.10	05/31/2003	06/02/2003	IV/RA
Mercury (Cold Vapor AA)	BDL	mg/Kg	7471A	0.100	05/30/2003	06/01/2003	MG

REPORT COMMENTS:

BDL: Indicates Analyte is Below Detection Limit MEDF: Matrix Effect Dilution Factor  
Unless otherwise noted, mg/Kg denotes wet weight

Unless otherwise noted in analyst section, all work performed by STL Miami  
10200 USA Today Way, Miramar Florida 33025. (954) 431-4550 (Alabama Cert ID# 41180)  
(Florida HRS Cert#: E86349,86413)

  
Project Manager

Chris Brockmeier  
American Env. Assoc.  
PO 3103

Tallahassee, FL 32315

Site Location/Project

Onyx

Page 2  
June 5, 2003  
Report # 305001529  
Order # 46124  
FDEP CompQAP# 990102  
FL-DOH Certification# E86349, 86413  
Alabama Cert ID# 41180

Sample I.D.: SB-2-A  
Collected: 05/29/03 08:35  
Received: 05/30/03 10:00  
Collected by: Client

PARAMETER	RESULT	UNITS	METHOD	DETECTION LIMIT-RQL	DATE EXT.	DATE ANALY.	ANALYST
Percent Solids	94.8	%	160.3(ASTM-D2216	0.10	05/31/2003	06/02/2003	IV/RA
Mercury (Cold Vapor AA)	BDL	mg/Kg	7471A	0.100	05/30/2003	06/01/2003	NG

**REPORT COMMENTS:**

BDL: Indicates Analyte is Below Detection Limit MEDF: Matrix Effect Dilution Factor  
Unless otherwise noted, mg/Kg denotes wet weight

Unless otherwise noted in analyst section, all work performed by STL Miami  
10200 USA Today Way, Miramar Florida 33025. (954) 431-4550 (Alabama Cert ID# 41180)  
(Florida HRS Cert#: E86349,86413)

  
Project Manager

Chris Brockmeier  
American Env. Assoc.  
PO 3103

Tallahassee, FL 32315

Site Location/Project

Onyx

Page 3  
June 5, 2003  
Report # 305001529  
Order # 46125  
FDEP CompQAP# 990102  
FL-DOH Certification# E86349, 86413  
Alabama Cert ID# 41180

Sample I.D.: SB-3-A  
Collected: 05/29/03 08:40  
Received: 05/30/03 10:00  
Collected by: Client

PARAMETER	RESULT	UNITS	METHOD	DETECTION LIMIT-RQL	DATE EXT.	DATE ANALY.	ANALYST
Percent Solids	85.6	%	160.3(ASTM-D2216	0.10	05/31/2003	06/02/2003	IV/RA
Mercury (Cold Vapor AA)	0.502	mg/Kg	7471A	0.100	05/30/2003	06/01/2003	MG

**REPORT COMMENTS:**

BDL: Indicates Analyte is Below Detection Limit MEDF: Matrix Effect Dilution Factor  
Unless otherwise noted, mg/Kg denotes wet weight

Unless otherwise noted in analyst section, all work performed by STL Miami  
10200 USA Today Way, Miramar Florida 33025. (954) 431-4550 (Alabama Cert ID# 41180)  
(Florida HRS Cert#: E86349,86413)

  
Project Manager

Chris Brockmeier  
American Env. Assoc.  
PO 3103

Tallahassee, FL 32315

Page 4  
June 5, 2003  
Report # 305001529  
Order # 46126  
FDEP CompQAP# 990102  
FL-DOH Certification# E86349, 86413  
Alabama Cert ID# 41180

Site Location/Project

Onyx

Sample I.D.: SB-4-A  
Collected: 05/29/03 08:47  
Received: 05/30/03 10:00  
Collected by: Client

PARAMETER	RESULT	UNITS	METHOD	DETECTION LIMIT-RQL	DATE EXT.	DATE ANALY.	ANALYST
Percent Solids	88.7	%	160.3(ASTM-D2216	0.10	06/04/2003	06/05/2003	EP
Mercury (Cold Vapor AA)	0.103	mg/Kg	7471A	0.100	05/30/2003	06/01/2003	MG

REPORT COMMENTS:

BDL: Indicates Analyte is Below Detection Limit MEDF: Matrix Effect Dilution Factor

Unless otherwise noted, mg/Kg denotes wet weight

Unless otherwise noted in analyst section, all work performed by STL Miami  
10200 USA Today Way, Miramar Florida 33025. (954) 431-4550 (Alabama Cert ID# 41180)  
(Florida HRS Cert#: E86349,86413)

  
Project Manager

Chris Brockmeier  
American Env. Assoc.  
PO 3103

Tallahassee, FL 32315

Site Location/Project  
Onyx

Page 5  
June 5, 2003  
Report # 305001529  
Order # 46127  
FDEP CompQAP# 990102  
FL-DOH Certification# E86349, 86413  
Alabama Cert ID# 41180

Sample I.D.: SB-5-A  
Collected: 05/29/03 08:55  
Received: 05/30/03 10:00  
Collected by: Client

PARAMETER	RESULT	UNITS	METHOD	DETECTION LIMIT-RQL	DATE EXT.	DATE ANALY.	ANALYST
Percent Solids	93.2	%	160.3(ASTM-D2216	0.10	06/04/2003	06/05/2003	EP
Mercury (Cold Vapor AA)	0.101	mg/Kg	7471A	0.100	05/30/2003	06/01/2003	MG

**REPORT COMMENTS:**

BDL: Indicates Analyte is Below Detection Limit MEDF: Matrix Effected Dilution Factor  
Unless otherwise noted, mg/Kg denotes wet weight

Unless otherwise noted in analyst section, all work performed by STL Miami  
10200 USA Today Way, Miramar Florida 33025. (954) 431-4550 (Alabama Cert ID# 41180)  
(Florida HRS Cert#: E86349,86413)

  
Project Manager

Chris Brockmeier  
American Env. Assoc.  
PO 3103

Tallahassee, FL 32315

Page 6  
June 5, 2003  
Report # 305001529  
Order # 46128  
FDEP CompQAP# 990102  
FL-DOH Certification# E86349, 86413  
Alabama Cert ID# 41180

Site Location/Project  
Onyx

Sample I.D.: SB-6-A  
Collected: 05/29/03 09:00  
Received: 05/30/03 10:00  
Collected by: Client

PARAMETER	RESULT	UNITS	METHOD	DETECTION LIMIT-RQL	DATE EXT.	DATE ANALY.	ANALYST
Percent Solids	90.2	%	160.3(ASTM-D2216	0.10	06/04/2003	06/05/2003	EP
Mercury (Cold Vapor AA)	0.244	mg/Kg	7471A	0.100	05/30/2003	06/01/2003	MG

**REPORT COMMENTS:**

BDL: Indicates Analyte is Below Detection Limit MEDF: Matrix Effect Dilution Factor  
Unless otherwise noted, mg/Kg denotes wet weight

Unless otherwise noted in analyst section, all work performed by STL Miami  
10200 USA Today Way, Miramar Florida 33025. (954) 431-4550 (Alabama Cert ID# 41180)  
(Florida HRS Cert#: E86349,86413)

  
Project Manager



Chris Brockmeier  
American Env. Assoc.  
PO 3103

Tallahassee, FL 32315

Page 7  
June 5, 2003  
Report # 305001529  
Order # 46129  
FDEP CompQAP# 990102  
FL-DOH Certification# E86349, 86413  
Alabama Cert ID# 41180

Site Location/Project

Onyx

Sample I.D.: SB-7-A  
Collected: 05/29/03 09:07  
Received: 05/30/03 10:00  
Collected by: Client

PARAMETER	RESULT	UNITS	METHOD	DETECTION LIMIT-RQL	DATE EXT.	DATE ANALY.	ANALYST
Percent Solids	89.6	%	160.3(ASTM-D2216	0.10	06/04/2003	06/05/2003	EP
Mercury (Cold Vapor AA)	BDL	mg/Kg	7471A	0.100	05/30/2003	06/01/2003	MG

REPORT COMMENTS:

BDL: Indicates Analyte is Below Detection Limit MEDF: Matrix Effect Dilution Factor  
Unless otherwise noted, mg/Kg denotes wet weight

Unless otherwise noted in analyst section, all work performed by STL Miami  
10200 USA Today Way, Miramar Florida 33025. (954) 431-4550 (Alabama Cert ID# 41180)  
(Florida HRS Cert#: E86349,86413)

  
Project Manager

Chris Brockmeier  
American Env. Assoc.  
PO 3103

Tallahassee, FL 32315

Site Location/Project

Onyx

Page 8  
June 5, 2003  
Report # 305001529  
Order # 46130  
FDEP CompQAP# 990102  
FL-DOH Certification# E86349, 86413  
Alabama Cert ID# 41180

Sample I.D.: SB-8-A  
Collected: 05/29/03 09:15  
Received: 05/30/03 10:00  
Collected by: Client

PARAMETER	RESULT	UNITS	METHOD	DETECTION LIMIT-RQL	DATE EXT.	DATE ANALY.	ANALYST
Percent Solids	92.5	%	160.3(ASTM-D2216	0.10	06/04/2003	06/05/2003	EP
Mercury (Cold Vapor AA)	BDL	mg/Kg	7471A	0.100	05/30/2003	06/01/2003	MG

**REPORT COMMENTS:**

BDL: Indicates Analyte is Below Detection Limit MEDF: Matrix Effect Dilution Factor  
Unless otherwise noted, mg/Kg denotes wet weight

Unless otherwise noted in analyst section, all work performed by STL Miami  
10200 USA Today Way, Miramar Florida 33025. (954) 431-4550 (Alabama Cert ID# 41180)  
(Florida HRS Cert#: E86349,86413)

  
Project Manager

Chris Brockmeier  
American Env. Assoc.  
PO 3103

Tallahassee, FL 32315

Page 9  
June 5, 2003  
Report # 305001529  
Order # 46131  
FDEP CompQAP# 990102  
FL-DOH Certification# E86349, 86413  
Alabama Cert ID# 41180

Site Location/Project  
Onyx

Sample I.D.: SB-9-A  
Collected: 05/29/03 09:20  
Received: 05/30/03 10:00  
Collected by: Client

PARAMETER	RESULT	UNITS	METHOD	DETECTION LIMIT-RQL	DATE EXT.	DATE ANALY.	ANALYST
Percent Solids	89.1	%	160.3(ASTM-D2216	0.10	06/04/2003	06/05/2003	EP
Mercury (Cold Vapor AA)	BDL	mg/Kg	7471A	0.100	05/30/2003	06/01/2003	MG

**REPORT COMMENTS:**

BDL: Indicates Analyte is Below Detection Limit MEDF: Matrix Effect Dilution Factor

Unless otherwise noted, mg/Kg denotes wet weight

Unless otherwise noted in analyst section, all work performed by STL Miami  
10200 USA Today Way, Miramar Florida 33025. (954) 431-4550 (Alabama Cert ID# 41180)  
(Florida HRS Cert#: E86349,86413)

  
Project Manager

Chris Brockmeier  
American Env. Assoc.  
PO 3103

Tallahassee, FL 32315

Page 10  
June 5, 2003  
Report # 305001529  
Order # 46132  
FDEP CompQAP# 990102  
FL-DOH Certification# E86349, 86413  
Alabama Cert ID# 41180

Site Location/Project

Onyx

Sample I.D.: SB-10-A  
Collected: 05/29/03 09:30  
Received: 05/30/03 10:00  
Collected by: Client

PARAMETER	RESULT	UNITS	METHOD	DETECTION LIMIT-RQL	DATE EXT.	DATE ANALY.	ANALYST
Percent Solids	90.5	%	160.3(ASTM-D2216	0.10	06/04/2003	06/05/2003	EP
Mercury (Cold Vapor AA)	BDL	mg/Kg	7471A	0.100	05/30/2003	06/01/2003	MG

REPORT COMMENTS:

BDL: Indicates Analyte is Below Detection Limit MEDF: Matrix Effect Dilution Factor

Unless otherwise noted, mg/Kg denotes wet weight

Unless otherwise noted in analyst section, all work performed by STL Miami  
10200 USA Today Way, Miramar Florida 33025. (954) 431-4550 (Alabama Cert ID# 41180)  
(Florida HRS Cert#: E86349, 86413)

  
Project Manager

Chris Brockmeier  
American Env. Assoc.  
PO 3103

Tallahassee, FL 32315

Page 11  
June 5, 2003  
Report # 305001529  
Order # 46133  
FDEP CompQAP# 990102  
FL-DOH Certification# E86349, 86413  
Alabama Cert ID# 41180

Site Location/Project

Onyx

Sample I.D.: SB-11-A  
Collected: 05/29/03 09:45  
Received: 05/30/03 10:00  
Collected by: Client

PARAMETER	RESULT	UNITS	METHOD	DETECTION LIMIT-RQL	DATE EXT.	DATE ANALY.	ANALYST
Percent Solids	89.6	%	160.3(ASTM-D2216	0.10	06/04/2003	06/05/2003	EP
Mercury (Cold Vapor AA)	BDL	mg/Kg	7471A	0.100	05/30/2003	06/01/2003	MG

REPORT COMMENTS:

BDL: Indicates Analyte is Below Detection Limit MEDF: Matrix Effect Dilution Factor  
Unless otherwise noted, mg/Kg denotes wet weight

Unless otherwise noted in analyst section, all work performed by STL Miami  
10200 USA Today Way, Miramar Florida 33025. (954) 431-4550 (Alabama Cert ID# 41180)  
(Florida HRS Cert#: E86349,86413)

  
Project Manager

Chris Brockmeier  
American Env. Assoc.  
PO 3103

Tallahassee, FL 32315

Page 12  
June 5, 2003  
Report # 305001529  
Order # 46134  
FDEP CompQAP# 990102  
FL-DOH Certification# E86349, 86413  
Alabama Cert ID# 41180

Site Location/Project

Onyx

Sample I.D.: SB-12-A  
Collected: 05/29/03 09:55  
Received: 05/30/03 10:00  
Collected by: Client

PARAMETER	RESULT	UNITS	METHOD	DETECTION LIMIT-RQL	DATE EXT.	DATE ANALY.	ANALYST
Percent Solids	91.7	%	160.3(ASTM-D2216	0.10	06/04/2003	06/05/2003	EP
Mercury (Cold Vapor AA)	BDL	mg/Kg	7471A	0.100	05/30/2003	06/01/2003	MG

**REPORT COMMENTS:**

BDL: Indicates Analyte is Below Detection Limit MEDF: Matrix Effect Dilution Factor

Unless otherwise noted, mg/Kg denotes wet weight

Unless otherwise noted in analyst section, all work performed by STL Miami

10200 USA Today Way, Miramar Florida 33025. (954) 431-4550 (Alabama Cert ID# 41180)

(Florida HRS Cert#: E86349,86413)

  
Project Manager

Chris Brockmeier  
American Env. Assoc.  
PO 3103

Tallahassee, FL 32315

Page 13  
June 5, 2003  
Report # 305001529  
Order # 46135  
FDEP CompQAP# 990102  
FL-DOH Certification# E86349, 86413  
Alabama Cert ID# 41180

Site Location/Project

Onyx

Sample I.D.: SB-13-A  
Collected: 05/29/03 10:05  
Received: 05/30/03 10:00  
Collected by: Client

PARAMETER	RESULT	UNITS	METHOD	DETECTION LIMIT-RQL	DATE EXT.	DATE ANALY.	ANALYST
Percent Solids	95.7	%	160.3(ASTM-D2216	0.10	06/04/2003	06/05/2003	EP
Mercury (Cold Vapor AA)	0.199	mg/Kg	7471A	0.100	05/30/2003	06/01/2003	MG

REPORT COMMENTS:

BDL: Indicates Analyte is Below Detection Limit MEDF: Matrix Effect Dilution Factor

Unless otherwise noted, mg/Kg denotes wet weight

Unless otherwise noted in analyst section, all work performed by STL Miami  
10200 USA Today Way, Miramar Florida 33025. (954) 431-4550 (Alabama Cert ID# 41180)  
(Florida HRS Cert#: E86349, 86413)

  
Project Manager

SUB# 03/05-1529

ord# 46123-46135

Page 1 of 2

## IntraNet Lab Services, LLLP

## Chain of Custody Record

Modified from DEP Form # 62-770.900(2)

## IntraNet Lab Services, LLLP

Address: 1690 Raymond Diehl Road, Suite B-3  
Tallahassee, FL 32308

Phone: (850) 385-9400

Fax: (850) 385-2468

Company Name American Environmental Association

## LAB ANALYSIS

Address P.O. Box 3103

Preservatives (see codes)

City Tallahassee State FL Zip 32315-3103Project Name OnyxProject Manager Chris Brackmeier

FDEP Facility No.:

Sampling CompQAP No.:

Approval Date:

Matrix Codes:

GW Groundwater

S Soil

SE Sediment

A Air

SW Surface Water

W Water (Blanks)

O Other (specify)

Preservative Codes:

H Hydrochloric + ice

I Ice Only

N Nitric Acid + ice

S Sulfuric Acid + ice

O Other (specify)

Item # Field ID No. Date Collected Time Collected Matrix (see codes) # of Cont.

PARAMETER

Mercury

Sub or Composite

COMMENTS/NOTES

SB-1-A

5/29/03

8:30

S

1

A

X

46123

SB-2-A

5/29/03

8:35

S

1

X

46124

SB-3-A

5/29/03

8:40

S

1

X

46125

SB-4-A

5/29/03

8:47

S

1

X

46126

SB-5-A

5/29/03

8:55

S

1

X

46127

SB-6-A

5/29/03

9:00

S

1

X

46128

SB-7-A

5/29/03

9:07

S

1

X

46129

SB-8-A

5/29/03

9:15

S

1

X

46130

SB-9-A

5/29/03

9:20

S

1

X

46131

SB-10-A

5/29/03

9:30

S

1

X

46132

Total Number of Containers

10

Sampling Kit No.

Equipment ID No.

Turnaround Time Request

X Standard

Rush

Date Required

Samples Recd.  
on Ice?

Yes No

Temp. °C

Cooler No.(s)/Temp (°C)

Sampled By [print name(s)]/Affiliation:

Item No. Relinquished by/Affiliation:

Date/Time

Sampler(s) Signature:

Received by/Affiliation:

Date/Time

Kit Box, Don O'Neil, ILS

5/28/03 08:48

Don O'Neil 5/28/03 11:45

10:03

Don O'Neil, ILS

5/29/03 3:03

Don O'Neil / ILS

5-29-03 15:03

FedEx

5-29-03 15:15

FedEx

5-30-03 10:00

Additional Comments:

DO NOT DISPOSE OF SAMPLE MATERIAL WHEN COMPOSITE.  
DEPENDENCY ON RESULTS MAY HAVE TO RUN TELB.



Page 2 of 2[illegible]