

ATTACHMENT NO. 4

LOCATION OF ACTIVITY

ATTACHMENT NO. 4 LOCATION OF ACTIVITY

The proposed Lido Key Hurricane and Storm Damage Reduction Project will be located on Lido Key on the west coast of Florida within the City of Sarasota in Sarasota County. Lido Key is about 45 miles south of downtown Tampa and 20 miles southeast of the mouth of Tampa Bay. Lido Key is a 2.6 mile long barrier island bordered by New Pass to the north and Big Sarasota Pass to the south. New Pass separates Lido Key from Longboat Key to the north and Big Sarasota Pass separates Lido Key from Siesta Key to the south.

Along the central and southern 1.6 miles of Lido Key, sediment from the channel and ebb shoal of Big Sarasota Pass will be placed between FDEP R-monuments R-34.5 and R-44. Also, a groin field is proposed to be constructed at the south end of the project between R-42 and R-44. Coordinates for the project limits, R-34, R-35 and R-44 are provided below. Northing and easting values for R-35 to R-44 are updated and maintained by the Florida Department of Environmental Protection. These values are in State Plane Coordinate System, Florida East Zone, 901, National American Datum of 1983 (NAD 83). These coordinates were converted into Geographic Coordinates (NAD 83) as shown below. Attachment No. 4a provides a USGS quadrangle map which identifies the location of the project area.

Control Monument	Latitude	Longitude	Northing	Easting
R-34	27.31963	-82.5835	1085805.9	466700.4
R-35	27.31738	-82.5818	1084982.2	467260.1
R-44	27.29899	-82.5672	1078276.3	471971.6
R-39+ 192 (Center of Project)	27.3082	-82.5742	1081636.2	469697.8

ATTACHMENT NO. 4a
USGS LOCATION MAP

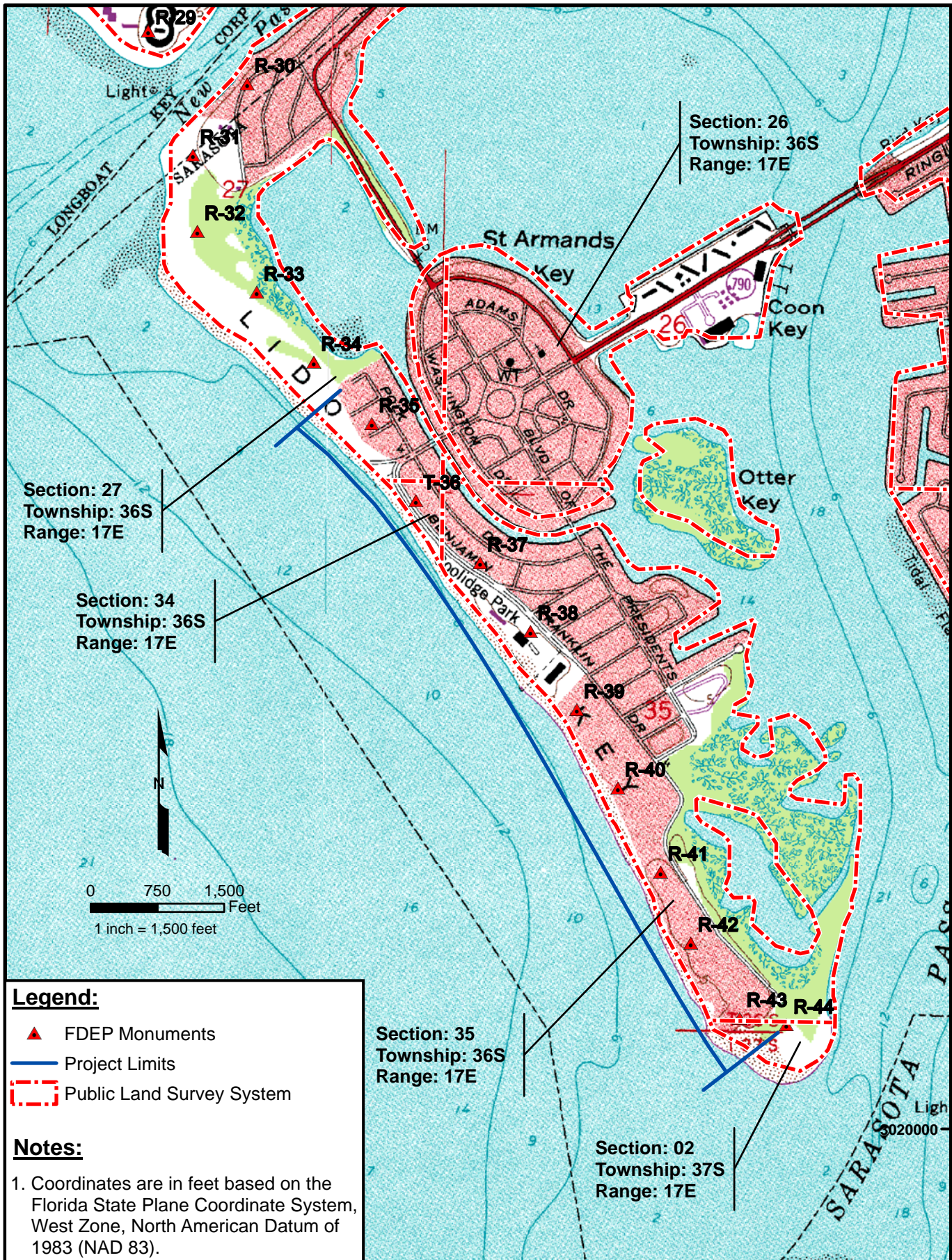

Attachment # 4 - Quad Map
Lido Key, Sarasota County
Florida Hurricane and Storm Damage Reduction Project

TITLE:

CB&I
Coastal Planning & Engineering, Inc.
Ph: (561) 391-8102
Fax: (561) 391-9116
2481 N. W. Boca Raton Boulevard
Boca Raton, FL 33431
C.O.A. FL #4028

DATE:
02/19/2015

BY:
ALS

COMM NO.:
150252

SHEET:
Att 4

NOT FOR CONSTRUCTION
FOR REGULATORY REVIEW ONLY

REVISIONS		
DATE	BY	DESCRIPTION