

Before the Florida Department of Environmental Regulation

FLORIDA TIRE RECYCLING, INC.

WASTE TIRE FACILITY PERMIT APPLICATIONS AND RELATED FILINGS

Table of Contents

Waste Tire General Permit Notification
Waste Tire Processing Facility Permit Application (5 years)
Waste Tire Collector Registration Application (copy)
Exhibit A -- Site Plan for Facility
Exhibit B -- Letter dated December 15, 1988, from St. Lucie County-Fort Pierce Fire District (copy)
Exhibit C -- Emergency Preparedness Manual
Exhibit D -- Section Map Showing Land Use and Zoning
Exhibit E -- Resolution No. 87-278 of Board of County Commissioners of of St. Lucie County, Florida
Exhibit F -- Solid Waste Volume Reduction Facility Data Form
Exhibit G -- Closure Plan
Exhibit H -- Estimate of Cost of Closure and Proof of Financial Responsibility
Exhibit I -- Letter notification to St. Lucie County-Fort Pierce Fire District (copy)

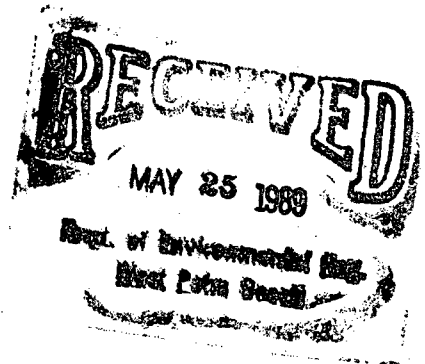



Florida Department of Environmental Regulation
Twin Towers Office Bldg. • 2600 Blair Stone Road • Tallahassee, Florida 32399-2400

WT 56-165345

RECEIVED

MAY 25 1989

DER Form # 17-711.900(6)
Form Title <u>Waste Tire Processing Facility Permit Ap</u>
Effective Date <u>February 22, 1988</u>
DER Application No. _____ (Filed in by DER)

Waste Tire Processing Facility Permit Application

West Palm Beach

WT 62

1. Facility information:

Facility name: FLORIDA TIRE RECYCLING, INC.
Street address (main entrance): 10151 Range Line Road
City Port St. Lucie County St. Lucie Zip Florida 34987
Mailing address: Same as above
City _____ State _____ Zip _____
Telephone number: (407) 465-0477
Location: Section 1 , Township 37 South , Range 38 East
Latitude 27°15'22" North , Longitude 80°29'00" West

2. Application type (check appropriate box):

- ☐ Proposed new facility.
☒ Existing unpermitted facility.
☐ Renewal of permitted facility. Permit number _____
☐ Modification of permitted facility. Permit number _____
☐ Other. Explain _____

3. Facility type (check appropriate box):

- ☒ Waste tire processing facility.
☐ Waste tire processing facility with on-site disposal of processed tires or processing residuals.
☐ Permitted solid waste management facility modification to allow waste tire site and processing.

4. Property owner information:

Owner's name: TRINITY HOLDING COMPANY, INC.
Owner's mailing address: 10151 Range Line Road
City Port St. Lucie State Florida Zip 34987
Owner's telephone number: (407) 465-0477
Ownership type (check appropriate box): ☐ Individual ☐ Partnership ☒ Corporation ☐ Government
☐ Other, explain _____

DER Form # 17-711.900(6)
Form Title <u>Waste Tire Processing Facility Permit Ap.</u>
Effective Date <u>February 22, 1989</u>
DER Application No _____ (Filed in by DER)

5. Facility operator information (if different from owner):

Operator's name: FLORIDA TIRE RECYCLING, INC.

Operator's mailing address: See response to question 1

City _____ State _____ Zip _____

Operator's telephone number: (_____) _____

Operator's type (check appropriate box): ☐ Individual ☐ Partnership ☐ Corporation ☐ Government

☐ Other, explain _____

6. Preparer of application:

Name of person preparing application: John J. Wilson

Mailing address: See response to question 1

City _____ State _____ Zip _____

Telephone: (_____) _____

Affiliation with facility: Officer and Director, Florida Tire Recycling, Inc.

7. Type of processing facility (check as many as apply):

☒ Shredder ☒ Cutter ☐ Chopper ☐ Incinerator only ☐ Incinerator with energy recovery ☐ Pyrolysis

☐ Other, explain _____

8. Required attachments: See attached addendum

Please include the following information items in the application or give an explanation, if they are not applicable.

A. Facility design.

NOTE: All maps, plan sheets, drawings, isometrics, cross sections, or aerial photographs shall be legible; be signed and sealed by a registered professional engineer responsible for their preparation; be of appropriate scale to show clearly all required details; be numbered, referenced to narrative, titled, have a legend of symbols used, contain horizontal and vertical scales (where applicable), and specify drafting or origination dates; and use uniform scales as much as possible, contain a north arrow and use NGVD for all elevations.

- ✓1) A topographic or section map of the facility, including the surrounding area for one mile, no more than one year old, showing land use and zoning within one mile of the facility.
- ✓2) Evidence that the facility is in conformance with local zoning.
- 3) A plot plan of the facility on a scale of not less than one inch equals 200 feet. At a minimum, the plot plan shall include:
 - ✓a) The facility design, including the location and size of all storage and processing areas for waste tires, processed tires, and residuals from processing;
 - ✓b) All wetlands and water bodies;
 - ✓c) Stormwater control measures, including ditches, dikes and other structures;
 - ✓d) Legal boundaries, easements and rights of way;
 - ✓e) Location of all wells, operating and abandoned;
 - ✓f) All structures and buildings that are or will be constructed at the facility; include those used in storage and processing operations;
 - ✓g) All areas used for loading and unloading;
 - ✓h) All access roads and internal roads, including fire lanes;
 - ✓i) Location of all fences, gates, and other access control measures; and
 - ✓j) Location of all processed tire or residual disposal areas.

DER Form 17-711.500(6)
Form Title <u>Waste Tire Processing Facility Permit /p</u>
Effective Date <u>February 22, 1989</u>
DER Application No _____ (Filed in by DER)

4) A completed application to construct a resource recovery and management facility for any disposal areas (DER Form 17-7.130(1), 12/10/85) must be submitted along with this application, if processed tires or processing residuals will be disposed of at the facility and the facility is not currently permitted as a solid waste management facility.

5) A completed solid waste volume reduction facility data form (DER Form 17-7.130(1), 12/10/85).

B. Facility Operation.

1) Description of the facility's operation, including how waste tires and processed tires will be collected, stored and processed.

2) Description of how each of storage requirements of Rule 17-711.540, F.A.C., will be met.

3) Copy of the emergency preparedness manual for the facility.

4) Copy of the fire safety survey.

5) Description of how 75% of the annual accumulation of waste tires and processed tires will be processed and removed for disposal or recycling.

C. Completed closure plan for the facility as required by Rule 17-711.700(2) and (3), F.A.C.

D. Attach proof of financial responsibility as required by Rule 17-711.510(2), F.A.C.

E. Attach permit fee required pursuant to Rule 17-141, F.A.C.

9. Indicate the quantities of waste tires and processed tires, expressed in tons, stored at the facility:

	Current Storage (tons)	Storage Area (sq. ft.)	Maximum Storage (tons)
Waste tires	-0-	-0-	-0-
Processed tires	500	25,000	2,500
TOTALS	500	25,000	2,500

10. Facilities that will not be disposing of processed tires or processing residual on the facility site must indicate the permitted solid waste management facility where processed tires or residuals will be disposed.

Name of facility See response to question 8.B.(5)

Street address _____

City _____

County _____

Zip _____

11. Facilities that will be delivering processed tires to a recycling facility must describe the existing or proposed markets for processed tires.

See response to question 8.B.(5)

DER Form # 17-711.900(6)
Form Title <u>Waste Tire Processing Facility Permit Ap.</u>
Effective Date <u>February 22, 1989</u>
DER Application No _____ (Filed in by DER)

12. Certification:

A. Applicant.

The undersigned applicant or authorized representative of FLORIDA TIRE RECYCLING, INC.
is aware that statements made in this form and attached information are an application for a waste tire processing facility.

Permit from the Florida Department of Environmental Regulation and certifies that the information in this application is true, correct and complete to the best of his knowledge and belief. Further, the undersigned agrees to comply with the provisions of Chapter 403, Florida Statutes, and all rules and regulations of the Department. It is understood that the permit is not transferable, and the Department will be notified prior to the sale or legal transfer of the facility.

This application is for a five-year processing facility permit.

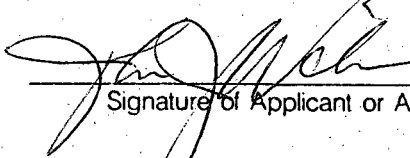

Signature of Applicant or Agent

John J. Wilson, Secretary-Treasurer

Name and Title

5/23/89

Date

Attach letter of authorization if agent is not a governmental official, owner or corporate officer.

B. Professional Engineer registered in Florida. See attached addendum.

This is to certify that the engineering features of this waste tire processing facility have been designed/examined by me and found to conform to engineering principals applicable to such facilities. In my professional judgement, this facility, when properly maintained and operated will comply with all applicable statutes of the State of Florida and rules of the Department. It is agreed that the undersigned will provide the applicant with a set of instructions for proper maintenance and operation of the facility.

Signature

Mailing address

Name and title

City, State, Zip

Florida Registration Number

Telephone number

(Please affix seal)

Mail completed form to
appropriate district office
listed on page 1.

EXHIBIT

C

FLORIDA TIRE RECYCLING, INC.
10151 Range Line Road
Port St. Lucie, Florida 34987
(407) 465-0477

[St. Lucie County: Section 1, Township 37 South, Range 38 East
Latitude 27°14'22" North, Longitude 80°29'00" West]

EMERGENCY PREPAREDNESS MANUAL

FLORIDA TIRE RECYCLING, INC.,
EMERGENCY PREPAREDNESS MANUAL

INDEX

	<u>Page</u>
Persons to Notify in Event of Fire or Other Emergency	1
Types of Emergency	2
Procedure to Follow for Fire	3

PERSONS TO NOTIFY IN EVENT OF FIRE OR OTHER EMERGENCY

<u>Name</u>	<u>Phone</u>
Andrew J. Brennan, President	225-2613
John J. Wilson, Secretary-Treasurer	283-4722
Walter Ploskonka, General Manager	220-3298
St. Lucie County Sheriff	911
Fort Pierce-St. Lucie County Fire Department	911
St. Lucie County Emergency Management Office	911

TYPES OF EMERGENCY

?
The primary emergency of special concern at the Florida Tire Recycling facility is fire, in particular a fire involving one or more of the shredded (processed) tire storage areas located on the rear (western portion) of the site.

The following features of the facility are important in the event of fire:

Shredded (processed) tires are stored in individual storage areas each of which is no greater than 50 feet wide, 10,000 square feet in total area, and 15 feet high.

An unobstructed 50-foot wide fire lane surrounds each shredded (processed) tire storage area.

The project includes a 25,000 gallon on-site water storage tank with a fire department connector. The fire department periodically tests this equipment.

On-site machinery includes a bucket loader and tractor, which may be needed to fight a shredded (processed) tire storage area fire.

Remember: once the Fire Department has arrived, the Fire Marshal is in charge. Employees should stand by to provide assistance if requested by the Fire Marshal, but must not interfere with Fire Department efforts.

PROCEDURE TO FOLLOW FOR FIRE

1. If fire cannot be extinguished immediately:

REMOVE CUSTOMERS and nonessential employees from vicinity of fire.

2. CALL FIRE DEPARTMENT: Dial 911

Tell them to respond to:

10151 Range Line Road, Port St. Lucie

and give approximate location on site.

3. SPREAD ALARM LOCALLY: Notify all employees on job site.

4. FIGHT THE FIRE:

By using fire extinguishers, moving equipment (for shredded tire material), and other means IF THIS CAN BE DONE SAFELY until arrival of Fire Department.

5. When Fire Department arrives:

FIRE MARSHAL IS IN CHARGE OF EVERYTHING.

Employees should stand by to provide assistance if requested by the Fire Marshal.

COOPERATE BUT DO NOT INTERFERE.

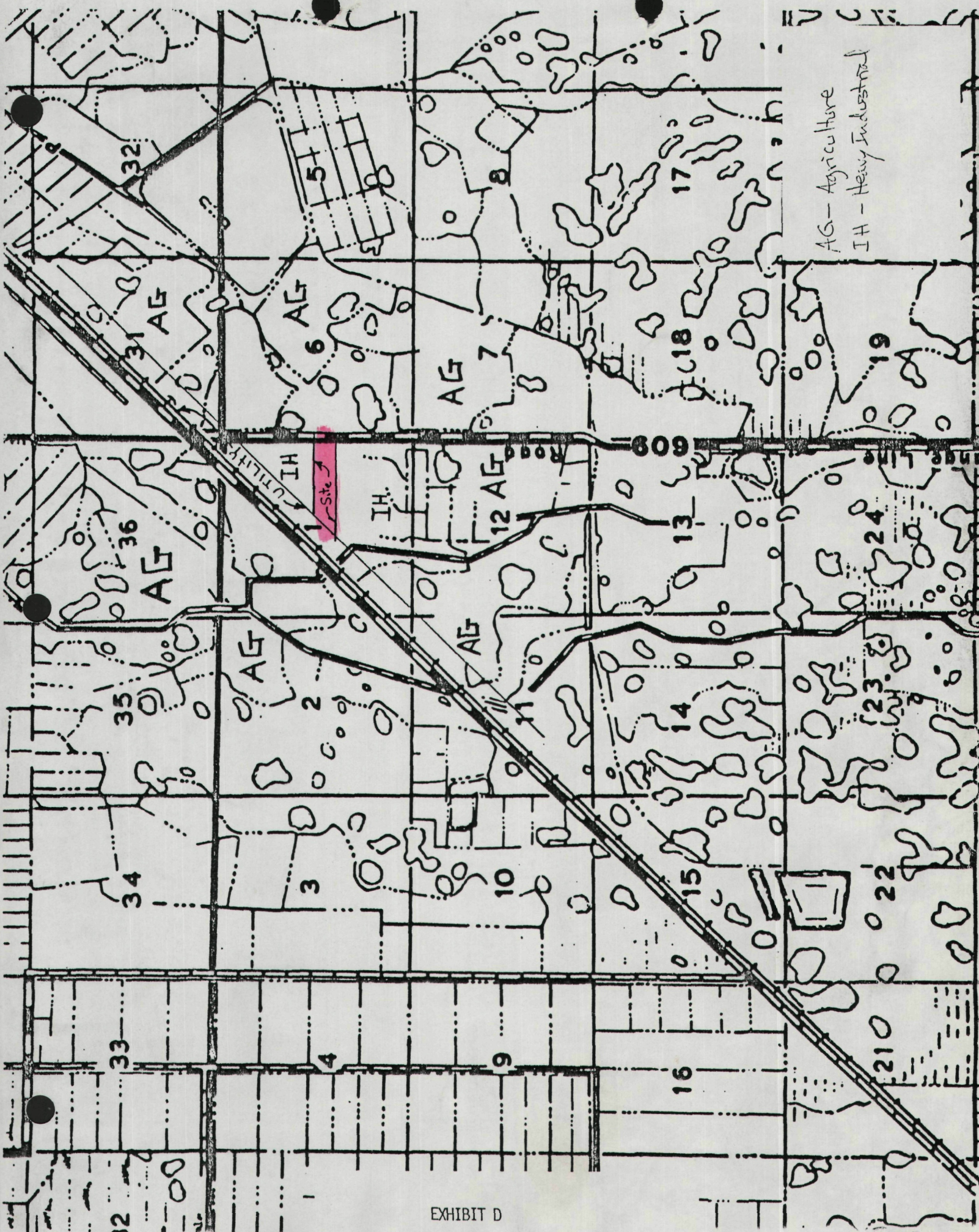

AG - Agriculture
IH - Heavy Industrial

RESOLUTION NO. 87-278

A RESOLUTION GRANTING SITE PLAN
APPROVAL FOR A PROJECT KNOWN
AS FLORIDA TIRE RECYCLING INC.

WHEREAS, the Board of County Commissioners of St. Lucie County, Florida, has made the following determinations:

1. A 6,000 s.f. tire recycling/reuse project has been proposed for location on Range Line Road, which project is to be known as Florida Tire Recycling, Inc.
2. The Site Plan Technical Review Committee has reviewed the site plan for the proposed project and has found it to meet all technical requirements, and to be consistent with both the existing zoning and the future land use maps from the St. Lucie County Growth Management Policy Plan.
3. The proposed project does not require the preparation of a traffic impact report.
4. The proposed project is consistent with the general purpose, goals, objectives, and standards of the St. Lucie County Zoning Ordinance, the St. Lucie County Growth Management Policy Plan, and the Code of Ordinances of St. Lucie County.
5. The proposed project will not have an undue adverse effect on adjacent property, the character of the neighborhood, traffic conditions, parking, utility facilities, or other matters affecting the public health, safety and general welfare.

18, 1987, last revised December 8, 1987, and date stamped received by the St. Lucie County Community Development Director on December 11, 1987.

B. This site plan shall expire on December 22, 1988, unless a building permit is issued or a site plan approval extension granted in accordance with Section 5.1.300(9), St. Lucie County Zoning Ordinance.

C. The conditions set forth in Section A are an integral and nonseverable part of the site plan approval granted by this resolution. If any condition set forth in Section A is determined to be invalid or unenforceable for any reason and the developer declines to comply voluntarily with that condition, the site plan approval granted by this resolution shall become null and void.

D. This approval is of a conceptual site plan and shall become final upon submission of detailed building and landscape plans. Such plans shall comply with all applicable County ordinances, regulations, and requirements.

E. A copy of this resolution shall be attached to the site plan drawings described in Section A, which plan shall on file with the St. Lucie County Community Development Director.

After motion and second, the vote on this resolution was as follows:

Chairman Jack Krieger

AYE

Vice-Chairman Havert Fenn	AYE
Commissioner R. Dale Trefelner	AYE
Commissioner Jim Minix	AYE
Commissioner Judy Culpepper	ABSENT

PASSED AND DULY ADOPTED this 22nd day of December 1987

BOARD OF COUNTY COMMISSIONERS
ST. LUCIE COUNTY, FLORIDA

BY

CHAIRMAN

ATTEST:

CLERK

APPROVED AS TO FORM AND
CORRECTNESS:

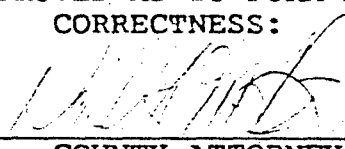
COUNTY ATTORNEY

866741

'88 JAN -4 P12:38

FILED AND RECORDED
DOUGLAS D. [unclear]
ST. LUCIE COUNTY

O. R. BOOK 570 PAGE 1103

EXHIBIT F

SOLID WASTE VOLUME REDUCTION AND
RESOURCE RECOVERY FACILITY DATA FORM

Permit No.: _____ Issue Date: _____ Expires: _____

Facility No. (DER Identification): _____

DER ACTION: ☐ Add ☐ Delete ☐ Change ☐ Deactivate Site ☐ Other

1. County St. Lucie		2. Site Name FLORIDA TIRE RECYCLING, INC.	
3. Date Form Completed		4. Facility Address 10151 Range Line Road Port St. Lucie, FL 34987	
4a. Facility Phone No. (407) 465-0477		4b. Facility Site Supervisor John J. Wilson	
5a. 27° 15' 22" N 80° 29' 00" W Latitude Longitude		5b. 37. South 38 East 1 Township Range Section	
6. Operating Authority Name FLORIDA TIRE RECYCLING, INC.		8. Operating Authority Address See responses to question 4	
7. Phone Number (407) 465-0477			
9. Owner of Site Property (if different from Operator) TRINITY HOLDING COMPANY, INC.		11. Address of Owner 10151 Range Line Road Port St. Lucie, FL 34987	
10. Phone Number of Owner (407) 465-0477			
12. Facility Type (check one or more) <input type="checkbox"/> Incinerator Only <input type="checkbox"/> Biomass Gas Production <input type="checkbox"/> Pyrolysis <input checked="" type="checkbox"/> Other: Waste tire processing facility <input type="checkbox"/> Sludge Concentration <input type="checkbox"/> Baler (compactor) <input type="checkbox"/> Composting Plant <input type="checkbox"/> Transfer Station <input type="checkbox"/> Waterwall Incinerator <input type="checkbox"/> Shredder (pulverizer)			
13. Month/Year Begun 9/88		14. Disposal Area None Acres	
15. Population Served Florida			
16. Expected Useful Lifetime 40 Years		17. Weighing Scales <input checked="" type="checkbox"/> Yes <input type="checkbox"/> No	
18. Waste Processed Per Operational Day 50 tons/day		19. Charge/ \$55/ton	
20. Days Operated Mon. through Sat. S M T W T F S		21. Hours/Day Operated 8:00 a.m.-5:00 p.m.	
22. Maximum Processing Rate 150 tons/day			
23. Material Recovered, Tons/Week Paper _____ Glass _____ Other: 100 (reusable tire casings recycled & processed tires refabricated into rubber products) Ferrous Metals _____ Non-Ferrous Metals _____ Aluminum _____ Plastics _____			
24. Energy Recovery, in units shown Does not apply. High Pressure Steam-lb/hr _____ Chilled Water-gal/hr _____ Gas-ft ³ /hr Low Pressure Steam-lb/hr _____ Oil-gal/hr _____ Gas-BTU/hr Electricity-kw/hr _____ Oil-BTU/hr _____ Other:			
25. Process Water Recycled <input type="checkbox"/> Yes <input checked="" type="checkbox"/> No		Treatment Method Used Does not apply	
Discharged to: Does not apply <input type="checkbox"/> Surface Waters <input type="checkbox"/> Underground		Class: Receiving Water	
26. Final Residue is DNA % of waste intake		Residue is disposed of at (Site Name) Does not apply	
27. Supplementary Fuel Used Does not apply Type Does not apply Quantity Used/Hour Does not apply			
28. Estimated Operating Costs Material - Energy Revenue \$ DNA		Total Cost/Ton \$ DNA Net Cost/Ton \$ DNA	
29. Number of Staff 20		30. State Pollution Control Bond Financing Amount \$ DNA	
31. Estimated Amount of Tax Exemptions that will be Requested \$ DNA			
32. Name and Title of Person Completing Form John J. Wilson, Secretary-Treasurer			

Note: All blanks must be filled or marked as not applicable.

ADDENDUM TO WASTE TIRE PROCESSING FACILITY PERMIT APPLICATION

8. Required Attachments:

A. Facility Design

- (1) A topographic or section map of the facility, including the surrounding area for one mile, no more than one year old, showing land use and zoning within one mile of the facility, is attached as Exhibit D.
- (2) The facility is in conformance with local zoning regulations, as demonstrated by Resolution No. 87-278 of the Board of County Commissioners of St. Lucie County, Florida, granting site plan approval for the facility (copy attached as Exhibit E).
- (3) A copy of the approved site plan for the facility is attached as Exhibit A.
- (4) Neither processed tires nor processing residuals will be disposed of at the facility.
- (5) A completed Solid Waste Volume Reduction Facility Data Form, DER form 17-7.130(1), is attached as Exhibit F.

B. Facility Operation.

- (1) A description of the facility's operation, including how waste tires and processed tires will be collected, stored, processed, and removed from the site, is set forth in response to question 6 of the Waste Tire General Permit Notification form.
- (2) A description of how each of the storage requirements of Fla. Admin. Code Rule 17-711.540 will be met is set forth in the response to question 7 of the Waste Tire General Permit Notification form.
- (3) A copy of the Emergency Preparedness Manual for the facility is attached as Exhibit C.
- (4) A copy of the letter from the St. Lucie County-Fort Pierce Fire District indicating compliance with the local fire code is attached as Exhibit B.
- (5) Approximately 33 percent of the volume of waste tires received (i) is comprised of reusable casings that are separated for transshipment to retreading facilities or (ii) is converted into various patented rubber products and equipment through refabrication processes. The balance of the volume is shredded, and the shredded material stored on-site temporarily before transshipment for overseas delivery as tire-derived fuel. A portion of the shredded material may be transported intermittently to permitted landfills for use as daily cover.

C.

A completed Closure Plan for the facility as required by Fla. Admin. Code Rule 17-711.700(2) and (3) is attached as Exhibit G.

D.

The applicant's estimate of the cost of closure of the facility and proof of financial responsibility as required by Fla. Admin. Code Rule 17-711.510(2) is attached as Exhibit H.

E.

The permit fee required by Fla. Admin. Code Rule 17-141 is attached.

* * *

12. B. Certification of Professional Engineer

This is to certify that the engineering features of this waste tire processing facility, as set forth on the site plan that is attached as Exhibit A, have been designed by me and found to conform to engineering principles applicable to such facilities. In my professional judgment, this facility, when properly maintained and operated, will comply with all applicable statutes of the State of Florida and Rules of the Florida Department of Environmental Regulation.

(SEAL)

CULPEPPER & TERPENING, INC.

By:

J. P. TERPENING, P.E.
Registered Professional Engineer
Florida Registration No. 24276
805 Virginia Avenue, Suite 15
Fort Pierce, FL 34982
(407) 464-3537

5/29/89

EXHIBIT G

CLOSURE PLAN FOR FLORIDA TIRE RECYCLING, INC., WASTE TIRE PROCESSING FACILITY

In accordance with Fla. Admin. Code Rule 17-711.700(2) and (3), Florida Tire Recycling, Inc., provides the following Closure Plan for its facility located at 10151 Range Line Road, Port St. Lucie, Florida:

The Florida Tire Recycling waste tire processing facility is not a permanent disposal site for any material but rather is a processing and transshipment establishment for waste tires, with final disposition of manufactured, recycled, and reprocessed tires being off-site. A description of the facility's operation, including how waste tires and processed tires will be collected, stored, processed, and removed from the site, is set forth in response to question 6 of the Waste Tire General Permit Notification Form.

At the time the applicant's facility is to be closed, the applicant shall:

- ✓ (a) Stop public access to the site.
- ✓ (b) Post a notice indicating that the site is closed and the location of the nearest site where waste tires can be deposited.
- ✓ (c) Notify the Florida Department of Environmental Regulation and the Board of County Commissioners of St. Lucie County of the closing.
- ✓ (d) Remove whole waste tires to retreading facilities.
- ✓ (e) Remove processed tires for shipment to overseas locations for use as tire-derived fuel, or to permitted landfills for use as daily cover.
- ✓ (f) Clean and scrape the stabilized areas used for above ground processed tire storage areas to remove all processed tire materials.
- ✓ (g) Accomplish all notice, removal, and other closure activities within 90 days of ceasing operation.

The applicant's facility generates no waste tire residuals or solid waste (except processed tires, the removal of which is provided for above). The applicant's estimate of the cost of closure of the facility and proof of financial

responsibility as required by Fla. Admin. Code Rule 17-711.510(2) is attached as Exhibit H.

FLORIDA TIRE RECYCLING, INC.

EXHIBIT H

ESTIMATE OF COST OF CLOSURE AND PROOF OF FINANCIAL RESPONSIBILITY

In accordance with Fla. Admin. Code Rule 17-711.510(2), Florida Tire Recycling, Inc., provides the following estimate of cost of closure of its facility located at 10151 Range Line Road, Port St. Lucie, Florida, and proof of financial responsibility to accomplish such closure:

Estimate of Cost of Closure

Posting notice of closure and alternate disposal site	\$ 250.00
Notifying Florida Department of Environmental Regulation and Board of County Commissioners of St. Lucie County of closure	100.00
Removing whole waste tires to retreading facilities	-0-
Removing processed tires for shipment to overseas locations for use as tire-derived fuel, or to permitted landfills for use as daily cover, 2,500 tons at \$3/ton	7,500.00
Clean and scrape stabilized areas used for above ground processed tire storage areas	2,000.00
Miscellaneous expenses, contingency	<u>5,000.00</u>
TOTAL	\$14,850.00

Proof of financial responsibility to accomplish closure, in the form of a performance bond issued in favor of the State of Florida in the amount of the estimate of cost of closure, is attached.

R.V. JOHNSON
Real Estate — Insurance

May 15, 1989

Mr. Jack Wilson
FLORIDA TIRE RECYCLING, INC.
10151 Range Line Road
Port St. Lucie, FL 34987

Re: CLOSURE BOND FOR STATE OF FLORIDA

Dear Jack:

Per our many recent phone conversations and your meetings with Rudy Johnson concerning the Bond that State is currently requiring from you, here is where we are at:

OHIO CASUALTY INSURANCE COMPANY, who also provides you with another bond, has advised us that they need to have the Bond Form to review before they can issue any bond.

It is not exactly clear how they want the bond to read. Ohio Casualty does not want to stick their neck out and provide a bond form that could be totally wrong in providing what the State wants.

Since you already have a bond with Ohio Casualty, they have your financial information for both Commercial and Personal on file. As far as this goes you are approved in this area.

Ohio Casualty has been sent all the information you provided us with and now all they need is the State's Bond form before they can make their final determination. Basically, if the form the State comes up with is similar in content to the Jacksonville bond form we write, there shouldn't really be a problem. At this time no one is sure just how the State wants the bond form to read.

We will just have our file inactive until we hear further from you. Please do not hesitate to call with any questions you have.

Yours truly,
R.V. JOHNSON AGENCY

Cynthia Bartels
(Mrs.) Cynthia Bartels

[Sample - Bond to be provided upon approval of form]

PERFORMANCE BOND

WE, FLORIDA TIRE RECYCLING, INC., as principal, and _____
_____, as surety, are bound to the State of Florida in the
sum of Fifteen Thousand and No/100s Dollars (\$15,000.00) for the payment of which
we bind ourselves, our successor and assigns, jointly and severally.

THE CONDITION OF THIS BOND is that if the principal shall complete the
Closure Plan for its facility located at 10151 Range Line Road, Port St. Lucie,
Florida, as set forth in the attached Exhibit G, then this bond is void;
otherwise it shall remain in force.

SIGNED AND SEALED on _____, 1989.

PRINCIPAL;

FLORIDA TIRE RECYCLING, INC.

By: _____
John J. Wilson, Secretary-Treasurer

SURETY:

By: _____
As Attorney in Fact

904/
FAX 487-4938



Florida Tire Recycling, Inc.

May 23, 1989

Chief John T. Harris
Fire Marshal
Fort Pierce-St. Lucie
County Fire District
2400 Rhode Island Avenue
Fort Pierce, FL 34950

Re: Florida Tire Recycling, Inc.

Tire recycling and process storage facility, 10151 Range Line Road,
Port St. Lucie, Florida 34897

Dear Chief Harris:

In accordance with Fla. Admin. Code Ch. 17-711, this is to provide formal notification to you that Florida Tire Recycling, Inc., operates a tire recycling and processed tire storage facility at the above address in St. Lucie County, Florida. Enclosed for your records is a copy of the site plan, indicating the location of on-site water storage and clear zones for fire and emergency access, and the emergency preparedness manual for the facility.

Sincerely,

John J. Wilson
Secretary-Treasurer

JJW/

cc: Fire Station 11
3501 Shinn Road
Fort Pierce, FL 34945

St. Lucie County Emergency
Management Office

EXHIBIT I

10151 Range Line Road • Port St. Lucie, Florida 34987 • (407) 465-0477



Florida Department of Environmental Regulation

Twin Towers Office Bldg. • 2000 Brian Stone Road • Tallahassee, Florida 32399-2400

DER Form # 17-711 (0001)
Form for Waste Tire Collector Registration Application
Effective Date February 22, 1998
DER Application No. _____ (Filed in by DER)

Waste Tire Collector Registration Application

Pursuant to Rule 17-711.520, Florida Administrative Code, to obtain a waste tire collector registration number and approval to transport waste tires, a collector shall submit the following information on this form to the Department.

- Business name of collector: FLORIDA TIRE RECYCLING, INC.
- Other business names of collector (DBA's): None
- Mailing address of collector: 10151 Range Line Road
City Port St. Lucie State FL Zip 34987
- Street address of collector: Same as above
City _____ County _____ Zip _____
- Telephone number of collector: (407) 465-0477
- Federal Employer Identification (FEID) number of Collector: 59-2801031
- Counties to be served: All Florida counties
- List all known sites where you will be depositing waste tires or processed tires for disposal or recycling (attach additional sheets if necessary):

Name	Address	County
<u>Florida Tire Recycling</u>	<u>Same as above</u>	

- Number of vehicles to be used: _____
- Please submit the following information for each vehicle you will use to transport waste tires or processed tires. If you are using more than one vehicle, you may attach additional sheets to this form that provide the required information for each vehicle. See attached addendum.
 - Description of vehicle: _____
 - License number of vehicle: _____
 - Department of Motor Vehicle registration number: _____
 - Name of registered vehicle owner (if the vehicle is owned by a business entity, include the names and addresses of the officers or owners of that entity): _____
 - The Public Service Commission authority number under which each vehicle is registered: _____
- Waste tire collector registration status: New ☒ Renewal ☐
If registration is a renewal, list previous registration number(s): _____

DER Form 17-711(9001)	
Form Fee: Waste Tire Collector Registration Application	
Effective Date:	February 22, 1989
DER Application No.	(Filed in by DER)

12. Attach payment for registration fees pursuant to Rule 17-711.500, F.A.C.

Fleet registration: ☒ Yes ☐ No

Note: Fleet registrant fees are \$25 per vehicle registered up to a maximum of \$250. If more than 10 decals are requested, include \$10 for each additional decal requested.

a. Number of vehicles 7 x \$25 = \$ 175
b. Number of additional decals requested x \$10 = \$
c. Total of lines a and b \$ 175

13. Certification:

To the best of my knowledge and belief, I certify the information provided in this application is true, accurate, and correct.

John J. Wilson, Secretary-Treasurer
Name of Authorized Agent

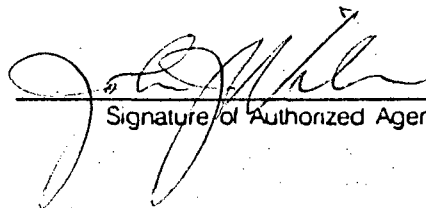
Signature of Authorized Agent

5/23/89
Date

Mail completed form to:
Florida Department of Environmental Regulation
Solid Waste Section
Attention: Tires
2600 Blair Stone Road
Tallahassee, Florida 32399-2400

ADDENDUM TO WASTE TIRE COLLECTOR REGISTRATION APPLICATION

10. Vehicle Information:

- (1) a. Description: 1976 GM Astro Tractor
b. License No.: AA34704
c. DMV Registration No.: TDC926V598641
d. Owner: Florida Tire Recycling, Inc.
e. Public Service Commission Authority No.: Does not apply
- (2) a. Description: 1981 GMC Astro Tractor
b. License No.: I1804B
c. DMV Registration No. 1GDP9LIC6BV5566597
d. Owner: Florida Tire Recycling, Inc.
e. Public Service Commission Authority No.: Does not apply
- (3) a. Description: 1982 GM Astro Tractor
b. License No.: I1788B
c. DMV Registration No.: 1GDP9LIC5CV590066
d. Owner: Florida Tire Recycling, Inc.
e. Public Service Commission Authority No.: Does not apply
- (4) a. Description: 1983 GMC Astro Tractor
b. License No.: I804B
c. DMV Registration No.: 1GDM9LIC1DV500058
d. Owner: Florida Tire Recycling, Inc.
e. Public Service Commission Authority No.: Does not apply
- (5) a. Description: 1984 GMC Astro Tractor
b. License No.: I1787B
c. DMV Registration No.: 1GDM9LIC9EV523346
d. Owner: Florida Tire Recycling, Inc.
e. Public Service Commission Authority No.: Does not apply

- (6)
 - a. Description: 1988 Ford F-150 Pickup Truck
 - b. License No.: CPR81I
 - c. DMV Registration No.: 1FTDF15Y0JNB04609
 - d. Owner: Florida Tire Recycling, Inc.
 - e. Public Service Commission Authority No.: Does not apply
- (7)
 - a. Description: 1989 GMC 2500 Pickup Truck
 - b. License No.: AJB766
 - c. DMV Registration No.: 1GTFC24KXKE506160
 - d. Owner: Florida Tire Recycling, Inc.
 - e. Public Service Commission Authority No.: Does not apply