

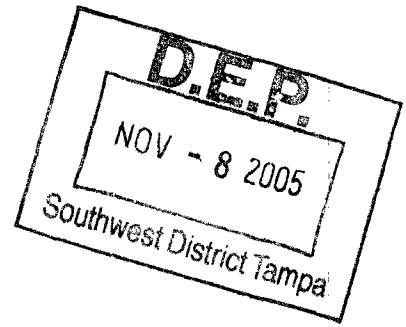

An employee-owned company



November 7, 2005

Susan J. Pelz, P.E.  
Solid Waste Manager  
Southwest District  
3804 Coconut Palm Drive  
Tampa, Florida 33619

RE: Lena Road Landfill, Manatee County  
Landfill Operation Permit No.: 39884-010-SO-SO/01

Dear Ms Pelz:

PBS&J is submitting this letter on behalf of Manatee County as required by the above referenced landfill operation permit.

#### Annual Aerial Photograph and Topography

As required by Landfill Operation Permit Specific Condition D.1.e, enclosed with this letter are four copies of the annual aerial photograph dated July 26, 2005, a topographic map of the Stage I Landfill based on this aerial photograph, and a topographic map of the Stage III Landfill. This topographic map shows that the overall exterior landfill side slopes are no greater than 5H:1V, and the Stage I Landfill at El. 132.4 is less than the permitted design peak elevation of 136. The aerial photograph and topographic landfill show that the other design features and related improvements conform to the Department-approved Permit Renewal Drawings and other supporting information.

#### Certification of Construction Completion

Attached to the Stage III Landfill topographic map is the certification of construction completion related to the excavation of soil from the landfill foundation prior to placing solid waste. The area for the certification is highlighted in yellow on the topographic map, and can be described as the area north of the old landfill access road between the road and the northern slurry wall. The design depth of excavation was limited to no deeper than El. 29. The topographic survey shows that the excavation is no deeper than El. 30. Upon completion of the replacement of the leachate collection system along the northern slurry wall, Manatee County plans to proceed with filling this area with solid waste. Filling may start as early as December 15, 2005, or be delayed until after January 1, 2006. FDEP is requested to inspect this area December 1, 2006, but the inspection can be scheduled at the convenience of your office.

Remaining Landfill Life Calculation

The Lena Road Landfill estimated solid waste design capacity is 32.6 million cubic yards. From the landfill topography based on the July 26, 2005 aerial photograph, it is estimated that 14.6 million cubic yards of landfill capacity has been consumed, and there is a remaining capacity of 18.0 million cubic yards. At an average annual filling rate of 500,000 cubic yards per year as measured between 1991 and 2005, the landfill has a remaining life of 36 years or will be full in the year 2041. The landfill remaining capacity by stages is summarized below:

<u>Landfill Stage</u>	<u>Design Capacity</u>	<u>Remaining Capacity</u>	<u>Remaining Life</u>
I	13.2 million C.Y.	0	0
II	12.7 million C.Y.	12.7 million C.Y.	25.4 years
III	6.8 million C.Y.	5.3 million C.Y.	10.6 years
Totals	32.6 million C.Y.	18.0 million C.Y.	36 years

Financial Assurance Cost Estimate Update

Enclosed with this letter are four copies of the Financial Assurance Cost Estimate Form updated for 2005 using a 2% inflation factor, which by Landfill Operation Permit Specific Condition D.3.a is due by March 1, 2006.

Sincerely,

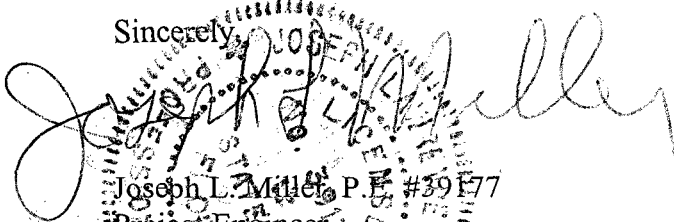

Joseph L. Miller, P.E. #39177  
Project Engineer

Cc: Gus DiFonzo, Manatee County w/ 2 copies  
File 120498.34

U:\OldGWASTEMAN\Manatee County\SW-34 Renew Lena Operation Permit\Application\Landfill Life Ltr to FDEP Nov 7 '05.doc

List of Attachments

- Aerial Photograph Dated July 26, 2005
- Stage I Landfill Topography based on July 26, 2005 Aerial Photograph
- Stage III Landfill Topography based on July 26, 2005 Aerial Photograph
- Certificate of Construction Completion
- Financial Assurance Cost Estimate Update dated November 3, 2005

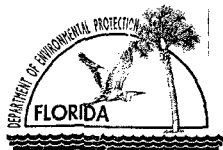

Florida Department of Environmental Protection  
Twin Towers Office Bldg. • 2600 Blair Stone Road • Tallahassee, FL 32399-2400

DEP Form # 62-701.900(2)  
Form Title Certification of Construction Completion  
Effective Date May 19, 1994  
DEP Application No. \_\_\_\_\_  
(Filed by DEP)

Certification of Construction Completion of a  
Solid Waste Management Facility

NOV 08 2005  
SOUTHWEST DISTRICT

DEP Construction Permit No: 39884-010-SO/01 County: Manatee

Name of Project: Stage III Landfill excavation of soil prior to waste filling.

Name of Owner: Manatee County

Name of Engineer: PBS&J, 482 South Keller Road, Orlando, FL. 32810 Attn: Joe Miller (407-647-7275)

Type of Project: Class I Landfill - This certification applies to the excavation of soil to El. 29 from the foundation of the Stage III Landfill in an area between the access road and the slurry wall.

Cost: Estimate \$ Not Applicable Actual \$ Not applicable

Site Design: Quantity: 1,200 ton/day Site Acreage: 316 Acres

Deviations from Plans and Application Approved by DEP: \_\_\_\_\_

The area of this certification is highlighted in yellow on the attached topographic map prepared from an aerial photograph dated July 26, 2005, and shows the excavation is above the design El. 29. The excavation lies on the north side of the Stage III Landfill between the old landfill access road and the existing slurry wall.

Address and Telephone No. of Site: 3333 Lena Road, Bradenton, FL 34202

Telephone # 941/748-5543

Name(s) of Site Supervisor: Mike Gore (Cell phone # 941-812-45310)

Date Site inspection is requested: December 1, 2005

This is to certify that, with the exception of any deviation noted above, the construction of the project has been completed in substantial accordance with the plans authorized by Construction

Permit No. 39884-010-SO/01 : Dated: June 13, 2005

Date: Nov. 7, 2005

*Joseph L. Miller*  
Signature of Professional Engineer  
Joseph L. Miller, P.E. #39177  
STATE OF FLORIDA

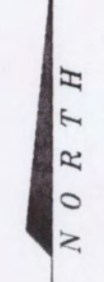

  
 0 50 100 200
   
 GRAPHIC SCALE
   
 SCALE: 1" = 100'

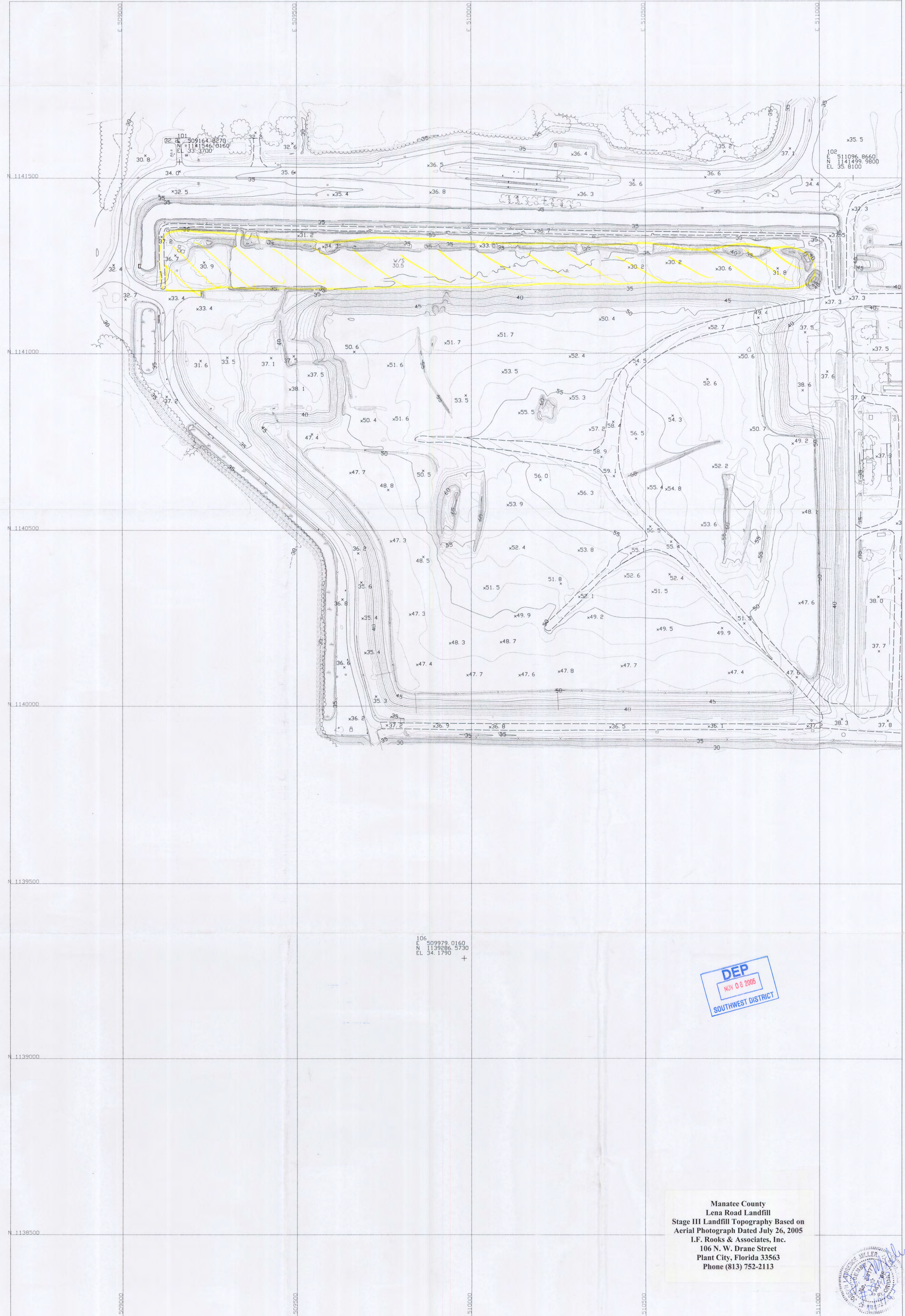

**DEP**
  
 NOV 08 2006
   
 SOUTHWEST DISTRICT

Manatee County
   
 Lena Road Landfill
   
 Stage III Landfill Topography Based on
   
 Aerial Photograph Dated July 26, 2005
   
 I.F. Rooks & Associates, Inc.
   
 106 N. W. Drane Street
   
 Plant City, Florida 33563
   
 Phone (813) 752-2113





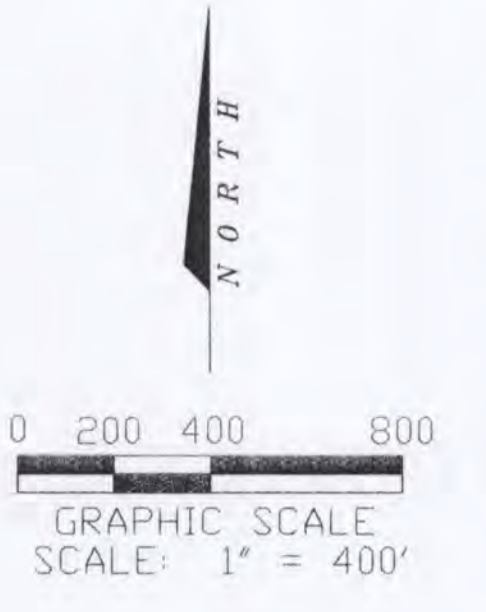

DEP  
NOV 08 2005  
SOUTHWEST DISTRICT

Manatee County  
Lena Road Landfill  
Aerial Photograph Dated July 26, 2005  
I.F. Rooks & Associates, Inc.  
106 N. W. Drane Street  
Plant City, Florida 33563  
Phone (813) 752-2113



NORTH  
0 50 100 200  
GRAPHIC SCALE  
SCALE: 1" = 100'



DEP  
NOV 04 2005  
SOUTHWEST DISTRICT

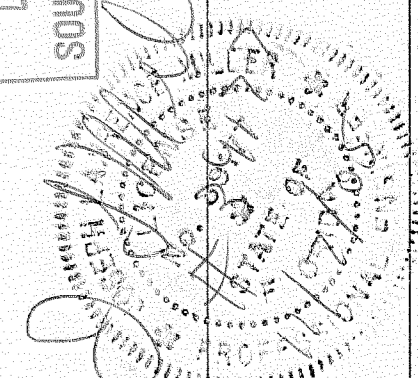

Manatee County  
Lena Road Landfill  
Stage I Landfill Topography Based on  
Aerial Photograph Dated July 26, 2005  
I.F. Rooks & Associates, Inc.  
106 N. W. Drane Street  
Plant City, Florida 33563  
Phone (813) 752-2113