

PERMIT APPLICATION PLANS

Garden Street Iron & Metal Waste Tire Processing Center

3350, FORT MYERS, FLORIDA 33916
SECTION 30, TOWNSHIP 44 S., RANGE 25 E.
LEE COUNTY, FLORIDA

STRAP # 30-44-25-P4-00108.0000

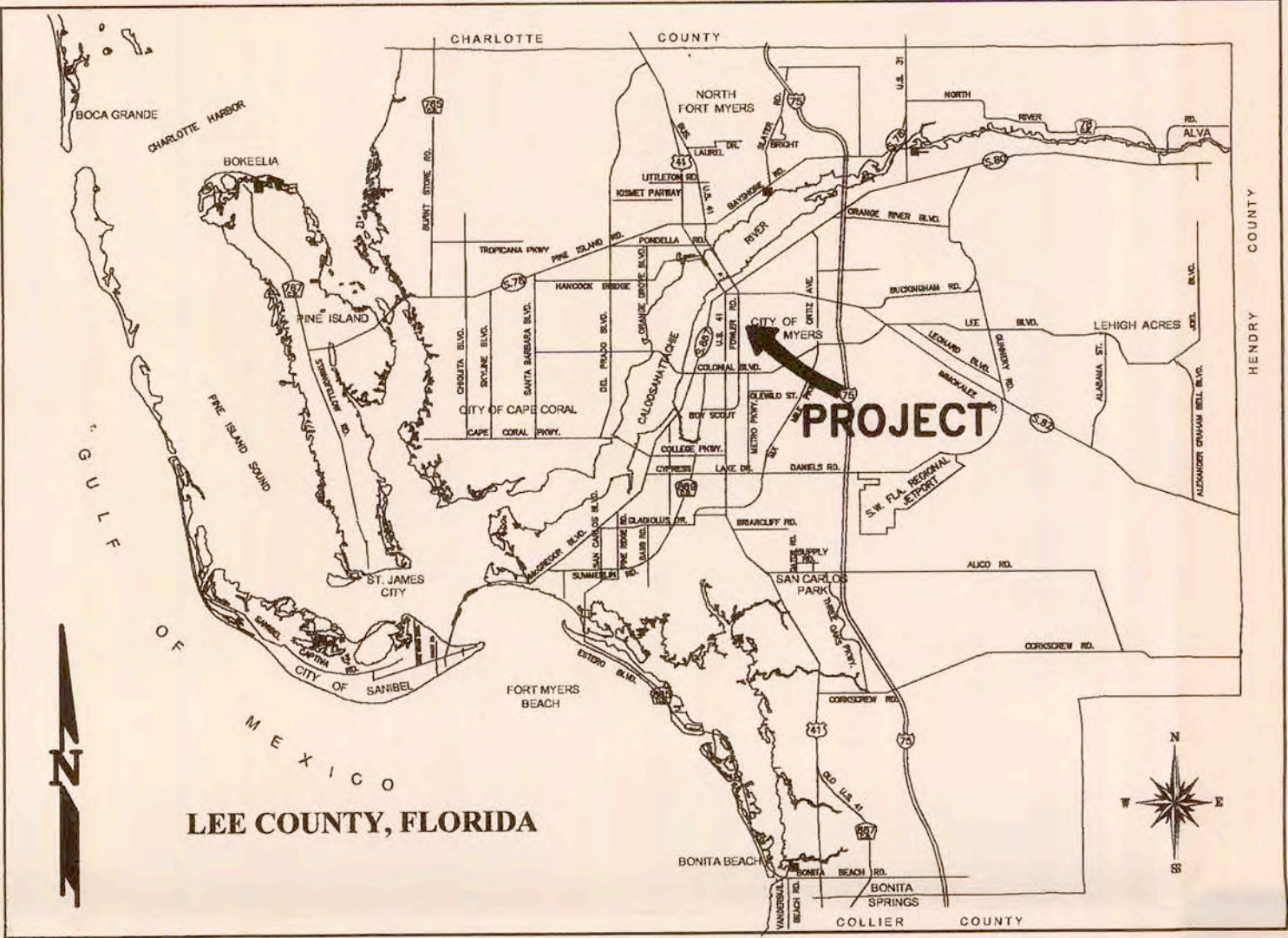

LOCATION MAP

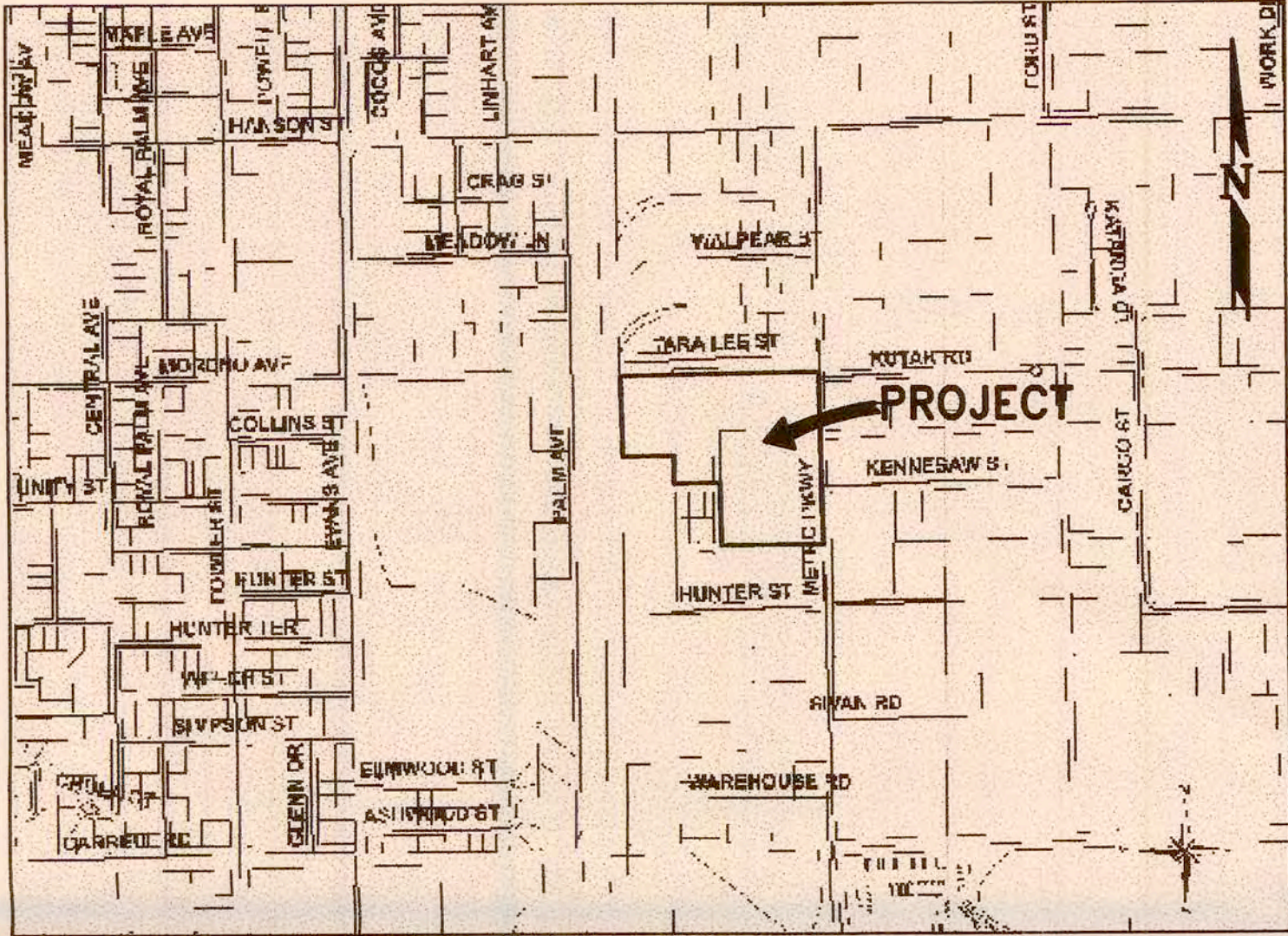

VICINITY MAP

OWNER:
GARDEN STREET IRON & METAL INC.
OF S.W. FLORIDA
3350 METRO PARKWAY
FORT MYERS , FL. 33916
CONTACT: ROB WEBER
(239) 337-5865

SITE ENGINEER:
KEENE ENGINEERING, INC.
PO BOX 2770
FORT MYERS, FL. 33902
(239) 939-0524
(239) 939-1968 FAX

SHEET INDEX:

1. COVER SHEET
2. EXISTING IMPROVMENTS PLAN
- 2A. GENERAL SITE PLAN
3. PROCESSING AREA PLAN
- 3A. FEED STOCK BLENDING AREA PLAN
- 3B. WASTE TIRE STORAGE AREA PLAN
- 3C. PROCESSED WASTE TIRE STORAGE AREA PLAN
- 3D. WASTE TIRE PROCESSING MATERIAL FLOW
4. SURROUNDING LAND USES WITHIN 1 MILE
5. PROJECT AERIAL

RECEIVED-D.E.P.
AUG 15 2011
SOUTH DISTRICT

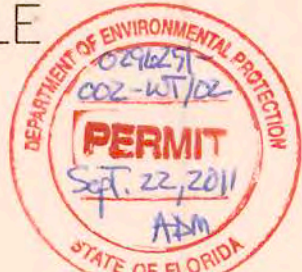

DRAWING SET DATE: 8-11-11

Garden Street Iron & Metal
Waste Tire Processing Center
COVER SHEET

SCALE:
24x36: N/A
11x17: N/A
SHEET
1 OF 5

KEENE ENGINEERING, INC.
10970 S. CLEVELAND AVE.
FORT MYERS, FLA 33907
239-939-0524 PHONE
239-939-1968 FAX
ENG. BUS. NO. 7578



REVISIONS	DATE
1. Revision per FDEP and CTR Fm Dpt.	08-07-09
2. Revision per FDEP	10-07-09
3. Revision per FDEP	11-10-09
4. Revision per FDEP	11-13-09
5. Revision per FDEP	11-13-09
6. Revision per FDEP	11-13-09
7. Revision per FDEP	11-13-09
8. Revision per FDEP	11-13-09
9. Revision per FDEP	11-13-09
10. Revision per FDEP	11-13-09
11. Revision per FDEP	11-13-09
12. Revision per FDEP	11-13-09
13. Revision per FDEP	11-13-09
14. Revision per FDEP	11-13-09
15. Revision per FDEP	11-13-09
16. Revision per FDEP	11-13-09
17. Revision per FDEP	11-13-09
18. Revision per FDEP	11-13-09
19. Revision per FDEP	11-13-09
20. Revision per FDEP	11-13-09

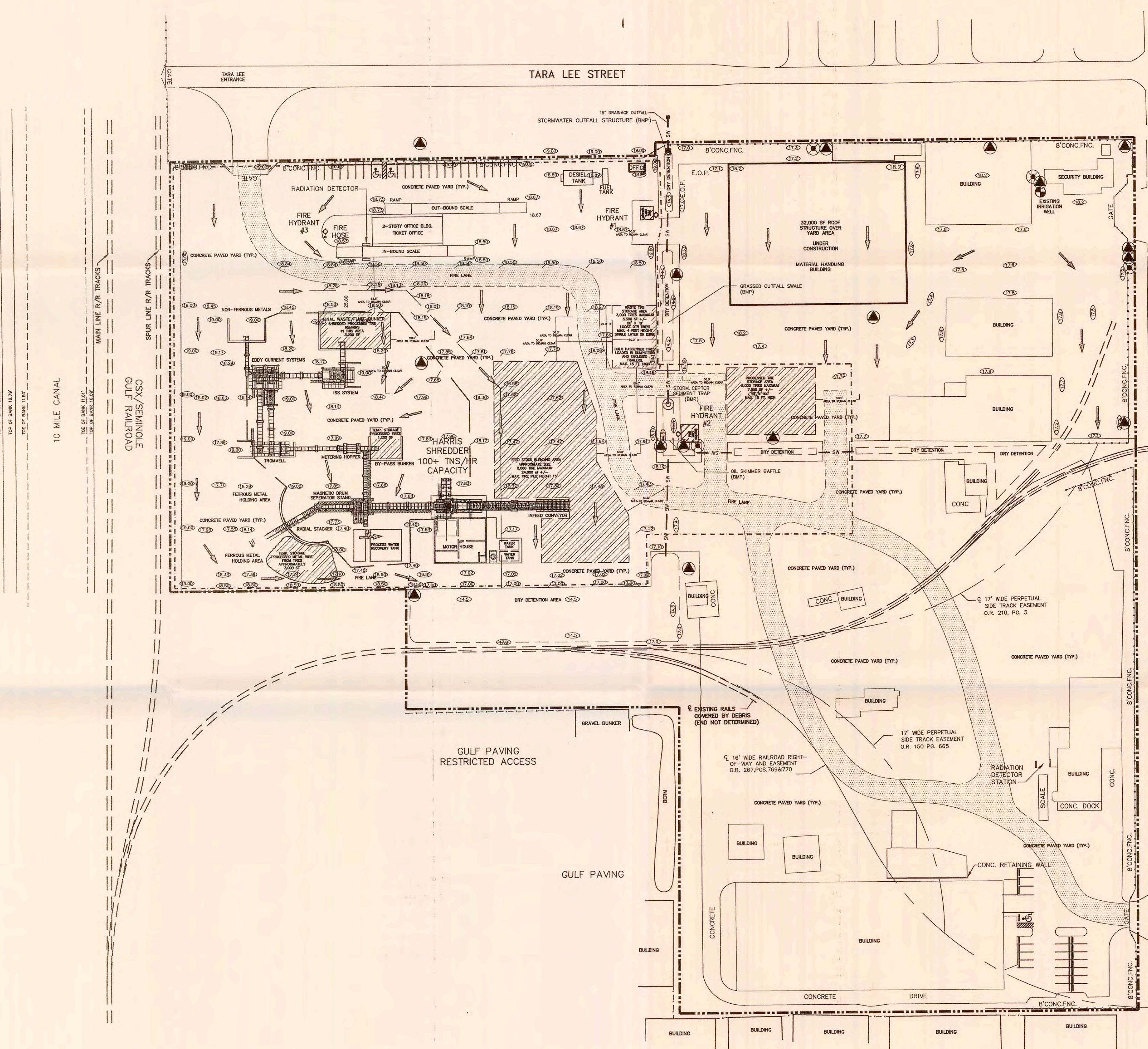

LEGEND

- 18.19 PAVEMENT ELEVATION
- [Pattern] FIRE LANE AREA
- [Pattern] TIRE STORAGE AREAS
- [Arrow] DRAINAGE FLOW PATTERN
- [Dashed Line] PROPERTY BOUNDARY
- [Pattern] WASTE TIRE PROCESSING CENTER LIMITS
- [Pattern] PRECAST CONCRETE FENCING
- [Line] STORM WATER PIPE
- [Pattern] CHAINLINK FENCING
- [Symbol] FIRE HYDRANT
- [Symbol] GROUNDWATER RECOVERY WELL
- [Symbol] GROUNDWATER TESTING WELL
- [Symbol] IRRIGATION WELL



REVISIONS	DATE
1. Revisions per FDP and CHN Fire Dept.	07-31-09
2. Revisions per FDP	09-27-09
3. Revisions per FDP	11-23-09
4. Revisions per FDP	11-23-09
5. New Fire Lanes, Inland Blind Area, Add Tires	11-23-09
6. & Processed Tires Storage Area	11-23-09
7. New Fire Lanes	11-23-09
8. New Fire Lanes & Office Location	11-23-09

APPROVED BY: [Signature]
WILLIAM L. KEENE
FLORIDA P.E. #89915
WASTE TIRE PROCESSING CENTER



KEENE ENGINEERING, INC.
10970 S. CLEVELAND AVE.
SUITE 303
FORT MYERS, FLA 33907
239-939-0524 PHONE
239-939-1968 FAX
ENG. BUS. NO. 7578

Garden Street Iron & Metal Waste Tire Processing Center GENERAL SITE PLAN

Entered into
OCULUS
South District
#3



RECEIVED
AUG 26 2011
D.E.P. South District

SCALE:
24x36: 1" = 60'
11x17: 1" = 120'
SHEET
2A OF 5

DRAWING SET DATE: 8-26-11

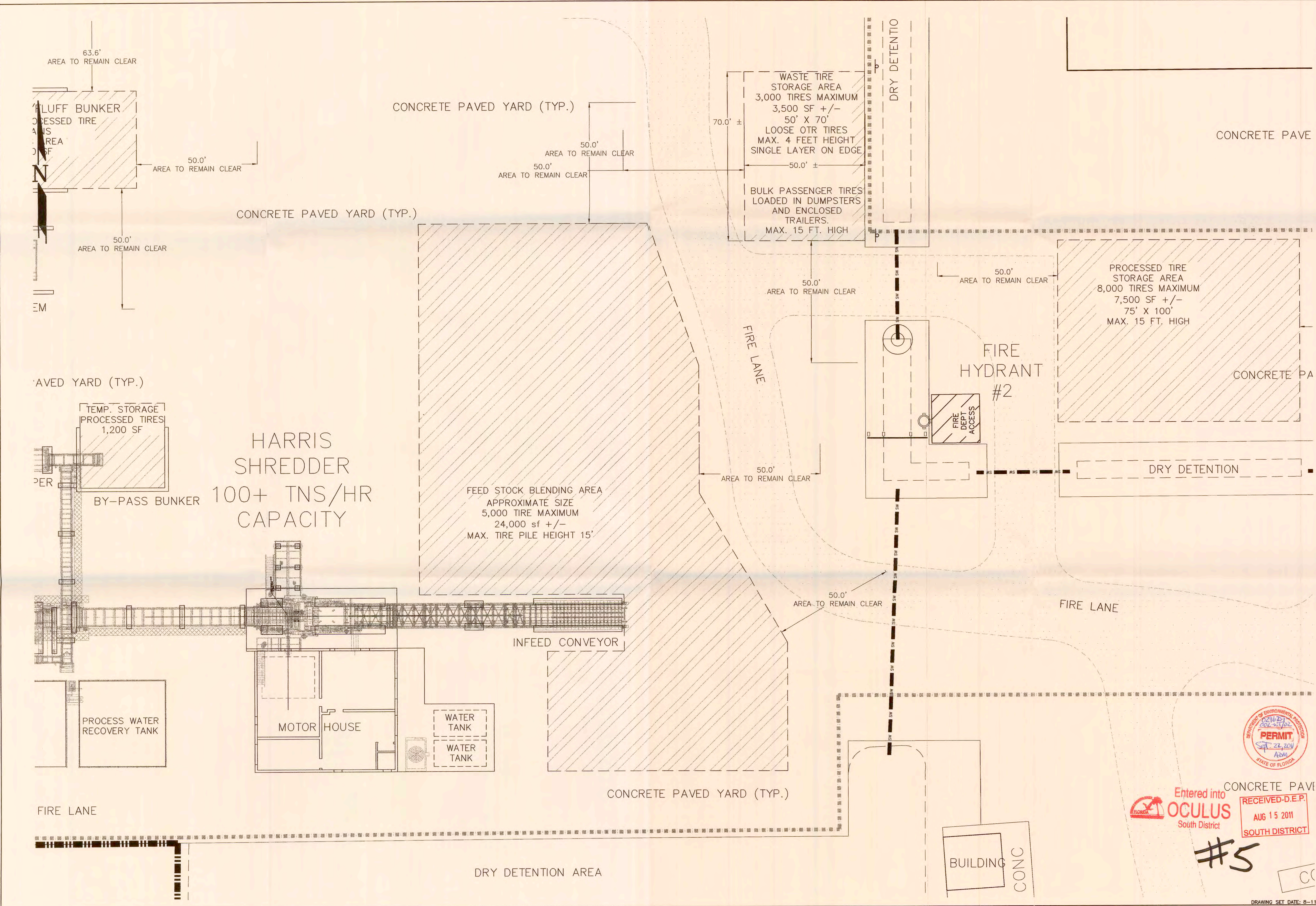

REVISIONS	DATE
1. Revisions per TSD and CTR Fire Dept.	07-31-09
2. Revisions per TSD and CTR Fire Dept.	08-10-09
3. Revisions per TSD and CTR Fire Dept.	10-16-09
4. Revisions per TSD and CTR Fire Dept.	11-2-09
5. Rev. Fire Ls, Inland Blvd Area, Add Tires	11-18-10
6. Rev Inland Area	8-11-11

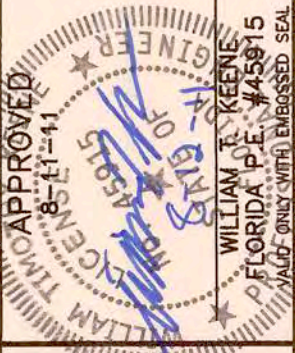

KEENE ENGINEERING, INC.
10870 S. CLEVELAND AVE.
SUITE 300
FORT MYERS, FL 33907
239-939-1884 PHONE
239-939-1888 FAX
ENG. BUS. NO. 7578

Garden Street Iron & Metal
Waste Tire Processing Center
FEED STOCK BLENDING AREA PLAN

SCALE:
24x36: 1" = 20'
11x17: 1" = 40'
SHEET
3A OF 5

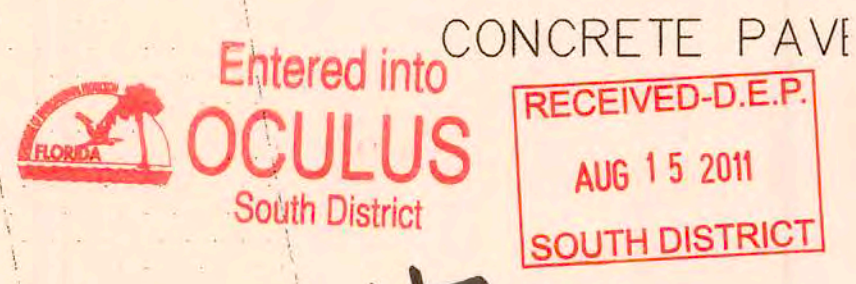

#5



Z:\Public Drive\00 Keene Engineering Inc\Garden Street Tire Facility Permit\Garden Street Tire Processing Facility.11.08.10.dwg, Tire Storage Area Plan, 8/11/2011 5:02:02 PM

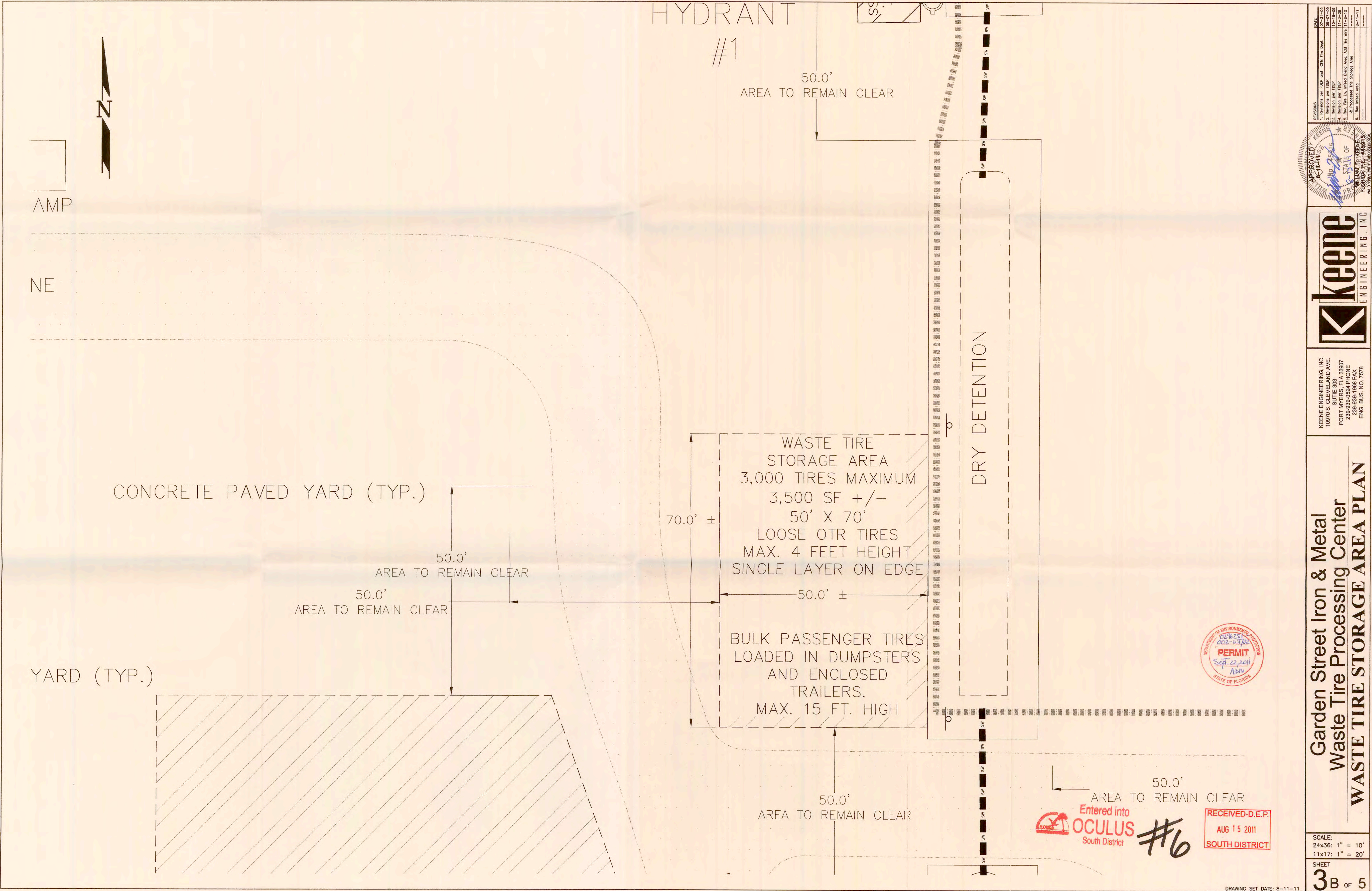

REVISIONS	DATE
1. Revisions per FDP and CPM Fire Dept.	07-31-09
2. Revisions per FDP	08-10-09
3. Revisions per FDP	10-10-09
4. Revisions per FDP	11-3-09
5. Rev. Fire Dept. Inland Blind Area, Add Tire Wnd	11-8-10
6. Rev. Inland Area	8-11-11

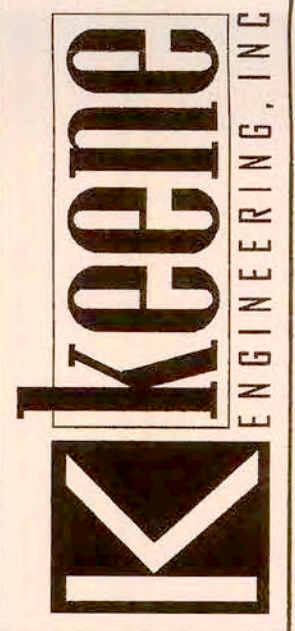

KEENE ENGINEERING, INC.
10970'S CLEVELAND AVE.
FORT MYERS, FLA 33907
239-939-4524 PHONE
239-939-1868 FAX
ENG. BUS. NO. 7579

Garden Street Iron & Metal
Waste Tire Processing Center
WASTE TIRE STORAGE AREA PLAN

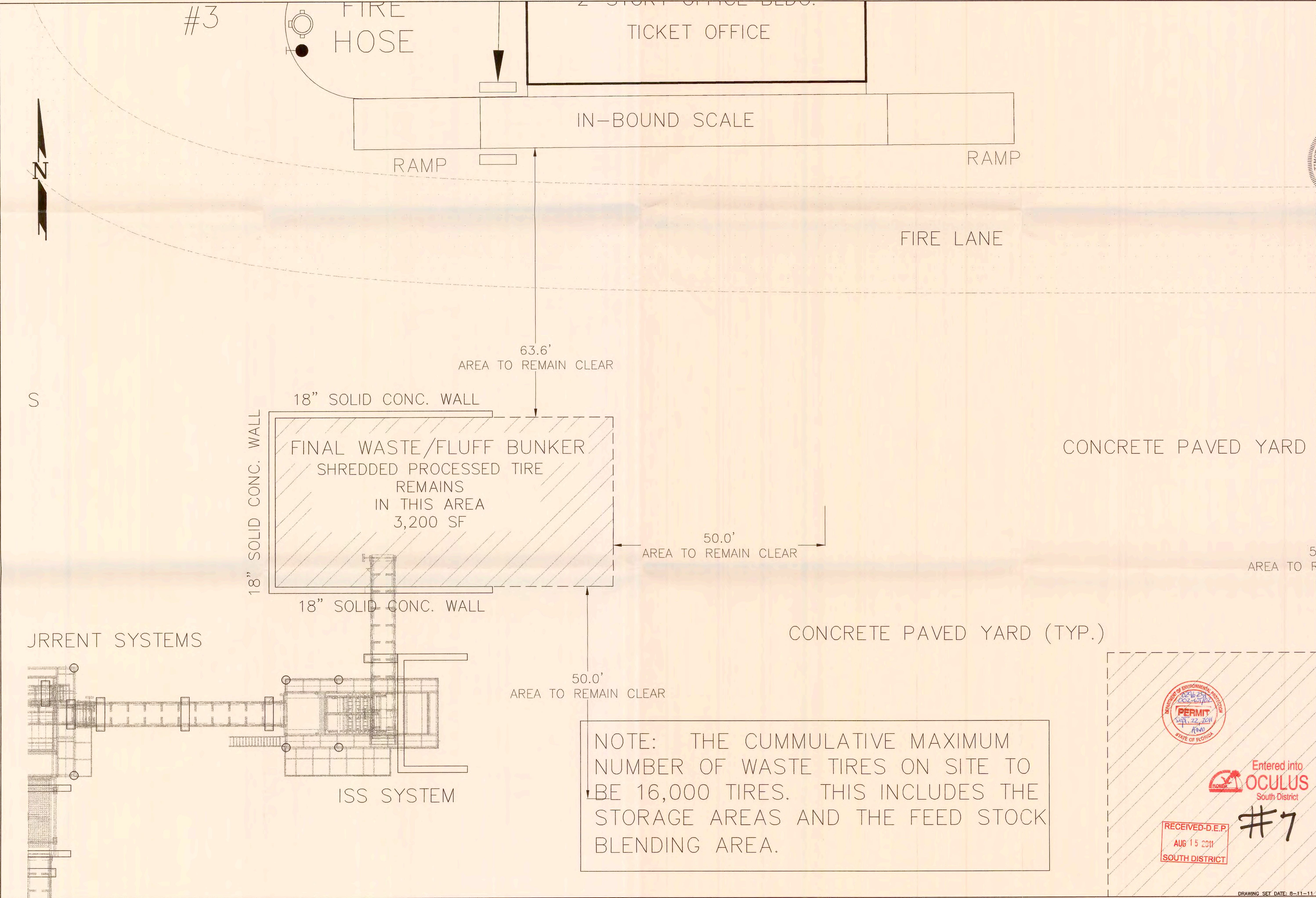

REVISIONS
1. Revision per FDP and CMV Fire Dept.
2. Revision per FDP
3. Revision per FDP
4. Revision per FDP
5. Rev. Fire Ls. Inland Blvd Area, Add Tire Area
6. Rev. Fire Ls. Inland Blvd Area, Add Tire Area
7. Rev. Fire Ls. Inland Blvd Area, Add Tire Area
8. Rev. Fire Ls. Inland Blvd Area, Add Tire Area
9. Rev. Fire Ls. Inland Blvd Area, Add Tire Area
10. Rev. Fire Ls. Inland Blvd Area, Add Tire Area

DATE
07-31-08
08-07-08
11-13-08
11-13-08
11-13-08
11-13-08
11-13-08
11-13-08
11-13-08
11-13-08

APPROVED
KEENE ENGINEERING, INC.
STATE OF FLORIDA
PROFESSIONAL ENGINEER
No. 10000
BORONIA, P.E.
10/07/09, 10/07/09, 10/07/09

keene
ENGINEERING, INC.

KEENE ENGINEERING, INC.
10970 S. CLEVELAND AVE.
SUITE 303
FORT MYERS, FLA 33907
239-939-1968 FAX
239-939-1968 FAX
ENG. BUS. NO. 7578

Garden Street Iron & Metal
Waste Tire Processing Center
PROCESSED WASTE TIRE STORAGE AREA PLAN

SCALE:
24x36: 1" = 10'
11x17: 1" = 20'
SHEET
3C OF 5

RECEIVED-D.E.P.
AUG 15 2011
SOUTH DISTRICT

Entered into
OCULUS
South District

#7

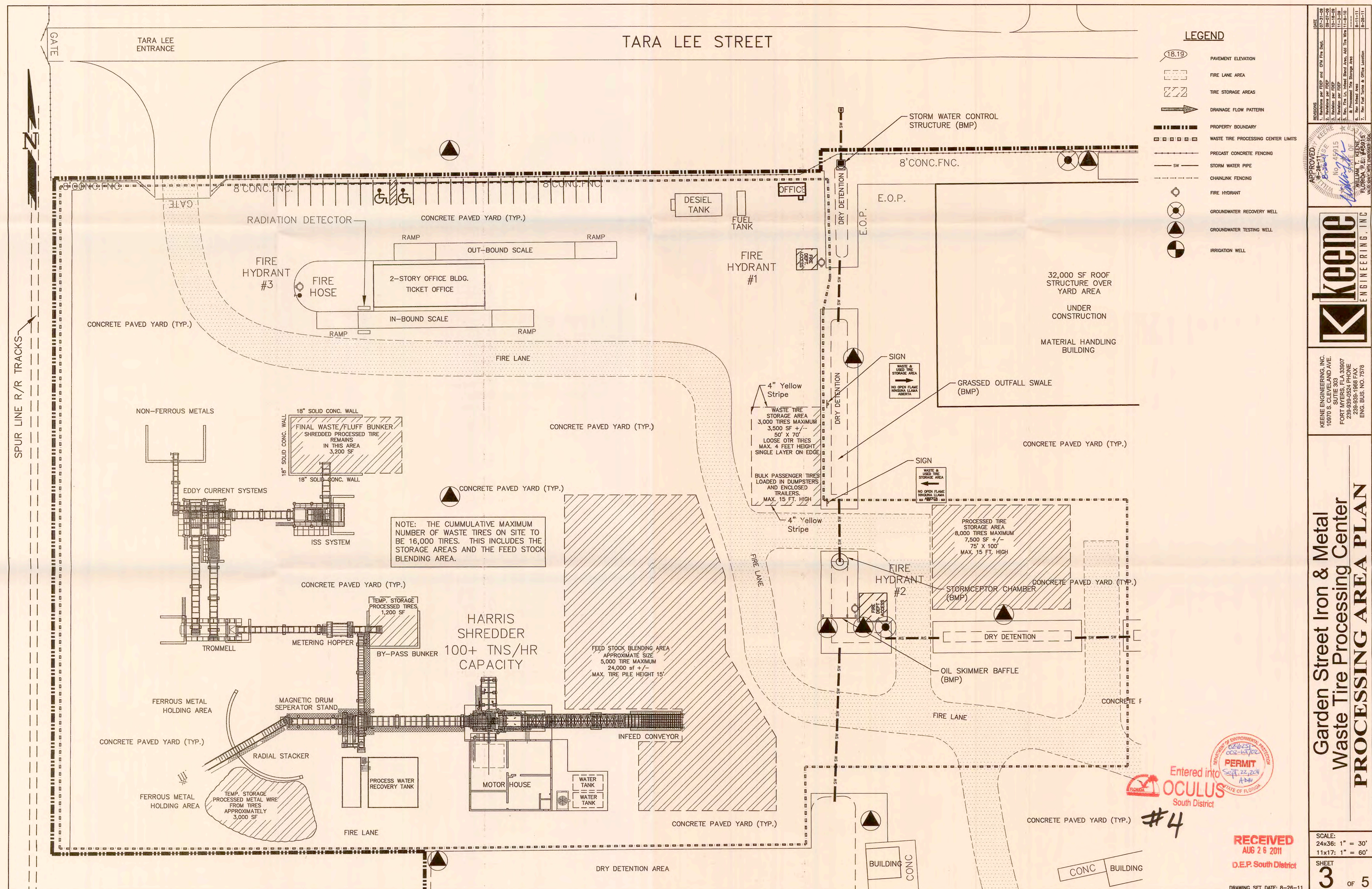
The logo for Keene Engineering Inc. features a large, stylized 'K' in a square frame, followed by the word 'keene' in a bold, lowercase sans-serif font, and 'ENGINEERING INC.' in a smaller, uppercase sans-serif font.

KEENE ENGINEERING, INC.
0970 S. CLEVELAND AVE.
SUTIE 303
FORT MYERS, FLA 33907
239-939-0524 PHONE
239-939-1968 FAX
ENG. BUS. NO. 7578

**Garden Street Iron & Metal
Waste Tire Processing Center
PROCESSING AREA PLAN**

SCALE:
24x36: 1" = 30'
11x17: 1" = 60'

SHEET
3 OF 5

DRAWING SET DATE: 8-26-1