



Locklear & Associates, LLC
Environmental Consulting Services

February 23, 2012

John Morris, P.G.
Florida Department of Environmental Protection – Southwest District
13051 N. Telecom Parkway
Temple Terrace, Florida 33637

RE: Minor Permit Modification
Enterprise Class III Landfill and Recycling Facility
Permit No. 177982-007-SO/T3
WACS No. 87895

Dept. of Environmental
Protection
FEB 24 2012
Southwest District

Dear Mr. Morris:

We are submitting this minor permit modification application for the above referenced facility on behalf of the applicant, Angelo's Aggregate Materials, Inc. The purpose of this application is to modify the proposed groundwater monitoring network for disposal Cell 6. The current operating permit calls for the installation of monitoring wells MW-2A and MW-2B as part of the Cell 6 construction certification requirements. As we have discussed, groundwater elevation data collected since the last permit application indicates a west-northwest flow direction with the Floridan aquifer. This flow direction results in the need to install additional groundwater monitoring wells along the western boundary of Cell 6. Additionally, the currently permitted locations for monitoring wells MW-2A and MW-2B are beyond the 100 feet horizontal zone of discharge of Cell 6 and, therefore, are not appropriately located to monitor this cell. Therefore, we are proposing to install three Floridan aquifer monitoring wells (MW-15B, MW-16B and MW-17B) to monitor groundwater downgradient of Cell 6. The proposed locations for monitoring wells MW-15B, MW-16B and MW-17B are shown in Attachment 1. A review of site boring logs, as well as groundwater elevation data from existing monitoring wells, indicates that the surficial aquifer is likely not present in the area of Cell 6. In the event that water bearing sediments are encountered above the clay units confining the Floridan aquifer system, surficial aquifer monitoring wells will be installed in cluster with the associated Floridan aquifer monitoring well. Typical well construction details for surficial aquifer and Floridan aquifer monitoring wells (Figures 16 and 17 from Section 5 of the August 2005 Enterprise Recycling and Disposal Facility Class III Landfill Permit Renewal Application) are provided in Attachment 2. Proposed screen interval elevations for all three Floridan aquifer monitoring wells is 55 to 75 feet, NGVD based on the range of groundwater elevations for existing site monitoring wells provided below:

Groundwater Elevations in Feet, NGVD

| | MW-1B | MW-3B | MW-11B |
|------|-------|-------|--------|
| 09S1 | 60.77 | 61.02 | 60.93 |
| 09S2 | 67.08 | 67.30 | 67.21 |
| 10S1 | 65.40 | 65.63 | 65.52 |
| 10S2 | 69.46 | 69.74 | 69.61 |
| 11S1 | 65.62 | 65.91 | 65.82 |

Standard Penetration Test Borings will be performed at each of the three Florida aquifer monitoring well locations to define the nature of the confining unit. In the event that the confining unit depth is more variable than anticipated, there will be lithologic information to determine if field conditions warrant a change to the construction detail (e.g., well screen elevation range and location of the bentonite seal). In the event that surficial aquifer monitoring well(s) are installed, they will be completed similar to wells MW-1A (if near MW-15B or MW-16B) and MW-2A (if near MW-17B).

In the event that excavation remains to be completed in areas adjacent to the proposed detection wells, the well casings will be "cut down" as needed to provide access to the wells during routine sampling events. Each time the wells are modified in this manner, the top of casing elevation will be re-established by a Florida licensed surveyor.

Additional changes to the facility's groundwater monitoring network not associated with Cell 6 will be addressed in

the upcoming operations permit renewal application due to be submitted to the Department by March 30, 2012.

If you have any questions regarding this information, please contact me at (352) 682-0781.

Sincerely,

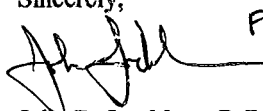
 FL # 2467
2/23/12

John D. Locklear, P.G.
President
Locklear & Associates, LLC

Cc: John Arnold, Angelo's Aggregate Materials

Attachment 1: Proposed Cell 6 Groundwater Monitoring Wells Location Map
Attachment 2: Well Construction Diagrams

Attachment 1
Proposed Cell 6 Groundwater Monitoring Wells Location Map

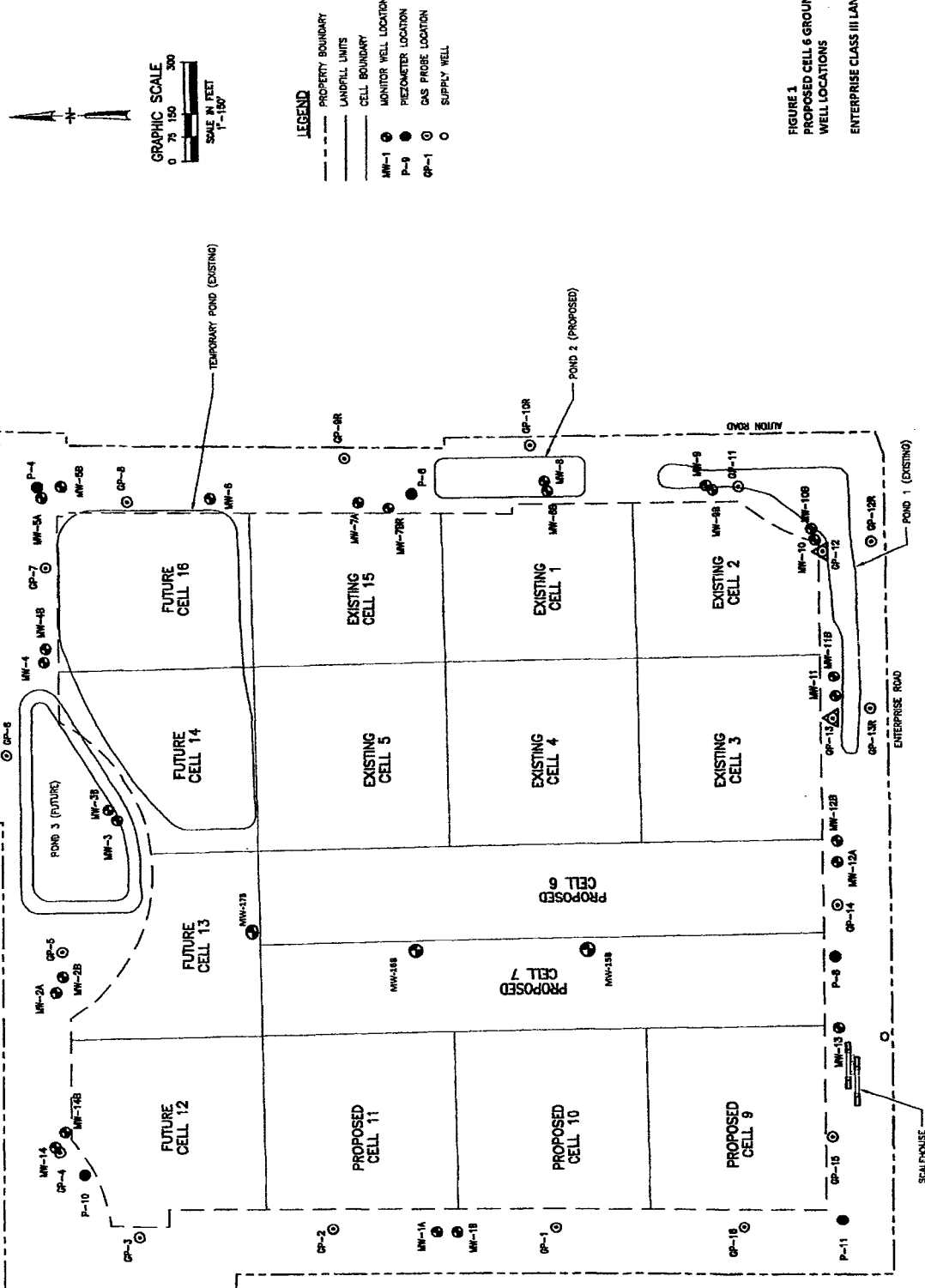

Attachment 2
Well Construction Diagrams

| WELL | A | B | C | D | E | F |
|--------|-----|-----|-----|----|-------|--------|
| MW-1 | 64' | 42' | 20' | 3' | 30/40 | 0.015" |
| MW-1A | 65' | 43' | 20' | 3' | 30/40 | 0.006" |
| MW-2A | 56' | 34' | 20' | 3' | 30/65 | 0.006" |
| MW-3 | 50' | 28' | 20' | 3' | 30/65 | 0.006" |
| MW-4 | 40' | 20' | 20' | 3' | 30/40 | 0.015" |
| MW-5A | 35' | 13' | 20' | 3' | 30/65 | 0.006" |
| MW-6 | 40' | 18' | 20' | 3' | 30/40 | 0.015" |
| MW-7A | 39' | 17' | 20' | 3' | 30/65 | 0.006" |
| MW-8 | 50' | 29' | 20' | 3' | 30/65 | 0.006" |
| MW-9 | 56' | 34' | 20' | 3' | 30/65 | 0.006" |
| MW-10 | 56' | 34' | 20' | 3' | 30/65 | 0.006" |
| MW-11 | 55' | 33' | 20' | 3' | 30/65 | 0.006" |
| MW-12A | 62' | 40' | 20' | 3' | 30/65 | 0.006" |
| MW-13 | 75' | 53' | 20' | 3' | 30/65 | 0.006" |
| MW-14 | 70' | 48' | 20' | 3' | 30/65 | 0.006" |

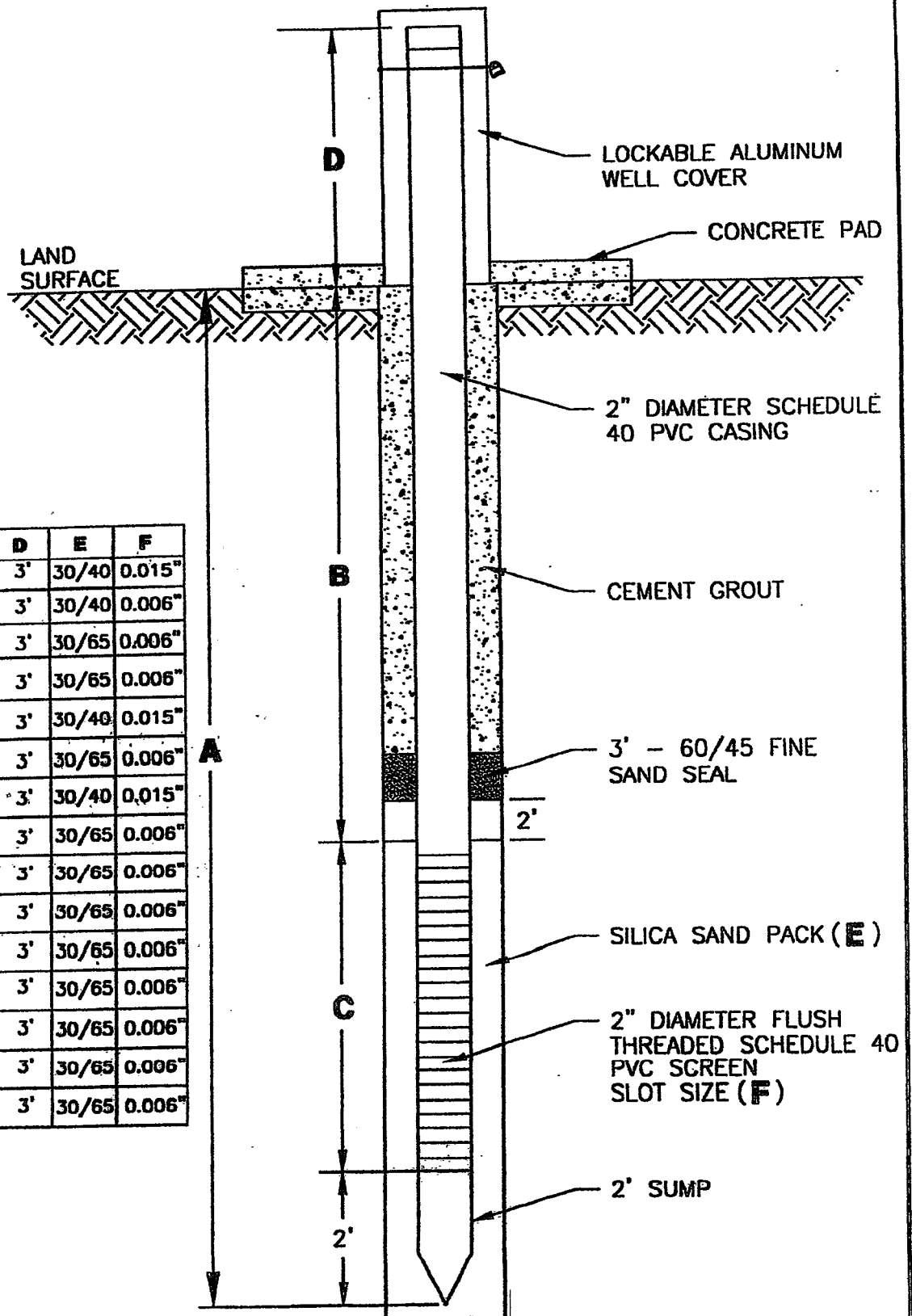

NOT TO SCALE



HARTMAN & ASSOCIATES, INC.
 engineers, hydrogeologists, geologists & environmental consultants
 201 EAST PINE STREET - SUITE 1000 - ORLANDO, FL 32801
 TELEPHONE (407) 833-3343 - FAX (407) 833-3730

**PROPOSED SURFICIAL AQUIFER MONITOR
 WELL DETAILS - PROPOSED ENTERPRISE
 RECYCLING AND DISPOSAL FACILITY
 DADE CITY, FLORIDA**

**FIGURE
 16**

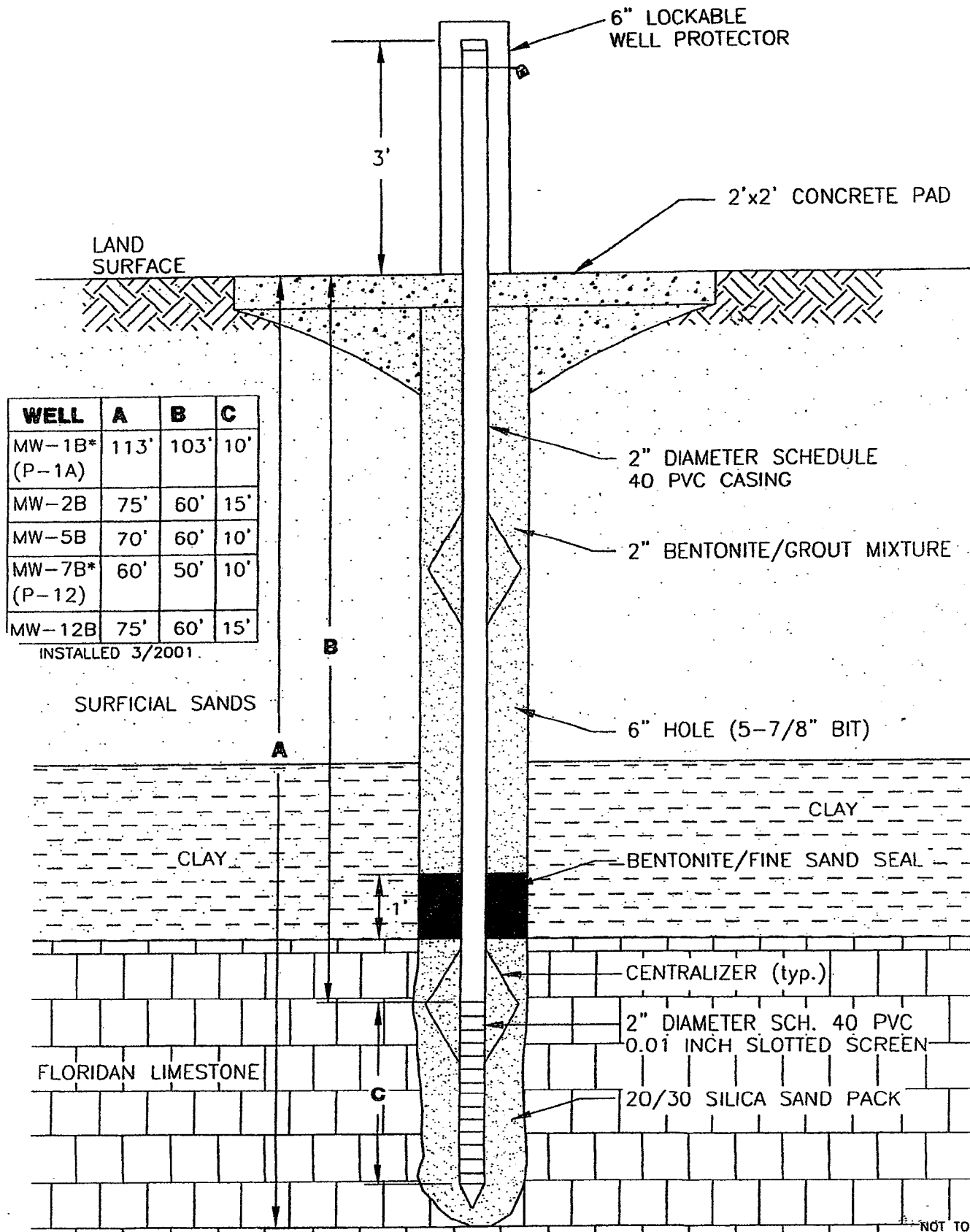

| WELL | A | B | C |
|------------------|------|------|-----|
| MW-1B* (P-1A) | 113' | 103' | 10' |
| MW-2B | 75' | 60' | 15' |
| MW-5B | 70' | 60' | 10' |
| MW-7B* (P-12) | 60' | 50' | 10' |
| MW-12B | 75' | 60' | 15' |

INSTALLED 3/2001

NOT TO SCALE



HARTMAN & ASSOCIATES, INC.
engineers, hydrogeologists, surveyors & management consultants
201 EAST PINE STREET - SUITE 1000 - ORLANDO, FL 32801
TELEPHONE (407) 839-3955 - FAX (407) 839-3790

**FLORIDAN MONITOR WELL DESIGN
PROPOSED ENTERPRISE RECYCLING
AND DISPOSAL FACILITY
DADE CITY, FLORIDA**

**FIGURE
17**