

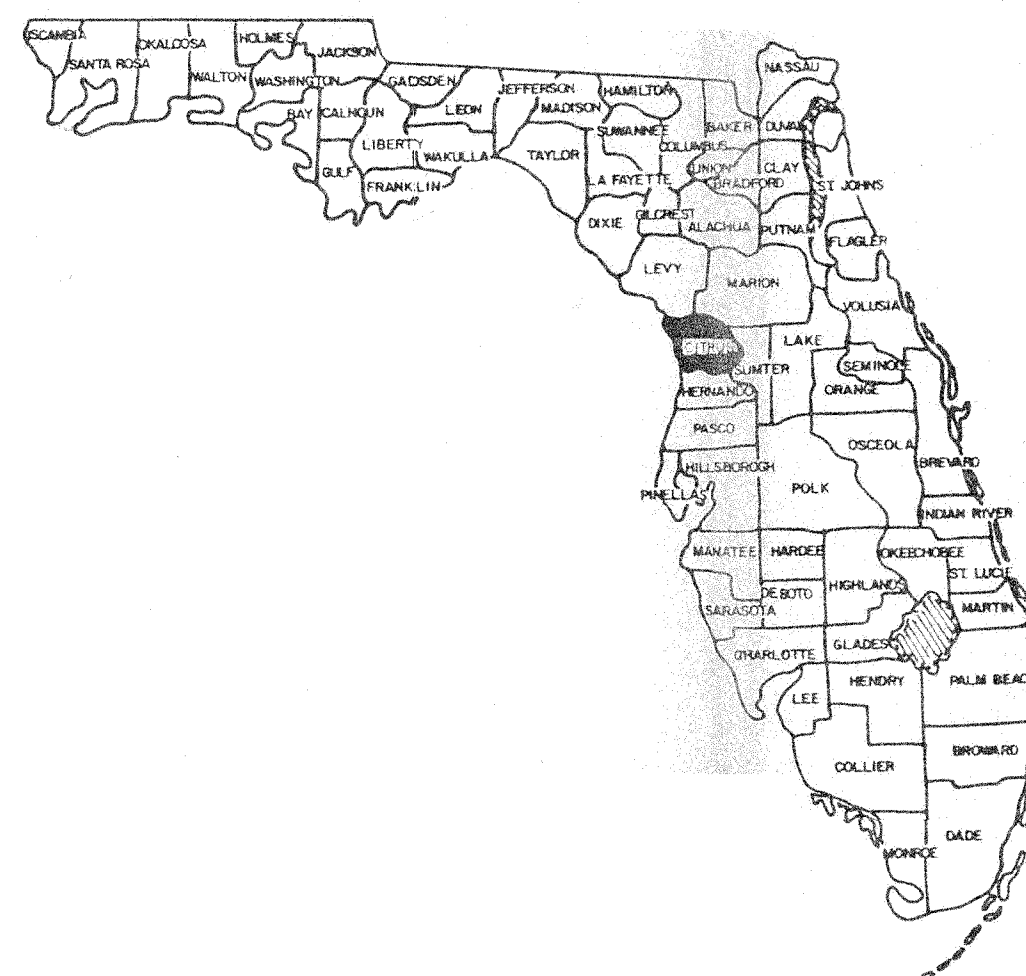

CL 3
WACS ID# 39859
Permit #S009-111795

CITRUS COUNTY 60 ACRE SANITARY LANDFILL CLOSURE PLAN



PHASE I
APPROX. 25 Acres

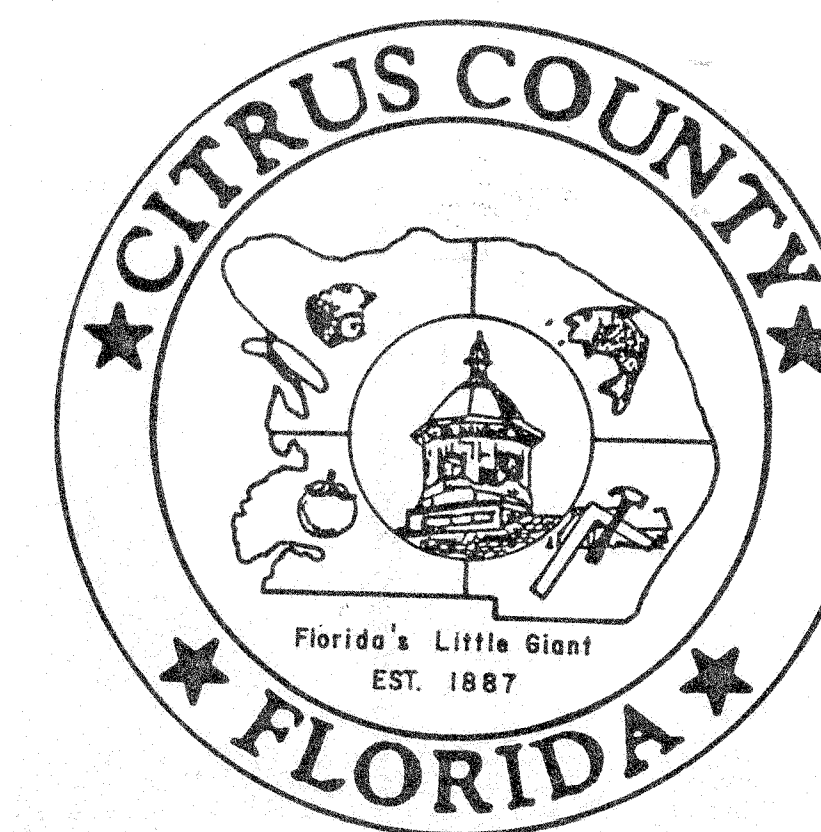

COUNTY COMMISSIONERS

SKIP HUDSON, CHAIRMAN
WILBUR LANGLEY, 1st VICE CHAIRMAN
WAYNE WEAVER, 2nd VICE CHAIRMAN
NICK BRYANT, COMMISSIONER
HANK COHEN, COMMISSIONER

COUNTY ADMINISTRATOR

CHRISTOPHER W. CHINAULT

COUNTY ENGINEER

JAMES W. PINKERTON

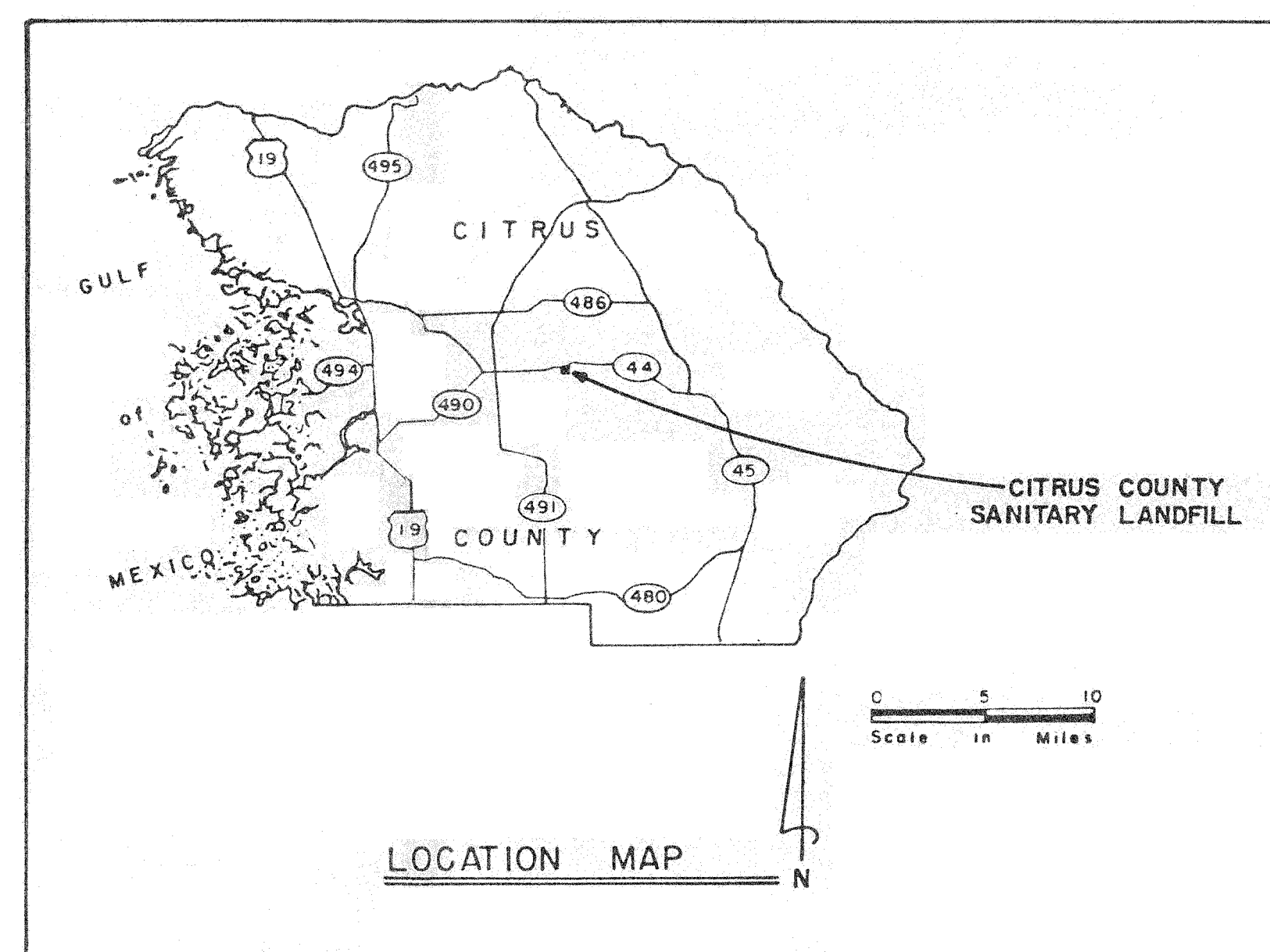

INDEX OF SHEETS

1. TITLE PAGE
2. OVERALL SITE GRADING PLAN
3. GRADING PLAN AREA I
4. GRADING PLAN AREA II
5. GRADING PLAN AREA III
6. GRADING PLAN AREA IV
7. DETAILS
8. DETAILS

PREPARED BY:
CITRUS COUNTY
DEPARTMENT OF TECHNICAL SERVICES
ENGINEERING DIVISION

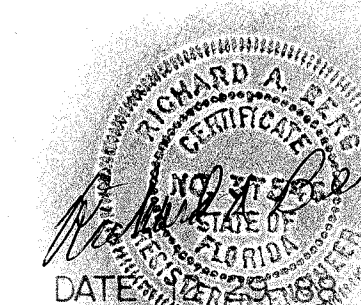
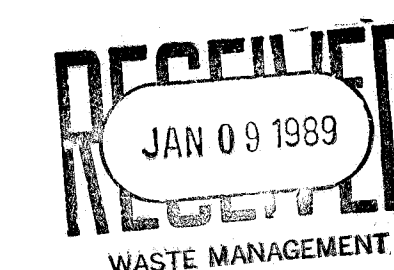

LEGEND	
SYMBOL	DESCRIPTION
	PROPOSED CONTOUR AND ELEVATION, ELEVATION RELATIVE TO NGVD-29, DERIVED FROM F.O.T. BENCHMARK
	EXISTING CONTOUR (SHEET N° 3 thru 6)
	ASSUMED COORDINATES
	GROUND TARGET
	PROPERTY BOUNDARY
	EXISTING STRUCTURE
	SECTION AND DETAIL DESIGNATION
	SHEET N° WHERE SECTION/DETAIL IS SHOWN
	SHEET N° WHERE SECTION/DETAIL IS FIRST INDICATED
	CULVERT W/ MITERED ENDS
	SLOPE
	RETENTION AREA
	PROPOSED SPOT ELEVATION
	EXISTING SPOT ELEVATION
	APPROXIMATE BOUNDARY OF AREAS THAT ARE NOT A PART OF THE CONTRACT
	LIMITS OF 30 mil PVC LINER
	APPROXIMATE BOUNDARY OF AREAS FOR SOLID WASTE RELOCATION
	GAS VENTILATION STRUCTURE

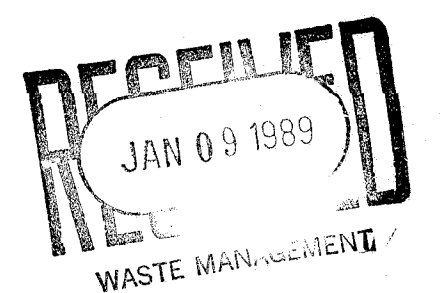
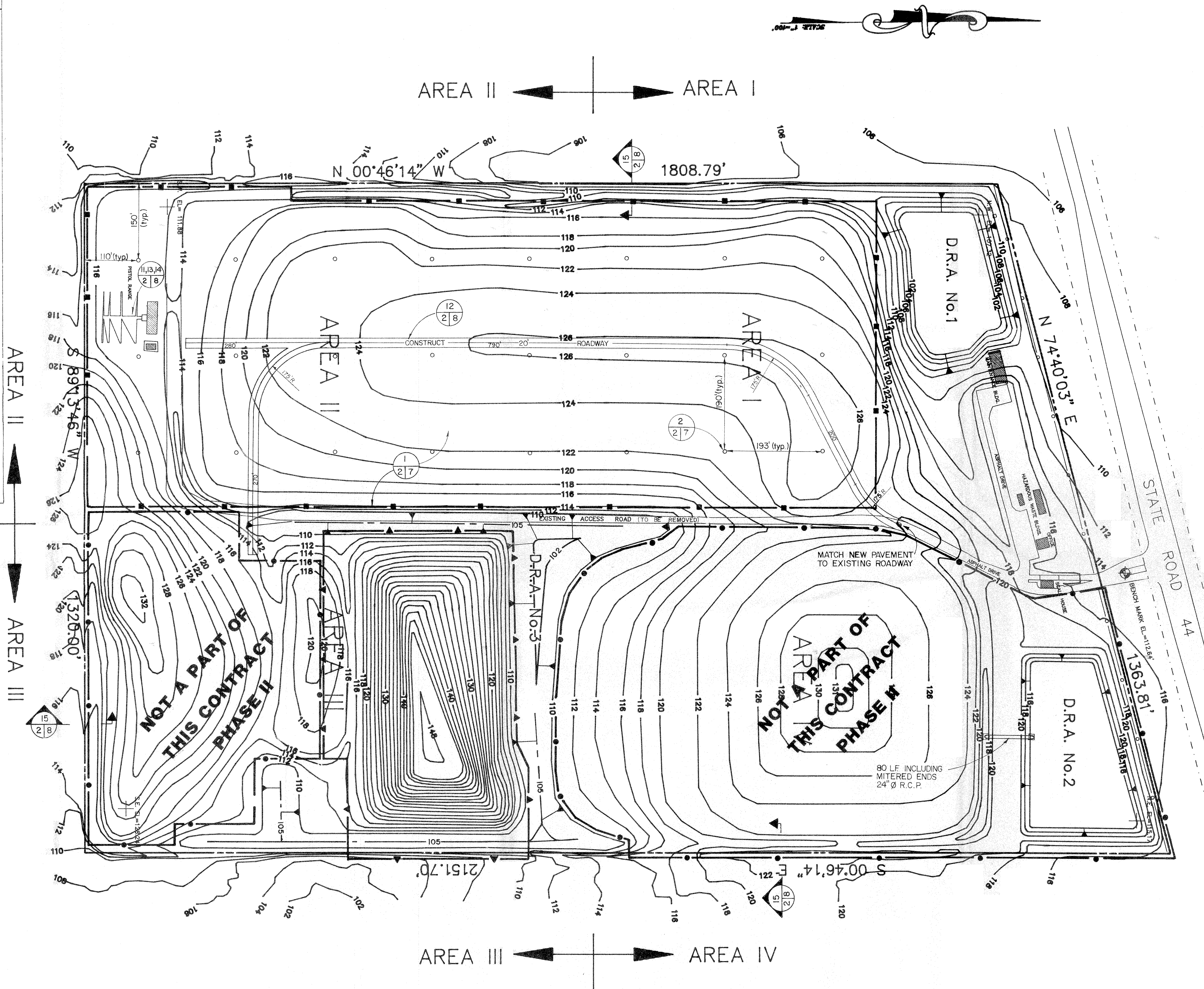

REVISIONS				PRELIMINARY		DESIGN		DEPARTMENT OF TECHNICAL SERVICES CITRUS COUNTY, FLORIDA ENGINEERING DIVISION	 60 Acre Sanitary Landfill Closure OVERALL SITE GRADING PLAN	PROJECT NUMBER	SHEET
BY		BY		BY	DATE	BY	DATE				2 OF 8
DATE		DATE								SCALE	FILE:
BY		BY		DRAWN		DESIGNED				1" = 100'	
DATE		DATE		CHECKED				SECTION	TOWNSHIP	RANGE	



REVISIONS						PRELIMINARY		DESIGN		DEPARTMENT OF TECHNICAL SERVICES CITRUS COUNTY, FLORIDA ENGINEERING DIVISION		60 Acre Sanitary Landfill Closure GRADING PLAN AREA I		PROJECT NUMBER		SHEET	
BY	DATE	BY	DATE	BY	DATE	BY	DATE	BY	DATE							SCALE	
						DRAWN						SECTION _____ TOWNSHIP _____ RANGE _____		1" = 50'		3 OF 8	
						DESIGNED										FILE: _____	
						CHECKED											

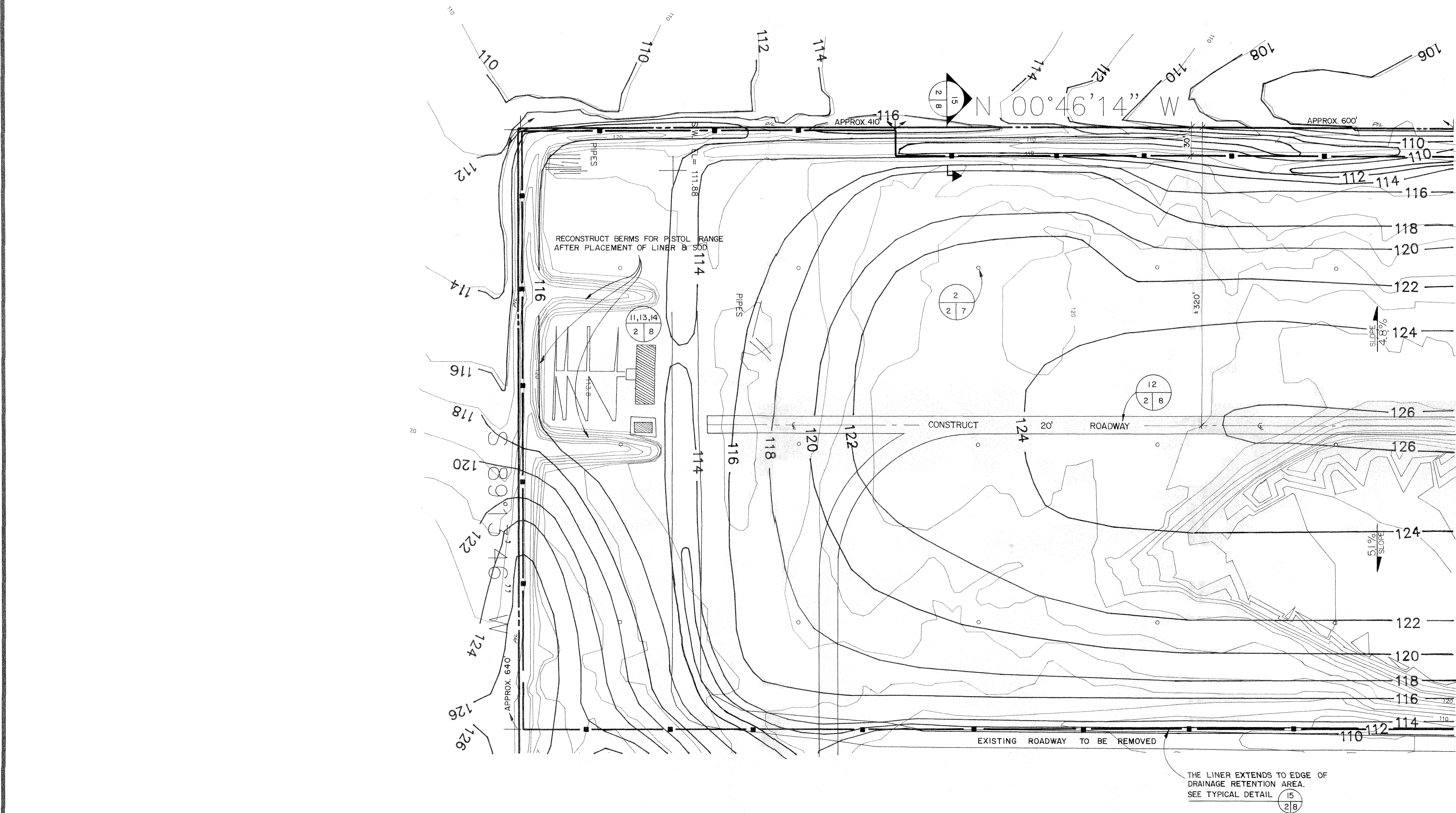

REVISIONS					
BY		BY		BY	
DATE		DATE		DATE	
BY		BY		BY	
DATE		DATE		DATE	

PRELIMINARY		DESIGN	
BY	DATE	BY	DATE
DRAWN			
DESIGNED			
CHECKED			

DEPARTMENT OF TECHNICAL SERVICES
CITRUS COUNTY, FLORIDA
ENGINEERING DIVISION

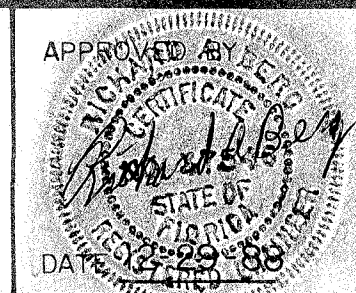

60 Acre Sanitary Landfill Closure
GRADING PLAN AREA II

SECTION _____ TOWNSHIP _____ RANGE _____

PROJECT NUMBER	SHEET 4 of 8
SCALE 1" = 50'	FILE: _____

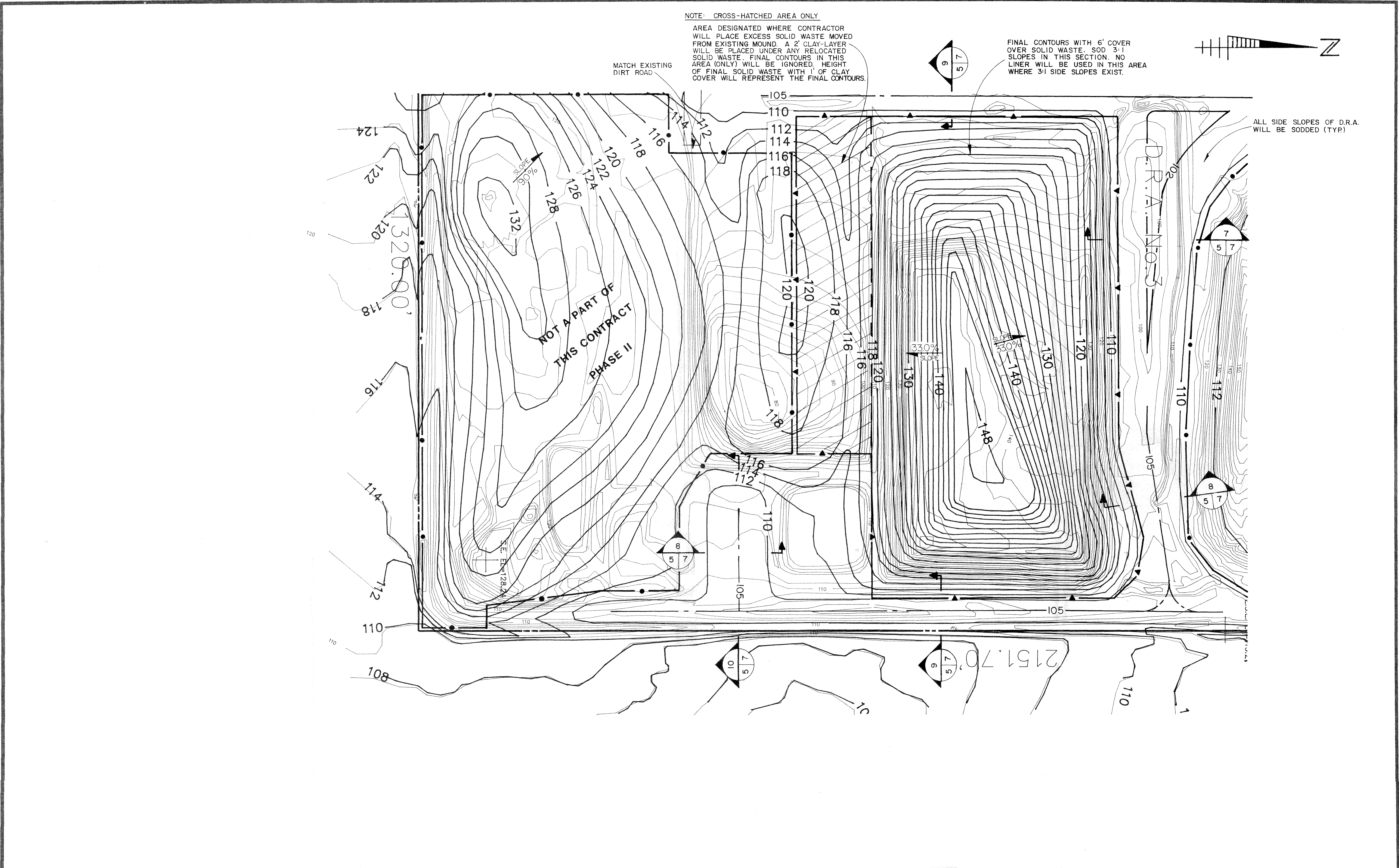

REVISIONS				PRELIMINARY		DESIGN		DEPARTMENT OF TECHNICAL SERVICES CITRUS COUNTY, FLORIDA ENGINEERING DIVISION		60 Acre Sanitary Landfill Closure GRADING PLAN AREA III		PROJECT NUMBER		SHEET	
BY	DATE	BY	DATE	BY	DATE	BY	DATE							SCALE	
BY		BY													5 OF 8
DATE		DATE													
BY		BY													
DATE		DATE													

APPROVED BY	APPROVED BY
DATE	DATE

SECTION	TOWNSHIP	RANGE

FILE	
------	--

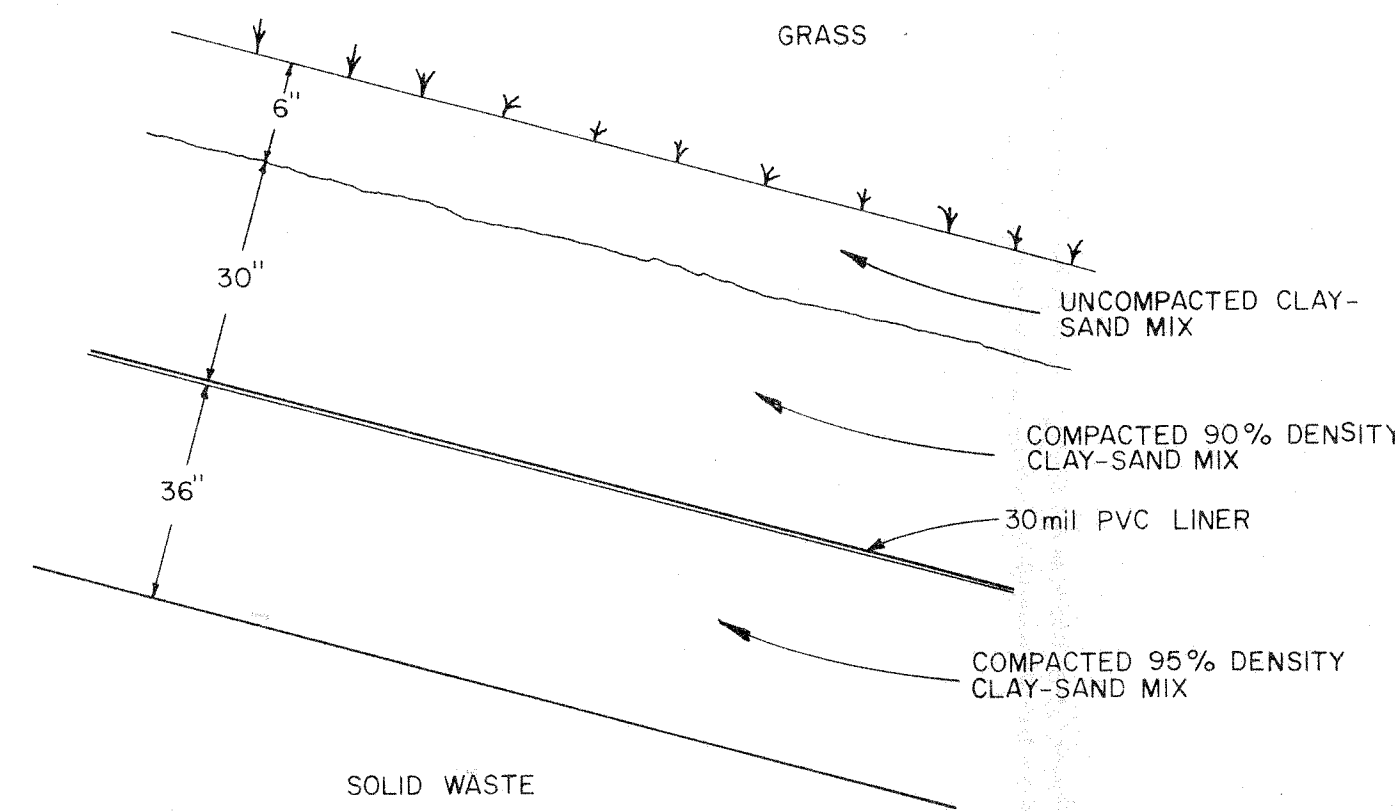

1 FINAL COVER DETAIL
2 7 N.T.S.

D.R.A.
No. 1

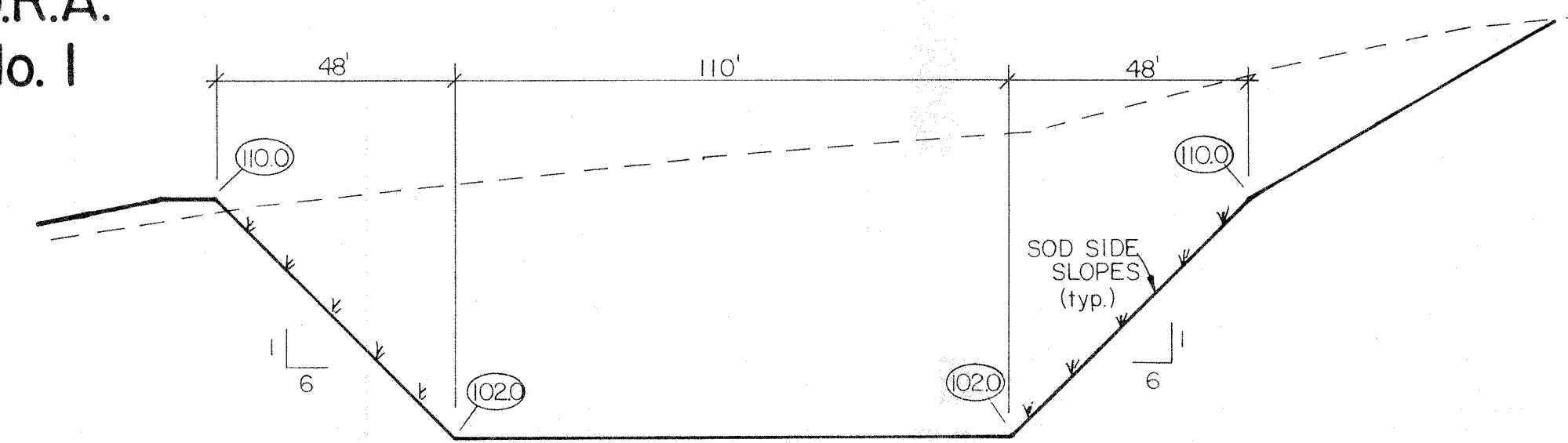

3 SECTION
3 7 SCALE: HORZ. - 1" = 30'
VERT. - 1" = 5'

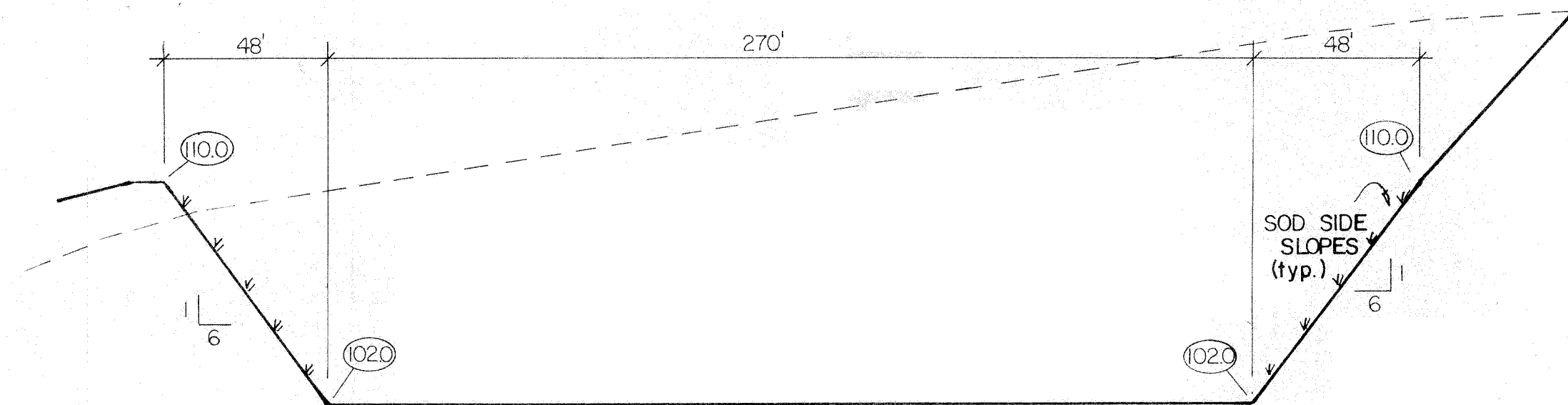

4 SECTION
3 7 SCALE: HORZ. - 1" = 40'
VERT. - 1" = 5'

D.R.A.
No. 2

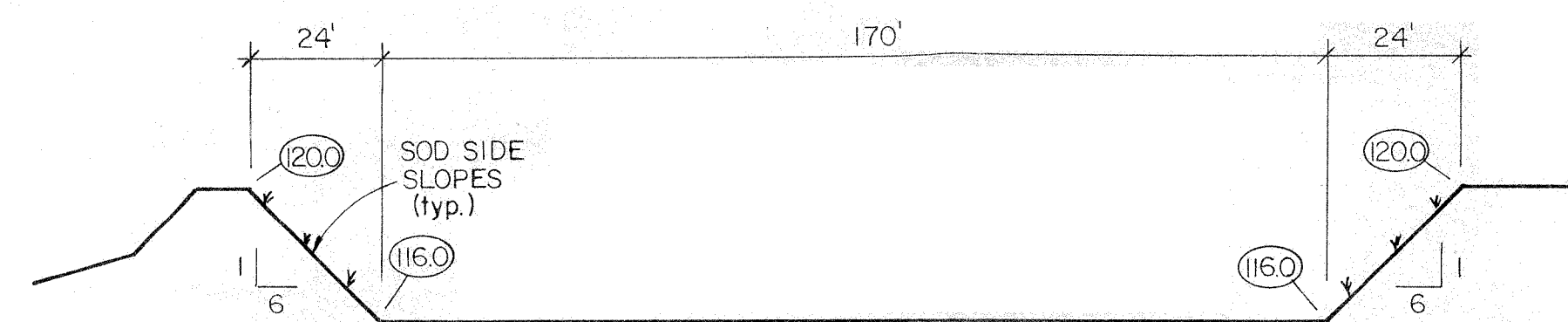

5 SECTION
6 7 SCALE: HORZ. - 1" = 30'
VERT. - 1" = 5'

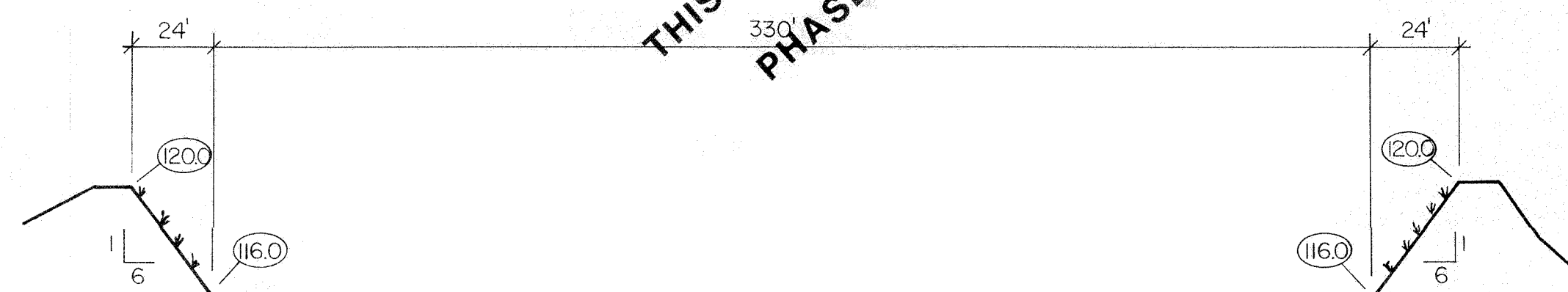

6 SECTION
6 7 SCALE: HORZ. - 1" = 40'
VERT. - 1" = 5'

D.R.A.
No. 3

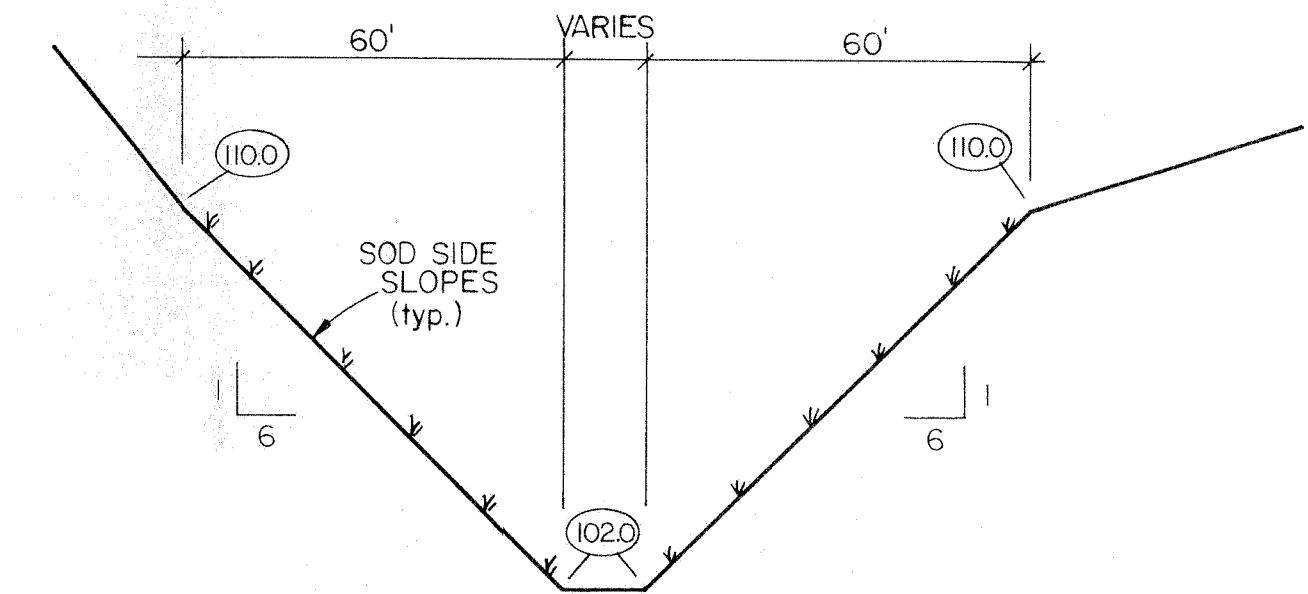

7 SECTION
5 7 SCALE: HORZ. - 1" = 30'
VERT. - 1" = 5'

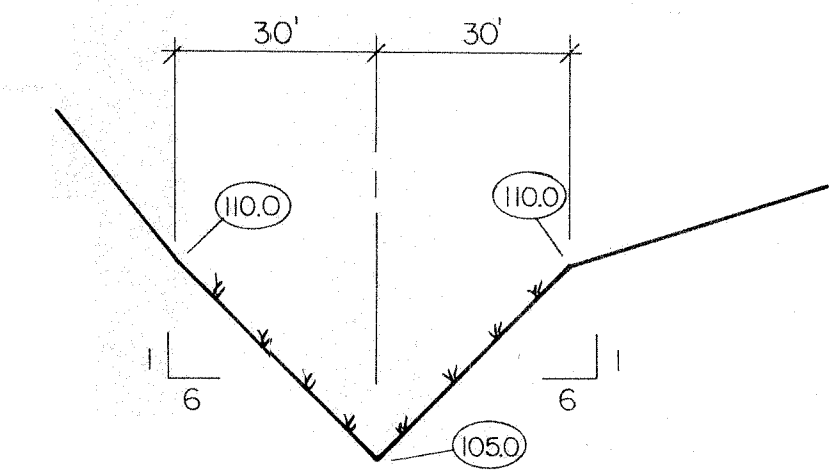

8 SECTION
5 7 SCALE: HORZ. - 1" = 30'
VERT. - 1" = 5'

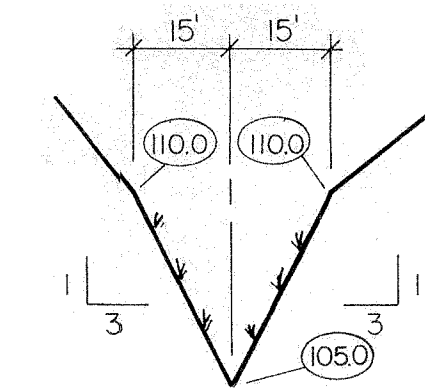

9 SECTION
5 7 SCALE: HORZ. - 1" = 30'
VERT. - 1" = 5'

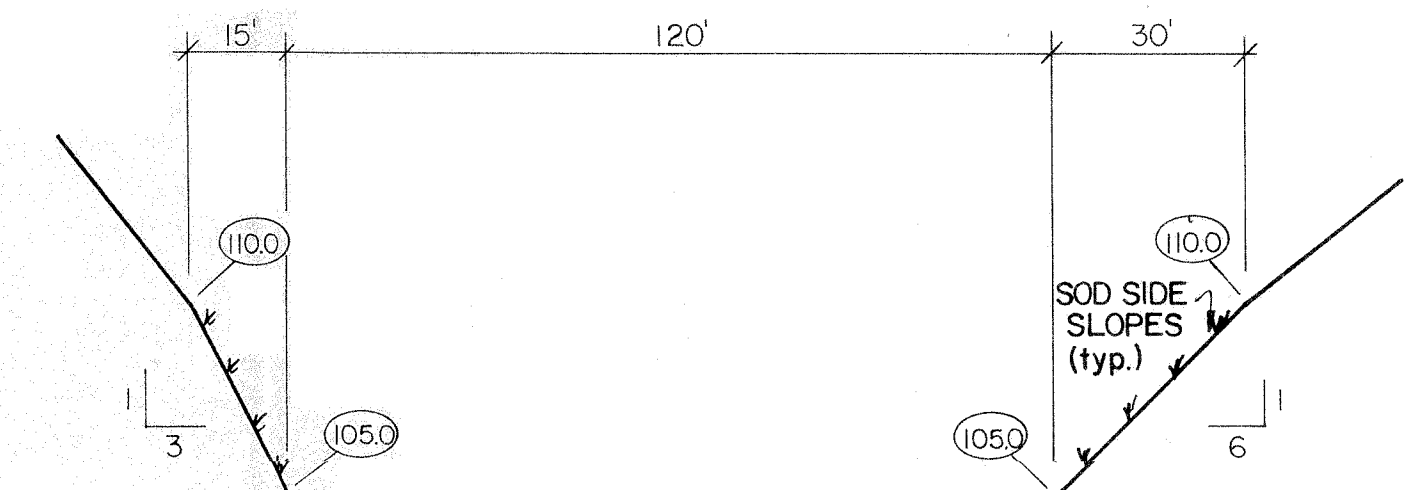

10 SECTION
5 7 SCALE: HORZ. - 1" = 30'
VERT. - 1" = 5'

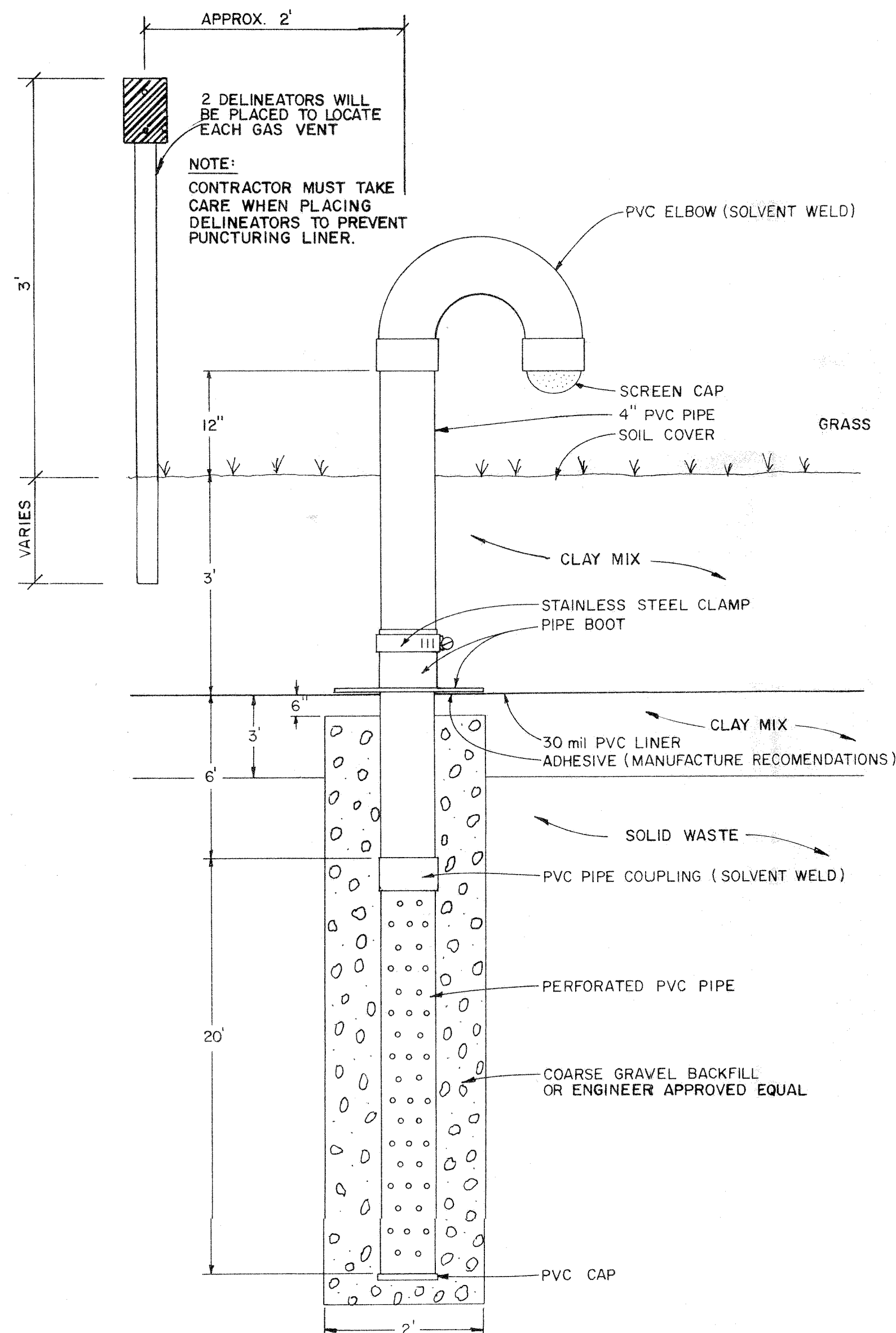

2 GAS VENT
2 7 N.T.S.

REVISIONS						PRELIMINARY		DESIGN	
BY		BY		BY		BY	DATE	BY	DATE
DATE		DATE		DATE					
BY		BY		BY		DRAWN			
DATE		DATE		DATE		DESIGNED			
						CHECKED			

DEPARTMENT OF TECHNICAL SERVICES
CITRUS COUNTY, FLORIDA
ENGINEERING DIVISION



60 Acre Sanitary Landfill Closure
DETAILS

SECTION _____ TOWNSHIP _____ RANGE _____

PROJECT NUMBER	SHEET 7 of 8
SCALE AS NOTED	FILE: _____

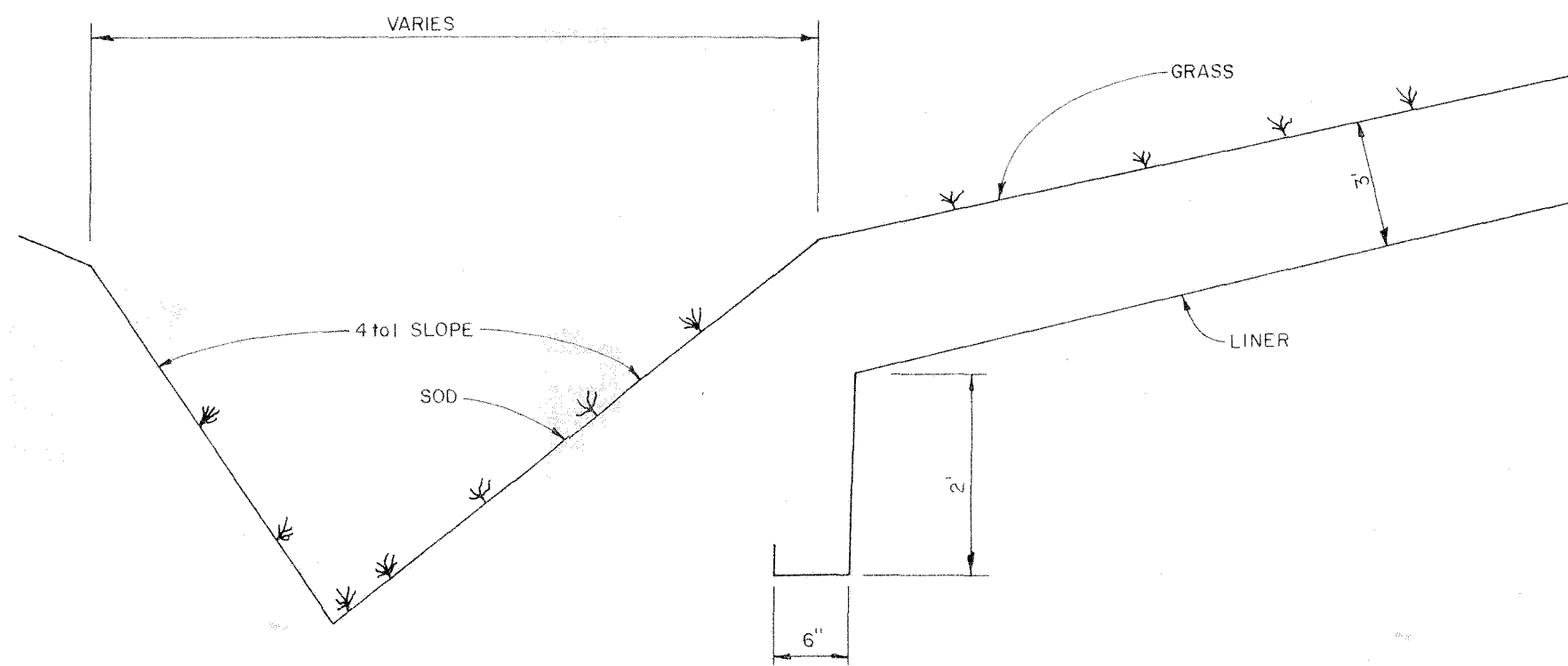

15 TYPICAL ANCHORING & SWALE DETAIL
2/8 N.T.S.

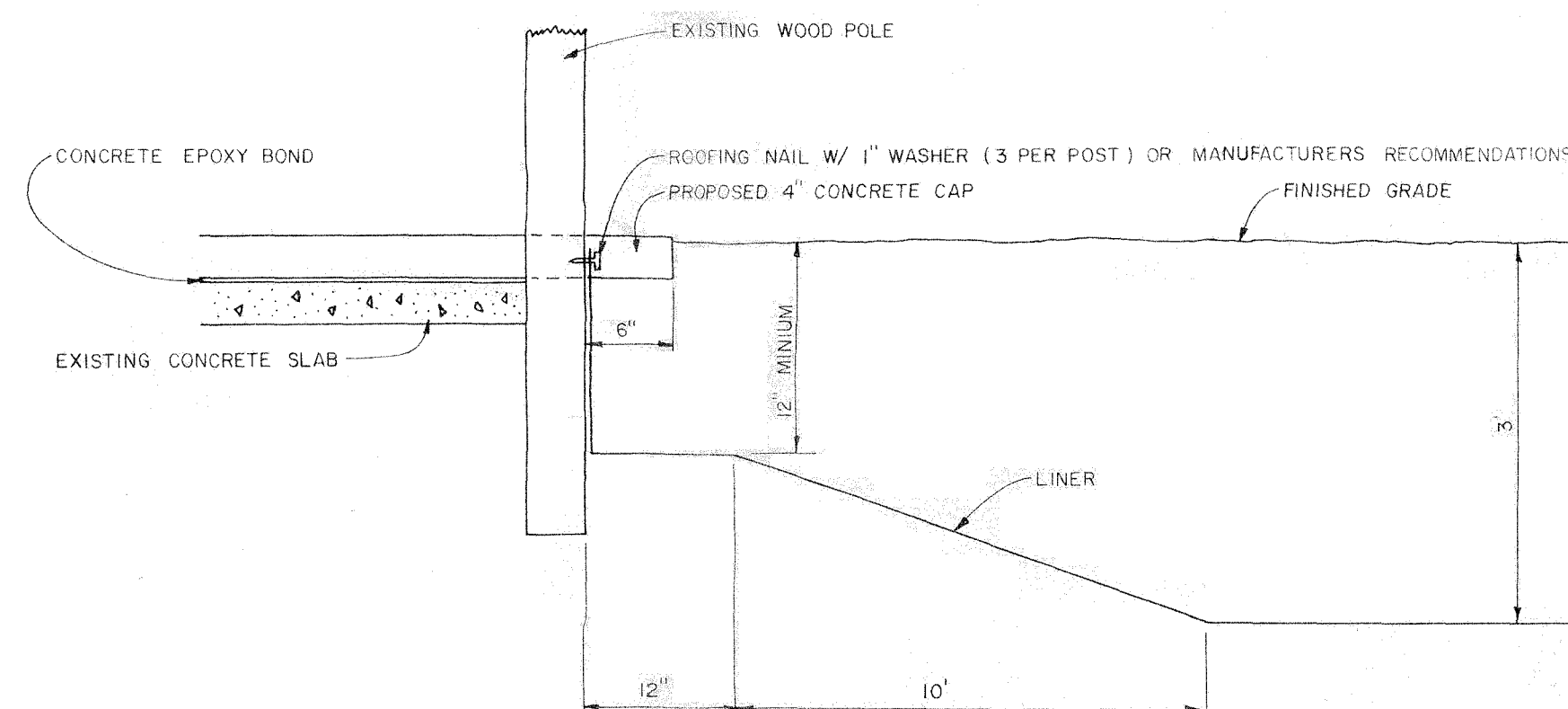

14 LINER CONNECTION DETAIL FOR PISTOL RANGE SHELTER
2/8 N.T.S.

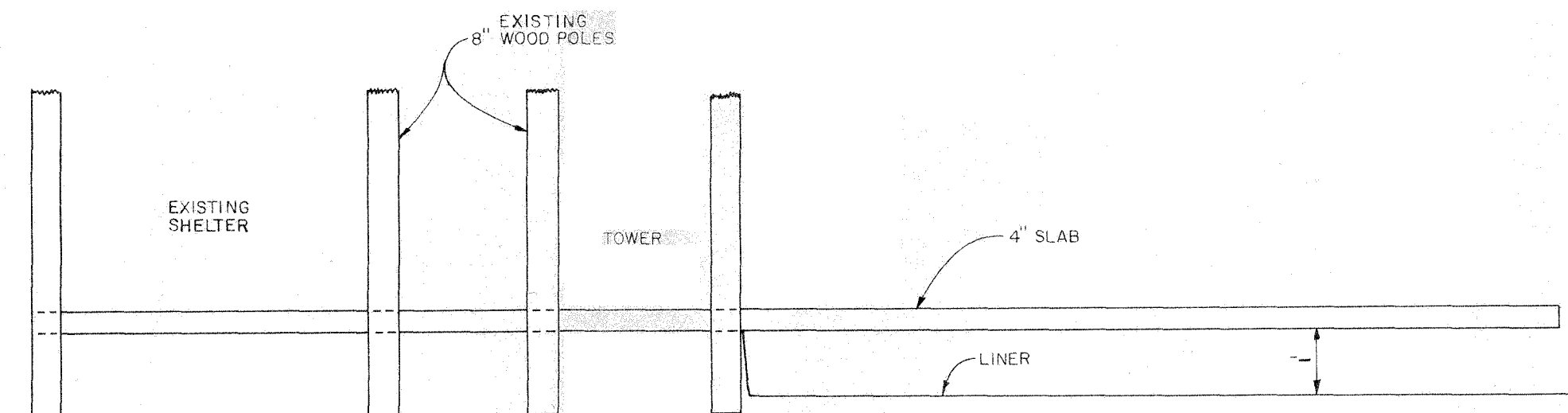

13 PISTOL RANGE CROSS-SECTION
2/8 N.T.S.

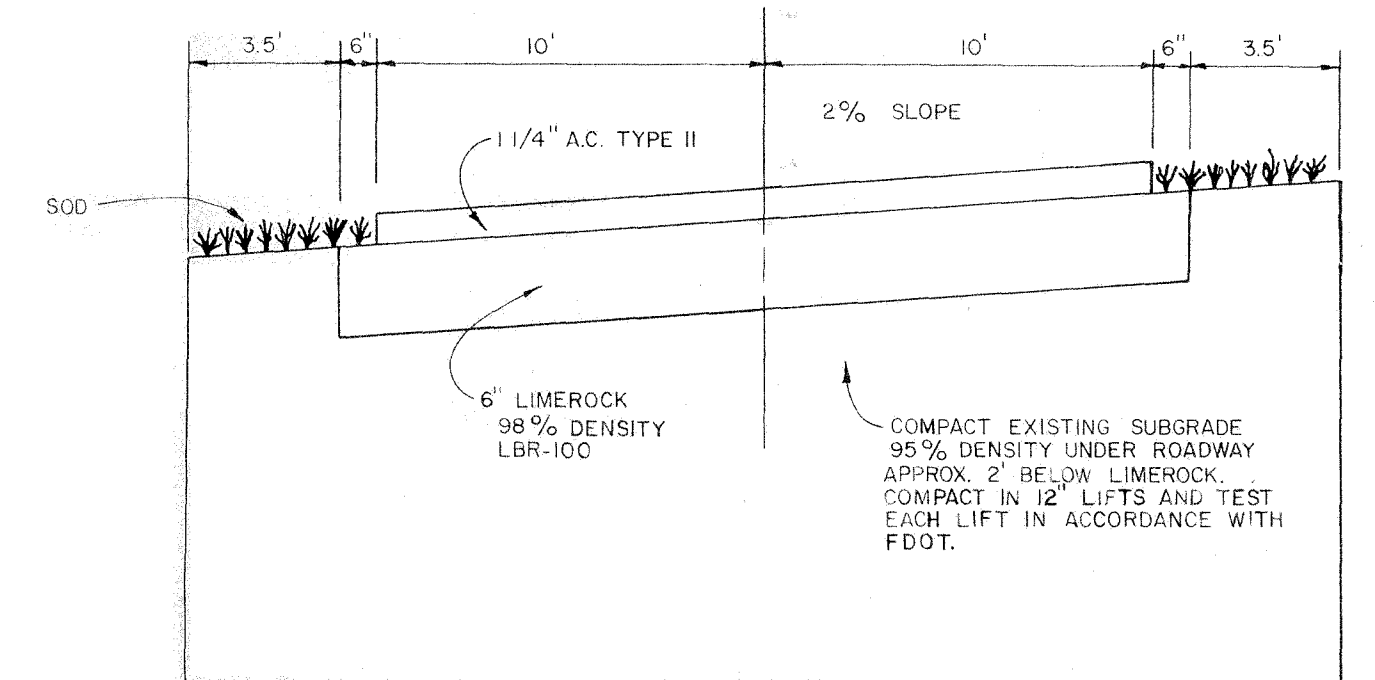

12 ROADWAY TYPICAL SECTION
2/8 N.T.S.

NOTE: CONTRACTOR WILL TAKE PHOTOGRAPHS OF THE PISTOL RANGE PRIOR TO ANY DEMOLITION, FOR A RECORD TO SHOW COMPLETE RESTORATION. AFTER PLACEMENT OF LINER, CONTRACTOR IS RESPONSIBLE FOR ELECTRICAL RESTORATION OF SERVICE LINES TO THE PISTOL RANGE.

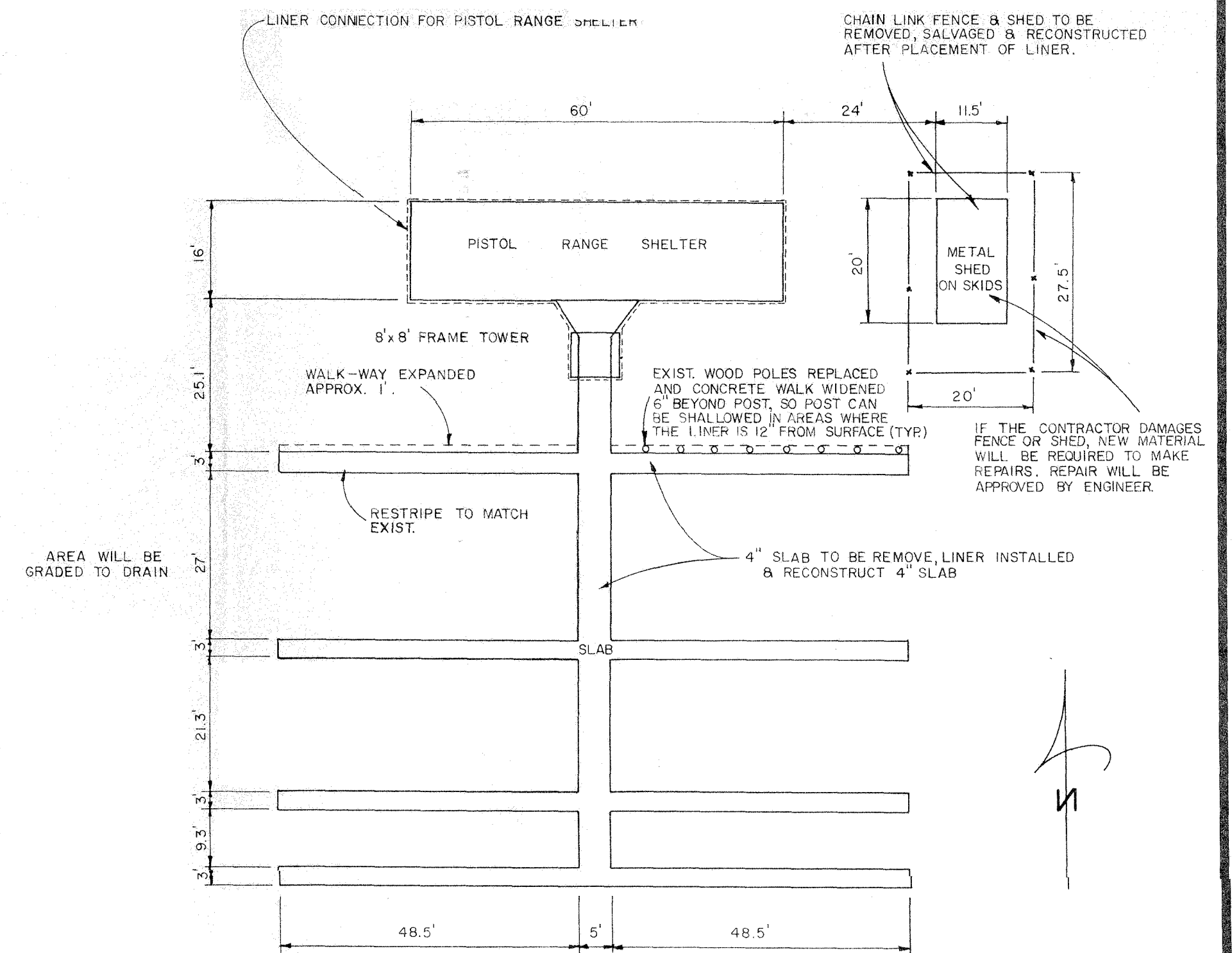

11 PISTOL RANGE
2/8 1"=100'

REVISIONS					
BY		BY		BY	
DATE		DATE		DATE	
BY		BY		BY	
DATE		DATE		DATE	

PRELIMINARY		DESIGN	
BY		BY	
DATE		DATE	
DRAWN			
DESIGNED			
CHECKED			

DEPARTMENT OF TECHNICAL SERVICES
CITRUS COUNTY, FLORIDA
ENGINEERING DIVISION

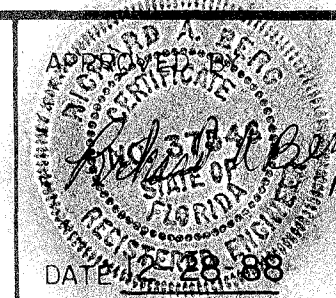

60 Acre Sanitary Landfill Closure
DETAILS

SECTION _____ TOWNSHIP _____ RANGE _____

PROJECT NUMBER	SHEET
SCALE	8 OF 8
AS NOTED	FILE: