

April 3, 1996

Ms. Susan J. Pelz  
Solid Waste Section  
Division of Waste Management  
Department of Environmental Protection  
Southwest District  
3804 Coconut Palm Drive  
Tampa, Florida 33619

**RECEIVED**  
APR - 5 1996

Departu Environmental Protection  
SOUTHWEST DISTRICT  
BY \_\_\_\_\_

40612  
4025C30001

**RE: Hardee County Landfill**  
**Pending Modification #286397 to Permit No. S025-214306**

Dear Ms. Pelz:

Thank you for your review and comments concerning the above referenced permit modification for Hardee County. In response to your letter of March 22, 1996 (included in attachment A), the following comments are provided. Your questions are indicated in bold type followed by our response.

- 1. Please provide an estimated schedule for filling the sequences shown in the drawings submitted. Please provide an estimated schedule for the implementation of the cover/leachate minimization plan, including placement of sod and additional soil.**

It has been determined that the Hardee County Landfill has a remaining capacity of approximately 267,600 cy (excluding final cover) as of September 1995. It is estimated that Hardee County Landfill will reach its final capacity in approximately 9 years based on a bale density of 1750 lbs./bale and an assumed intermediate cover volume of 10% of the waste volume. Based on the sequencing plan provided on Sheet 2 of the drawings, the estimated schedule for filling the sequences is as follows:

Sequence	Volume Available (cy)	Begin Filling Sequence
1	5,400	Upon FDEP approval
2	16,500	3 months after beginning Sequence 1
3	26,200	9 months after beginning Sequence 2
4	85,200	12 months after beginning Sequence 3
5	57,000	27 months after beginning Sequence 4
6	77,300	25 months after beginning Sequence 5



# Department of Environmental Protection

Lawton Chiles  
Governor

Southwest District  
3804 Coconut Palm Drive  
Tampa, Florida 33619

Virginia B. Wetherell  
Secretary

Mr. J.R. Prestridge, County Manager  
Hardee County Department of Solid Waste  
P.O. Box 246  
Wauchula, FL 33873

March 22, 1996

RE: Hardee County Landfill  
Pending Modification #286397 to Permit No. SO25-214306

Dear Mr. Prestridge:

This is to acknowledge receipt of your request to modify the existing operation permit for the solid waste management facility, referred to as the Hardee County Landfill. This letter constitutes notice that a permit will be required for your project pursuant to Chapter(s) 403, Florida Statutes. Your application for a permit modification is incomplete. Please provide the information listed below promptly. Evaluation of your proposed project will be delayed until all requested information has been received.

The following information is needed in support of the solid waste application [Chapter 62-701, Florida Administrative Code (F.A.C.)]:

1. Please provide an estimated schedule for filling the sequences shown in the drawings submitted. Please provide an estimated schedule for the implementation of the cover/leachate minimization plan, including placement of sod and additional soil.
2. It appears that Section D on Sheet 1 should be referenced back to Sheet 2 where the location of the section is shown. Please note the location of the silt fence detail on Sheet 2.
3. Please clarify if the area is graded to drain to stormwater and sodded "when the working area in [a] sequence... is reduced to [the size noted on the plans]...." and the next sequence begins.
4. How often will the silt screens be checked and cleaned?

NOTICE! Pursuant to the provisions of Section 120.60, F.S. and Chapter 62-4.070(5), F.A.C., if the Department does not receive a complete response to this request for information within 30 days of the date of this letter, the Department may issue a final order denying your application. You need to respond within 30 days after the date of this letter, responding to all of the information requests.

You are requested to submit your response to this letter together, as one complete package. If there are points which must be discussed and resolved, please contact me at (813) 744-6100 ext. 386.

Sincerely,

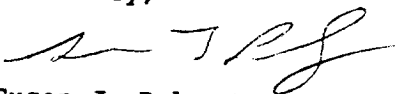
  
Susan J. Pelz, E.I.  
Solid Waste Section  
Division of Waste Management

sjp

cc: C. Edward Hilton, P.E., PBSJ, 1560 Orange Ave., Ste. 700, Winter Park, Fl. 32789  
Robert Butera, P.E., FDEP Tampa  
Steve Morgan, FDEP Tampa

"Protect, Conserve and Manage Florida's Environment and Natural Resources"

Ms. Susan J. Pelz  
April 3, 1996  
Page 2

Sequence 6 is expected to reach capacity approximately 32 months after filling this sequence begins.

Upon receiving approval for this permit modification from the FDEP, the County will initiate the cover/leachate minimization plan immediately.

2. **It appears that Section D on Sheet 1 should be referenced back to Sheet 2 where the location of the section is shown. Please note the location of the silt fence detail on Sheet 2.**

Section D on Sheet 1 was inadvertently referenced back to its own sheet. The detail title target has been revised so that Section D references Sheet 2.

On Sheet 2, a detail label for the silt fence, referencing Sheet 1, has been added to each of the sequences noting their locations.

3. **Please clarify if the area is graded to drain to stormwater and sodded "when the working area in [a] sequence...is reduced to [the size noted on the plans]...and the next sequence begins.**

Filled areas will be closed by placing and grading 12-inches of cover material to drain the rainfall to the existing stormwater management system and placing sod as the next sequence begins operation. The information has been clarified on the sequencing descriptions for the proposed stormwater design presented on Sheet 1 of the drawings.

4. **How often will the silt screens be checked and cleaned?**

The silt screens will be checked each work day and cleaned or replaced as necessary.

If you have any questions or comments regarding this response, please do not hesitate to call.

Sincerely,

C. Edward Hilton

C. Edward Hilton, Jr., P.E.  
Program Manager  
Solid Waste Program

c: J.R. Prestridge, Hardee County  
Bill Telford, PBS&J  
Maureen Mauriello, PBS&J

# **ATTACHMENT A**

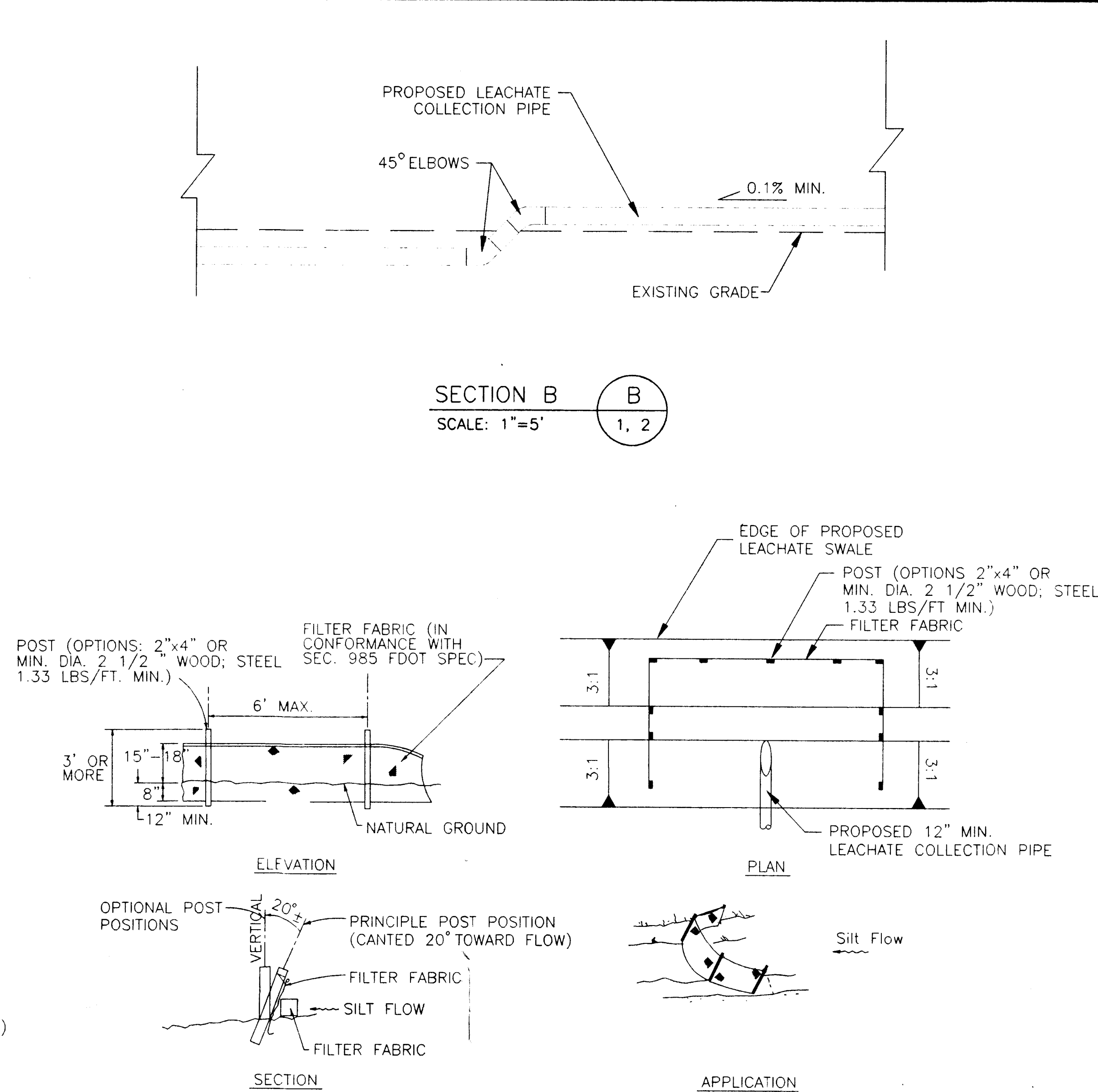
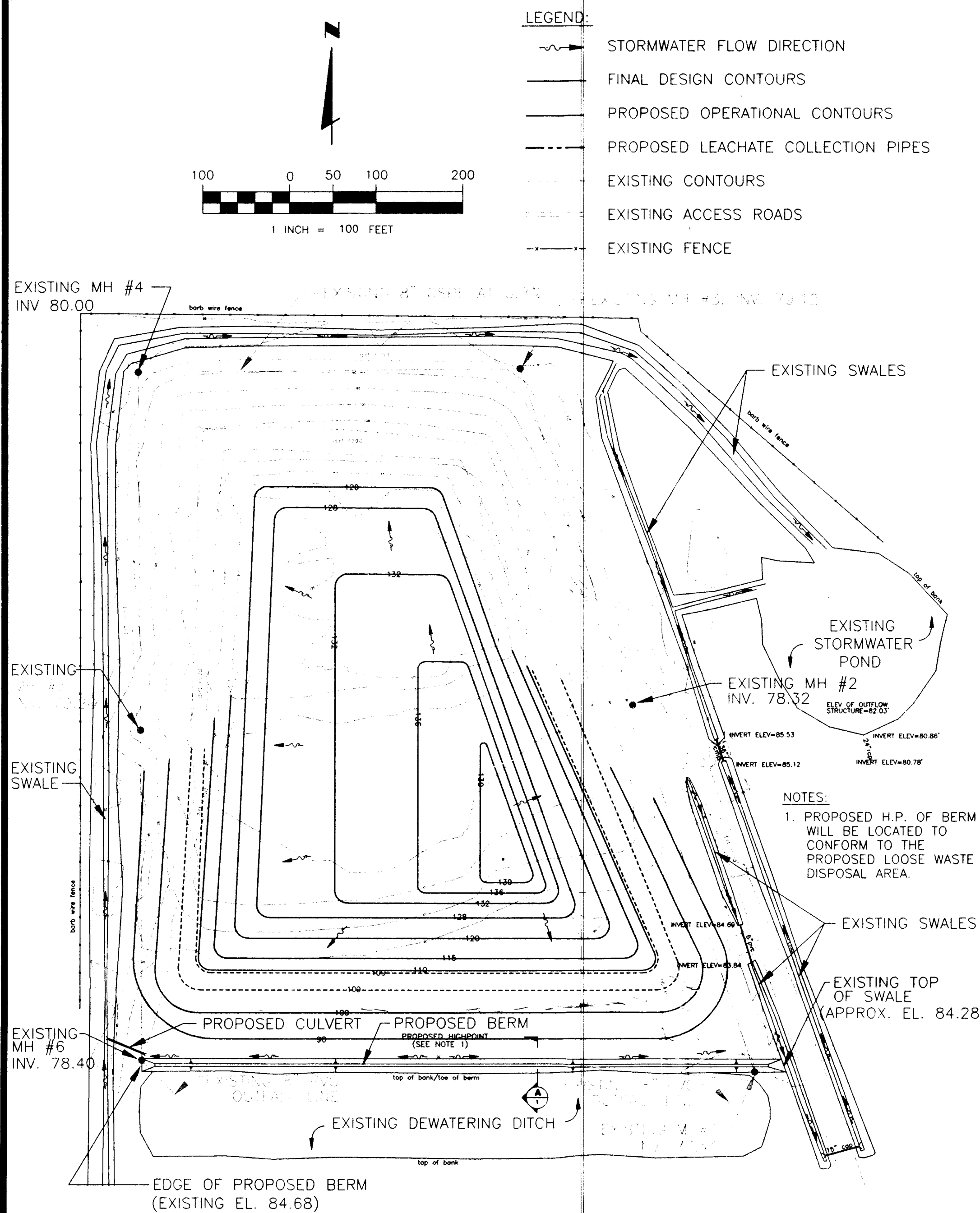

# DESCRIPTION OF PROPOSED STORMWATER DESIGN

## SEQUENCE 1

- CONSTRUCT LEACHATE SWALE AROUND WEST, SOUTH AND EAST SIDES OF WORKING AREA OF LANDFILL TO CAPTURE STORMWATER RUNOFF LEACHATE FROM WORKING AREA. WORKING AREA MAY BE DIVIDED INTO TWO (2) OR MORE SUB-AREAS WITH AN APPROXIMATE WORKING DISTANCE OF 100 FEET FROM PROPOSED SWALE. TEMPORARILY CLOSED LANDFILL AREAS AND SWALE TO BE FULLY SODDED FOR EROSION CONTROL.
- INSTALL TWO (2) 12-INCH (MIN.) LEACHATE COLLECTION PIPES TO CONVEY RUNOFF LEACHATE FROM SOUTHEAST AND SOUTHWEST CORNERS OF WORKING AREA TO EXISTING DEWATERING DITCH. PIPE MATERIAL TO BE SELECTED BY HARDEE COUNTY. PIPE TO FIT FIELD CONDITIONS TO AVOID SURFACE PONDING OF WATER AND TO BE LAID ON TOP OF EXISTING GROUND WITH MINIMAL MOUNDED COVER, WITH TRANSITION TO UNDER EXISTING GROUND NORTH OF BERM DESCRIBED IN STEP 3 BELOW. PIPE FROM SOUTHWEST CORNER TO RUN ALONG NORTHWEST EDGE OF LOOSE WASTE DISPOSAL AREA. INSTALL SILT FENCE AROUND UPSTREAM END OF PIPE IN LEACHATE SWALE FOR EROSION AND SEDIMENT CONTROL.
- CONSTRUCT BERM ALONG NORTHEAST EDGE OF LOOSE WASTE DISPOSAL AREA AND NORTH EDGE OF EXISTING DEWATERING DITCH TO DIVERT STORMWATER RUNOFF FROM NON-WORKING AREA OF LANDFILL AWAY FROM DEWATERING DITCH AND TOWARD EXISTING STORMWATER MANAGEMENT SYSTEM OF SWALES AND CULVERTS DRAINING TO EXISTING STORMWATER POND. NON-WORKING AREAS AND BERM TO BE FULLY SODDED FOR EROSION AND SEDIMENT CONTROL.

## SEQUENCE 2

- WHEN THE WORKING AREA IN SEQUENCE 1 IS REDUCED TO APPROXIMATELY 100 FEET FROM THE LEACHATE SWALE, CLOSE FILLED AREA BY APPLYING 12-INCHES OF COVER MATERIAL, GRADED TO DRAIN RAINFALL TO EXISTING STORMWATER MANAGEMENT SYSTEM, AND SODDING. REMOVE SWALE ADJACENT TO CLOSED LANDFILL AREA AND EXTEND LEACHATE SWALE ADDITIONAL 75 FEET TO SOUTH. SWALE TO EXTEND FAR ENOUGH EAST AND WEST TO PROVIDE COLLECTION OF THE WORKING AREA. SOD NEW SWALE FOR EROSION AND SEDIMENT CONTROL.
- REMOVE SECTION OF EXISTING LEACHATE COLLECTION PIPE BETWEEN EXISTING AND EXTENDED LEACHATE SWALES AND INSTALL SILT FENCE AROUND UPSTREAM END OF PIPE IN LEACHATE SWALE FOR EROSION AND SEDIMENT CONTROL.

## SEQUENCE 3

- SAME AS SEQUENCE 2. ADJUST LEACHATE COLLECTION PIPES TO PROVIDE UPSTREAM END AT LOW POINTS NEAR SOUTHWEST AND SOUTHEAST CORNERS OF PROPOSED SWALE.

## SEQUENCE 4

- SAME AS SEQUENCE 3. ADJUST LEACHATE COLLECTION PIPES TO PROVIDE UPSTREAM END AT LOW POINTS NEAR SOUTHWEST AND SOUTHEAST CORNERS OF PROPOSED SWALE.

## SEQUENCE 5

- WHEN THE WORKING AREA IN SEQUENCE 4 IS REDUCED TO APPROXIMATELY 75 FEET FROM THE LEACHATE SWALE, CLOSE FILLED AREA BY APPLYING 12-INCHES OF COVER MATERIAL, GRADED TO DRAIN RAINFALL TO EXISTING STORMWATER MANAGEMENT SYSTEM, AND SODDING. CONSTRUCT LEACHATE SWALE ALONG EAST AND WEST SIDES OF REMAINING AREA TO DIVERT LEACHATE RUNOFF TO EXISTING DEWATERING DITCH. SOD NEW SWALE TO PROVIDE EROSION AND SEDIMENT CONTROL. IN NON-WORKING AREAS, LEAVE PROPOSED BERM ALONG NORTH SIDE OF DEWATERING DITCH TO DIVERT STORMWATER RUNOFF TO EXISTING STORMWATER MANAGEMENT SWALE, CULVERT AND POND SYSTEM. WORKING AREA TO BE ALLOWED TO DRAIN TO EXISTING DEWATERING DITCH.

## SEQUENCE 6

- WHEN THE SOUTHERNMOST 75 FEET OF WORKING AREA ADJACENT TO EXISTING DEWATERING DITCH IS FILLED, CLOSE BY APPLYING 12-INCHES OF COVER MATERIAL, GRADED TO DRAIN RAINFALL TO EXISTING STORMWATER MANAGEMENT SYSTEM, AND SODDING. CONSTRUCT LEACHATE COLLECTION SWALE ALONG WEST, SOUTH AND EAST SIDES OF REMAINING WORKING AREA. SWALE TO EXTEND TO EAST AND WEST LIMITS OF LANDFILL.
- INSTALL TWO (2) 12-INCH (MIN.) LEACHATE COLLECTION PIPES TO CONVEY RUNOFF LEACHATE FROM SOUTHEAST AND SOUTHWEST CORNERS OF WORKING AREA TO EXISTING DEWATERING DITCH. PIPE MATERIAL TO BE SELECTED BY HARDEE COUNTY. PIPE TO FIT FIELD CONDITIONS TO AVOID SURFACE PONDING OF WATER AND TO BE LAID ON TOP OF GROUND WITH MINIMAL MOUNDED COVER. INSTALL SILT FENCE AROUND EXISTING UPSTREAM END OF PIPE IN LEACHATE SWALE FOR EROSION AND SEDIMENT CONTROL. NON-WORKING AREAS AND BERM TO BE FULLY SODDED FOR EROSION AND SEDIMENT CONTROL.

## FINAL BUILDOUT

- CLOSE FILLED AREA FROM SEQUENCE 6 BY APPLYING 12-INCHES OF COVER MATERIAL, GRADED TO DRAIN RAINFALL TO EXISTING STORMWATER MANAGEMENT SYSTEM, AND SODDING. CONSTRUCT BERM ALONG NORTH EDGE OF EXISTING DEWATERING DITCH TO DIVERT STORMWATER RUNOFF FROM CLOSED LANDFILL BOTH EAST AND WEST TO EXISTING STORMWATER MANAGEMENT SYSTEM OF SWALES AND CULVERTS DRAINING TO EXISTING STORMWATER POND. PROPOSED HIGH POINT OF BERM WILL BE LOCATED TO CONFORM TO FINAL, CLOSED LANDFILL GRADING.
- INSTALL A 12-INCH (MIN.) CULVERT AT THE WEST END OF PROPOSED BERM TO CONVEY DRAINAGE UNDER EXISTING DIRT ROAD TO EXISTING SWALE.

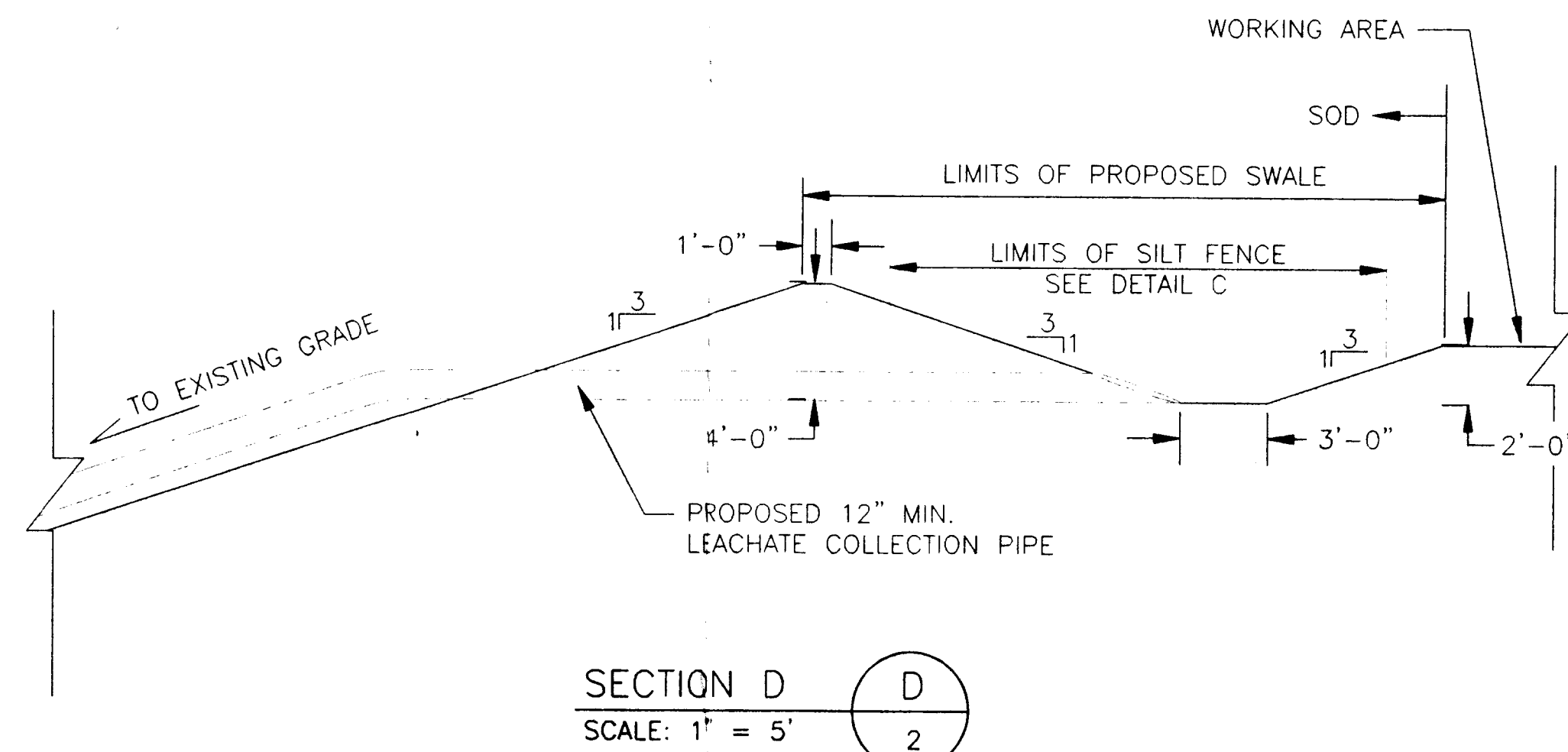
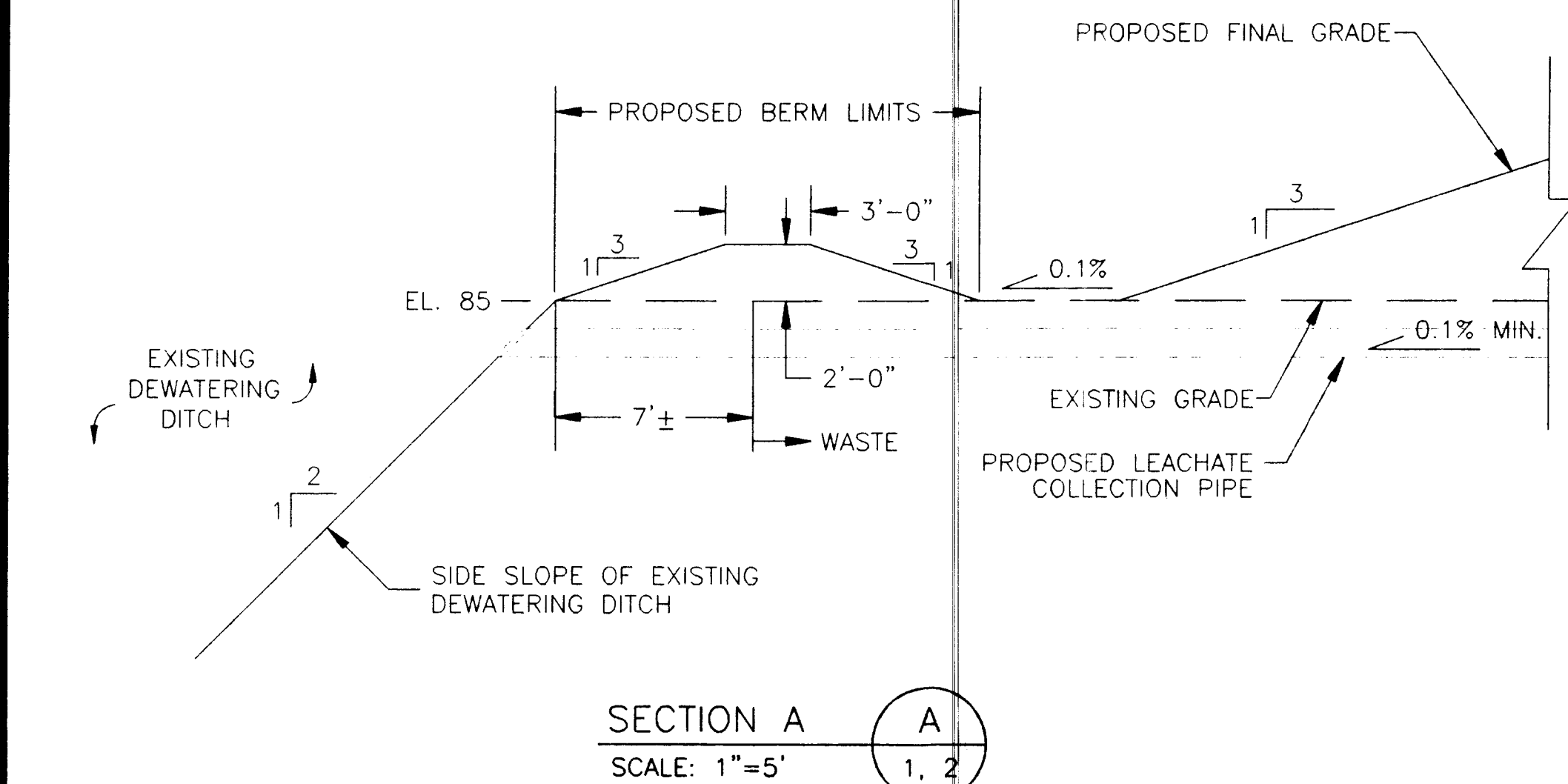

CLIENT  
HARDEE COUNTY  
BOARD OF COUNTY COMMISSIONERS

PROJECT  
HARDEE COUNTY LANDFILL

TASK  
PROPOSED STORMWATER DESIGN  
FINAL BUILDOUT  
AND  
DETAILS

ORIGINAL FEB. 1996  
REVISIONS:  
1 RAI - APRIL 1996  
2  
3  
4  
5

6  
7  
8  
9  
10  
11  
12

JOB NO. 07-862.15  
DRAWN MM  
DESIGN MM  
CHECKED BT  
Q.C. EH

SHEET 1



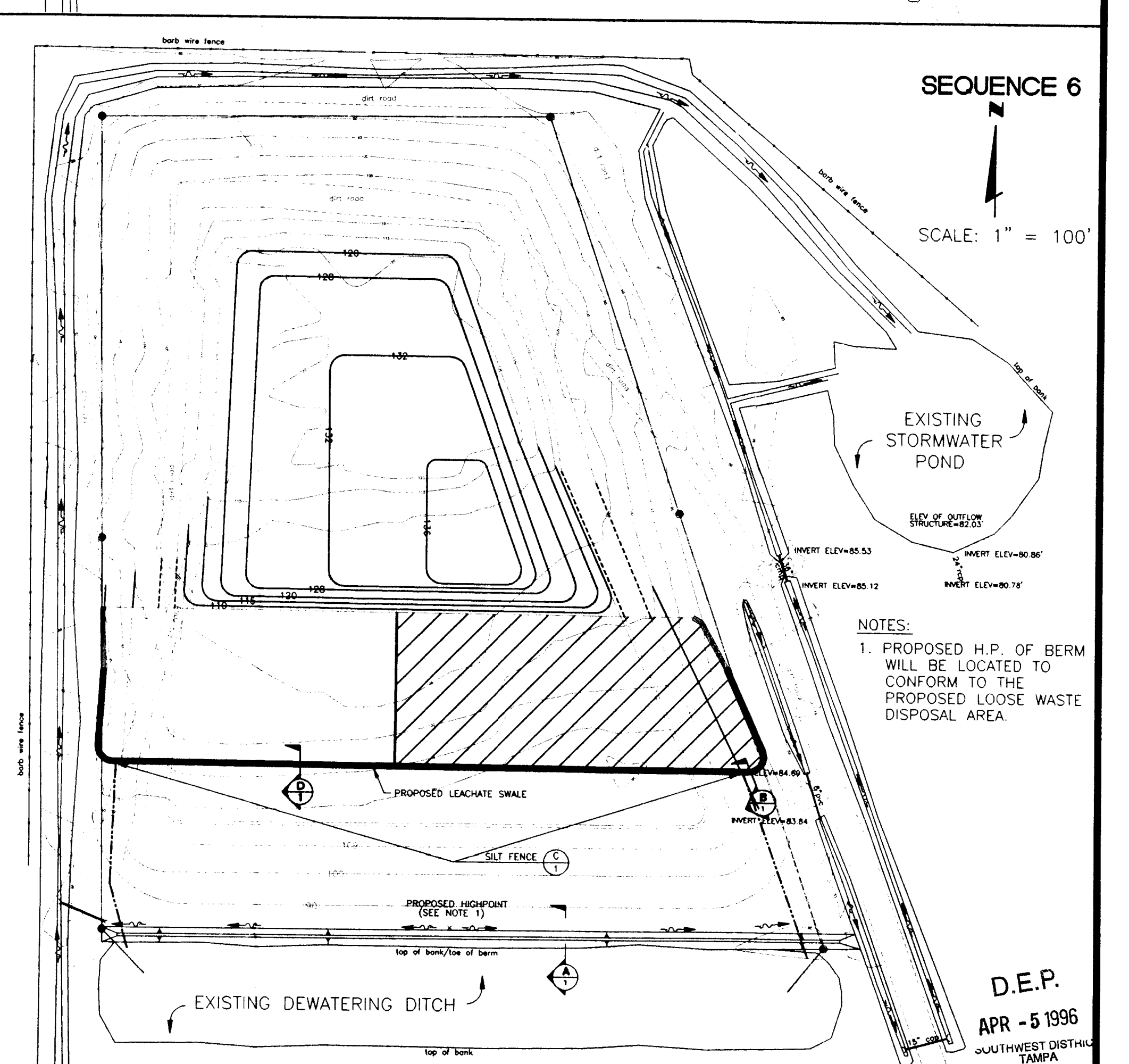
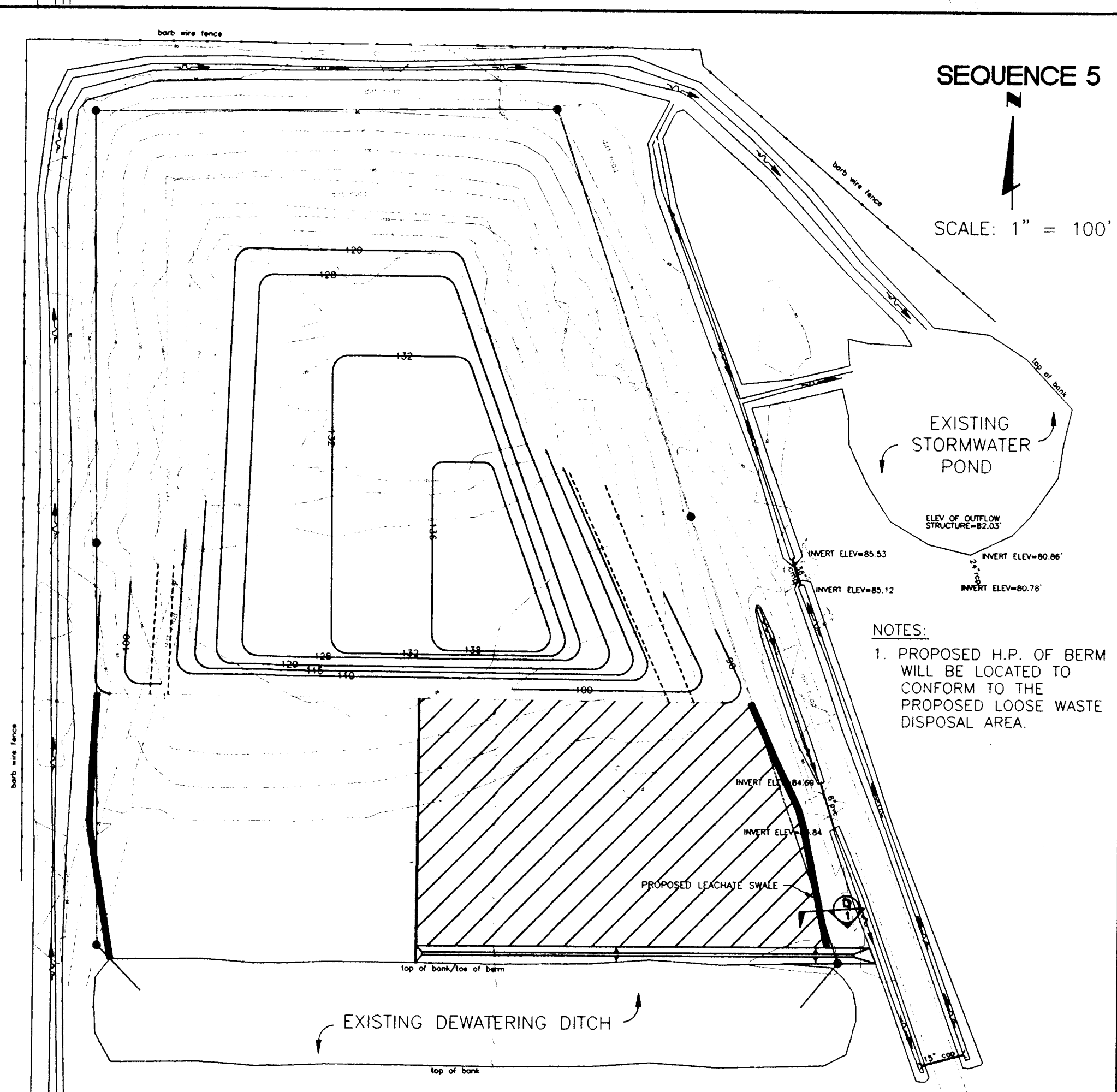
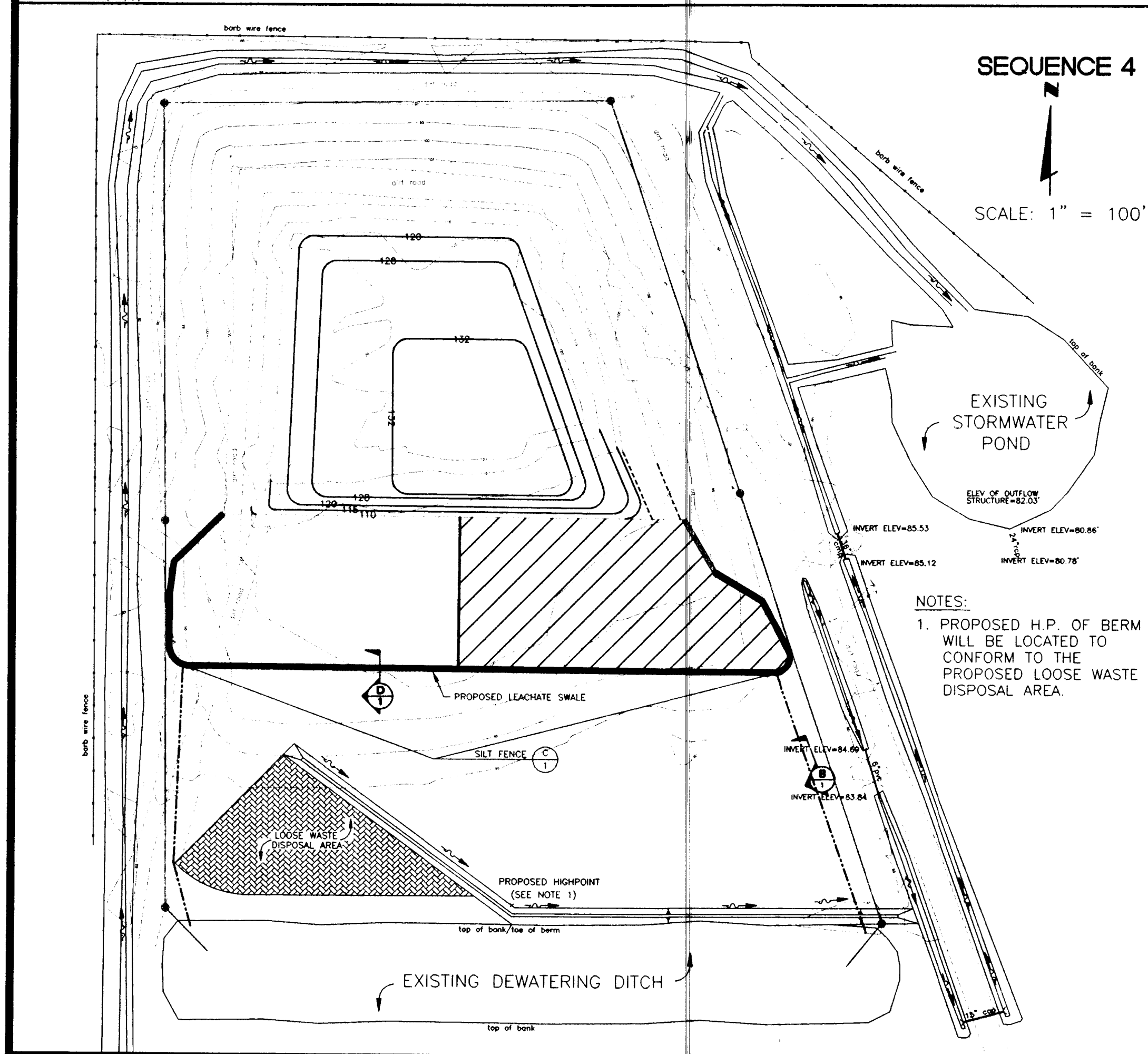
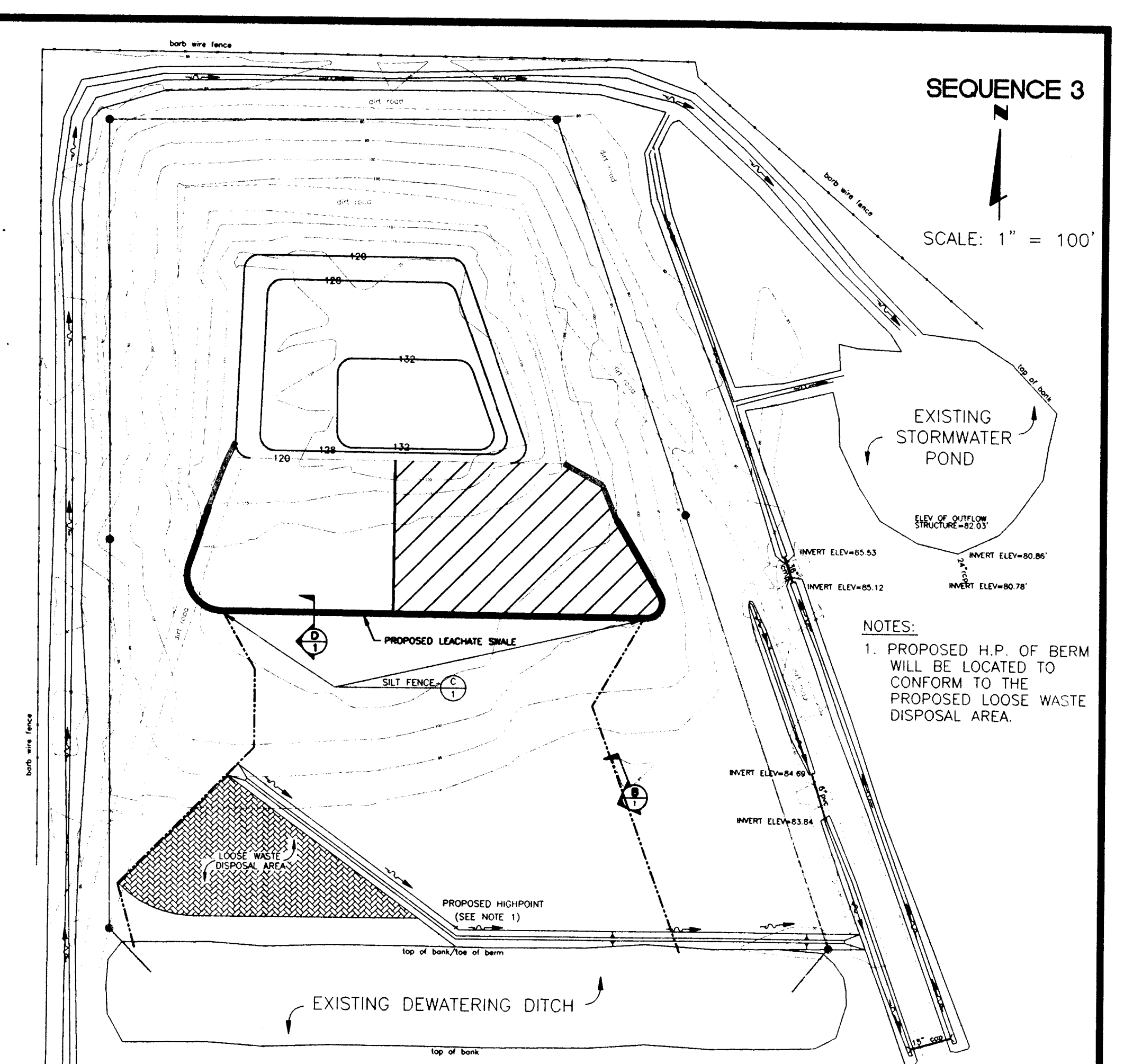
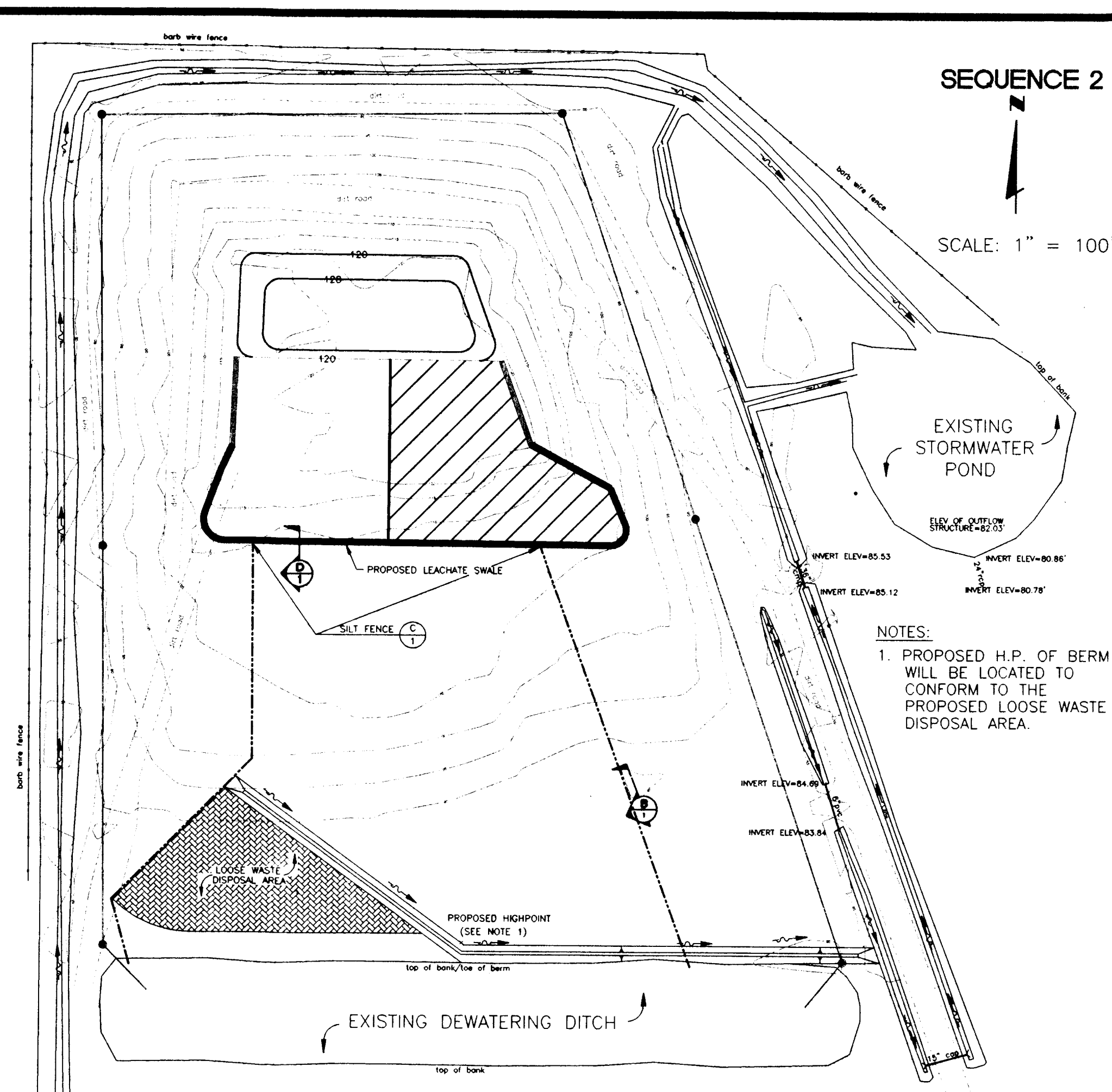
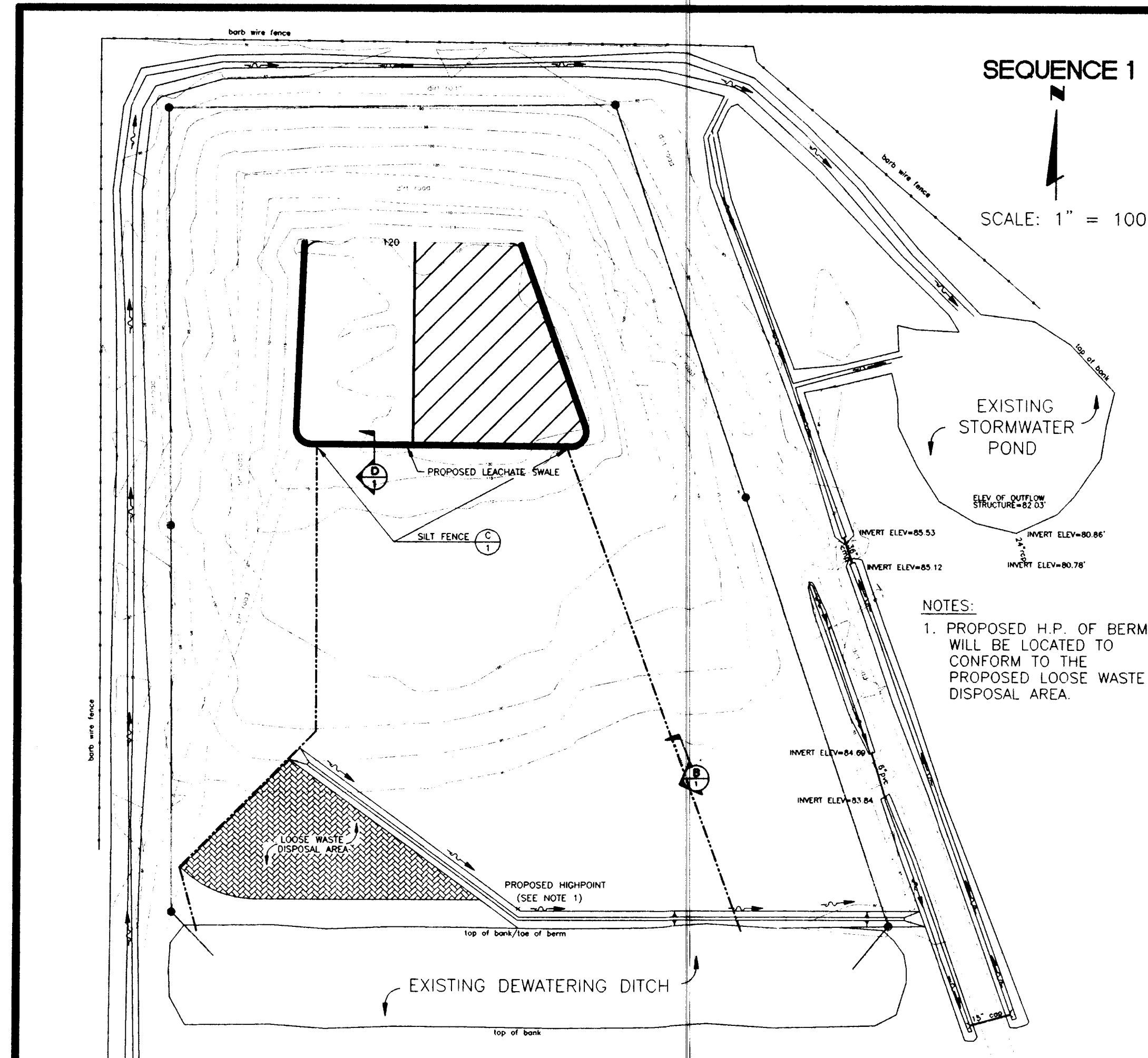

F:\ENV\9853\HARDEE\DWG\STWSEQ.DWG  
13:30:13  
19/06/96  
AutoCAD Release 14.0

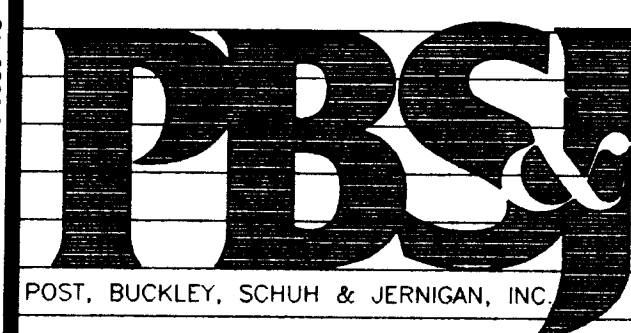

CLIENT  
**HARDEE COUNTY**  
**BOARD OF COUNTY COMMISSIONERS**

PROJECT  
**HARDEE COUNTY LANDFILL**

TASK  
**PROPOSED STORMWATER DESIGN**  
**OPERATIONAL SEQUENCING PLAN**

ORIGINAL FEB. 1996  
REVISIONS:  
1 RAI - APRIL 1996  
2  
3  
4  
5

6  
7  
8  
9  
10  
11  
12

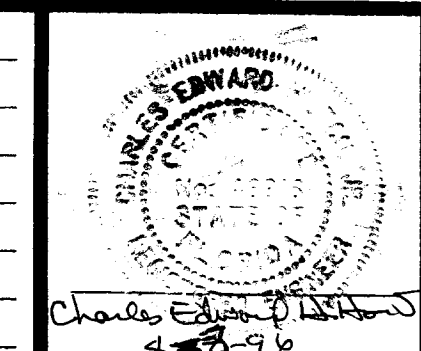

JOB NO. 07-862.15  
DRAWN MM  
DESIGN MM  
CHECKED BT  
Q.C. EH

SHEET 2

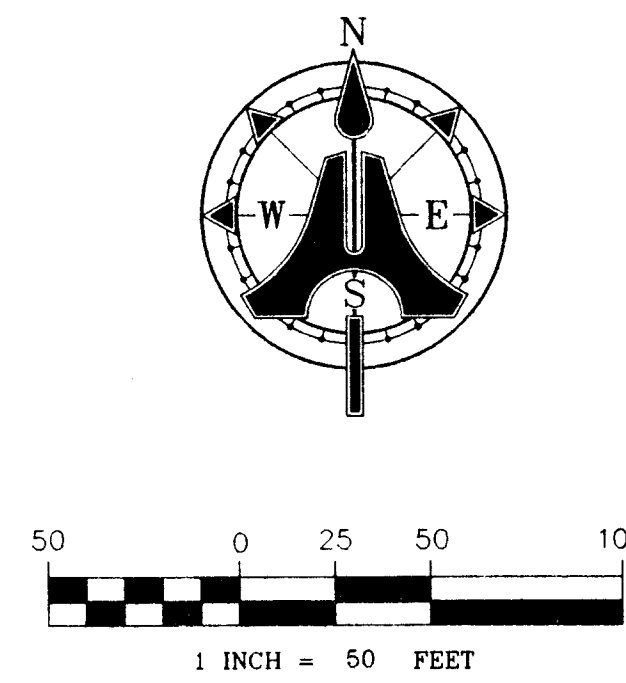
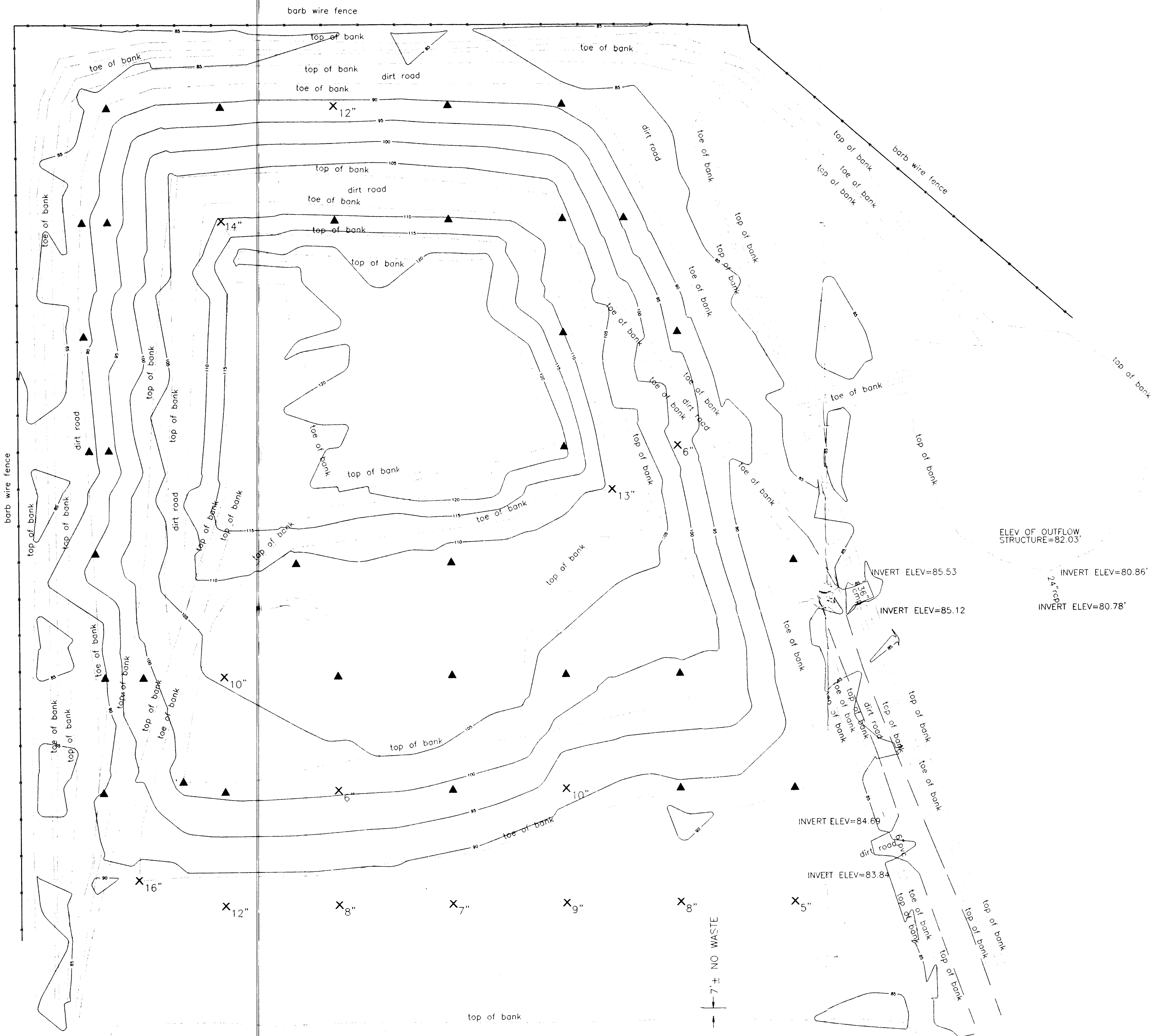

LEGEND:

- ▲ DEPTH OF COVER A MINIMUM OF 18 INCHES
- X<sub>6</sub>" ACTUAL DEPTH OF COVER

D.E.P.

FEB 28 1996

SOUTHWEST DISTRICT  
TAMPA

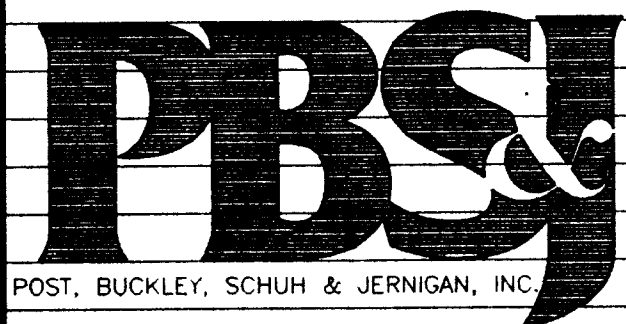

CLIENT	HARDEE COUNTY BOARD OF COUNTY COMMISSIONERS	PROJECT	HARDEE COUNTY LANDFILL	TASK	DEPTH OF COVER FIELD INVESTIGATION	ORIGINAL	DEC. 1995	6		JOB NO. 07-862.15
						REVISIONS:		7		DRAWN MM
						1		8		DESIGN MM
						2		9		CHECKED EH
						3		10		Q.C. SBL
						4		11		
						5		12		SHEET 3

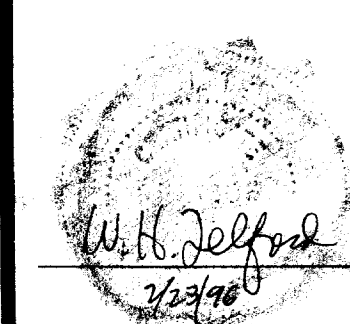

F:\ENVS\862\HARDEE\DWG\COVER.DWG  
MM 12/05/95 14:28:17  
AutoCAD - Release 12

**RECEIVED**

FEB 28 1996

Department of Environmental Protection  
SOUTHWEST DISTRICT

BY \_\_\_\_\_