

270586 (EXPENSION) 100494
includes private wells
GW
SW
LEACH



Hillsborough County
Florida

D.E.P.
APR 15 2004
Southwest District Tampa

ANALYTICAL DATA REPORT FEBRUARY 2004

SOUTHEAST COUNTY LANDFILL SITE HILLSBOROUGH COUNTY, FLORIDA

Hillsborough County
Solid Waste Management Department
Management & Environmental Services Section
P.O. Box 1110
Tampa, Florida 33601

April 8, 2004

FEB 2004
SAMPLING
EVENT

Florida Department of Environmental Protection

Twin Towers Office Bldg. 2600 Blair Stone Road Tallahassee, Florida 32399-2400

DEP Form # 62-522.900(2)
Form Title <u>Ground Water Monitoring Report</u>
Effective Date _____
DEP Application No. _____

GROUND WATER MONITORING REPORT
Rule 62-522.600(11)

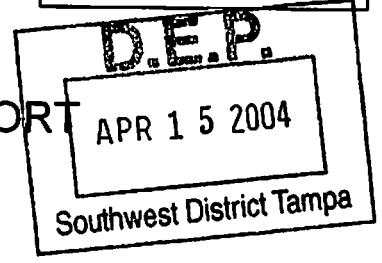

PART I GENERAL INFORMATION

- (1) Facility Name SOUTHEAST LANDFILL
 Address 15960 C. R. 672
 City PICNIC, FL Zip 33503
 Telephone Number (813) 671-7707
- (2) The GMS Identification Number 4029C30075
- (3) DEP Permit Number 35435-006-SO
- (4) Authorized Representative Name DARYL H. SMITH, DIRECTOR, SOLID WASTE MANAGEMENT DEPT
 Address P O BOX 1110
 City TAMPA, FLORIDA Zip 33601
 Telephone Number (813) 276-2900
- (5) Type of Discharge GROUNDWATER - POTENTIAL ONLY
- (6) Method of Discharge LANDFILL

Certification

I certify under penalty of law that I have personally examined and am familiar with the information submitted in this document and all attachments and that, based on my inquiry of those individuals immediately responsible for obtaining the information, I believe that the information is true, accurate, and complete. I am aware that there are significant penalties for submitting false information, including the possibility of fine and imprisonment.

Date: 4/14/04
[Signature]
 Signature of Owner or Authorized Representative

PART II QUALITY ASSURANCE REQUIREMENTS

Sample Organization Comp QAP # _____

Analytical Lab Comp QAP # /HRS Certification # _____

 *Comp QAP # /HRS Certification # _____

Lab Name ELAB, INC

Address 8 E. TOWER CIRCLE , ORMOND BEACH, FL 32174

Phone Number (386) 672-5668

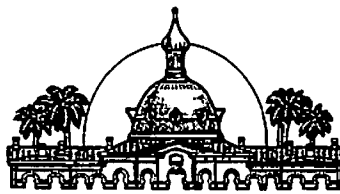

Hillsborough County
Florida

Office of the County Administrator
Patricia G. Bean

BOARD OF COUNTY COMMISSIONERS

Kathy Castor
Pat Frank
Ken Hagan
Jim Norman
Jan K. Platt
Thomas Scott
Ronda Storms

Assistant County Administrators
Bernardo Garcia
Carl S. Harness

April 8, 2004

Mr. John Morris, P.G.
Department of Environmental Protection
Southwest District-Solid Waste Section
3804 Coconut Palm Drive
Tampa, FL 33619-8318

FLORIDA DEPARTMENT OF
ENVIRONMENTAL PROTECTION
APR 15 2004
SOUTHWEST DISTRICT
TAMPA

**Re: Southeast County Landfill
Operations Permit No. 35435-006-SO
Semi-Annual Analytical Data Report, February 2004**

Dear Mr. Morris:

In accordance with the Landfill Operation Permits No. 35435-006-SO and 35435-007-SO, the Hillsborough County Solid Waste Management Department (SWMD) is pleased to provide the February 2004 analytical data report (ADR) for the semi-annual water quality monitoring at the Southeast County Landfill (SCLF). Samples were collected by the SWMD Field Sampling Team on February 9 through February 12, 2004.

The designated background well, TH-36A was sampled during this event for the parameters listed in Specific Condition 36(b) of the Operations Permit for Section 7. This well was inadvertently excluded from the November 10, 2003 sampling of the seven wells installed as part of the new permits.

The water quality observed across the SCLF remains consistent with the historical data set. The surficial aquifer monitoring wells continue to exhibit pH values below the acceptable range of 6.5 to 8.5 pH units. Iron and pH are consistently observed outside of their respective Secondary Drinking Water Standards (SDWS) within the surficial aquifer at the SCLF. The SWMD maintains the position that the iron and pH can be attributable to the previous usages of the property as a phosphate mining area. The violations of the water quality criteria and the overall impact to the future groundwater monitoring activities at the SCLF are discussed in applicable parameter specific details herein.

GENERAL PARAMETERS

pH

The surficial aquifer background and detection monitoring wells continue to indicate pH values below the SDWS acceptable range of 6.5 to 8.5 pH units. The pH values range from 4.48 to 6.27 pH units, and the background water quality well exhibits a value of 5.76 pH units. Surface water sites 3A and 3B2B in Long Flat Creek, and 1-D in Smith Lake exhibit pH values of 5.5, 6.37, and 6.16, respectively. The surface water discharge monitoring point 3C2 exhibited a value of 6.68 pH units. No unusual conditions or changes in pH values within any of the groundwater monitoring wells or surface water sites were observed during this sampling event.

Total Dissolved Solids

Total dissolved solids were observed above the secondary drinking water standard (SDWS) of 500 milligrams per liter (mg/l) in the surficial aquifer detection wells, TH-60 and TH-67 at concentrations of 570 mg/l and 630 mg/l, respectively. All the other groundwater monitoring wells were observed below the SDWS for total dissolved solids during this sampling event.

Radium 226

The Weeks' private supply well indicated concentrations of radium 226 at 6 picocuries per liter (pCi/l), which is above the Primary Drinking Water Standard (PDWS) of 5 pCi/l. This supply well has periodically been observed to exhibit radium 226 slightly above the MCL. No unusual conditions or changes in radium 226 values were observed during this sampling event.

METALS

Iron

Iron concentrations in twelve of the fourteen surficial aquifer monitoring wells were below the applicable SDWS of 0.300 mg/l. The highest concentration for iron was 7.3 mg/l in detection well TH-65. The SCLF private supply wells owned by Weeks and Holland exhibited levels of iron above the SDWS with concentrations of 0.570 mg/l and 1.6 mg/l, respectively. No unusual conditions or changes in iron concentrations within any of the groundwater monitoring wells or surface water samples at the site were observed during this event.

Nickel

Nickel was observed in TH-60 at the SDWS of 0.1 mg/l. The concentration of nickel in this well is lower for this sampling event than the previous sampling conducted on November 10, 2003. This could possibly be due to the lower turbidity value. The turbidity value observed during this event was 5.4 nephelometric turbidity units (NTU) as compared to 30 NTU in November. The

Mr. John Morris, P.G.
April 8, 2004
Page 3

possible correlation between the Nickel concentrations and turbidity values in this well will continue to be evaluated in the next sampling event scheduled for August 2004.

Turbidity

In accordance with the April 3, 2003 Approval of Corrective Action Plan letter from the Florida Department of Environmental Protection (FDEP), the SWMD has included the recorded turbidity data for the period from September 2003 to February 2004. A summary table of the turbidity data obtained from the surface water sampling points 3A, 3B2B and 3C2 located in Long Flat Creek is provided within this ADR. All of the turbidity measurements have been within the compliance level of 29 nephelometric turbidity units (NTU) above the background level. It continues to be apparent that the implementation of the stormwater improvement plan has been effective in reducing the turbidity entering Long Flat Creek. Future reporting of turbidity readings recorded at the SCLF shall continue to be submitted within each semi-annual ADR.

Enclosed for your review is a detailed site location map, the analytical data summary tables, a groundwater elevation data summary table, a surficial aquifer groundwater elevation contour diagram, a data summary table of turbidity monitoring, copies of the letters sent to the owners of the private wells, a data summary table for the private wells, and the complete laboratory analytical data report sheets.

Should you have any questions or require any additional information, please feel free to contact me at (813) 276-2944 or via e-mail at adamds@hillsboroughcounty.org.

Sincerely,

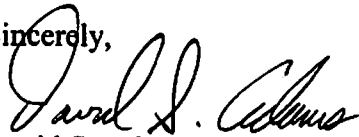

David S. Adams, P.G.
Environmental Manager
Solid Waste Management

4/8/04

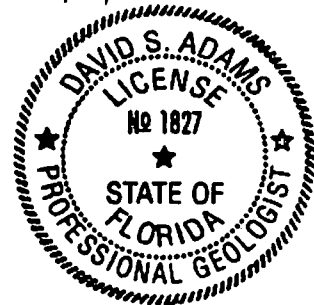

DSA/mdt

Enclosures

- xc: Daryl Smith, Director, SWMD, w/o enclosures
Patricia Berry, Section Manager, SWMD, w/o enclosures
Matt Matthews, Landfill Manager, SWMD
Ernest Ely, Landfill Manager, WM, Southeast Landfill
Carolyn McCreedy, Engineer, WM, Southeast Landfill
Larry Ruiz, Project Manager, SCS Engineers
Chongman Lee, Department of Environmental Protection
Paul Schipfer, Environmental Protection Commission
Irene Barnes, Southeast Hillsborough Civic Association

H:\USERS\Enviro\Projects\Acad\self\stfemap_scs1-04.dwg Apr 12, 2004 - 10:26am Layout Name: MW Locations-Proposed By: Administrator

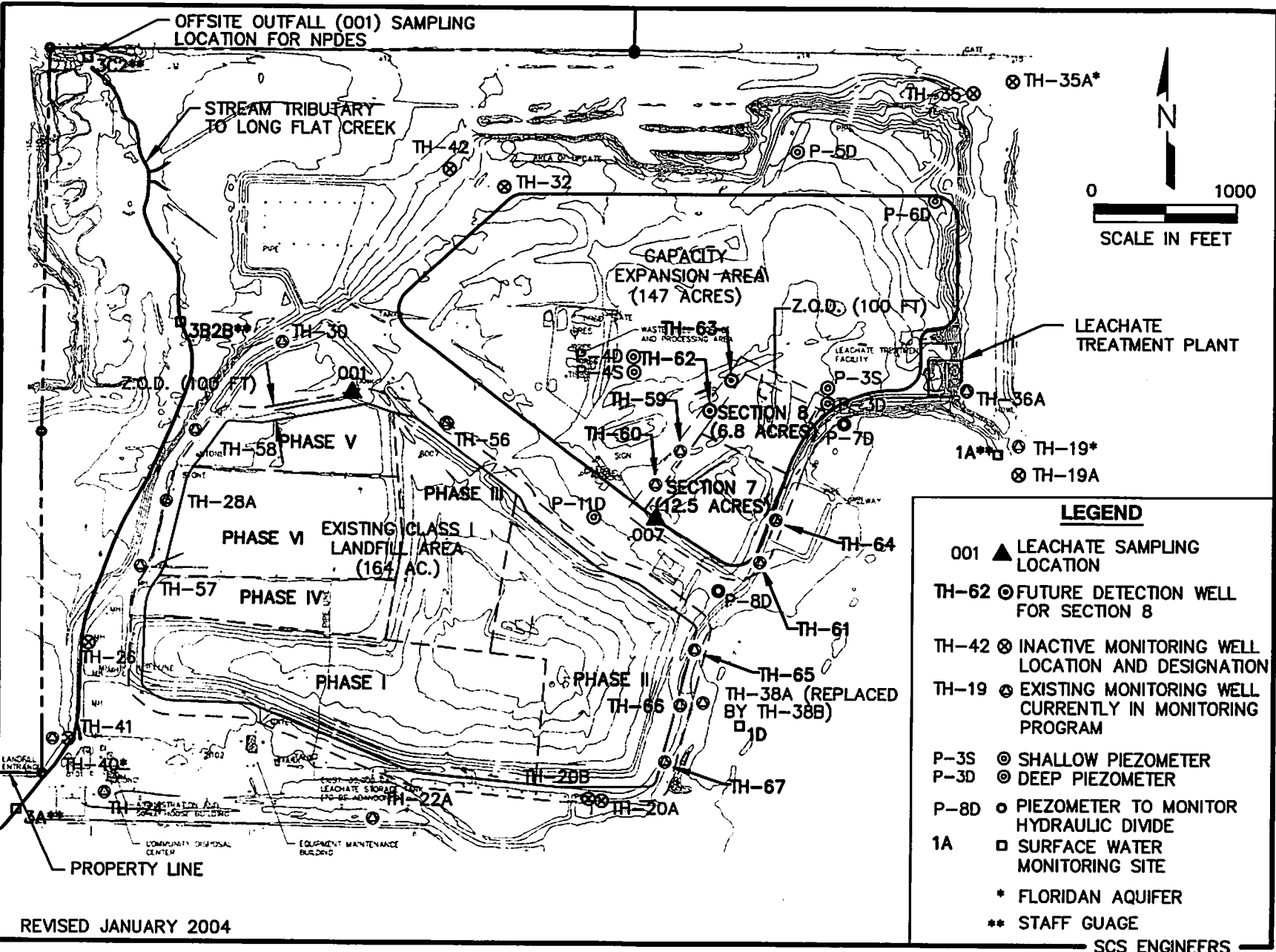

Figure M-1. Location of Monitoring Wells, Piezometers, and Surface Water Sampling Points Southeast County Facility, Hillsborough County, Florida

Southeast Landfill App. 2

PARAMETER MONITORING REPORT

Ground Water (Rule 62-520.400, .420, .460)

Surface Water (Rule 62-302.500, .510, .503)

Leachate (Rule 62-701.510)

LAB Submission Number: F04020263

Sample Number: F04020263-003



Facility WACS:	35435-006-SO	Sample Date/Time:	2/9/2004 2:00:00 PM
Well/Sampling Point WACS:	Leachate Sump	Report Period:	1st Semiannual 2004
Well/Sampling Point Name:	Leachate Sump	Well Purged:	YES
Classification of Groundwater:	G-II	Well Type:	Leachate
Ground Water Elevation: (NGVD):			

Storet Code	Parameter Monitored	Sampling Method	Filtered Y/N	Analysis Method	Analysis Date	Analysis Result	Q	Units	Detection Limits
FIELD									
	Color	Grab	N	FLD	2/9/2004	light brown			
	Conductivity	Grab	N	FLD	2/9/2004	11988		umhos/c	
	Dissolved Oxygen	Grab	N	FLD	2/9/2004	0.33		mg/L	
	pH	Grab	N	FLD	2/9/2004	6.86		S.U.	
	Temperature	Grab	N	FLD	2/9/2004	33.55		deg C	
INORGANICS									
00095	Conductance, Specific	Grab	N	E120.1	2/10/2004	11300		µmhos/c	1.00
70300	Solids, Total Dissolved	Grab	N	E160.1	2/11/2004	5800	*	mg/L	1.2
00940	Chloride	Grab	N	E300.0	2/10/2004	2700	*	mg/L	2.0
00620	Nitrogen, Nitrate	Grab	N	E300.0	2/10/2004	0.32	U	mg/L	0.32
00610	Nitrogen, Ammonia (As N)	Grab	N	E350.1	2/13/2004	280	*V	mg/L	0.20
00440	Alkalinity, Bicarbonate (As CaCO3)	Grab	N	SM2320	2/13/2004	2500		mg/L	0.16
00720	Cyanide	Grab	N	SW9012	2/20/2004	0.0050	I	mg/L	0.0030
00745	Sulfide	Grab	N	SW9034	2/12/2004	2.4		mg/L	0.32
METALS									
01002	Arsenic	Grab	N	SW6010	2/11/2004	11		µg/L	2.0
01007	Barium	Grab	N	SW6010	2/11/2004	26		µg/L	0.074
01012	Beryllium	Grab	N	SW6010	2/11/2004	0.12	U	µg/L	0.12
01027	Cadmium	Grab	N	SW6010	2/11/2004	0.30	I	µg/L	0.24
01034	Chromium	Grab	N	SW6010	2/11/2004	8.4		µg/L	0.60
01037	Cobalt	Grab	N	SW6010	2/11/2004	20		µg/L	1.5
01042	Copper	Grab	N	SW6010	2/11/2004	9.2		µg/L	0.58
01045	Iron	Grab	N	SW6010	2/11/2004	13000	*	µg/L	13
01051	Lead	Grab	N	SW6010	2/11/2004	1.8	U	µg/L	1.8
01067	Nickel	Grab	N	SW6010	2/11/2004	59		µg/L	2.0
01147	Selenium	Grab	N	SW6010	2/11/2004	4.0	U	µg/L	4.0
01077	Silver	Grab	N	SW6010	2/11/2004	4.8	I	µg/L	1.4
00929	Sodium	Grab	N	SW6010	2/16/2004	2000000	*	µg/L	1100
01102	Tin	Grab	N	SW6010	2/11/2004	2.7	U	µg/L	2.7
01087	Vanadium	Grab	N	SW6010	2/11/2004	22		µg/L	0.40

Data Qualifier Code Key: * Value exceeds Maximum Contaminant Level
 L Value above quantitation range
 U Not Detected Above the MDL
 I Analyte detected below quantitation limits
 S Spike Recovery outside accepted recovery limits
 V Analyte detected in the associated Method Blank

Southeast Landfill App. 2

PARAMETER MONITORING REPORT

Ground Water (Rule 62-520.400, .420, .460)

Surface Water (Rule 62-302.500, .510, .503)

Leachate (Rule 62-701.510)

LAB Submission Number: F04020263

Sample Number: F04020263-003



Facility WACS:	35435-006-SO	Sample Date/Time:	2/9/2004 2:00:00 PM
Well/Sampling Point WACS:	Leachate Sump	Report Period:	1st Semiannual 2004
Well/Sampling Point Name:	Leachate Sump	Well Purged:	YES
Classification of Groundwater:	G-II	Well Type:	Leachate
Ground Water Elevation: (NGVD):			

Storet Code	Parameter Monitored	Sampling Method	Filtered Y/N	Analysis Method	Analysis Date	Analysis			Detection Limits
						Result	Q	Units	
39500	Aroclor 1248	Grab	N	SW8082	2/12/2004	0.13	U	µg/L	0.13
39504	Aroclor 1254	Grab	N	SW8082	2/12/2004	0.10	U	µg/L	0.10
39508	Aroclor 1260	Grab	N	SW8082	2/12/2004	0.11	U	µg/L	0.11
	Chlorfenvinphos	Grab	N	SW8141	2/12/2004	0.22	U	µg/L	0.22
46314	Dimethoate	Grab	N	SW8141	2/12/2004	0.14	U	µg/L	0.14
81888	Disulfoton	Grab	N	SW8141	2/12/2004	0.20	U	µg/L	0.20
38462	Famphur	Grab	N	SW8141	2/12/2004	0.22	U	µg/L	0.22
39540	Parathion, Ethyl	Grab	N	SW8141	2/12/2004	0.34	U	µg/L	0.34
39600	Parathion, Methyl	Grab	N	SW8141	2/12/2004	0.19	U	µg/L	0.19
46313	Phorate	Grab	N	SW8141	2/12/2004	0.38	U	µg/L	0.38
39730	2,4-D	Grab	N	SW8151	2/19/2004	0.15	U	µg/L	0.15
81287	Dinoseb	Grab	N	SW8151	2/19/2004	0.090	U	µg/L	0.090
39032	Pentachlorophenol	Grab	N	SW8151	2/19/2004	0.030	U	µg/L	0.030
39740	2,4,5-T	Grab	N	SW8151	2/19/2004	0.020	U	µg/L	0.020
39760	2,4,5-TP (Silvex)	Grab	N	SW8151	2/19/2004	0.030	U	µg/L	0.030
81552	Acetone	Grab	N	SW8260	2/12/2004	0.91	U	µg/L	0.91
76997	Acetonitrile	Grab	N	SW8260	2/12/2004	2.4	U	µg/L	2.4
34210	Acrolein	Grab	N	SW8260	2/12/2004	2.0	U	µg/L	2.0
34215	Acrylonitrile	Grab	N	SW8260	2/12/2004	0.93	U	µg/L	0.93
78109	Allyl chloride	Grab	N	SW8260	2/12/2004	0.12	U	µg/L	0.12
34030	Benzene	Grab	N	SW8260	2/12/2004	2.8	U	µg/L	0.31
73085	Bromochloromethane	Grab	N	SW8260	2/12/2004	0.22	U	µg/L	0.22
32101	Bromodichloromethane	Grab	N	SW8260	2/12/2004	0.10	U	µg/L	0.10
32104	Bromoform	Grab	N	SW8260	2/12/2004	0.11	U	µg/L	0.11
34413	Bromomethane	Grab	N	SW8260	2/12/2004	0.12	U	µg/L	0.12
81595	2-Butanone	Grab	N	SW8260	2/12/2004	0.29	U	µg/L	0.29
77041	Carbon disulfide	Grab	N	SW8260	2/12/2004	0.25	U	µg/L	0.25
32102	Carbon tetrachloride	Grab	N	SW8260	2/12/2004	0.25	U	µg/L	0.25
34301	Chlorobenzene	Grab	N	SW8260	2/12/2004	3.7	U	µg/L	0.10
34311	Chloroethane	Grab	N	SW8260	2/12/2004	0.16	U	µg/L	0.16
32106	Chloroform	Grab	N	SW8260	2/12/2004	0.28	U	µg/L	0.28
34418	Chloromethane	Grab	N	SW8260	2/12/2004	0.31	U	µg/L	0.31
81520	Chloroprene	Grab	N	SW8260	2/12/2004	0.27	U	µg/L	0.27

Data Qualifier Code Key:	* Value exceeds Maximum Contaminant Level	I Analyte detected below quantitation limits
	L Value above quantitation range	S Spike Recovery outside accepted recovery limits
	U Not Detected Above the MDL	V Analyte detected in the associated Method Blank



Southeast Landfill App. 2

PARAMETER MONITORING REPORT

Ground Water (Rule 62-520.400, .420, .460)

Surface Water (Rule 62-302.500, .510, .503)

Leachate (Rule 62-701.510)

LAB Submission Number: F04020263

Sample Number: F04020263-003

Facility WACS:	35435-006-SO	Sample Date/Time:	2/9/2004 2:00:00 PM
Well/Sampling Point WACS:	Leachate Sump	Report Period:	1st Semiannual 2004
Well/Sampling Point Name:	Leachate Sump	Well Purged:	YES
Classification of Groundwater:	G-II	Well Type:	Leachate
Ground Water Elevation: (NGVD):			

Storet Code	Parameter Monitored	Sampling Method	Filtered Y/N	Analysis Method	Analysis Date	Analysis			Detection Limits
						Result	Q	Units	
32105	Dibromochloromethane	Grab	N	SW8260	2/12/2004	0.16	U	µg/L	0.16
77596	Dibromomethane	Grab	N	SW8260	2/12/2004	0.13	U	µg/L	0.13
77268	trans-1,4-Dichloro-2-butene	Grab	N	SW8260	2/12/2004	0.14	U	µg/L	0.14
34668	Dichlorodifluoromethane	Grab	N	SW8260	2/12/2004	0.52	U	µg/L	0.52
34496	1,1-Dichloroethane	Grab	N	SW8260	2/12/2004	0.30	U	µg/L	0.30
34531	1,2-Dichloroethane	Grab	N	SW8260	2/12/2004	0.10	U	µg/L	0.10
34501	1,1-Dichloroethene	Grab	N	SW8260	2/12/2004	0.10	U	µg/L	0.10
77093	cis-1,2-Dichloroethene	Grab	N	SW8260	2/12/2004	1.4	U	µg/L	0.15
34546	trans-1,2-Dichloroethene	Grab	N	SW8260	2/12/2004	0.17	U	µg/L	0.17
34541	1,2-Dichloropropane	Grab	N	SW8260	2/12/2004	0.12	U	µg/L	0.12
77173	1,3-Dichloropropane	Grab	N	SW8260	2/12/2004	0.50	U	µg/L	0.50
77170	2,2-Dichloropropane	Grab	N	SW8260	2/12/2004	0.10	U	µg/L	0.10
77168	1,1-Dichloropropene	Grab	N	SW8260	2/12/2004	0.060	U	µg/L	0.060
34704	cis-1,3-Dichloropropene	Grab	N	SW8260	2/12/2004	0.070	U	µg/L	0.070
34699	trans-1,3-Dichloropropene	Grab	N	SW8260	2/12/2004	0.11	U	µg/L	0.11
73570	Ethyl methacrylate	Grab	N	SW8260	2/12/2004	0.48	U	µg/L	0.48
34371	Ethylbenzene	Grab	N	SW8260	2/12/2004	24	U	µg/L	0.12
34391	Hexachlorobutadiene	Grab	N	SW8260	2/12/2004	0.34	U	µg/L	0.34
77103	2-Hexanone	Grab	N	SW8260	2/12/2004	0.26	U	µg/L	0.26
77424	Iodomethane	Grab	N	SW8260	2/12/2004	0.38	U	µg/L	0.38
77033	Isobutyl Alcohol	Grab	N	SW8260	2/12/2004	2.7	U	µg/L	2.7
81593	Methacrylonitrile	Grab	N	SW8260	2/12/2004	0.71	U	µg/L	0.71
81597	Methyl methacrylate	Grab	N	SW8260	2/12/2004	0.15	U	µg/L	0.15
81596	4-Methyl-2-pentanone	Grab	N	SW8260	2/12/2004	0.21	U	µg/L	0.21
34423	Methylene chloride	Grab	N	SW8260	2/12/2004	0.26	U	µg/L	0.26
77007	Propionitrile	Grab	N	SW8260	2/12/2004	1.8	U	µg/L	1.8
77128	Styrene	Grab	N	SW8260	2/12/2004	1.4	U	µg/L	0.17
77562	1,1,1,2-Tetrachloroethane	Grab	N	SW8260	2/12/2004	0.15	U	µg/L	0.15
34516	1,1,2,2-Tetrachloroethane	Grab	N	SW8260	2/12/2004	0.11	U	µg/L	0.11
34475	Tetrachloroethene	Grab	N	SW8260	2/12/2004	0.11	U	µg/L	0.11
34010	Toluene	Grab	N	SW8260	2/12/2004	4.8	U	µg/L	0.10
34506	1,1,1-Trichloroethane	Grab	N	SW8260	2/12/2004	0.24	U	µg/L	0.24
34511	1,1,2-Trichloroethane	Grab	N	SW8260	2/12/2004	0.13	U	µg/L	0.13

Data Qualifier Code Key:	* Value exceeds Maximum Contaminant Level	I Analyte detected below quantitation limits
	L Value above quantitation range	S Spike Recovery outside accepted recovery limits
	U Not Detected Above the MDL	V Analyte detected in the associated Method Blank



Southeast Landfill App. 2

PARAMETER MONITORING REPORT

Ground Water (Rule 62-520.400, .420, .460)

Surface Water (Rule 62-302.500, .510, .503)

Leachate (Rule 62-701.510)

LAB Submission Number: F04020263

Sample Number: F04020263-003

Facility WACS:	35435-006-SO	Sample Date/Time:	2/9/2004 2:00:00 PM
Well/Sampling Point WACS:	Leachate Sump	Report Period:	1st Semiannual 2004
Well/Sampling Point Name:	Leachate Sump	Well Purged:	YES
Classification of Groundwater:	G-II	Well Type:	Leachate
Ground Water Elevation: (NGVD):			

Storet Code	Parameter Monitored	Sampling Method	Filtered Y/N	Analysis Method	Analysis Date	Analysis Result	Q	Units	Detection Limits
39180	Trichloroethene	Grab	N	SW8260	2/12/2004	0.15	U	µg/L	0.15
34488	Trichlorofluoromethane	Grab	N	SW8260	2/12/2004	0.32	U	µg/L	0.32
77443	1,2,3-Trichloropropane	Grab	N	SW8260	2/12/2004	0.30	U	µg/L	0.30
77057	Vinyl acetate	Grab	N	SW8260	2/12/2004	0.15	U	µg/L	0.15
39175	Vinyl chloride	Grab	N	SW8260	2/12/2004	0.14	U	µg/L	0.14
34020	Xylenes, Total	Grab	N	SW8260	2/12/2004	25		µg/L	0.29
34205	Acenaphthene	Grab	N	SW8270	2/13/2004	0.80	U	µg/L	0.80
34200	Acenaphthylene	Grab	N	SW8270	2/13/2004	1.1	U	µg/L	1.1
81553	Acetophenone	Grab	N	SW8270	2/13/2004	1.0	U	µg/L	1.0
82204	2-Acetylaminofluorene	Grab	N	SW8270	2/13/2004	1.3	U	µg/L	1.3
77581	4-Aminobiphenyl	Grab	N	SW8270	2/13/2004	2.8	U	µg/L	2.8
34220	Anthracene	Grab	N	SW8270	2/13/2004	0.57	U	µg/L	0.57
34526	Benzo(a)anthracene	Grab	N	SW8270	2/13/2004	0.64	U	µg/L	0.64
34247	Benzo(a)pyrene	Grab	N	SW8270	2/13/2004	0.69	U	µg/L	0.69
34230	Benzo(b)fluoranthene	Grab	N	SW8270	2/13/2004	0.81	U	µg/L	0.81
34521	Benzo(g,h,i)perylene	Grab	N	SW8270	2/13/2004	1.0	U	µg/L	1.0
34242	Benzo(k)fluoranthene	Grab	N	SW8270	2/13/2004	0.66	U	µg/L	0.66
77147	Benzyl alcohol	Grab	N	SW8270	2/13/2004	0.65	U	µg/L	0.65
34278	Bis(2-chloroethoxy)methane	Grab	N	SW8270	2/13/2004	1.2	U	µg/L	1.2
34273	Bis(2-chloroethyl)ether	Grab	N	SW8270	2/13/2004	1.3	U	µg/L	1.3
73522	Bis(2-chloroisopropyl)ether	Grab	N	SW8270	2/13/2004	1.1	U	µg/L	1.1
39100	Bis(2-ethylhexyl)phthalate	Grab	N	SW8270	2/13/2004	0.78	U	µg/L	0.78
34636	4-Bromophenyl phenyl ether	Grab	N	SW8270	2/13/2004	0.64	U	µg/L	0.64
34292	Butyl benzyl phthalate	Grab	N	SW8270	2/13/2004	0.78	U	µg/L	0.78
34452	4-Chloro-3-methylphenol	Grab	N	SW8270	2/13/2004	1.8	U	µg/L	1.8
73529	4-Chloroaniline	Grab	N	SW8270	2/13/2004	1.2	U	µg/L	1.2
34581	2-Chloronaphthalene	Grab	N	SW8270	2/13/2004	0.65	U	µg/L	0.65
34586	2-Chlorophenol	Grab	N	SW8270	2/13/2004	1.3	U	µg/L	1.3
34641	4-Chlorophenyl phenyl ether	Grab	N	SW8270	2/13/2004	1.2	U	µg/L	1.2
34320	Chrysene	Grab	N	SW8270	2/13/2004	0.58	U	µg/L	0.58
73540	Diallate	Grab	N	SW8270	2/13/2004	1.3	U	µg/L	1.3
34556	Dibenzo(a,h)anthracene	Grab	N	SW8270	2/13/2004	0.85	U	µg/L	0.85
81302	Dibenzofuran	Grab	N	SW8270	2/13/2004	1.1	U	µg/L	1.1

Data	*	Value exceeds Maximum Contaminant Level	I	Analyte detected below quantitation limits
Qualifier	L	Value above quantitation range	S	Spike Recovery outside accepted recovery limits
Code Key:	U	Not Detected Above the MDL	V	Analyte detected in the associated Method Blank

Southeast Landfill App. 2

PARAMETER MONITORING REPORT

Ground Water (Rule 62-520.400, .420, .460)

Surface Water (Rule 62-302.500, .510, .503)

Leachate (Rule 62-701.510)

LAB Submission Number: F04020263

Sample Number: F04020263-003



Facility WACS:	35435-006-SO	Sample Date/Time:	2/9/2004 2:00:00 PM
Well/Sampling Point WACS:	Leachate Sump	Report Period:	1st Semiannual 2004
Well/Sampling Point Name:	Leachate Sump	Well Purged:	YES
Classification of Groundwater:	G-II	Well Type:	Leachate
Ground Water Elevation: (NGVD):			

Storet Code	Parameter Monitored	Sampling Method	Filtered Y/N	Analysis Method	Analysis Date	Analysis			Detection Limits
						Result	Q	Units	
34536	1,2-Dichlorobenzene	Grab	N	SW8270	2/13/2004	0.95	U	µg/L	0.95
34566	1,3-Dichlorobenzene	Grab	N	SW8270	2/13/2004	1.0	U	µg/L	1.0
34571	1,4-Dichlorobenzene	Grab	N	SW8270	2/13/2004	7.0	U	µg/L	1.0
34631	3,3'-Dichlorobenzidine	Grab	N	SW8270	2/13/2004	0.58	U	µg/L	0.58
34601	2,4-Dichlorophenol	Grab	N	SW8270	2/13/2004	0.98	U	µg/L	0.98
77541	2,6-Dichlorophenol	Grab	N	SW8270	2/13/2004	1.2	U	µg/L	1.2
34336	Diethyl phthalate	Grab	N	SW8270	2/13/2004	1.4	U	µg/L	1.4
34341	Dimethyl phthalate	Grab	N	SW8270	2/13/2004	1.1	U	µg/L	1.1
73558	p-Dimethylaminoazobenzene	Grab	N	SW8270	2/13/2004	1.1	U	µg/L	1.1
73559	7,12-Dimethylbenz(a)anthracene	Grab	N	SW8270	2/13/2004	2.0	U	µg/L	2.0
73560	3,3'-Dimethylbenzidine	Grab	N	SW8270	2/13/2004	2.3	U	µg/L	2.3
34606	2,4-Dimethylphenol	Grab	N	SW8270	2/13/2004	1.3	U	µg/L	1.3
39110	Di-n-butyl phthalate	Grab	N	SW8270	2/13/2004	0.70	U	µg/L	0.70
34657	4,6-Dinitro-2-methylphenol	Grab	N	SW8270	2/13/2004	1.1	U	µg/L	1.1
45622	1,3-Dinitrobenzene	Grab	N	SW8270	2/13/2004	1.2	U	µg/L	1.2
34616	2,4-Dinitrophenol	Grab	N	SW8270	2/13/2004	2.0	U	µg/L	2.0
34611	2,4-Dinitrotoluene	Grab	N	SW8270	2/13/2004	1.4	U	µg/L	1.4
34626	2,6-Dinitrotoluene	Grab	N	SW8270	2/13/2004	1.2	U	µg/L	1.2
34596	Di-n-octyl phthalate	Grab	N	SW8270	2/13/2004	0.69	U	µg/L	0.69
34346	1,2-Diphenylhydrazine	Grab	N	SW8270	2/13/2004	0.94	U	µg/L	0.94
73571	Ethyl methanesulfonate	Grab	N	SW8270	2/13/2004	1.1	U	µg/L	1.1
34376	Fluoranthene	Grab	N	SW8270	2/13/2004	0.53	U	µg/L	0.53
34381	Fluorene	Grab	N	SW8270	2/13/2004	1.4	U	µg/L	1.4
39700	Hexachlorobenzene	Grab	N	SW8270	2/13/2004	0.59	U	µg/L	0.59
34386	Hexachlorocyclopentadiene	Grab	N	SW8270	2/13/2004	3.6	U	µg/L	3.6
34396	Hexachloroethane	Grab	N	SW8270	2/13/2004	1.5	U	µg/L	1.5
73576	Hexachloropropene	Grab	N	SW8270	2/13/2004	1.4	U	µg/L	1.4
34403	Indeno(1,2,3-cd)pyrene	Grab	N	SW8270	2/13/2004	1.2	U	µg/L	1.2
39430	Isodrin	Grab	N	SW8270	2/13/2004	1.1	U	µg/L	1.1
34408	Isophorone	Grab	N	SW8270	2/13/2004	0.99	U	µg/L	0.99
73582	Isosafrole	Grab	N	SW8270	2/13/2004	1.0	U	µg/L	1.0
73589	Methapyrilene	Grab	N	SW8270	2/13/2004	1.3	U	µg/L	1.3
73595	Methyl methanesulfonate	Grab	N	SW8270	2/13/2004	1.5	U	µg/L	1.5

Data Qualifier Code Key:	* Value exceeds Maximum Contaminant Level	I Analyte detected below quantitation limits
	L Value above quantitation range	S Spike Recovery outside accepted recovery limits
	U Not Detected Above the MDL	V Analyte detected in the associated Method Blank



Southeast Landfill App. 2

PARAMETER MONITORING REPORT

Ground Water (Rule 62-520.400, .420, .460)

Surface Water (Rule 62-302.500, .510, .503)

Leachate (Rule 62-701.510)

LAB Submission Number: F04020263

Sample Number: F04020263-003

Facility WACS:	35435-006-SO	Sample Date/Time:	2/9/2004 2:00:00 PM
Well/Sampling Point WACS:	Leachate Sump	Report Period:	1st Semiannual 2004
Well/Sampling Point Name:	Leachate Sump	Well Purged:	YES
Classification of Groundwater:	G-II	Well Type:	Leachate
Ground Water Elevation: (NGVD):			

Storet Code	Parameter Monitored	Sampling Method	Filtered Y/N	Analysis Method	Analysis Date	Analysis Result	Q	Units	Detection Limits
73591	3-Methylcholanthrene	Grab	N	SW8270	2/13/2004	1.0	U	µg/L	1.0
77416	2-Methylnaphthalene	Grab	N	SW8270	2/13/2004	1.0	U	µg/L	1.0
77152	2-Methylphenol	Grab	N	SW8270	2/13/2004	1.5	U	µg/L	1.5
77146	3&4-Methylphenol	Grab	N	SW8270	2/13/2004	2.2	U	µg/L	2.2
34696	Naphthalene	Grab	N	SW8270	2/13/2004	14	U	µg/L	0.86
73600	1-Naphthylamine	Grab	N	SW8270	2/13/2004	1.4	U	µg/L	1.4
73601	2-Naphthylamine	Grab	N	SW8270	2/13/2004	1.7	U	µg/L	1.7
73599	1,4-Naphthoquinone	Grab	N	SW8270	2/13/2004	1.4	U	µg/L	1.4
78142	2-Nitroaniline	Grab	N	SW8270	2/13/2004	1.6	U	µg/L	1.6
78300	3-Nitroaniline	Grab	N	SW8270	2/13/2004	1.2	U	µg/L	1.2
73605	4-Nitroaniline	Grab	N	SW8270	2/13/2004	1.5	U	µg/L	1.5
34447	Nitrobenzene	Grab	N	SW8270	2/13/2004	1.4	U	µg/L	1.4
73622	5-Nitro-o-toluidine	Grab	N	SW8270	2/13/2004	1.3	U	µg/L	1.3
34591	2-Nitrophenol	Grab	N	SW8270	2/13/2004	1.1	U	µg/L	1.1
34646	4-Nitrophenol	Grab	N	SW8270	2/13/2004	0.99	U	µg/L	0.99
73611	N-Nitrosodiethylamine	Grab	N	SW8270	2/13/2004	1.5	U	µg/L	1.5
34438	N-Nitrosodimethylamine	Grab	N	SW8270	2/13/2004	0.63	U	µg/L	0.63
73609	N-Nitroso-di-n-butylamine	Grab	N	SW8270	2/13/2004	1.0	U	µg/L	1.0
34428	N-Nitroso-di-n-propylamine	Grab	N	SW8270	2/13/2004	1.2	U	µg/L	1.2
34433	N-Nitrosodiphenylamine	Grab	N	SW8270	2/13/2004	0.67	U	µg/L	0.67
73613	N-Nitrosomethylethylamine	Grab	N	SW8270	2/13/2004	1.2	U	µg/L	1.2
73619	N-Nitrosopiperidine	Grab	N	SW8270	2/13/2004	1.2	U	µg/L	1.2
78206	N-Nitrosopyrrolidine	Grab	N	SW8270	2/13/2004	1.1	U	µg/L	1.1
77793	Pentachlorobenzene	Grab	N	SW8270	2/13/2004	1.0	U	µg/L	1.0
73626	Phenacetin	Grab	N	SW8270	2/13/2004	1.0	U	µg/L	1.0
34461	Phenanthrene	Grab	N	SW8270	2/13/2004	0.73	U	µg/L	0.73
34694	Phenol	Grab	N	SW8270	2/13/2004	0.55	U	µg/L	0.55
73628	1,4-Phenylenediamine	Grab	N	SW8270	2/13/2004	1.2	U	µg/L	1.2
39080	Pronamide	Grab	N	SW8270	2/13/2004	1.1	U	µg/L	1.1
34469	Pyrene	Grab	N	SW8270	2/13/2004	0.72	U	µg/L	0.72
77545	Safrole	Grab	N	SW8270	2/13/2004	1.0	U	µg/L	1.0
77734	1,2,4,5-Tetrachlorobenzene	Grab	N	SW8270	2/13/2004	1.3	U	µg/L	1.3
77770	2,3,4,6/2,3,4,5-Tetrachlorophenol	Grab	N	SW8270	2/13/2004	3.8	U	µg/L	3.8

Data	*	Value exceeds Maximum Contaminant Level	I	Analyte detected below quantitation limits
Qualifier	L	Value above quantitation range	S	Spike Recovery outside accepted recovery limits
Code Key:	U	Not Detected Above the MDL	V	Analyte detected in the associated Method Blank



Southeast Landfill App. 2

PARAMETER MONITORING REPORT

Ground Water (Rule 62-520.400, .420, .460)

Surface Water (Rule 62-302.500, .510, .503)

Leachate (Rule 62-701.510)

LAB Submission Number: F04020263

Sample Number: F04020263-003

Facility WACS:	35435-006-SO	Sample Date/Time:	2/9/2004 2:00:00 PM
Well/Sampling Point WACS:	Leachate Sump	Report Period:	1st Semiannual 2004
Well/Sampling Point Name:	Leachate Sump	Well Purged:	YES
Classification of Groundwater:	G-II	Well Type:	Leachate
Ground Water Elevation: (NGVD):			

Storet Code	Parameter Monitored	Sampling Method	Filtered Y/N	Analysis Method	Analysis Date	Analysis Result	Q	Units	Detection Limits
73553	Thionazin	Grab	N	SW8270	2/13/2004	1.0	U	µg/L	1.0
77142	o-Toluidine	Grab	N	SW8270	2/13/2004	1.3	U	µg/L	1.3
34551	1,2,4-Trichlorobenzene	Grab	N	SW8270	2/13/2004	0.85	U	µg/L	0.85
77687	2,4,5-Trichlorophenol	Grab	N	SW8270	2/13/2004	1.7	U	µg/L	1.7
34621	2,4,6-Trichlorophenol	Grab	N	SW8270	2/13/2004	0.93	U	µg/L	0.93
73652	o,o,o-Triethylphosphorothioate	Grab	N	SW8270	2/13/2004	1.3	U	µg/L	1.3
73653	1,3,5-Trinitrobenzene	Grab	N	SW8270	2/13/2004	1.2	U	µg/L	1.2
SUB									
01519	Alpha, Gross	Grab	N	E900.0	2/18/2004	19	U	pCi/L	19
	Radium-226	Grab	N	E903.1	2/23/2004	3.9+/-0.6		pCi/L	0.20
	Radium-228	Grab	N	RA05	2/23/2004	1.5+/-0.7		pCi/L	0.90

Data Qualifier Code Key:

*	Value exceeds Maximum Contaminant Level	I	Analyte detected below quantitation limits
L	Value above quantitation range	S	Spike Recovery outside accepted recovery limits
U	Not Detected Above the MDL	V	Analyte detected in the associated Method Blank

Southest Landfill App. 2

PARAMETER MONITORING REPORT

Ground Water (Rule 62-520.400, .420, .460)

Surface Water (Rule 62-302.500, .510, .503)

Leachate (Rule 62-701.510)

LAB Submission Number: F04020263

Sample Number: F04020263-004



Facility WACS:	35435-006-SO	Sample Date/Time:	2/9/2004 12:18:00 PM
Well/Sampling Point WACS:	Travel Blank	Report Period:	1st Semiannual 2004
Well/Sampling Point Name:	Travel Blank	Well Purged:	YES
Classification of Groundwater:	G-II	Well Type:	Leachate
Ground Water Elevation: (NGVD):			

Storet Code	Parameter Monitored	Sampling Method	Filtered Y/N	Analysis Method	Analysis Date	Analysis Result	Q	Units	Detection Limits
ORGANICS									
81552	Acetone	Grab	N	SW8260	2/12/2004	0.91	U	µg/L	0.91
76997	Acetonitrile	Grab	N	SW8260	2/12/2004	2.4	U	µg/L	2.4
34210	Acrolein	Grab	N	SW8260	2/12/2004	2.0	U	µg/L	2.0
34215	Acrylonitrile	Grab	N	SW8260	2/12/2004	0.93	U	µg/L	0.93
78109	Allyl chloride	Grab	N	SW8260	2/12/2004	0.12	U	µg/L	0.12
34030	Benzene	Grab	N	SW8260	2/12/2004	0.31	U	µg/L	0.31
73085	Bromochloromethane	Grab	N	SW8260	2/12/2004	0.22	U	µg/L	0.22
32101	Bromodichloromethane	Grab	N	SW8260	2/12/2004	0.10	U	µg/L	0.10
32104	Bromoform	Grab	N	SW8260	2/12/2004	0.11	U	µg/L	0.11
34413	Bromomethane	Grab	N	SW8260	2/12/2004	0.12	U	µg/L	0.12
81595	2-Butanone	Grab	N	SW8260	2/12/2004	0.29	U	µg/L	0.29
77041	Carbon disulfide	Grab	N	SW8260	2/12/2004	0.25	U	µg/L	0.25
32102	Carbon tetrachloride	Grab	N	SW8260	2/12/2004	0.25	U	µg/L	0.25
34301	Chlorobenzene	Grab	N	SW8260	2/12/2004	0.10	U	µg/L	0.10
34311	Chloroethane	Grab	N	SW8260	2/12/2004	0.16	U	µg/L	0.16
32106	Chloroform	Grab	N	SW8260	2/12/2004	0.28	U	µg/L	0.28
34418	Chloromethane	Grab	N	SW8260	2/12/2004	0.31	U	µg/L	0.31
32105	Dibromochloromethane	Grab	N	SW8260	2/12/2004	0.16	U	µg/L	0.16
77596	Dibromomethane	Grab	N	SW8260	2/12/2004	0.13	U	µg/L	0.13
77268	trans-1,4-Dichloro-2-butene	Grab	N	SW8260	2/12/2004	0.14	U	µg/L	0.14
34668	Dichlorodifluoromethane	Grab	N	SW8260	2/12/2004	0.52	U	µg/L	0.52
34496	1,1-Dichloroethane	Grab	N	SW8260	2/12/2004	0.30	U	µg/L	0.30
34531	1,2-Dichloroethane	Grab	N	SW8260	2/12/2004	0.10	U	µg/L	0.10
34501	1,1-Dichloroethene	Grab	N	SW8260	2/12/2004	0.10	U	µg/L	0.10
77093	cis-1,2-Dichloroethene	Grab	N	SW8260	2/12/2004	0.15	U	µg/L	0.15
34546	trans-1,2-Dichloroethene	Grab	N	SW8260	2/12/2004	0.17	U	µg/L	0.17
34541	1,2-Dichloropropane	Grab	N	SW8260	2/12/2004	0.12	U	µg/L	0.12
77173	1,3-Dichloropropane	Grab	N	SW8260	2/12/2004	0.50	U	µg/L	0.50
77170	2,2-Dichloropropane	Grab	N	SW8260	2/12/2004	0.10	U	µg/L	0.10
77168	1,1-Dichloropropene	Grab	N	SW8260	2/12/2004	0.060	U	µg/L	0.060
34704	cis-1,3-Dichloropropene	Grab	N	SW8260	2/12/2004	0.070	U	µg/L	0.070

Data Qualifier Code Key:

- * Value exceeds Maximum Contaminant Level
- L Value above quantitation range
- U Not Detected Above the MDL
- I Analyte detected below quantitation limits
- S Spike Recovery outside accepted recovery limits
- V Analyte detected in the associated Method Blank

Southest Landfill App. 2

PARAMETER MONITORING REPORT

Ground Water (Rule 62-520.400, .420, .460)

Surface Water (Rule 62-302.500, .510, .503)

Leachate (Rule 62-701.510)

LAB Submission Number: F04020263

Sample Number: F04020263-004



Facility WACS:	35435-006-SO	Sample Date/Time:	2/9/2004 12:18:00 PM
Well/Sampling Point WACS:	Travel Blank	Report Period:	1st Semiannual 2004
Well/Sampling Point Name:	Travel Blank	Well Purged:	YES
Classification of Groundwater:	G-II	Well Type:	Leachate
Ground Water Elevation: (NGVD):			

Storet Code	Parameter Monitored	Sampling Method	Filtered Y/N	Analysis Method	Analysis Date	Analysis Result	Q	Units	Detection Limits
34699	trans-1,3-Dichloropropene	Grab	N	SW8260	2/12/2004	0.11	U	µg/L	0.11
73570	Ethyl methacrylate	Grab	N	SW8260	2/12/2004	0.48	U	µg/L	0.48
34371	Ethylbenzene	Grab	N	SW8260	2/12/2004	0.12	U	µg/L	0.12
34391	Hexachlorobutadiene	Grab	N	SW8260	2/12/2004	0.34	U	µg/L	0.34
77103	2-Hexanone	Grab	N	SW8260	2/12/2004	0.26	U	µg/L	0.26
77424	Iodomethane	Grab	N	SW8260	2/12/2004	0.38	U	µg/L	0.38
77033	Isobutyl Alcohol	Grab	N	SW8260	2/12/2004	2.7	U	µg/L	2.7
81593	Methacrylonitrile	Grab	N	SW8260	2/12/2004	0.71	U	µg/L	0.71
81597	Methyl methacrylate	Grab	N	SW8260	2/12/2004	0.15	U	µg/L	0.15
81596	4-Methyl-2-pentanone	Grab	N	SW8260	2/12/2004	0.21	U	µg/L	0.21
34423	Methylene chloride	Grab	N	SW8260	2/12/2004	0.26	U	µg/L	0.26
77007	Propionitrile	Grab	N	SW8260	2/12/2004	1.8	U	µg/L	1.8
77128	Styrene	Grab	N	SW8260	2/12/2004	0.17	U	µg/L	0.17
77562	1,1,1,2-Tetrachloroethane	Grab	N	SW8260	2/12/2004	0.15	U	µg/L	0.15
34516	1,1,2,2-Tetrachloroethane	Grab	N	SW8260	2/12/2004	0.11	U	µg/L	0.11
34475	Tetrachloroethene	Grab	N	SW8260	2/12/2004	0.11	U	µg/L	0.11
34010	Toluene	Grab	N	SW8260	2/12/2004	0.10	U	µg/L	0.10
34506	1,1,1-Trichloroethane	Grab	N	SW8260	2/12/2004	0.24	U	µg/L	0.24
34511	1,1,2-Trichloroethane	Grab	N	SW8260	2/12/2004	0.13	U	µg/L	0.13
39180	Trichloroethene	Grab	N	SW8260	2/12/2004	0.15	U	µg/L	0.15
34488	Trichlorofluoromethane	Grab	N	SW8260	2/12/2004	0.32	U	µg/L	0.32
77443	1,2,3-Trichloropropane	Grab	N	SW8260	2/12/2004	0.30	U	µg/L	0.30
77057	Vinyl acetate	Grab	N	SW8260	2/12/2004	0.15	U	µg/L	0.15
39175	Vinyl chloride	Grab	N	SW8260	2/12/2004	0.14	U	µg/L	0.14
34020	Xylenes, Total	Grab	N	SW8260	2/12/2004	0.29	U	µg/L	0.29

Data Qualifier Code Key: * Value exceeds Maximum Contaminant Level
 L Value above quantitation range
 U Not Detected Above the MDL
 I Analyte detected below quantitation limits
 S Spike Recovery outside accepted recovery limits
 V Analyte detected in the associated Method Blank