

# STORAGE VOLUME AND WEIGHT CALCULATIONS

- A. PROCESSED TIRES (PILE)  
80X50X5 = 20,000 CF  
@ 20#/CF = 200 TONS
  - B. WHOLE OR PROCESSED TIRES (TRAILERS)  
WHOLE TIRES  
TRAILER VOLUME: 8X50X8 = 118.5 CY  
5 TRAILERS @ 123.5 = 617.5 CY  
617.5 CY @ 540#/CY = 167 TONS  
PROCESSED TIRES  
7 TRAILERS @ 123.5 CY = 864.5 CY  
864.5 CY @ 540 #/CY = 233 TONS  
(BASED ON PROCESSED TIRES @ 203/CY)
  - C. WHOLE OR PROCESSED TIRES (PILES)  
58X50X6 = 17400 CF  
80X50X6 = 24000 CF  
43X54X6 = 13932 CF  
55,332 CF = 2049 CY  
LESS 17% FOR TRAPEZOID SHAPE = 17-1 CY  
1701 CY @ 10 TIRES/CY = 17010 TIRES  
17010 TIRES @ 20 #/TIRE = 170 TONS
  - D. RESERVED
  - E. INDOOR WHOLE TIRE PILE  
20X20X5 = 2000 CF = 74 CY  
74 CY @ 10 TIRES/CY = 740 TIRES  
740 TIRES @ 20#/TIRE = 7 TONS
  - F. TIRE LOADING HOPPERS  
2000 TIRES @ 20#/TIRE = 20 TONS  
TIRE PILE  
40X70X6 = 16800 CF = 622 CY  
622 CY @ 10 TIRES/CY = 6220 TIRES  
6220 TIRES @ 20#/TIRE = 62 TONS
  - G1. BAGGED CRUMB RUBBER  
50# BAGS - 720 PALLETS = 36000 LBS  
36000X40 BAGS/PALLET = 720 TONS
  - G2. BAGGED CRUMB RUBBER - PARKING LOT  
17 X 55 ROWS = 935 ONE TON BAGS = 935 TONS
  - H1. INSIDE STORAGE BIN 50X25X6 = 7500 CF
  - H2. INSIDE STORAGE BIN 9X8X6 = 432 CF
  - H3. INSIDE STORAGE BIN 50X20X5 = 5000 CF
  - H4. OUTSIDE BULK SHIPPING BINS 50X30X20 = 30,000 CF  
42,932 CF @ 20#/CF = 429 TONS
- TOTAL TONNAGE OF WASTE TIRE RUBBER = 2943 TONS
- WASTE & SCRAP STORAGE VOLUME AND WEIGHT
- I. FIBER RESIDUAL DUMPSTER  
2 DUMPSTER EQUIVALENT TRAILERS @ 30 CY EACH  
= 60 CY @ 667 #/CY = 20 TONS
  - J1. METAL RESIDUAL DUMPSTERS  
7 DUMPSTERS @ 30 CY = 210 CY  
2 EQUIVALENT DUMPSTERS @ 30 CY = 60 CY  
270 CY @ 1000 #/CY = 135 TONS
  - J2. FIBER PILE  
12X50X4 = 2400 CF = 89 CY @ 667#/CY = 30 TONS
  - J3. WIRE PILE  
12X50X4 = 2400 CF = 89 CY  
STEEL WIRE @ 1000 #/CY  
89 CY @ 1000 #/CY = 45 TONS
  - K. OFFICE DUMPSTER  
1 DUMPSTER @ 30 CY  
30 CY @ 333 #/CY = 5 TONS
- TOTAL TONNAGE WASTE AND SCRAP: 235 TONS

## NOTES:

THIS FIGURE IS A STAND-ALONE REPLICATION AND MODIFICATION OF THE APPROVED SITE PLAN (SHEET 1 OF 1 DATED 4/16/03) PREPARED BY RODGERS ENGINEERING, THIS FIGURE IS MEANT TO REPLACE THAT FIGURE.

ORIGINAL LAYOUT FIGURE PREPARED BY ROBERT L. RODGERS ENGINEERING CO. INC. - DRAWINGS HAVE BEEN PROVIDED TO APEX COMPANIES, LLC. FOR USE AND MODIFICATION.

THE DRAWING MODIFICATIONS HAVE BEEN PREPARED BY LAWRENCE G. SCHMALTZ; PROFESSIONAL ENGINEER #: 48294

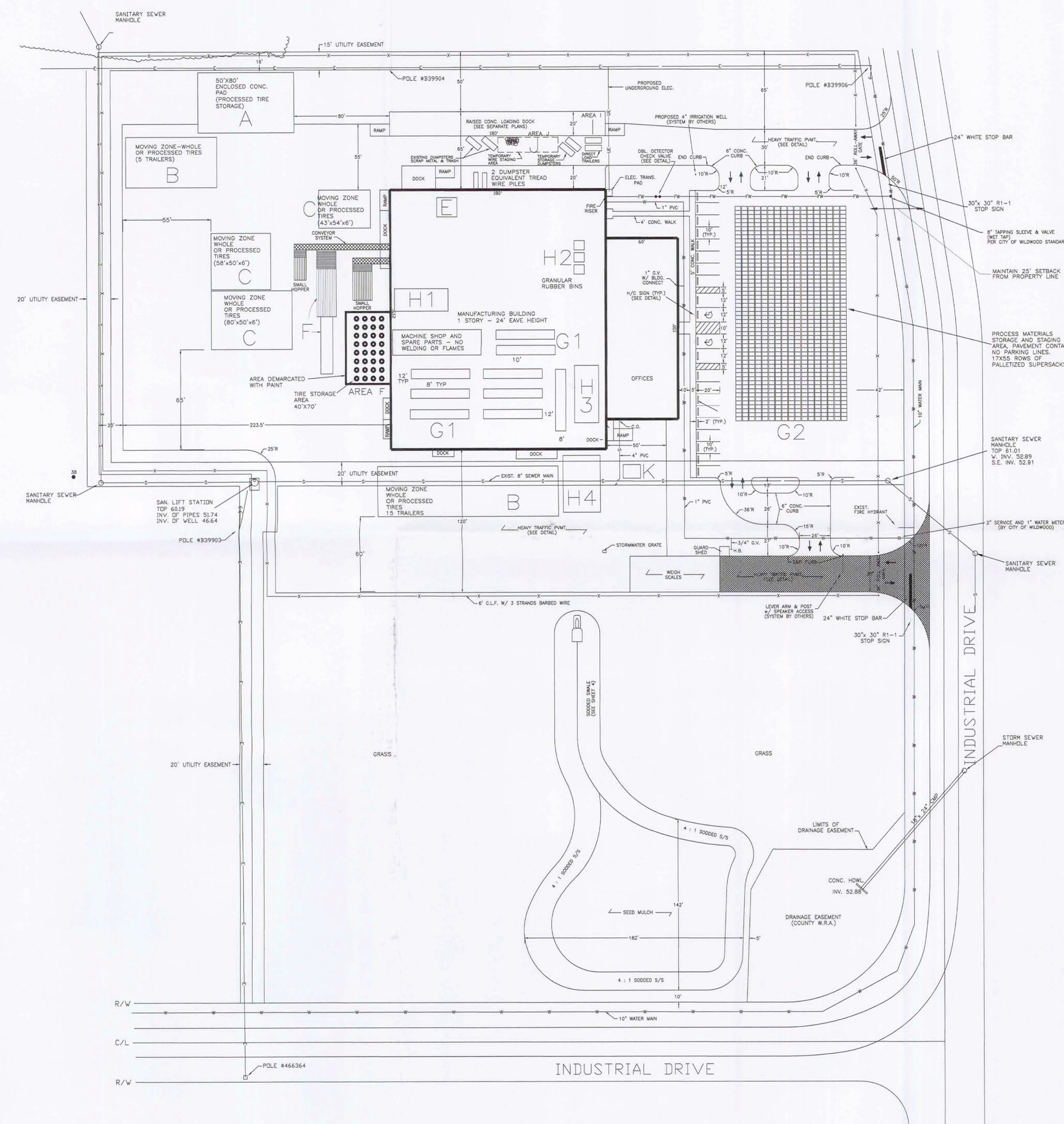

60 0 60 120 180 Feet

RECEIVED  
APR 12 2013  
DEF Central District

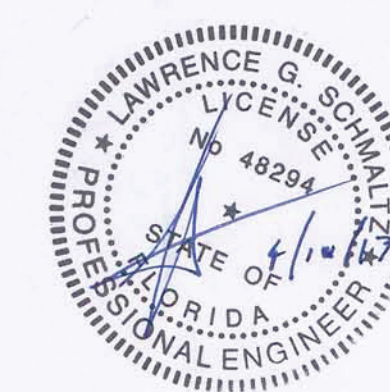

## General Notes

04	CALC. MODS	3/15/13
03	STORAGE MODS	7/16/08
02	MODIFY STAGING	1/04/08
01	MODIFY PARKING	10/19/07
No.	Revision/Issue	Date



Project Name and Address  
GLOBAL TIRE RECYCLING  
1201 INDUSTRIAL  
BOULEVARD  
WILDWOOD, FLORIDA

Project	340130119	Sheet	FACILITY PLOT PLAN
Date	4/1/13		
Scale	1" = 60'		FIGURE 1