



ENVIRONMENTAL PROTECTION DIVISION
Lori Cunniff, CEP, CHMM, Deputy Director
Community, Environmental and Development Services Department
800 Mercy Drive, Suite 4
Orlando, Florida 32808-7806
(407) 836-1400 • FAX (407) 836-1499
www.ocfl.net

April 9, 2014

Via Email and USPS:
westeves@wasteservicesinc.com

Mr. Wilson Esteves
Taft Recycling, Inc.
375 West 7th Street, Taft
Orlando, Florida 32824

RE: **Taft Recycling, Inc.**
375 West 7th Street, Taft
Permit: SW-022429-MRF/TS-06-1105
Compliance Inspection Report

Dear Mr. Esteves,

On March 17, 2014 a representative of the Orange County Environmental Protection Division (EPD) conducted an inspection of the above referenced facility. This inspection was performed to evaluate compliance with the Orange County Code Chapter 32, Article V, Solid Waste Management Ordinance, and those criteria in rules 62-701 through 62-722 Florida Administrative Code that have been adopted by reference. A copy of the inspection report is attached for your review.

Issues requiring a follow-up response were noted on the inspection report. Your response should include providing EPD a summary of actions taken to resolve the issue(s) and/or justification for any requested time extensions. Correspondence may be sent to EPD by email, fax, or postal mail. A follow-up inspection will be conducted to verify compliance.

If you have any questions, please contact me by phone at 407-836-1410 or by email at Arnaldo.Mercado@ocfl.net.

Sincerely,

Arnaldo Mercado
Environmental Programs Administrator

RAM/DB/AM: sgt

Enc: Compliance Inspection Report

EC: Solid Waste Inspection File
mkaiser@wasteservicesinc.com, Michael Kaiser, Waste Services, Inc.
gloria.depradine@dep.state.fl.us, Gloria-Jean DePradine, Central District, Florida DEP

**SOLID WASTE COMPLIANCE INSPECTION REPORT
WASTE PROCESSING FACILITY
(MATERIALS RECOVERY FACILITY / TRANSFER STATION)**

Environmental Protection Division
800 Mercy Drive, Orlando, FL 32808
Ph 407.836.1400 • Fax 407.836.1499
www.OrangeCountyFL.net



Facility:	Taft Recycling, Inc.
Location:	375 West 7th Street, Taft
Permit #:	SW-022429-MRF/TS-06-1105
Site Rep.:	Wilson Estevez

Date:	Mar 17, 2014	Time	14:20 – 15:40
Type:	<input type="checkbox"/> Field/Preliminary <input checked="" type="checkbox"/> Final		
Purpose:	<input checked="" type="checkbox"/> Monthly <input type="checkbox"/> Follow-up <input type="checkbox"/> Other		
Inspector	Ricardo A. Moore		

Observations and Notes:

Heavy rains during inspection. No odors and or dust detected on or off site. See site photos. Waste observed protruding past approved tipping floor on doors 1 and 2.

Issue	Description of issue(s) requiring follow-up by the facility, such as providing additional information or corrective action.	Due by date
1	Waste cannot be tipped or stored outside of approved tipping floor.	3/17/14
2		
3		

Inspector Signature: R. Anloze Date: 3/17/14

The requirements listed below provide an opportunity for the Division's inspector to indicate the conditions found at the time of the inspection. A "Not Ok" response to a requirement indicates either a potential violation of the corresponding rule or an area of concern that requires more attention. Both potential violations and areas of concern are discussed further at the beginning of this inspection report.

Item	Requirements	Ok	Not Ok	Unk	N/A
1	Facility permitted [32-214 (a)(1)] Expiration date: May 8, 2016	<input checked="" type="checkbox"/>	<input type="checkbox"/>	<input type="checkbox"/>	<input type="checkbox"/>
2	Prohibited routes free of inbound/outbound hauling vehicles? [32-216(a)(16)] Roads: <u>Between Orange Avenue and Sidney Hayes Road on: Pine, Palmetto, Cypress, First, Second, and Third; Between Landstreet Road and Fourth Street on: Boyce, Ave C and Ave E</u>	<input checked="" type="checkbox"/>	<input type="checkbox"/>	<input type="checkbox"/>	<input type="checkbox"/>
3	Haul route free of litter from site and inbound/outbound vehicles? [32-216(a)(13)] Roads: <u>West Seventh Street (west of Sydney Hayes), Sidney Hayes (between Seventh and Palmetto), Fourth (between Sidney Hayes and Boyce); adjacent portion of Boggy Creek Canal access road,; Recycle Center Road (if authorized by owner).</u>	<input checked="" type="checkbox"/>	<input type="checkbox"/>	<input type="checkbox"/>	<input type="checkbox"/>
4	Site entrance access road paved? [32-216(a)(6)]	<input checked="" type="checkbox"/>	<input type="checkbox"/>	<input type="checkbox"/>	<input type="checkbox"/>
5	Entrance clear of staging vehicles, dirt, and other obstructions or interference? [32-216(a)(18)]	<input checked="" type="checkbox"/>	<input type="checkbox"/>	<input type="checkbox"/>	<input type="checkbox"/>
6	Sign at entrance listing acceptable waste? [32-216(a)(14)]	<input checked="" type="checkbox"/>	<input type="checkbox"/>	<input type="checkbox"/>	<input type="checkbox"/>
7	Sign at entrance listing hours of operation?	<input checked="" type="checkbox"/>	<input type="checkbox"/>	<input type="checkbox"/>	<input type="checkbox"/>
8	Scalehouse or gate attendant present to observe and control incoming traffic? [32-216(a)(13)]	<input checked="" type="checkbox"/>	<input type="checkbox"/>	<input type="checkbox"/>	<input type="checkbox"/>
9	Haul vehicles with waste covered/tarped when entering/exiting facility?	<input checked="" type="checkbox"/>	<input type="checkbox"/>	<input type="checkbox"/>	<input type="checkbox"/>
10	Current Orange County permit displayed and plans available on site? [32-214(h)]	<input checked="" type="checkbox"/>	<input type="checkbox"/>	<input type="checkbox"/>	<input type="checkbox"/>
11	Current FDEP permit displayed?	<input checked="" type="checkbox"/>	<input type="checkbox"/>	<input type="checkbox"/>	<input type="checkbox"/>
12	Is a trained operator on duty at the facility at all times the facility is operating? [62-701.730(7)(d)] Name: Wilson Estevez.	<input checked="" type="checkbox"/>	<input type="checkbox"/>	<input type="checkbox"/>	<input type="checkbox"/>
13	Are training records current? [62-701.730(7)(d)] Operators: <u>Wilson Esteves (2/15/2016), Tony Santaniello (11/18/2015), Bruce Burke (4/10/2014), Steven Eosso (1/10/2016), Danie Guterrez (interim 3/2014), Sharon Allen (4/9/2014)</u> ; Spotters: <u>Any of the personnel above if needed.</u>	<input checked="" type="checkbox"/>	<input type="checkbox"/>	<input type="checkbox"/>	<input type="checkbox"/>
14	If scale used to quantify waste, is it calibrated each year and functional? [32-216(a)(22)] Last date: <u>January 7, 2014</u>	<input checked="" type="checkbox"/>	<input type="checkbox"/>	<input type="checkbox"/>	<input type="checkbox"/>
15	At least 3 detailed random load inspections being conducted and logged each week? [32-216(a)(14)]	<input checked="" type="checkbox"/>	<input type="checkbox"/>	<input type="checkbox"/>	<input type="checkbox"/>
16	Setbacks clear unless authorized (<u>see plans</u>)? [32-216(a)(11)]	<input checked="" type="checkbox"/>	<input type="checkbox"/>	<input type="checkbox"/>	<input type="checkbox"/>
17	Landscaping planted and maintained (<u>see plans</u>) [32-216(a)(11)]	<input checked="" type="checkbox"/>	<input type="checkbox"/>	<input type="checkbox"/>	<input type="checkbox"/>
18	Berms and other visual buffers established and maintained (<u>see plans</u>) [32-216(a)(11)]	<input checked="" type="checkbox"/>	<input type="checkbox"/>	<input type="checkbox"/>	<input type="checkbox"/>
19	Is access to the facility properly controlled (6 ft chain-link w/ locking gate)? [32-216(a)(13); 62-701.730(7)(c)]	<input checked="" type="checkbox"/>	<input type="checkbox"/>	<input type="checkbox"/>	<input type="checkbox"/>
20	Legible "No Trespassing" signs (3 sq ft, 5-inch letters, 500 ft centers, and corners)? [32-216(a)(13)]	<input checked="" type="checkbox"/>	<input type="checkbox"/>	<input type="checkbox"/>	<input type="checkbox"/>
21	Stormwater ponds and other controls maintained clear of vegetation/debris (<u>see plans</u>) [32-216(a)(32)]	<input checked="" type="checkbox"/>	<input type="checkbox"/>	<input type="checkbox"/>	<input type="checkbox"/>
22	Objectionable odors controlled from leaving site? [62-701.730(7)(e)]	<input checked="" type="checkbox"/>	<input type="checkbox"/>	<input type="checkbox"/>	<input type="checkbox"/>
23	Adequate dust control? [62-701.300(15)]	<input checked="" type="checkbox"/>	<input type="checkbox"/>	<input type="checkbox"/>	<input type="checkbox"/>
24	Adequate vector control? [32-216(a)(23)]	<input checked="" type="checkbox"/>	<input type="checkbox"/>	<input type="checkbox"/>	<input type="checkbox"/>
25	For areas not enclosed, is litter controlled and are litter control devices maintained? [62-701.710(3)(a)]	<input checked="" type="checkbox"/>	<input type="checkbox"/>	<input type="checkbox"/>	<input type="checkbox"/>
26	Is the leachate collection and removal system maintained and operated as required?[62-701.710(3)(b)]	<input checked="" type="checkbox"/>	<input type="checkbox"/>	<input type="checkbox"/>	<input type="checkbox"/>

Item	Requirements	Ok	Not Ok	Unk	N/A
27	Are all drains and leachate conveyances kept clean so that leachate flow is not impeded? [62-701.710(4)(b)]	<input checked="" type="checkbox"/>	<input type="checkbox"/>	<input type="checkbox"/>	<input type="checkbox"/>
28	Are putrescible wastes stored no longer than 48 hours or as otherwise allowed in the Operation and Maintenance Plan? [62-701.710(4)(b)]	<input checked="" type="checkbox"/>	<input type="checkbox"/>	<input type="checkbox"/>	<input type="checkbox"/>
29	Are areas where putrescible waste is stored or processed cleaned at least weekly (or more frequently if required by permit) to prevent odor and vector problems? [62-701.710(4)(b)] (Permit condition for dry sweep cleaning: Yes wet cleaning: As needed)	<input checked="" type="checkbox"/>	<input type="checkbox"/>	<input type="checkbox"/>	<input type="checkbox"/>
30	Is at least one trained spotter on duty at all times that waste is received at the facility to inspect the incoming waste? [32-216(a)(14); 62-701.710(4)(c)2] Names of spotters present: <u>Bruce Burke and Steven Eosso on front loaders.</u>	<input checked="" type="checkbox"/>	<input type="checkbox"/>	<input type="checkbox"/>	<input type="checkbox"/>
31	Is the facility accepting only permitted waste types? [32-216(a)(14)] Waste types authorized: Class I, III and C&D	<input checked="" type="checkbox"/>	<input type="checkbox"/>	<input type="checkbox"/>	<input type="checkbox"/>
32	Are unauthorized wastes removed from the waste stream and placed into appropriate containers for disposal at a permitted facility? [62-701.710(4)(c)2]	<input checked="" type="checkbox"/>	<input type="checkbox"/>	<input type="checkbox"/>	<input type="checkbox"/>
33	Regulated wastes properly stored in area separate from disposal or sorting areas? (e.g. secondary containment) Photo.	<input checked="" type="checkbox"/>	<input type="checkbox"/>	<input type="checkbox"/>	<input type="checkbox"/>
34	Unauthorized waste volume less than one 20-cu yd container, or as allowed in the Operation and Maintenance Plan? [32-216 (a)(14)] Amount allowed: No more than 10 cu-yards.	<input checked="" type="checkbox"/>	<input type="checkbox"/>	<input type="checkbox"/>	<input type="checkbox"/>
35	Recovered materials stored within permitted dimensions and volumes?	<input checked="" type="checkbox"/>	<input type="checkbox"/>	<input type="checkbox"/>	<input type="checkbox"/>
36	Recovered materials stored in a manner that prevents threats to ground water quality or air quality standards? [62-701.220(2)]	<input checked="" type="checkbox"/>	<input type="checkbox"/>	<input type="checkbox"/>	<input type="checkbox"/>
37	Recovered materials shipped out within one year? [62-701.220(1)]	<input checked="" type="checkbox"/>	<input type="checkbox"/>	<input type="checkbox"/>	<input type="checkbox"/>
38	If groundwater wells required (e.g. outdoor processing of C/D), are they intact and properly maintained? [62-701(2)(b); 62-701.710(10)(b)] See site sketch.	<input type="checkbox"/>	<input type="checkbox"/>	<input type="checkbox"/>	<input checked="" type="checkbox"/>
39	Unauthorized open-burning of solid waste prohibited. [62-701.300(3)]	<input checked="" type="checkbox"/>	<input type="checkbox"/>	<input type="checkbox"/>	<input type="checkbox"/>

Site Sketch

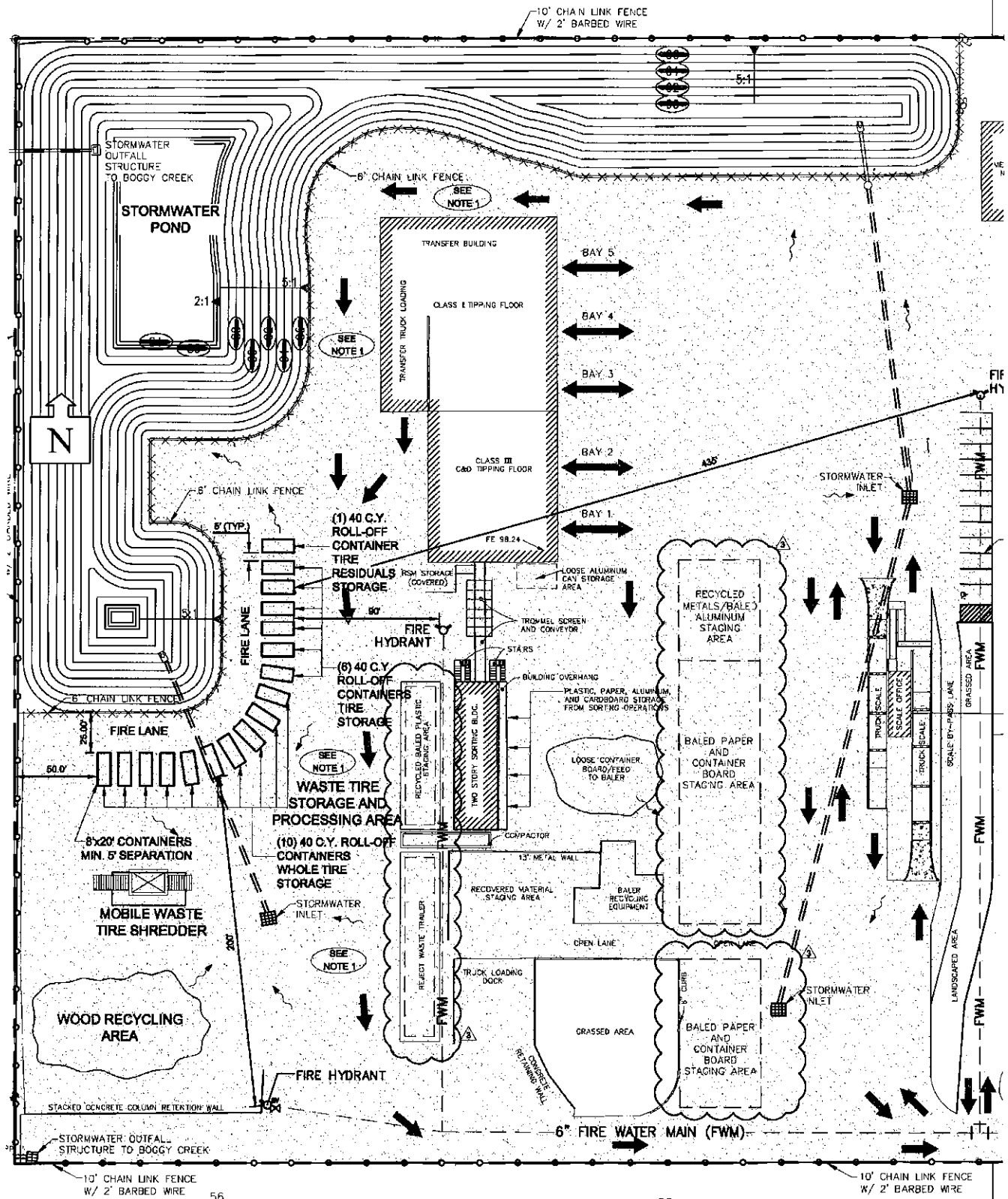



Photo 1: Storage area for unauthorized waste in roll off. Note cardboard, tires, Class III waste littering the parking lot. I was advised by Mr. Estevez that the waste and trash will be cleaned up at the end of the shift.



Photo 2: Doors #3, 4 and 5 waste is kept on approved tipping floor. At door #5 after the truck leaves front loader will push waste on parking lot into approved tipping floor.



Photo 3: Photo of doors 1 and 2.



Photo 4: W. side access road/parking lot facing S.



Photo 5: Bale bunker appears uncluttered.



Photo 6: Bale storage area under the recycling/sorting machine.



Photo 7: Roll offs in the background are tire roll offs. 20 cu-yard roll off contains CCA treated wood.



Photo 8: More full tire roll offs.



Photo 9: S.W. corner of site.



Photo 10: S.W. storm water retention pond drain.



Photo 11: S.E. storm water retention pond.



Photo 12: Close up of S.E. storm water retention pond.



Photo 13: Tire roll off.



Photo 14: N.E. storm water retention pond.