

2.0 Operations Plan

a. Designation of Responsible Operating and Maintenance Personnel

The Manatee County Solid Waste Management Facility (Landfill) is owned by Manatee County Government and operated under the direction of the Utilities Department, Solid Waste Division. An After Hours Contact List is provided in Table K-1, and a list of landfill positions is given below

Solid Waste Division Manager*	Landfill Superintendent *
Landfill Operation Supervisor (2) *	Household Hazardous Waste Technician*
Solid Waste Coordinator *	Solid Waste Maintenance Chief *
Solid Waste Disposal Chief (2)*	Administrative Assistant
Landfill Operator (15)*	Landfill Attendant*
Scalehouse Supervisor	Recycling Program Coordinator*
Senior Scalehouse Operator (2)	Recycling Program Specialist
Scalehouse Operator (4)	Solid Waste Enforcement Officers (4)*

* Trained spotters (Revised June 10, 2011)

b. Contingency Operations for Emergencies

In the event of an emergency, the County may close the landfill during the emergency event, but will maintain open access to the landfill after the emergency condition passes or the treat level drops. For example, the landfill will be closed during a hurricane, but opened after the hurricane has passed. On-site equipment may not be sufficient to maintain the excess volume of waste generated in an emergency. If so, backup equipment will be rented within 24 hours from the County's approved bid list. Additionally, back-up equipment will be provided for equipment breakdowns and down time for routine maintenance. In the case of equipment failure or emergencies, rental equipment or equipment from other County agencies will be delivered to the site within 24 hours if necessary.

Emergency conditions at the landfill may occur as a result of natural weather events (tornado, flooding, hurricanes, etc.) or fire. Staff is currently equipped to mobilize to alternative sites that will be designated as such in conjunction with the Manatee County Emergency Management Department. In the event that emergency conditions interrupt operations at the landfill, a contingency plan will be developed and implemented to establish temporary operations on a case-by-case basis, dependent on conditions at alternative sites such as the closed Erie Road Landfill. Such temporary operations will accept storm debris only, and will be terminated and disposal operations resumed at Lena Road Landfill as soon as practical. If the Lena Road Landfill cannot operate during an emergency, solid waste collection trucks will be diverted to Waste Management's Okeechobee Landfill.

When an emergency condition threatens the landfill operation, the following actions will be taken:

1. Daily cover shall be applied to all exposed refuse before a major storm arrives, if possible.
2. All landfill equipment shall be parked near any natural windcreens such as earthen mounds and berms.
3. All lightweight signs and equipment shall be secured.
4. When operation resumes, work shall commence in dry areas only (up from the active face).
5. Refuse shall not be disposed of in standing water.

Table K-1 (Revised June 10, 2011)
Emergency and After Hours Contacts
Lena Road Landfill/Solid Waste Division

Person/Agency	Telephone Number
<u>Fire Department</u> Battalion Captain Stacey Bailey Chief Byron Teates Manatee County Fire Rescue Administration Office: 3200 Lakewood Ranch Blvd, Bradenton First Responder: Station 2 803 60 th Street Court East Bradenton, FL 34202	911 Non-Emergency # 751-5611
<u>Ambulance</u> 911	<u>Sheriff</u> 911
<u>Bomb Squad</u> 911 Lieutenant Gary Samons	Non-Emergency # 747-3011 Extension 1980
<u>Public Safety Haz Mat Coordinator</u> Bob Tollise	911 Non-Emergency # 727-6223
<u>Mike Gore, Solid Waste Division Manager</u>	H: 322-8094 C: 812-4531
<u>Bryan White, Landfill Superintendent</u>	H: 322-2369 C: 812-2455
<u>Bob Bennett, Landfill Operations Supervisor</u>	H: 758-1741 C: 704-7855
<u>Anthony Detweiler, Landfill Operations Supervisor</u>	H: 322-8703 C: 812-8796
<u>Eric Siegfried, Solid Waste Disposal Chief</u>	H: 756-3507 C: 730-6554
<u>Joshua Fields, Solid Waste Disposal Chief</u>	C: 321-3290
<u>Richard Jones, Solid Waste Maintenance Chief</u>	C: 322-4104
<u>David Pickup, Recycling Coordinator</u>	C: 962-4087
<u>Debora Braziel-Jones Scalehouse Supervisor</u>	H: 755-8950
<u>Jeanne' Detweiler, Solid Waste Coordinator</u>	H: 322-8703 C: 812-4301
<u>Department of Environmental Protection</u> Susan Pelz	Office: 813-632-7600 X 386

Lena Road Landfill Operations Permit
May 10, 2010

- Used oil (up to 1000 gallons) is to be removed quarterly
- Paints (up to 16,600 gallons) are to be removed quarterly
- Batteries (up to 300 batteries) are to be removed quarterly
- Light bulbs (up to 3000) are to be removed at least quarterly
- Electronic devices (up to 50,000 pounds) are to be removed quarterly
- Household Hazardous Waste (up to 2,500 pounds) are to be removed quarterly

White Goods

All white goods containing Freon (e.g., refrigerators, air conditioners) are segregated from the waste stream and placed upright in the staging area. Freon is removed by a certified operator, and the item marked as being Freon free. The compressors are removed and oils drained off-site for collection by a licensed hazardous waste transporter under the direction of the scrap metal processor. The white goods are then moved to the general white goods/scrap metal area for collection by the scrap metal contractor.

All white goods, as defined in 62-701.200 (141), entering the landfill in separated loads are sent directly to the designated white goods/scrap metal storage area to be collected by a private scrap metal contractor for recycling purposes.

Up to 400 tons of scrap metal and white goods (a maximum of 600 pieces of white goods) can be stored in this area. The minimum frequency for removal is every six months.

Yard Waste

Disposal of yard waste in the Class I Landfill is prohibited. All incoming yard waste is directed to the designated area to be processed on site by a contracted vendor and removed from the site for re-use in land applications or waste-to-energy plants as fuel. Mulch is also used for the wet weather area during rainy season to assure access to the tipping area during rain events. The minimum frequency for processing yard trash is once every six months or when 3,000 tons (12,000 cubic yards) are accumulated. The contracted vendor then removes the shredded material for re-sale to various outlets for land applications or waste-to-energy plants for fuel. The fines generated are also utilized at the Landfill and mixed with soil for use as initial cover.

Tires

Tires entering the landfill are directed to the permitted storage area. Large agricultural equipment tires and large or solid forklift tires that cannot be processed for recycling are sent to the landfill disposal area for disposal in the landfill. The contracted vendor removes the tires to a waste-to-energy facility for processing and use as a fuel additive. Removal by the vendors is conducted on an on-call basis.

Batteries

State regulations prohibit disposal of lead-acid batteries in a landfill. The County prohibits collection of batteries by its franchised waste haulers. The Solid Waste Management Act aids in providing for proper disposal by requiring that all entities that sell batteries at retail shall accept used batteries as trade-ins for new batteries.

7.0 Waste Compaction

a. Waste Layer Thickness

Waste is typically dumped at the toe of the working face and is spread over the face in a maximum of two-foot lifts prior to compaction. This procedure continues throughout the day for a typical lift thickness of no more than 10-feet.

b. First Waste Layer

The area to be filled has been completely covered by waste during previous permit periods. The first layer of waste placed above the leachate collection system in Stage II will be a minimum of four feet in compacted thickness and shall consist of selected wastes containing no large rigid objects that may damage the leachate collection system. Special care shall be exercised when filling around pump stations to prevent damage.

c. Slopes and Lift Depths

The exterior landfill side slope is constructed at 4:1 (H:V) because due to settlement the side slope tends to settle to a final slope of 5:1. Any temporary slopes for such structures as storm water diversion dikes, roads, excavations, etc. are constructed with slopes no steeper than 3:1. The lift depths shall be 10-feet or less. The typical minimum top slopes to promote drainage are generally one percent within the bermed working face, and two percent on the intermediate cover areas.

d. Working Face

The active face width is no greater than necessary to accommodate the peak number of disposal vehicles at one time. The wider the active face, the more cover soil is used. The County uses an active face of 150 feet. The working area of the active face slope is approximately 5 horizontal to 1 vertical. The objective for the dimensions of the active face is to maximize the volume to face surface ratio.

e. Initial Cover Controls

Materials used as cover include tarp alternative daily cover (ADC), soil, street sweepings, ditch cleaning soil, dredge material, soil with up to 25% fines from the yard processing area and recovered screen material (RSM) from Department permitted facilities. The ADC, when used, covers the working face with a weighted tarp. Currently, 100' x 40' tarps are used to cover the working face. Soil, when used, is applied daily at a minimum thickness of six inches. While The Department in letters dated February 14, 2002 and August 27, 2002 (See attachment K-1 for copies of letters) permitted ground-up construction and demolition debris including asphalt roofing shingles, unscreened, applied in a six inch compacted layer as initial cover within the bermed working area. Manatee County no longer uses these types of materials and does not plan to use these again. Soil, with up to 25% fines from yard trash processing by volume, may be used for initial cover. (Revised June 10, 2011)

14.0 Special Waste Handling

a. Motor Vehicles

Motor vehicles are not presently accepted for disposal or temporary storage at Lena Road Landfill.

b. Shredded Waste

Shredded municipal waste is not accepted for disposal at Lend Road Landfill. Shredded tires may be accepted if not recycled.

c. Asbestos

Asbestos containing materials from sources covered under the National Emission Standards for Asbestos, 40 CFR Part 61, Subpart M are accepted at Lena Road Landfill, with prior approval of the County. These materials will be placed in the landfill by appointment only, covered with a minimum of one foot of ~~cover soil~~ non-asbestos containing waste or soil, and the location will be recorded in accordance with 40 CFR Part 61.154. A record of the location of asbestos-containing waste will be maintained. (Revised June 10, 2011)

d. Contaminated Soil

Soils contaminated with non-hazardous waste and petroleum-contaminated soil, which has been treated pursuant to Chapter 62-775, F.A.C., will be accepted at the discretion of the County.

e. Biological Waste

Biological waste is not accepted.

Attachment K-2

**Household Hazardous Waste Collection
And Storage Facility**

**Lena Road Landfill
3333 Lena Road
Bradenton, FL 34202**

Revised May 10, 2010

Prepared by:

Manatee County Government
Utilities **Operations** Department
Solid Waste Division
3333 Lena Road
Bradenton, FL 3421

(Revised June 10, 2011)

2.0 History

The Manatee County Household Hazardous Waste Collection and Storage Facility opened in May 1993 within the Stage III Landfill. This facility was removed as solid waste filled the Stage III Landfill.

The recently completed Administration Facilities includes a household hazardous waste collection and storage facility. The facility floor plan is shown on Figure K-2-1, and a cross section is shown on Figure K-2-2. The building includes forced air ventilation, dry chemical fire suppression system, and storage for hazardous waste. The building is engineered to comply with EPA, NAPA, and OSHA standards and regulations for storing hazardous chemicals and wastes. The building is also corrosion resistant and features secondary containment for the prevention of spills or leaks. The facility has a concrete slab and is under a roof as shown on the figures. The materials processed and the method of processing remains essentially the same at the new facility.

Note: Figure K-2-1 revised May 2011. (Revised June 10, 2011)

Facility Program

Monthly collections/events are operated by the certified Household Hazardous Waste Technician in the new Hazardous Waste Facility located at ~~of~~ the Landfill. The Hazardous Waste contractor is on site at the collection to assist with unloading. The contractor bulks and lab packs any of the waste material received during the collection. Partial containers are stored in the Hazardous Waste storage building until the following monthly collection. The ~~certified~~ Hazardous Waste Technician reviews all paperwork and has the responsibility of approving and signing outgoing manifests.

Materials are accepted from County residents during non-operating hours by appointment ~~or as determined by~~ the HHW technician. In addition, collection services at the residence are available for those persons who are unable to attend the event due to circumstance of health, ~~handicap~~ physically disabled or age.

Manatee County has a ~~permanent~~ Household Hazardous Waste program for the collection of materials at the facility. Monthly collections are conducted for the residential citizens and annual or semi-annual events for the CESQGs. These events are advertised in the County's utility billing and the local newspapers. General Household Hazardous Waste program information is available on the County's website at www.mymanatee.org/hhw.

~~Monthly collection events are operated by the Household Hazardous Waste Technician and two-three trained assistants. The Hazardous Waste contractor is also on site with staff and equipment to bulk and lab pack materials collected during the collection. All partial containers are stored within the Hazardous Waste storage building at the Lena Road Landfill until the following monthly collection.~~

(Revised June 10, 2011)

13.0 Waste Segregation

The following are bulked as grouped below:

- Latex based paints,
- Oil based paints,
- Antifreeze,
- Motor oil and transmission fluid.

The wastes are compatible for bulking, and are only bulked if clearly identified by sight, smell, container, label and source. Any wastes that are not clearly identifiable are not bulked, and the unknown wastes are sent with contractor.

Paint is stored in a lined 40 yard roll off container or lined crates located on a concrete pad. ~~covered with a plastic sheet.~~ Paint is bulked into a 55-gallon steel drum, and generally removed the same day or within 24-hours. If paint is spilled, it is contained on the plastic sheet by absorbent pads or absorbent.

Antifreeze is bulked into a 55-gallon drum. If antifreeze is spilled it is contained on the plastic sheet by absorbent pads or absorbent.

Motor oil and transmission fluid is being poured into a 20 gallon tank then pumped (or poured using a funnel) into a 500-gallon storage tank or in 375 or 275 gallon portable tanks. The bulking is done outside, under a main roof of the Hazardous Waste Facility. ~~within a containment area.~~

13.3 Unknowns

Unknowns are accepted. These items are materials that cannot be identified by either original labels or by participant knowledge. The following procedures are adhered to:

- Unknowns will be sent out with the contractor.
- Place material into appropriate storage building according to suspected hazards.

13.4 Electronic Waste

Electronic waste such as TVs, computer monitors, microwave ovens, telephones, keyboards, VCRs, radios, etc. are received at the Household Hazardous Waste Collection. The contractor is on site during the collection event and materials are sorted, palletized, shrink wrapped or put in Gaylord boxes then removed the day of the collection. If there are more pallets than the will fit in the contractor's trucks, the pallets of materials and/or roll-off box are stored under the roof of the Household Hazardous Waste Facility until the contractor comes to pick them up. The contracted e-scrap recycler removes the e-scrap for processing and recycling. Broken glass and components from broken units is swept up and properly disposed.

Electronic waste is also collected curbside by the contracted waste haulers. The hauler brings the materials to the landfill to be stored in the designated area which is the SW corner of the white goods/scrap metal concrete pad. Additionally, residents may drop off electronic waste Monday through Saturday during landfill hours. This material is stored in the SW corner of the white goods/scrap metal area also. Materials are removed by a private recycling contractor for proper recycling. (Revised June 10, 2011)

LENA ROAD LANDFILL EQUIPMENT REPLACEMENT SCHEDULE

MODEL/YEAR	ASSET #	CAT SERIAL NUMBER	DELIVERY DATE AMOUNT PAID	BUY BACK DATE BUY BACK AMOUNT	WARRANTY EXPIRES	2008/2009	2009/2010	2010/2011	2011/2012
1 <i>Compactor 06 Cat 836H</i>	50378	OBXD00426	10/30/2006/\$848,000	☀ 10/30/11 - \$200,000	10/30/11 or 7500 Hrs				
2 <i>Compactor 08 Cat 836H</i>	52582	OBXD00684	9/3/08/\$863,000	***** 9/3/2011 - \$280,000	9/3/11 or 7500 Hrs	863,000			
3 <i>Compactor 10 Cat 836H</i>	54462	OBXD01010	8/25/2010/\$788,988	9/26/2014 - \$250,000	9/26/14 or 7500Hrs		788,988		
4 <i>Dozer 07 Cat D7R LPG</i>	54106	OABJ01731	2/5/2010/\$478,305	2/5/2014 - \$180,000	2/5/14 or 7500 Hrs		479,000		
5 <i>Dozer 07 Cat D7R LPG</i>	54107	OABJ01732	2/8/2010/\$478,305	2/8/2014 - \$180,000	2/8/14 or 7500 Hrs		479,000		
6 <i>Dozer 07 Cat D7R LPG</i>	54108	OABJ01733	2/16/2010/\$478,305	2/16/2014 - \$180,000	2/16/10 or 7500 Hrs		479,000		
7 <i>Dozer 07 Cat D7R LPG</i>	54109	OABJ01734	2/22/2010/\$478,305	2/22/2014 - \$180,000	2/22/14 or 7500 Hrs		479,000		
8 Excavator 04 Cat 345BL	47296	OAGS02530	10/14/2004/\$320,000	10/14/09 - \$120,000	10/14/09 or 7500 Hrs				
9 <i>Excavator 06 Cat 345CL</i>	50365	PJW01406	10/5/2006/\$429,000	10/5/11 - \$165,000	11/14/11 or 7500 Hrs				
10 Scraper 03 Cat 623G	46268	OCES00463	1/16/2004/\$550,000	1/16/2009 - \$125,000	1/16/09 or 7500 Hrs				
11 Dozer 06 Cat D6TLGP	51116	OWCG00342	7/23/07/\$343,000		7/23/12 or 7500 Hrs				365,000
13 Dump Truck 06 Cat 740 Ejector	49857	OB1R00254	8/17/2006/\$580,000		8/17/11 or 7500 Hrs				
14 Dump Truck 08 Cat 740 Ejector	52386	OB1R00453	7/21/08/\$595,397		7/21/13 or 7500 Hrs				
15 Dump Truck 09 Cat 740 Ejector	53618	OB1R00465	5/14/09/\$515,000		5/14/14 or 7500 Hrs	515,000			
16 Loader 05 Cat 950G	47493	AXX01429	6/22/2005/\$180,000		6/22/09 or 7500 Hrs				258,000
17 Loader 07 Cat 950H	50843	KSK01381	5/15/07/\$241,000		5/15/12 or 7500 Hrs				
18 Loader 09 Cat 950G	53641	KS5K02393	6/10/09/\$256,436		6/10/14 or 6,000 Hrs	257,000			
19 Water Wagon 01 Cat 613C	42442	8LJ02122	7/13/2001/\$215,000						
20 Water Wagon 07 Cat 613CII	51835	8LJ03393	1/3/08/\$331,000		1/3/13 or 7000 Hrs				
21 Grader 02 Cat 143H	44155	1AL01321	9/20/2002/\$173,000		9/20/2007 or 5000 Hrs				
22 Vibrating Roller 07 Saki	50574		3/9/2007/\$76,000		3/19/10 or 3000 Hrs				
23 02 John Deere 7810	44484		12/10/2002/\$82,000						
24 02 Schulte 21' Flex Deck	45322		6/24/2003/\$16,000						16,900
25 06 Massey Ferguson 6495	49048		3/17/2006/\$80,000						
26 06 Alamo Eagle 20' Flex Deck	49770		7/19/2006/\$18,400						
27 07 Kubota M7040HDC	51225		8/29/07 \$43,000						
28 06 6' Finish Rotary Cutter Deck	49707		6/20/2006/\$3,500						
29 99 Bush Hog 15' Flex Deck	40672		11/17/1999/\$11,000						
30 Refueler 02 International 4300	44483		12/9/2002						
31 04 Roll-Off Truck/Containers	46828		7/13/2004/\$139,000						
32 Tarpomatic 04 28T	47295		10/4/2004/\$75,000						70,000
33 Tarpomatic 06 28T	49499		4/19/2006/\$82,000						
34 Pump 04 6" 6V-DDST-4-2011	47366		12/13/2004/\$25,000						
35 Pump 06 6" 6V-DDST-4-2011	48865		2/14/2006/\$28,000						
36 Air Compressor 99 2545E10	39965		2000/\$13,000					15,000	
37 Skag Mower 2010 # E2100202	54280		5/11/10/\$14,543				14,543		
38 Grasshopper Mower 08 928D	52367		7/16/08/\$13,500						
39 Forklift 96 JCB 930B	34465		8/26/1996/\$33,000						
40 Trailer 01 Crosley 8.5x25	42631		9/28/2001/\$8,000						
41 Flare Air Compressor IRN10H-150	54212		12/17/2009/\$12992						
42 Tennant Sweeper #S30-2151	54283		5/14/2010/\$42,291				42,291		
TOTAL COST REPLACEMENT						1,635,000	2,761,822	15,000	709,900

Equipment in red - on buy backs. ☀ Original buy back date for #50124 was 9/26/09, #50378 was 10/30/09, both in the amount of \$250,000.
 *****Price to rebuild #52582, not taking advantage of buy back. REV 11/2/10

CC: UD - Tina Fletcher, Bev Chiotti, FMD - Peggy Curtin, Sandy Kirkby
 Mike Gore, Bryan White, Bob Bennett, Anthony Detweiler, Jeanne Detweiler
 Fleet - Mike Brennen, Ron Kennedy

FLORIDA DEPARTMENT OF
 ENVIRONMENTAL PROTECTION
 JUN 15 2011
 SOUTHWEST DISTRICT
 TAMPA

LENA ROAD LANDFILL EQUIPMENT REPLACEMENT SCHEDULE

2012/2013	MODEL/YEAR	2013/2014	2014/2015	2015/2016	2016/2017	2017/2018	2018/2019	2019/2020	2020/2021	2021/2022	2022/2023
	1 <i>Compactor 06 Cat 836H</i>										
312,865	2 <i>Compactor 08 Cat 836H</i>				1,060,213				1,060,213		
	3 <i>Compactor 10 Cat 836H</i>	1,060,213				1,060,213				1,060,213	
	4 <i>Dozer 04 Cat D7RLGP</i>	479,000				479,000				479,000	
	5 <i>Dozer 04 Cat D7RLGP</i>	479,000				479,000				479,000	
	6 <i>Dozer 04 Cat D7RLGP</i>	479,000				479,000				479,000	
	7 <i>Dozer 04 Cat D7RLGP</i>	479,000				479,000				479,000	
	8 <i>Excavator 04 Cat 345BL</i>		472,000								
	9 <i>Excavator 06 Cat 345CL</i>				472,000						
	10 <i>Scraper 03 Cat 623G</i>			719,000					719,000		
	11 <i>Dozer 07 Cat D6TLGP</i>				365,000					365,000	
	12 <i>Dump Truck 06 Cat 740 Ejector</i>	700,000							700,000		
	13 <i>Dump Truck 08 Cat 740 Ejector</i>			700,000							700,000
	14 <i>Dump Truck 09 Cat 740 Ejector</i>				515,000						
	15 <i>Loader 05 Cat 950G</i>				258,000					258,000	
	16 <i>Loader 07 Cat 950H</i>	258,000					258,000				
	17 <i>Loader 09 Cat 950G</i>			258,000					258,000		
	18 <i>Water Wagon 01 Cat 613C</i>										
375,000	19 <i>Water Wagon 07 Cat 613CII</i>					375,000					375,000
	20 <i>Grader 02 Cat 143H</i>	173,000									173,000
	21 <i>Vibrating Roller 07 Saki</i>					76,000					
	22 <i>02 John Deere 7810</i>		80,000								
	23 <i>02 Schulte 21' Flex Deck</i>								16,900		
	24 <i>06 Massey Ferguson 6495</i>			80,000							
	25 <i>06 Alamo Eagle 20' Flex Deck</i>			18,400							
	26 <i>07 Kubota M7040HDC</i>				80,000						
	27 <i>06 6' Finish Rotary Cutter Deck</i>				3,500						
	28 <i>99 Bush Hog 15' Flex Deck</i>										
	29 <i>Refueler 02 International 4300</i>	93,000									
	30 <i>04 Roll-Off Truck/Containers</i>	139,000									139,000
	31 <i>Tarpomatic 04 28T</i>					70,000					
	32 <i>Tarpomatic 06 28T</i>		70,000						70,000		
25,000	33 <i>Pump 04 6" 6V-DDST-4-2011</i>								25,000		
	34 <i>Pump 06 6" 6V-DDST-4-2011</i>			25,000							25,000
	35 <i>Air Compressor 99 2545E10</i>				15,000						15,000
	36 <i>Skag Mower 2010 #E2100202</i>		15,000					15,000			
16,000	37 <i>Grasshopper Mower 08 928D</i>					16,000					
55,000	38 <i>Forklift 96 JCB 930B</i>										
	39 <i>Trailer 01 Crosley 8.5x25</i>		7,800								
	40										
	41 <i>Tennant Sweeper #S30-2151</i>							42,291			
783,865	TOTAL COST REPLACEMENT	4,339,213	644,800	1,800,400	2,768,713	3,513,213	258,000	57,291	2,849,113	3,599,213	1,427,000
Landfill -											

FLORIDA DEPARTMENT OF
ENVIRONMENTAL PROTECTION
JUN 15 2011
SOUTHWEST DISTRICT
TAMPA

U:\Old_H_S\ENVCADD\WASTEMAN\Manatee\Community Drop-Off\A1.1.dwg Jun 10, 2011 - 2:13pm

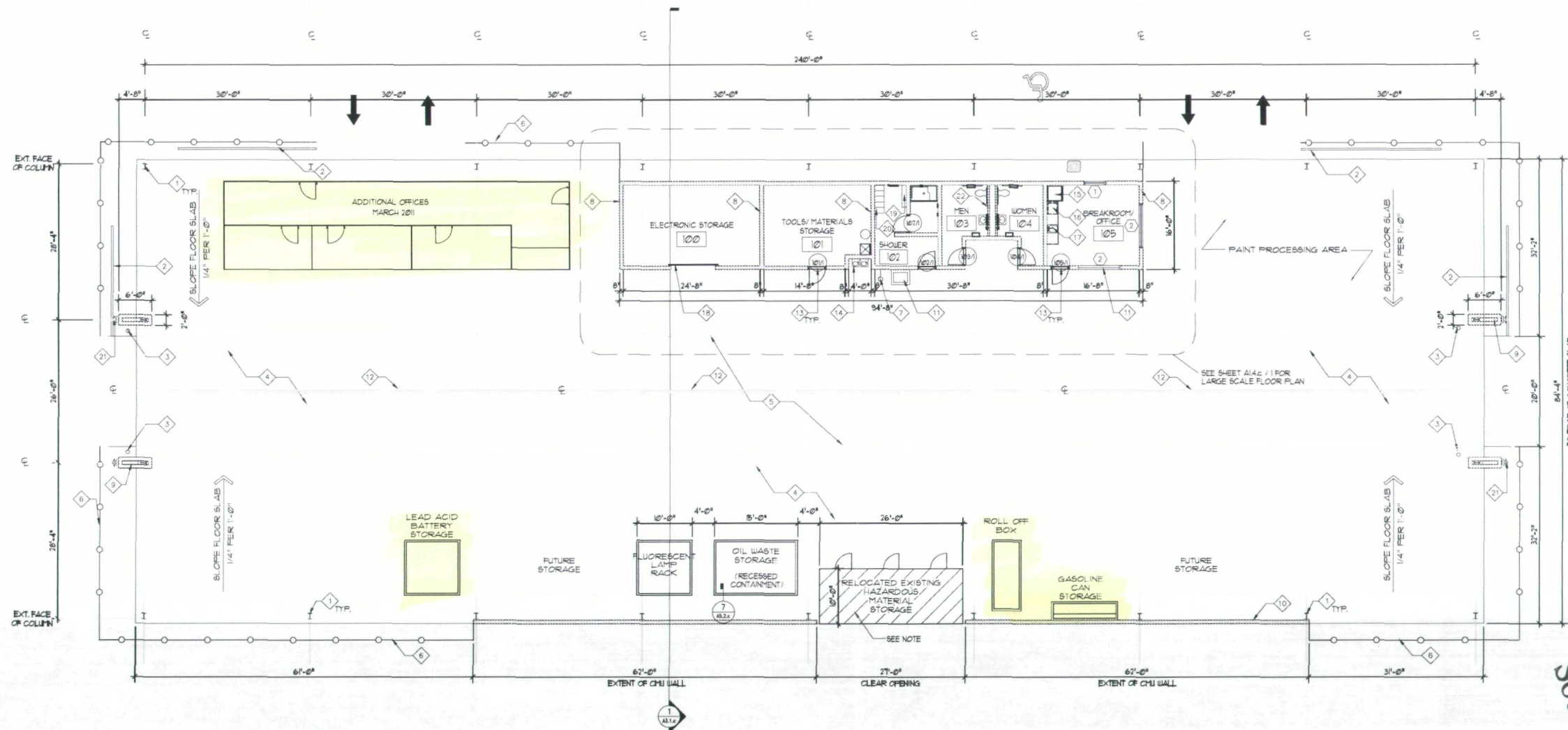

DRAWING NOTES

- 1 COLUMNS FOR METAL BUILDING STRUCTURE (TYP.)
- 2 25'-0" WIDE ROLLING GATE WITH OVERHEAD TRACK (TYP.)
- 3 8" PIPE BOLLARDS
- 4 CONCRETE SLAB
- 5 PAINTED STRIPES ON CONCRETE SLAB
- 6 8'-0" HIGH CHAIN LINK FENCE
- 7 EMERGENCY SHOWER / EYE WASH COMBINATION
- 8 8" CMU WALLS
- 9 2'-0" x 6'-0" CONC. PILASTERS (SEE ELEVATION SHEET A21.c)
- 10 8" CMU - SCREEN WALL
- 11 UTILITY TUB/SINK
- 12 TRENCH DRAIN
- 13 THRESHOLDS
- 14 HI-LO ELECTRIC WATER COOLERS
- 15 REFRIGERATOR (N.I.C.)
- 16 MICROWAVE (N.I.C.)
- 17 SINK
- 18 OVERHEAD DOOR
- 19 BENCH
- 20 LOCKERS
- 21 WALL SCONES (TYP.)
- 22 4" CMU WALLS - INTERIOR WALLS

NOTE:
CONTRACTOR SHALL COORDINATE WITH OWNER THE RELOCATION OF AN EXISTING HAZARDOUS MATERIAL STORAGE (PREFABRICATED BUILDING). THE EXISTING HAZARDOUS MATERIAL STORAGE SHALL BE PLACED IN ITS NEW LOCATION PRIOR TO INSTALLATION OF METAL BUILDING ROOF AND/OR STRUCTURAL MEMBERS THAT MAY INTERFERE WITH THE PLACEMENT OF THE STORAGE BUILDING.

LEGEND

- CMU WALLS
- INT. FRAME WALLS, NON-RATED
- DRAWING NOTES - SEE THIS SHEET
- DOOR KEY - SEE DOOR SCHEDULE, SHEET A61.c
- WINDOW KEY - SEE WINDOW SCHEDULE, SHEET A61.c
- ROOM TAG - SEE FINISH SCHEDULE, SHEET A61.c
- DETAIL KEY - SEE SHEET AS INDICATED
- WALL TYPES - SEE SHEET A61.c

Revised
May 2011

FLOOR PLAN
SCALE: 3/32" = 1'-0"
20,493 SQ. FT.

Southwest District
JUN 15 2011
Dept. of Environmental
Protection

FIG. K-2-1
NEW FACILITY FLOOR PLAN
HOUSEHOLD HAZARDOUS WASTE
COLLECTION AND STORAGE FACILITY
OPERATION PLAN



5300 WEST CYPRESS ST.
SUITE 300
TAMPA, FLORIDA 33607
Ph. (813) 282-7275

CLIENT
MANATEE COUNTY
PROJECT MANAGEMENT
DEPARTMENT
1026 26TH AVENUE EAST
BRADENTON, FLORIDA 34206

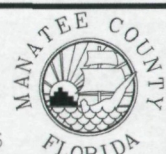

PROJECT NAME:

LENA ROAD LANDFILL

FACILITIES PROJECT - PHASE II

MANATEE COUNTY PROJECT NO:

60083

COMMUNITY DROP-OFF

FLOOR PLAN

ORIGINAL
REVISIONS

1
2
3
4
5

Handwritten signature and date: 6/15/11

NOT VALID FOR CONSTRUCTION
UNLESS SIGNED IN THIS BLOCK

PBS&J NO. 120498.13
DATE 11/25/02
DRAWN SC
CHECKED GS
QC
SHEET

A1.1.c

100% CONSTRUCTION DOCUMENTS

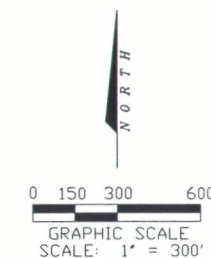
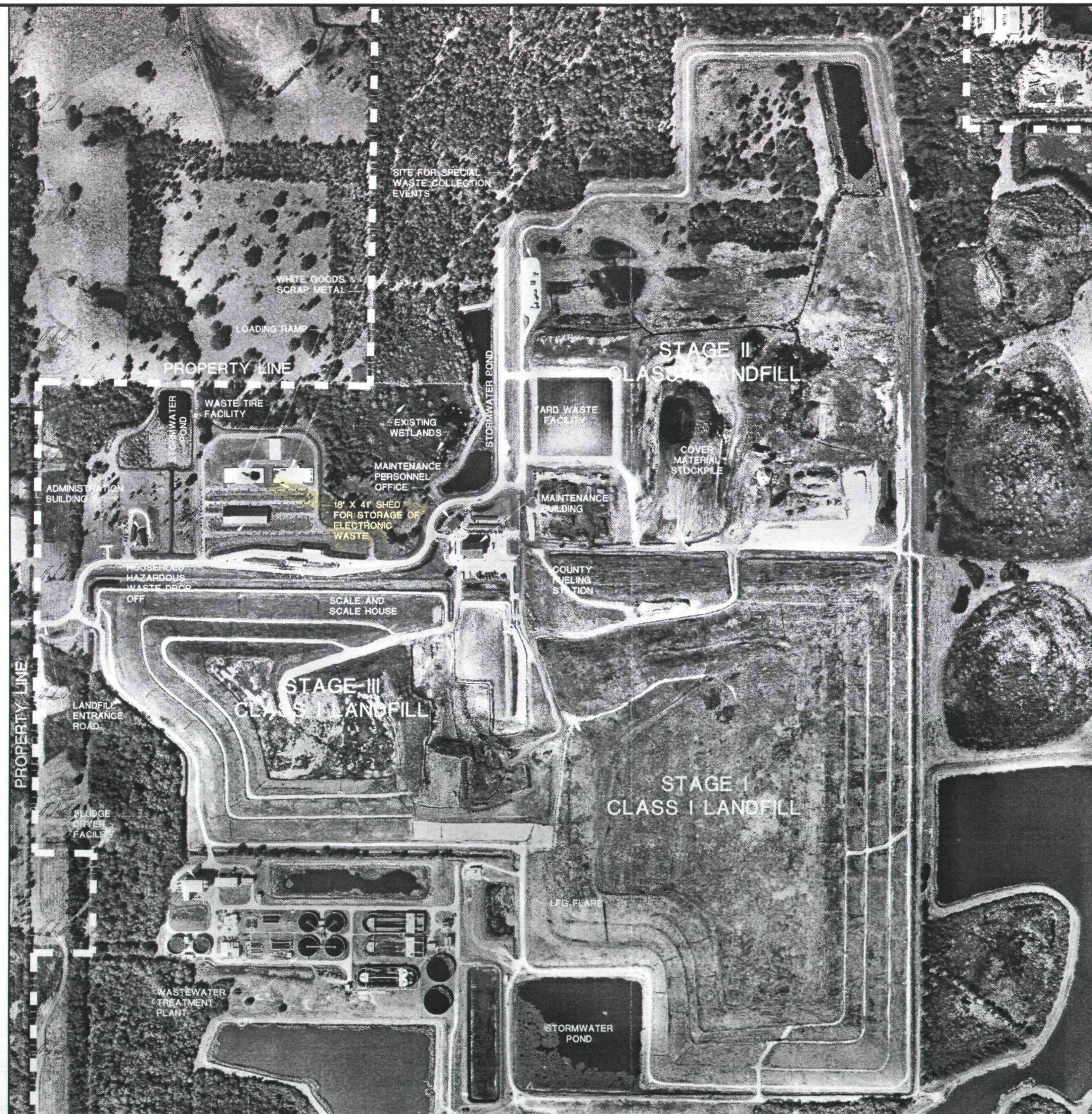

AERIAL PHOTOGRAPH PROVIDED BY:
 IF. ROOKS & ASSOCIATES, INC.
 106 N.W. DRANE ST.
 PLANT CITY, FL 33566
 (813) 752-2113

DATE FLOWN: JANUARY 25, 2010

Revised
 Dept. of Environmental
 Protection
 JUN 15 2011
 Southwest District

REPLACE 2009 AERIAL PHOTOGRAPHY
 WITH 2010 AERIAL PHOTOGRAPHY

C-2



482 South Keller Road
 ORLANDO, FL 32810-6101
 TEL. (407) 647-7275
 FAX. (407) 647-0624
 WWW.PBSJ.COM
 POST-BUCKLEY, SCHUH & JERNIGAN, Inc.
 5305 West Cypress Street Suite 200
 Tampa, FL 33607
 FPR Certificate of Authorization No. 24

CLIENT
MANATEE COUNTY
BOARD OF COUNTY COMMISSIONERS

PROJECT
LENA ROAD LANDFILL
FILL SEQUENCE PLAN

TASK
GENERAL SITE PLAN

ORIGINAL NOV. 2009
 REVISIONS:
 1. APRIL 2010
 2.
 3.
 4.
 5.

6.
 7.
 8.
 9.
 10.
 11.
 12.

NAME: JOSEPH L. MILLER
 Florida License No.: 32112
 Address: 4515 S. Keller Road
 Orlando, FL 32810-6101
 Signature: [Signature]
 Date: 6/10/11
 JOB NO. 100008517
 DRAWN: RGC
 DESIGN: RGC/JLM
 CHECKED: JLM
 O.C.: DED
 SHEET / #