

PIEZOMETER WELLS SCHEDULE					
WELL NO.	WACS NO.	LATITUDE	LONGITUDE	TOP OF PVC CASING ELEVATION (FT NGVD)	GROUND SURFACE ELEVATION
MW-3	4503	27°12'00.10"	82°22'36.50"	23.34	-
MW-5	4505	27°11'47.70"	82°22'26.30"	23.19	-
CW-8A	22883	27°12'02.89"	82°23'12.59"	35.04	-
CW-9	22884	27°12'02.78"	82°23'21.24"	26.58	-
CW-10R	22885	27°12'02.71"	82°23'26.50"	26.98	-
CW-15	27138	27°12'02.95"	82°23'31.93"	30.17	27.44
CW-16	27139	27°12'02.99"	82°23'38.06"	29.58	26.57

NATURAL ATTENUATION WELLS SCHEDULE					
WELL NO.	WACS NO.	LATITUDE	LONGITUDE	TOP OF PVC CASING ELEVATION (FT NGVD)	GROUND SURFACE ELEVATION
NAM-1	29091	27°11'16.21"	82°23'03.21"	19.87	-
NAM-2	29092	27°11'22.44"	82°23'38.05"	20.02	-
NAM-3	29093	27°11'43.83"	82°23'47.50"	20.62	-
NAM-4	29094	27°11'57.66"	82°24'00.06"	22.66	-

ABANDONED WELLS SCHEDULE					
WELL NO.	WACS NO.	LATITUDE	LONGITUDE	TOP OF PVC CASING ELEVATION (FT NGVD)	GROUND SURFACE ELEVATION
MW-18	23034	27°12'06.35"	82°23'47.32"	39.14	-
MW-19	23035	27°12'10.46"	82°23'44.87"	36.81	-
MW-20	23036	27°12'16.35"	82°23'44.86"	35.96	-

*Bradley D. Bayne*  
 PG 1733  
 6-17-15

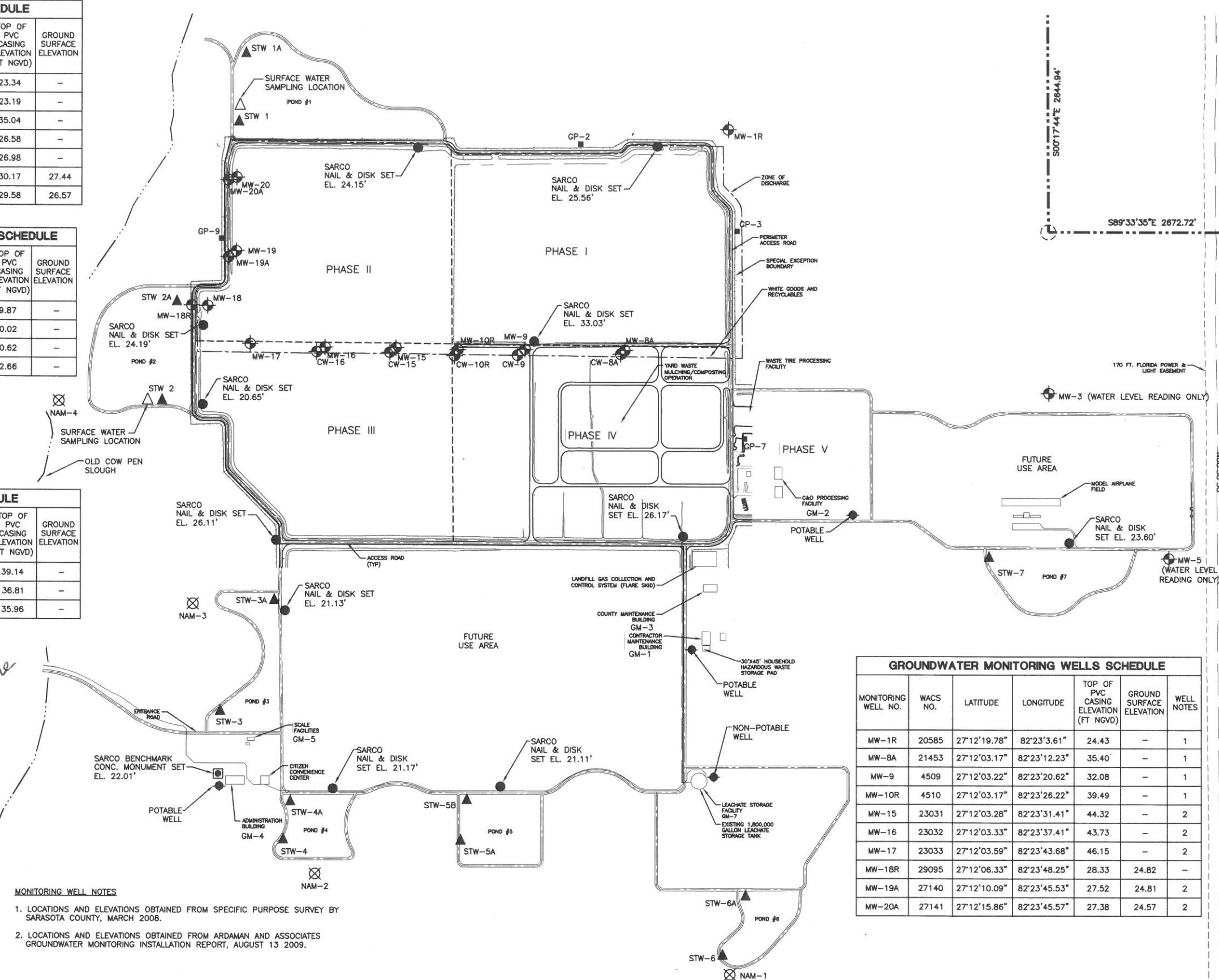

- SITE PLAN NOTES**
- LOCATIONS OF EXISTING PIEZOMETERS, MONITORING WELLS AND STAFF GAUGES OBTAINED FROM SPECIFIC PURPOSE SURVEY BY SARASOTA COUNTY, MARCH 2008.
  - APPROXIMATE LOCATION OF PHASE I LEACHATE FORCEMAIN OBTAINED FROM RECORD DRAWINGS BY CAMP DRESSER & MCKEE, INC. DATED APRIL 1998. VERIFY LOCATION IN FIELD.
  - APPROXIMATE LOCATION OF LEACHATE FORCEMAIN TO OFFSITE WTP OBTAINED FROM CONFORMED DRAWINGS BY PBS&J DATED JULY 2005. VERIFY LOCATION IN FIELD.
  - LOCATION OF CONDENSATE SUMPS OBTAINED FROM PHASE I LFGCCS AS-BUILT DRAWINGS DATED AUGUST 2010.
  - ELEVATIONS BASE ON SARASOTA COUNTY BENCHMARK 363, ELEVATION BEING 15.261 FEET N.G.V.D. 1929.

- LEGEND**
- GP-1 GAS PROBE
  - MW-10R GROUNDWATER MONITORING WELL
  - GM-1 GAS MONITORING LOCATION
  - WATER SUPPLY WELL
  - ▲ STW-1 STORMWATER MONITORING STATION
  - △ POND 1 SURFACE WATER MONITORING LOCATION
  - SARCOS NAIL & DISK SET
  - SARCOS BENCHMARK CONCRETE MONUMENT SET
  - ZONE OF DISCHARGE
  - WATERWAY
  - LIMITS OF EASEMENT
  - EASEMENT CENTERLINE
  - EXISTING ROADWAY
  - PHASE BOUNDARY
  - PROPERTY BOUNDARY
  - ⊗ NATURAL ATTENUATION MONITORING WELLS

GROUNDWATER MONITORING WELLS SCHEDULE						
MONITORING WELL NO.	WACS NO.	LATITUDE	LONGITUDE	TOP OF PVC CASING ELEVATION (FT NGVD)	GROUND SURFACE ELEVATION	WELL NOTES
MW-1R	20585	27°12'19.78"	82°23'3.61"	24.43	-	1
MW-8A	21453	27°12'03.17"	82°23'12.23"	35.40	-	1
MW-9	4509	27°12'03.22"	82°23'20.62"	32.08	-	1
MW-10R	4510	27°12'03.17"	82°23'26.22"	39.49	-	1
MW-15	23031	27°12'03.28"	82°23'31.41"	44.32	-	2
MW-16	23032	27°12'03.33"	82°23'37.41"	43.73	-	2
MW-17	23033	27°12'03.59"	82°23'43.68"	46.15	-	2
MW-18R	29095	27°12'06.33"	82°23'48.25"	28.33	24.82	-
MW-19A	27140	27°12'10.09"	82°23'45.53"	27.52	24.81	2
MW-20A	27141	27°12'15.86"	82°23'45.57"	27.38	24.57	2

- MONITORING WELL NOTES**
- LOCATIONS AND ELEVATIONS OBTAINED FROM SPECIFIC PURPOSE SURVEY BY SARASOTA COUNTY, MARCH 2008.
  - LOCATIONS AND ELEVATIONS OBTAINED FROM ARDAMAN AND ASSOCIATES GROUNDWATER MONITORING INSTALLATION REPORT, AUGUST 13 2009.

**FIGURE 1**

<p>5300 W. BOY SCOUT BOULEVARD TAMPA, FLORIDA 33607 FBPR CERTIFICATE OF AUTHORIZATION NO.24</p>	<p>482 SOUTH KELLER ROAD Orlando, FL 32810-6101 TEL. (407) 647-7275 FAX. (407) 647-0624 www.atkinsglobal.com</p>	<p>CLIENT <b>SARASOTA COUNTY</b></p>	<p>PROJECT <b>CENTRAL COUNTY SOLID WASTE DISPOSAL COMPLEX CLASS I LANDFILL</b></p>	<p>TASK <b>WATER QUALITY MONITORING PLAN</b></p>	<p>ORIGINAL <b>8/01/2012</b></p> <p>REVISIONS:          1. <b>8/19/2013</b>          2. <b>6/24/2014</b>          3.          4.          5.</p>	<p>6. 7. 8. 9. 10. 11. 12.</p>	<p>Name: Florida P.E. No.: Address: ATKINS 482 S. Keller Road Orlando, FL 32810-6101</p> <p>Signature _____ Date _____</p>	<p>JOB NO. <b>00-000.00</b>          DRAWN <b>GG</b>          DESIGN <b>RS</b>          CHECKED _____          Q.C. _____</p> <p><b>SHEET 1/1</b></p>
---	--	--	--	--	--	--	--	---