



**Atkins North America, Inc.**  
482 South Keller Road  
Orlando, Florida 32810-6101

**Telephone: +1.407.647.7275**

**[www.atkinsglobal.com/northamerica](http://www.atkinsglobal.com/northamerica)**

June 10, 2011

Susan J. Pelz, P.E.  
Solid Waste Manager  
Southwest District  
Florida Department of Environmental Protection  
13051 North Telecom Parkway  
Temple Terrace, Florida 33637-0926

Re: Lena Road Class I Landfill Operation Permit  
Manatee County, WACS No. SWD-41-44795  
Application for Minor Modification to  
Operation Permit No.: 39884-018-SO/01

Dear Ms. Pelz:

Enclosed please find for the above referenced permit four complete applications for a minor modification to the Operation Permit to bring the Operation Plan up to date. Changes were highlighted in green of yellow and dated. The \$250 check for the application fee will be sent directly from our Accounting Department.

If you have any questions, please call me at 407-806-4153, or e-mail me at [joseph.miller@atkinsglobal.com](mailto:joseph.miller@atkinsglobal.com).

Sincerely,

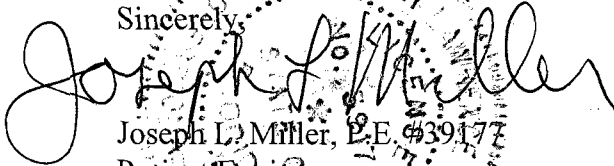

Joseph L. Miller, P.E. #39177  
Project Engineer

Cc: Bryan White, Manatee County Solid Waste w/2 copy

Attachments:

- 1) Application including Parts A, B and S.
- 2) Operation Permit Application Section K Operations Plan, Revised Pages K-2, K-3, K-4, K-7, K-17 and K-48.
- 3) Operation Permit Application Section K Attachment K-2, Revised Pages: Cover, K2-2, K2-4 and K2-15.
- 4) Revised table "Lena Road Landfill Equipment Replacement Schedule".
- 5) Revised Figure K-2-1 – Floor Plan for Household Hazardous Waste Collection and Storage Facility
- 6) Lena Road Landfill – Fill Sequence Plan – General Site Plan – Drawing C-2. Revised to show the location of the new shed for storage of electronic waste.

FLORIDA DEPARTMENT OF  
ENVIRONMENTAL PROTECTION  
JUN 15 2011  
SOUTHWEST DISTRICT  
TAMPA

Reset Form

Print Form



# Florida Department of Environmental Protection

Bob Martinez Center  
2600 Blair Stone Road  
Tallahassee, Florida 32399-2400

DEP Form #: 62-701.900(1), F.A.C.

Form Title: Application to Construct, Operate, Modify, or  
Close a Solid Waste Management Facility

Effective Date: January 6, 2010

Incorporated in Rule: 62-701.330(3), F.A.C.

## STATE OF FLORIDA DEPARTMENT OF ENVIRONMENTAL PROTECTION

### APPLICATION TO CONSTRUCT, OPERATE, MODIFY, OR CLOSE A SOLID WASTE MANAGEMENT FACILITY

### APPLICATION INSTRUCTIONS AND FORMS

Northwest District  
160 Governmental Center  
Pensacola, FL 32502-5794  
850-595-8360

Northeast District  
7825 Baymeadows Way, Ste. B200  
Jacksonville, FL 32256-7590  
904-807-3300

Central District  
3319 Maguire Blvd., Ste. 232  
Orlando, FL 32803-3767  
407-894-7555

Southwest District  
13051 N. Telecom Pkwy  
Temple Terrace, FL 33637  
813-632-7600

South District  
2295 Victoria Ave., Ste. 364  
Fort Myers, FL 33901-3881  
239-332-6975

Southeast District  
400 North Congress Ave.  
West Palm Beach, FL 33401  
561-681-6600

## INSTRUCTIONS TO APPLY FOR A SOLID WASTE MANAGEMENT FACILITY PERMIT

### I. General

Solid Waste Management Facilities shall be permitted pursuant to Section 403.707, Florida Statutes, (FS) and in accordance with Florida Administrative Code (FAC) Chapter 62-701. A minimum of four copies of the application shall be submitted to the Department's District Office having jurisdiction over the facility. The appropriate fee in accordance with Rule 62-701.315, FAC, shall be submitted with the application by check made payable to the Department of Environmental Protection (DEP).

Complete appropriate sections for the type of facility for which application is made. Entries shall be typed or printed in ink. All blanks shall be filled in or marked "not applicable" or "no substantial change". Information provided in support of the application shall be marked "submitted" and the location of this information in the application package indicated. The application shall include all information, drawings, and reports necessary to evaluate the facility. Information required to complete the application is listed on the attached pages of this form.

### II. Application Parts Required for Construction and Operation Permits

- A. Landfills and Ash Monofills - Submit Parts A through S
- B. Asbestos Monofills - Submit Parts A,B,C,D,E,F,I,K,M, O through S
- C. Industrial Solid Waste Disposal Facilities - Submit Parts A through S

**NOTE:** Portions of some Parts may not be applicable.

**NOTE:** For facilities that have been satisfactorily constructed in accordance with their construction permit, the information required for A, B and C type facilities does not have to be resubmitted for an operation permit if the information has not substantially changed during the construction period. The appropriate portion of the form should be marked "no substantial change".

### III. Application Parts Required for Closure Permits

- A. Landfills and Ash Monofills - Submit Parts A,B,L, N through S
- B. Asbestos Monofills - Submit Parts A,B,M, O through S
- C. Industrial Solid Waste Disposal Facilities - Submit Parts A,B, L through S

**NOTE:** Portions of some Parts may not be applicable.

### IV. Permit Renewals

The above information shall be submitted at time of permit renewal in support of the new permit. However, facility information that was submitted to the Department to support the expiring permit, and which is still valid, does not need to be re-submitted for permit renewal. Portions of the application not re-submitted shall be marked "no substantial change" on the application form.

**V. Application Codes**

|          |   |   |
|----------|---|---|
| S        | - | Submitted                                       |
| LOCATION | - | Physical location of information in application |
| N/A      | - | Not Applicable                                  |
| N/C      | - | No Substantial Change                           |

**VI. LISTING OF APPLICATION PARTS**

|         |  |
|---------|--|
| PART A: | GENERAL INFORMATION  |
| PART B: | DISPOSAL FACILITY GENERAL INFORMATION                        |
| PART C: | PROHIBITIONS   |
| PART D: | SOLID WASTE MANAGEMENT FACILITY PERMIT REQUIREMENTS, GENERAL |
| PART E: | LANDFILL PERMIT REQUIREMENTS                                 |
| PART F: | GENERAL CRITERIA FOR LANDFILLS                               |
| PART G: | LANDFILL CONSTRUCTION REQUIREMENTS                           |
| PART H: | HYDROGEOLOGICAL INVESTIGATION REQUIREMENTS                   |
| PART I: | GEOTECHNICAL INVESTIGATION REQUIREMENTS                      |
| PART J: | VERTICAL EXPANSION OF LANDFILLS                              |
| PART K: | LANDFILL OPERATION REQUIREMENTS                              |
| PART L: | WATER QUALITY AND LEACHATE MONITORING REQUIREMENTS           |
| PART M: | SPECIAL WASTE HANDLING REQUIREMENTS                          |
| PART N: | GAS MANAGEMENT SYSTEM REQUIREMENTS                           |
| PART O: | LANDFILL CLOSURE REQUIREMENTS                                |
| PART P: | OTHER CLOSURE PROCEDURES                                     |
| PART Q: | LONG-TERM CARE   |
| PART R: | FINANCIAL ASSURANCE  |
| PART S: | CERTIFICATION BY APPLICANT AND ENGINEER OR PUBLIC OFFICER    |



STATE OF FLORIDA  
DEPARTMENT OF ENVIRONMENTAL PROTECTION  
APPLICATION FOR A PERMIT TO CONSTRUCT, OPERATE, MODIFY OR CLOSE  
A SOLID WASTE MANAGEMENT FACILITY

Please Type or Print

**PART A. GENERAL INFORMATION**

1. Type of disposal facility (check all that apply):

- |  |  |
|--|--|
| <input checked="" type="checkbox"/> Class I Landfill | <input type="checkbox"/> Ash Monofill      |
| <input type="checkbox"/> Class III Landfill          | <input type="checkbox"/> Asbestos Monofill |
| <input type="checkbox"/> Industrial Solid Waste      |  |
| <input type="checkbox"/> Other Describe:             |  |

---

---

---

---

**NOTE:** Waste Processing Facilities should apply on Form 62-701.900(4), FAC;  
Land Clearing Disposal Facilities should notify on Form 62-701.900(3), FAC;  
Compost Facilities should apply on Form 62-701.900(10), FAC; and  
C&D Disposal Facilities should apply on Form 62-701.900(6), FAC

2. Type of application:

- ☐ Construction  
☒ Operation  
☐ Construction/Operation  
☐ Closure  
☐ Long-term Care Only

3. Classification of application:

- |                                  |  |
|----------------------------------|--|
| <input type="checkbox"/> New     | <input type="checkbox"/> Substantial Modification      |
| <input type="checkbox"/> Renewal | <input type="checkbox"/> Intermediate Modification     |
|                                  | <input checked="" type="checkbox"/> Minor Modification |

4. Facility name: Lena Road Class I Landfill Operation Permit

5. DEP ID number: SWD-41-44795 County: Manatee

6. Facility location (main entrance):  
3333 Lena Road, Bradenton, Florida 34211

7. Location coordinates:

Section: (1) (31) (6&7) Township: (35S) (34S) (35S) Range: (18E) (19E) (19E)

Latitude: 27° 28° 10" Longitude: 82° 26' 35"

Datum: NAD 83 Coordinate Method: State Plane Florida East Zone NAD 83

Collected by: Issac F. Rooks, Jr., PSM #5416 Company/Affiliation: I.F. Rooks & Associates

8. Applicant name (operating authority): Manatee County Government - Utilities Department  
Mailing address: 3333 Lena Road, Bradenton, Florida 34211  
Street or P.O. Box City State Zip  
Contact person: Mike Gore Telephone: (941 ) 806-5543 Ext. 8005  
Title: Solid Waste Division Manager  
mike.gore@mymanatee.org  
E-Mail address (if available)
9. Authorized agent/Consultant: Atkins  
Mailing address: 482 South Keller Road, Orlando, Florida 32810  
Street or P.O. Box City State Zip  
Contact person: Joe Miller Telephone: (407 ) 806-4153  
Title: Project Manager  
joseph.miller@atkinsglobal.com  
E-Mail address (if available)
10. Landowner (if different than applicant): \_\_\_\_\_  
Mailing address: \_\_\_\_\_  
Street or P.O. Box City State Zip  
Contact person: \_\_\_\_\_ Telephone: ( ) \_\_\_\_\_  
\_\_\_\_\_ E-Mail address (if available)
11. Cities, towns and areas to be served:  
All of Manatee County, both incorporated and unincorporated, Long Boat Key and small portions of  
neighboring counties.  
\_\_\_\_\_  
\_\_\_\_\_  
\_\_\_\_\_
12. Population to be served:  
Current: 318,176 Five-Year Projection: 326,072
13. Date site will be ready to be inspected for completion: N/A
14. Expected life of the facility: 31 years
15. Estimated costs:  
Total Construction: \$ 0 Closing Costs: \$ 0
16. Anticipated construction starting and completion dates:  
From: N/A To: N/A
17. Expected volume or weight of waste to be received:  
\_\_\_\_\_ yds<sup>3</sup>/day \_\_\_\_\_ 1,280 tons/day \_\_\_\_\_ gallons/day

**PART B. DISPOSAL FACILITY GENERAL INFORMATION**

1. Provide brief description of disposal facility design and operations planned under this application:  
This application is for a minor modification to the operation permit for changes in the operation plan.
2. Facility site supervisor: Brian White  
Title: Landfill Superintendent Telephone: (941) 748-5543 Ext. 8008  
bryan.white@mymanatee.org  
E-Mail address (if available)
3. Disposal area: Total 316 acres; Used 316 acres; Available 0 acres.
4. Weighing scales used: ☒ Yes ☐ No
5. Security to prevent unauthorized use: ☒ Yes ☐ No
6. Charge for waste received: \_\_\_\_\_ \$/yds<sup>3</sup> 36 \$/ton
7. Surrounding land use, zoning:
- |  |   |
|--|---|
| <input checked="" type="checkbox"/> Residential                  | <input type="checkbox"/> Industrial                 |
| <input checked="" type="checkbox"/> Agricultural                 | <input type="checkbox"/> None                       |
| <input type="checkbox"/> Commercial                              | <input checked="" type="checkbox"/> Other Describe: |
| <u>Transportation and Utilities - Wastewater Treatment Plant</u> |   |
8. Types of waste received:
- |  |  |
|--|--|
| <input checked="" type="checkbox"/> Household              | <input checked="" type="checkbox"/> C & D debris       |
| <input checked="" type="checkbox"/> Commercial             | <input checked="" type="checkbox"/> Shredded/cut tires |
| <input type="checkbox"/> Incinerator/WTE ash               | <input checked="" type="checkbox"/> Yard trash         |
| <input type="checkbox"/> Treated biomedical                | <input type="checkbox"/> Septic tank                   |
| <input checked="" type="checkbox"/> Water treatment sludge | <input type="checkbox"/> Industrial                    |

- ☐ Air treatment sludge                      ☐ Industrial sludge  
☒ Agricultural                                      ☒ Domestic sludge  
☒ Asbestos    ☐ Other Describe:

---

---

---

---

---

9. Salvaging permitted: ☐ Yes ☒ No

10. Attendant: ☒ Yes ☐ No

Trained operator: ☒ Yes ☐ No

11. Trained spotters: ☒ Yes ☐ No

Number of spotters used: 16

12. Site located in: ☐ Floodplain

☐ Wetlands

☒ Other:

---

---

---

---

---

13. Days of operation: Monday through Saturday

14. Hours of operation: 8:00 A.M. to 5:00 P.M.

15. Days Working Face covered: Daily - Monday through Saturday

16. Elevation of water table: 29 ft. Datum Used: Florida East Zone NAD 83

17. Number of monitoring wells: 18

18. Number of surface monitoring points: 2

19. Gas controls used: ☒ Yes ☐ No

Type controls: ☒ Active ☐ Passive

Gas flaring: ☒ Yes ☐ No

Gas recovery: ☒ Yes ☐ No

20. Landfill unit liner type:

☒ Natural soils

☐ Double geomembrane

☐ Single clay liner

☐ Geomembrane & composite

☐ Single geomembrane

☐ Double composite

☐ Single composite

☐ None

☒ Slurry wall

☐ Other Describe:

---

---

---

---

---

---

---

21. Leachate collection method:

- |  |   |
|--|---|
| <input checked="" type="checkbox"/> Collection pipes | <input type="checkbox"/> Sand layer         |
| <input type="checkbox"/> Geonets                     | <input type="checkbox"/> Gravel layer       |
| <input type="checkbox"/> Well points                 | <input type="checkbox"/> Interceptor trench |
| <input type="checkbox"/> Perimeter ditch             | <input type="checkbox"/> None               |
| <input type="checkbox"/> Other Describe:             |   |

---

---

---

---

---

---

22. Leachate storage method:

- |  |   |
|--|---|
| <input type="checkbox"/> Tanks           | <input type="checkbox"/> Surface impoundments |
| <input type="checkbox"/> Other Describe: |   |

There is no leachate storage at the landfill

---

---

---

---

---

---

23. Leachate treatment method:

- |                                    |   |
|------------------------------------|---|
| <input type="checkbox"/> Oxidation | <input type="checkbox"/> Chemical treatment |
| <input type="checkbox"/> Secondary | <input type="checkbox"/> Settling           |
| <input type="checkbox"/> Advanced  | <input checked="" type="checkbox"/> None    |
| <input type="checkbox"/> Other     |   |

---

---

---

---

---

---

24. Leachate disposal method:

- |  |  |
|--|--|
| <input type="checkbox"/> Recirculated        | <input checked="" type="checkbox"/> Pumped to WWTP           |
| <input type="checkbox"/> Transported to WWTP | <input type="checkbox"/> Discharged to surface water/wetland |
| <input type="checkbox"/> Injection well      | <input type="checkbox"/> Percolation ponds                   |
| <input type="checkbox"/> Evaporation         | <input type="checkbox"/> Spray Irrigation                    |
| <input type="checkbox"/> Other               |  |

---

---

---

---

---

---

25. For leachate discharged to surface waters:

Name and Class of receiving water:

Not applicable

---

---

---

---

---

---

---

---

26. Storm Water:

Collected: ☒ Yes ☐ No

Type of treatment:

Sand filter and/or mechanical filter.

---

---

---

---

---

---

---

---

Name and Class of receiving water:

Cypress Strand and Gates Creek via on-site wetlands.

---

---

---

---

---

---

---

---

27. Environmental Resources Permit (ERP) number or status:

MSSW Permit #403143.01

---

---

---

---

---

---

---

---

1. Applicant:

\_\_\_\_\_ is aware that statements made in this form and attached

  
Signature of Applicant or Agent

4410 66th Street West  
Mailing Address

Bradenton, Florida 34210

---

City, State, Zip Code

(941 ) 792-8811  
Telephone Number

Date: 6/13/2011

Attach letter of authorization if agent is not a governmental official, owner, or corporate officer.

2. Professional Engineer registered in Florida (or Public Officer if authorized under Sections 403.707 and 403.7075, Florida Statutes):

This is to certify that the engineering features of this solid waste management facility have been designed/examined by me and found to conform to engineering principles applicable to such facilities. In my professional judgment, this facility, when properly maintained and operated, will comply with all applicable statutes of the State of Florida and rules of the Department. It is agreed that the undersigned will provide the applicant with a set of instructions of proper maintenance and operation of the facility.

Signature  
Joseph L. Miller, P.E. Project Manager  
Name and Title (please type)

482 South Keller Road  
Mailing Address

Orlando, Florida 32810

---

City, State, Zip Code

joseph.miller@atkinsglobal.com  
E-Mail address (if available)

39177  
Florida Registration Number  
(please affix seal)

(407 ) 806-4153  
Telephone Number

Date: June 10, 2011

Figure K-1

**Landfill Operations - Typical Workweek Staff Schedule**  
(Revised June 10, 2011)

| Monday   | Tuesday  | Wednesday  | Thursday   | Friday   | Saturday                              |
|--|--|--|--|--|---------------------------------------|
| Robert Bennett<br>Landfill Operations<br>Supervisor    | Robert Bennett<br>Landfill Operations<br>Supervisor    | Robert Bennett<br>Landfill Operations<br>Supervisor    | Robert Bennett<br>Landfill Operations<br>Supervisor    | Robert Bennett<br>Landfill Operations<br>Supervisor    |                                       |
| Joshua Fields<br>Disposal Chief                        | Joshua Fields<br>Disposal Chief                        | Joshua Fields<br>Disposal Chief                        | Joshua Fields<br>Disposal Chief                        |  |                                       |
| Roy Ezell<br>Landfill Attendant                        | Roy Ezell<br>Landfill Attendant                        | Roy Ezell<br>Landfill Attendant                        | Roy Ezell<br>Landfill Attendant                        | Roy Ezell<br>Landfill Attendant                        |                                       |
| Wiley Ballard<br>Landfill Operator                     | Wiley Ballard<br>Landfill Operator                     | Wiley Ballard<br>Landfill Operator                     | Wiley Ballard<br>Landfill Operator                     |  |                                       |
| John Gigiliotti<br>Landfill Operator                   | John Gigiliotti<br>Landfill Operator                   |  |  | John Gigiliotti<br>Landfill Operator                   | John Gigiliotti<br>Landfill Operator  |
| Joe Dobosz<br>Landfill Operator                        | Joe Dobosz<br>Landfill Operator                        |  | Joe Dobosz<br>Landfill Operator                        | Joe Dobosz<br>Landfill Operator                        |                                       |
| Juan Garza<br>Landfill Operator                        | Juan Garza<br>Landfill Operator                        |  |  | Juan Garza<br>Landfill Operator                        | Juan Garza<br>Landfill Operator       |
| Timothy Clarkson<br>Landfill Operator                  | Timothy Clarkson<br>Landfill Operator                  |  |  | Timothy Clarkson<br>Landfill Operator                  | Timothy Clarkson<br>Landfill Operator |
| Clayton Mathis<br>Landfill Operator                    | Clayton Mathis<br>Landfill Operator                    | Clayton Mathis<br>Landfill Operator                    | Clayton Mathis<br>Landfill Operator                    | Clayton Mathis<br>Landfill Operator                    |                                       |
|  |  | Eric Siegfried<br>Disposal Chief                       | Eric Siegfried<br>Disposal Chief                       | Eric Siegfried<br>Disposal Chief                       | Eric Siegfried<br>Disposal Chief      |
| Keith Jones<br>Landfill Operator                       | Keith Jones<br>Landfill Operator                       |  | Keith Jones<br>Landfill Operator                       | Keith Jones<br>Landfill Operator                       |                                       |
|  |  | Vacant<br>Landfill Operator                            | Vacant<br>Landfill Operator                            | Vacant<br>Landfill Operator                            | Vacant<br>Landfill Operator           |
|  |  | Danny Newman<br>Landfill Operator                      | Danny Newman<br>Landfill Operator                      | Danny Newman<br>Landfill Operator                      | Danny Newman<br>Landfill Operator     |
| Mathew Stull<br>Landfill Operator                      | Mathew Stull<br>Landfill Operator                      | Mathew Stull<br>Landfill Operator                      | Mathew Stull<br>Landfill Operator                      |  |                                       |
| Anthony Detweiler<br>Landfill Operations<br>Supervisor | Anthony Detweiler<br>Landfill Operations<br>Supervisor | Anthony Detweiler<br>Landfill Operations<br>Supervisor | Anthony Detweiler<br>Landfill Operations<br>Supervisor | Anthony Detweiler<br>Landfill Operations<br>Supervisor |                                       |
| Richard Jones<br>Maintenance Chief                     | Richard Jones<br>Maintenance Chief                     | Richard Jones<br>Maintenance Chief                     | Richard Jones<br>Maintenance Chief                     | Richard Jones<br>Maintenance Chief                     |                                       |
| Armando Ayala<br>Landfill Operator                     | Armando Ayala<br>Landfill Operator                     | Armando Ayala<br>Landfill Operator                     | Armando Ayala<br>Landfill Operator                     | Armando Ayala<br>Landfill Operator                     |                                       |
| Mark Bell<br>Landfill Operator                         | Mark Bell<br>Landfill Operator                         | Mark Bell<br>Landfill Operator                         | Mark Bell<br>Landfill Operator                         | Mark Bell<br>Landfill Operator                         |                                       |
| Keith Parker<br>Landfill Operator                      | Keith Parker<br>Landfill Operator                      | Keith Parker<br>Landfill Operator                      | Keith Parker<br>Landfill Operator                      | Keith Parker<br>Landfill Operator                      |                                       |
| Gary Seeley<br>Landfill Operator                       | Gary Seeley<br>Landfill Operator                       | Gary Seeley<br>Landfill Operator                       | Gary Seeley<br>Landfill Operator                       | Gary Seeley<br>Landfill Operator                       |                                       |
| Richard Beaulieu<br>Landfill Operator                  | Richard Beaulieu<br>Landfill Operator                  | Richard Beaulieu<br>Landfill Operator                  | Richard Beaulieu<br>Landfill Operator                  | Richard Beaulieu<br>Landfill Operator                  |                                       |

Note: This schedule is updated as needed



## 2.0 Operations Plan

### a. Designation of Responsible Operating and Maintenance Personnel

The Manatee County Solid Waste Management Facility (Landfill) is owned by Manatee County Government and operated under the direction of the Utilities Department, Solid Waste Division. An After Hours Contact List is provided in Table K-1, and a list of landfill positions is given below

|                                     |                                       |
|-------------------------------------|---------------------------------------|
| Solid Waste Division Manager*       | Landfill Superintendent *             |
| Landfill Operation Supervisor (2) * | Household Hazardous Waste Technician* |
| Solid Waste Coordinator *           | Solid Waste Maintenance Chief *       |
| Solid Waste Disposal Chief (2)*     | Administrative Assistant              |
| Landfill Operator (15)*             | Landfill Attendant*                   |
| Scalehouse Supervisor               | Recycling Program Coordinator*        |
| Senior Scalehouse Operator (2)      | Recycling Program Specialist          |
| Scalehouse Operator (4)             | Solid Waste Enforcement Officers (4)* |

\* Trained spotters (Revised June 10, 2011)

### b. Contingency Operations for Emergencies

In the event of an emergency, the County may close the landfill during the emergency event, but will maintain open access to the landfill after the emergency condition passes or the threat level drops. For example, the landfill will be closed during a hurricane, but opened after the hurricane has passed. On-site equipment may not be sufficient to maintain the excess volume of waste generated in an emergency. If so, backup equipment will be rented within 24 hours from the County's approved bid list. Additionally, back-up equipment will be provided for equipment breakdowns and down time for routine maintenance. In the case of equipment failure or emergencies, rental equipment or equipment from other County agencies will be delivered to the site within 24 hours if necessary.

Emergency conditions at the landfill may occur as a result of natural weather events (tornado, flooding, hurricanes, etc.) or fire. Staff is currently equipped to mobilize to alternative sites that will be designated as such in conjunction with the Manatee County Emergency Management Department. In the event that emergency conditions interrupt operations at the landfill, a contingency plan will be developed and implemented to establish temporary operations on a case-by-case basis, dependent on conditions at alternative sites such as the closed Erie Road Landfill. Such temporary operations will accept storm debris only, and will be terminated and disposal operations resumed at Lena Road Landfill as soon as practical. If the Lena Road Landfill cannot operate during an emergency, solid waste collection trucks will be diverted to Waste Management's Okeechobee Landfill.

When an emergency condition threatens the landfill operation, the following actions will be taken:

1. Daily cover shall be applied to all exposed refuse before a major storm arrives, if possible.
2. All landfill equipment shall be parked near any natural windcreens such as earthen mounds and berms.
3. All lightweight signs and equipment shall be secured.
4. When operation resumes, work shall commence in dry areas only (up from the active face).
5. Refuse shall not be disposed of in standing water.



**Table K-1 (Revised June 10, 2011)**  
**Emergency and After Hours Contacts**  
**Lena Road Landfill/Solid Waste Division**

| Person/Agency   | Telephone Number                           |
|---|--|
| <u>Fire Department</u><br>Battalion Captain Stacey Bailey<br>Chief Byron Teates<br>Manatee County Fire Rescue<br>Administration Office:<br>3200 Lakewood Ranch Blvd, Bradenton<br>First Responder: Station 2<br>803 60 <sup>th</sup> Street Court East<br>Bradenton, FL 34202 | 911 Non-Emergency # 751-5611               |
| <u>Ambulance</u> 911  | <u>Sheriff</u> 911                         |
| <u>Bomb Squad</u> 911<br>Lieutenant Gary Samons   | Non-Emergency # 747-3011<br>Extension 1980 |
| <u>Public Safety Haz Mat Coordinator</u><br>Bob Tollise   | 911<br>Non-Emergency # 727-6223            |
| <u>Mike Gore, Solid Waste Division Manager</u>  | H: 322-8094<br>C: 812-4531                 |
| <u>Bryan White, Landfill Superintendent</u>   | H: 322-2369<br>C: 812-2455                 |
| <u>Bob Bennett, Landfill Operations Supervisor</u>  | H: 758-1741<br>C: 704-7855                 |
| <u>Anthony Detweiler, Landfill Operations Supervisor</u>  | H: 322-8703<br>C: 812-8796                 |
| <u>Eric Siegfried, Solid Waste Disposal Chief</u>   | H: 756-3507<br>C: 730-6554                 |
| <u>Joshua Fields, Solid Waste Disposal Chief</u>  | C: 321-3290                                |
| <u>Richard Jones, Solid Waste Maintenance Chief</u>   | C: 322-4104                                |
| <u>David Pickup, Recycling Coordinator</u>  | C: 962-4087                                |
| <u>Debora Braziel-Jones Scalehouse Supervisor</u>   | H: 755-8950                                |
| <u>Jeanne' Detweiler, Solid Waste Coordinator</u>   | H: 322-8703<br>C: 812-4301                 |
| <u>Department of Environmental Protection</u><br>Susan Pelz   | Office: 813-632-7600<br>X 386              |

Lena Road Landfill Operations Permit  
May 10, 2010



- Used oil (up to 1000 gallons) is to be removed quarterly
- Paints (up to 16,600 gallons) are to be removed quarterly
- Batteries (up to 300 batteries) are to be removed quarterly
- Light bulbs (up to 3000) are to be removed at least quarterly
- Electronic devices (up to 50,000 pounds) are to be removed quarterly
- Household Hazardous Waste (up to 2,500 pounds) are to be removed quarterly

#### White Goods

All white goods containing Freon (e.g., refrigerators, air conditioners) are segregated from the waste stream and placed upright in the staging area. Freon is removed by a certified operator, and the item marked as being Freon free. The compressors are removed and oils drained off-site for collection by a licensed hazardous waste transporter under the direction of the scrap metal processor. The white goods are then moved to the general white goods/scrap metal area for collection by the scrap metal contractor.

All white goods, as defined in 62-701.200 (141), entering the landfill in separated loads are sent directly to the designated white goods/scrap metal storage area to be collected by a private scrap metal contractor for recycling purposes.

Up to 400 tons of scrap metal and white goods (a maximum of 600 pieces of white goods) can be stored in this area. The minimum frequency for removal is every six months.

#### Yard Waste

Disposal of yard waste in the Class I Landfill is prohibited. All incoming yard waste is directed to the designated area to be processed on site by a contracted vendor and removed from the site for re-use in land applications or waste-to-energy plants as fuel. Mulch is also used for the wet weather area during rainy season to assure access to the tipping area during rain events. The minimum frequency for processing yard trash is once every six months or when 3,000 tons (12,000 cubic yards) are accumulated. The contracted vendor then removes the shredded material for re-sale to various outlets for land applications or waste-to-energy plants for fuel. The fines generated are also utilized at the Landfill and mixed with soil for use as initial cover.

#### Tires

Tires entering the landfill are directed to the permitted storage area. Large agricultural equipment tires and large or solid forklift tires that cannot be processed for recycling are sent to the landfill disposal area for disposal in the landfill. The contracted vendor removes the tires to a waste-to-energy facility for processing and use as a fuel additive. Removal by the vendors is conducted on an on-call basis.

#### Batteries

State regulations prohibit disposal of lead-acid batteries in a landfill. The County prohibits collection of batteries by its franchised waste haulers. The Solid Waste Management Act aids in providing for proper disposal by requiring that all entities that sell batteries at retail shall accept used batteries as trade-ins for new batteries.



## 7.0 Waste Compaction

---

### a. Waste Layer Thickness

Waste is typically dumped at the toe of the working face and is spread over the face in a maximum of two-foot lifts prior to compaction. This procedure continues throughout the day for a typical lift thickness of no more than 10-feet.

### b. First Waste Layer

The area to be filled has been completely covered by waste during previous permit periods. The first layer of waste placed above the leachate collection system in Stage II will be a minimum of four feet in compacted thickness and shall consist of selected wastes containing no large rigid objects that may damage the leachate collection system. Special care shall be exercised when filling around pump stations to prevent damage.

### c. Slopes and Lift Depths

The exterior landfill side slope is constructed at 4:1 (H:V) because due to settlement the side slope tends to settle to a final slope of 5:1. Any temporary slopes for such structures as storm water diversion dikes, roads, excavations, etc. are constructed with slopes no steeper than 3:1. The lift depths shall be 10-feet or less. The typical minimum top slopes to promote drainage are generally one percent within the bermed working face, and two percent on the intermediate cover areas.

### d. Working Face

The active face width is no greater than necessary to accommodate the peak number of disposal vehicles at one time. The wider the active face, the more cover soil is used. The County uses an active face of 150 feet. The working area of the active face slope is approximately 5 horizontal to 1 vertical. The objective for the dimensions of the active face is to maximize the volume to face surface ratio.

### e. Initial Cover Controls

Materials used as cover include tarp alternative daily cover (ADC), soil, street sweepings, ditch cleaning soil, dredge material, soil with up to 25% fines from the yard processing area and recovered screen material (RSM) from Department permitted facilities. The ADC, when used, covers the working face with a weighted tarp. Currently, 100' x 40' tarps are used to cover the working face. Soil, when used, is applied daily at a minimum thickness of six inches. While The Department in letters dated February 14, 2002 and August 27, 2002 (See attachment K-1 for copies of letters) permitted ground-up construction and demolition debris including asphalt roofing shingles, unscreened, applied in a six inch compacted layer as initial cover within the bermed working area. Manatee County no longer uses these types of materials and does not plan to use these again. Soil, with up to 25% fines from yard trash processing by volume, may be used for initial cover. (Revised June 10, 2011)

## 14.0 Special Waste Handling

---

a. Motor Vehicles

Motor vehicles are not presently accepted for disposal or temporary storage at Lena Road Landfill.

b. Shredded Waste

Shredded municipal waste is not accepted for disposal at Lend Road Landfill. Shredded tires may be accepted if not recycled.

c. Asbestos

Asbestos containing materials from sources covered under the National Emission Standards for Asbestos, 40 CFR Part 61, Subpart M are accepted at Lena Road Landfill, with prior approval of the County. These materials will be placed in the landfill by appointment only, covered with a minimum of one foot of ~~cover soil~~ non-asbestos containing waste or soil, and the location will be recorded in accordance with 40 CFR Part 61.154. A record of the location of asbestos-containing waste will be maintained. (Revised June 10, 2011)

d. Contaminated Soil

Soils contaminated with non-hazardous waste and petroleum-contaminated soil, which has been treated pursuant to Chapter 62-775, F.A.C., will be accepted at the discretion of the County.

e. Biological Waste

Biological waste is not accepted.



**Attachment K-2**

**Household Hazardous Waste Collection  
And Storage Facility**

**Lena Road Landfill  
3333 Lena Road  
Bradenton, FL 34202**

**Revised May 10, 2010**

Prepared by:

Manatee County Government  
Utilities **Operations** Department  
Solid Waste Division  
3333 Lena Road  
Bradenton, FL 3421

**(Revised June 10, 2011)**

## 2.0 History

---

The Manatee County Household Hazardous Waste Collection and Storage Facility opened in May 1993 within the Stage III Landfill. This facility was removed as solid waste filled the Stage III Landfill.

The recently completed Administration Facilities includes a household hazardous waste collection and storage facility. The facility floor plan is shown on Figure K-2-1, and a cross section is shown on Figure K-2-2. The building includes forced air ventilation, dry chemical fire suppression system, and storage for hazardous waste. The building is engineered to comply with EPA, NAPA, and OSHA standards and regulations for storing hazardous chemicals and wastes. The building is also corrosion resistant and features secondary containment for the prevention of spills or leaks. The facility has a concrete slab and is under a roof as shown on the figures. The materials processed and the method of processing remains essentially the same at the new facility.

Note: Figure K-2-1 revised May 2011. (Revised June 10, 2011)



## Facility Program

---

Monthly collections/events are operated by the certified Household Hazardous Waste Technician in the new Hazardous Waste Facility located at ~~of~~ the Landfill. The Hazardous Waste contractor is on site at the collection to assist with unloading. The contractor bulks and lab packs any of the waste material received during the collection. Partial containers are stored in the Hazardous Waste storage building until the following monthly collection. The ~~certified~~ Hazardous Waste Technician reviews all paperwork and has the responsibility of approving and signing outgoing manifests.

Materials are accepted from County residents during non-operating hours by appointment ~~or as determined by~~ the HHW technician. In addition, collection services at the residence are available for those persons who are unable to attend the event due to circumstance of health, ~~handicap~~ physically disabled or age.

Manatee County has a ~~permanent~~ Household Hazardous Waste program for the collection of materials at the facility. Monthly collections are conducted for the residential citizens and annual or semi-annual events for the CESQGs. These events are advertised in the County's utility billing and the local newspapers. General Household Hazardous Waste program information is available on the County's website at [www.myanatee.org/hhw](http://www.myanatee.org/hhw).

~~Monthly collection events are operated by the Household Hazardous Waste Technician and two-three trained assistants. The Hazardous Waste contractor is also on site with staff and equipment to bulk and lab pack materials collected during the collection. All partial containers are stored within the Hazardous Waste storage building at the Lena Road Landfill until the following monthly collection.~~

(Revised June 10, 2011)



## 13.0 Waste Segregation

---

The following are bulked as grouped below:

- Latex based paints,
- Oil based paints,
- Antifreeze,
- Motor oil and transmission fluid.

The wastes are compatible for bulking, and are only bulked if clearly identified by sight, smell, container, label and source. Any wastes that are not clearly identifiable are not bulked, and the unknown wastes are sent with contractor.

Paint is stored in a lined 40 yard roll off container or lined crates located on a concrete pad. ~~covered with a plastic sheet.~~ Paint is bulked into a 55-gallon steel drum, and generally removed the same day or within 24-hours. If paint is spilled, it is contained on the plastic sheet by absorbent pads or absorbent.

Antifreeze is bulked into a 55-gallon drum. If antifreeze is spilled it is contained on the plastic sheet by absorbent pads or absorbent.

Motor oil and transmission fluid is being poured into a 20 gallon tank then pumped (or poured using a funnel) into a 500-gallon storage tank or in 375 or 275 gallon portable tanks. The bulking is done outside, under a main roof of the Hazardous Waste Facility. ~~within a containment area.~~

### 13.3 Unknowns

Unknowns are accepted. These items are materials that cannot be identified by either original labels or by participant knowledge. The following procedures are adhered to:

- Unknowns will be sent out with the contractor.
- Place material into appropriate storage building according to suspected hazards.

### 13.4 Electronic Waste

Electronic waste such as TVs, computer monitors, microwave ovens, telephones, keyboards, VCRs, radios, etc. are received at the Household Hazardous Waste Collection. The contractor is on site during the collection event and materials are sorted, palletized, shrink wrapped or put in Gaylord boxes then removed the day of the collection. If there are more pallets than the will fit in the contractor's trucks, the pallets of materials and/or roll-off box are stored under the roof of the Household Hazardous Waste Facility until the contractor comes to pick them up. The contracted e-scrap recycler removes the e-scrap for processing and recycling. Broken glass and components from broken units is swept up and properly disposed.

Electronic waste is also collected curbside by the contracted waste haulers. The hauler brings the materials to the landfill to be stored in the designated area which is the SW corner of the white goods/scrap metal concrete pad. Additionally, residents may drop off electronic waste Monday through Saturday during landfill hours. This material is stored in the SW corner of the white goods/scrap metal area also. Materials are removed by a private recycling contractor for proper recycling. (Revised June 10, 2011)



**LENA ROAD LANDFILL EQUIPMENT REPLACEMENT SCHEDULE**

| MODEL/YEAR                         | ASSET # | CAT SERIAL<br>NUMBER | DELIVERY DATE<br>AMOUNT PAID | BUY BACK DATE<br>BUY BACK AMOUNT | WARRANTY<br>EXPIRES   | 2008/2009        | 2009/2010        | 2010/2011     | 2011/2012      |
|------------------------------------|---------|----------------------|------------------------------|----------------------------------|-----------------------|------------------|------------------|---------------|----------------|
| 1 <i>Compactor 06 Cat 836H</i>     | 50378   | OBXD00426            | 10/30/2006/\$848,000         | ☀ 10/30/11 - \$200,000           | 10/30/11 or 7500 Hrs  |                  |                  |               |                |
| 2 <i>Compactor 08 Cat 836H</i>     | 52582   | OBXD00684            | 9/3/08/\$863,000             | ***** 9/3/2011 - \$280,000       | 9/3/11 or 7500 Hrs    | 863,000          |                  |               |                |
| 3 <i>Compactor 10 Cat 836H</i>     | 54462   | OBXD01010            | 8/25/2010/\$788,988          | 9/26/2014 - \$250,000            | 9/26/14 or 7500Hrs    |                  | 788,988          |               |                |
| 4 <i>Dozer 07 Cat D7R LPG</i>      | 54106   | OABJ01731            | 2/5/2010/\$478,305           | 2/5/2014 - \$180,000             | 2/5/14 or 7500 Hrs    |                  | 479,000          |               |                |
| 5 <i>Dozer 07 Cat D7R LPG</i>      | 54107   | OABJ01732            | 2/8/2010/\$478,305           | 2/8/2014 - \$180,000             | 2/8/14 or 7500 Hrs    |                  | 479,000          |               |                |
| 6 <i>Dozer 07 Cat D7R LPG</i>      | 54108   | OABJ01733            | 2/16/2010/\$478,305          | 2/16/2014 - \$180,000            | 2/16/10 or 7500 Hrs   |                  | 479,000          |               |                |
| 7 <i>Dozer 07 Cat D7R LPG</i>      | 54109   | OABJ01734            | 2/22/2010/\$478,305          | 2/22/2014 - \$180,000            | 2/22/14 or 7500 Hrs   |                  | 479,000          |               |                |
| 8 Excavator 04 Cat 345BL           | 47296   | OAGS02530            | 10/14/2004/\$320,000         | 10/14/09 - \$120,000             | 10/14/09 or 7500 Hrs  |                  |                  |               |                |
| 9 <i>Excavator 06 Cat 345CL</i>    | 50365   | PJW01406             | 10/5/2006/\$429,000          | 10/5/11 - \$165,000              | 11/14/11 or 7500 Hrs  |                  |                  |               |                |
| 10 Scraper 03 Cat 623G             | 46268   | OCES00463            | 1/16/2004/\$550,000          | 1/16/2009 - \$125,000            | 1/16/09 or 7500 Hrs   |                  |                  |               |                |
| 11 Dozer 06 Cat D6TLGP             | 51116   | OWCG00342            | 7/23/07/\$343,000            |                                  | 7/23/12 or 7500 Hrs   |                  |                  |               | 365,000        |
| 13 Dump Truck 06 Cat 740 Ejector   | 49857   | OB1R00254            | 8/17/2006/\$580,000          |                                  | 8/17/11 or 7500 Hrs   |                  |                  |               |                |
| 14 Dump Truck 08 Cat 740 Ejector   | 52386   | OB1R00453            | 7/21/08/\$595,397            |                                  | 7/21/13 or 7500 Hrs   |                  |                  |               |                |
| 15 Dump Truck 09 Cat 740 Ejector   | 53618   | OB1R00465            | 5/14/09/\$515,000            |                                  | 5/14/14 or 7500 Hrs   | 515,000          |                  |               |                |
| 16 Loader 05 Cat 950G              | 47493   | AXX01429             | 6/22/2005/\$180,000          |                                  | 6/22/09 or 7500 Hrs   |                  |                  |               | 258,000        |
| 17 Loader 07 Cat 950H              | 50843   | KSK01381             | 5/15/07/\$241,000            |                                  | 5/15/12 or 7500 Hrs   |                  |                  |               |                |
| 18 Loader 09 Cat 950G              | 53641   | KS5K02393            | 6/10/09/\$256,436            |                                  | 6/10/14 or 6,000 Hrs  | 257,000          |                  |               |                |
| 19 Water Wagon 01 Cat 613C         | 42442   | 8LJ02122             | 7/13/2001/\$215,000          |                                  |                       |                  |                  |               |                |
| 20 Water Wagon 07 Cat 613CII       | 51835   | 8LJ03393             | 1/3/08/\$331,000             |                                  | 1/3/13 or 7000 Hrs    |                  |                  |               |                |
| 21 Grader 02 Cat 143H              | 44155   | 1AL01321             | 9/20/2002/\$173,000          |                                  | 9/20/2007 or 5000 Hrs |                  |                  |               |                |
| 22 Vibrating Roller 07 Saki        | 50574   |                      | 3/9/2007/\$76,000            |                                  | 3/19/10 or 3000 Hrs   |                  |                  |               |                |
| 23 02 John Deere 7810              | 44484   |                      | 12/10/2002/\$82,000          |                                  |                       |                  |                  |               |                |
| 24 02 Schulte 21' Flex Deck        | 45322   |                      | 6/24/2003/\$16,000           |                                  |                       |                  |                  |               | 16,900         |
| 25 06 Massey Ferguson 6495         | 49048   |                      | 3/17/2006/\$80,000           |                                  |                       |                  |                  |               |                |
| 26 06 Alamo Eagle 20' Flex Deck    | 49770   |                      | 7/19/2006/\$18,400           |                                  |                       |                  |                  |               |                |
| 27 07 Kubota M7040HDC              | 51225   |                      | 8/29/07 \$43,000             |                                  |                       |                  |                  |               |                |
| 28 06 6' Finish Rotary Cutter Deck | 49707   |                      | 6/20/2006/\$3,500            |                                  |                       |                  |                  |               |                |
| 29 99 Bush Hog 15' Flex Deck       | 40672   |                      | 11/17/1999/\$11,000          |                                  |                       |                  |                  |               |                |
| 30 Refueler 02 International 4300  | 44483   |                      | 12/9/2002                    |                                  |                       |                  |                  |               |                |
| 31 04 Roll-Off Truck/Containers    | 46828   |                      | 7/13/2004/\$139,000          |                                  |                       |                  |                  |               |                |
| 32 Tarpomatic 04 28T               | 47295   |                      | 10/4/2004/\$75,000           |                                  |                       |                  |                  |               | 70,000         |
| 33 Tarpomatic 06 28T               | 49499   |                      | 4/19/2006/\$82,000           |                                  |                       |                  |                  |               |                |
| 34 Pump 04 6" 6V-DDST-4-2011       | 47366   |                      | 12/13/2004/\$25,000          |                                  |                       |                  |                  |               |                |
| 35 Pump 06 6" 6V-DDST-4-2011       | 48865   |                      | 2/14/2006/\$28,000           |                                  |                       |                  |                  |               |                |
| 36 Air Compressor 99 2545E10       | 39965   |                      | 2000/\$13,000                |                                  |                       |                  |                  | 15,000        |                |
| 37 Skag Mower 2010 # E2100202      | 54280   |                      | 5/11/10/\$14,543             |                                  |                       |                  | 14,543           |               |                |
| 38 Grasshopper Mower 08 928D       | 52367   |                      | 7/16/08/\$13,500             |                                  |                       |                  |                  |               |                |
| 39 Forklift 96 JCB 930B            | 34465   |                      | 8/26/1996/\$33,000           |                                  |                       |                  |                  |               |                |
| 40 Trailer 01 Crosley 8.5x25       | 42631   |                      | 9/28/2001/\$8,000            |                                  |                       |                  |                  |               |                |
| 41 Flare Air Compressor IRN10H-150 | 54212   |                      | 12/17/2009/\$12992           |                                  |                       |                  |                  |               |                |
| 42 Tennant Sweeper #S30-2151       | 54283   |                      | 5/14/2010/\$42,291           |                                  |                       |                  | 42,291           |               |                |
| <b>TOTAL COST REPLACEMENT</b>      |         |                      |                              |                                  |                       | <b>1,635,000</b> | <b>2,761,822</b> | <b>15,000</b> | <b>709,900</b> |

Equipment in red - on buy backs. ☀ Original buy back date for #50124 was 9/26/09, #50378 was 10/30/09, both in the amount of \$250,000.  
 \*\*\*\*\*Price to rebuild #52582, not taking advantage of buy back. REV 11/2/10

CC: UD - Tina Fletcher, Bev Chiotti, FMD - Peggy Curtin, Sandy Kirkby  
 Mike Gore, Bryan White, Bob Bennett, Anthony Detweiler, Jeanne Detweiler  
 Fleet - Mike Brennen, Ron Kennedy

FLORIDA DEPARTMENT OF  
 ENVIRONMENTAL PROTECTION  
 JUN 15 2011  
 SOUTHWEST DISTRICT  
 TAMPA



**LENA ROAD LANDFILL EQUIPMENT REPLACEMENT SCHEDULE**

| 2012/2013  | MODEL/YEAR                                | 2013/2014        | 2014/2015      | 2015/2016        | 2016/2017        | 2017/2018        | 2018/2019      | 2019/2020     | 2020/2021        | 2021/2022        | 2022/2023        |
|------------|---|------------------|----------------|------------------|------------------|------------------|----------------|---------------|------------------|------------------|------------------|
|            | 1 <i>Compactor 06 Cat 836H</i>            |                  |                |                  |                  |                  |                |               |                  |                  |                  |
| 312,865    | 2 <i>Compactor 08 Cat 836H</i>            |                  |                |                  | 1,060,213        |                  |                |               | 1,060,213        |                  |                  |
|            | 3 <i>Compactor 10 Cat 836H</i>            | 1,060,213        |                |                  |                  | 1,060,213        |                |               |                  | 1,060,213        |                  |
|            | 4 <i>Dozer 04 Cat D7RLGP</i>              | 479,000          |                |                  |                  | 479,000          |                |               |                  | 479,000          |                  |
|            | 5 <i>Dozer 04 Cat D7RLGP</i>              | 479,000          |                |                  |                  | 479,000          |                |               |                  | 479,000          |                  |
|            | 6 <i>Dozer 04 Cat D7RLGP</i>              | 479,000          |                |                  |                  | 479,000          |                |               |                  | 479,000          |                  |
|            | 7 <i>Dozer 04 Cat D7RLGP</i>              | 479,000          |                |                  |                  | 479,000          |                |               |                  | 479,000          |                  |
|            | 8 <i>Excavator 04 Cat 345BL</i>           |                  | 472,000        |                  |                  |                  |                |               |                  |                  |                  |
|            | 9 <i>Excavator 06 Cat 345CL</i>           |                  |                |                  | 472,000          |                  |                |               |                  |                  |                  |
|            | 10 <i>Scraper 03 Cat 623G</i>             |                  |                | 719,000          |                  |                  |                |               | 719,000          |                  |                  |
|            | 11 <i>Dozer 07 Cat D6TLGP</i>             |                  |                |                  | 365,000          |                  |                |               |                  | 365,000          |                  |
|            | 12 <i>Dump Truck 06 Cat 740 Ejector</i>   | 700,000          |                |                  |                  |                  |                |               | 700,000          |                  |                  |
|            | 13 <i>Dump Truck 08 Cat 740 Ejector</i>   |                  |                | 700,000          |                  |                  |                |               |                  |                  | 700,000          |
|            | 14 <i>Dump Truck 09 Cat 740 Ejector</i>   |                  |                |                  | 515,000          |                  |                |               |                  | 258,000          |                  |
|            | 15 <i>Loader 05 Cat 950G</i>              |                  |                |                  | 258,000          |                  |                |               |                  |                  |                  |
|            | 16 <i>Loader 07 Cat 950H</i>              | 258,000          |                |                  |                  |                  | 258,000        |               |                  |                  |                  |
|            | 17 <i>Loader 09 Cat 950G</i>              |                  |                | 258,000          |                  |                  |                |               | 258,000          |                  |                  |
|            | 18 <i>Water Wagon 01 Cat 613C</i>         |                  |                |                  |                  |                  |                |               |                  |                  |                  |
| 375,000    | 19 <i>Water Wagon 07 Cat 613CII</i>       |                  |                |                  |                  | 375,000          |                |               |                  |                  | 375,000          |
|            | 20 <i>Grader 02 Cat 143H</i>              | 173,000          |                |                  |                  |                  |                |               |                  |                  | 173,000          |
|            | 21 <i>Vibrating Roller 07 Saki</i>        |                  |                |                  |                  | 76,000           |                |               |                  |                  |                  |
|            | 22 <i>02 John Deere 7810</i>              |                  | 80,000         |                  |                  |                  |                |               |                  |                  |                  |
|            | 23 <i>02 Schulte 21' Flex Deck</i>        |                  |                |                  |                  |                  |                |               | 16,900           |                  |                  |
|            | 24 <i>06 Massey Ferguson 6495</i>         |                  |                | 80,000           |                  |                  |                |               |                  |                  |                  |
|            | 25 <i>06 Alamo Eagle 20' Flex Deck</i>    |                  |                | 18,400           |                  |                  |                |               |                  |                  |                  |
|            | 26 <i>07 Kubota M7040HDC</i>              |                  |                |                  | 80,000           |                  |                |               |                  |                  |                  |
|            | 27 <i>06 6' Finish Rotary Cutter Deck</i> |                  |                |                  | 3,500            |                  |                |               |                  |                  |                  |
|            | 28 <i>99 Bush Hog 15' Flex Deck</i>       |                  |                |                  |                  |                  |                |               |                  |                  |                  |
|            | 29 <i>Refueler 02 International 4300</i>  | 93,000           |                |                  |                  |                  |                |               |                  |                  |                  |
|            | 30 <i>04 Roll-Off Truck/Containers</i>    | 139,000          |                |                  |                  |                  |                |               |                  |                  | 139,000          |
|            | 31 <i>Tarpomatic 04 28T</i>               |                  |                |                  |                  | 70,000           |                |               |                  |                  |                  |
|            | 32 <i>Tarpomatic 06 28T</i>               |                  | 70,000         |                  |                  |                  |                |               | 70,000           |                  |                  |
| 25,000     | 33 <i>Pump 04 6" 6V-DDST-4-2011</i>       |                  |                |                  |                  |                  |                |               | 25,000           |                  |                  |
|            | 34 <i>Pump 06 6" 6V-DDST-4-2011</i>       |                  |                | 25,000           |                  |                  |                |               |                  |                  | 25,000           |
|            | 35 <i>Air Compressor 99 2545E10</i>       |                  |                |                  | 15,000           |                  |                |               |                  |                  | 15,000           |
|            | 36 <i>Skag Mower 2010 #E2100202</i>       |                  | 15,000         |                  |                  |                  |                | 15,000        |                  |                  |                  |
| 16,000     | 37 <i>Grasshopper Mower 08 928D</i>       |                  |                |                  |                  | 16,000           |                |               |                  |                  |                  |
| 55,000     | 38 <i>Forklift 96 JCB 930B</i>            |                  |                |                  |                  |                  |                |               |                  |                  |                  |
|            | 39 <i>Trailer 01 Crosley 8.5x25</i>       |                  | 7,800          |                  |                  |                  |                |               |                  |                  |                  |
|            | 40  |                  |                |                  |                  |                  |                |               |                  |                  |                  |
|            | 41 <i>Tennant Sweeper #S30-2151</i>       |                  |                |                  |                  |                  |                | 42,291        |                  |                  |                  |
| 783,865    | <b>TOTAL COST REPLACEMENT</b>             | <b>4,339,213</b> | <b>644,800</b> | <b>1,800,400</b> | <b>2,768,713</b> | <b>3,513,213</b> | <b>258,000</b> | <b>57,291</b> | <b>2,849,113</b> | <b>3,599,213</b> | <b>1,427,000</b> |
| Landfill - |   |                  |                |                  |                  |                  |                |               |                  |                  |                  |

FLORIDA DEPARTMENT OF  
ENVIRONMENTAL PROTECTION  
JUN 15 2011  
SOUTHWEST DISTRICT  
TAMPA



U:\OldH\_S\ENVCADD\WASTEMAN\Manatee\Community Drop-Off\A1.1.dwg Jun 10, 2011 - 2:13pm

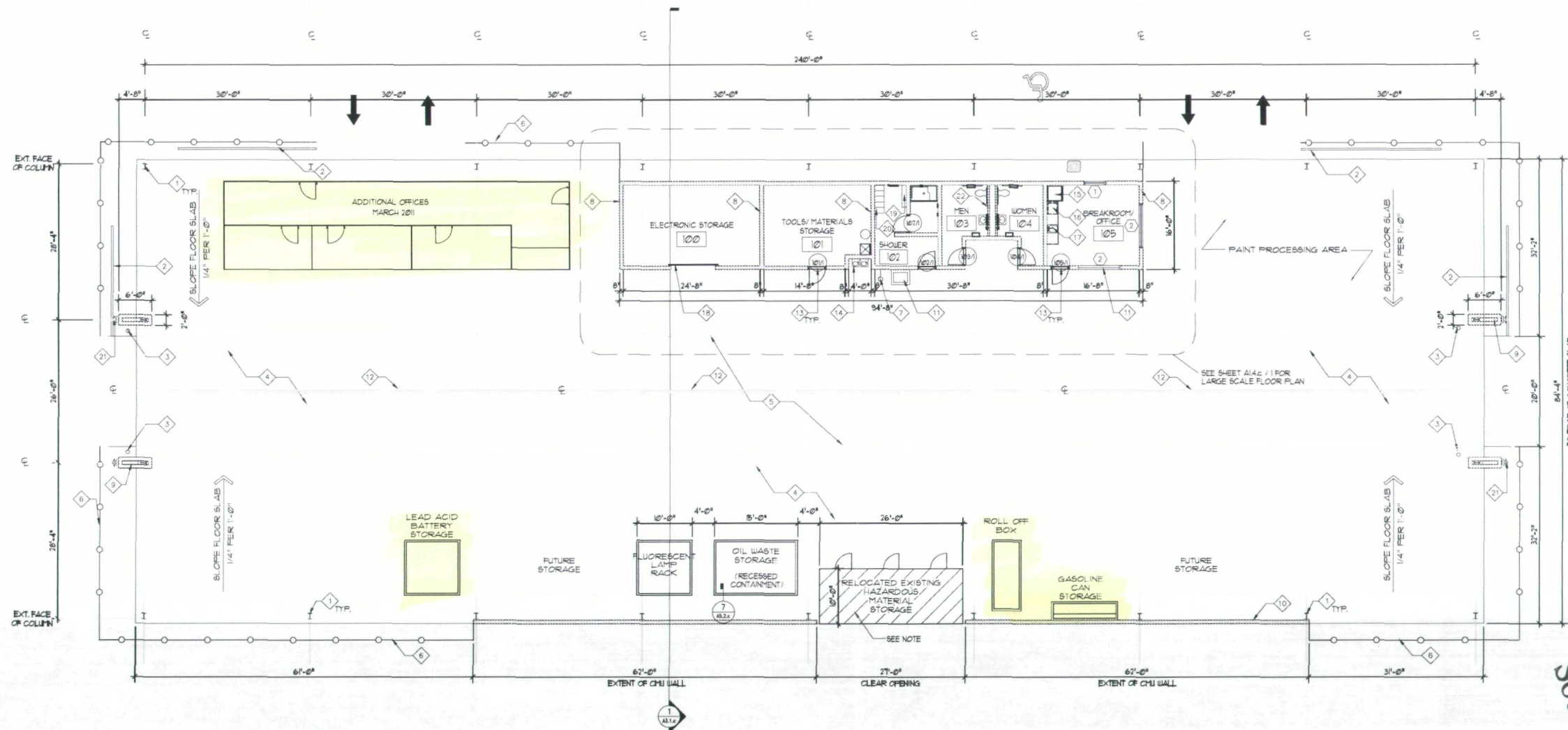

# DRAWING NOTES

- 1. COLUMNS FOR METAL BUILDING STRUCTURE (TYP.)
- 2. 75'-0" WIDE ROLLING GATE WITH OVERHEAD TRACK (TYP.)
- 3. 8" PIPE BOLLARDS
- 4. CONCRETE SLAB
- 5. PAINTED STRIPES ON CONCRETE SLAB
- 6. 8'-0" HIGH CHAIN LINK FENCE
- 7. EMERGENCY SHOWER / EYE WASH COMBINATION
- 8. 8" CMU WALLS
- 9. 2'-0" x 6'-0" CONC. PILASTERS (SEE ELEVATION SHEET A21.c)
- 10. 8" CMU - SCREEN WALL
- 11. UTILITY TUB/SINK
- 12. TRENCH DRAIN
- 13. THRESHOLDS
- 14. HI-LO ELECTRIC WATER COOLERS
- 15. REFRIGERATOR (N.I.C.)
- 16. MICROWAVE (N.I.C.)
- 17. SINK
- 18. OVERHEAD DOOR
- 19. BENCH
- 20. LOCKERS
- 21. WALL SCONES (TYP.)
- 22. 4" CMU WALLS - INTERIOR WALLS

NOTE:  
CONTRACTOR SHALL COORDINATE WITH OWNER THE RELOCATION OF AN EXISTING HAZARDOUS MATERIAL STORAGE (PREFABRICATED BUILDING). THE EXISTING HAZARDOUS MATERIAL STORAGE SHALL BE PLACED IN ITS NEW LOCATION PRIOR TO INSTALLATION OF METAL BUILDING ROOF AND/OR STRUCTURAL MEMBERS THAT MAY INTERFERE WITH THE PLACEMENT OF THE STORAGE BUILDING.

## LEGEND

- CMU WALLS
- INT. FRAME WALLS, NON-RATED
- DRAWING NOTES - SEE THIS SHEET
- DOOR KEY - SEE DOOR SCHEDULE, SHEET A61.c
- WINDOW KEY - SEE WINDOW SCHEDULE, SHEET A61.c
- ROOM TAG - SEE FINISH SCHEDULE, SHEET A61.c
- DETAIL KEY - SEE SHEET AS INDICATED
- WALL TYPES - SEE SHEET A61.c

Revised  
May 2011

FLOOR PLAN  
SCALE: 3/32" = 1'-0"  
20,493 SQ. FT.

Southwest District  
JUN 15 2011  
Dept. of Environmental  
Protection

FIG. K-2-1  
NEW FACILITY FLOOR PLAN  
HOUSEHOLD HAZARDOUS WASTE  
COLLECTION AND STORAGE FACILITY  
OPERATION PLAN



5300 WEST CYPRESS ST.  
SUITE 300  
TAMPA, FLORIDA 33607  
Ph. (813) 282-7275

CLIENT  
**MANATEE COUNTY  
PROJECT MANAGEMENT  
DEPARTMENT**  
1026 26TH AVENUE EAST  
BRADENTON, FLORIDA 34206

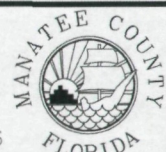

PROJECT NAME:

**LENA ROAD LANDFILL**

**FACILITIES PROJECT - PHASE II**

MANATEE COUNTY PROJECT NO:

60083

**COMMUNITY DROP-OFF**

**FLOOR PLAN**

ORIGINAL  
REVISIONS

1  
2  
3  
4  
5

Handwritten signature and date: 6/15/11

NOT VALID FOR CONSTRUCTION  
UNLESS SIGNED IN THIS BLOCK

PBS&J NO. 120498.13  
DATE 11/25/02  
DRAWN SC  
CHECKED GS  
QC  
SHEET

A1.1.c

100% CONSTRUCTION DOCUMENTS



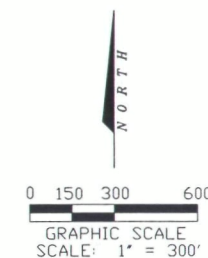
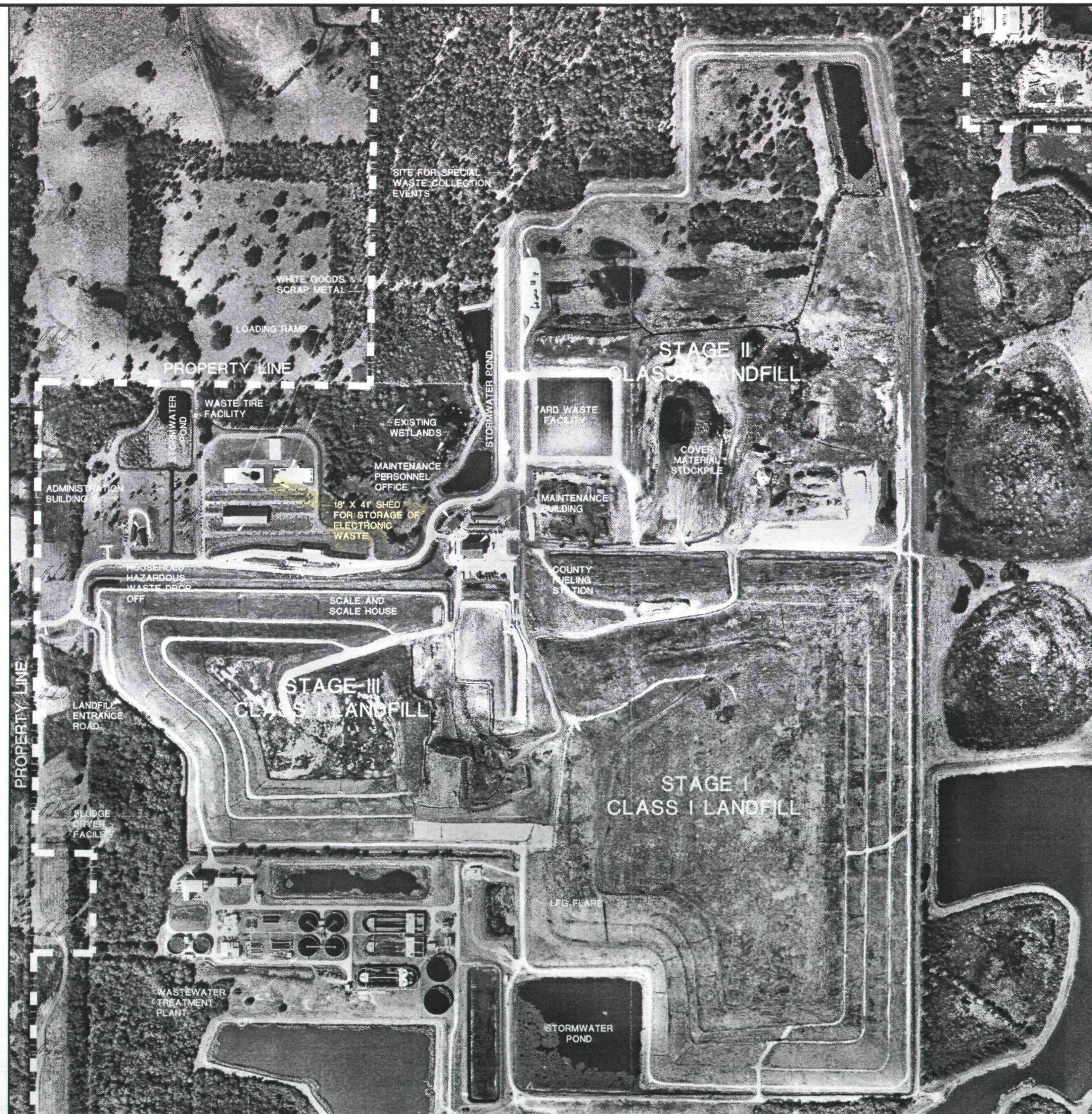

AERIAL PHOTOGRAPH PROVIDED BY:  
 IF. ROOKS & ASSOCIATES, INC.  
 106 N.W. DRANE ST.  
 PLANT CITY, FL 33566  
 (813) 752-2113

DATE FLOWN: JANUARY 25, 2010

*Revised*  
 Dept. of Environmental  
 Protection  
 JUN 15 2011  
 Southwest District

REPLACE 2009 AERIAL PHOTOGRAPHY  
 WITH 2010 AERIAL PHOTOGRAPHY

LAWRENCE MILLER  
 ENGINEER

C-2



482 South Keller Road  
 ORLANDO, FL 32810-6101  
 TEL. (407) 647-7275  
 FAX. (407) 647-0624  
 WWW.PBSJ.COM  
 POST-BUCKLEY, SCHUH & JERNIGAN, Inc.  
 5505 West Cypress Street Suite 200  
 Tampa, FL 33607  
 FPR Certificate of Authorization No. 24

CLIENT  
**MANATEE COUNTY**  
**BOARD OF COUNTY COMMISSIONERS**

PROJECT  
**LENA ROAD LANDFILL**  
**FILL SEQUENCE PLAN**

TASK  
**GENERAL SITE PLAN**

ORIGINAL NOV. 2009  
 REVISIONS:  
 1. APRIL 2010  
 2.  
 3.  
 4.  
 5.

6.  
 7.  
 8.  
 9.  
 10.  
 11.  
 12.

NAME: JOSEPH L. MILLER  
 FLORIDA P.E. No.: 32112  
 Address: 1815 S. Keller Road  
 Orlando, FL 32810-6101  
 Signature: [Signature]  
 Date: 6/10/11  
 JOB NO. 100008517  
 DRAWN: RGC  
 DESIGN: RGC/JLM  
 CHECKED: JLM  
 O.C.: DED  
 SHEET / #