

ROAD CROSSINGS DETAIL (1/1)
NOT TO SCALE

NOTE:
1. SUB-BASE CONSISTS OF 18" OF TYPE "B" STABILIZATION MIN. LBR 40.

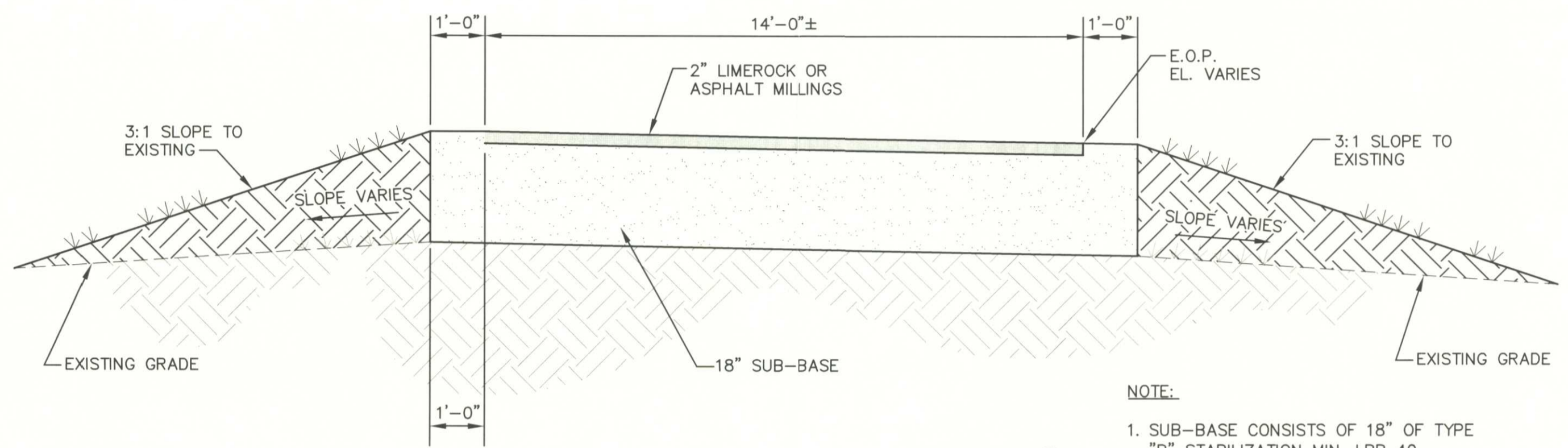

ACCESS ROAD DETAIL (2/1)
NOT TO SCALE

NOTE:
1. SUB-BASE CONSISTS OF 18" OF TYPE "B" STABILIZATION MIN. LBR 40.

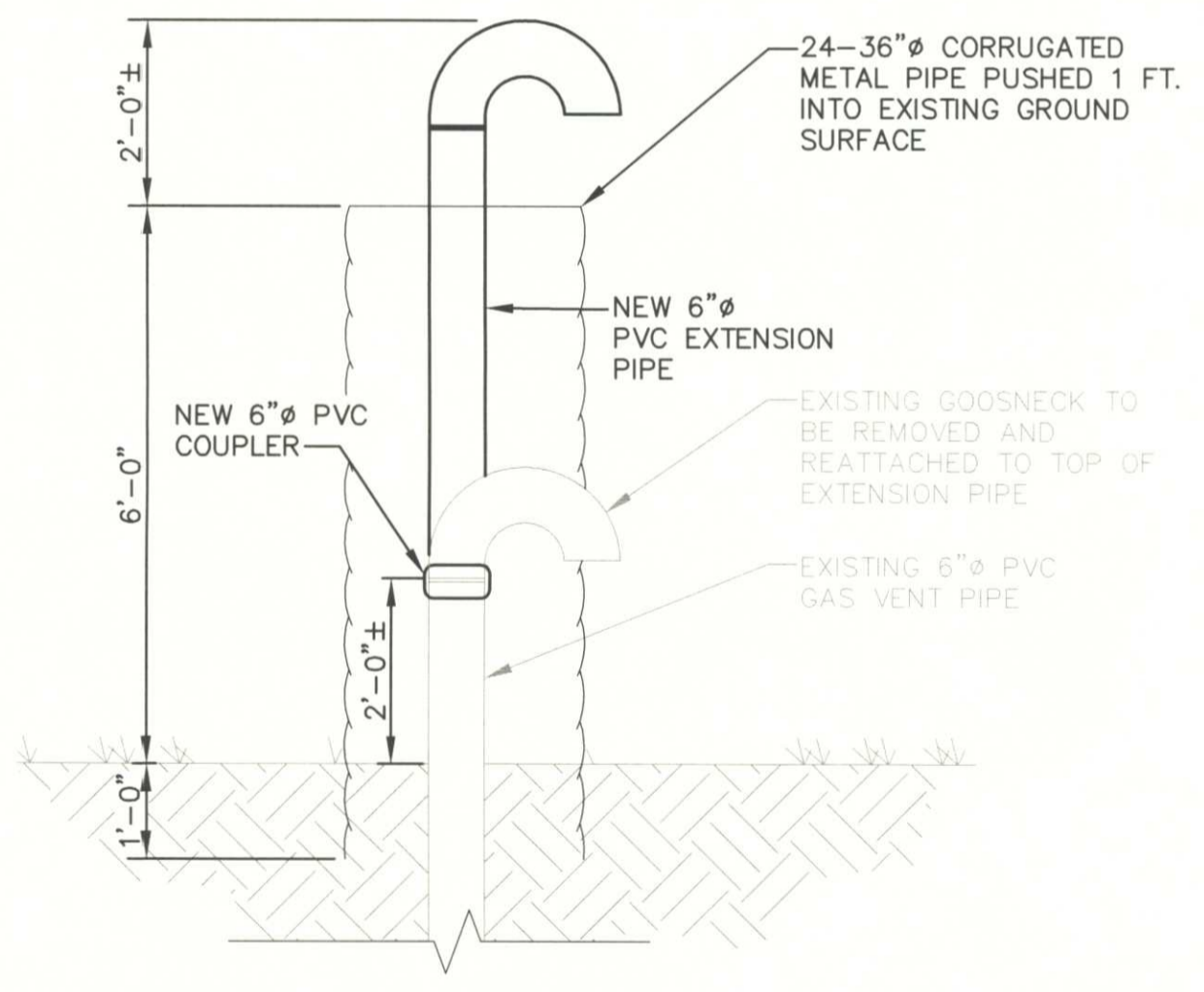

GAS VENT EXTENSION DETAIL (3/1)
SCALE: 1" = 2'

SURVEY SOURCE NOTE:
TOPOGRAPHIC SURVEY INFORMATION SHOWN WAS DEVELOPED BY PHOTOGRAMMETRIC METHODS AND PERFORMED BY KUCERA SOUTH, LAKELAND, FLORIDA.
AERIAL PHOTO DATE: 10/11/07

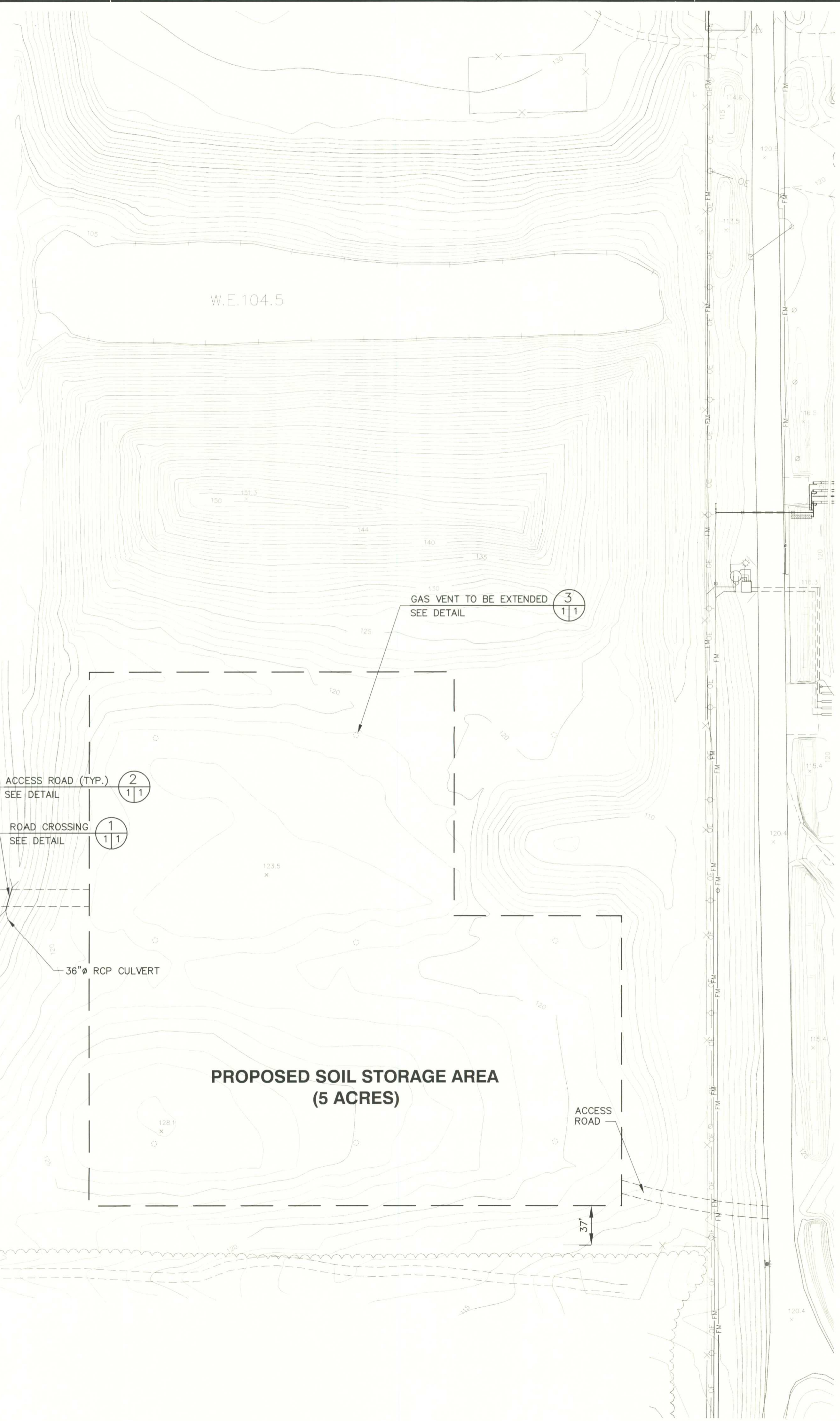

LEGEND
 - - - - - EXISTING ELEVATIONAL CONTOURS (FEET) - 10/11/07 SURVEY
 - - - - - SOIL STORAGE AREA
 ○ EXISTING PASSIVE GAS VENT

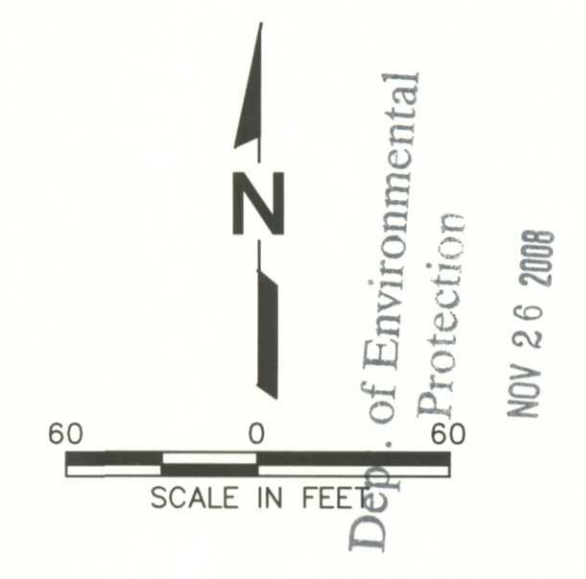

Daniel R. Cooper, P.E.
 License No. 66440
 NOV 26 2008
 Southwest District

REV	DATE	DESCRIPTION	BY

DRAWING TITLE
PROPOSED SOIL STORAGE AREA PLAN

PROJECT TITLE
7-ACRE CLOSED LANDFILL OPERATIONS PERMIT-MINOR MODIFICATION APPLICATION

CITRUS COUNTY
LECANTO, FLORIDA

CLIENT	SCS ENGINEERS STEARNS, CONRAD AND SCHMIDT CONSULTING ENGINEERS 4041 PARK OAKS BLVD., SUITE 100, TAMPA, FL 33610 813 821-0080 FAX 813 823-6757 FLORIDA CERTIFICATE OF AUTHORIZATION NO. 00004882
DRAWN BY:	SDA
CHECKED BY:	DRC
DATE:	09/20/04
APP. BY:	RJD

CADD FILE: 074901SOILSTORAGE
 DATE: NOVEMBER 2008
 SCALE: AS SHOWN
 DRAWING NO.

1

of 1

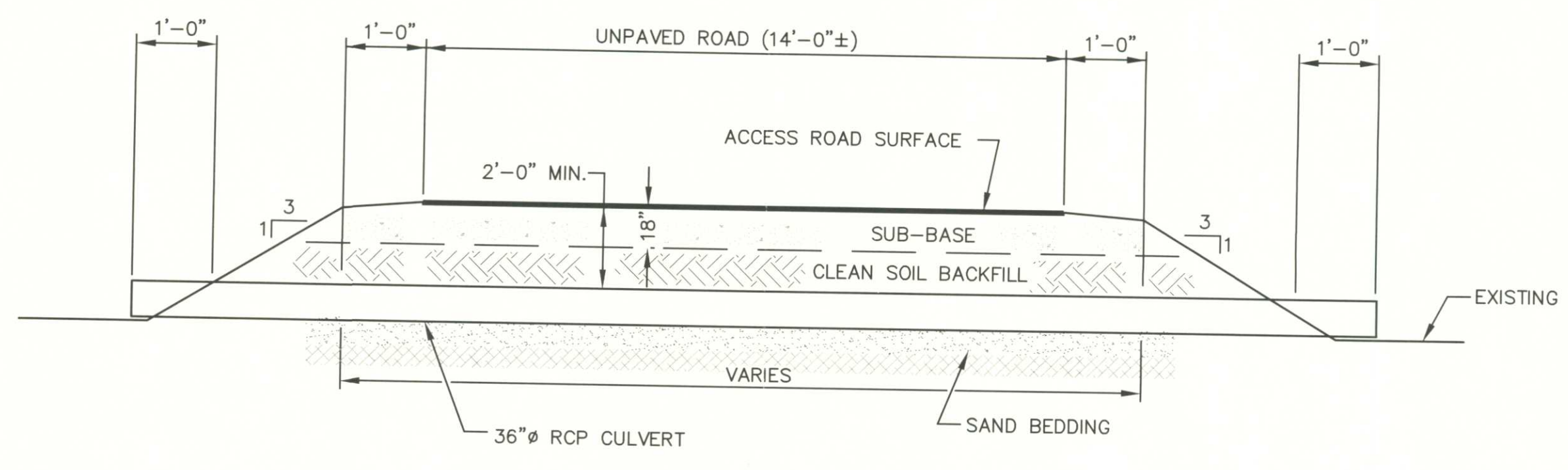

ROAD CROSSINGS DETAIL
NOT TO SCALE

NOTE:
1. SUB-BASE CONSISTS OF 18" OF TYPE "B" STABILIZATION MIN. LBR 40.

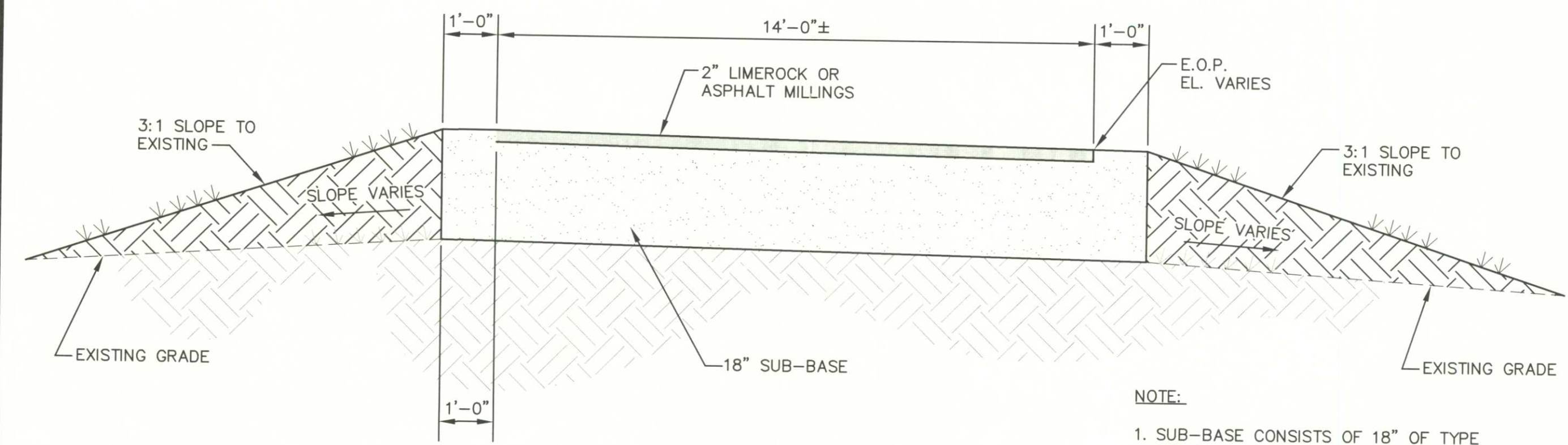

ACCESS ROAD DETAIL
NOT TO SCALE

NOTE:
1. SUB-BASE CONSISTS OF 18" OF TYPE "B" STABILIZATION MIN. LBR 40.

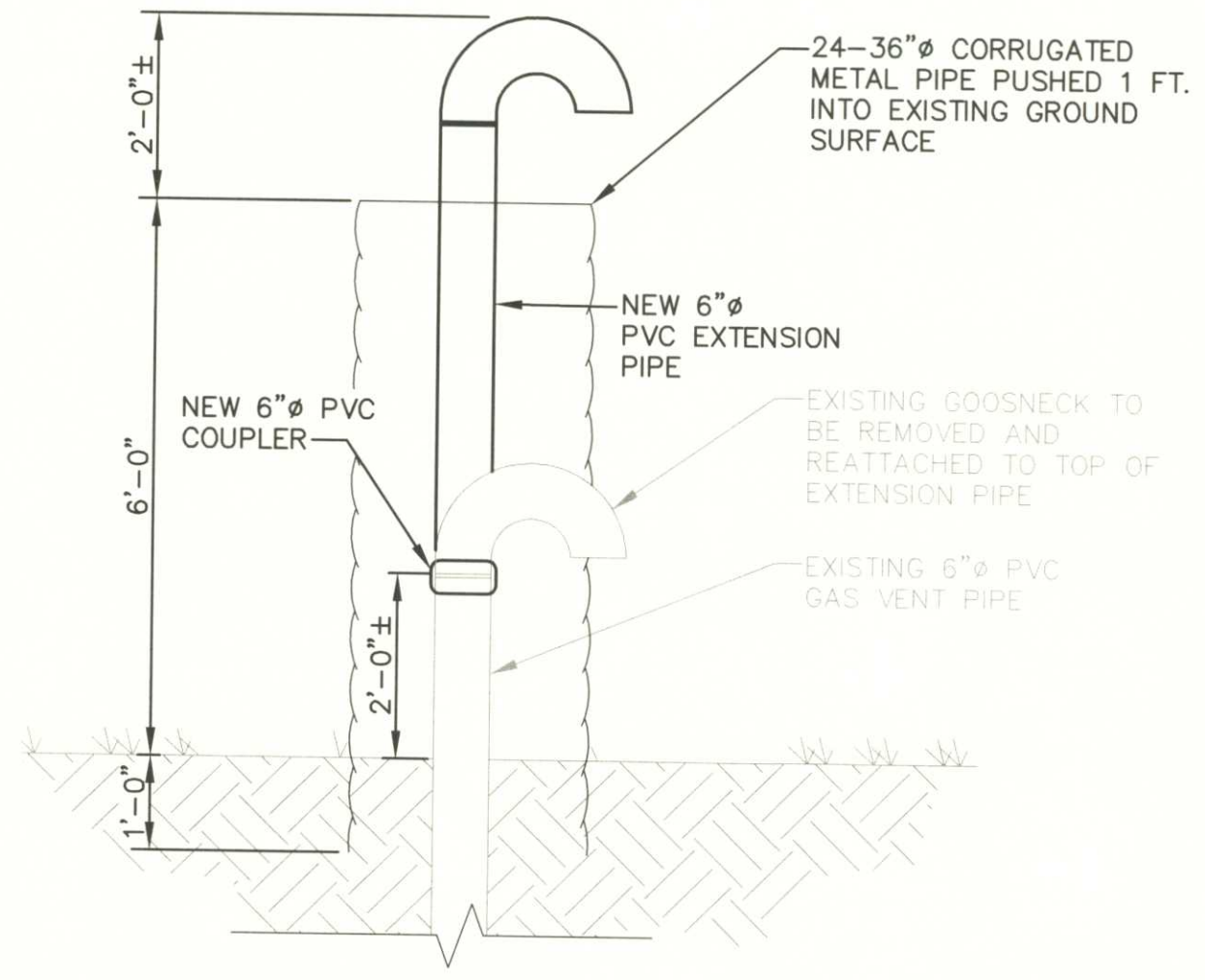

GAS VENT EXTENSION DETAIL
SCALE: 1" = 2'

SURVEY SOURCE NOTE:
TOPOGRAPHIC SURVEY INFORMATION SHOWN WAS DEVELOPED BY PHOTOGRAMMETRIC METHODS AND PERFORMED BY KUCERA SOUTH, LAKELAND, FLORIDA.
AERIAL PHOTO DATE: 10/11/07

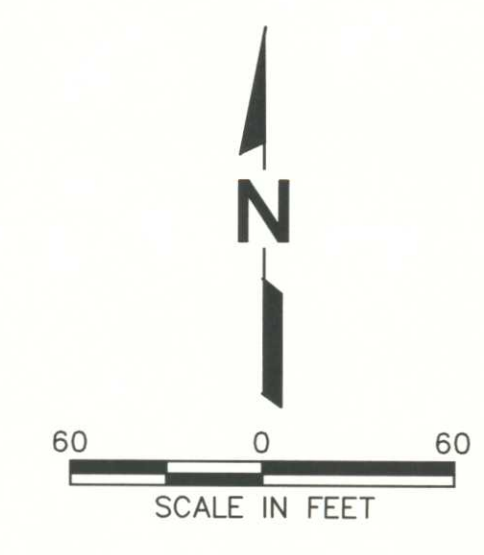
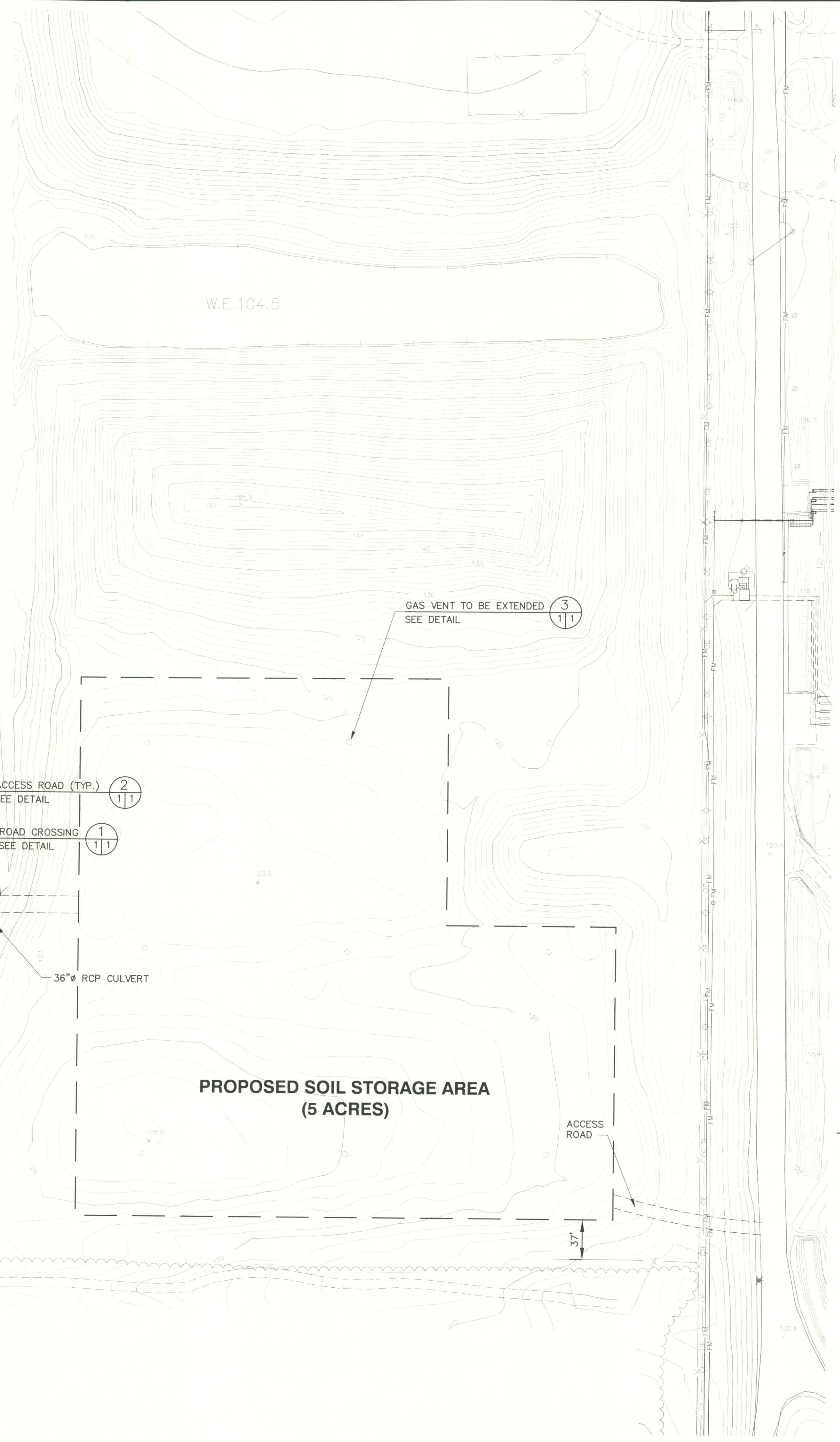

LEGEND
 --- EXISTING ELEVATIONAL CONTOURS (FEET) - 10/11/07 SURVEY
 --- SOIL STORAGE AREA
 ○ EXISTING PASSIVE GAS VENT

Dept. of Environmental Protection
 NOV 26 2008
 Southwest District

BY	
DESCRIPTION	
DATE	
REV	
DRAWING TITLE: PROPOSED SOIL STORAGE AREA PLAN PROJECT TITLE: 7-ACRE CLOSED LANDFILL OPERATIONS PERMIT-MINOR MODIFICATION APPLICATION	
CITRUS COUNTY, FLORIDA LECANTO, FLORIDA	
CLIENT	
SCS ENGINEERS STEARNS, CONRAD AND SCHMIDT CONSULTING ENGINEERS 4041 PARK OAKS BLVD., SUITE 100, TAMPA, FL 33610 813 821-0080 FAX 813 822-6757 FLORIDA CERTIFICATE OF AUTHORIZATION NO. 0000882 PROJECT NO. 09207049.01 DRAWN BY: SDA CHECKED BY: DRC APPR. BY: RJD	CADD FILE: 074901SOILSTORAGE DATE: NOVEMBER 2008 SCALE: AS SHOWN DRAWING NO. 1 of 1