

Surface water
file

**SARASOTA COUNTY GOVERNMENT
SARASOTA, FLORIDA**

**Solid Waste Department
Operations Division**

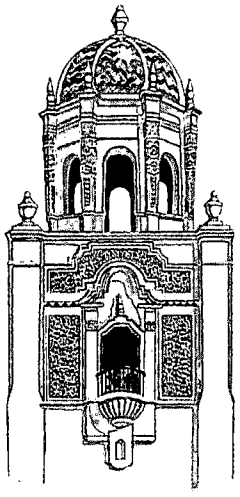

8350 Bee Ridge Road
Sarasota, Florida 34241
Telephone (941) 316-1166
FAX (941) 316-1167

March 12, 1997

Certified Mail: P 261 684 631

Allison E. Amram, P.G. Environmental Specialist III
Division of Waste Management
Department of Environmental Protection
3804 Coconut Palm Drive
Tampa, FL 33619-8318

DEP
MAR 17 1997
TAMPA

Subject: Survey Locations & Elevations of Surface Water Monitoring Stations
at Central County Solid Waste Disposal Complex

Dear Ms. Amram:

Enclosed find recently surveyed locations and elevations of the Surface Water Monitoring
Stations at Central County Solid Waste Disposal Complex.

If you have any questions please call me at 941-484-5543.

Sincerely,

Don Shaulis
Site Development Representative

Enclosures:

cc: Robert J. Butera, P.E., DEP
Gerald L. Bennett, Deputy Solid Waste Director
Timothy Lawrence, P.E., solid Waste Operations Manager
Thomas Walker, Camp, Dresser, & McKee

A:\aade4.doc
CCC:Admin-DEP Correspondence





March 7, 1997

Mr. Don Shaulis
Sarasota County Solid Waste Operations Division
8350 Bee Ridge Road
Sarasota, FL 34241

Subject: Elevations and State Plane Coordinates for Surface Water Monitoring Stations at Central County (Walton Tract) Landfill

Dear Don:

At your recent request, we have established elevations and State Plane Coordinate for the various surface water staff gauges at the Central County (Walton Tract) Landfill.

The following is a list of Staff Gauges with their corresponding elevations and Florida State Plane Grid Coordinates (1983 Datum). Elevations shown hereon are in feet and are relative to the National Geodetical Datum (NGVD) of 1929 and are based on the same datum as the bench marks for the site provided to us by the D.M.K. surveyors.

Staff Gauge No.	Northing	Eastng	NGVD Elevation
B-1A	1,046,101.46	523,266.72	12.01 on 1.00 foot Mark
B-1B	1,046,094.41	523,276.96	17.00 on 2.00 foot Mark
B-2	1,045,973.31	531,027.75	20.50 on 2.00 foot Mark
B-3	1,037,147.81	524,707.85	16.20 on 1.00 foot Mark
B-4	1,039,296.73	525,991.57	16.45 on 2.00 foot Mark
B-5A	1,031,844.37	522,840.74	12.80 on 0.00 foot Mark
B-5B	1,031,838.02	522,845.85	16.82 on 2.00 foot Mark
B-6A	1,032,819.06	527,146.07	12.62 on 2.00 foot Mark
B-6B	1,032,788.89	527,162.47	16.62 on 4.00 foot Mark
B-7	1,039,925.32	534,987.56	21.72 on 0.00 foot Mark

Mr. Don Shaulis
March 7, 1997
Page 2

The above coordination values are based on the Florida State Plane Grid Coordinate System (1983 Adjustment) and are derived from the Bishop & Associates GPS survey dated 11/14/89, under Job Number SRSB-9002 and the Special Exception Boundary Survey for the project as shown on Sheet No. G-8 of the CDM construction plans for said Central County Solid Waste Disposal Complex.

We are in the process of preparing a location sketch of the various staff gauges which we will complete early next week.

Please advise if additional information is needed.

Very truly yours,

POST, BUCKLEY, SCHUH & JERNIGAN, INC.



O. Clark Sartor, PLS
Florida Registered Land Surveyor No. 2685

Enclosures

cc: Timothy Lawrence
Pete Putman
Steve Lienhart

Staff Gauge No.	Northing	Easting	NGVD Elevation
B-1A	1,046,101.46	523,266.72	12.01 on 1.00 foot Mark
B-1B	1,046,094.41	523,276.96	17.00 on 2.00 foot Mark
B-2	1,045,973.31	531,027.75	20.50 on 2.00 foot Mark
B-3	1,037,147.81	524,707.85	16.20 on 1.00 foot Mark
B-4	1,039,296.73	525,991.57	16.45 on 2.00 foot Mark
B-5A	1,031,844.37	522,840.74	12.80 on 0.00 foot Mark
B-5B	1,031,838.02	522,845.85	16.82 on 2.00 foot Mark
B-6A	1,032,819.06	527,146.07	12.62 on 2.00 foot Mark
B-6B	1,032,788.89	527,162.47	16.62 on 4.00 foot Mark
B-7	1,039,925.32	534,987.56	21.72 on 0.00 foot Mark

SCALE APPROXIMATE

1" = 2500'

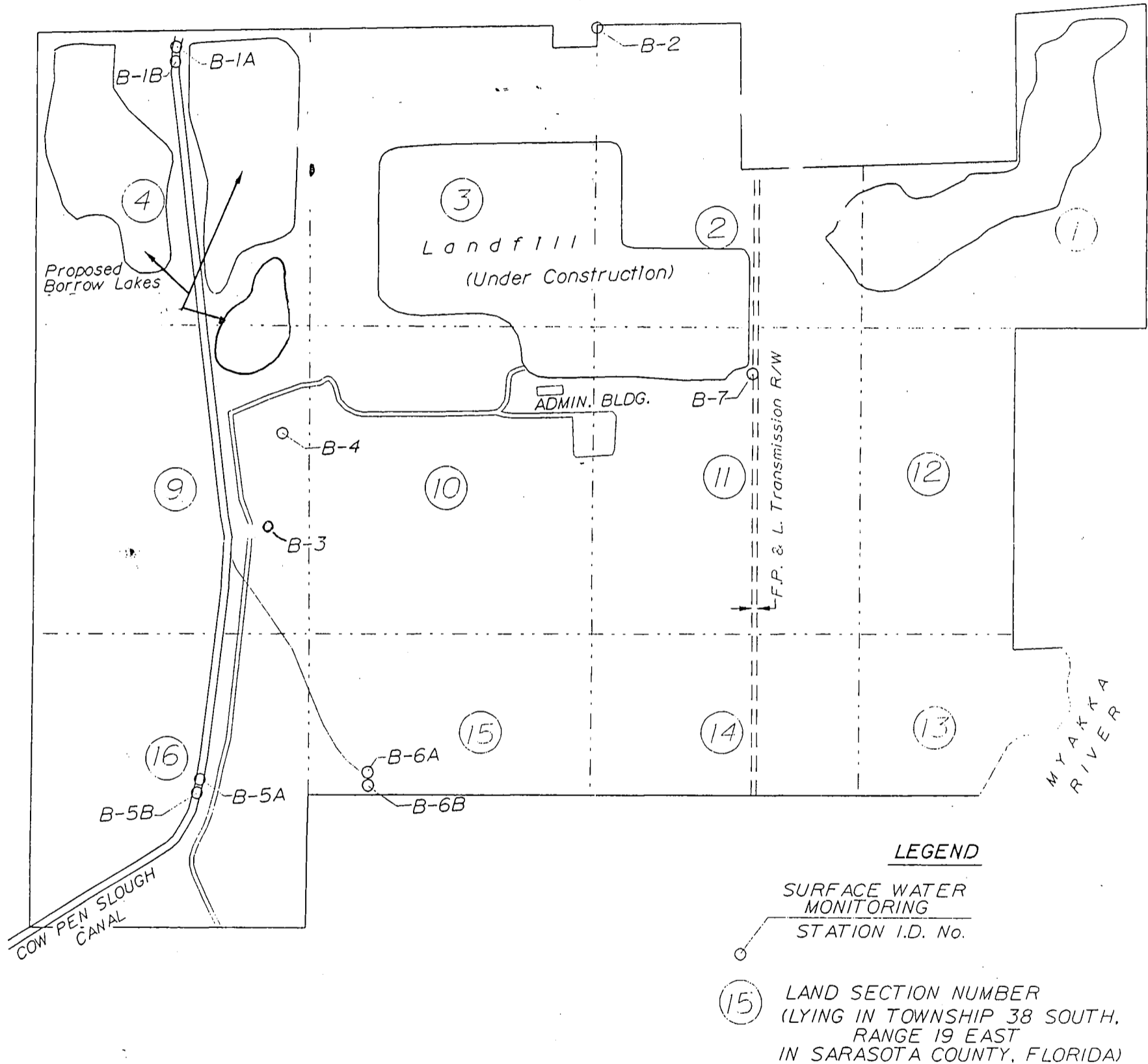

NOTES

1. THIS MAP IS NOT A SURVEY.
2. THE LOCATION OF SURFACE WATER MONITORING STATIONS IS ONLY APPROXIMATE; THE GRAPHIC DEPICTION OF THE SURFACE WATER MONITORING STATIONS HAVE BEEN EXAGGERATED FOR CLARITY.
3. THE LOCATION AND ELEVATIONS OF THE SURFACE WATER MONITORING STATIONS ARE BASED ON FIELD WORK BY PBS&J COMPLETED ON FEBRUARY 28, 1997. OTHER PHYSICAL FEATURES ARE SCALED FROM A SARASOTA COUNTY PERMIT DRAWING.
4. ELEVATIONS SHOWN HEREON FOR THE STAFF GAUGES ARE IN FEET AND ARE RELATIVE TO NATIONAL GEODETIC VERTICAL DATUM (NGVD) OF 1929. THE ELEVATIONS ARE BASED ON BENCH MARKS FOR THE SITE PROVIDED BY D.M.K. SURVEYORS.
5. THE COORDINATE VALUES SHOWN ABOVE ARE BASED ON THE FLORIDA STATE PLANE GRID COORDINATE SYSTEM (1983 ADJUSTMENT) AND ARE DERIVED FROM THE BISHOP & ASSOCIATES GPS SURVEY DATED 11/14/89, UNDER JOB NUMBER SRSB-9002 AND THE SPECIAL EXCEPTION BOUNDARY SURVEY FOR THE PROJECT AS SHOWN ON SHEET NO. G-8 OF THE CDM CONSTRUCTION PLANS FOR SAID CENTRAL COUNTY SOLID WASTE DISPOSAL COMPLEX.



POST, BUCKLEY, SCHUH, & JERNIGAN, INC.

5300 WEST CYPRESS STREET
SUITE 300
TAMPA, FLORIDA 33607
Ph. (813) 877-7275

**SURFACE WATER MONITORING STATIONS
SARASOTA COUNTY CENTRAL
SOLID WASTE DISPOSAL COMPLEX**

DATE
FEBRUARY 28, 1997