

CDM Camp Dresser & McKee Inc.

consulting
engineering
construction
operations

Westshore Center
1715 North Westshore Boulevard, Suite 875
Tampa, Florida 33607
Tel: 813 281-2900 Fax: 813 288-8787

October 25, 2001

D.E.P.
OCT 31 2001
Southwest District Tampa

Mr. Kim Ford, P.E.
Solid Waste Section
Division of Waste Management
Florida Department of Environmental Protection
3804 Coconut Palm Drive
Tampa, Florida 33619

Subject: West Pasco - Waste Tire Processing Facility
Pending Permit # 126935-001-WT
Response to Request for Additional Information

Dear Mr. Ford:

We are in receipt of your Request for Additional Information dated September 7, 2001 as relates to the subject facility. The following responses are provided in support of all previously submitted information.

1. a) *ER Section 1.2. Revisions to Figure 1-2 are requested to 1) show 50-foot fire lanes around each side of the chip storage pile, and 2) delete the "Entrance Road" which is not shown on the site plan received in 1997.*

Response: Provided as Attachment 1 is the revised Figure 1-2 with the requested revisions.

1. b) *ER Section 1.3.2. Where is the "processing area" for the location of processing equipment and for the "relocation" of the tires? Why will tire shreds be "relocated" to the "intermediate" cover stockpile rather than the initial daily cover stockpile?*

Response: The revised Figure 1-2 (Attachment 1) now shows the "processing area". References to the "intermediate cover stockpile" and the "initial daily cover stockpile" are misleading. All chipped tires will be stored in the 50' x 200' "chip storage" pile. Provided as Attachment 2 is a revised Engineering Report, re-describing the tire processing equipment and procedures.

1. c) *ER Section 1.3.3. Why is a 50 x 50 foot rim storage area needed if rims are to be "relocated to the scrap metal pile"? Where is the scrap metal pile?*

Response: The "scrap metal pile" and the "rim storage pile" are one and the same. Provided as Attachment 2 is a revised Engineering Report, re-describing the tire processing equipment and procedures.

Mr. Kim Ford, P.E.
October 24, 2001
Page 2

2. 62-701.320(8)(a). *Proof of publication of notice of application.*

Response: Provided as Attachment 3 is the Proof of Publication for the Notice of Application.

3. 62-701.900(23). *A replacement application form is requested with the following revisions:*

Response: Provided as Attachment 4 are four signed and sealed originals of the revised Application Form 62-701.900(23). Please note that Pasco County has designated Mr. John Power as the Authorized Agent for Pasco County.

4. 62-711.500(3). *Closure cost estimates for 2500 tons of waste tires and proof of financial assurance.*

Response: Closure cost estimates and financial assurance provisions have previously been submitted to the Department as a subset of the West Pasco Class III facility.

5. 62-711.530(4)(b). *A description of records for tires that may be inadvertently accepted from someone that is not a registered waste tire collector.*

Response: The facility accepts tires from non-registered waste tire collectors (citizens) as well as registered waste tire collectors, therefore, the term "inadvertent acceptance" is not applicable. When more than five waste tires from a citizen are observed at the scalehouse, the scalehouse operator records the number of tires, the person's name, and the person's telephone number. These records are maintained with all other waste tire delivery records at the County's on-site office.

6. 62-711.540(1)(d). *A copy of the most recent fire safety survey, not more than one year old, to demonstrate that the local fire protection authorities are satisfied with the current and proposed designs and operations.*

Response: Provided as Attachment 5 is the latest fire inspection survey.

7. 62-711.541(1)(e). *An emergency preparedness manual.*

Response: Provided as Attachment 2 is a revised Engineering Report. Appendix A to the revised Engineering Report is an updated Emergency Preparedness Manual (Contingency Plan).

8. 62-711.540(3)(c). *A description of the 50-foot fire lanes around each tire pile including the chip storage, with unobstructed access.*

Response: The 50-foot fire lane around each tire pile, including the chip storage pile, is a 50-foot unobstructed lane that allows access for emergency vehicles.

Mr. Kim Ford, P.E.

October 24, 2001

Page 3

If additional information is necessary, please do not hesitate to contact us at (813) 281-2900.

Very truly yours,

CAMP DRESSER & McKEE INC.



Jason M. Gorrie, P.E.

cc: John Power, Pasco County
Bob Butera, SW District

ATTACHMENT 1

scondals

10:30:07

10/25/01 11:28:44

FIG2

116104\0000\

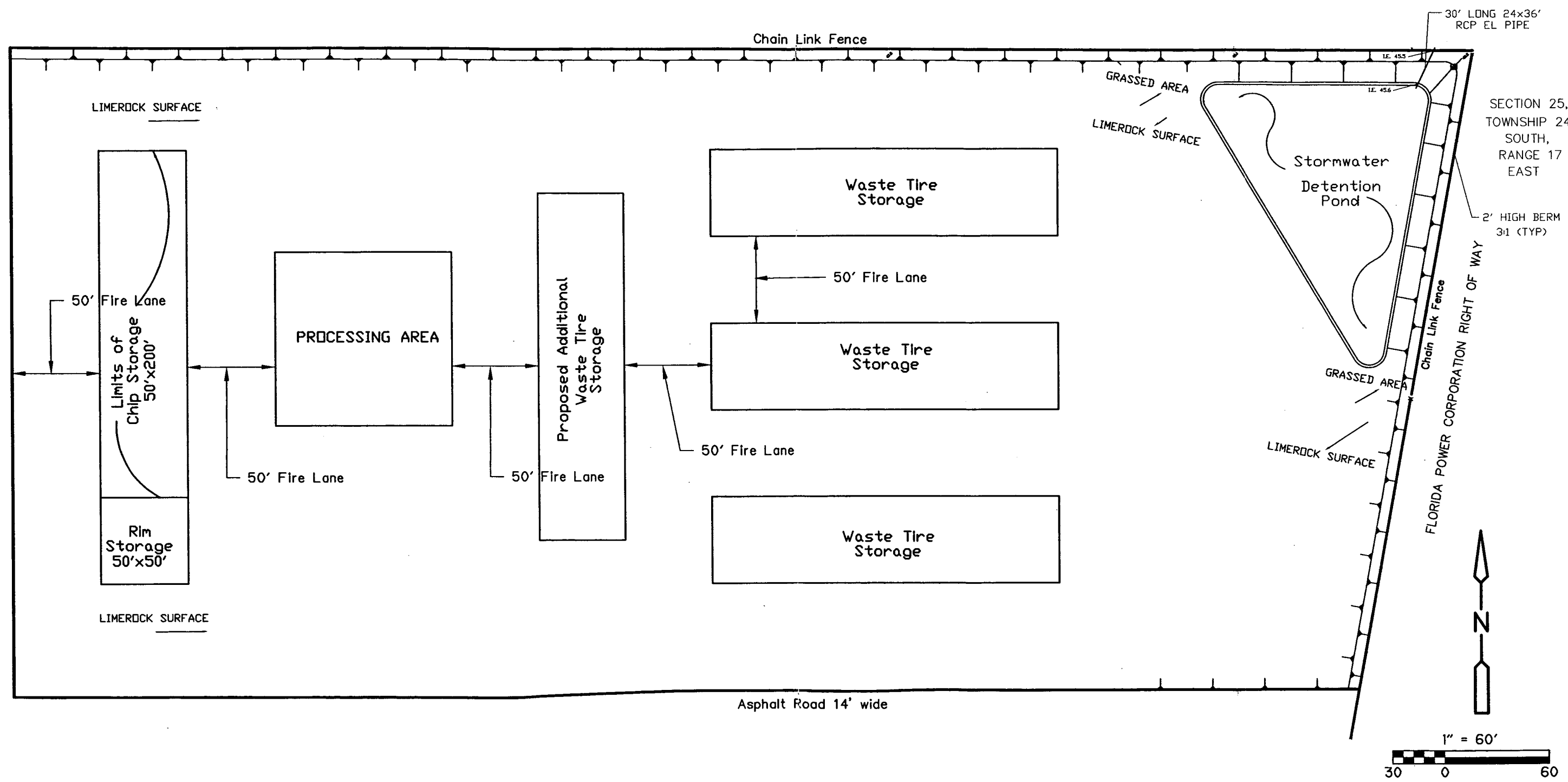

ATTACHMENT 2

Pasco County, Florida

West Pasco Waste Tire Facility

October 2001

*Permit Application
Engineering Report*

Contents

Facility Operation

1.1	Background.....	1-1
1.2	Facility Improvements.....	1-1
1.3	Operations.....	1-1
1.3.1	Incoming Waste Tires.....	1-1
1.3.2	Tire Processing Equipment.....	1-1
1.3.3	Process Residue.....	1-2
1.3.4	Throughput.....	1-2
1.3.5	Tire Storage.....	1-2
1.3.6	Financial Assurance.....	1-3

Appendices

Appendix A Contingency Plan (Emergency Preparedness Manual)

West Pasco Waste Tire Facility

Facility Operation

1.1 Background

The West Pasco Waste Tire Facility is a single component of the larger West Pasco Solid Waste Complex. Other waste operations conducted at the site include the Pasco County Resource Recovery Facility, the West Pasco Class I Landfill, and the West Pasco Class III landfill. **Figure 1-1** shows the location of the Solid Waste Complex and the surrounding land use.

1.2 Facility Improvements

To improve the functionality of waste tire storage, Pasco County desires to add an additional whole tire storage pile. This proposed pile is shown on **Figure 1-2**. The dimensions for the new pile are proposed to be identical to those of the existing three piles: 50 feet wide, 10,000 square feet, and 15 feet high. A 50 foot wide fire lane will exist between the new pile and the existing piles. To accommodate this proposed new pile, the existing chipped tire pile location will be relocated to west, as shown on **Figure 1-2**. The new pile, as well as the relocated chipped tire pile, will be formed on the existing limerock base at the site.

1.3 Operations

1.3.1 Incoming Waste Tires

The West Pasco Solid Waste Complex is open during the hours of 7:00 a.m. to 5:00 p.m., Monday through Saturday to receive waste for disposal or storage in designated locations according to material type.

The entrance to the facility is equipped with two electronically operated and computer controlled motor truck scales. These scales are tied into a local area network computer system utilizing Dickey Scales Refuse Vehicle Scale Management System II software.

All inbound loads of tires are scaled for gross weight and then reweighed for tare upon exiting. Tare weights are recorded in the computer for all regular customers using designated vehicles enabling them to bypass the reweigh process. All transactions involving up to five individual passenger car tires are approximated at 20 pounds per tire, the equivalent of 100 tires per ton. All transactions involving up to 5 individual truck tires are approximated at 100 pounds per tire, equivalent to 20 tires per ton.

1.3.2 Tire Processing Equipment

Pasco County maintains a contract with a private company for biannual waste tire processing. The processing is performed on-site with shredding equipment mobilized to the landfill's Waste Tire Processing Area. The equipment is positioned adjacent to the Waste Tire Storage (see **Figure 1-2**), where any metal rims are removed and

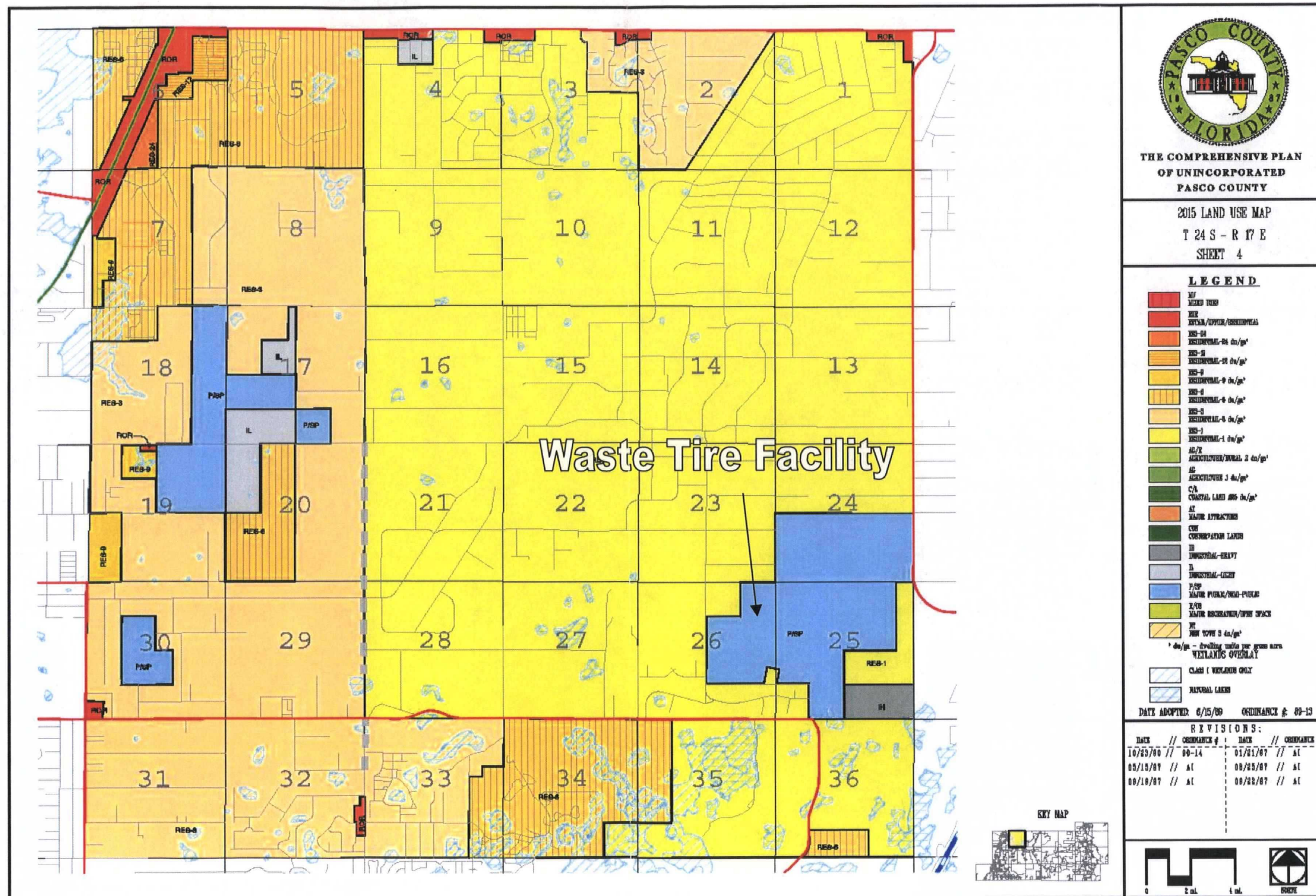

Figure 1-1
Surrounding Land Use

seconds

10/30/07

10/25/01 11:28:44

FIG2

5104\0000\

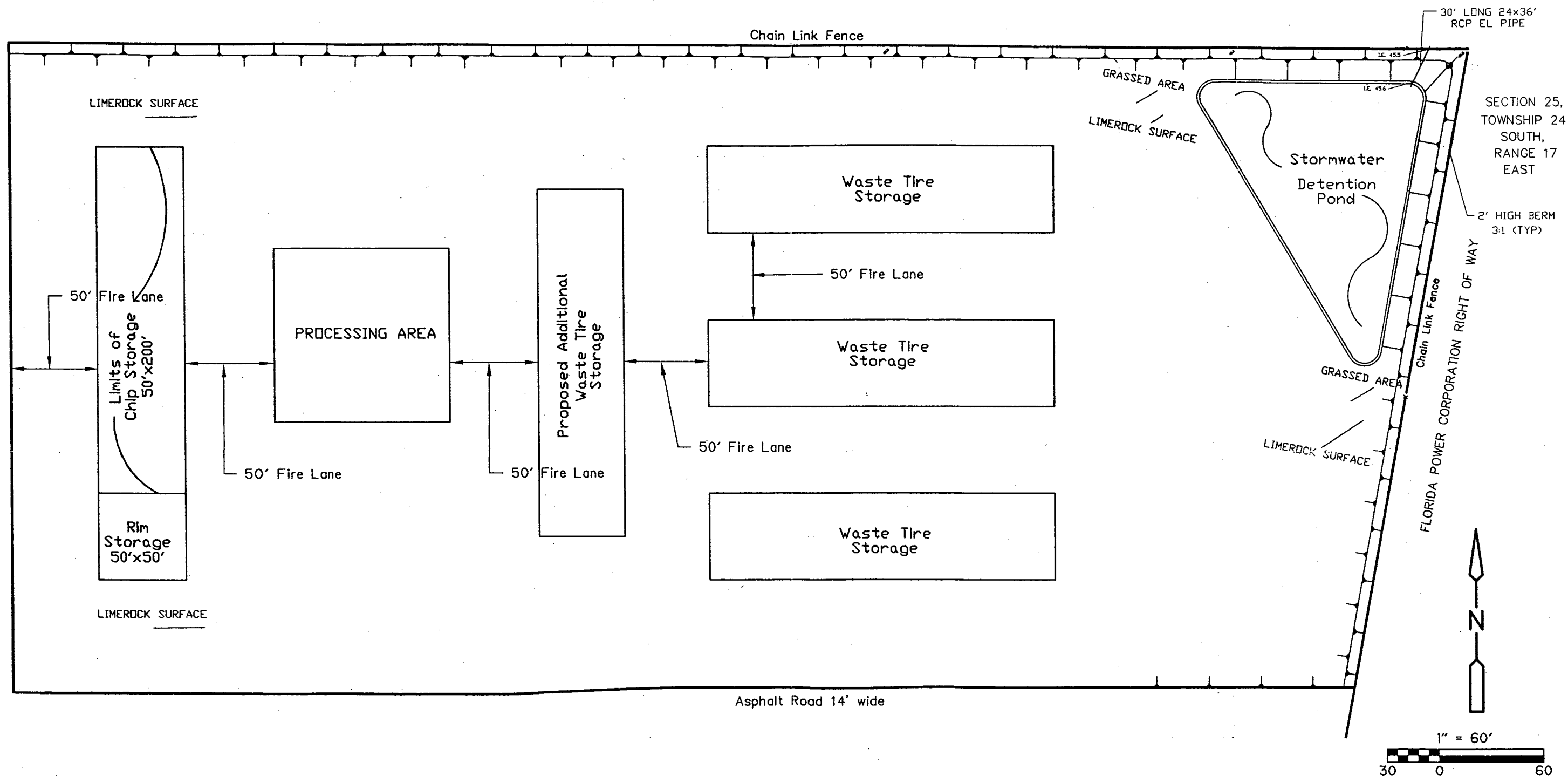

stockpiled. The equipment shreds the individual tires to 3 square inches or less. The shredded material is then transported to the Waste-to-Energy Facility for combustion and/or transported to the Class I landfill for use as daily cover.

The current company under contract uses waste tire shredding equipment manufactured by the Columbus McKinnon Corporation and a tire de-rimming machine. The shredder has a manufacturer's rated capacity of shredding up to 10 tons per hour.

1.3.3 Process Residue

The shredded tires are stored in chipped tire storage pile that is 50 feet wide by 200 feet long. The height of the pile will kept to less than 10 feet. All of the chipped tires are hauled by truck to the waste-to-energy facility for combustion in accordance with Specific Condition No. A.7.1.8 of FDEP Permit No. 1010056-002-AV or used to supplement daily cover at MSW Cell SW-1. The only significant residue created by the bi-annual tire chipping operation is the metal rims. Prior to shredding, the metal rims are removed by the contractor and placed in a scrap metal pile (also referred to as the rim storage area). From there, a scrap metal dealer is dispatched to the site to collect them and remove them from the site.

1.3.4 Throughput

On an average day, the site receives approximately 5 tons of tires for storage. As stated previously, this equates to approximately 2,500 tons per year. Records of the quantity of waste tires received at the site are created by the automated scale software and are maintained by the Facility Manager. Appendix B includes the storage area calculations based on a throughput of 2500 tons per year.

1.3.5 Tire Storage

Signs are posted at the entrance of the site stating the operating hours of the facility as well as the tipping fees for disposing of waste tires. Additional signage at the storage area prohibits open flames in the vicinity of the storage piles. Pasco County employees monitor the area and are present when tires are being off-loaded by the general public. These County employees are equipped with two-way radios to insure that Pasco County Fire Rescue is contacted in case of a fire.

Additional measures to protect the public health and welfare include routine spraying and periodic site inspections by the Pasco County Mosquito Control Section. Pasco County Solid Waste employees are also instructed to remain vigilant of rodents and other vectors that may create a nuisance at the site.

In the unlikely event that such a fire or other emergency should occur, Pasco County will immediately contact the Department and submit a written report within two weeks of the emergency describing the origin of the emergency and an analysis of the actions that were taken in response to the emergency.

An updated Emergency Preparedness Manual has been created for the site and is included as Attachment A to comply with the provisions of Rule 62-711.540(1)(e), F.A.C. This manual will be kept on site in the Facility Manager's office. A copy will also be maintained at the Utility Services Branch of the Pasco County Government Center on Ridge Road.

1.3.6 Financial Assurance

The financial assurance provisions of Chapter 62-711, F.A.C. were recently updated and provided to the Department under separate cover as a subset to the adjacent Class III landfill.

APPENDIX A
CONTINGENCY PLAN
(Emergency Preparedness Manual)
PASCO COUNTY GOVERNMENT
**UTILITIES FISCAL SERVICES/
SPECIAL PROJECTS DEPARTMENT**

**WASTE TIRE COLLECTION AND
STORAGE SITE**

**AT
HAYS ROAD
SPRING HILL, FLORIDA**

RECEIVED
NOV 29 2001

Department of Environmental Protection
SOUTHWEST DISTRICT
BY _____

November 29, 2001

Introduction

Pasco County owns and operates a permanent public waste tire collection and storage site permitted with the Florida Department of Environmental Protection (FDEP).

The site is part of a large Solid Waste Management Complex (800 acres) that includes the West Pasco Class III Landfill, the Pasco County Waste-to-Energy Facility, an Ash Cell, a Recycling Center, and a Household Hazardous Waste Center (Figure 1).

Purpose and Scope

The purpose of this plan is to provide information and guidance for responses to emergency incidents (fire) at the Pasco County waste tire collection and storage site.

This plan addresses all facets of activities at the waste tire site. This plan, however, will be subjected to review by fire fighting agencies in the County and will be updated as the situation dictates.

RECEIVED
NOV 29 2001

Site Function and Limitations

The purpose for establishing this site is to provide the County residents and County businesses with a means by which they can safely dispose of their waste tires in an environmentally sound manner. By so doing, removing a fire hazard and reducing or eliminating mosquito breeding grounds can be achieved in Pasco County. An additional benefit is the utilization of chipped waste tires as fuel in electrical cogen at the County's Waste-to-Energy Facility.

The waste tire site is designed to safely accommodate a relatively large number of waste tires. It also provides a space for derimming an onsite tire chipping several times annually. The site is also used for educational purposes and is visited by a number of school children and other institutions. Tires are stored for a minimum amount of time and always processed as soon as possible. No waste of any kind is generated at the site.

Site Description

The waste tire collection and storage site is approximately 950 x 450 feet and is located in the north central portion of the Solid Waste Management Complex (Figure 1). It is lined with compressed limerocks. The total complex is secured by a six-foot chain link fence and two security gates, one of which is electronically controlled.

Waste tire piles (five piles) stored at the site are approximately 10,000 square feet (200 x 50 each) and seldom reach a maximum height of 15 feet. Each storage pile has a 50-foot wide fire lane. The site is sloped toward an earth berm in order to prevent run-offs in case of fire. The total complex is devoid of any water body. However, a well head and a fire hydrant located within 3,000 feet (250 gpm) of the site will be used as a water source to suppress the fire in case of a fire accident. The storage area is accessible through a paved road and is posted with information and no open flame signs. The area immediately surrounding the storage area is practically clear of wood, brush, and underbrush vegetation in order to minimize the possibility of fire.

The site is open to the public six days a week. Prior to reaching the site itself to unload, cars and trucks loaded with waste tires must first proceed to a scale house where weights are recorded and records are maintained. Hours of operation and fee schedules are posted at the entrance to the scale house.

The waste tire collection and storage site as well as the total Solid Waste Management Complex is under the watcheyes of the site attendants who are in constant communication by radio with each other and with the scale house attendant (also with the base). Fire protection equipment is stored at the scale house and maintenance building, inspected and certified twice a year, and is readily available for usage in case of a fire.

Preparedness

Local authorities have been notified and will be kept apprised of the operations at the waste tire collection and storage site. The site is inspected by the fire marshal on an annual basis. A site diagram (**Figure 2 – Evacuation Routes**) is included at the end of this document which will guide the authority in case of fire. Also, a copy of this plan is posted at the scale house. Waste tire inventory is taken on a daily basis. Monthly statistics are posted inside the scale house. The local fire department, the local hospital, and the Sheriff's Office each will receive a copy of this plan, and their solicited comments will be used to update this plan.

Agencies notified:

Local Police Department:

Pasco County Sheriff's Office
7530 Little Road
New Port Richey, FL 34654
(727) 847-5878

Local Fire Department:

Station No. 20
15900 Little Ranch Road
Hudson, FL 34669
(727) 856-5519

Station No. 21
S.R. 52 and South Road
Hudson, FL 34667
(727) 856-3259

Local Fire Tower:

Department of Forestry
S.R. 52 West
Land O'Lakes, FL 34639
(727) 754-6777

RECEIVED
NOV 29 2001
Department of Environmental Protection
SOUTHWEST DISTRICT
BY _____

Local Hospital:

HCA Bayonet Point/Hudson Medical Center
14000 Fivay Road
Hudson, FL 34667
(727) 863-2411

Environmental:

Florida Department of Environmental Protection
3804 Coconut Palm Drive
Tampa, FL 33619-8318
(813) 744-6100

Every effort shall be made to operate the site in a safe manner. All necessary materials to contain small fire and minor run-off are maintained onsite as outlined on the emergency supply list indicated below. The ability to clean up all residues, thereof, is also available.

Emergency Supplies List

Materials:

Absorbents
Absorbent pads
Drums
Over-packs
Barricades
Booms

Equipment:

Two-way radios
Front-end loaders
Truck excavator
Dozers
Shovels
Fire extinguishers
SCBA cylinder
Camcorder
First-aid kits

Personal Protection Equipment:

Impervious coveralls
Chemically resistant gloves
Respirators and cartridges
Hard hats
Face shields
Face masks
Goggles

Site Layout

See Figure 1 for site layout, waste tire collection center location, entrances and exits to the site, and location of water wells and fire hydrants that could be used to abate a potential fire. Please note the security fence surrounding the whole complex and the scale house where vehicles are checked and directed toward the tire collection site.

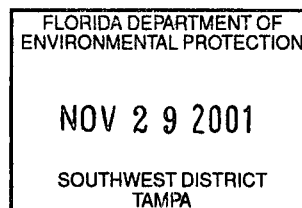

Emergency Response Coordinators and Emergency Response Team

1. Emergency Response Coordinator

a. Primary: John Power
Solid Waste Facility Manager

Address: 14230 Hays Road
Spring Hill, FL 34610

Telephone: Work (727) 856-0119

Responsibility: To ascertain the severity and magnitude of the emergency, contact the fire marshal, assign tasks to individual workers, implement the Contingency Plan, and, if necessary, order an evacuation of the premises.

b. Secondary: Ronald J. Walker
Solid Waste Superintendent

Address: 14230 Hays Road
Spring Hill, FL 34610

Telephone: Work (727) 861-3004
Home (727) 856-6685

Responsibility: To assist the primary emergency response coordinator to mobilize staff, if necessary, to prepare emergency equipment; to assist local response agencies, if needed to; and to supervise the cleaning up operations after the fire is completely abated.

Jim Geiger

Address: 14230 Hays Road
Spring Hill, FL 34610

Telephone: Work (727) 861-3053
Home (727) 842-3714

Responsibility: In charge of cleaning up operations, assign tasks to all participants, supervise packing and disposal of contaminated soil, absorbents, booms, etc.

RECEIVED
NOV 29 2001
Department of Environmental Protection
SOUTHWEST DISTRICT
BY _____

c. Chain of Command:

Until the arrival of the fire marshal and local response agencies, the County personnel will take command of the site. The chain of command will be as follows:

Emergency Response Primary Coordinator

John Power
Solid Waste Facility Manager

Emergency Response Secondary Coordinator

Ronald J. Walker
Solid Waste Superintendent

Staff and Equipment Coordinator

Jim Geiger
Landfill Operator

In an emergency situation where local authorities are called in, the senior officer of the responding agency (Pasco County Fire Department) shall assume command of the operations. County staff will then take a secondary position and can only provide assistance if requested. Equipment will also be made available to the agency involved. However, County staff will be heavily involved in the clean-up operations after the site is secured and the fire is put out.

Prevention of Emergency Situations

Operations at Pasco County's waste tire collection and storage site shall be conducted in a manner that maximizes the safety of the staff, the safety of the public, and the safety of the environment. "No Open Flame" signs will be posted at the site, and no smoking will be permitted at the site. Residents bringing in their waste tires are instructed at the entrance (scale house) of safety rules, protocol, and how and where to unload their vehicles.

The prevention of fire at the waste tire center is a primary goal of the staff. We recognize the fact that in dealing with stockpiles of scrap tires, prevention is of paramount importance because of the potential size, environmental impact, and costs of a tire fire. Therefore, prefire plans were instituted which included the following:

1. The perimeter of the site has a chain link fence with two security gates. Clearly visible signs with business hours are posted near the site entrance. A site attendant is always present on site during work hours.

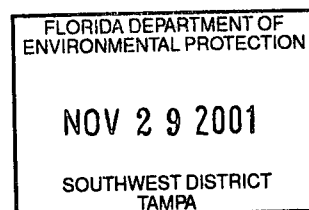

2. The waste tire collection site is provided with emergency vehicle access routes. No portion of the waste tire pile is more than 450 feet from the access routes.
3. The access routes to the tire pile are designed to support the loads imposed by heavy machinery and trucks similar to those used by the fire fighting vehicles and equipment.
4. Access routes are all asphalt-paved roads.
5. Access routes are unobstructed, can be used year-round, are well maintained, and are accessible to the fire department at all times.
6. The whole tire piles are designed to be limited to 15 feet in height with a maximum perimeter of 200 feet by 50 feet. The edges of the pile are 50 feet from the perimeter and are void of debris or vegetation.
7. No buildings, vehicles, chemicals, or flammable materials are permitted within 250 feet of the tire pile.
8. Tires are stored on compressed limerock foundation. No surface waters are nearby.
9. No open air burning is permitted anywhere on the total complex. No smoking is allowed near or within 200 feet of the piles.
10. Two water supply wells located at the complex will provide adequate water to suppress a fire in case of fire incident.
11. All vehicles (e.g., front-end loader, trucks) operating at the tire storage area are equipped with a fire extinguisher.
12. Site inspections are conducted by the Pasco County Fire Marshal on an annual basis.

Emergency Procedures

In a major fire, it is unlikely that the County resources will be sufficient to completely control the fire. In this case, the goal of the staff is to protect the site, evacuate when needed, and immediately notify the local fire agency.

Whenever an actual emergency situation arises, the emergency coordinator on-site shall take the responsibility for implementing this Contingency Plan. The emergency coordinator must immediately identify the nature, extent, and location of fire (where in the pile the fire started). Furthermore, the emergency coordinator must also assess possible hazard to the human health and the environment caused by the fire.

Evacuation of civilians, a life safety consideration, should be considered as a highest

RECEIVED
NOV 29 2001

priority by the coordinator. No strategy for managing the incident should bypass evacuation consideration. Any areas exposed to the smoke plume or subject to such exposure from shifting winds should be evacuated as a precaution.

Should an emergency occur, the emergency coordinator must take reasonable measures to ensure that the fire will not spread to the rest of the pile or to the adjacent facilities or equipment. If the fire is minor, loaders may be used to remove the unaffected tires from the piles. Extinguishers and water hoses may assist in this case. If the fire is major, neither the emergency coordinator nor his staff should approach the pile; this should best be left for the local fire agency which is equipped to handle such a situation.

Public agencies, as identified in the prefire plan, should be contacted in the earliest possible stages of the incident. If possible, the emergency coordinator should provide the local fire agencies with any information pertinent to the incident prior to their arrival on the fire ground.

The use of heavy equipment such as front-end loaders and mid-size bulldozers are necessary in gaining access and removing unburned tires from the pile. Since the responding fire agencies may not provide such equipment, the emergency coordinator may be included to provide this task using County equipment (on-site) and staff. Furthermore, in many cases, the only effective means of managing large tire fires is by smothering the burning portions with dirt or fill materials. In this case the coordinator could provide this service since a pile of fill dirt is always present at or near the tire pile (used for daily cover at the landfill).

During emergencies, accurate information gathering is essential. Such information could be coordinated and provided by the emergency coordinator. Examples include gauging the hot spots, the fire's locations, and the rate of spreading.

In the event of a small fire, the person discovering this fire (an attendant) must make a determination as to whether or not it can be extinguished safely and quickly with the available fire extinguishers, and/or smothered with available dirt. If it is determined that the fire can be easily extinguished with the available tools, notification of emergency coordinator should then be followed by taking an appropriate action.

The emergency response coordinator shall be notified immediately, and he shall determine if the site should be evacuated and if local agencies need to be immediately contacted. Additionally, the emergency response coordinator should determine if it is necessary to seal the stormwater outfall at the northeast corner of the site. If deemed necessary, fill dirt should be placed at the headwall of the stormwater pipe to preclude oily materials from migrating off-site.

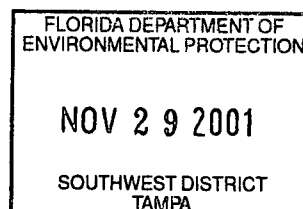

If the person(s) first discovering the fire assesses the situation and determines that the fire cannot be handled by the staff at the site, the fire department, the Sheriff's Office, and the local hospital will be immediately notified. This person(s) also should immediately order an evacuation of the personnel on-site.

Evacuation

Evacuation routes are depicted in Figure 2. In case of emergency and the on-site emergency coordinator deems it necessary to evacuate, he/she shall give the instructions to immediate evacuate. Upon receiving the instructions, the staff shall leave the site by the nearest exit. Special attention will be paid to County residents and visiting guests present on the site to ensure their safety and assist their egress.

Upon evacuation of the site, all personnel are to proceed directly to the rallying point. Upon evacuation, all nonresponsive personnel shall be kept a safe distance from the site. Traffic on roads leading into the complex will be stopped or rerouted, if necessary.

Rallying Point: At the scale house at the main entrance to the complex.

Notification

In the event of fire, all personnel at the site must be immediately notified. Should the emergency coordinator determine that outside assistance is needed or notification of local emergency response authorities is warranted, he should:

1. Call the fire department first (dial "9-1-1")
2. Call the local hospital
3. Call the Sheriff's Office

The emergency coordinator must be available to help the local emergency authorities. Should the coordinator decide that evacuation of the local area is advisable, he should notify the above three agencies of his assessment. Having done so, the emergency coordinator must then proceed to inform the environmental protection agencies at the local, State, and Federal levels.

Follow-Up

The emergency coordinator must note in the operating record the time, date, and details of any incident which requires implementing this Contingency Plan. The coordinator must develop a written report on the incident within 10 days after its occurrence.

1. All information included in the initial emergency notification and information indicated above. The report should also include information updating the original report.

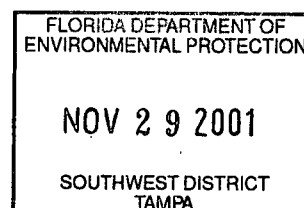

2. Actions taken to respond to and contain the run-off/release resulting from the fire.
3. An assessment of actual or potential hazards to human health and the environment where this is applicable. This should include any known or anticipated acute or chronic health risks associated with the run-off/release resulting from the fire.
4. Advice regarding medical attention necessary for exposed individuals.
5. Estimated quantity and disposition of recovered materials that resulted from the incident (contaminated soils).
6. A critique of the emergency response plan and how it was implemented.

Copies are to be forwarded to local and State emergency groups.

After the Fire Clean-Up

Environmental impacts associated with large tire fire could be substantial. Extreme heat turns rubber into oil. A standard passenger car tire can generate about two gallons of oil as it burns and liquefies. The danger associated with this toxic oil is that it could leach into the soil and reach the shallow drinking water aquifer thus contaminating a very valuable drinking water source.

It is imperative to contain the run-off from the pile as well as all residue resulting from the incident. A tire fire should be treated as a hazmat incident. Environmental contamination must be monitored for groundwater and soil (there are no surface waters at the site).

Groundwater monitoring is done at the site. Air pollution monitoring will be best left to the Florida Department of Environmental Protection to carry out since they are better equipped to handle this task.

Immediately after the emergency, the emergency coordinator shall provide for treating, storing, or disposing of recovered waste, contaminated soil, or any other material that results from the fire.

The emergency coordinator must ensure that in the affected areas of the site.

1. All clean up operations are completed.
2. All emergency equipment listed in the Contingency Plan and indicated earlier are cleaned and ready for its intended use (if used) before the waste tire collection site is open for business again.

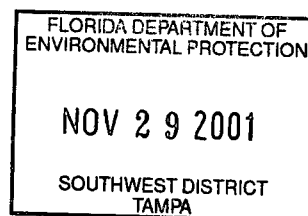

Contaminated equipment shall be cleaned with an appropriate solvent, and the discarded solution handled in an environmentally sound manner (may be treated as hazardous waste). Contaminated soils should be handled in accordance with the appropriate provisions of Chapter 62 of the Florida Administrative Code.

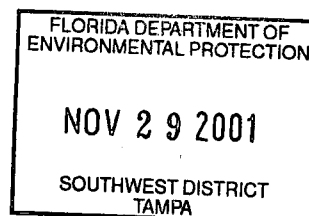

Figure 1

Site Layout

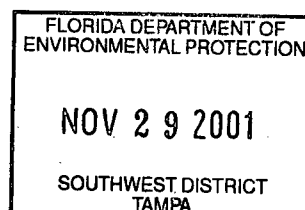
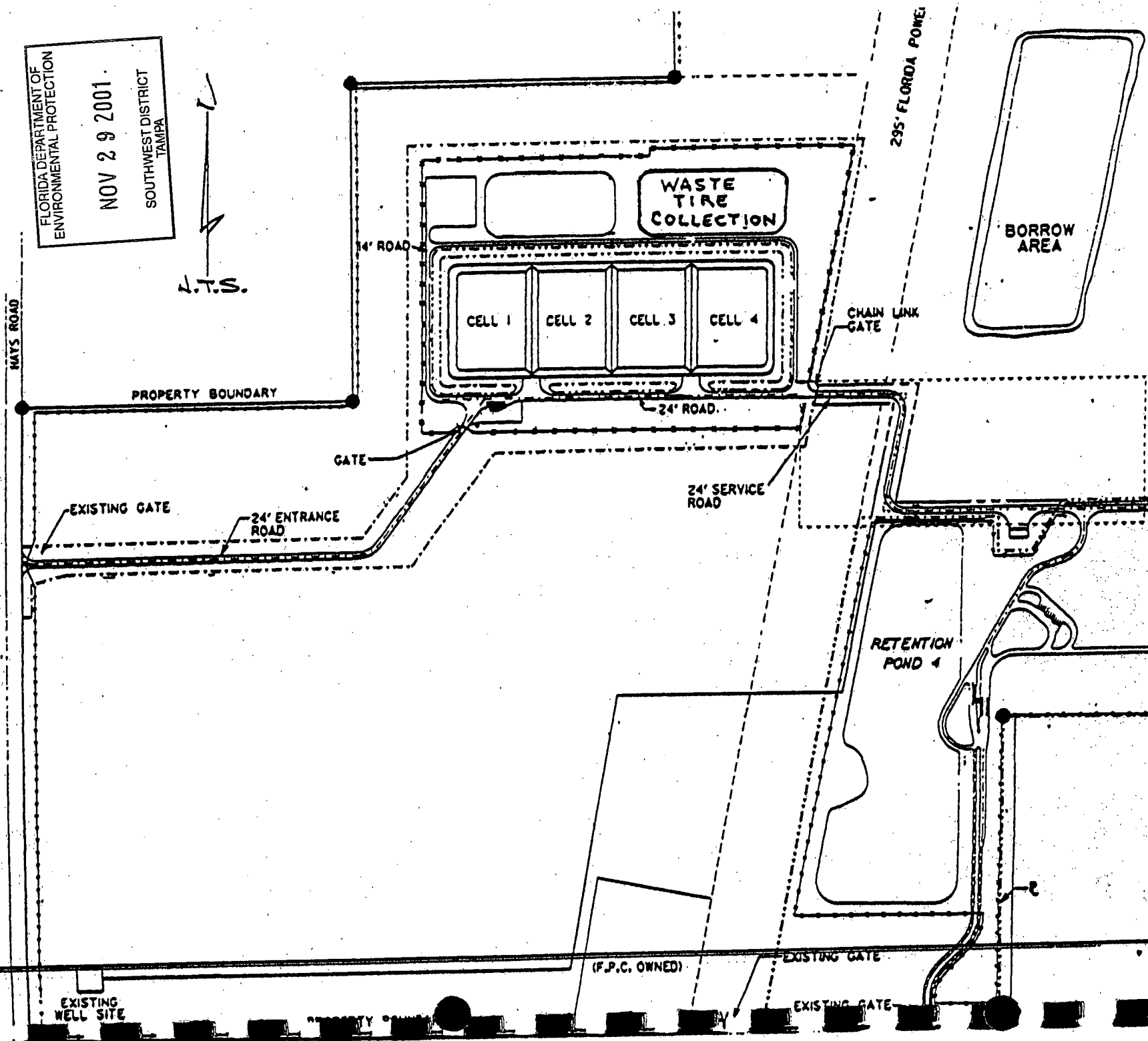

FIGURE 1: Waste Tire
Collection and Processing
Facility. Layout Diagram



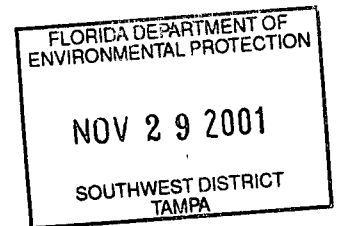

Figure 2

Evacuation Routes

Figure 2: Waste Tire Collection

FLORIDA DEPARTMENT OF
ENVIRONMENTAL PROTECTION

NOV 29 2001

SOUTHWEST DISTRICT
TAMPA

WASTE TIRE PROCESSING AND RECYCLING CENTER EVACUATION ROUTES

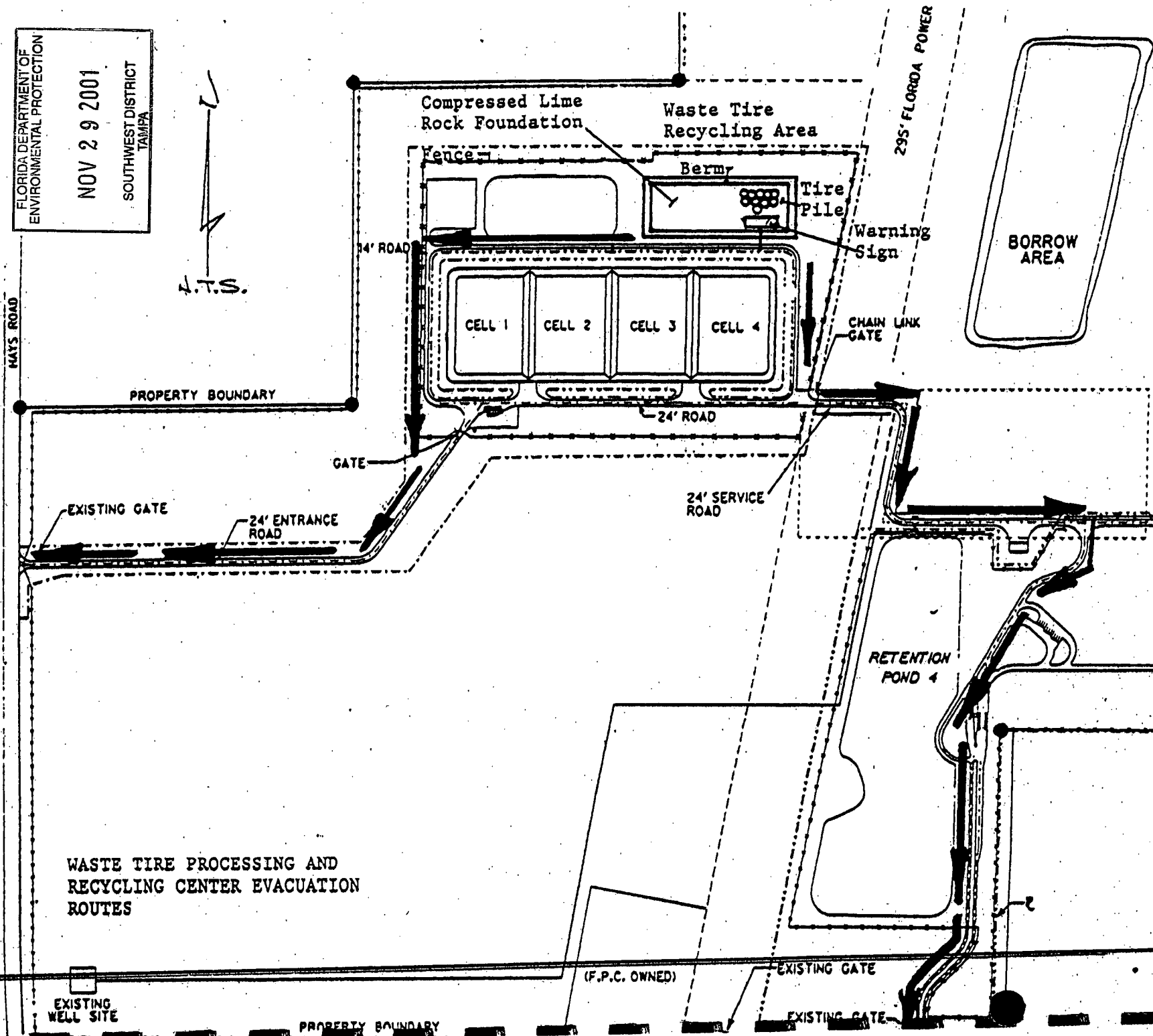

ATTACHMENT 3

PASCO TIMES

An Edition of the St. Petersburg Times

Published Daily
Port Richey, Pasco County, Florida**STATE OF FLORIDA
COUNTY OF PASCO:**

Before the undersigned authority personally appeared Debra Hoover who on oath says that she is Legal Clerk of the Pasco Times a daily newspaper published at Port Richey, in Pasco County, Florida: that the attached copy of advertisement, being a Legal Notice in the matter of RE: Notice of Application

_____ in the _____ Court
was published in said newspaper in the issues of
September 19, 2001

Affiant further says the said Pasco Times is a newspaper published at Port Richey, in said Pasco County, Florida, and that the said newspaper has heretofore been continuously published in said Pasco County, Florida, each day and has been entered as second class mail matter at the post office in Port Richey in said Pasco County, Florida, for a period of one year next preceding the first publication of the attached copy of advertisement; and affiant further says that she has neither paid nor promised any person, firm, or corporation any discount, rebate, commission or refund for the purpose of securing this advertisement for publication in the said newspaper.

Debra Hoover

Sworn to and subscribed before me this 19th day
of September, 2001



Kimberly L. Cronshaw
MY COMMISSION # CCA15950 EXPIRES
June 24, 2003
BONDED THRU TROY FAIR INSURANCE, INC.

Kimberly L. Cronshaw
Signature of Notary Public

Personally known X or produced identification _____

Type of identification produced _____

State of Florida
Department of
Environmental Protection
Notice of Application
The Department hereby
announces receipt of an
application for permit renewal
from Pasco County for a
solid waste transfer and waste
treatment facility,
subject to Department rules,
located at the existing West
Pasco Solid Waste Complex,
at 14230 Hays Road, Spring
Hill, Pasco County, Florida.
This application is being
processed and is available
for public inspection during
normal business hours, 8:00
a.m. to 5:00 p.m., Monday
through Friday, except legal
holidays, at the Department
of Environmental Protection,
Southwest District Office,
3804 Coconut Palm Drive,
Tampa, Florida 33619-1352.
(971) 292-6101 9/19/01

ATTACHMENT 4

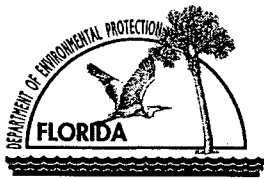

Department of Environmental Protection

DEP Form # 62-701.900(23)
Waste Tire Processing Facility
Form Title <u>Permit Application</u>
Effective Date <u>3/22/00</u>
DEP Application No. _____ (Filled in by DEP)

Waste Tire Processing Facility Permit Application

Permit No. WT51-284934

Renewal ☒ Modification ☒ Existing unpermitted facility ☐ Proposed new facility ☐

Part I-General Information:

A. Applicant Information:

1. Applicant Name: Pasco County Board of County Commissioners, Utility Service Branch
2. Applicant Street Address: 7530 Little Road
3. City: New Port Richey County: Pasco Zip: 34654
4. Applicant Mailing Address: same
5. City: _____ County: _____ Zip: _____
6. Contact person: John Power Phone: (727) 856-0119 FEID No: _____
7. Have any enforcement actions been taken by the Department against the applicant relating to the operation of any solid waste management facility in this state? This includes any Complaint, Notice of Violation, or revocation of a permit or registration, as well as any Consent Order in which a violation of Department rules is admitted. It does not include a Warning Letter, Warning Notice, Notice of Noncompliance, or other similar document which does not constitute agency action.
Yes _____ No ☒ If yes, attach a history and description of the enforcement actions.

B. Facility Information:

1. Facility Name: West Pasco Solid Waste Complex
2. Facility Street Address (Main Entrance): 14230 Hays Road
3. City: Spring Hill County: Pasco Zip: 34610
4. Facility Mailing Address: same
5. City: _____ State: _____ Zip: _____
6. Contact Person: _____ Phone: ()
7. Facility Location Coordinates:
Section: 25 Township: 24S Range: 17E
Latitude: N 28 22 47 Longitude: W 82 33 55
8. Anticipated date for starting construction N/A and for completion of construction N/A
9. Anticipated date for receipt of tires N/A and for start of processing N/A

Mail completed form to
appropriate district office listed below

Northwest District
160 Governmental Center
Pensacola, FL 32501-5794
850-595-8360

Northeast District
7825 Baymeadows Way, Ste. 200 B
Jacksonville, FL 32256-7590
904-448-4300

Central District
3319 Maguire Blvd., Ste. 232
Orlando, FL 32803-3767
407-894-7555

Southwest District
3804 Coconut Palm Dr.
Tampa, FL 33619
813-744-6100

South District
2295 Victoria Ave., Ste. 364
Fort Myers, FL 33902-2549
941-332-6975

Southeast District
400 North Congress Ave.
West Palm Beach, FL 33401
561-681-6600

DEP Form # 62-701.900(23)
Waste Tire Processing Facility
Form Title <u>Permit Application</u>
Effective Date <u>3/22/00</u>
DEP Application No. _____ (Filled in by DEP)

C. Land Owner Information (if different from applicant):

- Owner's name: same as applicant
- Land owner's mailing address: _____
- City: _____ State: _____ Zip: _____
- Authorized Agent: _____ Agent's phone () _____
- Current lease expires: _____

D. Facility Operator Information (if different from applicant):

- Operator's name: same as applicant
- Operator's mailing address: _____
- City: _____ State: _____ Zip: _____
- Contact person: _____ Phone: () _____

E. Preparer of Application:

- Name of person preparing application: Jason M. Gorrie, P.E. -- Camp Dresser & McKee
- Mailing address: 1715 N. Westshore Blvd., Suite 875
- City: Tampa State: Florida Zip: 33607
- Phone: (813) 281-2900
- Affiliation with facility: Engineering Consultant

Part II-Operations:

A. Facility type (check appropriate box):

- ☐ Waste tire processing facility.
- ☐ Waste tire processing facility with on-site disposal of processed tires or processing residuals.
See Attachment _____
- ☐ Waste tire processing facility with on-site consumption of waste tires or processing residuals.
See Attachment F
- ☐ Permitted solid waste management facility modification to allow waste tire site and processing.

B. Type of processing facility (check as many as apply):

- ☒ Shredder ☐ Cutter ☐ Chopper ☐ Incinerator only ☒ Incinerator with energy recovery
☐ Pyrolysis ☐ Supplemental fuel user ☒ Other, explain landfill daily cover

C. Storage: Indicate the maximum quantities of whole waste tires, processed waste tires, and processing residuals, expressed in tons, to be stored at the facility, in accordance with Rule 62-711.530(2), F.A.C.

	Outdoor Storage(tons)	Outdoor Storage (sq.ft)	Indoor Storage (tons)	Indoor Storage (sq.ft)	Total Storage (tons)
Whole waste tires:	<u>2000</u>	<u>40,000</u>	<u>0</u>	<u>0</u>	<u>2000</u>
Processed tires:	<u>450 (avg.)</u>	<u>10,000</u>	<u>0</u>	<u>0</u>	<u>450 (avg.)</u>
Processing residuals:	<u>50 (avg.)</u>	<u>2500</u>	<u>0</u>	<u>0</u>	<u>50 (avg.)</u>
TOTALS:	<u>2500</u>	<u>52,500</u>	<u>0</u>	<u>0</u>	<u>2500</u>

RECEIVED
NOV 29 2001

Department of Environmental Protection
SOUTHWEST DISTRICT
BY _____

DEP Form # 62-701.900(23)
Waste Tire Processing Facility
Form Title <u>Permit Application</u>
Effective Date <u>3/22/00</u>
DEP Application No. _____ (Filled in by DEP)

D. For reporting quantity of tires in tons, tires will be: weighed on site ☒ weighed off site ☐ weights will be calculated ☐

E. Facilities that will not be disposing of processed tires or processing residual on the facility site must indicate the permitted solid waste management facility where processed tires or residuals will be disposed.

1. Name of facility N/A
2. Street address: _____
3. City: _____ County: _____ Zip: _____

F. Facilities that will be delivering processed tires to consuming facilities must describe the existing or proposed markets for those processed tires.

Pasco County does not dispose processed tires away from the Solid Waste Complex, which contains the Waste Tire Facility. The processed tires are used for daily cover for the SW-1 cell and the remainder are processed in the Resource Recovery Facility. An independent scrap metal dealer collects rims and hauls them away for recycling.

Part III-Attachments:

A. Facility design

NOTE: All maps, plan sheets, drawings, isometrics, cross sections, or aerial photographs shall be legible; be signed and sealed by a registered professional engineer responsible for their preparation; be of appropriate scale to show clearly all required details; be numbered, referenced to narrative, titled, have a legend of symbols used, contain horizontal and vertical scales (where applicable), and specify drafting or origination dates; and use uniform scales as much as possible, contain a north arrow and use NGVD for all elevations.

1. A topographic or section map of the facility, including the surrounding area for one mile, no more than one year old, showing land use and zoning within one mile of the facility
2. A plot plan of the facility on a scale of not less than one inch equals 200 feet. At a minimum, the plot plan shall include
 - a. The facility design, including the location and size of all storage and processing areas for used tires, unprocessed waste tires, processed waste tires, and waste tire processing residuals;
 - b. All wetlands and water bodies within the facility or within 200 feet of any storage area;
 - c. Stormwater control measures, including ditches, dikes, and other structures;
 - d. Boundaries of the facility, legal boundaries of the land containing the facility, and any easements or rights of way that are within the facility or within 200 feet of any storage area;
 - e. Location, size, and depth of all wells within the facility or within 200 feet of any storage area;
 - f. All structures and buildings that are, or will be, constructed at the facility; include those used in storage and processing operations;
 - g. All areas used for loading and unloading;
 - h. All access roads and internal roads, including fire lanes;
 - i. Location of all fences, gates, and other access control measures; and
 - j. Location of all disposal areas within the facility.

B. Facility operation.

1. A description of the facility's operation, process and products including how waste tires will be received and stored.
2. A description of the equipment used for processing tires. This description shall include the make, model, and hourly capacity of each piece of equipment.
3. Description of the waste from the process, the amount of waste expected and how and where this waste will be disposed of.
4. Statement of the maximum daily throughput and the planned daily and annual throughput.
5. A description of how the operator will maintain compliance with each of the storage requirements of Rule 62-711.540, F.A.C.
6. A copy of the emergency preparedness manual for the facility with a statement of the on site and off site locations where that manual will be maintained.
7. A copy of the fire safety survey
8. A description of how 75% of the annual accumulation of waste tires will be removed for disposal or recycling.

C. Completed closing plan for the facility as required by Rule 62-711.700(2) and (3), F.A.C.

DEP Form # 62-701.900(23)
Waste Tire Processing Facility
Form Title <u>Permit Application</u>
Effective Date <u>3/22/00</u>
DEP Application No. _____ (Filled in by DEP)

- D. Attach proof of financial responsibility as requirement by Rule 62-711.500(3) OR a calculation showing that financial assurance documents, currently on file with the Department, are sufficient to assure closing of the waste tire site as well as any other solid waste management facility at that location.
- E. A letter from the land owner (if different from applicant) authorizing use of the land as a waste tire processing facility.
- F. If waste tires will be consumed at the facility, attach a description of the other environmental permits that the applicant has for this use, including, permit number, date of issue, and name of issuing agency
- G. The permit fee as required in Rule 62-4, F.A.C.

Part IV-Certification:

A. Applicant:

The undersigned applicant or authorized representative of Pasco County
Is aware that statements made in this form and attached information are an application for a
Waste Tire Fac. Operating Permit from the Florida Department of Environmental Protection and certifies that
The information in this application is true, correct and complete to the best of his knowledge and belief.
Further, the undersigned agrees to comply with the provisions of Chapter 403, Florida Statutes, and all rules
and regulations of the Department. It is understood that the Department will be notified prior to the sale or
legal transfer of the facility.

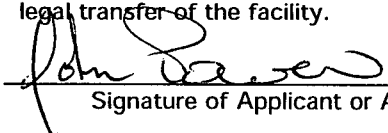
Signature of Applicant or Authorized Agent

John Power, Solid Waste Fac. Mgr

Name and Title

10/29/01
Date

B. Professional Engineer registered in Florida.

This is to certify that the engineering features of this waste tire processing facility have been
Designed/examined by me and found to conform to engineering principals applicable to such facilities. In my
professional judgment, this facility, when properly maintained and operated will comply with all applicable
statutes of the State of Florida and rules of the Department. It is agreed that the undersigned will provide the
applicant with a set of instructions for proper maintenance and operation of the facility.

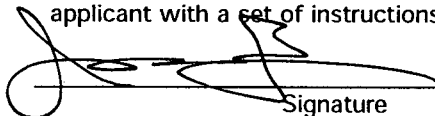
Signature

Jason M. Gorrie, P.E.

Name and Title

55341

Florida Registration Number

1715 N. Westshore Blvd., Suite 875

Mailing Address

Tampa, Florida 33607

City, State, Zip

(813) 281-2900

Telephone number

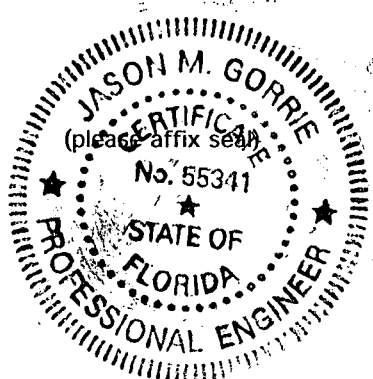

10/25/01
Date

ATTACHMENT 5

**PASCO COUNTY, FLORIDA
INTER-OFFICE MEMORANDUM**

TO: John Power
Solid Waste Facility Manager

DATE: 10/15/01

FILE: ES02-2003

SUBJECT: Inspection of Waste Tire
Processing Facility

FROM: *Lawrence M. Whitten*
Lawrence M. Whitten
Fire Marshal

REFERENCE:

Fire Safety Inspector, Sheffield Van De Boe, inspected your facility on September 26, 2001 and found that everything is in order.

Your plan and operations of the processing facility appears sufficient to handle the 2,500 tons of material. It also appears that the County's Standard Operations Procedures comply with the fire codes that are presently in effect.

If I can be of further assistance, please contact me.

LMW/dv

AK cc: Anthony F. Lopinto, Emergency Services Director