



Florida Department of Environmental Protection

Southwest District Office
13051 North Telecom Parkway
Temple Terrace, Florida 33637-0926

Charlie Crist
Governor

Jeff Kottkamp
Lt. Governor

Michael W. Sole
Secretary

CERTIFIED MAIL 7004 1350 0002 5576 8469
RETURN RECEIPT REQUESTED

September 11, 2007

NOTICE OF PERMIT

Sarasota County Environmental Services
Solid Waste Operations
4000 Knights Trail Road
Nokomis, Florida 34275
Attn: Mr. Frank Coggins, Operations Manager

RE: **Sarasota Central Waste Tire Processing Facility**
Sarasota County

Dear Mr. Frank Coggins:

Enclosed is permit number **126775-002-WT/02**, issued pursuant to Section(s) 403.087(1), Florida Statutes.

This letter and its attachments constitute a **complete permit** and **replace** all previous permits and permit modifications for the above referenced facility.

The Department's proposed agency action shall become final unless a timely petition for an administrative hearing is filed under Sections 120.569 and 120.57, Florida Statutes (F.S.), before the deadline for filing a petition. The procedures for petitioning for a hearing are set forth below.

A person whose substantial interests are affected by the Department's proposed permitting decision may petition for an administrative proceeding (hearing) under Sections 120.569 and 120.57, F.S. The petition must contain the information set forth below and must be filed (received) in the Office of General Counsel of the Department at 3900 Commonwealth Boulevard, Mail Station 35, Tallahassee, Florida 32399-3000.

Petitions by the applicant or any of the parties listed below must be filed within 14 days of receipt of this written notice. Petitions filed by other persons must be filed within 14 days of publication of the notice or receipt of the written notice, whichever occurs first. Under Section 120.60(3), F.S., however, any person who asked the Department for notice of agency action may file a petition within fourteen days of receipt of such notice, regardless of the date of publication. The petitioner shall mail a copy of the petition to the applicant at the address indicated above at the time of filing. The failure of any person to file a petition within the appropriate time period shall constitute a

waiver of that person's right to request an administrative determination (hearing) under Sections 120.569 and 120.57, F.S., or to intervene in this proceeding and participate as a party to it. Any subsequent intervention (in a proceeding initiated by another party) will be only at the discretion of the presiding officer upon the filing of a motion in compliance with Rule 28-106.205, F.A.C.

A petition that disputes the material facts on which the Department's action is based must contain the following information:

- (a) The name, address, and telephone number of each petitioner, the applicant's name and address, the Department File Number and the county in which the project is proposed;
- (b) A statement of how and when each petitioner received notice of the Department's action or proposed action;
- (c) A statement of how each petitioner's substantial interests are or will be affected by the Department's action or proposed action;
- (d) A statement of all material facts disputed by petitioner or a statement that there are no disputed facts;
- (e) A statement of the ultimate facts alleged, including a statement of the specific facts, which the petitioner contends, warrant reversal or modification of the Department's action or proposed action;
- (f) A statement of the specific rules or statutes the petitioner contends require reversal or modification of the Department's action or proposed action; and
- (g) A statement of the relief sought by the petitioner, stating precisely the action the petitioner wants the Department to take with respect to the Department's action or proposed action.

A petition that does not dispute the material facts on which the Department's action is based shall state that no such facts are in dispute and otherwise shall contain the same information as set forth above, as required by Rule 28-106.301, F.A.C.

Because the administrative hearing process is designed to formulate final agency action, the filing of a petition means that the Department's final action may be different from the position taken by it in this notice. Persons whose substantial interests will be affected by any such final decision of the Department have the right to petition to become a party to the proceeding, in accordance with the requirements set forth above.

In accordance with Section 120.573, F.S., the Department advises that mediation is not available in this case under the provisions of that statute. This does not prevent any interested parties from agreeing to other forms of alternate dispute resolution.

Any party to this order has the right to seek judicial review of it under Section 120.68, F.S., by filing a notice of appeal under Rule 9.110, Florida Rules of Appellate Procedure, with the clerk of the Department in the Office of General Counsel, Mail Station 35, 3900 Commonwealth Boulevard, Tallahassee, Florida 32399-3000, and by filing a copy of the notice of appeal accompanied by the applicable filing fees with the appropriate district court of appeal. The notice of appeal must be filed within thirty days after this order is filed with the clerk of the Department.

Executed in Hillsborough County, Florida.

STATE OF FLORIDA DEPARTMENT
OF ENVIRONMENTAL PROTECTION

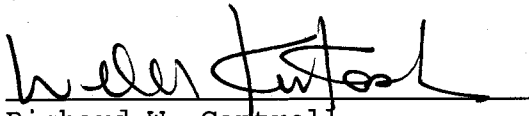
Richard W. Cantrell
Interim Director
Southwest District

RWC/re
Attachment

Copies furnished to:

Sarasota County Notification list
John A. Banks, P.E., SCS Engineers, 4041 Park Oaks Boulevard, Suite 100,
Tampa, Florida 33610
Richard Tedder, P.E., FDEP Tallahassee
Patricia Comer, FDEP OGC Tallahassee
Fred Wick, FDEP Tallahassee
Jan Clark, FDEP Tallahassee
Susan Pelz, P.E., FDEP Tampa
Permit Notebook

PERMITTEE: Sarasota County
c/o Mr. Frank Coggins

Permit No.: 126775-002-WT/02
Sarasota Central Waste Tire Processing Facility
Page 4

CERTIFICATE OF SERVICE

This undersigned duly designated deputy clerk hereby certifies that this **NOTICE OF PERMIT** and all copies were mailed before the close of business on September 11, 2007 to the listed persons.
(date stamp)

FILING AND ACKNOWLEDGMENT

FILED, on this date, pursuant to Section 120.52(10), Florida Statutes, with the designated Department, Clerk, receipt of which is hereby acknowledged.

Anna Black

Clerk

9-11-07

Date



Florida Department of Environmental Protection

Southwest District Office
13051 North Telecom Parkway
Temple Terrace, Florida 33637-0926

Charlie Crist
Governor

Jeff Kottkamp
Lt. Governor

Michael W. Sole
Secretary

PERMITTEE

Sarasota County Environmental
Services Solid Waste Operations
4000 Knights Trail Road
Nokomis, Florida 34275
Attn: Mr. Frank Coggins,
Operations Manager

PERMIT/CERTIFICATION

WACS Facility ID No: SWD-58-51614
Permit No: 126775-002-WT/02
Date of Issue: **09/11/2007**
Expiration Date: **09/11/2012**
County: Sarasota
Lat/Long: 27°11'58"
82°23'02"
Sec/Town/Rge: 1-4, 9-16/38S/19E
Project: Sarasota Central Waste
Tire Processing Facility

This permit is issued under the provisions of Chapter 403, Florida Statutes, and Florida Administrative Code Rule(s) 62-4, 62-701, and 62-711. The above named permittee is hereby authorized to perform the work or operate the facility shown on the application and approved drawing(s), plans and other documents, attached hereto or on file with the Department and made a part hereof and specifically described as follows:

To operate a waste tire processing facility (WTPF) at the Central County Solid waste Disposal Complex (CCSWDC), subject to the specific and general conditions attached, located at the existing Class I landfill at the north end of Knights Trail Road, 2 miles east of I-75, Nokomis, Sarasota County, Florida. The specific conditions attached are for the operation of:

1. Waste Tire Processing Facility

General Information: Facility receives waste tires from residents and businesses of Sarasota County. Incoming whole tires are weighed upon receipt at the truck scales and then the vehicle is directed to the storage area where the tires are piled in an area surrounded by an earthen berm to assure that in the event of a fire there will be no liquid runoff from the immediate area. The purpose of this facility is for temporary storage and shredding (processing) of waste tires. Processed tires are transported to the class I landfill immediately at the end of the processing cycle and are stockpiled near the working face for the purpose of using the processed tires for daily cover. The WTPF receives approximately 800 tons of tires per year.

Maximum tire storage	650 tons
Maximum tire throughput	64 tons/day

Replaces Permit No.: 126775-001-WT

This permit contains compliance items summarized in Attachment 1 that shall be complied with and submitted to the Department by the dates noted. If the compliance dates are not met and submittals are not received by the Department on the dates noted, enforcement action may be initiated to assure compliance with the conditions of this permit.

PERMITTEE: Sarasota County

PERMIT NO.: 126775-002-WT/02

FACILITY: Sarasota Central Waste Tire Processing Facility

GENERAL CONDITIONS:

1. The terms, conditions, requirements, limitations and restrictions set forth in this permit, are "permit conditions" and are binding and enforceable pursuant to Sections 403.141, 403.161, 403.727, or 403.861, Florida Statutes. The permittee is placed on notice that the Department will review this permit periodically and may initiate enforcement action for any violation of these conditions.
2. This permit is valid only for the specific processes and operations applied for and indicated in the approved drawings or exhibits. Any unauthorized deviation from the approved drawings, exhibits, specifications, or conditions of this permit may constitute grounds for revocation and enforcement action by the Department.
3. As provided in subsections 403.087(6) and 403.722(5), F.S., the issuance of this permit does not convey any vested rights or any exclusive privileges. Neither does it authorize any injury to public or private property or any invasion of rights, nor any infringement of federal, State, or local laws or regulations. This permit is not a waiver of or approval of any other Department permit that may be required for other aspects of the total project which are not addressed in this permit.
4. This permit conveys no title to land or water, does not constitute State recognition or acknowledgment of title, and does not constitute authority for the use of submerged lands unless herein provided and the necessary title or leasehold interests have been obtained from the State. Only the Trustees of the Internal Improvement Trust Fund may express State opinion as to title.
5. This permit does not relieve the permittee from liability for harm or injury to human health or welfare, animal, or plant life, or property caused by the construction or operation of this permitted source, or from penalties therefore; nor does it allow the permittee to cause pollution in contravention of Florida Statutes and Department rules, unless specifically authorized by an order from the Department.
6. The permittee shall properly operate and maintain the facility and systems of treatment and control (and related appurtenances) that are installed and used by the permittee to achieve compliance with the conditions of this permit, are required by Department rules. This provision includes the operation of backup or auxiliary facilities or similar systems when necessary to achieve compliance with the conditions of the permit and when required by Department rules.

GENERAL CONDITIONS:

7. The permittee, by accepting this permit, specifically agrees to allow authorized Department personnel, upon presentation of credentials or other documents as may be required by law and at reasonable times, access to the premises where the permitted activity is located or conducted to:

- (a) Have access to and copy any records that must be kept under conditions of the permit;
- (b) Inspect the facility, equipment, practices, or operations regulated or required under this permit; and
- (c) Sample or monitor any substances or parameters at any location reasonably necessary to assure compliance with this permit or Department rules.

Reasonable time may depend on the nature of the concern being investigated.

8. If, for any reason, the permittee does not comply with or will be unable to comply with any condition or limitation specified in this permit, the permittee shall immediately provide the Department with the following information:

- (a) A description of and cause of noncompliance; and
- (b) The period of noncompliance, including dates and times; or, if not corrected, the anticipated time the noncompliance is expected to continue, and steps being taken to reduce, eliminate, and prevent recurrence of the noncompliance.

The permittee shall be responsible for any and all damages which may result and may be subject to enforcement action by the Department for penalties or for revocation of this permit.

9. In accepting this permit, the permittee understands and agrees that all records, notes, monitoring data and other information relating to the construction or operation of this permitted source which are submitted to the Department may be used by the Department as evidence in any enforcement case involving the permitted source arising under the Florida Statutes or Department rules, except where such use is prescribed by Sections 403.111 and 403.73, F.S. Such evidence shall only be used to the extent it is consistent with the Florida Rules of Civil Procedure and appropriate evidentiary rules.

10. The permittee agrees to comply with changes in Department rules and Florida Statutes after a reasonable time for compliance; provided, however, the permittee does not waive any other rights granted by Florida Statutes or Department rules.

11. This permit is transferable only upon Department approval in accordance with Rule 62-4.120 and 62-730.300, Florida Administrative Code, as applicable. The permittee shall be liable for any non-compliance of the permitted activity until the transfer is approved by the Department.

GENERAL CONDITIONS:

12. This permit or a copy thereof shall be kept at the work site of the permitted activity.

13. This permit also constitutes:

- (a) Determination of Best Available Control Technology (BACT)
- (b) Determination of Prevention of Significant Deterioration (PSD)
- (c) Certification of compliance with State Water Quality Standards (Section 401, PL 92-500)
- (d) Compliance with New Source Performance Standards

14. The permittee shall comply with the following:

(a) Upon request, the permittee shall furnish all records and plans required under Department rules. During enforcement actions, the retention period for all records will be extended automatically unless otherwise stipulated by the Department.

(b) The permittee shall hold at the facility or other location designated by this permit records of all monitoring information (including all calibration and maintenance records and all original strip chart recordings for continuous monitoring instrumentation) required by the permit, copies of all reports required by this permit, and records of all data used to complete the application for this permit. These materials shall be retained at least three years from the date of the sample, measurement, report, or application unless otherwise specified by Department rule.

(c) Records of monitoring information shall include:

- 1. the date, exact place, and time of sampling or measurements;
- 2. the person responsible for performing the sampling or measurements;
- 3. the dates analyses were performed;
- 4. the person responsible for performing the analyses;
- 5. the analytical techniques or methods used;
- 6. the results of such analyses.

15. When requested by the Department, the permittee shall within a reasonable time furnish any information required by law which is needed to determine compliance with the permit. If the permittee becomes aware the relevant facts were not submitted or were incorrect in the permit application or in any report to the Department, such facts or information shall be corrected promptly.

SPECIFIC CONDITIONS: PART A -SOLID WASTE FACILITY GENERAL REQUIREMENTS

1. **Facility Designation.** This site shall be classified as a waste tire processing facility and shall be operated and closed in accordance with all applicable requirements of Chapters 62-4, 62-711, and 62-701, Florida Administrative Code (F.A.C.). This facility is limited to the acceptance of whole waste tires only. Other wastes shall not be accepted at this facility.

2. **Permit Application Documentation.** This permit is valid for operation of the waste tire processing facility in accordance with all applicable requirements of Department rules and the reports, plans and other information as follows:

a. Document entitled, Central County Solid Waste Disposal Complex Waste Tire Permit, dated April 24, 2007 (received April 26, 2007) and prepared by Sarasota County (unbound copy), revised by SCS Engineers dated July 5, 2007 (received July 6, 2007). This information includes, but is not limited to:

- 1) Waste Tire Facility Operations [Attachment B];
- 2) Emergency Preparedness Manual [Appendix A];
- 3) Storage Capacity Calculations [Appendix D]

3. **Permit Modifications.** Any construction or operation not previously approved as part of this permit shall require a separate Department permit unless the Department determines a permit modification to be more appropriate, or unless otherwise approved in writing by the Department. Permits shall be modified in accordance with the requirements of Rule 62-4.080, F.A.C. A modification which is reasonably expected to lead to substantially different environmental impacts, which require a detailed review by the Department, is considered a substantial modification.

4. **Permit Renewal.** Pursuant to Rule 62-4.090(1), F.A.C., **no later than sixty (60) days** before the expiration of the Department permit, the permittee shall apply for a renewal of a permit on forms and in a manner prescribed by the Department, in order to assure conformance with all applicable Department rules. Permits shall be renewed at least every five years as required by Rule 62-4.070(4), F.A.C.

5. **Professional Certification.** Where required by Chapter 471 (P.E.) or Chapter 492 (P.G.), Florida Statutes, applicable portions of permit applications and supporting documents, which are submitted to the Department for public record, shall be signed and sealed by the professional(s) who prepared or approved them.

6. **General Conditions.** The permittee shall be aware of and operate under the "General Conditions". General Conditions are binding upon the permittee and enforceable pursuant to Chapter 403, Florida Statutes.

PERMITTEE: Sarasota County

PERMIT NO.: 126775-002-WT/02

FACILITY: Sarasota Central Waste Tire Processing Facility

SPECIFIC CONDITIONS: PART A -SOLID WASTE FACILITY GENERAL REQUIREMENTS

7. **Permit Acceptance.** By acceptance of this Permit, the Permittee certifies that he/she has read and understands the obligations imposed by the Specific and General Conditions contained herein and also including date of permit expiration and renewal deadlines. It is a violation of this permit for failure to comply with all conditions and deadlines.

8. **Regulations.** Chapters 62-701, and 62-711, F.A.C., is incorporated into this permit by reference. In the event that the regulations governing this permitted operation are revised, the Department shall notify the permittee, and the permittee shall request modification of those specific conditions, which are affected by the revision of regulations to incorporate those revisions.

9. **Prohibitions.** The prohibitions of Rule 62-711.400, F.A.C., shall not be violated by activities at this site.

a. Waste Burning. Open burning of solid waste is prohibited except in accordance with Rule 62-701.300(3) and Chapter 62-256, F.A.C. All fires which require longer than one (1) hour to extinguish must be promptly reported to the Department and in accordance with Specific Condition #C.6., below.

PERMITTEE: Sarasota County

PERMIT NO.: 126775-002-WT/02

FACILITY: Sarasota Central Waste Tire Processing Facility

SPECIFIC CONDITIONS: PART B - CONSTRUCTION REQUIREMENTS

1. **Construction.** All construction activities shall be approved by the Department prior to initiating work, unless specifically authorized otherwise.

2. **Certification of Construction Completion.** All information required by this Specific Condition shall be signed and sealed by a registered professional engineer or land surveyor as appropriate. At the completion of construction, information listed below shall be provided to the Department as part of the Certification of Construction Completion.

a. **Within sixty (60) days** after any specified construction has been completed or as otherwise specified in this permit, the following activities shall be completed and submitted by the permittee to the Department. Operation of the constructed systems, structures, equipment, etc., shall not be initiated prior to Department approval of the information required by this Specific Condition.

1) The owner or operator shall submit a Certification of Construction Completion, Form 62-701.900(2), signed and sealed by the professional engineer responsible for the construction to the Department for approval, and shall arrange for Department representatives to inspect the construction in the company of the permittee, the engineer, and the facility operator.

2) The owner or operator shall submit Record Drawings/Documents showing all changes (i.e. all additions, deletions, revisions to the plans previously approved by the Department). The Record Documents shall include as-built plans details and elevations (survey) as appropriate.

3) The owner or operator shall submit a narrative indicating all changes in plans and the cause of the deviations, and certification by the design engineer to the Department.

SPECIFIC CONDITIONS: PART C - OPERATION REQUIREMENTS

1. Facility Operation Requirements.

- a. The permittee shall operate this facility in accordance with Rule 62-711.530, F.A.C., the facility's Operation Plan [ref. SC#A.2.a.(1)], and any other applicable requirements.
- b. Incoming loads shall be unloaded at the waste tire storage area where the tires are collected in two piles.
- c. The tire piles, each a maximum of 50 feet wide by 180 feet long, are separated by a fifty-foot fire lane. Tires shall not be piled more than 15 feet in height [ref. Op. Plan, Sec. 1.0(3)(b)].
- d. The facility's operating hours are 8:00 AM to 5:00 PM Monday through Saturday.
- e. In the event of a fire, additional waste shall not be accepted in the area affected by the fire until the fire is completely extinguished, and the Department shall be notified in accordance with Specific Condition C.6.c.

2. Operating Personnel. A trained supervisor or foreman shall be responsible for operating and maintaining the facility in an orderly, safe, and sanitary manner. An attendant shall be present at all times when the facility is open to the public [ref. Op. Plan, Sec. 1.0(1)(c)] and tires are being received. Sufficient personnel shall be employed to adequately operate the facility.

3. Control of Access. Access to, and use of, the facility is controlled by the use of fences and gates. Access controls include a locking access gate at the entrance of the scale facility [ref. Op. Plan, Sec. 1.0(3)(d)].

4. Monitoring of Waste. The permittee shall not knowingly accept hazardous waste or any hazardous substance at this site. Hazardous waste is a waste in Chapter 62-730, F.A.C. Hazardous substances are those defined in Section 403.703, Florida Statute or in any other applicable state or federal law or administrative rule.

5. Control of Nuisance Conditions. The owner or operator shall control vectors so as to protect the public health and welfare. The operating authority shall be responsible for the control of odors and fugitive particulates arising from the operation. Such control shall minimize the creation of nuisance conditions on adjoining property. Complaints received from the general public, and confirmed by Department personnel upon site inspection, shall constitute a nuisance condition, and the permittee must take immediate corrective action to abate the nuisance.

SPECIFIC CONDITIONS: PART C - OPERATION REQUIREMENTS

6. Facility Maintenance and Repair.

a. The site shall be properly maintained. In the event of damage to any portion of the waste tire processing site facilities, equipment, storage areas, or buildings, failure of any portion of the associated systems, fire, explosion, or the development of sinkhole(s) at the site, the permittee shall **immediately (within 24 hours)** notify the Department explaining such occurrence, method to prevent reoccurrence, remedial measures to be taken and time needed for repairs. Written detailed notification shall be submitted to the Department **within seven (7) days** following the occurrence.

b. The facility shall ensure that the area within the earthen berm, which surrounds the waste tire piles, are kept free of grass, underbrush, and other potentially flammable vegetation at all times [ref. Op. Plan, Sec. 1.0(1)(d)].

c. In the event of a tire fire, impacted soils and/or liquids shall be contained, and shall be characterized prior to disposal either at the on-site Class I landfill or at an appropriately permitted offsite disposal facility. The results of this characterization shall be provided to the Department with the written notification required by Specific Condition #C.6.a. above, prior to disposal of the material.

7. Stormwater Management. The site shall have a surface water management system operated and maintained to prevent surface water flow on to unloading, loading and storage areas, and a stormwater runoff control system operated and maintained to collect and control stormwater to meet the requirements of Florida Administrative Code Rule 62-330, any other applicable Department rules, and the requirements of the respective water management district.

8. Material Management and Storage. All waste tires shall be stored in accordance with Rules 62-711.530 and 62-711.540, F.A.C., the operations plan, and as shown on the referenced Site Plan (Figure No. G-5 dated November 1995) and Proposed Grading and Paving (Sheet No. LFC-35 dated May 1994).

a. Onsite storage at the WTPF is limited to 650 tons of waste tires. The tires will be stored in two piles outdoors, each in an area of 9,000 square feet separated by a fifty-foot fire lane.

b. If the facility has reached its permitted storage capacity, the permittee shall not accept additional waste tires until sufficient capacity has been restored.

c. Tires accepted at the facility shall only be received from residents and businesses of Sarasota County.

PERMITTEE: Sarasota County

PERMIT NO.: 126775-002-WT/02

FACILITY: Sarasota Central Waste Tire Processing Facility

SPECIFIC CONDITIONS: PART C - OPERATION REQUIREMENTS

(Specific Condition #C.8. cont'd)

d. At least 75 percent of the whole tires, used tires, and processed tires that are delivered to or are contained on the site of the WTPF at the beginning of each calendar year shall be processed or removed for disposal or recycling from the facility during the year, or disposed of at a permitted solid waste management facility.

e. The processed waste tires may be used as initial cover or landfilled at the Class I landfill. When landfilled, the waste tires shall be cut into at least 8 substantially equal pieces [ref. Op. Plan, Sec. 3.0].

f. Only waste tires, processed tires and residuals from waste tire processing (e.g., shreds or rims) shall be stored at the WTPF. Other materials (e.g., mulch, special wastes) shall not be stored at the WTPF.

9. Fire Safety.

a. A fire safety inspection shall be conducted at least **annually**. The fire safety inspection report shall be maintained at the facility for five years and copies shall be provided to the Department upon request.

b. In the event that deficiencies are noted in the annual fire safety inspection report, **within 30 days** of completion, the permittee shall provide documentation to the Department indicating correction of any deficiencies noted. The documentation shall include approval of the corrections by the local fire authority.

SPECIFIC CONDITIONS: PART D - RECORDKEEPING

1. **Report Submittals.** Unless otherwise specified, all submittals, notifications, requests for permit modification, reports for compliance with this permit, etc. shall be sent to: Solid Waste Section, Department of Environmental Protection, Southwest District Office, 13051 North Telecom Parkway, Temple Terrace, Florida 33637-0926.

2. **Operation Plan and Operating Record.**

a. A copy of the Department approved permit, operational plan, construction reports and record drawings, and supporting information shall be kept at the facility at all times for reference and inspection.

b. Proposed changes to the current Department approved Operation Plan shall be submitted in writing to the Department for review and may require a permit modification in accordance with Specific Condition #A.3. The Operation Plan shall be updated as operations change and for renewal of the permit. Revised pages shall be provided as replacement pages with revisions noted (deletions may be struckthrough [~~struckthrough~~] and additions may be shaded [~~shaded~~] or a similar method may be used) and each page numbered with the document title and date of revision.

3. **Waste Records.**

a. Operational records shall be recorded and maintained for a minimum of **three years** and be available for inspection by Department personnel during normal business hours.

b. The owner or operator of the waste tire processing facility shall record on Department Form 62-711.900(21), F.A.C., the amount of waste tires received, processed tires and residuals, stored, and removed from the site. The following information shall be compiled monthly and submitted to the Department quarterly, by **January 20th, April 20th, July 20th and October 20th** of each year, pursuant to Rule 62-711.530(5), F.A.C.

1) The total quantity, in tons, for waste tires received at the facility during the quarter;

2) The total quantities, in tons, for waste tires processed at the facility during the quarter;

3) The total quantity, in tons, for waste tires shipped from the facility during the quarter;

4) The total quantity, in tons, of waste tires stored at the facility on the last day of the quarter;

5) The total quantity of waste tire processing residuals and other solid wastes removed for offsite disposal or stored onsite for the quarter; and

PERMITTEE: Sarasota County

PERMIT NO.: 126775-002-WT/02

FACILITY: Sarasota Central Waste Tire Processing Facility

SPECIFIC CONDITIONS: PART D - RECORDKEEPING

(Specific Condition #D.3., cont'd)

6) A list of all dates on which the waste tires exceeded the storage limit, and how this condition was relieved or will be relieved.

c. The following reports, documents and other information shall be kept at the facility for reference, and copies shall be provided to the Department upon request:

1) A log of the facility operator's inspections, and any subsequent corrective actions; and

2) A copy of the facility's Emergency Preparedness Manual shall be kept at the site and a copy shall be kept at an off-site location;

4. **Financial Assurance.** The permittee shall provide adequate financial assurance for the facility in accordance with Rule 62-711.500(3), F.A.C.

a. All costs for closure shall be adjusted and submitted **annually, by September 1st of each year** to: Solid Waste Manager, Solid Waste Section, Department of Environmental Protection, 13051 North Telecom Parkway, Temple Terrace, Florida 33637-0926.

b. Proof that the financial mechanism has been adequately funded shall be **submitted annually** to: Financial Coordinator, Solid Waste Section, Department of Environmental Protection, 2600 Blair Stone Road, MS #4565, Tallahassee, Florida 32399-2400.

PERMITTEE: Sarasota County

PERMIT NO.: 126775-002-WT/02

FACILITY: Sarasota Central Waste Tire Processing Facility

PART E - WATER QUALITY MONITORING REQUIREMENTS

(THERE ARE NO WATER QUALITY MONITORING REQUIREMENTS FOR THIS FACILITY)

PART F - LANDFILL GAS MANGEMENT

(THERE ARE NO LANDFILL GAS MANAGEMENT REQUIREMENTS FOR THIS FACILITY)

PART G - CLOSURE AND LONG TERM CARE REQUIREMENTS

1. **Closure Requirements.** The facility shall be closed in accordance with the requirements of FAC Rule 62-711.700. The waste tire facility owner or operator shall notify the Department at least **ninety (90) days prior** to the date when tires will no longer be accepted for storage, as required by F.A.C. 62-711.700(2).

Executed in Hillsborough County, Florida.

STATE OF FLORIDA DEPARTMENT
OF ENVIRONMENTAL PROTECTION

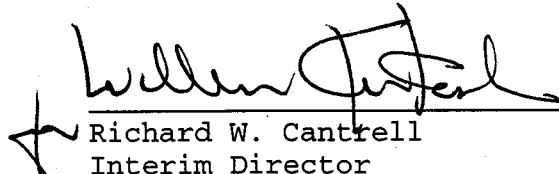
Richard W. Cantrell
Interim Director
Southwest District

PERMITTEE: Sarasota County

PERMIT NO.: 126775-002-WT/02

FACILITY: Sarasota Central Waste Tire Processing Facility

ATTACHMENT 1

SPECIFIC CONDITION	SUBMITTAL DUE DATE	REQUIRED ITEM
A.4	60 days prior to permit expiration	Submit application for permit renewal
D.3.b.	Quarterly, by January 20 th , April 20 th , July 20 th and October 20 th each year	Submit waste tire processing reports
D.4.a.	Annually, by March 1 st each year	Submit revised cost estimates
D.4.b.	Annually	Submit proof of funding
G.1	Within 90 days prior to ceasing operations	Notification of Closure

Events Scheduled

24 of 90

Site # 0126775 Site Name SARASOTA CO. CENTRAL SOLID WASTE COMPLEX WTPF (WTP)
Permit # Type/Subtype WT / 02 Received 04/26/2007
Project # 002 Project Name WASTE TIRE RENEWAL

> Issue Final Permit: Pending

Event	Begin Date	Period	Due Date	Rmn	Status	End Date
Receive Request	04/26/2007	1	04/27/2007		Done	04/26/2007
Fee Verification	04/26/2007	2	04/28/2007		Sufficient Fee	04/26/2007
Completeness Review	04/26/2007	30	05/26/2007		Incomplete	05/25/2007
RESET CLOCK	05/25/2007	1	05/26/2007		Done	05/25/2007
Awaiting Additional Information	05/25/2007	45	07/09/2007		Received	07/06/2007
Completeness Review	07/06/2007	30	08/05/2007		Complete	07/06/2007
Determine Agency Action	07/06/2007	90	10/04/2007		Issue	09/11/2007
Issue Final Permit	09/11/2007	14	09/25/2007	14	Issued	09/11/2007
Publish Notice of Application	04/26/2007	74	07/09/2007		Done	06/04/2007
Return Proof of Publication of Notice of App	06/04/2007	21	06/25/2007		Received	06/08/2007

CL AREA **SWD** Logged Total **CRAF006A \$1,250.00**

Collection Point Log Remittance

Remittance ID **725246** Type **OP** Received Date **04/26/2007** Status **RECEIVED**

System Receipt **585475** PNR Check # **00918351** Amount **1,250.00**

SSN/FEID Name **SARASOTA COUNTY BOCC**

First Middle Title Suffix

Address1

Address2

City **SARASOTA** ST **FL** Zip

Country Short Comments **SO 126775-002**

PAYMENT (\$)

Payment ID	Distribution	Object	Code/Description	Payment Amount	Reference#	Appl	Fund *	Status
725246	SWD	00000	WASTE TIRE PROC					

COMMIT FREQUENTLY **\$1,250.00** Payment Total

SITE Permit

Site Name **SARASOTA CO. CENTRAL SOLID WASTE COMPLEX WTPF (WTP)** Site # **0126775**

County **SARASOTA** Comments **N** RPAs **N** # Cases **0**

Project

Permit # Project # **002** Received **04/26/2006** CRA # **283954**

Permit Office **SWD (DISTRICT)** Agency Action **Pending**

Project Name **WASTE TIRE RENEWAL** Desc

Type/Sub/Des **WT / 02** W/T PROCESSING FACILITY COE #

Logged **04/30/2007** Issued Expires OGC

Fee **1250.00** Fee Recd **1250.00** Dele Override **NONE**

Related Party

Role **APPLICANT** Begin **04/30/2007** End

Name **COGGINS, FRANK** Company **SARASOTA COUNTY SOLID WASTE**

Address **4000 KNIGHTS TRAIL ROAD**

City **NOKOMIS** State **FL** Zip **34275** Country **U.S.A.**

Phone **941-861-1578** Fax Email

Processors

Processor **EVANS_R** Active **04/30/2007** Inactive Events

Permitting Application - Permit Detail and Log Permit									
SITE Permit									
Site Name SARASOTA CO. CENTRAL SOLID WASTE COMPLEX WTPF (WTP)						Site # 0126775			
County SARASOTA		Comments N		RPAs N		# Cases 0			
Project									
Permit # - - -		Project # 002		Received 04/26/2007		CRA # 283954			
Permit Office SWD (DISTRICT)		Agency Action Pending							
Project Name WASTE TIRE RENEWAL		Desc 							
Type/Sub/Des WT / 02		W/T PROCESSING FACILITY				COE # 			
Logged 04/30/2007		Issued 		Expires 		OGC 			
Fee 1250.00		Fee Recd 1250.00		Dele 		Override NONE			
Related Party									
Role APPLICANT		Begin 04/30/2007		End 					
Name COGGINS, FRANK		Company SARASOTA COUNTY SOLID WASTE							
Address 4000 KNIGHTS TRAIL ROAD									
City NOKOMIS		State FL		Zip 34275		Country U.S.A.			
Phone 941-861-1578		Fax 		Email 					
Processors									
Processor EVANS_R		Y		Active 04/30/2007		Inactive 		Events 	

Pelley

**Southwest District
Permitting Application**

New Site

Site Name:		
Site ID:		
County:		
Type/Subcode:		
Fee submitted:	() correct	() incorrect
Total Fee Required \$ _____ Need \$ _____ Refund \$ _____		

Existing Site

Site ID:	<i>126775</i>	
Project Name:	<i>Waste Tire Renewal</i>	
Type/Subcode:	<i>WT/02</i>	
Fee submitted:	<i>\$1,250</i>	<input checked="" type="checkbox"/> correct () incorrect
Total Fee Required \$ _____ Need \$ _____ Refund \$ _____		

Applicant Information

Name:		<i>Mr. Frank Coggins</i>	
Role:		<i>Applicant</i>	
Company:		<i>ON FILE</i>	
Address:			
City:		Zip Code:	
Phone:			

Fee verified by: *R. Evans*

Application Assigned To: *Evans* Date: *4/27/07*

Memorandum

Florida Department of Environmental Protection

PERMIT COVER MEMO

TO: x Richard W. Cantrell, INTERIM DIRECTOR

FROM/THROUGH: *[Signature]*

William Kutash

Susan Pelz, P.E. *[Signature]*

Roger Evans

ENVIRONMENTAL ADMINISTRATOR

SOLID WASTE MANAGER

SOLID WASTE ENGINEER *RE*

DATE: August 21, 2007

FILE NAME: Sarasota Central Waste Tire
Processing Facility

PERMIT #: 126775-002-WT/02

PROGRAM : Solid Waste

COUNTY : Sarasota

TYPE OF PERMIT ACTION: X ISSUE DENY MODIFY
 TRANSFER OWNER NOD
 PUBLIC NOTICE INTENT TO ISSUE

PUBLIC NOTICE PERIOD CLOSED?

PETITION FILED?

PERMIT SUMMARY: This permit is for the continued operation of a waste tire processing facility which conducts the shredding of waste tires at least four times per year. The shredded tires may be used for cover or landfilled at the on-site landfill. The facility has a storage capacity of 650 tons with a maximum processing throughput of 64 tons/day.

PROFESSIONAL RECOMMENDATION: X APPROVE DENY

EVALUATION SUMMARY: The applicant has provided sufficient information to demonstrate they qualify for the renewal of their existing permit.

Total processing time (TIH)= 117 days (to 08/21/07)
Department processing time (TTP)= 75 days (to 08/21/07)

		TTP
Application received	04/26/07	
Initial review (RAI #1)	05/25/07	29
Additional information received	07/06/07	
Application complete	07/06/07	
Final permit routing for signature	08/21/07	46

DAY (90)/30 FOR THIS ACTION IS: 10/04/07



Florida Department of Environmental Protection

Southwest District Office
13051 North Telecom Parkway
Temple Terrace, Florida 33637-0926

Charlie Crist
Governor

Jeff Kottkamp
Lt. Governor

Michael W. Sole
Secretary

CERTIFIED MAIL 7004 1350 0002 5576 8469
RETURN RECEIPT REQUESTED

September 11, 2007

NOTICE OF PERMIT

Sarasota County Environmental Services
Solid Waste Operations
4000 Knights Trail Road
Nokomis, Florida 34275
Attn: Mr. Frank Coggins, Operations Manager

RE: **Sarasota Central Waste Tire Processing Facility**
Sarasota County

Dear Mr. Frank Coggins:

Enclosed is permit number **126775-002-WT/02**, issued pursuant to Section(s) 403.087(1), Florida Statutes.

This letter and its attachments constitute a **complete permit** and **replace** all previous permits and permit modifications for the above referenced facility.

The Department's proposed agency action shall become final unless a timely petition for an administrative hearing is filed under Sections 120.569 and 120.57, Florida Statutes (F.S.), before the deadline for filing a petition. The procedures for petitioning for a hearing are set forth below.

A person whose substantial interests are affected by the Department's proposed permitting decision may petition for an administrative proceeding (hearing) under Sections 120.569 and 120.57, F.S. The petition must contain the information set forth below and must be filed (received) in the Office of General Counsel of the Department at 3900 Commonwealth Boulevard, Mail Station 35, Tallahassee, Florida 32399-3000.

Petitions by the applicant or any of the parties listed below must be filed within 14 days of receipt of this written notice. Petitions filed by other persons must be filed within 14 days of publication of the notice or receipt of the written notice, whichever occurs first. Under Section 120.60(3), F.S., however, any person who asked the Department for notice of agency action may file a petition within fourteen days of receipt of such notice, regardless of the date of publication. The petitioner shall mail a copy of the petition to the applicant at the address indicated above at the time of filing. The failure of any person to file a petition within the appropriate time period shall constitute a

waiver of that person's right to request an administrative determination (hearing) under Sections 120.569 and 120.57, F.S., or to intervene in this proceeding and participate as a party to it. Any subsequent intervention (in a proceeding initiated by another party) will be only at the discretion of the presiding officer upon the filing of a motion in compliance with Rule 28-106.205, F.A.C.

A petition that disputes the material facts on which the Department's action is based must contain the following information:

- (a) The name, address, and telephone number of each petitioner, the applicant's name and address, the Department File Number and the county in which the project is proposed;
- (b) A statement of how and when each petitioner received notice of the Department's action or proposed action;
- (c) A statement of how each petitioner's substantial interests are or will be affected by the Department's action or proposed action;
- (d) A statement of all material facts disputed by petitioner or a statement that there are no disputed facts;
- (e) A statement of the ultimate facts alleged, including a statement of the specific facts, which the petitioner contends, warrant reversal or modification of the Department's action or proposed action;
- (f) A statement of the specific rules or statutes the petitioner contends require reversal or modification of the Department's action or proposed action; and
- (g) A statement of the relief sought by the petitioner, stating precisely the action the petitioner wants the Department to take with respect to the Department's action or proposed action.

A petition that does not dispute the material facts on which the Department's action is based shall state that no such facts are in dispute and otherwise shall contain the same information as set forth above, as required by Rule 28-106.301, F.A.C.

Because the administrative hearing process is designed to formulate final agency action, the filing of a petition means that the Department's final action may be different from the position taken by it in this notice. Persons whose substantial interests will be affected by any such final decision of the Department have the right to petition to become a party to the proceeding, in accordance with the requirements set forth above.

In accordance with Section 120.573, F.S., the Department advises that mediation is not available in this case under the provisions of that statute. This does not prevent any interested parties from agreeing to other forms of alternate dispute resolution.

Any party to this order has the right to seek judicial review of it under Section 120.68, F.S., by filing a notice of appeal under Rule 9.110, Florida Rules of Appellate Procedure, with the clerk of the Department in the Office of General Counsel, Mail Station 35, 3900 Commonwealth Boulevard, Tallahassee, Florida 32399-3000, and by filing a copy of the notice of appeal accompanied by the applicable filing fees with the appropriate district court of appeal. The notice of appeal must be filed within thirty days after this order is filed with the clerk of the Department.

Executed in Hillsborough County, Florida.

STATE OF FLORIDA DEPARTMENT
OF ENVIRONMENTAL PROTECTION

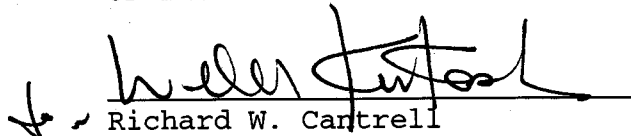
Richard W. Cantrell
Interim Director
Southwest District

RWC/re
Attachment

Copies furnished to:

Sarasota County Notification list
John A. Banks, P.E., SCS Engineers, 4041 Park Oaks Boulevard, Suite 100,
Tampa, Florida 33610
Richard Tedder, P.E., FDEP Tallahassee
Patricia Comer, FDEP OGC Tallahassee
Fred Wick, FDEP Tallahassee
Jan Clark, FDEP Tallahassee
Susan Pelz, P.E., FDEP Tampa
Permit Notebook

PERMITTEE: Sarasota County
c/o Mr. Frank Coggins

Permit No.: 126775-002-WT/02
Sarasota Central Waste Tire Processing Facility
Page 4

CERTIFICATE OF SERVICE

This undersigned duly designated deputy clerk hereby certifies that this **NOTICE OF PERMIT** and all copies were mailed before the close of business on September 11, 2007 to the listed persons.
(date stamp)

FILING AND ACKNOWLEDGMENT
FILED, on this date, pursuant
to Section 120.52(10), Florida
Statutes, with the designated
Department, Clerk, receipt of
which is hereby acknowledged.

Anna Black

Clerk

9-11-07

Date



Florida Department of Environmental Protection

Southwest District Office
13051 North Telecom Parkway
Temple Terrace, Florida 33637-0926

Charlie Crist
Governor

Jeff Kottkamp
Lt. Governor

Michael W. Sole
Secretary

PERMITTEE

Sarasota County Environmental
Services Solid Waste Operations
4000 Knights Trail Road
Nokomis, Florida 34275
Attn: Mr. Frank Coggins,
Operations Manager

PERMIT/CERTIFICATION

WACS Facility ID No: SWD-58-51614
Permit No: 126775-002-WT/02
Date of Issue: **09/11/2007**
Expiration Date: **09/11/2012**
County: Sarasota
Lat/Long: 27°11'58"
82°23'02"
Sec/Town/Rge: 1-4, 9-16/38S/19E
Project: Sarasota Central Waste
Tire Processing Facility

This permit is issued under the provisions of Chapter 403, Florida Statutes, and Florida Administrative Code Rule(s) 62-4, 62-701, and 62-711. The above named permittee is hereby authorized to perform the work or operate the facility shown on the application and approved drawing(s), plans and other documents, attached hereto or on file with the Department and made a part hereof and specifically described as follows:

To operate a waste tire processing facility (WTPF) at the Central County Solid waste Disposal Complex (CCSWDC), subject to the specific and general conditions attached, located at the existing Class I landfill at the north end of Knights Trail Road, 2 miles east of I-75, Nokomis, Sarasota County, Florida. The specific conditions attached are for the operation of:

1. Waste Tire Processing Facility

General Information: Facility receives waste tires from residents and businesses of Sarasota County. Incoming whole tires are weighed upon receipt at the truck scales and then the vehicle is directed to the storage area where the tires are piled in an area surrounded by an earthen berm to assure that in the event of a fire there will be no liquid runoff from the immediate area. The purpose of this facility is for temporary storage and shredding (processing) of waste tires. Processed tires are transported to the class I landfill immediately at the end of the processing cycle and are stockpiled near the working face for the purpose of using the processed tires for daily cover. The WTPF receives approximately 800 tons of tires per year.

Maximum tire storage	650 tons
Maximum tire throughput	64 tons/day

Replaces Permit No.: 126775-001-WT

This permit contains compliance items summarized in Attachment 1 that shall be complied with and submitted to the Department by the dates noted. If the compliance dates are not met and submittals are not received by the Department on the dates noted, enforcement action may be initiated to assure compliance with the conditions of this permit.

"More Protection, Less Process"

www.dep.state.fl.us

PERMITTEE: Sarasota County

PERMIT NO.: 126775-002-WT/02

FACILITY: Sarasota Central Waste Tire Processing Facility

GENERAL CONDITIONS:

1. The terms, conditions, requirements, limitations and restrictions set forth in this permit, are "permit conditions" and are binding and enforceable pursuant to Sections 403.141, 403.161, 403.727, or 403.861, Florida Statutes. The permittee is placed on notice that the Department will review this permit periodically and may initiate enforcement action for any violation of these conditions.
2. This permit is valid only for the specific processes and operations applied for and indicated in the approved drawings or exhibits. Any unauthorized deviation from the approved drawings, exhibits, specifications, or conditions of this permit may constitute grounds for revocation and enforcement action by the Department.
3. As provided in subsections 403.087(6) and 403.722(5), F.S., the issuance of this permit does not convey any vested rights or any exclusive privileges. Neither does it authorize any injury to public or private property or any invasion of rights, nor any infringement of federal, State, or local laws or regulations. This permit is not a waiver of or approval of any other Department permit that may be required for other aspects of the total project which are not addressed in this permit.
4. This permit conveys no title to land or water, does not constitute State recognition or acknowledgment of title, and does not constitute authority for the use of submerged lands unless herein provided and the necessary title or leasehold interests have been obtained from the State. Only the Trustees of the Internal Improvement Trust Fund may express State opinion as to title.
5. This permit does not relieve the permittee from liability for harm or injury to human health or welfare, animal, or plant life, or property caused by the construction or operation of this permitted source, or from penalties therefore; nor does it allow the permittee to cause pollution in contravention of Florida Statutes and Department rules, unless specifically authorized by an order from the Department.
6. The permittee shall properly operate and maintain the facility and systems of treatment and control (and related appurtenances) that are installed and used by the permittee to achieve compliance with the conditions of this permit, are required by Department rules. This provision includes the operation of backup or auxiliary facilities or similar systems when necessary to achieve compliance with the conditions of the permit and when required by Department rules.

GENERAL CONDITIONS:

7. The permittee, by accepting this permit, specifically agrees to allow authorized Department personnel, upon presentation of credentials or other documents as may be required by law and at reasonable times, access to the premises where the permitted activity is located or conducted to:

- (a) Have access to and copy any records that must be kept under conditions of the permit;
- (b) Inspect the facility, equipment, practices, or operations regulated or required under this permit; and
- (c) Sample or monitor any substances or parameters at any location reasonably necessary to assure compliance with this permit or Department rules.

Reasonable time may depend on the nature of the concern being investigated.

8. If, for any reason, the permittee does not comply with or will be unable to comply with any condition or limitation specified in this permit, the permittee shall immediately provide the Department with the following information:

- (a) A description of and cause of noncompliance; and
- (b) The period of noncompliance, including dates and times; or, if not corrected, the anticipated time the noncompliance is expected to continue, and steps being taken to reduce, eliminate, and prevent recurrence of the noncompliance.

The permittee shall be responsible for any and all damages which may result and may be subject to enforcement action by the Department for penalties or for revocation of this permit.

9. In accepting this permit, the permittee understands and agrees that all records, notes, monitoring data and other information relating to the construction or operation of this permitted source which are submitted to the Department may be used by the Department as evidence in any enforcement case involving the permitted source arising under the Florida Statutes or Department rules, except where such use is prescribed by Sections 403.111 and 403.73, F.S. Such evidence shall only be used to the extent it is consistent with the Florida Rules of Civil Procedure and appropriate evidentiary rules.

10. The permittee agrees to comply with changes in Department rules and Florida Statutes after a reasonable time for compliance; provided, however, the permittee does not waive any other rights granted by Florida Statutes or Department rules.

11. This permit is transferable only upon Department approval in accordance with Rule 62-4.120 and 62-730.300, Florida Administrative Code, as applicable. The permittee shall be liable for any non-compliance of the permitted activity until the transfer is approved by the Department.

GENERAL CONDITIONS:

12. This permit or a copy thereof shall be kept at the work site of the permitted activity.

13. This permit also constitutes:

- (a) Determination of Best Available Control Technology (BACT)
- (b) Determination of Prevention of Significant Deterioration (PSD)
- (c) Certification of compliance with State Water Quality Standards (Section 401, PL 92-500)
- (d) Compliance with New Source Performance Standards

14. The permittee shall comply with the following:

(a) Upon request, the permittee shall furnish all records and plans required under Department rules. During enforcement actions, the retention period for all records will be extended automatically unless otherwise stipulated by the Department.

(b) The permittee shall hold at the facility or other location designated by this permit records of all monitoring information (including all calibration and maintenance records and all original strip chart recordings for continuous monitoring instrumentation) required by the permit, copies of all reports required by this permit, and records of all data used to complete the application for this permit. These materials shall be retained at least three years from the date of the sample, measurement, report, or application unless otherwise specified by Department rule.

(c) Records of monitoring information shall include:

- 1. the date, exact place, and time of sampling or measurements;
- 2. the person responsible for performing the sampling or measurements;
- 3. the dates analyses were performed;
- 4. the person responsible for performing the analyses;
- 5. the analytical techniques or methods used;
- 6. the results of such analyses.

15. When requested by the Department, the permittee shall within a reasonable time furnish any information required by law which is needed to determine compliance with the permit. If the permittee becomes aware the relevant facts were not submitted or were incorrect in the permit application or in any report to the Department, such facts or information shall be corrected promptly.

SPECIFIC CONDITIONS: PART A -SOLID WASTE FACILITY GENERAL REQUIREMENTS

1. **Facility Designation.** This site shall be classified as a waste tire processing facility and shall be operated and closed in accordance with all applicable requirements of Chapters 62-4, 62-711, and 62-701, Florida Administrative Code (F.A.C.). This facility is limited to the acceptance of whole waste tires only. Other wastes shall not be accepted at this facility.

2. **Permit Application Documentation.** This permit is valid for operation of the waste tire processing facility in accordance with all applicable requirements of Department rules and the reports, plans and other information as follows:

a. Document entitled, Central County Solid Waste Disposal Complex Waste Tire Permit, dated April 24, 2007 (received April 26, 2007) and prepared by Sarasota County (unbound copy), revised by SCS Engineers dated July 5, 2007 (received July 6, 2007). This information includes, but is not limited to:

- 1) Waste Tire Facility Operations [Attachment B];
- 2) Emergency Preparedness Manual [Appendix A];
- 3) Storage Capacity Calculations [Appendix D]

3. **Permit Modifications.** Any construction or operation not previously approved as part of this permit shall require a separate Department permit unless the Department determines a permit modification to be more appropriate, or unless otherwise approved in writing by the Department. Permits shall be modified in accordance with the requirements of Rule 62-4.080, F.A.C. A modification which is reasonably expected to lead to substantially different environmental impacts, which require a detailed review by the Department, is considered a substantial modification.

4. **Permit Renewal.** Pursuant to Rule 62-4.090(1), F.A.C., **no later than sixty (60) days** before the expiration of the Department permit, the permittee shall apply for a renewal of a permit on forms and in a manner prescribed by the Department, in order to assure conformance with all applicable Department rules. Permits shall be renewed at least every five years as required by Rule 62-4.070(4), F.A.C.

5. **Professional Certification.** Where required by Chapter 471 (P.E.) or Chapter 492 (P.G.), Florida Statutes, applicable portions of permit applications and supporting documents, which are submitted to the Department for public record, shall be signed and sealed by the professional(s) who prepared or approved them.

6. **General Conditions.** The permittee shall be aware of and operate under the "General Conditions". General Conditions are binding upon the permittee and enforceable pursuant to Chapter 403, Florida Statutes.

PERMITTEE: Sarasota County

PERMIT NO.: 126775-002-WT/02

FACILITY: Sarasota Central Waste Tire Processing Facility

SPECIFIC CONDITIONS: PART A -SOLID WASTE FACILITY GENERAL REQUIREMENTS

7. **Permit Acceptance.** By acceptance of this Permit, the Permittee certifies that he/she has read and understands the obligations imposed by the Specific and General Conditions contained herein and also including date of permit expiration and renewal deadlines. It is a violation of this permit for failure to comply with all conditions and deadlines.

8. **Regulations.** Chapters 62-701, and 62-711, F.A.C., is incorporated into this permit by reference. In the event that the regulations governing this permitted operation are revised, the Department shall notify the permittee, and the permittee shall request modification of those specific conditions, which are affected by the revision of regulations to incorporate those revisions.

9. **Prohibitions.** The prohibitions of Rule 62-711.400, F.A.C., shall not be violated by activities at this site.

a. Waste Burning. Open burning of solid waste is prohibited except in accordance with Rule 62-701.300(3) and Chapter 62-256, F.A.C. All fires which require longer than one (1) hour to extinguish must be promptly reported to the Department and in accordance with Specific Condition #C.6., below.

SPECIFIC CONDITIONS: PART B - CONSTRUCTION REQUIREMENTS

1. **Construction.** All construction activities shall be approved by the Department prior to initiating work, unless specifically authorized otherwise.

2. **Certification of Construction Completion.** All information required by this Specific Condition shall be signed and sealed by a registered professional engineer or land surveyor as appropriate. At the completion of construction, information listed below shall be provided to the Department as part of the Certification of Construction Completion.

a. **Within sixty (60) days** after any specified construction has been completed or as otherwise specified in this permit, the following activities shall be completed and submitted by the permittee to the Department. Operation of the constructed systems, structures, equipment, etc., shall not be initiated prior to Department approval of the information required by this Specific Condition.

1) The owner or operator shall submit a Certification of Construction Completion, Form 62-701.900(2), signed and sealed by the professional engineer responsible for the construction to the Department for approval, and shall arrange for Department representatives to inspect the construction in the company of the permittee, the engineer, and the facility operator.

2) The owner or operator shall submit Record Drawings/Documents showing all changes (i.e. all additions, deletions, revisions to the plans previously approved by the Department). The Record Documents shall include as-built plans details and elevations (survey) as appropriate.

3) The owner or operator shall submit a narrative indicating all changes in plans and the cause of the deviations, and certification by the design engineer to the Department.

SPECIFIC CONDITIONS: PART C - OPERATION REQUIREMENTS

1. Facility Operation Requirements.

- a. The permittee shall operate this facility in accordance with Rule 62-711.530, F.A.C., the facility's Operation Plan [ref. SC#A.2.a.(1)], and any other applicable requirements.
- b. Incoming loads shall be unloaded at the waste tire storage area where the tires are collected in two piles.
- c. The tire piles, each a maximum of 50 feet wide by 180 feet long, are separated by a fifty-foot fire lane. Tires shall not be piled more than 15 feet in height [ref. Op. Plan, Sec. 1.0(3)(b)].
- d. The facility's operating hours are 8:00 AM to 5:00 PM Monday through Saturday.
- e. In the event of a fire, additional waste shall not be accepted in the area affected by the fire until the fire is completely extinguished, and the Department shall be notified in accordance with Specific Condition C.6.c.

2. Operating Personnel. A trained supervisor or foreman shall be responsible for operating and maintaining the facility in an orderly, safe, and sanitary manner. An attendant shall be present at all times when the facility is open to the public [ref. Op. Plan, Sec. 1.0(1)(c)] and tires are being received. Sufficient personnel shall be employed to adequately operate the facility.

3. Control of Access. Access to, and use of, the facility is controlled by the use of fences and gates. Access controls include a locking access gate at the entrance of the scale facility [ref. Op. Plan, Sec. 1.0(3)(d)].

4. Monitoring of Waste. The permittee shall not knowingly accept hazardous waste or any hazardous substance at this site. Hazardous waste is a waste in Chapter 62-730, F.A.C. Hazardous substances are those defined in Section 403.703, Florida Statute or in any other applicable state or federal law or administrative rule.

5. Control of Nuisance Conditions. The owner or operator shall control vectors so as to protect the public health and welfare. The operating authority shall be responsible for the control of odors and fugitive particulates arising from the operation. Such control shall minimize the creation of nuisance conditions on adjoining property. Complaints received from the general public, and confirmed by Department personnel upon site inspection, shall constitute a nuisance condition, and the permittee must take immediate corrective action to abate the nuisance.

SPECIFIC CONDITIONS: PART C - OPERATION REQUIREMENTS

6. Facility Maintenance and Repair.

a. The site shall be properly maintained. In the event of damage to any portion of the waste tire processing site facilities, equipment, storage areas, or buildings, failure of any portion of the associated systems, fire, explosion, or the development of sinkhole(s) at the site, the permittee shall **immediately (within 24 hours)** notify the Department explaining such occurrence, method to prevent reoccurrence, remedial measures to be taken and time needed for repairs. Written detailed notification shall be submitted to the Department **within seven (7) days** following the occurrence.

b. The facility shall ensure that the area within the earthen berm, which surrounds the waste tire piles, are kept free of grass, underbrush, and other potentially flammable vegetation at all times [ref. Op. Plan, Sec. 1.0(1)(d)].

c. In the event of a tire fire, impacted soils and/or liquids shall be contained, and shall be characterized prior to disposal either at the on-site Class I landfill or at an appropriately permitted offsite disposal facility. The results of this characterization shall be provided to the Department with the written notification required by Specific Condition #C.6.a. above, prior to disposal of the material.

7. Stormwater Management. The site shall have a surface water management system operated and maintained to prevent surface water flow on to unloading, loading and storage areas, and a stormwater runoff control system operated and maintained to collect and control stormwater to meet the requirements of Florida Administrative Code Rule 62-330, any other applicable Department rules, and the requirements of the respective water management district.

8. Material Management and Storage. All waste tires shall be stored in accordance with Rules 62-711.530 and 62-711.540, F.A.C., the operations plan, and as shown on the referenced Site Plan (Figure No. G-5 dated November 1995) and Proposed Grading and Paving (Sheet No. LFC-35 dated May 1994).

a. Onsite storage at the WTPF is limited to 650 tons of waste tires. The tires will be stored in two piles outdoors, each in an area of 9,000 square feet separated by a fifty-foot fire lane.

b. If the facility has reached its permitted storage capacity, the permittee shall not accept additional waste tires until sufficient capacity has been restored.

c. Tires accepted at the facility shall only be received from residents and businesses of Sarasota County.

PERMITTEE: Sarasota County

PERMIT NO.: 126775-002-WT/02

FACILITY: Sarasota Central Waste Tire Processing Facility

SPECIFIC CONDITIONS: PART C - OPERATION REQUIREMENTS

(Specific Condition #C.8. cont'd)

d. At least 75 percent of the whole tires, used tires, and processed tires that are delivered to or are contained on the site of the WTPF at the beginning of each calendar year shall be processed or removed for disposal or recycling from the facility during the year, or disposed of at a permitted solid waste management facility.

e. The processed waste tires may be used as initial cover or landfilled at the Class I landfill. When landfilled, the waste tires shall be cut into at least 8 substantially equal pieces [ref. Op. Plan, Sec. 3.0].

f. Only waste tires, processed tires and residuals from waste tire processing (e.g., shreds or rims) shall be stored at the WTPF. Other materials (e.g., mulch, special wastes) shall not be stored at the WTPF.

9. Fire Safety.

a. A fire safety inspection shall be conducted at least **annually**. The fire safety inspection report shall be maintained at the facility for five years and copies shall be provided to the Department upon request.

b. In the event that deficiencies are noted in the annual fire safety inspection report, **within 30 days** of completion, the permittee shall provide documentation to the Department indicating correction of any deficiencies noted. The documentation shall include approval of the corrections by the local fire authority.

SPECIFIC CONDITIONS: PART D - RECORDKEEPING

1. **Report Submittals.** Unless otherwise specified, all submittals, notifications, requests for permit modification, reports for compliance with this permit, etc. shall be sent to: Solid Waste Section, Department of Environmental Protection, Southwest District Office, 13051 North Telecom Parkway, Temple Terrace, Florida 33637-0926.

2. **Operation Plan and Operating Record.**

a. A copy of the Department approved permit, operational plan, construction reports and record drawings, and supporting information shall be kept at the facility at all times for reference and inspection.

b. Proposed changes to the current Department approved Operation Plan shall be submitted in writing to the Department for review and may require a permit modification in accordance with Specific Condition #A.3. The Operation Plan shall be updated as operations change and for renewal of the permit. Revised pages shall be provided as replacement pages with revisions noted (deletions may be struckthrough [~~struckthrough~~] and additions may be shaded [~~shaded~~] or a similar method may be used) and each page numbered with the document title and date of revision.

3. **Waste Records.**

a. Operational records shall be recorded and maintained for a minimum of **three years** and be available for inspection by Department personnel during normal business hours.

b. The owner or operator of the waste tire processing facility shall record on Department Form 62-711.900(21), F.A.C., the amount of waste tires received, processed tires and residuals, stored, and removed from the site. The following information shall be compiled monthly and submitted to the Department quarterly, by **January 20th, April 20th, July 20th and October 20th** of each year, pursuant to Rule 62-711.530(5), F.A.C.

1) The total quantity, in tons, for waste tires received at the facility during the quarter;

2) The total quantities, in tons, for waste tires processed at the facility during the quarter;

3) The total quantity, in tons, for waste tires shipped from the facility during the quarter;

4) The total quantity, in tons, of waste tires stored at the facility on the last day of the quarter;

5) The total quantity of waste tire processing residuals and other solid wastes removed for offsite disposal or stored onsite for the quarter; and

PERMITTEE: Sarasota County

PERMIT NO.: 126775-002-WT/02

FACILITY: Sarasota Central Waste Tire Processing Facility

SPECIFIC CONDITIONS: PART D - RECORDKEEPING

(Specific Condition #D.3., cont'd)

6) A list of all dates on which the waste tires exceeded the storage limit, and how this condition was relieved or will be relieved.

c. The following reports, documents and other information shall be kept at the facility for reference, and copies shall be provided to the Department upon request:

1) A log of the facility operator's inspections, and any subsequent corrective actions; and

2) A copy of the facility's Emergency Preparedness Manual shall be kept at the site and a copy shall be kept at an off-site location;

4. **Financial Assurance.** The permittee shall provide adequate financial assurance for the facility in accordance with Rule 62-711.500(3), F.A.C.

a. All costs for closure shall be adjusted and submitted **annually, by September 1st of each year** to: Solid Waste Manager, Solid Waste Section, Department of Environmental Protection, 13051 North Telecom Parkway, Temple Terrace, Florida 33637-0926.

b. Proof that the financial mechanism has been adequately funded shall be **submitted annually** to: Financial Coordinator, Solid Waste Section, Department of Environmental Protection, 2600 Blair Stone Road, MS #4565, Tallahassee, Florida 32399-2400.

PERMITTEE: Sarasota County

PERM. NO.: 126775-002-WT/02

FACILITY: Sarasota Central Waste Tire Processing Facility

PART E - WATER QUALITY MONITORING REQUIREMENTS

(THERE ARE NO WATER QUALITY MONITORING REQUIREMENTS FOR THIS FACILITY)

PART F - LANDFILL GAS MANGEMENT

(THERE ARE NO LANDFILL GAS MANAGEMENT REQUIREMENTS FOR THIS FACILITY)

PART G - CLOSURE AND LONG TERM CARE REQUIREMENTS

1. **Closure Requirements.** The facility shall be closed in accordance with the requirements of FAC Rule 62-711.700. The waste tire facility owner or operator shall notify the Department at least **ninety (90) days prior** to the date when tires will no longer be accepted for storage, as required by F.A.C. 62-711.700(2).

Executed in Hillsborough County, Florida.

STATE OF FLORIDA DEPARTMENT
OF ENVIRONMENTAL PROTECTION

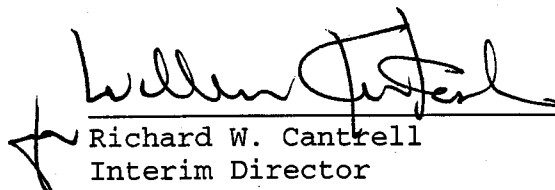
Richard W. Cantrell
Interim Director
Southwest District

PERMITTEE: Sarasota County

PERMIT NO.: 126775-002-WT/02

FACILITY: Sarasota Central Waste Tire Processing Facility

ATTACHMENT 1

SPECIFIC CONDITION	SUBMITTAL DUE DATE	REQUIRED ITEM
A.4	60 days prior to permit expiration	Submit application for permit renewal
D.3.b.	Quarterly, by January 20 th , April 20 th , July 20 th and October 20 th each year	Submit waste tire processing reports
D.4.a.	Annually, by March 1 st each year	Submit revised cost estimates
D.4.b.	Annually	Submit proof of funding
G.1	Within 90 days prior to ceasing operations	Notification of Closure

SCS ENGINEERS

July 5, 2007
File No. 09201010.24

Dept. of Environmental
Protection

Mr. Roger Evans
Florida Department of Environmental Protection
Southwest District Office
13051 North Telecom Parkway
Temple Terrace, FL 33637-0926

JUL 06 2007

Southwest District

Subject: Sarasota County CCSWDC Landfill – Waste Tire Facility Permit Renewal
Pending Permit No.: 126775-002-WT/02

Dear Mr. Evans:

SCS Engineers (SCS), on behalf of Sarasota County, submits the following responses to comments made in your letter to Mr. Wrangler on May 25, 2007 regarding the referenced permit application renewal. For ease of review, the Florida Department of Environmental Protection (FDEP) comments are in bold, followed by our response.

The following documents are provided with this submittal:

1. New permit application including;
 - Application Form
 - Attachment A – Waste Tire Facility Design
 - Attachment B – Waste Tire Facility Operation
 - Appendix A – Standard Operating Procedures
 - Appendix B – Pest Management Plan
 - Appendix C – Tire Shredding Bid
 - Appendix D – Calculations (Includes new Closure Cost Estimate)
 - Appendix E – Fire Inspection Safety Report (Includes 2006 Report)
2. Copy of September 29, 2006 Financial Assurance Funding Letter
3. Proof of Publication of Notice of Application
4. FY 2006 Waste Tire Tonnage Records
1. **Please provide specific references to any previously submitted documents that you are requesting the Department to consider in support of this application. The references should specifically identify the parts of the previously submitted document in which the subject information was originally submitted (prepared by, date of preparation, date received by the Department, section, etc.) and verify that**



the document is located in the Department's current files and remains valid. Otherwise please resubmit the information and/or submit revisions to the supporting information, as appropriate.

Response: Comment noted. A new permit application form and associated exhibits is enclosed with this letter and all other references for previously submitted information we referenced as requested.

2. **Rule 62-711.530 (6), F.A.C. Application Form #62-701.900 (23):** Please address the following comments regarding the permit application form and provide the appropriate application form with the revised information, where applicable:

- a) **This application is for the operation renewal of a "Waste Tire Processing Facility Permit Application" but the application provided (Form #62-701.900 (25)) to the Department is for a "Waste Tire Collection Center Permit Application". Please provide the correct application form.**

Response: A new permit application is submitted as Attachment (1) with this letter. DEP Form #62-701.900 (25), "Waste Tire Collection Center Permit Application" has been replaced by DEP Form #62-701.900 (23), "Waste Tire Processing Facility Permit Application.

- b) **Part I.B.7 – Facility Location Coordinates: The Section, Township, and Range appear to be incorrectly identified. Please provide a revised application form that identifies the correct Section, Township, and Range for the facility.**

Response: A revised application form has been provided that identifies the correct Section, Township, and Range for the facility.

- c) **Part I.C – Land Owner Information: This part of the application form was identified as not applicable. Please identify if the landowner is the same as the applicant.**

Response: The landowner has been identified as being the same as the applicant.

- d) **Part IV – Certification: Please provide a letter of authorization for Paul Winger from the County Solid Waste Department Director.**

Response: SCS Engineers has been authorized by Sarasota County to sign as the agent for Sarasota County.

3. **Rule 62-701.320(8), F.A.C. Proof of publication: Please publish the attached Notice of Application and provide proof of publication to the Department.**

Response: The Notice of Application was published on June 4, 2007 and the proof of publication has been included as Attachment (3) with this submittal.

Rule 62-711.530, F.A.C. Operations Plan:

Please provide the following additional information and revisions to the Operations Plan.

4. **A copy of Figure G-5 was not included with the documentation. Please provide the Figure G-5 of Attachment A. See Comment #1.**

Response: Figure G-5 is now included in Attachment A of the application.

5. **Please provide documentation to support that the Waste Tire Processing Facility currently receives approximately 500 tons of tires per year.**

Response: Documentation showing how many tons of tires were received at the facility for fiscal year 2006 has been included as Attachment (4) with this submittal.

6. **Storage Requirements, Section 1.0: Please clarify what is meant by, "All waste tires are stored in accordance with the waste tire site requirements of 62-711.510 F.A.C. and storage standards of 62-711.540 F.A.C."**

Response: The text has been revised to read, "All waste tires are stored in accordance with the storage standards of 62-711.540 F.A.C."

7. **Fire Protection, Section 1.0(1) (d):**

- a) **Please provide a copy of the most recent fire-safety survey.**

Response: A copy of the most recent fire-safety survey, conducted on November 15, 2006, is provided in Appendix E of the new application included with this submittal.

- b) **Please include a general statement in this section that in the event of a facility fire the Operator will stop all incoming waste to the waste tire facility.**

Response: A general statement stating that, "the Operator will stop all incoming waste to the waste tire facility" has been included in Fire Protection, Section 62-711.540 (1) (d).

- c) **Please clarify if the Waste Tire Processing Facility has had any fires during the past five year permit cycle.**

Response: The Waste Tire Processing Facility has not had any fires during the past five year permit cycle.

8. **Emergency Preparedness Manual, Section 1.0 (1) (e):** The text indicates that a copy of the Emergency Preparedness Manual is included in Appendix A. Please submit a copy of this manual. See Comment #1.

Response: A copy of the Emergency Preparedness Manual is part of the Standard Operating Procedures and has been included in Appendix A of the application.

9. **Emergency Preparedness Manual, Section 1.0 (4):** Please explain where processed tires are taken if they are not transported to the Class I landfill. If the processed tires are indeed taken to the Class I landfill, please modify the language to specify "Processed tires shall be transported to the Class I landfill....."

Response: We believe the document referenced in this comment was intended to be Attachment B to the application, Waste Tire Facility Operation. The language in Attachment B, Section 1.0 (4) has been modified to read, "Process tires **shall be** transported to the Class I landfill....."

10. **Maximum Storage Limits, Section 2.0:** The text indicates that the Engineer's calculation is included in Appendix D. Please submit a copy of the Engineer's calculation. See Comment #1.

Response: A copy of the Engineer's calculations are now included in Appendix D.

11. **Permit Application, Section 6.0:** The application Form 62-701.900 (23), signed and sealed by a professional engineer registered in Florida, was not included in the submittal. See Comment #2a.

Response: The application Form 62-701.900 (23), has been signed and sealed by a professional engineer registered in Florida and is now included in the submittal.

12. **Closing Cost Estimate and Financial Assurance – Section 8.0:** The closure cost included as a line item "Site Specific Cost" in the CCSWDC facility financial assurance cost estimate is based on information provided as part of the waste tire processing permit application. Cost estimates provided as part of a permit renewal shall be revised cost estimates, including information and calculations to support quantities provided and current third-party quotes to support unit costs provided. Revised cost estimates cannot be based on inflation adjustment of previously approved costs. Please provide revised closure cost estimates for this waste tire processing facility. You may contact Mr. Steve Morgan at (813) 632-7600, ext. 385, to discuss this item.

Response: Revised closure cost estimates for the waste tire processing facility have been provided in Appendix D of the new application included with this submittal. The updated

closure cost is \$138,417.50. Last year the estimated closing cost of the Waste Tire Facility was \$128,520.00. Proof of funding for financial assurance was provided to the Department via letter to Chad Fetrow from Peter Ramsden dated September 29, 2006 showing an escrow balance surplus of \$209,116.80. Thus the increase in the Waste Tire Closure Cost Estimate (\$9,897.50) is already met with the 2006 Escrow account balance. The Escrow balance requirement for 2007 shall be adjusted to reflect the new closure cost estimate for the Waste Tire Facility.

Standard Operating Procedures:

Please provide the following additional information and revisions to the Standard Operating Procedures.

13. Safety:

- a) **Safety Officer:** Please update the names of the Solid Waste Operations Division Safety Officer and the Solid Waste Operations Division Manager.

Response: The text has been modified to include Frank Coggins, Solid Waste Operations Division Manager and Terry Foxworthy, Solid Waste Operations Division Safety Officer.

14. Emergency and Fire Safety:

- a) **Used Tire Storage Area Special Rules:** Please change the name of the agency from Department of Environmental Regulation to Department of Environmental Protection.

Response: The name of the agency has been changed from Department of Environmental Regulation to Department of Environmental Protection.

- b) **Used Tire Storage Area Special Rules:** Please correct the telephone number for the FDEP Tampa Office to reflect the telephone number of (813) 632-7600.

Response: The correct telephone number for the FDEP Tampa Office had been revised in the text to read (813) 632-7600.

- 15. Site Plans:** Please provide specific references to any previous submitted drawings that remain valid or provide the Department with current record drawings which are signed and sealed by a registered professional engineer or land surveyor as appropriate. See comment #1.

Response: All of the previously submitted drawings that remain valid have been included with this submittal.

Mr. Roger Evans
July 5, 2007
Page 6

Please do not hesitate to contact us if you have any additional questions on the information provided.

Very truly yours,

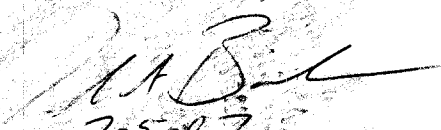

7-5-07
John A. Banks, P.E.
Project Director



C. E. Hilton, P.E.
Vice President
SCS ENGINEERS

JAB/CEH:med

cc: Paul Wingler, Sarasota County
Frank Coggins, Sarasota County
Susan Pelz, P.E., FDEP Tampa

Attachment 1

**SARASOTA COUNTY CENTRAL COUNTY
SOLID WASTE DISPOSAL COMPLEX
RENEWAL APPLICATION FOR THE
WASTE TIRE PROCESSING FACILITY**

Prepared for:

Sarasota County
4000 Knights Trail Road
Nokomis, Florida 34275
(941) 486-2600

Prepared by:

SCS Engineers
4041 Park Oaks Boulevard, Suite 100
Tampa, Florida 33610
(813) 621-0080

File No. 09201010.24
July 5, 2007

TABLE OF CONTENTS

<u>Section</u>	<u>Page</u>
Waste Tire Processing Facility Permit Application	
<u>Attachments</u>	
A	Waste Tire Processing Facility Design.....A-1
B	Waste Tire Processing Facility OperationB-1
1.0	Storage Requirements - 62-711.530 (1).....1
2.0	Maximum Storage Limits - 62-711.530(2)5
3.0	Processed Tires - 62-711.530 (3).....5
4.0	Record Keeping And Maintenance - 62-711.530(4)6
5.0	Submission Of Reports - 62-711.530(5).....6
6.0	Permit Application - 62-711.530(6).....7
7.0	Closure - 62-711.7007
8.0	Closing Cost Estimate And Financial Assurance 62-711.500(3)7
<u>Appendices</u>	
A	Standard Operating Procedures
B	Pest Management Plan
C	Tire Shredding Bid
D	Calculations
E	Fire Inspection Safety Report



Department of Environmental Protection

DEP Form # 62-701.900(23)
Waste Tire Processing Facility
Form Title <u>Permit Application</u>
Effective Date <u>3/22/00</u>
DEP Application No. _____ (Filled in by DEP)

Waste Tire Processing Facility Permit Application

Permit No. 126775-002-WT/02

Renewal ☒ Modification ☐ Existing unpermitted facility ☐ Proposed new facility ☐

Part I-General Information:

A. Applicant Information:

1. Applicant Name: Sarasota County Environmental Services Solid Waste Operations
2. Applicant Street Address: 4000 Knights Trail Road
3. City: Nokomis County: Sarasota Zip: 34275
4. Applicant Mailing Address: Same as above
5. City: _____ County: _____ Zip: _____
6. Contact person: Frank Coggins Phone: (941) 861-1571 FEID No: _____
7. Have any enforcement actions been taken by the Department against the applicant relating to the operation of any solid waste management facility in this state? This includes any Complaint, Notice of Violation, or revocation of a permit or registration, as well as any Consent Order in which a violation of Department rules is admitted. It does not include a Warning Letter, Warning Notice, Notice of Noncompliance, or other similar document which does not constitute agency action.
Yes _____ No ☒ If yes, attach a history and description of the enforcement actions.

B. Facility Information:

1. Facility Name: Central County Solid Waste Disposal Complex (CCSWDC)
2. Facility Street Address (Main Entrance): 4000 Knights Trail Road
3. City: Nokomis County: Sarasota Zip: 34275
4. Facility Mailing Address: 4000 Knights Trail Road
5. City: Nokomis State: FL Zip: 34275
6. Contact Person: Frank Coggins Phone: (941) 861-1571
7. Facility Location Coordinates:
Section: 1-4 + 9-16 Township: 38S Range: 19E
Latitude: 27°12'00" Longitude: 82°23'00"
8. Anticipated date for starting construction N/A and for completion of construction N/A
9. Anticipated date for receipt of tires N/A and for start of processing N/A

Mail completed form to
appropriate district office listed below

Northwest District
160 Governmental Center
Pensacola, FL 32501-5794
850-595-8360

Northeast District
7825 Baymeadows Way, Ste. 200 B
Jacksonville, FL 32256-7590
904-448-4300

Central District
3319 Maguire Blvd., Ste. 232
Orlando, FL 32803-3767
407-894-7555

Southwest District
3804 Coconut Palm Dr.
Tampa, FL 33619
813-744-6100

South District
2295 Victoria Ave., Ste. 364
Fort Myers, FL 33902-2549
941-332-6975

Southeast District
400 North Congress Ave.
West Palm Beach, FL 33401
561-681-6600

DEP Form # 62-701.900(23)
Waste Tire Processing Facility
Form Title <u>Permit Application</u>
Effective Date <u>3/22/00</u>
DEP Application No. _____ (Filled in by DEP)

C. Land Owner Information (if different from applicant): Same as applicant

- Owner's name: _____
- Land owner's mailing address: _____
- City: _____ State: _____ Zip: _____
- Authorized Agent: _____ Agent's phone () _____
- Current lease expires: _____

D. Facility Operator Information (if different from applicant):

- Operator's name: _____
- Operator's mailing address: _____
- City: _____ State: _____ Zip: _____
- Contact person: _____ Phone: () _____

E. Preparer of Application:

- Name of person preparing application: John A. Banks, P.E. - SCS Engineers
- Mailing address: 4041 Park Oaks Boulevard, Suite 100
- City: Tampa State: FL Zip: 33610
- Phone: (813) 621-0080
- Affiliation with facility: Consultant

Part II-Operations:

A. Facility type (check appropriate box):

- ☐ Waste tire processing facility.
- ☒ Waste tire processing facility with on-site disposal of processed tires or processing residuals.
See Attachment _____
- ☐ Waste tire processing facility with on-site consumption of waste tires or processing residuals.
See Attachment F
- ☐ Permitted solid waste management facility modification to allow waste tire site and processing.

B. Type of processing facility (check as many as apply):

- ☒ Shredder ☐ Cutter ☐ Chopper ☐ Incinerator only ☐ Incinerator with energy recovery
- ☐ Pyrolysis ☐ Supplemental fuel user ☐ Other, explain _____

C. Storage: Indicate the maximum quantities of whole waste tires, processed waste tires, and processing residuals, expressed in tons, to be stored at the facility, in accordance with Rule 62-711.530(2), F.A.C.

	Outdoor Storage(tons)	Outdoor Storage (sq.ft)	Indoor Storage (tons)	Indoor Storage (sq.ft)	Total Storage (tons)
Whole waste tires:	<u>650</u>	<u>18,000</u>	<u>N/A</u>	<u>N/A</u>	<u>650</u>
Processed tires:	_____	_____	_____	_____	_____
Processing residuals:	_____	_____	_____	_____	_____
TOTALS:	<u>650</u>	<u>18,000</u>	<u>N/A</u>	<u>N/A</u>	<u>650</u>

DEP Form # 62-701.900(23)
Waste Tire Processing Facility
Form Title <u>Permit Application</u>
Effective Date <u>3/22/00</u>
DEP Application No. _____
(Filled in by DEP)

D. For reporting quantity of tires in tons, tires will be: weighed on site ☒ weighed off site ☐ weights will be calculated ☐

E. Facilities that will not be disposing of processed tires or processing residual on the facility site must indicate the permitted solid waste management facility where processed tires or residuals will be disposed. N/A

1. Name of facility _____

2. Street address: _____

3. City: _____ County: _____ Zip: _____

F. Facilities that will be delivering processed tires to consuming facilities must describe the existing or proposed markets for those processed tires. N/A

Part III-Attachments:

A. Facility design

NOTE: All maps, plan sheets, drawings, isometrics, cross sections, or aerial photographs shall be legible; be signed and sealed by a registered professional engineer responsible for their preparation; be of appropriate scale to show clearly all required details; be numbered, referenced to narrative, titled, have a legend of symbols used, contain horizontal and vertical scales (where applicable), and specify drafting or origination dates; and use uniform scales as much as possible, contain a north arrow and use NGVD for all elevations.

1. A topographic or section map of the facility, including the surrounding area for one mile, no more than one year old, showing land use and zoning within one mile of the facility
2. A plot plan of the facility on a scale of not less than one inch equals 200 feet. At a minimum, the plot plan shall include
 - a. The facility design, including the location and size of all storage and processing areas for used tires, unprocessed waste tires, processed waste tires, and waste tire processing residuals;
 - b. All wetlands and water bodies within the facility or within 200 feet of any storage area;
 - c. Stormwater control measures, including ditches, dikes, and other structures;
 - d. Boundaries of the facility, legal boundaries of the land containing the facility, and any easements or rights of way that are within the facility or within 200 feet of any storage area;
 - e. Location, size, and depth of all wells within the facility or within 200 feet of any storage area;
 - f. All structures and buildings that are, or will be, constructed at the facility; include those used in storage and processing operations;
 - g. All areas used for loading and unloading;
 - h. All access roads and internal roads, including fire lanes;
 - i. Location of all fences, gates, and other access control measures; and
 - j. Location of all disposal areas within the facility.

B. Facility operation.

1. A description of the facility's operation, process and products including how waste tires will be received and stored.
2. A description of the equipment used for processing tires. This description shall include the make, model, and hourly capacity of each piece of equipment.
3. Description of the waste from the process, the amount of waste expected and how and where this waste will be disposed of.
4. Statement of the maximum daily throughput and the planned daily and annual throughput.
5. A description of how the operator will maintain compliance with each of the storage requirements of Rule 62-711.540, F.A.C.
6. A copy of the emergency preparedness manual for the facility with a statement of the on site and off site locations where that manual will be maintained.
7. A copy of the fire safety survey
8. A description of how 75% of the annual accumulation of waste tires will be removed for disposal or recycling.

C. Completed closing plan for the facility as required by Rule 62-711.700(2) and (3), F.A.C.

DEP Form # 62-701.900(23)
Waste Tire Processing Facility
Form Title <u>Permit Application</u>
Effective Date <u>3/22/00</u>
DEP Application No. _____ (Filled in by DEP)

- D. Attach proof of financial responsibility as requirement by Rule 62-711.500(3) OR a calculation showing that financial assurance documents, currently on file with the Department, are sufficient to assure closing of the waste tire site as well as any other solid waste management facility at that location.
- E. A letter from the land owner (if different from applicant) authorizing use of the land as a waste tire processing facility.
- F. If waste tires will be consumed at the facility, attach a description of the other environmental permits that the applicant has for this use, including, permit number, date of issue, and name of issuing agency
- G. The permit fee as required in Rule 62-4, F.A.C.

Part IV-Certification:

A. Applicant:

The undersigned applicant or authorized representative of Sarasota County Solid Waste Business Unit
Is aware that statements made in this form and attached information are an application for a
Waste Tire Processing Facility Permit from the Florida Department of Environmental Protection and certifies that
The information in this application is true, correct and complete to the best of his knowledge and belief.
Further, the undersigned agrees to comply with the provisions of Chapter 403, Florida Statutes, and all rules
and regulations of the Department. It is understood that the Department will be notified prior to the sale or
legal transfer of the facility.

<u>Frank Coggins</u>	Frank Coggins, Operations Manager	<u>7-6-07</u>
Signature of Applicant or Authorized Agent	Name and Title	Date

B. Professional Engineer registered in Florida.

This is to certify that the engineering features of this waste tire processing facility have been
Designed/examined by me and found to conform to engineering principals applicable to such facilities. In my
professional judgment, this facility, when properly maintained and operated will comply with all applicable
statutes of the State of Florida and rules of the Department. It is agreed that the undersigned will provide the
applicant with a set of instructions for proper maintenance and operation of the facility.

<u>John A. Banks</u>	SCS Engineers
Signature	Mailing Address
John A. Banks, P.E. <u>7-5-07</u>	4041 Park Oaks Boulevard, Suite 100, Tampa, FL 33610
Name and Title	City, State, Zip
39397	(813) 621-0080
Florida Registration Number	Telephone number

(please affix seal)

Date

ATTACHMENT A
WASTE TIRE PROCESSING FACILITY DESIGN

ATTACHMENT A

WASTE TIRE PROCESSING FACILITY DESIGN

Attachment A has been reproduced from the 1997 Operation Permit Application for convenience. Drawing G-5, Site Plan North, illustrating an overall plan of the Central County Solid Waste Disposal Complex (CCSWDC) incorporating the waste tire processing facility and the associated solid waste landfill, is included in this attachment. Drawings LFC-35 and LFC-61A delineating plan and section, respectively, of the Waste Tire Processing Facility are also included in this attachment to facilitate easy reference for this document.

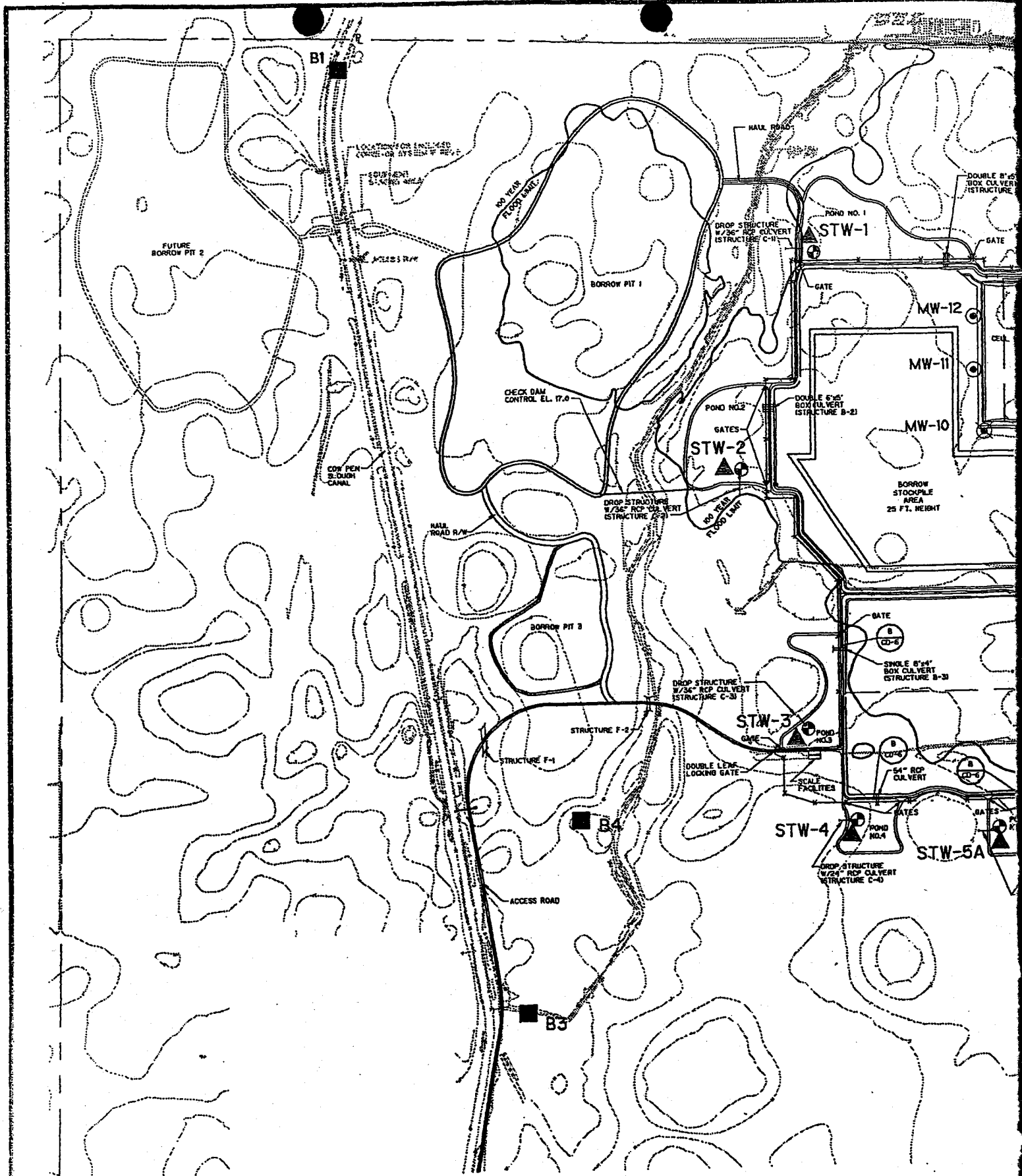

CDM

Camp Dresser & McKee

**environmental
services**

NOTE:
THIS MODIFIED
ON CONFORME
LANDFILL SITE
PLANS, SHEET

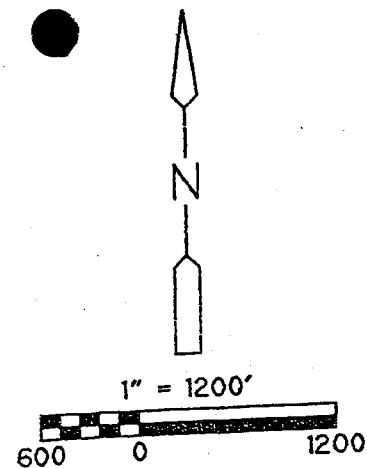
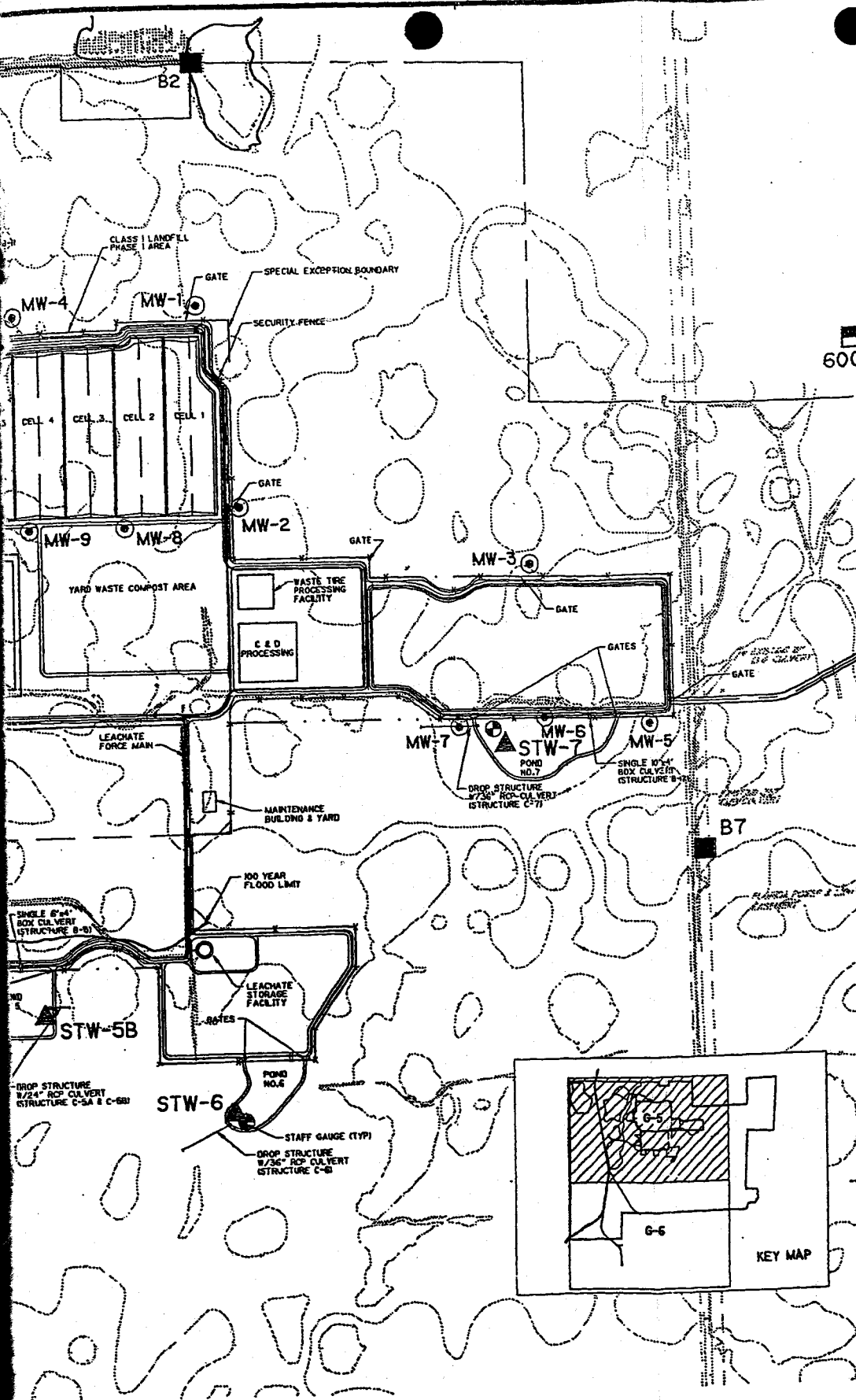

LEGEND

- STAFF GAUGE LOCATION
- EXISTING MONITOR WELL LOCATIONS
- EXISTING DAMAGED MONITOR WELL
- SURFACE WATER MONITORING STATIONS
- STORMWATER MONITORING STATIONS

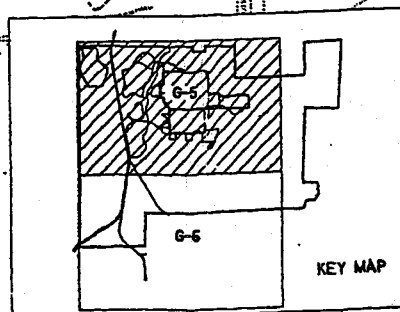

FLORIDA DEPARTMENT OF
ENVIRONMENTAL PROTECTION

JUL 06 2007

SOUTHWEST DISTRICT
TAMPA

SARASOTA COUNTY
CENTRAL COUNTY SOLID WASTE DISPOSAL COMPLEX
**SITE PLAN
NORTH**

Figure No. G-5

DRAWING IS BASED
ON NOVEMBER 1995
WORK CONSTRUCTION
NO. G-5.

LIMITS OF CONSTRUCTION

-SPECIAL EXCEPTION BOUNDARY

-WETLAND BUFFER



P1
N 1042134.37
E 531272.11

D
CD-6 CURBING

2
LFC-6A

—DEPRESSION
IN ROADWAY

-EL 24.0

N 1041744.20
E 531555.83

CONTRACTOR TO GRADE.
—SEED & MULCH (1 YR) —

PI
N 1041365.80
E 531275.70

£ 532,000

MATCH LINE SHEET NO LFC-36

 $\gamma = 60^\circ$

KEY MAP

LFC-27	LFC-28	LFC-29		
LFC-30	LFC-31	LFC-32		
LFC-33	LFC-34	LFC-35	LFC-36	LFC-37
LFC-38	LFC-39	LFC-40	LFC-41	LFC-42
LFC-43	LFC-44	LFC-45		
LFC-46	LFC-47	LFC-48		

KEY MAP

FLORIDA DEPARTMENT OF
ENVIRONMENTAL PROTECTION

JUL 06 2007

SOUTHWEST DISTRICT
TAMPA

CHANGE ORDER NO. 2

PROJECT NO.
9250-58-CON

SHEET NO.
LFC-35

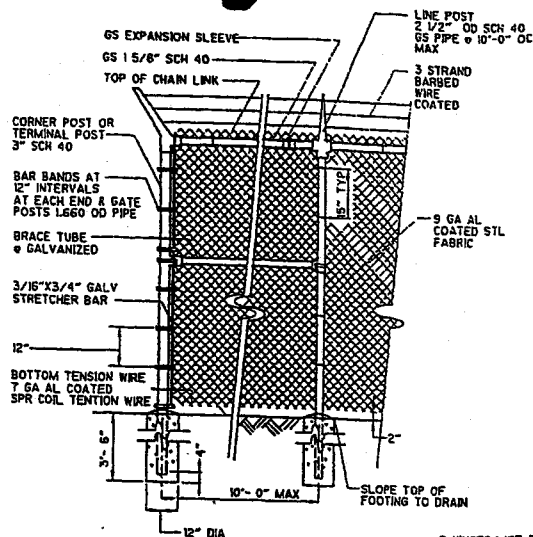

CHAIN LINK FENCE
DETAIL A
NTS 6-7

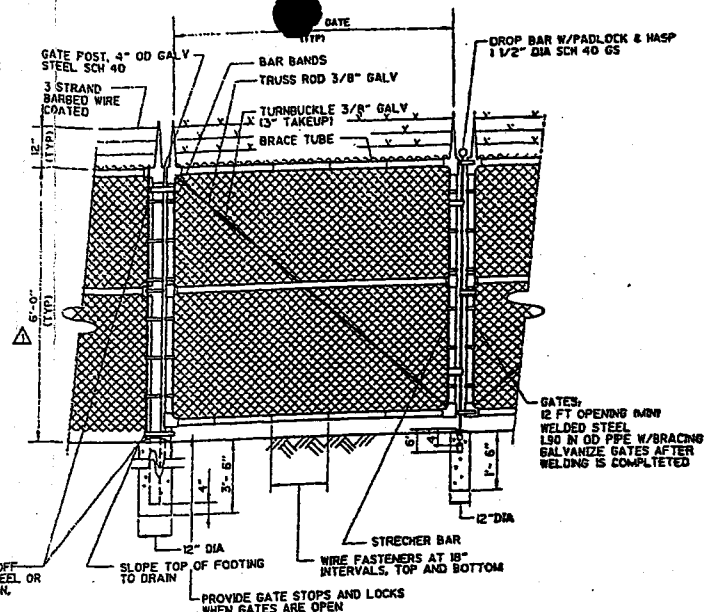

CHAIN LINK FENCE-GATE
DETAIL B
NTS 6-7

HALT PRIME COAT
CEMENT TREATED BASE
STABILIZED SUB GRADE

SECTION 4
LFC-61A

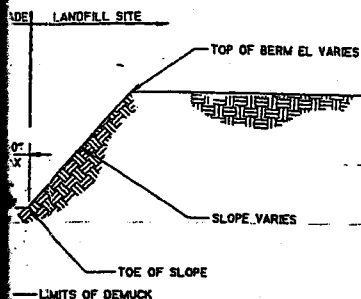

SECTION 5
LFC-28 & 35

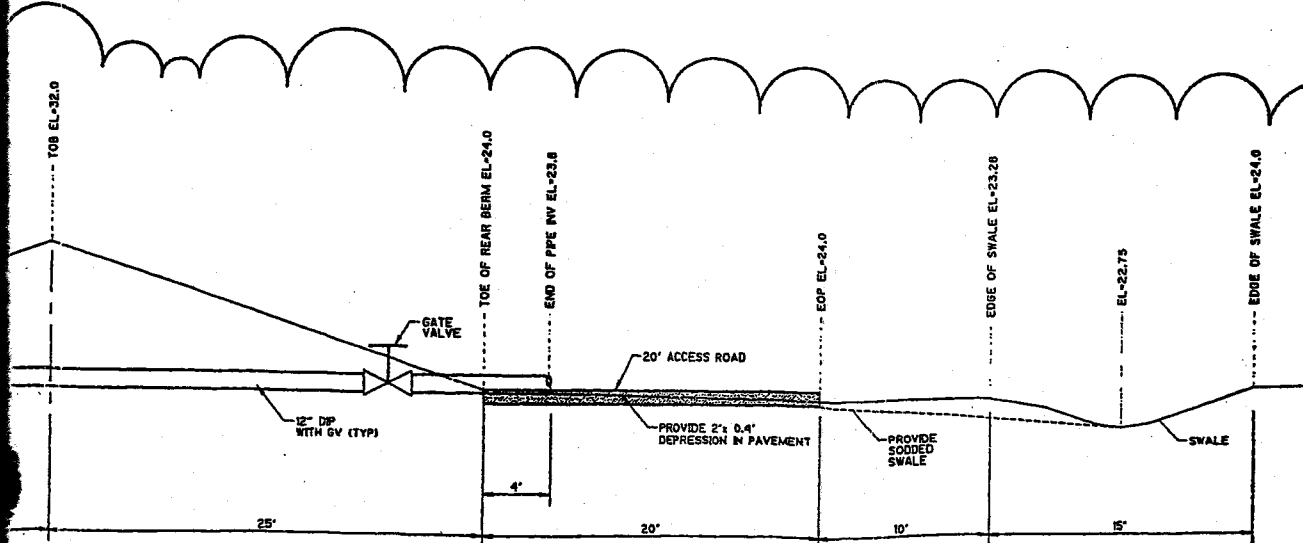

SECTION 2
LFC-35

FLORIDA DEPARTMENT OF
ENVIRONMENTAL PROTECTION
JUL 06 2007
SOUTHWEST DISTRICT
TAMPA

CHANGE ORDER NO. 2

SARASOTA COUNTY, FLORIDA

CENTRAL COUNTY SOLID WASTE DISPOSAL COMPLEX
LANDFILL SITE WORK

MISCELLANEOUS SECTIONS & DETAILS

PROJECT NO.
9250-58-CON

SHEET NO.
LFC-61A

ATTACHMENT B

WASTE TIRE PROCESSING FACILITY OPERATION

ATTACHMENT B

WASTE TIRE PROCESSING FACILITY OPERATION

The Waste Tire Processing Facility (WTPF) is located, as shown on Figure G-5 of Attachment A. The facility is located within the confines of the Central County Solid Waste Disposal Complex (CCSWDC), which is located at the north end of Knights Trail Road in Sarasota County, Florida. The Solid Waste Business Unit of Sarasota County, or a selected qualified contractor, will operate the associated landfill and the WTPF.

The Waste Tire Processing Facility is for the use and convenience of the residents and businesses of Sarasota County and is not intended for use by any other persons. The purpose of this facility is for temporary storage and shredding (processing) of waste tires. Waste tires are received as other wastes being delivered to the CCSWDC. The tires are weighed using the truck scales, and a fee is charged according to the current Rate Resolution as enacted by the Board of County Commissioners of Sarasota County, Florida. Persons delivering waste tires to the facility are directed to the storage area, and the tires are piled as set forth herein.

The WTPF at CCSWDC receives approximately 800 tons of tires per year. The operation of the facility is carried out in conformance with the requirements of 62-711.530 F.A.C.

Deleted: 5

1.0 STORAGE REQUIREMENTS - 62-711.530 (1)

All waste tires are stored in accordance with the ~~waste tire site requirements of 62-711.510 F.A.C.~~ and storage standards of 62-711.540 F.A.C.

Formatted: Strikethrough

(1) Technical and Operational Standards for Storage - 62-711.540(1)

(a) Signage - 62-711.540(1) (a)

A sign is posted at the entrance of the CCSWDC stating operating hours, cost of disposal and site rules. The operating hours of the WTPF are the same as the operating hours of the CCSWDC, which is 8:00 AM to 5:00 PM Monday through Saturday exclusive of the holidays of Christmas Day, New Years Day, Independence Day, and Thanksgiving Day. The cost of disposal of tires is stated as a dollar amount per ton.

(b) Use of Open Flame - 62-711.540 (1) (b)

There is absolutely no use of open flame within twenty-five (25) feet of the waste tire piles.

(c) Attendant - 62-711.540(1) (c)

An attendant is present at all times when the facility is open to the public.

(d) Fire Protection - 62-711.540 (1) (d)

A fire-safety survey is conducted annually at the WTPF, and the survey report is submitted to Florida Department of Environmental Protection (FDEP) as part of the next quarterly report. The following fire prevention, emergency response and pollution control measures are followed.

- The waste tire piles are placed in an area surrounded by an earthen berm to assure that in the event of a fire there will be no liquid runoff from the immediate area. This berm is 8 feet high with 3:1 side slopes and is properly maintained. The area within the berm is kept free of grass, underbrush, and other potentially flammable vegetation at all times.
- The Sarasota County Fire Service provides fire protection assistance. The closest operating fire station is located approximately 7¼ miles from the location of the Waste Tire Facility. The Fire Department is furnished with a key to all gates for the fence surrounding the facility and is kept informed of the location and size of the tire pile. In the event of a fire within this facility, the Operator will stop all incoming waste to the waste tire facility and the Sarasota County Fire Service will be immediately notified of the fire. The Fire Department will be notified through the Sarasota County Emergency Operator by telephone by dialing 911 on regular telephones or by dialing 4911 on phones within the Sarasota County System or by other alternate methods.
- All liquid created as a result of the fire, including water used to control the fire, melted rubber or other material and any rainfall, will be contained within the bermed area. Additional fill from the soil stockpile area will be used to close the gap in the earthen berm at the entrance to the tire facility. After the fire is extinguished and the area has cooled down, any remaining liquid will be removed from the bermed area by contracting with the hauling company contracted to haul leachate or another similar hauling company. Care shall be exercised to minimize the amount of sand or other solids collected with the liquid. Any remaining liquids will be allowed to percolate or evaporate. Any solid residues will be transported to the landfill working face and disposed.

(e) Emergency Preparedness Manual - 62-711.540(1) (e)

The emergency preparedness manual for this facility has been developed with the cooperation of the Sarasota County Fire Service. A copy of this manual is included in Appendix A. One copy of this manual is kept at the CCSWDC site and one copy at the Sarasota County Solid Waste Business Unit's office offsite.

(f) FDEP Notification - 62-711.540(1)(f)

In the event of a fire or other emergency, and within three (3) days, the Operator of the WTPF will notify the Florida Department of Environmental Protection of the facts of the fire or emergency as soon as practical. Within two weeks a full written report on the fire or emergency will be submitted to the FDEP describing the origins of the emergency, the actions that were taken to deal with the emergency, the results of the actions that were taken, and an analysis of the success or failure of the actions.

(g) Record Keeping - 62-711.540(1) (g)

The operator of the WTPF will maintain records of the number of tons of waste tires received and processed on the site. For additional details, see Section 4.0, Record Keeping and Maintenance, of this Attachment.

(h) Owner/Operator - 62-711.540(1) (h)

The associated landfill and Sarasota County Solid Waste Business Unit, or a selected qualified contractor will operate WTPF.

(i) Communication Equipment - 62-711.540 (1) (i)

A telephone is installed at the scale house and the maintenance/ administration building of the CCSWDC to facilitate contact with fire protection authorities in case of a fire.

(j) Pest Management - 62-711.540(1)(j)

The operator of the WTPF follows the directions of the Outdoor Integrated Pest Management program as set forth in Sarasota County Administrative Directive 9.02A, a copy of which is included in Appendix.

(k) Access Road - 62-711.540 (1)(k)

A paved entrance is provided from Knights Trail Road; the road ends at the landfill perimeter roadway. An all-weather access road will route traffic to the WTPF.

(2) Additional Requirements For Indoor Storage - 62-711.540(2)

The WTPF at the CCSWDC does not store any waste or processed tires indoors; therefore, the requirements of 62-711.540(2) F.A.C. are not applicable to this facility.

(3) Additional Requirements For Outdoor Storage - 62-711.540(3)

(a) Offset/Setback (62-711.540(3)(a))

The location of the WTPF, with respect to any natural or artificial body of water, including wetlands within the jurisdiction of the FDEP and bodies of water contained completely within the property boundaries of the CCSWDC which do not ordinarily discharge from the site to surface waters, is delineated on Sheet LFC-35 (see Attachment A). A permit to construct the WTPF and the associated landfill has been issued by FDEP (Permit No. SC5S-21493I). The isolated wetland located just north of the WTPF does not have to meet the 200 feet setback since it constitutes a body of water contained completely within the property boundaries of the facility which does not ordinarily discharge from the site to surface waters located adjacent. The Southwest Florida Water Management District (SWFWMD) also permits the CCSWDC; the stormwater controls as set within that permit applies to the WTPF. The drainage swales around the WTPF is designed and managed to divert stormwater or floodwaters around and away from the storage piles.

(b) Maximum Dimensions - 62-711.540 (3) (b)

The waste tires are stored in piles outdoors in the area shown on the drawing. The waste tires are collected in two piles, each in an area of 9,000 square feet separated by a fifty-foot fire lane. Tire piles are not more than 50 feet wide by 180 feet long and are not be piled more than 15 feet in height.

(c) Fire Lanes and Access to Facility - 62-711.540 (3) (c)

Access roads and the fire lanes to the waste tire piles will remain open at all times for the use of emergency vehicles. The minimum width of all fire lanes is a minimum of 50 feet. The minimum width of the access roads is 20 feet. The access roads and fire lanes are maintained as all weather roads to assure access to emergency vehicles.

(d) Fences/Barriers - 62-711.540 (3) (d)

Access to the site is controlled by the use of fences and gates. Access controls or other barriers include a locking access gate at the entrance to the CCSWDC at the scale facility.

(e) Liquid Runoff Containment - 62-711.540 (3) (e)

See Section 1.0 (1)(d), Fire Protection, of this Document.

(f) Potentially Flammable Vegetation - 62-711.540(3)02

See Section 1.0 (1)(d), Fire Protection, of this document.

(4) Temperature Monitoring And Control - 62-711.540 (4)

Processed tires ~~may shall~~ be transported to the Class I landfill immediately at the end of the processing cycle and are stockpiled near the working face for the purpose of using the processed tires for daily cover. Therefore, temperature monitoring and control at the WTPF is not required.

Formatted: Strikethrough

(5) Residuals Management - 62-711.540 (5)

Any residual waste from the processing of the tires are deposited in the landfill.

2.0 MAXIMUM STORAGE LIMITS - 62-711.530(2)

Stockpiled waste tires are processed by a shredding process by a Contractor hired by Sarasota County. A copy of the sample draft specifications for the tire shredding service and are included in Appendix C.

Stockpiled whole waste tires do not exceed 30 times the daily through-put of the processing equipment being used. The maximum storage capacity of the whole waste tires, based on two piles of 180'x 50'x 15' each, is calculated to be 650 tons. (Engineer's calculation is included in Appendix D).

The maximum daily processing through-put is 64 tons per day, based on the equipment currently being used for processing. The equipment currently being used is the Tire Shredder, serial number 9059, 480 HP, as manufactured by Columbus McKinnon Corporation, Sarasota, Florida. The anticipated annual through-put is 2,000 tons. The average daily expected through-put to the facility is 6.5 tons per day at six days per week. The storage capacity is 650 tons, which is deemed ample provided that processing is conducted at least four times per year at the anticipated annual through-put rate. It requires approximately eleven days to process 650 tons. Based on daily processing through-put of 64 tons and 30 days of processing time, 1,920 tons is allowed to be stored onsite, under this rule, which is far greater than the 650 tons of actual storage capacity available.

At the WTPF at CCSWDC, the storage of waste tires abides by the maximum limits established under this rule.

3.0 PROCESSED TIRES - 62-711.530 (3)

Each year at least 75 percent of all material received are processed and disposed of prior to the end of the year.

The storage capacity provided (650 tons) represents approximately 25 percent of the annual through-put and at least three processing sessions necessarily have to occur before the end of the year for compliance with this rule. Shredding is done at a frequency of 4 to 6 times per year.

Processed waste tires may be used as initial cover or landfilled at the CCSWDC Class I landfill. For use as initial cover, 70 percent of the waste tire material are cut into pieces of 4 square inches or less and 100 percent of the waste material is 32 square inches or less. For landfilling (disposal), a waste tire is cut into at least 8 substantially equal pieces.

4.0 RECORD KEEPING AND MAINTENANCE - 62-711.530(4)

An office is located in the maintenance facility located at CCSWDC. Records are maintained for the following information for a minimum of three years.

- The name and registration number of the waste tire collector who delivered waste tires to the facility, along with the quantity of tires delivered. Also, for individuals who are not registered, waste tire collectors who deliver more than five tires, the name, address, telephone number, and quantity of tires delivered are recorded.
- If the facility were to ship or remove waste tires for any reason, the following information will be recorded and FDEP will be notified and records maintained in accordance with this rule.
 - The name and registration number of the waste tire collector who accepted the waste tires for transport.
 - The quantity of waste tires shipped with the collector.
 - If the tires are not shipped with a waste tire collector the number of tires shipped, the person's name, address and telephone number along with the place the tires were deposited.

5.0 SUBMISSION OF REPORTS - 62-711.530(5)

Sarasota County will submit quarterly reports, by the 20th of the month following the close of each calendar quarter, to FDEP that summarizes the information collected as described in Section 4.0, Record Keeping and Maintenance, using Form 62-711.900(4). The following information will also be provided:

- Facility name, address and permit number.
- Time period covered by the report.
- Total quantity by category of waste tires received.
- Quantity of waste tires shipped from the facility, if any.
- Quantity of waste tires processed.
- Quantity of waste tires by category located at the facility on the last day of the quarter.
- A list of all dates on which one or more categories of waste tires exceeded the storage limit and how this condition was relieved or will be relieved.

6.0 PERMIT APPLICATION - 62-711.530(6)

This submittal constitutes an application for a permit to operate the WTPF at CCSWDC. Form 62-701.900(23) duly filled, signed and sealed by a professional engineer registered in Florida, is included herein.

7.0 CLOSURE - 62-711.700

Closure will commence concurrent with closure of the landfill facilities at the Central County Solid Waste Disposal Complex. The estimated life of the CCSWDC Class I Landfill is 40 years. Closure of the WTPF will include removal of all remaining processed and residual tire material and placement into the Class I landfill prior to final capping. At the time of the closure, the following activities will take place. All other closure activities will be consistent with closure procedures associated with the Class I landfill site.

- Public access to the site will be stopped by locking the entrance gate at all times except for entrance and exit of authorized personnel.
- A notice indicating the site is closed will be posted. The notice will provide the phone number of the Sarasota County Solid Waste Business Unit.
- The Sarasota County Solid Waste Business Unit will notify FDEP.
- All remaining waste tires will be processed and disposed in the CCSWDC Class I Landfill prior to implementing closure activities. All remaining residues or other materials will be placed in the landfill prior to closing this facility.
- Any solid waste will also be removed from the WTPF as described above.
- FDEP will be notified by Sarasota County when closure is complete.

8.0 CLOSING COST ESTIMATE AND FINANCIAL ASSURANCE 62-711.500(3)

Per 62-711.500(3) F.A.C., landfills which meet the financial assurance requirements of 62-701.630, F.A.C. are not required to submit separate closing cost estimates or financial assurance documents.

The requirements of 62-701.630, F.A.C. will be addressed in the annual update of financial assurance requirements for the CCSWDC to be submitted to FDEP in August.

Deleted: have been

Deleted: already

Deleted: .

APPENDIX A
STANDARD OPERATING PROCEDURES

Solid Waste Operations Division
CENTRAL COUNTY SOLID WASTE DISPOSAL
COMPLEX



STANDARD OPERATING PROCEDURES

SAFETY

Training	1
Equipment.....	1
Special Procedures.....	1
Safety Meetings	2
Safety Officer.....	2

EMERGENCY AND FIRE SAFETY

Notification: Call 911	3
Used Tire Storage Area Special Rules.....	3
List of Emergency Response Equipment.....	4
List of Emergency Response Persons.....	4
Procedure to be Followed for Cleanup	4

CONTINGENCY PLAN

Contingency Plan	5
------------------	---

SAFETY

The program shall consist of the following parts:

Training - General training of all employees will be required to develop the skills of emergency first aid and CPR. General training includes:

- Red Cross Multimedia certification is required initially upon employment and subsequently re-certification on a three-year schedule is required.
- Red Cross Cardiopulmonary Resuscitation Basic Life Support Course certification initially upon employment and subsequently on an annual basis thereafter is required.
- All employees shall be trained in the job-specific aspects of their position. This training will be provided by and is the responsibility of the employee's immediate supervisor.
- Special training shall be required for each employee on a job-specific basis. Each operator of a piece of equipment shall be trained in the operation of that piece of equipment by the immediate supervisor. This training shall be given in accordance with the manufacturer's recommendations and operating manuals. This training will be provided by and is the responsibility of the immediate supervisor in charge of the employee.

Equipment - This section shall outline the basic safety equipment to be provided to the employees of this Division.

- Uniforms shall be furnished for and shall be worn by all employees except office personnel. Special exemption from this requirement may be granted by the Director of Solid Waste Operations Division on a case-by-case basis.
- Special safety equipment such as rain gear including rubber boots, boots having steel toes and stainless steel puncture resistant soles, work gloves, goggles, dust masks, protective eye glasses, rubber gloves, face guards, hearing protection, and rubber aprons shall be utilized as part of the day-to-day operational procedures of this Division. It shall be the responsibility of each individual employee and the immediate supervisor to assure that proper safety equipment is in use. Standard operating procedures will be developed and included as a part of this program. Development of these procedures will be the responsibility of all supervisory personnel.
- All employees will be required to wear safety shoes or boots when working in an environment dictating the need for such equipment. Generally, safety shoes will be required except when working in the scalehouse or office. Safety shoes will be issued to all employees whose duties require the wearing of safety shoes.

Special Procedures - Special procedures shall consist of operational plans, which shall be prepared by the supervisor in charge of each separate operation within the Solid Waste Operations Division. Operational plans shall be prepared for the following separate functions within the Solid Waste Operations Division - office, landfill, transfer station, hazardous wastes and infectious wastes.

Safety Meetings - Safety meetings shall be held as deemed necessary by the Solid Waste Operations Division Safety Officer but no less than one meeting shall be held every other month.

Safety meetings shall be the responsibility of the Solid Waste Operations Division Safety Officer.

Safety meeting topics shall include a discussion of all incidents, which have occurred within the Division since the last safety meeting was held, along with topics of current importance and interest.

Safety Officer - the Manager of the Solid Waste Operations Division shall appoint the Solid Waste Operations Division Safety Officer. The Solid Waste Operations Division Safety Officer is Terry Foxworthy. The Solid Waste Operations Division Manager is Frank Coggins.

The position of solid -Waste Operations Division Safety Officer shall be held in conjunction with the regular duties of the position for which the person was hired. However, the Solid Waste Operations Division Safety Officer shall be given time during the regular working hours to perform the duties of the Solid Waste Operations Division Safety Officer.

EMERGENCY AND FIRE SAFETY

This section provides the standard operating procedure for all personnel in the event of an emergency or fire of any nature that may take place within the boundaries of landfill or transfer station.

Notification: CALL 911 as in any emergency, the first thing to do is to immediately notify the proper emergency response team. In the case of FIRE, immediately notify the Fire Department through the emergency phone number 911. Remember, if you are calling from a phone, which is connected to the County switchboard, you must dial 4911 to reach the emergency operator.

If the office or one of the scalehouses is open, you can contact them by radio for your emergency, and they will be able to place the necessary phone call.

Be sure to **SPEAK SLOWLY, DISTINCTLY, DELIBERATELY**, and remain as calm as possible. Briefly tell the person to whom you are reporting the emergency the following:

- the nature of the emergency;
- any injuries or persons involved; and
- where the emergency is located.

If there are injuries, you should render whatever assistance you can without endangering yourself. Use the First Aid and/or CPR training you have learned to assist where necessary. if possible, evacuate any person or equipment that may be endangered.

In the event of small fires, the use of a fire extinguisher may be sufficient to contain the fire until the arrival of the Emergency Responders. Fire extinguishers are found in every Solid Waste Operations Division vehicle and on every machine. In the event of larger fires, a 4000-gallon water tanker and the pressure washer trailer is available for fighting fires.

Upon arrival of the Emergency Responders, you should take whatever steps necessary to assist.

In the event of fire in the landfill, it may be necessary to smother the fire using available dirt from the dirt stockpiles located at the landfill. In this case, the Manager of the landfill shall make immediate provisions to provide that earth cover.

Used Tire Storage Area Special Rules - In the event there is a fire or other emergency in the used tire storage area, the following special rules shall apply:

- After following the emergency procedure outline above, the Manager shall insure that the dike around the waste tire pile is intact and that the valve of the drainpipe through the berm is closed. This shall be accomplished by patrolling the exterior of the dike and by adding earth to the dike wherever necessary to assure that no oily material generated by the combustion of the tires escapes the immediate area.

- The State of Florida, Department of Environmental Protection Regulation, shall be immediately notified by calling the Tampa office at (813) 632-7600, 813-744-6100 if fire, or another emergency, poses an unanticipated threat to the public health or environment. Within two weeks of any emergency involving potential off-site impact, a report shall be submitted to the Department including information on the emergency, the results of the action taken, and an analysis of the success or failure of the actions.
- In addition, any special conditions as set forth by the Sarasota county Fire Department shall be net.

Formatted: Strikethrough

Formatted: Strikethrough

List of Emergency Response Equipment - In the event of a fire emergency, the following equipment is available at the landfill and may be used as the situation dictates in the evolution of responding to a fire emergency, such as repair of dikes, smothering with earth and materials, and then use of water in extinguishing fires:

(2) D-6N bulldozers	4000-gallon water tanker
623-B Excavator	8-inch Mac Pump w/diesel engine
950 Endloaders	Pressure washer trailer

It should be noted that from time to time the equipment available for fire emergency use may be changed, and it should be the responsibility of the persons in charge at the facility to be aware of those changes and respond accordingly with the appropriate equipment in the event of a fire emergency.

Dry hydrant connections are available as shown on the drawings for the purpose of supplying water in the event of a fire or other emergency.

Also available at the site is an 8-inch Mac pump with hose and discharge pipe to be used and for filling the 4000-gallon tanker. Upon arrival of the fire department, this pump and water supply will be used under the direction of the officer in charge from the fire department.

Fire extinguishers are available in every vehicle and piece of equipment on the site. Although fire extinguishers are very ineffective against a large fire, it may be possible through their use to control the fire until larger equipment is brought to bar the fire.

List of Emergency Responses Persons:

	Home Phone Number
Frank Coggins	(941) 406-4667
Dan McAllister	(941) 650-2689

Deleted: Gary Bennett

Deleted: 497-3191

Deleted: Don Shaulis

Deleted: 921-2674

Procedure to be Followed for Cleanup - Any residual from a fire at the tire storage area shall be removed for proper disposal by County personnel. The County will provide all cleanup services and equipment required. All debris and contaminated soil will be placed in the landfill and all liquids will be pumped into a hauling truck for proper disposal.

CONTINGENCY PLAN

In the event an emergency should occur that would interrupt operations at the proposed facility the following procedures shall be implemented:

1. The waste collection entities operating within the County shall be notified of the operational interruption and approximate time when operations will be restored.
2. If it is anticipated that the interruption of operations will be no longer than 48 hours, an alternate disposal site shall be determined. The following alternate disposal sites are available and listed in order of preference. Should one facility also not be available the next facility on the list shall be contacted.
 - a. Manatee County Lena Road Landfill
 - b. Charlotte County Zemel Road Landfill
 - c. Waste Management Landfill in Okeechobee County

Sarasota County will develop agreements with the first three facilities listed above to provide disposal capacity on an emergency basis.

APPENDIX B
PEST MANAGEMENT PLAN

SARASOTA COUNTY GOVERNMENT

ADMINISTRATIVE DIRECTIVE

NUMBER: 9.02A

ISSUED: January 18, 1995

EFFECTIVE: January 18, 1995

SUPERSEDES: 9.02

SUBJECT:

Interdepartmental Integrated Pest Management (IPM) Program .

AUTHORITY:

Sarasota County Board of County Commissioners Resolution # 91-092, which provided for adoption of integrated pest management practices by County Government pest control programs and established an Environmental Pest Management Advisory Board.

PURPOSE:

This administrative directive sets forth the policy and procedures for County personnel involved with operations related to the management of pests and undesirable vegetation.

POLICY:

Integrated Pest Management (IPM) in Sarasota County is an approach to managing vectors/pests and undesirable vegetation that incorporates the following key ingredients:

Identification of the pest or undesirable problem, regular monitoring, determination of injury or problem levels, record keeping, selection of the least toxic strategies and techniques, and evaluation of actions taken to control or correct the problem.

County departments managing pests or vegetation will develop and implement comprehensive written integrated pest and vegetation management programs in accordance with the requirements of this policy.

Integrated pest and vegetation management programs shall include the following elements:

- 1) Goals and objectives of the Department's Program.
- 2) Description of the scope of responsibility and boundaries of the system/property to be managed.
- 3) Pesticide usage/storage procedures
- 4) Training and education requirements for personnel involved in the departmental Pest Management Program.
- 6) Recordkeeping for pesticide use/reporting
- 5) Identification of the pest or conditions causing a problem to occur. This can change seasonally.
- 7) Regular inspections of the areas or sites for potential pest/vegetation problems
- 8) Determination of when pest levels/vegetation problems are likely to require action (based on a monitoring plan). Maintain records to measure pest occurrence and determine when numbers or situations pose a problem.
- 9) Identification of ways to change these conditions to discourage recurrences of the problem.
- 9) Selection of the most environmentally sound and economically viable treatment strategies to suppress the pest problem.
- 10) Evaluation after treatment to determine if action taken has been effective worthwhile, and cost effective.

RESPONSIBILITY:

All County Government Departments are responsible for accomplishing the provisions of this Administrative Directive. The County Administrator will designate a Pest Management Coordinator who will:

- 1) Assist the departments in implementing this Directive.
- 2) Provide staff support to the Environmental Pest Management Advisory Board.
- 3) Provide support for educational programs on IPM activities.

- 4) Update IPM directives and procedures as required.
- 5) Maintain a master file of all labels and Material Safety Data Sheets (MSDS) for those pesticides being used by County departments.

PROCEDURES:

All County departments managing pests or vegetation will:

- 1) Identify an IPM coordinator(s) and alternate(s) to provide overall departmental program management. Assist the Designated County Pest Management Coordinator and the Environmental Pest Management Advisory Board in developing recommended policy.
- 2) Develop and implement comprehensive written integrated pest and vegetation management programs containing, as a minimum, the elements identified in policy section above.
- 3) Provide continuing personnel training in integrated pest and vegetation management concepts and methods. Assistance will be provided by Cooperative Extension and other qualified personnel in the County.
- 4) Modify job descriptions to assure that training and educational requirements for the applicator personnel comply with State regulations pertaining to the control of vegetation and pests and the use of pesticides.
- 5) Review plans and specifications to enhance the use of IPM procedures and decisions for the planning for modification/repair/replacement/construction of new buildings, landscapes, roads, drainage structures/systems with the objective of minimizing pest problems. Departments are encouraged to seek assistance from the IPM Working Group in this process.
- 6) Shall purchase and use non-biorational pesticides only where feasible alternatives are not available. Non-biorational pesticides are conventional broad spectrum chemical pesticides whereas biorational pesticides tend to have less negative impact on the environment and beneficial predators. Examples of biorational products include: Bacillus thuringiensis (Bt, Bti), Insecticidal oils and soaps, insect growth regulators (IGRs), insect-attacking nematodes, borate-based compounds, and insecticidal baits.
- 7) Suggest research needs to the Environmental Pest Management Advisory Board, through the County's designated Coordinator for consideration by the University of Florida.

- 8) In coordination with the County's Designated Coordinator conduct an annual evaluation of the Department's IPM program and determine where improvements should/could be made.
- 9) Will develop operational guidelines and standards for general maintenance activities, and IPM prescriptions for specific pests.
- 10) Will develop pesticide procedures for at least the following:
 - a. Procedures for public notification of pesticide applications (according to each Departments operations and State laws).
 - b. Pesticide application procedures.
 - c. Pesticide spill response procedures.
 - d. Pesticide storage procedures.
 - e. Cleaning and calibration of equipment procedures.
 - f. Storage and disposal of containers

GUIDELINES:

When using pesticides, Departments will give consideration to the selection of the least toxic material, beneficial organisms, identification of the pest, efficacy of the material, timing of application, method of application, characteristics of the treatment site, and qualifications of applicator personnel. Departments will consider the following:

- 1) Disruption of natural enemies - Become familiar with beneficial organisms. Use available charts and literature to evaluate impact of control strategies and their toxicity to specific natural enemies.
- 2) Identification - Proper identification of the pest or problem is critical to understanding its management and selection of the appropriate pesticide strategy.
- 3) Pesticide Toxicity - select effective pesticides that are the least toxic available in order to minimize threats to the applicator as well as to other non-target organisms. Use only when other control methods would not be effective or practical in maintaining the established level of service.
- 4) Efficacy - Pesticide efficacy can vary from one pest to another, one location to another, and even from one year to the next in the same location. It is

essential when pesticides have to be used to select the correct materials based upon their least toxic impact and efficacy. Good record keeping will be used to support selections.

- 5) Timing of Application - The effective use of pesticides is enhanced by regularly monitoring pest and beneficial populations to determine the optimum application time. Attack pests during the most susceptible point in their life cycle or growth period. The same holds true for undesirable vegetation. Young, actively growing weeds are usually the easiest to control, e.g., translocating herbicides designed to control weeds by moving from foliage to roots will be most effective at this time.
- 6) Rate and Method of Application - Regardless of the pest, a method of application should be chosen based on distribution of the pest relative to its environment so that adequate coverage is achieved. Proper application will maximize effectiveness and minimize need for additional sprays. The Goal - is to reduce pesticide use without compromising control.
- 7) Characteristics of Application Sites - The physical texture, mineral, and chemistry of soils and other geologic materials affect the mobility of water and soluble pesticides. In addition, the topography of the application site, its proximity to surface water, climate and wind conditions are important considerations.
- 8) Applicator requirements - Pesticides must be applied by certified personnel. To evaluate the effectiveness of pest management activities it is essential to consider the following:
 - a. Monitor the Program - Keep written records of site pest management objectives, when and where pest problems are seen, decisions made, actions taken, and effectiveness of treatment action. Data provided by the monitoring system should reflect the actual pest/vegetation problem.
 - b. Working Injury Level - Select an injury level that provides sufficient advance warning to permit taking treatment action before intolerable levels of pests or vegetation presence are reached (arrived at through monitoring).
 - c. Treatment Activities - Formal monitoring data, or other channels of communication about the pest problem should show that the pest numbers of situations have gone down or been corrected as a result of control activities. Return to the site to evaluate the success of the total treatment.

- d. Integration of the Services Rendered - Ensure that all parties involved in the pest problem understand how their actions are contributing to the overall program.
- e. Education Program - Educate County employees on the connection between their own or other causal activities and pest/vegetation problem/solution and the public as appropriate.

This Administrative Directive supercedes Sarasota County Administrative Directive No. 9.02 (Outdoor Integrated Pest Management (I.P.M.) Program)

Approved:

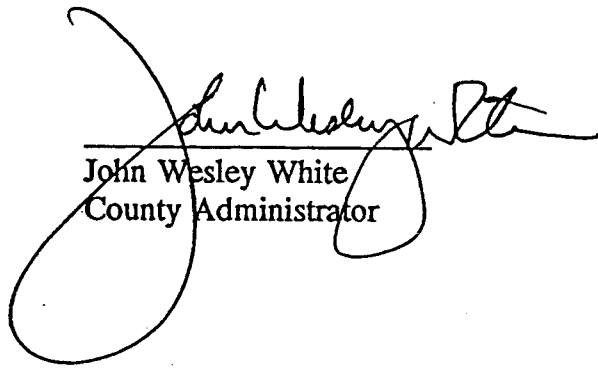

John Wesley White
County Administrator

APPENDIX C
TIRE SHEDDING BID

TECHNICAL SPECIFICATIONS FOR
TIRE SHREDDING SERVICE
FOR SARASOTA COUNTY, FLORIDA

The Contractor is to furnish all labor, materials, tools, and equipment and perform all work and services for furnishing a tire shredding service for Sarasota County Florida, as herein described.

A. DEFINITIONS:

1. The term "County" used herein throughout these specifications shall mean the Environmental Services Department, Solid Waste Operations Division of Sarasota County, Florida.

2. The term "Contractor" shall mean the person or firm which is the successful bidder and to which a contract is awarded for furnishing the tire shredding service as specified herein.

3. The term "Bee Ridge Landfill" shall mean the County's Landfill which is located at 8350 Bee Ridge Road, Sarasota County, Florida.

B. TIRE SHREDDING SERVICE: The Contractor shall furnish a tire shredding service to the County as follows:

1. The Contractor shall furnish a tire shredding service to the County a minimum of once each quarter of the fiscal year. The fiscal year shall be defined as the period from October 1 to September 30.

2. The tire shredding service to be provided by the Contractor will require the Contractor to shred all of the tires, regardless of the size or type of tire, that are stockpiled at the Bee Ridge Landfill.

3. Tires are to be shredded so that the shredded pieces can be used for daily cover, 70% of the waste tire material must be cut into pieces of 4 square inches or less and 100% of the waste tire is 32 square inches or less.

4. The unit price bid shall be the price per ton for shredding all of the tires in the tire stockpile.

5. Hours of operation of the Bee Ridge Landfill are Monday through Saturday from 8:00 A.M. to 5:00 P.M. exclusive of the days of Christmas, New Year's Day, Independence Day, and Thanksgiving Day; and the Contractor will be allowed to perform the tire shredding service only during the hours of operation described herein.

6. The exact number of tires to be shredded is unknown. However, the average tonnage of tires recorded at the scalehouse each month is approximately 108 tons.

7. The Contractor will be required to remove any rims which may be on the tires if unable to shred along with the tires. Cost of removal of the rims shall be included in the unit price for shredding of the tires. Rims that have been removed by the Contractor shall remain the property of the County and shall be stockpiled, at the direction of the County, adjacent to the tire stockpile.

8. The Contractor will be required to load the shredded tires on a suitable transport for the purpose of weighing the shredded tires on the County's scales which are located at the Bee Ridge Landfill. The net weight of tires shredded will be the basis for payment per ton of tires shredded. The Contractor shall then deposit, at the direction of the County, the shredded tires to a designated area to be used for daily cover.

9. The Contractor will be required to meet the limits set forth in F.A.C. Rule 17-711.530(2) in that the Contractor must be able to process enough tires to meet the 30 times the daily through-put of the processing equipment the Contractor will use.

10. If the Contractor is required by the County to provide the service on a more frequent basis than that as set forth in paragraph B.1. of these specifications, then the Contractor will be required to do same at the unit price bid per ton of tires shredded.

APPENDIX D
CALCULATIONS

Maximum Storage Capacity

Based on the design plans two piles of 180 ft x 50 ft x 15 ft separated by a 50' fire lane in conformance with 62-711.540(3) can be maintained.

$$\text{Area of each pile} = 180 \text{ ft} \times 50 \text{ ft} = 9000 \text{ ft}^2 < 10,000 \text{ ft}^2$$

∴ O.K.

Volume of each pile (for maximum storage) using 1:1 side slope.

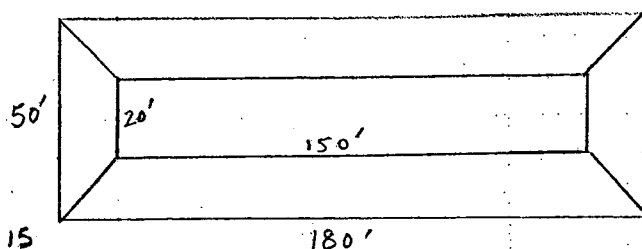

$$\text{Vol.} = \frac{(180 \times 50) + (150 \times 20)}{2} \times 15$$

$$= 90,000 \text{ ft}^3 \text{ or } 3333.33 \text{ CY}$$

PLAN (Max^m Ht = 15 ft)

$$\therefore 2 \text{ piles provide } 2 \times 3333.33 = 6667 \text{ CY of storage capacity}$$

Based on 62-711.200(7) quantity criteria - 200 lbs per cubic yard of unit weight is used to estimate tonnage.

At 200 lbs/CY, 6667 CY of storage can accommodate approximately 667 tons of whole waste tires

With safety factor Max^m storage capacity = 650 tons

Max^m Area Available = 18,000 sq. feet

SCS ENGINEERS

SHEET 1 OF 1

CLIENT	Sarasota County	PROJECT	Sarasota County Waste Tire Processing	JOB NO.	09201010.24
SUBJECT	Closure Cost Estimate	Facility		BY	MED
				CHECKED	QIB
				DATE	7/3/2007
				DATE	7/5/2007

Tonnage Limit: 650 tons (per original permit)

Processing Fee: \$113.95/ton (per Sarasota County)

Tipping Fee: \$99.00/ton (per Manatee County Landfill - out of county waste)

$$650 \text{ tons} \times (\$113.95/\text{ton} + \$99.00/\text{ton}) = \$138,417.50$$

Closure Cost Estimate for Waste Tire Processing Facility = \$138,417.50

APPENDIX E
FIRE SAFETY INSPECTION REPORT

COPY

SARASOTA COUNTY GOVERNMENT

- Dedicated to Quality Service -
FIRE SAFETY INSPECTION REPORT

6750 Bee Ridge Road
Sarasota, FL 34241
PH (941) 861-2290
FAX (941) 373-7566

DATE: Nov 15, 2006

OUTDOOR TIRE PILE

Business Name: SARASOTA COUNTY SOLID WASTE OPERATIONS

INVOICE # 9

Address: 4000 KNIGHTS TRAIL RD NOKOMI, FL

Sq Ft. N/A Fee: \$

Contact Name: DAN McALISTER PH # 650-2689

Pager/Cell #

Emergency Contact: DAN McALISTER PH # 650-2689

PH #

Bill To: 4000 KNIGHTS TRAIL

NOKOMI, FL 34275

Occupancy Type: INDUSTRIAL

Inspection Type: R RC-1 RC-2 RC-3 # STORIES

QUANTITY	ITEM	TYPE	SERVICED BY	DATE	LOCATION
<u>N/A</u>	Fire Extinguisher				
	Hood Cleaning	<u>N/A</u>			
	Hood Suppression	<u>N/A</u>			
	FDC		Obstructed Yes or No		
	Sprinkler System				
	Fire Pump	<u>N/A</u>			
<input checked="" type="checkbox"/>	Knox Box	Yes or No	Proper Keys Yes or No		
	Alarm	<u>N/A</u>			

Alarm Monitored By: _____

VIOLATIONS:

TIRE PILE IN GOOD ORDER

FAILURE TO CORRECT & PENALTIES – Pursuant to Sarasota County Code Enforcement Ordinances No. 93-006, and Chapter 162, Florida Statutes, empowered by County Ordinance 2000-052, you are notified that items noted in this report are in violation of Florida Fire Prevention Code, or Superseding Ordinances, or other County Ordinances as referenced. Failure to correct the deficiencies on the date specified can result in an affidavit or statement of violation to be filed with the Code Enforcement Special Master, charging you with the violation set out above, upon which a hearing will be held which you may attend. If the Code Enforcement Special Master finds a violation exists, penalties may be imposed in the amount of \$250.00 per day, for each day the violation exists beyond the date set for corrective action in this notice.

Fire Inspector Jim Donsen

Signature of Occupant Dan McAlister

Inspector # CF-83

Date required for compliance _____

RC-1 _____ RC-2 _____ RC-3 _____ SCFD

**SARASOTA COUNTY
BOARD OF COUNTY COMMISSIONERS
OFFICE OF THE FIRE MARSHAL**

No 4810

This document becomes a receipt
only when validated below.

CASHIER VALIDATION

NAME: SARASOTA County Solid Waste
ADDRESS: _____
BILL TO NAME: _____
ADDRESS: 4000 Knights Trail
CITY, STATE, ZIP: Nokomis, FL 34275

ALL REQUIREMENTS HAVE BEEN COMPLETED FOR:

FIRE SAFETY INSPECTION
BY: JIM DENTON CF-83 DATE: 11-15-2006

001000	Inspect - Routine	\$25 - \$300	001002	CO Inspection	
001001	Re-Inspection		001003	Tent - Permit	
				TOTAL	\$250

BACK SIDE OF
RECEIPT HAS
IMPORTANT
INFORMATION

Distribution: White - Remit Yellow - Customer Goldenrod - Inspector Pink - Inspections Admin

Attachment 2

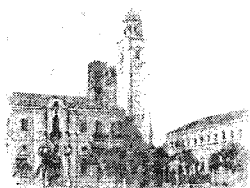

Sarasota County

KAREN E. RUSHING

Clerk of the Circuit Court and County Comptroller

2000 Main Street • P.O. Box 3079 • Sarasota, FL 34230-3079 • Phone: 941-861-7400 • www.sarasotaclerk.com

FILE COPY

10-17-06
Frank,
FYI
Gary

September 29, 2006

Mr. Chad Fetrow, Environmental Specialist
Solid Waste Section
Department of Environmental Protection
Twin Towers Office Building
2600 Blair Stone Road, MS 4565
Tallahassee, FL 32399-2400

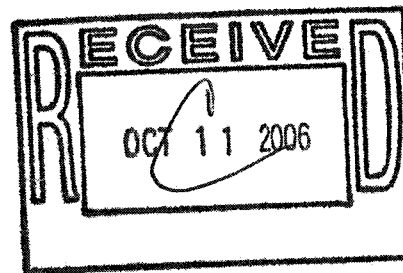

RE: WACS 00051614- Sarasota Central County Solid Waste Disposal Complex:
Class I Landfill, Materials Processing Facility (MRF) and
Waste Tire Processing Facility (WTPF)

Dear Sir:

I have been informed that you are requesting additional information in order to complete your review of the Central County Solid Waste Disposal Complex. Per your request, below is the detail of the County's closure information as of September 30, 2005.

Total Closure Closing Costs	\$38,539,327.00
Less: Waste Tire Facility	(128,520.00)
Less: Materials Recovery Facility	(849,590.00)
Required for DEP- Landfill I	<u>\$37,561,217.00</u>

Landfill's life expectancy: 40 years
Years to-date: 7 years
Remaining life: 33 years

Class I Landfill Closure	\$4,542,124.98
Waste Tire Facility	\$126,000.00
Materials Recovery Facility	\$832,931.00
Escrow Cash Balance 9/30/04	<u>\$5,501,055.98</u>

The Waste Tire Facility of \$128,520.00 and the Materials Recovery Facility of \$849,590.00 are funded at 100% since these facilities do not have a design life. Therefore, these items are removed from the 2005 landfill closure calculation for cash escrow.

Using the "Pay-In" method as prescribed in Rule 62-701.630(5)(d)(1)(a), Florida Administrative Code (F.A.C.), the amount needed to fund the landfill closure portion of the cash escrow as of September 30, 2005 is \$5,542,124.98, which is computed in the following manner:

Total Class I Landfill Closure Cost	\$37,561,217.00
Less: Current Value, Landfill Escrow	<u>(\$4,542,124.98)</u>
Unfunded Class I Landfill Cost	\$33,019,092.02
Divide: Remaining Life	33
Additional Funding Required FY05	<u>\$1,000,578.55</u>

Current Value, Landfill Escrow	\$4,542,124.98
Add: Additional Funding Required FY05	\$1,000,578.55
Landfill I closure Escrow 9/30/05	<u>\$5,542,703.53</u>

Thus, the total required cash escrow for the Sarasota County Central County Solid Waste Disposal Complex is \$6,520,813.53 comprised of the following:

Class I Landfill Closure	\$5,542,703.53
Waste Tire Facility	\$128,520.00
Materials Recovery Facility	\$849,590.00
Escrow Cash Balance 9/30/05	<u>\$6,520,813.53</u>

On the Annual Report of the Central County Landfill Management Escrow Cash issued to you as of September 30, 2005, the County had an escrow cash balance of \$6,729,930.33 which, based on this analysis, adequately meets the funding requirements of Rule 62-701.630(5)(d)(1)(a), F.A.C.

The Sarasota County Clerk of Circuit Court, Accountant to the Board of County Commissioners, has established fund 428 for the sole purpose of landfill closure and long-term care of the Central County Solid Waste Disposal Complex, in accordance with the requirements of Rule 62-701.630, F.A.C. Monies in this fund will not be used for any other purpose than landfill closure and long-term care.

Fund 428 participates in the pooled cash investment program under the direction of Sarasota County Resolution 1995-221, which established in writing the policy and procedures for the investment of County funds (see attached). Interest earned is allocated on a monthly basis to individual funds based upon their average monthly balance in the cash pool.

Accordingly, the Annual Report of the Central County Landfill Management Escrow Cash for September 30, 2006 will be issued in compliance with Rule 62-701.630, F.A.C. and will also present the required information in the manner requested by the Department of Environmental Protection.

I trust this information will be acceptable for your purposes. Please feel free to call Kelly Betz, Financial Analyst, at 941-861-5133 if you have additional questions.

Sincerely,

Karen E. Rushing
Clerk of Circuit Court

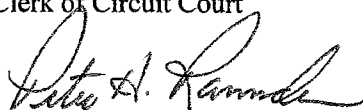

Peter H. Ramsden
Director of Finance

cc: Karen E. Rushing, Clerk of Circuit Court
Jeanette L. Phillips, Assistant Director of Finance
Kelly Betz, Senior Financial/Accounting Analyst
Gerald Bennett, General Manager of Solid Waste

Attachment 3



SARASOTA COUNTY
"Dedicated to Quality Service"

FILE COPY

June 5, 2007

Roger Evans
Environmental Engineer
Solid Waste Section
Florida Department of Environmental Protection
Southwest District Office
13051 North Telecom Parkway
Temple Terrace, FL 33637-0926

Re: Sarasota Central Waste Tire Facility
Pending Permit No.: 126775-002-WT/02
Proof of Publication

Dear Mr. Evans:

Pursuant to Rule 62-701.320 (8), F.A.C. - Proof of Publication

As requested in your letter dated May 25, 2007, attached is the "Notice of Application", Legal Notice that was published in the Sarasota Herald-Tribune on June 4, 2007.

If you have any questions, please do not hesitate to contact me directly at (941) 861-1571, Cell (941) 650-4160, or email at fcoggins@scgov.net.

Sincerely,

Frank Coggins
Manager, Solid Waste Operations

Attachment

c: Gary Bennett, General Manager, Solid Waste
Steve Morgan, FDEP Tampa
Susan Pelz, P.E., FDEP Tampa
Fred Wick, FDEP Tallahassee

K:\projects\Central County Solid Waste Disposal Complex\FDEP\Newspaper - Legal Notices\Waste Tire Facility - June 4, 2007.doc

ENVIRONMENTAL SERVICES, Solid Waste Operations • 4000 Knights Trail Road, Nokomis, FL 34275
Tel 941-861-5000 • Fax 941-486-2620

AFFIDAVIT OF PUBLICATION

SARASOTA HERALD-TRIBUNE
PUBLISHED DAILY
SARASOTA, SARASOTA COUNTY, FLORIDA

STATE OF FLORIDA
COUNTY OF SARASOTA

BEFORE THE UNDERSIGNED AUTHORITY PERSONALLY APPEARED SHARI BRICKLEY, WHO ON OATH SAID SHE IS ADVERTISING MANAGER OF THE SARASOTA HERALD-TRIBUNE, A DAILY NEWSPAPER PUBLISHED AT SARASOTA, IN SARASOTA COUNTY FLORIDA; AND CIRCULATED IN SARASOTA COUNTY DAILY; THAT THE ATTACHED COPY OF ADVERTISEMENT BEING A NOTICE IN THE MATTER OF:

State of Florida Department of Environmental Protection Notice of Application File No.: 126775-002-WT/02 The Department announces the receipt of an application for permit from Sarasota County Solid Waste Department, Mr. Paul Wingler, Project Manager, for

IN THE COURT WAS PUBLISHED IN THE SARASOTA EDITION OF SAID NEWSPAPER IN THE ISSUES OF:

6/4 1x

AFFIANT FURTHER SAYS THAT THE SAID SARASOTA HERALD-TRIBUNE IS A NEWSPAPER PUBLISHED AT SARASOTA, IN SAID SARASOTA COUNTY, FLORIDA, AND THAT THE SAID NEWSPAPER HAS THERETOFORE BEEN CONTINUOUSLY PUBLISHED IN SAID SARASOTA COUNTY, FLORIDA, EACH DAY, AND HAS BEEN ENTERED AS SECOND CLASS MAIL MATTER AT THE POST OFFICE IN SARASOTA, IN SAID SARASOTA COUNTY, FLORIDA, FOR A PERIOD OF ONE YEAR NEXT PRECEDING THE FIRST PUBLICATION OF THE ATTACHED COPY OF ADVERTISEMENT; AND AFFIANT FURTHER SAYS THAT SHE HAS NEITHER PAID NOR PROMISED ANY PERSON, FIRM OR CORPORATION ANY DISCOUNT, REBATE, COMMISSION OR REFUND FOR THE PURPOSE OF SECURING THIS ADVERTISEMENT FOR PUBLICATION IN THE SAID NEWSPAPER.

SIGNED

Shari Brickley

SWORN OR AFFIRMED TO, AND SUBSCRIBED BEFORE ME THIS 4 DAY OF June, A.D., 2007
BY SHARI BRICKLEY WHO IS PERSONALLY KNOWN TO ME.

Mariann Gusbar
Notary Public



Mariann Gusbar
My Commission DD355235
Expires November 6, 2008

My commission expires 6 day of Nov, 2008

State of Florida
Department of Environmental Protection
Notice of Application
File No.: 126775-002-WT/02

The Department announces the receipt of an application for permit from Sarasota County Solid Waste Department, Mr. Paul Wingler, Project Manager, for the operation of a waste tire processing facility, referred to as the Sarasota Central Waste Tire Facility, located at 4000 Knights Trail Road, Nokomis, Sarasota County, Florida.

This application is being processed and is available for public inspection during normal business hours, 8:00 a.m. to 5:00 p.m., Monday through Friday, except legal holidays at the Department of Environmental Protection, Southwest District office, 13051 North Telecom Parkway, Temple Terrace, Florida 33637-0928.

Published: June 4, 2007

Attachment 4

SOLID WASTE OPERATIONS CENTRAL COUNTY SOLID WASTE DISPOSAL COMPLEX TONNAGE TRACKING REPORT																
TOTAL 05/06 CODES	MATERIAL	Oct-05	Nov-05	Dec-05	Jan-06	Feb-06	Mar-06	Apr-06	May-06	Jun-06	Jul-06	Aug-06	Sep-06	GROSS TOTAL	COMML / RES FEL Adjustment	ADJUSTED TOTAL
MIXED GARBAGE	TOTAL	27,592.61	28,398.48	26,730.11	28,626.23	25,619.44	29,247.41	26,298.86	27,619.99	26,389.87	25,824.52	26,788.26	24,477.76	323,613.54	-	323,613.54
YARD WASTE	TOTAL	6,089.56	5,893.56	4,523.86	5,015.40	4,704.24	6,707.34	5,581.71	5,440.25	5,502.92	5,298.58	5,404.95	5,343.06	65,505.43	-	65,505.43
YARD WASTE	TOTAL															
TIRES	TIRES - PUBLIC	47.01	78.15	33.13	51.87	54.12	37.76	69.67	46.31	51.89	56.28	50.03	45.83	622.05		622.05
TIRES	COMM TIRES - WASTE MANAGEMENT	7.38	2.08	2.42	4.03	4.82	5.37	4.43	3.70	6.24	5.00	7.89	3.34	56.70		56.70
TIRES	G08	7.74	1.81	1.36	3.54	3.58	7.35	10.48	6.23	0.75	6.95	1.70	8.94	60.43		60.43
TIRES	MUNI TIRES - NORTH PORT AND VENICE	-	2.05	-	7.93	0.97	3.63	0.75	-	3.26	-	-	0.95	19.54		19.54
TIRES	R08	1.87	0.29	-	1.88	1.07	0.28	0.16	1.01	-	-	-	-	6.56		6.56
TIRES	RES TIRES - WASTE MANAGEMENT	3.95	1.49	1.85	2.10	5.04	3.41	4.00	1.97	2.39	5.11	3.50	5.95	40.76		40.76
TIRES	SARASOTA CITY TIRES															
TIRES	BTB															
TIRES	BIG TIRES BURIED															
TIRES	WMG	0.69	0.31	0.62	0.73	0.85	0.84	1.27	1.13	1.12	1.06	2.65	1.38	12.65		12.65
TIRES	TIRES FROM MEYER & GABBERT															
TIRES	WHOLE TIRES CURBSIDE	0.57	0.38	0.59	0.45	0.51	0.73	0.63	0.80	0.78	1.27	1.54	1.11	9.36		9.36
TIRES	WTC															
TIRES	WHOLE TIRES CURBSIDE - WASTE MANAGEMENT															
TIRES	WHOLE TIRES FROM LANDFILL															
TIRES	WTL															
TIRES	TOTAL	69.21	86.56	39.97	72.53	70.96	59.37	91.39	61.15	76.60	75.67	67.31	67.50	838.22	-	838.22
WHITE GOODS	TOTAL	149.86	143.04	167.77	154.97	134.93	139.91	122.95	127.64	151.18	115.54	120.69	145.54	1,674.02	-	1,674.02
ASBESTOS	TOTAL	2.53	1.90	2.36	12.47	75.33	7.52	23.49	18.91	24.24	19.89	6.04	10.00	204.68	-	204.68
ASBESTOS	TOTAL	1,047.95	898.73	2,380.96	1,283.16	1,206.18	1,796.42	459.74	427.08	609.91	377.50	362.07	435.42	11,285.12	-	11,285.12
ASBESTOS	TOTAL	13,292.41	16,568.63	13,688.52	14,230.03	13,134.64	16,584.65	14,507.41	16,441.48	12,714.47	13,209.35	16,299.53	14,864.72	175,535.84	-	175,535.84
ASBESTOS	TOTAL	48,244.13	51,990.90	47,533.55	49,394.79	44,945.72	54,542.62	47,085.55	50,136.50	45,469.19	44,921.05	49,048.85	45,344.00	578,456.85	-	578,456.85
ASBESTOS	GRAND TOTAL															



SARASOTA COUNTY

"Dedicated to Quality Service"

Dept. of Environmental
Protection

JUN 08 2007

Southwest District

June 5, 2007

Roger Evans
Environmental Engineer
Solid Waste Section
Florida Department of Environmental Protection
Southwest District Office
13051 North Telecom Parkway
Temple Terrace, FL 33637-0926

Re: Sarasota Central Waste Tire Facility
Pending Permit No.: 126775-002-WT/02
Proof of Publication

Dear Mr. Evans:

Pursuant to Rule 62-701.320 (8), F.A.C. - Proof of Publication

As requested in your letter dated May 25, 2007, attached is the "Notice of Application", Legal Notice that was published in the Sarasota Herald-Tribune on June 4, 2007.

If you have any questions, please do not hesitate to contact me directly at (941) 861-1571, Cell (941) 650-4160, or email at fcoggins@scgov.net.

Sincerely,

Frank Coggins
Manager, Solid Waste Operations

Attachment

c: Gary Bennett, General Manager, Solid Waste
Steve Morgan, FDEP Tampa
Susan Pelz, P.E., FDEP Tampa
Fred Wick, FDEP Tallahassee

JUN 08 2007

AFFIDAVIT OF PUBLICATION

SARASOTA HERALD-TRIBUNE
PUBLISHED DAILY
SARASOTA, SARASOTA COUNTY, FLORIDA

Southwest District

STATE OF FLORIDA
COUNTY OF SARASOTA

BEFORE THE UNDERSIGNED AUTHORITY PERSONALLY APPEARED SHARI BRICKLEY, WHO ON OATH SAID SHE IS ADVERTISING MANAGER OF THE SARASOTA HERALD-TRIBUNE, A DAILY NEWSPAPER PUBLISHED AT SARASOTA, IN SARASOTA COUNTY FLORIDA; AND CIRCULATED IN SARASOTA COUNTY DAILY; THAT THE ATTACHED COPY OF ADVERTISEMENT BEING A NOTICE IN THE MATTER OF:

State of Florida Department of Environmental Protection Notice of Application File No.: 126775-002-WT/02 The Department announces the receipt of an application for permit from Sarasota County Solid Waste Department, Mr. Paul Wingler, Project Manager, for

IN THE COURT WAS PUBLISHED IN THE SARASOTA EDITION OF SAID NEWSPAPER IN THE ISSUES OF:

6/4 1x

AFFIANT FURTHER SAYS THAT THE SAID SARASOTA HERALD-TRIBUNE IS A NEWSPAPER PUBLISHED AT SARASOTA, IN SAID SARASOTA COUNTY, FLORIDA, AND THAT THE SAID NEWSPAPER HAS THERETOFORE BEEN CONTINUOUSLY PUBLISHED IN SAID SARASOTA COUNTY, FLORIDA, EACH DAY, AND HAS BEEN ENTERED AS SECOND CLASS MAIL MATTER AT THE POST OFFICE IN SARASOTA, IN SAID SARASOTA COUNTY, FLORIDA, FOR A PERIOD OF ONE YEAR NEXT PRECEDING THE FIRST PUBLICATION OF THE ATTACHED COPY OF ADVERTISEMENT; AND AFFIANT FURTHER SAYS THAT SHE HAS NEITHER PAID NOR PROMISED ANY PERSON, FIRM OR CORPORATION ANY DISCOUNT, REBATE, COMMISSION OR REFUND FOR THE PURPOSE OF SECURING THIS ADVERTISEMENT FOR PUBLICATION IN THE SAID NEWSPAPER.

SIGNED

Shari Brickley

SWORN OR AFFIRMED TO, AND SUBSCRIBED BEFORE ME THIS 4 DAY OF June, A.D., 2007
BY SHARI BRICKLEY WHO IS PERSONALLY KNOWN TO ME.

Mariann Gusbar
Notary Public



Mariann Gusbar
My Commission DD355235
Expires November 6, 2008

My commission expires 6 day of Nov, 2008

Dept. of Environmental
Protection

JUN 08 2007

Southwest District

The Department announces the receipt of an application for permit from Sarasota County Solid Waste Department, Mr. Paul Winkler, Project Manager, for the operation of a waste tire processing facility, referred to as the Sarasota Central Waste Tire Facility, located at 4000 Knights Trail Road, Nokomis, Sarasota County, Florida.

This application is being processed and is available for public inspection during normal business hours, 8:00 a.m. to 5:00 p.m., Monday through Friday, except legal holidays at the Department of Environmental Protection, Southwest District office, 13051 North Telecom Parkway, Temple Terrace, Florida 33637-0926.

Published: June 4, 2007

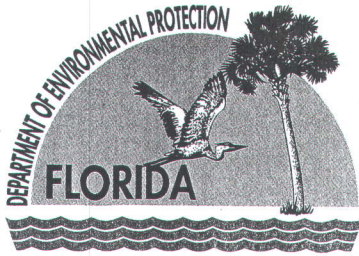

Florida Department of Environmental Protection

Southwest District Office
13051 North Telecom Parkway
Temple Terrace, Florida 33637-0926

Charlie Crist
Governor

Jeff Kottkamp
Lt. Governor

Michael W. Sole
Secretary

May 25, 2007

Mr. Paul Wingler, P.E.
Sarasota County Solid Waste Department
4000 Knights Trail Road
Nokomis, Florida 34275

Re: **Sarasota Central Waste Tire Facility**
Pending Permit No.: 126775-002-WT/02, Sarasota County
1st Request for Additional Information

Dear Mr. Wingler:

This is to acknowledge receipt of the permit application dated April 2007, (received April 26, 2007), to renew a waste tire processing facility.

This letter constitutes notice that a permit will be required for your project pursuant to Chapter(s) 403, Florida Statutes.

Your application for a permit is incomplete. Please provide the information listed below promptly. Evaluation of your proposed project will be delayed until all requested information has been received.

GENERAL:

1. The requested information and comments below do not necessarily repeat the information submitted by the applicant. However, every effort has been made to concisely refer to the section, page, drawing detail number, etc. where the information has been presented in the original submittal.

2. Please submit 4 copies of all requested information. Please specify if revised information is intended to supplement or replace previously submitted information. Please submit all revised plans and reports as a complete package. For revisions to the narrative reports, deletions may be struckthrough (~~struckthrough~~) and additions may be shaded ~~shaded~~ or similar notation method. This format will expedite the review process. Please include revision date on all revised pages.

3. Please provide a summary of all revisions to drawings, and indicate the revision on each of the applicable plan sheets. Please use a consistent numbering system for drawings. If new sheets must be added to the original plan set, please use the same numbering system with a prefix or suffix to indicate the sheet was an addition, e.g. Sheet 1A, 1B, P1-A, etc.

4. Please be advised that although some comments may not explicitly request additional information, the intent of all comments shall be to request revised calculations, narrative, technical specifications, QA documentation, plan sheets, clarification to the item, and/or other information as appropriate.

The following information is needed in support of the solid waste application [Chapter 62-711, Florida Administrative Code (F.A.C.)].

1. Please provide specific references to any previously submitted documents that you are requesting the Department to consider in support of this application. The references should specifically identify the parts of the previously submitted document in which the subject information was originally submitted (prepared by, date of preparation, date received by the Department, section, etc.) and verify that the document is located in the Department's current files **and** remains valid. Otherwise please resubmit the information and/or submit revisions to the supporting information, as appropriate.

2. **Rule 62-711.530(6), F.A.C. Application Form #62-701.900(23):** Please address the following comments regarding the permit application form and provide the appropriate application form with the revised information, where applicable:

a. This application is for the operation renewal of a 'Waste Tire Processing Facility Permit Application' but the application provided (Form #62-701.900(25)) to the Department is for a 'Waste Tire Collection Center Permit Application.' Please provide the correct application form.

b. Part I.B.7 - Facility Location Coordinates: The Section, Township and Range appear to be incorrectly identified. Please provide a revised application form that identifies the correct Section, Township and Range for the facility.

c. Part I.C - Land Owner Information: This part of the application form was identified as not applicable. Please identify if the landowner is the same as the applicant.

d. Part IV - Certification: Please provide a letter of authorization for Paul Wingler from the County Solid Waste Department Director.

3. **Rule 62-701.320(8), F.A.C. Proof of Publication:** Please publish the attached Notice of Application and provide proof of publication to the Department.

Rule 62-711.530, F.A.C. Operations Plan:

Please provide the following additional information and revisions to the Operations Plan.

4. A copy of Figure G-5 was not included with the documentation. Please provide the Figure G-5 of Attachment A. See Comment #1.

5. Please provide documentation to support that the Waste Tire Processing Facility currently receives approximately 500 tons of tires per year.

6. Storage Requirements, Section 1.0: Please clarify what is meant by, "All waste tires are stored in accordance with the waste tire site requirements of 62-711.510 F.A.C. and storage standards of 62-711.540 F.A.C."

7. Fire Protection, Section 1.0(1)(d):

a. Please provide a copy of the most recent fire-safety survey.

b. Please include a general statement in this section that in the event of a facility fire the Operator will stop all incoming waste to the waste tire facility.

- c. Please clarify if the Waste Tire Processing Facility has had any fires during the past five year permit cycle.
8. Emergency Preparedness Manual, Section 1.0(1)(e): The text indicates that a copy of the Emergency Preparedness Manual is included in Appendix A. Please submit a copy of this manual. See Comment #1.
9. Emergency Preparedness Manual, Section 1.0(4): Please explain where processed tires are taken if they are not transported to the Class I landfill. If the processed tires are indeed taken to the Class I landfill, please modify the language to specify "Processed tires shall be transported to the Class I landfill..."
10. Maximum Storage Limits, Section 2.0: The text indicates that the Engineer's calculation is included in Appendix D. Please submit a copy of the Engineer's calculation. See Comment #1.
11. Permit Application, Section 6.0: The application Form 62-701.900(23), signed and sealed by a professional engineer registered in Florida, was not included in the submittal. See Comment #2a.
12. Closing Cost Estimate and Financial Assurance - Section 8.0: The closure cost included as a line item "Site Specific Cost" in the CCSWDC facility financial assurance cost estimates is based on information provided as part of the waste tire processing permit application. Cost estimates provided as part of a permit renewal shall be revised cost estimates, including information and calculations to support quantities provided and current third-party quotes to support unit costs provided. Revised cost estimates cannot be based on inflation adjustment of previously approved costs. Please provide revised closure cost estimates for this waste tire processing facility. You may contact Mr. Steve Morgan at (813)632-7600, ext. 385, to discuss this item.
- Standard Operating Procedures:**
Please provide the following additional information and revisions to the Standard Operating Procedures.
13. Safety:
- a. Safety Officer: Please update the names of the Solid Waste Operations Division Safety Officer and the Solid Waste Operations Division Manager.
14. Emergency and Fire Safety:
- a. Used Tire Storage Area Special Rules: Please change the name of the agency from Department of Environmental Regulation to Department of Environmental Protection.
- b. Used Tire Storage Area Special Rules: Please correct the telephone number for the FDEP Tampa Office to reflect the telephone number of (813)632-7600.
15. Site Plans: Please provide specific references to any previous submitted drawings that remain valid or provide the Department with current record drawings which are signed and sealed by a registered professional engineer or land surveyor as appropriate. See Comment #1.

Please **respond within 45 days** after you receive this letter, responding to all of the information requests and indicating when a response to any unanswered questions will be submitted. If the response will require longer than 45 days to develop, you should develop a specific time table for the submission of the requested information for Department review and consideration. Pursuant to the provisions of Rule 62-4.055(1), F.A.C., if the Department does not receive a timely, complete response to this request for information the Department may issue a final order denying your application. A denial for lack of information or response will be unbiased as to the merits of the application. The applicant may reapply as soon as the requested information is available.

You are requested to submit your response to this letter as one complete package. If there are points that must be discussed and resolved, please contact me at (813) 632-7600 ext. 382.

Sincerely,



Roger Evans
Environmental Engineer
Solid Waste Section
Southwest District

Attachment

cc: Frank Coggins, Director, Sarasota County Solid Waste Department, 4000 Knights Trail Road,
Nokomis, Florida 34275
Fred Wick, FDEP Tallahassee
Susan Pelz, P.E., FDEP Tampa
Steve Morgan, FDEP Tampa

62-110.106 (6) Public Notice of Application and Proposed Agency Action
Publication of a notice of application shall be required for those projects that, because of their size, potential effect on the environment or natural resources, controversial nature, or location, are reasonably expected by the Department to result in a heightened public concern or likelihood of request for administrative proceedings. If required, the notice shall be published by the applicant one time only within fourteen days after a complete application is filed and shall contain the name of the applicant, a brief description of the project and its location, the location of the application file, and the times when it is available for public inspection. The notice shall be prepared by the Department and shall comply with the following format:

State of Florida
Department of Environmental Protection
Notice of Application
File No.: 126775-002-WT/02

The Department announces the receipt of an application for permit from Sarasota County Solid Waste Department, Mr. Paul Wingler, Project Manager, for operation of a waste tire processing facility, referred to as the Sarasota Central Waste Tire Facility, located at 4000 Knights Trail Road, Nokomis, Sarasota County, Florida.

This application is being processed and is available for public inspection during normal business hours, 8:00 a.m. to 5:00 p.m. Monday through Friday, except legal holidays, at the Department of Environmental Protection, Southwest District Office, 13051 North Telecom Parkway, Temple Terrace, Florida 33637-0926.



SARASOTA COUNTY

"Dedicated to Quality Service"

April 24, 2007

Susan Pelz, PE
Florida Department of Environmental Protection
Southwest District Office
13051 N. Telcom Parkway
Temple Terrace, FL 33637-0926

Dept. of Environmental
Protection

APR 26 2007

Southwest District

Re: Central County Solid Waste Disposal Complex
Waste Tire Permit
No.: 126775-001-WT

Dear Ms. Pelz:

The enclosed materials and check (#00918351) in the amount of \$1,250.00 are submitted for your review toward the renewal of our Waste Tire Permit.

At present it is the intent of the operation that the ground tires are utilized on-site in connection with our cover material and as a drainage layer at various locations.

Sincerely,

Paul A. Wingler

Paul A. Wingler, PE
Project Manager

Enclosures

Cc: Steve Morgan, FDEP

C



Department of Environmental Protection

Form # 62-701.900(25)
Waste Tire Collection Center
Form Title Permit Application
Effective Date 3/22/00
DEP Application No. _____
(Filled in by DEP)

Dept. of Environmental
Protection

APR 26 2007

Waste Tire Collection Center Permit Application

A Waste Tire Collection Center Permit allows up to 1,500 waste tires to be stored at the facility at any on time. If this quantity is exceeded, a Waste Tire Processing Facility Permit is required.

Permit No. 126775-001-WT

Southwest District

Renewal ☒ Modification ☐ Existing unpermitted facility ☐ Proposed new facility ☐

Part I-General Information:

A. Applicant Information:

1. Applicant Name: Central County Solid Waste Disposal Complex
2. Applicant Street Address: 4000 Knights Trail Road
3. City: Nokomis County: Sarasota Zip: 34275
4. Applicant Mailing Address: 4000 Knights Trail Road
5. City: Nokomis County: Sarasota Zip: 34275
6. Contact person: Paul A. Wingler, PE Phone: (941) 861-1578 FEID No: _____
7. Have any enforcement actions been taken by the Department against the applicant relating to the operation of any solid waste management facility in this state? This includes any Complaint, Notice of Violation, or revocation of a permit or registration, as well as any Consent Order in which a violation of Department rules is admitted. It does not include a Warning Letter, Warning Notice, Notice of Noncompliance, or other similar document which does not constitute agency action.
Yes _____ No X If yes, attach a history and description of the enforcement actions.

B. Facility Information:

1. Facility Name: Central County Solid Waste Disposal Complex
2. Facility Street Address (Main Entrance): 4000 Knights Trail Road
3. City: Nokomis County: Sarasota Zip: 34275
4. Facility Mailing Address: Same as above
5. City: _____ State: _____ Zip: _____
6. Contact Person: Paul Wingler, PE Phone: (941) 861-1578

Facility Location Coordinates:

7. Section: 1-4 Township: 9-16 Range: 385/19E
8. Latitude: 27 11' 58" N Longitude: 82 23' 02 W
9. Anticipated date for starting construction n/a and for completion of construction n/a
10. Anticipated date for receipt of tires open since 1998

Mail completed form to
appropriate district office listed below

Northwest District
160 Governmental Center
Pensacola, FL 32501-5794
850-595-8360

Northeast District
7825 Baymeadows Way, Ste. 200 B
Jacksonville, FL 32256-7590
904-448-4300

Central District
3319 Maguire Blvd., Ste. 232
Orlando, FL 32803-3767
407-894-7555

Southwest District
3804 Coconut Palm Dr.
Tampa, FL 33619
813-744-6100

South District
2295 Victoria Ave., Ste. 364
Fort Myers, FL 33902-2549
941-332-6975

Southeast District
400 North Congress Ave.
West Palm Beach, FL 33401
561-681-6600

DEP	# 62-701.900(25)
Waste Tire Collection Center	
Form Title	Permit Application
Effective Date	3/22/00
DEP Application No.	(Filled in by DEP)

C. Land Owner Information (if different from applicant):

- Owner's name: n/a
- Land owner's mailing address: _____
- City: _____ State: _____ Zip: _____
- Authorized Agent: _____ Agent's phone: () _____
- Current lease expires: _____

D. Facility Operator Information (if different from applicant):

- Operator's name: _____
- Operator's mailing address: _____
- City: _____ State: _____ Zip: _____
- Contact person: _____ Phone: () _____

E. Preparer of Application:

- Name of person preparing application: Paul A. Wingler, PE
- Mailing address: 4000 Knights Trail Road
- City: Nokomis State: Florida Zip: 34275
- Phone: (941) 861-1578
- Affiliation with facility: Project Manager

Part II Operations:

A. Describe the general operation of the collection center _____
Tires come in voer scale and to some degree are picked from the MSW

B. Describe how and where the waste tires will be used, sold, or disposed of _____
Tires are ground and the segments used for cover drainage layer

DEP Form # 62-701.900(25)
Waste Tire Collection Center
Form Title <u>Permit Application</u>
Effective Date <u>3/22/00</u>
DEP Application No. _____ (Filled in by DEP)

Part III-Attachments:

Please attach the following information to this application:

- A. A plot plan of the collection center showing:
 - 1. Boundaries of the area being permitted, easements, and rights of way.
 - 2. All wetlands and water bodies in or within 200 feet of this area
 - 3. The waste tire storage area.
 - 4. All structures including buildings, fences, roadways, stormwater control devices, and water wells.
- B. A copy of a fire safety survey of the collection center
- C. A copy of the emergency preparedness manual.
- D. A letter from the landowner (if different from applicant) authorizing the use of the land as a waste tire collection center.
- E. A check for the application fee.

NOTE: The record keeping requirements of 62-711.400(5) apply to collection centers. However, reports to the Department are not required.

Part IV Certification:

To the best of my knowledge and belief, I certify the information provided in this application is true, accurate, and correct. I have attached all documents and/or authorizations that are required.

<u>Paul A. Wingler, PE</u> Print Name of Authorized Agent	<u>Paul Wingler</u> Signature of Authorized Agent	<u>4/20/07</u> Date
--	--	------------------------

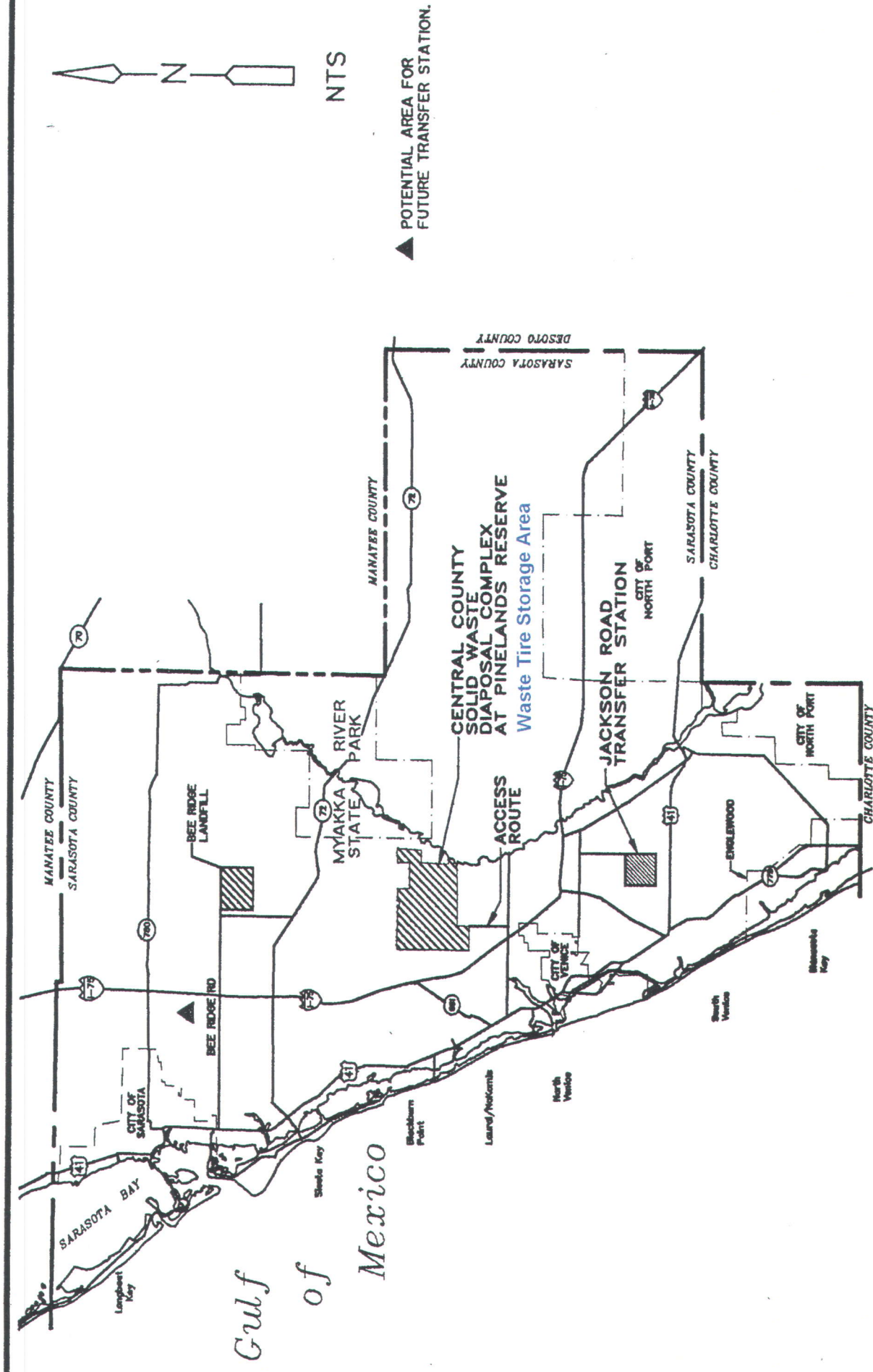

Location Map - Sarasota County Solid Waste Facilities



CELL 5

EXISTING CLASS I LANDFILL
(CELLS 1 THROUGH 4)

WASTE TIRE
STORAGE AREA

MAINTENANCE
AREA

SCALE HOUSE

ENTRANCE
ROAD

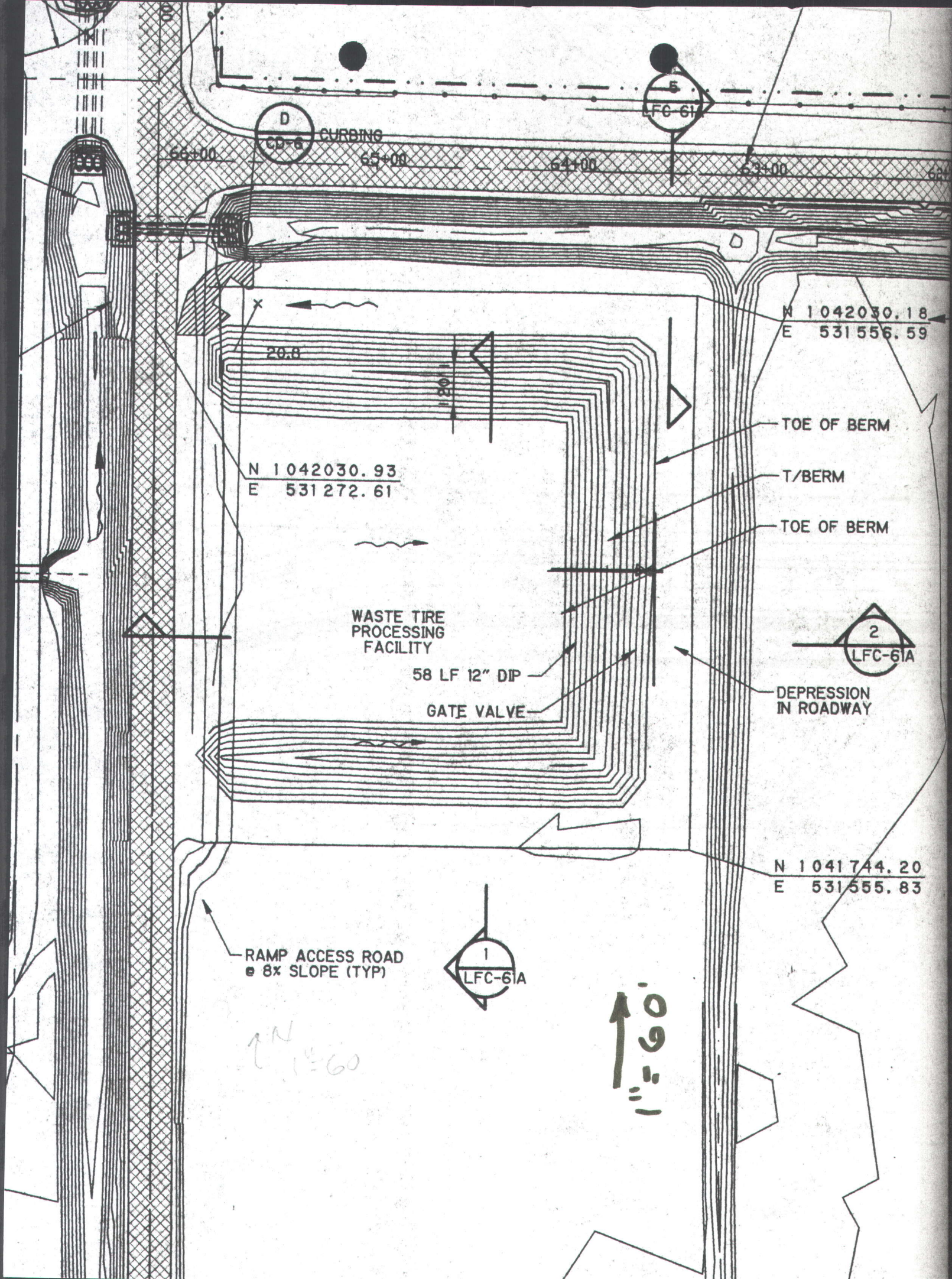

WASTE TIRE PROCESSING FACILITY OPERATION

Dept. of Environmental
Protection

APR 29 1985

Southwest District

WASTE TIRE PROCESSING FACILITY OPERATION

The Waste Tire Processing Facility (WTPF) is located, as shown on Figure G-5 of Attachment A. The facility is located within the confines of the Central County Solid Waste Disposal Complex (CCSWDC), which is located at the north end of Knights Trail Road in Sarasota County, Florida. The Solid Waste Business Unit of Sarasota County, or a selected qualified contractor, will operate the associated landfill and the WTPF.

The Waste Tire Processing Facility is for the use and convenience of the residents and businesses of Sarasota County and is not intended for use by any other persons. The purpose of this facility is for temporary storage and shredding (processing) of waste tires. Waste tires are received as other wastes being delivered to the CCSWDC. The tires are weighed using the truck scales, and a fee is charged according to the current Rate Resolution as enacted by the Board of County Commissioners of Sarasota County, Florida. Persons delivering waste tires to the facility are directed to the storage area, and the tires are piled as set forth herein.

The WTPF at CCSWDC receives approximately 500 tons of tires per year. The operation of the facility is carried out in conformance with the requirements of 62-711.530 F.A.C.

1.0 STORAGE REQUIREMENTS - 62-711.530 (1)

All waste tires are stored in accordance with the waste tire site requirements of 62-711.510 F.A.C. and storage standards of 62-711.540 F.A.C.

(1) Technical and Operational Standards for Storage - 62-711.540(1)

(a) Signage - 62-711.540(1) (a)

A sign is posted at the entrance of the CCSWDC stating operating hours, cost of disposal and site rules. The operating hours of the WTPF are the same as the operating hours of the CCSWDC, which is 8:00 AM to 5:00 PM Monday through Saturday exclusive of the holidays of Christmas Day, New Years Day, Independence Day, and Thanksgiving Day. The cost of disposal of tires is stated as a dollar amount per ton.

(b) Use of Open Flame - 62-711.540 (1) (b)

There is absolutely no use of open flame within twenty-five (25) feet of the waste tire piles.

(c) Attendant - 62-711.540(1) (c)

An attendant is present at all times when the facility is open to the public.

(d) Fire Protection - 62-711.540 (1) (d)

A fire-safety survey is conducted annually at the WTPF, and the survey report is submitted to Florida Department of Environmental Protection (FDEP) as part of the next quarterly report. The following fire prevention, emergency response and pollution control measures are followed.

- The waste tire piles are placed in an area surrounded by an earthen berm to assure that in the event of a fire there will be no liquid runoff from the immediate area. This berm is 8 feet high with 3:1 side slopes and is properly maintained. The area within the berm is kept free of grass, underbrush, and other potentially flammable vegetation at all times.
- The Sarasota County Fire Service provides fire protection assistance. The closest operating fire station is located approximately 7¼ miles from the location of the Waste Tire Facility. The Fire Department is furnished with a key to all gates for the fence surrounding the facility and is kept informed of the location and size of the tire pile. In the event of a fire within this facility the Sarasota County Fire Service will be immediately notified of the fire. The Fire Department will be notified through the Sarasota County Emergency Operator by telephone by dialing 911 on regular telephones or by dialing 4911 on phones within the Sarasota County System or by other alternate methods.
- All liquid created as a result of the fire, including water used to control the fire, melted rubber or other material and any rainfall, will be contained within the bermed area. Additional fill from the soil stockpile area will be used to close the gap in the earthen berm at the entrance to the tire facility. After the fire is extinguished and the area has cooled down, any remaining liquid will be removed from the bermed area by contracting with the hauling company contracted to haul leachate or another similar hauling company. Care shall be exercised to minimize the amount of sand or other solids collected with the liquid. Any remaining liquids will be allowed to percolate or evaporate. Any solid residues will be transported to the landfill working face and disposed.

(e) Emergency Preparedness Manual - 62-711.540(1) (e)

The emergency preparedness manual for this facility has been developed with the cooperation of the Sarasota County Fire Service. A copy of this manual is included in Appendix A. One copy of this manual is kept at the CCSWDC site and one copy at the Sarasota County Solid Waste Business Unit's office offsite.

(f) FDEP Notification - 62-711.540(1)(f)

In the event of a fire or other emergency, and within three (3) days, the Operator

of the WTPF will notify the Florida Department of Environmental Protection of the facts of the fire or emergency as soon as practical. Within two weeks a full written report on the fire or emergency will be submitted to the FDEP describing the origins of the emergency, the actions that were taken to deal with the emergency, the results of the actions that were taken, and an analysis of the success or failure of the actions.

(g) Record Keeping - 62-711.540(1) (g)

The operator of the WTPF will maintain records of the number of tons of waste tires received and processed on the site. For additional details, see Section 4.0, Record Keeping and Maintenance, of this Attachment.

(h) Owner/Operator - 62-711.540(1) (h)

The associated landfill and Sarasota County Solid Waste Business Unit, or a selected qualified contractor will operate WTPF.

(i) Communication Equipment - 62-711.540 (1) (i)

A telephone is installed at the scale house and the maintenance/ administration building of the CCSWDC to facilitate contact with fire protection authorities in case of a fire.

(j) Pest Management - 62-711.540(1)(j)

The operator of the WTPF follows the directions of the Outdoor Integrated Pest Management program as set forth in Sarasota County Administrative Directive 9.02A, a copy of which is included in Appendix.

(k) Access Road - 62-711.540 (1)(k)

A paved entrance is provided from Knights Trail Road; the road ends at the landfill perimeter roadway. An all-weather access road will route traffic to the WTPF.

(2) Additional Requirements For Indoor Storage - 62-711.540(2)

The WTPF at the CCSWDC does not store any waste or processed tires indoors; therefore, the requirements of 62-711.540(2) F.A.C. are not applicable to this facility.

(3) Additional Requirements For Outdoor Storage - 62-711.540(3)

(a) Offset/Setback (62-71 1.540(3)(a))

The location of the WTPF, with respect to any natural or artificial body of water,

including wetlands within the jurisdiction of the FDEP and bodies of water contained completely within the property boundaries of the CCSWDC which do not ordinarily discharge from the site to surface waters, is delineated on Sheet LFC-35 (see Attachment A). A permit to construct the WTPF and the associated landfill has been issued by FDEP (Permit No. SC5S-21493I). The isolated wetland located just north of the WTPF does not have to meet the 200 foot setback since it constitutes a body of water contained completely within the property boundaries of the facility which does not ordinarily discharge from the site to surface waters located adjacent. The Southwest Florida Water Management District (SWFWMD) also permits the CCSWDC; the stormwater controls as set within that permit applies to the WTPF. The drainage swales around the WTPF is designed and managed to divert stormwater or floodwaters around and away from the storage piles.

(b) Maximum Dimensions - 62-711.540 (3) (b)

The waste tires are stored in piles outdoors in the area shown on the drawing. The waste tires are collected in two piles, each in an area of 9,000 square feet separated by a fifty-foot fire lane. Tire piles are not more than 50 feet wide by 180 feet long and are not be piled more than 15 feet in height.

(c) Fire Lanes and Access to Facility - 62-711.540 (3) (c)

Access roads and the fire lanes to the waste tire piles will remain open at all times for the use of emergency vehicles. The minimum width of all fire lanes is a minimum of 50 feet. The minimum width of the access roads is 20 feet. The access roads and fire lanes are maintained as all weather roads to assure access to emergency vehicles.

(d) Fences/Barriers - 62-711.540 (3) (d)

Access to the site is controlled by the use of fences and gates. Access controls or other barriers include a locking access gate at the entrance to the CCSWDC at the scale facility.

(e) Liquid Runoff Containment - 62-711.540 (3) (e)

See Section 1.0 (1)(d), Fire Protection, of this Document.

(f) Potentially Flammable Vegetation - 62-711.540(3)02

See Section 1.0 (1)(d), Fire Protection, of this document.

(4) Temperature Monitoring And Control - 62-711.540 (4)

Processed tires may be transported to the Class I landfill immediately at the end of the

processing cycle and are stockpiled near the working face for the purpose of using the processed tires for daily cover. Therefore, temperature monitoring and control at the WTPF is not required.

(5) Residuals Management - 62-711.540 (5)

Any residual waste from the processing of the tires are deposited in the landfill.

2.0 MAXIMUM STORAGE LIMITS - 62-711.530(2)

Stockpiled waste tires are processed by a shredding process by a Contractor hired by Sarasota County. A copy of the sample draft specifications for the tire shredding service and are included in Appendix C.

Stockpiled whole waste tires do not exceed 30 times the daily through-put of the processing equipment being used. The maximum storage capacity of the whole waste tires, based on two piles of 180'x 50'x 15' each, is calculated to be 650 tons. (Engineer's calculation is included in Appendix D).

The maximum daily processing through-put is 64 tons per day, based on the equipment currently being used for processing. The equipment currently being used is the Tire Shredder, serial number 9059, 480 HP, as manufactured by Columbus McKinnon Corporation, Sarasota, Florida. The anticipated annual through-put is 2,000 tons. The average daily expected through-put to the facility is 6.5 tons per day at six days per week. The storage capacity is 650 tons, which is deemed ample provided that processing is conducted at least four times per year at the anticipated annual through-put rate. It requires approximately eleven days to process 650 tons. Based on daily processing through-put of 64 tons and 30 days of processing time, 1,920 tons is allowed to be stored onsite, under this rule, which is far greater than the 650 tons of actual storage capacity available.

At the WTPF at CCSWDC, the storage of waste tires abides by the maximum limits established under this rule.

3.0 PROCESSED TIRES - 62-711.530 (3)

Each year at least 75 percent of all material received are processed and disposed of prior to the end of the year.

The storage capacity provided (650 tons) represents approximately 25 percent of the annual through-put and at least three processing sessions necessarily have to occur before the end of the year for compliance with this rule. Shredding is done at a frequency of 4 to 6 times per year.

Processed waste tires may be used as initial cover or landfilled at the CCSWDC Class I landfill. For use as initial cover, 70 percent of the waste tire material are cut into pieces of 4 square inches or less and 100 percent of the waste material is 32 square inches or less. For landfilling (disposal), a waste tire is cut into at least 8 substantially equal pieces.

4.0 RECORD KEEPING AND MAINTENANCE - 62-711.530(4)

An office is located in the maintenance facility located at CCSWDC. Records are maintained for the following information for a minimum of three years.

- The name and registration number of the waste tire collector who delivered waste tires to the facility, along with the quantity of tires delivered. Also, for individuals who are not registered, waste tire collectors who deliver more than five tires, the name, address, telephone number, and quantity of tires delivered are recorded.
- If the facility were to ship or remove waste tires for any reason, the following information will be recorded and FDEP will be notified and records maintained in accordance with this rule.
 - The name and registration number of the waste tire collector who accepted the waste tires for transport.
 - The quantity of waste tires shipped with the collector.
 - If the tires are not shipped with a waste tire collector the number of tires shipped, the person's name, address and telephone number along with the place the tires were deposited.

5.0 SUBMISSION OF REPORTS - 62-711.530(5)

Sarasota County will submit quarterly reports, by the 20th of the month following the close of each calendar quarter, to FDEP that summarizes the information collected as described in Section 4.0, Record Keeping and Maintenance, using Form 62-711.900(4). The following information will also be provided:

- Facility name, address and permit number.
- Time period covered by the report.
- Total quantity by category of waste tires received.
- Quantity of waste tires shipped from the facility, if any.
- Quantity of waste tires processed.
- Quantity of waste tires by category located at the facility on the last day of the quarter.
- A list of all dates on which one or more categories of waste tires exceeded the storage limit and how this condition was relieved or will be relieved.

6.0 PERMIT APPLICATION - 62-711.530(6)

This submittal constitutes an application for a permit to operate the WTPF at CCSWDC. Form 62-701.900(23) duly filled, signed and sealed by a professional engineer registered in Florida, is included herein.

7.0 CLOSURE - 62-711.700

Closure will commence concurrent with closure of the landfill facilities at the Central County Solid Waste Disposal Complex. The estimated life of the CCSWDC Class I Landfill is 40 years. Closure of the WTPF will include removal of all remaining processed and residual tire material and placement into the Class I landfill prior to final capping. At the time of the closure, the following activities will take place. All other closure activities will be consistent with closure procedures associated with the Class I landfill site.

- Public access to the site will be stopped by locking the entrance gate at all times except for entrance and exit of authorized personnel.
- A notice indicating the site is closed will be posted. The notice will provide the phone number of the Sarasota County Solid Waste Business Unit.
- The Sarasota County Solid Waste Business Unit will notify FDEP.
- All remaining waste tires will be processed and disposed in the CCSWDC Class I Landfill prior to implementing closure activities. All remaining residues or other materials will be placed in the landfill prior to closing this facility.
- Any solid waste will also be removed from the WTPF as described above.
- FDEP will be notified by Sarasota County when closure is complete.

8.0 CLOSING COST ESTIMATE AND FINANCIAL ASSURANCE 62-711.500(3)

Per 62-711.500(3) F.A.C., landfills which meet the financial assurance requirements of 62-701.630, F.A.C. are not required to submit separate closing cost estimates or financial assurance documents.

The requirements of 62-701.630, F.A.C. have been addressed in the annual update of financial assurance requirements for the CCSWDC already submitted to FDEP.

STANDARD OPERATING PROCEDURES

SAFETY

Training	1
Equipment.....	1
Special Procedures.....	1
Safety Meetings	2
Safety Officer	2

EMERGENCY AND FIRE SAFETY

Notification: Call 911	3
Used Tire Storage Area Special Rules	3
List of Emergency Response Equipment.....	4
List of Emergency Response Persons.....	4
Procedure to be Followed for Cleanup	4

SAFETY

The program shall consist of the following parts:

Training - General training of all employees will be required to develop the skills of emergency first aid and CPR. General training includes:

- Red Cross Multimedia certification is required initially upon employment and subsequently re-certification on a three-year schedule is required.
- Red Cross Cardiopulmonary Resuscitation Basic Life Support Course certification initially upon employment and subsequently on an annual basis thereafter is required.
- All employees shall be trained in the job-specific aspects of their position. This training will be provided by and is the responsibility of the employee's immediate supervisor.
- Special training shall be required for each employee on a job-specific basis. Each operator of a piece of equipment shall be trained in the operation of that piece of equipment by the immediate supervisor. This training shall be given in accordance with the manufacturer's recommendations and operating manuals. This training will be provided by and is the responsibility of the immediate supervisor in charge of the employee.

Equipment - This section shall outline the basic safety equipment to be provided to the employees of this Division.

- Uniforms shall be furnished for and shall be worn by all employees except office personnel. Special exemption from this requirement may be granted by the Director of Solid Waste Operations Division on a case-by-case basis.
- Special safety equipment such as rain gear including rubber boots, boots having steel toes and stainless steel puncture resistant soles, work gloves, goggles, dust masks, protective eye glasses, rubber gloves, face guards, hearing protection, and rubber aprons shall be utilized as part of the day-to-day operational procedures of this Division. It shall be the responsibility of each individual employee and the immediate supervisor to assure that proper safety equipment is in use. Standard operating procedures will be developed and included as a part of this program. Development of these procedures will be the responsibility of all supervisory personnel.
- All employees will be required to wear safety shoes or boots when working in an environment dictating the need for such equipment. Generally, safety shoes will be required except when working in the scalehouse or office. Safety shoes will be issued to all employees whose duties require the wearing of safety shoes.

Special Procedures - Special procedures shall consist of operational plans, which shall be prepared by the supervisor in charge of each separate operation within the Solid Waste

Operations Division. Operational plans shall be prepared for the following separate functions within the Solid Waste Operations Division - office, landfill, transfer station, hazardous wastes and infectious wastes.

Safety Meetings - Safety meetings shall be held as deemed necessary by the Solid Waste Operations Division Safety Officer but no less than one meeting shall be held every other month.

Safety meetings shall be the responsibility of the Solid Waste Operations Division Safety Officer.

Safety meeting topics shall include a discussion of all incidents, which have occurred within the Division since the last safety meeting was held, along with topics of current importance and interest.

Safety Officer - the Manager of the Solid Waste Operations Division shall appoint the Solid Waste Operations Division Safety Officer. The Solid Waste Operations Division Safety Officer is Terry Foxworthy. The Solid Waste Operations Division Manager is Gary Bennet.

The position of solid -Waste Operations Division Safety Officer shall be held in conjunction with the regular duties of the position for which the person was hired. However, the Solid Waste Operations Division Safety Officer shall be given time during the regular working hours to perform the duties of the Solid Waste Operations Division Safety Officer.

EMERGENCY AND FIRE SAFETY

This section provides the standard operating procedure for all personnel in the event of an emergency or fire of any nature that may take place within the boundaries of landfill or transfer station.

Notification: CALL 911 as in any emergency, the first thing to do is to immediately notify the proper emergency response team. In the case of FIRE, immediately notify the Fire Department through the emergency phone number 911. Remember, if you are calling from a phone, which is connected to the County switchboard, you must dial 4911 to reach the emergency operator.

If the office or one of the scalehouses is open, you can contact them by radio for your emergency, and they will be able to place the necessary phone call.

Be sure to SPEAK SLOWLY, DISTINCTLY, DELIBERATELY, and remain as calm as possible. Briefly tell the person to whom you are reporting the emergency the following:

- the nature of the emergency;
- any injuries or persons involved; and
- where the emergency is located.

If there are injuries, you should render whatever assistance you can without endangering yourself. Use the First Aid and/or CPR training you have learned to assist where necessary. if possible, evacuate any person or equipment that may be endangered.

In the event of small fires, the use of a fire extinguisher may be sufficient to contain the fire until the arrival of the Emergency Responders. Fire extinguishers are found in every Solid Waste Operations Division vehicle and on every machine. In the event of larger fires, a 4000-gallon water tanker and the pressure washer trailer is available for fighting fires.

Upon arrival of the Emergency Responders, you should take whatever steps necessary to assist.

In the event of fire in the landfill, it may be necessary to smother the fire using available dirt from the dirt stockpiles located at the landfill. In this case, the Manager of the landfill shall make immediate provisions to provide that earth cover.

Used Tire Storage Area Special Rules - In the event there is a fire or other emergency in the used tire storage area, the following special rules shall apply:

- After following the emergency procedure outline above, the Manager shall insure that the dike around the waste tire pile is intact and that the valve of the drainpipe through the berm is closed. This shall be accomplished by patrolling the exterior of the dike and by adding earth to the dike wherever necessary to assure that no oily material generated by the combustion of the tires escapes the immediate area.
- The State of Florida, Department of Environmental Regulation, shall be immediately

notified by calling the Tampa office at 813\744-6100 if fire, or another emergency, poses an unanticipated threat to the public health or environment. Within two weeks of any emergency involving potential off-site impact, a report shall be submitted to the Department including information on the emergency, the results of the action taken, and an analysis of the success or failure of the actions.

- In addition, any special conditions as set forth by the Sarasota county Fire Department shall be met.

List of Emergency Response Equipment - In the event of a fire emergency, the following equipment is available at the landfill and may be used as the situation dictates in the evolution of responding to a fire emergency, such as repair of dikes, smothering with earth and materials, and then use of water in extinguishing fires:

(2) D-6N bulldozers	4000-gallon water tanker
623-B Excavator	8-inch Mac Pump w/diesel engine
950 Endloaders	Pressure washer trailer

It should be noted that from time to time the equipment available for fire emergency use may be changed, and it should be the responsibility of the persons in charge at the facility to be aware of those changes and respond accordingly with the appropriate equipment in the event of a fire emergency.

Dry hydrant connections are available as shown on the drawings for the purpose of supplying water in the event of a fire or other emergency.

Also available at the site is an 8-inch Mac pump with hose and discharge pipe to be used and for filling the 4000-gallon tanker. Upon arrival of the fire department, this pump and water supply will be used under the direction of the officer in charge from the fire department.

Fire extinguishers are available in every vehicle and piece of equipment on the site. Although fire extinguishers are very ineffective against a large fire, it may be possible through their use to control the fire until larger equipment is brought to bear the fire.

List of Emergency Responses Persons:

	Home Phone Number
Frank Coggins	(941) 406-4667
Dan McAllister	(941) 923-5907

Procedure to be Followed for Cleanup - Any residual from a fire at the tire storage area shall be removed for proper disposal by County personnel. The County will provide all cleanup services and equipment required. All debris and contaminated soil will be placed in the landfill and all liquids will be pumped into a hauling truck for proper disposal.