

© 2018 CDM SMITH. ALL RIGHTS RESERVED. THESE DOCUMENTS AND DESIGNS PROVIDED BY PROFESSIONAL SERVICE, INCORPORATED HEREIN, ARE THE PROPERTY OF CDM SMITH AND ARE NOT TO BE USED, IN WHOLE OR PART, FOR ANY OTHER PROJECT WITHOUT THE WRITTEN AUTHORIZATION OF CDM SMITH.

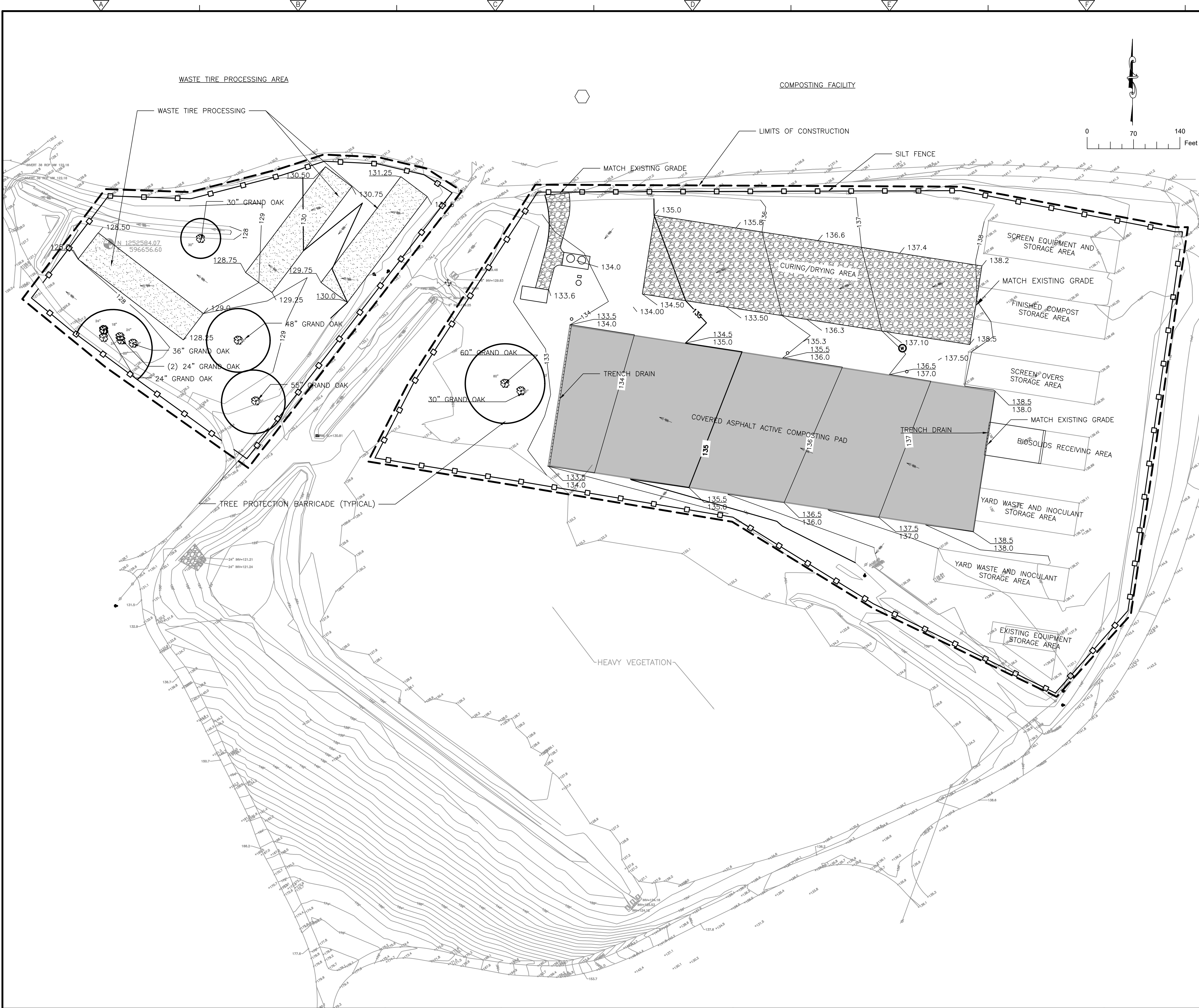

- PAVING, GRADING AND DRAINAGE NOTES**
1. ALL DIMENSIONS ARE TO THE EDGE OF PAVEMENT UNLESS OTHERWISE NOTED ON PLANS.
 2. TOPO INFORMATION SHOWN ON THESE PLANS BASED ON TOPOGRAPHIC SURVEY PERFORMED BY HYATT SURVEY SERVICES, INC., DATED SEPTEMBER 2018.
 3. ALL DISTURBED AREAS SHALL BE SODDED UNLESS OTHERWISE NOTED ON PLANS. SOD INSTALLED ON SLOPES 3:1 OR GREATER SHALL BE HELD IN PLACE WITH 12-IN STAPLES.
 4. PROPOSED GRADING OF ENHANCED AREAS DEPICT FINAL GRADES UPON PLACEMENT OF NECESSARY FILL.
 5. THE CONTRACTOR SHALL PERFORM HIS OWN INVESTIGATIONS AND CALCULATIONS AS NECESSARY TO ASSURE HIMSELF OF EARTHWORK QUANTITIES. THERE IS NO IMPLICATION THAT EARTHWORK BALANCES AND THE CONTRACTOR SHALL BE RESPONSIBLE FOR ANY IMPORT FILL NEEDED, OR FOR REMOVAL AND DISPOSAL OF ANY EXCESS MATERIALS.
 6. THE CONTRACTOR SHALL BE RESPONSIBLE FOR OBTAINING THE NECESSARY TESTING TO ASSURE THAT THE PROPER COMPACTION HAS BEEN ACHIEVED ON THE SUBGRADE, BASE, AND ALL OTHER PERTINENT AREAS THAT HAVE BEEN COMPLETED, AS REQUIRED BY DESIGN DRAWINGS AND SPECIFICATIONS. THE CONTRACTOR SHALL BEAR ALL COSTS ASSOCIATED WITH TESTING AND SHALL PROVIDE THE OWNER AND THE ENGINEER WITH COPIES OF THE CERTIFICATION OF COMPACTION FROM THE TESTING COMPANY.
 7. GRADING SHOWN ON THESE PLANS IS PROVIDED TO THE CONTRACTOR TO EXPRESS THE GENERAL GRADING INTENT OF THE PROJECT. THE CONTRACTOR SHALL GRADE THE ENTIRE SITE TO PROVIDE POSITIVE DRAINAGE IN ALL AREAS. SMOOTH TRANSITIONS SHALL BE PROVIDED BETWEEN CONTOURS OR SPOT ELEVATIONS AS SHOWN ON THE PLANS TO ACCOMPLISH THE GRADING INTENT. NO STANDING WATER ("BIROBATHS") SHALL REMAIN WITHIN ASPHALT COMPOSTING PAD. ALL SLOPES SHALL BE STABILIZED IMMEDIATELY AFTER FINAL GRADING HAS BEEN COMPLETED. CONTRACTOR SHALL NOTIFY OWNER AND ENGINEER A MINIMUM OF FORTY-EIGHT(48) HOURS PRIOR TO DEMOBILIZATION OF GRADING EQUIPMENT TO DETERMINE THAT THE GRADING INTENT HAS BEEN ACHIEVED.
 8. ALL MATERIALS AND CONSTRUCTION METHODS ARE TO BE IN ACCORDANCE WITH FDOT STANDARD SPECIFICATIONS FOR ROAD AND BRIDGE CONSTRUCTION (LATEST EDITION) AND THE APPLICABLE FDOT INDEX NUMBER DETAIL AS SHOWN IN FDOT ROADWAY AND TRAFFIC DESIGN STANDARDS (LATEST EDITION).
 9. ALL ORGANIC SOILS BELOW UTILITY TRENCHES SHALL BE REMOVED AND REPLACED WITH SUITABLE MATERIAL AND COMPACTED TO NO LESS THAN 98% OF THE MODIFIED PROCTOR MAXIMUM DENSITY (AASHTO T - 180).
 10. STABILIZED SUBGRADE TO BE FDOT TYPE "C".
 11. ALL CURBS SHALL HAVE CONTRACTION JOINTS AT INTERVALS NOT TO EXCEED 10'-FT ON CENTER. CONSTRUCTION OF CURBS SHALL BE IN CONFORMANCE WITH FDOT STANDARD SPECIFICATIONS FOR ROAD AND BRIDGE CONSTRUCTION (LATEST EDITION) SECTION 520 AND DETAILS PROVIDED ON THE CONSTRUCTION PLANS.
 12. THE SEQUENCE OF CONSTRUCTION SHALL BE SUCH THAT ALL UNDERGROUND INSTALLATIONS OF EVERY KIND, SHALL BE PLACED BENEATH THE PAVEMENT AND ITS EDGES AND TESTED OR INSPECTED PRIOR TO THE CONSTRUCTION OF THE PAVEMENT. THE PAVEMENT SHALL NOT BE CUT WITHOUT PRIOR APPROVAL OF THE ENGINEER AND OWNER.
 13. ALL FILL MATERIALS SHALL BE FREE OF MUCK, STUMPS, ROOTS, BRUSH, VEGETATIVE MATTER, RUBBISH, OR OTHER UNSUITABLE MATTER.
 14. ALL EXCESS USEABLE MATERIALS EXCAVATED SHALL REMAIN THE PROPERTY OF THE OWNER AND SHALL BE STOCKPILED AT ON-SITE LOCATIONS AS SPECIFIED BY THE OWNER. EXCESS MATERIALS SHALL BE STOCKPILED SEPARATELY AS TO USEABLE (NONORGANIC) FILL STOCKPILES AND ORGANIC (MUCK) STOCKPILES IF MUCK IS ENCOUNTERED. CONTRACTOR SHALL BE RESPONSIBLE FOR THE REMOVAL OF ALL UNSUITABLE FILL MATERIALS FROM THE SITE. THE OWNER MAY, AT HIS SOLE DISCRETION, REQUIRE THE CONTRACTOR, AT NO ADDITIONAL EXPENSE TO THE OWNER, TO PROPERLY REMOVE AND DISPOSE OF ANY EXCESS MATERIAL, WHETHER USEABLE OR ORGANIC. FILL MATERIALS PLACED UNDER ASPHALT PAVEMENT OR AREAS PROPOSED FOR STABILIZED SUBGRADE SHALL BE COMPACTED TO AT LEAST 98% MAXIMUM DENSITY AS SPECIFIED IN AASHTO T-180. ALL OTHER AREAS ARE TO BE COMPACTED TO AT LEAST 95% MAXIMUM DENSITY AS SPECIFIED IN AASHTO T-180. FILL MATERIALS SHALL BE PLACED AND COMPACTED IN A MAXIMUM OF 12" LIFTS. REFER TO "REPORT OF GEOTECHNICAL EXPLORATION" PREPARED BY AREHNA ENGINEERING, INC., DATED APRIL 12, 2018, FOR ADDITIONAL INFORMATION. THE CONTRACTOR SHALL PROVIDE THE ENGINEER AND THE OWNER WITH ALL (PASSING AND FAILING) TESTING RESULTS. RESULTS SHALL BE PROVIDED ON A TIMELY AND REGULAR BASIS PRIOR TO CONTRACTOR'S PAY REQUEST SUBMITTAL.

REV. NO.	DATE	DRWN	CHKD	REMARKS

DESIGNED BY: J. GRISSOM
DRAWN BY: N. SMITH
SHEET CHK'D BY: V. PANGASA
CROSS CHK'D BY: M. SMITH
APPROVED BY: J. GRISSOM
DATE: DECEMBER 2018

CDM Smith
2002 N. Lois Avenue, Suite 200
Tampa, FL 33607
Tel: (813) 281-2900
FL COA No. EB-0000020

GRISSOM SMITH
Consulting Engineers
2719 Letap Court, #102
Land O Lakes, FL 34638
Tel: (813) 230-3462
FL COA No. 31605

HILLSBOROUGH COUNTY PUBLIC UTILITIES DEPARTMENT
SOUTHEAST COUNTY LANDFILL
BIOSOLIDS COMPOSTING FACILITY
COUNTY CIP NO: 10281

PAVING GRADING AND DRAINAGE PLAN

JENNIFER L. GRISSOM
LICENSE
No. 69832
Professional Engineer
STATE OF FLORIDA

DATE:
JENNIFER L. GRISSOM
PE NO. 69832

PROJECT NO. 6033-232031
FILE NAME: C003

SHEET NO.
C-3

From: Pangasa, Vipin
To: [EPOST SWM; Ciaravella, Philip](#)
Cc: [Larry Ruiz](#); [Dilmore, Cory](#); [Morgan, Steve](#); [Kimberly Byer](#); [Brown, Elizabeth \(Liz\)](#); [Restrepo, Carolina](#)
Subject: RE: WACS 41193 Southeast County Waste Tire Processing Facility Request for Additional Information
Date: Friday, February 8, 2019 4:17:52 PM
Attachments: [C003.pdf](#)

Good afternoon Mr. Ciaravella:

With reference to Hillsborough County's application for an intermediate modification pertaining to County's existing Waste Tire Processing Facility (WTPF) permit and the subsequent receipt of Department's request for additional information (RAI), I am pleased to submit, on behalf of Hillsborough County, the following response (in a Q and A format):

Q 1a. Proposed use of disposal method for the stored tires.

A 1a. Hillsborough County shall transport stored car tires from the storage pads to Hillsborough County's Resource Recovery Facility (waste to energy) to be used as fuel. Stored tires with rim and stored truck tires shall be removed from the storage pads by an outside contractor for disposal. Currently, Hillsborough County has a contract with Angelos Aggregate Materials for removal, transportation and disposal services of tires with rim and truck tires.

Q 1b. The maximum daily throughput, the planned daily throughput and the annual throughput.

A 1b. The maximum and planned daily throughput is 5 tons (per day). The anticipated annual throughput is 1,560 tons (per year).

Q 1c. A description of how 75% of the annual accumulation of waste tires will be removed for disposal or recycling. (Regulatory Reference 62-711.530(6) F.A.C.)

A 1c. Hillsborough County's Resource Recovery Facility (waste to energy) can take up to 54 tons per day of tires. Also, please see response to Q 1a above.

Q 2. A description of stormwater control measures and measures to divert stormwater or floodwaters away from the storage piles. (Regulatory Reference 62-711.540(3)(a)).

A 2. A signed and sealed copy of the designed paving grading and drainage plan for the proposed facility (Sheet C-3) is attached. The proposed waste tire storage pads are 6" thick and overlay the existing grade. The tire pads are sloped to direct runoff off the pads and prevent accumulation of standing water. The surrounding site is graded to allow stormwater to run around the storage pads to the stormwater swale (and interconnected pond system) towards (south and then) the west for treatment and attenuation. The existing site Environmental Resource Permit (ERP) was recently modified. FDEP issued ERP No. 29-0270881-009-EM on February 5, 2019 to allow construction of the overall proposed project (Biosolids Composting Facility) which includes the relocated waste tire processing facility.

Regards,
Vipin Pangasa, P.E.
CDM Smith

From: EPOST_SWM <EPOST_SWM@dep.state.fl.us>

Sent: Thursday, January 31, 2019 3:38 PM

To: Kimberly Byer <ByerK@hillsboroughcounty.org>

Cc: Larry Ruiz <ruizle@hillsboroughcounty.org>; Pangasa, Vipin <PangasaV@cdmsmith.com>; Dilmore, Cory <Cory.Dilmore@dep.state.fl.us>; Morgan, Steve <Steve.Morgan@FloridaDEP.gov>; Ciaravella, Philip <Philip.Ciaravella@dep.state.fl.us>

Subject: WACS 41193 Southeast County Waste Tire Processing Facility Request for Additional Information

In an effort to provide a more efficient service, the Florida Department of Environmental Protection's Solid Waste Regulation Section is forwarding the attached document to you by electronic correspondence in lieu of a hard copy through the normal postal service.

We ask that **only the Permittee** verify receipt of this document by sending a "reply" message to EPOST_SWM@dep.state.fl.us. (An automatic "reply message" is not sufficient to verify receipt). If your email address has changed or you anticipate that it will change in the future, please advise accordingly in your reply. You may also update this information by contacting Philip Ciaravella at 850-245-8742.

The attached document is in "pdf" format and will require Adobe Reader 6 or higher to open properly. You may download a free copy of this software at www.adobe.com/products/acrobat/readstep2.html. Please note that our documents are sent virus free. However, if you use Norton Anti-virus software, a warning may appear when attempting to open the document. Please disregard this warning. Your cooperation in helping us affect this process by replying as requested is greatly appreciated. If you should have any questions about the attached document(s), please direct your questions to:

Philip Ciaravella

FDEP-Solid Waste Section

2600 Blair Stone Road/MS 4565

Tallahassee, FL 32399

philip.ciaravella@floridadep.gov

(850) 245-8742

Fax 850-245-8803

Permitting Consistency Initiative: The Florida Department of Environmental Protection is committed to providing efficient, consistent and quality service to the citizens of Florida. In keeping with these objectives, we are pleased to announce ongoing improvements to our permitting process by standardizing and simplifying our documents. Last fall, the Department began issuing permitting correspondence that is formatted consistently throughout all programs. Although you may receive documents that look slightly different from past correspondence, please be assured that the content continues to be driven by applicable

Rules and Statutes. As always, if you have any questions, please contact your local Department office.

