

Devonshire, Antoine C

From: Tallam, Laxmana
Sent: Thursday, June 17, 2021 11:29 AM
To: Devonshire, Antoine C
Cc: Bhavsar, Kajal H
Subject: FW: New and Used Wholesale Tires Inc. - Waste Tire Processing Facility Application
Attachments: New and Used Wholesale Tires Inc. - Waste Tire Processing Facility Application 6.17.21 (01504552xBA9D6).pdf

Antione,

Please log this into the PA system.

Send me the PA events and Permitting timeline. Thanks!

~Laxmana

From: Jamie Woods <jwoods@llw-law.com>
Sent: Thursday, June 17, 2021 10:05 AM
To: DL CHD50 EPost SWM <EPOST_SWM_SEPB@flhealth.gov>
Cc: Bhavsar, Kajal H <Kajal.Bhavsar@flhealth.gov>; Morales, Jaime A <Jaime.Morales@flhealth.gov>; Simler, Andrew G <Andrew.Simler@flhealth.gov>; 'wally nutire.com' <wally@nutire.com>; Alfred Malefatto <amalefatto@llw-law.com>; 'Buchko, Matt' <MBuchko@ardaman.com>; Zrallack, Dan <DZrallack@ardaman.com>; Tallam, Laxmana <Laxmana.Tallam@flhealth.gov>
Subject: New and Used Wholesale Tires Inc. - Waste Tire Processing Facility Application

EXTERNAL EMAIL: DO NOT CLICK links or open attachments unless you recognize the sender and know the content is safe.

Good Morning,

Please find New and Used Wholesale Tires Inc.'s Waste Tire Processing Facility Permit Application, which includes the Part III Attachments and the Emergency Preparedness Manual, attached to this email. The application fee payment will be coming shortly. Please do not hesitate to reach out if you have any questions or concerns.

Kind Regards,

James "Jamie" Woods | Attorney

West Palm Beach, Florida 33401

jwoods@llw-law.com | 561.640.0820

Working remotely to adhere to LLW's COVID-19 Policy, [learn more](#)

vCard | [Website](#) | [Bio](#) | [join us online](#)



The information contained in this transmission may be legally privileged and confidential. It is intended only for the use of the recipient(s) named above. If the reader of this message is not the intended recipient, you are hereby notified that you received this communication in error, and that any dissemination, distribution, or copying of this communication is strictly prohibited. If you have received this communication in error, please notify the sender immediately by reply email and delete the message and all copies of it.



Florida Department of Environmental Protection

Bob Martinez Center
2600 Blair Stone Road
Tallahassee, Florida 32399-2400

DEP Form #62-701.900(23)
Form Title: Waste Tire Processing
Facility Permit Application
Effective Date: January 6, 2010
Incorporated in Rule 62-711.530(6)

Waste Tire Processing Facility Permit Application

Permit No. _____

Renewal ☐ Modification ☐ Existing unpermitted facility ☒ Proposed new facility ☐

Part I-General Information:

A. Applicant Information:

1. Applicant Name: New and Used Wholesale Tires Inc.
2. Applicant Street Address: 1200 W 15th St
3. City: Riviera Beach County: Palm Beach Zip: 33404
4. Applicant Mailing Address: 1200 W 15th St
5. City: Riviera Beach County: Palm Beach Zip: 33404
6. Contact person: _____ Phone: (561) 844-4821 FEID No: 21-1099567

7. Have any enforcement actions been taken by the Department against the applicant relating to the operation of any solid waste management facility in this state? This includes any Complaint, Notice of Violation, or revocation of a permit or registration, as well as any Consent Order in which a violation of Department rules is admitted. It does not include a Warning Letter, Warning Notice, Notice of Noncompliance, or other similar document which does not constitute agency action.
- Yes ☒ No ☐ If yes, attach a history and description of the enforcement actions.

B. Facility Information:

1. Facility Name: New and Used Wholesale Tires Inc.
2. Facility Street Address (Main Entrance): 1200 W 15th St
3. City: Riviera Beach County: Palm Beach Zip: 33404
4. Facility Mailing Address: Same as above
5. City: _____ State: _____ Zip: _____
6. Contact Person: Khader Alhidri Phone: (954) 552 9638
7. Facility Location Coordinates:
Section: _____ Township: _____ Range: _____
Latitude: _____ Longitude: _____
8. Anticipated date for starting construction _____ and for completion of construction _____
9. Anticipated date for receipt of tires _____ and for start of processing _____

Mail completed form to
appropriate district office listed below

Northwest District
160 Government Center
Pensacola, FL 32501-5794
850-595-8360

Northeast District
7825 Baymeadows Way, Ste. 200 B
Jacksonville, FL 32256-7590
904-807-3300

Central District
3319 Maguire Blvd., Ste. 232
Orlando, FL 32803-3767
407-894-7555

Southwest District
13051 N. Telecom Pky
Temple Terrace, FL
813-632-7600

South District
2295 Victoria Ave., Ste. 364
Fort Myers, FL 33902-2549
239-332-6975

Southeast District
400 North Congress Ave.
West Palm Beach, FL 33401
561-681-6600

C. Land Owner Information (if different from applicant):

1. Owner's name: _____
2. Land owner's mailing address: _____
3. City: _____ State: _____ Zip: _____
4. Authorized Agent: _____ Agent's phone () _____
5. Current lease expires: _____

D. Facility Operator Information (if different from applicant):

1. Operator's name: _____
2. Operator's mailing address: _____
3. City: _____ State: _____ Zip: _____
4. Contact person: _____ Phone: () _____

E. Preparer of Application:

1. Name of person preparing application: Ardaman & Associates, Inc.
2. Mailing address: 2200 N FL Mango Rd, 101
3. City: West Palm Beach State: FL Zip: 33409
4. Phone: (561) 687-8200
5. Affiliation with facility: Authorized agent

Part II-Operations:

A. Facility type (check appropriate box):

- ☒ Waste tire processing facility.
- ☐ Waste tire processing facility with on-site disposal of processed tires or processing residuals.
- ☐ Waste tire processing facility with on-site consumption of waste tires or processing residuals.
- ☐ Permitted solid waste management facility modification to allow waste tire site and processing.

B. Type of processing facility (check as many as apply):

- ☐ Shredder ☐ Cutter ☐ Chopper ☐ Incinerator only ☐ Incinerator with energy recovery
- ☐ Pyrolysis ☐ Supplemental fuel user ☒ Other, explain Wholesaler, distributor

C. Storage: Indicate the maximum quantities of whole waste tires, processed waste tires, and processing residuals, expressed in tons, to be stored at the facility, in accordance with Rule 62-711.530(2), F.A.C.

	Outdoor Storage(tons)	Outdoor Storage (sq.ft)	Indoor Storage (tons)	Indoor Storage (sq.ft)	Total Storage (tons)
Whole waste tires:	<u>10</u>	<u>650</u>	<u>90</u>	<u>18,000</u>	<u>100</u>
Processed tires:	_____	_____	_____	_____	_____
Processing residuals:	_____	_____	_____	_____	_____
TOTALS:	<u>10</u>	<u>650</u>	<u>90</u>	<u>18,000</u>	

- D. For reporting quantity of tires in tons, tires will be: weighed on site ☐ weighed off site ☒
weights will be calculated ☐
- E. Facilities that will not be disposing of processed tires or processing residual on the facility site must indicate the permitted solid waste management facility where processed tires or residuals will be disposed.

1. Name of facility Solid Waste Authority of Palm Beach County

2. Street address: 7501 N Jog Road

3. City: West Palm Beach County: Palm Beach Zip: 33412

- F. Facilities that will be delivering processed tires to consuming facilities must describe the existing or proposed markets for those processed tires.
- _____
- _____
- _____

Part III-Attachments:

A. Facility design

NOTE: All maps, plan sheets, drawings, isometrics, cross sections, or aerial photographs shall be legible; be signed and sealed by a registered professional engineer responsible for their preparation; be of appropriate scale to show clearly all required details; be numbered, referenced to narrative, titled, have a legend of symbols used, contain horizontal and vertical scales (where applicable), and specify drafting or origination dates; and use uniform scales as much as possible, contain a north arrow and use NGVD for all elevations.

1. A topographic or section map of the facility, including the surrounding area for one mile, no more than one year old, showing land use and zoning within one mile of the facility
2. A plot plan of the facility on a scale of not less than one inch equals 200 feet. At a minimum, the plot plan shall include
 - a. The facility design, including the location and size of all storage and processing areas for used tires, unprocessed waste tires, processed waste tires, and waste tire processing residuals;
 - b. All wetlands and water bodies within the facility or within 200 feet of any storage area;
 - c. Stormwater control measures, including ditches, dikes, and other structures;
 - d. Boundaries of the facility, legal boundaries of the land containing the facility, and any easements or rights of way that are within the facility or within 200 feet of any storage area;
 - e. Location, size, and depth of all wells within the facility or within 200 feet of any storage area;
 - f. All structures and buildings that are, or will be, constructed at the facility; include those used in storage and processing operations;
 - g. All areas used for loading and unloading;
 - h. All access roads and internal roads, including firelanes;
 - i. Location of all fences, gates, and other access control measures; and
 - j. Location of all disposal areas within the facility.

B. Facility operation.

1. A description of the facility's operation, process and products including how waste tires will be received and stored.
 2. A description of the equipment used for processing tires. This description shall include the make, model, and hourly capacity of each piece of equipment.
 3. Description of the waste from the process, the amount of waste expected and how and where this waste will be disposed of.
 4. Statement of the maximum daily throughput and the planned daily and annual throughput.
 5. A description of how the operator will maintain compliance with each of the storage requirements of Rule 62 - 711.540, F.A.C.
 6. A copy of the emergency preparedness manual for the facility with a statement of the on site and off site locations where that manual will be maintained.
 7. A copy of the fire safety survey
 8. A description of how 75% of the annual accumulation of waste tires will be removed for disposal or recycling.
- C. Completed closing plan for the facility as required by Rule 62 - 711.700(2) and (3), F.A.C.

- D. Attach proof of financial responsibility as requirement by Rule 62 -711.500(3) OR a calculation showing that financial assurance documents, currently on file with the Department, are sufficient to assure closing of the waste tire site as well as any other solid waste management facility at that location.
- E. A letter from the land owner (if different from applicant) authorizing use of the land as a waste tire processing facility.
- F. If waste tires will be consumed or disposed of at the facility, attach a description of the other environmental permits that the applicant has for this use, including, permit number, date of issue, and name of issuing agency
- G. The permit fee as required in Rule 62-4, F.A.C.

Part IV-Certification:**A. Applicant:**

The undersigned applicant or authorized representative of New & Used Wholesale Tires Inc
 is aware that statements made in this form and attached information are an application for a Waste Tire Processing Permit from the Florida Department of Environmental Protection and certifies that
 The information in this application is true, correct and complete to the best of his knowledge and belief.
 Further, the undersigned agrees to comply with the provisions of Chapter 403, Florida Statutes, and all rules and regulations of the Department. It is understood that the Department will be notified prior to the sale or legal transfer of the facility.

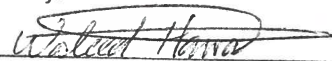

Signature of Applicant or Authorized Agent

Waleed Hawa - President
 Name and Title

5/12/2021
 Date
B. Professional Engineer registered in Florida.

This is to certify that the engineering features of this waste tire processing facility have been
 Designed/Examined by me and found to conform to engineering principals applicable to such facilities. In my
 professional judgment, this facility, when properly maintained and operated will comply with all applicable statutes of
 the State of Florida and rules of the Department. It is agreed that the undersigned will provide the applicant with a
 set of instructions for proper maintenance and operation of the facility.

 Signature

Dan J. Zrallack, P.E. Branch Manager Name and Title

2200 N. Florida Mango Road, Suite 101 Mailing Address

West Palm Beach, FL 33409 City, State, Zip

63911 Florida Registration Number

561-687-8200 Telephone number

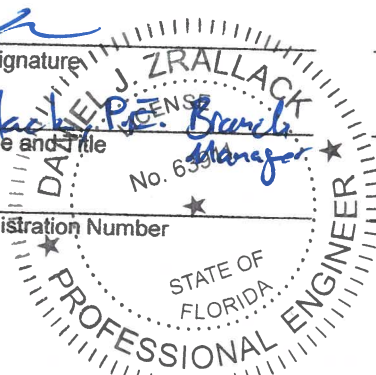

(please affix seal)

5/14/21
 Date

ATTACHMENT TO WASTE TIRE COLLECTOR REGISTRATION APPLICATION:
DESCRIPTION OF PREVIOUS CITATION HISTORY.

On March 3, 2021, officers from the Florida Department of Environmental Protection (“DEP”) inspected Mr. Waleed Hawa’s tire wholesale company, New and Used Wholesale Tires, Inc. (“NuTire”). Mr. Hawa was cited (Agency Case No. WESA21OFF000012) for “failure to obtain permit required by rule or regulation or to violate or fail to comply with rule, regulation, order, permit” under F.A.C. 62-711.300(9)(c). The citation was a result of NuTire having more than 1,500 tires on the premises when the inspection occurred. The pending enforcement action has not yet been resolved, but it is expected that completing this permitting process will help resolve the matter.

Prior to the DEP officers’ visit to NuTire on March 3, 2021, Mr. Hawa was not inspected, notified, or otherwise contacted regarding NuTires’ permit status. NuTire has been in business since 2009. As a result, Mr. Hawa believed he complied with all State and local regulations and laws. Mr. Hawa, in response to the citation, has engaged Lewis, Longman & Walker P.A. and Ardaman & Associates, Inc., to assure he is compliant and permitted moving forward.

01485556-1

JACKSONVILLE

245 Riverside Ave., Suite 150
Jacksonville, Florida 32202
T: 904.353.6410
F: 904.353.7619

ST. PETERSBURG

100 Second Ave., South, Suite 501-S
St. Petersburg, Florida 33701
T: 727.245.0820
F: 727.290.4057

TALLAHASSEE

315 South Calhoun St., Suite 830
Tallahassee, Florida 32301
T: 850.222.5702
F: 850.224.9242

WEST PALM BEACH

515 North Flagler Dr., Suite 1500
West Palm Beach, Florida 33401
T: 561.640.0820
F: 561.640.8202

Florida Department of Health
Palm Beach County
800 Clematis Street, Room 545
West Palm Beach Florida 33401

**Subject: Waste Tire Processing Facility Permit Application – Part III Attachments
New and Used Wholesale Tires, Inc. (“NuTire”) Facility
1200 West 15th Street
Riviera Beach, Palm Beach County, Florida**

Ardaman & Associates, Inc. (Ardaman) is pleased to submit this Waste Tire Processing Facility Permit Application on behalf of New and Used Wholesale Tires, Inc. (“NuTire”). This letter provides the required items in Part III of the application form.

Section A – Facility Design

Provided below is an outline of the required items corresponding to the attached Figures in which they can be found.

1. Topographic and zoning maps – Figures 1a and 1b.
2. Plot Plan of facility
 - a. Facility Design – Figure 2a.
 - includes location and size of all buildings, waste tire storage areas, site boundaries, nearby easements, stormwater control measures, loading/unloading areas, disposal areas (none), and access and internal roads and fire lanes, fences and gates.
 - b. Nearby Wetlands and Water bodies – Figure 2b.
 - c. On-site or nearby wells – There are no on-site wells on the subject property. No wells were observed within 200 feet of the subject property during Ardaman’s site visit on May 5, 2021. Additionally, a review of the Wellfield Protection Zones of Influence Maps produced by the Palm Beach County Department of Environmental Resources Management (ERM), the subject property is not located within a zone of influence of a public wellfield in Palm Beach County.

Copies of a boundary survey and site map completed by others in June 2019 at the time of renovations are also attached.

Section B – Facility Operation

This facility operates as a wholesale distributor for new and used tires. Tires are received in truck shipments and stored at the facility for no more than two-month periods and subsequently transported by truck to the Port of Palm Beach for sale in the Caribbean. No processing of tires of any kind are conducted at the site. A limited number of used tires that are not resale quality

are collected and periodically transported offsite for disposal at a licensed landfill. Records for the disposed tires are maintained at the onsite facility office.

Based on discussions with the operator, Mr. Whaleed Hawa (property and business owner), the facility ships and receives approximately 3 to 4 truckloads of tires per week. Each shipment contains approximately 5 tons of tires. The annual throughput of the facility is approximately 70 to 1040 tons of tires, and the facility typically maintains approximately 100 tons of stored tires.

Waste Tire Storage Requirements Rule 62-711.540, F.A.C

Below is a description of how the operator will maintain compliance with the applicable tire storage requirements of Rule 62-711.540, F.A.C.

As noted above, the facility receives truck shipments of tires and does not accept tires from the public. There are no operations or activities conducted at the site that involve the use of open flames. Services from the local fire department have been ensured through notification of the facility and the scheduling of a fire safety survey, attached.

An example Emergency Preparedness Manual has been attached to be used as a template document by the owner. The manual must be reviewed, revised, approved and maintained by the owner and operator to provide best management practices for all possible emergency situations. Ardaman cannot be held liable for the completeness, accuracy or maintenance of the Emergency Preparedness Manual. The Emergency Preparedness Manual must be kept in a designated, accessible location at the facility. A copy of the manual will also be kept at an off-site location chosen by the operator. The manual includes mosquito control measures that are implemented at the facility. Within two weeks of any emergency, the operator of the site will submit to the Florida Department of Environmental Protection (FDEP) a written report on the emergency. The report will describe the origins of the emergency, the actions that were taken to deal with the emergency, the results of the actions that were taken, and an analysis of the success or failure of the actions.

The operator will be responsible to continue to maintain records of the quantity of tires received, stored, and shipped from the site such as those provided as an attachment to this document.

Access to the facility is provided from West 15th Street to the south, and an asphalt paved parking lot to the east of the building. The building is also positioned along the roadway with clear, passable approaches available at all times for emergency vehicles.

Based on Ardaman's site reconnaissance on May 5, 2021, the facility appeared to maintain the indoor storage requirements listed in F.A.C. Rule 62-711.540(2) items (a) through (h) pertaining to limits to the size, height, and placements of tire piles at the time of our site visit. We note the operator was already familiar with these requirements from previous fire department inspections and consultations. Our observations also confirmed the facility appeared to be maintaining the outdoor storage requirements listed in F.A.C. Rule 62-711.540(3) items (a) through (f) at the time of our site visit. Tires outside the main warehouse building were observed to be stored along the fencing or in trailers; and stacked in arrangements neither wider than 5 feet nor taller than 8 feet.

Section C – Closing Plan

It is our understanding the requirements of Rule 62-711.700 were repealed as of February 16, 2012.

Section D – Financial Responsibility

The facility temporarily stores a limited number of tires that are received but deemed not to be of sellable quality. The owner provided receipts for several recent landfill disposal events (included in the attachments). It is our understanding based on information provided by the owner that one truck load typically contains about 500 tires (total of approximately 5 tons). Based on the provided receipts, the cost to dispose of the tires is \$75/ton, giving approximately \$375/truck load. We note that this cost does not include a cost to load and transport the tires, which we have estimated to be approximately \$500/truck load. Therefore, the total estimated cost to load, transport and dispose of a truck load of 500 tires is approximately \$875 (\$175/ton). Based on an estimate of the number of tires present at the facility during our site visit on May 5, 2021, there were about 10,000 tires stored at the facility. The owner indicated that the number of tires at the facility was typical for their normal operations. Therefore, we have estimated that the cost to dispose of 10,000 tires (100 tons) is \$17,500.

CLOSURE

Please note that the information and conclusions presented in this letter are limited to the observations of the site on the date noted, and information provided by our client. Ardaman cannot be held responsible for inaccurate information presented to us or any changes in conditions or operations following our site visit.

We are pleased to provide this information to you on behalf of our client, New and Used Wholesale Tires, Inc. ("NuTire"). If you have any questions or require any additional information, please feel free to contact the undersigned by phone at (561) 687-8200 or by e-mail at dzrallack@ardaman.com.

ARDAMAN & ASSOCIATES INC.
FL. Certificate of Authorization No. 5950

Dan Zrallack, P.E.
Branch Manager
Florida License No. 63911

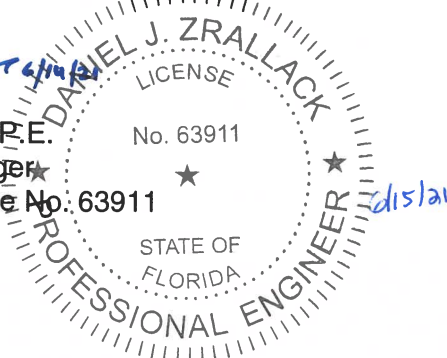

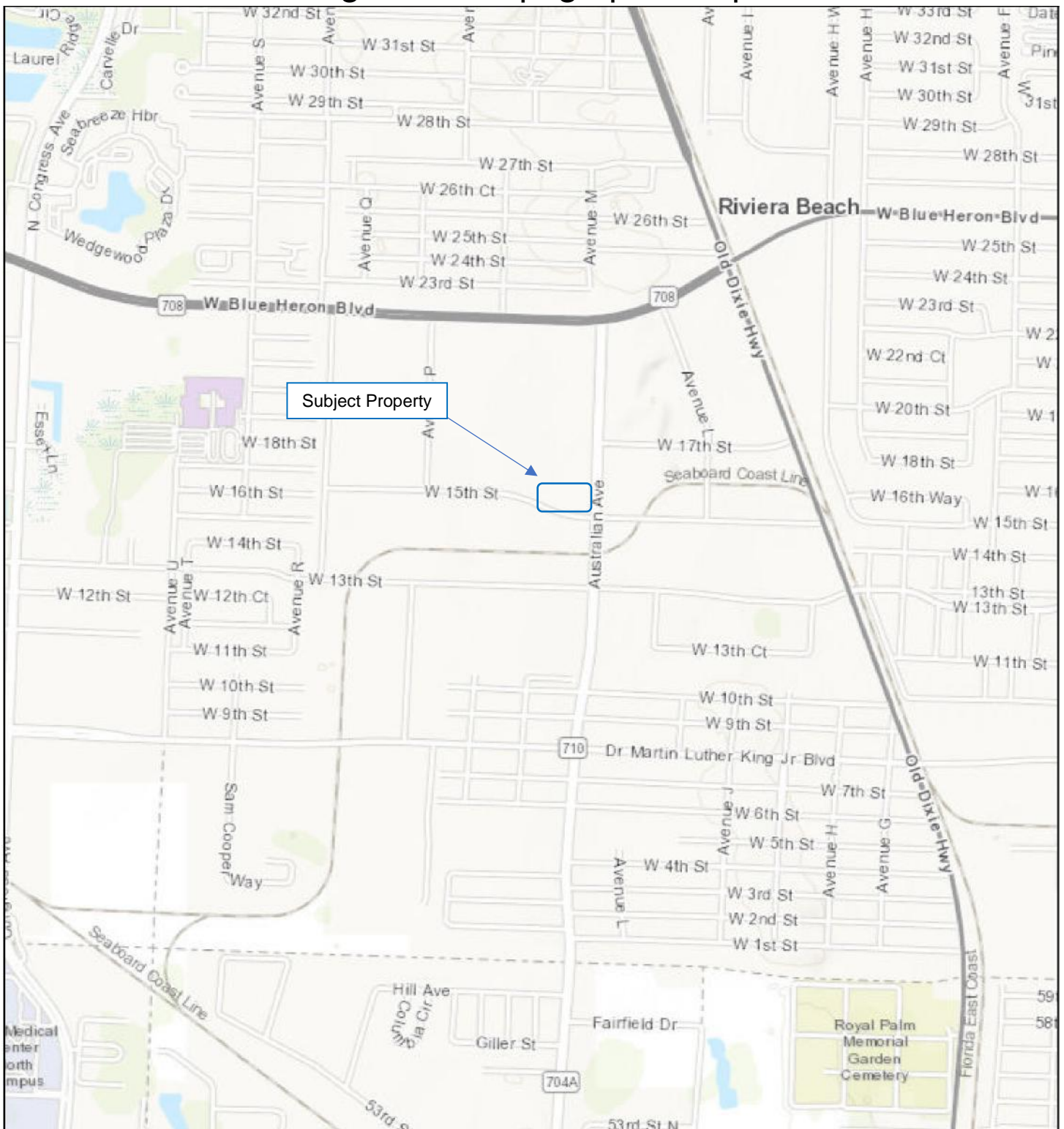

Matthew Buchko, E.I.
Staff Engineer

Figure 1a: Topographic Map

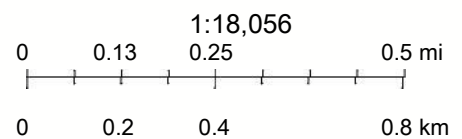

5/13/2021, 12:22:13 PM



Esri, HERE, Garmin, INCREMENT P, USGS, METI/NASA, EPA, USDA

Figure 1b: Zoning and Future Land Use

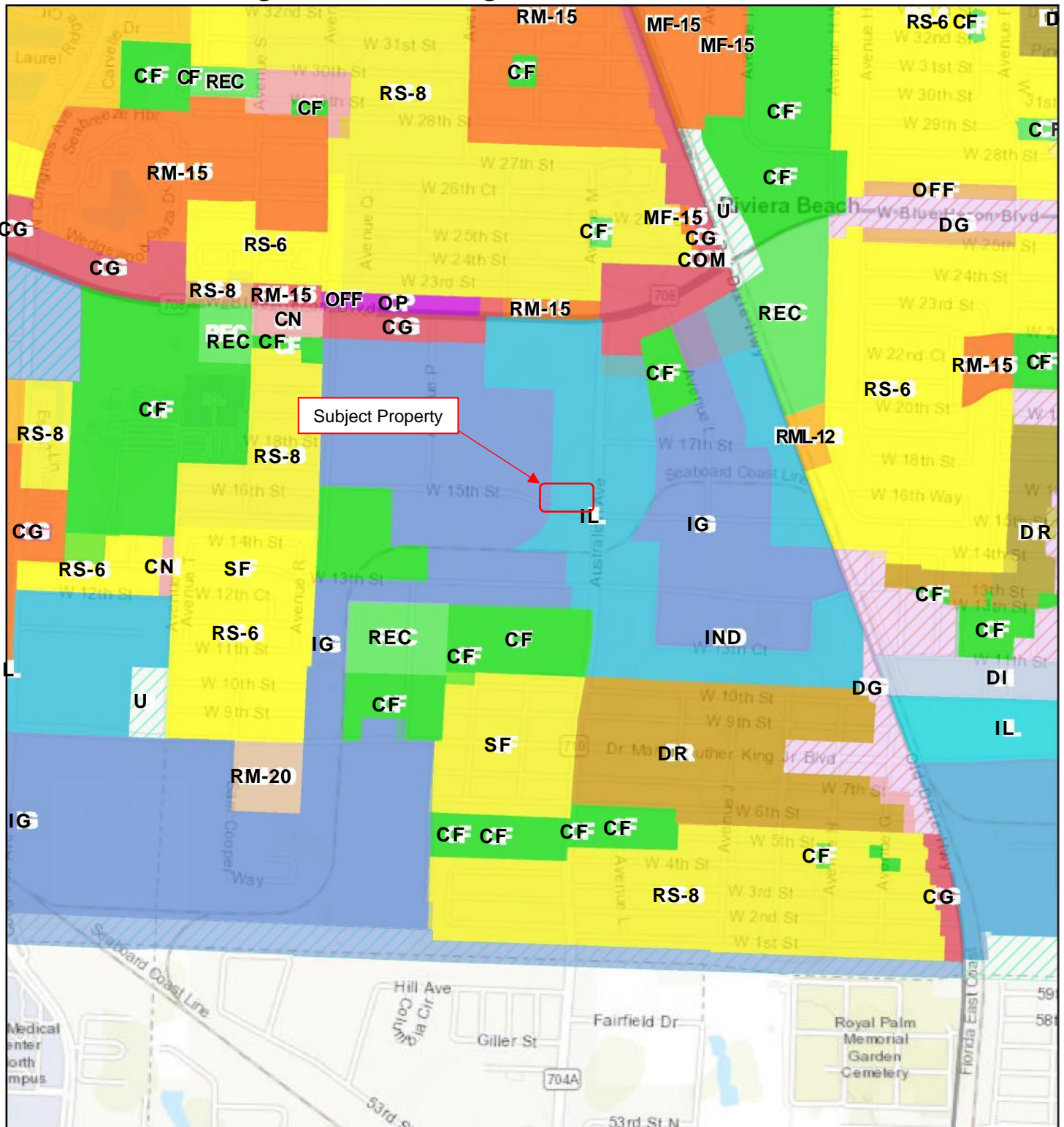

5/13/2021, 12:25:37 PM

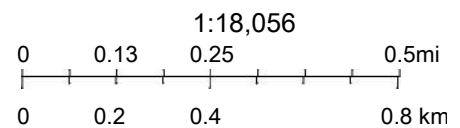
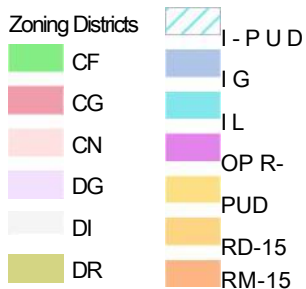

Esri, HERE, Garmin, INCREMENT P, USGS, METI/NASA, EPA, USDA

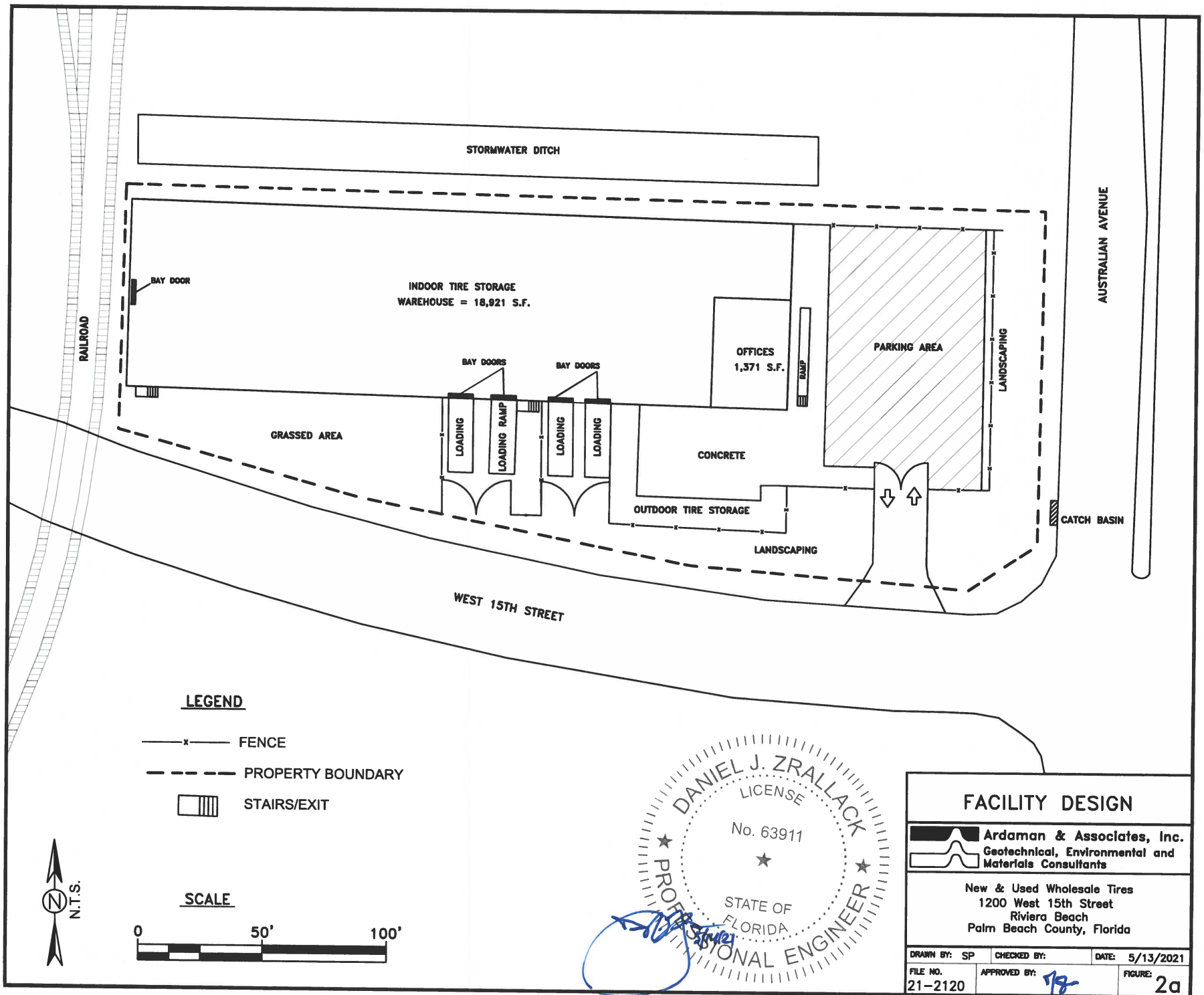



U.S. Fish and Wildlife Service



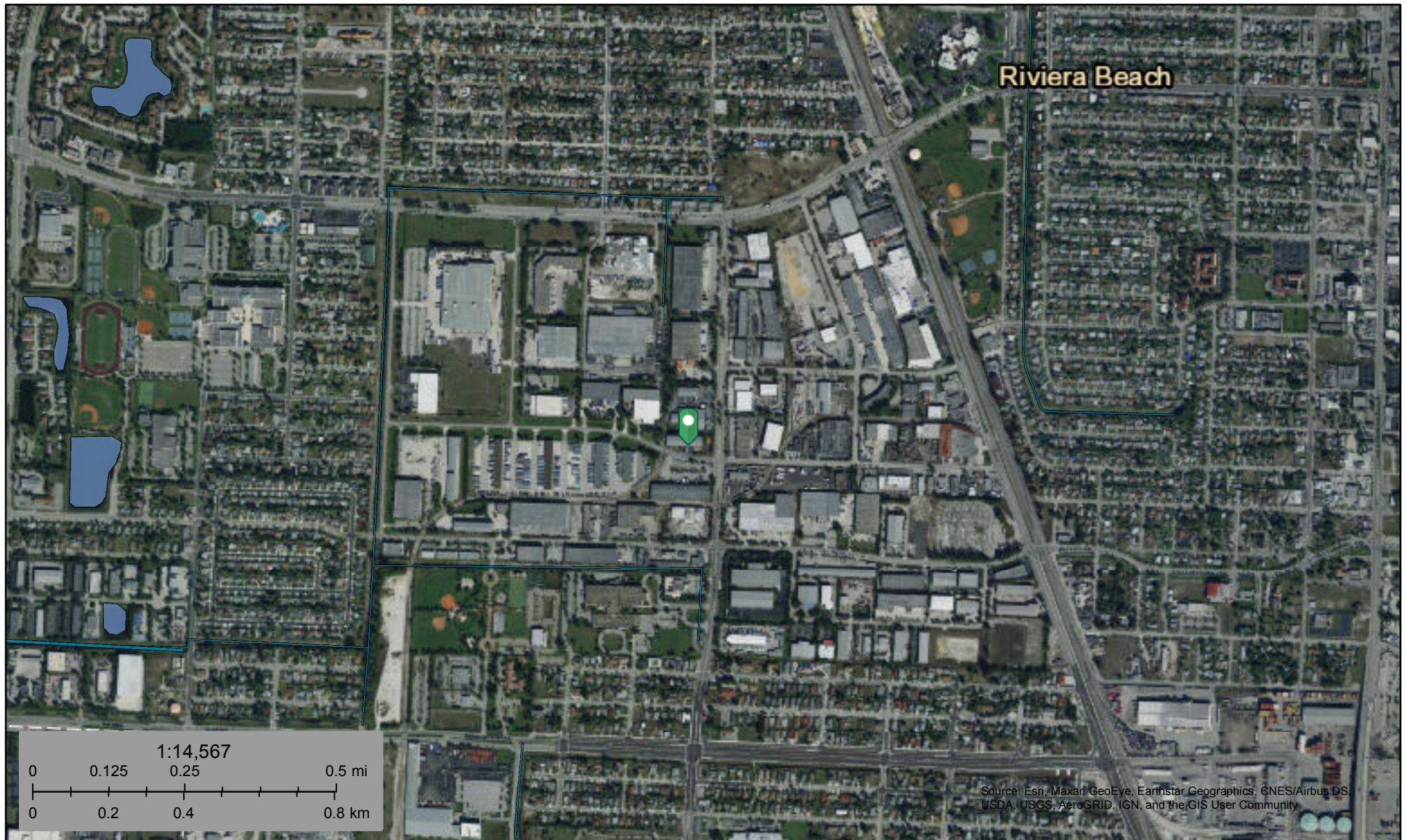

National Wetlands Inventory

Figure 2b: Wetlands and Water Bodies



May 13, 2021

Wetlands

	Estuarine and Marine Deepwater		Freshwater Emergent Wetland		Lake
	Estuarine and Marine Wetland		Freshwater Forested/Shrub Wetland		Other
			Freshwater Pond		Riverine

This map is for general reference only. The US Fish and Wildlife Service is not responsible for the accuracy or currentness of the base data shown on this map. All wetlands related data should be used in accordance with the layer metadata found on the Wetlands Mapper web site.

Location Map

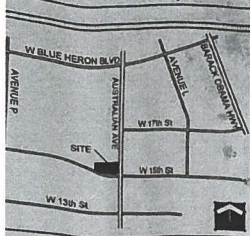

Site Data

Application Name	1200 W 15th Street
Existing Future Land Use Designation	TBD
Section, Township, Range	28/42/43
Property Control Number	66-43-42-39-43-000-0240
Property Use	Warehouse/Distribution
Property Area	1.10 AC (47,714 s.f.)
Total Gross Floor Area	20,292 s.f.
Warehouse	18,921 s.f.
Warehouse/Wholesale	13,711 s.f.
Accessory Office (10%)	1,371 s.f.

Concurrence Approval	20,292 s.f.
Warehouse/Wholesale	18,921 s.f.
Accessory Office (10%)	1,371 s.f.

Total Floor Area Ratio	43
Total Building Coverage	43%
Impervious Area	76%
Pavement/Walks	20,292 s.f.
Pervious Area	16,777 s.f.
Open Space	24%
Building Height	max. 35'
Number of Stories	1
Parking Required	20 SPACES
Warehouse/Wholesale - 1 space/1,000 s.f. @ 20,292 s.f. = 20	20 SPACES
Handicap Spaces Required	1
Handicap Spaces Proposed	2
Loading Required (12' x 30')	3
Loading Provided (12' x 30')	135
Traffic Analysis Zone	135

Development Regulations

PROPERTY DEVELOPMENT REQUIREMENTS											
EXISTING STRUCT.	MINIMUM LOT DIMENSION	MAX. FAR	MAX. BLDG. COVER	MIN. PERVIOUS	MAX. IMPERVIOUS	FRONT YARD INTERIOR	REAR YARD INTERIOR	SIDE YARD INTERIOR	REAR YARD INTERIOR	REAR YARD INTERIOR	REAR YARD INTERIOR
IL	20,000 s.f.	1.15	45%	20%	85%	40'	15'	15'	15'	20'	20'
IL	47,714 s.f.	371	371	155'	43	43%	24%	76%	101	10'	67

Development Team

DEVELOPER	1200 W 15th STREET LLC 1200 W 15th STREET RIVIERA BEACH, FL 33404 (561) 884-6141
PLANNER	SCHMIDT NICHOLS 1551 N FLAGLER DRIVE SUITE 102 WEST PALM BEACH, FL 33411 (561) 884-6141
SURVEYOR/ENGINEER	PM SURVEYING 4540 CAMBRIDGE STREET WEST PALM BEACH, FL 33411 (561) 476-7764

Notes

* BASE INFORMATION FOR THIS PROJECT WAS OBTAINED FROM A SURVEY PREPARED BY PM SURVEYING

FLU: IND
Zoning: IG
Use: Warehouse/
Distribution; FEC
Railway

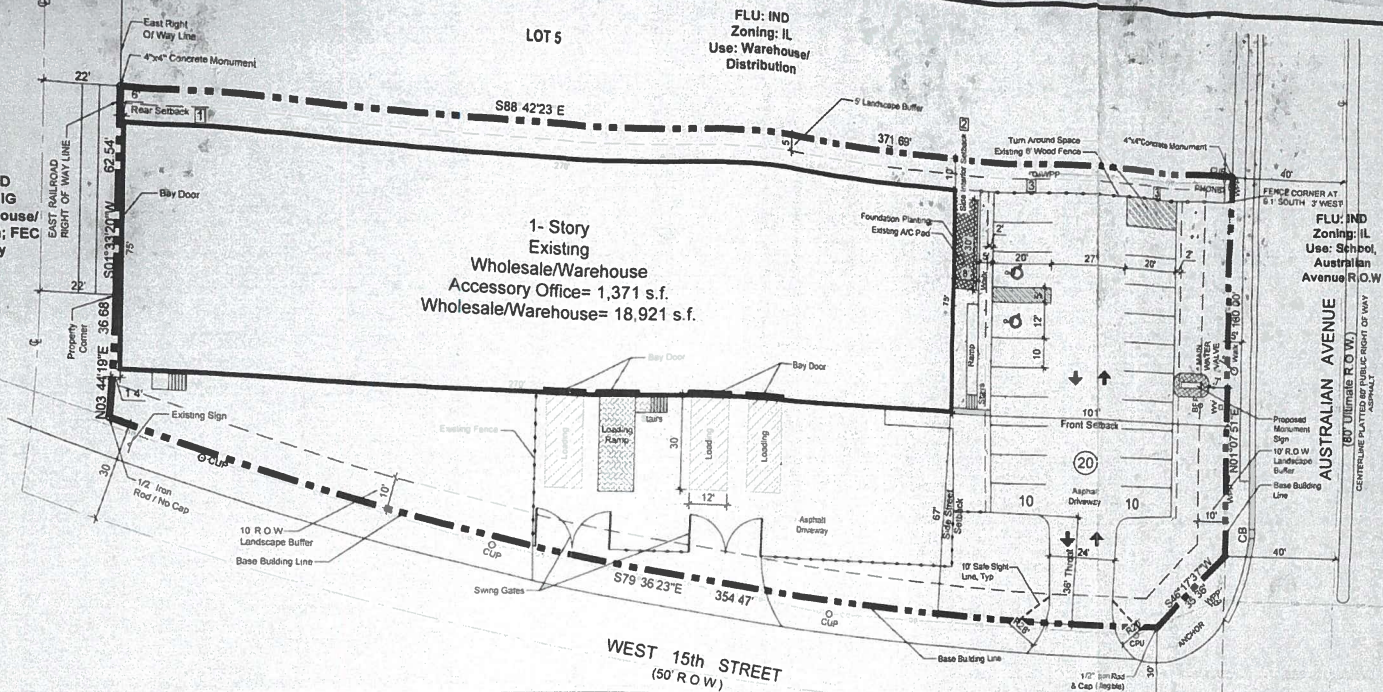

EXISTING NONCONFORMITY CHART			
CODE SECTION	REQUIRED	PROVIDED	NONCONFORMITY
1	Sec 31-363.3 C Property Development Standards	20' Rear Setback (FEC Railway)	0' 6" Side Setback (FEC Railway) Allow a 10' 4" Side Setback reduction for the existing warehouse building along the west property line.
2	Sec 31-363.3 B Property Development Standards	15' Side Interior Setback (North Property Line)	10' Side Interior Setback (North Property Line) Allow a 5' 5" Side Interior Setback reduction for the existing warehouse building along the north property line.
3	Sec 31-610 C 6 Parking areas for multifamily and all nonresidential developments	The owner shall provide terminal landscaped islands at the end of each parking row. Terminal landscaped islands shall be not less than ten feet in width and one parking space in length.	0 terminal landscaped islands Allow the elimination of terminal landscaped islands at the end of each parking row.

FLU: IND
Zoning: IL
Use: School, W
15th Street R.O.W.

Master Sign Program

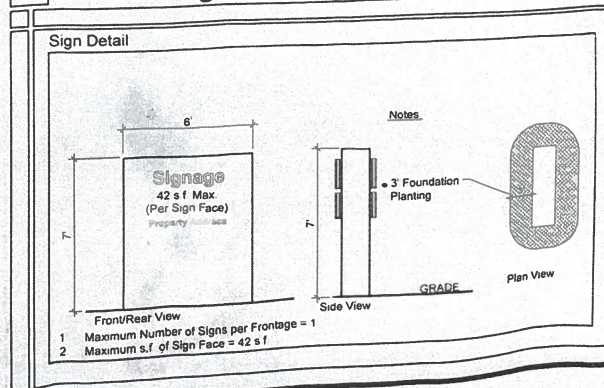

Parking and Striping

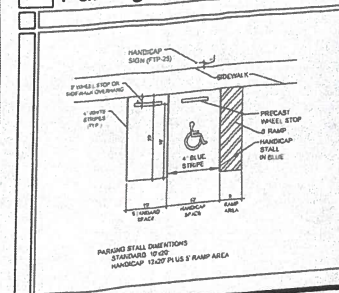

Amendment Stamp

Zoning Stamp

SCHMIDT NICHOLS
LANDSCAPE ARCHITECTURE
AND URBAN PLANNING

1551 N Flagler Dr, Ste 102
West Palm Beach, FL 33401
Phone: 561 884 6141
Email: info@schmidtnichols.com
Website: www.schmidtnichols.com
License No. LC26000232

1200 W 15th Street
1200 W 15th Street, Riviera Beach, FL, 33404

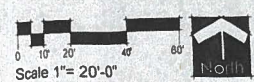

Date: 07/15/19
Scale: 1" = 20'-0"
Design By: JAA
Drawn By: JAA
Checked By: JAA
File No.: 953.01
Job No.: 19-4E

REVISIONS / SUBMISSIONS

SP-1 of 1

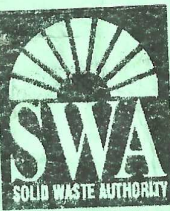

**SOLID WASTE AUTHORITY
OF PALM BEACH COUNTY**
7501 N. JOG RD
WEST PALM BEACH, FL 33412
PHONE 561-640-4000

SITE: Renewable Energy Facility - Plant

TICKET # 70086770
HOLD # H07-131914

DATE	TIME	OpID	lane
IN: 05/07/2021	01:07 PM	ZM	2A
OUT: 05/07/2021	01:30 PM	MT	3A

CUSTOMER # : 999999
CUSTOMER NAME : CASH CUSTOMER
TRUCK DECAL # : H07-131914
TRAILER DECAL#:

ORIGIN : AA -DIST 1 - NORTHEAST PBC
DELIVER TO : REF # 2

GROSS WEIGHT	: 23,340 LBS	11.67 TN
TARE WEIGHT	: 13,720 LBS	6.86 TN
NET WEIGHT	: 9,620 LBS	4.81 TN

MATERIAL

160 - BT-TIRES - PASSENGER	\$360.75
4.81 TN @ \$75.00/TN	
SUBTOTAL:	\$360.75

TOTAL: \$360.75

PAYMENT METHOD(S):
Cash \$400.00

CHANGE: \$39.25



**SOLID WASTE AUTHORITY
OF PALM BEACH COUNTY**
7501 N. JOG RD
WEST PALM BEACH, FL 33412
PHONE 561-640-4000

TICKET # 07387441 05/07/2020 09:26

RELATED TICKET # 07387440
CUSTOMER # : 999999
CUSTOMER NAME : CASH CUSTOMER

WASTE TYPE : BT - TIRES - PASSENGER
SECTOR ORIGIN : AA - DIST 1 - NORTH OCEAN
DELIVER TO : REF # 2

GROSS WEIGHT	: 23,260 LBS
TARE WEIGHT	: 13,400 LBS
NET WEIGHT	: 9,860 LBS

TE .027500 x 9,860 LBS = 269.50
X @ .00% = 00
TAL FEE, BY WEIGHT = 269.50
WH PYMNT FROM RET TICKETS = 270.00
AMT OF CASH REFUND = .50

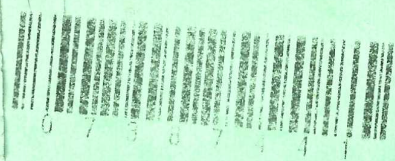

CUSTOMER/DRIVER COPY



**SOLID WASTE
OF PALM BEACH COUNTY**
7501 N. JOG RD
WEST PALM BEACH, FL 33412
PHONE 561-640-4000

SITE: Landfill

TICKET # 80090217
HOLD # H08-169818

DATE	TIME
IN: 05/21/2021	10:41 AM
OUT: 05/21/2021	12:13 PM

CUSTOMER # : 999999
CUSTOMER NAME : CASH CUSTOMER
TRUCK DECAL # : H08-169818
TRAILER DECAL#:

ORIGIN : AA -DIST 1 - NORTHEAST PBC
DELIVER TO : LANDFILL-CLASS II

GROSS WEIGHT	: 61,780 LBS
TARE WEIGHT	: 33,200 LBS
NET WEIGHT	: 27,800 LBS

MATERIAL

160 - BT-TIRES - PASSENGER	\$
13.90 TN @ \$75.00/TN	
SUBTOTAL:	\$1,042.50

PAYMENT METHOD(S):
Cash \$1,042.50
Cash \$

CHANGE:



**SOLID WASTE AUTHORITY
OF PALM BEACH COUNTY**

7501 N. JOG RD
WEST PALM BEACH, FL 33412

PHONE 561-640-4000

DATE: 03/29/2021 TIME: 11:38 AM

TICKET # 70061444
HOLD # H07-130651

DATE	TIME	OpID	Lane
IN: 03/29/2021	11:38 AM	RR	2A
OUT: 03/29/2021	12:08 PM	MMC	3A

CUSTOMER # : 999999
CUSTOMER NAME : CASH CUSTOMER
TRUCK DECAL # : H07-130651
TRAILER DECAL#:

ORIGIN : AA -DIST 1 - NORTHEAST PBC
DELIVER TO : REF # 2

GROSS WEIGHT	: 23,180 LBS	11.59 TN
TARE WEIGHT	: 13,820 LBS	6.91 TN
NET WEIGHT	: 9,360 LBS	4.68 TN

MATERIAL

160 - BT-TIRES - PASSENGER	\$351.00
4.68 TN @ \$75.00/TN	
SUBTOTAL:	\$351.00

TOTAL:	\$351.00
PAYMENT METHOD(S):	
Cash	\$400.00

CHANGE: \$49.00



**SOLID WASTE AUTHORITY
OF PALM BEACH COUNTY**

7501 N. JOG RD
WEST PALM BEACH, FL 33412

PHONE 561-640-4000

SITE: Renewable Energy Facility - Plant

TICKET # 70061559
HOLD # H07-129648

DATE	TIME	OpID	Lane
IN: 03/01/2021	12:01 PM	AS	2A
OUT: 03/01/2021	12:25 PM	AS	3A

CUSTOMER # : 999999
CUSTOMER NAME : CASH CUSTOMER
TRUCK DECAL # : H07-129648
TRAILER DECAL#:

ORIGIN : AA -DIST 1 - NORTHEAST PBC
DELIVER TO : REF # 2

GROSS WEIGHT	: 22,900 LBS	11.45 TN
TARE WEIGHT	: 13,980 LBS	6.99 TN
NET WEIGHT	: 8,920 LBS	4.46 TN

MATERIAL

160 - BT-TIRES - PASSENGER	\$351.00
4.46 TN @ \$75.00/TN	
SUBTOTAL:	\$351.00

TOTAL:	\$351.00
PAYMENT METHOD(S):	
Cash	\$400.00

CHANGE: \$49.00



SOLID WASTE AUTHORITY
OF PALM BEACH COUNTY
7501 N. JOG RD
WEST PALM BEACH, FL 33412
PHONE 561-640-4000

SITE: Renewable Energy Facility - Plant

TICKET # 70052740
HOLD # H07-128916

DATE	TIME	OpID	Lane
IN: 02/04/2021	11:37 AM	MK	2A
OUT: 02/04/2021	01:23 PM	MK	3A

CUSTOMER # : 999999
CUSTOMER NAME : CASH CUSTOMER
TRUCK DECAL # : H07-128916
TRAILER DECAL#:

ORIGIN : AA -DIST 1 - NORTHEAST PBC
DELIVER TO : REF # 2

GROSS WEIGHT	: 22,460 LBS	11.23 TN
TARE WEIGHT	: 17,760 LBS	6.88 TN
NET WEIGHT	: 4,700 LBS	4.35 TN

MATERIAL

160 - BT-TIRES - PASSENGER	\$326.25
4.35 TN @ \$75.00/TN	
SUBTOTAL:	\$326.25

PAYMENT METHOD(S):
Cash \$380.00

CHANGE: \$53.75



SOLID WASTE AUTHORITY
OF PALM BEACH COUNTY
7501 N. JOG RD
WEST PALM BEACH, FL 33412
PHONE 561-640-4000

SITE: Renewable Energy Facility - Plant

TICKET # 70053965
HOLD # H07-129038

DATE	TIME	OpID	Lane
IN: 02/08/2021	03:03 PM	SFR	2A
OUT: 02/08/2021	03:45 PM	SFR	3A

CUSTOMER # : 999999
CUSTOMER NAME : CASH CUSTOMER
TRUCK DECAL # : H07-129038
TRAILER DECAL#:

ORIGIN : AA -DIST 1 - NORTHEAST PBC
DELIVER TO : REF # 2

GROSS WEIGHT	: 22,940 LBS	11.47 TN
TARE WEIGHT	: 13,840 LBS	6.92 TN
NET WEIGHT	: 9,100 LBS	4.55 TN

MATERIAL

160 - BT-TIRES - PASSENGER	\$341.25
4.55 TN @ \$75.00/TN	
SUBTOTAL:	\$341.25

PAYMENT METHOD(S):
Cash \$400.00

CHANGE: \$58.75



SOLID WASTE AUTHORITY
OF PALM BEACH COUNTY
7501 N. JOG RD
WEST PALM BEACH, FL 33412
PHONE 561-640-4000

SITE: Renewable Energy Facility - Plant

TICKET # 70059200
HOLD # H07-129453

DATE	TIME	OpID	Lane
IN: 02/23/2021	10:06 AM	GR	2A
OUT: 02/23/2021	10:38 AM	GR	3A

CUSTOMER # : 999999
CUSTOMER NAME : CASH CUSTOMER
TRUCK DECAL # : H07-129453
TRAILER DECAL#:

ORIGIN : AA -DIST 1 - NORTHEAST PBC
DELIVER TO : REF # 2

GROSS WEIGHT	: 23,160 LBS	11.58 TN
TARE WEIGHT	: 13,980 LBS	6.99 TN
NET WEIGHT	: 9,180 LBS	4.59 TN

MATERIAL

160 - BT-TIRES - PASSENGER	\$344.25
4.59 TN @ \$75.00/TN	
SUBTOTAL:	\$344.25

PAYMENT METHOD(S):
Cash \$400.00

CHANGE: \$55.75

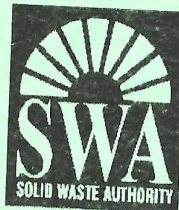

SOLID WASTE AUTHORITY
OF PALM BEACH COUNTY
7501 N. JOG RD
WEST PALM BEACH, FL 33412
PHONE 561-640-4000

SITE: Renewable Energy Facility - Plant

TICKET # 70044664
HOLD # H07-128251

DATE	TIME	OpID	Lane
IN: 01/14/2021	03:56 PM	MMI	2A
OUT: 01/14/2021	04:24 PM	MMI	3A

CUSTOMER # : CASH
CUSTOMER NAME : CASH CUSTOMER
TRUCK DECAL # : H07-128251
TRAILER DECAL#:

ORIGIN : AA -DIST 1 - NORTHEAST PBC
DELIVER TO : REF # 2

GROSS WEIGHT	: 23,920 LBS	11.96 TN
TARE WEIGHT	: 13,920 LBS	6.96 TN
NET WEIGHT	: 10,000 LBS	5.00 TN

MATERIAL

160 - BT-TIRES - PASSENGER	\$375.00
5.00 TN @ \$75.00/TN	
SUBTOTAL:	\$375.00

PAYMENT METHOD(S):
Cash \$320.00
Cash \$60.00

CHANGE: \$5.00



SOLID WASTE AUTHORITY
OF PALM BEACH COUNTY
7501 N. JOG RD
WEST PALM BEACH, FL 33412
PHONE 561-640-4000

SITE: Renewable Energy Facility - Plant

TICKET # 70047440
HOLD # H07-128477

DATE	TIME	OpID	Lane
IN: 01/21/2021	03:42 PM	GE	2A
OUT: 01/21/2021	04:30 PM	GE	3A

CUSTOMER # : 999999
CUSTOMER NAME : CASH CUSTOMER
TRUCK DECAL # : H07-128477
TRAILER DECAL#:

ORIGIN : AA -DIST 1 - NORTHEAST PBC
DELIVER TO : REF # 2

GROSS WEIGHT	: 22,160 LBS	11.08 TN
TARE WEIGHT	: 10,640 LBS	6.82 TN
NET WEIGHT	: 11,520 LBS	4.26 TN

MATERIAL

160 - BT-TIRES - PASSENGER	\$319.50
4.26 TN @ \$75.00/TN	
SUBTOTAL:	\$319.50

TOTAL: \$319.50
PAYMENT METHOD(S):
Cash \$340.00

CHANGE: \$20.50

Tires In & Out April 2021			
Date/Location	Import- Bob's Tire (lbs)	Export- Domestic (lbs)	Export - International (lbs)
4/1/21	0	3,000	0
4/5/21	50,000	0	25,000
04/06/2021	25,000	10,000	25,000
04/07/2021	25,000	2, 000	0
04/12/2021	25,000	6,000	25,000
04/13/2021	0	4,000	25,000
4/19/21	50,000	0	0
4/20/2021	25,000	18,000	25,000
4/21/2021	0	0	25,000
4/28/2021	25,000	25,000	25,000
4/29/2021	25,000	0	0

Tires In & Out May 2021			
Date/Location	Import- Bob's Tire (lbs)	Export- Domestic (lbs)	Export - International (lbs)
5/3/21	25,000	2500	0
5/4/21	0	25,000	25,000
05/06/2021	0	25,000	0
05/07/2021	0	0	25,000
05/10/2021	25,000	2,000	25,000
05/11/2021	50,000	0	25,000
5/15/21	25,000	2, 500	0
5/17/2021	25,000	16,000	0
5/21/2021	25,000	0	25,000
5/22/2021	25,000	25,000	0
5/24/2021	25,000	0	0
5/25/2021	50,000	15,000	4,000
5/26/2021	25,000	0	25,000
5/27/2021	0	25,000	0
5/29/2021	25,000	0	25,000



CITY OF RIVIERA BEACH FIRE PREVENTION & INSPECTIONS

600 WEST BLUE HERON BLVD. - RIVIERA BEACH, FLORIDA 33404
O-(561)845-4106 F-(561)845-4137



Occupant Name: New & Used Wholesale Tires, Inc.
Address: 1500 West 15th Street
City: Riviera Beach
Suite:
Inspection Date: 6/14/2021 (Initial Insp. Date: 4/26/2019)
InspectionType: Reinspection #14 (Business)
Inspected By: Edward Jones

Insp. Result	Location	Code Set	Code
Fail - Cleared		FL NFPA 01 2015 Chapter 4 General Requirements	4.5.8.1 - Continuously maintained - device, equipment, system
	✓	Cleared on 6/14/2021	
Fail - Cleared		FL NFPA 01 2015 Chapter 11 Building Services	11.1.2.1 - Electric, installation and maintenance
	✓	Cleared on 6/14/2021	
Fail - Cleared		FL NFPA 01 2015 Chapter 11 Building Services	11.1.2.3 - Electrical Wiring - Abandoned electrical wiring
	✓	Cleared on 6/14/2021	
Fail - Cleared		FL NFPA 01 2015 Chapter 11 Building Services	11.1.7.3.1 - Breakers shall be legibly marked.
	✓	Cleared on 6/14/2021	
Fail - Cleared		FL NFPA 01 2015 Chapter 11 Building Services	11.1.8 - Open Electrical Boxes
	✓	Cleared on 6/14/2021	
Fail - Cleared		FL NFPA 01 2015 Chapter 13 Fire Protection Systems	13.1.2 - Fire protection system testing and maintenance - property owner responsibility.
	✓	Cleared on 6/14/2021	
Fail - Cleared		FL NFPA 01 2015 Chapter 13 Fire Protection Systems	13.3.3.2 - Sprinkler system shall be inspected, tested, and maintained.
	✓	Cleared on 6/14/2021	
Fail - Cleared		FL NFPA 01 2015 Chapter 13 Fire Protection Systems	13.3.3.5.1.5.4 - Sprinkler - provide spare sprinkler head(s) per code.
	✓	Cleared on 6/14/2021	
Fail - Cleared		FL NFPA 01 2015 Chapter 13 Fire Protection Systems	13.3.3.5.1.5.5 - Sprinkler- Sprinkler wrench required



Cleared on 6/14/2021

Fail - Cleared

FL NFPA 101 2015
Chapter 4 General

4.6.12.1 - Must Maintain all systems, equipment, egress etc.



Cleared on 6/14/2021

Thank you for your cooperation in keeping your business and our community safe! If you have any questions, please contact the Fire Prevention & Inspections office at (561) 845-4106.

Ref: 210-4547

EMERGENCY PREPAREDNESS MANUAL

New & Used Wholesale Tires, Inc.
1200 West 15th Street
Riviera Beach, Palm Beach County, Florida

Emergency Response Coordinator: Waleed Hawa

Work: 561-844-4821

Mobile: 954-336-6937

Emergency Services Contact Information:

Riviera Beach Fire Department	911
600 West Blue Heron Boulevard	(Non-Emergency) 561-845-4110
Riviera Beach Police Department	911
	(Non-Emergency) 561-845-4123
Electric Provider: FPL	866-263-9185
Palm Beach County Health Department	561-840-3137
Palm Beach County Emergency Management	561-712-6400

CONTINGENCY PLAN ACTION STEPS: These are the specific steps the owner or operator of a Waste Tire Processing Operation or Storage Site employees will take in response to site emergencies.

Fire or Explosion: In the event of a fire, explosion, or other emergency, the emergency response coordinator will:

- Evacuate all workers from the processing operation. Note: Small fires may be addressed by facility personnel before they grow beyond control.
- Notify emergency services listed in this plan.

Note: Fire Extinguishers are located at each entrance/exit to the facility and the facility maintains an automatic sprinkler system installed in compliance with "The Standard for Storage of Rubber Tires," NFPA 231D.

Run-Off Resulting from Fire Explosion: In the event of a fire, explosion, or other emergency, the emergency response coordinator will control or contain the flow of contaminated run-off by taking the following steps:

- Minimizing outdoor storage of tires and maintaining solid barrier at the base of the fencing bordering the outdoor tire storage area.

Mosquitoes Breeding in Waste Tires:

- Mosquito control will be done by draining accumulated water from all waste tires as often as necessary.
- Tires will not be stored outdoors longer than 7 days.
- Contact the Palm Beach County Health Department listed in this plan if control of water accumulation is ineffective, or if mosquitos are found breeding in waste tires.

Note: Within two weeks of any emergency, the operator of the site shall submit to the Florida Department of Environmental Protection (FDEP) a written report on the emergency. The report shall describe the origins of the emergency, the actions that were taken to deal with the emergency, the results of the actions that were taken, and an analysis of the success or failure of the actions.