

# ANGELO'S RECYCLED MATERIALS

P.O. BOX 1493  
LARGO, FL 33770



87895  
11-2009

Dept. Of Environmental Protection  
MAR 02 2010  
Southwest District

|           |              |                    |       |              |                    |
|-----------|--------------|--------------------|-------|--------------|--------------------|
| APOPKA    | 407.290.8010 | 407.290.8115 (FAX) | TAMPA | 813.903.0588 | 813.632.9157 (FAX) |
| DADE CITY | 352.567.7676 | 352.567.9448 (FAX) | LARGO | 727.581.1544 | 727.586.5676 (FAX) |

February 26, 2010

Ms. Susan Pelz, P.E.  
Solid Waste Section Manager  
Florida Department of Environmental Protection – Southwest District  
13051 North Telecom Parkway  
Temple Terrace, FL 33637

RE: Angelo's Recycled Materials  
Enterprise Class III Landfill, Permit No.: 177982-002-SO  
Specific Condition C.13.c - Topographic Survey and Disposal Capacity Estimate

Dear Ms. Pelz:

This letter report is provided to the Department as required by Specific Condition C.13.c of the facility Operations Permit. A new topographic survey (signed and sealed) showing the top of the active fill areas was completed by Simmons and Beall, Inc. on February 8, 2010 and is enclosed.

To date Cells 1, 2, 3, 4, 5, and 15 have been constructed, certified by the Department, and have accepted Class III materials. Since the time of the last topographic survey (dated 03/10/09 and submitted to the Department with last years estimate) disposal operations have primarily occurred in Cells 3 and 4. An estimate of the volume (airspace) between the two referenced topographic surveys was performed and indicates that approximately 219,000 cy of airspace was consumed.

The remaining airspace capacity of the permitted landfill is estimated to be approximately 567,000 cy, which will take approximately 2.6 years to fill assuming the current annual disposal rate remains constant.

If you have any questions, please feel free to call me at (352) 339-1408.

Sincerely,

A handwritten signature in blue ink that reads "John P. Arnold".

John P. Arnold, P.E.

Enclosure

xc: Dominic Iafrate  
Jeff Rogers  
Gary Bucholz

# ANGELO'S RECYCLED MATERIALS ENTERPRISE ROAD FACILITIES

SECTION 8 TOWNSHIP 25 SOUTH RANGE 22 EAST  
PASCO COUNTY, FLORIDA

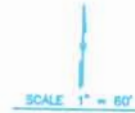

THE ELEVATIONS SHOWN HEREON ARE BASED ON THE NATIONAL GEODETIC REFERENCE SYSTEM OF 1983 AND REFERENCED TO U.S.M.S. BENCHMARK # 2406 AND BENCHMARK MARKS LOCATED ON THE NORTH SIDE OF JOHNSON ROAD AND THE WEST-SOUTH-WEST LINE OF THE OLD HIGHWAY APPROXIMATELY TWO MILES NORTH OF DADE CITY, FLORIDA.

THE SITE BENCHMARK IS LOCATED ON THE NORTH SIDE OF ENTERPRISE ROAD APPROXIMATELY 75 FEET WEST OF THE ENTRANCE TO ANGELO'S RECYCLED MATERIALS LAND FILL, BEING A SURVEY ROD AND CAP NO. 10828 IN THE CENTER OF AN AERIAL PANEL WITH AN ELEVATION OF 142.34 FEET.

I HEREBY CERTIFY THAT THE INFORMATION CONTAINED ON THIS PUBLICATION WAS OBTAINED UNDER MY SUPERVISION ON FEBRUARY 23, 2010 AND IS A TRUE REPRESENTATION OF THE ORIGINAL ELEVATION DATA ON SAID DATA.

Southwest District  
MAR 02 2010  
Dept. Of Environmental Protection

| NO. | DESCRIPTION | DATE | BY  |
|-----|-------------|------|-----|
| 1   | ...         | ...  | ... |
| 2   | ...         | ...  | ... |
| 3   | ...         | ...  | ... |
| 4   | ...         | ...  | ... |
| 5   | ...         | ...  | ... |
| 6   | ...         | ...  | ... |
| 7   | ...         | ...  | ... |
| 8   | ...         | ...  | ... |
| 9   | ...         | ...  | ... |
| 10  | ...         | ...  | ... |

PREPARED BY  
ANGELO'S RECYCLED MATERIALS  
NOT VALID UNLESS SIGNED AND DATED HERE



# ANGELO'S RECYCLED MATERIALS ENTERPRISE ROAD FACILITIES

SECTION 8 TOWNSHIP 25 SOUTH RANGE 22 EAST  
PASCO COUNTY, FLORIDA



SCALE 1" = 60'

THE ELEVATIONS SHOWN HEREON ARE BASED ON THE NATIONAL GEODETIC VERTICAL DATUM OF 1929 AND REFERENCED TO U.S.G.S. BENCHMARK # Q-56, SAID BENCHMARK BEING LOCATED ON THE NORTH SIDE OF JORDAN ROAD AND THE WEST RIGHT-OF-WAY LINE OF THE CSX RAILROAD APPROXIMATELY TWO MILES NORTH OF DADE CITY, FLORIDA.

THE SITE BENCHMARK IS LOCATED ON THE NORTH SIDE OF ENTERPRISE ROAD APPROXIMATELY 75 FEET WEST OF THE ENTRANCE TO ANGELO'S RECYCLED MATERIALS LAND FILL, BEING A 5/8" IRON ROD AND CAP NO. LB6382 IN THE CENTER OF AN AERIAL PANEL WITH AN ELEVATION OF 148.94 FEET.

I HEREBY CERTIFY THAT THE INFORMATION CONTAINED ON THIS PUBLICATION WAS OBTAINED UNDER MY DIRECTION ON MARCH 11, 2009 AND IS A TRUE REPRESENTATION OF THE GROUND ELEVATIONS EXISTING ON SAID DATE.

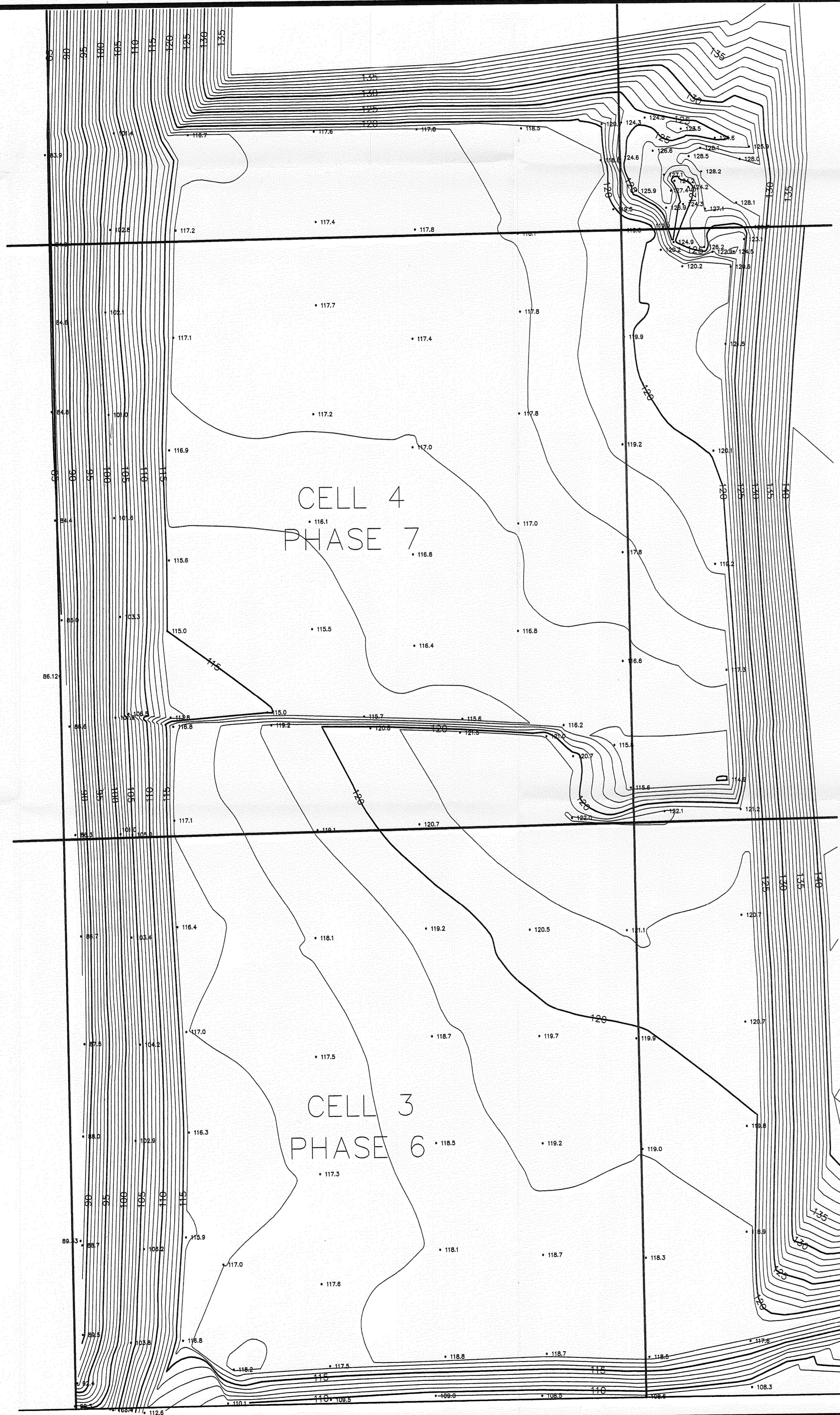

PREPARED BY: *[Signature]*  
BOBBY W. SIMMONS  
PROFESSIONAL LAND SURVEYOR  
FLORIDA PLS. CERT. NO. 3763  
FLORIDA LB CERT. NO. 6382  
NOT VALID UNLESS IMPRINTED WITH RAISED SEAL

| GENERAL LEGEND |                                | SIMMONS & BEALL, INC.<br>SURVEYING & MAPPING   |                   |
|----------------|--------------------------------|--|-------------------|
| (D)            | - Deed or Description          | <p>P.O. BOX 1297<br/>12216 HWY. 301 S.<br/>DADE CITY, FLORIDA 33526<br/>(352) 567-0048<br/>FAX (352) 567-0675<br/>LB NUMBER 6382</p> |                   |
| CM             | - Concrete Monument            |  |                   |
| POB            | - Point of Beginning           |  |                   |
| P.C.P.         | - Permanent Control Point      |  |                   |
| P.R.M.         | - Permanent Reference Monument |  |                   |
| R/W            | - Right of Way                 |  |                   |
| RRS            | - Railroad Spike               |  |                   |
| N&D            | - Nail and Disk                |  |                   |
| (C)            | - Computed Data                |  |                   |
| P.C.           | - Point of Curvature           |  |                   |
| P.T.           | - Point of Tangency            |  |                   |
| IP             | - Iron Pipe                    |  |                   |
| (P)            | - Plot                         |  |                   |
| FD             | - Found                        |  |                   |
| S              | - Set                          |  |                   |
| (NR)           | - Non Radial                   |  |                   |
| REVISIONS      |                                | Date of Survey: 03-10-09   | Drawn by: JLH     |
|                |                                | Date of Plot: 03-11-09   | Checked by: BWS   |
|                |                                | Job Number: 06087-CELL 4&3   | Sheet: ONE OF ONE |
|                |                                | CERTIFIED TO: ANGELO'S RECYCLED MATERIALS  |                   |