

From: [Angela Kurth](#)
To: [Blyden, Tamara](#); [PRP Inspector](#)
Cc: SKISPROPERTIES@GMAIL.COM
Subject: FIELD ACTIVITY NOTIFICATION / Pioneer Brake & Auto Service Center 378510357
Date: Tuesday, April 2, 2024 1:02:18 PM
Attachments: [SITE MAP-PIONEER BRAKE, TALLAHASSEE.pdf](#)
Importance: High

Caution: This is an external email and may be malicious. Please take care when clicking links or opening attachments.

Field Activity Notification
Pioneer Brake & Auto Service Center
539 West Brevard Street
Tallahassee, Leon County, FL
FDEP Facility ID # 37/8510357
Discharge Date (Program/Score): 12/11/2018 (ATRP / 59)
FDEP PO #: C3524E / PRP Ref No.: 798-054D
Field Contact: Bradley Harmon (352/293-1236)

Good Afternoon – Please accept this email as notification of scheduled field activities. CES will be onsite the following dates to perform the field activities as authorized under the referenced PO.

Field Activity Description:	Groundwater Sampling
Field Dates:	May 15-16, 2024

Property Owners: If the business location is tenant occupied, please inform them of the upcoming field work. During the scheduled field date(s), it will be necessary to move any equipment, cars/trucks or any obstructions at the locations of the proposed soil borings and/or monitoring wells and have all gates unlocked for access.

In addition, please forward any as-builts or site maps you have depicting the locations of petroleum storage system layout and/or any underground utilities.

Tenants: The FDEP has an executed access agreement with the Property Owner for the above referenced parcel. Field work will be completed per the referenced PO and under the terms of the signed and executed access agreement.

Thank you –

Thank you -

Angela

Angela Kurth
Sr. Project Manager / Environmental Scientist
CES / CEC JV PRP Contract Manager
700 Desoto Avenue, Brooksville, Florida 34601
(352) 796-3374 office | **(904) 993-3113** mobile
akurth@creativeenvironmental.com email
www.creativeenvironmental.com website

WEST BREVARD STREET

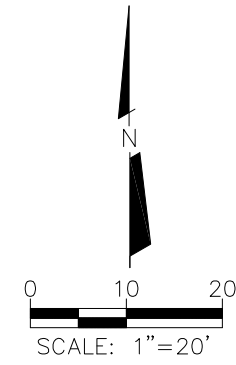

LEGEND

- APPROXIMATE PROPERTY BOUNDARY
- COMPLIANCE WELL (ABANDONED)
- MONITORING WELL
- DEEP MONITORING WELL
- MONIOR WELLS TO BE SAMPLED

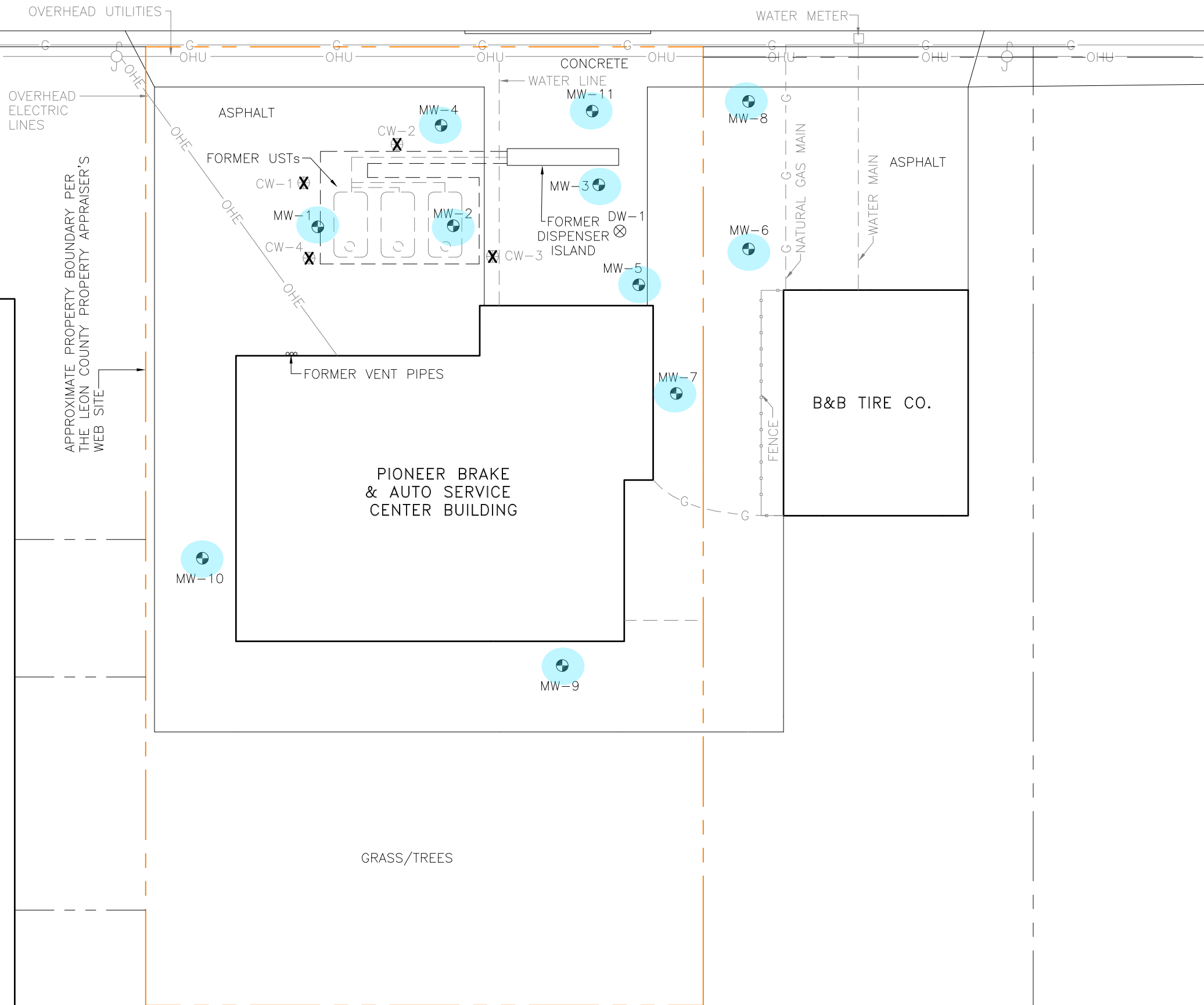

FIGURE NO.	1
FIGURE TITLE	SITE MAP

FACILITY NAME	PIONEER BRAKE & AUTO SERVICE CENTER
FACILITY ADDRESS	539 WEST BREVARD STREET TALLAHASSEE, LEON COUNTY, FL
FACILITY ID NO.	378510357
DATE PREPARED	02-10-23

Creative Environmental Solutions, Inc.
 700 DeSoto Avenue
 Brooksville, Florida 34601
 Phone: (352) 796-3374 Fax: (352) 796-2449

Florida Department of Environmental Protection - Petroleum Restoration Program

FDEP Facility ID#: 378510357

STCM Facility Name: PIONEER BRAKE & AUTO SERVICE CENTER

Any blank fields are not applicable to the scope of work.

WATER SAMPLING TABLE																			
Task #	Well #(s) or Water Sample Location	Frequency (if applicable)	Expedited Turnaround (TA)	Water Level/FP Gauging Only (8-7.)	# MWs Sampled (8-1./8-2.)	(9-29.) BTEX + MTBE + VOHs	(9-30.) PAHs	(9-36.) TRPH (FL-PRO)	(9-41.) Lead, Total	(9-27.) BTEX + MTBE									
1	MW-1	Once			1	1	1	1											
1	MW-2	Once			1	1	1	1											
1	MW-3	Once			1	1	1	1											
1	MW-4	Once			1	1	1	1											
1	MW-5	Once			1	1	1	1											
1	MW-6	Once			1	1	1	1											
1	MW-7	Once			1	1	1	1											
1	MW-8	Once			1	1	1	1											
1	MW-9	Once			1	1	1	1											
1	MW-10	Once			1	1	1	1											
1	MW-11	Once			1	1	1	1											
1	DW-1	Once			1	1	1	1											
2	IDW	Once							1	1									
2	Newly Deep Well	Once			1	1	1	1	1										
2	Newly Deep Well	Once			1	1	1	1	1										
2	Newly Deep Well	Once			1	1	1	1	1										
2	Newly Deep Well	Once			1	1	1	1	1										
Task 1 Subtotal				0	12	12	12	12	0	0	0	0	0	0	0	0	0	0	0
Task 2 Subtotal				0	4	4	4	4	5	1	0	0	0	0	0	0	0	0	0
GRAND TOTALS				0	16	16	16	16	5	1	0	0	0	0	0	0	0	0	0