PERMA-FIX OF FT. LAUDERDALE, INC.

**USED OIL PROCESSING FACILITY PERMIT
APPLICATION**

EPA ID NUMBER FLD 981 018 773

April 15, 1997

SUBMITTED BY:

PERMA-FIX
ENVIRONMENTAL SERVICES

Perma-Fix of Ft. Lauderdale, Inc.
3701 S.W. 47th Avenue - Davie, FL 33314 - 954/583-3795 - Fax 954/583-8017

SW 36th STREET (OAKES ROAD)

SW 47th AVENUE

- SITE LIGHTING SPECIFICATIONS**
- ILLUMINATION SHALL PROVIDE AN AVERAGE OF ONE FOOT CANDLE EQUAL TO ONE LUMEN PER SQUARE FOOT
 - ALL LIGHTING TO BE 250 WAT HIGH-PRESSURE SODIUM VAPOR LIGHTS WITH TIME CLOCK AND LIGHT SENSORS. LIGHT FIXTURES TO BE F.P. & L. APPROVED
 - LIGHTS TO OPERATE AT LEAST 30 MINUTES AFTER CLOSING OF BUSINESS. TIME CLOCK TO HAVE MANUAL OVERRIDE SWITCH
 - SHADE LIGHTING IN A MANNER TO LIMIT SPILLOVER ONTO ADJACENT PROPERTY AND RIGHT OF WAYS
 - ALL STREET LIGHTING IS EXISTING
 - ALL LIGHTING FIXTURES TO BE CONNECTED TO EXISTING A SEPARATE BUILDING PERMIT AND DETAIL OF CONNECTION WILL BE REQUIRED AT THE TIME OF INSTALLATION

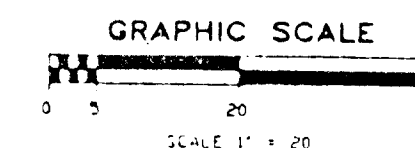
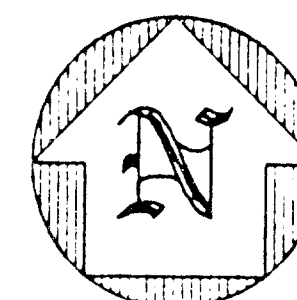

Notes & Attach. Inc. all levels and details. For proposed slopes, grades or measurements. All figures to be verified by the contractor in the field.

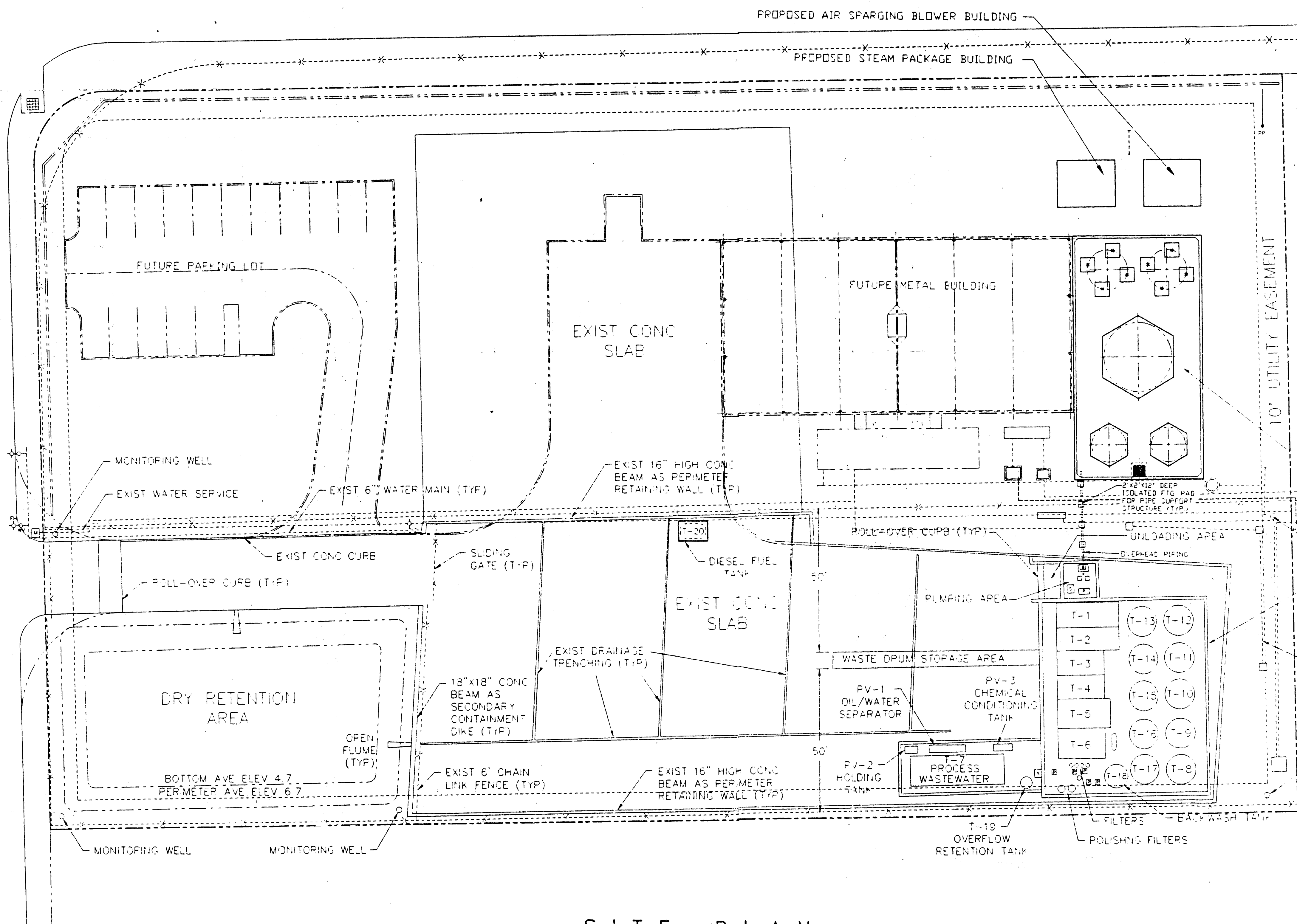

S I T E P L A N

SCALE: 1" = 20'

LEGAL DESCRIPTION:

THE NORTH 167.00 FEET OF TRACT 5 OF "JOHN W. NEWMAN'S SURVEY" OF SECTION 25, TOWNSHIP 50 SOUTH, RANGE 41 EAST, AS RECORDED IN PLAT BOOK 2 PAGE 26 OF THE PUBLIC RECORDS OF DADE COUNTY, FLORIDA, LESS THE NORTH 15.00 FEET AND LESS THE WEST 15.00 FEET FOR ROAD RIGHT-OF-WAY AND LESS THEREFROM THE EAST 195.00 FEET THEREOF AND LESS ALL THAT EXTERNAL AREA LYING NORTHWESTERLY OF THE ARC FORMED BY A 2500 FOOT RADIUS WHICH IS TANGENT TO A LINE 1500 FEET EAST OF AND PARALLEL TO THE WEST BOUNDARY OF TRACT 5, SECTION 25, TOWNSHIP 50 SOUTH, RANGE 41 EAST, NEWMAN'S SURVEY, ACCORDING TO THE PLAT THEREOF, AS RECORDED IN PLAT BOOK 2 PAGE 26 OF THE PUBLIC RECORDS OF DADE COUNTY, FLORIDA AND TANGENT TO A LINE 15.00 SOUTH OF AND PARALLEL TO THE NORTH BOUNDARY OF SAID TRACT 5.

TOGETHER WITH:

THE SOUTH 104.00 FEET OF THE NORTH 271.00 FEET OF TRACT 5, "JOHN W. NEWMAN'S SURVEY" OF SECTION 25, TOWNSHIP 50 SOUTH, RANGE 41 EAST, AS RECORDED IN PLAT BOOK 2 PAGE 26 OF THE PUBLIC RECORDS OF DADE COUNTY, FLORIDA, LESS THE EAST 195.00 FEET AND LESS THE WEST 15.00 FEET FOR RIGHT-OF-WAY.

SAID LANDS SITUATE, LYING AND BEING IN THE TOWN OF DAVIE, BROWARD COUNTY, FLORIDA, AND CONTAINING 111,000 SQUARE FEET OR 2.5482 ACRES MORE OR LESS.

SITE DATA AND REQUIREMENTS

SITE AREA (GROSS AND NET)	(2.54 ACRES)	110,681 SF = 100% COVERAGE
NEW BUILDINGS TOTAL		10,280 SF = 9.3%
OFFICE BUILDING	3,080 SF = 2.8%	
STORAGE CANOPY	7,200 SF = 6.5%	
NEW CONCRETE		10,545 SF = 9.5%
NEW PAVING		8,512 SF = 7.7%
EXISTING CONCRETE		28,530 SF = 25.9%
TOTAL IMPERVIOUS		57,967 SF = 52.4%
TOTAL PERVIOUS (LANDSCAPED)		52,714 SF = 47.6%

PARKING CALCULATIONS/REQUIREMENTS

REQUIREMENTS:
OFFICE USES $\frac{1 \text{ SPACE}}{200 \text{ SF BLDG}} \times 3080 \text{ SF BLDG} = 15 \text{ SPACES}$

PROVIDED SPACES = 17 > 15 MEETS REQUIREMENTS
BREAKDOWN (16) STD = 10' WIDE X 18' DEEP + (1) HANDICAP = 12' W X 18' D

DRAINAGE CALCULATIONS

DESIGN CRITERIA = BROWARD COUNTY SURFACE WATER MANAGEMENT REQUIRED ON SITE STORAGE OF THE FIRST ONE (1) INCH OF RAINFALL

NEGLECT SOIL STORAGE WHILE GIVING A 50% CREDIT FOR DRY RETENTION IN SWALES

REQUIRED STORAGE = $110,681 \text{ FT}^2 \times 1.12 \text{ IN} \text{ FT} = 9,223 \text{ CU FT}$
50% CREDIT = $9,223 \text{ CU FT} \times 0.50 = 4,612 \text{ CU FT}$

VOLUME OF SWALE STORAGE
EXISTING RETENTION POND = 7,500 CU FT
NEW SWALE #1 = 2,500 CU FT
NEW SWALE #2 = 1,200 CU FT
NEW SWALE #3 = 850 CU FT
TOTAL STORAGE = 13,540 CU FT > 4,612 CU FT

CURRENT AND PROPOSED ZONING = M-4 (TRACENDIA VILLAGE)
ZONING OF BOTH ADJACENT LOTS = M-4 (TRACENDIA VILLAGE)

SCALE	1" = 20' - 0"
DRAWING NUMBER	7101013
DATE	11/23/95
DRAWN BY	D.A.M./C.M.
REVISION	

PLANS FOR SITE PLAN
Project - fix of Ft. Lauderdale
3670 SW 47th Avenue
Davie, Florida 33314
SHEET NO. 1 OF 1