



Universal Waste & Transit, Inc.

A Division of City Management Corporation

9280 Bay Plaza Blvd.
Suite 707
Tampa, FL 33619-4453
(813) 623-5302
FAX: (813) 628-0842

FACSIMILE TRANSMISSION

D.E.P.

AUG 17 1995

SOUTHWEST DISTRICT
TAMPA

DATE: 8/11/95

TO: Charles Kovach

FROM: John A. Taylor

NUMBER OF PAGES: _____

(Including Cover Sheet)

MESSAGE: Enclosed is the information you requested.
Included is relevant information previously
submitted to Roger Evans. Do not hesitate to
call me should you have any questions.



Universal Waste & Transit, Inc.

A Division of City Management Corporation

9280 Bay Plaza Blvd.
Suite 707
Tampa, FL 33619-4453
(813) 623-5302
FAX: (813) 628-0842

D.E.P.

AUG 17 1995

SOUTHWEST DISTRICT
TAMPA

November 16, 1994

Mr. Roger Evans
Department of Environmental Protection
3804 Coconut Palm Drive
Tampa, Florida 33619

Dear Mr. Evans:

Enclosed is the information you requested concerning the groundwater monitoring program at UWT. Included is a one-page summary of our groundwater program and a map of the well locations. The general well information is also listed below:

<u>WELL NO.</u>	<u>INSTALLATION DATE</u>	<u>GENERAL LOCATION</u>	<u>1994 Data Renumbering</u>
MW1	October 20, 1989	Northeast	MW 3
MW2	October 20, 1989	Southeast	MW 1
MW2A	May 23, 1994	Northwest	MW 2A
MW3	October 20, 1989	Northwest	N/A
MW4	May 23, 1994	Southwest	MW 4

If you have any questions, please do not hesitate to call me.

Sincerely,

John A. Taylor
General Manager

The UWT facility is in a heavily industrialized area (Orient Park) in Tampa, Florida. The previous use of the UWT property was residential (one residence) and vacant land. There is significant documented groundwater contamination in the area. Two NPL (Superfund) sites adjacent to the UWT facility are being investigated and remediated under the direction of the EPA. There are also several other sites or former sites potentially contributing to the documented Orient Park groundwater contamination.

UWT voluntarily monitors the groundwater from its property for liability protection. Several regulated compounds have been detected by the UWT groundwater monitoring program. All hazardous waste stored at UWT is in a specially designed totally enclosed storage building with over 5,000 gallons of secondary containment. There have been no known releases of hazardous waste to the environment at the UWT facility. There is no statistical correlation between downgradient and upgradient analytical results to confirm contribution to any groundwater contamination by UWT. It is the belief of UWT that any elevated levels of regulated compounds detected in the groundwater at the UWT property is either background or the result of offsite migration from other sites. This is supported by the previously stated information.

The firm PBS&J has been contracted to investigate and document groundwater quality at the UWT property. They have recommended the re-installation of one well and installation of another new well to confirm previous results and further document the migration of offsite regulated materials to the UWT property.

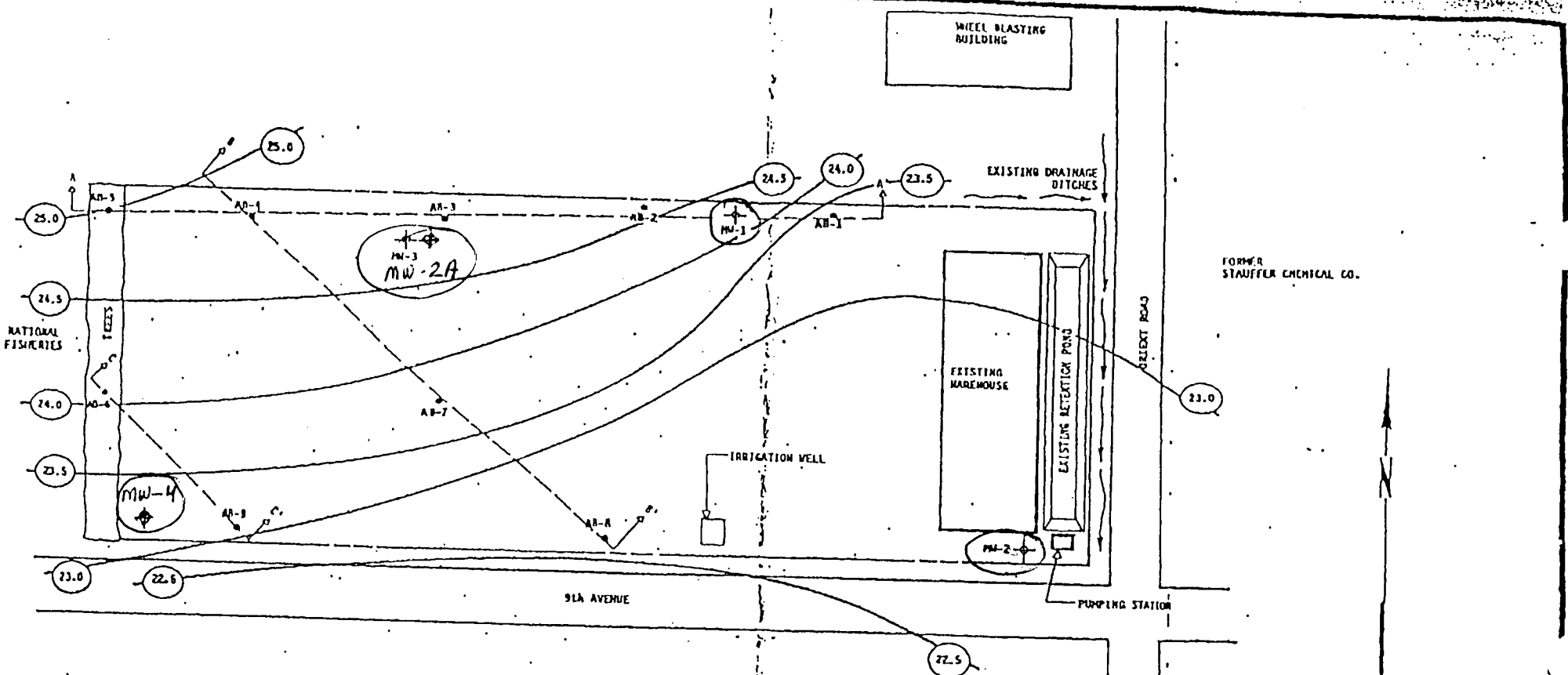

Note: MW numerical changes

MAP	1992 Data	1994 Data
MW1	1	3
MW2	2	1
MW3	3	2
MW4	N/A	4
MW2A	N/A	2A

PROJECT NO: 1106-89-401
 SCALE: 1"=40'
 DRN BY: SAM DATE: 12/27/89
 CHK BY: DA DATE: 12/27/89

Westinghouse Environmental and Geotechnical Services, Inc.
 TAMPA, FLORIDA

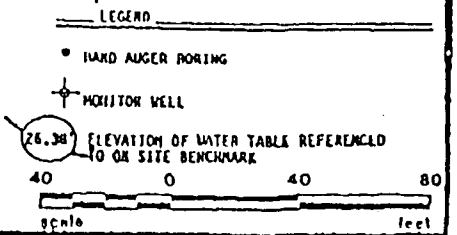

FIGURE 7
 GROUNDWATER TABLE CONTOUR MAP
 UNIVERSAL WASTE & TRANSIT INC.
 TAMPA, FLORIDA



ENSECO-WADSWORTH/ALERT Laboratories

Division of Corning Lab Services, Inc.

5910 Breckenridge Parkway, Suite H Tampa, FL 33610
813-621-0784 FAX 813-623-6021

THIS REPORT COVERS THE CURRENT SITE.

MW 1 SE Retention
2A New NW Fish + Whed b.
3 N Supply Trailer
4 New SW 9th Ave + Fish

ANALYTICAL REPORT

PROJECT NO. 10327.00

UNIVERSAL WASTE

DEDA JOHANSEN

PBS & J

ENSECO-WADSWORTH/ALERT LABORATORIES
Certification Numbers: E84059, HRS84297
FDEP CompQAP: 870270G

Nancy Robertson (signature)

NANCY ROBERTSON
Project Manager

June 28, 1994



ENSECO-WADSWORTH/ALERT
Laboratories

ANALYTICAL METHODS SUMMARY

<u>Parameters</u>	<u>Methods</u>
Pesticides/PCBS	USEPA 608
Volatile Organics	USEPA 624
Polyaromatic Hydrocarbons	USEPA 625
Herbicides	SW846 8150
Silver	MCAWW 200.7
Barium	MCAWW 200.7
Cadmium	MCAWW 200.7
Chromium	MCAWW 200.7
Arsenic	MCAWW 206.2
Lead	MCAWW 239.2
Mercury	MCAWW 245.1
Selenium	MCAWW 270.2

References:

- MCAWW Methods for Chemical Analysis of Water and Wastes, ©EMSL:
Cincinnati, OH: March 1983 and its updates.
- SW846 "Test Methods for Evaluating Solid Waste, Physical/Chemical
Methods", Third Edition, September, 1986.
- USEPA Methods for Organic Chemical Analysis of Municipal and
Industrial Wastewater, 40CFR, Part 136, Appendix A,
October 26, 1984 (and its revisions and amendments)



ENSECO-WADSWORTH/ALERT
Laboratories

SAMPLE SUMMARY

The analytical results of the samples listed below are presented on the following pages:

<u>WO #</u>	<u>LABORATORY ID</u>	<u>SAMPLE IDENTIFICATION</u>
O1290	B4F130054-001	MW-1
O1291	B4F130054-002	MW-2A
O1292	B4F130054-003	MW-3
O1293	B4F130054-004	MW-4



ENSECO-WADSWORTH/ALERT
Laboratories

PBS & J

MW-1

WO #: O1290112
LAB #: B4F130054-001
MATRIX: WATER

DATE SAMPLED: 6/13/94
DATE RECEIVED: 6/13/94

GC Semi-Volatiles

1 OF 2

<u>PARAMETER</u>	<u>RESULT</u> (ug/L)	<u>REPORTING</u> <u>LIMIT</u>	<u>METHOD</u>	<u>EXTRACTION-</u> <u>ANALYSIS DATE</u>	<u>QC</u> <u>BATCH</u>
Aldrin	ND	5.0	USEPA 608	06/18-06/22/94	4169015
alpha-BHC	20	5.0	USEPA 608	06/18-06/22/94	4169015
beta-BHC	ND	5.0	USEPA 608	06/18-06/22/94	4169015
delta-BHC	ND	5.0	USEPA 608	06/18-06/22/94	4169015
gamma-BHC (Lindane)	5.4	5.0	USEPA 608	06/18-06/22/94	4169015
Chlordane	ND	50	USEPA 608	06/18-06/22/94	4169015
4,4'-DDD	ND	5.0	USEPA 608	06/18-06/22/94	4169015
4,4'-DDE	ND	5.0	USEPA 608	06/18-06/22/94	4169015
4,4'-DDT	ND	5.0	USEPA 608	06/18-06/22/94	4169015
Dieldrin	ND	5.0	USEPA 608	06/18-06/22/94	4169015
Endosulfan I	ND	5.0	USEPA 608	06/18-06/22/94	4169015
Endosulfan II	ND	5.0	USEPA 608	06/18-06/22/94	4169015
Endosulfan sulfate	ND	5.0	USEPA 608	06/18-06/22/94	4169015
Endrin	ND	5.0	USEPA 608	06/18-06/22/94	4169015
Endrin aldehyde	ND	5.0	USEPA 608	06/18-06/22/94	4169015
Heptachlor	ND	5.0	USEPA 608	06/18-06/22/94	4169015
Heptachlor epoxide	ND	5.0	USEPA 608	06/18-06/22/94	4169015
Aroclor-1016	ND	50	USEPA 608	06/18-06/22/94	4169015
Aroclor-1221	ND	50	USEPA 608	06/18-06/22/94	4169015
Aroclor-1232	ND	50	USEPA 608	06/18-06/22/94	4169015
Aroclor-1242	ND	50	USEPA 608	06/18-06/22/94	4169015
Aroclor-1248	ND	50	USEPA 608	06/18-06/22/94	4169015
Aroclor-1254	ND	50	USEPA 608	06/18-06/22/94	4169015
Aroclor-1260	ND	50	USEPA 608	06/18-06/22/94	4169015
<u>SURROGATE RECOVERY</u>	<u>%</u>	<u>ACCEPTABLE LIMITS</u>			
Tetrachloro-m-xylene	DIL OUT	(33 - 122)			
Dibutylchloroendate	DIL OUT	(18 - 129)			

NOTE: AS RECEIVED

ND NOT DETECTED AT THE STATED REPORTING LIMIT



ENSECO-WADSWORTH/ALERT
Laboratories

PBS &J

MW-1

WO #: O1290112
LAB #: B4F130054-001
MATRIX: WATER

DATE SAMPLED: 6/13/94
DATE RECEIVED: 6/13/94

----- GC Semi-Volatiles -----

2 OF 2

<u>PARAMETER</u>	<u>RESULT</u> (ug/L)	<u>REPORTING</u> <u>LIMIT</u>	<u>METHOD</u>	<u>EXTRACTION-</u> <u>ANALYSIS DATE</u>	<u>QC</u> <u>BATCH</u>
Toxaphene	ND	250	USEPA 608	06/18-06/22/94	416901:

SURROGATE RECOVERY

%

ACCEPTABLE LIMITS

Tetrachloro-m-xylene	DIL OUT	(33 - 122)
Dibutylchlorendate	DIL OUT	(18 - 129)

NOTE: AS RECEIVED

ND NOT DETECTED AT THE STATED REPORTING LIMIT



ENSECO-WADSWORTH/ALERT
Laboratories

PBS &J

MW-1

WO #: O1290110
LAB #: B4F130054-001
MATRIX: WATER

DATE SAMPLED: 6/13/94
DATE RECEIVED: 6/13/94

GC/MS Volatiles

1 OF 2

<u>PARAMETER</u>	<u>RESULT</u> (ug/L)	<u>REPORTING</u> <u>LIMIT</u>	<u>METHOD</u>	<u>EXTRACTION-</u> <u>ANALYSIS DATE</u>	<u>QC</u> <u>BATCH</u>
Acrolein	ND	20	USEPA 624	06/21/94	4173051
Acrylonitrile	ND	20	USEPA 624	06/21/94	4173051
Benzene	ND	2.0	USEPA 624	06/21/94	4173051
Bromodichloromethane	ND	2.0	USEPA 624	06/21/94	4173051
Bromoform	ND	2.0	USEPA 624	06/21/94	4173051
Bromomethane	ND	2.0	USEPA 624	06/21/94	4173051
Carbon tetrachloride	ND	2.0	USEPA 624	06/21/94	4173051
Chlorobenzene	ND	2.0	USEPA 624	06/21/94	4173051
Dibromochloromethane	ND	2.0	USEPA 624	06/21/94	4173051
Chloroethane	ND	2.0	USEPA 624	06/21/94	4173051
2-Chloroethyl vinyl ether	ND	2.0	USEPA 624	06/21/94	4173051
Chloroform	ND	2.0	USEPA 624	06/21/94	4173051
Chloromethane	ND	2.0	USEPA 624	06/21/94	4173051
1,2-Dichlorobenzene	ND	2.0	USEPA 624	06/21/94	4173051
1,3-Dichlorobenzene	ND	2.0	USEPA 624	06/21/94	4173051
1,4-Dichlorobenzene	ND	2.0	USEPA 624	06/21/94	4173051
1,1-Dichloroethane	ND	2.0	USEPA 624	06/21/94	4173051
1,2-Dichloroethane	ND	2.0	USEPA 624	06/21/94	4173051
1,1-Dichloroethene	ND	2.0	USEPA 624	06/21/94	4173051
cis-1,2-Dichloroethene	ND	2.0	USEPA 624	06/21/94	4173051
trans-1,2-Dichloroethene	ND	2.0	USEPA 624	06/21/94	4173051
1,2-Dichloropropane	ND	2.0	USEPA 624	06/21/94	4173051
cis-1,3-Dichloropropene	ND	2.0	USEPA 624	06/21/94	4173051
trans-1,3-Dichloropropene	ND	2.0	USEPA 624	06/21/94	4173051
<u>SURROGATE RECOVERY</u>	<u>%</u>	<u>ACCEPTABLE LIMITS</u>			
1,2-Dichloroethane	110	(78 - 130)			
Toluene-d8	98	(90 - 109)			
Bromofluorobenzene	96	(81 - 117)			

NOTE: AS RECEIVED

ND NOT DETECTED AT THE STATED REPORTING LIMIT



ENSECO-WADSWORTH/ALERT
Laboratories

PBS &J

MW-1

WO #: O1290110
LAB #: B4F130054-001
MATRIX: WATER

DATE SAMPLED: 6/13/94
DATE RECEIVED: 6/13/94

----- GC/MS Volatiles -----

2 OF 2

<u>PARAMETER</u>	<u>RESULT</u> (ug/L)	<u>REPORTING</u> <u>LIMIT</u>	<u>METHOD</u>	<u>EXTRACTION-</u> <u>ANALYSIS DATE</u>	<u>QC</u> <u>BATCH</u>
Ethylbenzene	4.8	2.0	USEPA 624	06/21/94	4173051
Trichlorofluoromethane	ND	2.0	USEPA 624	06/21/94	4173051
Methylene chloride	ND	2.0	USEPA 624	06/21/94	4173051
1,1,2,2-Tetrachloroethane	ND	2.0	USEPA 624	06/21/94	4173051
Tetrachloroethene	ND	2.0	USEPA 624	06/21/94	4173051
Toluene	ND	2.0	USEPA 624	06/21/94	4173051
1,1,1-Trichloroethane	ND	2.0	USEPA 624	06/21/94	4173051
1,1,2-Trichloroethane	ND	2.0	USEPA 624	06/21/94	4173051
Trichloroethene	ND	2.0	USEPA 624	06/21/94	4173051
Vinyl chloride	ND	2.0	USEPA 624	06/21/94	4173051
Xylenes, Total	220	2.0	USEPA 624	06/21/94	4173051

<u>SURROGATE RECOVERY</u>	<u>%</u>	<u>ACCEPTABLE LIMITS</u>
1,2-Dichloroethane	110	(78 - 130)
Toluene-d8	98	(90 - 109)
Bromofluorobenzene	96	(81 - 117)

NOTE: AS RECEIVED

ND NOT DETECTED AT THE STATED REPORTING LIMIT



ENSECO-WADSWORTH/ALERT
Laboratories

PBS &J

MW-1

WO #: O1290109
LAB #: B4F130054-001
MATRIX: WATER

DATE SAMPLED: 6/13/94
DATE RECEIVED: 6/13/94

----- GC/MS Semi-Volatiles -----

<u>PARAMETER</u>	<u>RESULT</u> (ug/L)	<u>REPORTING</u> <u>LIMIT</u>	<u>METHOD</u>	<u>EXTRACTION-</u> <u>ANALYSIS DATE</u>	<u>QC</u> <u>BATCH</u>
Acenaphthene	ND	5.0	USEPA 625	06/18-06/22/94	4169018
Acenaphthylene	ND	5.0	USEPA 625	06/18-06/22/94	4169018
Anthracene	ND	5.0	USEPA 625	06/18-06/22/94	4169018
Benzo(a)anthracene	ND	5.0	USEPA 625	06/18-06/22/94	4169018
Benzo(b)fluoranthene	ND	5.0	USEPA 625	06/18-06/22/94	4169018
Benzo(k)fluoranthene	ND	5.0	USEPA 625	06/18-06/22/94	4169018
Benzo(ghi)perylene	ND	5.0	USEPA 625	06/18-06/22/94	4169018
Benzo(a)pyrene	ND	5.0	USEPA 625	06/18-06/22/94	4169018
Chrysene	ND	5.0	USEPA 625	06/18-06/22/94	4169018
Dibenz(a,h)anthracene	ND	5.0	USEPA 625	06/18-06/22/94	4169018
Fluoranthene	ND	5.0	USEPA 625	06/18-06/22/94	4169018
Fluorene	ND	5.0	USEPA 625	06/18-06/22/94	4169018
Indeno(1,2,3-cd)pyrene	ND	5.0	USEPA 625	06/18-06/22/94	4169018
2-Methylnaphthalene	ND	5.0	USEPA 625	06/18-06/22/94	4169018
Naphthalene	27	5.0	USEPA 625	06/18-06/22/94	4169018
Phenanthrene	ND	5.0	USEPA 625	06/18-06/22/94	4169018
Pyrene	ND	5.0	USEPA 625	06/18-06/22/94	4169018
1-Methylnaphthalene	ND	5.0	USEPA 625	06/18-06/22/94	4169018

SURROGATE RECOVERY

%

ACCEPTABLE LIMITS

Nitrobenzene-d5	72	(22 - 135)
2-Fluorobiphenyl	72	(34 - 140)
Terphenyl-d14	27	(10 - 132)

NOTE: AS RECEIVED

•ND NOT DETECTED AT THE STATED REPORTING LIMIT



ENSECO-WADSWORTH/ALERT
Laboratories

PBS & J

MW-1

WO #: 01290111
LAB #: B4F130054-001
MATRIX: WATER

DATE SAMPLED 6/
DATE RECEIVED 6/

----- GC Semi-Volatiles -----

<u>PARAMETER</u>	<u>RESULT</u> (ug/L)	<u>REPORTING</u> <u>LIMIT</u>	<u>METHOD</u>	<u>EXTRACT</u> <u>ANALYST</u>	<u>QC</u> <u>BATCH</u>
2,4-D	3,600 E	77	SW846 8150	06/20-5/94	41710
2,4,5-TP(Silvex)	ND	7.7	SW846 8150	06/20-5/94	417106

SURROGATE RECOVERY

%

ACCEPTABLE LIMITS

2,4-Dichlorophenoxyacetic acid DIL OUT (40 - 160)

NOTE: AS RECEIVED

ND NOT DETECTED AT THE STATED REPORTING LIMIT

E ESTIMATED RESULT. CONCENTRATION EXCEEDS CALIBRATION RANGE.



ENSECO-WADSWORTH/ALERT
Laboratories

PBS &J

MW-1

WO #: O1290211
LAB #: B4F130054-001
MATRIX: WATER

DATE SAMPLED: 6/13/94
DATE RECEIVED: 6/13/94

----- GC Semi-Volatiles -----

<u>PARAMETER</u>	<u>RESULT</u> (ug/L)	<u>REPORTING</u> <u>LIMIT</u>	<u>METHOD</u>	<u>EXTRACTION-</u> <u>ANALYSIS DATE</u>	<u>QC</u> <u>BATCH</u>
2,4-D	4,100	390	SW846 8150	06/20-06/24/94	417106

SURROGATE RECOVERY

%

ACCEPTABLE LIMITS

2,4-Dichlorophenoxyacetic acid DIL OUT

(40 - 160)

NOTE: AS RECEIVED



ENSECO-WADSWORTH/ALERT
Laboratories

PBS &J

MW-1

WO #: O1290
LAB #: B4F130054-001
MATRIX: WATER

DATE SAMPLED: - 6/13/94
DATE RECEIVED: 6/13/94

----- REQUESTED METALS -----

<u>PARAMETER</u>	<u>RESULT</u>	<u>REPORTING LIMIT</u>	<u>UNIT</u>	<u>METHOD</u>	<u>PREPARATION - ANALYSIS DATE</u>	<u>QC BATCH</u>
Silver	ND	50.0	ug/L	MCAWW 200.7	6/16- 6/21/94	416701
Barium	ND	100	ug/L	MCAWW 200.7	6/16- 6/21/94	416701
Cadmium	ND	5.0	ug/L	MCAWW 200.7	6/16- 6/21/94	416701
Chromium	67.3	50.0	ug/L	MCAWW 200.7	6/16- 6/21/94	416701
Arsenic	112	5.0	ug/L	MCAWW 206.2	6/16/94	416701
Lead	14.6	5.0	ug/L	MCAWW 239.2	6/16/94	416701
Mercury	ND	0.20	ug/L	MCAWW 245.1	6/16- 6/17/94	416701
Selenium	ND	20.0	ug/L	MCAWW 270.2	6/16/94	416701

NOTE: AS RECEIVED

ND NOT DETECTED AT THE STATED REPORTING LIMIT



ENSECO-WADSWORTH/ALERT
Laboratories

PBS &J

MW-2A

WO #: O1291112
LAB #: B4F130054-002
MATRIX: WATER

DATE SAMPLED: 6/13/94
DATE RECEIVED: 6/13/94

GC Semi-Volatiles

1 OF 2

<u>PARAMETER</u>	<u>RESULT</u> (ug/L)	<u>REPORTING</u> <u>LIMIT</u>	<u>METHOD</u>	<u>EXTRACTION-</u> <u>ANALYSIS DATE</u>	<u>QC</u> <u>BATCH</u>
Aldrin	ND	50	USEPA 608	06/18-06/22/94	4169015
alpha-BHC	300	50	USEPA 608	06/18-06/22/94	4169015
beta-BHC	56	50	USEPA 608	06/18-06/22/94	4169015
delta-BHC	82	50	USEPA 608	06/18-06/22/94	4169015
gamma-BHC (Lindane)	120	50	USEPA 608	06/18-06/22/94	4169015
Chlordane	ND	500	USEPA 608	06/18-06/22/94	4169015
4,4'-DDD	ND	50	USEPA 608	06/18-06/22/94	4169015
4,4'-DDE	ND	50	USEPA 608	06/18-06/22/94	4169015
4,4'-DDT	ND	50	USEPA 608	06/18-06/22/94	4169015
Dieldrin	ND	50	USEPA 608	06/18-06/22/94	4169015
Endosulfan I	ND	50	USEPA 608	06/18-06/22/94	4169015
Endosulfan II	ND	50	USEPA 608	06/18-06/22/94	4169015
Endosulfan sulfate	ND	50	USEPA 608	06/18-06/22/94	4169015
Endrin	ND	50	USEPA 608	06/18-06/22/94	4169015
Endrin aldehyde	ND	50	USEPA 608	06/18-06/22/94	4169015
Heptachlor	ND	50	USEPA 608	06/18-06/22/94	4169015
Heptachlor epoxide	ND	50	USEPA 608	06/18-06/22/94	4169015
Aroclor-1016	ND	500	USEPA 608	06/18-06/22/94	4169015
Aroclor-1221	ND	500	USEPA 608	06/18-06/22/94	416901
Aroclor-1232	ND	500	USEPA 608	06/18-06/22/94	416901
Aroclor-1242	ND	500	USEPA 608	06/18-06/22/94	416901
Aroclor-1248	ND	500	USEPA 608	06/18-06/22/94	416901
Aroclor-1254	ND	500	USEPA 608	06/18-06/22/94	416901
Aroclor-1260	ND	500	USEPA 608	06/18-06/22/94	416901
<u>SURROGATE RECOVERY</u>	<u>%</u>	<u>ACCEPTABLE LIMITS</u>			
Tetrachloro-m-xylene	DIL OUT	(33 - 122)			
Dibutylchlorendate	DIL OUT	(18 - 129)			

NOTE: AS RECEIVED

(ND) NOT DETECTED AT THE STATED REPORTING LIMIT



ENSECO-WADSWORTH/ALERT
Laboratories

PBS &J

MW-2A

WO #: O1291112
LAB #: B4F130054-002
MATRIX: WATER

DATE SAMPLED: 6/13/94
DATE RECEIVED: 6/13/94

----- GC Semi-Volatiles -----

2 OF 2

<u>PARAMETER</u>	<u>RESULT</u> (ug/L)	<u>REPORTING</u> <u>LIMIT</u>	<u>METHOD</u>	<u>EXTRACTION-</u> <u>ANALYSIS DATE</u>	<u>QC</u> <u>BATCH</u>
Toxaphene	ND	2,500	USEPA 608	06/18-06/22/94	416901

SURROGATE RECOVERY

%

ACCEPTABLE LIMITS

Tetrachloro-m-xylene
Dibutylchloredate

DIL OUT
DIL OUT

(33 - 122)
(18 - 129)

NOTE: AS RECEIVED

•ND NOT DETECTED AT THE STATED REPORTING LIMIT



ENSECO-WADSWORTH/ALERT
Laboratories

PBS & J

MW-2A

WO #: O1291110
LAB #: B4F130054-002
MATRIX: WATER

DATE SAMPLED: 6/13/94
DATE RECEIVED: 6/13/94

GC/MS Volatiles

1 OF 2

PARAMETER	RESULT (ug/L)	REPORTING LIMIT	METHOD	EXTRACTION- ANALYSIS DATE	QC BATCH
Acrolein	ND	10	USEPA 624	06/20-06/21/94	417205
Acrylonitrile	ND	10	USEPA 624	06/20-06/21/94	417205
Benzene	11	1.0	USEPA 624	06/20-06/21/94	417205
Bromodichloromethane	ND	1.0	USEPA 624	06/20-06/21/94	417205
Bromoform	ND	1.0	USEPA 624	06/20-06/21/94	417205
Bromomethane	ND	1.0	USEPA 624	06/20-06/21/94	417205
Carbon tetrachloride	ND	1.0	USEPA 624	06/20-06/21/94	417205
Chlorobenzene	66	1.0	USEPA 624	06/20-06/21/94	417205
Dibromochloromethane	ND	1.0	USEPA 624	06/20-06/21/94	417205
Chloroethane	ND	1.0	USEPA 624	06/20-06/21/94	417205
2-Chloroethyl vinyl ether	ND	1.0	USEPA 624	06/20-06/21/94	417205
Chloroform	ND	1.0	USEPA 624	06/20-06/21/94	417205
Chloromethane	ND	1.0	USEPA 624	06/20-06/21/94	417205
1,2-Dichlorobenzene	48	1.0	USEPA 624	06/20-06/21/94	417205
1,3-Dichlorobenzene	2.2	1.0	USEPA 624	06/20-06/21/94	417205
1,4-Dichlorobenzene	100	1.0	USEPA 624	06/20-06/21/94	417205
1,1-Dichloroethane	ND	1.0	USEPA 624	06/20-06/21/94	417205
1,2-Dichloroethane	ND	1.0	USEPA 624	06/20-06/21/94	417205
1,1-Dichloroethene	ND	1.0	USEPA 624	06/20-06/21/94	417205
cis-1,2-Dichloroethene	ND	1.0	USEPA 624	06/20-06/21/94	417205
trans-1,2-Dichloroethene	ND	1.0	USEPA 624	06/20-06/21/94	417205
1,2-Dichloropropane	5.0	1.0	USEPA 624	06/20-06/21/94	417205
cis-1,3-Dichloropropene	ND	1.0	USEPA 624	06/20-06/21/94	417205
trans-1,3-Dichloropropene	ND	1.0	USEPA 624	06/20-06/21/94	417205

SURROGATE RECOVERY

%

ACCEPTABLE LIMITS

1,2-Dichloroethane	109	(78 - 130)
Toluene-d8	98	(90 - 109)
Bromofluorobenzene	102	(81 - 117)

NOTE: AS RECEIVED

• ND NOT DETECTED AT THE STATED REPORTING LIMIT



ENSECO-WADSWORTH/ALERT
Laboratories

PBS & J

MW-2A

WO #: O1291110
LAB #: B4F130054-002
MATRIX: WATER

DATE SAMPLED: 6/13/94
DATE RECEIVED: 6/13/94

GC/MS Volatiles

2 OF 2

<u>PARAMETER</u>	<u>RESULT</u> (ug/L)	<u>REPORTING</u> <u>LIMIT</u>	<u>METHOD</u>	<u>EXTRACTION-</u> <u>ANALYSIS DATE</u>	<u>QC</u> <u>BATCH</u>
Ethylbenzene	2.0	1.0	USEPA 624	06/20-06/21/94	417205
Trichlorofluoromethane	ND	1.0	USEPA 624	06/20-06/21/94	417205
Methylene chloride	ND	1.0	USEPA 624	06/20-06/21/94	417205
1,1,2,2-Tetrachloroethane	ND	1.0	USEPA 624	06/20-06/21/94	417205
Tetrachloroethene	ND	1.0	USEPA 624	06/20-06/21/94	417205
Toluene	ND	1.0	USEPA 624	06/20-06/21/94	417205
1,1,1-Trichloroethane	ND	1.0	USEPA 624	06/20-06/21/94	417205
1,1,2-Trichloroethane	ND	1.0	USEPA 624	06/20-06/21/94	417205
Trichloroethene	ND	1.0	USEPA 624	06/20-06/21/94	417205
Vinyl chloride	ND	1.0	USEPA 624	06/20-06/21/94	417205
Xylenes, Total	32	1.0	USEPA 624	06/20-06/21/94	417205

<u>SURROGATE RECOVERY</u>	<u>%</u>	<u>ACCEPTABLE LIMITS</u>
1,2-Dichloroethane	109	(78 - 130)
Toluene-d8	98	(90 - 109)
Bromofluorobenzene	102	(81 - 117)

NOTE: AS RECEIVED

*ND NOT DETECTED AT THE STATED REPORTING LIMIT

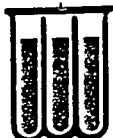

ENSECO-WADSWORTH/ALERT
Laboratories

PBS & J

MW-2A

DATE SAMPLED: 6/1
DATE RECEIVED: 6/1

WO #: O1291109
LAB #: B4F130054-002
MATRIX: WATER

----- GC/MS Semi-Volatiles -----

<u>PARAMETER</u>	<u>RESULT</u> (ug/L)	<u>REPORTING</u> <u>LIMIT</u>	<u>METHOD</u>	<u>EXTRACTION-</u> <u>ANALYSIS DATE</u>	<u>QC</u> <u>BATCH</u>
Acenaphthene	ND	5.0	USEPA 625	06/18-06/22/94	4169018
Acenaphthylene	ND	5.0	USEPA 625	06/18-06/22/94	4169018
Anthracene	ND	5.0	USEPA 625	06/18-06/22/94	4169018
Benzo (a) anthracene	ND	5.0	USEPA 625	06/18-06/22/94	4169018
Benzo (b) fluoranthene	ND	5.0	USEPA 625	06/18-06/22/94	4169018
Benzo (k) fluoranthene	ND	5.0	USEPA 625	06/18-06/22/94	4169018
Benzo (ghi) perylene	ND	5.0	USEPA 625	06/18-06/22/94	4169018
Benzo (a) pyrene	ND	5.0	USEPA 625	06/18-06/22/94	4169018
Chrysene	ND	5.0	USEPA 625	06/18-06/22/94	4169018
Dibenz (a, h) anthracene	ND	5.0	USEPA 625	06/18-06/22/94	4169018
Fluoranthene	ND	5.0	USEPA 625	06/18-06/22/94	4169018
Fluorene	ND	5.0	USEPA 625	06/18-06/22/94	4169018
Indeno (1, 2, 3-cd) pyrene	ND	5.0	USEPA 625	06/18-06/22/94	4169018
2-Methylnaphthalene	ND	5.0	USEPA 625	06/18-06/22/94	4169018
Naphthalene	5.3	5.0	USEPA 625	06/18-06/22/94	4169018
Phenanthrene	ND	5.0	USEPA 625	06/18-06/22/94	4169018
Pyrene	ND	5.0	USEPA 625	06/18-06/22/94	4169018
1-Methylnaphthalene	ND	5.0	USEPA 625	06/18-06/22/94	4169018

SURROGATE RECOVERY

%

ACCEPTABLE LIMITS

Nitrobenzene-d5	69	(22 - 135)
2-Fluorobiphenyl	67	(34 - 140)
Terphenyl-d14	34	(10 - 132)

NOTE: AS RECEIVED

* ND NOT DETECTED AT THE STATED REPORTING LIMIT



ENSECO-WADSWORTH/ALERT
Laboratories

PBS &J

MW-2A

WO #: O1291111
LAB #: B4F130054-002
MATRIX: WATER

DATE SAMPLED: 6/13/94
DATE RECEIVED: 6/13/94

----- GC Semi-Volatiles -----

<u>PARAMETER</u>	<u>RESULT</u> (ug/L)	<u>REPORTING</u> <u>LIMIT</u>	<u>METHOD</u>	<u>EXTRACTION-</u> <u>ANALYSIS DATE</u>	<u>QC</u> <u>BATCH</u>
2,4-D	160	76	SW846 8150	06/20-06/24/94	417106
2,4,5-TP (Silvex)	ND	7.6	SW846 8150	06/20-06/24/94	417106

SURROGATE RECOVERY

%

ACCEPTABLE LIMITS

Unipon

DIL OUT

(40 - 160)

NOTE: AS RECEIVED

* ND NOT DETECTED AT THE STATED REPORTING LIMIT



ENSECO-WADSWORTH/ALERT
Laboratories

PBS & J

MW-2A

WO #: O1291
LAB #: B4F130054-002
MATRIX: WATER

DATE SAMPLED: 6/13/94
DATE RECEIVED: 6/13/94

----- REQUESTED METALS -----

<u>PARAMETER</u>	<u>RESULT</u>	<u>REPORTING LIMIT</u>	<u>UNIT</u>	<u>METHOD</u>	<u>PREPARATION - ANALYSIS DATE</u>	<u>QC BATCH</u>
Silver	ND	50.0	ug/L	MCAWW 200.7	6/16- 6/21/94	4167011
Barium	184	100	ug/L	MCAWW 200.7	6/16- 6/21/94	4167011
Cadmium	9.9	5.0	ug/L	MCAWW 200.7	6/16- 6/21/94	4167011
Chromium	238	50.0	ug/L	MCAWW 200.7	6/16- 6/21/94	4167011
Arsenic	75.0	10.0	ug/L	MCAWW 206.2	6/16/94	4167011
Lead	34.8	5.0	ug/L	MCAWW 239.2	6/16/94	4167011
Mercury	ND	0.20	ug/L	MCAWW 245.1	6/16- 6/17/94	4167013
Selenium	ND	20.0	ug/L	MCAWW 270.2	6/16/94	4167011

NOTE: AS RECEIVED

•ND NOT DETECTED AT THE STATED REPORTING LIMIT



ENSECO-WADSWORTH/ALERT
Laboratories



ENSECO-WADSWORTH/ALERT
Laboratories

PBS & J

MW-3

WO #: O1292112
LAB #: B4F130054-003
MATRIX: WATER

DATE SAMPLED: 6/13/94
DATE RECEIVED: 6/13/94

GC Semi-Volatiles

1 OF 2

PARAMETER	RESULT (ug/L)	REPORTING LIMIT	METHOD	EXTRACTION- ANALYSIS DATE	QC BATCH
Aldrin	ND	0.48	USEPA 608	06/18-06/22/94	4169015
alpha-BHC	2.6	0.48	USEPA 608	06/18-06/22/94	4169015
beta-BHC	ND	0.48	USEPA 608	06/18-06/22/94	4169015
delta-BHC	ND	0.48	USEPA 608	06/18-06/22/94	4169015
gamma-BHC (Lindane)	ND	0.48	USEPA 608	06/18-06/22/94	4169015
Chlordane	ND	4.8	USEPA 608	06/18-06/22/94	4169015
4,4'-DDD	ND	0.48	USEPA 608	06/18-06/22/94	4169015
4,4'-DDE	ND	0.48	USEPA 608	06/18-06/22/94	4169015
4,4'-DDT	ND	0.48	USEPA 608	06/18-06/22/94	4169015
Dieldrin	ND	0.48	USEPA 608	06/18-06/22/94	4169015
Endosulfan I	ND	0.48	USEPA 608	06/18-06/22/94	4169015
Endosulfan II	ND	0.48	USEPA 608	06/18-06/22/94	4169015
Endosulfan sulfate	ND	0.48	USEPA 608	06/18-06/22/94	4169015
Endrin	ND	0.48	USEPA 608	06/18-06/22/94	4169015
Endrin aldehyde	ND	0.48	USEPA 608	06/18-06/22/94	4169015
Heptachlor	ND	0.48	USEPA 608	06/18-06/22/94	4169015
Heptachlor epoxide	ND	0.48	USEPA 608	06/18-06/22/94	4169015
Aroclor-1016	ND	4.8	USEPA 608	06/18-06/22/94	4169015
Aroclor-1221	ND	4.8	USEPA 608	06/18-06/22/94	4169015
Aroclor-1232	ND	4.8	USEPA 608	06/18-06/22/94	4169015
Aroclor-1242	ND	4.8	USEPA 608	06/18-06/22/94	4169015
Aroclor-1248	ND	4.8	USEPA 608	06/18-06/22/94	4169015
Aroclor-1254	ND	4.8	USEPA 608	06/18-06/22/94	4169015
Aroclor-1260	ND	4.8	USEPA 608	06/18-06/22/94	4169015
<u>SURROGATE RECOVERY</u>	<u>%</u>	<u>ACCEPTABLE LIMITS</u>			
Tetrachloro-m-xylene	92	(33 - 122)			
Dibutylchloroendate	48	(18 - 129)			

NOTE: AS RECEIVED

• ND NOT DETECTED AT THE STATED REPORTING LIMIT



ENSECO-WADSWORTH/ALERT
Laboratories

PBS &J

MW-3

WO #: O1292112
LAB #: B4F130054-003
MATRIX: WATER

DATE SAMPLED: 6/13/94
DATE RECEIVED: 6/13/94

GC Semi-Volatiles

2 OF 2

<u>PARAMETER</u>	<u>RESULT</u> (ug/L)	<u>REPORTING</u> <u>LIMIT</u>	<u>METHOD</u>	<u>EXTRACTION-</u> <u>ANALYSIS DATE</u>	<u>QC</u> <u>BATCH</u>
Toxaphene	ND	24	USEPA 608	06/18-06/22/94	4169015

SURROGATE RECOVERY

%

ACCEPTABLE LIMITS

Tetrachloro-m-xylene
Dibutylchloredate

92
48

(33 - 122)
(18 - 129)

NOTE: AS RECEIVED

ND NOT DETECTED AT THE STATED REPORTING LIMIT



ENSECO-WADSWORTH/ALERT
Laboratories

PBS & J

MW-3

WO #: O1292101
LAB #: B4F130054-003
MATRIX: WATER

DATE SAMPLED: 6/13/94
DATE RECEIVED: 6/13/94

GC/MS Volatiles

1 OF 2

<u>PARAMETER</u>	<u>RESULT</u> (ug/L)	<u>REPORTING</u> <u>LIMIT</u>	<u>METHOD</u>	<u>EXTRACTION-</u> <u>ANALYSIS DATE</u>	<u>QC</u> <u>BATCH</u>
Acrolein	ND	10	USEPA 624	06/20-06/21/94	4172054
Acrylonitrile	ND	10	USEPA 624	06/20-06/21/94	4172054
Benzene	1.7	1.0	USEPA 624	06/20-06/21/94	4172054
Bromodichloromethane	ND	1.0	USEPA 624	06/20-06/21/94	4172054
Bromoform	ND	1.0	USEPA 624	06/20-06/21/94	4172054
Bromomethane	ND	1.0	USEPA 624	06/20-06/21/94	4172054
Carbon tetrachloride	ND	1.0	USEPA 624	06/20-06/21/94	4172054
Chlorobenzene	2.0	1.0	USEPA 624	06/20-06/21/94	4172054
Dibromochloromethane	ND	1.0	USEPA 624	06/20-06/21/94	4172054
Chloroethane	ND	1.0	USEPA 624	06/20-06/21/94	4172054
2-Chloroethyl vinyl ether	ND	1.0	USEPA 624	06/20-06/21/94	4172054
Chloroform	ND	1.0	USEPA 624	06/20-06/21/94	4172054
Chloromethane	ND	1.0	USEPA 624	06/20-06/21/94	4172054
1,2-Dichlorobenzene	ND	1.0	USEPA 624	06/20-06/21/94	4172054
1,3-Dichlorobenzene	ND	1.0	USEPA 624	06/20-06/21/94	4172054
1,4-Dichlorobenzene	1.2	1.0	USEPA 624	06/20-06/21/94	4172054
1,1-Dichloroethane	ND	1.0	USEPA 624	06/20-06/21/94	4172054
1,2-Dichloroethane	ND	1.0	USEPA 624	06/20-06/21/94	4172054
1,1-Dichloroethene	ND	1.0	USEPA 624	06/20-06/21/94	4172054
cis-1,2-Dichloroethene	ND	1.0	USEPA 624	06/20-06/21/94	4172054
trans-1,2-Dichloroethene	ND	1.0	USEPA 624	06/20-06/21/94	4172054
1,2-Dichloropropane	ND	1.0	USEPA 624	06/20-06/21/94	4172054
cis-1,3-Dichloropropene	ND	1.0	USEPA 624	06/20-06/21/94	4172054
trans-1,3-Dichloropropene	ND	1.0	USEPA 624	06/20-06/21/94	4172054
<u>SURROGATE RECOVERY</u>	<u>%</u>	<u>ACCEPTABLE LIMITS</u>			
1,2-Dichloroethane	110	(78 - 130)			
Toluene-d8	93	(90 - 109)			
Bromofluorobenzene	99	(81 - 117)			

NOTE: AS RECEIVED

• ND NOT DETECTED AT THE STATED REPORTING LIMIT



ENSECO-WADSWORTH/ALERT
Laboratories

PBS & J

MW-3

WO #: O1292101
LAB #: B4F130054-003
MATRIX: WATER

DATE SAMPLED: 6/13/94
DATE RECEIVED: 6/13/94

GC/MS Volatiles

2 OF 2

<u>PARAMETER</u>	<u>RESULT</u> (ug/L)	<u>REPORTING</u> <u>LIMIT</u>	<u>METHOD</u>	<u>EXTRACTION-</u> <u>ANALYSIS DATE</u>	<u>QC</u> <u>BATCH</u>
Ethylbenzene	26	1.0	USEPA 624	06/20-06/21/94	417205
Trichlorofluoromethane	ND	1.0	USEPA 624	06/20-06/21/94	417205
Methylene chloride	ND	1.0	USEPA 624	06/20-06/21/94	417205
1,1,2,2-Tetrachloroethane	ND	1.0	USEPA 624	06/20-06/21/94	417205
Tetrachloroethene	ND	1.0	USEPA 624	06/20-06/21/94	417205
Toluene	2.7	1.0	USEPA 624	06/20-06/21/94	417205
1,1,1-Trichloroethane	ND	1.0	USEPA 624	06/20-06/21/94	417205
1,1,2-Trichloroethane	ND	1.0	USEPA 624	06/20-06/21/94	417205
Trichloroethene	ND	1.0	USEPA 624	06/20-06/21/94	417205
Vinyl chloride	ND	1.0	USEPA 624	06/20-06/21/94	417205
Xylenes, Total	290	1.0	USEPA 624	06/20-06/21/94	417205

<u>SURROGATE RECOVERY</u>	<u>%</u>	<u>ACCEPTABLE LIMITS</u>
1,2-Dichloroethane	110	(78 - 130)
Toluene-d8	93	(90 - 109)
Bromofluorobenzene	99	(81 - 117)

NOTE: AS RECEIVED

ND NOT DETECTED AT THE STATED REPORTING LIMIT



**ENSECO-WADSWORTH/ALERT
Laboratories**

PBS &J

MW-3

WO #: O1292110
LAB #: B4F130054-003
MATRIX: WATER

DATE SAMPLED: 6/13/94
DATE RECEIVED: 6/13/94

----- GC/MS Semi-Volatiles -----

<u>PARAMETER</u>	<u>RESULT</u> (ug/L)	<u>REPORTING</u> <u>LIMIT</u>	<u>METHOD</u>	<u>EXTRACTION-</u> <u>ANALYSIS DATE</u>	<u>QC</u> <u>BATCH</u>
Acenaphthene	ND	10	USEPA 625	06/18-06/25/94	4169018
Acenaphthylene	ND	10	USEPA 625	06/18-06/25/94	4169018
Anthracene	ND	10	USEPA 625	06/18-06/25/94	4169018
Benzo (a) anthracene	ND	10	USEPA 625	06/18-06/25/94	4169018
Benzo (b) fluoranthene	ND	10	USEPA 625	06/18-06/25/94	4169018
Benzo (k) fluoranthene	ND	10	USEPA 625	06/18-06/25/94	4169018
Benzo (ghi) perylene	ND	10	USEPA 625	06/18-06/25/94	4169018
Benzo (a) pyrene	ND	10	USEPA 625	06/18-06/25/94	4169018
Chrysene	ND	10	USEPA 625	06/18-06/25/94	4169018
Dibenz (a, h) anthracene	ND	10	USEPA 625	06/18-06/25/94	4169018
Fluoranthene	ND	10	USEPA 625	06/18-06/25/94	4169018
Fluorene	ND	10	USEPA 625	06/18-06/25/94	4169018
Indeno (1, 2, 3-cd) pyrene	ND	10	USEPA 625	06/18-06/25/94	4169018
2-Methylnaphthalene	ND	10	USEPA 625	06/18-06/25/94	4169018
Naphthalene	120	10	USEPA 625	06/18-06/25/94	4169018
Phenanthrene	ND	10	USEPA 625	06/18-06/25/94	4169018
Pyrene	ND	10	USEPA 625	06/18-06/25/94	4169018
1-Methylnaphthalene	ND	10	USEPA 625	06/18-06/25/94	4169018

<u>SURROGATE RECOVERY</u>	<u>%</u>	<u>ACCEPTABLE LIMITS</u>
Nitrobenzene-d5	59	(22 - 135)
2-Fluorobiphenyl	56	(34 - 140)
Terphenyl-d14	18	(10 - 132)

NOTE: AS RECEIVED

ND NOT DETECTED AT THE STATED REPORTING LIMIT



ENSECO-WADSWORTH/ALERT
Laboratories

PBS & J

MW-3

WO #: O1292111
LAB #: B4F130054-003
MATRIX: WATER

DATE SAMPLED: 6/13/94
DATE RECEIVED: 6/13/94

----- GC Semi-Volatiles -----

<u>PARAMETER</u>	<u>RESULT</u> (ug/L)	<u>REPORTING</u> <u>LIMIT</u>	<u>METHOD</u>	<u>EXTRACTION-</u> <u>ANALYSIS DATE</u>	<u>QC</u> <u>BATCH</u>
2,4-D	2,400	200	SW846 8150	06/20-06/25/94	4171067
2,4,5-TP(Silvex)	ND	20	SW846 8150	06/20-06/25/94	4171067

SURROGATE RECOVERY

%

ACCEPTABLE LIMITS

2,4-Dichlorophenoxyacetic acid DIL OUT

(40 - 160)

NOTE: AS RECEIVED

ND NOT DETECTED AT THE STATED REPORTING LIMIT



ENSECO-WADSWORTH/ALERT
Laboratories

PBS &J

MW-3

WO #: O1292
LAB #: B4F130054-003
MATRIX: WATER

DATE SAMPLED: 6/13/94
DATE RECEIVED: 6/13/94

----- REQUESTED METALS -----

<u>PARAMETER</u>	<u>RESULT</u>	<u>REPORTING LIMIT</u>	<u>UNIT</u>	<u>METHOD</u>	<u>PREPARATION - ANALYSIS DATE</u>	<u>QC BATCH</u>
Silver	ND	50.0	ug/L	MCAWW 200.7	6/16- 6/21/94	4167011
Barium	ND	100	ug/L	MCAWW 200.7	6/16- 6/21/94	4167011
Cadmium	ND	5.0	ug/L	MCAWW 200.7	6/16- 6/21/94	4167011
Chromium	ND	50.0	ug/L	MCAWW 200.7	6/16- 6/21/94	4167011
Arsenic	ND	5.0	ug/L	MCAWW 206.2	6/16/94	4167011
Lead	6.5	5.0	ug/L	MCAWW 239.2	6/16/94	4167011
Mercury	ND	0.20	ug/L	MCAWW 245.1	6/16- 6/17/94	4167013
Selenium	ND	5.0	ug/L	MCAWW 270.2	6/16/94	4167011

NOTE: AS RECEIVED

• ND NOT DETECTED AT THE STATED REPORTING LIMIT



ENSECO-WADSWORTH/ALERT
Laboratories

PBS & J

MW-4

WO #: O1293112
LAB #: B4F130054-004
MATRIX: WATER

DATE SAMPLE 6/13/94
DATE RECEIVED 6/13/94

GC Semi-Volatiles

1 OF 2

PARAMETER	RESULT	REPORTING	METHOD	EXTRACT-	QC
	(ug/L)	LIMIT		ANALYS	DATE
Aldrin	ND	10	USEPA 608	06/18-02/94	4169015
alpha-BHC	60	10	USEPA 608	06/18-02/94	4169015
beta-BHC	ND	10	USEPA 608	06/18-02/94	4169015
delta-BHC	ND	10	USEPA 608	06/18-02/94	4169015
gamma-BHC (Lindane)	ND	10	USEPA 608	06/18-02/94	4169015
Chlordane	ND	100	USEPA 608	06/18-02/94	4169015
4,4'-DDD	ND	10	USEPA 608	06/18-02/94	4169015
4,4'-DDE	ND	10	USEPA 608	06/18-02/94	4169015
4,4'-DDT	ND	10	USEPA 608	06/18-02/94	4169015
Dieldrin	ND	10	USEPA 608	06/18-06/22/94	4169015
Endosulfan I	ND	10	USEPA 608	06/18-06/22/94	4169015
Endosulfan II	ND	10	USEPA 608	06/18-06/22/94	4169015
Endosulfan sulfate	ND	10	USEPA 608	06/18-06/22/94	4169015
Endrin	ND	10	USEPA 608	06/18-06/22/94	4169015
Endrin aldehyde	ND	10	USEPA 608	06/18-06/22/94	4169015
Heptachlor	ND	10	USEPA 608	06/18-06/22/94	4169015
Heptachlor epoxide	ND	10	USEPA 608	06/18-06/22/94	4169015
Aroclor-1016	ND	100	USEPA 608	06/18-06/22/94	4169015
Aroclor-1221	ND	100	USEPA 608	06/18-06/22/94	4169015
Aroclor-1232	ND	100	USEPA 608	06/18-06/22/94	4169015
Aroclor-1242	ND	100	USEPA 608	06/18-06/22/94	4169015
Aroclor-1248	ND	100	USEPA 608	06/18-06/22/94	4169015
Aroclor-1254	ND	100	USEPA 608	06/18-06/22/94	4169015
Aroclor-1260	ND	100	USEPA 608	06/18-06/22/94	4169015
<u>SURROGATE RECOVERY</u>	<u>%</u>	<u>ACCEPTABLE LIMITS</u>			
Tetrachloro-m-xylene	DIL OUT	(33 - 122)			
Dibutylchlorendate	DIL OUT	(18 - 129)			

NOTE: AS RECEIVED

ND NOT DETECTED AT THE STATED REPORTING LIMIT



ENSECO-WADSWORTH/ALERT
Laboratories

PBS &J

MW-4

WO #: O1293112
LAB #: B4F130054-004
MATRIX: WATER

DATE SAMPLED: 6/13/94
DATE RECEIVED: 6/13/94

----- GC Semi-Volatiles -----

2 OF 2

<u>PARAMETER</u>	<u>RESULT</u> (uq/L)	<u>REPORTING</u> <u>LIMIT</u>	<u>METHOD</u>	<u>EXTRACTION</u> <u>ANALYSIS DTE</u>	<u>QC</u> <u>BATCH</u>
Toxaphene	ND	500	USEPA 608	06/18-06/22/94	4169015

SURROGATE RECOVERY

%

ACCEPTABLE LIMITS

Tetrachloro-m-xylene
Dibutylchloroendate

DIL OUT (33 - 122)
DIL OUT (18 - 129)

NOTE: AS RECEIVED

ND NOT DETECTED AT THE STATED REPORTING LIMIT



ENSECO-WADSWORTH/ALERT
Laboratories

PBS & J

MW-4

WO #: O1293110
LAB #: B4F130054-004
MATRIX: WATER

DATE SAMPLED: 6/13/94
DATE RECEIVED: 6/13/94

GC/MS Volatiles

1 OF 2

<u>PARAMETER</u>	<u>RESULT</u> (ug/L)	<u>REPORTING</u> <u>LIMIT</u>	<u>METHOD</u>	<u>EXTRACTION-</u> <u>ANALYSIS DATE</u>	<u>QC</u> <u>BATCH</u>
Acrolein	ND	10	USEPA 624	06/20-06/21/94	417205
Acrylonitrile	ND	10	USEPA 624	06/20-06/21/94	417205
Benzene	5.5	1.0	USEPA 624	06/20-06/21/94	417205
Bromodichloromethane	ND	1.0	USEPA 624	06/20-06/21/94	417205
Bromoform	ND	1.0	USEPA 624	06/20-06/21/94	417205
Bromomethane	ND	1.0	USEPA 624	06/20-06/21/94	417205
Carbon tetrachloride	ND	1.0	USEPA 624	06/20-06/21/94	417205
Chlorobenzene	46	1.0	USEPA 624	06/20-06/21/94	417205
Dibromochloromethane	ND	1.0	USEPA 624	06/20-06/21/94	417205
Chloroethane	ND	1.0	USEPA 624	06/20-06/21/94	417205
2-Chloroethyl vinyl ether	ND	1.0	USEPA 624	06/20-06/21/94	417205
Chloroform	ND	1.0	USEPA 624	06/20-06/21/94	417205
Chloromethane	ND	1.0	USEPA 624	06/20-06/21/94	417205
1,2-Dichlorobenzene	4.0	1.0	USEPA 624	06/20-06/21/94	417205
1,3-Dichlorobenzene	ND	1.0	USEPA 624	06/20-06/21/94	417205
1,4-Dichlorobenzene	10	1.0	USEPA 624	06/20-06/21/94	417205
1,1-Dichloroethane	2.4	1.0	USEPA 624	06/20-06/21/94	417205
1,2-Dichloroethane	ND	1.0	USEPA 624	06/20-06/21/94	417205
1,1-Dichloroethene	ND	1.0	USEPA 624	06/20-06/21/94	417205
cis-1,2-Dichloroethene	ND	1.0	USEPA 624	06/20-06/21/94	417205
trans-1,2-Dichloroethene	ND	1.0	USEPA 624	06/20-06/21/94	417205
1,2-Dichloropropane	5.9	1.0	USEPA 624	06/20-06/21/94	417205
cis-1,3-Dichloropropene	ND	1.0	USEPA 624	06/20-06/21/94	417205
trans-1,3-Dichloropropene	ND	1.0	USEPA 624	06/20-06/21/94	417205
<u>SURROGATE RECOVERY</u>	<u>%</u>	<u>ACCEPTABLE LIMITS</u>			
1,2-Dichloroethane	112	(78 - 130)			
Toluene-d8	98	(90 - 109)			
Bromofluorobenzene	101	(81 - 117)			

NOTE: AS RECEIVED

• ND NOT DETECTED AT THE STATED REPORTING LIMIT



ENSECO-WADSWORTH/ALERT
Laboratories

PBS & J

MW-4

WO #: O1293110
LAB #: B4F130054-004
MATRIX: WATER

DATE SAMPLED: 6/13/94
DATE RECEIVED: 6/13/94

----- GC/MS Volatiles -----

2 OF 2

<u>PARAMETER</u>	<u>RESULT</u> (ug/L)	<u>REPORTING</u> <u>LIMIT</u>	<u>METHOD</u>	<u>EXTRACTION-</u> <u>ANALYSIS DATE</u>	<u>QC</u> <u>BATCH</u>
Ethylbenzene	ND	1.0	USEPA 624	06/20-06/21/94	4172054
Trichlorofluoromethane	ND	1.0	USEPA 624	06/20-06/21/94	4172054
Methylene chloride	ND	1.0	USEPA 624	06/20-06/21/94	4172054
1,1,2,2-Tetrachloroethane	ND	1.0	USEPA 624	06/20-06/21/94	4172054
Tetrachloroethene	ND	1.0	USEPA 624	06/20-06/21/94	4172054
Toluene	3.4	1.0	USEPA 624	06/20-06/21/94	4172054
1,1,1-Trichloroethane	ND	1.0	USEPA 624	06/20-06/21/94	4172054
1,1,2-Trichloroethane	ND	1.0	USEPA 624	06/20-06/21/94	4172054
Trichloroethene	ND	1.0	USEPA 624	06/20-06/21/94	4172054
Vinyl chloride	ND	1.0	USEPA 624	06/20-06/21/94	4172054
Xylenes, Total	10	1.0	USEPA 624	06/20-06/21/94	4172054

SURROGATE RECOVERY

%

ACCEPTABLE LIMITS

1,2-Dichloroethane	112	(78 - 130)
Toluene-d8	98	(90 - 109)
Bromofluorobenzene	101	(81 - 117)

NOTE: AS RECEIVED

• ND NOT DETECTED AT THE STATED REPORTING LIMIT



ENSECO-WADSWORTH/ALERT
Laboratories

PBS & J

MW-4

WO #: O1293109
LAB #: B4F130054-004
MATRIX: WATER

DATE SAMPLED: 6/13/94
DATE RECEIVED: 6/13/94

GC/MS Semi-Volatiles

<u>PARAMETER</u>	<u>RESULT</u> (ug/L)	<u>REPORTING</u> <u>LIMIT</u>	<u>METHOD</u>	<u>EXTRACTION-</u> <u>ANALYSIS DATE</u>	<u>QC</u> <u>BATCH</u>
Acenaphthene	ND	5.0	USEPA 625	06/18-06/22/94	4169018
Acenaphthylene	ND	5.0	USEPA 625	06/18-06/22/94	4169018
Anthracene	ND	5.0	USEPA 625	06/18-06/22/94	4169018
Benzo (a) anthracene	ND	5.0	USEPA 625	06/18-06/22/94	4169018
Benzo (b) fluoranthene	ND	5.0	USEPA 625	06/18-06/22/94	4169018
Benzo (k) fluoranthene	ND	5.0	USEPA 625	06/18-06/22/94	4169018
Benzo (ghi) perylene	ND	5.0	USEPA 625	06/18-06/22/94	4169018
Benzo (a) pyrene	ND	5.0	USEPA 625	06/18-06/22/94	4169018
Chrysene	ND	5.0	USEPA 625	06/18-06/22/94	4169018
Dibenz (a, h) anthracene	ND	5.0	USEPA 625	06/18-06/22/94	4169018
Fluoranthene	ND	5.0	USEPA 625	06/18-06/22/94	4169018
Fluorene	ND	5.0	USEPA 625	06/18-06/22/94	4169018
Indeno (1,2,3-cd) pyrene	ND	5.0	USEPA 625	06/18-06/22/94	4169018
2-Methylnaphthalene	ND	5.0	USEPA 625	06/18-06/22/94	4169018
Naphthalene	5.3	5.0	USEPA 625	06/18-06/22/94	4169018
Phenanthrene	ND	5.0	USEPA 625	06/18-06/22/94	4169018
Pyrene	ND	5.0	USEPA 625	06/18-06/22/94	4169018
1-Methylnaphthalene	ND	5.0	USEPA 625	06/18-06/22/94	4169018

<u>SURROGATE RECOVERY</u>	<u>%</u>	<u>ACCEPTABLE LIMITS</u>
Nitrobenzene-d5	75	(22 - 135)
2-Fluorobiphenyl	75	(34 - 140)
Terphenyl-d14	17	(10 - 132)

NOTE: AS RECEIVED

ND NOT DETECTED AT THE STATED REPORTING LIMIT



ENSECO-WADSWORTH/ALERT
Laboratories

PBS &J

MW-4

WO #: O1293111
LAB #: B4F130054-004
MATRIX: WATER

DATE SAMPLED: 6/13/94
DATE RECEIVED: 6/13/94

----- GC Semi-Volatiles -----

<u>PARAMETER</u>	<u>RESULT</u> (ug/L)	<u>REPORTING</u> <u>LIMIT</u>	<u>METHOD</u>	<u>EXTRACTION-</u> <u>ANALYSIS DATE</u>	<u>QC</u> <u>BATCH</u>
2,4-D	8.3	4.0	SW846 8150	06/20-06/25/94	4171067
2,4,5-TP (Silvex)	ND	1.0	SW846 8150	06/20-06/25/94	4171067

SURROGATE RECOVERY

%

ACCEPTABLE LIMITS

2,4-Dichlorophenoxyacetic acid 116

(40 - 160)

NOTE: AS RECEIVED

ND NOT DETECTED AT THE STATED REPORTING LIMIT



ENSECO-WADSWORTH/ALERT
Laboratories

PBS & J

MW-4

WO #: O1293
LAB #: B4F130054-004
MATRIX: WATER

DATE SAMPLED: 6/13/94
DATE RECEIVED: 6/13/94

----- REQUESTED METALS -----

<u>PARAMETER</u>	<u>RESULT</u>	<u>REPORTING LIMIT</u>	<u>UNIT</u>	<u>METHOD</u>	<u>PREPARATION - ANALYSIS DATE</u>	<u>QC BATCH</u>
Silver	ND	50.0	ug/L	MCAWW 200.7	6/16- 6/21/94	416701
Barium	718	100	ug/L	MCAWW 200.7	6/16- 6/21/94	416701
Cadmium	8.7	5.0	ug/L	MCAWW 200.7	6/16- 6/21/94	416701
Chromium	396	50.0	ug/L	MCAWW 200.7	6/16- 6/21/94	416701
Arsenic	ND	5.0	ug/L	MCAWW 206.2	6/16/94	416701
Lead	43.0	10.0	ug/L	MCAWW 239.2	6/16/94	416701
Mercury	0.47	0.20	ug/L	MCAWW 245.1	6/16- 6/17/94	416701
Selenium	ND	20.0	ug/L	MCAWW 270.2	6/16/94	416701

NOTE: AS RECEIVED

, ND NOT DETECTED AT THE STATED REPORTING LIMIT