Application for Individual and Conceptual Approval Environmental Resource Permit and Authorization to Use State-Owned Submerged Lands

Florida Department of Environmental Protection/
Water Management Districts

Effective June 1, 2018



Instructions for Use of This Form:

This form is designed to assist you in submitting a complete application. All applications must include Section A- General Information for All Activities. Sections B through H list typical information that is needed based on the proposed activities and are only required as applicable. Part 1-C of Section A will guide you to the correct sections needed based on your proposed activities. Applicants are advised to consult Chapter 62-330, F.A.C., and the Environmental Resource Permit Applicant's Handbooks Volumes I and II for information regarding the ERP permitting process and requirements while preparing their application. Internet addresses for Chapter 62-330, F.A.C., and the Applicant's Handbook, Agency contact information, and additional instructions for this form can be found in Attachment 1.

What Sections of the Application Must I Fill Out?

Type of Activity	Section A	Section B	Section C	Section D	Section E	Section F	Section G	Section H
Fill in wetlands or waters for a single family residence?	Y	Y	N	N	N	N	N	N
Docks, shoreline stabilization, seawalls associated with a single family residence?	Y	Y	N	N	N	Y, as needed	N	N
Wetland impacts (other than association with an individual residence)?	Y	N	Y	N	N	N	N	N
Boating facilities, a marina, jetty, reef, or dredging?	Y	N	Y	Y	N	Y, as needed	N	N
Any work on state owned submerged land?	Y	N	Y	N	N	Y	N	N
Construction of a stormwater management system?	Y	N	Y, as needed	N	Y	N	N	N
Constructing a mitigation bank?	Y	N	Y	N	Y, as needed	N	Y	N
Creating a mine?	Y	N	Y, as needed	N	N	N	N	Y

Note- if you are required to provide Section B, then you do not have to provide any other Sections, unless the activities are on state-owned submerged lands. In that case, Section F will also be required.

If you have any questions, or would like assistance completing this form, please contact the staff of the nearest office of either the Florida Department of Environmental Protection (DEP) or a Water Management District (WMD) (see Attachment 2).

Section A: General Information for All Activities

Part 1: Name, Application Type, Location, and Description of Activity

A. Name of project, including phase if applicable: Louh Dock

B. This is for (check all that apply):

- ☒ Construction and operation of **new** works, activities, and/ or a stormwater management system
- ☐ **Conceptual Approval** of proposed works, activities and/ or a stormwater management system
- ☐ Modification or alteration of **existing** works, activities, and/or a stormwater management system. Provide the existing DEP or WMD permit #, if known: Note: Minor modifications do not require completion of this form, and may instead be requested by letter in accordance with section 6.2 of Applicant's Handbook Volume I.
- ☐ **Maintenance or repair** of works, activities, and/ or a stormwater management system previously permitted by the DEP or WMD. Provide existing permit #, if known:
- ☐ Abandonment or removal of works, activities, and/ or a stormwater management system.
Provide existing DEP or WMD permit #, if known:
- ☐ Operation of an **existing unpermitted** work, activity, and/or stormwater management system.
- ☐ Construction of additional phases of a permitted work, activity, or system.
Provide the existing DEP or WMD permit #, if known:

C. **List the type of activities proposed. Check all that apply, and provide the supplemental information requested in each of the referenced application sections.** Please also reference Applicant's Handbook Volumes I and II for the type of information that may be needed.

- ☒ Activities associated with one single-family residence, duplex, triplex, or quadruplex that do not qualify for an exemption or a General Permit: **Provide the information requested in Section B. Do not complete Section C.**
- ☐ Activities within wetlands or surface waters, or within 25 feet of a wetland or surface water, (not including the activities associated with an individual single-family residence). Examples include dredging, filling, outfall structures, docks, piers, over-water structures, shoreline stabilization, mitigation, reclamation, and restoration/enhancement. **Provide the information requested in Section C.**

- ☐ Activities within navigable or flowing surface waters such as a multi-slip dock or marina, dry storage facility, dredging, bridge, breakwaters, reefs, or other offshore structures: **In addition to Section C, also provide the information requested in Section D.**
- ☐ Activities that are (or may be) located within, on, or over state-owned submerged lands (See Chapter 18-21, F.A.C. <https://www.flrules.org/gateway/ChapterHome.asp?Chapter=18-21>): **In addition to Section B or C, also provide the information requested in Section F.**
- ☐ Construction or alteration of a stormwater management system serving residential, commercial, transportation, industrial, agricultural, or other land uses, or a solid waste facility (excluding mines that are regulated by DEP). **Provide the information requested in Section E.**
- ☐ Creation or modification of a Mitigation Bank (refer to Chapter 62-342, F.A.C. <https://www.flrules.org/gateway/ChapterHome.asp?Chapter=62-342>): **Provide the information requested in Section G.**
- ☐ Mines (as defined in Section 2.0 of Applicant's Handbook Volume I) that are regulated by the DEP: **Provide the information requested in Section H.**
- ☐ Other, describe: Please contact the Agency to determine which additional sections of the application are needed. See Attachment 2 for Agency contacts.

D. Describe in general terms the proposed project, system, works, or other activities. For permit modifications, please briefly describe the changes requested to the permit: Construct a Dock

E. Project/Activity Street/Road Address or other location (if applicable): 2951 Front Rd
City: Jacksonville County(ies): Duval Zip: 32257

Note: For utility, road, or ditch/canal activities, provide a starting and ending point using street names and nearest house numbers or provide length of project in miles along named streets or highways.

F. Project location map and Section, Township, and Range information (use additional sheets if needed):

Please attach a location map showing the location and boundaries of the proposed activity in relation to major intersections or other landmarks. The map should also contain a north arrow and a graphic scale; show Section(s), Township(s), and Range(s); and must be of sufficient detail to allow a person unfamiliar with the site to find it.

Section(s): 39 Township: **3S** Range: 27E Land Grant name, if applicable:
Section(s): Township: Range:

G. Latitude (DMS) **30.205987** Longitude (DMS) **-81.637812** (Taken from central location of the activity). Explain source for obtaining latitude and longitude (i.e. U.S.G.S. Quadrangle Map, GPS, online resource): Google Earth

H. Tax Parcel Identification Number(s): 149412 0160

[Number may be obtained from property tax bill or from the county property appraiser's office; if on multiple parcels, provide multiple Tax Parcel Identification Numbers]

I. Directions to Site (from major roads; include distances and landmarks as applicable): .

J. Project area or phase area: +/-0.54 ac. acres

K. Name of waterbody(ies) (if known) in which activities will occur or into which the system will discharge:
St. Johns River

The following questions (M-O) are not applicable to activities related to an individual single-family residence, including a dock, pier, and/or seawall associated with that residence.

L. Is it part of a larger plan of development or sale? ☐ yes ☒ no

M. Impervious or semi-impervious area excluding wetlands and other surface waters (if applicable):

acres or square feet

N. Volume of water the system is capable of impounding (if applicable):

Normal Pool: acre-feet. Depth ft.
Maximum Pool: acre-feet. Depth ft.

Part 2: Supplemental Information, and Permit History

A. Is this an application to modify an existing Environmental Resource Permit or to construct or implement ~~for~~ part of a multi-phase project, such as a project with a Conceptual Approval permit? ☐ Yes ☐ No (If you answered "yes", please provide permit numbers below):

Agency	Date	Permit/Application No.	Project Name

Agency	Date	Permit/Application No.	Project Name

- B. Indicate if there have been any **pre-application meeting(s)** with the DEP, WMD, or delegated local government, or other discussions, meetings, or coordination with other stakeholders or agencies about the proposed project, system or activity. If so, please provide the date(s), location(s) of the meeting, and the name(s) of Agency staff that attended the meeting(s):

Agency	Date	Location	Meeting Attendees

- C. **Attach a depiction (plan and section views), which clearly shows the works or other activities proposed to be constructed.** Use multiple sheets, if necessary, a scale sufficient to show the location and type of works, and include a north arrow and a key to any symbols used. **Specific information to be included in the plans is based on the activities proposed and is further described in Sections B-H.** However, supplemental information may be required based on the specific circumstances or location of the proposed works or other activities.
- D. Processing Fee: **Please submit the application processing fee along with this application form and supplemental information.** Processing fees vary based on the size of the activity, the type of permit applied for, and the reviewing Agency. Please reference Appendix D of Applicant's Handbook Volume I to determine the appropriate fee.

Part 3: Applicant and Associated Parties Information

Instructions: Please complete the following sections. For corporations, list a person who is a registered agent or officer of the corporation who has the legal authority to bind the corporation.

A. Applicant (Entity Must Have Sufficient Real Property Interest)

☐ This is a Contact Person for Additional Information

Last Name: Louh

First Name: Anthony

Middle Initial:

Title:

Company:

Address: 2951 Front Rd

City: Jacksonville

State: FL

Zip: 32257

Home Telephone:

Work Telephone:

Cell Phone: 904-655-2287

E-mail Address: Anthony.Louh@gmail.com

Correspondence will be sent via email, unless you check here to receive it via US Mail: ☐

B. Land Owner(S) (If Different or in Addition to Applicant)

Form 62-330.060(1) - Application for Individual and Conceptual Approval Environmental Resource Permit and Authorization to Use State-Owned Submerged Lands

Incorporated by reference in subsection 62-330.060(1), F.A.C. (June 1, 2018)

Section A, Page 6 of 10

☐ **Check here if land owner is also a co-applicant**

Last Name:	First Name:	Middle Initial:
Title:	Company:	
Address:		
City:	State:	Zip:
Home Telephone:	Work Telephone:	
Cell Phone:		
E-mail Address:		

Correspondence will be sent via email, unless you check here to receive it via US Mail: ☐

C. Operation and Maintenance Entity(see Applicant's Handbook I, Section 12.3)

Last Name:	First Name:	Middle Initial:
Title:	Company:	
Address:		
City:	State:	Zip:
Home Telephone:	Work Telephone:	
Cell Phone:		
E-mail Address:		

Correspondence will be sent via email, unless you check here to receive it via US Mail: ☐

D. Co-Applicant (If Different or In Addition to Applicant and Owner)

Last Name:	First Name:	Middle Initial:
Title:	Company:	
Address:		
City:	State:	Zip:
Home Telephone:	Work Telephone:	
Cell Phone:		
E-mail Address:		

Correspondence will be sent via email, unless you check here to receive it via US Mail: ☐

E. Registered Professional Consultant

☐ **This is a contact person for additional information**

Last Name:	First Name:	Middle Initial:
Title:	Company:	
Address:		
City:	State:	Zip:
Home Telephone:	Work Telephone:	
Cell Phone:		
E-mail Address:		

Correspondence will be sent via email, unless you check here to receive it via US Mail: ☐

F. Environmental Consultant

☒ **This is a contact person for additional information**

Last Name: Spahr	First Name: Brian	Middle Initial:
Title:	Company:	
Address:		
City:	State:	Zip:

Home Telephone:
Cell Phone: 904-626-1377
E-mail Address: briansphr@yahoo.com

Work Telephone:

Correspondence will be sent via email, unless you check here to receive it via US Mail: ☐

G. Agent Authorized to Secure Permit (If Different from Consultant)

Last Name:	First Name:	Middle Initial:
Title:	Company:	
Address:		
City:	State:	Zip:
Home Telephone:	Work Telephone:	
Cell Phone:		
E-mail Address:		

Correspondence will be sent via email, unless you check here to receive it via US Mail: ☐

If necessary, please add additional pages for other contacts and property owners related to this project.

H. Real Property Interest

- a. Permits are only issued to entities having sufficient real property interest as described in Section 4.2.3(d) of Applicant's Handbook Volume I. **Please attach evidence of the applicant's real property interest over the land upon which the activities subject to the application will be conducted, including mitigation areas (if applicable).** Refer to Sections 4.2.3(d)-(e) for sufficient real property interest documentation.
- b. For activities that require a recorded notice in accordance with rule 62-330.090(7), F.A.C., please provide either the complete legal description of the property or a copy of the pages of the document recorded in the public records that contains the complete legal description. If the land upon which the proposed activities are to occur is not owned by the applicant, the applicant must also provide copies of any right-of-way, leases, easements, or other legal agreement which authorizes the applicant to perform the activities on those lands.

Part 4: Signatures and Authorization to Access Property

Instructions: For multiple applicants please provide a separate Part 4 for each applicant. For corporations, the application must be signed by a person authorized to bind the corporation. A person who has sufficient real property interest (see Section 4.2.3(d) of Applicant's Handbook Volume I) is required in (B) to authorize access to the property, except when the applicant has the power of eminent domain.

A. By signing this application form, I am applying for the permit and any proprietary authorizations identified above, according to the supporting data and other incidental information filed with this application. I am familiar with the information contained in this application and represent that such information is true, complete and accurate. I understand this is an application and not a permit, and that work prior to approval is a violation. I understand that this application and any permit issued or proprietary authorization issued pursuant thereto does not relieve me of any obligation for obtaining any other required federal, state, water management district, or local permit prior to commencement of construction. I agree to operate and maintain the permitted system unless the permitting agency authorizes transfer of the permit to a different responsible operation and maintenance entity. I understand that knowingly making any false statement or representation in this application is a violation of Section 373.430, F.S. and 18 U.S.C. Section 1001.

Anthony Louh

Typed/Printed Name of Applicant or
Applicant's Authorized Agent

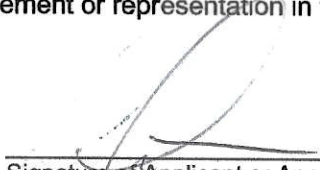
Signature of Applicant or Applicant's
Authorized Agent

Date 4/13/2025

(Corporate Title if applicable)

B. Certification of Sufficient Real Property Interest And Authorization For Staff To Access The Property:

I certify that:

☒ I possess sufficient real property interest in or control, as defined in Section 4.2.3 (d) of Applicant's Handbook Volume I, over the land upon which the activities described in this application are proposed and I have legal authority to grant permission to access those lands. I hereby grant permission, evidenced by my signature below, for staff of the Agency to access, inspect, and sample the lands and waters of the property as necessary for the review of the proposed works and other activities specified in this application, upon advance notice. I authorize these agents or personnel to enter the property as many times as may be necessary to make such review, inspection, and/ or sampling. Further, if a permit is granted, upon advance notice, I agree to provide entry to the project site for such agents or personnel with proper identification to determine compliance with permit conditions and permitted plans and specifications.

OR

☐ I represent an entity having the power of eminent domain and condemnation authority, and I/we shall make appropriate arrangements to enable staff of the Agency to legally access, inspect, and sample the property as described above.

Anthony Louh

Typed/Printed Name

Signature

Date 4/13/2025

(Corporate Title if applicable)

C. Designation of Authorized Agent (If Applicable):

I hereby designate and authorize **Brian Spahr** to act on my behalf, or on behalf of my corporation, as the agent in the processing of this application for the permit and/or proprietary authorization indicated above; and to furnish, on request, supplemental information in support of the application. In addition, I authorize the above-listed agent to bind me, or my corporation, to perform any requirements which may be necessary to procure the permit or authorization indicated above. I understand that knowingly making any false statement or representation in this application is a violation of Section 373.430, F.S., and 18 U.S.C. Section 1001.

Anthony Louh

Typed/Printed Name of Applicant

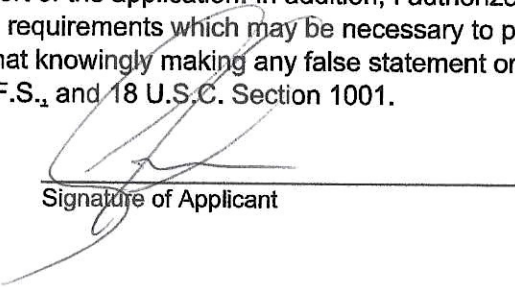
Signature of Applicant

4/13/2025
Date

(Corporate Title if applicable)

Section B: For Single-Family Projects

Instructions: This section is for providing supplemental information required for works or other activities involving one individual single-family (including a duplex, triplex or quadruplex) residential property that do not qualify for an exemption or general permit. This is intended to be used in conjunction with the Applicant's Handbook, Vol. I & II. The Agency will also provide a copy of the application to the Florida Fish and Wildlife Conservation Commission, the Department of State's Division of Historical Resources, and other agencies as applicable for review. Project modifications may be required as a result of those comments. The supplemental information required by this section is in addition to the information required by Section A of the application.

Part I: Project Information Summary

1. Does the project include construction of any docks, piers, or other types of over-water structures or mooring areas?
☒ yes (complete items a. through f., below) ☐ no (skip to #2)
 - a. Total square feet of structure(s) over water:
existing: new: proposed total: 3229.5
 - b. Type of materials (e.g., treated wood, plastic, concrete, etc.) for the:
dock structure: Treated Wood pilings: Treated Wood
 - c. Proposed dock plank spacing (if applicable): 1/4"
 - d. Number of in-water slips or mooring areas for vessels:
existing: new: proposed total: 1
 - e. Please indicate the size (length and draft) and type of vessels that will be mooring at the dock or structure:
 - f. Please address how the dock, pier, or other structures or mooring areas will not significantly impede navigation within the waterbody: Dock will extend less than 25% accross channel
2. Does the project include construction of any shoreline stabilization, such as riprap revetment, living shoreline, or seawall?
☐ yes (complete items a. through f., below) ☒ no (skip to #3)
 - a. Linear feet of shoreline (at the mean or ordinary high water line) proposed to be stabilized or modified:
 - b. Describe the existing condition of the shoreline, including vegetation:
 - c. Is the proposed shoreline stabilization limited solely to repair/replacement of existing structures of the same type and design?
☐ Yes ☐ No ☐ I don't know
 - d. Type(s) of shoreline stabilization proposed (check all that apply):
☐ living shoreline ☐ vertical seawall ☐ riprap or other sloped revetment



- e. Please describe the type(s) of material (e.g. riprap, treated wood, concrete, plastic or steel sheetpile) to be used to construct the shoreline stabilization structure(s). If riprap is proposed, describe the type and average diameter or size:
- f. If the project involves construction or repair of any vertical seawalls, will it be located entirely within a manmade canal that is currently occupied (at least in part) by vertical seawalls?
☐ Yes ☐ No ☐ Not applicable/no vertical seawalls proposed
If the answer is "no", it is recommended that you contact the reviewing agency prior to submitting your application.
3. Does the project include construction of any boat ramp or launch area?
☐ yes (complete items a. through e., below) ☒ no (skip to #4)
- a. Material to be used as a base and surface fill:
- b. Methods and materials for side slope stabilization:
- c. Method and equipment to be used during dredging and construction:
- d. Approximate amount of material that needs to be dredged, if any. Please indicate the total square footage of area and the number of cubic yards of material.
- e. Approximate amount of fill material, if any. Please indicate the total square footage of area and the number of cubic yards of material.
4. Does the project include any other type of dredging or filling of wetlands or other surface waters?
☐ yes (complete items a. through f., below) ☒ no (skip to #5)
- a. Total square feet of the area(s) to be dredged:
- b. Total square feet of the area(s) to be filled:
- c. Total volume of material to be dredged: cubic yards
- d. Final depth of proposed dredge area in feet, relative to mean low water (tidal waters) or ordinary or seasonal high water (for non-tidal waters):
- e. Methods and equipment to be used during dredging and/or filling:
- f. How and where will dredged material be stored and disposed? *Include a description of any temporary stockpile areas and best management practices (BMPs):*
5. Total area of work (dredging, filling, construction, alteration, or removal) in, on, or over wetlands or other surface waters: 3229.5 square feet; acres
6. Please provide the name (if known) of the wetland or other surface waterbody in which the proposed work or activities will occur. *Be advised that individual waterbodies or wetlands, or geographic areas, may have certain legal designations that affect the permitting requirements for your project. Examples of such designations include Aquatic Preserves, Outstanding Florida Waters, Special Basins, Riparian Habitat Protection Zones, Class II or other classified shellfishing waters, and impaired waters. It is recommended that you contact your local agency office to determine if your project is located within any such waters prior to submitting your application.*
 Waterbody: St. Johns River ☐ I don't know

Part II: Environmental Considerations

1. Elimination or Reduction of Impacts (Avoidance and Minimization) *(Refer to Applicant's Handbook, Vol. I, s. 10.2.1 through 10.2.1.3)*

Please describe measures taken to eliminate or reduce impacts to wetlands and other surface waters.

If all practicable modifications have been made to reduce or eliminate adverse impacts to wetland or surface water functions, including functions provided to fish, wildlife and listed species, and adverse impacts remain, mitigation may be required. It is recommended that you discuss mitigation requirements with the reviewing agency, prior to submitting this application. For more information, refer to Applicant's Handbook, Vol. I, s. 10.2.2 through 10.2.2.4, and s. 10.3 through 10.3.8. If you have a mitigation proposal, you may include it with your application submittal.

2. Public Interest Test *(Refer to Applicant's Handbook, Vol. I, s. 10.2.3 through 10.2.3.7)*

You are not required to complete this question – it is optional. Please be advised that the reviewing agency will determine whether the proposed activity will be **not contrary** to the public interest, **OR** if such activity will significantly degrade or is located within an Outstanding Florida Water (OFW), that the activity will be **clearly in** the public interest. To make this determination, the agency will consider the following:

- a. Whether the regulated activity will adversely affect public health, safety, or the welfare or the property of others
- b. Whether the regulated activity will adversely affect the conservation of fish and wildlife, including endangered or threatened species, or their habitats
- c. Whether the regulated activity will adversely affect navigation or the flow of water or cause harmful erosion or shoaling
- d. Whether the regulated activity will adversely affect the fishing or recreational values or marine productivity in the vicinity of the activity
- e. Whether the regulated activity will be of a temporary or permanent nature
- f. Whether the regulated activity will adversely affect significant historical and archaeological resources, under the provisions of section 267.061, F.S.
- g. Whether the regulated activity will adversely affect the current condition and relative value of functions being performed by areas affected by the proposed regulated activity.

If you wish to describe additional measures taken to place your project clearly in (or not contrary to) the public interest, as described above, please do so here:

3. Water Quality *(Refer to Applicant's Handbook, Vol. I, s. 10.2.4 through 10.2.4.5)*

Please describe how the proposed project will be designed to not violate water quality standards. *Include descriptions of all proposed turbidity, erosion, and sedimentation control measures:* Best management practices will be utilized and turbidity barrier will be utilized where necessary.

4. Secondary Impacts (*Refer to Applicant's Handbook, Vol. I, s. 10.2.7*)

Will an upland buffer, **with a minimum width of 15' and an average width of at least 25'**, be provided between the proposed project and all wetlands and other surface waters to be preserved, enhanced, restored, or created? ☐ Yes ☒ No

If no, please describe how the project will be designed and constructed to avoid adverse secondary impacts to the water resource: The project site is currently a managed single family home, no additional secondary impacts will occur with the construction of the dock.

5. Water Quantity (*Refer to the Design and Performance Guidance for an Individual Private, Residential Single-Family Residence Involving Dredging or Filling in Wetlands or Other Surface Waters found in Applicant's Handbook, Vol. I, References and Design Aids*)

Please describe how the proposed project will be designed and constructed to avoid causing the following:

Adverse water quantity impacts to receiving waters and adjacent lands: Standard marine construction methods will be employed along with the standard turbidity control in order to prevent water quality impacts

Adverse flooding to on-site or off-site property: No fill or change in grade is proposed, therefore no flooding will result from the proposed project.

Adverse impacts to existing surface water storage and conveyance capabilities. The dock has been designed as to avoid impacts to existing surface water storage or conveyance.

Part III: Plans

Attach depictions (plan and section views), which clearly show all proposed structures or works. Use multiple sheets, if necessary. Plans should be scaled, dimensioned, and legible. Use a scale sufficient to show the location and type of works. *Be advised that certain items may require the services of a Florida registered professional.* At a minimum, plans must include the information listed below as applicable, based on the activity proposed:

1. All Activities

- ☒ Project location map that clearly depicts the location of all proposed activities
- ☒ Location of property lines, including linear feet of shoreline owned by the applicant
- ☒ Mean high water line (MHWL) (tidal waters) or ordinary (or seasonal) high water line (OHWL) (non-tidal waters)
- ☒ The location and dimensions (length, width, height) of all existing and proposed structures or works located in, on, or over wetlands or other surface waters, within the project area
- ☒ Detailed cross-section views with complete dimensions
- ☐ The boundaries, size (square feet and acres), and type of each wetland (including herbaceous, forested, mangroves, seagrass, and other submerged/emergent vegetation) and other surface water in the project area
- ☐ Clearly shade or hatch each dredge or fill area, and label with the area (acres and square feet) and volume (cubic yards)
- ☐ Location and type of all proposed turbidity, erosion, and sedimentation control measures

2. Docks, Piers, Boat Slips, and Ramps

- ☒ Profile-view drawings that clearly show the elevation of the structure above MHWL (tidal waters) or OHWL (non-tidal waters); and water depth, in relation to mean low water (tidal waters) or ordinary or seasonal low water (non-tidal waters) at mooring sites and the bottom of the boat ramp (if applicable)
- ☒ Show width of waterway and the path and distance between the waterward end of the structure and the nearest marked navigation channel
- ☐ Number each slip
- ☐ Show and label width of deck planks and plank spacing

3. Seawalls and Other Shoreline Stabilization

- ☐ Location of the proposed structures in relation to MHWL (tidal waters), or OHWL (non-tidal waters), including measurements from at least 3 fixed structures or in relation to the existing structure(s), and location of new structure
- ☐ Cross-section drawings depicting the proposed shoreline stabilization structures (including geotextile fabric, anchors/tiebacks, and other features, if applicable) that clearly show the slope ratio (horizontal:vertical)
- ☐ Show how your structure will tie into neighboring structures, if applicable
- ☐ For living shorelines, identify the proposed plant species, and for each species, indicate the locations, spacing, and elevations relative to the mean high and low (for tidal waters) or ordinary or seasonal high (for non-tidal waters) water line

NOTE: If any part of your project has a potential to be located on state-owned submerged lands (i.e., waterward of the line of mean or ordinary high water of rivers, streams, bays, bayous, sounds, the Gulf of Mexico, the Atlantic Ocean, or natural lakes), please complete Section F of this application, as a separate authorization may be required to conduct activities on such lands.

Louh Dock

2951 Front Rd.
Jacksonville, FL 32257
Figure 1

Legend

 2951 Front Rd

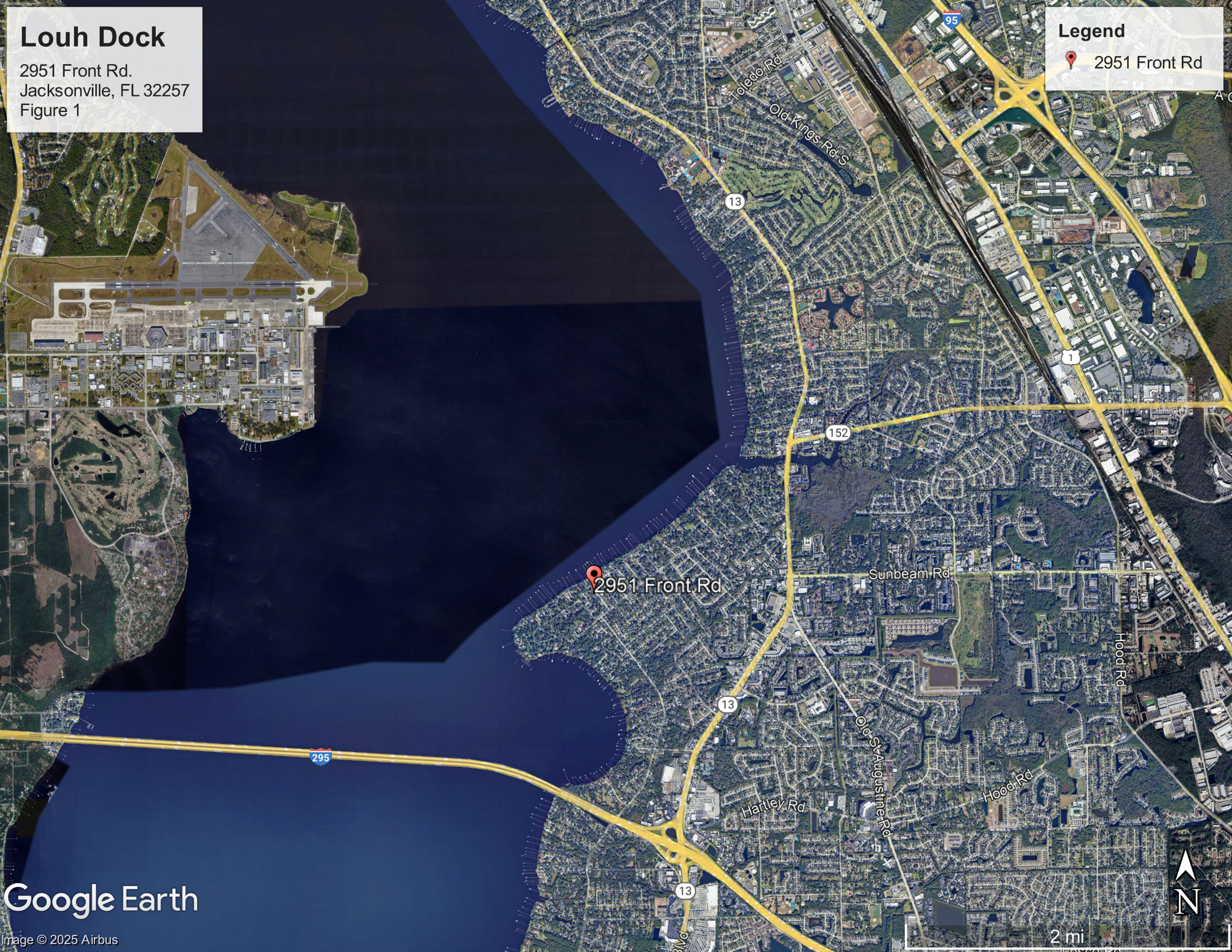

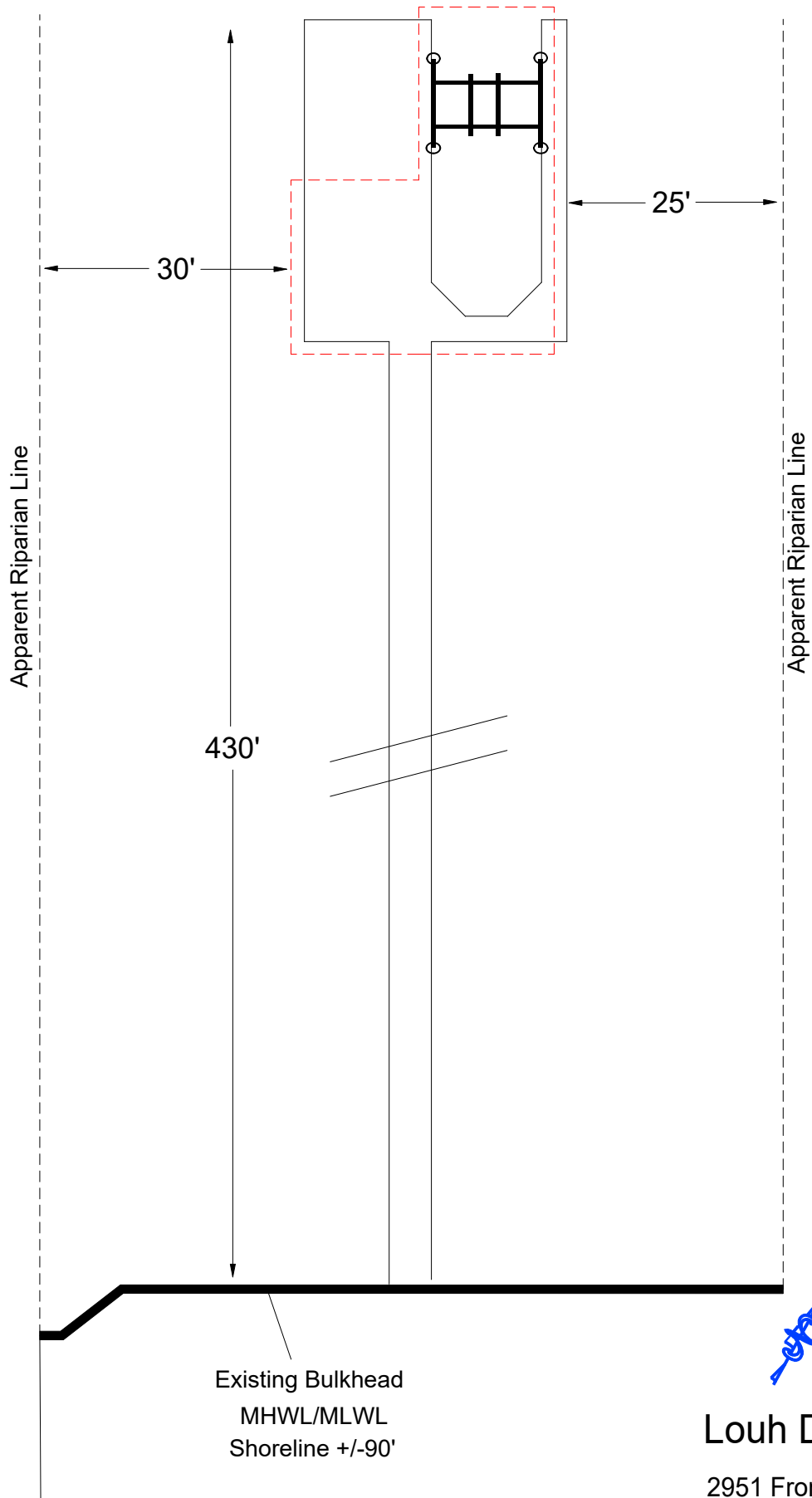

Louh Dock

2951 Front Rd.

Jacksonville, FL 32257

Figure 3

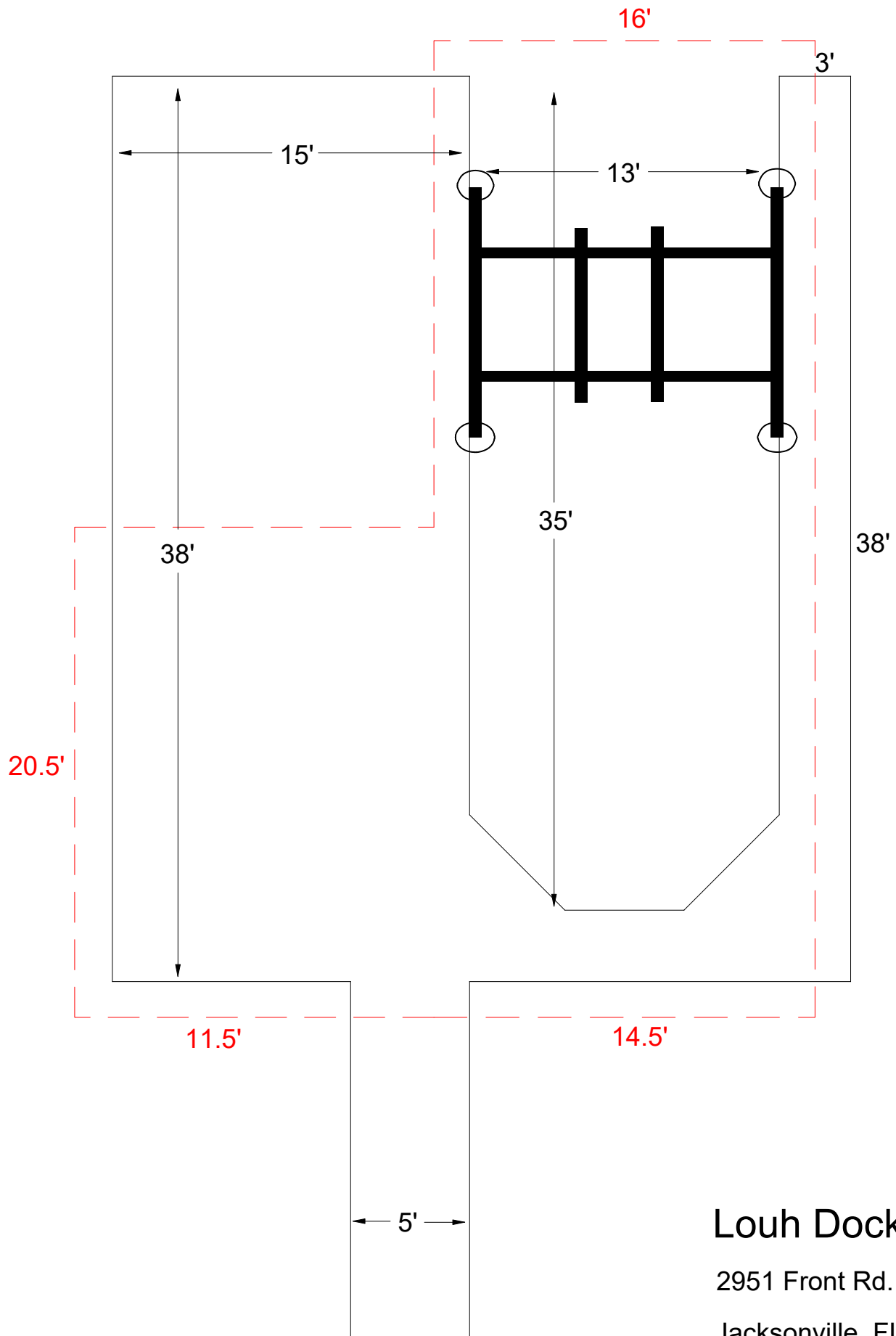

Louh Dock

2951 Front Rd.

Jacksonville, FL 32257

Figure 3

Louh Dock

2951 Front Rd.

Jacksonville, FL 32257

Figure 4

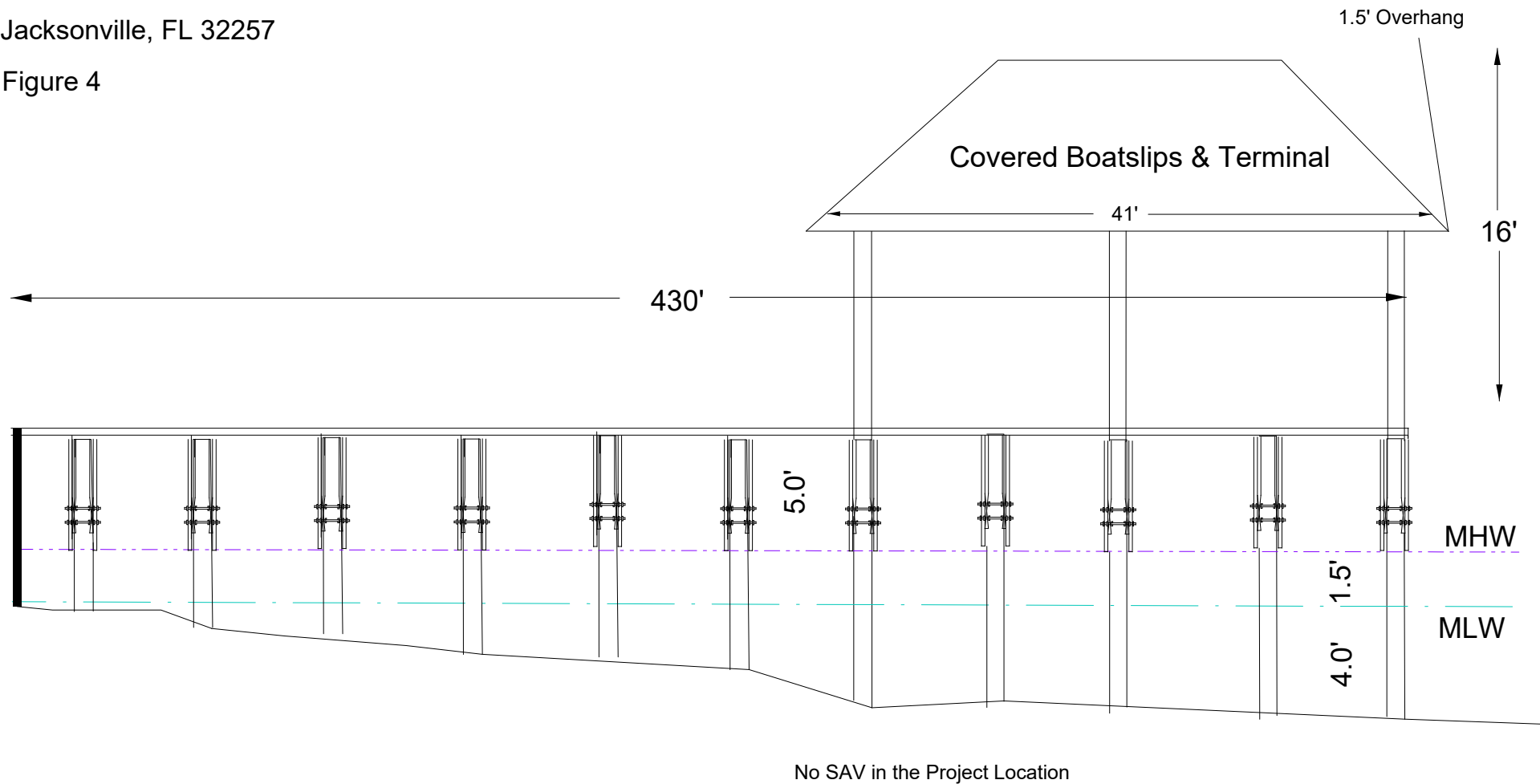

Louh Dock
2951 Front Rd.
Jacksonville, FL 32257
Figure 5

