

**TANK CLOSURE ASSESSMENT REPORT
30,000 GALLON USED OIL TANK**

**CEMEX SCL CEMENT MILL AND QUARRY
1200 NW 137TH AVENUE
MIAMI, MIAMI-DADE COUNTY, FLORIDA
Facility ID: 8521974**

Prepared for:

**CEMEX
1200 NW 137TH
Miami, Florida 33182**

Prepared by:



**700 DeSoto Avenue
Brooksville, FL 34601
Tel: 352.796.3374
Fax: 352.796.2449**

October 8, 2018

FLORIDA PROFESSIONAL GEOLOGIST CERTIFICATION

This closure assessment report for the 30,000-gallon used oil tank at the Cemex SCL Cement Mill and Quarry facility located at 1200 NW 137th Avenue, Miami, Miami-Dade County, Florida has been reviewed by George K. Foster of Creative Environmental Solutions, Inc. (CES), Brooksville, Florida, and appears to comply with the current standards and practices in the field of geology in the State of Florida. CES's professional services have been performed using the degree of care and skill ordinarily exercised under similar circumstances by other professionals practicing in this field. The certification of geologic work contained herein applies only to the original sealed document(s), and specifically does not pertain to any copies of this document or any portion thereof including mylars, linen, sepia or other materials which can be changed by the entity or entities with whom such document(s) are filed. No other warranty, expressed or implied, is made as to the professional advice in this report.

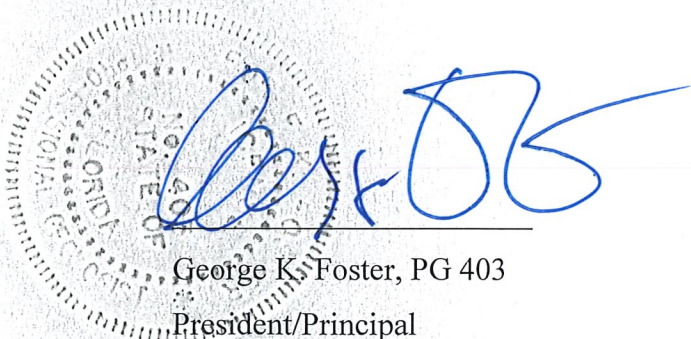

George K. Foster, PG 403
President/Principal
CES

10/2/18
Date of signature

INTRODUCTION

The Cemex SCL Cement Mill and Quarry facility is located at 1200 NW 137TH Avenue, Miami, Miami-Dade County, Florida and has been assigned Facility Identification Number 8521974. This Tank Closure Assessment Report (TCAR) is for a 30,000-gallon used oil above ground storage tank (AST) that has been removed. The tank was taken out of service decades ago. A site location map (Figure 1) and a site plan (Figure 2) are attached. The tank had been located at position 25°47'11.67" N and 80°25'10.36" W.

The tank held used oil that fueled the old wet-process cement kiln that was retired decades ago. At the same time, the product line that served the system was abandoned in place and filled with concrete.

IDENTIFICATION OF CONTRACTORS

Cliff Berry, Inc. of Miami, Florida conducted all construction activities. Waste soil and water were disposed in the Waste Management facility in Pompano Beach, Florida. Creative Environmental Solutions, Inc. (CES) of Brooksville, Florida prepared this TCAR.

SUMMARY OF CLOSURE ASSESSMENT

The 30,000-gallon used oil tank was removed on May 30, 2018 after 300 gallons of oily water had been pumped from the tank and disposed offsite. Removal of the underlying slab and enclosing building followed the tank removal. Impacted soil was identified beneath the tank on June 5, 2018, and Miami-Dade County Department of Environmental Resources Management (DERM) was notified of the release via email the same date. Between July 9 and July 11, 2018, impacted soil and concrete from around the base of the tank were excavated and disposed offsite. The presence of impacted soil was based on visual examination only. The areas excavated are shown on Figure 3. Photographs made during the excavation activities are attached. The excavation revealed the presence of free product on the water table. On August 6, 2018, product floating on the water table was skimmed and disposed offsite. The ratio of product to water was not estimated. On August 7, 2018, additional impacted soil was excavated and disposed offsite. Between

August 8 and August 27, 2018, additional product floating on the water table was skimmed and disposed offsite. No soil or groundwater samples were collected and/or analyzed as part of the TCAR. Waste manifests and weigh tickets are attached. A Discharge Reporting Form (DRF) was submitted to DERM on August 20, 2018; a copy is attached.

RESULTS

The source removal produced an excavation inside the containment structure roughly 25 feet by 25 feet in area and 6 feet deep. The excavation outside and on the west side of the containment structure was approximately 30 feet long, 5 feet wide and four feet deep. The water table was approximately 5 feet deep at the time of the source removal. According to the manifests, 35,800 gallons of petroleum-impacted water were pumped and disposed offsite. According the manifests and weigh tickets, 289.89 tons of petroleum-impacted soil were excavated and disposed offsite.

CONCLUSIONS AND RECOMMENDATIONS

The closure assessment demonstrated that a petroleum release has occurred at this facility. Additional impacted soil will be excavated and disposed offsite the week of October 8, 2018. The area will be backfilled with clean soil. At that time, a site assessment will be initiated. A formal Site Assessment Report will be delivered to DERM within 270 days of the date of discovery, which was June 5, 2018.

FIGURES

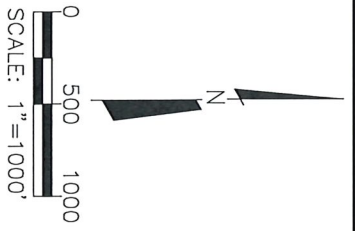

QUADRANGLE LOCATION

SECTION 34,
TOWNSHIP 53 SOUTH,
RANGE 39 EAST

Base Map:
HALEAH SW,
FLORIDA

USGS 7.5 Minute Quadrangle

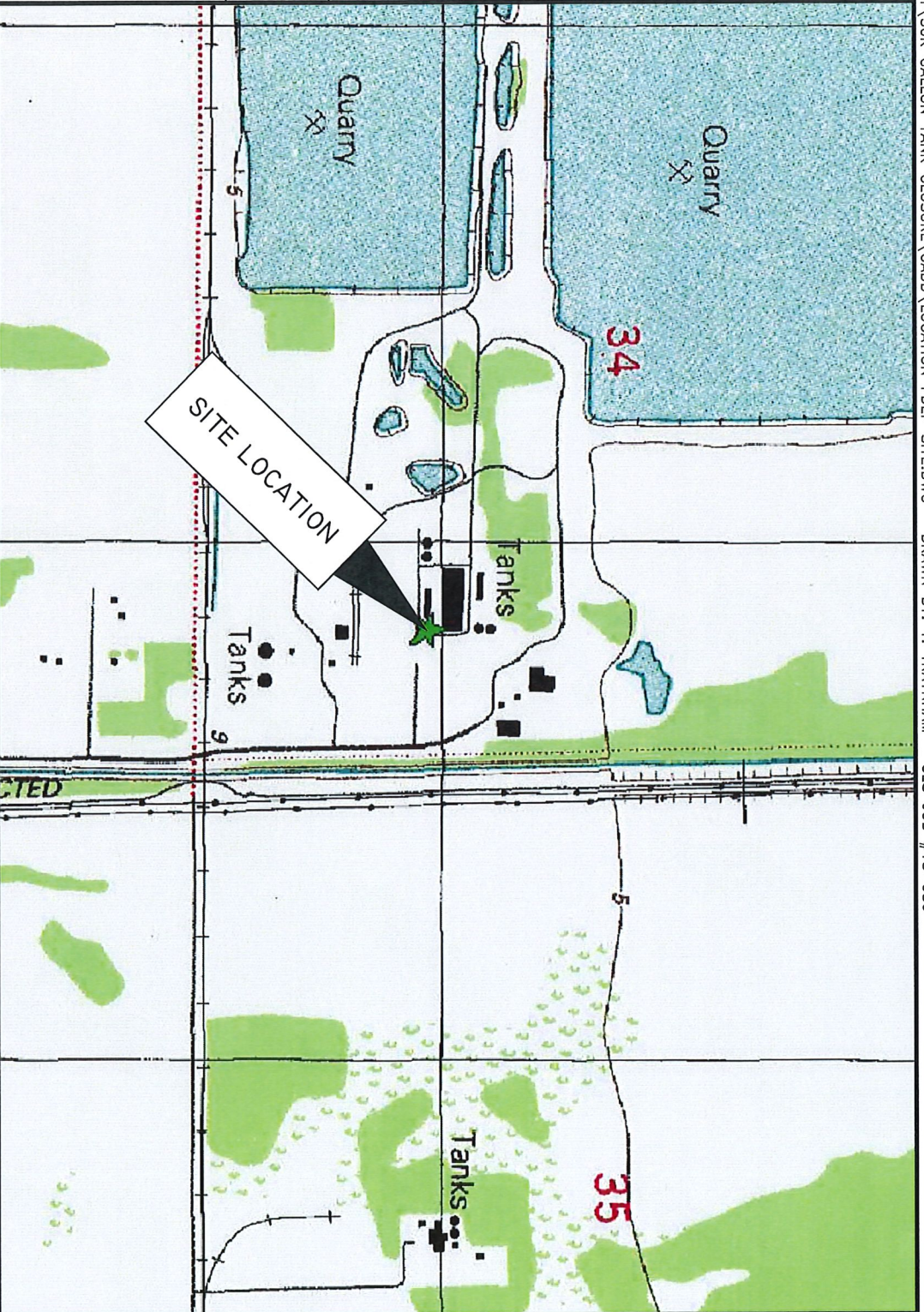

700 DeSoto Avenue
Brooksville, Florida 34601
Phone: (352) 796-3374 Fax: (352) 796-2449

FACILITY NAME

CEMEX-SCL CEMENT MILL & QUARRY

FACILITY ADDRESS

1200 NW 137th AVENUE
MIAMI, MIAMI-DADE COUNTY, FL

FACILITY ID NO.

138521974

DATE PREPARED

09-27-18

FIGURE NO.

1

FIGURE TITLE

SITE
LOCATION MAP

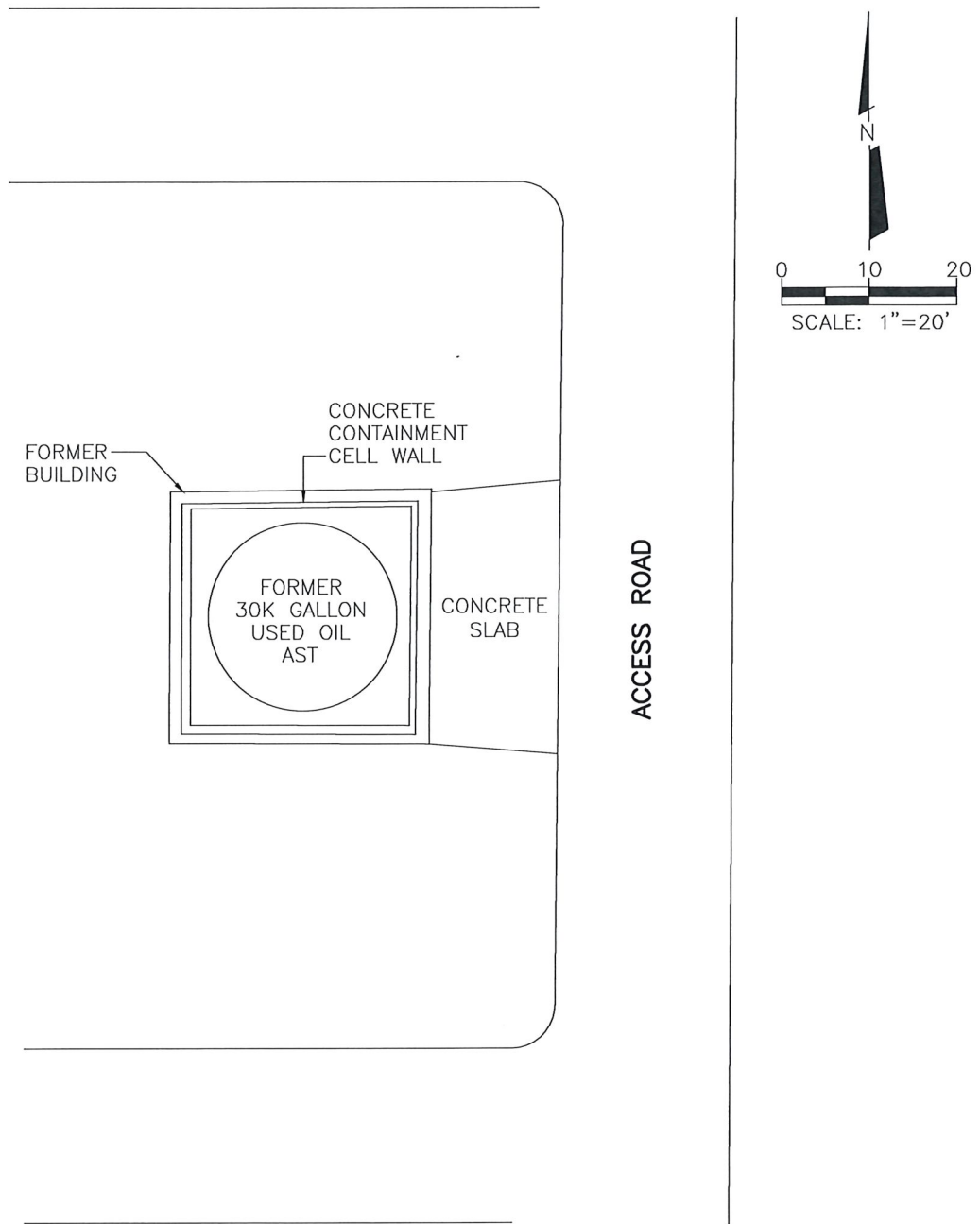

FACILITY NAME	CEMEX-SCL CEMENT MILL & QUARRY
FACILITY ADDRESS	1200 NW 137th AVENUE MIAMI, MIAMI-DADE COUNTY, FL
FACILITY ID NO.	138521974
DATE PREPARED	09-27-18

FIGURE NO.	2
FIGURE TITLE	30,000 GALLON USED OIL AST SITE PLAN

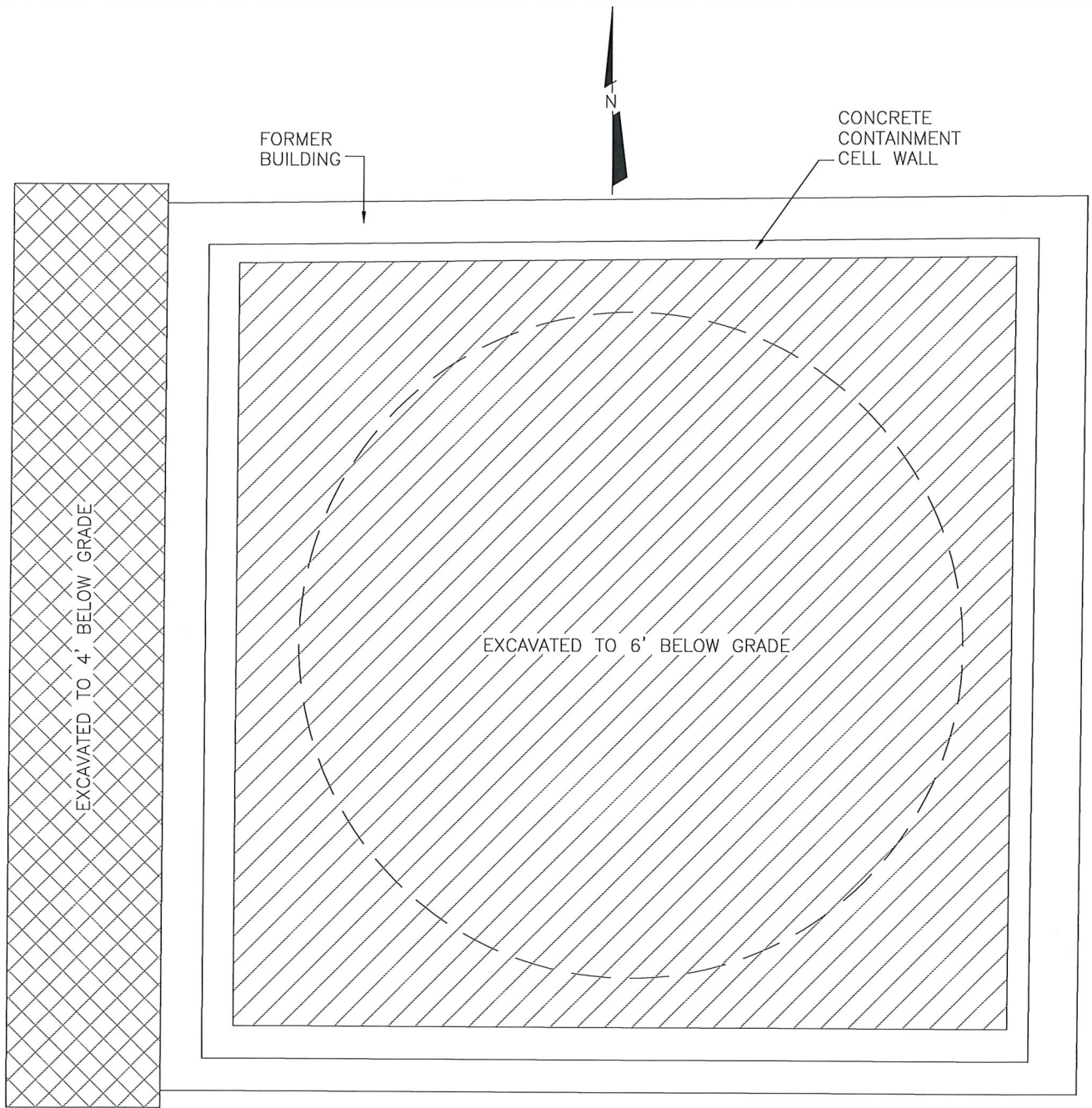

creative
Environmental
Solutions, Inc.
700 DeSoto Avenue
Brooksville, Florida 34601
Phone: (352) 796-3374 Fax: (352) 796-2449

FACILITY NAME

CEMEX-SCL CEMENT
MILL & QUARRY

FACILITY ADDRESS

1200 NW 137th AVENUE
MIAMI, MIAMI-DADE COUNTY, FL

FACILITY ID NO.

138521974

DATE PREPARED

09-27-18

FIGURE
NO.

3

FIGURE
TITLE

30,000
GALLON
USED
OIL AST
EXCAVATION
DETAIL

WASTE MANIFESTS AND WEIGHT TICKETS

Cliff Berry, Inc.
Environmental Services

Emergency Contact Telephone Number
3E@800-451-8346

433081

BILL OF LADING

1. Generator's US EPA ID No.

FLD981758485

Manifest Document No.

180406

2. Page 1 of 1

3. Name and Mailing Address
CEMEX CONSTRUCTION MATERIALS
SHARED SERVICES - POP TEAM
PO BOX 24731
WEST PALM BEACH FL, 33416-4731

DISPOSAL NON MARINE
FTL INDUSTRIAL MAINT

4. Phone 352-598-8822

4506301481

5. Transporter 1 Company Name
Cliff Berry (DANIA)

6. USA EPA ID Number
FLR000083071

A. Transporter's Phone
954-763-3390

7. Transporter 2 Company Name

8. USA EPA ID Number

B. Transporter's Phone

9. Designated Facility Name and Site Address
CLIFF BERRY MIAMI
3033 NW NORTH RIVER DRIVE, MIAMI, FL, 33142

10. USA EPA ID Number
FLD058560699

C. Facility's Phone
800 899-7745

11. Shipping Name and Description

12. Containers
No. Type

13. Total
Quantity

14. Unit
Wt/Vol

a. Non-Hazardous Liquid, (Petroleum contact water for recovery and recycling),

1

TT

300

G

b. Non-Hazardous Solid (Solids from line above)

1

TT

-

G

D. Additional Descriptions for Materials Listed Above
NR PCW

E. Pickup Location
CEMEX CONSTRUCTION MATERIALS
1200 NW 137TH AVENUE
MIAMI FL, 33182

PH 7.2

15. Special Handling Instructions and Additional Information
recover fuel for recycling

FLASHPOINT ABOVE 200F PETROLEUM CONTACT WATER (PCW) DESTINED FOR PRODUCT RECOVERY IN ACCORDANCE WITH CHAPTER 62-740FAC. PRODUCER HAS DETERMINED THE PCW DOES NOT CONTAIN LEVELS OF HAZARDOUS CONSTITUENTS ABOVE THOSE FOUND IN THE SOURCE OF THE PCW.

16. CERTIFICATION: This is to certify that the above named materials are properly classified, described, packaged, marked and labeled, and are in proper condition for transportation according to the applicable regulation of the Department of Transportation. I certify the materials described above on this manifest are not subject to federal regulations for reporting proper disposal of Hazardous Waste.

Printed/Typed Name

Signature

Month Day Year

17. Transporter 1 Acknowledgement of Receipt of Materials

Printed/Typed Name

Signature

Month Day Year

18. Transporter 2 Acknowledgement of Receipt of Materials

Printed/Typed Name

Signature

Month Day Year

19. Discrepancy Indication Space

20. Facility Owner or Operator: Certification of receipt of hazardous materials covered by this manifest except as noted in Item 19.

Printed/Typed Name

Signature

Month Day Year

7-BLC-M5 (Rev 10/96)

WHITE - ACCOUNTING / GREEN - TRANSPORTER 1 / YELLOW - TRANSPORTER 2 / PINK - FACILITY / GOLD - CUSTOMER

Cliff Berry, Inc.
Environmental Services

Emergency Contact Telephone Number
3E@800-451-8346

441633

**NON-HAZARDOUS
WASTE MANIFEST**

1. Generator's US EPA ID No.
FLD981758485

Manifest
Document No.
196288

Page 1 of 1

3. Name and Mailing Address CEMEX CONSTRUCTION MATERIALS
SHARED SERVICES - POP TEAM
PO BOX 24731
WEST PALM BEACH, FL 33416-4731

4. Phone 352-598-8822

DISPOSAL REMEDIATION
FTL INDUSTRIAL MAINT
pending 15-06492813

5. Transporter 1 Company Name
RETRANCA EQUIPMENT & TRUCKING CORP

6. USA EPA ID Number

A. Transporter's Phone
954-581-6613

7. Transporter 2 Company Name

8. USA EPA ID Number

B. Transporter's Phone

9. Designated Facility Name and Site Address
WASTE MANAGEMENT
2700 NW 48th Street, POMPANO BCH, FL,

10. USA EPA ID Number

C. Facility's Phone
305-325-9160

11. Shipping Name and Description

12. Containers
No. Type

13.
Total
Quantity

14.
Unit
Wt/Vol

a "Non-Hazardous Solid, (Sand-Soil-Grit and Petroleum Spirit)",

196288

1

DT

T

D. Additional Descriptions for Materials Listed Above
NR PETROLEUM CONTAMINATED SOIL

E. Pickup Location
CEMEX CONSTRUCTION MATERIALS
1200 NW 137TH AVENUE
MIAMI, FL 33182

15. Special Handling Instructions and Additional Information

Profile # 22346CB

67720(4)

16. CERTIFICATION: This is to certify that the above named materials are properly classified, described, packaged, marked and labeled, and are in proper condition for transportation according to the applicable regulation of the Department of Transportation. I certify the materials described above on this manifest are not subject to federal regulations for reporting proper disposal of Hazardous Waste.

Printed/Typed Name MARIA RODRIGUEZ

Signature

Maria Rodriguez

Month

Day

Year

17. Transporter 1 Acknowledgement of Receipt of Materials

Printed/Typed Name

Dan Timenez

Signature

Dan Timenez

Month

Day

Year

18. Transporter 2 Acknowledgement of Receipt of Materials

Printed/Typed Name

Signature

Month

Day

Year

19. Discrepancy Indication Space

20. Facility Owner or Operator: Certification of receipt of hazardous materials covered by this manifest except as noted in Item 19.

Printed/Typed Name

STORTI

Signature

STORTI

Month

Day

Year

1

7-BLC-MS (Rev 10/96)

WHITE - ACCOUNTING / GREEN - TRANSPORTER 1 / YELLOW - TRANSPORTER 2 / PINK - FACILITY / GOLD - CUSTOMER



Monarch Hill
2700 NW 48th Street
Pompano Beach, FL, 33073
Ph: (954) 984-2000

Original
Ticket# 1264638

Customer Name CLIFF CLIFF BERRY

Ticket Date 08/07/2018

Payment Type Credit Account

Manual Ticket#

Hauling Ticket#

Route

State Waste Code 22340C BROWARD

Manifest 196288

Destination

PO

Profile 22340CB (Soil Petro Spills)

Generator 114-CBI CLIFF BERRY INC

Carrier REC REC TRUCKING

Vehicle# 521

Volume

Container

Driver

Check#

Billing # 0008363

Gen EPA ID MASTER/VAR PROFILES

Grid

	Time	Scale	Operator	Inbound	Gross	
In	08/07/2018 14:36:59	Scale 4-307	ctorti		Tare	67720 lb
Out	08/07/2018 14:36:59		ctorti		Net	27820 lb
					Tons	39900 lb
						19.95

Comments

THANK YOU!

Product	LD%	Qty	UOM	Rate	Fee	Amount	Origin
1 Cont Soil Pet-Tons	100	19.95	Tons				BROWARD
2 FUEL-Fuel Surcharg	100		%				BROWARD
3 EVF-P-Standard Env	100		%				BROWARD
4 RCR-P-Regulatory C	100		%				BROWARD

"I certify that the waste I delivered to this facility on this date does not contain any regulated hazardous, toxic, radioactive waste or substances, or other non-allowable wastes. I also agree to remove any non-allowable wastes I bring to this facility, or pay all costs for proper removal of such wastes, upon request from this facility".

DRIVER: PLEASE SIGN HERE

Total Fees

Total Ticket

Cliff Berry, Inc.
Environmental Services

Emergency Contact Telephone Number
3E@800-451-8346

441633

**NON-HAZARDOUS
WASTE MANIFEST**

1. Generator's US EPA ID No.

FLD981758485

Manifest
Document No.

196289

Page 1 of 1

3. Name and Mailing Address CEMEX CONSTRUCTION MATERIALS
SHARED SERVICES - POP TEAM
PO BOX 24731
WEST PALM BEACH, FL 33416-4731

4. Phone 352-598-8822

DISPOSAL REMEDIATION

FTL INDUSTRIAL MAINT

pending

5. Transporter 1 Company Name
RETRANCA EQUIPMENT & TRUCKING CORP

6. USA EPA ID Number

A. Transporter's Phone

954-581-6613

7. Transporter 2 Company Name

8. USA EPA ID Number

B. Transporter's Phone

9. Designated Facility Name and Site Address
WASTE MANAGEMENT
2700 NW 48th Street, POMPAO BCH, FL,

10. USA EPA ID Number

C. Facility's Phone

305-325-9160

11. Shipping Name and Description

12. Containers

No. Type

13.
Total
Quantity

14.
Unit
Wt/Vol

a "Non-Hazardous Solid, (Sand-Soil-Grit and Petroleum Spirit)",

(196289)

1

DT

T

D. Additional Descriptions for Materials Listed Above
NR PETROLEUM CONTAMINATED SOIL

E. Pickup Location
CEMEX CONSTRUCTION MATERIALS
1200 NW 137TH AVENUE
MIAMI, FL 33182

15. Special Handling Instructions and Additional Information

Profile # 2234GCB

413203

16. CERTIFICATION: This is to certify that the above named materials are properly classified, described, packaged, marked and labeled, and are in proper condition for transportation according to the applicable regulation of the Department of Transportation. I certify the materials described above on this manifest are not subject to federal regulations for reporting proper disposal of Hazardous Waste.

Printed/Typed Name MARIA RODRIGUEZ

Signature

Maria Rodriguez

Month

Day

Year

17. Transporter 1 Acknowledgement of Receipt of Materials

Printed/Typed Name Jesus Garcia

Signature

Jesus Garcia

Month

Day

Year

18. Transporter 2 Acknowledgement of Receipt of Materials

Printed/Typed Name

Signature

Month

Day

Year

19. Discrepancy Indication Space

20. Facility Owner or Operator: Certification of receipt of hazardous materials covered by this manifest except as noted in Item 19.

Printed/Typed Name

Signature

OTOT

Month

Day

Year

SHIPPER / GENERATOR

TRANSPORTER

FACILITY

DRIVER'S Signature



Monarch Hill
2700 NW 48th Street
Pompano Beach, FL, 33073
Ph: (954) 984-2000

Original
Ticket# 1264646

Customer Name CLIFF CLIFF BERRY
Ticket Date 08/07/2018
Payment Type Credit Account
Manual Ticket#
Hauling Ticket#
Route
State Waste Code 2234GC BROWARD
Manifest 196289
Destination
PO
Profile 2234GCB (Soil Petro Spills)
Generator 114-CBI CLIFF BERRY INC

Carrier REC REC TRUCKING
Vehicle# 525
Container
Driver
Check#
Billing # 0008363
Gen EPA ID MASTER/VAR PROFILES
Grid

Volume

	Time	Scale	Operator	Inbound	Gross	
In	08/07/2018 14:53:36	Scale 3-307	ctorti		Tare	41320 lb
Out	08/07/2018 14:53:36		ctorti		Net	26480 lb
					Tons	14840 lb
						7.42

Comments

THANK YOU!

Product	LD%	Qty	UOM	Rate	Fee	Amount	Origin
1 Cont Soil Pet-Tons	100	7.42	Tons				BROWARD
2 FUEL-Fuel Surcharg	100		%				BROWARD
3 EVF-P-Standard Env	100		%				BROWARD
4 RCA-P-Regulatory C	100		%				BROWARD

"I certify that the waste I delivered to this facility on this date does not contain any regulated hazardous, toxic, radioactive waste or substances, or other non-allowable wastes. I also agree to remove any non-allowable wastes I bring to this facility, or pay all costs for proper removal of such wastes, upon request from this facility".

DRIVER: PLEASE SIGN HERE

Total Fees
Total Ticket

Cliff Berry, Inc.
Environmental Services

Emergency Contact Telephone Number
3E@800-451-8346

441633

**NON-HAZARDOUS
WASTE MANIFEST**

1. Generator's US EPA ID No.
FLD981758485

Manifest
Document No.
196287

Page 1 of 1

525

3. Name and Mailing Address
CEMEX CONSTRUCTION MATERIALS
SHARED SERVICES - POP TEAM
PO BOX 24731
WEST PALM BEACH, FL 33416-4731

4. Phone 352-598-8822

DISPOSAL REMEDIATION
FTL INDUSTRIAL MAINT
pending 4506492813

5. Transporter 1 Company Name
RETRANCA EQUIPMENT & TRUCKING CORP

6. USA EPA ID Number

A. Transporter's Phone
954-581-6613

7. Transporter 2 Company Name

8. USA EPA ID Number

B. Transporter's Phone

9. Designated Facility Name and Site Address
WASTE MANAGEMENT
2700 NW 48th Street, POMPANO BCH, FL,

10. USA EPA ID Number

C. Facility's Phone
305-325-9160

11. Shipping Name and Description

12. Containers
No. Type

13.
Total
Quantity

14.
Unit
Wt/Vol

a "Non-Hazardous Solid, (Sand-Soil-Grit and Petroleum Spirit)",

(196287)

1

DT

T

D. Additional Descriptions for Materials Listed Above
NR PETROLEUM CONTAMINATED SOIL

E. Pickup Location
CEMEX CONSTRUCTION MATERIALS
1200 NW 137TH AVENUE
MIAMI, FL 33182

15. Special Handling Instructions and Additional Information

Profile # 2234 GCB

(4) 6000

16. CERTIFICATION: This is to certify that the above named materials are properly classified, described, packaged, marked and labeled, and are in proper condition for transportation according to the applicable regulation of the Department of Transportation. I certify the materials described above on this manifest are not subject to federal regulations for reporting proper disposal of Hazardous Waste.

Printed/Typed Name MARIA RODRIGUEZ

Signature

Month 8 Day 7 Year 18

17. Transporter 1 Acknowledgement of Receipt of Materials

Printed/Typed Name

Jesus Garcia

Signature

Month 7 Day 8 Year 18

18. Transporter 2 Acknowledgement of Receipt of Materials

Printed/Typed Name

Signature

Month Day Year

19. Discrepancy Indication Space

20. Facility Owner or Operator: Certification of receipt of hazardous materials covered by this manifest except as noted in Item 19.

Printed/Typed Name

Philip Canedo

Signature

Month 8 Day 7 Year 18

7-BLC-115 (Rev 10/96)

WHITE - ACCOUNTING / GREEN - TRANSPORTER 1 / YELLOW - TRANSPORTER 2 / PINK - FACILITY / GOLD - CUSTOMER



Monarch Hill
2700 NW 48th Street
Pompano Beach, FL, 33073
Ph: (954) 984-2000

Original
Ticket# 1264901

Customer Name CLIFF CLIFF BERRY
Ticket Date 08/07/2018
Payment Type Credit Account
Manual Ticket#
Hauling Ticket#
Route
State Waste Code 2234GC BROWARD
Manifest 196287
Destination
PO
Profile 2234GCB (Soil Petro Spills)
Generator 114-CBI CLIFF BERRY INC

Carrier REC REC TRUCKING
Vehicle# 525
Container
Driver
Check#
Billing # 0008363
Gen EPA ID MASTER/VAR PROFILES
Grid

Volume

	Time	Scale	Operator	Inbound	Gross	
In	08/07/2018 11:31:44	Scale 4-304	pcamacho		Tare	61000 lb
Out	08/07/2018 11:53:46	Scale 2-304	pcamacho		Net	25640 lb
					Tons	35360 lb
						17.68

Comments REPLACEMENT TICKET FOR TICKET # 1264530

THANK YOU!

Product	LD%	Qty	UDM	Rate	Fee	Amount	Origin
1 Cont Soil Pet-Tons	100	17.68	Tons				BROWARD
2 FUEL-Fuel Surcharg	100		%				BROWARD
3 EVF-P-Standard Env	100		%				BROWARD
4 RCR-P-Regulatory C	100		%				BROWARD

"I certify that the waste I delivered to this facility on this date does not contain any regulated hazardous, toxic, radioactive waste or substances, or other non-allowable wastes. I also agree to remove any non-allowable wastes I bring to this facility, or pay all costs for proper removal of such wastes, upon request from this facility".

DRIVER: PLEASE SIGN HERE

Total Fees
Total Ticket

405WMFL

Signature

Cliff Berry, Inc.
Environmental Services

Emergency Contact Telephone Number
3E@800-451-8346

441633

NON-HAZARDOUS WASTE MANIFEST

1. Generator's US EPA ID No.
FLD981758485

Manifest
Document No.
196277

2. Page 1 of 1
① 521

3. Name and Mailing Address CEMEX CONSTRUCTION MATERIALS
SHARED SERVICES - POP TEAM
PO BOX 24731
WEST PALM BEACH, FL 33416-4731

4. Phone 352-598-8822

DISPOSAL REMEDIATION
FTL INDUSTRIAL MAINT
pending 4506492813

5. Transporter 1 Company Name
RETRANCA EQUIPMENT & TRUCKING CORP

6. USA EPA ID Number

A. Transporter's Phone
954-581-6613

7. Transporter 2 Company Name

8. USA EPA ID Number

B. Transporter's Phone

9. Designated Facility Name and Site Address
WASTE MANAGEMENT

10. USA EPA ID Number

C. Facility's Phone
305-325-9160

10800 NE 128TH AVE, OKEECHOBEE, FL 34072-7105

2300 NW 48th Street, Pompano Bch Fl

11. Shipping Name and Description

12. Containers
No. Type 13. Total
Quantity 14. Unit
Wt/Vol

a "Non-Hazardous Solid, (Sand-Soil-Grit and Petroleum Spirit)",

(196277)

1

OT

T

D. Additional Descriptions for Materials Listed Above
NR PETROLEUM CONTAMINATED SOIL

E. Pickup Location
CEMEX CONSTRUCTION MATERIALS
1200 NW 137TH AVENUE
MIAMI, FL 33182

15. Special Handling Instructions and Additional Information

Profile # 2234 GCB

③ 67360

16. CERTIFICATION: This is to certify that the above named materials are properly classified, described, packaged, marked and labeled, and are in proper condition for transportation according to the applicable regulation of the Department of Transportation. I certify the materials described above on this manifest are not subject to federal regulations for reporting proper disposal of Hazardous Waste.

Printed/Typed Name MARIA RODRIGUEZ

Signature

Month 7 Day 18 Year 18

17. Transporter 1 Acknowledgement of Receipt of Materials

Printed/Typed Name David Jimenez

Signature

Month 8 Day 7 Year 18

18. Transporter 2 Acknowledgement of Receipt of Materials

Printed/Typed Name

Signature

Month Day Year

19. Discrepancy Indication Space

20. Facility Owner or Operator: Certification of receipt of hazardous materials covered by this manifest except as noted in Item 19.

Printed/Typed Name Phillip Camacho

Signature

Month 8 Day 7 Year 18

WHITE - ACCOUNTING / GREEN - TRANSPORTER 1 / YELLOW - TRANSPORTER 2 / PINK - FACILITY / GOLD - CUSTOMER



Monarch Hill
2700 NW 48th Street
Pompano Beach, FL, 33073
Ph: (954) 984-2000

Original
Ticket# 1264898

Customer Name CLIFF CLIFF BERRY

Ticket Date 08/07/2018

Payment Type Credit Account

Manual Ticket#

Hauling Ticket#

Route

State Waste Code 22346C BROWARD

Manifest 196277

Destination

PG

Profile 22346CB (Soil Petro Spills)

Generator 114-CBI CLIFF BERRY INC

Carrier REC REC TRUCKING

Vehicle# 521

Volume

Container

Driver

Check#

Billing # 0008363

Gen EPA ID MASTER/VAR PROFILES

Grid

	Time	Scale	Operator	Inbound	Gross	
In	08/07/2018 11:30:13	Scale 3-304	pcamacho		Tare	67360 lb
Out	08/07/2018 11:50:52	Scale 3-304	pcamacho		Net	27640 lb
					Tons	39720 lb
						19.86

Comments REPLACEMENT TICKET FOR TICKET # 1264529

THANK YOU!

Product	LD%	Qty	UOM	Rate	Fee	Amount	Origin
1 Cont Soil Pet-Tons 100		19.86	Tons				BROWARD
2 FUEL-Fuel Surcharg 100			%				BROWARD
3 EVF-P-Standard Env 100			%				BROWARD
4 RCR-P-Regulatory C 100			%				BROWARD

"I certify that the waste I delivered to this facility on this date does not contain any regulated hazardous, toxic, radioactive waste or substances, or other non-allowable wastes. I also agree to remove any non-allowable wastes I bring to this facility, or pay all costs for proper removal of such wastes, upon request from this facility".

DRIVER: PLEASE SIGN HERE

Total Fees
Total Ticket

405WMFL

Driver's Signature

Cliff Berry, Inc.
Environmental Services

Emergency Contact Telephone Number
3E@800-451-8346

441633

Page 1 of 1

NON-HAZARDOUS WASTE MANIFEST

1. Generator's US EPA ID No.
FLD981758485

Manifest
Document No.
192983

2. #10

2812

3. Name and Mailing Address
CEMEX CONSTRUCTION MATERIALS
SHARED SERVICES - POP TEAM
PO BOX 24731
WEST PALM BEACH, FL 33416-4731

DISPOSAL REMEDIATION
FTL INDUSTRIAL MAINT
PENDING

4. Phone 352-598-8822

5. Transporter 1 Company Name
RETRANCA EQUIPMENT & TRUCKING CORP

6. USA EPA ID Number

A. Transporter's Phone
954-581-6613

7. Transporter 2 Company Name

8. USA EPA ID Number

B. Transporter's Phone

9. Designated Facility Name and Site Address
WASTE MANAGEMENT
2700 NW 48th Street, POMPANO BCH, FL,

10. USA EPA ID Number

C. Facility's Phone
305-325-9160

11. Shipping Name and Description

12. Containers
No. Type

13. Total
Quantity

14. Unit
Wt/Vol

a "Non-Hazardous Solid, (Sand-Soil-Grit and Petroleum Spirit)",

1

DT

20

T

D. Additional Descriptions for Materials Listed Above
NR PETROLEUM CONTAMINATED SOIL

E. Pickup Location
CEMEX CONSTRUCTION MATERIALS
1200 NW 137TH AVENUE
MIAMI, FL 33182

15. Special Handling Instructions and Additional Information

Profile # 2234600

③ 64640

16. CERTIFICATION: This is to certify that the above named materials are properly classified, described, packaged, marked and labeled, and are in proper condition for transportation according to the applicable regulation of the Department of Transportation. I certify the materials described above on this manifest are not subject to federal regulations for reporting proper disposal of Hazardous Waste.

7/10/18

Printed/Typed Name

Roger Hogg

Signature

[Signature]

Month Day Year

17. Transporter 1 Acknowledgement of Receipt of Materials

Printed/Typed Name

Eván O. DECAPO

Signature

[Signature]

Month Day Year

18. Transporter 2 Acknowledgement of Receipt of Materials

Printed/Typed Name

Signature

Month Day Year

19. Discrepancy Indication Space

20. Facility Owner or Operator: Certification of receipt of hazardous materials covered by this manifest except as noted in Item 19.

Printed/Typed Name

Phillip Camacho

Signature

[Signature]

7 11 18
Month Day Year

7-BLC-M5 (Rev 10/96)

WHITE - ACCOUNTING / GREEN - TRANSPORTER 1 / YELLOW - TRANSPORTER 2 / PINK - FACILITY / GOLD - CUSTOMER



Total Fees
Total Ticket

Driver's Signature

Monarch Hill

Original

2700 NW 48th Street
Pompano Beach, FL, 33073
Ph: (954) 984-2000

Ticket# 1256625

Customer Name CLIFF CLIFF BERRY

Carrier REC REC TRUCKING

Ticket Date 07/11/2018

Vehicle# 2812

Volume

Payment Type Credit Account

Container

Manual Ticket#

Driver

Hauling Ticket#

Check#

Route

Billing # 0008363

State Waste Code 22346C DADE

Gen EPA ID MASTER/VAR PROFILES

Manifest 192983

Grid

Destination

PO

Profile 22346CD (Soil Petro Spills)

Generator 114-CBI CLIFF BERRY INC

	Time	Scale	Operator	Inbound	Gross	
In	07/11/2018 11:56:08	Scale 3-301	pcamacho		Tare	64640 lb
Out	07/11/2018 11:56:08		pcamacho		Net	24850 lb
					Tons	39780 lb
						19.89

Comments

THANK YOU!

Product	LD%	Qty	UOM	Rate	Fee	Amount	Origin
1 Cont Soil Pet-Tons	100	19.89	Tons				MIAMIDADE
2 FUEL-Fuel Surcharg	100		%				MIAMIDADE
3 EVF-P-Standard Env	100		%				MIAMIDADE
4 RCR-P-Regulatory C	100		%				MIAMIDADE

"I certify that the waste I delivered to this facility on this date does not contain any regulated hazardous, toxic, radioactive waste or substances, or other non-allowable wastes. I also agree to remove any non-allowable wastes I bring to this facility, or pay all costs for proper removal of such wastes, upon request from this facility".

DRIVER: PLEASE SIGN HERE

405WMFL

Total Fees
Total Ticket

Cliff Berry, Inc.
Environmental Services

Emergency Contact Telephone Number
3E@800-451-8346

441633

**NON-HAZARDOUS
WASTE MANIFEST**

1. Generator's US EPA ID No.
FLD981758485

Manifest
Document No.
192982

2. Page 1 of 1

#9 1984

3. Name and Mailing Address CEMEX CONSTRUCTION MATERIALS
SHARED SERVICES - POP TEAM
PO BOX 24731
WEST PALM BEACH, FL 33416-4731

4. Phone 352-598-8822

DISPOSAL REMEDIATION
FTL INDUSTRIAL MAINT
PENDING

5. Transporter 1 Company Name
RETRANCA EQUIPMENT & TRUCKING CORP

6. USA EPA ID Number

A. Transporter's Phone
954-581-6613

7. Transporter 2 Company Name

8. USA EPA ID Number

B. Transporter's Phone

9. Designated Facility Name and Site Address
WASTE MANAGEMENT
2700 NW 48th Street, POMPANO BCH, FL,

10. USA EPA ID Number

C. Facility's Phone
305-325-9160

11. Shipping Name and Description

12. Containers
No. Type

13.
Total
Quantity

14.
Unit
Wt/Vol

a "Non-Hazardous Solid, (Sand-Soil-Grit and Petroleum Spirit)",

(192982)

1

DT

20

G

D. Additional Descriptions for Materials Listed Above
NR PETROLEUM CONTAMINATED SOIL

E. Pickup Location
CEMEX CONSTRUCTION MATERIALS
1200 NW 137TH AVENUE
MIAMI, FL 33182

15. Special Handling Instructions and Additional Information

Profile # 2234600

71040

16. CERTIFICATION: This is to certify that the above named materials are properly classified, described, packaged, marked and labeled, and are in proper condition for transportation according to the applicable regulation of the Department of Transportation. I certify the materials described above on this manifest are not subject to federal regulations for reporting proper disposal of Hazardous Waste.

Printed/Typed Name

Roger Hogg

Signature

7/10/10

Month Day Year

17. Transporter 1 Acknowledgement of Receipt of Materials

Printed/Typed Name

Signature

Month Day Year

18. Transporter 2 Acknowledgement of Receipt of Materials

Printed/Typed Name

Signature

Month Day Year

19. Discrepancy Indication Space

20. Facility Owner or Operator Certification of receipt of hazardous materials covered by this manifest except as noted in Item 19.

Printed/Typed Name

Warner

Signature

7 11 10

Month Day Year



Original

Monarch Hill

2700 NW 48th Street
Pompano Beach, FL, 33073
Ph: (954) 984-2000

Ticket# 1256600

Customer Name CLIFF CLIFF BERRY

Ticket Date 07/11/2018

Payment Type Credit Account

Manual Ticket#

Hauling Ticket#

Route

State Waste Code 2234GC DADE

Manifest 192982

Destination

PO

Profile 2234GCD (Soil Petro Spills)

Generator 114-CBI CLIFF BERRY INC

Carrier REC REC TRUCKING

Vehicle# 1984

Volume

Container

Driver

Check#

Billing # 0008363

Gen EPA ID MASTER/VAR PROFILES

Grid

	Time	Scale	Operator	Inbound	Gross	
In	07/11/2018 11:34:20	Scale 1-309	ASUAZ		Tare	71040 lb
Out	07/11/2018 11:34:20		ASUAZ		Net	24200 lb
					Tons	46840 lb
						23.42

Comments

THANK YOU!

Product	LDX	Qty	UDM	Rate	Fee	Amount	Origin
1 Cont Soil Pet-Tons	100	23.42	Tons				MIAMIDADE
2 FUEL-Fuel Surcharg	100		%				MIAMIDADE
3 EVF-P-Standard Env	100		%				MIAMIDADE
4 RCR-P-Regulatory C	100		%				MIAMIDADE

"I certify that the waste I delivered to this facility on this date does not contain any regulated hazardous, toxic, radioactive waste or substances, or other non-allowable wastes. I also agree to remove any non-allowable wastes I bring to this facility, or pay all costs for proper removal of such wastes, upon request from this facility".

DRIVER: PLEASE SIGN HERE

Total Fees

Total Ticket

Cliff Berry, Inc.
Environmental Services

Emergency Contact Telephone Number
3E@800-451-8346

441633

**NON-HAZARDOUS
WASTE MANIFEST**

1. Generator's US EPA ID No.
FLD981758485

Manifest
Document No.
192981

2. #8 Page 1 of 1

3. Name and Mailing Address
CEMEX CONSTRUCTION MATERIALS
SHARED SERVICES - POP TEAM
PO BOX 24731
WEST PALM BEACH, FL 33416-4731

DISPOSAL REMEDIATION
FTL INDUSTRIAL MAINT
PENDING

4. Phone 352-598-8822

5. Transporter 1 Company Name
RETRANCA EQUIPMENT & TRUCKING CORP

6. USA EPA ID Number

A. Transporter's Phone
954-581-6613

7. Transporter 2 Company Name

8. USA EPA ID Number

B. Transporter's Phone

9. Designated Facility Name and Site Address
WASTE MANAGEMENT
2700 NW 48th Street, POMPANO BCH, FL,

10. USA EPA ID Number

C. Facility's Phone
305-325-9160

11. Shipping Name and Description

12. Containers
No. Type

13. Total
Quantity

14. Unit
Wt/Vol

a "Non-Hazardous Solid, (Sand-Soil-Grit and Petroleum Spirit)",

1

DT

20

T

D. Additional Descriptions for Materials Listed Above
NR PETROLEUM CONTAMINATED SOIL

E. Pickup Location
CEMEX CONSTRUCTION MATERIALS
1200 NW 137TH AVENUE
MIAMI, FL 33182

15. Special Handling Instructions and Additional Information

Profile # 2234600

73880(3)

16. CERTIFICATION: This is to certify that the above named materials are properly classified, described, packaged, marked and labeled, and are in proper condition for transportation according to the applicable regulation of the Department of Transportation. I certify the materials described above on this manifest are not subject to federal regulations for reporting proper disposal of Hazardous Waste.

7/10/18

Printed/Typed Name Roger Hogg

Signature [Signature]

Month Day Year

17. Transporter 1 Acknowledgement of Receipt of Materials

Printed/Typed Name

Signature

Month Day Year

18. Transporter 2 Acknowledgement of Receipt of Materials

Printed/Typed Name CRUZ IVAN

Signature [Signature]

Month Day Year

19. Discrepancy Indication Space

20. Facility Owner or Operator: Certification of receipt of hazardous materials covered by this manifest except as noted in Item 19.

Printed/Typed Name GORTI

Signature [Signature]

Month Day Year

7-BLC-MS (Rev 10/96)

WHITE - ACCOUNTING / GREEN - TRANSPORTER 1 / YELLOW - TRANSPORTER 2 / PINK - FACILITY / GOLD - CUSTOMER



Monarch Hill
2700 NW 48th Street
Pompano Beach, FL, 33073
Ph: (954) 984-2000

Original
Ticket# 1256373

Customer Name CLIFF CLIFF BERRY
Ticket Date 07/10/2018
Payment Type Credit Account
Manual Ticket#
Hauling Ticket#
Route
State Waste Code 22346C DADE
Manifest 192981
Destination
PO
Profile 22346CD (Soil Petro Spills)
Generator 114-CBI CLIFF BERRY INC

Carrier REC REC TRUCKING
Vehicle# 1305
Container
Driver
Check#
Billing # 0008363
Gen EPA ID MASTER/VAR PROFILES
Grid

Volume

	Time	Scale	Operator	Inbound	Gross	
In	07/10/2018 10:57:23	Scale 3-307	ctorti		Tare	73880 lb
Out	07/10/2018 10:57:23		ctorti		Net	24600 lb
					Tons	49280 lb
						24.64

Comments REPLACEMENT TICKET FOR TICKET # 1256208

THANK YOU!

Product	LDX	Qty	UOM	Rate	Fee	Amount	Origin
1 Cont Soil Pet-Tons	100	24.64	Tons				MIAMIDADE
2 FUEL-Fuel Surcharg	100		%				MIAMIDADE
3 EVF-P-Standard Env	100		%				MIAMIDADE
4 RCR-P-Regulatory C	100		%				MIAMIDADE

"I certify that the waste I delivered to this facility on this date does not contain any regulated hazardous, toxic, radioactive waste or substances, or other non-allowable wastes. I also agree to remove any non-allowable wastes I bring to this facility, or pay all costs for proper removal of such wastes, upon request from this facility".

DRIVER: PLEASE SIGN HERE

Total Fees
Total Ticket

405WMFL

Driver's Signature

Cliff Berry, Inc.
Environmental Services

Emergency Contact Telephone Number
3E@800-451-8346

441633

**NON-HAZARDOUS
WASTE MANIFEST**

1. Generator's US EPA ID No.

FLD981758485

Manifest
Document No.

192718

2. Page 1 of 1

#22812

3. Name and Mailing Address
CEMEX CONSTRUCTION MATERIALS
SHARED SERVICES - POP TEAM
PO BOX 24731
WEST PALM BEACH, FL 33416-4731

4. Phone 352-598-8822

DISPOSAL REMEDIATION
FTL INDUSTRIAL MAINT
PENDING

5. Transporter 1 Company Name
RETRANCA EQUIPMENT & TRUCKING CORP

6. USA EPA ID Number

A. Transporter's Phone
954-581-6613

7. Transporter 2 Company Name

8. USA EPA ID Number

B. Transporter's Phone

9. Designated Facility Name and Site Address
WASTE MANAGEMENT

10. USA EPA ID Number

C. Facility's Phone
305-325-9160

~~10000 NE 128TH AVE, OKEECHOBEE, FL 34972-7105~~
J.S.
2700 NW 48TH ST. Pompano Beach FL.

11. Shipping Name and Description

12. Containers
No. Type

13.
Total
Quantity

14.
Unit
Wt/Vol

a "Non-Hazardous Solid, (Sand-Soil-Grit and Petroleum Spirit)",

1

DT

20

T

D. Additional Descriptions for Materials Listed Above
NR PETROLEUM CONTAMINATED SOIL

E. Pickup Location
CEMEX CONSTRUCTION MATERIALS
1200 NW 137TH AVENUE
MIAMI, FL 33182

15. Special Handling Instructions and Additional Information

Profile # 2234660

67080 ①

16. CERTIFICATION: This is to certify that the above named materials are properly classified, described, packaged, marked and labeled, and are in proper condition for transportation according to the applicable regulation of the Department of Transportation. I certify the materials described above on this manifest are not subject to federal regulations for reporting proper disposal of Hazardous Waste.

Printed/Typed Name

Roger Hogg

Signature

[Signature]

Month Day Year

7/7/18

17. Transporter 1 Acknowledgement of Receipt of Materials

Printed/Typed Name

Ron O. DeGroot

Signature

[Signature]

Month Day Year

18. Transporter 2 Acknowledgement of Receipt of Materials

Printed/Typed Name

Signature

[Signature]

Month Day Year

19. Discrepancy Indication Space

20. Facility Owner or Operator: Certification of receipt of hazardous materials covered by this manifest except as noted in Item 19.

Printed/Typed Name

C. T. S. R. T. I.

Signature

[Signature]

Month Day Year

7/9/18

1 SLC-M5 (Rev 10/96)

WHITE - ACCOUNTING / GREEN - TRANSPORTER 1 / YELLOW - TRANSPORTER 2 / PINK - FACILITY / GOLD - CUSTOMER



Monarch Hill
2700 NW 48th Street
Pompano Beach, FL, 33073
Ph: (954) 984-2000

Original
Ticket# 1256367

Customer Name CLIFF CLIFF BERRY
Ticket Date 07/09/2018
Payment Type Credit Account
Manual Ticket#
Hauling Ticket#
Route
State Waste Code 22346C DADE
Manifest 192718
Destination
PO
Profile 22346CD (Soil Petro Spills)
Generator 114-CBI CLIFF BERRY INC

Carrier REC REC TRUCKING
Vehicle# 2812
Container
Driver
Check#
Billing # 0008363
Gen EPA ID MASTER/VAR PROFILES
Grid

Volume

	Time	Scale	Operator	Inbound	Gross	
In	07/09/2018 11:49:05	Scale 2-304	ctorti		Tare	67080 lb
Out	07/09/2018 12:17:01	Scale 1-307	ctorti		Net	24860 lb
					Tons	42280 lb
						21.11

Comments REPLACEMENT TICKET FOR TICKET # 1255794

THANK YOU!

Product	LDX	Qty	UOM	Rate	Fee	Amount	Origin
1	Cont Soil Pet-Tons 100	21.11	Tons				MIAMIDADE
2	FUEL-Fuel Surcharg 100		%				MIAMIDADE
3	EVF-P-Standard Env 100		%				MIAMIDADE
4	RCR-P-Regulatory C 100		%				MIAMIDADE

"I certify that the waste I delivered to this facility on this date does not contain any regulated hazardous, toxic, radioactive waste or substances, or other non-allowable wastes. I also agree to remove any non-allowable wastes I bring to this facility, or pay all costs for proper removal of such wastes, upon request from this facility".

DRIVER: PLEASE SIGN HERE

Total Fees
Total Ticket

405WMFL

Driver's Signature

Cliff Berry, Inc.
Environmental Services

Emergency Contact Telephone Number
3E@800-451-8346

441633

**NON-HAZARDOUS
WASTE MANIFEST**

1. Generator's US EPA ID No.

FLD981758485

Manifest Document No.

192719

Page 1 of 1

#3 1984

3. Name and Mailing Address CEMEX CONSTRUCTION MATERIALS

SHARED SERVICES - POP TEAM

PO BOX 24731

WEST PALM BEACH, FL 33416-4731

4. Phone 352-598-8822

DISPOSAL REMEDIATION

FTL INDUSTRIAL MAINT

PENDING

5. Transporter 1 Company Name
RETRANCA EQUIPMENT & TRUCKING CORP

6. USA EPA ID Number

A. Transporter's Phone
954-581-6613

7. Transporter 2 Company Name

8. USA EPA ID Number

B. Transporter's Phone

9. Designated Facility Name and Site Address
WASTE MANAGEMENT

10. USA EPA ID Number

C. Facility's Phone
305-325-9160

10800 NE 128TH AVE, OKEECHOBEE, FL 34972-7105 JS,

11. Shipping Name and Description

12. Containers

No.

Type

13. Total Quantity

14. Unit Wt/Vol

a "Non-Hazardous Solid, (Sand-Soil-Grit and Petroleum Spirit)",

1

DT

20

T

D. Additional Descriptions for Materials Listed Above
NR PETROLEUM CONTAMINATED SOIL

E. Pickup Location
CEMEX CONSTRUCTION MATERIALS
1200 NW 137TH AVENUE
MIAMI, FL 33182

15. Special Handling Instructions and Additional Information

Profile # 2234600

65640 (4)

16. CERTIFICATION: This is to certify that the above named materials are properly classified, described, packaged, marked and labeled, and are in proper condition for transportation according to the applicable regulation of the Department of Transportation. I certify the materials described above on this manifest are not subject to federal regulations for reporting proper disposal of Hazardous Waste.

Printed/Typed Name

Roger Hogg

Signature

[Signature]

Month Day Year

7/19/18

17. Transporter 1 Acknowledgement of Receipt of Materials

Printed/Typed Name

X [Signature]

Signature

[Signature]

Month Day Year

18. Transporter 2 Acknowledgement of Receipt of Materials

Printed/Typed Name

Signature

[Signature]

Month Day Year

19. Discrepancy Indication Space

20. Facility Owner or Operator Certification of receipt of hazardous materials covered by this manifest except as noted in Item 19.

Printed/Typed Name

[Signature]

Signature

[Signature]

Month Day Year

7 9 18



Total Fees
Total Ticket

Driver's Signature

Monarch Hill

Original

2700 NW 48th Street
Pompano Beach, FL, 33073
Ph: (954) 984-2000

Ticket# 1255988

Customer Name CLIFF CLIFF BERRY

Carrier REC REC TRUCKING

Ticket Date 07/09/2018

Vehicle# 1984

Volume

Payment Type Credit Account

Container

Manual Ticket#

Driver

Hauling Ticket#

Check#

Route

Billing # 0008363

State Waste Code 2234GC DADE

Gen EPA ID MASTER/VAR PROFILES

Manifest 192719

Grid

Destination

PD

Profile 2234GCD (Soil Petro Spills)

Generator 114-CBI CLIFF BERRY INC

	Time	Scale	Operator	Inbound	Gross	
In	07/09/2018 11:57:31	Scale 4-309	cmecado		fare	65640 lb 24200 lb
Out	07/09/2018 12:15:59	Scale 2-309	cmecado		Net	41440 lb
					Tons	20.72

Comments REPLACEMENT TICKET FOR TICKET # 1255802

THANK YOU!

Product	LD%	Qty	UOM	Rate	Fee	Amount	Origin
---------	-----	-----	-----	------	-----	--------	--------

"I certify that the waste I delivered to this facility on this date does not contain any regulated hazardous, toxic, radioactive waste or substances, or other non-allowable wastes. I also agree to remove any non-allowable wastes from this facility. I will pay all costs for proper removal of such wastes, upon request from this facility".

DRIVER: PLEASE SIGN HERE

MIAMI/DADE

1305 - Requisition # 10898880

Cliff Berry, Inc.
Environmental Services

Emergency Contact Telephone Number
3E@800-451-8346

441633

**NON-HAZARDOUS
WASTE MANIFEST**

1. Generator's US EPA ID No.
FLD981758485

Manifest
Document No.
192720

2. Page 1 of 1

3. Name and Mailing Address
CEMEX CONSTRUCTION MATERIALS
SHARED SERVICES - POP TEAM
PO BOX 24731
WEST PALM BEACH, FL 33416-4731

DISPOSAL REMEDIATION
FTL INDUSTRIAL MAINT
PENDING

4. Phone 352-598-8822

5. Transporter 1 Company Name
RETRANCA EQUIPMENT & TRUCKING CORP

6. USA EPA ID Number

A. Transporter's Phone
954-581-6613

7. Transporter 2 Company Name

8. USA EPA ID Number

B. Transporter's Phone

9. Designated Facility Name and Site Address
WASTE MANAGEMENT

10. USA EPA ID Number

C. Facility's Phone
305-325-9160

10800 NE 128TH AVE, OKEECHOBEE, FL 34972-7105

2600 NW 48 ST

11. Shipping Name and Description

12. Containers
No. Type

13. Total
Quantity

14. Unit
Wt/Vol

a "Non-Hazardous Solid, (Sand-Soil-Grit and Petroleum Spirit)",

1

DT

20

T

D. Additional Descriptions for Materials Listed Above
NR PETROLEUM CONTAMINATED SOIL

E. Pickup Location
CEMEX CONSTRUCTION MATERIALS
1200 NW 137TH AVENUE
MIAMI, FL 33182

15. Special Handling Instructions and Additional Information

Profile # 2234600

72080

16. CERTIFICATION: This is to certify that the above named materials are properly classified, described, packaged, marked and labeled, and are in proper condition for transportation according to the applicable regulation of the Department of Transportation. I certify the materials described above on this manifest are not subject to federal regulations for reporting proper disposal of Hazardous Waste.

Printed/Typed Name

Roger Hagg

Signature

[Signature]

Month Day Year

7/9/18

17. Transporter 1 Acknowledgement of Receipt of Materials

Printed/Typed Name

Signature

Month Day Year

18. Transporter 2 Acknowledgement of Receipt of Materials

Printed/Typed Name

CRUZ JUAN

Signature

[Signature]

Month Day Year

19. Discrepancy Indication Space

20. Facility Owner or Operator: Certification of receipt of hazardous materials covered by this manifest except as noted in Item 19.

Printed/Typed Name

Cindy M

Signature

[Signature]

Month Day Year

9-18

1

7-BLC-M5 (Rev 10/96)

WHITE - ACCOUNTING / GREEN - TRANSPORTER 1 / YELLOW - TRANSPORTER 2 / PINK - FACILITY / GOLD - CUSTOMER



Monarch Hill

Total Fees

Total Ticket

Ticket# 1255909

2700 NW 48th Street

Pompano Beach, FL, 33073

Ph: (954) 984-2000

Driver's Signature

Customer Name CLIFF CLIFF BERRY

Ticket Date 07/09/2018

Payment Type Credit Account

Manual Ticket#

Hauling Ticket#

Route

State Waste Code 22346C DADE

Manifest 192720

Destination

PO

Profile 22346CD (Soil Petro Spills)

Generator 114-CBI CLIFF BERRY INC

Carrier REC REC TRUCKING

Vehicle# 1305

Volume

Container

Driver

Check#

Billing # 0008363

Gen EPA ID MASTER/VAR PROFILES

Grid

	Time	Scale	Operator	Inbound	Gross	
In	07/09/2018 13:49:37	Scale 3-301	caerado		Tare	72000 lb
Out	07/09/2018 13:49:37		caerado		Net	24600 lb
					Tons	47400 lb
						23.74

Comments REPLACEMENT TICKET FOR TICKET # 1255894

THANK YOU!

Product	LDX	Qty	UOM	Rate	Fee	Amount	Origin
1 Cont Soil Pet-Tons 100		23.74	Tons				MIAMI/DADE
2 FUEL-Fuel Surcharg 100			%				
3 EVF-P-Standard Env 100			%				
4 RCR-P-Regulatory C 100			%				

"I certify that the waste I delivered to this facility on this date does not contain any regulated hazardous, toxic, radioactive waste or substances, or other non-allowable wastes. I also agree to remove any non-allowable wastes I bring to this facility, or pay all costs for proper removal of such wastes, upon request from this facility".

DRIVER: PLEASE SIGN HERE

Total Fees

Total Ticket

405WMFL

Driver's Signature

Cliff Berry, Inc.
Environmental Services

Emergency Contact Telephone Number
3E@800-451-8346

441633

**NON-HAZARDOUS
WASTE MANIFEST**

1. Generator's US EPA ID No.
FLD981758485

Manifest
Document No.
192721

2. Page 1 of 1

3. Name and Mailing Address
CEMEX CONSTRUCTION MATERIALS
SHARED SERVICES - POP TEAM
PO BOX 24731
WEST PALM BEACH, FL 33416-4731

4. Phone 352-598-8822

DISPOSAL REMEDIATION
FTL INDUSTRIAL MAINT
PENDING

5. Transporter 1 Company Name
RETRANCA EQUIPMENT & TRUCKING CORPC

6. USA EPA ID Number

A. Transporter's Phone
954-581-6613

7. Transporter 2 Company Name

8. USA EPA ID Number

B. Transporter's Phone

9. Designated Facility Name and Site Address
WASTE MANAGEMENT

10. USA EPA ID Number

C. Facility's Phone
305-325-9160

10800 NE 128TH AVE, OKEECHOBEE, FL 34972-7105

2700 NW 48TH ST Pompano Beach FLA

11. Shipping Name and Description

12. Containers
No. Type

13.
Total
Quantity

14.
Unit
Wt/Vol

a "Non-Hazardous Solid, (Sand-Soil-Grit and Petroleum Spirit)",

1

DT

20

T

D. Additional Descriptions for Materials Listed Above
NR PETROLEUM CONTAMINATED SOIL

E. Pickup Location
CEMEX CONSTRUCTION MATERIALS
1200 NW 137TH AVENUE
MIAMI, FL 33182

15. Special Handling Instructions and Additional Information

Profile # 2234600

72340

16. CERTIFICATION: This is to certify that the above named materials are properly classified, described, packaged, marked and labeled, and are in proper condition for transportation according to the applicable regulation of the Department of Transportation. I certify the materials described above on this manifest are not subject to federal regulations for reporting proper disposal of Hazardous Waste.

Printed/Typed Name

Roger Hagg

Signature

[Signature]

Month Day Year

7/9/18

17. Transporter 1 Acknowledgement of Receipt of Materials

Printed/Typed Name

[Signature]

Signature

[Signature]

Month Day Year

18. Transporter 2 Acknowledgement of Receipt of Materials

Printed/Typed Name

Signature

Month Day Year

19. Discrepancy Indication Space

20. Facility Owner or Operator: Certification of receipt of hazardous materials covered by this manifest except as noted in Item 19.

Printed/Typed Name

Cindy m

Signature

[Signature]

Month Day Year

7-9-18

WHITE - ACCOUNTING / GREEN - TRANSPORTER 1 / YELLOW - TRANSPORTER 2 / PINK - FACILITY / GOLD - CUSTOMER



Original

Monarch Hill

2700 NW 48th Street
Pompano Beach, FL, 33073
Ph: (954) 984-2000

Ticket# 1255990

Customer Name CLIFF CLIFF BERRY

Ticket Date 07/09/2018

Payment Type Credit Account

Manual Ticket#

Hauling Ticket#

Route

State Waste Code 22340C D4DE

Manifest 192721

Destination

PO

Profile 22340CD (Soil Petro Spills)

Generator 114-CBI CLIFF BERRY INC

Carrier REC REC TRUCKING

Vehicle# 1984

Volume

Container

Driver

Check#

Billing # 0000363

Gen EPA ID MASTER/VAR PROFILES

Grid

	Time	Scale	Operator	Inbound	Gross	
In	07/09/2018 14:22:12	Scale 1-301	cwercado		Lare	72340 lb
Out	07/09/2018 14:22:12		cwercado		Net	24200 lb
					Tons	48140 lb
						24.07

Comments REPLACEMENT TICKET FOR TICKET # 1255915

THANK YOU!

Product	LD%	Qty	UOM	Rate	Fee	Amount	Origin
1 Cont Soil Pet-Tons	100	24.07	Tons				MIAMI/DADE
2 FUEL-Fuel Surcharg	100		%				
3 EVF-P-Standard Env	100		%				
4 RCR-P-Regulatory C	100		%				

"I certify that the waste I delivered to this facility on this date does not contain any regulated hazardous, toxic, radioactive waste or substances, or other non-allowable wastes. I also agree to remove any non-allowable wastes I bring to this facility, or pay all costs for proper removal of such wastes, upon request from this facility".

DRIVER: PLEASE SIGN HERE

Total Fees
Total Ticket

Cliff Berry, Inc.
Environmental Services

Emergency Contact Telephone Number
3E@800-451-8346

441633

NON-HAZARDOUS WASTE MANIFEST

1. Generator's US EPA ID No.
FLD981758485

Manifest
Document No.
192980

2. *#7* Page 1 of 1

3. Name and Mailing Address CEMEX CONSTRUCTION MATERIALS
SHARED SERVICES - POP TEAM
PO BOX 24731
WEST PALM BEACH, FL 33416-4731

4. Phone 352-598-8822

DISPOSAL REMEDIATION
FTL INDUSTRIAL MAINT
PENDING

5. Transporter 1 Company Name
RETRANCA EQUIPMENT & TRUCKING CORP

6. USA EPA ID Number

A. Transporter's Phone
954-581-6613

7. Transporter 2 Company Name

8. USA EPA ID Number

B. Transporter's Phone

9. Designated Facility Name and Site Address
WASTE MANAGEMENT
2700 NW 48th Street, POMPANO BCH, FL

10. USA EPA ID Number

C. Facility's Phone
305-325-9160

11. Shipping Name and Description

12. Containers
No. Type

13. Total
Quantity

14. Unit
Wt/Vol

a "Non-Hazardous Solid, (Sand-Soil-Grit and Petroleum Spirit)",

192980

1

DT

20

T

D. Additional Descriptions for Materials Listed Above
NR PETROLEUM CONTAMINATED SOIL

E. Pickup Location
CEMEX CONSTRUCTION MATERIALS
1200 NW 137TH AVENUE
MIAMI, FL 33182

15. Special Handling Instructions and Additional Information

PROFILE # 2234600

③ 67960

16. CERTIFICATION: This is to certify that the above named materials are properly classified, described, packaged, marked and labeled, and are in proper condition for transportation according to the applicable regulation of the Department of Transportation. I certify the materials described above on this manifest are not subject to federal regulations for reporting proper disposal of Hazardous Waste.

Printed/Typed Name

Roger Hogg

Signature

[Signature]

Month Day Year

7/16/18

17. Transporter 1 Acknowledgement of Receipt of Materials

Printed/Typed Name

Signature

Month Day Year

18. Transporter 2 Acknowledgement of Receipt of Materials

Printed/Typed Name

Signature

Month Day Year

19. Discrepancy Indication Space

20. Facility Owner or Operator: Certification of receipt of hazardous materials covered by this manifest except as noted in item 19.

Printed/Typed Name

Philip Canache

Signature

[Signature]

Month Day Year

7 16 18

7-BLC-M5 (Rev 10/96)

WHITE - ACCOUNTING / GREEN - TRANSPORTER 1 / YELLOW - TRANSPORTER 2 / PINK - FACILITY / GOLD - CUSTOMER



Original

Monarch Hill

2700 NW 48th Street
Pompano Beach, FL, 33073
Ph: (954) 984-2000

Ticket# 1256171

Customer Name CLIFF CLIFF BERRY
Ticket Date 07/10/2018
Payment Type Credit Account
Manual Ticket#
Hauling Ticket#
Route
State Waste Code 22346C DADE
Manifest 192980
Destination
PD
Profile 22346C (Soil Petro Spills)
Generator 114-CBI CLIFF BERRY INC

Carrier REC REC TRUCKING
Vehicle# 7
Container
Driver
Check#
Billing # 0000363
Gen EPA ID MASTER/VAR PROFILES
Grid

Volume

	Time	Scale	Operator	Inbound	Gross	
In	07/10/2018 10:11:35	Scale 3-301	pcamacho		Tare	67980 lb
Out	07/10/2018 10:11:35		pcamacho		Net	26620 lb
					Tons	41360 lb
						20.68

Comments

THANK YOU!

Product	LDX	Qty	UOM	Rate	Fee	Amount	Origin
1 Cont Soil Pet-Tons	100	20.68	Tons				MIAMIDADE
2 FUEL-Fuel Surcharg	100		%				MIAMIDADE
3 EVF-P-Standard Env	100		%				MIAMIDADE
4 RCR-P-Regulatory C	100		%				MIAMIDADE

"I certify that the waste I delivered to this facility on this date does not contain any regulated hazardous, toxic, radioactive waste or substances, or other non-allowable wastes. I also agree to remove any non-allowable wastes I bring to this facility, or pay all costs for proper removal of such wastes, upon request from this facility".

DRIVER: PLEASE SIGN HERE

Total Fees
Total Ticket

405WMFL

Driver's Signature

Requisition # 10898880

Cliff Berry, Inc.
Environmental Services

Emergency Contact Telephone Number
3E@800-451-8346

441633

NON-HAZARDOUS WASTE MANIFEST

1. Generator's US EPA ID No.
FLD981758485

Manifest
Document No.
192722

2. Page 1 of 1
#6 2812

3. Name and Mailing Address CEMEX CONSTRUCTION MATERIALS
SHARED SERVICES - POP TEAM
PO BOX 24731
WEST PALM BEACH, FL 33416-4731

DISPOSAL REMEDIATION
FTL INDUSTRIAL MAINT
PENDING

4. Phone 352-598-8822

5. Transporter 1 Company Name
RETRANCA EQUIPMENT & TRUCKING CORP

6. USA EPA ID Number

A. Transporter's Phone
954-581-6613

7. Transporter 2 Company Name

8. USA EPA ID Number

B. Transporter's Phone

9. Designated Facility Name and Site Address
WASTE MANAGEMENT

10. USA EPA ID Number

C. Facility's Phone
305-325-9160

10000 NE 120TH AVE, OKEECHOBEE, FL 34972-7105 J.S.
2700 NW 48TH ST Pompano Beach FL

11. Shipping Name and Description

12. Containers
No. Type

13. Total
Quantity

14. Unit
Wt/Vol

a "Non-Hazardous Solid, (Sand-Soil-Grit and Petroleum Spirit)",

1

DT

20

T

D. Additional Descriptions for Materials Listed Above
NR PETROLEUM CONTAMINATED SOIL

E. Pickup Location
CEMEX CONSTRUCTION MATERIALS
1200 NW 137TH AVENUE
MIAMI, FL 33182

15. Special Handling Instructions and Additional Information

Profile # 2234600

74000 (4)

16. CERTIFICATION: This is to certify that the above named materials are properly classified, described, packaged, marked and labeled, and are in proper condition for transportation according to the applicable regulation of the Department of Transportation. I certify the materials described above on this manifest are not subject to federal regulations for reporting proper disposal of Hazardous Waste.

Printed/Typed Name

Roger Hogg

Signature

[Signature]

Month Day Year

17. Transporter 1 Acknowledgement of Receipt of Materials

Printed/Typed Name

Ivan O. Delgado

Signature

[Signature]

Month Day Year

18. Transporter 2 Acknowledgement of Receipt of Materials

Printed/Typed Name

Signature

Month Day Year

19. Discrepancy Indication Space

20. Facility Owner or Operator: Certification of receipt of hazardous materials covered by this manifest except as noted in Item 19.

Printed/Typed Name

G. TORTI

Signature

[Signature]

Month Day Year

7-9-18

WHITE - ACCOUNTING / GREEN - TRANSPORTER 1 / YELLOW - TRANSPORTER 2 / PINK - FACILITY / GOLD - CUSTOMER



Monarch Hill
2700 NW 48th Street
Pompano Beach, FL, 33073
Ph: (954) 984-2000

Original
Ticket# 1256364

Customer Name CLIFF CLIFF BERRY

Ticket Date 07/09/2018

Payment Type Credit Account

Manual Ticket#

Hauling Ticket#

Route

State Waste Code 22346C DADE

Manifest 192722

Destination

90

Profile 22346CD (Soil Petro Spills)

Generator 114-CBI CLIFF BERRY INC

Carrier REC REC TRUCKING

Vehicle# 2812

Volume

Container

Driver

Check#

Billing # 0008363

Gen EPA ID MASTER/VAR PROFILES

Grid

	Time	Scale	Operator	Inbound	Gross	
In	07/09/2018 14:34:21	Scale 4-307	ctorti		Tare	74000 lb
Out	07/09/2018 14:34:21		ctorti		Net	24860 lb
					Tons	49140 lb
						24.57

Comments REPLACEMENT TICKET FOR TICKET # 1255929

THANK YOU!

Product	LD%	Qty	UDM	Rate	Fee	Amount	Origin
1 Cont Soil Pet-Tons 100		24.57	Tons				MIAMIDADE
2 FUEL-Fuel Surcharg 100			%				MIAMIDADE
3 EVF-P-Standard Env 100			%				MIAMIDADE
4 RCR-P-Regulatory C 100			%				MIAMIDADE

"I certify that the waste I delivered to this facility on this date does not contain any regulated hazardous, toxic, radioactive waste or substances, or other non-allowable wastes. I also agree to remove any non-allowable wastes I bring to this facility, or pay all costs for proper removal of such wastes, upon request from this facility".

DRIVER: PLEASE SIGN HERE

Total Fees

Total Ticket

405WMFL

Driver's Signature

Cliff Berry, Inc.
Environmental Services

Emergency Contact Telephone Number
3E@800-451-8346

441633

**NON-HAZARDOUS
WASTE MANIFEST**

1. Generator's US EPA ID No.

FLD981758485

Manifest Document No.

192147

2.

Page 1 of 1

#1 1305

3. Name and Mailing Address

CEMEX CONSTRUCTION MATERIALS
SHARED SERVICES - POP TEAM
PO BOX 24731
WEST PALM BEACH, FL 33416-4731

DISPOSAL REMEDIATION
FTL INDUSTRIAL MAINT
PENDING

4. Phone 352-598-8822

5. Transporter 1 Company Name

RETRANCA EQUIPMENT & TRUCKING CORP

6. USA EPA ID Number

A. Transporter's Phone

954-581-6613

7. Transporter 2 Company Name

8. USA EPA ID Number

B. Transporter's Phone

9. Designated Facility Name and Site Address
WASTE MANAGEMENT

10. USA EPA ID Number

C. Facility's Phone

305-325-9160

10800 NE 128TH AVE, OKEECHOBEE, FL 34972-7105 J.S.

2700 NW 48TH ST Pompano Beach FLA

11. Shipping Name and Description

12. Containers

No.

Type

13. Total Quantity

14. Unit Wt/Vol

a "Non-Hazardous Solid, (Sand-Soil-Grit and Petroleum Spirit)",

1

DT

20

T

D. Additional Descriptions for Materials Listed Above
NR PETROLEUM CONTAMINATED SOIL

E. Pickup Location
CEMEX CONSTRUCTION MATERIALS
1200 NW 137TH AVENUE
MIAMI, FL 33182

15. Special Handling Instructions and Additional Information

Profile # 2234600

68900 (3)

16. CERTIFICATION: This is to certify that the above named materials are properly classified, described, packaged, marked and labeled, and are in proper condition for transportation according to the applicable regulation of the Department of Transportation. I certify the materials described above on this manifest are not subject to federal regulations for reporting proper disposal of Hazardous Waste.

7/9/18

Printed/Typed Name

Roger Hogg

Signature

[Signature]

Month Day Year

17. Transporter 1 Acknowledgement of Receipt of Materials

Printed/Typed Name

RICARDO IVAN

Signature

[Signature]

Month Day Year

18. Transporter 2 Acknowledgement of Receipt of Materials

Printed/Typed Name

Signature

Month Day Year

19. Discrepancy Indication Space

20. Facility Owner or Operator: Certification of receipt of hazardous materials covered by this manifest except as noted in Item 19.

Printed/Typed Name

CTORTI

Signature

[Signature]

7/9/18

7-BLC-M5 (Rev 10/96)

WHITE - ACCOUNTING / GREEN - TRANSPORTER 1 / YELLOW - TRANSPORTER 2 / PINK - FACILITY / GOLD - CUSTOMER



Monarch Hill
2700 NW 48th Street
Pompano Beach, FL, 33073
Ph: (954) 984-2000

Original
Ticket# 1256369

Customer Name CLIFF CLIFF BERRY
Ticket Date 07/09/2018
Payment Type Credit Account
Manual Ticket#
Hauling Ticket#
Route
State Waste Code 22346C DADE
Manifest 192147
Destination

Carrier REC REC TRUCKING
Vehicle# 1305
Container
Driver
Check#
Billing # 0000363
Gen EPA ID MASTER/VAR PROFILES
Grid

Volume

PQ
Profile 22346CD (Soil Petro Spills)
Generator 114-CBI CLIFF BERRY INC

	Time	Scale	Operator	Inbound	Gross	
In	07/09/2018 10:45:09	Scale 3-307	ctorti		Tare	68900 lb
Out	07/09/2018 11:14:57	Scale 3-307	ctorti		Net	24600 lb
					Tons	44300 lb
						22.15

Comments REPLACEMENT TICKET FOR TICKET # 1259742

THANK YOU!

Product	LO%	Qty	UOM	Rate	Fee	Amount	Origin
1 Cont Soil Pet-Tons 100		22.15	Tons				MIAMIDADE
2 FUEL-Fuel Surcharg 100			%				MIAMIDADE
3 EVF-P-Standard Env 100			%				MIAMIDADE
4 RCR-P-Regulatory C 100			%				MIAMIDADE

"I certify that the waste I delivered to this facility on this date does not contain any regulated hazardous, toxic, radioactive waste or substances, or other non-allowable wastes. I also agree to remove any non-allowable wastes I bring to this facility, or pay all costs for proper removal of such wastes, upon request from this facility".

DRIVER: PLEASE SIGN HERE

Total Fees
Total Ticket

405WMFL

Driver's Signature



Cliff Berry, Incorporated
Environmental Services

P.O. Box 13079 Ft. Lauderdale, FL 33346
1 800 899 7745

441633

IN CASE OF EMERGENCY
CONTACT 3E@ 800-451-8346

DISPATCH TICKET

Manifest Doc #: 192906

PO#:

1. Generator's US EPA ID No.: FLD981758485

2. Generator Site:

CEMEX CONSTRUCTION MATERIALS
1200 NW 137TH AVENUE
MIAMI FL 33182

3. Bill To:

CEMEX CONSTRUCTION MATERIALS
SHARED SERVICES - POP TEAM
WEST PALM BEACH FL, 33416-4731
Contact Name: mariat.rodriguez@cemex.com
Contact Phone #: 352-598-8822

4. Generator Phone: 305-229-2945

Generator Contact: MARIA T RODRIGUES

5. Transporter Name/Phone: 954-763-3390

Cliff Berry (DANIA)

EPA ID#: FLR000083071

6. Designated Facility/Phone: 800 899-7745

MIAMI PLANT
3033 NW NORTH RIVER DRIVE
MIAMI FL, 33142

EPA ID#: FLD058560699

7. Description of Service/Instructions:
PUMP OUT OILY WATER

Department Location: FTL INDUSTRIAL MAINT Driver/Tech: HECTOR Truck: VT63
Scheduled Date of Work: 07/09/2018 Scheduled Time: Method of Payment: NET60

8. Work Site Remarks:

Time Left Yard (Start): 10:20 AM Time Arrived On Site: 11:30 AM Date: 7/9
Time Left Site: 2:30 PM Time Arrived At Yard (Stop): 4:30 PM Date: 7/9

A I M	9. PROPER SHIPPING NAME/DESCRIPTION	HAZ CLASS	I.D. #	PKG. GP	CONTAINERS		TOTAL QTY	UNIT Wt/Vol
					No.	TYPE		
a.	"Non-Hazardous Liquid, Oily Water (< 1000 ppm halogens)" 192906				1	TT	2500	0

10. SPECIAL HANDLING INSTRUCTIONS:

Halogens <1000ppm

11. CERTIFICATION: This is to certify that the above named materials are properly classified, described, packaged, marked and labeled, and are in proper condition for transportation according to the applicable regulation of the Department of Transportation. I certify the materials described above on this manifest are not subject to federal regulations for reporting proper disposal of Hazardous Waste.
TERMS & CONDITIONS: Customer agrees that work has been performed satisfactorily. Payment is due upon completion of services. Where CBI extends credit, a charge of 1-1/2% per month, 18% per annum, will be added to balances unpaid 30 days after date of invoice. Collection costs and/or reasonable attorney's fees will be due in the event any collection process becomes necessary. This is not an invoice, but merely an estimate of charges. Applicable taxes, tariffs and fuel surcharges will be forwarded on invoice.

Printed/Typed Name: Signature: Month: Day: Year:

12. Transporter Acknowledgement of Receipt of Materials

Printed/Typed Name: Signature: Month: Day: Year:

13. Facility Owner or Operator: Certification of receipt of materials covered by this manifest.

Printed/Typed Name: Signature: Month: Day: Year:



Cliff Berry, Incorporated
Environmental Services
P.O. Box 13079 Ft. Lauderdale, FL 33316
1 800 899 7745

Requisition # 10818810

441633

IN CASE OF EMERGENCY
CONTACT 3E@ 800-451-8346

DISPATCH TICKET

Manifest Doc #: 192994

1. Generator's US EPA ID No.: FLD981758485

PO#: PENDING

2. Generator Site:

CEMEX CONSTRUCTION MATERIALS
1200 NW 137TH AVENUE
MIAMI FL33182

3. Bill To:

CEMEX CONSTRUCTION MATERIALS
SHARED SERVICES - POP TEAM
WEST PALM BEACH FL, 33416-4731
Contact Name: mariat.rodriguez@cemex.com
Contact Phone #: 352-598-8822

4. Generator Phone: 305-229-2945

Generator Contact: MARIA T RODRIGUES

5. Transporter Name/Phone: 954-763-3390

Cliff Berry (DANIA)

EPA ID#: FLR000083071

6. Designated Facility/Phone: 800 899-7745

MIAMI PLANT
3033 NW NORTH RIVER DRIVE
MIAMI FL, 33142

EPA ID#: FLD058560699

7. Description of Service/Instructions:

PUMP OUT OILY WATER FROM EXCAVATION PIT

Department Location: FTL INDUSTRIAL MAINT Driver/Tech: TONY

Truck: VT63

Scheduled Date of Work: 07/10/2018

Scheduled Time:

Method of Payment: NET60

8. Work Site Remarks:

Time Left Yard (Start): 7:30

Time Arrived On Site: 8:30

Date:

Time Left Site: 10:15

Time Arrived At Yard (Stop): 1:00

Date:

A I M	9. PROPER SHIPPING NAME/DESCRIPTION	HAZ CLASS	I.D. #	PKG. GP	CONTAINERS		TOTAL QTY	UNIT Wt/Vol
					No.	TYPE		
a.	"Non-Hazardous Liquid, Oily Water (< 1000 ppm halogens)" 192994				1	TT	2500	G

10. SPECIAL HANDLING INSTRUCTIONS:

Halogens <1000ppm

PH 7.5

11. CERTIFICATION: This is to certify that the above named materials are properly classified, described, packaged, marked and labeled, and are in proper condition for transportation according to the applicable regulation of the Department of Transportation. I certify the materials described above on this manifest are not subject to federal regulations for reporting proper disposal of Hazardous Waste.

TERMS & CONDITIONS: Customer agrees that work has been performed satisfactorily. Payment is due upon completion of services. Where CBI extends credit, a charge of 1-1/2% per month, 18% per annum, will be added to balances unpaid 30 days after date of invoice. Collection costs and/or reasonable attorney's fees will be due in the event any collection process becomes necessary. This is not an invoice, but merely an estimate of charges. Applicable taxes, tariffs and fuel surcharges will be forwarded on invoice.

Printed/Typed Name

Maria Rodriguez

Signature

Maria T. Rodriguez

Month

Day

Year

12. Transporter Acknowledgement of Receipt of Materials

Printed/Typed Name

Tony H

Signature

Tony H

Month

Day

Year

13. Facility Owner or Operator: Certification of receipt of materials covered by this manifest.

Printed/Typed Name

AR BNT

Signature

AR BNT

Month

Day

Year



Cliff Berry, Incorporated
Environmental Services
P.O. Box 13079 Ft. Lauderdale, FL 33316
1 800 899 7745

441633

IN CASE OF EMERGENCY
CONTACT 3E@ 800-451-8346

DISPATCH TICKET

Manifest Doc #: 196592

1. Generator's US EPA ID No.: FLD981758485

PO#: PENDING 4506492813

2. Generator Site:

CEMEX CONSTRUCTION MATERIALS
1200 NW 137TH AVENUE
MIAMI FL 33182

3. Bill To:

CEMEX CONSTRUCTION MATERIALS
SHARED SERVICES - POP TEAM
WEST PALM BEACH FL, 33416-4731
Contact Name: mariat.rodriguez@cemex.com
Contact Phone #: 352-598-8822

4. Generator Phone: 305-229-2945

Generator Contact: MARIA T RODRIGUES

5. Transporter Name/Phone: 954-763-3390

Cliff Berry (DANIA)

EPA ID#: FLR000083071

6. Designated Facility/Phone: 800 899-7745

MIAMI PLANT
3033 NW NORTH RIVER DRIVE
MIAMI FL, 33142

EPA ID#: FLD058560699

7. Description of Service/Instructions:

SKIM EXCAVATION PIT - BRING ALL SAFETY PPE

Department Location: FTL INDUSTRIAL MAINT Driver/Tech: JERRY / STEWART Truck: VT79 / SV117

Scheduled Date of Work: 08/06/2018 Scheduled Time: Method of Payment: NET60

8. Work Site Remarks:

Time Left Yard (Start): 12:30pm Time Arrived On Site: 1:00pm Date: 8/6/18
Time Left Site: 3:00pm Time Arrived At Yard (Stop): 5:30pm Date: 8/6/18

A I M	9. PROPER SHIPPING NAME/DESCRIPTION	HAZ CLASS	I.D. #	PKG. GP	CONTAINERS		TOTAL QTY	UNIT Wt/Vol
					No.	TYPE		
a.	"Non-Hazardous Liquid, Oily Water (< 1000 ppm halogens)" 196592					TT	1800	G

10. SPECIAL HANDLING INSTRUCTIONS:

halogens <1000ppm

SS: 0.4%

PH = 7.5%

11. CERTIFICATION: This is to certify that the above named materials are properly classified, described, packaged, marked and labeled, and are in proper condition for transportation according to the applicable regulation of the Department of Transportation. I certify the materials described above on this manifest are not subject to federal regulations for reporting proper disposal of Hazardous Waste.

TERMS & CONDITIONS: Customer agrees that work has been performed satisfactorily. Payment is due upon completion of services. Where CBI extends credit, a charge of 1-1/2% per month, 18% per annum, will be added to balances unpaid 30 days after date of invoice. Collection costs and/or reasonable attorney's fees will be due in the event any collection process becomes necessary. This is not an invoice, but merely an estimate of charges. Applicable taxes, tariffs and fuel surcharges will be forwarded on invoice.

Printed/Typed Name

Signature

Month 8 Day 6 Year 18

12. Transporter Acknowledgement of Receipt of Materials

Printed/Typed Name

Signature

Month 8 Day 6 Year 18

13. Facility Owner or Operator: Certification of receipt of materials covered by this manifest.

Printed/Typed Name

Signature

Month 8 Day 6 Year 18

Cliff Berry, Inc.
Environmental Services

Emergency Contact Telephone Number
3E@800-451-8346

441633

**NON-HAZARDOUS
WASTE MANIFEST**

1. Generator's US EPA ID No.
FLD981758485

Manifest
Document No.
196308

2. Page 1 of 1

3. Name and Mailing Address
CEMEX CONSTRUCTION MATERIALS
SHARED SERVICES - POP TEAM
PO BOX 24731
WEST PALM BEACH, FL 33416-4731

4. Phone 352-598-8822

DISPOSAL NON MARINE
FTL INDUSTRIAL MAINT
PENDING 4/20/43 13

5. Transporter 1 Company Name
Cliff Berry (DANIA)

6. USA EPA ID Number
FLR000083071

A. Transporter's Phone
954-763-3390

7. Transporter 2 Company Name

8. USA EPA ID Number

B. Transporter's Phone

9. Designated Facility Name and Site Address
CLIFF BERRY MIAMI
3033 NW NORTH RIVER DRIVE, MIAMI, FL, 33142

10. USA EPA ID Number
FLD058560699

C. Facility's Phone
800 899-7745

11. Shipping Name and Description

12. Containers
No. Type

13.
Total
Quantity

14.
Unit
Wt/Vol

a "Non-Hazardous Liquid, Oily Water (< 1000 ppm halogens)",

1

TT

2500

G

D. Additional Descriptions for Materials Listed Above

AAA OILY WATER
PH = 8.5

E. Pickup Location
CEMEX CONSTRUCTION MATERIALS
1200 NW 137TH AVENUE
MIAMI, FL 33182

15. Special Handling Instructions and Additional Information
Halogens <1000ppm
PH. 8.5

16. CERTIFICATION: This is to certify that the above named materials are properly classified, described, packaged, marked and labeled, and are in proper condition for transportation according to the applicable regulation of the Department of Transportation. I certify the materials described above on this manifest are not subject to federal regulations for reporting proper disposal of Hazardous Waste.

Printed/Typed Name *[Signature]* Signature *[Signature]* Month *8* Day *6* Year *18*

17. Transporter 1 Acknowledgement of Receipt of Materials

Printed/Typed Name *SEKAY G.* Signature *[Signature]* Month *8* Day *6* Year *18*

18. Transporter 2 Acknowledgement of Receipt of Materials

Printed/Typed Name Signature Month Day Year

19. Discrepancy Indication Space

20. Facility Owner or Operator: Certification of receipt of hazardous materials covered by this manifest except as noted in Item 19.

Printed/Typed Name *[Signature]* Signature *[Signature]* Month *8* Day *6* Year *18*

7-BLC-M5 (Rev 10/96)

WHITE - ACCOUNTING / GREEN - TRANSPORTER 1 / YELLOW - TRANSPORTER 2 / PINK - FACILITY / GOLD - CUSTOMER



Cliff Berry, Incorporated
Environmental Services

P.O. Box 13079 Ft. Lauderdale, FL 33316
1 800 899 7745

441633

IN CASE OF EMERGENCY
CONTACT 3E@ 800-451-8346

DISPATCH TICKET

Manifest Doc #: 196845

PO#: 4576492813

1. Generator's US EPA ID No.: FLD981758485

2. Generator Site:

CEMEX CONSTRUCTION MATERIALS
1200 NW 137TH AVENUE
MIAMI-FL 33182

3. Bill To:

CEMEX CONSTRUCTION MATERIALS
SHARED SERVICES - POP TEAM
WEST PALM BEACH FL, 33416-4731
Contact Name: mariat.rodriguez@cemex.com
Contact Phone #: 352-598-8822

4. Generator Phone: 305-229-2945

Generator Contact: MARIA T RODRIGUES

5. Transporter Name/Phone: 954-763-3390

Cliff Berry (DANIA)

EPA ID#: FLR000083071

6. Designated Facility/Phone: 800 899-7745

MIAMI PLANT
3033 NW NORTH RIVER DRIVE
MIAMI FL, 33142

EPA ID#: FLD058560699

7. Description of Service/Instructions:

SKIM EXCAVATION PIT - BRING ALL SAFETY PPE

Department Location: FTL INDUSTRIAL MAINT Driver/Tech: JERRY /CEDIEU Truck: VT79

Scheduled Date of Work: 08/08/2018 Scheduled Time: Method of Payment: NET60

8. Work Site Remarks:

Time Left Yard (Start): 6:30 Time Arrived On Site: 8:00 AM Date: 8/8/18
Time Left Site: 5:00 PM Time Arrived At Yard (Stop): 5:30 PM Date: 8/8/18

A I M	9. PROPER SHIPPING NAME/DESCRIPTION	HAZ- CLASS	I.D. #	PKG. GP	CONTAINERS		TOTAL QTY	UNIT Wt/Vol
					No.	TYPE		
a.	"Non-Hazardous Liquid, Oily Water (< 1000 ppm halogens)" 196845				1	TT	2500	G

10. SPECIAL HANDLING INSTRUCTIONS:

halogens <1000ppm

PH = 7.5
BSS = 0.2%

11. CERTIFICATION: This is to certify that the above named materials are properly classified, described, packaged, marked and labeled, and are in proper condition for transportation according to the applicable regulation of the Department of Transportation. I certify the materials described above on this manifest are not subject to federal regulations for reporting proper disposal of Hazardous Waste.

TERMS & CONDITIONS: Customer agrees that work has been performed satisfactorily. Payment is due upon completion of services. Where CBI extends credit, a charge of 1-1/2% per month, 18% per annum, will be added to balances unpaid 30 days after date of invoice. Collection costs and/or reasonable attorney's fees will be due in the event any collection process becomes necessary. This is not an invoice, but merely an estimate of charges. Applicable taxes, tariffs and fuel surcharges will be forwarded on invoice.

Printed/Typed Name: MARIA T. RODRIGUES Signature: Maria T. Rodriguez Month: 8 Day: 8 Year: 18

12. Transporter Acknowledgement of Receipt of Materials

Printed/Typed Name: JERRY Signature: Jerry Month: 8 Day: 8 Year: 18

13. Facility Owner or Operator: Certification of receipt of materials covered by this manifest.

Printed/Typed Name: JARED T. Signature: Jared T. Month: 8 Day: 8 Year: 18



Cliff Berry, Incorporated
Environmental Services
P.O. Box 13079 Ft. Lauderdale, FL 33316
1 800 899 7745

441633

IN CASE OF EMERGENCY
CONTACT 3E@ 800-451-8346

DISPATCH TICKET

Manifest Doc #: 196919

1. Generator's US EPA ID No.: FLD981758485

PO#:

2. Generator Site:

CEMEX CONSTRUCTION MATERIALS
1200 NW 137TH AVENUE
MIAMI FL33182

3. Bill To:

CEMEX CONSTRUCTION MATERIALS
SHARED SERVICES - POP TEAM
WEST PALM BEACH FL, 33416-4731
Contact Name: mariaf.rodriguez@cemex.com
Contact Phone #: 352-598-8822

4. Generator Phone: 305-229-2945

Generator Contact: MARIA T RODRIGUES

5. Transporter Name/Phone: 954-763-3390

Cliff Berry (DANIA)

EPA ID#: FLR000083071

6. Designated Facility/Phone: 800 899-7745

MIAMI PLANT
3033 NW NORTH RIVER DRIVE
MIAMI FL, 33142

EPA ID#: FLD058560699

7. Description of Service/Instructions:

SKIM EXCAVATION PIT - BRING ALL SAFETY PPE

Department Location: FTL INDUSTRIAL MAINT Driver/Tech: JERRY /CEDIEU Truck: VT79
Scheduled Date of Work: 08/09/2018 Scheduled Time: Method of Payment: NET60

8. Work Site Remarks:

Time Left Yard (Start): 6:45am Time Arrived On Site: 8:00 AM Date: 8/9/18
Time Left Site: 2:30pm Time Arrived At Yard (Stop): 5:30pm Date: 8/9/18

A I M	9. PROPER SHIPPING NAME/DESCRIPTION	HAZ CLASS	I.D. #	PKG. GP	CONTAINERS		TOTAL QTY	UNIT Wt/Vol
					No.	TYPE		
a.	"Non-Hazardous Liquid, Oily Water (< 1000 ppm halogens)" 196919				1	TT	2800	G

10. SPECIAL HANDLING INSTRUCTIONS:

Halogens <1000ppm

11. CERTIFICATION: This is to certify that the above named materials are properly classified, described, packaged, marked and labeled, and are in proper condition for transportation according to the applicable regulation of the Department of Transportation. I certify the materials described above on this manifest are not subject to federal regulations for reporting proper disposal of Hazardous Waste.

TERMS & CONDITIONS: Customer agrees that work has been performed satisfactorily. Payment is due upon completion of services. Where CBI extends credit, a charge of 1-1/2% per month, 18% per annum, will be added to balances unpaid 30 days after date of invoice. Collection costs and/or reasonable attorney's fees will be due in the event any collection process becomes necessary. This is not an invoice, but merely an estimate of charges. Applicable taxes, tariffs and fuel surcharges will be forwarded on invoice.

Printed/Typed Name: MARIA RODRIGUES Signature: [Signature] Month: 8 Day: 9 Year: 18

12. Transporter Acknowledgement of Receipt of Materials
Printed/Typed Name: JERRY Signature: [Signature] Month: 8 Day: 9 Year: 18

13. Facility Owner or Operator: Certification of receipt of materials covered by this manifest.
Printed/Typed Name: JERRY Signature: [Signature] Month: 8 Day: 9 Year: 18



Cliff Berry, Incorporated
Environmental Services
P.O. Box 13079 Ft. Lauderdale, FL 33316
1 800 899 7745

441633

IN CASE OF EMERGENCY
CONTACT 3E@ 800-451-8346

DISPATCH TICKET

Manifest Doc #: 196992

1. Generator's US EPA ID No.: FLD981758485

PO#: 4506472813

2. Generator Site:

CEMEX CONSTRUCTION MATERIALS
1200 NW 137TH AVENUE
MIAMI FL33182

3. Bill To:

CEMEX CONSTRUCTION MATERIALS
SHARED SERVICES - POP TEAM
WEST PALM BEACH FL, 33416-4731
Contact Name: mariat.rodriguez@cemex.com
Contact Phone #: 352-598-8822

4. Generator Phone: 305-229-2945

Generator Contact: MARIA T RODRIGUES

5. Transporter Name/Phone: 954-763-3390

Cliff Berry (DANIA)

EPA ID#: FLR000083071

6. Designated Facility/Phone: 800 899-7745

MIAMI PLANT
3033 NW NORTH RIVER DRIVE
MIAMI FL, 33142

EPA ID#: FLD058560699

7. Description of Service/Instructions:

SKIM EXCAVATION PIT - BRING ALL SAFETY PPE

Department Location: FTL INDUSTRIAL MAINT Driver/Tech: JERRY /CEDIEU Truck: VT79

Scheduled Date of Work: 08/10/2018 Scheduled Time: Method of Payment: NET60

8. Work Site Remarks:

Time Left Yard (Start): 8:30am Time Arrived On Site: 10:00am Date: 8/10/18
Time Left Site: 1:45 Time Arrived At Yard (Stop): 3:00pm Date: 8/10/18

A I M	9. PROPER SHIPPING NAME/DESCRIPTION	HAZ CLASS	I.D. #	PKG. GP	CONTAINERS		TOTAL QTY	UNIT Wt/Vol
					No.	TYPE		
a.	"Non-Hazardous Liquid, Oily Water (< 1000 ppm halogens)" 196992				1	TT	200	G

10. SPECIAL HANDLING INSTRUCTIONS:
Halogens <1000ppm

PH 7.8

11. CERTIFICATION: This is to certify that the above named materials are properly classified, described, packaged, marked and labeled, and are in proper condition for transportation according to the applicable regulation of the Department of Transportation. I certify the materials described above on this manifest are not subject to federal regulations for reporting proper disposal of Hazardous Waste.

TERMS & CONDITIONS: Customer agrees that work has been performed satisfactorily. Payment is due upon completion of services. Where CBI extends credit, a charge of 1-1/2% per month, 18% per annum, will be added to balances unpaid 30 days after date of invoice. Collection costs and/or reasonable attorney's fees will be due in the event any collection process becomes necessary. This is not an invoice, but merely an estimate of charges. Applicable taxes, tariffs and fuel surcharges will be forwarded on invoice.

Printed/Typed Name: MARIA T RODRIGUES Signature: Maria T Rodriguez Month: 8 Day: 10 Year: 18

12. Transporter Acknowledgement of Receipt of Materials

Printed/Typed Name: JERRY Signature: Jerry Month: 8 Day: 10 Year: 18

13. Facility Owner or Operator: Certification of receipt of materials covered by this manifest.

Printed/Typed Name: JARROLD Signature: Jarrold Month: 8 Day: 10 Year: 18



Cliff Berry, Incorporated
Environmental Services

P.O. Box 13079 Ft. Lauderdale, FL 33316
1 800 899 7745

441633

IN CASE OF EMERGENCY
CONTACT 3E@ 800-451-8346

DISPATCH TICKET

Manifest Doc #: 197265

PO#: 4506492513

1. Generator's US EPA ID No.: FLD981758485

2. Generator Site:

CEMEX CONSTRUCTION MATERIALS
1200 NW 137TH AVENUE
MIAMI FL33182

3. Bill To:

CEMEX CONSTRUCTION MATERIALS
SHARED SERVICES - POP TEAM
WEST PALM BEACH FL, 33416-4731
Contact Name: mariat.rodriguez@cemex.com
Contact Phone #: 352-598-8822

4. Generator Phone: 305-229-2945

Generator Contact: MARIA T RODRIGUES

5. Transporter Name/Phone: 954-763-3390

Cliff Berry (DANIA)

EPA ID#: FLR000083071

6. Designated Facility/Phone: 800 899-7745

MIAMI PLANT
3033 NW NORTH RIVER DRIVE
MIAMI FL, 33142

EPA ID#: FLD058560699

7. Description of Service/Instructions:

SKIM EXCAVATION PIT - BRING ALL SAFETY PPE

P.O. #

Department Location: FTL INDUSTRIAL MAINT Driver/Tech: JERRY /CEDIEU Truck: VT79
Scheduled Date of Work: 08/13/2018 Scheduled Time: Method of Payment: NET60

8. Work Site Remarks:

Time Left Yard (Start): 9:00am Time Arrived On Site: 10:30am Date: 8/13/18
Time Left Site: 1:30pm Time Arrived At Yard (Stop): 3:30pm Date: 8/13/18

A I M	9. PROPER SHIPPING NAME/DESCRIPTION	HAZ CLASS	I.D. #	PKG. GP	CONTAINERS		TOTAL QTY	UNIT Wt/Vol
					No.	TYPE		
a.	"Non-Hazardous Liquid, Oily Water (< 1000 ppm halogens)" 197265					TT	2400	G

10. SPECIAL HANDLING INSTRUCTIONS:

halogens <1000ppm

pH 7.8

11. CERTIFICATION: This is to certify that the above named materials are properly classified, described, packaged, marked and labeled, and are in proper condition for transportation according to the applicable regulation of the Department of Transportation. I certify the materials described above on this manifest are not subject to federal regulations for reporting proper disposal of Hazardous Waste.
TERMS & CONDITIONS: Customer agrees that work has been performed satisfactorily. Payment is due upon completion of services. Where CBI extends credit, a charge of 1-1/2% per month, 18% per annum, will be added to balances unpaid 30 days after date of invoice. Collection costs and/or reasonable attorney's fees will be due in the event any collection process becomes necessary. This is not an invoice, but merely an estimate of charges. Applicable taxes, tariffs and fuel surcharges will be forwarded on invoice.

Printed/Typed Name	Signature	Month	Day	Year
MARIA RODRIGUES	[Signature]	8	13	2018
12. Transporter Acknowledgement of Receipt of Materials				
Printed/Typed Name	Signature	Month	Day	Year
JERRY	[Signature]	8	13	18
13. Facility Owner or Operator: Certification of receipt of materials covered by this manifest.				
Printed/Typed Name	Signature	Month	Day	Year
JARRED T.	[Signature]	8	13	18



Cliff Berry, Incorporated
Environmental Services
P.O. Box 13079 Ft. Lauderdale, FL 33316
1 800 899 7745

441633

IN CASE OF EMERGENCY
CONTACT 3E@ 800-451-8346

DISPATCH TICKET

Manifest Doc #: 197373

PO#:

1. Generator's US EPA ID No.: FLD981758485

2. Generator Site:

CEMEX CONSTRUCTION MATERIALS
1200 NW 137TH AVENUE
MIAMI FL33182

3. Bill To:

CEMEX CONSTRUCTION MATERIALS
SHARED SERVICES - POP TEAM
WEST PALM BEACH FL, 33416-4731
Contact Name: ,maria.t.rodriguez@cemex.com
Contact Phone #: 352-598-8822

4. Generator Phone: 305-229-2945

Generator Contact: MARIA T RODRIGUES

5. Transporter Name/Phone: 954-763-3390

Cliff Berry (DANIA)

EPA ID#: FLR000083071

6. Designated Facility/Phone: 800 899-7745

MIAMI PLANT
3033 NW NORTH RIVER DRIVE
MIAMI FL, 33142

EPA ID#: FLD058560699

7. Description of Service/Instructions:

SKIM EXCAVATION PIT - BRING ALL SAFETY PPE

Department Location: FTL INDUSTRIAL MAINT Driver/Tech: JERRY /CEDIEU Truck: VT79

Scheduled Date of Work: 08/14/2018 Scheduled Time: Method of Payment: NET60

8. Work Site Remarks:

Time Left Yard (Start): 7:30am Time Arrived On Site: 9:00am Date: 8/15/18

Time Left Site: 2:30pm Time Arrived At Yard (Stop): 5:00pm Date: 8/15/18

A I M	9. PROPER SHIPPING NAME/DESCRIPTION	HAZ CLASS	I.D. #	PKG. GP	CONTAINERS No.	TYPE	TOTAL QTY	UNIT Wt/Vol
a.	"Non-Hazardous Liquid, Oily Water (< 1000 ppm halogens)" 197373					TT	2500	G

10. SPECIAL HANDLING INSTRUCTIONS:

Halogens <1000ppm

TSS: 0.4% PH 7.4

11. CERTIFICATION: This is to certify that the above named materials are properly classified, described, packaged, marked and labeled, and are in proper condition for transportation according to the applicable regulation of the Department of Transportation. I certify the materials described above on this manifest are not subject to federal regulations for reporting proper disposal of Hazardous Waste.

TERMS & CONDITIONS: Customer agrees that work has been performed satisfactorily. Payment is due upon completion of services. Where CBI extends credit, a charge of 1-1/2% per month, 18% per annum, will be added to balances unpaid 30 days after date of invoice. Collection costs and/or reasonable attorney's fees will be due in the event any collection process becomes necessary. This is not an invoice, but merely an estimate of charges. Applicable taxes, tariffs and fuel surcharges will be forwarded on invoice.

Printed/Typed Name

Signature

Month

Day

Year

12. Transporter Acknowledgement of Receipt of Materials

Printed/Typed Name

Signature

Month

Day

Year

13. Facility Owner or Operator: Certification of receipt of materials covered by this manifest.

Printed/Typed Name

Signature

Month

Day

Year



Cliff Berry, Incorporated
Environmental Services
P.O. Box 13079 Ft. Lauderdale, FL 33316
1 800 899 7745

441633

IN CASE OF EMERGENCY
CONTACT 3E@ 800-451-8346

DISPATCH TICKET

Manifest Doc #: 197597

1. Generator's US EPA ID No.: FLD981758485

PO#: 4506417243

2. Generator Site:
CEMEX CONSTRUCTION MATERIALS
1200 NW 137TH AVENUE
MIAMI FL33182

3. Bill To:
CEMEX CONSTRUCTION MATERIALS
SHARED SERVICES - POP TEAM
WEST PALM BEACH FL, 33416-4731
Contact Name: mariat.rodriguez@cemex.com
Contact Phone #: 352-598-8822

4. Generator Phone: 305-229-2945

Generator Contact: MARIA T RODRIGUES

5. Transporter Name/Phone: 954-763-3390
Cliff Berry (DANIA)
EPA ID#: FLR000083071

6. Designated Facility/Phone: 800 899-7745
MIAMI PLANT
3033 NW NORTH RIVER DRIVE
MIAMI FL, 33142
EPA ID#: FLD058560699

7. Description of Service/Instructions:
SKIM EXCAVATION PIT - BRING ALL SAFETY PPE

Department Location: FTL INDUSTRIAL MAINT Driver/Tech: JERRY /CEDIEU Truck: VT79
Scheduled Date of Work: 08/17/2018 Scheduled Time: Method of Payment: NET60

8. Work Site Remarks:

Time Left Yard (Start): 9:30am Time Arrived On Site: 11:00am Date: 8/17/18
Time Left Site: 3:00pm Time Arrived At Yard (Stop): 5:30pm Date: 8/17/18

A I M	9. PROPER SHIPPING NAME/DESCRIPTION	HAZ CLASS	I.D. #	PKG. GP	CONTAINERS		TOTAL QTY	UNIT Wt/Vol
					No.	TYPE		
a.	"Non-Hazardous Liquid, Oily Water (< 1000 ppm halogens)" 197597				1	TT	1600	5

10. SPECIAL HANDLING INSTRUCTIONS:

Halogens <1000ppm

11. CERTIFICATION: This is to certify that the above named materials are properly classified, described, packaged, marked and labeled, and are in proper condition for transportation according to the applicable regulation of the Department of Transportation. I certify the materials described above on this manifest are not subject to federal regulations for reporting proper disposal of Hazardous Waste.
TERMS & CONDITIONS: Customer agrees that work has been performed satisfactorily. Payment is due upon completion of services. Where CBI extends credit, a charge of 1-1/2% per month, 18% per annum, will be added to balances unpaid 30 days after date of invoice. Collection costs and/or reasonable attorney's fees will be due in the event any collection process becomes necessary. This is not an invoice, but merely an estimate of charges. Applicable taxes, tariffs and fuel surcharges will be forwarded on invoice.

Printed/Typed Name: Signature: Month: 8 Day: 17 Year: 18

12. Transporter Acknowledgement of Receipt of Materials

Printed/Typed Name: JERRY Signature: Month: 8 Day: 17 Year: 18

13. Facility Owner or Operator: Certification of receipt of materials covered by this manifest.

Printed/Typed Name: JARRET Signature: Month: 8 Day: 17 Year: 18



Cliff Berry, Incorporated
Environmental Services
P.O. Box 13079 Ft. Lauderdale, FL 33316
1 800 899 7745

441633

IN CASE OF EMERGENCY
CONTACT 3E@ 800-451-8346

DISPATCH TICKET

Manifest Doc #: 198022

PO#: pending

1. Generator's US EPA ID No.: FLD981758485

2. Generator Site:

CEMEX CONSTRUCTION MATERIALS
1200 NW 137TH AVENUE
MIAMI FL33182

3. Bill To:

CEMEX CONSTRUCTION MATERIALS
SHARED SERVICES - POP TEAM
WEST PALM BEACH FL, 33416-4731
Contact Name: mariat.rodriquez@cemex.com
Contact Phone #: 352-598-8822

4. Generator Phone: 305-229-2945

Generator Contact: MARIA T RODRIGUES

5. Transporter Name/Phone: 954-763-3390

Cliff Berry (DANIA)

6. Designated Facility/Phone: 800 899-7745

MIAMI PLANT
3033 NW NORTH RIVER DRIVE
MIAMI FL, 33142

EPA ID#: FLR000083071

EPA ID#: FLD058560699

7. Description of Service/Instructions:

SKIM EXCAVATION PIT - BRING ALL SAFETY PPE

P.O. #

Department Location: FTL INDUSTRIAL MAINT Driver/Tech: JERRY /CEDIEU Truck: VT79

Scheduled Date of Work: 08/20/2018 Scheduled Time: Method of Payment: NET60

8. Work Site Remarks:

Time Left Yard (Start): 8:30am Time Arrived On Site: 10:00am Date: 8/20/18

Time Left Site: 8:00pm Time Arrived At Yard (Stop): 6:00pm Date: 8/20/18

A I M	9. PROPER SHIPPING NAME/DESCRIPTION	HAZ CLASS	I.D. #	PKG. GP	CONTAINERS		TOTAL QTY	UNIT Wt/Vol
					No.	TYPE		
a.	"Non-Hazardous Liquid, Oily Water (< 1000 ppm halogens)" 198022				1	TT	2500	G

10. SPECIAL HANDLING INSTRUCTIONS:

Halogens <1000ppm

AH 7.8

11. CERTIFICATION: This is to certify that the above named materials are properly classified, described, packaged, marked and labeled, and are in proper condition for transportation according to the applicable regulation of the Department of Transportation. I certify the materials described above on this manifest are not subject to federal regulations for reporting proper disposal of Hazardous Waste.
TERMS & CONDITIONS: Customer agrees that work has been performed satisfactorily. Payment is due upon completion of services. Where CBI extends credit, a charge of 1-1/2% per month, 18% per annum, will be added to balances unpaid 30 days after date of invoice. Collection costs and/or reasonable attorney's fees will be due in the event any collection process becomes necessary. This is not an invoice, but merely an estimate of charges. Applicable taxes, tariffs and fuel surcharges will be forwarded on invoice.

Printed/Typed Name: Signature: Month: Day: Year:

12. Transporter Acknowledgement of Receipt of Materials

Printed/Typed Name: Signature: Month: Day: Year:

13. Facility Owner or Operator: Certification of receipt of materials covered by this manifest.

Printed/Typed Name: Signature: Month: Day: Year:



Cliff Derry, Incorporated
Environmental Services
P.O. Box 13079 Ft. Lauderdale, FL 33316
1 800 899 7745

441633

IN CASE OF EMERGENCY
CONTACT 3E@ 800-451-8346

DISPATCH TICKET

Manifest Doc #: 198338

PO#: pending 4500492813

1. Generator's US EPA ID No.: FLD981758485

2. Generator Site:
CEMEX CONSTRUCTION MATERIALS
1200 NW 137TH AVENUE
MIAMI FL33182

3. Bill To:
CEMEX CONSTRUCTION MATERIALS
SHARED SERVICES - POP TEAM
WEST PALM BEACH FL, 33416-4731
Contact Name: mariat.rodriguez@cemex.com
Contact Phone #: 352-598-8822

4. Generator Phone: 305-229-2945

Generator Contact: MARIA T RODRIGUES

5. Transporter Name/Phone: 954-763-3390
Cliff Berry (DANIA)

6. Designated Facility/Phone: 800 899-7745
MIAMI PLANT
3033 NW NORTH RIVER DRIVE
MIAMI FL, 33142
EPA ID#: FLD058560699

EPA ID#: FLR000083071

7. Description of Service/Instructions:
SKIM EXCAVATION PIT - BRING ALL SAFETY PPE

Department Location: FTL INDUSTRIAL MAINT Driver/Tech: JERRY /CEDIEU Truck: VT79
Scheduled Date of Work: 08/22/2018 Scheduled Time: Method of Payment: NET60

8. Work Site Remarks:

Time Left Yard (Start): 8:45 PM Time Arrived On Site: 10:00 AM Date: 8/22/18
Time Left Site: 3:00 PM Time Arrived At Yard (Stop): 6:00 PM Date: 8/22/18

A I M	9. PROPER SHIPPING NAME/DESCRIPTION	HAZ CLASS	I.D. #	PKG. GP	CONTAINERS No.	TYPE	TOTAL QTY	UNIT Wt/Vol
a.	"Non-Hazardous Liquid, Oily Water (< 1000 ppm halogens)" 198338					TT	6000	G

10. SPECIAL HANDLING INSTRUCTIONS:
Halogens <1000ppm

11. CERTIFICATION: This is to certify that the above named materials are properly classified, described, packaged, marked and labeled, and are in proper condition for transportation according to the applicable regulation of the Department of Transportation. I certify the materials described above on this manifest are not subject to federal regulations for reporting proper disposal of Hazardous Waste.
TERMS & CONDITIONS: Customer agrees that work has been performed satisfactorily. Payment is due upon completion of services. Where CBI extends credit, a charge of 1-1/2% per month, 18% per annum, will be added to balances unpaid 30 days after date of invoice. Collection costs and/or reasonable attorney's fees will be due in the event any collection process becomes necessary. This is not an invoice, but merely an estimate of charges. Applicable taxes, tariffs and fuel surcharges will be forwarded on invoice.

Printed/Typed Name: Signature: Month: Day: Year: 8/22/18

12. Transporter Acknowledgement of Receipt of Materials

Printed/Typed Name: Signature: Month: Day: Year: 8/22/18

13. Facility Owner or Operator: Certification of receipt of materials covered by this manifest

Printed/Typed Name: Signature: Month: Day: Year: 8/22/18



Cliff Berry, Incorporated
Environmental Services
P.O. Box 13079 Ft. Lauderdale, FL 33316
1 800 899 7745

441633

IN CASE OF EMERGENCY
CONTACT 3E@ 800-451-8346

DISPATCH TICKET

Manifest Doc #: 198743

1. Generator's US EPA ID No.: FLD981758485

PO#: pending

2. Generator Site:

CEMEX CONSTRUCTION MATERIALS
1200 NW 137TH AVENUE
MIAMI FL 33182

3. Bill To:

CEMEX CONSTRUCTION MATERIALS
SHARED SERVICES - POP TEAM
WEST PALM BEACH FL, 33416-4731
Contact Name: mariat.rodriguez@cemex.com
Contact Phone #: 352-598-8822

4. Generator Phone: 305-229-2945

Generator Contact: MARIA T RODRIGUES

5. Transporter Name/Phone: 954-763-3390

Cliff Berry (DANIA)

EPA ID#: FLR000083071

6. Designated Facility/Phone: 800 899-7745

MIAMI PLANT
3033 NW NORTH RIVER DRIVE
MIAMI FL, 33142

EPA ID#: FLD058560699

7. Description of Service/Instructions:

SKIM EXCAVATION PIT - BRING ALL SAFETY PPE

Department Location: FTL INDUSTRIAL MAINT Driver/Tech: JERRY /CEDIEU Truck: VT79

Scheduled Date of Work: 08/24/2018 Scheduled Time: Method of Payment: NET60

8. Work Site Remarks:

Time Left Yard (Start): 10:30 Time Arrived On Site: 12:00 pm Date: 8/24/18
Time Left Site: 3:00 Time Arrived At Yard (Stop): 5:30 pm Date: 8/24/18

A I M	9. PROPER SHIPPING NAME/DESCRIPTION	HAZ CLASS	I.D. #	PKG. GP	CONTAINERS		TOTAL QTY	UNIT Wt/Vol
					No.	TYPE		
a.	"Non-Hazardous Liquid, Oily Water (< 1000 ppm halogens)" 198743					TT	2800	

10. SPECIAL HANDLING INSTRUCTIONS:

Halogens <1000ppm

pH 7.6

11. CERTIFICATION: This is to certify that the above named materials are properly classified, described, packaged, marked and labeled, and are in proper condition for transportation according to the applicable regulation of the Department of Transportation. I certify the materials described above on this manifest are not subject to federal regulations for reporting proper disposal of Hazardous Waste.

TERMS & CONDITIONS: Customer agrees that work has been performed satisfactorily. Payment is due upon completion of services. Where CBI extends credit, a charge of 1-1/2% per month, 18% per annum, will be added to balances unpaid 30 days after date of invoice. Collection costs and/or reasonable attorney's fees will be due in the event any collection process becomes necessary. This is not an invoice, but merely an estimate of charges. Applicable taxes, tariffs and fuel surcharges will be forwarded on invoice.

Printed/Typed Name: JERRY Signature: Month: 8 Day: 24 Year: 18

12. Transporter Acknowledgement of Receipt of Materials

Printed/Typed Name: JERRY Signature: Month: 8 Day: 24 Year: 18

13. Facility Owner or Operator: Certification of receipt of materials covered by this manifest.

Printed/Typed Name: JAREDTC Signature: Month: 8 Day: 24 Year: 18



Cliff Berry, Incorporated
Environmental Services
P.O. Box 13079 Ft. Lauderdale, FL 33316
1 800 899 7745

441633

IN CASE OF EMERGENCY
CONTACT 3E@ 800-451-8346

DISPATCH TICKET

Manifest Doc #: 198886

1. Generator's US EPA ID No.: FLD981758485

PO#: pending

2. Generator Site:

CEMEX CONSTRUCTION MATERIALS
1200 NW 137TH AVENUE
MIAMI FL33182

3. Bill To:

CEMEX CONSTRUCTION MATERIALS
SHARED SERVICES - POP TEAM
WEST PALM BEACH FL, 33416-4731
Contact Name: mariat.rodriguez@cemex.com
Contact Phone #: 352-598-8822

4. Generator Phone: 305-229-2945

Generator Contact: MARIA T RODRIGUES

5. Transporter Name/Phone: 954-763-3390

Cliff Berry (DANIA)

EPA ID#: FLR000083071

6. Designated Facility/Phone: 800 899-7745

MIAMI PLANT
3033 NW NORTH RIVER DRIVE
MIAMI FL, 33142

EPA ID#: FLD058560699

7. Description of Service/Instructions:

SKIM EXCAVATION PIT - BRING ALL SAFETY PPE

PO#4506492813

Department Location: FTL INDUSTRIAL MAINT Driver/Tech: JERRY /CEDIEU Truck: VT79

Scheduled Date of Work: 08/27/2018 Scheduled Time: Method of Payment: NET60

8. Work Site Remarks:

Time Left Yard (Start): 9:30am Time Arrived On Site: 10:00 Date: 8/27/18
Time Left Site: 3:00 Time Arrived At Yard (Stop): 5:30pm Date: 8/27/18

A I M	9. PROPER SHIPPING NAME/DESCRIPTION	HAZ CLASS	I.D. #	PKG. GP	CONTAINERS No.	TYPE	TOTAL QTY	UNIT Wt/Vol
a.	"Non-Hazardous Liquid, Oily Water (< 1000 ppm halogens)" 198886				1	TT	2100	G

10. SPECIAL HANDLING INSTRUCTIONS:

Halogens <1000ppm

pH 7.8

11. CERTIFICATION: This is to certify that the above named materials are properly classified, described, packaged, marked and labeled, and are in proper condition for transportation according to the applicable regulation of the Department of Transportation. I certify the materials described above on this manifest are not subject to federal regulations for reporting proper disposal of Hazardous Waste.

TERMS & CONDITIONS: Customer agrees that work has been performed satisfactorily. Payment is due upon completion of services. Where CBI extends credit, a charge of 1-1/2% per month, 18% per annum, will be added to balances unpaid 30 days after date of invoice. Collection costs and/or reasonable attorney's fees will be due in the event any collection process becomes necessary. This is not an invoice, but merely an estimate of charges. Applicable taxes, tariffs and fuel surcharges will be forwarded on invoice.

Printed/Typed Name	Signature	Month	Day	Year
JERRY	[Signature]	8	27	18
12. Transporter Acknowledgement of Receipt of Materials				
Printed/Typed Name	Signature	Month	Day	Year
JERRY	[Signature]	8	27	18
13. Facility Owner or Operator: Certification of receipt of materials covered by this manifest.				
Printed/Typed Name	Signature	Month	Day	Year
JARBDT	[Signature]	8	27	18

PHOTOGRAPHS





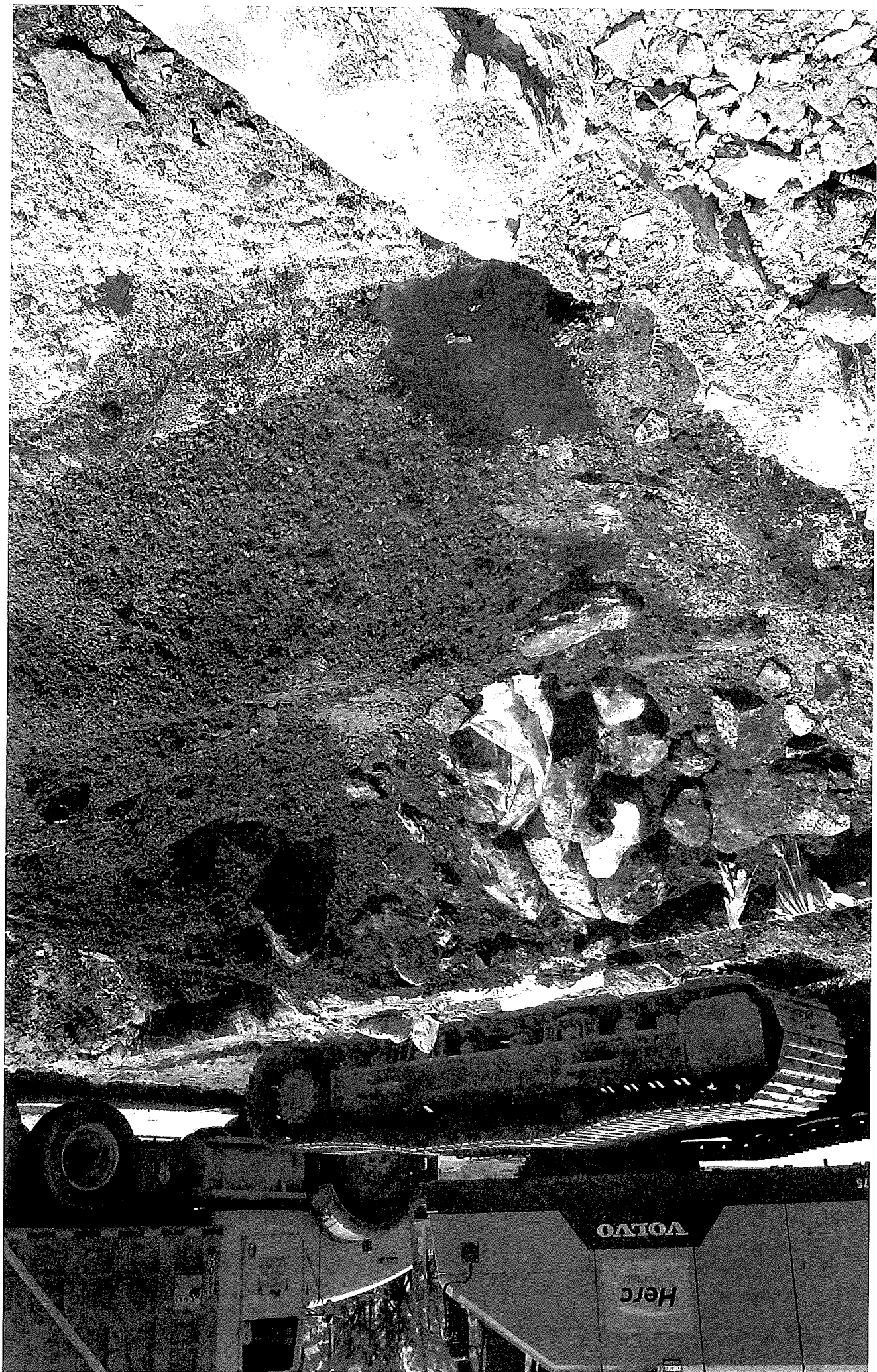









DISCHARGE REPORTING FORM



Department of Environmental Protection

2600 Blair Stone Road ♦ Tallahassee, Florida 32399-2400

DISCHARGE REPORT FORM

DEP Form: 62-762.901(1)

Form Title: Discharge Report Form

Effective Date: January 2017

Incorporated in Rule 62-762.411, F.A.C.

Complete all applicable blanks, and submit copies of any analytical or field test results confirming contamination to soils, surface water, or groundwater to the County via email or mail.

Facility ID Number (If Registered): 8521974 Date of Form Completion: 8/20/2018 Date of Discovery: 6/5/2018
Facility Name: CEMEX Miami Cement Plant County: Miami-Dade
Facility (Property) Owner: CEMEX Construction Materials of Florida LLC Telephone Number: (305) 229-2949
Owner Mailing Address: 1200 NW 137th Ave, Miami FL 33182
Location of Discharge (Facility Street Address): 1200 NW 137th Ave, Miami FL 33182 Lat/Long: 25.783/-80.417
Date of receipt of any test or analytical results confirming a discharge: N/A Estimated number of gallons discharged: unknown

Discharge affected: (Check all that apply)

☒ Soil ☐ Groundwater ☐ Soil water (water body name) _____
☐ Drinking water well(s) ☐ Shoreline ☐ Other (specify) _____

Evidence of discharge: (Check all that apply)

☐ Visual observation of sheen ☐ Results or receipt of results of analytical tests ☒ Stained soils
☐ Visual observation of free product ☐ Spill or vehicle overfill > 25 gallons to a pervious surface ☒ Other (explain in comments)

Method of discovery and confirmation of discharge: (Check all that apply, see rule language explanation on instructions for this form)

☒ Visual observation ☒ Closure/Closure sampling assessment ☐ Surface water analytical results
☐ Groundwater analytical results ☐ Soil analytical results ☐ Other (specify) _____

Type of regulated substance discharged: (Check all that apply)

☐ Gasoline ☐ Jet fuel ☐ Mineral acids (ASTs)
☐ Diesel ☒ Used/waste oil ☐ Ammonia compound ☐ Chlorine compound
☐ Heating oil ☐ New motor/lube oil ☐ Biofuel blends
☐ Kerosene ☐ Pesticide ☐ Unknown
☐ Aviation gas ☐ Grade 5 & 6 residual oils ☐ Other (specify) _____
☐ Hazardous substance (USTs) – write name or Chemical Abstract Service (CAS) #: _____

Discharge originated from a: (Check all that apply)

☒ Tank ☐ Other secondary containment ☐ Railroad tankcar
☐ Piping ☐ Fitting or pipe connection ☐ Barge, tanker ship or other vessel
☐ Spill bucket ☐ Valve ☐ Pipeline
☐ Dispenser ☐ Tank truck ☐ Drum
☐ Piping sump ☐ Vehicle or customer vehicle ☐ Unknown
☐ Dispenser sump ☐ Aircraft ☐ Other (specify) _____

Cause of the discharge: (Check all that apply)

☐ Spill ☐ Material failure (crack, split, etc.) ☐ Collision ☐ Weather
☐ Overfill ☐ Material incompatibility ☐ Vehicle accident ☐ Human error
☐ Corrosion ☐ Improper installation ☐ Fire/explosion ☒ Unknown
☐ Puncture ☐ Loose connection ☐ Vandalism ☐ Other (specify) _____

Actions taken in response to the discharge:

Upon discovery of the impacted soil after the tank was removed, Miami-Dade County DERM was notified via email on June 5, 2018. The concrete slab of the building was removed and impacted soil was excavated and disposed off site. Since then, product has been skimmed from the open excavation with a vac truck.

Comments:

Skimming impacted area is ongoing. A plan is being developed to remove the impacted material and remediate the area.

Agencies notified (as applicable):

☐ Fire Department ☒ County Program Miami-Dade DERM ☐ District Office ☐ State Watch Office ☐ National Response Center
800-320-0519 800-424-8802

To the best of my knowledge and belief, all information submitted on this form is true, accurate and complete.

Luis G Lopez
Printed Name of Owner, Operator or Authorized Representative

[Signature]
Signature of Owner, Operator or Authorized Representative