

HARDEE COUNTY LANDFILL OPERATIONS DRAWINGS

Dept. of Environmental
Protection
MAR 16 2007
Southwest District

PREPARED FOR
BOARD OF COUNTY COMMISSIONERS
HARDEE COUNTY, FLORIDA

MARCH 2007

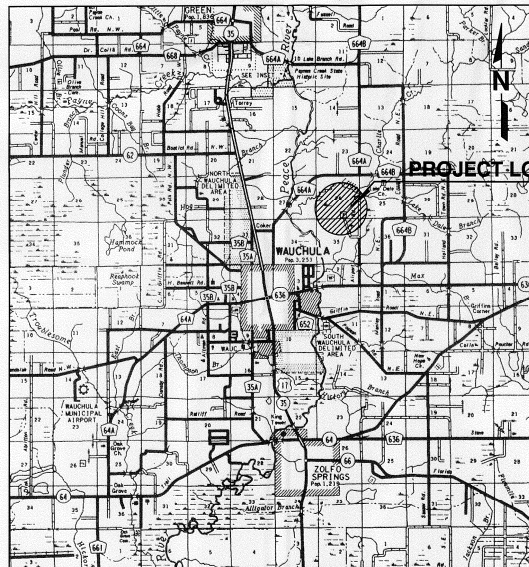

LOCATION MAP
NOT TO SCALE

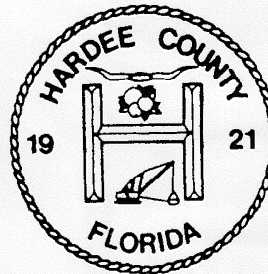

DRAWING INDEX

DRAWING NO.	DRAWING TITLE
1	COVER SHEET
2	AERIAL PHOTOGRAPHY - MAY 2003
3	AERIAL PHOTOGRAPHY - JUNE 2006
4	EXISTING CONDITIONS - JUNE 2006
5	FILL SEQUENCE PLAN - 1
6	FILL SEQUENCE PLAN - 2
7	FILL SEQUENCE PLAN - 3
8	FINAL BUILDOUT (TOP OF INTERMEDIATE COVER)
9	SECTIONS
10	DETAILS - 1
11	DETAILS - 2
12	DETAILS - 3

Dept. of Environmental
Protection
MAR 16 2007
Southwest District

Dept. of Environmental
Protection
MAR 16 2007
Southwest District

SCS ENGINEERS
STEARNS, CONRAD AND SCHMIDT
CONSULTING ENGINEERS

3012 U.S. HWY. 301 N. SUITE 700
TAMPA, FLORIDA 33619
PH (813) 871-0900 FAX NO. (813) 873-6757
WWW.SCSENGINEERS.COM
FLORIDA CERTIFICATE OF AUTHORIZATION NO. 00004892
SCS PROJECT NO. 09199033.03

SHANE R. FISCHER, P.E.
P.E. No. 58026

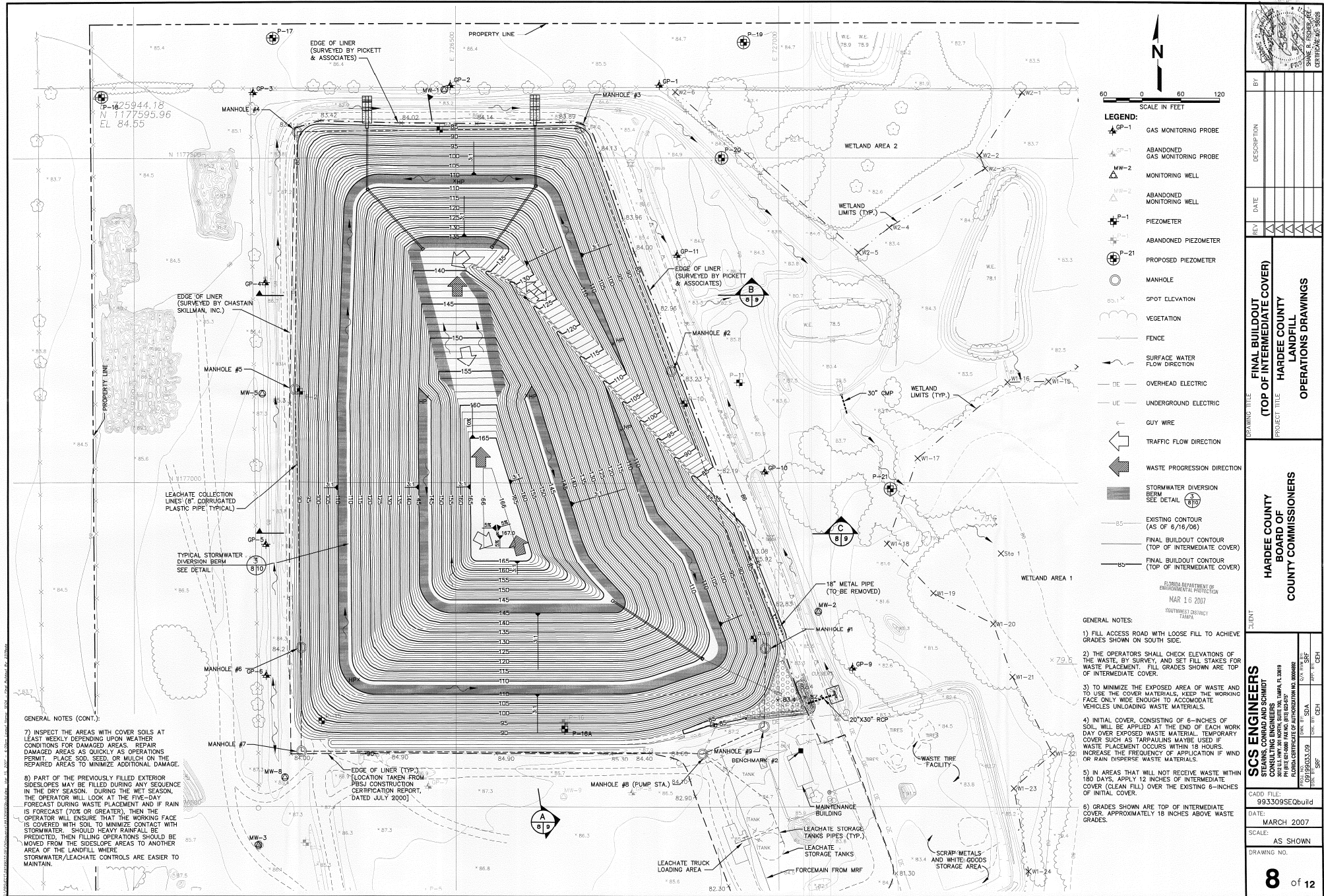

BY	DESCRIPTION
DATE	REV
DRAWING TITLE FINAL BUILDOUT (TOP OF INTERMEDIATE COVER)	
PROJECT TITLE HARDEE COUNTY LANDFILL OPERATIONS DRAWINGS	
CLIENT HARDEE COUNTY BOARD OF COUNTY COMMISSIONERS	
SCS ENGINEERS STEVENSON, CONRAD AND SCHMIDT CONSULTING ENGINEERS 1201 N. W. 10th Ave., Suite 100 Fort Lauderdale, FL 33304 PHONE: (954) 571-1234 FAX: (954) 571-1235 E-MAIL: info@scs-engineers.com FLORIDA CERTIFICATE OF AUTHORIZATION NO. 00000000 DATE: 12/17/06 PAGE: 11 OF 12	
CADD FILE: 993309SE01build	
DATE: MARCH 2007	
SCALE: AS SHOWN	
DRAWING NO. 8 of 12	

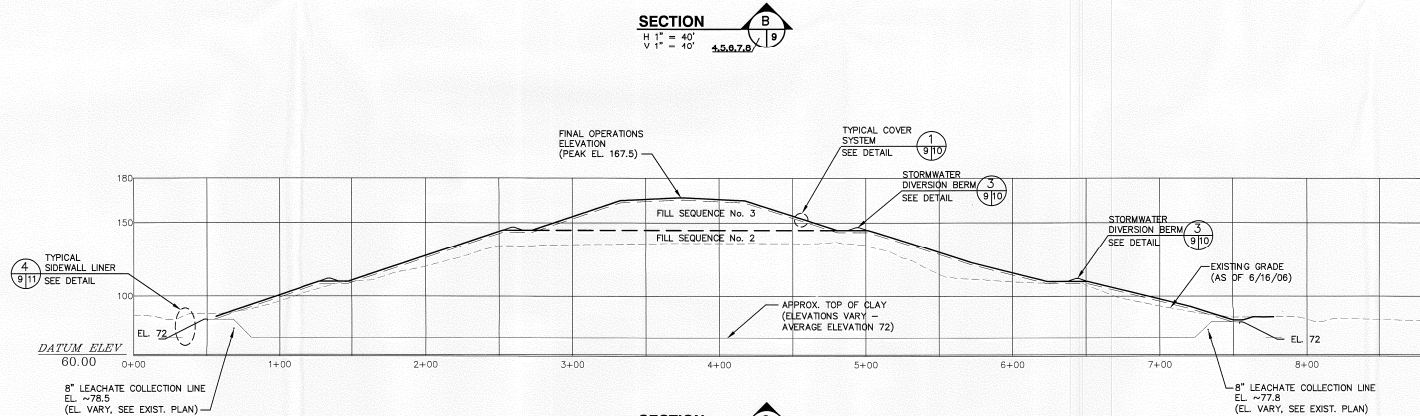
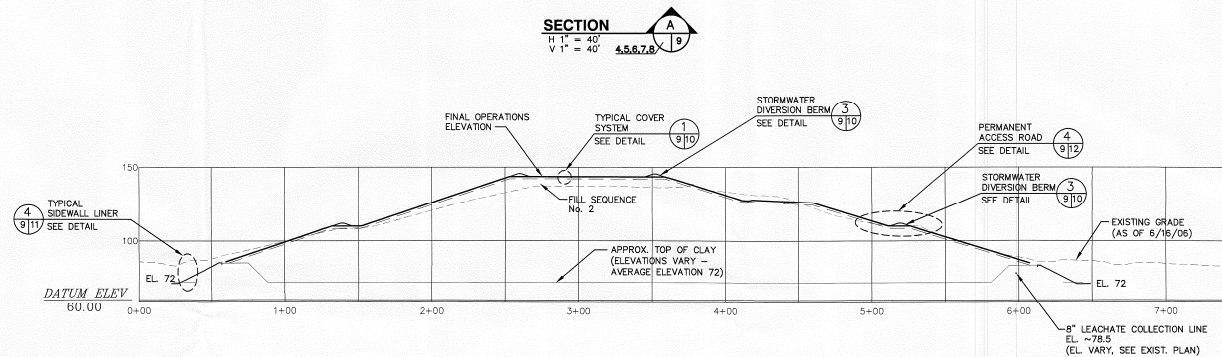
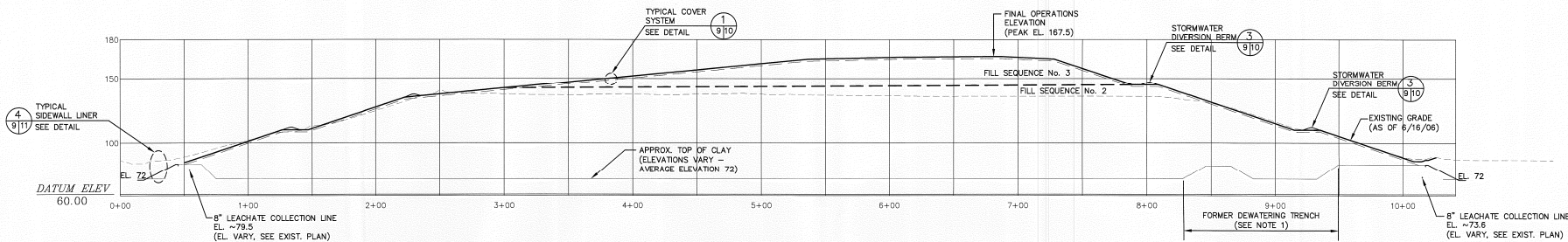

NOTES:

1. BOTTOM CLAY ELEVATIONS AND SIDESLOPE SHOWN WERE APPROXIMATED FROM DRAWINGS BY ENVISOR, DATED NOVEMBER 1982, PROJECT NO. 81 014-82(1). ACTUAL DEPTH OF WASTE NOT DETERMINED.
2. FINE GRADING WITH CLEAN SOIL ONLY (FREE OF WASTE, ROCKS, DEBRIS).
3. PREVIOUSLY FILLED OUTER SLOPES DESIGNATED TO RECEIVE WASTE SHALL BE SURVEYED OR HAND BORINGS DUG AND MARKED IN THE FIELD TO ENSURE THAT AT LEAST A 2-FOOT THICK COMPACTED WASTE LAYER CAN BE PLACED PRIOR TO DISTURBING EXISTING COVER. ADDITIONAL SPACE CAN BE MADE AVAILABLE BY REMOVING COVER SOILS; HOWEVER, 18 INCHES OF SOILS SHALL BE PLACED OVER THE WASTE MATERIAL TO ACHIEVE GRADES SHOWN.
4. SLOPES SHALL NOT EXCEED 3(H):1(V) AT ANY TIME, AFTER APPLICATION OF COVER SOILS. ALL FINAL SLOPES SHALL CONFORM TO THE DESIGN DIMENSIONS, SLOPES, AND ELEVATION.
5. ALL FILL SEQUENCE GRADES SHOWN ARE TOP OF INTERMEDIATE COVER.

BY	DESCRIPTION
DATE	
REV	
SECTIONS HARDEE COUNTY LANDFILL OPERATIONS DRAWINGS	
DRAWING TITLE PROJECT TITLE OPERATIONS DRAWINGS	
CLIENT HARDEE COUNTY BOARD OF COUNTY COMMISSIONERS	
SCS ENGINEERS STEARN, CONRAD AND SCHMIDT 1001 E. 10TH AVE. SUITE 100, TAMPA, FL 33601 PH 813 241-1111 FAX 813 241-1112 FLORIDA CERTIFICATE OF AUTHORIZATION NO. 000159333.09 DATE: 03/16/07	
CADD FILE:	993309SE03SECTIONS
DATE:	MARCH 2007
SCALE:	AS SHOWN
DRAWING NO.	9 of 12

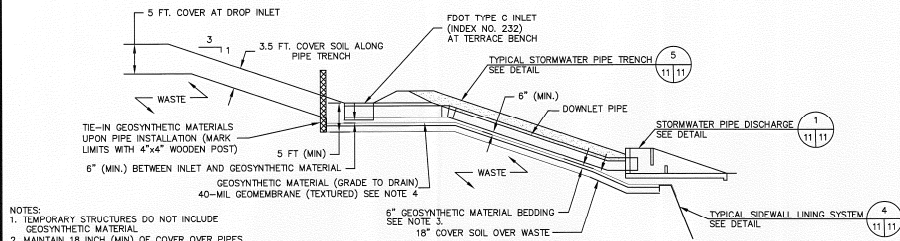

- NOTES:
1. TEMPORARY STRUCTURES DO NOT INCLUDE GEOSYNTHETIC MATERIAL.
 2. MAINTAIN 18 INCH (MIN) OF COVER OVER PIPES.
 3. GEOSYNTHETIC MATERIAL BEDDING 6 INCH (MIN) - CLEAN COMPACTED SOIL (SP, SC, SOILS WITH <15% 200 SIEVE).
 4. NO ROCKS, STICKS, ROOTS.
 5. PLACE ADDITIONAL PIECE OF GEOSYNTHETIC MATERIAL, 40-MIL LLDPE GEOMEMBRANE (TEXTURED), OVER 40-MIL LLDPE GEOMEMBRANE (TEXTURED) UNDER ALL PERMANENT STRUCTURE, INLETS, AND END TREATMENTS.

TYPICAL STORMWATER DOWNLET DETAIL

SCALE H 1" = 10'
V 1" = 10'

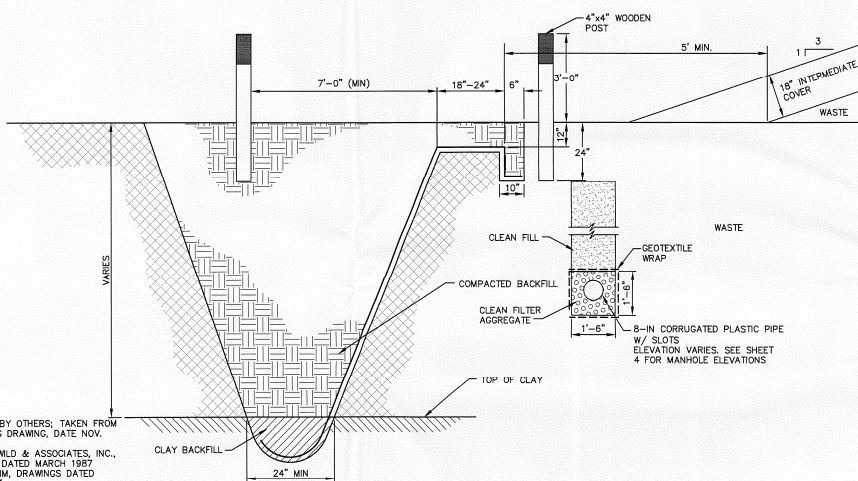

TYPICAL SIDEWALL LINING SYSTEM DETAIL

NOT TO SCALE

- NOTES:
1. DESIGNED BY OTHERS, TAKEN FROM - ENVIROSONS DRAWING, DATE NOV. 1982 - BRILEY, WILD & ASSOCIATES, INC., DRAWINGS DATED MARCH 1987 - WADE TRIM, DRAWINGS DATED SEPT. 1994
 2. SEE PLANS FOR LIMITS OF INTERMEDIATE COVER.

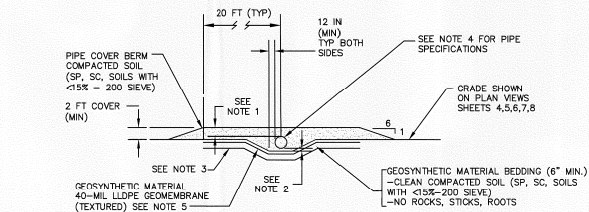

TYPICAL STORMWATER TRENCH DETAIL

SCALE H 1" = 10'
V 1" = 10'

- NOTE:
1. MAINTAIN 18 INCH (MIN) OF COMPACTED SOIL (SP, SC, SOILS WITH <15% 200 SIEVE) COVER OVER PIPES.
 2. MAINTAIN 6 INCH OF COMPACTED SOIL (SP, SC, SOILS WITH <15% 200 SIEVE) BETWEEN PIPE AND GEOSYNTHETIC MATERIALS.
 3. MAINTAIN 18 INCH COVER SOIL OVER WASTE.
 4. ALL STORMWATER PIPES - CORRUGATED PLASTIC PIPE SMOOTH INTERIOR ADS N-12 WITH WATERTIGHT COUPLINGS AND FITTINGS. INSTALL PIPE PER ASTM D 2321.
 5. PLACE ADDITIONAL PIECE OF GEOSYNTHETIC MATERIAL, 40-MIL LLDPE GEOMEMBRANE (TEXTURED), OVER 40-MIL LLDPE GEOMEMBRANE (TEXTURED) UNDER ALL PERMANENT STRUCTURE, INLETS, AND END TREATMENTS.

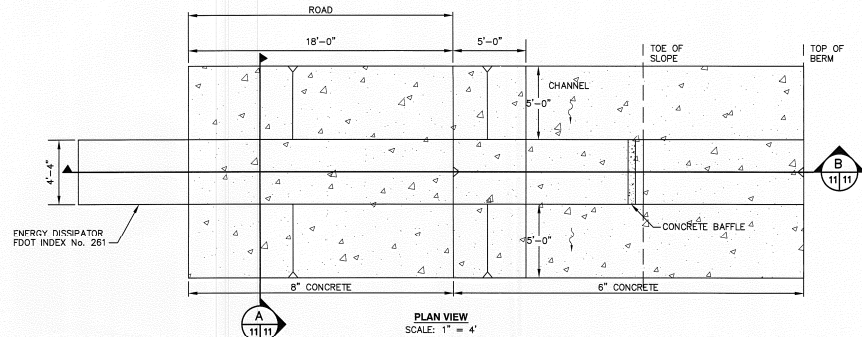

PLAN VIEW

SCALE: 1" = 4'

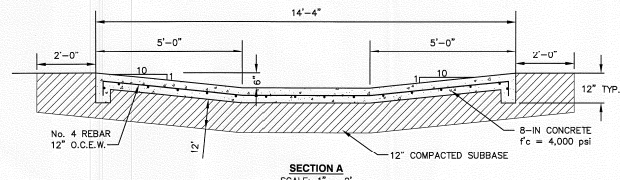

SECTION A

SCALE: 1" = 2'

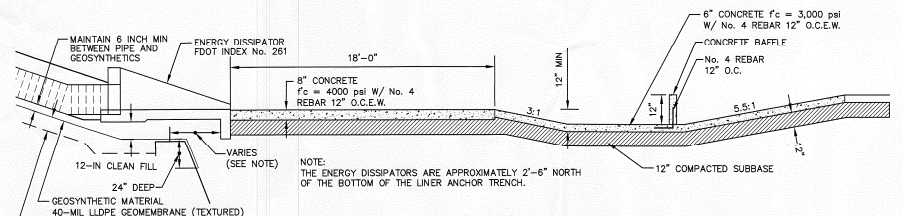

SECTION B

SCALE: 1" = 4'

STORMWATER PIPE DISCHARGE DETAIL

NO SCALE

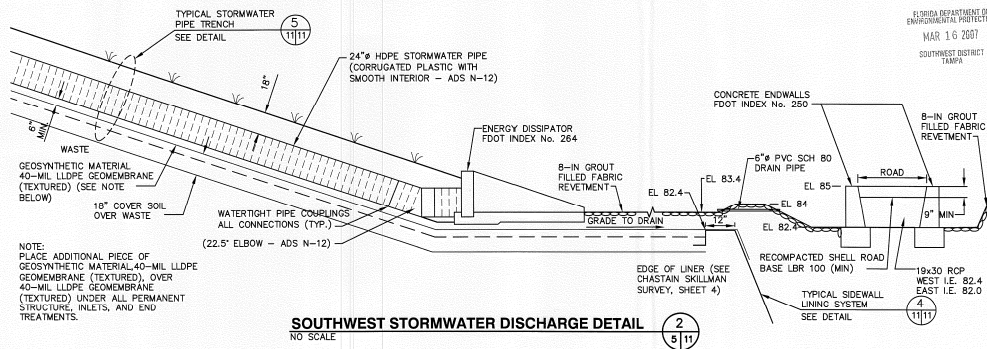

SOUTHWEST STORMWATER DISCHARGE DETAIL

NO SCALE

	BY	DATE	REV	DESCRIPTION
DRAWING TITLE				
DETAILS - 2				
PROJECT TITLE				
HARDEE COUNTY LANDFILL OPERATIONS DRAWINGS				
CLIENT				
HARDEE COUNTY BOARD OF COUNTY COMMISSIONERS				
SCS ENGINEERS				
STEARNS, CONRAD AND SCHMIT				
CONSULTING ENGINEERS, TAMPA, FL 33618				
FLORIDA CERTIFICATE OF AUTHORIZATION NO. 00000000				
CADD FILE: 993309SEQDET				
DATE: MARCH 2007				
SCALE: AS SHOWN				
DRAWING NO. 11 of 12				

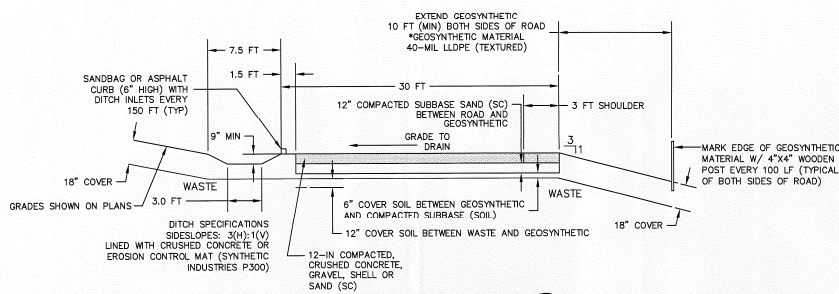

TYPICAL PERMANENT ACCESS ROAD DETAIL
NOT TO SCALE

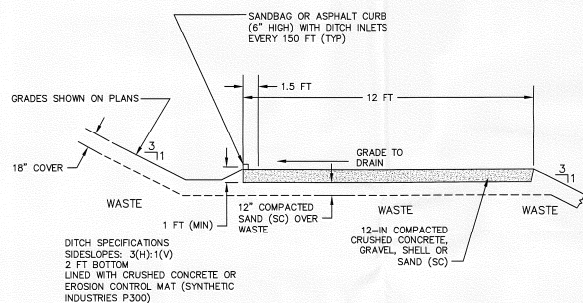

TYPICAL TEMPORARY ACCESS ROAD DETAIL
NOT TO SCALE

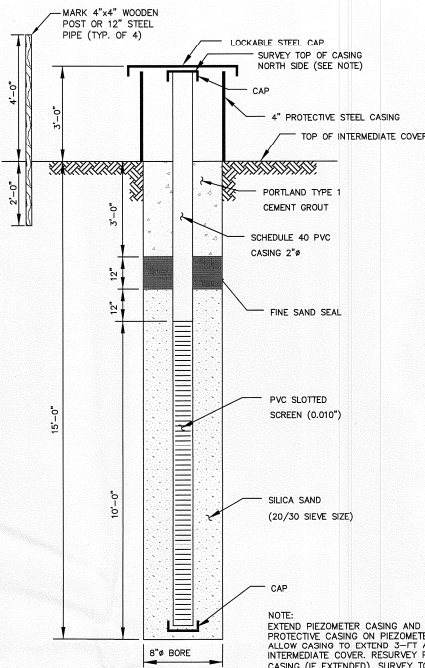

TYPICAL PIEZOMETER DETAIL
NOT TO SCALE

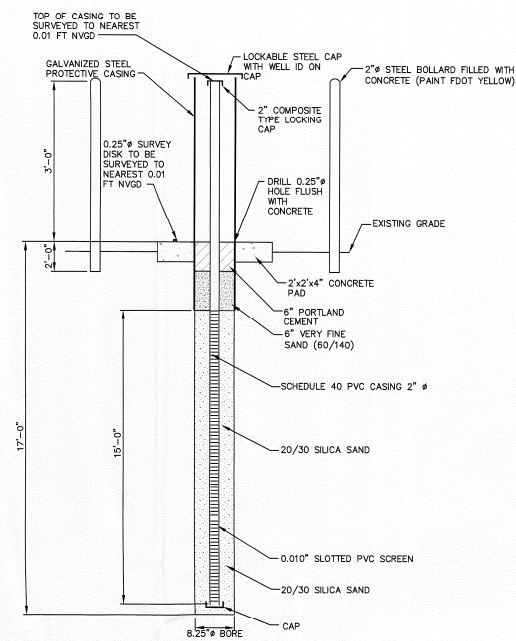

TYPICAL MONITORING WELL DETAIL
NOT TO SCALE

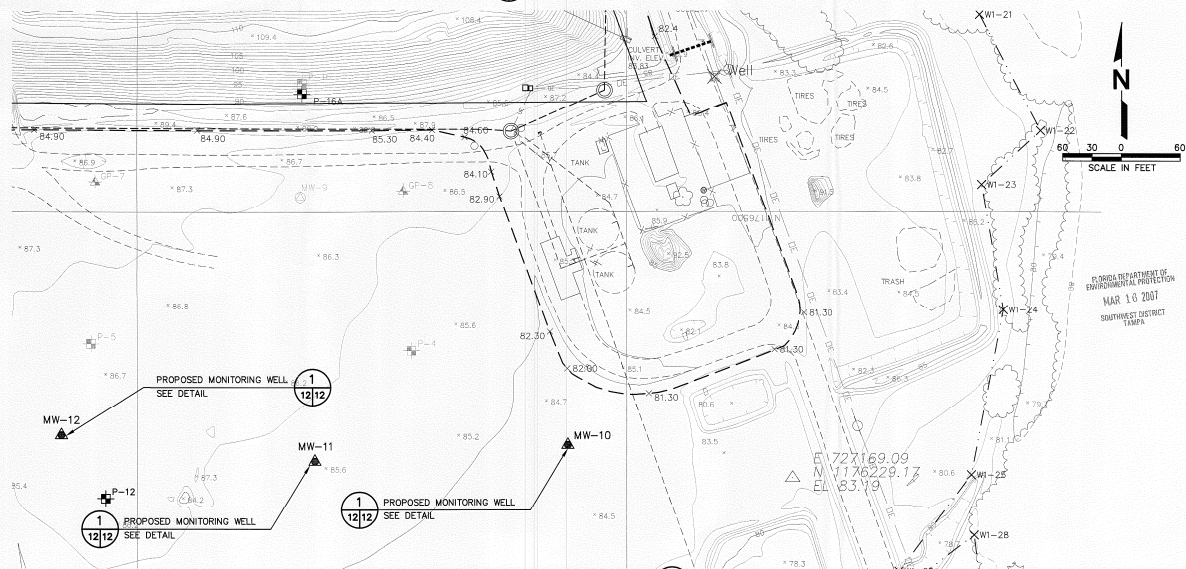

MONITORING WELL LOCATION MAP
SCALE: AS SHOWN

		BY	
		DESCRIPTION	
		DATE	
		REV	
DETAILS - 3			
HARDEE COUNTY LANDFILL OPERATIONS DRAWINGS			
HARDEE COUNTY BOARD OF COUNTY COMMISSIONERS			
SCS ENGINEERS STEARNS, CONRAD AND SCHMIDT CONSULTING ENGINEERS 1116229.17 FLORIDA CERTIFICATE OF AUTHORIZATION NO. 0000000 PH 813 941-1688 FAX 813 941-1687 000190033.09 DATE: 07/10/07 DRAWN BY: SCS CHECKED BY: CEH DATE: 07/10/07			
CADD FILE: 993309SECDTEL			
DATE: MARCH 2007			
SCALE: AS SHOWN			
DRAWING NO.			
12 of 12			