

LEGEND

SYMBOL	DESCRIPTION
	PROPOSED CONTOUR AND ELEVATION. ELEVATION RELATIVE TO NGVD-29, DERIVED FROM F.D.O.T. BENCHMARK
	EXISTING CONTOUR (SHEET # 3 thru 6)
$N 3390.67$ $E 3727.72$	ASSUMED COORDINATES
	GROUND TARGET
	PROPERTY BOUNDARY
	EXISTING STRUCTURE
	SECTION AND DETAIL DESIGNATION
	SHEET # WHERE SECTION/DETAIL IS SHOWN
	SHEET # WHERE SECTION/DETAIL IS FIRST INDICATED
	CULVERT W/ MITERED ENDS
	SLOPE
	RETENTION AREA
	PROPOSED SPOT ELEVATION
	EXISTING SPOT ELEVATION
	APPROXIMATE BOUNDARY OF AREAS THAT ARE NOT A PART OF THE CONTRACT
	LIMITS OF 30 mil PVC LINER
	APPROXIMATE BOUNDARY OF AREAS FOR SOLID WASTE RELOCATION
	GAS VENTILATION STRUCTURE
	GROUNDWATER MONITOR WELL
	FENCE

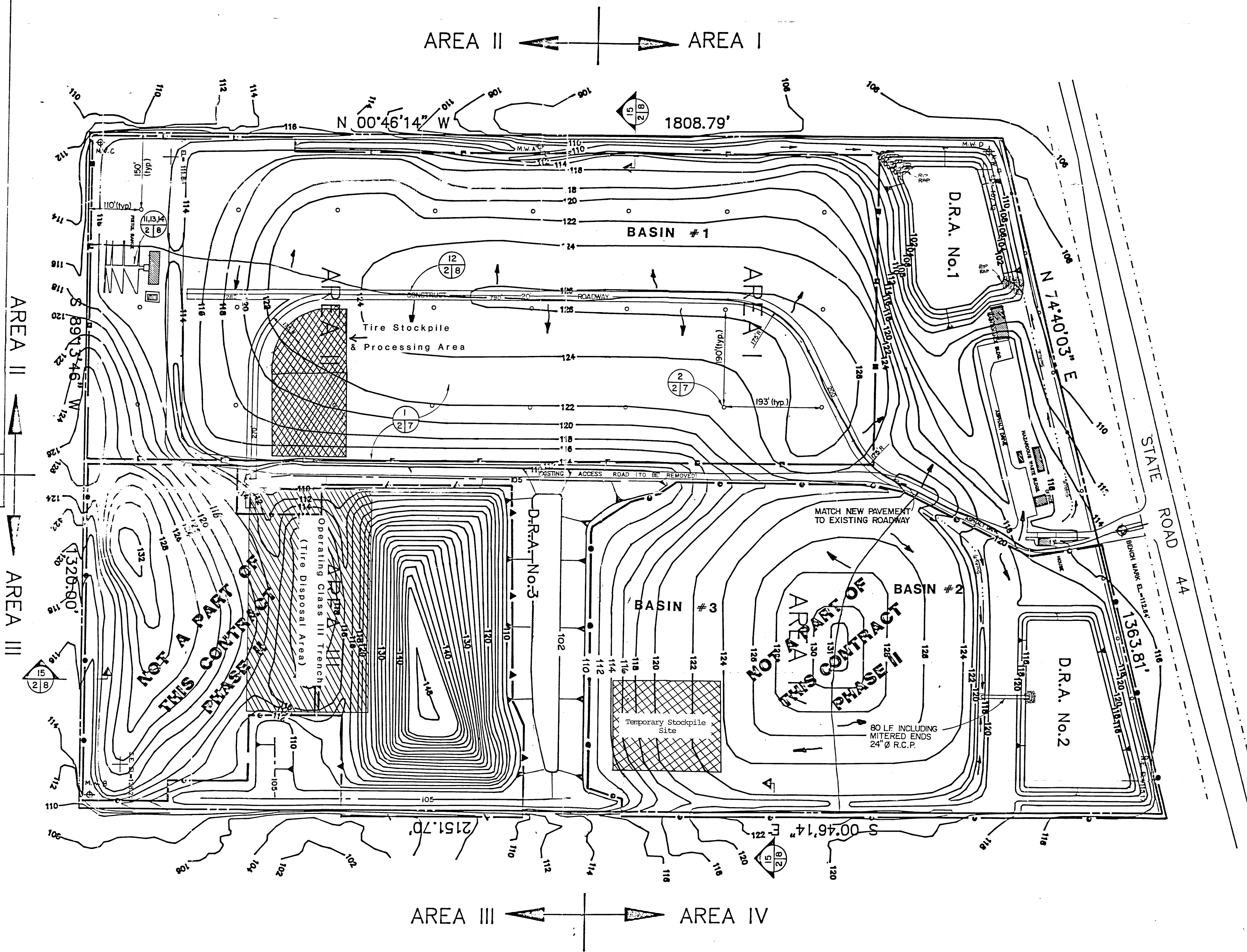

REVISIONS	
BY DATE	REVISED BY B.T. 3-13-89
BY DATE	REVISED BY R.M. 5-22-89

	PRELIMINARY		DESIGN	
	BY	DATE	BY	DATE
DRAWN	B.A.	11-88	B.A.	12-88
DESIGNED	B.T.	11-88	B.T.	12-88
CHECKED	B.T.	11-88	B.T.	12-88

DEPARTMENT OF TECHNICAL SERVICES
CITRUS COUNTY, FLORIDA
ENGINEERING DIVISION

APPROVED BY:
Richard A. Boy
DATE 12-29-88

60 Acre Sanitary Landfill Closure
OVERALL SITE GRADING PLAN
SECTION I TOWNSHIP 19S RANGE 18E

PROJECT NUMBER 89-64
SHEET 2 OF 8
SCALE 1" = 100'
FILE #

D.E.R.
SEP 19 1989