

SWIFT X12  
150904

J 8/23



**Board of County Commissioners**  
**DEPARTMENT OF PUBLIC WORKS**  
**SOLID WASTE MANAGEMENT DIVISION**

P.O. Box 340, Lecanto, Florida 34460  
Telephone: (352) 527-7670 FAX: (352) 527-7672  
email: landfillinfo@bocc.citrus.fl.us  
TDD Telephone: (352) 527-5303  
Citrus Springs/Dunnellon/Inglis/Yankeetown area Toll Free (352) 489-2120

August 18, 2010

Dept. of Environmental Protection  
**AUG 23 2010**  
Southwest District

Susan J. Pelz, P.E.  
Solid Waste Section  
Department of Environmental Protection  
13051 N Telecom Pkwy  
Temple Terrace, Fl 33637-0926

**Re: Citrus County Central Landfill – Permit No. 21375-008-SO/01  
Landfill Gas Monitoring**

Dear Ms. Pelz,

The attached report was prepared by SCS Engineers for the County and reports the results of gas monitoring for the third quarter of 2010. This monitoring is in accordance with Specific Conditions F2 and F3 of the referenced permit.

No methane was detected in any of the probes or monitoring points.

Please contact me if you have questions or require additional information.

Sincerely,

T. Casey Stephens  
Director, Division of  
Solid Waste Management

CC: Ken Frink, Director, Public Works Department (w/o attachments)  
Ed Hilton, SCS Engineers, Tampa (w/o attachments)  
Ed Gough – Withlacoochee Technical Institute  
Mike Penn – Division of Forestry

## SCS ENGINEERS

August 13, 2010  
File No. 09208040.05

Mr. Casey Stephens, Director  
Citrus County Department of Public Works  
Division of Solid Waste Management  
P.O. Box 340  
Lecanto, Florida 34460

Subject: Landfill Gas Monitoring Report, Third Quarter 2010  
Central Landfill, Citrus County, Florida

Dear Casey:

SCS Engineers (SCS) is pleased to submit the results of the second quarter landfill gas (LFG) monitoring at Citrus County Central Landfill. SCS conducted this monitoring in accordance with our scope of services dated September 9, 2009. Provided below is a description of our activities, summary of the monitoring results, and recommendations.

### BACKGROUND

In April 2007, the Florida Department of Environmental Protection (FDEP) approved extending the compliance boundary for LFG migration monitoring at the site to coincide with the boundaries of the 2006 lease agreement between Citrus County and the Florida Division of Forestry. As a result, the 18 LFG monitoring probes installed along the new property boundary now serve as the compliance points for migration monitoring. The remaining 62 permanent LFG probes and 12 interim probes have been abandoned in place and are no longer monitored on a quarterly basis. Figure 1 in Attachment 1 includes a site map that shows the LFG monitoring probe locations.

Rule 62-701.530(1)(a) of the Florida Administrative Code (F.A.C.) requires the following:

- The methane concentration in on, or off-site structures, may not exceed 25 percent of the lower explosive limit (LEL). The LEL for methane is five percent by volume in air. Therefore, the maximum allowable concentration in on, or off-site structures, is 1.25 percent methane by volume.
- The methane concentration at or beyond the landfill property boundary may not exceed the LEL (i.e., five percent (5.0%) methane by volume).

This quarterly monitoring was conducted in accordance with Rule 62-701.530(2)(c), F.A.C.



## MONITORING RESULTS

On August 12, 2010, SCS personnel monitored the LFG monitoring probes and on-site structures. SCS used a Landtec GEM-2000 gas monitor to measure gas composition in the monitoring probes and on-site structures. The GEM-2000 measures gas by percent volume of methane, carbon dioxide, oxygen, and balance gas, which is considered to be composed primarily of nitrogen. The instrument was calibrated prior to use and once more during the sampling event.

### **LFG Monitoring Probes**

Table 1 of Attachment 2 shows the readings obtained from the 18 probes along the property boundary. Methane was not detected in any of the monitoring probes. A site plan showing the probe locations is included in Attachment 1.

### **Monitoring of On-Site Structures**

No methane was detected in the scalehouse, administration building, shop, leachate treatment facility, or firing range as shown in Table 1 of Attachment 2. Floor plans of the scale house and the administration building are included in Attachment 1.

SCS monitored in the restrooms of the administration building, as well as in select closets, the break room, conference room, and hallways. In the scalehouse, SCS monitored the main work area, cabinets, the restroom, and at electrical outlets. Monitoring of the leachate treatment facility included around the base of structures, at the control panel, and inside the electrical room.

At the firing range, SCS monitored the floor joints, electrical outlets, and the base of slabs or posts that penetrated the ground.

### **Testing Methane Monitor**

SCS checked the methane monitor in the leachate treatment plant electrical building and determined that the monitor is operating in accordance with the manufacturer's standards.

## CONCLUSIONS

No methane was detected during this monitoring event in the 18 probes, which are the compliance points for migration or within any of the buildings monitored on-site.

SCS is providing you two signed and sealed originals of this submittal. Please keep one for your files and forward the other to the FDEP Southwest District office at the following address:

Mr. Casey Stephens, Director  
August 13, 2010  
Page 3

Florida Department of Environmental Protection  
13051 N. Telecom Parkway  
Temple Terrace, Florida 33637-0926

SCS appreciates the opportunity to assist you with this work. Please call us at (800) 569-9702 if you have any questions or would like additional information.

Sincerely,



8-13-10

Daniel R. Cooper, P.E.  
Project Manager



Raymond J. Dever, P.E., BCEE  
Vice President  
**SCS ENGINEERS**

DRC/RJD: drc

Attachments

**ATTACHMENT 1**  
**MONITORING LOCATIONS**

G:\PROJECT\Citrus\09208040.01\GasMonitor\original.dwg Aug 12, 2010 - 4:46pm Layout Name: GasMonPlan Br. cadd

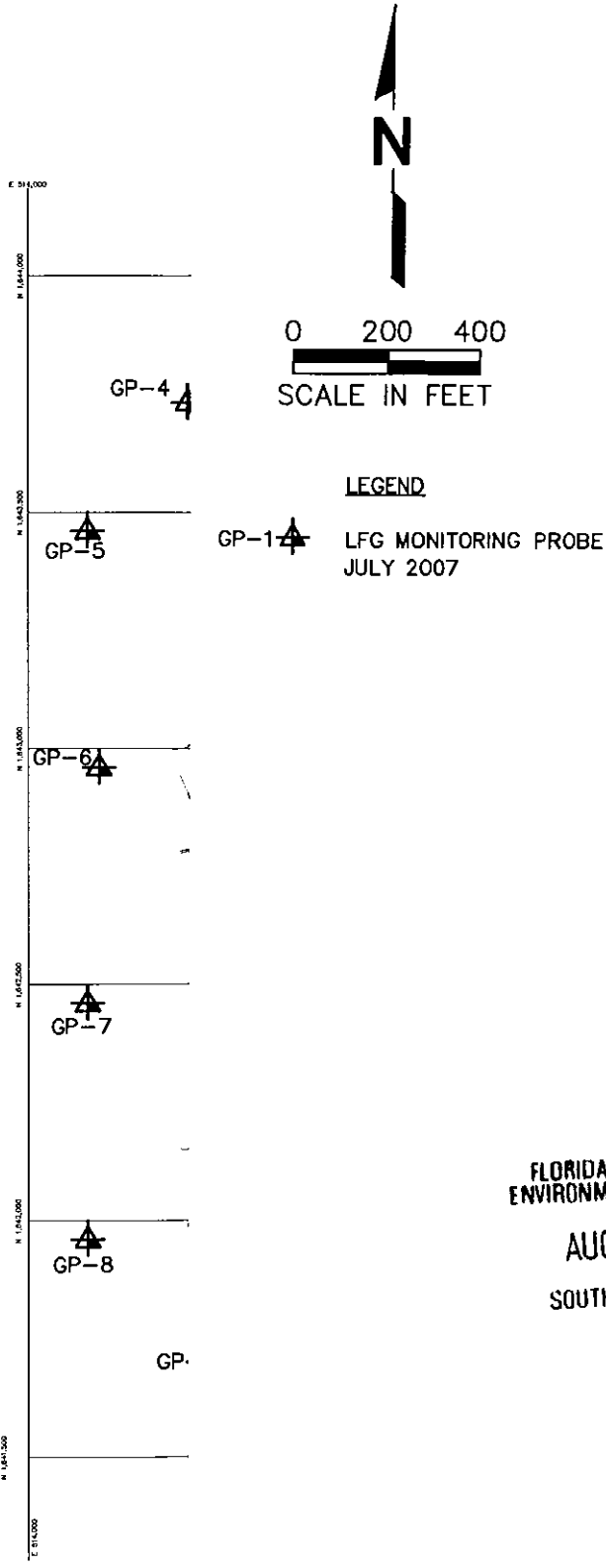

FLORIDA DEPARTMENT OF ENVIRONMENTAL PROTECTION

AUG 23 2010

SOUTHWEST DISTRICT TAMPA

SCS ENGINEERS

G:\PROJECT\Citrus\09208040\_01\ADMIN\_FLOOR\_PLAN.dwg Aug 13, 2010 - 10:18am Layout Name: ADMIN\_FLOOR\_PLAN By: cadd

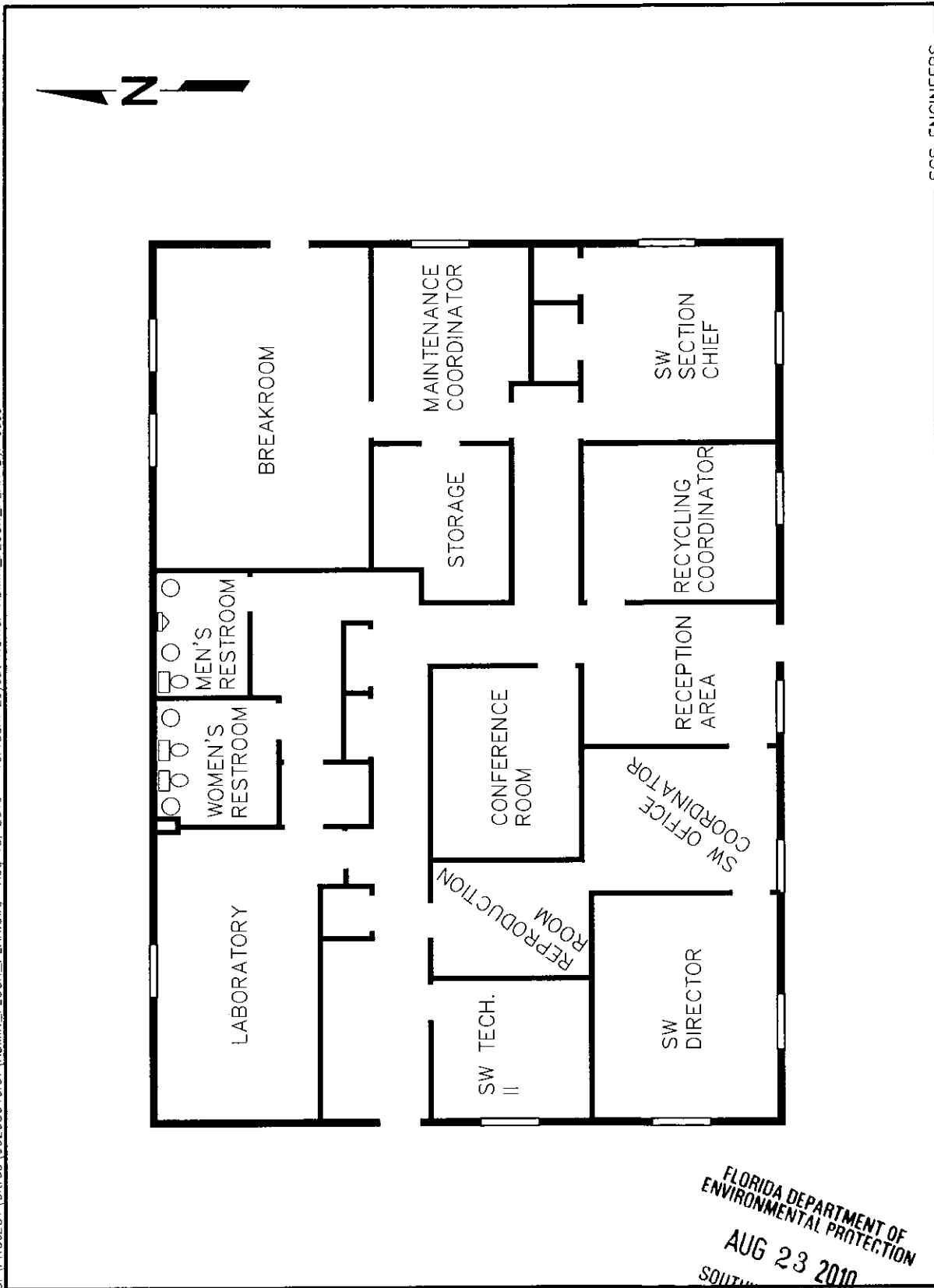

FLORIDA DEPARTMENT OF ENVIRONMENTAL PROTECTION  
AUG 23 2010  
SOUTHWEST DISTRICT  
TAMPA

Figure 2. Administration Building Floor Plan

C:\PROJECT\Citrus\09208040\_01\SCALEHOUSE\_FLOOR\_PLAN.dwg Aug 13, 2010 - 10:19am Layout Name: SCALEHOUSE\_FLOOR\_PLAN.Br.cadd

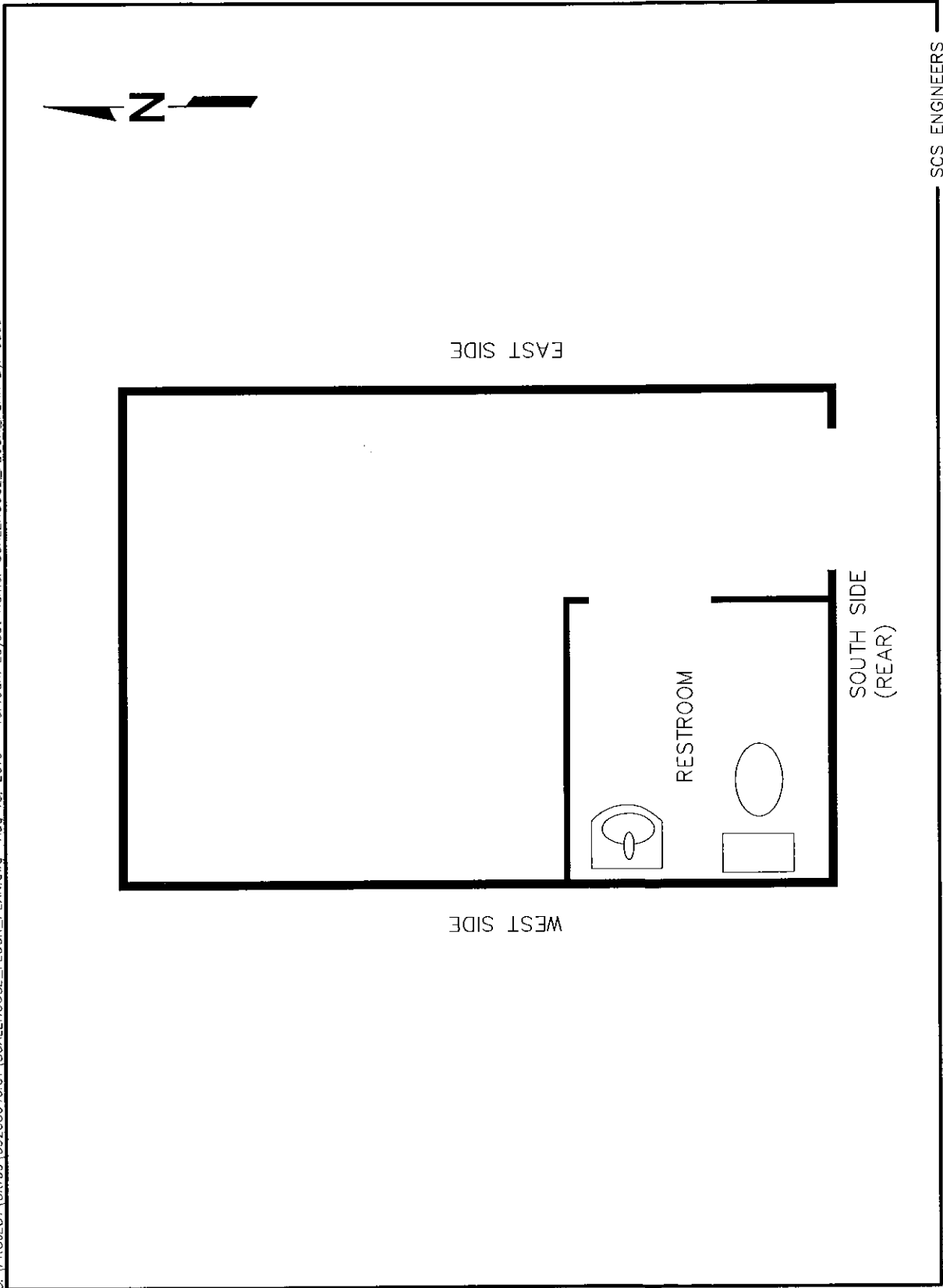

Figure 3. Scalehouse Floor Plan



**ATTACHMENT 2**  
**LFG MONITORING RESULTS**

**TABLE 1**  
**LANDFILL GAS MIGRATION MONITORING, THIRD QUARTER 2010**  
**CENTRAL LANDFILL, CITRUS COUNTY**

| Probe No. | CH <sub>4</sub><br>(%) | CO <sub>2</sub><br>(%) | O <sub>2</sub><br>(%) | Balance<br>(%) | Pressure<br>(in-w.c.) | Comments |
|-----------|------------------------|------------------------|-----------------------|----------------|-----------------------|----------|
| GP-1      | 0.0                    | 1.1                    | 18.7                  | 80.2           | 0.0                   |          |
| GP-2      | 0.0                    | 1.3                    | 18.9                  | 79.8           | 0.0                   |          |
| GP-3      | 0.0                    | 1.0                    | 18.8                  | 80.2           | 0.0                   |          |
| GP-4      | 0.0                    | 2.1                    | 18.1                  | 79.8           | 0.0                   |          |
| GP-5      | 0.0                    | 1.2                    | 19.4                  | 79.4           | 0.0                   |          |
| GP-6      | 0.0                    | 1.9                    | 19.1                  | 79.0           | 0.0                   |          |
| GP-7      | 0.0                    | 1.1                    | 19.6                  | 79.3           | 0.0                   |          |
| GP-8      | 0.0                    | 0.8                    | 19.7                  | 79.5           | 0.0                   |          |
| GP-9      | 0.0                    | 0.7                    | 20.1                  | 79.2           | 0.0                   |          |
| GP-10     | 0.0                    | 1.5                    | 19.4                  | 79.1           | 0.0                   |          |
| GP-11     | 0.0                    | 0.8                    | 19.7                  | 79.5           | 0.0                   |          |
| GP-12     | 0.0                    | 1.0                    | 19.5                  | 79.5           | 0.0                   |          |
| GP-13     | 0.0                    | 0.6                    | 19.4                  | 80.0           | 0.0                   |          |
| GP-14     | 0.0                    | 0.6                    | 19.7                  | 79.7           | 0.0                   |          |
| GP-15     | 0.0                    | 1.4                    | 19.2                  | 79.4           | 0.1                   |          |
| GP-16     | 0.0                    | 1.1                    | 19.0                  | 79.9           | 0.0                   |          |
| GP-17     | 0.0                    | 0.3                    | 19.7                  | 80.0           | 0.0                   |          |
| GP-18     | 0.0                    | 0.8                    | 19.3                  | 79.9           | 0.0                   |          |

| On Site                 | CH <sub>4</sub><br>(%) | % LEL |
|-------------------------|------------------------|-------|
| Scalehouse              | 0.0                    | 0.0   |
| Shop                    | 0.0                    | 0.0   |
| Administration Building | 0.0                    | 0.0   |
| Treatment Facility      | 0.0                    | 0.0   |
| Firing Range            | 0.0                    | 0.0   |

Notes:

1. Monitoring performed by SCS Engineers (813) 621-0080 on 8/12/2010.
2. Temperature: scattered showers, warm and 88 degrees F.
3. Barometric Pressure: 29.77 in. Hg