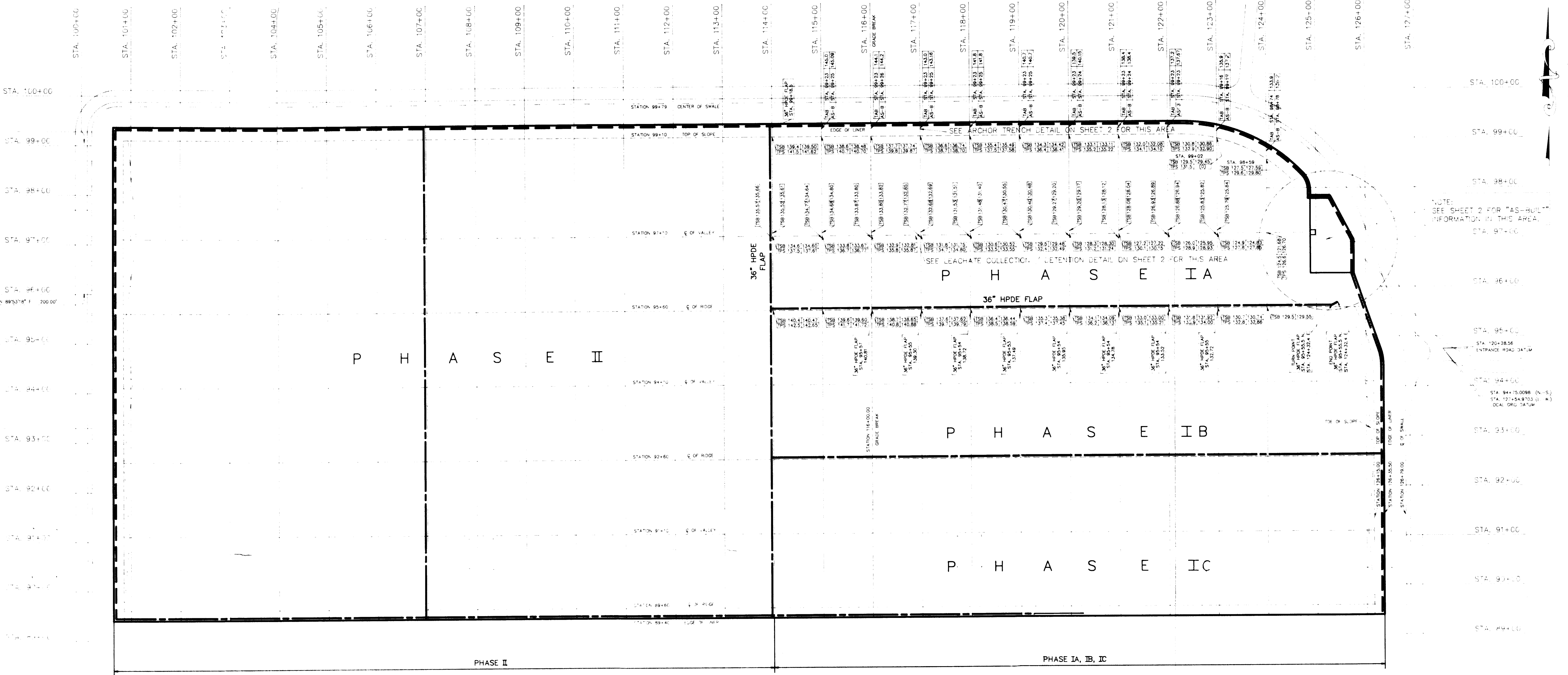

IMAGE QUALITY

AS YOU VIEW THE NEXT PAGE(S), PLEASE
NOTE THAT THE ORIGINAL DOCUMENT
WAS OF POOR QUALITY

SECTION 24
SECTION 19
N 00°06'42" W 420.79'
N 00°06'42" W 1311.58'
N 00°06'42" W 311.56'



BOUNDARY CORNER

DESIGNED BY SUNSHINE STATE SURVEYORS, INC.

PHASE	DATE	LOCATION
A	3-14-92	STA. 95+00.00 TO STA. 97+00.00 (NORTH)
A	3-14-92	STA. 124+71.60 TO STA. 125+76.00 (EAST)
A	3-14-92	STA. 95+60.00 TO STA. 99+00.00 (NORTH)
A	3-14-92	STA. 114+00.00 TO STA. 117+00.00 (EAST)
A	3-15-92	STA. 97+06.00 TO STA. 99+00.00 (NORTH)
A	3-15-92	STA. 114+00.00 TO STA. 118+00.00 (EAST)
A	3-23-92	STA. 97+05.00 TO STA. 99+00.00 (NORTH)
A	3-23-92	STA. 119+00.00 (EAST)
A	3-23-92	STA. 97+05.00 TO STA. 97+05.00 (NORTH)
A	3-23-92	STA. 113+80.00 TO STA. 114+00.00 (EAST)
A	3-23-92	STA. 97+05.00 TO STA. 99+00.00 (NORTH)
A	3-23-92	STA. 114+00.00 TO STA. 117+00.00 (EAST)
A	3-23-92	STA. 95+00.00 TO STA. 99+00.00 (NORTH)
A	3-23-92	STA. 124+00.00 TO STA. 125+00.00 (EAST)
A	3-23-92	STA. 95+00.00 TO STA. 99+00.00 (NORTH)
A	3-23-92	STA. 124+00.00 TO STA. 124+00.00 (EAST)
A	3-23-92	STA. 95+00.00 TO STA. 99+00.00 (NORTH)
A	3-23-92	STA. 114+00.00 TO STA. 117+00.00 (EAST)
A	3-23-92	STA. 95+00.00 TO STA. 99+00.00 (NORTH)
A	3-23-92	STA. 124+00.00 TO STA. 124+00.00 (EAST)
A	3-23-92	STA. 95+00.00 TO STA. 99+00.00 (NORTH)
A	3-23-92	STA. 114+00.00 TO STA. 117+00.00 (EAST)
A	3-23-92	STA. 95+00.00 TO STA. 99+00.00 (NORTH)
A	3-23-92	STA. 124+00.00 TO STA. 124+00.00 (EAST)

SHEET 1 OF 2

I HEREBY CERTIFY THAT THE SURVEY HEREIN (COLLECTIVE AND INDIVIDUALLY) IS A TRUE AND CORRECT REPRESENTATION OF THE SURVEY DATA AS SHOWN HEREON AND THAT THE SURVEY HEREIN MEETS THE MINIMUM TECHNICAL STANDARDS AS SET FORTH BY CHAPTER 472.02 OF THE FLORIDA STATUTES.

ROBERT S. CURTIS, SURVEYOR NO. 4341

"AS-BUILT"

LINER SYSTEM AS-BUILT FOR TRAIL RIDGE LANDFILL JACKSONVILLE, DUVAL COUNTY, FLORIDA

SUNSHINE STATE SURVEYORS, INC.
SURVEYORS & LAND PLANNERS 2131 ST. JOHNS BLUFF RD., SOUTH, JACKSONVILLE, FLORIDA 32218
(904) 642-8558

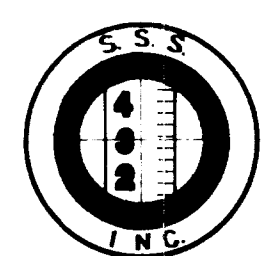

- LEGEND
- PHASE LINE
 - 36" HPDE FLAP
 - LINER
 - C OF VALLEY
 - C OF RIDGE
 - C OF SWALE
 - EDGE OF LINER
 - TOP OF SLOPE
 - TOP OF SUBBASE ELEV.
 - TOP OF ANDOR-BERM

NOTE: FOR DETAILS, SEE SHEET 2 OF THIS AREA.

NOTE: SEE SHEET 2 FOR "AS-BUILT" INFORMATION IN THIS AREA.

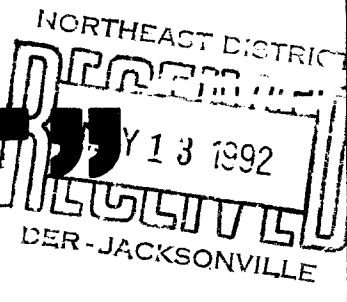

SCALE: 1" = 100'

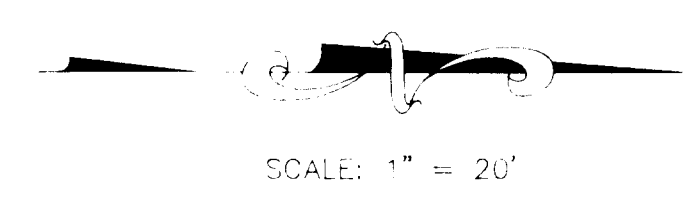
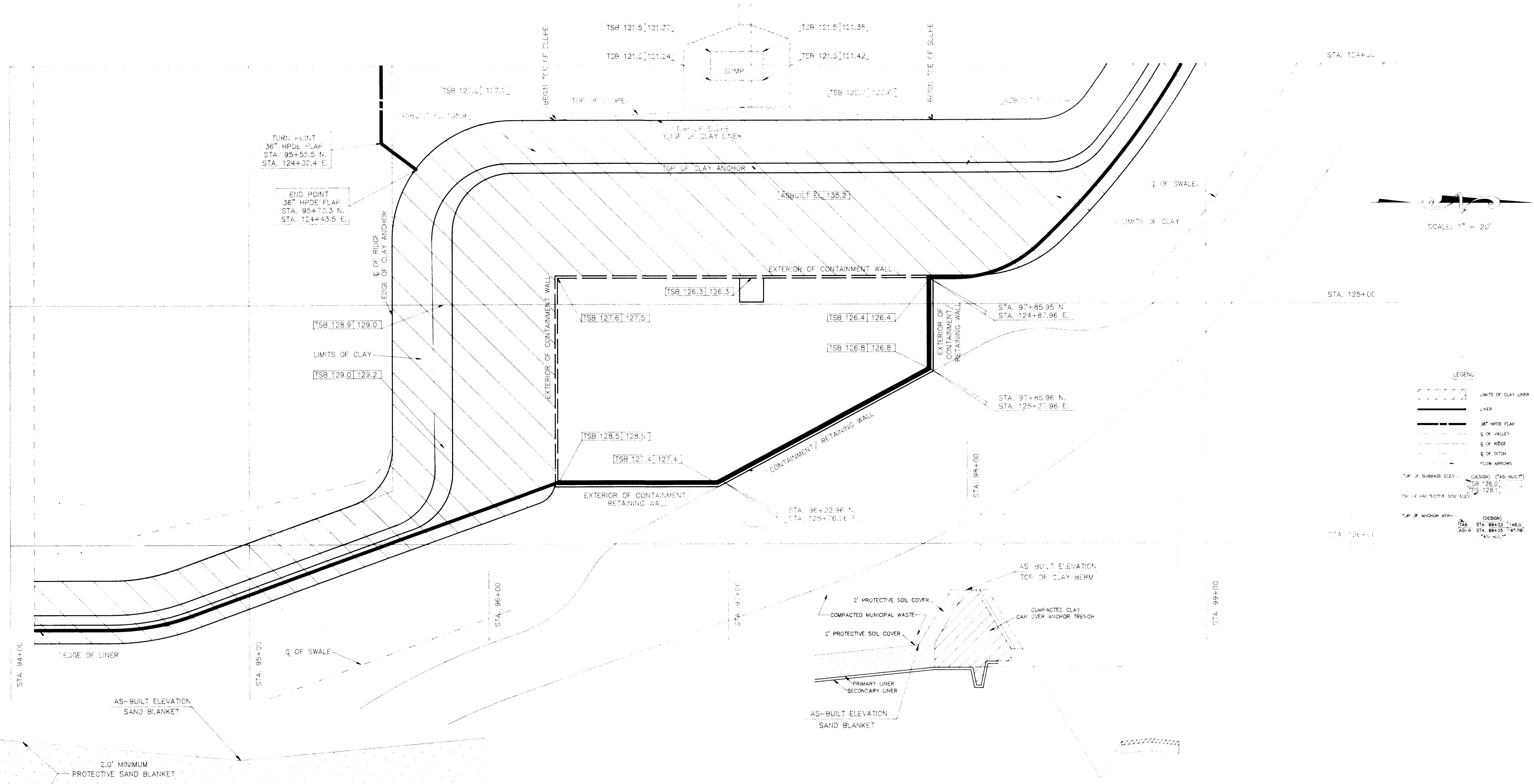

- LEGEND
- LIMITS OF CLAY LINER
 - LINER
 - 36" HDPE FLAP
 - C. OF VALLEY
 - C. OF RIDGE
 - C. OF DITCH
 - FLOW ARROWS
 - TOP OF SUBBASE ELEV. (DESIGN) (AS-BUILT) TSB 126.0 | 126.0
 - TOP OF PROTECTIVE SOIL ELEV. (DESIGN) (AS-BUILT) TSB 128.1 | 128.1
 - TOP OF ANCHOR BERM (DESIGN) (AS-BUILT) STA. 99+23 | 145.0, STA. 99+25 | 145.0, STA. 99+25 | 145.0

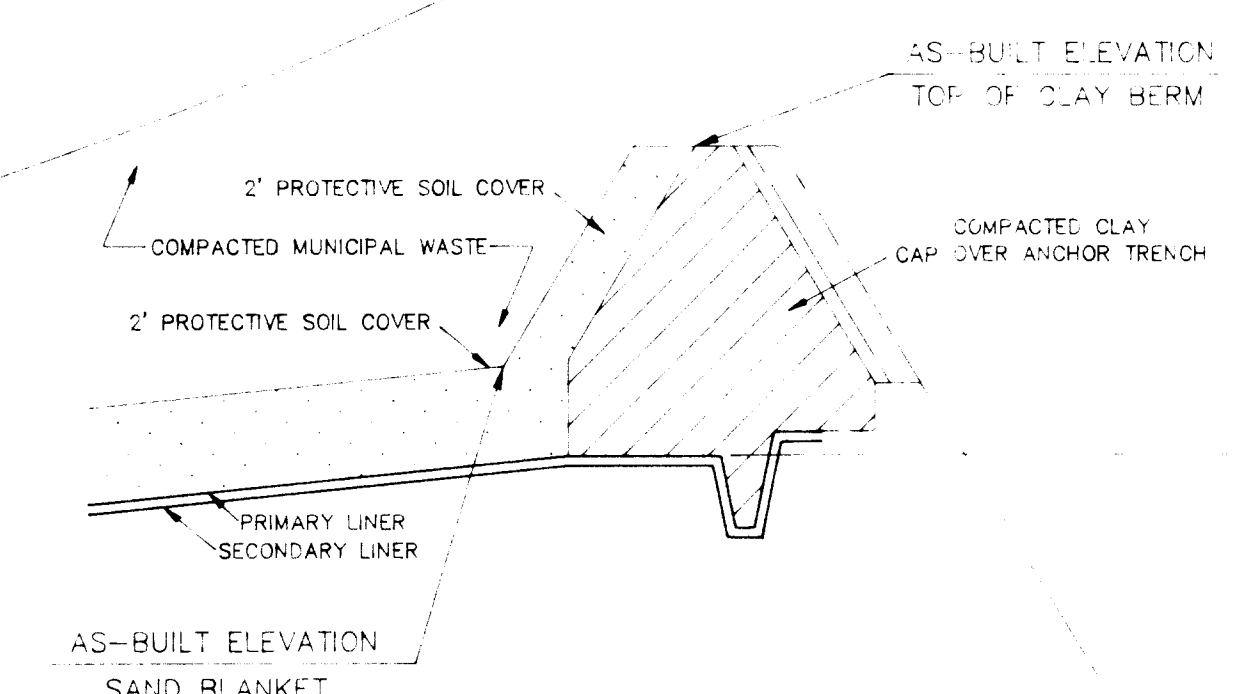

NORTH ANCH DETAILOR TRENCH DETAIL
 SCALE: 1" = 20' HORIZONTAL
 1" = 4' VERTICAL

SHEET 2 OF 2

DATE	PHASE
5-12-92	1A

I HEREBY CERTIFY THAT THE CLAY SUB-BASE, PROTECTIVE SAND, 36" HDPE FLAP, AND THE TOP OF CLAY BERM SHOWN HEREON ARE AT THE HORIZONTAL AND/OR VERTICAL LOCATION AS DEPICTED ON THIS "AS-BUILT" AND MEETS THE MINIMUM TECHNICAL STANDARDS AS SET FORTH BY CHAPTER 472.007 OF THE FLORIDA STATUTES.

ROBERT S. CORSA, FLORIDA SURVEYOR NO. 4341

"AS-BUILT"

LINER SYSTEM AS-BUILT FOR TRAIL RIDGE LANDFILL JACKSONVILLE, DUVAL COUNTY, FLORIDA

SUNSHINE STATE SURVEYORS, INC.
 SURVEYORS & LAND PLANNERS 3131 ST. JOHNS BLUFF RD. SOUTH, JACKSONVILLE, FLORIDA 32216
 (904) 642-8550

LEACHATE COLLECTION / DETECTION TRENCH DETAIL