



Florida Department of Environmental Protection

Bob Martinez Center
2600 Blair Stone Road
Tallahassee, Florida 32399-2400

DEP Form # 62-701.900(23)
Form Title: Waste Tire Processing
Facility Permit Application
Effective Date: January 6, 2010
Incorporated in Rule 62-711.530(6)

Waste Tire Processing Facility Permit Application

Permit No. WACS # 100855

Renewal Modification Existing unpermitted facility Proposed new facility

Part I-General Information:

A. Applicant Information:

1. Applicant Name: Aziz Mounir

2. Applicant Street Address: 750 Central 11915 Ottawa Ave

3. City: Orlando County: Orange Zip: 32832

4. Applicant Mailing Address: Same

5. City: _____ County: _____ Zip: _____

6. Contact person: Aziz Mounir Phone: (407) 535-3685 FEID No: _____

7. Have any enforcement actions been taken by the Department against the applicant relating to the operation of any solid waste management facility in this state? This includes any Complaint, Notice of Violation, Revocation of a permit or registration, as well as any Consent Order in which a violation of Department rules is admitted. It does not include a Warning Letter, Warning Notice, Notice of Noncompliance, or other similar document which does not constitute agency action.

Yes No If yes, attach a history and description of the enforcement actions.

RECEIVED
OCT 15 2012
DEP Central District

RECEIVED
OCT 22 2012
DEP Orange District
correct fee received 10/22/12

B. Facility Information:

1. Facility Name: Rayan's Used Tire Wholesale

2. Facility Street Address (Main Entrance): 750 Central Florida Pkwy

3. City: Orlando County: Orange Zip: 32824

4. Facility Mailing Address: 750 Central Florida Pkwy

5. City: Orlando State: FL Zip: 32824

6. Contact Person: Aziz Mounir Phone: (407) 535-3685

7. Facility Location Coordinates:

Section: 11 Township: 24 Range: 29

Latitude: 28° 24' 25" Longitude: 81° 23' 13"

8. Anticipated date for starting construction 10/12 and for completion of construction 1/13

9. Anticipated date for receipt of tires Current and for start of processing Current

Mail completed form to appropriate district office listed below

- Northwest District: 160 Government Center, Pensacola, FL 32501-5794, 850-595-8360
- Northeast District: 7825 Baymeadows Way, Ste. 200 B, Jacksonville, FL 32256-7590, 904-807-3300
- Central District: 3319 Maguire Blvd., Ste. 232, Orlando, FL 32803-3767, 407-894-7555
- Southwest District: 13051 N. Telecom Pky, Temple Terrace, FL, 813-632-7600
- South District: 2295 Victoria Ave., Ste. 364, Fort Myers, FL 33902-2549, 239-332-6975
- Southeast District: 400 North Congress Ave., West Palm Beach, FL 33401, 561-681-6600

C. Land Owner Information (if different from applicant):

- Owner's name: Welcom Holdings, LLC
- Land owner's mailing address: 365 W Tatt-Vineland Rd # 105
- City: Orlando State: FL Zip: 32824-8139
- Authorized Agent: John Russel Agent's phone (407) 816 8181
- Current lease expires: 2014

D. Facility Operator Information (if different from applicant):

- Operator's name: Rayan's Used Tires Wholesale, LLC
- Operator's mailing address: 750 Central Florida Parkway
- City: Orlando State: Florida Zip: 32824
- Contact person: Aziz Mounir Phone: (407) 535-3685

E. Preparer of Application:

- Name of person preparing application: Aziz Mounir
- Mailing address: Rayan's Used Tire Wholesale, LLC
- City: Orlando State: FL Zip: _____
- Phone: (407) 535-3685
- Affiliation with facility: owner

Part II-Operations:

A. Facility type (check appropriate box):

- Waste tire processing facility.
- Waste tire processing facility with on-site disposal of processed tires or processing residuals.
- Waste tire processing facility with on-site consumption of waste tires or processing residuals.
- Permitted solid waste management facility modification to allow waste tire site and processing.

B. Type of processing facility (check as many as apply):

- Shredder Cutter Chopper Incinerator only Incinerator with energy recovery
- Pyrolysis Supplemental fuel user Other, explain Sorting & storage

C. Storage: Indicate the maximum quantities of whole waste tires, processed waste tires, and processing residuals, expressed in tons, to be stored at the facility, in accordance with Rule 62-711.530(2), F.A.C.:

	Outdoor Storage(tons)	Outdoor Storage (sq.ft)	Indoor Storage (tons)	Indoor Storage (sq.ft)	Total Storage (tons)
Whole waste tires:	<u>0</u>	<u>0</u>	<u>500</u>	<u>8,750</u>	<u>500</u>
Processed tires:	<u>0</u>	<u>0</u>	<u>0</u>	<u>0</u>	<u>0</u>
Processing residuals:	<u>0</u>	<u>0</u>	<u>0</u>	<u>0</u>	<u>0</u>
TOTALS:	<u>0</u>	<u>0</u>	<u>500</u>	<u>8,750</u>	<u>500</u>

RECEIVED
 OCT 15 2012
 DEP Central District

D. For reporting quantity of tires in tons, tires will be: weighed on site weighed off site
 weights will be calculated

E. Facilities that will not be disposing of processed tires or processing residual on the facility site must indicate the permitted solid waste management facility where processed tires or residuals will be disposed.

1. Name of facility: Green Tire Processing, Inc
 2. Street address: 9680 Boggy Creek Rd
 3. City: Orlando County: Orange Zip: 32824

F. Facilities that will be delivering processed tires to consuming facilities must describe the existing or proposed markets for those processed tires.

Part III-Attachments:

A. Facility design

NOTE: All maps, plan sheets, drawings, isometrics, cross sections, or aerial photographs shall be legible; be signed and sealed by a registered professional engineer responsible for their preparation; be of appropriate scale to show clearly all required details; be numbered, referenced to narrative, titled, have a legend of symbols used, contain horizontal and vertical scales (where applicable), and specify drafting or origination dates; and use uniform scales as much as possible, contain a north arrow and use NGVD for all elevations.

1. A topographic or section map of the facility, including the surrounding area for one mile, no more than one year old, showing land use and zoning within one mile of the facility
- ✓ 2. A plot plan of the facility on a scale of not less than one inch equals 200 feet. At a minimum, the plot plan shall include
 - a. The facility design, including the location and size of all storage and processing areas for used tires, unprocessed waste tires, processed waste tires, and waste tire processing residuals;
 - b. All wetlands and water bodies within the facility or within 200 feet of any storage area;
 - c. Stormwater control measures, including ditches, dikes, and other structures;
 - d. Boundaries of the facility, legal boundaries of the land containing the facility, and any easements or rights of way that are within the facility or within 200 feet of any storage area;
 - e. Location, size, and depth of all wells within the facility or within 200 feet of any storage area;
 - f. All structures and buildings that are, or will be, constructed at the facility; include those used in storage and processing operations;
 - g. All areas used for loading and unloading;
 - h. All access roads and internal roads, including fire lanes;
 - i. Location of all fences, gates, and other access control measures; and
 - j. Location of all disposal areas within the facility.

~~RECEIVED
 OCT 15 2012
 DEP Central District~~

B. Facility operation.

- ✓ 1. A description of the facility's operation, process and products including how waste tires will be received and stored.
- ✓ 2. A description of the equipment used for processing tires. This description shall include the make, model, and hourly capacity of each piece of equipment.
- ✓ 3. Description of the waste from the process, the amount of waste expected and how and where this waste will be disposed of.
- ✓ 4. Statement of the maximum daily throughput and the planned daily and annual throughput.
- ✓ 5. A description of how the operator will maintain compliance with each of the storage requirements of Rule 62 - 711.540, F.A.C.
- ✓ 6. A copy of the emergency preparedness manual for the facility with a statement of the on site and off site locations where that manual will be maintained.
- ✓ 7. A copy of the fire safety survey
- ✓ 8. A description of how 75% of the annual accumulation of waste tires will be removed for disposal or recycling.

~~✓~~ Completed closing plan for the facility as required by Rule 62-711.700(2) and (3), F.A.C.

- D. Attach proof of financial responsibility as requirement by Rule 62-711.500(3) OR a calculation showing that financial assurance documents, currently on file with the Department, are sufficient to assure closing of the waste tire site as well as any other solid waste management facility at that location.
- ✓ E. A letter from the land owner (if different from applicant) authorizing use of the land as a waste tire processing facility.
- X F. If waste tires will be consumed or disposed of at the facility, attach a description of the other environmental permits that the applicant has for this use, including, permit number, date of issue, and name of issuing agency
- ✓ G. The permit fee as required in Rule 62-4, F.A.C.

Part IV-Certification:

A. Applicant:

The undersigned applicant or authorized representative of Ryan's Used Tire Wholesale Inc
 is aware that statements made in this form and attached information are an application for a
Permit from the Florida Department of Environmental Protection and certifies that
 The information in this application is true, correct and complete to the best of his knowledge and belief.
 Further, the undersigned agrees to comply with the provisions of Chapter 403, Florida Statutes, and all rules and regulations of the Department. It is understood that the Department will be notified prior to the sale or legal transfer of the facility.

[Signature] Signature of Applicant or Authorized Agent Aziz Mounir Name and Title 10/6/12 Date

B. Professional Engineer registered in Florida.

This is to certify that the engineering features of this waste tire processing facility have been Designed/examined by me and found to conform to engineering principals applicable to such facilities. In my professional judgment, this facility, when properly maintained and operated will comply with all applicable statutes of the State of Florida and rules of the Department. It is agreed that the undersigned will provide the applicant with a set of instructions for proper maintenance and operation of the facility.

[Signature] Signature Po Box 690942 Mailing Address
Darcy Unroe PE Name and Title Orlando, FL 32801 City, State, Zip
60929 Florida Registration Number 407 299-0650 Telephone number

Darcy@unroeengineering.com

10/12/12 Date

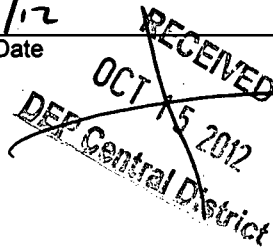
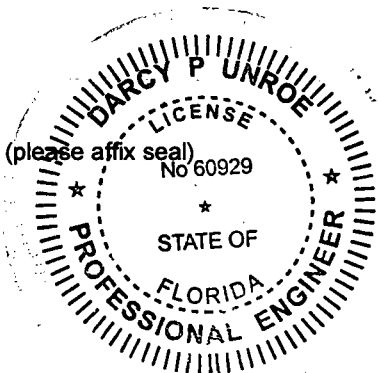

Welcome Holdings, I.L.C
365 Taft Vineland Road, Suite 105 Orlando, FL 32824
407-816-8181

July 31, 2012

To Whom It May Concern,

Rayan Used Tire Wholesale, LLC is authorized to sell wholesale used tires at the facility owned by Welcome Holdings, LI.C located at 750 Central Florida Parkway, Orlando, FL 32824.

Sincerely,

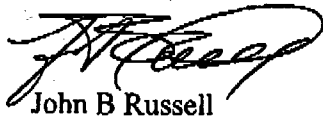

John B Russell

~~RECEIVED
OCT 15 2012
DEP. Central District~~

Fire Protection System Summary Inspection and Testing Form

VSC Fire & Security, Inc.

P.O. Box 680490
Orlando, FL 32868

Phone 407-679-3332
Fax 407-679-1733

www.vscfs.com

PART A: GENERAL INFORMATION

Frequency: Quarterly

Inspection Technician 3334 Customer # 3334MID002 Date: 2-3-12

Contract Name: Mid- Florida Warehousing

Site Address: 750 Central Florida Parkway

Site City: Orlando Site State: FL Site Postal Code: 32824

Scheduling Contact: Laura Polncot Phone Number: (407) 816-8181

Site Contact: Laura Polncot Phone Number (407) 816-8181 Pager Number _____

Last inspection date: 5/4/2011 11-9-11

Central Station (C.S) Provider: _____ C.S. Phone Number: _____

AHJ: Orange County Fire

Fire Department: _____ Phone Number: _____

PART B: QUESTIONS FOR OWNER OR OWNERS REPRESENTATIVE TO ANSWER

Yes	No
<input checked="" type="checkbox"/>	<input checked="" type="checkbox"/>
<input checked="" type="checkbox"/>	<input type="checkbox"/>
<input checked="" type="checkbox"/>	<input type="checkbox"/>
<input type="checkbox"/>	<input checked="" type="checkbox"/>
<input checked="" type="checkbox"/>	<input type="checkbox"/>
<input checked="" type="checkbox"/>	<input type="checkbox"/>

- A. Is the building occupied?
- B. Is the building and occupancy/hazard the same as the previous inspection (date _____)?.....
- C. Are all systems in service?
- D. Have there been any additions to the building or modifications/renovations since the last inspection?
- E. Is adequate heat available to wet system piping or dry, preaction, deluge or valve enclosures?
- F. Was property free from system activation?
- G. You have been shown the location of your system shut off valve. _____ (Initial Here)

The owner's representative acknowledges that applicable code makes the owner responsible for the operating conditions of the component parts of the fire protection system.

Comments NOT MONITORED

Initials of Owner's Representative _____

Date 2-3-12

PART C: TEST NOTIFICATIONS

PRIOR TO START

UPON COMPLETION

	Yes	No	Time
Monitoring Entity/Central Station		/	
Building Management		/	
Building Occupant		/	
AHJ/FD		/	
Did alarm panel reset properly?		/	

	Yes	No	Time
		/	
		/	
		/	
		/	

PART D: INSPECTION PERFORMED (Copies Attached of Items Checked)

- | | | |
|---|--|--|
| <input checked="" type="checkbox"/> Water Based System Form | <input checked="" type="checkbox"/> Standpipe and Hose Inspection Form | <input checked="" type="checkbox"/> Water Storage Tanks Form |
| <input checked="" type="checkbox"/> Dry Pipe Sprinkler Form | <input checked="" type="checkbox"/> Hydrant Flow Test Form | <input checked="" type="checkbox"/> Private Fire Service Mains Form |
| <input checked="" type="checkbox"/> Sprinkler Piping Condition Form | <input checked="" type="checkbox"/> Fire Alarm Detection Form | <input checked="" type="checkbox"/> Backflow Test Form |
| <input checked="" type="checkbox"/> Fire Pump Inspection Form | <input checked="" type="checkbox"/> Preaction Deluge System Form | <input checked="" type="checkbox"/> Addendum to Report of Inspection |
| <input checked="" type="checkbox"/> Foam System Form | <input checked="" type="checkbox"/> Suppression System Form | <input checked="" type="checkbox"/> Fire Extinguisher Form |
| <input checked="" type="checkbox"/> Range Hood Form | | |

Water-Based Fire Protection Sprinkler System Inspection and Testing Form

Location Mid-Florida Warehousing Inspection #: 3400420 Test Date: 2-3-12
750 Central Florida Parkway
Orlando, FL 32824

PART A - QUARTERLY INSPECTION/TESTING ITEMS (Frequency as per contract with customer)

1. Valves

Item Type.....
 Location.....

- a. Make.....
- b. Model.....
- c. Type.....
- d. Size.....
- e. Quantity.....
- f. Serial Number.....
- g. Seal Number.....

Control Valve						
Wall PIV	ALARM					
	LIMP					
PIV						
8"						
1						
192434	192624					

- g. Free from physical damage?.....
- h. Valves in correct position?.....
- i. Accessible?.....
- j. No leakage?.....
- k. Valve Opened then closed back one-quarter turn?.....
- Locked or supervised with tamper switches functional?.....

Y	N	N/A	Y	N	N/A	Y	N	N/A	Y	N	N/A	Y	N	N/A	Y	N	N/A
/																	
/																	
/																	
/																	
/	/																
	/																

2. Gauges

- a. Location.....
- b. Sprinkler system water pressure prior to test.....
- c. Sprinkler system residual pressure.....
- d. Sprinkler system static pressure after test.....
- e. Sprinkler system previous test.....

Riser					
70 PSI	PSI	PSI	PSI	PSI	PSI
65 PSI	PSI	PSI	PSI	PSI	PSI
70 PSI	PSI	PSI	PSI	PSI	PSI
70 STATIC	STATIC	STATIC	STATIC	STATIC	STATIC
65 RESIDUAL	RESIDUAL	RESIDUAL	RESIDUAL	RESIDUAL	RESIDUAL

- f. Above test comparable to previous test?.....
- g. Sprinkler system main drain flow observed?.....
- h. Are all pressures normal?.....
- i. Good Condition/functional?.....

Y	N	N/A
/		
/		
/		
/		
		/
		/
/		
/		

- 3. Proper number and type of spare sprinkler heads?.....
- 4. Proper number and type of sprinkler wrenches?.....
- 5. Alarm Devices
 - a. Alarm devices undamaged?.....
 - b. Mechanical water flow device operated?.....

- c. Electric water flow device operated by flowing inspector's test connection or bypass line?.....

Y	N	N/A
		/
		/
		/
/		
/		
/		
/		
/		

- 6. Hydraulic nameplate present, attached and legible?.....

- 7. Fire department connections:
 - a. Visible?.....
 - b. Accessible?.....
 - c. Swivel/coupling functional?.....
 - d. FDC I.D. plate secure?.....
 - e. Check valve holding?.....
 - f. Ball drip functional?.....
 - g. Plugs/caps/gaskets in place/functional?.....

Addendum to Report of Inspection

Location Mid-Florida Warehousing

Inspection #: 3400420

Test Date: 2-3-12

SUMMATION ITEMS

(IF ANSWER TO ANY IS YES, EXPLAIN FULLY IN COMMENTS SECTION)

- A. Is open source suction intake valve defective?.....
- B. Has any obstructive material been discharged?.....
- C. Have any foreign materials been found during inspection?.....
- D. Is drain or roof test water heavily discolored?.....
- E. Have any inspector's tests or auxiliary drains been found to be plugged?.....
- F. Has the system been out of service for more than one year?.....

Yes	No	N/A
		✓
	✓	
	✓	
	✓	
	✓	
	✓	

OUTSIDE WATER MOTOR 3 ONG ONLY

System restored to normal operation, alarm panel is clear, all parties on Summary Inspection Form notified and addendum has been fully explained. Inspection conducted in accordance with NFPA #25.

Name of Inspector/Technician Ann P. ... Date 2-3-12

Signature _____ Time _____

Name of Owner Representative _____ Date _____

Signature _____ Time _____

(Sign here and initial Summary Form 7/94-P)

Rayan Used Tire Wholesale Facility Operation

General Information

Facility Location: 750 Central Florida Parkway, Orlando, Florida 32824

Facility Phone#: (407) 301-5205

Directions to Facility

From South Orange Blossom Trail, take Central Florida Parkway East. Facility is 1.3 miles on the Left

Emergency Contacts:

Aziz Mournir - (407) 535-3685

Gary Alstade - (407) 301-5205

Facility Operations:

The facility processes used tires by serving as a transfer station. Used tires are delivered to this facility. The tires are temporarily stored at the facility until they are re-sold.

The tires are stored indoors and are not exposed to storm water. The average storage time for individual tires is 30 days. The maximum number of tires stored in the facility at any one time is 20,000 tires. The average weekly throughput is 12,000 tires / week.

Daily operations consist of receiving tires delivered by semi-trailer trucks. The tires are sorted by size and quality. They are then stored in receiving bins. Any unusable tires are delivered to a separate waste tire processing plant for disposal. Concurrently, sold tires are loaded into semi-trailers or containers and delivered to final customer destinations.

Emergency Plan

General Precautions

Access to Site: The facility is accessible by a paved road from the east and west. It is located 2.5 miles from the nearest fire department station.

Communication Equipment: All personnel have access to hardwired and cellular phone lines.

Fire Emergency Events

The operator will maintain records of the quantity of tires received, shipped and stored at the site for use by emergency personnel in the event of a fire.

The operator will immediately inform the Florida Dept of Environmental Protection in the event of a fire or any other emergency and submit a written report within (2) two weeks.

Fire Protection Services

Fire protection is provided by Orange County Fire Rescue. A fire survey has been performed by the Fire Marshal and is included with this report.

Fire Controls

- No operations involving the use of open flames will be conducted on-site.
- No flammable liquids will be stored on-site.
- All individual tire piles will be not more than 50' wide except those adjacent walls which will not be more than 25' wide. Storage bins have been installed to ensure this requirement.
- The main aisles between storage bins shall be not less than 8 feet in width
- The clearance from the top of the storage to the bottom of roof structure will be greater than 3 feet.
- No unit heaters, radiant space heaters, duct furnaces or flues exist or are proposed to be installed in the facility
- Waste tire piles are less than 15' high. (Wall between adjacent warehouse areas have a four hour rating).
- Access to storage areas is controlled by overhead doors.

On-site Emergency Response Resources

Water Supply:

An adequate water supply is available through Orange County Utilities for use by the fire department. The nearest fire hydrant is located 130 ft from facility.

Fire Extinguishers:

Fire extinguishers are distributed throughout the facility. Six extinguishers minimum.

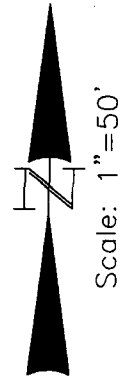
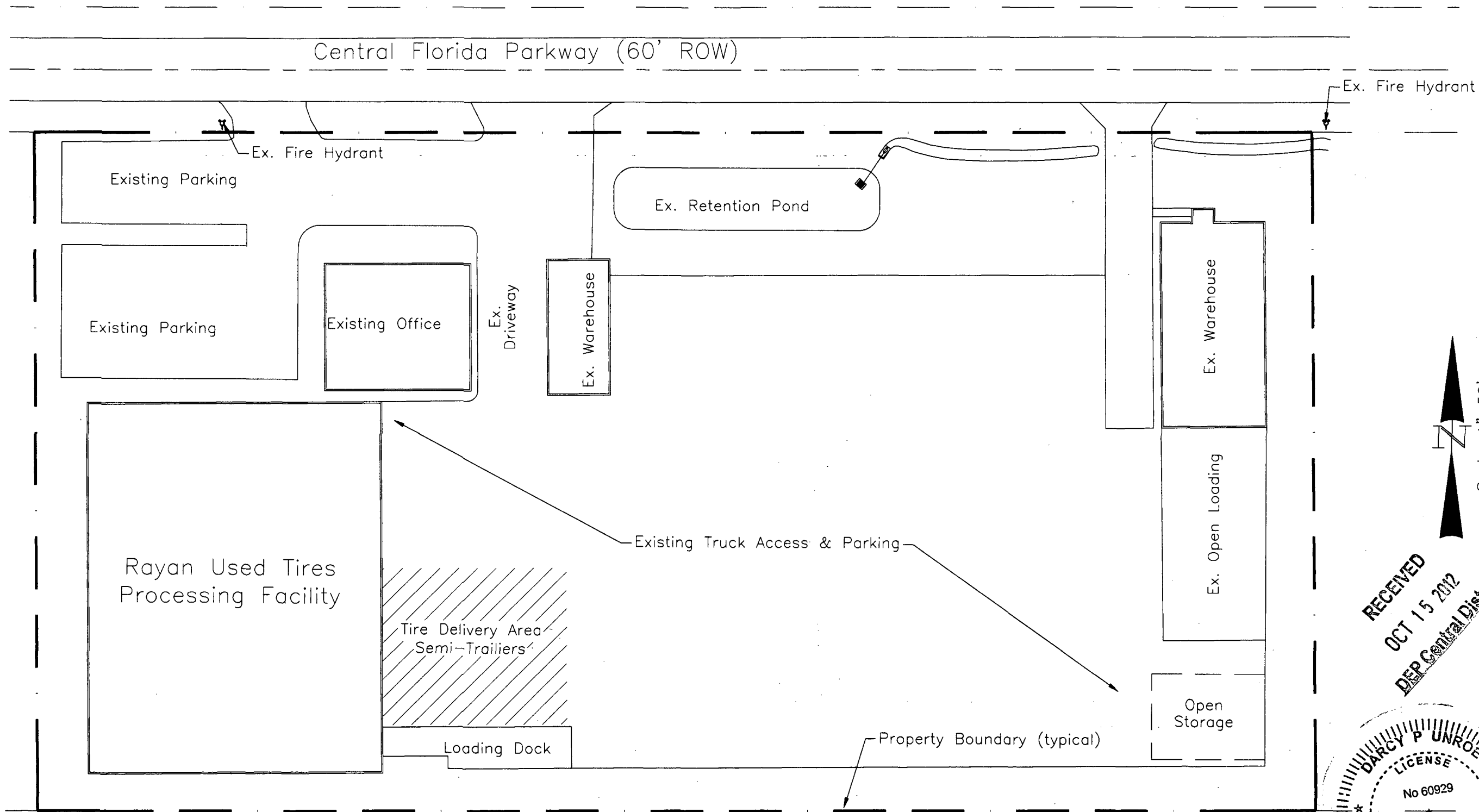

RECEIVED
OCT 15 2012
DEP Central District

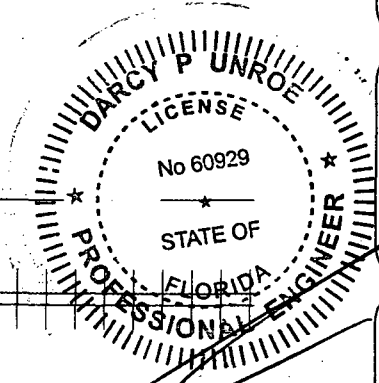

- Facility Design:
- All tires are stored inside existing building
 - Stormwater control is provided by existing on-site collection. Stormwater is piped to existing on-site stormwater pond. Since all tires are stored inside, no other stormwater controls are required.
 - No tires are disposed off on-site. Any scrap tires generated will be disposed off off-site.

Existing Railway Spur

10/12/12
Darcy Unroe PE 60929

Rayan Used Tires - Facility Plot Plan
750 Central Florida Parkway, Orlando, Florida 32824

Unroe Engineering
Civil Engineering/Planning/Scientific Evaluations
PO Box 690942, Orlando, FL 32869 ◊ PH 407-229-0650 ◊ FX 407-429-7639

Date: 08/14/12
Scale: 1"=50'
File: RUT-A

Drawing No. **A**

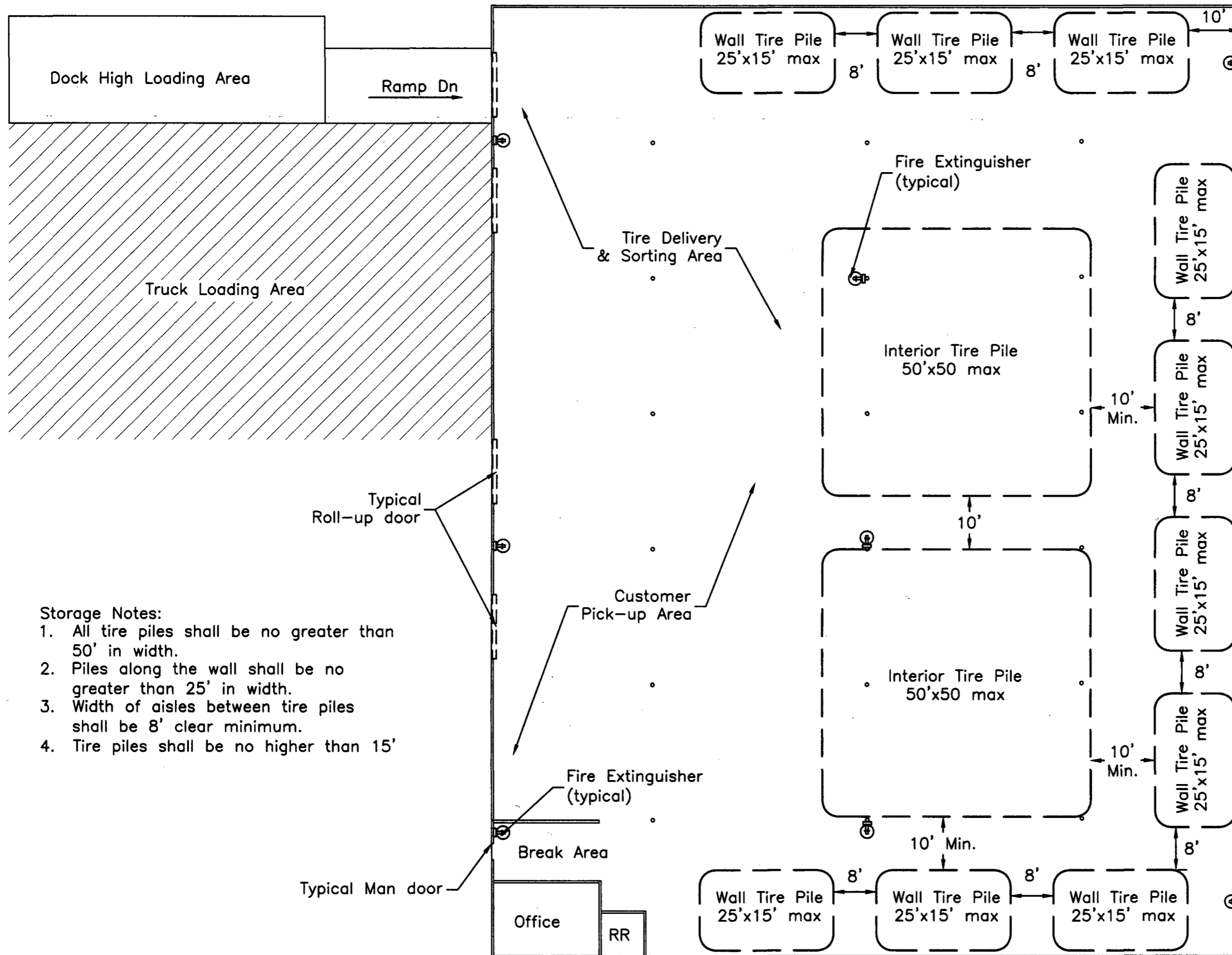

Storage Notes:

1. All tire piles shall be no greater than 50' in width.
2. Piles along the wall shall be no greater than 25' in width.
3. Width of aisles between tire piles shall be 8' clear minimum.
4. Tire piles shall be no higher than 15'

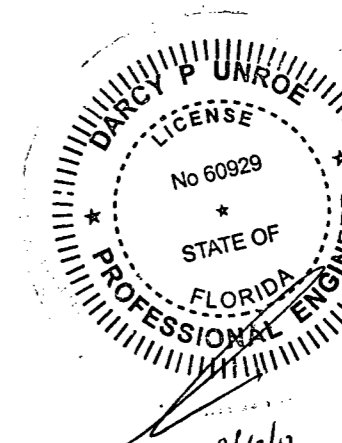

Darcy Unroe PE 60929

Rayan Used Tires - Facility Layout Plan

750 Central Florida Parkway, Orlando, Florida 32824

Unroe Engineering
Civil Engineering/Planning/Scientific Evaluations



PO Box 600942, Orlando, FL 32869 ◊ PH 407-229-0650 ◊ Fx 407-429-7639

Date: 08/14/12

Scale: 1"=20'

File: RUT-B

Drawing No.

B