



NORTHEAST DISTRICT
RECEIVED

2013 APR 11 PM 1:16

WASTE MANAGEMENT OF NORTH FLORIDA

Trail Ridge Landfill, Inc.
5110 U.S. Highway 301 South
Baldwin, FL 32234-3608
P: 904.289.9100 F: 904.289.9013

April 9, 2013

Emerson Raulerson
Northeast District FDEP
8800 Baymeadows Way West, Suite 100
Jacksonville, Florida 32256

Re: Trail Ridge Landfill
Methane Monitoring Results/2nd Qtr. 2013
FDEP Permit # 0013493-010-SC
I.D. #: NED/16/00033628

Dear Mr. Raulerson:

In accordance with Specific Condition #37 of the above referenced permit, enclosed please find the 2nd Quarter 2013 Gas Monitoring Data for Trail Ridge Landfill. As indicated on the report, there was negligible/no detection of methane gas at the site.

If you have any questions or need additional information regarding this submittal, please contact me at (904) 748-6006, or email at eparker1@wm.com.

Respectfully Submitted,

A handwritten signature in black ink, appearing to read 'Eric Parker'.

Eric Parker, CHMM
Environmental Program Manager
Florida Market Area

cc: Greg Mathes, Waste Management
Jim Christiansen, Waste Management
Craig Pelton, Waste Management
Brian Dolihite, Waste Management
Chris Pearson, City of Jacksonville
Jeff Foster, City of Jacksonville

Transmitted via email to Emerson.Raulerson@dep.state.fl.us

**TRAIL RIDGE LANDFILL
QUARTERLY LANDFILL GAS MONITORING AND ACTIVITIES REPORT
2nd QUARTER 2013**

SIGNIFICANT ACTIVITIES

- (1) Regular gas monitoring occurred on 04/04/2013 and is presented below. No gas was detected.

GAS MONITORING RESULTS

Date Monitored: April 04, 2013
Analyst: Barry Sperber
Instrument Type: GEM 2000; Serial No: GM08185

Calibration Acceptable: Yes; Span Gas 50% volume, response 49.8%
Water Level Instrument Type: Slope Indicator; Serial No. N/A
Weather Conditions; 69°F, Cloudy, Winds South West at 3 Mph
Barometric Pressure: 29.77" Hg

NORTH HAVEN DISTRICT
RECEIVED
2013 APR 11 PM 4:16

MON. POINT	TIME	PRESSURE (inches w.c.)	METHANE (% by Vol. air)	METHANE (% LEL)	LIQUID LEVEL (FT TOC)	COMMENTS
GP-06	0844	N/A	0	0	1.0'	
GP-07	0840	N/A	0	0	0.0'	
GP-08	0836	N/A	0	0	0.0'	
GP-09	0832	N/A	0	0	0.0'	
GP-10	0829	N/A	0	0	0.0'	
MM-01	0914	N/A	0	0	N/A	Scale House South
MM-02	0912	N/A	0	0	N/A	Scale House North
MM-03	0919	N/A	0	0	N/A	Admin. Building
MM-04	0905	N/A	0	0	N/A	1 st Floor Op's
MM-05	0903	N/A	0	0	N/A	2 nd Floor Op's

Comments: GP-are permanent probes; MM-are in structure locations

Gas Monitoring Probe, Typ.

ATTACHMENT 0

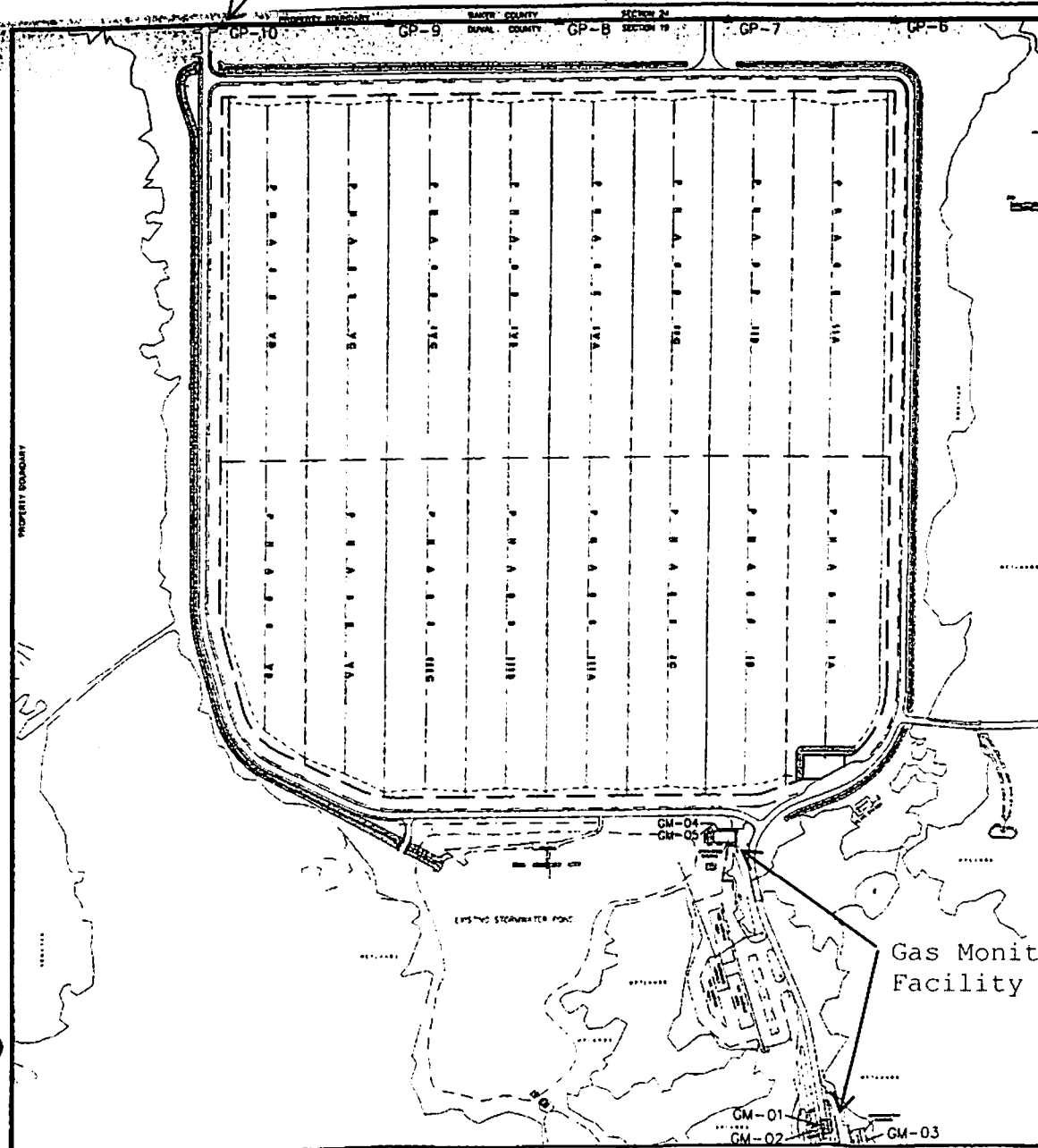

LEGEND

- ▲ GAS PROBE
- GP-10 GAS PROBE NUMBER
- GM-04 GAS MONITORING LOCATION

GAS PROBE PLAN TRAIL RIDGE LANDFILL PERMIT RENEWAL FOR TRAIL RIDGE LANDFILL, INC.	
PREPARED BY: J.E.C. CHECKED BY: J.E.C. DATE: 07/20/00	SCALE: 1" = 400'

England-Thompson & Miller, Inc.
 ENGINEERS - PLANNERS - ENVIRONMENTAL - LANDSCAPE ARCHITECTS
 10700 LANTANA DRIVE, SUITE 100
 FORT MYERS, FLORIDA 33907
 PHONE: (813) 941-1000 FAX: (813) 941-1001