

NOTICE OF PERMIT

SUMTER COUNTY WASTE TIRE SMALL PROCESSING FACILITY

PERMIT NO.: 126848-006-WT/06

**WACS Facility #SWD/60/53008
Sumter County**

CERTIFIED MAIL NO.: 7011 3500 0000 3205 0234

Mailed August 16, 2012

4320 502E 0000 005E TT02	U.S. Postal Service™	
	CERTIFIED MAIL™ RECEIPT	
	<i>(Domestic Mail Only; No Insurance Coverage Provided)</i>	
	For delivery information visit our website at www.usps.com ®	
	OFFICIAL USE	
	Postage	\$
Certified Fee		Postmark Here
Return Receipt Fee (Endorsement Required)		
Restricted Delivery Fee (Endorsement Required)		
Total Postage		
Sent To	Mr. Scott Cottrell	
Street, Apt. No., or PO Box No.	Sumter County BCC	
City, State, ZIP+	7375 Powell Road (CR 139)	
	Wildwood, FL 34785	
PS Form 3800, August 2006. See reverse for instructions.		

SENDER: COMPLETE THIS SECTION

- Complete items 1, 2, and 3. Also complete item 4 if Restricted Delivery is desired.
- Print your name and address on the reverse so that we can return the card to you.
- Attach this card to the back of the mailpiece, or on the front if space permits.

4. Article Addressed to:

Mr. Scott Cottrell
Sumter County BCC
7375 Powell Road (CR 139)
Wildwood, FL 34785

NO P # 126848-006-WT/26
Sumter Waste Tire SPF

COMPLETE THIS SECTION ON DELIVERY

A. Signature

X

[Signature]☐ Agent☐ Addressee

B. Received by (Printed Name)

SANDRA COLLINS

C. Date of Delivery

8/20/12

D. Is delivery address different from item 1?

☐ Yes

If YES, enter delivery address below:

☐ No

3. Service Type

☒ Certified Mail☐ Express Mail☐ Registered☒ Return Receipt for Merchandise☐ Insured Mail☐ C.O.D.

4. Restricted Delivery? (Extra Fee)

☐ Yes

2. Article Number.

(Transfer from service label)

7011 3500 0000 3205 0234

UNITED STATES POSTAL SERVICE



First-Class Mail
Postage & Fees Paid
USPS
Permit No. G-10

- Sender: Please print your name, address, and ZIP+4 in this box •

Florida Department of Environmental Protection
Southwest District
c/o Nancy Gaskin – Solid Waste
13051 North Telecom Parkway
Temple Terrace, FL 33637-0926

Dept. Of Environmental Protection
AUG 24 2012
Southwest District



Florida Department of Environmental Protection

Southwest District
13051 North Telecom Parkway
Temple Terrace, Florida 33637-0926
Telephone: 813-632-7600

Rick Scott
Governor

Jennifer Carroll
Lt. Governor

Herschel T. Vinyard Jr.
Secretary

August 16, 2012

CERTIFIED MAIL 7011 3500 0000 3205 0234
RETURN RECEIPT REQUESTED

NOTICE OF PERMIT

Sumter County
Board Of County Commissioners
7375 Powell Road
Wildwood, Florida 34785
c/o Mr. Scott Cottrell

Permit No: 126848-006-WT/06
County: Sumter
WACS ID: SWD-60-53008

Dear Mr. Cottrell:

Enclosed is **Operation Permit Number** 126848-006-WT/06, issued pursuant to Section(s) 403.087(1), Florida Statutes to continue operation of the Sumter County Waste Tire Small Processing Facility (WTPF), located at 835 CR 529, Sumterville, Sumter County, Florida.

The Department's proposed agency action shall become final unless a timely petition for an administrative hearing is filed under Sections 120.569 and 120.57, Florida Statutes (F.S.), before the deadline for filing a petition. The procedures for petitioning for a hearing are set forth below.

A person whose substantial interests are affected by the Department's proposed permitting decision may petition for an administrative proceeding (hearing) under Sections 120.569 and 120.57, F.S. The petition must contain the information set forth below and must be filed (received) in the Office of General Counsel of the Department at 3900 Commonwealth Boulevard, Mail Station 35, Tallahassee, Florida 32399-3000.

Petitions by the applicant or any of the parties listed below must be filed within 14 days of receipt of this written notice. Petitions filed by other persons must be filed within 14 days of publication of the notice or receipt of the written notice, whichever occurs first. Under Section 120.60(3), F.S., however, any person who asked the Department for notice of agency action may file a petition within fourteen days of receipt of such notice, regardless of the date of publication. The petitioner shall mail a copy of the petition to the applicant at the address indicated above at the time of filing. The failure of any person to file a petition within the appropriate time period shall constitute a waiver of that person's right to request an administrative determination (hearing) under Sections 120.569 and 120.57, F.S., or to intervene in

this proceeding and participate as a party to it. Any subsequent intervention (in a proceeding initiated by another party) will be only at the discretion of the presiding officer upon the filing of a motion in compliance with Rule 28-106.205, F.A.C.

A petition that disputes the material facts on which the Department's action is based must contain the following information:

- (a) The name and address of each agency affected and each agency's file or identification number, if known;
- (b) The name, address, and telephone number of the petitioner; the name, address, and telephone number of the petitioner's representative, if any, which shall be the address for service purposes during the course of the proceeding; and an explanation of how the petitioner's substantial interests will be affected by the agency determination;
- (c) A statement of when and how the petitioner received notice of the agency decision;
- (d) A statement of all disputed issues of material fact. If there are none, the petition must so indicate;
- (e) A concise statement of the ultimate facts alleged, including the specific facts the petitioner contends warrant reversal or modification of the agency's proposed action;
- (f) A statement of the specific rules or statutes the petitioner contends require reversal or modification of the agency's proposed action, including an explanation of how the alleged facts relate to the specific rules or statutes; and
- (g) A statement of the relief sought by the petitioner, stating precisely the action petitioner wishes the agency to take with respect to the agency's proposed action.

A petition that does not dispute the material facts on which the Department's action is based shall state that no such facts are in dispute and otherwise shall contain the same information as set forth above, as required by Rule 28-106.301, F.A.C.

Because the administrative hearing process is designed to formulate final agency action, the filing of a petition means that the Department's final action may be different from the position taken by it in this notice. Persons whose substantial interests will be affected by any such final decision of the Department have the right to petition to become a party to the proceeding, in accordance with the requirements set forth above. In accordance with Section 120.573, F.S., the Department advises that mediation is not available in this case under the provisions of that statute. This does not prevent any interested parties from agreeing to other forms of alternate dispute resolution.

PERMITTEE: Sumter County BOCC
c/o Mr. Scott Cottrell

PERMIT NO.: 126848-006-WT/06
Waste Tire Small Processing Facility

Any party to this order has the right to seek judicial review of it under Section 120.68, F.S., by filing a notice of appeal under Rule 9.110, Florida Rules of Appellate Procedure, with the clerk of the Department in the Office of General Counsel, Mail Station 35, 3900 Commonwealth Boulevard, Tallahassee, Florida 32399-3000, and by filing a copy of the notice of appeal accompanied by the applicable filing fees with the appropriate district court of appeal. The notice of appeal must be filed within thirty days after this order is filed with the clerk of the Department.

Executed in Hillsborough County, Florida.

STATE OF FLORIDA DEPARTMENT
OF ENVIRONMENTAL PROTECTION

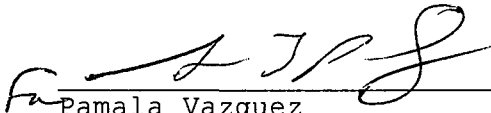
Pamala Vazquez
Acting District Director
Southwest District

PV/NDG

Attachment

Copies furnished to:

Sumter County Board of County Commissioners
Sumter County Notification List
Aimee Webb, Sumter County Development, Aimee.Webb@sumtercountyfl.gov David
Springstead, P.E., david@springsteadeng.net
Chris McGuire, OGC Tallahassee
Richard Tedder, P.E., FDEP Tallahassee
Frank Hornbrook, FDEP Tallahassee
Permit Notebook

CERTIFICATE OF SERVICE

This undersigned duly designated deputy clerk hereby certifies that this **NOTICE OF PERMIT** was mailed to the addressee, and either mailed or transmitted electronically to the listed persons before the close of business on August 16, 2012.
(date)

FILING AND ACKNOWLEDGMENT FILED,
on this date, pursuant to
Section 120.52(11), Florida
Statutes, with the designated
Department Clerk, receipt of which
is hereby acknowledged.

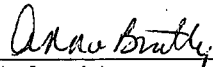
(Clerk)

8/16/12
(Date)



Florida Department of Environmental Protection

Southwest District
13051 North Telecom Parkway
Temple Terrace, Florida 33637-0926
Telephone: 813-632-7600

Rick Scott
Governor

Jennifer Carroll
Lt. Governor

Herschel T. Vinyard Jr.
Secretary

PERMITTEE

Sumter County
Board Of County Commissioners
7375 Powell Road
Wildwood, Florida 34785
c/o Mr. Scott Cottrell

PERMIT/CERTIFICATION

WACS Facility ID: SWD/60/53008
Permit No: 126848-006-WT/06
Date of Issue: **08/16/2012**
Expiration Date: **08/16/2017**
County: Sumter
Lat/Long: 28°44'30"
82°05'20"
Sec/Town/Rge: 15/20S/22E
Project: Sumter County Waste
Tire Small Processing Facility

This permit is issued under the provisions of Chapter 403, Florida Statutes, and Florida Administrative Code Rule(s) 62-4, 62-701, and 62-711. The above named permittee is hereby authorized to perform the work or operate the facility shown on the application and approved drawing(s), plans and other documents, attached hereto or on file with the Department and made a part hereof and specifically described as follows:

To construct, operate and close a waste tire small processing facility at the existing Sumter County Solid Waste Facility, subject to the specific and general conditions attached, located at 835 CR 539, Sumter County, Florida. The specific conditions attached are for the operation of:

1. Waste Tire Small Processing Facility

General Information: Only waste tires or tire scraps are accepted at this Waste Tire Small Processing Facility (WTPF). The WTPF includes an area for storage and a shed for a tire derimming machine. Tires are removed from the Center on a first in first out basis. No tires are stored for more than one year at the Center. The maximum tire storage is 350 tires.

Replaces Permit No.: 126848-005-WT

This permit contains compliance items summarized in Attachment 1 that shall be complied with and submitted to the Department by the dates noted. If the compliance dates are not met and submittals are not received by the Department on the dates noted, enforcement action may be initiated to assure compliance with the conditions of this permit.

PERMITTEE: Sumter County BOCC
c/o Mr. Scott Cottrell

PERMIT NO.: 126848-006-WT/06
Waste Tire Small Processing Facility

GENERAL CONDITIONS:

1. The terms, conditions, requirements, limitations and restrictions set forth in this permit, are "permit conditions" and are binding and enforceable pursuant to Sections 403.141, 403.161, 403.727, or 403.861, Florida Statutes. The permittee is placed on notice that the Department will review this permit periodically and may initiate enforcement action for any violation of these conditions.
2. This permit is valid only for the specific processes and operations applied for and indicated in the approved drawings or exhibits. Any unauthorized deviation from the approved drawings, exhibits, specifications, or conditions of this permit may constitute grounds for revocation and enforcement action by the Department.
3. As provided in subsections 403.087(6) and 403.722(5), F.S., the issuance of this permit does not convey any vested rights or any exclusive privileges. Neither does it authorize any injury to public or private property or any invasion of rights, nor any infringement of federal, State, or local laws or regulations. This permit is not a waiver of or approval of any other Department permit that may be required for other aspects of the total project which are not addressed in this permit.
4. This permit conveys no title to land or water, does not constitute State recognition or acknowledgment of title, and does not constitute authority for the use of submerged lands unless herein provided and the necessary title or leasehold interests have been obtained from the State. Only the Trustees of the Internal Improvement Trust Fund may express State opinion as to title.
5. This permit does not relieve the permittee from liability for harm or injury to human health or welfare, animal, or plant life, or property caused by the construction or operation of this permitted source, or from penalties therefore; nor does it allow the permittee to cause pollution in contravention of Florida Statutes and Department rules, unless specifically authorized by an order from the Department.
6. The permittee shall properly operate and maintain the facility and systems of treatment and control (and related appurtenances) that are installed and used by the permittee to achieve compliance with the conditions of this permit, are required by Department rules. This provision includes the operation of backup or auxiliary facilities or similar systems when necessary to achieve compliance with the conditions of the permit and when required by Department rules.

GENERAL CONDITIONS:

7. The permittee, by accepting this permit, specifically agrees to allow authorized Department personnel, upon presentation of credentials or other documents as may be required by law and at reasonable times, access to the premises where the permitted activity is located or conducted to:

- (a) Have access to and copy any records that must be kept under conditions of the permit;
- (b) Inspect the facility, equipment, practices, or operations regulated or required under this permit; and
- (c) Sample or monitor any substances or parameters at any location reasonably necessary to assure compliance with this permit or Department rules.

Reasonable time may depend on the nature of the concern being investigated.

8. If, for any reason, the permittee does not comply with or will be unable to comply with any condition or limitation specified in this permit, the permittee shall immediately provide the Department with the following information:

- (a) A description of and cause of noncompliance; and
- (b) The period of noncompliance, including dates and times; or, if not corrected, the anticipated time the noncompliance is expected to continue, and steps being taken to reduce, eliminate, and prevent recurrence of the noncompliance.

The permittee shall be responsible for any and all damages which may result and may be subject to enforcement action by the Department for penalties or for revocation of this permit.

9. In accepting this permit, the permittee understands and agrees that all records, notes, monitoring data and other information relating to the construction or operation of this permitted source which are submitted to the Department may be used by the Department as evidence in any enforcement case involving the permitted source arising under the Florida Statutes or Department rules, except where such use is prescribed by Sections 403.111 and 403.73, F.S. Such evidence shall only be used to the extent it is consistent with the Florida Rules of Civil Procedure and appropriate evidentiary rules.

10. The permittee agrees to comply with changes in Department rules and Florida Statutes after a reasonable time for compliance; provided, however, the permittee does not waive any other rights granted by Florida Statutes or Department rules.

11. This permit is transferable only upon Department approval in accordance with Rule 62-4.120 and 62-730.300, Florida Administrative Code, as applicable. The permittee shall be liable for any non-compliance of the permitted activity until the transfer is approved by the Department.

GENERAL CONDITIONS:

12. This permit or a copy thereof shall be kept at the work site of the permitted activity.

13. This permit also constitutes:

- (a) Determination of Best Available Control Technology (BACT)
- (b) Determination of Prevention of Significant Deterioration (PSD)
- (c) Certification of compliance with State Water Quality Standards (Section 401, PL 92-500)
- (d) Compliance with New Source Performance Standards

14. The permittee shall comply with the following:

- (a) Upon request, the permittee shall furnish all records and plans required under Department rules. During enforcement actions, the retention period for all records will be extended automatically unless otherwise stipulated by the Department.
- (b) The permittee shall hold at the facility or other location designated by this permit records of all monitoring information (including all calibration and maintenance records and all original strip chart recordings for continuous monitoring instrumentation) required by the permit, copies of all reports required by this permit, and records of all data used to complete the application for this permit. These materials shall be retained at least three years from the date of the sample, measurement, report, or application unless otherwise specified by Department rule.
- (c) Records of monitoring information shall include:
 - 1. the date, exact place, and time of sampling or measurements;
 - 2. the person responsible for performing the sampling or measurements;
 - 3. the dates analyses were performed;
 - 4. the person responsible for performing the analyses;
 - 5. the analytical techniques or methods used;
 - 6. the results of such analyses.

15. When requested by the Department, the permittee shall within a reasonable time furnish any information required by law which is needed to determine compliance with the permit. If the permittee becomes aware the relevant facts were not submitted or were incorrect in the permit application or in any report to the Department, such facts or information shall be corrected promptly.

SPECIFIC CONDITIONS: PART A -SOLID WASTE FACILITY GENERAL REQUIREMENTS

1. **Facility Designation.** This site shall be classified as a waste tire processing facility and shall be operated, maintained and closed in accordance with all applicable requirements of Chapters 62-4, 62-711, and 62-701, Florida Administrative Code (F.A.C.). This facility is limited to the acceptance of whole waste tires only. Other wastes shall not be accepted at this facility.

2. **Permit Application Documentation.** This permit is valid for operation of the waste tire small processing facility in accordance with all applicable requirements of Department rules and the reports, plans and other information prepared by Springstead Engineering, (unless otherwise noted) as follows:

a. Document entitled, Waste Tire Small Processing Facility Permit Application, dated April 30, 2012 (received May 22, 2012). This information includes, but is not limited to:

- 1) Operational Plan
- 2) Emergency Preparedness Manual

b. Drawings entitled, Construction Plans Sumter County Citizen Drop-Off Area..., 12 Sheets, prepared by Bower Singleton, received August 10, 2012.

c. Drawings entitled, A New 12' X 12' Tire De-Rimmer Shed for: Sumter County Citizen Drop-Off Area, 8 Sheets, prepared by Architecture Studio Inc., received August 10, 2012.

3. **Permit Modifications.** Any construction or operation not previously approved as part of this permit shall require a separate Department permit unless the Department determines a permit modification to be more appropriate, or unless otherwise approved in writing by the Department. Permits shall be modified in accordance with the requirements of Rule 62-4.080, F.A.C. A modification which is reasonably expected to lead to substantially different environmental impacts, which require a detailed review by the Department, is considered a substantial modification.

4. **Permit Renewal.** In order to ensure uninterrupted operation of this facility, a timely and sufficient permit renewal application must be submitted to the Department in accordance with Rule 62-701.320(10), F.A.C. A permit application submitted at least **61 days** prior to the expiration of this permit is considered timely and sufficient.

5. **Professional Certification.** Where required by Chapter 471 (P.E.) or Chapter 492 (P.G.), Florida Statutes, applicable portions of permit applications and supporting documents, which are submitted to the Department for public record, shall be signed and sealed by the professional(s) who prepared or approved them.

SPECIFIC CONDITIONS: PART A -SOLID WASTE FACILITY GENERAL REQUIREMENTS

6. **General Conditions.** The permittee shall be aware of and operate under the "General Conditions". General Conditions are binding upon the permittee and enforceable pursuant to Chapter 403, Florida Statutes.

7. **Permit Acceptance.** By acceptance of this Permit, the Permittee certifies that he/she has read and understands the obligations imposed by the Specific and General Conditions contained herein and also including date of permit expiration and renewal deadlines. It is a violation of this permit for failure to comply with all conditions and deadlines.

8. **Regulations.** Chapters 62-701, and 62-711, F.A.C., are incorporated into this permit by reference. In the event that the regulations governing this permitted operation are revised, the Department shall notify the permittee, and the permittee shall request modification of those specific conditions, which are affected by the revision of regulations to incorporate those revisions.

9. **Prohibitions.** The prohibitions of Rule 62-711.400, F.A.C., shall not be violated by activities at this site.

a. Waste Burning. Open burning of solid waste is prohibited except in accordance with Rule 62-701.300(3) and Chapter 62-256, F.A.C. All fires which require longer than one (1) hour to extinguish must be promptly reported to the Department and in accordance with Specific Condition #C.6., below.

SPECIFIC CONDITIONS: PART B - CONSTRUCTION REQUIREMENTS

1. **Construction.** All construction activities shall be approved by the Department prior to initiating work, unless specifically authorized otherwise.

2. **Certification of Construction Completion.** All information required by this Specific Condition shall be signed and sealed by a registered professional engineer or land surveyor as appropriate. At the completion of construction, information listed below shall be provided to the Department as part of the Certification of Construction Completion.

a. **Within sixty (60) days** after any specified construction has been completed or as otherwise specified in this permit, the following activities shall be completed and submitted by the permittee to the Department. Operation of the constructed systems, structures, equipment, etc., shall not be initiated prior to Department approval of the information required by this Specific Condition.

1) The owner or operator shall submit a Certification of Construction Completion, Form 62-701.900(2), signed and sealed by the professional engineer responsible for the construction to the Department for approval, and shall arrange for Department representatives to inspect the construction in the company of the permittee, the engineer, and the facility operator.

2) The owner or operator shall submit Record Drawings/Documents showing all changes (i.e. all additions, deletions, revisions to the plans previously approved by the Department). The Record Documents shall include as-built plans details and elevations (survey) as appropriate.

3) The owner or operator shall submit a narrative indicating all changes in plans and the cause of the deviations, and certification by the design engineer to the Department.

SPECIFIC CONDITIONS: PART C - OPERATION REQUIREMENTS

1. Facility Operation Requirements.

a. The permittee shall operate this facility in accordance with Rule 62-711.530, F.A.C., the facility's Operational Plan [ref. SC#A.2.a.(1)], and any other applicable requirements.

b. Incoming loads shall be unloaded at the waste tire small processing facility, in the Citizen Drop-Off Area. Tires will be unloaded in a paved area with a push wall along one side and a 3-sided shed which contains a tire de-rimming machine [SC#A.2.b. Sheet 8 of 11].

c. In the event of a fire, additional waste shall not be accepted in the area affected by the fire until the fire is completely extinguished, and the Department shall be notified in accordance with Specific Condition C.6.c.

d. Waste streams generated by the operation or maintenance of the facility and equipment shall be managed such that any residual contaminants (such as gasoline, oil, paint, antifreeze, PCBs, etc.) shall be stored such that the residues or constituents thereof are not spilled, leaked, dumped, or otherwise discharged onto the ground or into surface or groundwaters.

2. Operating Personnel. A trained supervisor or foreman shall be responsible for operating and maintaining the facility in an orderly, safe, and sanitary manner. An attendant shall be present at all times when the facility is open to the public and tires are being received. Sufficient personnel shall be employed to adequately operate the facility.

3. Control of Access. Access to, and use of, the facility is controlled by the use of fencing. Public access shall occur only when the scale house attendant is on duty.

4. Monitoring of Waste. The permittee shall not knowingly accept hazardous waste or any hazardous substance at this site. Hazardous waste is a waste in Chapter 62-730, F.A.C. Hazardous substances are those defined in Section 403.703, Florida Statute or in any other applicable state or federal law or administrative rule.

5. Control of Nuisance Conditions. The owner or operator shall control vectors so as to protect the public health and welfare. The operating authority shall be responsible for the control of odors and fugitive particulates arising from the operation. Such control shall minimize the creation of nuisance conditions on adjoining property. Complaints received from the general public, and confirmed by Department personnel upon site inspection, shall constitute a nuisance condition, and the permittee must take immediate corrective action to abate the nuisance.

SPECIFIC CONDITIONS: PART C - OPERATION REQUIREMENTS

6. Facility Maintenance and Repair.

a. The site shall be properly maintained. In the event of damage to any portion of the waste tire processing site facilities, equipment, storage areas, or buildings, failure of any portion of the associated systems, fire, explosion, or the development of sinkhole(s) at the site, the permittee shall **immediately (within 24 hours)** notify the Department explaining such occurrence, method to prevent reoccurrence, remedial measures to be taken and time needed for repairs. Written detailed notification shall be submitted to the Department **within seven (7) days** following the occurrence.

b. The permittee shall ensure that the paved area, which stores the waste tires, is kept free of grass, underbrush, and other potentially flammable vegetation at all times.

c. In the event of a tire fire, impacted soils and/or liquids shall be contained, and shall be characterized prior to disposal at an appropriately permitted disposal facility. The results of this characterization shall be provided to the Department with the written notification required by Specific Condition #C.6.a. above, prior to disposal of the material.

7. Stormwater Management. The site shall have a surface water management system operated and maintained to prevent surface water flow on to unloading, loading and storage areas, and a stormwater runoff control system operated and maintained to collect and control stormwater to meet the requirements of Florida Administrative Code Rule 62-330, any other applicable Department rules, and the requirements of the respective water management district.

8. Material Management and Storage. All waste tires shall be stored in accordance with Rule 62-711.540, F.A.C., and the operations plan.

a. On site storage at the WTPF is limited to 350 tires.

b. If the facility has reached its permitted storage capacity, the permittee shall not accept additional waste tires until sufficient capacity has been restored.

c. At least once per year, all waste tires and processed tires that are delivered to or are contained at the waste tire site shall be removed for disposal or recycling from the facility during the year, or disposed of at a permitted solid waste management facility.

SPECIFIC CONDITIONS: PART C - OPERATION REQUIREMENTS

(Specific Condition #C.8. cont'd)

- d. Only waste tires and residuals from waste tire derimming operation shall be stored at the WTPF. The scrap rims shall be stored in a container and sent offsite when full, for recycling.
9. **Fire Safety.**
- a. A fire safety inspection shall be conducted at least **annually**. The fire safety inspection report shall be maintained at the facility for five years and copies shall be provided to the Department upon request.
 - b. In the event that deficiencies are noted in the annual fire safety inspection report, **within 30 days** of completion, the permittee shall provide documentation to the Department indicating correction of any deficiencies noted. The documentation shall include approval of the corrections by the local fire authority.

SPECIFIC CONDITIONS: PART D - RECORDKEEPING

1. **Report Submittals.** Unless otherwise specified, all submittals, notifications, requests for permit modification, reports for compliance with this permit, etc. shall be sent to: Solid Waste Section, Department of Environmental Protection, Southwest District Office, 13051 North Telecom Parkway, Temple Terrace, Florida 33637-0926.
2. **Operation Plan and Operating Record.**
 - a. A copy of the Department approved permit, operational plan, construction reports and record drawings, and supporting information shall be kept at the facility at all times for reference and inspection.
 - b. Proposed changes to the current Department approved Operational Plan shall be submitted in writing to the Department for review and may require a permit modification in accordance with Specific Condition #A.3. The Operational Plan shall be updated as operations change and for renewal of the permit. Revised pages shall be provided as replacement pages with revisions noted (deletions may be struckthrough [~~struckthrough~~] and additions may be underlined [underlined] or a similar method may be used) and each page numbered with the document title and date of revision.
3. **Waste Records.**
 - a. Operational records shall be recorded and maintained for a minimum of **three years** and be available for inspection by Department personnel during normal business hours.
 - b. The owner or operator of the waste tire collection facility shall record on Department Form 62-711.900(22), F.A.C., the amount of waste tires collected, where or from whom the waste tires were collected and the quantity, and where the waste tires were deposited and the quantity. This report shall be submitted to the Department **annually** by March 1 to: Solid Waste Section, Department of Environmental Protection, 2600 Blair Stone Road, MS #4565, Tallahassee, Florida 32399-2400.
 - c. The following reports, documents and other information shall be kept at the facility for reference, and copies shall be provided to the Department upon request:
 - 1) A log of the facility operator's inspections, and any subsequent corrective actions; and
 - 2) A copy of the facility's Emergency Preparedness Manual shall be kept at the site.

SPECIFIC CONDITIONS: PART D - RECORDKEEPING

4. **Financial Assurance.** The permittee shall provide adequate financial assurance for the facility in accordance with Rule 62-711.500(3), F.A.C. All costs for closure and proof that the financial mechanism has been funded adequately shall be submitted **annually** shall be submitted in accordance with **Permit Number 126941-007-SO/08**, or its successors.

PART E - WATER QUALITY MONITORING REQUIREMENTS

(THERE ARE NO WATER QUALITY MONITORING REQUIREMENTS FOR THIS FACILITY)

PART F - LANDFILL GAS MANGEMENT

(THERE ARE NO LANDFILL GAS MANAGEMENT REQUIREMENTS FOR THIS FACILITY)

PART G - CLOSURE AND LONG TERM CARE REQUIREMENTS

1. **Closure Requirements.** The facility shall be closed in accordance with the requirements of Rule 62-711.700, F.A.C. The waste tire facility owner or operator shall notify the Department at least **ninety (90) days prior** to the date when tires will no longer be accepted for storage, as required by Rule 62-711.700(2), F.A.C.

Executed in Hillsborough County, Florida.

STATE OF FLORIDA DEPARTMENT
OF ENVIRONMENTAL PROTECTION

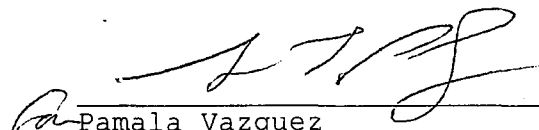
Pamala Vazquez
Acting District Director
Southwest District

PERMITTEE: Sumter County BOCC
c/o Mr. Scott Cottrell

PERMIT NO.: 126848-006-WT/06
Waste Tire Small Processing Facility

ATTACHMENT 1

SPECIFIC CONDITION	SUBMITTAL DUE DATE	REQUIRED ITEM
A.4	By June 15, 2017	Submit application for permit renewal
D.3.b.	Annually, by March 1 st each year	Submit waste tire report
D.4	Annually	Submit revised cost estimates and proof of funding
G.1	Within 90 days prior to ceasing operations	Notification of Closure

Memorandum

Florida Department of Environmental Protection

PERMIT COVER MEMO

TO: x Pam Vazquez, Acting District Director

FROM/THROUGH:

Susan Pelz, P.E. 8/15/12
Steve Morgan
Nancy Gaskin 8/5

WASTE PROGRAM ADMINISTRATOR
SOLID WASTE SECTION 8/5/12
SOLID WASTE SECTION

DATE: August 15, 2012

FILE NAME: Sumter County Waste Tire Small Processing Facility

PERMIT #:126848-006-WT/06
COUNTY: Sumter

PROGRAM: Solid Waste

TYPE OF PERMIT ACTION: ISSUE FINAL PERMIT
PUBLIC NOTICE PERIOD CLOSED: NA

PERMIT SUMMARY: This is an application for the continued operation of an existing County Waste Tire Small Processing Facility.

PROFESSIONAL RECOMMENDATION: X APPROVE DENY

EVALUATION SUMMARY: The applicant has provided sufficient information to demonstrate compliance with Department Rules.

To 08/15/12: TIH=85 TTP=85		TTP
Application received	05/22/12	
Application complete	05/22/12	
PERMIT permit for routing	08/15/12	85

DAY 90 FOR THIS ACTION IS: ASAP: D90=08/19/2012

Brantley, Anna

From: Brantley, Anna
Sent: Thursday, August 16, 2012 7:39 AM
To: 'david@springsteadeng.net'; McGuire, Chris; Tedder, Richard; Solid Waste Financial Coordinator; Commissioner Dick Hoffman; Commissioner Doug Gilpin; Commissioner Garry Breeden; Commissioner Randy Mask; County Administrator Arnold Bradley; Planning & Zoning - Aimee Webb; Planning & Zoning - Brad Cornelius; Representative Marlene O'Toole; Representative Robert Schenck; Senator Paula Dockery
Cc: Gaskin, Nancy
Subject: Notice of Permit for Sumter County Waste Tire Small Processing Facility [WACS 53008]
Attachments: NOP_Sumter County WTPF.126848-006-WT-06. [WACS 53008] (08-16-2012).pdf

Attached please find Notice of Permit and Final Permit for the subject Solid Waste Facility. These are the only copies you will receive. Hard copy was mailed to addressee only.

NOTE: If you have questions concerning the content of these documents, please contact the DEP permit processor nancy.gaskin@dep.state.fl.us.

Acrobat Reader 6.0 or greater is required to read these documents. It is available for downloading at: <http://www.adobe.com/products/acrobat/readstep.html>

Anna

Anna Brantley
Administrative Assistant II
FL DEP / SWD / Waste Management
13051 North Telecom Parkway
Temple Terrace FL 33637-0629
Tel: 813/632-7600, Ext. 377
Fax: 813/632-7664
anna.brantley@dep.state.fl.us

The Department of Environmental Protection values your feedback as a customer. DEP Secretary Hershel T. Vinyard Jr. is committed to continuously assessing and improving the level and quality of services provided to you. Please take a few minutes to comment on the quality of service you received. Simply click on [this link to the DEP Customer Survey](#). Thank you in advance for completing the survey.

Brantley, Anna

From: Microsoft Exchange
To: Commissioner Dick Hoffman; Commissioner Doug Gilpin; Commissioner Garry Breeden;
Commissioner Randy Mask; County Administrator Arnold Bradley; Planning & Zoning - Aimee Webb;
Planning & Zoning - Brad Cornelius
Sent: Thursday, August 16, 2012 7:39 AM
Subject: Relayed: Notice of Permit for Sumter County Waste Tire Small Processing Facility [WACS 53008]

Delivery to these recipients or distribution lists is complete, but delivery notification was not sent by the destination:

Commissioner Dick Hoffman

Commissioner Doug Gilpin

Commissioner Garry Breeden

Commissioner Randy Mask

County Administrator Arnold Bradley

Planning & Zoning - Aimee Webb

Planning & Zoning - Brad Cornelius

Subject: Notice of Permit for Sumter County Waste Tire Small Processing Facility [WACS 53008]

Sent by Microsoft Exchange Server 2007

Brantley, Anna

From: Microsoft Exchange
To: Representative Marlene O'Toole; Representative Robert Schenck
Sent: Thursday, August 16, 2012 7:39 AM
Subject: Relayed: Notice of Permit for Sumter County Waste Tire Small Processing Facility [WACS 53008]

Delivery to these recipients or distribution lists is complete, but delivery notification was not sent by the destination:

Representative Marlene O'Toole

Representative Robert Schenck

Subject: Notice of Permit for Sumter County Waste Tire Small Processing Facility [WACS 53008]

Sent by Microsoft Exchange Server 2007

Brantley, Anna

From: Microsoft Exchange
To: 'david@springsteadeng.net'
Sent: Thursday, August 16, 2012 7:39 AM
Subject: Relayed: Notice of Permit for Sumter County Waste Tire Small Processing Facility [WACS 53008]

Delivery to these recipients or distribution lists is complete, but delivery notification was not sent by the destination:

'david@springsteadeng.net'

Subject: Notice of Permit for Sumter County Waste Tire Small Processing Facility [WACS 53008]

Sent by Microsoft Exchange Server 2007

Brantley, Anna

From: Microsoft Exchange
To: Gaskin, Nancy; McGuire, Chris
Sent: Thursday, August 16, 2012 7:39 AM
Subject: Delivered: Notice of Permit for Sumter County Waste Tire Small Processing Facility [WACS 53008]

Your message has been delivered to the following recipients:

Gaskin, Nancy

McGuire, Chris

Subject: Notice of Permit for Sumter County Waste Tire Small Processing Facility [WACS 53008]

Sent by Microsoft Exchange Server 2007

Brantley, Anna

From: Microsoft Exchange
To: Tedder, Richard; Solid Waste Financial Coordinator
Sent: Thursday, August 16, 2012 7:39 AM
Subject: Delivered: Notice of Permit for Sumter County Waste Tire Small Processing Facility [WACS 53008]

Your message has been delivered to the following recipients:

Tedder, Richard

Solid Waste Financial Coordinator

Subject: Notice of Permit for Sumter County Waste Tire Small Processing Facility [WACS 53008]

Sent by Microsoft Exchange Server 2007



Department of Environmental Protection

Bob Martinez Center
2600 Blair Stone Road
Tallahassee, Florida 32399-2400

DEP Form #: 62-701.900(24)
Form Title: Waste Tire Small Processing Facility Permit Application
Effective Date: January 6, 2010
DEP Application No. _____ (Completed by DEP)

WASTE TIRE SMALL PROCESSING FACILITY PERMIT APPLICATION

A Small Waste Tire Processing Facility Permit allows up to 1,500 waste tires to be stored at the facility at any one time and allows up to 1,500 waste tires to be processed during any 30 day period. If these quantities are exceeded, a Waste Tire Processing Facility Permit is required.

Permit No. 126848-003-WT

Renewal ☐ Modification ☐ Existing unpermitted facility ☐ Proposed new facility ☒

Part I-General Information:

A. Applicant Information:

1. Applicant Name: Sumter County Board of County Commissioners
2. Applicant Street Address: 7375 Powell Road
3. City: Wildwood County: Sumter Zip: 34785
4. Applicant Mailing Address: Same as above
5. City: _____ County: _____ Zip: _____
6. Contact person: Scott B. Cottrell, P.E. Phone: (352) 569-6700 FEID No: _____
7. Have any enforcement actions been taken by the Department against the applicant relating to the operation of any solid waste management facility in this state? This includes any Complaint, Notice of Violation, or revocation of a permit or registration, as well as any Consent Order in which a violation of Department rules is admitted. It does not include a Warning Letter, Warning Notice, Notice of Noncompliance, or other similar document which does not constitute agency action.
Yes ☒ No ☐ If yes, attach a history and description of the enforcement actions.

B. Facility Information:

1. Facility Name: Sumter County Citizen's Drop-off Facility
2. Facility Street Address (Main Entrance): 835 CR 529
3. City: Sumterville County: Sumter Zip: 33585
4. Facility Mailing Address: Same as above
5. City: _____ State: _____ Zip: _____
6. Contact Person: Jimmy Wise Phone: (352) 569-1975

Facility Location Coordinates:

7. Section: 15/22 Township: 20 Range: 22
8. Latitude: 28-44-30 Longitude: 82-05-20
9. Anticipated date for starting construction 3/31/12 and for completion of construction 10/30/12
10. Anticipated date for receipt of tires currently receiving and for start of processing _____

Mail completed form to
the appropriate District office
listed below

Northwest District
160 Government Center
Pensacola, FL 32501-5794
850-595-8360

Northeast District
7825 Baymeadows Way, Ste. 200 B
Jacksonville, FL 32256-7590
904-807-3300

Central District
3319 Maguire Blvd., Ste. 232
Orlando, FL 32803-3767
407-894-7555

Southwest District
13051 N. Telecom Pkwy
Temple Terrace, FL
813-632-7600

South District
2295 Victoria Ave., Ste. 364
Fort Myers, FL 33902-2549
239-332-6975

Southeast District
400 North Congress Ave.
West Palm Beach, FL 33401
561-681-6600

C. Land Owner Information (if different from applicant):

1. Owner's name: Same as applicant
2. Land owner's mailing address: _____
3. City: _____ State: _____ Zip: _____
4. Authorized Agent: _____ Agent's phone () _____
5. Current lease expires: _____

D. Facility Operator Information (if different from applicant):

1. Operator's name: Same as applicant
2. Operator's mailing address: _____
3. City: _____ State: _____ Zip: _____
4. Contact person: _____ Phone: () _____

E. Preparer of Application:

1. Name of person preparing application: David W. Springstead, P.E., Springstead Engineering, Inc.
2. Mailing address: 727 South 14th Street
3. City: Leesburg State: Florida Zip: 34748
4. Phone: (352) 787-1414
5. Affiliation with facility: Engineer

Part II Operations:

- A.** Describe the process and products and how storage will be maintained in compliance with 62 -711.540, F.A.C.:
Operator accepts used and scrap tires from public. Disposers are directed to take used tires to the recycling area of the citizen's drop-off
area where the tires are unloaded, derimmed and stored on an asphalt surface. The tires are then loaded into a trailer for hauling to a
recycler. Upon accumulation of a full load of tires, the waste tires are hauled to the recycler.
- B.** Describe the equipment (other than the hand held equipment) used for processing waste tires. Thi s description shall include the make, model, and hourly capacity of each piece of equipment:
The tire derimmer is an electric home-made derimmer capable of derimming 12 tires per hour. Anticipated maximum is 50 times per day.

- C.** Describe the waste from the process, the amount of waste expected from 1,500 tires, and how and where it will be disposed of:
The steel rims are the waste generated by the process. The rims are placed in the metal recycling containers. All other scrap waste is
placed in the tire scraps.

Part III Attachments:

Please attach the following information to this application:

- A. A plot plan of the small processing facility showing:
1. Boundaries of the area being permitted, easements, and rights of way **See site plan.**
 2. All wetlands and water bodies in or within 200 feet of this area. **Not applicable.**
 3. The storage areas for whole tires, processed tires and processing waste. **See revised citizen's drop-off area plan.**
 4. The processing area. **See site plan.**
 5. All structures including buildings, fences, roadways, stormwater control devices, and water wells. **See site plan.**
- B. A copy of a fire safety survey of the small processing facility. **Provided upon completion of construction.**
- C. A copy of the emergency preparedness manual. **See attached operation manual.**
- D. A letter from the landowner (if different from applicant) authorizing use of the land as a small waste tire processing facility. **Not applicable.**
- E. A check for the application fee. **See attached.**

Note: the record keeping requirements of 62-711.530(4) apply to small processing facilities. Quarterly reports to the Department are required by 62-711.530(5), F.A.C.

Part IV Certification:

To the best of my knowledge and belief, I certify the information provided in this application is true, accurate, and correct. I have attached all documents and/or authorizations that are required.

Scott B. Cottrell, P.E.

Print Name of Authorized Agent

Signature of Authorized Agent

Date

**Operational Plan for Handling Waste Tires
Sumter County Recycling, Processing and Composting Facility.**

General

An attendant is on duty during all operating hours at the entrance to the facility. The Senior Equipment Operator (SEO) is also on duty at the facility during all hours of operation. Personnel are on duty during operating hours to help with unloading operations and inspect the delivered materials.

The entire facility is surrounded by fencing, with entry being controlled by locking gates.

A sign indicating the name of the facility and operator is located at the entrance on CR 470. Instructional signs pertaining to traffic flow are placed around the facility. Signs specifying rates and acceptable wastes are placed to inform patrons approaching the scale. Signs are posted directing traffic after tipping material to exit the facility. Signs are posted indicating the hours of daily operation, that the facility is closed on Sundays, Mondays and/or holidays, and that hazardous materials are not accepted.

All material enters the facility on CR 529. This is a paved all-weather road which leads from CR 470 to the CDA drop off area.

Patrons are directed to the waste tire disposal area. Assistance is provided for unloading. This assistance is to insure proper placement and to inspect the material so that non-acceptable materials are not left at the facility.

Operation Plan

When a visitor who has a waste tire(s) is identified, the visitor is directed to the waste tire storage area. Waste tires are unloaded at this point. Whole and partial tires are accepted at the facility.

The tires storage and processing area is located east of the community drop-off area. The processing area consists of a bunkered a 40' x 40' asphalt area containing a tire derimming area, a bunkered temporary tire storage area, the tire disposal area.

Tires are unloaded in front of the tire derimming area. If needed, the tires are derimmed and placed in the tire storage by facility personnel. If the manpower and equipment is not immediately available to load tires in the trailer, the tires are placed in the tire storage area until loaded.

Approximately 500 tires are stored in the storage area at capacity. When the storage area reaches capacity, the tires are transported to an approved disposal facility such as Global Tire Recycling or Waste Services.

**Operational Plan for Handling Waste Tires
Sumter County Recycling, Processing and Composting Facility.**

Approximately 250 tires per month are accepted at the facility. A full load of tires are removed from the facility every 2 to 4 weeks.

Fire protection services for the site are provided by the Sumter County Fire/Rescue Department located approximately 3 miles from the site.

Additional information relative to the Facility:

The waste tires are not located within 200 feet of any water body or wetland.

The waste tire storage area is located on an impervious surface sloped to direct stormwater away from the tire pile toward stormwater retention area.

An unobstructed 50-foot wide clear area shall be maintained around the waste tire storage pile for fire protection and fire fighting.

Mosquitoes and rodents are controlled.

No operation involving an open flame will be conducted within 25 feet of the waste tire storage pile.

The Emergency Preparedness Manual is attached.

**EMERGENCY PREPAREDNESS MANUAL
OPERATIONAL PLAN FOR HANDLING WASTE TIRES
SUMTER COUNTY RECYCLING, PROCESSING AND COMPOSTING FACILITY**

Persons to contact in case of fire, flood or other emergency:

First Contact:

Mr. Jimmy Wise
Senior Equipment Operator (SEO)
(352) 569-1975
Cell (352) 254-1442

Second Contact:

Mr. Jackey Jackson
Asst. Director of Operations (ADO)
(352) 569-6711
Cell (352) 303-8543

In Case of Fire:

Sumter County Fire Rescue
911

In no response to any of the above contacts:

Sumter County Sheriff's Office
911

Emergency Response Equipment and Procedures in case of fire or emergency:

Fire extinguishers are located around the facility. These should be used to extinguish small isolated fires.

For large fires, emergency response equipment includes the payloaders and trucks. The area of the fire should be isolated by removing any combustible materials not ignited in the immediate vicinity of the fire. These materials should be dragged away with the bucket of the payloaders.

FDEP should be immediately notified (813-632-7600) of a fire or emergency at the facility. A full written report describing origins, actions, and an evaluation of the success or failure of the actions concerning the emergency shall be delivered to the Department within 2 weeks of the emergency.

MATCH LINE

SITE DATA

PROJECT SITE AREA	308 ACRES
TOTAL PERMITTED AREA	4536 ACRES
EXISTING ZONING	RS
PROJECT SITE IMPERVIOUS AREA	187 ACRES (64%)
PROJECT SITE PERVIOUS AREA	121 ACRES (36%)
TOTAL PERMITTED IMPERVIOUS AREA	8400 ACRES (53%)
TOTAL PERVIOUS AREA	8136 ACRES (47%)
EXISTING LAND USE	FLUCCS 8300 UTILITIES
PROPOSED LAND USE	FLUCCS 8300 UTILITIES

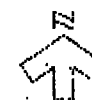

MATCH LINE

(BY OTHERS)

PROP. CITY
RETENTION
POND (10)

IMPROVEMENTS
BY OTHERS

TIRE DERIMMER

TABLE OF MATERIALS STORAGE		
MATERIAL	CONTAINER(S)	TOTAL VOLUME
SOUP	12 6" x 10" x 6"	31.2 CT
PECKA	12 6" x 10" x 6"	31.2 CT
PECKA	12 6" x 10" x 6"	31.2 CT
SOUP (WAL)	12 6" x 10" x 6"	31.2 CT
HOUSEHOLD WASH	12 6" x 10" x 6"	31.2 CT
WASH	12 6" x 10" x 6"	31.2 CT
WASH	12 6" x 10" x 6"	31.2 CT

LEGEND

- PROPOSED PAVEMENT
- EXIST. PAVEMENT TO BE REMOVED
- LIMITS OF PROJECT

SEE PLAN FOR
OPERATOR TO CONDUCT
OPERATE OR MODIFY A WASTE
PROCESSING FACILITY
AND
APPLICATION FOR A WASTE WTE
COLLECTION COVER
DISCLOSURE

Springstead Engineering, Inc.
Consulting Engineers
Planners
Surveyors
Geologists
10-000700
787 South 14th Street
Tomball, TX 77468
(832) 797-6614



BOWYER
SINGLETON

FLORIDA
SUNSHINE COUNTY

OVERALL SITE PLAN

SUNSHINE COUNTY GAZETTE OFFICIAL MAPS
SUNSHINE COUNTY GAZETTE OFFICIAL MAPS
SUNSHINE COUNTY GAZETTE OFFICIAL MAPS

SUNSHINE COUNTY



Map of Sunshine County
to all other maps
10-000700

SEE PLAN
11/10/2023 100

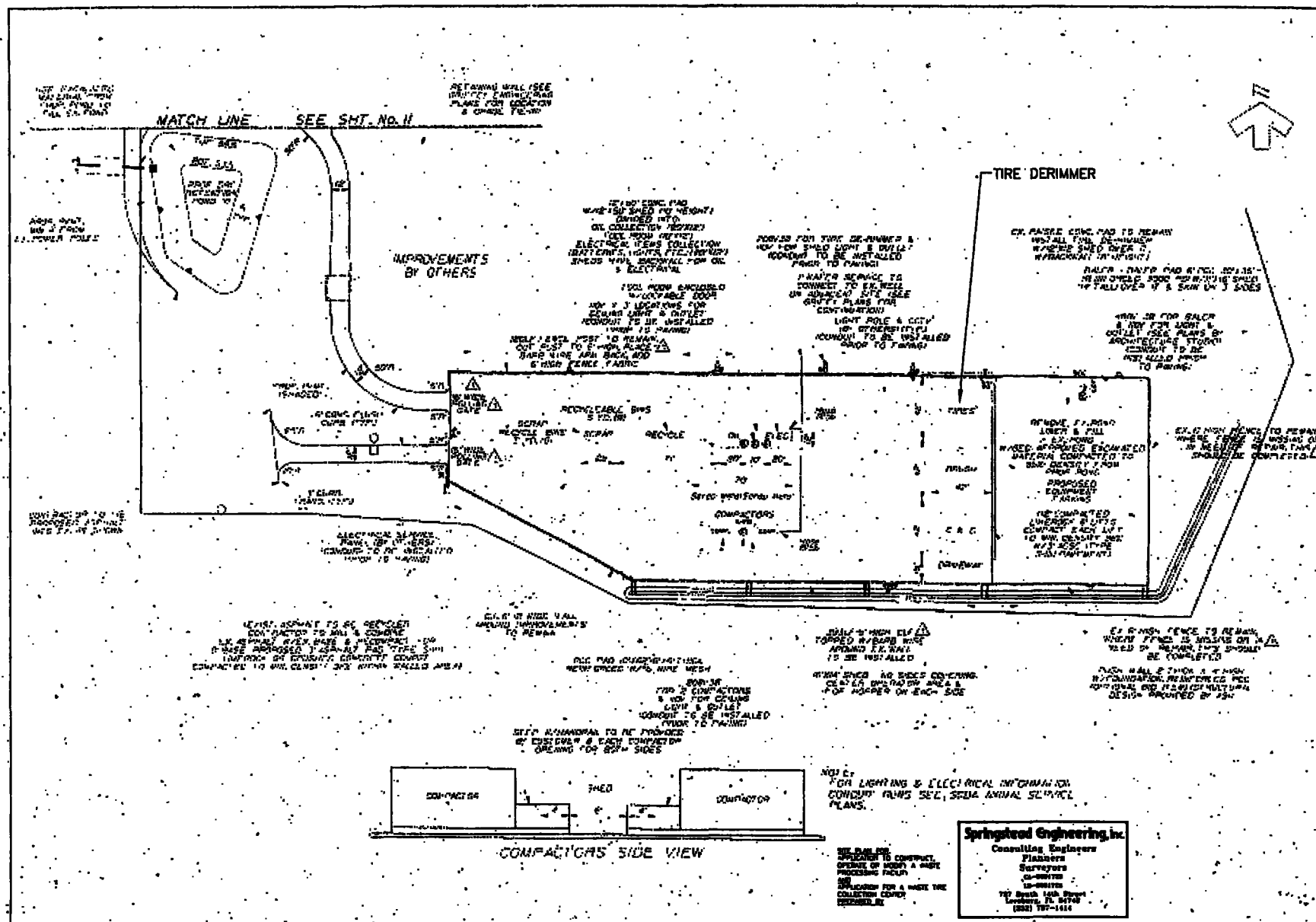

Springstead Engineering, Inc.
Consulting Engineers
Planners
Surveyors
CIVIL ENGINEERS
LAND ENGINEERS
717 South 14th Street
Lubbock, TX 79408
(806) 787-1414

**Southwest District
Permitting Application**

New Site

Site Name:		
Site ID:	WACS ID#:	
County:		
Type/Subcode:		
Fee submitted:	() correct	() incorrect
Total Fee Required \$ _____ Need \$ _____ Refund \$ _____		

Existing Site

Site ID: 126848-006		
Project Name:	WACS ID#:	
SUMTER CO. SOLID WASTE WTPF	53008	
Type/Subcode:	New / Modification <u>Renewal</u>	
WT/06		
Fee submitted: \$ 500.00	(x) correct	() incorrect
Total Fee Required \$ 500.00 Need \$ <u>X</u> Refund \$ <u>X</u>		

Applicant Information

Name: SCOTT COTRELL, P.E.		
Role: APPLICANT		
Company: SUMTER Co Board of County Commissioners		
Address: 7375 POWELL ROAD		
City: WILDWOOD	State: FL	Zip Code: 34785
Phone: (352) 569-6700		

Fee verified by: N. GASKIN

Application Assigned To: N. GASKIN Date: 5/22/12

FLORIDA DEPARTMENT OF
ENVIRONMENTAL PROTECTION

APR 30 2007

SOUTHWEST DISTRICT
TAMPA

Sumter County Waste Tire Collection Center Permit Renewal Application



April 23, 2007

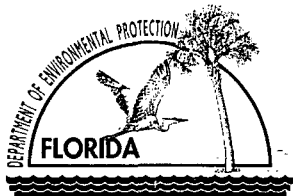

Department of Environmental Protection

DEP Form # 62-701.900(25)
Waste Tire Collection Center
Form Title <u>Permit Application</u>
Effective Date <u>3/22/00</u>
DEP Application No. _____ (Filled in by DEP)

Waste Tire Collection Center Permit Application

A Waste Tire Collection Center Permit allows up to 1,500 waste tires to be stored at the facility at any one time. If this quantity is exceeded, a Waste Tire Processing Facility Permit is required.

Permit No. 126848-004-WT

Renewal ☒ Modification ☐ Existing unpermitted facility ☐

Part I-General Information:

A. Applicant Information:

1. Applicant Name: Board of Sumter County Commissioners
2. Applicant Street Address: 209 North Florida Street
3. City: Bushnell, Florida County: Sumter Zip: 33513
4. Applicant Mailing Address: Same as above
5. City: _____ County: _____ Zip: _____
6. Contact person: Sandra Howell Phone: (352) 793-0207 FEID No: _____
7. Have any enforcement actions been taken by the Department against the applicant relating to the operation of any solid waste management facility in this state? This includes any Complaint, Notice of Violation, or revocation of a permit or registration, as well as any Consent Order in which a violation of Department rules is admitted. It does not include a Warning Letter, Warning Notice, Notice of Noncompliance, or other similar document which does not constitute agency action.
Yes ☒ No ☐ If yes, attach a history and description of the enforcement actions.

B. Facility Information:

1. Facility Name: Sumter County Solid Waste Composting & Recycling Facility
2. Facility Street Address (Main Entrance): 835 CR 529
3. City: Lake Panasoffkee County: Sumter Zip: 33538
4. Facility Mailing Address: Same as above
5. City: _____ State: _____ Zip: _____
6. Contact Person: Jimmy Wise Phone: (352) 793-3368

Facility Location Coordinates:

7. Section: 15/22 Township: 20 Range: 22
8. Latitude: 28 Degrees 44' 30" Longitude: 82 Degrees 05' 26"
9. Anticipated date for starting construction N/A and for completion of construction N/A
10. Anticipated date for receipt of tires This is a permit renewal. The facility currently receives tires.

Mail completed form to
appropriate district office listed below

Northwest District
160 Governmental Center
Pensacola, FL 32501-5794
850-595-8360

Northeast District
7825 Baymeadows Way, Ste. 200 B
Jacksonville, FL 32256-7590
904-448-4300

Central District
3319 Maguire Blvd., Ste. 232
Orlando, FL 32803-3767
407-894-7555

Southwest District
3804 Coconut Palm Dr.
Tampa, FL 33619
813-744-6100

South District
2295 Victoria Ave., Ste. 364
Fort Myers, FL 33902-2549
941-332-6975

Southeast District
400 North Congress Ave.
West Palm Beach, FL 33401
561-681-6600

DEP Form # 62-701.900(25)
Waste Tire Collection Center
Form Title <u>Permit Application</u>
Effective Date <u>3/22/00</u>
DEP Application No. _____ (Filled in by DEP)

C. Land Owner Information (if different from applicant):

- Owner's name: Same as applicant
- Land owner's mailing address: _____
- City: _____ State: _____ Zip: _____
- Authorized Agent: _____ Agent's phone: () _____
- Current lease expires: _____

D. Facility Operator Information (if different from applicant):

- Operator's name: Same as applicant
- Operator's mailing address: _____
- City: _____ State: _____ Zip: _____
- Contact person: _____ Phone: () _____

E. Preparer of Application:

- Name of person preparing application: Joseph L. Miller, P.E.,
- Mailing address: PBS&J, 482 South Keller Rd.
- City: Orlando State: Florida Zip: 32810
- Phone: (407) 806-4153
- Affiliation with facility: Consulting Engineer

Part II Operations:

A. Describe the general operation of the collection center Operator receives used and scrap tires from public. Tires are dropped off on the asphalt pad located southeast of the community drop-off area. The rims are removed to be recycled, and are sold with the other recycled scrap metal. The tires are stored on the asphalt pad or placed in the 40 cubic yard container. Full containers are hauled to the disposal facility.

B. Describe how and where the waste tires will be used, sold, or disposed of _____
The tires are disposed of at the Global Tire Facility in Wildwood, Florida.

DEP Form # 62-701.900(25)
Waste Tire Collection Center
Form Title <u>Permit Application</u>
Effective Date <u>3/22/00</u>
DEP Application No. _____ (Filled in by DEP)

Part III-Attachments:

Please attach the following information to this application:

- A.** A plot plan of the collection center showing:
 - 1. Boundaries of the area being permitted, easements, and rights of way.
 - 2. All wetlands and water bodies in or within 200 feet of this area
 - 3. The waste tire storage area.
 - 4. All structures including buildings, fences, roadways, stormwater control devices, and water wells.
- B.** A copy of a fire safety survey of the collection center
- C.** A copy of the emergency preparedness manual.
- D.** A letter from the landowner (if different from applicant) authorizing the use of the land as a waste tire collection center.
- E.** A check for the application fee.

NOTE: The record keeping requirements of 62-711.400(5) apply to collection centers. However, reports to the Department are **not** required.

Part IV Certification:

To the best of my knowledge and belief, I certify the information provided in this application is true, accurate, and correct. I have attached all documents and/or authorizations that are required.

Joseph L. Miller P.E. #39177
 Print Name of Authorized Agent

Joseph L. Miller
 Signature of Authorized Agent

April 23, 2007
 Date

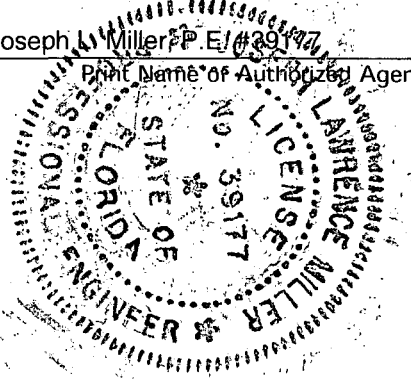

PART III – ATTACHMENTS

– Replaced with info
contained in response
to RA1 #1.

ATTACHMENT A: PLOT PLAN OF THE COLLECTION CENTER SHOWING:

1. Boundaries of the area being permitted, easements and right of way.
2. All wetlands and water bodies in or within 200 feet of this area.
3. The waste storage area.
4. All structures including buildings, fences, roadways, storm water control devices and water wells.

A copy of the previously approved plot plan is included with this permit application renewal. There have been no changes at the Center since the previous application. The information below provides a general overview, the operation manual, and additional relevant information about the collection center.

General

An attendant is on duty during all operating hours at the scale house located at the entrance to the Solid Waste Facility. The facility director is Mr. Jimmy Wise. Personnel are on duty during operating hours to help with unloading and inspecting the waste tires. The Solid Waste Facility is fenced, and the gates locked when the Facility is closed. A Facility sign is located on CR 470 at the intersection with the entry road. Signs are posted along the Facility access roads directing traffic to the scale house, then to the Waste Tire Collection Center for unloading, back to the scale house after tipping, and from the scale house back to CR 470. Signs are posted indicating the hours of operation. The Facility is closed on Sundays and certain legal holidays. The sign includes a notice stating that hazardous materials are not accepted.

All vehicles enter the Facility on CR 529. The Facility entry road is a paved all-weather road, which leads from CR 470 to the scale house/office building. Every vehicle which enters the facility must stop at the scale house to weigh or sign-in. State certified scales at the scale house measure all of the material received. The weight is used for billings, planning and FDEP reports.

Operation Plan

When tire loads are identified at the scale house, the patron is directed to the Waste Tire Collection Center. Signs are posted along the access road directing patrons to the Waste Tire Collection Center, which is located east of the community drop-off area. The Waste Tire Collection Center consists of a paved area with traffic barriers on three sides. Patrons are assisted by County staff in unloading the tires and properly placing the tires in the Center. The tires are stood on end and placed in rows with one tire leaning against the other tire. The staff inspects each load for hazardous materials. Only waste tires or tire scraps are accepted at this Center. After unloading the tires, the patron is directed back to the scale house for weighing. If one or more waste tires are found in a mixed load of solid waste dumped on the tipping floor, the tires are removed and taken to the Waste Tire Collection Center for proper disposal.

The Waste Tire Collection Center, along with the brush, pallets and spool disposal areas, consists of a bunkered 40-foot by 100-foot area paved with RAP (Recycled Asphalt Pavement). The Center includes an area for tire storage, a tire derimming machine, container for scrap steel rims from the tire derimming operation and a 40 cubic yard box for transporting the waste tires to the disposal facility.

The tires, if they still have rims, are unloaded in front of the tire derimming machine. The tires are derimmed and placed in the 40 cubic yard container. The rims are placed in the steel scrap container and are recycled. The derimmed tires are then placed in the 40-cubic yard container. If the container is full, the tires are stacked in the storage area until a container is available. The 40-cubic yard container, depending on the mix of car and truck tires, can hold approximately 200 tires. When the container is full, the County hauls the container to the Global Tire Facility in Wildwood, Florida.

The facility receives between 250 and 350 tires per month. As soon as the container is full, the waste tires are hauled to the disposal facility so rarely does the Center have more than 200 tires on site. The Waste Tire Collection Center Permit allows a maximum storage of 1,000 waste tires. Tires are removed regularly from this Center on a first in first out basis. No tires are ever stored for more than one year at the Center.

Additional information relative to this Waste Tire Collection Center:

The Lake Panasoffkee Fire Department, located 3 miles from the site, provides fire protection. A 50-foot wide fire lane shall be maintained around the perimeter of the waste tire pile. Access to the fire lane for emergency vehicles must be unobstructed at all times. No operation involving an open flame will be conducted within 25-feet of the waste tires.

The Center is not located within 200-feet of any body of water or wetlands. Waste tires are stored on an impervious surface sloped to drain storm water away from the tires and into the storm water retention area.

Mosquitoes and rodents are controlled by removing the tires as quickly as possible to keep the number of tires in the storage area to a minimum. If mosquitoes or rodents are seen at the Center, the area will be treated until the problem is eliminated.

A copy of the Emergency Preparedness Manual is kept at the facility.

The Center will comply with the record keeping requirements of 62-711.400(5); however the reports do not need to be submitted to the FDEP.

ATTACHMENT B: A COPY OF A FIRE SAFETY SURVEY OF THE COLLECTION CENTER.

The Sumter County Waste Tire Collection Center conducts an annual fire survey, and the surveys are kept on file at the Facility. The most recent fire safety survey was on October 9, 2006. A copy is included with this application. The next fire safety survey is scheduled for May 2007. The fire safety survey is not sent to FDEP unless there are deficiencies noted.

ATTACHMENT C: A COPY OF THE EMERGENCY PREPAREDNESS MANUAL.

**EMERGENCY PREPAREDNESS MANUAL
SUMTER COUNTY SOLID WASTE COMPOSTING & RECYCLING FACILITY
WASTE TIRE COLLECTION CENTER**

Persons to contact in case of fire, flood or other emergency:

First Contact: Mr. Jimmy Wise – Solid Waste Operations Specialist
Telephone # 352-793-3368

Second Contact: Mr. Tommy Hurst – Public Works Director
Telephone #352-793-0240

Third Contact: Ms. Sandra Howell – County Administrator
Telephone # 352-793-0215

In case of FIRE: Lake Panasoffkee Fire Protection Association
Emergency Telephone # 352-793-2621

Other Emergencies: Sumter County Sheriff's Office
Emergency Telephone # 911

FDEP: Ms. Susan Pelz or Mr. John Morris - Solid Waste Section
Telephone #813-632-7600

Emergency Response Equipment and Procedures:

Fire extinguishers are located around the facility inside of buildings. These are used to extinguish small isolated fires only. For large fires, first call the fire emergency telephone number. Then use the emergency response equipment, which includes loaders and trucks, to fight the fire. The area of the fire should be isolated by removing any combustible materials not ignited in the immediate vicinity of the fire. These materials should be dragged away with the bucket of the loader. After the burning materials are isolated, the loaders and trucks may be used to place soil around the burning materials to prevent spreading of the fire. The soils will also prevent the spread of any residues generated by the burning tires. After the fire is confined, additional soil should be placed on top of the burning tires to extinguish the flames. After the flames are extinguished and the tires have cooled, the burnt materials may be spread out within the confined area to ensure that all the smoldering material is extinguished. If not, any remaining smoldering materials should be recovered with chemical retardants, water or soil.

FDEP should be immediately notified in case of a fire or other emergency at the facility. A full written report describing origins, actions and an evaluation of the success or failure of the actions concerning the emergency shall be delivered to the Department within two weeks of the emergency.

ATTACHMENT D: A LETTER FROM THE LANDOWNER (IF DIFFERENT FROM APPLICANT) AUTHORIZING THE USE OF THE LAND AS A WASTE TIRE COLLECTION CENTER.

This part is not applicable since the applicant is also the landowner.

ATTACHMENT E: A CHECK FOR THE APPLICATION FEE.

A \$100 check from Sumter County for the permit application fee is included with this application.

ATTACHMENT F:

Sumter County was issued a Model Consent Order on 3/18/04 and has met all of its obligations to the consent order and is awaiting word from the DEP on the Contamination Assessment Plan submitted in 2006, which is the last document under review by the Department. The documents listed below are what the DEP Tampa office should have on record between Sumter and themselves. Copies can be sent to the Department upon request.

- Correspondence from DEP: Re: Executed Model Consent Order dated March 18, 2004 (including Exhibit A, B and C)
- Correspondence from DEP; Re: Department Review of Preliminary Contamination Assessment Report, dated May 10, 2006
- Correspondence from DEP: Re: Sumter County Solid Waste Management Facility OGC Case No 04-0131 dated March 23, 2006
- Contamination Assessment Plan dated July 2006 Prepared by The Colinas Group, Inc.

Sumter County Fire Rescue Fire & Life Safety Checklist

Date 10-9-06		Time 10:00		Date of Last Inspection	
Address 835 CR 529 LAKE PAVASOFF-KEE					
Name of Business SUMTER COUNTY SOLID WASTE - FIRE RESCUE					
Contact Person			Phone No.		
Type of Occupancy EXISTING 121D			NFPA 101 Chap.		
Type of Construction N/A			Number of Stories N/A		

1. MEANS OF EGRESS	Pass	Fail	N/A	Supervised System?	Pass	Fail	N/A
Doors blocked?			X	Portable Fire Extinguishers	X		
Doors locked?			X	Standpipe			X
No knowledge hardware installed?			X	Valves			X
Door opens in direction of travel?			X	4. Interior Finish			
Stairs			X	Fixed Seating			X
Ramps			X	Wall Finish			X
Exit Signs			X	Floor Finish			X
Emergency Lighting			X	Wall Decoration			X
Fire Escapes			X	Furnishing			X
Elevators			X	Ceiling Finish			X
Windows			X	5. HVAC System			
Aisles			X	Outside Air Intake			X
Discharge from exits	OK	X		Inside Air Intake			X
Occupant load			X	Air Handling Room(s)			X
Security Bars/ Shutters			X	Smoke Detection			X
Evacuation Plan Posted			X	Heat Detection			X
Fire Drills Conducted			X	Smoke Removal System			X
2. Alarm System				General Maintenance Of Returns & Ducts			X
Smoke detectors			X	6. Utilities			
Heat Detectors			X	Electrical Wiring	X		
System Operation			X	Electrical MDP	X		
Audible Alarm			X	LP Gas Lines			X
Visual Alarm			X	LP Gas Tanks, Location & Condition			X
Within Certification?			X	LP Gas Meter & Shutoff			X
Automatic Initiation			X	7. Hazards			
Manual Initiation			X	Flammable Liquids	X		
Fire Alarm Panel			X	Flammable Gases	X		
3. Protective Systems				Flammable Dusts	X		
Automatic Sprinkler Sys.			X	Flammable Solids	X		
Automatic Extinguisher Sys.			X	Open Flame			X
System Within Certification?			X	Hazardous Materials (storage)	X		
Smoke Evacuation System			X	Hazardous Conditions/Structural Features	X		
Hood & Duct System			X	Trash & Rubbish	X		
Linked to Alarm System?			X	Use of Electrical Extension Cords	X		
Fire Department Connection			X	Use of Power Strips	X		

Reference deficiencies on SCFR Form 503A by section number

Inspection Performed By: Donna S. SCFR 116632

SCFR Form 503 Sept 03

INSP. PASSED 10/9/06

**RESPONSE TO REQUEST
FOR ADDITIONAL
INFORMATION #1**



An employee-owned company

June 14, 2007

FLORIDA DEPARTMENT OF
ENVIRONMENTAL PROTECTION

JUN 18 2007

SOUTHWEST DISTRICT
TAMPA

Ms. Susan J. Pelz, P.E.
Solid Waste Manager
Southwest District
13051 North Telecom Parkway
Temple Terrace, Florida 33637-0926

RE: Sumter County Waste Tire Collection Center
Pending Operation Permit No.: 126848-005-WT/05

Dear Ms. Pelz:

This letter is in response to your letter dated May 30, 2007 requesting additional information for the above referenced pending permit. Your questions are given below in italics followed by our responses in normal type.

1. *Rule 62-711.540 (1) (b), F.A.C. Please provide a revised operations plan that includes the information required by this rule.*

Response: On page 2 of the Operation Plan in the section "Additional information relative to this Waste Tire Collection Center," the last sentence in the first paragraph states "No operation involving an open flame will be conducted within 25-feet of the waste tires." The revised Operation Plan made this sentence a separate bullet to highlight this critical point.

2. *Rule 62-711.540(e), F.A.C. Please provide emergency preparedness procedures that include the information required by this rule.*

- a. *The information submitted states, "waste tires are stored on an impervious surface sloped to drain storm water away from the tires and into the storm water retention area." Please explain how residue from a tire fire will be prevented from entering the storm water management system.*

Response: The impervious surface has concrete traffic barriers on three sides. Sumter County added an impervious asphalt barrier at the base of the concrete traffic barriers to a minimum height of 12-inches. A 4" diameter pipe with treaded ends and a cap was installed at the lowest point to drain storm water run-off. The cap will be screwed on to the pipe during a tire fire to prevent residue from the fire from entering the storm water management

system. In case of a fire, Sumter County will fight the fire with fire extinguishers, and contain and smother the fire with dirt. The fire department will fight a tire fire with foam rather than water to prevent residue from leaving the impervious pad and contaminating the storm water management system.

- b. *The information indicates that the combustible materials will be "dragged away with the bucket of the loader." Please clarify where the burning materials will be dragged and how environmental impacts will be prevented.*

Response: The plan calls for removing not ignited combustible material only. Burning materials will be left on the impervious pad, and covered with dirt and foam until the fire is extinguished. The section was revised to clarify the procedure.

- c. *The information indicates that soil will be placed around the burning materials to prevent the spread of fire. Please clarify the source of this soil, i.e., where soil is stored onsite.*

Response: Sumter County maintains a 200-300 cubic yard soil pile for emergencies. This soil stockpile is located approximately 300 yards from the Waste Tire Collection Center, and is just south of the milled asphalt storage area and Compost Finishing Building. Sumter County will also maintain another 50-cubic yard soil stockpile adjacent to the Waste Tire Collection Center for fighting fires.

- d. *Please specify the disposition of residues from a tire fire.*

Response: Slightly charred tires would be sent with the other tires to Global Tire for recycling. Steel belts remaining from the fire would be placed in the steel recycling bin. Residue, miscellaneous debris and contaminated soil remaining from the fire would be loaded into a solid waste transfer trailer, and taken to the Class I landfill for disposal with the other solid waste. This information has been added to the revised Operation Plan and the Emergency Preparedness Plan.

3. *Rule 62-711.500(3), F.A.C. Please provide financial assurance cost estimates and proof of funding for closing the waste tire collection center. The cost estimates shall include the costs of loading, hauling and disposal of all waste tires and residuals, and shall be for a third party performing the work.*

Response: The financial assurance cost estimates and proof of funding for closing the Waste Tire Collection Center are on file with FDEP. The financial

assurance cost estimate for the Waste Tire Facility is combined with the financial assurance cost estimates for Permit 126941-003-SO – Waste Processing Facility and 126940-010-SO – Composting Facility. Included with this response is the Sumter County letter dated August 21, 2006 transmitting the Financial Assurance Cost Estimate Form for these three permits, and FDEP letter dated December 15, 2006 approving the estimates until September 1, 2007.

If you have any further questions, please call me at 407-806-4153.

Sincerely,

Joseph L. Miller, P.E. #39177
Project Engineer
Seal: JOSEPH L. MILLER, P.E., No. 39177, State of Florida, Professional Engineer, License No. 39177, Exp. 12/31/2010

Cc: Sandra Howell, County Administrator for Sumter County
Jimmy Wise, Sumter County Solid Waste Operations Specialist
Denise Warnock/Tommy Hurst, Sumter County Public Works
Miriam Zimms, Kessler Consulting, Inc.

Attachments

Revised Part III - Attachments
FDEP Letter dated December 15, 2006
Sumter County Letter dated August 21, 2006

U:\SO\Projects\SUMTER\Waste Tire Permit\FDEP Response 1.doc

PART III – ATTACHMENTS

ATTACHMENT A: PLOT PLAN OF THE COLLECTION CENTER SHOWING:

1. Boundaries of the area being permitted, easements and right of way.
2. All wetlands and water bodies in or within 200 feet of this area.
3. The waste storage area.
4. All structures including buildings, fences, roadways, storm water control devices and water wells.

A copy of the previously approved plot plan is included with this permit application renewal. There have been no changes at the Center since the previous application. The information below provides a general overview, the operation manual, and additional relevant information about the collection center.

General

An attendant is on duty during all operating hours at the scale house located at the entrance to the Solid Waste Facility. The facility director is Mr. Jimmy Wise. Personnel are on duty during operating hours to help with unloading and inspecting the waste tires. The Solid Waste Facility is fenced, and the gates locked when the Facility is closed. A Facility sign is located on CR 470 at the intersection with the entry road. Signs are posted along the Facility access roads directing traffic to the scale house, then to the Waste Tire Collection Center for unloading, back to the scale house after tipping, and from the scale house back to CR 470. Signs are posted indicating the hours of operation. The Facility is closed on Sundays and certain legal holidays. The sign includes a notice stating that hazardous materials are not accepted.

All vehicles enter the Facility on CR 529. The Facility entry road is a paved all-weather road, which leads from CR 470 to the scale house/office building. Every vehicle which enters the facility must stop at the scale house to weigh or sign-in. State certified scales at the scale house measure all of the material received. The weight is used for billings, planning and FDEP reports.

Operation Plan

When tire loads are identified at the scale house, the patron is directed to the Waste Tire Collection Center. Signs are posted along the access road directing patrons to the Waste Tire Collection Center, which is located east of the community drop-off area. The Waste Tire Collection Center consists of a paved area with traffic barriers on three sides. Patrons are assisted by County staff in unloading the tires and properly placing the tires in the Center. The tires are stood on end and placed in rows with one tire leaning against the other tire. The staff inspects each load for hazardous materials. Only waste tires or tire scraps are accepted at this Center. After unloading the tires, the patron is directed back to the scale house for weighing. If one or more waste tires are found in a mixed load of solid waste dumped on the tipping floor, the tires are removed and taken to the Waste Tire Collection Center for proper disposal.

The Waste Tire Collection Center consists of a bunkered 75-foot wide (east to west) by 87-foot deep (north to south) area paved with RAP (Recycled Asphalt Pavement). The Center includes an area for tire storage, a tire derimming machine, container for scrap steel rims from the tire derimming operation and a 40 cubic yard box for transporting the waste tires to the disposal facility.

The tires, if they still have rims, are unloaded in front of the tire derimming machine. The tires are derimmed and placed in the 40 cubic yard container. The rims are placed in the steel scrap container and are recycled. The derimmed tires are then placed in the 40-cubic yard container. If the container is full, the tires are stacked in the storage area until a container is available. The 40-cubic yard container, depending on the mix of car and truck tires, can hold approximately 200 tires. When the container is full, the County hauls the container to the Global Tire Facility in Wildwood, Florida.

The facility receives between 250 and 350 tires per month. As soon as the container is full, the waste tires are hauled to the disposal facility so rarely does the Center have more than 200 tires on site. The Waste Tire Collection Center Permit allows a maximum storage of 1,000 waste tires. Tires are removed regularly from this Center on a first in first out basis. No tires are ever stored for more than one year at the Center.

Additional information relative to this Waste Tire Collection Center:

- The Lake Panasoffkee Fire Department, located 3 miles from the site, provides fire protection.
- A 50-foot wide fire lane shall be maintained around the perimeter of the waste tire pile. Access to the fire lane for emergency vehicles must be unobstructed at all times.
- A minimum of 50-cubic yards of soil shall be kept in a stockpile adjacent to the Waste Tire Collection Center for fighting fires.
- No operation involving an open flame will be conducted within 25-feet of the waste tires.
- The Center is not located within 200-feet of any body of water or wetlands. Waste tires are stored on an impervious surface sloped to drain storm water away from the tires and into the storm water retention area.
- Mosquitoes and rodents are controlled by removing the tires as quickly as possible to keep the number of tires in the storage area to a minimum. If mosquitoes or rodents are seen at the Center, the area will be treated until the problem is eliminated.
- A copy of the Emergency Preparedness Manual is kept at the facility.
- The Center will comply with the record keeping requirements of 62-711.400(5); however the reports do not need to be submitted to the FDEP.

ATTACHMENT B: A COPY OF A FIRE SAFETY SURVEY OF THE COLLECTION CENTER.

The Sumter County Waste Tire Collection Center conducts an annual fire survey, and the surveys are kept on file at the Facility. The most recent fire safety survey was on October 9, 2006. A copy is included with this application. The fire safety survey is not sent to FDEP unless there are deficiencies noted.

ATTACHMENT C: A COPY OF THE EMERGENCY PREPAREDNESS MANUAL.

**EMERGENCY PREPAREDNESS MANUAL
SUMTER COUNTY SOLID WASTE COMPOSTING & RECYCLING FACILITY
WASTE TIRE COLLECTION CENTER**

Persons to contact in case of fire, flood or other emergency:

First Contact: Mr. Jimmy Wise – Solid Waste Operations Specialist
Telephone # 352-793-3368

Second Contact: Mr. Tommy Hurst – Public Works Director
Telephone #352-793-0240

Third Contact: Ms. Sandra Howell – County Administrator
Telephone # 352-793-0215

In case of FIRE: Lake Panasoffkee Fire Protection Association
Emergency Telephone # 352-793-2621

Other Emergencies: Sumter County Sheriff's Office
Emergency Telephone # 911

FDEP: Ms. Susan Pelz or Mr. John Morris - Solid Waste Section
Telephone #813-632-7600

Emergency Response Equipment and Procedures:

Fire extinguishers are located around the facility inside of buildings. Fire extinguishers are used to fight small isolated fires only. Sumter County maintains a 200-300 cubic yard soil stockpile for emergencies. This soil stockpile is located approximately 300 yards from the Waste Tire Collection Center, and is just south of the milled asphalt storage area and Compost Finishing Building. Sumter County also maintains a 50-cubic yard soil stockpile adjacent to the Waste Tire Collection Center for fighting tire fires. Sumter County has emergency response equipment, which includes loaders and trucks, to fight tire fires. The loaders and dump trucks will move dirt, and use the dirt to isolate and cover burning tires.

The Waste Tire Collection Center has an impervious surface with concrete traffic barriers on three sides. The concrete barriers have an impervious asphalt barrier at the base up to a minimum height of 12-inches. A 4" diameter pipe with treaded ends and a cap is located at the lowest point to drain storm water run-off. In case of a fire, the cap must be screwed on to the pipe to prevent residue from the fire from entering the storm water management system.

In case of a fire, Sumter County will first call the fire department. Then fight the fire with fire extinguishers, and mobilize the loaders and trucks to move dirt to contain and smother the

fire with dirt. The fire department will fight the tire fire with foam rather than water to prevent residue from leaving the impervious pad.

The burning tires should first be isolated. Any tires or other combustible materials near the fire, but not yet burning, should be dragged away from the fire with the bucket of the loader. After the burning tires are isolated, the loaders and trucks shall place soil around the burning tires to prevent the spread of residue generated by the burning tires. After the fire is confined, additional soil should be placed on top of the burning tires to extinguish the flames.

After the flames are extinguished and the tires have cooled, the burnt materials may be spread out within the confined area to ensure that all the smoldering material is extinguished. If not, any remaining smoldering materials should be recovered with chemical retardants or soil.

Slightly charred tires can be sent with the other tires to Global Tire for recycling. Steel belts remaining from the fire can be placed in the steel recycling bin. Residue, miscellaneous debris and contaminated soil remaining from the fire can be loaded into a solid waste transfer trailer, and taken to the Class I landfill for disposal with the other solid waste.

FDEP should be immediately notified in case of a fire or other emergency at the facility. A full written report describing origins, actions and an evaluation of the success or failure of the actions concerning the emergency shall be delivered to the Department within two weeks of the emergency.

ATTACHMENT D: A LETTER FROM THE LANDOWNER (IF DIFFERENT FROM APPLICANT) AUTHORIZING THE USE OF THE LAND AS A WASTE TIRE COLLECTION CENTER.

This part is not applicable since the applicant is also the landowner.

ATTACHMENT E: A CHECK FOR THE APPLICATION FEE.

A \$500 check from Sumter County for the permit application fee is included with this application.

ATTACHMENT F:

Sumter County was issued a Model Consent Order on 3/18/04 and has met all of its obligations to the consent order and is awaiting word from the DEP on the Contamination Assessment Plan submitted in 2006, which is the last document under review by the Department. The documents listed below are what the DEP Tampa office should have on record between Sumter and themselves. Copies can be sent to the Department upon request.

- Correspondence from DEP: Re: Executed Model Consent Order dated March 18, 2004 (including Exhibit A, B and C)
- Correspondence from DEP; Re: Department Review of Preliminary Contamination Assessment Report, dated May 10, 2006
- Correspondence from DEP: Re: Sumter County Solid Waste Management Facility OGC Case No 04-0131 dated March 23, 2006
- Contamination Assessment Plan dated July 2006 Prepared by The Colinas Group, Inc.

Board of County Commissioners

Sumter County, Florida

209 North Florida Street, Suite 3 • Bushnell, FL 33513-6146 • Phone (352) 793-0200 • FAX: (352) 793-0207
SunCom: 665-0200 • Website <http://sumtercountyfl.gov>

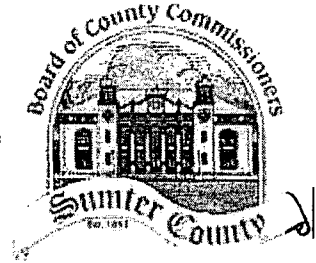

August 21, 2006

Ms. Susan J. Pelz, P.E.
Department of Environmental Protection
1305 N. Telecom Parkway
Temple Terrace, Florida 33637-0926

RE: Sumter County Financial Assurance Cost Estimates for Permits: the Closed Landfill Long-Term Care (22926-003-SF), the Materials Recovery Facility (126941-003-SO), Composting Facility (126940-010-SO) and the Waste Tire Collection Facility (126848-004-WT)

Dear Ms. Pelz:

Please find attached two forms for the Sumter County's Financial Assurance Cost Estimates for the Closed Landfill Long-Term Care, the Materials Recovery Facility, Composting Facility and the Waste Tire Collection Center as a requirement for all four permits mentioned above. The first form includes only the total estimate for the Closed Landfill Long Term Care and the second form includes a total estimate for the other three permits.

This submittal complies with specific conditions 14.a & 14.c from the MRF permit, with specific condition 16 from the Composting permit, with specific condition 15.a from the Waste Tire Collection Center permit and with specific condition 9.a from the Long-Term Care permit.

Please review the attached documents and contact me if you have any questions or require additional information. I look forward to hearing back from you on their approval so we can begin the process to provide proper proof of funding to the Tallahassee DEP Finance office.

Sincerely,

Sandra D. Howell
Interim County Administrator

Attachments

xc: Steve Morgan, DEP Tampa Office
Chad Fetrow, DEP Tallahassee – Solid Waste Financial Coordinator
Denise Warnock/Tommy Hurst, Director of Public Works
Garry Reynolds, Director of Finance
Jackey Jackson, Assistant Public Works Director
Miriam Zimms, Kessler Consulting, Inc.

Richard "Dick" Hoffman, Dist 1
(352) 753-1592 or 793-0200
209 North Florida Street
Bushnell, FL 33513

Joey A. Chandler, Chairman
Dist 2, (352) 748-5005
6255 CR 429
Lake Panasoffkee, FL 33538

Michael E. Francis, Dist 3
(352) 753-1592 or 793-0200
209 North Florida Street
Bushnell, FL 33513

Jim Roberts, Vice Chairman
Dist 4, (352) 793-4776
209 North Florida Street, Suite 3
Bushnell, FL 33513-6146

Randy Mask, Dist 5
(352) 793-0200
209 North Florida Street
Bushnell, FL 33513

Bradley Arnold, County Administrator
(352) 793-0200
209 North Florida Street, Suite 3
Bushnell, FL 33513-6146

Gloria R. Hayward, Clerk & Auditor
(352) 793-0215
209 North Florida Street
Bushnell, FL 33513

Randall N. Thornton
County Attorney
(352) 793-4040 P.O. Box 58
Lake Panasoffkee, FL 33538

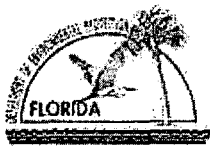

Florida Department of Environmental Protection
Twin Towers Office Bldg. • 2600 Blair Stone Road • Tallahassee, FL 32399-2400

DEP Form # 62-701.900(28)
Form Title <u>Financial Assurance Cost Estimate Form</u>
Effective Date <u>05-27-01</u>
DEP Application No. _____ (Filled by DEP)

FINANCIAL ASSURANCE COST ESTIMATE FORM

Date: 8/11/06 Date of DEP Approval: _____

I. GENERAL INFORMATION:

Facility Name: Sumter County Recycling & Composting WACS or GMSID #: SWD/60/53008

Permit / Application No.: 126941003SO, 126940010SO, 126848004WT Expiration Date: 05/01/2009

Facility Address: 835 CR 529, Sunterville, FL 33585

Permittee: Sumter County, Public Works

Mailing Address: 319 East Anderson Avenue, Bushnell, FL 33513

Latitude: 22°44'36" Longitude: 82°05'19" or UTM: _____

Solid Waste Disposal Units Included in Estimate:

Phase / Cell	Acres	Date Unit Began Accepting Waste	Design Life of Unit From Date of Initial Receipt of Waste
_____	_____	_____	_____
_____	_____	_____	_____
_____	_____	_____	_____
_____	_____	_____	_____
_____	_____	_____	_____
_____	_____	_____	_____
_____	_____	_____	_____
_____	_____	_____	_____

Total Landfill Acreage included in this estimate. _____ Closure _____ Long-Term Care _____

Type of landfill: _____ Class I _____ Class III _____ C&D Debris _____

II. TYPE OF FINANCIAL ASSURANCE DOCUMENT (Check Type)

☒ Letter of Credit*

Insurance Certificate

*Indicates
mechanisms that
require use of a
Standby Trust Fund
Agreement

_____ Surety Bond*

Escrow Account

Trust Fund Agreement

Financial Test

Northwest District
160 Governmental Center
Pensacola, FL 32501-5794
850-595-8360

Northeast District
7825 Baymeadows Way, Ste. B200
Jacksonville, FL 32256-7590
904-448-4300

Central District
3319 Maguire Blvd., Ste. 232
Orlando, FL 32803-3767
407-894-7555

Southwest District
3804 Coconut Palm Dr.
Tampa, FL 33619
813-744-6100

South District
2295 Victoria Ave., Ste. 364
Fort Myers, FL 33901-3881
941-332-6975

Southeast District
400 North Congress Ave.
West Palm Beach, FL 33401
561-881-6600

III. ESTIMATE ADJUSTMENT

40 CFR Part 264 Subpart H as adopted by reference in Rule 62-701.630, Florida Administrative Code sets forth the method of annual cost estimate adjustment. Cost estimates may be adjusted by using an inflation factor or by recalculating the maximum costs of closure in current dollars. Select one of the methods of cost estimate adjustment below.

☒ (a) Inflation Factor Adjustment

Inflation adjustment using an inflation factor may only be made when a Department approved closure cost estimate exists and no changes have occurred in the facility operation which would necessitate modification to the closure plan. The inflation factor is derived from the most recent Implicit Price Deflator for Gross National Product published by the U.S. Department of Commerce in its survey of Current Business. The inflation factor is the result of dividing the latest published annual Deflator by the Deflator for the previous year. The inflation factor may also be obtained from the Solid Waste Financial Coordinator at (850)-245-8732.

This adjustment is based on the Department approved closure cost estimate dated: 08/23/2005

Latest Department Approved Closure Cost Estimate:		Current Year Inflation Factor		Inflation Adjusted Closure Cost Estimate:
\$205,717.04	X	1.030	=	\$211,888.55

This adjustment is based on the Department approved long-term care cost estimate dated: _____

Latest Department Approved Annual Long-Term Care Cost Estimate:		Current Year Inflation Factor		Inflation Adjusted Annual Long-Term Care Cost Estimate:
	X	1.030	=	\$0.00

Number of Years of Long Term Care Remaining: X

Inflation Adjusted Long-Term Care Cost Estimate: = 0.00

☐ (b) Recalculate Estimates (see section V)

IV. CERTIFICATION BY ENGINEER

This is to certify that the Financial Assurance Cost Estimates pertaining to the engineering features of the this solid waste management facility have been examined by me and found to conform to engineering principals applicable to such facilities. In my professional judgement, the Cost Estimates are a true, correct and complete representation of the financial liabilities for closing and long-term care of the facility and comply with the requirements of Florida Administrative Code (F.A.C.), Rule 62-701.630 and all other Department of Environmental Protection rules, and statutes of the State of Florida. It is understood that the Financial Assurance Cost Estimates shall be submitted to the Department annually, revised or adjusted as required by Rule 62-701.630(4), F.A.C.

Signature of Engineer

Tommy Hurst
Signature of Owner/Operator

Name & Title (please type)

Tommy Hurst, Director of Public Works
Name & Title (please type)

Florida Registration Number (affix seal) & Date

(352) 793-0240

Telephone Number

Mailing Address

Telephone Number



Florida Department of Environmental Protection
Twin Towers Office Bldg. • 2600 Blair Stone Road • Tallahassee, FL 32399-2400

DEP Form # 62-701.900(28)
Form Title Financial Assurance Cost Estimate Form
Effective Date 05-27-01
DEP Application No. _____
(Filled by DEP)

FINANCIAL ASSURANCE COST ESTIMATE FORM

Date: 8/11/06 Date of DEP Approval: _____

I. GENERAL INFORMATION:

Facility Name: Sumter County Closed Landfill WACS or GMSID #: SWD/60/53008
Permit / Application No.: 22926-003-SF Expiration Date: 06/15/2009
Facility Address: 835 CR 529 Sumterville, FL 33585
Permittee: Sumter County, Public Works Department
Mailing Address: 319 East Anderson Avenue, Bushnell, FL 33513

Latitude: 28°44'36" Longitude: 82°05'19" or UTM: _____

Solid Waste Disposal Units Included in Estimate:

Phase / Cell	Acres	Date Unit Began Accepting Waste	Design Life of Unit From Date of Initial Receipt of Waste
N/A	14.5	N/A	Closed 1990

Total Landfill Acreage included in this estimate. 0 Closure 14.5 Long-Term Care

Type of landfill: ☒ Class Class III ☐ C&D Debris

II. TYPE OF FINANCIAL ASSURANCE DOCUMENT (Check Type)

Letter of Credit* Insurance Certificate
Surety Bond* ☒ Escrow Account
Trust Fund Agreement Financial Test
*Indicates mechanisms that require use of a Standby Trust Fund Agreement

Northwest District
160 Governmental Center
Pensacola, FL 32501-5794
850-595-8360

Northeast District
7825 Baymeadows Way, Ste. B200
Jacksonville, FL 32256-7590
904-448-4300

Central District
3319 Maguire Blvd., Ste. 232
Orlando, FL 32803-3767
407-894-7555

Southwest District
3804 Coconut Palm Dr.
Tampa, FL 33619
813-744-6100

South District
2295 Victoria Ave., Ste. 364
Fort Myers, FL 33901-3881
941-332-6975

Southeast District
400 North Congress Ave.
West Palm Beach, FL 33401
561-681-6800

III. ESTIMATE ADJUSTMENT

40 CFR Part 264 Subpart H as adopted by reference in Rule 62-701.630, Florida Administrative Code sets forth the method of annual cost estimate adjustment. Cost estimates may be adjusted by using an inflation factor or by recalculating the maximum costs of closure in current dollars. Select one of the methods of cost estimate adjustment below.

☒ (a) Inflation Factor Adjustment

Inflation adjustment using an inflation factor may only be made when a Department approved closure cost estimate exists and no changes have occurred in the facility operation which would necessitate modification to the closure plan. The inflation factor is derived from the most recent Implicit Price Deflator for Gross National Product published by the U.S. Department of Commerce in its survey of Current Business. The inflation factor is the result of dividing the latest published annual Deflator by the Deflator for the previous year. The inflation factor may also be obtained from the Solid Waste Financial Coordinator at (850)-245-8732.

This adjustment is based on the Department approved closure cost estimate dated: 08/23/2005

Latest Department Approved Closure Cost Estimate:		Current Year Inflation Factor		Inflation Adjusted Closure Cost Estimate:
	X	<u>1.030</u>	=	<u>\$0.00</u>

This adjustment is based on the Department approved long-term care cost estimate dated:

Latest Department Approved Annual Long-Term Care Cost Estimate:		Current Year Inflation Factor		Inflation Adjusted Annual Long-Term Care Cost Estimate:
<u>\$27,012.53</u>	X	<u>1.030</u>	=	<u>\$27,822.91</u>
Number of Years of Long Term Care Remaining:	X			<u>4</u>
Inflation Adjusted Long-Term Care Cost Estimate:			=	<u>111,291.62</u>

☐ (b) Recalculate Estimates (see section V)

IV. CERTIFICATION BY ENGINEER

This is to certify that the Financial Assurance Cost Estimates pertaining to the engineering features of the this solid waste management facility have been examined by me and found to conform to engineering principals applicable to such facilities. In my professional judgement, the Cost Estimates are a true, correct and complete representation of the financial liabilities for closing and long-term care of the facility and comply with the requirements of Florida Administrative Code (F.A.C.), Rule 62-701.630 and all other Department of Environmental Protection rules, and statutes of the State of Florida. It is understood that the Financial Assurance Cost Estimates shall be submitted to the Department annually, revised or adjusted as required by Rule 62-701.630(4), F.A.C.

Signature of Engineer

Tommy Hurst
Signature of Owner/Operator

Name & Title (please type)

Tommy Hurst, Director of Public Works
Name & Title (please type)

Florida Registration Number (affix seal) & Date

(352) 793-0240
Telephone Number

Mailing Address

Telephone Number

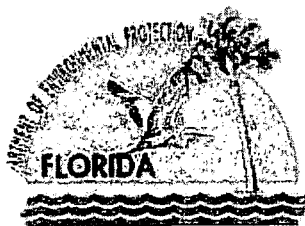

Jeb Bush
Governor

Department of Environmental Protection

Southwest District
13051 North Telecom Parkway
Temple Terrace, FL 33637-0926
Telephone: 813-632-7600

Colleen M. Castille
Secretary

Mr. Tommy Hurst, Director
Sumter County Public Works Department
209 N. Florida Avenue
Bushnell, Florida 33513

December 15, 2006

Re: Sumter County Recycling and Composting Facility |
Financial Assurance Cost Estimates
Permit Nos.: 126941-003-SO - Waste Processing Facility
126940-010-SO - Composting Facility
126848-003-SO - Waste Tire Facility

Dear Mr. Hurst:

This letter is to acknowledge receipt of inflation-adjusted cost estimates dated August 21, 2006 (received August 22, 2006), for closing of the Sumter County Recycling and Composting Facility. The cost estimates received August 22, 2006 (total for closure \$211,888.55), are **APPROVED for 2006**. The closure cost are for closing the Sumter County Waste Processing Facility, Composting Facility, and Waste Tire Processing Facility. The next annual update (revised or inflation-adjusted estimates) is due no later than **September 1, 2007**.

A copy of these estimates will be forwarded to Mr. Fred Wick, Solid Waste Section, FDEP, 2600 Blair Stone Road, Tallahassee, Florida 32399-2407. Please work with him directly to assess the facility's compliance with the funding mechanism requirements of Rule 62-701.630, F.A.C. If you have any questions, you may contact me at (813) 632-7600 ext. 385.

Sincerely,

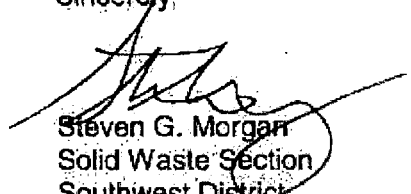
Steven G. Morgan
Solid Waste Section
Southwest District

sgm

cc: Fred Wick, FDEP Tallahassee w/attachment
Susan Pelz, P.E., FDEP

"More Protection, Less Process"

Printed on recycled paper.

**RESPONSE TO REQUEST
FOR ADDITIONAL
INFORMATION #2**



An employee-owned company

August 1, 2007

Ms. Susan J. Pelz, P.E.
Solid Waste Manager
Southwest District
13051 North Telecom Parkway
Temple Terrace, Florida 33637-0926

FLORIDA DEPARTMENT OF
ENVIRONMENTAL PROTECTION
AUG 08 2007
SOUTHWEST DISTRICT
TAMPA

RE: Sumter County Waste Tire Collection Center
Pending Operation Permit No.: 126848-005-WT/05

Dear Ms. Pelz:

This letter is in response to your letter of July 17, 2007 requesting an updated closure cost estimate to load, transport and dispose of the maximum of 1000 tires (Approximately 10 tons based on an average weight of 20 pounds per tire) permitted for the above referenced Waste Tire Collection Center. It was assumed that the tires would be disposed of at Global Tire Recycling Inc. in Wildwood, Florida at a quoted disposal rate on August 1, 2007 of \$55 per ton, and a distance of 12.5 miles from the Center. The closure costs are as follows:

Description	Quantity	Unit Cost	Total Cost
Load 1000 tires with a loader	4 hours	\$100/hour	\$400
Transport 500 tires/trip - 2 trips at 26 miles/trip	52 miles	\$2.39/mile	\$125
Disposal	10 tons	\$55/ton	\$550
Management, profit and overhead fee	1	Lump Sum	\$500
TOTAL CLOSURE COST			\$1,575

Sincerely,

Joseph P. Miller, P.E. #39177

Project Engineer

Sandra Howell, County Administrator for Sumter County
Jimmy Wise, Sumter County Solid Waste Operations Specialist
Denise Warnock/Tommy Hurst, Sumter County Public Works
Miriam Zimms, Kessler Consulting, Inc.

Attachments

Map of route from Waste Tire Collection Center to Global Tire Recycling with distance
Cost estimate for hauling costs

U:\SO\Projects\SUMTER\Waste Tire Permit\FDEP Response 2.doc

Directions to WILDWOOD L

Summary and Notes

START **A** 835 County Road 529, LAKE PANASOFFKEE, FL

FINISH **B** Global Tire Recycling (352) 330-2213
1201 Industrial Dr, WILDWOOD, FL

Total Distance: 12.5 miles, Total Time:
17 mins (approx.)

Add your notes here...

Distance

A 835 COUNTY ROAD 529, LAKE PANASOFFKEE, FL

1. Start at 835 COUNTY ROAD 529, LAKE PANASOFFKEE go 0.1 mi
2. Continue on CR-470 go < 0.1 mi
3. Take ramp onto I-75 N toward OCALA go 8.2 mi
4. Take exit #329/WILDWOOD onto SR-44 toward WILDWOOD/LEESBURG go 3.4 mi
5. Turn **L** on COUNTY ROAD 213 go 0.4 mi
6. Turn **R** on INDUSTRIAL DR go 0.4 mi
7. Arrive at 1201 INDUSTRIAL DR, WILDWOOD

B 1201 INDUSTRIAL DR, WILDWOOD, FL

Distance: 12.5 miles, Time: 17 mins

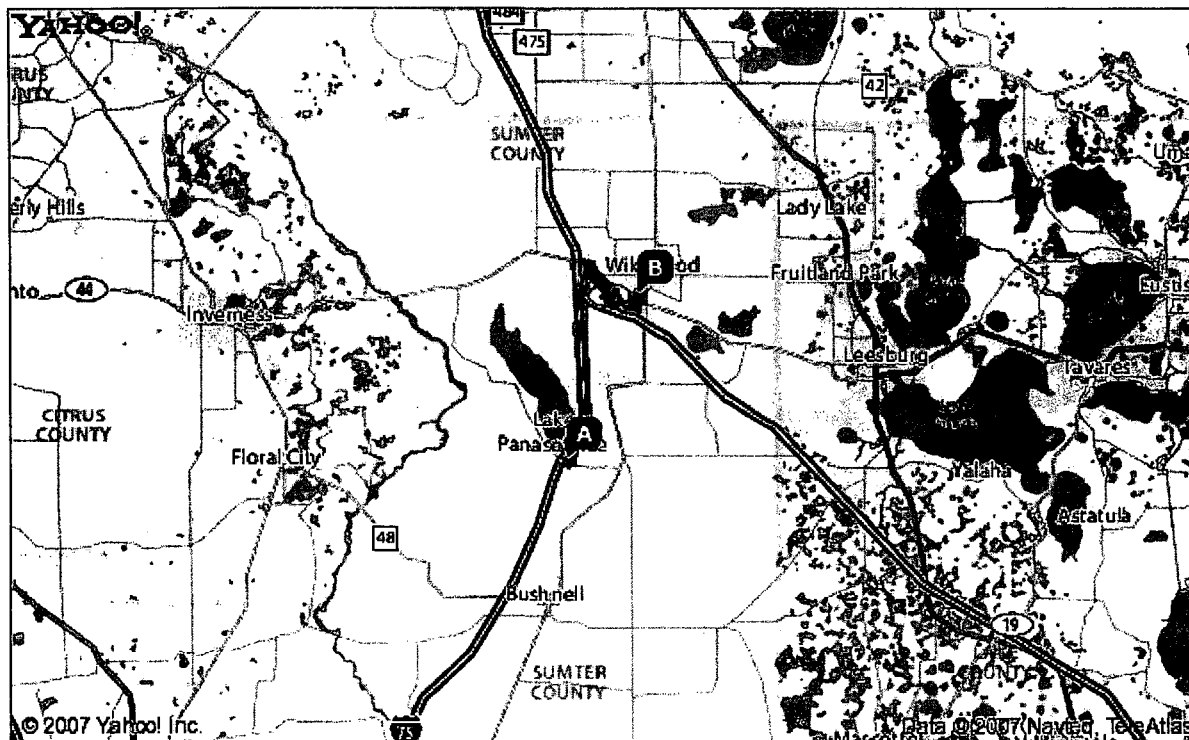

When using any driving directions or map, it's a good idea to do a reality check and make sure the road still exists, watch out for construction, and follow all traffic safety precautions. This is only to be used as an aid in planning.

TRANSPORTATION COSTS FOR TRANSFER VEHICLES PER MILE

EQUIPMENT - AMORTIZATION OF CAPITAL COSTS

Tractor - Capital cost of \$100,000 for 4 Years less \$20,000 residual value based on 320,000 miles.	\$0.25 per mile	
Trailer - Capital cost of \$80,000 for 4 Years less \$10,000 residual value based on 320,000 miles.	\$0.22 per mile	
BASED ON 320,000 MILES OVER 4 YEARS, TOTAL CAPITAL EQUIPMENT COST PER MILE:		\$0.47 per mile

EQUIPMENT - OPERATING & MAINTENANCE COSTS

Repair and Maintenance for tractor @ 10% of capital cost and 80,000 miles per year	\$0.13 per mile	
Repair and Maintenance for trailer @ 10% of capital cost and 80,000 miles per year	\$0.10 per mile	
Fuel based on \$3.00 per gallon and 4.5 miles per gallon	\$0.67 per mile	
Tires based on 20,000 miles per set and \$6,000 per set	\$0.30 per mile	
Insurance based on \$8,000 per year and 80,000 miles per year	\$0.10 per mile	
TOTAL EQUIPMENT OPERATING AND MAINTENANCE COSTS PER MILE:		\$1.30 per mile

LABOR COSTS

Labor costs are based on salary costs of \$16/hour. This includes: raw salary of \$13/hr., and benefits of \$3/hr.		
Drivers average productivity is 40 miles per hour	\$0.40 per mile	
TOTAL LABOR COSTS PER MILE:		\$0.40 per mile
TOTAL TRANSPORTATION COSTS PER MILE:		\$2.17 per mile
TRUCKING CONTRACTOR'S PROFIT AND OVERHEAD OF 10%:		\$0.22 per mile
TOTAL ESTIMATED TRANSPORTATION COST PER MILE:		\$2.39 per mile

This engineer expressly reserves the exclusive common law copyright and property rights to these drawings which may not be reproduced, changed or copied in any form or manner, nor are they to be assigned to any party without the engineer's written consent.

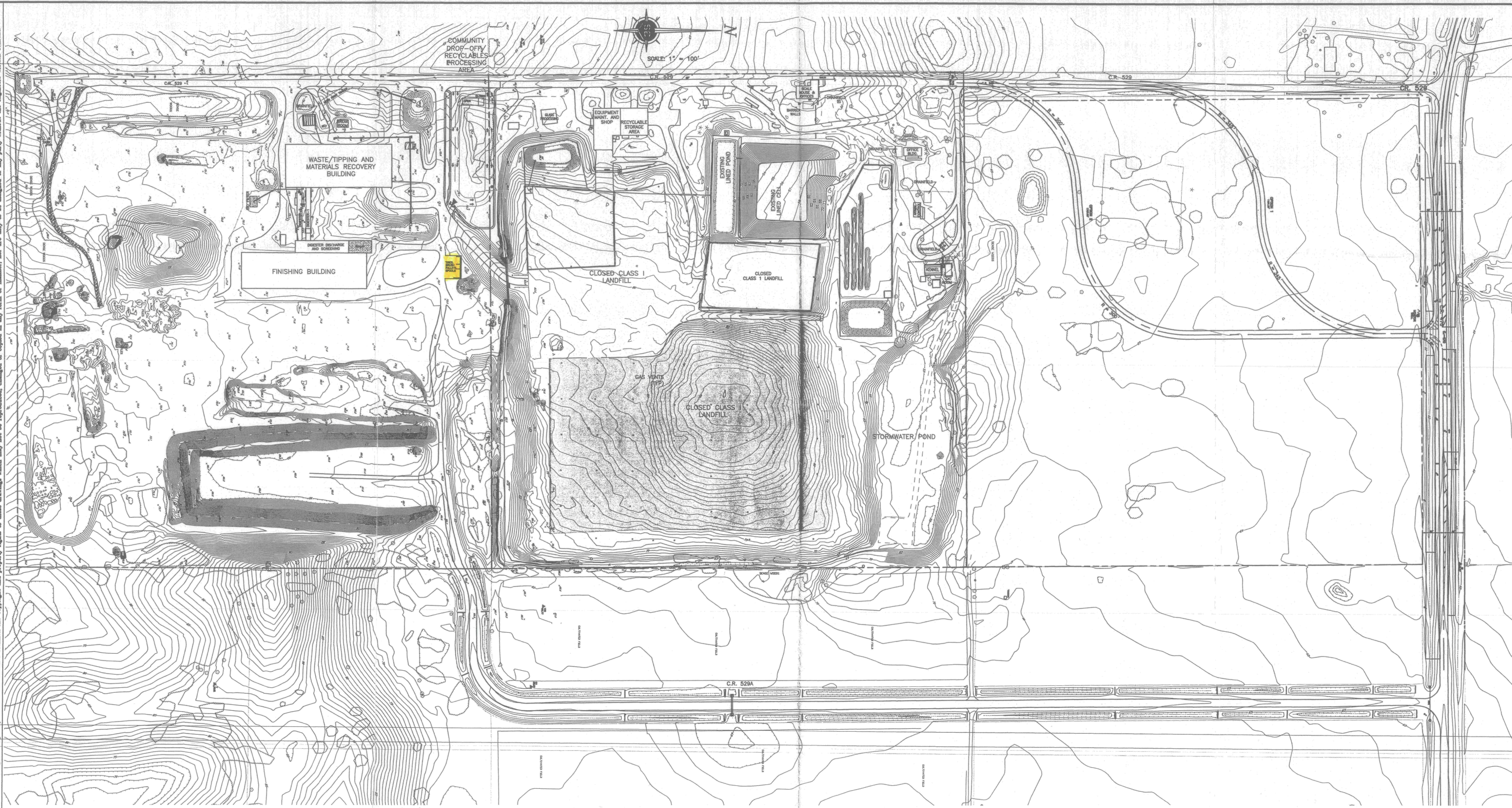

DEPS-SO-886
943221

CLIENT: SUMTER COUNTY BOARD OF COUNTY COMMISSIONERS
PROJECT: SUMTER COUNTY COMPOST FACILITY
DRAWING: OVERALL SITE PLAN W/ OPTIONS 1 AND 2 1 of 1

Springstead Engineering, Inc.

Consulting Engineers
Architects, Planners
Surveyors
EB-0001723
LB-0001723 AA-0002820
727 South 14th Street
Leesburg, FL 34748
(352) 787-1414

SCALE: 1" = 100'	FILE: DUMP-SITE	DATE: 10/05/05
DESIGN: <i>AWC</i>	DRAWN: <i>US</i>	CHECKED: <i>AWC</i>
DRAWING: OVERALL SITE PLAN WITH OPTION 1 AND 2		
CLIENT: S.C.B.C.C. COMPOST FACILITY		
JOB NO.: 921100.020	SHEET: 1	OF: 1