



Citrus Co. LF

Department of Environmental Protection

Lawton Chiles
Governor

Southwest District
3804 Coconut Palm Drive
Tampa, Florida 33619

Virginia B. Wetherell
Secretary

July 27, 1998

Ms. Susan Metcalfe, P.G.
Citrus County
Solid Waste Management
P. O. Box 340
Lecanto, FL 34460-0340

Re: Emergency Detonation or Thermal Treatment
Citrus County Central Landfill, Citrus County

Dear Ms. Metcalfe:

Thank you for your December 19, 1997 response to DEP's September 18, 1997 letter concerning compliance with Florida Administrative Code Rule 62-730.320 (attached) and potential impacts upon the related solid waste facility. The location shown by a X is not approved. The Solid Waste Section has no objections to the location shown by a Y as described in your response subject to the following specific conditions:

- (a) All other local, state, and federal approvals and licenses required for the activities allowed in this authorization shall be obtained.
- (b) Visible residual materials shall be recovered from the site and properly disposed of in accordance with Department rules.
- (c) Adequate fire protection to assure confinement and control of any fire resulting from the operation shall be provided.
- (d) The local Department representative or their designee shall be notified and may be present to observe the treatment or detonation.
- (e) Prior to treatment or detonation, the site shall be secured and no site access allowed except by authorized personnel. The area around the site shall be visually inspected to assure that no unauthorized personnel are present. The securing and inspection of the site shall be made to at least the following distances:

<u>POUNDS OF WASTE EXPLOSIVE</u>	<u>MINIMUM DISTANCE</u>
0 to 100	204 meters (670 feet)
101 to 1,000	380 meters (1250 feet)
1,001 to 10,000	530 meters (1730 feet)
10,001 to 30,000	690 meters (2260 feet)

"Protect, Conserve and Manage Florida's Environment and Natural Resources"

Ms. Susan Metcalfe, P.G.
Citrus County

July 27, 1998
Page Two

- (f) Thermal treatment or detonation shall be conducted only at the times and place specified in the permittee's notice to the Department.
- (g) The Department may require, as a condition of its approval, that soil sampling be conducted before and after the detonation or treatment.
- (h) Within 30 days of the emergency detonation or thermal treatment, the authorized person shall submit to the Department a complete written summary of the detonation or treatment which shall include actual procedures used, disposition of any residues from the process, and other pertinent information.

Be advised: the Department continues to require that "the person having custody of the waste contacts the Department and obtains oral or written permission prior to the detonation or treatment" pursuant to Rule 62-730.320(1)(a). Compliance with this rule requires permission from the Department's Hazardous Waste Section.

In addition to compliance with FAC 62-730.320 requirements the Department requests the following:

- (1) The permittee be informed and cognizant of all detonation activities to assure that detonations occur at locations in compliance with the set back requirements indicated on the attached site plan.
- (2) All detonation occurrences be documented and retained on site which includes at a minimum, the name of the person responsible for the detonation, location and date of the detonation.
- (3) The Department requests that all future construction such as closure construction, installation of passive or active gas control systems, buildings, leachate pump stations that occurs on site which may encroach on the set back distances specified in FAC 62-730.320 be submitted to the Department for review and guidance.

Your continued cooperation is appreciated. If you have any questions concerning this letter, you may contact Kim Ford or myself at (813) 744-6100, extensions 382 or 451.

Sincerely,

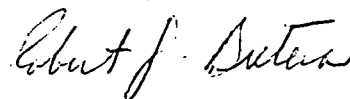

Robert J. Butera, P.E.
Solid Waste Manager
Division of Waste Management

KBF/ab

Attachment

cc: Stanley Tam, P.E., FDEP Tampa/Hazardous Waste Section

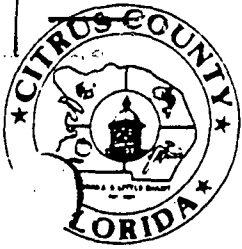

BOARD OF COUNTY COMMISSIONERS DEPARTMENT OF PUBLIC WORKS

30 DAY
FILE

REPLY TO:
Solid Waste Management
P.O. Box 340
Lecanto, Florida 34460

December 19, 1997

3600 W. SOVEREIGN PATH
LECANTO, FLORIDA 34461

ADMINISTRATION OFFICE
Suite 212
352-527-5477 Phone
352-527-5479 Fax

ENGINEERING DIVISION:
Suite 241
352-527-5446 Phone
352-527-5476 Fax

- Land Section
Suite 205
352-527-5447 Phone
352-527-5459 Fax
- Permits & Compliance Sec.
Suite 204
352-527-5448 Phone
352-527-5319 Fax
- Project Management Sec.
Suite 241
352-527-5449 Phone
352-527-5482 Fax
- Survey Section
Suite 241
352-527-5446 Phone
352-527-5482 Fax

1300 S. LECANTO HIGHWAY
LECANTO, FLORIDA 34461

MAINTENANCE OPERATIONS:
• Facilities Maint. Section
PO Box 143
Lecanto, FL 34460
352-527-0333 Phone
352-527-0654 Fax

• Fleet Management Section
PO Box 215
Lecanto, FL 34460
352-746-6888 Phone
352-746-5011 Fax

AQUATIC SERVICES
PO Box 440
Lecanto, FL 34460
352-746-2694 Phone
352-746-9189 Fax

ROAD MAINTENANCE
PO Box 167
Lecanto, FL 34460
352-746-4107 Phone
352-746-1203 Fax

UTILITIES DIVISION
PO Box 440
Lecanto, FL 34460
352-746-2694 Phone
-1676 Fax

SOLID WASTE MANAGEMENT
2300 Gulf to Lake Highway
PO Box 340
Lecanto, FL 34460
352-746-3400 Phone

Richard D. Garrity, Ph.D., Director of District Management
Florida Department of Environmental Protection
3804 Coconut Palm Drive
Tampa, Florida 33619

Re: Emergency Detonation or Thermal Treatment of Certain Hazardous Waste,
62-730.320 FAC

Dear Dr. Garrity:

In response to your letter of September 18 requesting that each solid waste facility designate a location for emergency detonations, Citrus County proposes to use the location shown with an X on the attached diagram (SC23 ZOD). This location is near the southwest corner of the closed 60-acre landfill. This area was filled in 1975 and gas monitoring wells in the area have not detected explosive concentrations of gas. This area is owned by the State, but is leased to the Withlacoochee Technical Institute for law enforcement training. The area has earthen berms on three sides (West, South and East) about 15 feet tall which would prevent flying debris from escape from the site. At least two feet of soil covers the plastic cap used for closure. There are no confined spaces for accumulation of methane gas in the area. The location of the gas vents, flares, leachate sumps and occupied buildings are shown on the site plan.

A location on the adjacent active landfill property in an area that has not been filled is proposed as an alternate if the Department finds that preferable. This location, shown by a Y on the attached diagram is between the soil stockpile and the fill area and is protected on the north by the soil stockpile in excess of 50 feet high. The location of features of the active site is depicted on the enclosed figure ES-1

Please contact me if you have any additional questions.

Sincerely,

Susan J. Metcalfe
Director

CC: Kenneth Saunders, Director, Public Works Department

D.E.P.
JUL - 1 1998
SOUTH FLORIDA DISTRICT
TAMPA

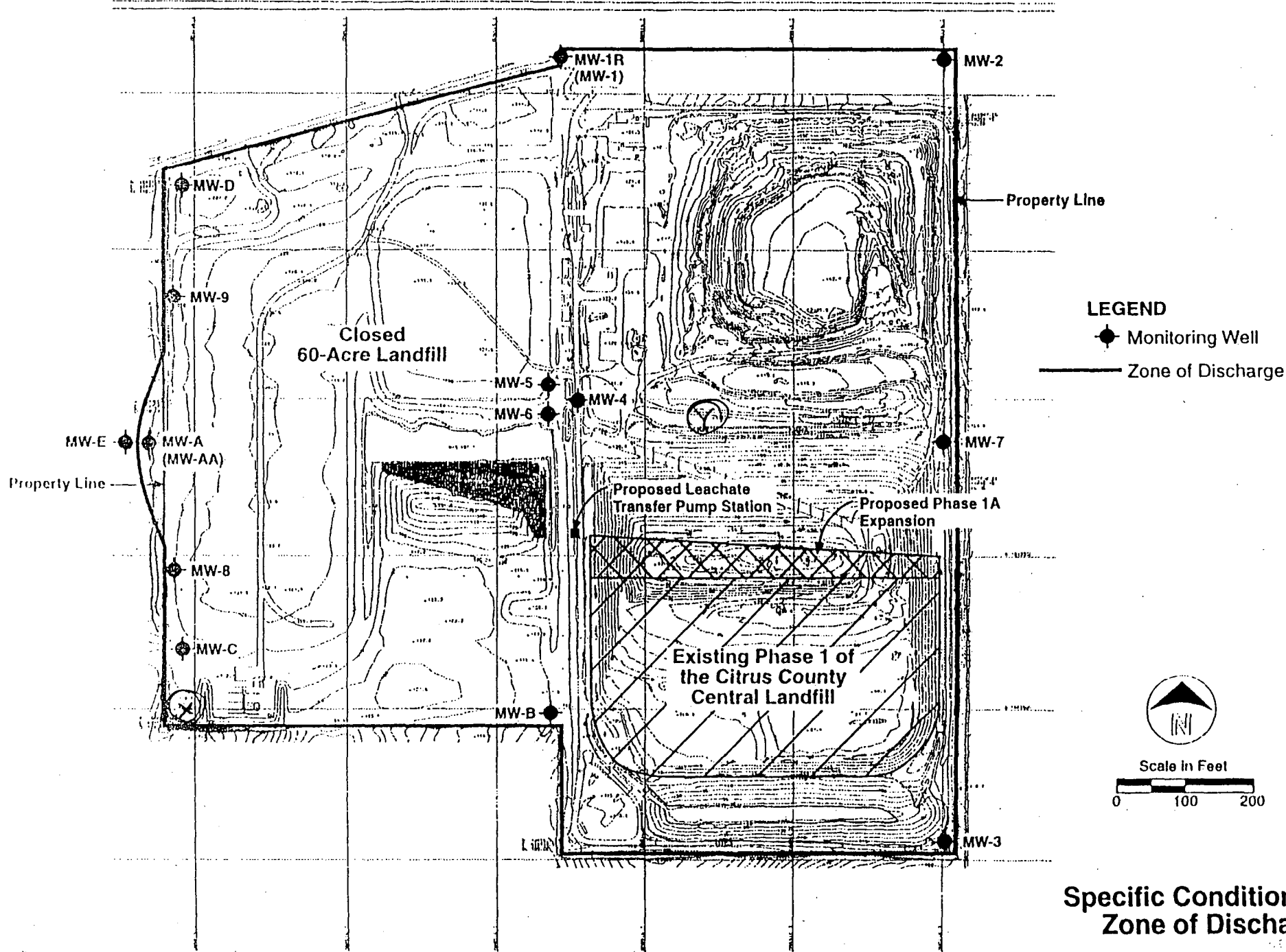

Specific Condition 33
Zone of Discharge

CH2MHILL

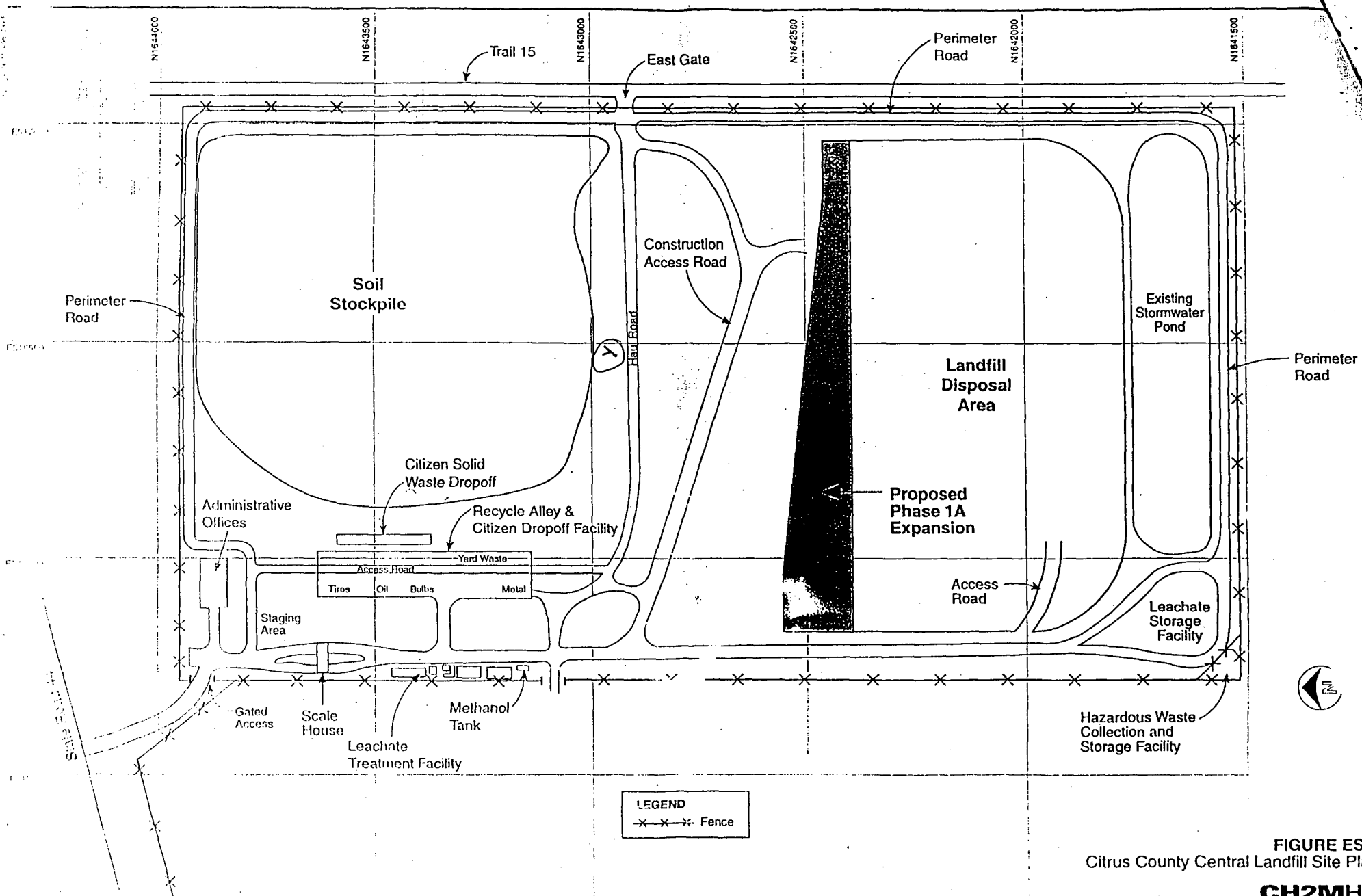

FIGURE ES-1
Citrus County Central Landfill Site Plan