

Board of County Commissioners

DEPARTMENT OF PUBLIC WORKS

SOLID WASTE MANAGEMENT DIVISION

P.O. Box 340, Lecanto, Florida 34460

Telephone: (352) 527-7670 FAX: (352) 527-7672

email: landfillinfo@bocc.citrus.fl.us

TDD Telephone: (352) 527-5303

Citrus Springs/Dunnellon/Inglis/Yankeetown area Toll Free (352) 489-2120

September 16, 2015

Mr. Steve Morgan
Solid Waste Section
Department of Environmental Protection
13051 N Telecom Pkwy
Temple Terrace, FL 33637-0926

**Re: Citrus County Central Landfill – Permit No. 21375-018-SO/01
Landfill Gas Monitoring (Electronically Submitted)**

Dear Mr. Morgan,

The attached report was prepared by SCS Engineers for the County and reports the results of gas monitoring for the Third Quarter of 2015. This monitoring is in accordance with Specific Conditions F2 and F3 of the referenced permit.

No methane was detected in any of the probes or monitoring points.

Please contact me if you have questions or require additional information.

Sincerely,

Henry C. Norris, Jr.
Director, Division of
Solid Waste Management

CC: Jeff Rogers, P.E., Director, Dept. of Public Works (electronic copy)
Ed Hilton, SCS Engineers, Tampa (electronic copy)
Ed Gough – Withlacoochee Technical Institute (electronic copy)
Mike Penn – Division of Forestry (hard copy)

SCS ENGINEERS

September 9, 2015
File No. 09210021.24

Larry Brock
Assistant Public Works Director
Division of Solid Waste Management
P.O. Box 340
Lecanto, Florida 34460

Subject: Landfill Gas Monitoring Report, Third Quarter 2015
Central Landfill, Citrus County, Florida

Dear Charles:

SCS Engineers (SCS) is pleased to submit the results of the Third Quarter landfill gas (LFG) monitoring at Citrus County Central Landfill. Provided below is a description of our activities, summary of the monitoring results, and recommendations.

BACKGROUND

In April 2007, the Florida Department of Environmental Protection (FDEP) approved extending the compliance boundary for LFG migration monitoring at the site to coincide with the boundaries of the 2006 lease agreement between Citrus County and the Florida Division of Forestry. As a result, 18 LFG monitoring probes installed along the new property boundary were to serve as the compliance points for migration monitoring. The remaining 62 permanent LFG probes and 12 interim probes have been abandoned in place and are no longer monitored on a quarterly basis. In November 2010, as part of the Phase III cell expansion, GP-19 was installed. Figure 1 in Attachment 1 includes a site map that shows all LFG monitoring probe locations.

Rule 62-701.530(1)(a) of the Florida Administrative Code (F.A.C.) requires the following:

- The methane concentration may not exceed 25 percent of the lower explosive limit (LEL) in structures on- or off-site. The LEL for methane is five percent by volume in air. Therefore, the maximum allowable concentration in on-site or off-site structures is 1.25 percent methane by volume.
- The methane concentration at or beyond the landfill property boundary may not exceed the LEL (i.e., five percent (5.0%) methane by volume).

This quarterly monitoring was conducted in accordance with Rule 62-701.530(2)(c), F.A.C.

MONITORING RESULTS

On August 24, 2015, SCS personnel monitored the LFG monitoring probes and on-site structures. SCS used a Landtec GEM-2000 gas monitor to measure gas composition in the monitoring probes and on-site structures. The GEM-2000 measures gas by percent volume of methane, carbon dioxide, oxygen, and balance gas, which is considered to be composed primarily of nitrogen. The instrument was calibrated prior to use during the sampling event and the calibration sheet is included in Attachment 2.

LFG Monitoring Probes

Table 1 of Attachment 2 shows the readings obtained from the 19 probes along the property boundary. As shown in Table 1, no methane was detected in the gas monitoring probes. A site plan showing the probe locations is included in Attachment 1.

Monitoring of On-Site Structures

No methane was detected in the scalehouse, administration building, shop, leachate treatment facility, or firing range as shown in Table 1 of Attachment 2. Floor plans of the scale house and the administration building are included in Attachment 1.

SCS monitored in the restrooms of the administration building, as well as in select closets, the break room, conference room, and hallways. In the scalehouse, SCS monitored the main work area, cabinets, the restroom, and at electrical outlets. Monitoring of the leachate treatment facility included around the base of structures, at the control panel, and inside the electrical room.

At the firing range, SCS monitored the floor joints, electrical outlets, and the base of slabs or posts that penetrated the ground.

Methane Monitor

A new methane monitor was installed in the leachate treatment plant electrical building in May 2015 to replace the broken one found during the last quarterly monitoring. This monitor was found functioning upon inspection. SCS monitored the leachate treatment plant electrical building for methane gas, and confirmed that no gas was present in the building. The additional sensor installed previously in the building that measures methane and propane gas appeared operational. This sensor is scheduled for removal in the near future now that new methane monitor is operational.

CONCLUSIONS

No methane was detected during this monitoring event in the 19 probes, which are the compliance points for migration or within any of the buildings monitored on-site.

SCS is providing you two signed and sealed originals of this submittal. Please keep one for your files and forward the other to the FDEP Southwest District office at the following address:

Florida Department of Environmental Protection
13051 N. Telecom Parkway
Temple Terrace, Florida 33637-0926

SCS appreciates the opportunity to assist you with this work. Please call us at (800) 569-9702 if you have any questions or would like additional information.

Sincerely,

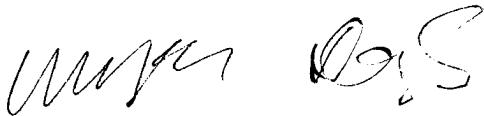

Alyson F. Dagly, E.I.
Project Professional

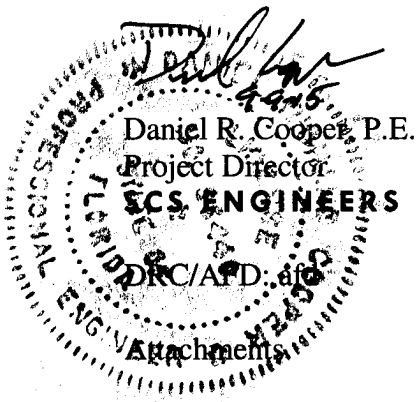

ATTACHMENT 1
MONITORING LOCATIONS

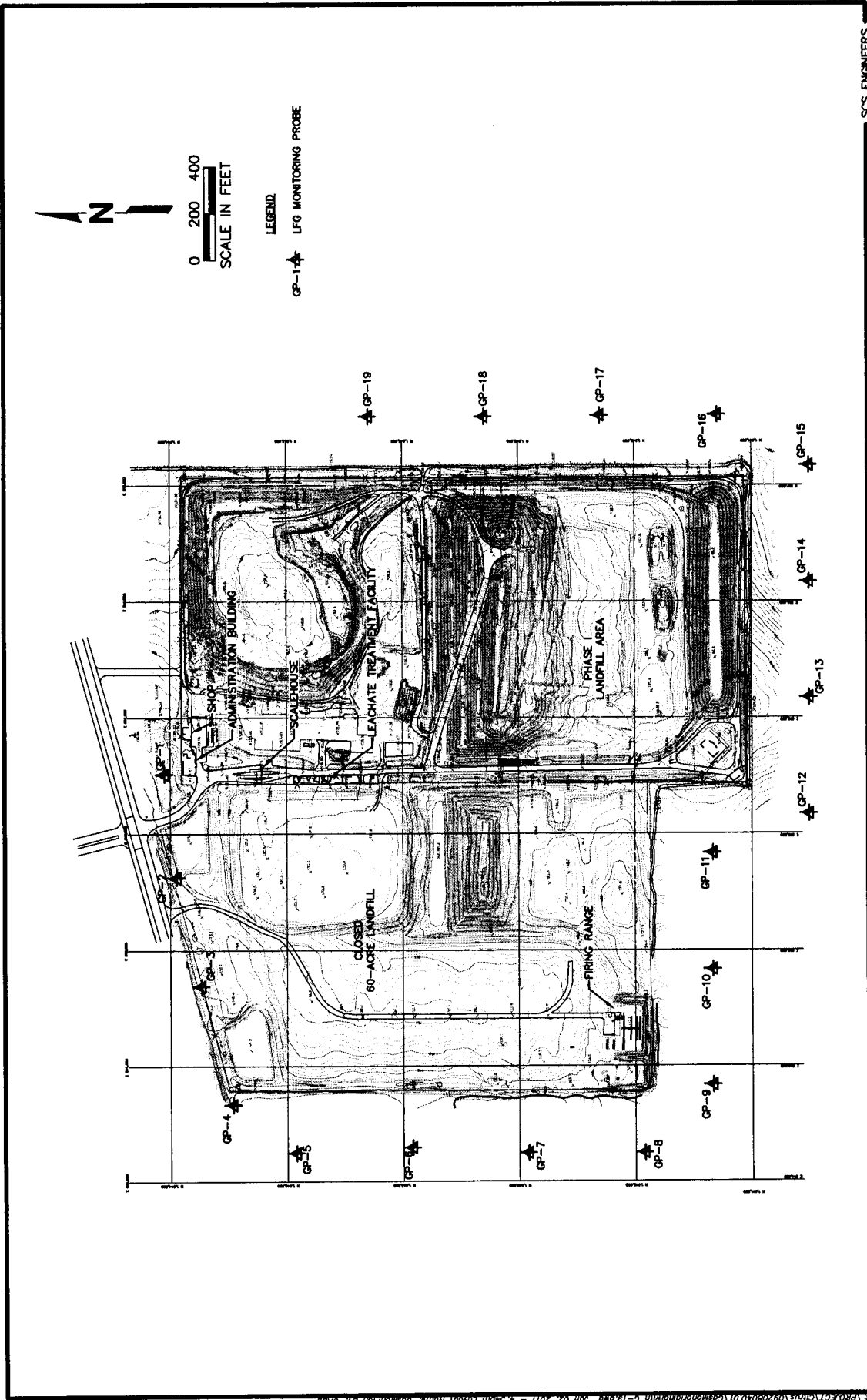
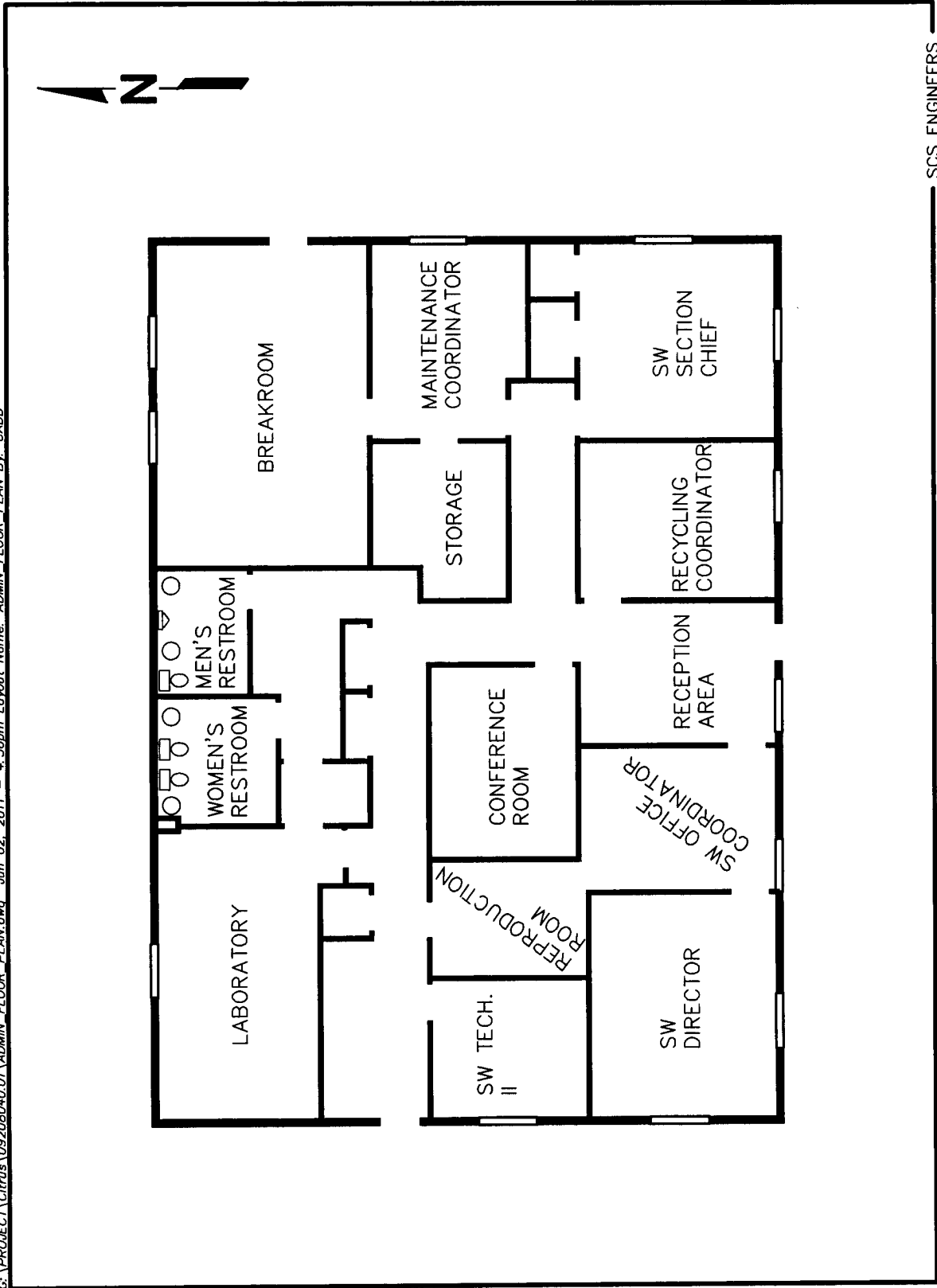

Figure 1. Landfill Gas Monitoring Probe Locations, Central Landfill, Citrus County, Florida

G:\PROJECT\Citrus\09208040.01\ADMIN_FLOOR_PLAN.dwg Jun 02, 2011 - 4:36pm Layout Name: ADMIN_FLOOR_PLAN.Br. CADD



SCS ENGINEERS

Figure 2. Administration Building Floor Plan

G:\PROJECT\Citrus\09208040.01\SCALEHOUSE_FLOOR_PLAN.dwg Jun 02, 2011 - 4:36pm Layout Name: SCALEHOUSE_FLOOR_PLAN.By: CADD

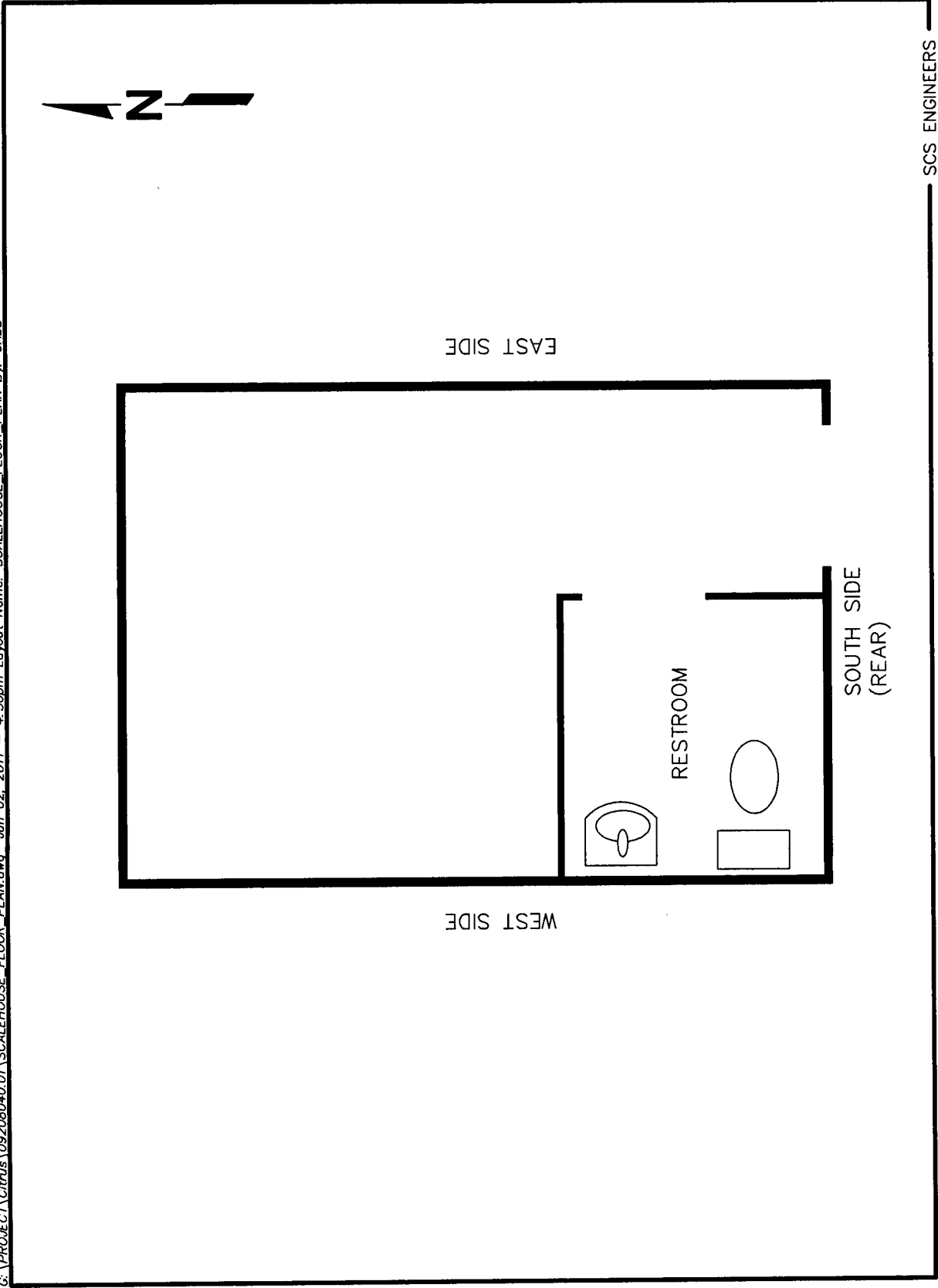

Figure 3. Scalehouse Floor Plan

ATTACHMENT 2
LFG MONITORING RESULTS

TABLE 1
LANDFILL GAS MIGRATION MONITORING, THIRD QUARTER 2015
CENTRAL LANDFILL, CITRUS COUNTY

Probe No.	CH ₄ (%)	CO ₂ (%)	O ₂ (%)	Balance (%)	Comments
GP-1	0.0	0.8	19.7	79.4	
GP-2	0.0	2.8	15.7	81.3	
GP-3	0.0	0.7	20.5	78.8	
GP-4	0.0	1.9	19.8	78.7	
GP-5	0.0	1.5	19.6	78.8	
GP-6	0.0	3.1	18.2	78.8	
GP-7	0.0	2.4	18.5	79.0	
GP-8	0.0	1.1	19.5	79.3	
GP-9	0.0	1.4	19.5	79.0	
GP-10	0.0	5.3	14.6	80.1	
GP-11	0.0	1.4	18.2	80.3	
GP-12	0.0	1.8	18.9	79.2	
GP-13	0.0	2.9	14.7	82.3	
GP-14	0.0	1.0	18.5	80.4	
GP-15	0.0	1.1	19.8	78.9	
GP-16	0.0	1.3	19.2	79.5	
GP-17	0.0	4.3	14.4	81.0	
GP-18	0.0	0.6	20.1	79.2	
GP-19	0.0	0.9	20.2	78.9	

On Site	CH ₄ (%)	% LEL
Scalehouse	0.0	0.0
Shop	0.0	0.0
Administration Building	0.0	0.0
Treatment Facility	0.0	0.0
Firing Range	0.0	0.0

Notes:

1. Monitoring performed by SCS Engineers (813) 621-0080 on: 8/24/2015
2. Temperature: 88 deg F
3. Barometric Pressure: 29.92 in. Hg

GEM-2000 Field Calibration Data Sheet

GEM-2000 Instrument Data

Instrument Serial No.: GM08790
 Technician Name: Alyson Dagle
 Date and Time: 8/24/2015 12:40
 Last Factory Calibration Date: October 2014

Calibration Gas Manufacturer's Data

Manufactured by: Landtec
 Manufactured date: LAN-399-2
 Lot Number: March 2018
 Expiration Date:

Prior to taking any measurements the instrument must undergo a full calibration according to manufacturer's instructions. This should then be followed by a calibration verification using ambient air and calibration gas to verify instrument performance prior to measurement.

Tabulated below are the acceptable gas concentrations that should be demonstrated when zeroing the instrument and calibrating the span gas concentrations.

Zero Gas Composition			
CH ₄ (%)	CO ₂ (%)	N ₂ (%)	O ₂ (%)
0.0	0.0	0.0	0.0 (Calibration Gas)

Span Gas Composition			
CH ₄ (%)	CO ₂ (%)	N ₂ (%)	O ₂ (%)
50.0	35.0	15.0	20.1 (Ambient Air)

Calibration must be verified by conducting the following procedures:

- 1) Turn on the instrument and allow it to run and purge with ambient air for 3 minutes and then record the gas concentration readings.
- 2) Apply calibration gas to the instrument, wait 1 minute for the readings to stabilize and then record the gas concentration readings.
- 3) Determine if the reading is within 10% of calibration gas concentration. If so indicate that the instrument "Passes" the field calibration for that gas.
- 4) If any of the sensors display a reading outside of the acceptable range, then a full manufacturer's calibration must be performed.

Target Gas (%)	Ambient Air Purge Gas Readings (%)	Acceptable Ambient Air Range (%)	Calibration Gas Instrument Readings (%)	Acceptable Calibration Gas Range (%)	Pass/Fail
CH ₄	0.0	0.0 - 0.3	48	47.0 - 53.0	Pass
CO ₂	0.0	0.0 - 0.3	36	32.0 - 38.0	Pass
O ₂	20.8	19.9 - 21.9	0.2	0.0 - 1.0	Pass