

**BLOWER BLDG. FOUNDATION PLAN**  
SCALE: 3/16" = 1'-0"

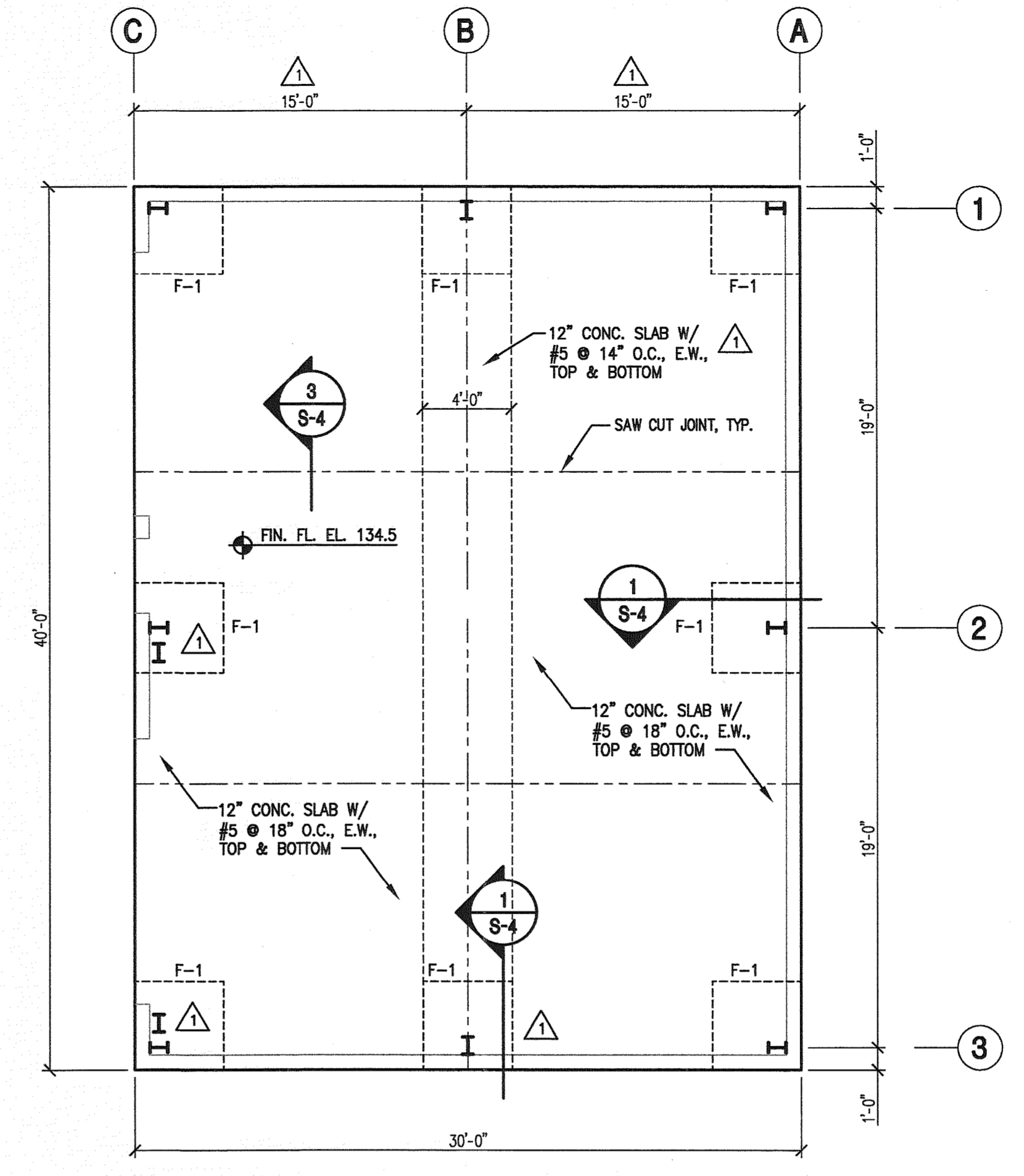

**STORAGE BLDG. FOUNDATION PLAN**  
SCALE: 3/16" = 1'-0"

FOOTING SCHEDULE			
NO.	SIZE	REINFORCEMENT	REMARKS
F-1	4'-0" X 4'-0" X 2'-0"	(4) #5 E.W., TOP & BOTTOM	COLUMN FTG.
F-2	14'-0" X 14'-0" X 2'-0"	#5 @ 18" O.C., E.W. TOP #8 @ 18" O.C., E.W. BOTTOM	FLARE PAD
F-3	6'-0" X 12'-0" X 1'-0"	#5 @ 18" O.C., E.W., TOP & BOTTOM	GENERATOR PAD

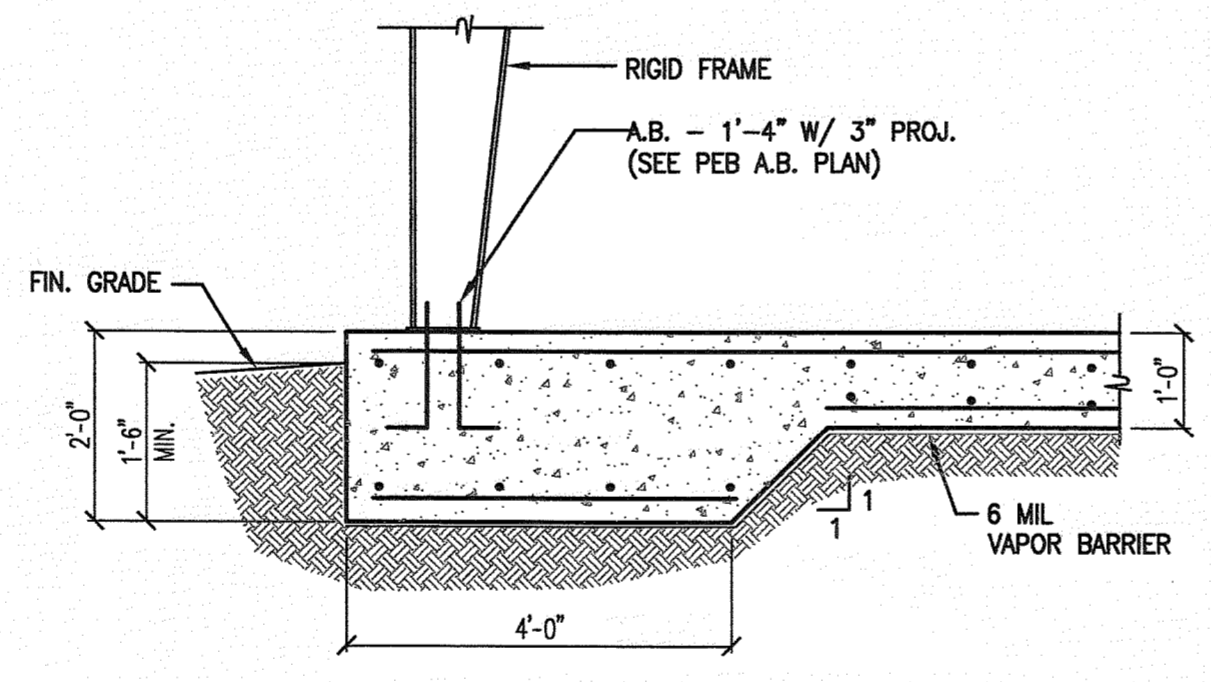

**1 EXTERIOR COLUMN FOOTING**  
SCALE: 1/2" = 1'-0"

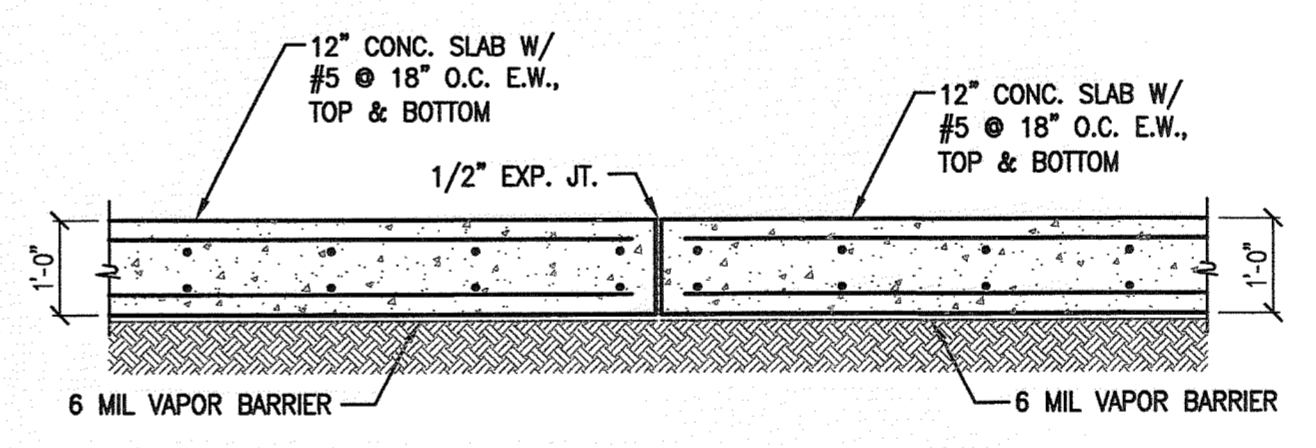

**2 SEALED EXPANSION JOINTS**  
SCALE: N.T.S.

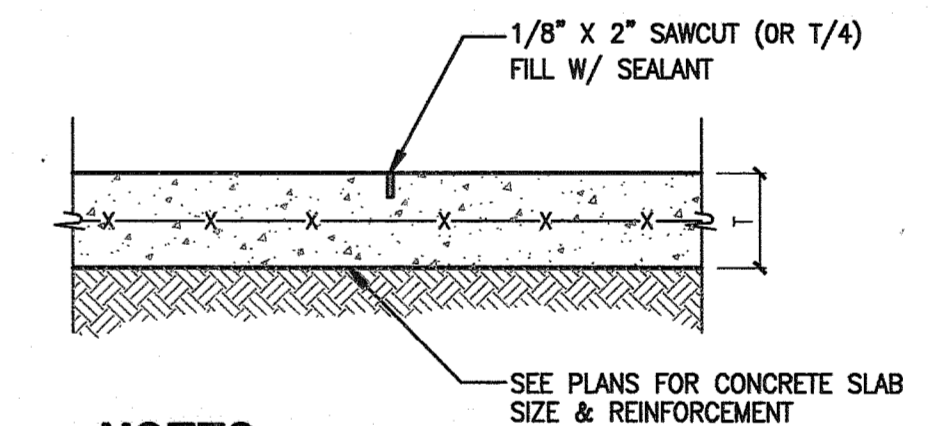

**NOTES:**  
 - INSTALL CONTROL JOINT IN A STRAIGHT LINE  
 - INSTALL CONTROL JOINT WHILE CONCRETE IS WET OR AS SOON AS IT CAN BE WALKED ON  
 - INSTALL CONTROL JOINT IN SECTIONS NOT EXCEEDING 400 S.F. OF SLAB AREA  
 - THE RATIO OF LENGTH-TO-WIDTH OF PANELS WITHIN THE CONTROL JOINTS SHALL NOT EXCEED 1.5 (i.e. ON 4' SIDEWALK SPACING SHOULD NOT BE MORE THAN 6')

**3 TYPICAL CONTROL JOINT**  
SCALE: N.T.S.

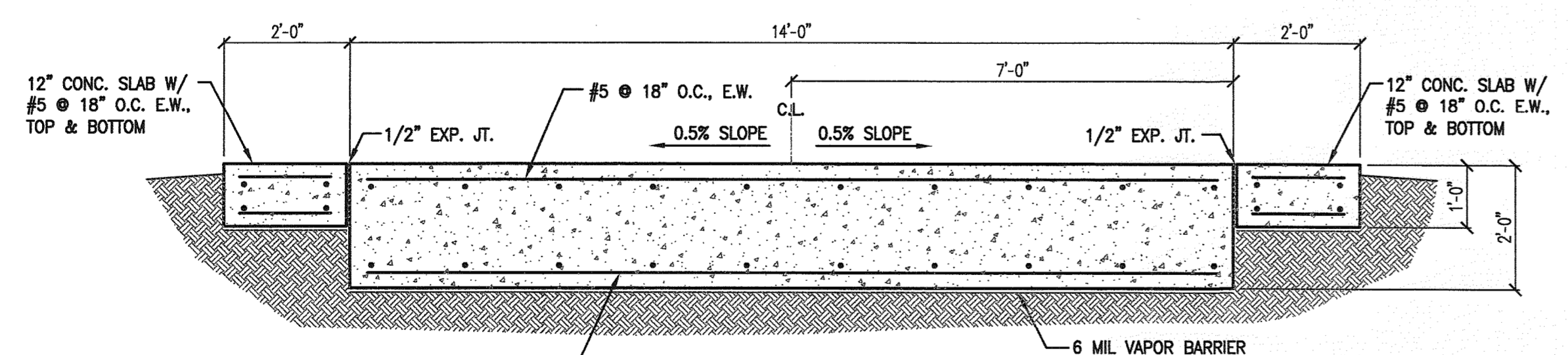

**4 FLARE PAD**  
SCALE: 1/2" = 1'-0"

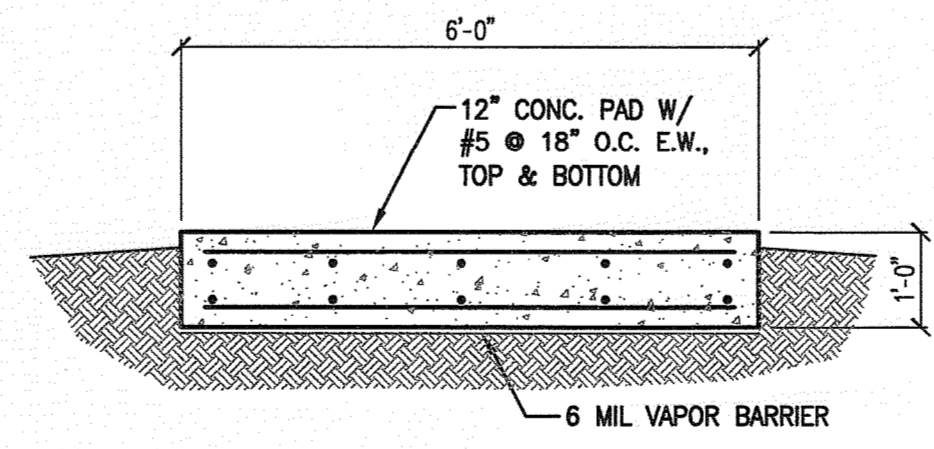

**5 GENERATOR PAD**  
SCALE: 1/2" = 1'-0"

REV	DATE	DESCRIPTION	BY
1	4/21/09	COLUMN CHANGE - PER OWNER	BE
2	4/15/10	REVISED FOR THE RECORD	BE
3			
4			
5			

DRAWING TITLE: **BLOWER/STORAGE BUILDINGS FOUNDATION PLAN**  
 PROJECT: **SOUTHEAST COUNTY LANDFILL LANDFILL GAS COLLECTION AND CONTROL SYSTEM**

CLIENT: **HILLSBOROUGH COUNTY SOLID WASTE MANAGEMENT DEPARTMENT TAMPA, FLORIDA**

SCS ENGINEERS  
 STEARNS, CONRAD AND SCHMIDT  
 CONSULTING ENGINEERS  
 4041 Park Oaks Blvd, Suite 100, Tampa, FL 33610  
 PH (813) 821-0880 FAX NO. (813) 823-8257  
 FLORIDA CERTIFICATE OF AUTHORIZATION NO. 00004882  
 PROJ. NO. 09207055.00  
 DWN. BY: DEG  
 CHK. BY: EAB  
 Q/A R/W BY: EAB  
 APP. BY: EAB

CADD FILE: BE-3531 - S-4  
 DATE: JULY 2008  
 SCALE: AS SHOWN  
 DRAWING NO. S-4 of 30

**RECORD DRAWING**  
DATE: APRIL 15, 2010

ELIZABETH A. BROADWAY  
 PROFESSIONAL ENGINEER  
 FLORIDA REGISTRATION NO. 38558

**BROADWAY ENGINEERING, P.A.**  
 CIVIL, MECHANICAL, STRUCTURAL AND BUILDING DESIGN  
 See Us At www.Broadway-Eng.com  
 1335 W. Cass Street  
 Tampa, Florida 33606 813-251-9244  
 Fax 813-251-9330 EMail: info@broadway-eng.com  
 BE-8531 Certificate of Authorization No. 4599

C:\Users\ADMINISTRATOR\AppData\Local\Temp\Apr 15 2010 - 8:49pm Layout Name: S-4.dwg 00004882.dwg